

# Eve Colour Selection

Date MARCH 14, 2007

3515 Kariya Drive, Mississauga, ON. Suite # 307 Unit # 6 Level 3 Floorplan L

Purchaser(s): 2044458 ONTARIO INC.

## Kitchen:

- ☐ A ☐ B ☒ C  
☒ Added Height Upper Cabinets ☐ 1 1/4" Granite Countertop ☐ White (cabinet only)  
☐ Valance Lighting ☐ Under-mount Kitchen Sink

## Appliances:

- ☐ White ☐ Black ☒ Stainless  
☐ Fridge Waterline Upgrade Model # \_\_\_\_\_

## Main Bathroom:

- ☐ D ☐ E ☐ F ☐ G ☐ H ☒ I  
☐ J Stone Vanity Countertop ☐ Shower Stall ☐ Jetted Tub ☐ Under-Mount sink

## Master Ensuite:

- ☐ D ☐ E ☐ F ☐ G ☐ H ☐ I  
☐ J Stone Vanity Countertop ☐ Shower Stall ☐ Jetted Tub ☐ Under-Mount sink

## Hardwood:

- ☐ K ☐ L ☒ M ☒ Living Room/Dining Room/ Hallway ☐ Den  
☐ Master Bedroom ☐ 2<sup>nd</sup> Bedroom ☐ 3<sup>rd</sup> Bedroom ☐ Entry ☐ Kitchen

## Carpet:

- ☐ N ☐ O ☒ P

## Venetian Blinds:

- ☐ Supply and install Venetian blinds.

## Miscellaneous:

# Eve Colour Selection

3515 Kariya Drive, Mississauga, ON. Suite # 307 Unit # 6 Level 3  
Purchaser(s). 2044458 ONTARIO INC.

floorplan I:

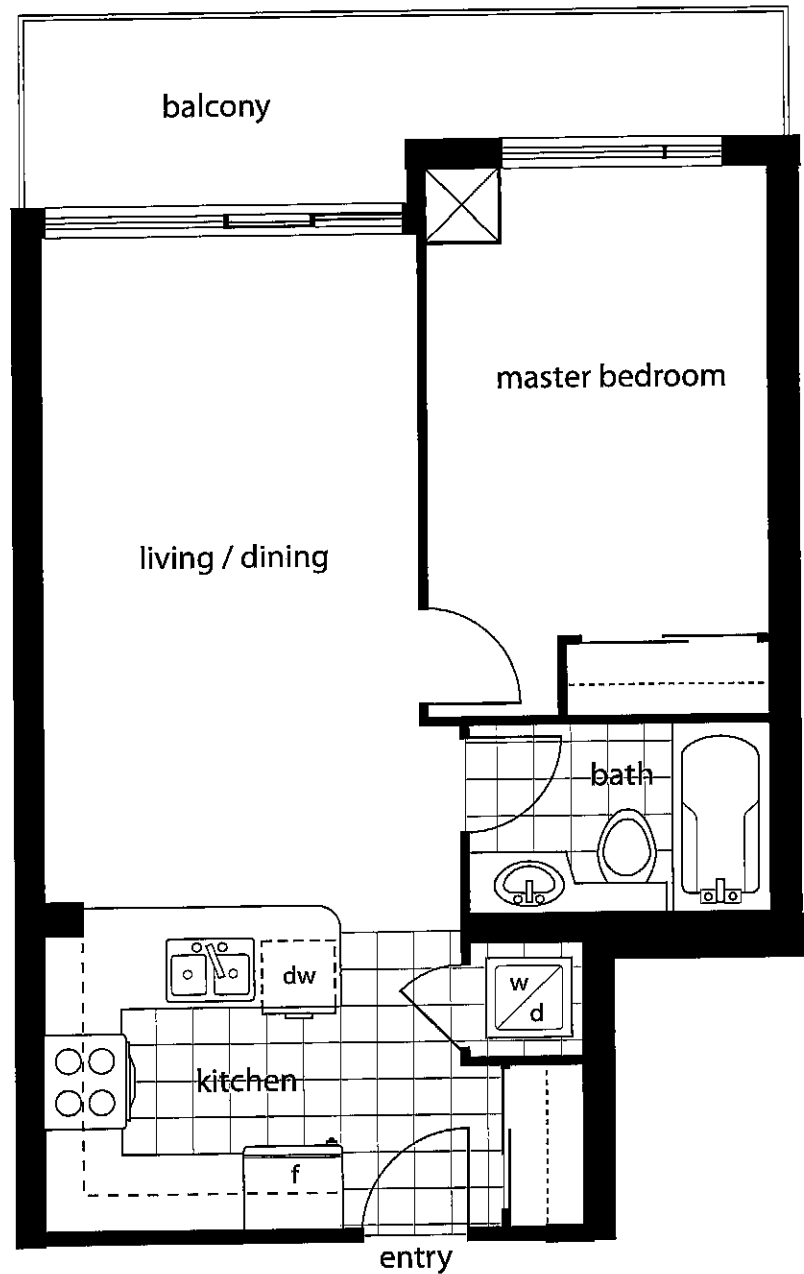

The floor plan shown above is for reference purposes only. This plan is not to scale and is subject to architectural review and revision, including, without limitation, the Unit being constructed with a layout that is the reverse of that set out above. All details and dimensions, if any, are approximate, and subject to change without notice in order to comply with building site conditions, municipal, structural, Vendor and/or architectural requirements. Balconies and Terraces are exclusive use common elements, shown for display purposes only and location and size vary according to applicable floor plan design layout. Materials, specifications, floor plans and dimensions are subject to change without notice. Window size and type may vary. E & O.E.