

Elle Construction Colour Scheme
3525 Kariya Drive
Suite 1705, Level 14, Unit 4

CABINETRY AND COUNTERTOPS

| | |
|---|--|
| KITCHEN CABINET | Cartier 318 Maple Pecan |
| <input type="checkbox"/> 42" Upper Cabinets | <input type="checkbox"/> White Cabinet Only <input type="checkbox"/> Valence Lighting |
| MAIN BATH CABINET | White Shaker |
| ENSUITE CABINET | |
| KITCHEN COUNTERTOP | Ciot Baltic Brown 3/4" Granite Slab Single Square Profile Edge |
| <input type="checkbox"/> 1 1/4" Granite Counter Top | <input type="checkbox"/> Under-Mount Kitchen Sink |
| MAIN BATH COUNTERTOP | Wilsonart 4823-60 Antique Brush |
| <input type="checkbox"/> Stone Vanity Counter Top | <input type="checkbox"/> Shower Stall <input type="checkbox"/> Jetted Tub <input type="checkbox"/> Undermount Sink |
| ENSUITE COUNTERTOP | |
| <input type="checkbox"/> Stone Vanity Counter Top | <input type="checkbox"/> Shower Stall <input type="checkbox"/> Jetted Tub <input type="checkbox"/> Undermount Sink |

| | |
|------------|-----------|
| APPLIANCES | Stainless |
|------------|-----------|

TILES

| | |
|---------------------------|---|
| ENTRY FLOOR TILE | Olympia Regal Beige Matte 12" x 12" |
| KITCHEN FLOOR TILE | Olympia Regal Beige Matte 12" x 12" |
| KITCHEN BACKSPLASH | Olympia Yukon Glossy Bisquit Y10 3" x 6" |
| BATHROOM FLOOR TILE | Olympia Keliker Cream 13" x 13" |
| BATHROOM WALL TILE | Olympia Gatineau Vertical Stack Bone Matte 4" x 16" |
| BATHROOM WALL ACCENT TILE | Olympia Cannes Beige Tumble Marble Mosaic 1" x 1" |
| ENSUITE FLOOR TILE | |
| ENSUITE WALL TILE | |
| ENSUITE WALL ACCENT TILE | |

HARDWOOD

| | | | |
|---|--------------------------------------|--------------------------------------|----------------------------------|
| Kultur Clique Sequoia Maple Lounge 4" Width | | | |
| <input checked="" type="checkbox"/> Living Room/Dining Room/Hallway | <input type="checkbox"/> Den | <input type="checkbox"/> Entry | <input type="checkbox"/> Kitchen |
| <input type="checkbox"/> Master Bedroom | <input type="checkbox"/> 2nd Bedroom | <input type="checkbox"/> 3rd Bedroom | |

CARPET

| |
|----------------------------|
| Peerless Excel Canvas 6304 |
|----------------------------|

ELECTRICAL

| | | | | |
|---|---|---|--|--|
| <input type="checkbox"/> Valence Lighting | <input type="checkbox"/> Electrical Outlets | <input type="checkbox"/> TV/Cable Outlets | <input type="checkbox"/> Phone Outlets | <input type="checkbox"/> Light Fixture |
|---|---|---|--|--|

VENETIAN BLINDS

| |
|--|
| <input checked="" type="checkbox"/> No |
|--|

NOTES

Elle Colour Selection

3525 Kariya Drive, Mississauga, ON. Suite # 1705 Unit # 4 Level 14
Purchaser(s) BORKA VUKOVIC AND SLOBODAN VUKOVIC

floorplan 5:

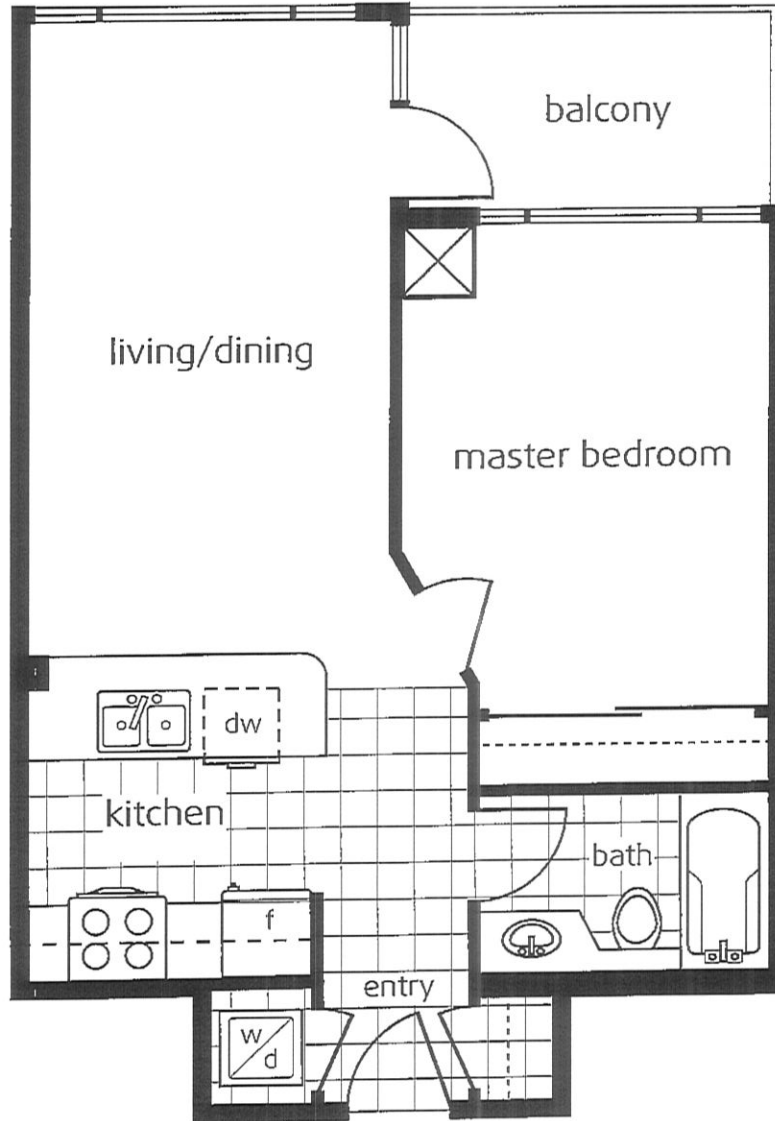

The floor plan shown above is for reference purposes only. This plan is not to scale and is subject to architectural review and revision, including, without limitation, the Unit being constructed with a layout that is the reverse of that set out above. All details and dimensions, if any, are approximate, and subject to change without notice in order to comply with building site conditions, municipal, structural, Vendor and/or architectural requirements. Balconies and Terraces are exclusive use common elements, shown for display purposes only and location and size vary according to applicable floor plan design layout. Materials, specifications, floor plans and dimensions are subject to change without notice. Window size and type may vary. E & O.E.