



CONSTRUCTION SUMMARY

4 - 1 - PRESTON 3 (35-8) ELEV A

Extras at Time of Sale

Note:

CABINETRY

Inv.761	1 - CABINET (CLASSIC)TO ACCOMODATE BUILT-IN OVEN (BOTTOM OF OVEN TO BE COUNTER LEVEL) ABOVE OVEN,A CABINET (DBL DOOR), INTERIOR OF CABINET TO HAVE SLOTS FOR BAKING PANS.CABINET TO GO TO BULKHEAD. BELOW STOVE,SMALL CUTLERY DRAWER, 2 DRAWERS (SEE SKETCH )
Line6937	Note: LOCATION OF OVEN TO BE NEXT TO OPTIONAL PANTRY (SEE SKETCH)
9May16 / 8Jun16	
Inv.761	1 - ADD A BANK OF DRAWERS (NEXT TO DISHWASHER), TO MATCH DRAWERS NEXT TO FRIDGE (SEE SKETCH)
Line6933	Note:
9May16 / 8Jun16	

CABINETRY - ACCESSORIES

Inv.761	1 - UNDER CABINET LIGHTING WITH VALANCE (CLASSIC) IN KITCHEN. (SEE SKETCH )
Line6940	Note:
9May16 / 8Jun16	

CABINETRY - PANTRY CABINETS

Inv.761	1 - OPTIONAL PANTRY(CLASSIC) TO GO TO BULKHEAD (SEE SKETCH A)
Line6939	Note:
9May16 / 8Jun16	

CABINETRY - UPPER CABINETS

Inv.761	1 - KITCHEN CABINETS-CLASSIC CABINETRY NEWPORT MAPLE SHALE-GREY
Line6930	Note:
9May16 / 8Jun16	

MISCELLANEOUS

Inv.761	1 - GAS LINE FOR COOK TOP AND BARBEQUE
Line6935	Note:
9May16 / 8Jun16	
Inv.761	1 - DELETE STOVE AREA., SUPPLY AND INSTALL GAS COOK TOP 30".CABINET BELOW WITH FALSE TOP DRAWER, AND 2-POTS AND PANS DRAWERS BELOW(CLASSIC). (SEE SKETCH C)
Line6932	Note:
9May16 / 8Jun16	
Inv.761	1 - DECOR HOOD WITH 600CFM FAN OVER GAS COOKTOP (SEE SKETCH )
Line6936	Note:
9May16 / 8Jun16	

WALL - INTERIOR

Inv.761	1 - CLOSE WALL BETWEEN COUNTRY KITCHEN AND FAMILY ROOM. MAKE OPEN PASS THROUGH AN ENTRY WAY FROM FAMILY ROOM INTO THE COUNTRY KITCHEN (SEE SKETCH.)
Line6929	Note:
9May16 / 8Jun16	



**CONSTRUCTION SUMMARY**

**4 - 1 - PRESTON 3 (35-8) ELEV A**

ЕТСН"А





**FRENDEL**  
KITCHENS LIMITED

1350 Sheppard Drive, Mississauga, ON L4W 1C5

**BAYVIEW WELLINGTON  
VICTORIA VILLAGE  
MODEL: 35-8 (PRESTON 3)**

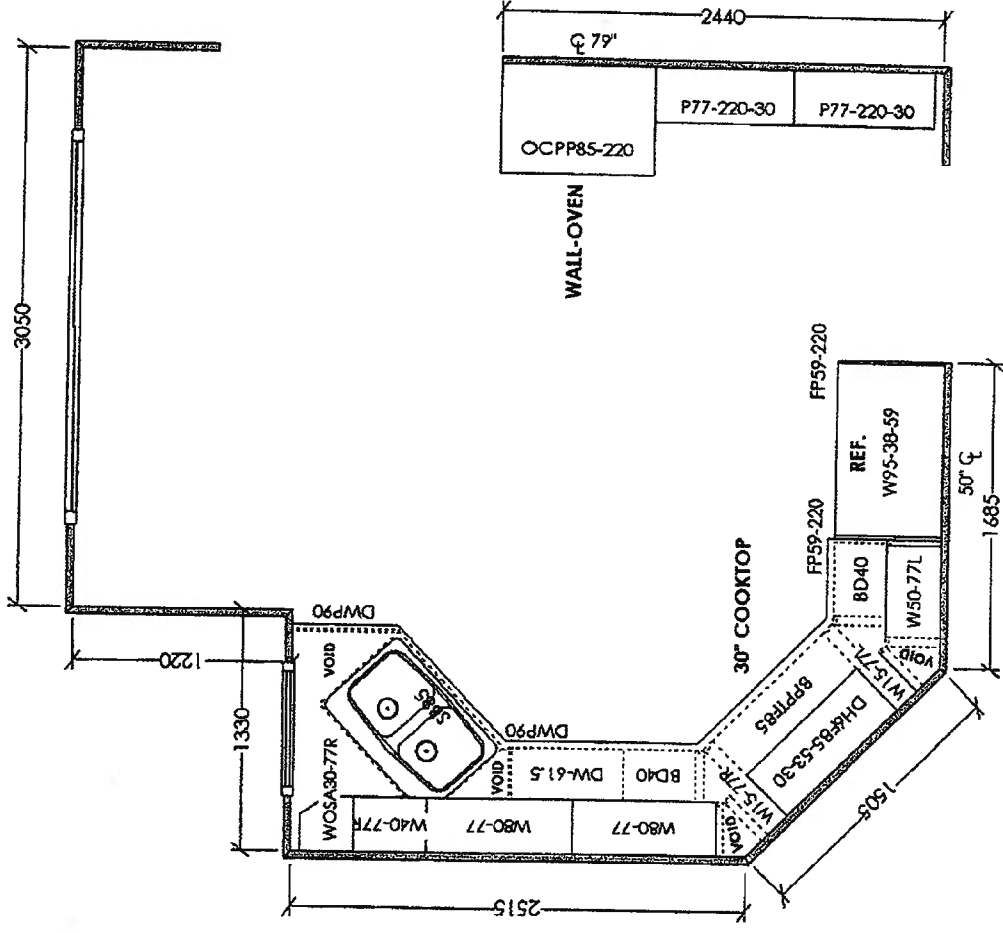

THIS SKETCH IS FOR DESIGN PURPOSES ONLY.  
IT IS NOT AN EXACT RENDITION.



F R E N D E L  
K I T C H E N S L I M I T E D

1350 Shawson Drive, Mississauga, ON L4W 1C5

Tel: (905) 470-7898  
Fax: (905) 470-1986  
www.frendel.com

BAYVIEW WELLINGTON  
VICTORIA VILLAGE  
MODEL: LOT 4 (35-8, PRESTON 3)

Sketch A.

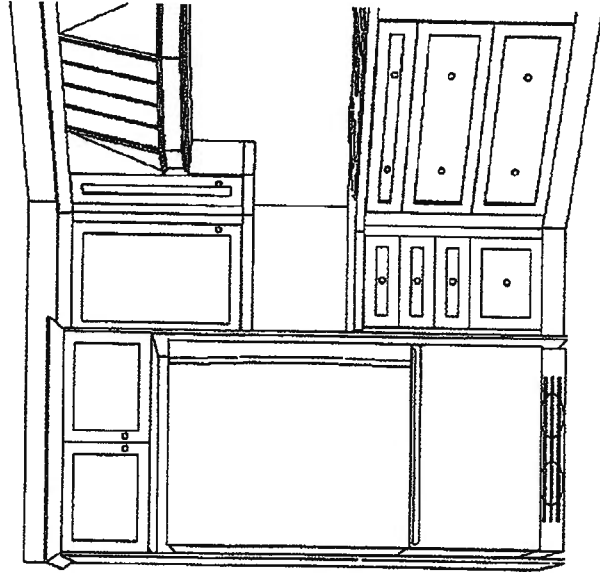
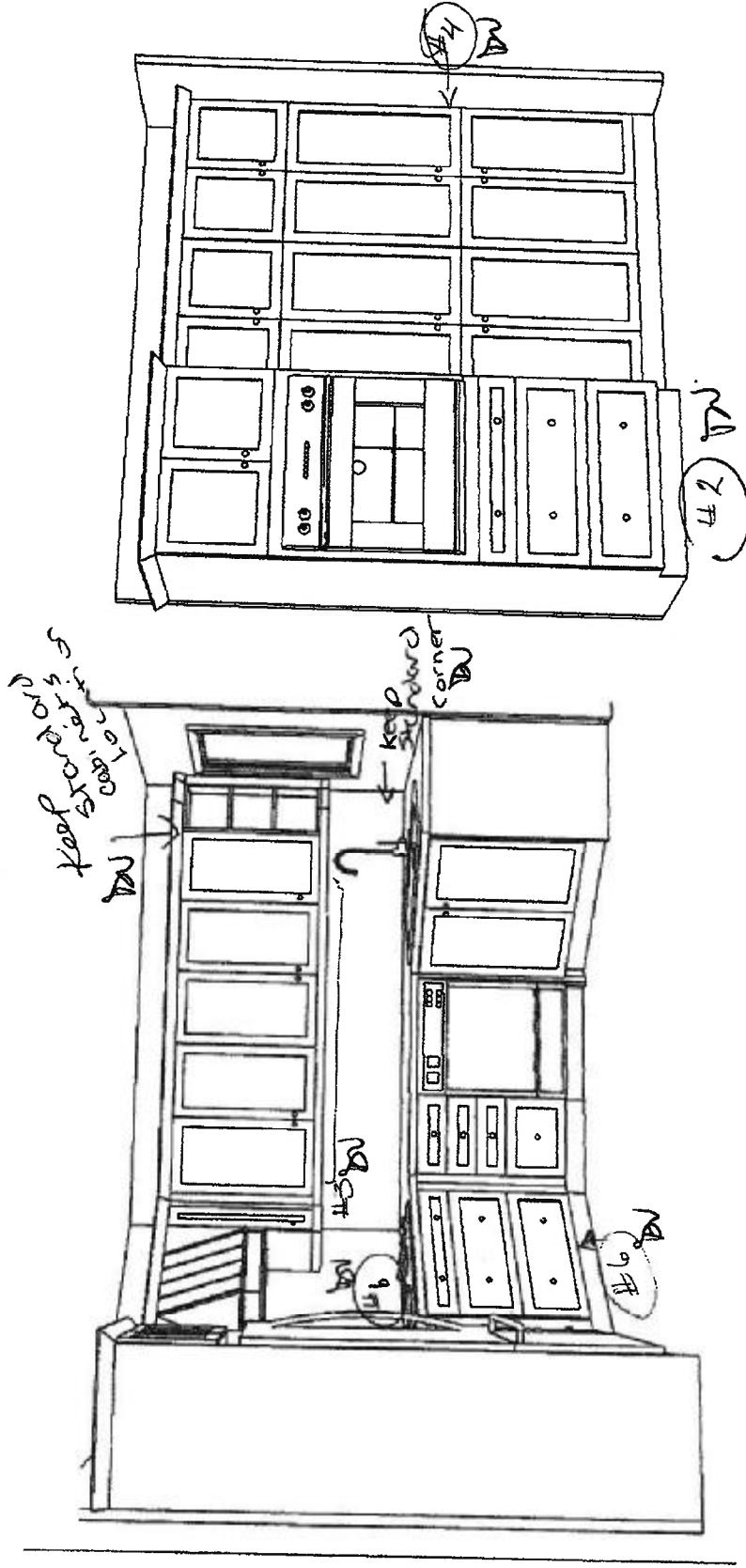

5/19/2016

THIS SKETCH IS FOR DESIGN PURPOSES ONLY.  
IT IS NOT AN EXACT RE rendition.