

GOEMANS APPLIANCES

1-877-463-6267

HST # 105167993

WWW.GOEMANS.COM

Find us on Facebook at www.facebook.com/GoemansAppliances

PACKING SLIP

HB00016435-1

Salesperson: JASON NG
Purchase Date: 10/07/17
Invoice Finished Date:
Delivery/Pickup Date: Jul 02, 2018
Invoice Type: VBL
Date Printed: Oct 11, 2017
Page: 1

ONLINE BANKING ACCOUNT

BILL TO: 4168177360

CHEN & JIAO, MING & CAROL

220 INVERNESS WAY

LOT # 118

BRADFORD, ON L3Z 0W6

TEL# (416) 817-7360 BUS# (905) 251-2882

Directions: 6TH LINE & SIMCOE ROAD

SHIP TO: 4168177360

CHEN & JIAO, MING & CAROL

220 INVERNESS WAY

LOT # 118

BRADFORD, ON L3Z 0W6

TEL# (416) 817-7360 BUS# (905) 251-2882

QTY	LOC	MODEL #	SERIAL #	COLOUR	BRAND - DESCRIPTION
1		JS48PPDUDE'			
-1		P-CJEN-1710-20P			
1		P-CJEN-1710-750			
1		JGRP436WP			
-1		P-CJEN-1710-20P			
1		P-CJEN-1710-600			
1		JXW9036WP			
-1		P-CJEN-1710-20P			
1		JDTSS244GP			
-1		P-CJEN-1710-20P			
1		JMC2430DP			
-1		P-CJEN-1710-20P			
1		WM9000HVA		GRAPHITE	LGE, WAFL: WASHER, FRONT LOAD, LARGE CAPA 6 CU FT, STEAM WASHER, FRONT LOAD
		STANDARD HOSES SHIP WITH THIS UNIT			
1		DLEX9000V		GRAPHITE	LGE, DREFL: DRYER, ELECTRIC - TO MATCH LAR 9 CU FT ELECTRIC DRYER, SS DRUM
1		WD200CV		GRAPHITE	LGE, WAFC: WASHER, FRONT LOAD, COMPACT 29 GRAPHITE STEEL SIDEKICK, 1.1 CU.FT., 700RPM,
1		WDP5V		GRAPHITE	LGE, ALAU: ACCESSORY, LAUNDRY 13.6 PEDESTAL, 29W, POCKET HANDLE, FOR 8000 PAIR
This special order or clearance product requires a 50% deposit & is considered FINAL SALE.					
x_____					

- All products remain the property of Goemans until paid in full.
- Removal of old appliances at owner's risk and must be disconnected.
- Please refer to delivery/installation brochures for important details.
- All authorized returned products will be subject to a restocking charge.
- Interest of 18% per annum will be charged on overdue accounts.
- Upon delivery customer agrees to accept service in accordance with manufacturer's warranty.
- This sales invoice is based on delivery within 12 months from date of purchase. After 12 months (or if market conditions adversely change) Goemans reserves the right to review pricing/delivery on this order and offer our customers options to accommodate these changes. Any & all date sensitive supplier promotions are exempt from the 12 month price guarantee and must be taken by the promotional delivery deadline.

WHITE CUSTOMER COPY

PINK GOEMANS COPY

GOEMANS APPLIANCES

1-877-463-6267

HST # 105167993

WWW.GOEMANS.COM

Find us on Facebook at www.facebook.com/GoemansAppliances

PACKING SLIP

HB00016435-1

Salesperson:	JASON NG
Purchase Date:	10/07/17
Invoice Finished Date:	
Delivery/Pickup Date:	Jul 02, 2018
Invoice Type:	VBL
Date Printed:	Oct 11, 2017
Page:	2

ONLINE BANKING ACCOUNT

BILL TO: 4168177360

CHEN & JIAO, MING & CAROL
220 INVERNESS WAY
LOT # 118
BRADFORD, ON L3Z 0W6

TEL# (416) 817-7360 BUS# (905) 251-2882

Directions: 6TH LINE & SIMCOE ROAD

SHIP TO: 4168177360

CHEN & JIAO, MING & CAROL
220 INVERNESS WAY
LOT # 118
BRADFORD, ON L3Z 0W6

TEL# (416) 817-7360 BUS# (905) 251-2882

QTY	LOC	MODEL #	SERIAL #	COLOUR	BRAND - DESCRIPTION
1		P-DELIVERY \$5,000-9,999			
-1		SALES DELIVERY ALLOWANCE Payment			MASTER CARD

- All products remain the property of Goemans until paid in full.
- Removal of old appliances at owner's risk and must be disconnected.
- Please refer to delivery/installation brochures for important details.
- All authorized returned products will be subject to a restocking charge.
- Interest of 18% per annum will be charged on overdue accounts.
- Upon delivery customer agrees to accept service in accordance with manufacturer's warranty.
- This sales invoice is based on delivery within 12 months from date of purchase. After 12 months (or if market conditions adversely change) Goemans reserves the right to review pricing/delivery on this order and offer our customers options to accommodate these changes. Any & all date sensitive supplier promotions are exempt from the 12 month price guarantee and must be taken by the promotional delivery deadline.

WHITE CUSTOMER COPY

PINK GOEMANS COPY

48" SIDE-BY-SIDE REFRIGERATORS WITH ICE & WATER DISPENSER

JS48PPDUDE – 48³/₈" x 83³/₈" x 27³/₄" (with handles)**JS48SSDUDE** – 48³/₈" x 83³/₈" x 27¹/₈" (with handles)

PRODUCT DIMENSIONS

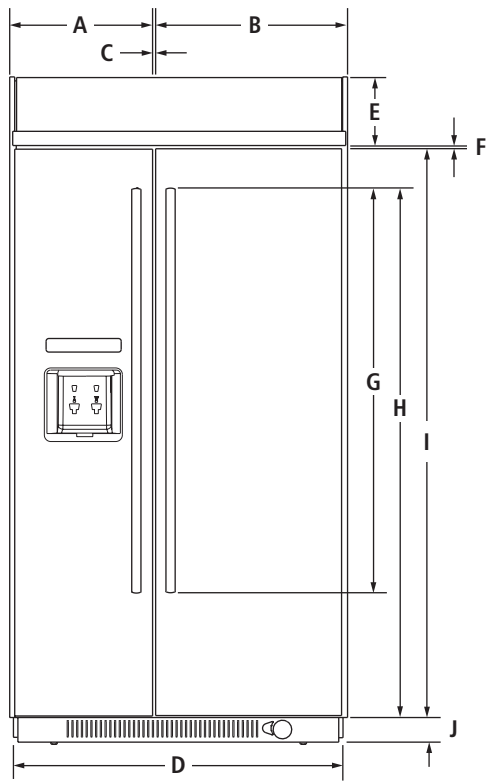

FRONT VIEW

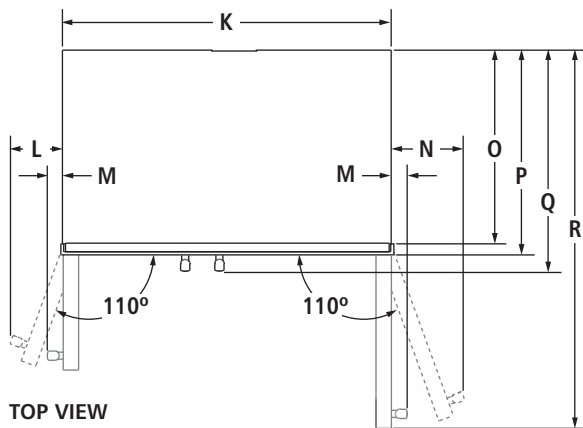

TOP VIEW

MODEL #		JS48PPDUDE JS48SSDUDE	
		in	cm
A	Width of freezer door (including hinge side offset)	20	50.8
B	Width of refrigerator door (including hinge side offset)	27	68.6
C	Space between doors	³ / ₈	1.0
D	Overall width (Including side trim)	48 ³ / ₈	122.9
E	Height of top grille	8 ³ / ₈	21.7
F	Space between doors and top grille	³ / ₈	1.0
G	Height of handles		
	Pro-Style® Stainless	45 ⁹ / ₁₆	115.7
	Euro Style Stainless	50	127.1
H	Height to top of handles		
	Pro-Style® Stainless	63 ¹¹ / ₁₆	163.5
	Euro Style Stainless	65 ³ / ₄	167.0
I	Height of doors	71	180.2
J	Height of bottom grille	3	7.6
K	Width of recessed refrigerator	47	119.4
L	Width from side of refrigerator to freezer handle – door fully open 110°		
	Pro-Style® Stainless	8 ³ / ₈	21.3
	Euro Style Stainless	8	20.3
M	Width from side of refrigerator to handle – door open 90°		
	Pro-Style® Stainless	2 ⁵ / ₈	6.7
	Euro Style Stainless	2	5.1
N	Width from side of refrigerator to refrigerator handle – door fully open 110°		
	Pro-Style® Stainless	10 ⁷ / ₈	27.6
	Euro Style Stainless	10 ¹ / ₄	26.1
O	Depth without doors	22 ¹ / ₈	56.2
P	Depth with doors	25 ¹ / ₈	63.8
Q	Depth with handles		
	Pro-Style® Stainless	27 ³ / ₄	70.5
	Euro Style Stainless	27 ¹ / ₈	68.8
R	Depth with refrigerator door open 90°	50 ¹³ / ₁₆	129.0

IMPORTANT: Dimensional specifications are provided for planning purposes only.

Do not make any cutouts based on this information. Refer to the Installation or Use & Care Guide before selecting cabinetry, verifying electrical/gas connections, making cutouts or beginning installation.

All Jenn-Air® appliances are appropriately UL, CUL or CSA approved.

48" SIDE-BY-SIDE REFRIGERATORS WITH ICE & WATER DISPENSER

JS48PPDUDE – 48³/₈" x 83³/₈" x 27³/₄" (with handles)JS48SSDUDE – 48³/₈" x 83³/₈" x 27¹/₈" (with handles)

DIMENSIONS AS INSTALLED

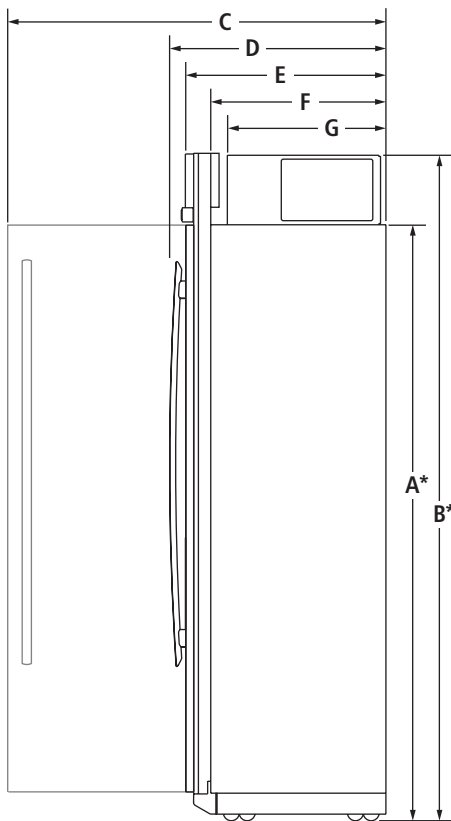

SIDE VIEW

MODEL #		JS48PPDUDE JS48SSDUDE	
		in	cm
A*	Height without compressor (min.)	74 ³ / ₈	188.9
B*	Height of recessed refrigerator (min.)	83 ³ / ₈	211.8
C	Depth with refrigerator door open 90° (min.)	51 ¹ / ₈	129.7
D	Depth with handles (min.)		
	Pro-Style® Stainless	27 ³ / ₄	70.5
	Euro Style Stainless	27 ¹ / ₈	68.8
E	Depth with doors (min.)	25 ¹ / ₈	63.8
F	Depth without doors (min.)	22 ¹ / ₈	56.2
G	Depth of compressor (min.)	19 ⁵ / ₈	49.8

*Add 1¹/₄" (3.2 cm) to the height dimension when leveling legs are fully extended.**IMPORTANT:** Dimensional specifications are provided for planning purposes only.

Do not make any cutouts based on this information. Refer to the Installation or Use & Care Guide before selecting cabinetry, verifying electrical/gas connections, making cutouts or beginning installation.

All Jenn-Air® appliances are appropriately UL, CUL or CSA approved.

48" SIDE-BY-SIDE REFRIGERATORS WITH ICE & WATER DISPENSER

JS48PPDUDE – 48³/₈" x 83³/₈" x 27³/₄" (with handles)JS48SSDUDE – 48³/₈" x 83³/₈" x 27¹/₈" (with handles)

OPENING/CLEARANCE DIMENSIONS

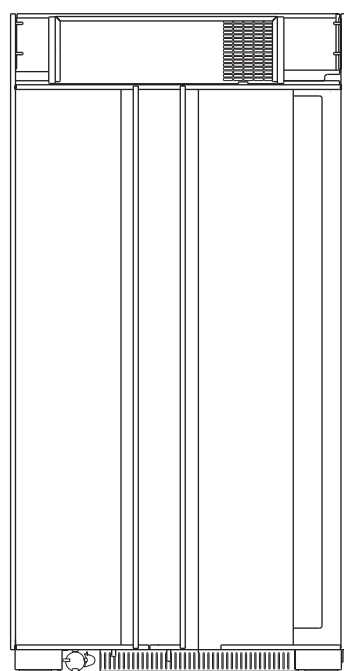
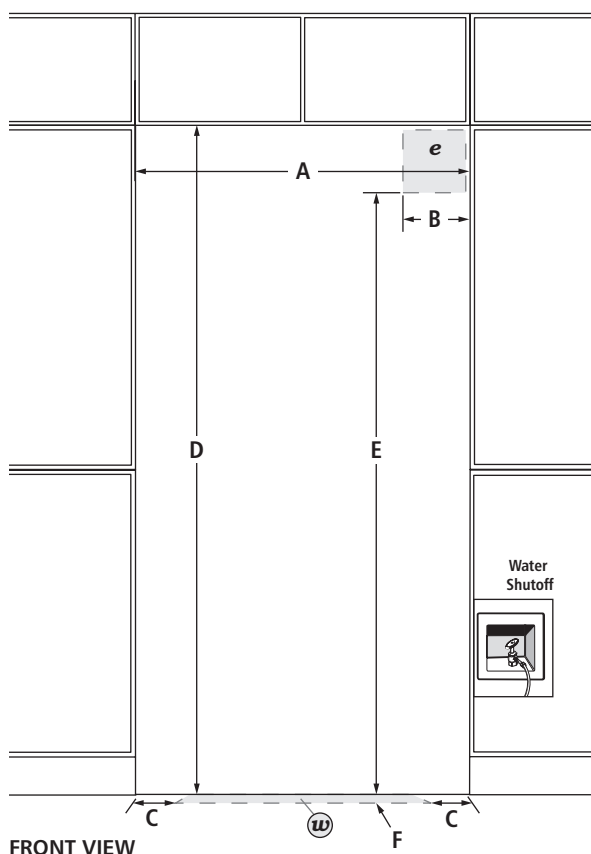

MODEL #		JS48PPDUDE JS48SSDUDE	
		in	cm
A	Width (min.)	47½	120.7
B	Width of recommended electrical location	13½	34.3
C	Distance from side of cabinet to recommended water connection location	6	15.2
D	Height (min.)	84	213.4
E	Height to recommended electrical location	77	195.6
F	Depth of recommended water connection location (max.)	1	2.5
e	Recommended electrical connection location		
w	Recommended water connection location		

ELECTRICAL REQUIREMENTS

115 volt, 60 Hz, AC only, 15- or 20-amp fused, grounded circuit is required. A dedicated circuit is recommended. Use an outlet that cannot be turned off by a switch.

Minimum length of power cord is 84" (213.4 cm). Do not use an extension cord.

WATER PRESSURE REQUIREMENTS

A cold water supply with water pressure between 30 and 120 psi (207 and 827 kPa) is required to operate the water dispenser and ice maker. Call a licensed, qualified plumber with any questions about the water pressure.

Reverse Osmosis Water Supply

IMPORTANT: The pressure of the water coming out of a reverse osmosis system going to the water inlet valve of the refrigerator needs to be between 30 and 120 psi (207 and 827 kPa).

If a reverse osmosis water filtration system is connected to the cold water supply, the water pressure to the reverse osmosis system needs to be a minimum of 40 to 60 psi (276 to 414 kPa).

LOCATION REQUIREMENTS

Floor must be able to support refrigerator (more than 600 lb [272 kg]) and contents of the refrigerator and must be at the same level as flooring in the room.

IMPORTANT: Dimensional specifications are provided for planning purposes only.

Do not make any cutouts based on this information. Refer to the Installation or Use & Care Guide before selecting cabinetry, verifying electrical/gas connections, making cutouts or beginning installation. All Jenn-Air® appliances are appropriately UL, CUL or CSA approved.

36" PRO-STYLE® GAS RANGES

JGRP536WP, JLRP536WP, **JGRP436WP**, JLRP436WP – 35⁷/₈" x 38³/₄" x 29¹/₄"

PRODUCT DIMENSIONS

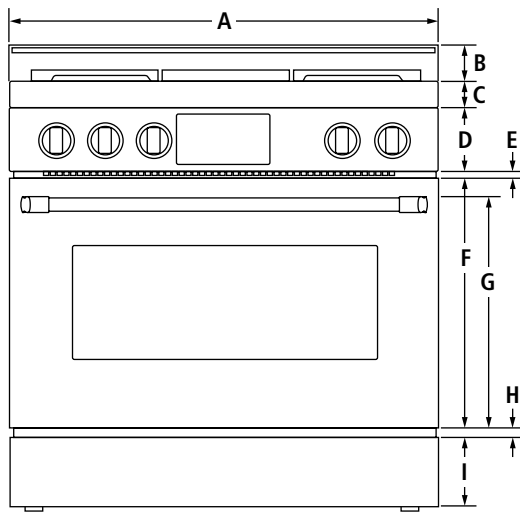

FRONT VIEW

MODEL #		JGRP536WP JLRP536WP JGRP436WP JLRP436WP	
		in	cm
A	Overall width	35 ⁷ / ₈	91.1
B	Height of island trim backsplash	3	7.6
C	Height of bullnose	2 ¹ / ₄	5.5
D	Height of control panel	5 ³ / ₈	13.5
E	Space between door and control panel	⁷ / ₈	2.0
F	Height of door	20 ³ / ₄	52.5
G	Height to top of handle	19 ³ / ₈	49.0
H	Space between door and lower panel	1	2.5
I	Height of lower panel	5 ¹ / ₂	14.0
J	Depth with control panel overhang	27 ³ / ₈	69.5
K	Depth with handle	29 ¹ / ₄	74.2
L	Depth with door fully open	45 ³ / ₄	116.2

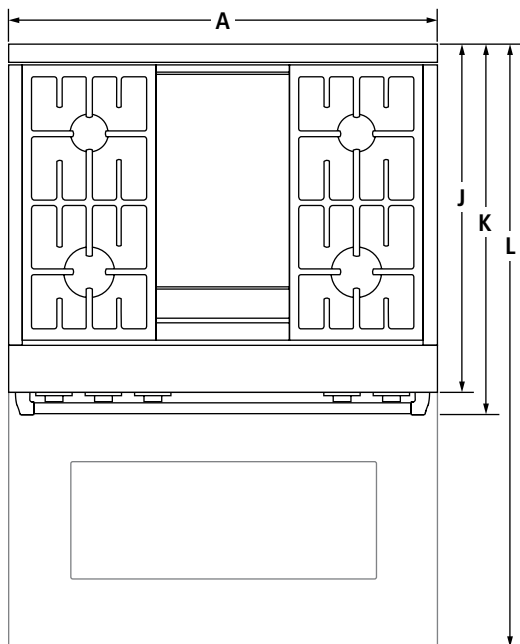

TOP VIEW

IMPORTANT: Dimensional specifications are provided for planning purposes only.Do not make any cutouts based on this information. Refer to the Installation Guide *before* selecting cabinetry, verifying electrical/gas connections, making cutouts or beginning installation.

All Jenn-Air® appliances are appropriately UL, CUL or CSA approved.

36" PRO-STYLE® GAS RANGES

JGRP536WP, JLRP536WP, JGRP436WP, JLRP436WP – 35⁷/₈" x 38³/₄" x 29¹/₄"

DIMENSIONS AS INSTALLED

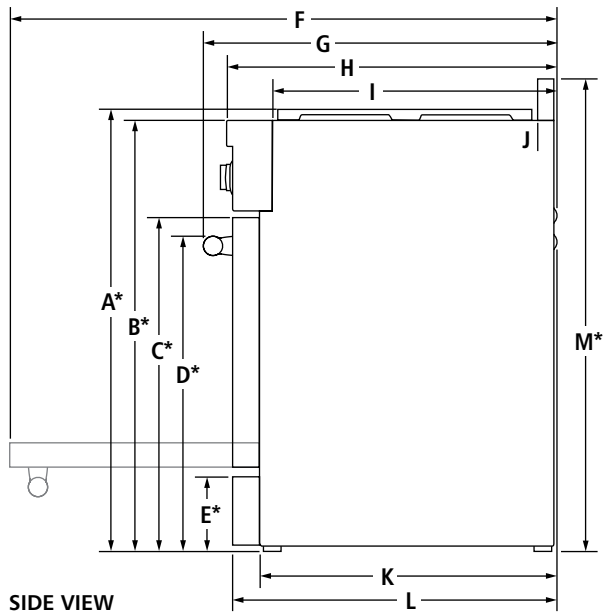

MODEL #		JGRP536WP JLRP536WP JGRP436WP JLRP436WP	
		in	cm
A*	Height to top of grates (min.)	36 ³ / ₄	93.3
B*	Height to top of cooking surface (min.)	35 ³ / ₄	90.8
C*	Height to top of door (min.)	27 ³ / ₈	69.5
D*	Height to top of handle (min.)	25 ⁷ / ₈	65.7
E*	Height to top of lower panel (min.)	5 ⁷ / ₈	14.9
F	Depth with door fully open	45 ³ / ₄	116.2
G	Depth with handle	29 ¹ / ₄	74.2
H	Depth with control panel overhang	27 ³ / ₈	69.5
I	Depth without control panel	23 ¹ / ₂	59.5
J	Depth of island trim backsplash	2 ¹ / ₄	5.7
K	Depth without door	24 ⁵ / ₈	62.5
L	Depth with door	26 ³ / ₄	68.0
M*	Height to top of island trim backsplash (min.)	38 ³ / ₄	98.4

*Add 1³/₄" (4.4 cm) to the height dimension when leveling legs are fully extended.

IMPORTANT: Dimensional specifications are provided for planning purposes only.

Do not make any cutouts based on this information. Refer to the Installation Guide *before* selecting cabinetry, verifying electrical/gas connections, making cutouts or beginning installation.

All Jenn-Air® appliances are appropriately UL, CUL or CSA approved.

36" PRO-STYLE® GAS RANGES

JGRP536WP, JLRP536WP, JGRP436WP, JLRP436WP – 35⁷/₈" x 38³/₄" x 29¹/₄"

OPENING/CLEARANCE DIMENSIONS

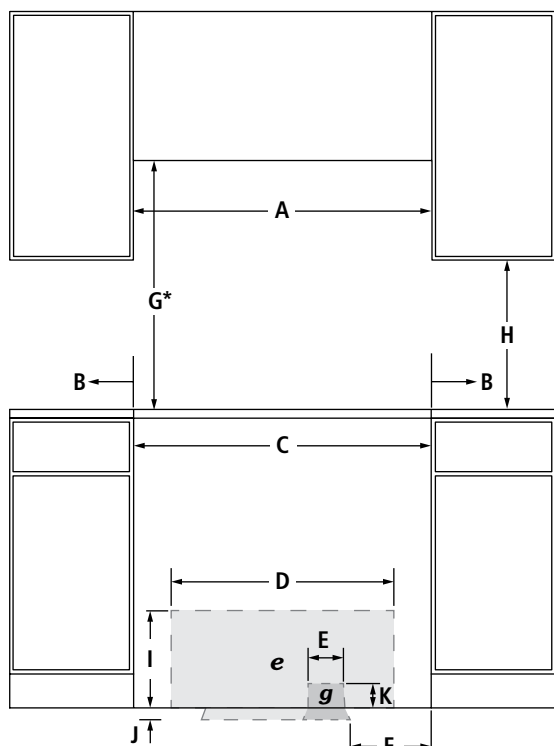

FRONT VIEW

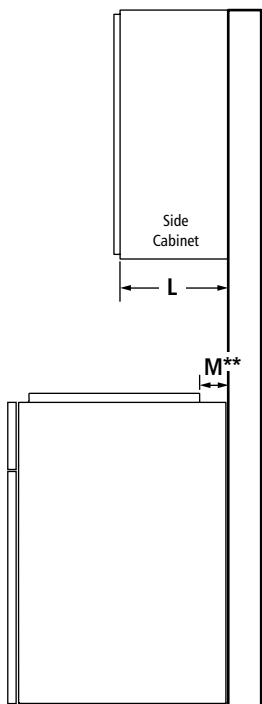

SIDE VIEW

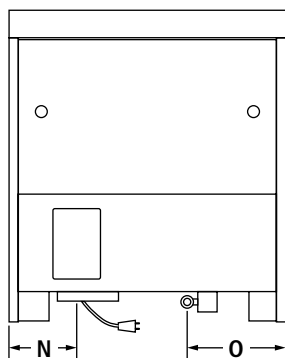

BACK VIEW

MODEL #		JGRP536WP JLRP536WP JGRP436WP JLRP436WP	
		in	cm
A	Width of combustable area above cooking surface (min.)	36	91.4
B	Width from range to fixed wall or other combustable material (min.)	6	15.2
C	Width of opening (min.)	36 ¹ / ₄	92.1
D	Width of electrical installation area	28	71.1
E	Width of gas installation area	14	35.5
F	Width from side cabinet to gas installation area	6	15.2
G*	Height to bottom of uncovered wood or metal cabinet above cooking surface (min.)	42	106.7
H	Height to bottom of uncovered wood or metal cabinet (min.)	18	45.7
I	Height of electrical installation area	15	38.1
J	Depth of electrical and gas installation area	5	12.7
K	Height of gas installation area	3	7.6
L	Depth of upper cabinet (max.)	13	33.0
M**	Depth to wall (min.)	6	15.2
N	Width to electrical conduit	9 ¹ / ₈	23.0
O	Width to gas inlet	14 ³ / ₈	36.5
e	Recommended electrical access location		
g	Recommended gas supply line location		

*If installing a hood or hood liner above the range, follow the hood or hood liner instructions for dimensional clearances above the cooking surface.

**If back wall is constructed of a combustable material and a backsplash is not installed, a 6" (15.2 cm) minimum clearance is required.

ELECTRICAL REQUIREMENTS

120 volt, 60 Hz, AC only, 15-amp fused, grounded circuit is required. A dedicated circuit is recommended.

IMPORTANT: Dimensional specifications are provided for planning purposes only.

Do not make any cutouts based on this information. Refer to the Installation Guide *before* selecting cabinetry, verifying electrical/gas connections, making cutouts or beginning installation.

All Jenn-Air® appliances are appropriately UL, CUL or CSA approved.

48"/36"/30" PRO-STYLE™ WALL-MOUNT HOODS

~~JXW9048WP – 48" x 19³/₈" x 25"~~**JXW9036WP – 36" x 19³/₈" x 25"**~~JXW9030WP – 30" x 19³/₈" x 25"~~

PRODUCT DIMENSIONS

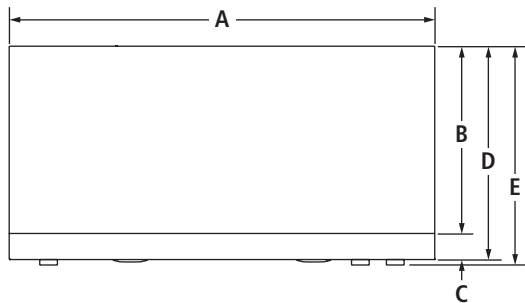

FRONT VIEW

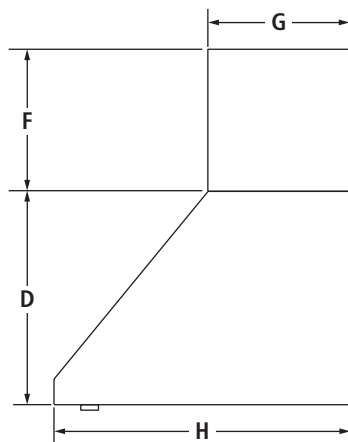

SIDE VIEW

(shown with optional duct cover)

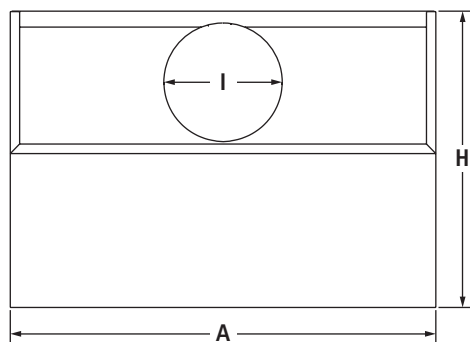

TOP VIEW

MODEL #		JXW9048WP		JXW9036WP		JXW9030WP	
		in	cm	in	cm	in	cm
A	Overall width	48	121.9	36	91.4	30	76.2
B	Height without trim	15 ³ / ₄	40.0	15 ³ / ₄	40.0	15 ³ / ₄	40.0
C	Height of trim	2 ¹ / ₄	5.7	2 ¹ / ₄	5.7	2 ¹ / ₄	5.7
D	Height without controls	18	45.7	18	45.7	18	45.7
E	Height with controls	19 ³ / ₈	49.1	19 ³ / ₈	49.1	19 ³ / ₈	49.1
F	Height of optional duct cover	12	30.5	12	30.5	12	30.5
G	Depth of optional duct cover	12	30.5	12	30.5	12	30.5
H	Depth of hood	25	63.5	25	63.5	25	63.5
I	Vent collar diameter	9 ⁷ / ₈	25.1	9⁷/₈	25.1	9 ⁷ / ₈	25.1

IMPORTANT: Dimensional specifications are provided for planning purposes only.Do not make any cutouts based on this information. Refer to the Installation Guide *before* selecting cabinetry, verifying electrical/gas connections, making cutouts or beginning installation.

All Jenn-Air® appliances are appropriately UL, CUL or CSA approved.

48"/36"/30" PRO-STYLE™ WALL-MOUNT HOODS

JXW9048WP – 48" x 19³/₈" x 25"JXW9036WP – 36" x 19³/₈" x 25"JXW9030WP – 30" x 19³/₈" x 25"

OPENING/CLEARANCE DIMENSIONS

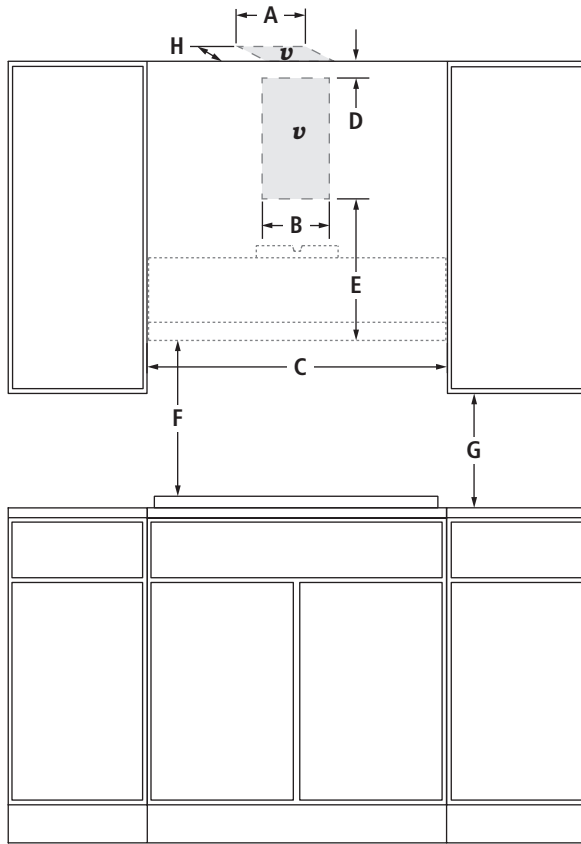

FRONT VIEW

ELECTRICAL REQUIREMENTS

120 volt, 60 Hz, AC only, 15-amp fused, electrical circuit is required. The knockout into the back of the terminal box is located on the right side.

VENTING REQUIREMENTS

The hood is factory set for venting through the roof or wall. Do not terminate the vent in an attic or other enclosed area.

LOCATION REQUIREMENTS

The minimum height from the floor to the top of the vent hood is 7' (2.1 m). The minimum height from the floor to the top of the optional duct cover is 8' (2.4 m).

MODEL #		JXW9048WP		JXW9036WP		JXW9030WP	
		in	cm	in	cm	in	cm
A	Width of vent entry location – ceiling option	12	30.5	12	30.5	12	30.5
B	Width of vent entry location – wall option	12	30.5	12	30.5	12	30.5
C	Width of cabinet opening (min.)	48	121.9	36	91.4	30	76.2
D	Height from vent entry location to ceiling – wall option (min.)	2	5.1	2	5.1	2	5.1
E	Height from hood to vent entry location – wall option (min.)	24	61.0	24	61.0	24	61.0
F	Height from hood to cooking surface (min.-max.)	30-36	76.2-91.4	30-36	76.2-91.4	30-36	76.2-91.4
G	Height from upper cabinet to countertop (min.)	18	45.7	18	45.7	18	45.7
H	Depth of vent entry location – ceiling option	12	30.5	12	30.5	12	30.5
v	Recommended vent entry location						

IMPORTANT: Dimensional specifications are provided for planning purposes only.

Do not make any cutouts based on this information. Refer to the Installation Guide *before* selecting cabinetry, verifying electrical/gas connections, making cutouts or beginning installation. All Jenn-Air® appliances are appropriately UL, CUL or CSA approved.

Product and Cabinet Opening Dimensions

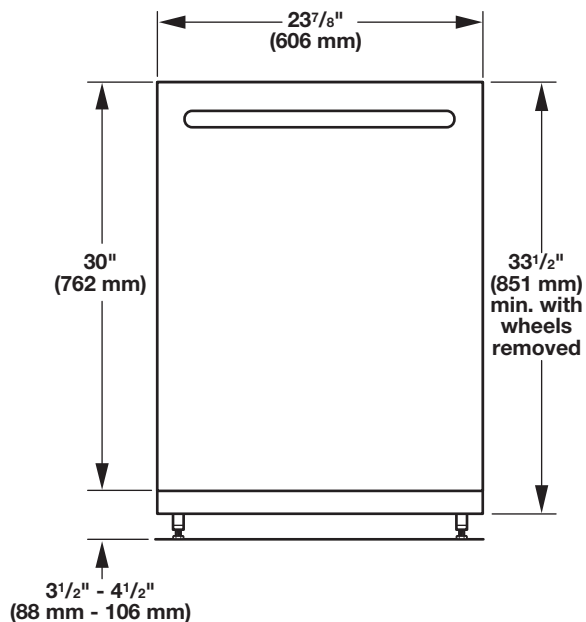

For $4"$ (100 mm) toe kick, height of cabinet opening is $34\frac{1}{2}"$ (863 mm).

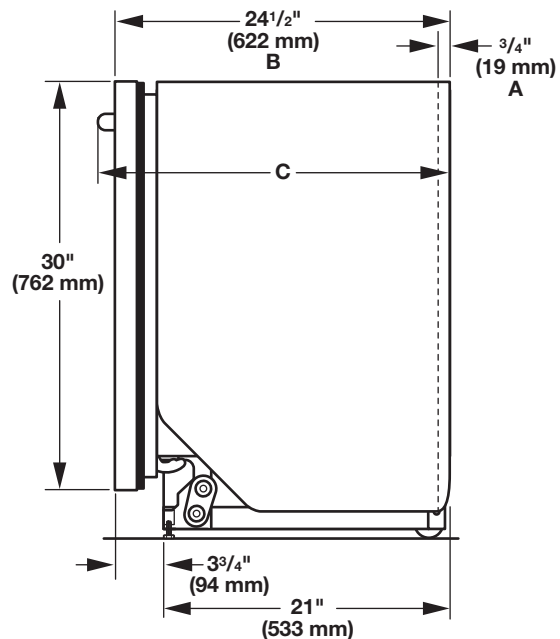

- A. Insulation may be compressed (not used on all models).
 B. For panel-ready models, dishwasher depth is $24"$ (610 mm), not including the $\frac{3}{4}"$ (19 mm) custom door panel.
 C. Door handles may protrude forward of the face of the dishwasher, varies by model.

Check that all surfaces have no protrusions that would prohibit dishwasher installation.

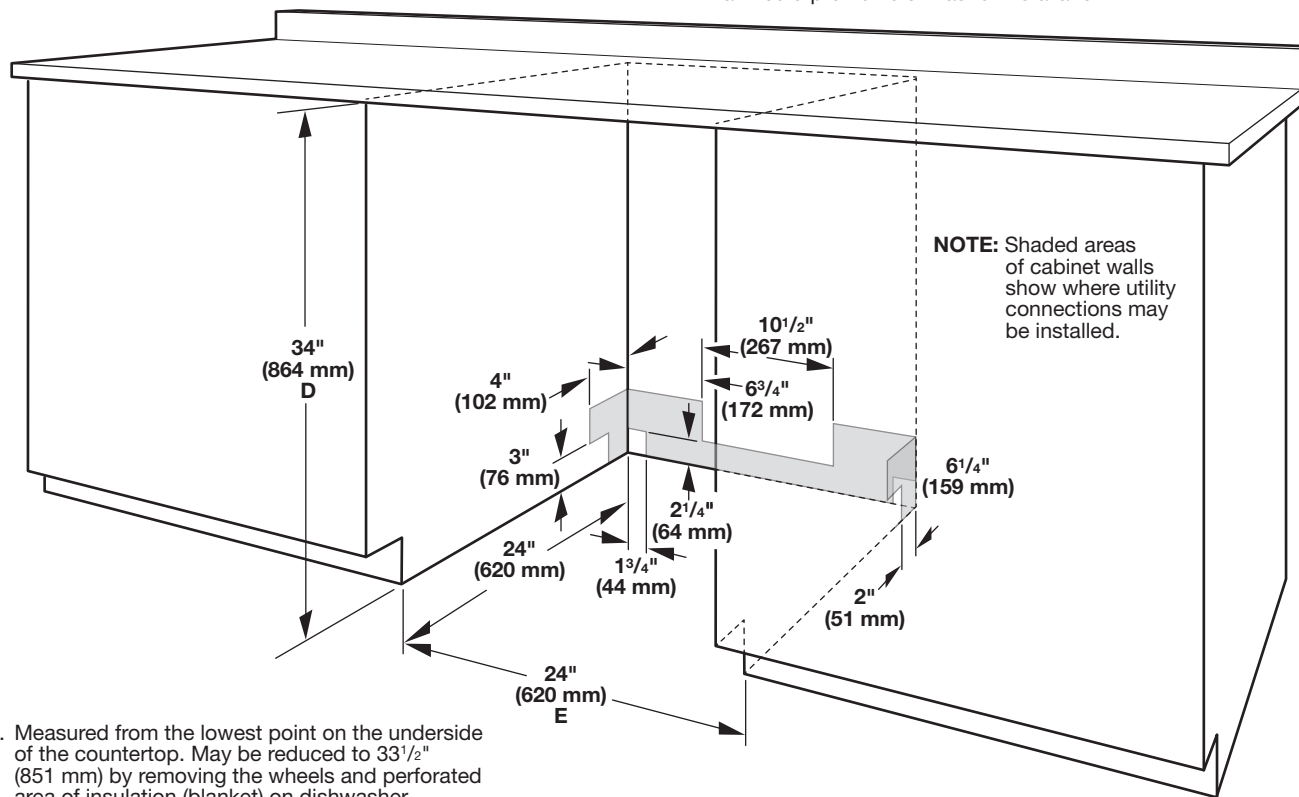

- D. Measured from the lowest point on the underside of the countertop. May be reduced to $33\frac{1}{2}"$ (851 mm) by removing the wheels and perforated area of insulation (blanket) on dishwasher.
 E. Minimum, measured from narrowest point of opening

DRAIN REQUIREMENTS

- A new drain hose is supplied with your dishwasher. If drain hose is not long enough, use a new drain hose with a maximum length of 12 ft (3.7 m) that meets all current AHAM/IAPMO test standards, is resistant to heat and detergent, and fits the 1" (25 mm) drain connector of the dishwasher. See the "Tools and Parts" section at the front of the guide for part details and orders.

NOTE: Do not connect multiple drain hoses together.

- Make sure to connect drain hose to waste tee or disposer inlet above drain trap in house plumbing and 20" (508 mm) minimum above the floor. It is recommended that the drain hose either be looped up and securely fastened to the underside of the counter or be connected to an air gap.
- Make sure to use an air gap if the drain hose is connected to house plumbing lower than 20" (508 mm) above subfloor or floor.

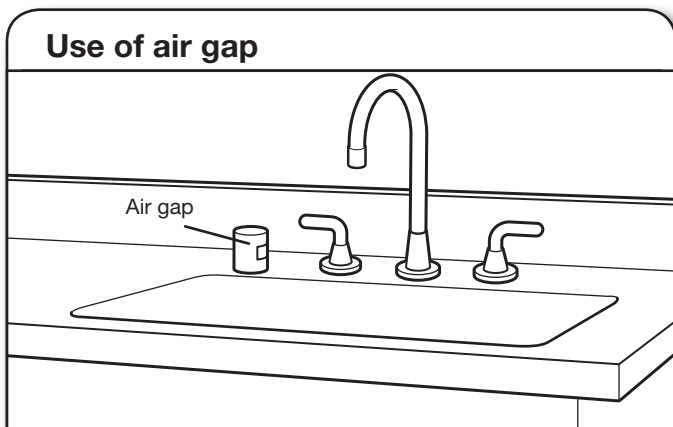

- If required, the air gap should be installed in accordance with the air gap installation instructions. When you are connecting the air gap, a rubber hose (not provided) will be needed to connect to the waste tee or disposer inlet.
- Use 1/2" minimum I.D. drain line fittings.

WATER SUPPLY REQUIREMENTS

- This dishwasher has a water heating feature and also requires a connection to a hot water supply line.
- A hot water line with 20 to 120 psi (138 to 862 kPa) water pressure can be verified by a licensed plumber.
- 120°F (49°C) water at dishwasher
- 3/8" O.D. copper tubing with compression fitting or flexible braided water supply line. See the "Tools and Parts" section at the front of the guide for part details and orders.

NOTE: 1/2" minimum plastic tubing is not recommended.

- A 90° elbow with 3/4" hose connection with rubber washer. See the "Tools and Parts" section at the front of the guide for part details and orders.
- Do not solder within 6" (152 mm) of the water inlet valve.
- If installed in new construction, make sure the house water supply lines have been flushed prior to connecting the dishwasher to remove any debris that may exist in the supply line.

NOTE: If replacing an existing dishwasher, it is recommended to install a new water line (see the "Tools and Parts" section at the front of the guide for part details) and drain hose (supplied) with the new dishwasher.

ELECTRICAL REQUIREMENTS

Be sure that the electrical connection and wire size are adequate and in conformance with the National Electrical Code, ANSI/NFPA 70 - latest edition, and all local codes and ordinances.

A copy of the above code standards can be obtained from:

National Fire Protection Association
1 Batterymarch Park
Quincy, MA 02169-7471

You Must Have:

- 120-volt, 60 Hz, AC-only, 15- or 20-amp, fused electrical supply
- Copper wire only
- A maximum of 2 field wiring supply conductors (12 AWG largest size) plus 1 grounding conductor are permitted in the terminal box.

We Recommend:

- A time-delay fuse or circuit breaker
- A separate circuit

If Connecting Dishwasher with a Power Cord:

- Use UL Listed power cord kit marked for use with dishwasher. See the "Tools and Parts" section at the front of the guide for part details and orders.
- Plug into a grounded 3 prong outlet. Outlet must meet all local codes and ordinances.

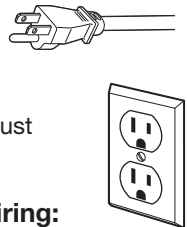

If Connecting Dishwasher with Direct Wiring:

- Use flexible, armored, or nonmetallic sheathed copper wire with grounding wire that meets the wiring requirements for your home and local codes and ordinances.
- Use a UL Listed/CSA Approved metallic strain relief. See the "Tools and Parts" section at the front of the guide for part details and orders.



BUILT-IN MICROWAVE OVENS

JMC2430D – 29³/₄" x 19⁷/₈" x 24³/₄"~~JMC2427D – 26³/₄" x 19⁷/₈" x 24¹¹/₁₆"~~

PRODUCT DIMENSIONS

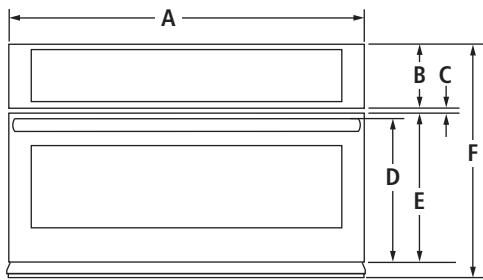

FRONT VIEW

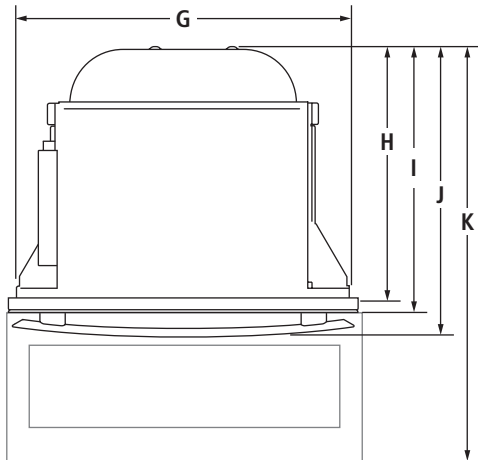

TOP VIEW

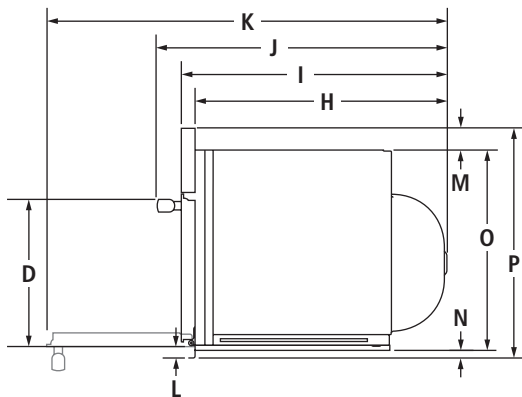

SIDE VIEW

MODEL #		JMC2430D		JMC2427D	
		in	cm	in	cm
A	Overall width	29 ³ / ₄	75.6	26 ³ / ₄	68.0
B	Height of control panel	5 ¹ / ₂	14.0	5 ¹ / ₂	14.0
C	Space between control panel and door				
	Pro-Style® Stainless	7 ¹ / ₁₆	1.1	—	—
	Euro-Style Stainless	7 ¹ / ₁₆	1.1	7 ¹ / ₁₆	1.1
	Black Floating Glass	1 ¹ / ₂	1.2	—	—
D	Height to top of handle				
	Pro-Style® Stainless	12 ³ / ₈	31.4	—	—
	Euro-Style Stainless	12 ³ / ₁₆	31.0	12 ³ / ₁₆	31.0
	Black Floating Glass	12 ³ / ₁₆	31.0	—	—
E	Height of door	12 ³ / ₄	32.3	12 ³ / ₄	32.3
F	Overall height	19 ⁷ / ₈	50.3	19 ⁷ / ₈	50.3
G	Width of recessed oven	28 ³ / ₈	72.1	25 ³ / ₈	64.5
H	Depth of recessed oven	21 ¹ / ₂	54.6	21 ¹ / ₂	54.6
I	Depth with door				
	Pro-Style® Stainless	22 ¹¹ / ₁₆	57.7	—	—
	Euro-Style Stainless	22 ¹¹ / ₁₆	57.7	22 ⁵ / ₈	57.5
	Black Floating Glass	22 ⁵ / ₈	57.5	—	—
J	Depth with handle				
	Pro-Style® Stainless	25 ³ / ₈	64.4	—	—
	Euro-Style Stainless	24 ³ / ₄	62.9	24 ¹¹ / ₁₆	62.8
	Black Floating Glass	24 ¹¹ / ₁₆	62.8	—	—
K	Depth with door fully open				
	Pro-Style® Stainless	34 ³ / ₈	87.4	—	—
	Euro-Style Stainless	34 ³ / ₈	87.4	34 ³ / ₈	87.4
	Black Floating Glass	34 ¹ / ₂	87.6	—	—
L	Height of trim				
	Pro-Style® Stainless	1 ¹ / ₈	2.9	—	—
	Euro-Style Stainless	1 ¹ / ₈	2.9	1 ³ / ₁₆	3.0
	Black Floating Glass	1 ³ / ₁₆	3.0	—	—
M	Height from top of recessed oven to top of control panel	1 ¹⁵ / ₁₆	5.0	1 ¹⁵ / ₁₆	5.0
N	Height from bottom of recessed oven to bottom of trim	5 ⁵ / ₈	1.6	5 ⁵ / ₈	1.6
O	Height of recessed oven	17 ³ / ₈	44.1	17 ³ / ₈	44.1
P	Height to top of control panel	19 ³ / ₁₆	48.8	19 ³ / ₁₆	48.8

IMPORTANT: Dimensional specifications are provided for planning purposes only.

Do not make any cutouts based on this information. Refer to the Installation Guide before selecting cabinetry, verifying electrical/gas connections, making cutouts or beginning installation.

All Jenn-Air® appliances are appropriately UL, CUL or CSA approved.

BUILT-IN MICROWAVE OVENS

JMC2430D – 29³/₄" x 19⁷/₈" x 24³/₄"JMC2427D – 26³/₄" x 19⁷/₈" x 24¹¹/₁₆"***STANDARD
INSTALLATION**

OPENING/CLEARANCE DIMENSIONS

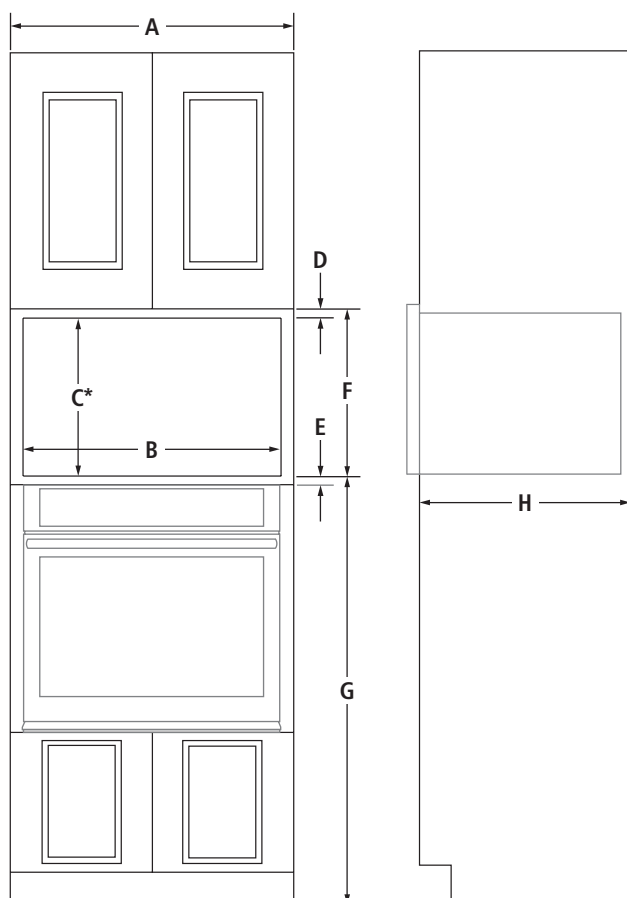
**FRONT VIEW – INSTALLATION OVER
SINGLE OVEN**Approved models: JJW3430D, JJW2430D,
JJW2427D**SIDE VIEW**

MODEL #		JMC2430D		JMC2427D	
		in	cm	in	cm
A	Width of cabinet (min.)	30	76.2	27	68.6
B	Width of cutout	28 ¹ / ₂	72.4	25 ¹ / ₂	64.8
C*	Height of cutout	17 ³ / ₈ - 17 ³ / ₄	44.1- 45.1	17 ³ / ₈ - 17 ³ / ₄	44.1- 45.1
D	Top of cutout to bottom of upper cabinet (min.)	2 ³ / ₁₆	5.5	2 ³ / ₁₆	5.5
E	Bottom of cutout to top of single oven (min.)	1	2.5	1	2.5
	Bottom of cutout to top of cabinet door (min.)	1 ¹ / ₂	3.8	1 ¹ / ₂	3.8
F	Bottom of cutout to bottom of upper cabinet door	19 ⁷ / ₈	50.3	19 ⁷ / ₈	50.3
G	Bottom of cutout to floor (recommended)	40	101.6	40	101.6
H	Depth of cutout (min.)	21 ⁷ / ₈	55.5	21 ⁷ / ₈	55.5

*Optional spacer kits are available for a cutout height of 19"-19¹³/₁₆" (48.3-50.2 cm).**ELECTRICAL REQUIREMENTS**

240 volt, 20-amp fused, grounded circuit is required. A dedicated circuit is recommended.

The length of conduit provided is for serviceability. Do not cut the conduit. The junction box should be located 3" (7.6 cm) maximum below the support surface. Drill a 1" (2.5 cm) minimum diameter hole in the left rear corner of the support surface for access to the junction box.

If the junction box is on the rear wall behind the oven, it must be recessed and located in any corner of the cabinet.

LOCATION REQUIREMENTS

Support structure must be able to support 90 lb (41.0 kg) including microwave oven and contents.

IMPORTANT: Dimensional specifications are provided for planning purposes only.**Do not make any cutouts based on this information.** Refer to the Installation Guide *before* selecting cabinetry, verifying electrical/gas connections, making cutouts or beginning installation.

All Jenn-Air® appliances are appropriately UL, CUL or CSA approved.

BUILT-IN MICROWAVE OVENS – FLUSH INSTALLATION

JMC2430D – 29³/₄" x 19⁷/₈" x 22¹/₁₆" (depth without handle)JMC2427D – 26³/₄" x 19⁷/₈" x 22⁵/₈" (depth without handle)*** FLUSH
INSTALLATION**

OPENING/CLEARANCE DIMENSIONS

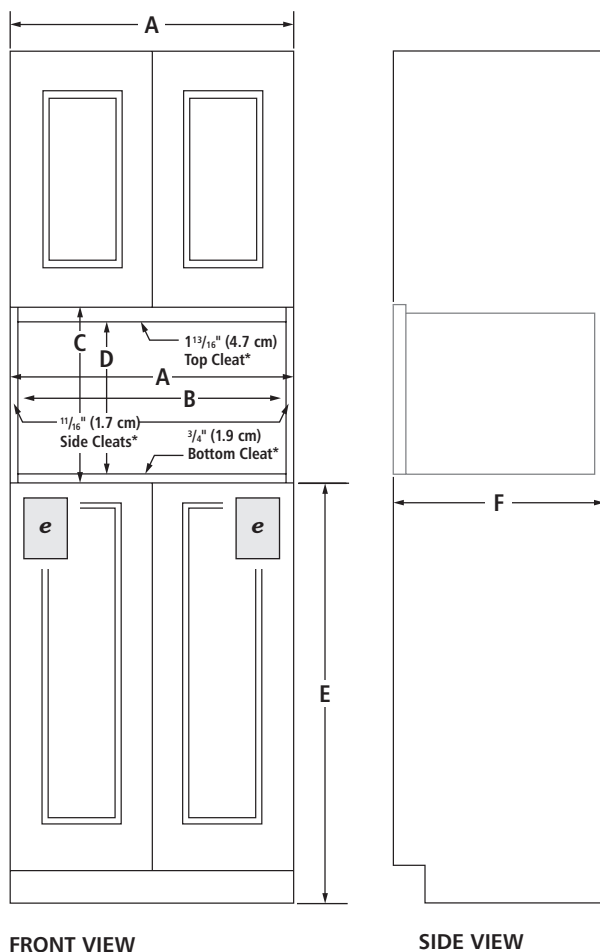

MODEL #		JMC2430D		JMC2427D	
		in	cm		
A	Width of flush inset cutout (min.)	30 ¹ / ₄	76.8	27 ¹ / ₄	69.2
B	Width of opening (min.)	28 ⁷ / ₈	70.8	25 ⁷ / ₈	65.7
C	Height of flush inset cutout (min.)	20 ³ / ₁₆	51.3	20 ³ / ₁₆	51.3
D	Height of opening (min.)	17 ⁵ / ₈	44.7	17 ⁵ / ₈	44.7
E	Bottom of cutout to floor	40	101.6	40	101.6
F	Depth of cutout (min.)	23 ¹ / ₄	59.0	23 ¹ / ₄	59.0
e	Recommended junction box location				

ELECTRICAL REQUIREMENTS

240 volt, 20-amp fused, grounded circuit is required. A dedicated circuit is recommended.

The length of conduit provided is for serviceability. Do not cut the conduit. The junction box should be located 3" (7.6 cm) maximum below the support surface. Drill a 1" (2.5 cm) minimum diameter hole in the left rear corner of the support surface for access to the junction box.

FLUSH INSTALLATION REQUIREMENTS

A 23¹/₄" (59.0 cm) minimum cutout depth is required.

These dimensions will result in a 1/4" (0.6 cm) reveal on the top, a 1/4" (0.6 cm) reveal on the sides and a 1/8" (0.3 cm) reveal on the bottom of the microwave oven.

The front face of the cleats and platform will be visible and should be treated as a finished surface.

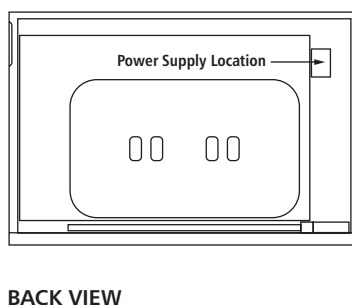
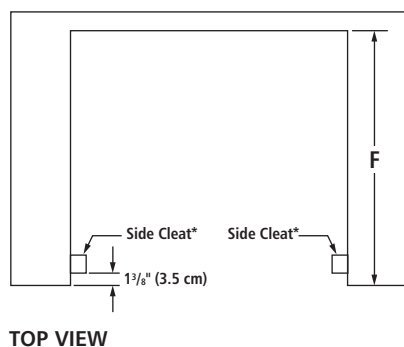

*Cleats and platform must be recessed 1³/₈" (3.5 cm) from the front of the cabinet.

IMPORTANT: Dimensional specifications are provided for planning purposes only.

Do not make any cutouts based on this information. Refer to the Installation Guide *before* selecting cabinetry, verifying electrical/gas connections, making cutouts or beginning installation. All Jenn-Air® appliances are appropriately UL, CUL or CSA approved.

WM9000HVA

6.0 cu.ft. MEGA Capacity w/ On-Door Control Panel & TurboWash®

***BOTH WASHER
AND DRYER ARE
29" WIDE WITH
PEDESTALS ON
BOTH UNIT
JAY**

MAKE LAUNDRY DAY ANYTHING BUT ROUTINE

Can inspiration be found in the laundry room? Look no further than LG's stunning new front load washer. Huge 6.0 cu. ft. Mega Capacity cleans a king-size comforter and a full set of bedding in one fell swoop. And, with the turbocharged power of LG TurboWash®, a normal load gets done up to 30 minutes faster. And, master multi-taskers take note: This LG washer is TWIN Wash System™ compatible, which means you can add the ingenious LG SideKick™ pedestal washer to tackle two loads of laundry—both large and small—all at the same time.

SPECIFICATIONS

- 29" Width
- 6.0 cu. ft. Ultra Capacity with NeveRust™ Stainless Steel Drum
- Direct Drive Motor with 10-Year Limited Warranty
- 1,300 RPM
- 14 Washing Programs
- 5 Temperature Settings (All Cold Rinses)

STYLISH DESIGN

- On-Door Electronic Control Panel with LED Display and Dial-A-Cycle™
- Large Tinted Glass Door with On-Door Controls
- Ergonomically Angled Drum & Door
- Extra Wide Door Opening
- Optional Matching Drawer Pedestal
- Optional Sidekick™ Pedestal Washer (WD200CV)

INNOVATIONS

- 2015 ENERGY STAR® Most Efficient
- CEE Tier 3
- CSA Sustainability
- TurboWash® 2.0 Technology
- LG Steam Technology
- ASC Qualified Allergiene™ Cycle
- Smart ThinQ™ (Wi-Fi)
- ColdWash™ Option
- 6Motion™ Technology
- SmartDiagnosis™
- TrueBalance™ Anti-Vibration System
- LoDecibel™ Quiet Operation
- SenseClean™
- Delay Wash (Up to 19 Hours)
- Easy Loading 10° TiTub™



Graphite Steel



TurboWash® Technology

Soccer practice. Groceries. Dinner. Dishes. Shouldn't your laundry move as fast as you? Now it can, with LG's enhanced TurboWash® technology. Powerful high-pressure nozzles save up to 30 minutes per load* - without shortcutting cleaning performance, even on larger loads. Innovation that keeps up with your family calendar? That's not just laundry done fast - it's laundry at the speed of life.

6.0 cu.ft. MEGA Capacity

Towers of towels, piles of sweatshirts, and a mountain of jeans? Go for it. The ultra large capacity (6.0 cu.ft.) tub lets you do more laundry in fewer loads. That's time saved and sore backs avoided.

Integrated Electronic Control Panel with Dual LED Display

Electronic control panel is integrated into the door for a distinct style plus the intuitive functionality you expect from an LG washer.

PRODUCT FEATURES

CAPACITY	
Capacity	6.0 cu. ft.
APPEARANCE	
Design Look	Front Control
On-Door Electronic Control Panel with LED Display	•
Touch Buttons	•
Dial-A-Cycle™	•
ENERGY	
2015 ENERGY STAR® Most Efficient	•
CEE Tier	3
WASH PROGRAMS	
No. of Programs	14
Wash Programs	Cotton/Normal, Perm. Press/Casual, Delicates, Speed Wash, TubClean™, Sanitary, Allergiene™, Heavy Duty, BrightWhites™, Towels, Rinse+Spin, Download, Jumbo Wash, Bedding
No. of Options	12
Options	Prewash, Delay Wash, Extra Rinse, Child Lock, ColdWash™, FreshCare™, Steam, TurboWash™, Custom Program, Drum Light, Smart Grid, Remote Start
No. of Wash/Rinse Temps	5
	Extra Hot, Hot, Warm, Cold, Tap Cold (All Cold Rinses)
Spin Speeds	Extra High (1,300 max.), High, Medium, Low, No Spin
No. of Water Levels	Automatically adjusts to the size of load
No. of Soil Levels	5
FABRIC CARE FEATURES	
TurboWash® 2.0 Technology	•
Steam Technology	•
Allergiene™ Cycle	•
Sanitary Cycle	•
ColdWash™ Option	•
SenseClean™ System	•
CONVENIENCE FEATURES	
TrueBalance™ Anti-Vibration System	•
4 Tray Dispenser	Prewash, Main Wash (with liquid detergent cup), Bleach, Fabric Softener
LoDecibel™ Quiet Operation	•
End of Cycle Signal	•
LoadSense	•
Child Lock	•
Auto Suds Removal	•
Forced Drain System	•
Leveling Legs	4 Adjustable Legs
SmartDiagnosis™	• (v 3.0)
Smart ThinQ™ (Wi-Fi)	Smart Grid Ready, Smart Access, Smart Adapt, Energy Monitoring, Laundry Starts
NFC Tag On	•

MOTOR AND AGITATOR	
Motor Type	Inverter Direct Drive Motor
Motor Speed	Variable
Max RPM	1,300
Axis	Horizontal
MATERIALS AND FINISHES	
NeveRust™ Stainless Steel Drum	•
Cabinet	PCM
Control Panel	Plastic
Top Plate	Painted
Door Rim	Glass/Chrome
Door Cover	Dark Black Tinted Square Cover
Door Opening	42 1/8"
Available Colours	Graphite Steel (V)
POWER SOURCE	
Ratings	UL Listed
Electrical Requirements	120V, 10 Amps
Type	Electric
OPTIONS	
Pedestal	WDPSV
Pedestal (WxHxD)	29" x 14 1/10" x 30 4/5"
Sidekick™ Pedestal Washer	WD200CW, WD200CV
Sidekick™ Pedestal Washer (WxHxD)	29" x 14 1/10" x 30 4/5"
DIMENSIONS	
Product (WxHxD)	29" x 41 1/4" x 33 3/4" (55 15/16" W with door open)
Carton (WxHxD)	31 5/16" x 44 19/64" x 35 5/8"
Weight (Product/Carton)	227.1 lbs / 233.7 lbs
LIMITED WARRANTY	
1 Year Parts and Labour, 10 Years Motor, 5 Year on Drum	
UPC CODES	
WM9000HVA Washer (Graphite Steel)	772454 058837
DLEX9000V Electric Dryer (Graphite Steel)	772454 058813
DLGX9001V Gas Dryer (Graphite Steel)	772454 058820
WDPSV Pedestal (Graphite Steel)	048231 012904
WD200CV Sidekick™ Pedestal Washer (Graphite Steel)	772454 064753



LG ELECTRONICS CANADA INC.

20 Norelco Drive, North York, Ontario M9L 2X6

Tel: 647-253-6300 | LG.com

Customer Service & Parts

1-888-542-2623

Design, features and specifications are subject to change without notice.
Non-metric weights and measurements are approximate.
All trademarks are property of their respective owners.

Printed in October 2015

DLEX9000V/DLGX9001V

9.0 cu.ft. MEGA Capacity TurboSteam™ Dryer w/ On-Door Control Panel

DREAM BIG, STEAM BIG.

When you picture your dream laundry room, this is the dryer that you'll want to be in it. Every contour, every elegant line creates a look like no other, with unexpected touches like an integrated control panel right on the door. The 9.0 cu. ft. Mega Capacity keeps up with even LG's biggest washers, load for load. But no dream is complete without the power of LG TurboSteam™ technology that lets you reduce wrinkles and odors and give favorite clothes new life in only 10 minutes.

SPECIFICATIONS

- 9.0 cu. ft. MEGA Capacity with NeveRust™ Stainless Steel Drum
- 14 Drying Programs
- 5 Temperature Settings

STYLISH DESIGN

- Upfront Electronic Control Panel with Dual LED Display and Dial-A-Cycle™
- Large Tinted Glass Door with On-Door Controls
- Optional Matching Drawer Pedestal
- Reversible Door

INNOVATIONS

- TurboSteam™ Technology
- ENERGY STAR® Qualified
- SteamFresh™ Cycle
- Sensor Dry System
- Precise Temperature Control with Variable Heat Source
- LoDecibel™ Quiet Operation
- Smart ThinQ™ (Wi-Fi)
- SmartDiagnosis™
- 3 Minute Installation Check
- FlowSense™ Duct Clogging Indicator
- Wrinkle Care Option
- Anti-Bacterial Cycle
- Damp Dry Signal

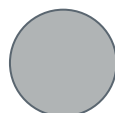

Graphite Steel



9.0 cu.ft. MEGA Capacity

When it comes to laundry capacity, big is good, bigger is better, but biggest is best. With 9.0 cu.ft. of mega capacity, now you can fit a king size comforter and full set of bedding in a single load! You'll definitely have more room to dry.

TurboSteam™ Technology

LG TurboSteam™ technology to the rescue. Toss the shirt in the dryer, turn on the TurboSteam™ and in just 10 minutes your shirt is back in tip-top shape. Also helps refresh fabrics and reduce wrinkles in half the time of other steam settings.

PRODUCT FEATURES

CAPACITY	
Capacity	9.0 cu. ft.
ENERGY	
ENERGY STAR® Qualified	•
APPEARANCE	
Design Look	On-Door Front Control Panel
Intelligent Electronic Controls with Dual LED Display	•
Touch Buttons	•
Dial-A-Cycle™	•
DRYER PROGRAMS	
No. of Programs	14
Programs (Sensor Dry)	Cotton/Normal, Perm. Press/Casual, Towels, Delicates, Heavy Duty, SteamFresh™ SteamSanitary™, Bedding, LowTemp Dry, Anti-Bacterial, Jumbo Dry, Download/Super Dry
Programs (Manual Dry)	Speed Dry, Air Dry
No. of Options	13
Options	More Time, Less Time, Custom Program, PGM Save, Damp Dry Signal, Wrinkle Care, Child Lock, Wi-Fi Connect, Drum Light, Energy Saver, TurboSteam, Smart Grid, Remote Start
Temperature Settings	High, Medium High, Medium, Low, Ultra Low
Drying Levels	Very Dry, More Dry, Normal Dry, Less Dry, Damp Dry
Manual Dry Times	60 min., 50 min., 40 min., 30 min., 20 min., More Time/Less Time
CONVENIENCE FEATURES	
LoDecibel™ Quiet Operation	•
End of Cycle Signal	•
Drum Light	•
Reversible Door	•
FlowSense™ Duct Clogging Indicator	•
Venting Option	Electric: 4 Way Venting / Gas: 3 Way Venting
Leveling Legs	4 Adjustable Legs
Remaining Time Display/Status Indicator(s)	•
3 Minute Installation Check	•
SmartDiagnosis™	• (v 3.0)
Smart ThinQ™ (Wi-Fi)	Smart Grid Ready, Energy Monitoring, Black Box, Remote Control, Home Chat
MATERIALS AND FINISHES	
NeverRust™ Stainless Steel Drum	•
Cabinet	Painted Steel
Control Panel	Plastic
Top Cover	Painted Steel
Door	Glass/Chrome
Door Cover	Dark Black Tinted Square Cover
Available Colours	Graphite Steel (V)
POWER SOURCE	
Ratings	CSA Listed
Electrical Requirements	120V, 15 Amps (Gas) / 240V, 30 Amps (Electric)
Type	Gas/Electric
BTU	20,000

Integrated Electronic Control Panel with Dual LED Display

Electronic control panel is integrated into the door for a distinct style plus the intuitive functionality you expect from an LG dryer.

OPTIONS	
Pedestal	WDP5V
Pedestal (WxHxD)	29" x 13 9/10" x 29 2/5"
DIMENSIONS	
Product (WxHxD)	29" x 40 7/8" x 33 3/8" (56" with door open)
Carton (WxHxD)	31 5/16" x 44 15/16" x 35 5/8"
Weight (Product/Carton) Electric	157.4lbs / 182.1lbs
Weight (Product/Carton) Gas	160.7lbs / 185.4lbs
LIMITED WARRANTY	
1 Year Parts and Labour	
UPC CODES	
DLEX9000V Electric Dryer (Graphite Steel)	772454 058813
DLGX9001V Gas Dryer (Graphite Steel)	772454058820
WM9000HVA Washer (Graphite Steel)	772454 058837
WDP5V Pedestal (Graphite Steel)	048231 012904
WD200CV Sidekick™ Pedestal Washer (Graphite Steel)	772454 064753



LG ELECTRONICS CANADA INC.

20 Norelco Drive, North York, Ontario M9L 2X6

Tel: 647-253-6300 | LG.com

Customer Service & Parts

1-888-542-2623

Design, features and specifications are subject to change without notice.
Non-metric weights and measurements are approximate.
All trademarks are property of their respective owners.

Printed in October 2015

WD200_

29"/30" LG SideKick™ Pedestal Washer

KEY FEATURES

1.0 cu. ft. Capacity w/ NeveRust™ Stainless Steel Drum

Compatible with select 29"/30" Front Load Washers

Direct Drive Motor with 10-Year Limited Warranty

Magnetic Remote Control (sold separately)

Perfect for Intimates, Hand Wash or Active Wear

Available in Graphite Steel or White



LG SideKick™

PRODUCT FEATURES

CAPACITY	
Capacity	1.0 cu. ft.
APPEARANCE	
Design Look	Front Control
Electronic Control Panel with LED Display	•
Touch Buttons	•
WASH PROGRAMS	
3 Motion Technology	•
No. of Programs	6
Wash Programs	Normal, Intimates, Hand Wash, Active Wear, Rinse + Spin, Tub Clean
No. of Options	3
Options	Warm Water, Extra Rinse, Child Lock
No. of Wash/Rinse Temps	2 (Warm, Cold)
CONVENIENCE FEATURES	
End of Cycle Signal	•
Child Lock	•
Auto Suds Removal	•
Forced Drain System	•
Leveling Legs	4 Adjustable Legs
SmartDiagnosis™	•
MOTOR AND AGITATOR	
Motor Type	Direct Drive Motor
Motor Speed	Variable
Max RPM	700
MATERIALS AND FINISHES	
NeveRust™ Stainless Steel Drum	•
Cabinet	PCM
Control Panel	Plastic
Top Plate	Painted
Door Rim	Plastic / Chrome
Door Cover	Transparent Tinted Semi-Circle Cover
Available Colors	White (W), Graphite Steel (V)

POWER SOURCE	
Ratings	UL Listed
Electrical Requirements	120V, 5 Amps
Type	Electric
ACCESSORIES	
Magnetic Remote Control	Remote RCW1 sold separately
Hose Included	No
DIMENSIONS	
Product (WxHxD)	29" x 14 1/8" x 30 7/8" (50 9/16 with drawer open)
Carton (WxHxD)	30 7/8" x 16 13/16" x 33 1/16"
Weight (Product/Carton)	105 lbs / 115 lbs
LIMITED WARRANTY	
1 Year Parts and Labor, 10 Years Motor, Lifetime on Drum	
UPC CODES	
WD200CV Sidekick™ Pedestal Washer (Graphite Steel)	048231 015189
WD200CW Sidekick™ Pedestal Washer (White)	048231 015196
RCW1 Remote Control	048231 017138

Design, features and specifications are subject to change without notice. Non-metric weights and measurements are approximate.

© 2016 LG Electronics USA, Inc. All rights reserved. "LG Life's Good" is a registered trademark of LG Corp. All other product and brand names are trademarks or registered trademarks of their respective companies. 1/25/16