

Brampton Encore - 112 - 1 - 38-5 Elev.A HANDEL

CENTRAL VAC AND WIRING

Inv.472	1 - TELEPHONE AND CABLE ROUGH-IN LOCATIONS
Line5698	Note:
28Apr16 / 9Jun16	

EXTERIOR COLOURS

Inv.472	1 - EXTERIOR COLOUR PACKAGE 6
Line6791	Note:
28Apr16 / 9Jun16	

FRAMING

Inv.472	1 - MANDOR - GARAGE TO HOUSE- AS PER PLAN AND GRADE PERMITTING
Line6790	Note: AS PER APS BONUS PACKAGE
28Apr16 / 9Jun16	

GRANITE MARBLE QUARTZ

Inv.891	1 - KITCHEN: INSTALL 2 CM GRP 1 Optional Flush BBar
Line12397	Note:
5Oct16 / 26Oct16	

HARDWOOD

Inv.891	1 - DINING ROOM: INSTALL Upgrade 1 PROVERCO, SOLID FLEX IN CAPPUCCINO, IN LIEU OF STANDARD NATURAL FINISH LEVEL S IN Dining
Line12385	Note:
5Oct16 / 26Oct16	
Inv.891	1 - FAMILY ROOM: INSTALL Upgrade 1 PROVERCO, SOLID FLEX IN CAPPUCCINO, IN LIEU OF STANDARD NATURAL FINISH LEVEL S IN Family
Line12386	Note:
5Oct16 / 26Oct16	
Inv.891	1 - MAIN HALL: INSTALL Upgrade 1 PROVERCO, SOLID FLEX IN CAPPUCCINO, IN LIEU OF STANDARD NATURAL FINISH LEVEL S IN Main Hall
Line12387	Note:
5Oct16 / 26Oct16	
Inv.891	1 - LANDING: INSTALL Upgrade 1 PROVERCO, SOLID FLEX IN CAPPUCCINO, IN LIEU OF STANDARD NATURAL FINISH LEVEL S ON Landing
Line12388	Note:
5Oct16 / 26Oct16	
Inv.891	1 - UPPER HALL: INSTALL Upgrade 1 PROVERCO, SOLID FLEX IN CAPPUCCINO, IN LIEU OF STANDARD CARPET LEVEL S IN Upper Hall
Line12389	Note:
5Oct16 / 26Oct16	

KITCHEN AND BATH CABINETRY

Inv.891	1 - TWIN BATH: INSTALL Handles Twin Bath bed 3/4
Line12395	Note:
5Oct16 / 26Oct16	

MISC.

Brampton Encore - 112 - 1 - 38-5 Elev.A HANDEL

Inv.472	1 - BONUS PACKAGE: \$2260.00 (INCLUDING TAXES) WORTH OF UPGRADES FROM GOLD PARK HOMES DÉCOR CENTRE IS BEING APPLIED TOWARD THE STRUCTURAL APPOINTMENT. PURCHASER HAS A REMAINING AMOUNT OF \$7740.00 (INCLUDING TAXES) TO BE USED TOWARD THE COLOUR APPOINTMENT
Line5700	Note:
28Apr16 / 9Jun16	
Inv.472	1 - Purchaser has attended a Structural appointment at the Decor Centre & has DECLINED any additional upgrades and accepts and acknowledges that there will be no further structural changes/additions/deletions to be made upon signing on April 28, 2016.
Line5701	Note:
28Apr16 / 9Jun16	
Inv.891	1 - BONUS PACKAGE: \$7740.00 (INCLUDING TAXES) WORTH OF UPGRADES FROM GOLD PARK HOMES DÉCOR CENTRE IS BEING APPLIED TOWARD THE COLOUR APPOINTMENT
Line12396	Note:
5Oct16 / 26Oct16	
Inv.891	1 - Purchaser has attended a Colour appointment at the Decor Centre & has DECLINED any additional upgrades and accepts and acknowledges that there will be no further structural changes/additions/deletions to be made upon signing on October 5, 2016
Line12398	Note:
5Oct16 / 26Oct16	
Inv.891	1 - Purchasers are aware & accepts that ANY changes made to upgrades after signing this Purchasers Extra Form are subject to a minimum administration fee of \$500. PLUS a 10% holdback fee
Line12399	Note:
5Oct16 / 26Oct16	

PAINTING

Inv.891	1 - STAIRCASE: Stain staircase 2 Storey Model (Euroline Pickets Charged Separately)
Line12390	Note:
5Oct16 / 26Oct16	

WINDOWS AND DOORS

Inv.472	1 - KITCHEN: INSTALL GARDEN DOORS IN LIEU OF PATIO SLIDERS-
Line5699	Note:
28Apr16 / 9Jun16	
Inv.472	1 - MAN DOOR GARAGE TO HOUSE - OPTIONAL - IF GRADE PERMITS
Line6789	Note: AS PER APS BONUS PACKAGE
28Apr16 / 9Jun16	

Purchasers: PARAMVIR SINGH SAINI & GURMEET KAUR P **Property:** 112 of Plan -

Telephone Res. / Bus: (416) 722-4690

Project: Fieldwalk Investments Inc.

Decor Advisor: Terri Parisani

Model and Elevation: 38-5 Elev.A HANDEL

Layout Changes: ☒ Yes ☐ No

Sketch Attached: ☒ Yes ☐ No

Exterior Colour Scheme:
1. Cabinetry

	Style and Colour	Counter	Hardware
Kitchen / Breakfast	Siena(oak)Butternut	Grigio Sardo Granite Edge: C-30	cs1-21
Laundry Room			
Powder Room			
TWIN BATH	Toscana(pvc)AntiqWhite	4926K-07 Black Alicante Laminate	*CH-44
Master Ensuite Bathroom	Toscana(pvc)ChocMapl	6696-46 Carrara Bianco Laminate	cs1-21
Second Ensuite Bathroom (If Applicable)	Toscana(pvc)SilkenMapl	4928-38 Venetian Ivory Laminate	cs1-21
Dishwasher Cabinet	N/A		

Comment
2. Floor Tile

	Selection	Grout	Threshold
Entrance Vestibule	Serpentine Beyaz, 13 x 13	N/A	N/A
Main Hall			
Kitchen / Breakfast	Serpentine Beyaz, 13 x 13	N/A	N/A
Laundry Room	Serpentine Beyaz, 13 x 13	N/A	N/A
Powder Room	Serpentine Beyaz, 13 x 13	N/A	N/A
TWIN BATH	Serpentine Syrak, 13 x 13	N/A	N/A
Master Ensuite Bathroom	Serpentine Beyaz, 13 x 13	N/A	N/A
Second Ensuite Bathroom (If Applicable)	New Reeds Silver, 13 x 13	N/A	N/A
Lower Landing (If Applicable)			

Comment
3. Wall Tile

	Selection	Listello/Inserts	Describe
TWIN BATH	Serpentine Syrak, 8 x 10	<input type="radio"/> Yes <input checked="" type="radio"/> No	
Master Ensuite Bathroom			
Tub Deck	Serpentine Beyaz, 8 x 10	<input type="radio"/> Yes <input checked="" type="radio"/> No	
Shower Stall	Serpentine Beyaz, 8 x 10	<input type="radio"/> Yes <input checked="" type="radio"/> No	
Bathroom Walls	Serpentine Beyaz, 8 x 10	<input type="radio"/> Yes <input checked="" type="radio"/> No	
Second Ensuite Bathroom (If Applicable)	New Reeds Silver, 8 x 10	<input type="radio"/> Yes <input checked="" type="radio"/> No	
		<input type="radio"/> Yes <input checked="" type="radio"/> No	
Kitchen Backsplash	<input type="radio"/> Yes <input checked="" type="radio"/> No	Backsplash Behind Fridge	None

Comment

Purchasers: PARAMVIR SINGH SAINI & GURMEET KAUR P. **Property:** 112 of Plan -

Telephone Res. / Bus: (416) 722-4690

Project: Fieldwalk Investments Inc.

Decor Advisor: Terri Parisani

Model and Elevation: 38-5 Elev.A **HANDEL**
4. Plumbing Fixtures

<input type="checkbox"/>	Second Ensuite	<input type="checkbox"/>	Powder Room	<input type="checkbox"/>
Master Ensuite Bathroom	<input type="checkbox"/>	Other Room - Specify	<input type="checkbox"/>	Other Washroom
<input type="text"/>				

Comment

PLUMBING FIXTURES ARE STANDARD THROUGHOUT

5. Hardwood Flooring

	Type and Stain		Type and Stain
Main Hall	*Upg.1 Proverco Cappuccino	Upper Landing	*Upg.1 Proverco Cappuccino
Kitchen / Breakfast	<input type="text"/>	Upper Hall	*Upg.1 Proverco Cappuccino
Living Room	<input type="text"/>	Master Bedroom	<input type="text"/>
Dining Room	*Upg.1 Proverco Cappuccino	Bedroom #2	<input type="text"/>
Family Room	*Upg.1 Proverco Cappuccino	Bedroom #3	<input type="text"/>
Den/Library	<input type="text"/>	Bedroom #4	<input type="text"/>
Entrance Vestibule	<input type="text"/>	Bedroom #5	<input type="text"/>
Lower Landing (If Applicable)	<input type="text"/>	Other Room - Specify	<input type="text"/>

Comment
6. Carpeting

	Upgrade	Description
Main Hall	<input type="checkbox"/>	<input type="text"/>
Living Room	<input type="checkbox"/>	<input type="text"/>
Dining Room	<input type="checkbox"/>	<input type="text"/>
Family Room	<input type="checkbox"/>	<input type="text"/>
Den/Library	<input type="checkbox"/>	<input type="text"/>
Upper Hall	<input type="checkbox"/>	<input type="text"/>
Master Bedroom	<input type="checkbox"/>	T-07
Bedroom #2	<input type="checkbox"/>	T-07
Bedroom #3	<input type="checkbox"/>	T-07
Bedroom #4	<input type="checkbox"/>	T-07
Bedroom #5	<input type="checkbox"/>	<input type="text"/>
<input type="text"/>	<input type="checkbox"/>	<input type="text"/>
Upper Landing (If Applicable)	<input type="checkbox"/>	<input type="text"/>
Lower Landing (If Applicable)	<input type="checkbox"/>	<input type="text"/>

Upgrade Underpad	Type Standard	Area <input type="text"/>
Carpet on Stairs	Capped N/A	Runner - *Upgrade N/A

Comment

Purchasers: PARAMVIR SINGH SAINI & GURMEET KAUR P Property: 112 of Plan -

Telephone Res. / Bus: (416) 722-4690

Project: Fieldwalk Investments Inc.

Decor Advisor: Terri Parisani

Model and Elevation: 38-5 Elev.A HANDEL

7. Fireplace

	Living Room			Family Room			Other Room - Specify		
	Purchased	As Per Plan	N/A	Purchased	As Per Plan	N/A	Purchased	As Per Plan	N/A
Fireplace Type	<input type="radio"/>	<input type="radio"/>	<input checked="" type="radio"/>	<input type="radio"/>	<input checked="" type="radio"/>	<input type="radio"/>	<input type="radio"/>	<input type="radio"/>	<input checked="" type="radio"/>
Mantle Type				STANDARD					
Colour / Stain				NF-20					
Surround				WHITE PAINT-GRADE					
Hearth				BIANCO CARRARA					
Comment				NONE					
<div></div>									

8. Trim Carpentry

Interior Doors	STANDARD	Front Door Glass Inserts	STANDARD	Door Handles	STANDARD
Interior Trim	STANDARD				
Comment	<div></div>				

9. Plaster Mouldings and Medallions

Entrance Vestibule	N/A		Kitchen/Breakfast	N/A	
Main Hall	N/A		Den/Library	N/A	
Living Room	N/A		Lower Landing	N/A	
Dining Room	N/A		Other Room - Specify		
Family Room	N/A				
Comment	<div></div>				

10. Railings and Spindles

Railing Package	STANDARD			
Railing Colour	*CAPPUCCINO	Spindle Colour	*CAPPUCCINO	
Stringer / Riser	*CAPPUCCINO	Treads	*CAPPUCCINO	
Comment			Oak Stairs	<input checked="" type="radio"/> Yes <input type="radio"/> No
<div></div>				

11. Wall Paint

Main & Upper Hall	WARM GREY	Master Bedroom	WARM GREY
Living Room	WARM GREY	Bedroom #2	WARM GREY
Dining Room	WARM GREY	Bedroom #3	WARM GREY
Kitchen / Breakfast	WARM GREY	Bedroom #4	WARM GREY
Family Room	WARM GREY	Bedroom #5	WARM GREY
Powder Room	WARM GREY	Master Ensuite	WARM GREY
Laundry Room	WARM GREY	TWIN BATH	WARM GREY
Den/Library	WARM GREY	Second Ensuite	WARM GREY
Trim Paint	WHITE		
Comment	Smooth Ceilings First Floor		
<div></div>			

Scheduled Closing Date: Thursday, October 20, 2016

Purchasers: PARAMVIR SINGH SAINI & GURMEET KAUR P. **Property:** 112 of Plan -

Telephone Res. / Bus: (416) 722-4690

Project: Fieldwalk Investments Inc.

Decor Advisor: Terri Parisani

Model and Elevation: 38-5 Elev.A HANDEL

12. Electrical

Plugs and Switches ☒ White ☐ Ivory
Hood Fan ☐ White ☐ Ivory
Appliances **Built in Cooktop** ☐ Yes ☒ No **Built in Oven** ☐ Yes ☒ No **Gas Stove** ☐ Yes ☒ No **Microwave** ☐ Yes ☒ No
Above Kitchen Cabinet Light ☐ Yes ☒ No **Below Kitchen Cabinet Light** ☐ Yes ☒ No

Comment

STANDARD HOOD FAN: STAINLESS STEEL

13. Heating and Air Conditioning

Air Conditioning **Gas Provisions Stove**
Gas Provisions Dryer **Gas Provisions Barbecue**

Comment

GAS LINE FOR BBQ IS STANDARD

14. Additional Comments
15. Disclaimers and Notes

- Colours of all materials are as close as possible to builder's selection, but not necessarily identical due to variances in manufacturing.
- Any extras listed above are null and void unless accompanied by a separate invoice/amendment. Said invoice must be paid in full.
- The Purchaser acknowledges that after Interior Colour Selection form is signed and dated, no further changes will be permitted other than re-selection due to unavailability. _____ Purchaser's Initials
- The Purchaser acknowledges reading and accepting the "Gold Park Homes Decor Centre Disclaimers" form. This document contains other miscellaneous disclaimers.

This Interior Colour Selection is final and approved by:

Signature: *Paramvir Saini* Date: Oct 5/16 Signature: *Gurmeet Kaur* Date: October 5/2016

encore
BRAMPTON

Telephone — (P)
Cable — (C)

The Handel
38' SERIES

Elevation A • 2,603 sq.ft. | Elevation B • 2,603 sq.ft.

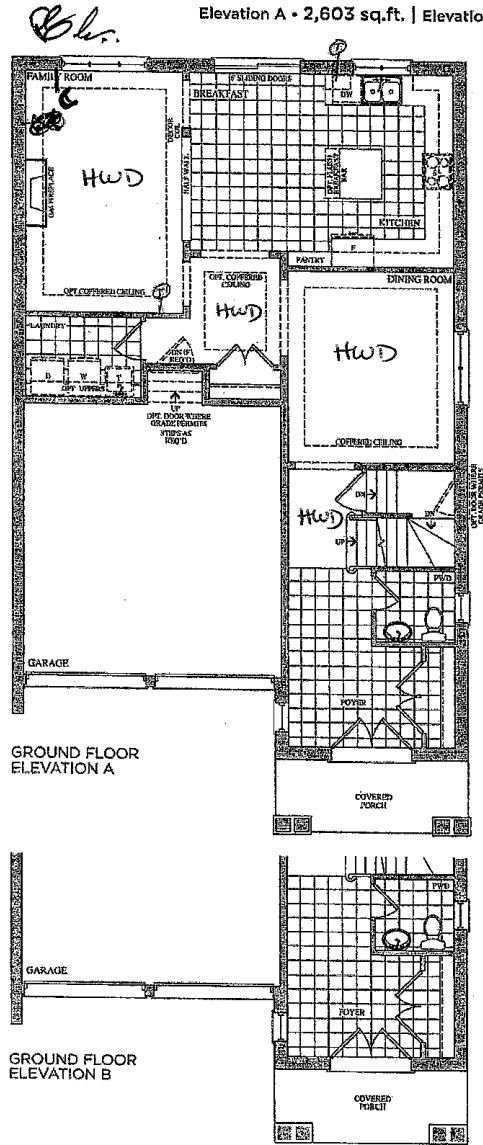

Lot 112
April 28, 16
(P) (C)

Prices, finishes, elevations, sizes, features and finishes are subject to change without notice. E.S.O.E. Areas and dimensions are approximate and actual usable floor space may vary from the stated area. Layout may be reverse of the unit purchased. E & B O.E.

GOLDPARK
HOMES

Lot 112
Oct. 5, 16
(P) (C)

encore
BRAMPTON

Telephone ①
Cable ②

The Handel
38' SERIES

Elevation A • 2,603 sq.ft. | Elevation B • 2,603 sq.ft.

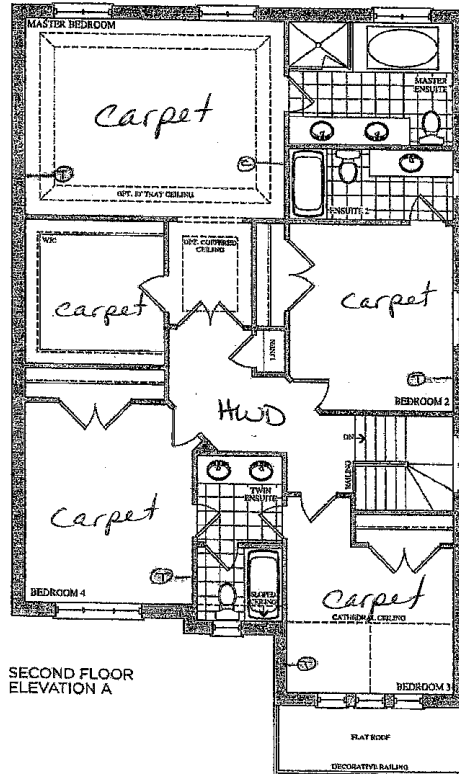

SECOND FLOOR
ELEVATION A

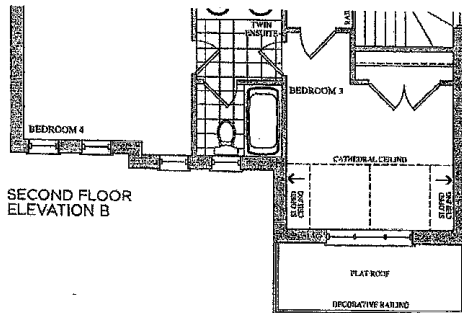

SECOND FLOOR
ELEVATION B

Lot 112
April 28, 16
① ②

Prices, figures, illustrations, sizes, features and finishes are subject to change without notice. E&OE. Areas and dimensions are approximate and actual usable floor space may vary from the stated area. Layout may be reverse of the unit purchased. E & OE

GOLDPARK
HOMES

Lot 112
Oct 5, 16

① ②

CORTINA

KITCHENS INC.

70 Regina Road Woodbridge ON L4L 8L6
905-264-6464

INFORMATION - PVC DOORS

Builder: Gold Park Homes Project: Encore Lot #: 112

All cabinets with PVC (Thermofoil) Doors come with melamine gables, panels and kick. The doors, crown moulding and light valance are PVC wrapped. Open shelves incorporated in design will only be available with melamine interiors. There will be variations in colour shades between the PVC parts (doors, crown and Light valance) and the melamine parts (open shelves, Gables, Panels and Kick) due to the difference in material.

Furring Panel with crown moulding to the ceiling is not available on all PVC door styles due to subtle variations in colour shades between the PVC parts (moulding) and the melamine parts (furring panel) due to the difference in material. Grain directions in wood grain pattern melamine, vary between the furring panel, crown moulding (horizontal) and the PVC doors (vertical).

Thank you for your understanding.

I am well informed of this information, and agree to the purchase of the above.

Purchaser: *Lawrence*
Guarant Raur

Date: *Oct 5/16*



CSI-6



CSI-10

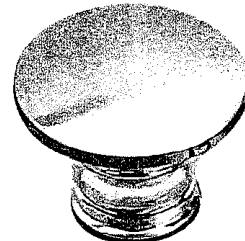

CSI-14

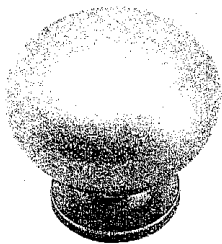

CSI-16

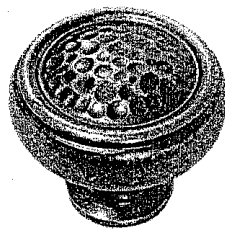

CSI-18

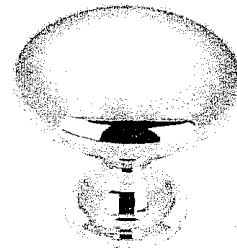

CSI-19

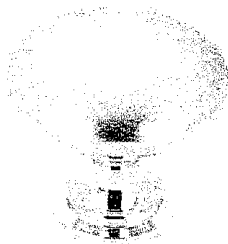

CSI-20

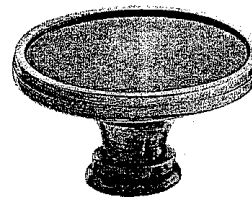

CSI-21

Kitchen
Master
Eas. 2

CSI-22

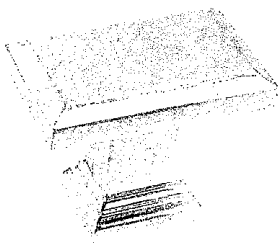

CSI-23

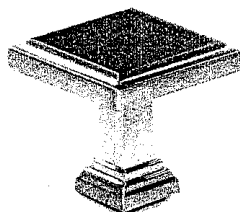

CSI-24

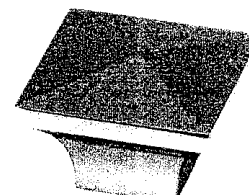

CSI-25

***NOTES:**

- IMAGES ARE FOR QUICK REFERENCE PURPOSES ONLY
- ACTUAL SIZES AND FINISHES AS PER HARDWARE
- SAMPLE BOARD PROVIDED TO DECOR CENTRE

M.
P.S.

UPGRADE HARDWARE



UPGRADE HARDWARE



CH-32

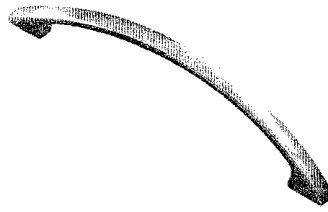

CH-38

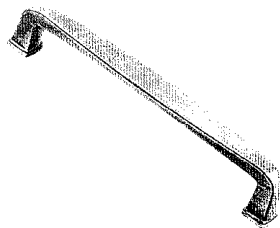

CH-44

Twin
Bath

CH-45

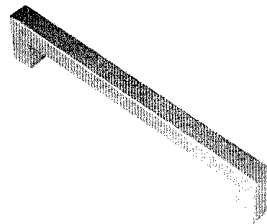

CH-46

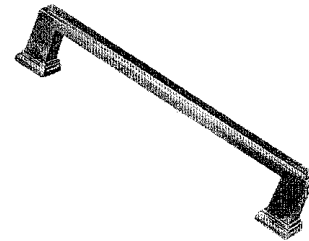

CH-47

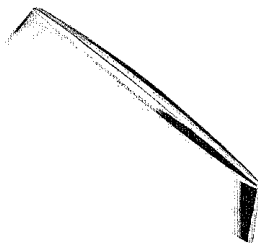

CH-48

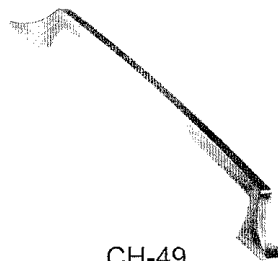

CH-49

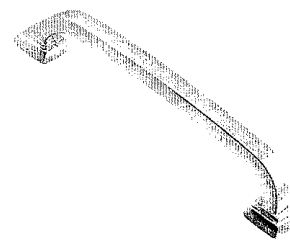

CH-50

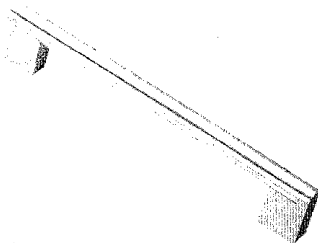

CH-51

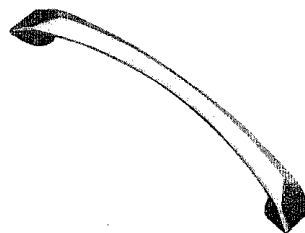

CH-52

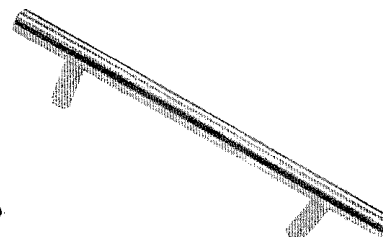

CH-53

*NOTES:

- IMAGES ARE FOR QUICK REFERENCE PURPOSES ONLY
- ACTUAL SIZES AND FINISHES AS PER HARDWARE
- SAMPLE BOARD PROVIDED TO DECOR CENTRE

CORTINA

KITCHENS INC.
70 Regatta Road, Woodbridge, Ontario L4L 8L8
Tel: 905-294-4484 Fax: 905-294-0564
www.CortinaKitchens.com

QUOTATION

Date: 06/23/16

Trade Name: Gold Park Homes

Site location: Brampton

Model: 38-5

Address:

Project: Encore

Phase:

This layout has been explained to the purchaser by Cortina Kitchens Inc. and is understood by the purchaser.

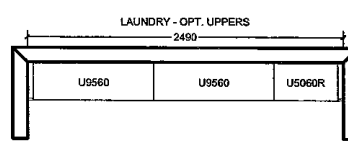
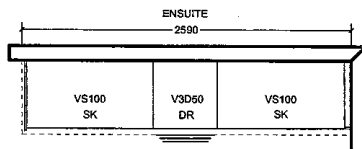
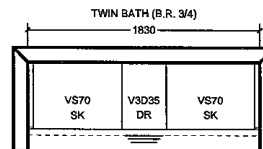
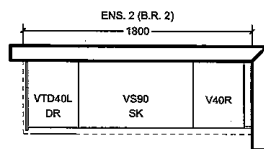
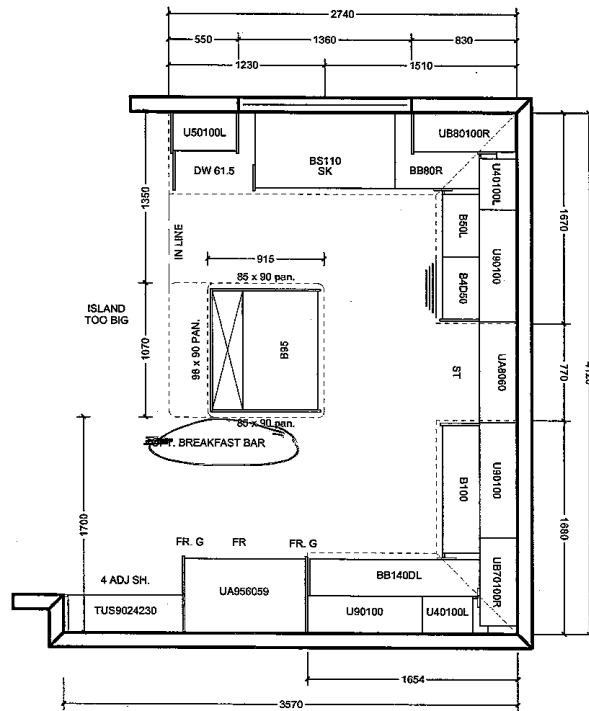

All prices subject to confirmation from head office.
This quotation is subject to the terms & conditions set out
in Cortina's Agreement of Purchase and Sale.

All agreements are contingent upon strikes, accidents, and delay beyond our control.
Please provide our installer with template for sinkholes or \$150.00 will be charged for callback.

ACCEPTED DATE: Oct 5th 2016

CUSTOMER SIGNATURE: [Signature]

SALESPERSON SIGNATURE: [Signature]

CORTINA HEAD OFFICE APPROVAL

ITEM A: Wood grain and colour are characteristics of the product, we cannot guarantee that such grain and colour will always match.
ITEM B: Cortina Kitchens reserves the right to alter dimensions and make technical changes without notice.