

## Brampton Encore - 8 - 1 - 38-4 Elev.A VIVALDI

### CARPET

Inv.874	1 - BEDROOM #2: INSTALL City View Berber IN Bed 2
Line12111	Note:
28Sep16 / 11Oct16	
Inv.874	1 - BEDROOM #3: INSTALL City View Berber IN Bed 3
Line12112	Note:
28Sep16 / 11Oct16	
Inv.874	1 - BEDROOM #4: INSTALL City View Berber IN Bed 4
Line12113	Note:
28Sep16 / 11Oct16	
Inv.874	1 - MASTER BEDROOM: INSTALL City View Berber IN Master Bed
Line12114	Note:
28Sep16 / 11Oct16	

### CENTRAL VAC AND WIRING

Inv.494	1 - TELEPHONE AND CABLE ROUGH-IN LOCATIONS
Line6005	Note:
12May16 / 27May16	

### EXTERIOR COLOURS

Inv.494	1 - EXTERIOR COLOUR PACKAGE 9
Line6156	Note:
12May16 / 27May16	

### FORMING

Inv.494	1 - EXTERIOR: INSTALL SIDE DOOR- HOME TO EXTERIOR- AS PER PLAN AND GRADE PERMITTING
Line6006	Note:
12May16 / 27May16	

### FRAMING

Inv.494	1 - MANDOOR - GARAGE TO HOUSE- AS PER PLAN AND GRADE PERMITTING
Line6158	Note: AS PER BONUS PKG APS
12May16 / 27May16	

### GRANITE MARBLE QUARTZ

Inv.874	1 - KITCHEN: INSTALL 2 CM GRP 1 Optional Flush BBar
Line12102	Note:
28Sep16 / 11Oct16	

### HARDWOOD

Inv.874	1 - DINING ROOM: INSTALL Upgrade 2 EXPRESSION HARD MAPLE, IN LIEU OF THE STANDARD NATURAL OAK LEVEL I Dining
Line12103	Note:
28Sep16 / 11Oct16	
Inv.874	1 - FAMILY ROOM: INSTALL Upgrade 2 EXPRESSION HARD MAPLE, IN LIEU OF THE STANDARD NATURAL OAK, LEVEL I IN Family RM
Line12104	Note:
28Sep16 / 11Oct16	

## Brampton Encore - 8 - 1 - 38-4 Elev.A VIVALDI

Inv.874	1 - LANDINGS: INSTALL Upgrade 2 EXPRESSION HARD MAPLE, IN LIEU OF THE STANDARD NATURAL OAK LEVEL I ON Landing
Line12105	Note:
28Sep16 / 11Oct16	
Inv.874	1 - MAIN HALL: INSTALL Upgrade 2 EXPRESSION HARD MAPLE, IN LIEU OF THE STANDARD NATURAL OAK LEVEL I IN Main Hall
Line12106	Note:
28Sep16 / 11Oct16	
Inv.874	1 - DINING ROOM: INSTALL Upgrade 2 EXPRESSION HARD MAPLE, IN LIEU OF THE STANDARD CARPET LEVEL I IN Upper Hall
Line12107	Note:
28Sep16 / 11Oct16	

### MISC.

Inv.445	1 - BONUS PACKAGE: 1,452.05 (INCLUDING TAXES) WORTH OF UPGRADES FROM GOLD PARK HOMES DÉCOR CENTRE IS BEING APPLIED TOWARD THE STRUCTURAL APPOINTMENT. PURCHASER HAS A REMAINING AMOUNT OF \$13,547.95 (INCLUDING TAXES) TO BE USED TOWARD THE COLOUR APPOINTMENT
Line5487	Note:
21Apr16 / 27May16	
Inv.445	1 - Purchasers are aware & accepts that ANY changes made to upgrades after signing this Purchasers Extra Form are subject to a minimum administration fee of \$500. PLUS a 10% holdback fee
Line5488	Note:
21Apr16 / 27May16	
Inv.494	1 - BONUS PACKAGE: \$2768.50 (INCLUDING TAXES) WORTH OF UPGRADES FROM GOLD PARK HOMES DÉCOR CENTRE IS BEING APPLIED TOWARD THE STRUCTURAL APPOINTMENT. PURCHASER HAS A REMAINING AMOUNT OF \$10,779.45 (INCLUDING TAXES) TO BE USED TOWARD THE COLOUR APPOINTMENT
Line6008	Note:
12May16 / 27May16	
Inv.494	1 - Purchaser has attended a Structural appointment at the Decor Centre & has DECLINED any additional upgrades and accepts and acknowledges that there will be no further structural changes/additions/deletions to be made upon signing on May 12, 2016
Line6009	Note:
12May16 / 27May16	
Inv.494	1 - Purchasers are aware & accepts that ANY changes made to upgrades after signing this Purchasers Extra Form are subject to a minimum administration fee of \$500. PLUS a 10% holdback fee
Line6010	Note:
12May16 / 27May16	
Inv.874	1 - STAIRCASE VS FLOORING WOOD SPECIES DIFFERENCE: STAIRCASE - The purchaser was advised and therefore accepts and acknowledges that the wood species of the staircase and flooring chosen do not match. This difference may result in a stain colour variance
Line12115	Note: The purchaser agrees that the vendor is to be exempt from any and all claims by the purchaser regarding this colour variance
28Sep16 / 11Oct16	
Inv.874	1 - BONUS PACKAGE: \$10,779.45 (INCLUDING TAXES) WORTH OF UPGRADES FROM GOLD PARK HOMES DÉCOR CENTRE IS BEING APPLIED TOWARD THE COLOUR APPOINTMENT
Line12116	Note:
28Sep16 / 11Oct16	
Inv.874	1 - Purchaser has attended a Colour appointment at the Decor Centre & has DECLINED any additional upgrades and accepts and acknowledges that there will be no further structural changes/additions/deletions to be made upon signing on September 26, 2016
Line12117	Note:
28Sep16 / 11Oct16	

## Brampton Encore - 8 - 1 - 38-4 Elev.A VIVALDI

Inv.874	1 - Purchasers are aware & accepts that ANY changes made to upgrades after signing this Purchasers Extra Form are subject to a minimum administration fee of \$500. PLUS a 10% holdback fee
Line12118	Note:
28Sep16 / 11Oct16	

### PAINTING

Inv.874	1 - STAIRCASE: Stain Staircase 2 Storey Model (Euroline Pickets Charged Separately)
Line12108	Note: STAIN ON MAPLE FLOORS WILL APPEAR DIFFERENT ON OAK STAIRS
28Sep16 / 11Oct16	

### PLUMBING

Inv.494	1 - KITCHEN: INSTALL ROUGH-IN - WATERLINE FOR FRIDGE
Line6007	Note:
12May16 / 27May16	

### WINDOWS - BASEMENT

Inv.445	1 - BASEMENT: INSTALL ONE(1) BASEMENT WINDOWS - UPGRADE EXISTING BASEMENT WINDOW TO 53 INCH X 16 INCH EGRESS. TO BE APPROVED BY CONSTRUCTION. SEE SKETCH
Line5486	Note:
21Apr16 / 27May16	
Inv.445	3 - BASEMENT - INSTALL THREE (X3) BASEMENT WINDOWS - UPGRADE EXISTING BASEMENT WINDOW TO 30 INCH X 16 INCH. TO BE APPROVED BY CONSTRUCTION - SEE SKETCH
Line5891	Note:
21Apr16 / 27May16	

### WINDOWS AND DOORS

Inv.494	1 - MAN DOOR GARAGE TO HOUSE - OPTIONAL - IF GRADE PERMITS
Line6157	Note: AS PER BONUS PKG APS
12May16 / 27May16	

Purchaser: Sasikaran Mailvaganam

Property: 8 of Plan -

Telephone Res. / Bus: (905) 276-2231

Project: Fieldwalk Investments Inc.

Decor Advisor: Laura Di Pede

Model and Elevation: 38-4 Elev.A VIVALDI

 Layout Changes: ☐ Yes ☒ No

 Sketch Attached: ☒ Yes ☐ No

Exterior Colour Scheme:

**1. Cabinetry**

	Style and Colour	Counter	Hardware
Kitchen / Breakfast	Venice(pvc)Choc.Maple	Crema Caramel GRANITE Edge: C20	cs1-14
Laundry Room	N/A	N/A	N/A
Powder Room	N/A	N/A	N/A
Master Ensuite Bathroom	Cararra(pvc)Vanilla Stix	P-948CA Hiverna LAMINATE	cs1-22
Second Ensuite Bathroom (If Applicable)	Toscana(pvc)Silver	8830-58 Elementain Concrete LAMINATE	cs1-6
Twin ensuite	Siena(oak)Olive	4925K-07 Calcutta Marble LAMINATE	cs1-20
Dishwasher Cabinet	N/A		

Comment

**2. Floor Tile**

	Selection	Grout	Threshold
Entrance Vestibule	New Reeds Silver, 13x13	N/A	N/A
Main Hall	n/a	N/A	N/A
Kitchen / Breakfast	New Reeds Silver, 13x13	N/A	N/A
Laundry Room	New Reeds Silver, 13x13	N/A	N/A
Powder Room	New Reeds Silver, 13x13	N/A	N/A
Master Ensuite Bathroom	New Reeds Taupe, 13x13	N/A	N/A
Second Ensuite Bathroom (If Applicable)	New Reeds Grey, 13x13	N/A	N/A
Lower Landing (If Applicable)	n/a	N/A	N/A
Twin ensuite	New Reeds Silver, 13x13	N/A	N/A

Comment

**3. Wall Tile**

	Selection	Listello/Inserts	Describe
		<input type="radio"/> Yes <input checked="" type="radio"/> No	
Master Ensuite Bathroom			
Tub Deck	New Reeds Taupe, 8 x 10	<input type="radio"/> Yes <input checked="" type="radio"/> No	
Shower Stall	New Reeds Taupe, 8 x 10	<input type="radio"/> Yes <input checked="" type="radio"/> No	
Bathroom Walls	New Reeds Taupe, 8 x 10	<input type="radio"/> Yes <input checked="" type="radio"/> No	
Second Ensuite Bathroom (If Applicable)	New Reeds Grey, 8 x 10	<input type="radio"/> Yes <input checked="" type="radio"/> No	
TWIN BATH	New Reeds Silver, 8 x 10	<input type="radio"/> Yes <input checked="" type="radio"/> No	

Kitchen Backsplash

☐ Yes ☒ No

Backsplash Behind Fridge

no

Comment

**Purchaser:** Sasikaran Mailvaganam

**Property:** 8 of Plan -

**Telephone Res. / Bus:** (905) 276-2231

**Project:** Fieldwalk Investments Inc.

**Decor Advisor:** Laura Di Pede

**Model and Elevation:** 38-4 Elev.A VIVALDI

**4. Plumbing Fixtures**

<input type="text"/>	<b>Second Ensuite</b>	<input type="text"/>	<b>Powder Room</b>	<input type="text"/>
<b>Master Ensuite Bathroom</b>	<input type="text"/>	<b>Other Room - Specify</b>	<input type="text"/>	<b>Other Washroom</b>
<input type="text"/>				

**Comment**

ALL PLUMBING FIXTURES TO BE STANDARD THROUGHOUT

**5. Hardwood Flooring**

	Type and Stain		Type and Stain
<b>Main Hall</b>	*Upg.2 Expression Maple-Komodo	<b>Upper Landing</b>	*Upg.2 Expression Maple-Komodo
<b>Kitchen / Breakfast</b>	<input type="text"/>	<b>Upper Hall</b>	*Upg.2 Expression Maple-Komodo
<b>Living Room</b>	<input type="text"/>	<b>Master Bedroom</b>	<input type="text"/>
<b>Dining Room</b>	*Upg.2 Expression Maple-Komodo	<b>Bedroom #2</b>	<input type="text"/>
<b>Family Room</b>	*Upg.2 Expression Maple-Komodo	<b>Bedroom #3</b>	<input type="text"/>
<b>Den/Library</b>	<input type="text"/>	<b>Bedroom #4</b>	<input type="text"/>
<b>Entrance Vestibule</b>	<input type="text"/>	<b>Bedroom #5</b>	<input type="text"/>
<b>Lower Landing (If Applicable)</b>	<input type="text"/>	<b>Other Room - Specify</b>	<input type="text"/>

**Comment**

\*\*NOTE: FLOORING IS MAPLE AND THE STAIN WILL SHOW DIFFERENTLY ON THE OAK STAIRCASE

**6. Carpeting**

	Upgrade	Description
<b>Main Hall</b>	<input type="checkbox"/>	<input type="text"/>
<b>Living Room</b>	<input type="checkbox"/>	<input type="text"/>
<b>Dining Room</b>	<input type="checkbox"/>	<input type="text"/>
<b>Family Room</b>	<input type="checkbox"/>	<input type="text"/>
<b>Den/Library</b>	<input type="checkbox"/>	<input type="text"/>
<b>Upper Hall</b>	<input type="checkbox"/>	<input type="text"/>
<b>Master Bedroom</b>	<input type="checkbox"/>	*UPG1, 927 BALLGOWN CITYVIEW BERBER
<b>Bedroom #2</b>	<input type="checkbox"/>	*UPG1, 927 BALLGOWN CITYVIEW BERBER
<b>Bedroom #3</b>	<input type="checkbox"/>	*UPG1, 927 BALLGOWN CITYVIEW BERBER
<b>Bedroom #4</b>	<input type="checkbox"/>	*UPG1, 927 BALLGOWN CITYVIEW BERBER
<b>Bedroom #5</b>	<input type="checkbox"/>	<input type="text"/>
<input type="text"/>	<input type="checkbox"/>	<input type="text"/>
<b>Upper Landing (If Applicable)</b>	<input type="checkbox"/>	<input type="text"/>
<b>Lower Landing (If Applicable)</b>	<input type="checkbox"/>	<input type="text"/>

<b>Upgrade Underpad</b>	<b>Type</b>	<b>Area</b>
	STANDARD	N/A
<b>Carpet on Stairs</b>	<b>Capped</b>	<b>Runner - *Upgrade</b>
	N/A	N/A

**Comment**

Purchaser: Sasikaran Mailvaganam

Property: 8 of Plan -

Telephone Res. / Bus: (905) 276-2231

Project: Fieldwalk Investments Inc.

Decor Advisor: Laura Di Pede

Model and Elevation: 38-4 Elev.A VIVALDI

**7. Fireplace**

	Living Room			Family Room			Other Room - Specify		
	Purchased	As Per Plan	N/A	Purchased	As Per Plan	N/A	Purchased	As Per Plan	N/A
Fireplace Type	<input type="radio"/>	<input type="radio"/>	<input checked="" type="radio"/>	<input type="radio"/>	<input checked="" type="radio"/>	<input type="radio"/>	<input type="radio"/>	<input type="radio"/>	<input checked="" type="radio"/>
Mantle Type				N/A					
Colour / Stain				NF24					
Surround				WHITE PAINT GRADE					
Hearth				Travertino Classico					
Comment	<input type="text"/>								

**8. Trim Carpentry**

Interior Doors	STD	Front Door Glass Inserts	STD	Door Handles	STD
Interior Trim	STD				
Comment	<input type="text"/>				

**9. Plaster Mouldings and Medallions**

Entrance Vestibule	NO	NO	Kitchen/Breakfast	NO	NO
Main Hall	NO	NO	Den/Library	NO	NO
Living Room	NO	NO	Lower Landing	NO	NO
Dining Room	NO	NO	Other Room - Specify	NO	NO
Family Room	NO	NO	NO		
Comment	<input type="text"/>				

**10. Railings and Spindles**

Railing Package	STANDARD	
Railing Colour	*KOMODO	Spindle Colour
Stringer / Riser	*KOMODO	Treads
Comment	Oak Stairs <input checked="" type="radio"/> Yes <input type="radio"/> No	
**NOTE: FLOORING IS MAPLE AND THE STAIN WILL SHOW DIFFERENTLY ON THE OAK STAIRCASE		

**11. Wall Paint**

Main & Upper Hall	WARM GREY	Master Bedroom	WARM GREY
Living Room	WARM GREY	Bedroom #2	WARM GREY
Dining Room	WARM GREY	Bedroom #3	WARM GREY
Kitchen / Breakfast	WARM GREY	Bedroom #4	WARM GREY
Family Room	WARM GREY	Bedroom #5	N.A
Powder Room	WARM GREY	Master Ensuite	WARM GREY
Laundry Room	WARM GREY	TWIN ENSUITE	WARM GREY
Den/Library	N.A	Second Ensuite	WARM GREY
Trim Paint	WHITE		
Comment	Smooth Ceilings First Floor		

Scheduled Closing Date: Thursday, September 08, 2016

Purchaser: Sasikaran Mailvaganam

Property: 8 of Plan -

Telephone Res. / Bus: (905) 276-2231

Project: Fieldwalk Investments Inc.

Decor Advisor: Laura Di Pede

Model and Elevation: 38-4 Elev.A VIVALDI

**12. Electrical**

Plugs and Switches ☒ White ☐ Ivory   
 Hood Fan ☒ White ☐ Ivory  
 Appliances Built in Cooktop Built in Oven Gas Stove Microwave  
☐ Yes ☒ No ☐ Yes ☒ No ☐ Yes ☒ No ☐ Yes ☒ No

**Comment**

STANDARD HOOD FAN: STAINLESS STEEL

**13. Heating and Air Conditioning**

Air Conditioning  Gas Provisions Stove   
 Gas Provisions Dryer  Gas Provisions Barbecue

**Comment**

GAS LINE FOR BBQ IS STANDARD

**14. Additional Comments**

**15. Disclaimers and Notes**

- Colours of all materials are as close as possible to builder's selection, but not necessarily identical due to variances in manufacturing.
- Any extras listed above are null and void unless accompanied by a separate invoice/amendment. Said invoice must be paid in full.
- The Purchaser acknowledges that after Interior Colour Selection form is signed and dated, no further changes will be permitted other than re-selection due to unavailability. \_\_\_\_\_ Purchaser's Initials
- The Purchaser acknowledges reading and accepting the "Gold Park Homes Decor Centre Disclaimers" form. This document contains other miscellaneous disclaimers.

This Interior Colour Selection is final and approved by:

Signature: *Laura Di Pede* Date: Sep 28, 2016

encore  
BRAMPTON

# The Vivaldi

## 38' SERIES

Elevation A • 2,518 sq.ft. | Elevation B • 2,518 sq.ft.

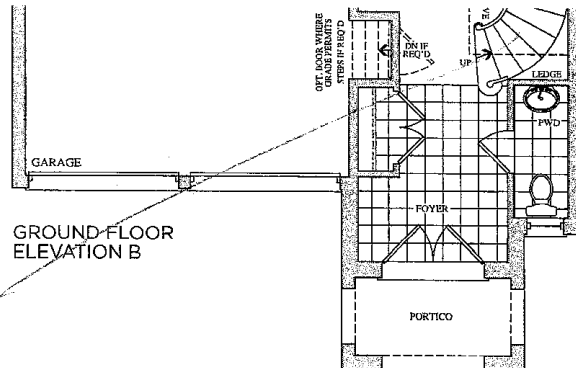
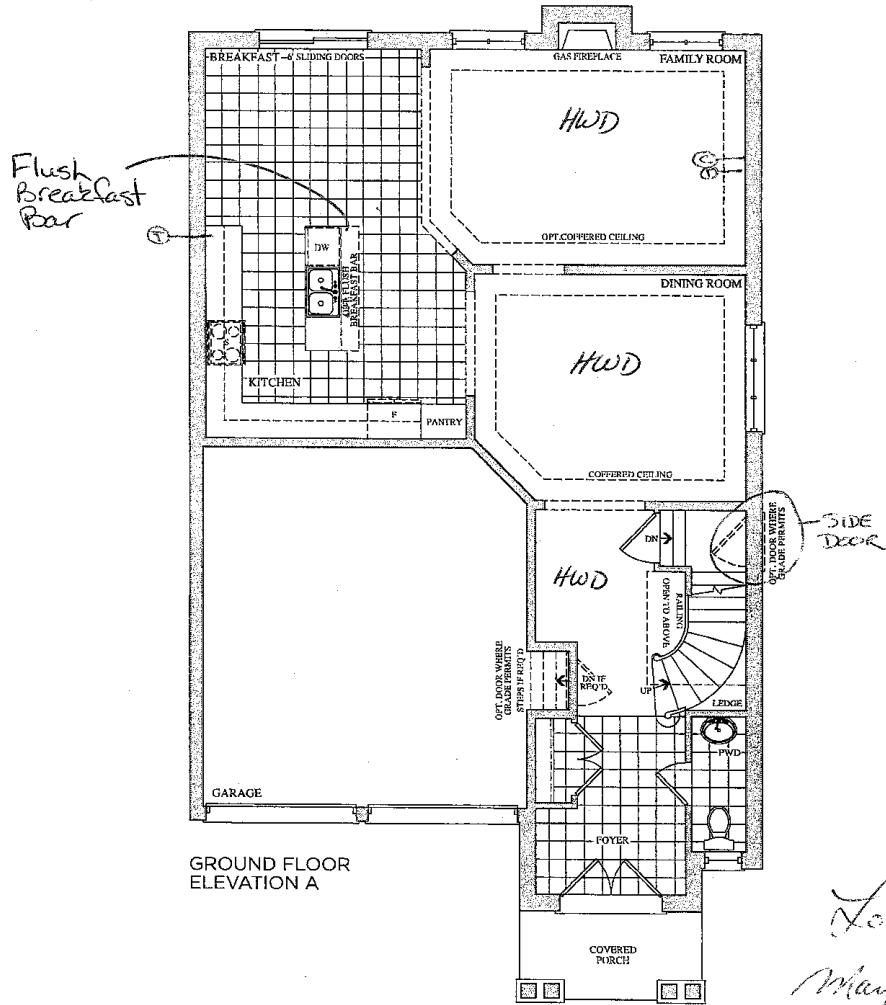

Lot 8  
Sept 28, 16  
SM

Prices, figures, illustrations, sizes, features and finishes are subject to change without notice. E & O.E. Areas and dimensions are approximate and actual usable floor space may vary from the stated area. Layout may be reverse of the unit purchased. E & O.E.

**GOLDPARK**  
HOMES



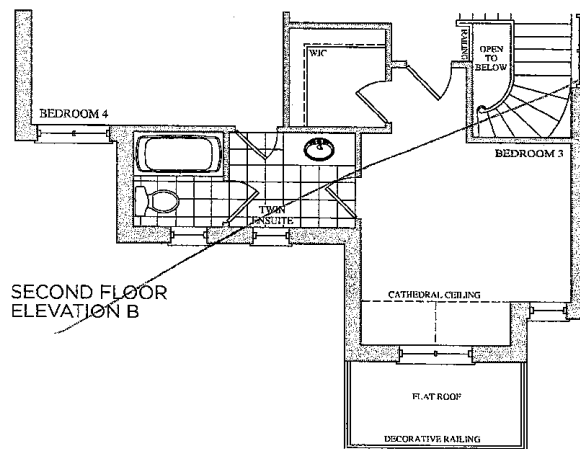
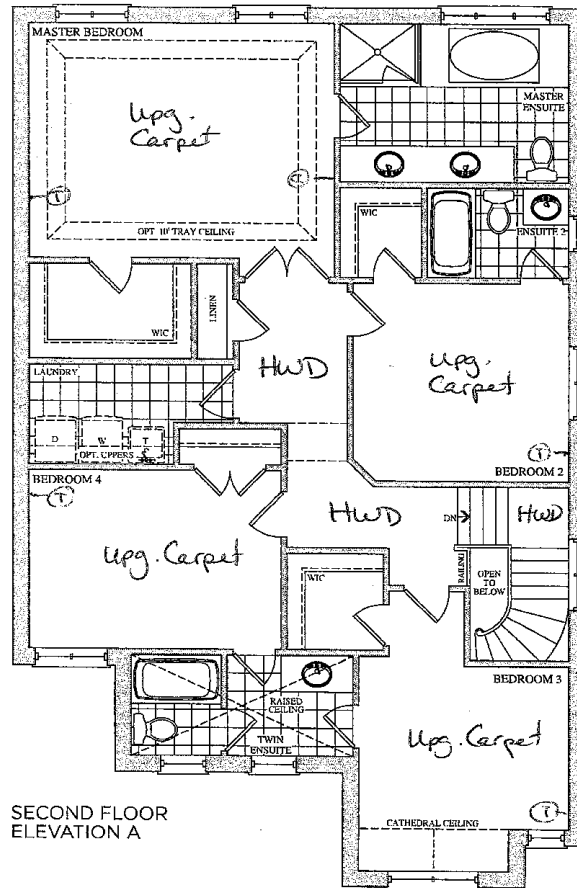

Lot 8

May 12, 16

En

Lot 8  
Sept 28, 16

En

# CORTINA

KITCHENS INC.  
75 Regan Road, Woodbridge, Ontario L4L 6L6  
Tel: 905-254-0481 Fax: 905-254-0854  
www.CortinaKitchens.com

## QUOTATION

Date: 06/23/16

Trade Name: Gold Park Homes

Site location: Brampton

Model: 38-4

Address:

Project: Encore

Phase:

This layout has been explained to the purchaser by Cortina Kitchens Inc. and is understood by the purchaser.

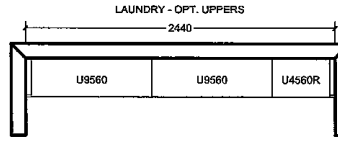
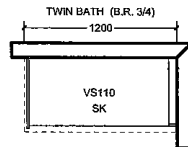
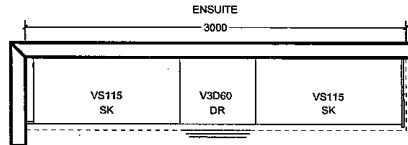
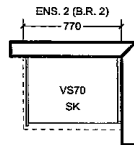
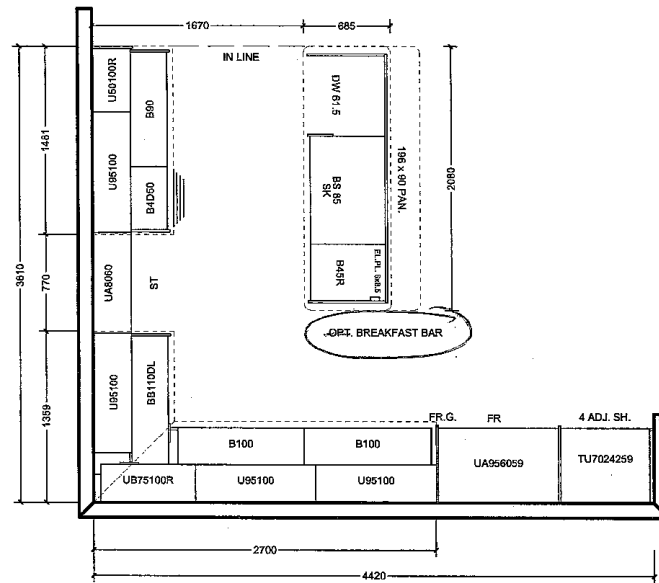

All prices subject to confirmation from head office.  
This quotation is subject to the terms & conditions set out  
in Cortina's Agreement of Purchase and Sale

ACCEPTED DATE: Sep 28 2016

CUSTOMER SIGNATURE

All agreements are contingent upon strikes, accidents, and delay beyond our control.  
Please provide our installer with template for sinkholes or \$150.00 will be charged for callback.

SALESPERSON SIGNATURE

CORTINA HEAD OFFICE APPROVAL

ITEM A. Wood grain and colour are characteristics of the product, we cannot guarantee that such grain and colour will always match  
ITEM B. Cortina Kitchens reserves the right to alter dimensions and make technical changes without notice.

# CORTINA

KITCHENS INC.

70 Regina Road Woodbridge ON L4L 8L6  
905-264-6464

## INFORMATION - PVC DOORS

Builder: Gold Park Homes Project: Encore Lot #: 8

All cabinets with PVC (Thermofoil) Doors come with melamine gables, panels and kick. The doors, crown moulding and light valance are PVC wrapped. Open shelves incorporated in design will only be available with melamine interiors. There will be variations in colour shades between the PVC parts (doors, crown and Light valance) and the melamine parts (open shelves, Gables, Panels and Kick) due to the difference in material.

Furring Panel with crown moulding to the ceiling is not available on all PVC door styles due to subtle variations in colour shades between the PVC parts (moulding) and the melamine parts (furring panel) due to the difference in material. Grain directions in wood grain pattern melamine, vary between the furring panel, crown moulding (horizontal) and the PVC doors (vertical).

Thank you for your understanding.

---

I am well informed of this information, and agree to the purchase of the above.

Purchaser: [Signature]

Date: Sep 28, 2016

## STANDARD HARDWARE



STANDARD HARDWARE

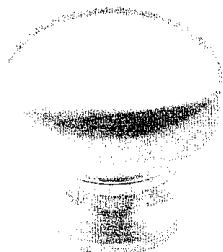

CSI-6

Ensuite 2



CSI-10

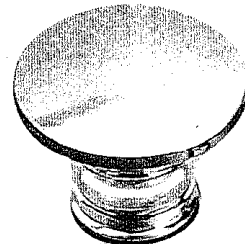

CSI-14

Kitchen

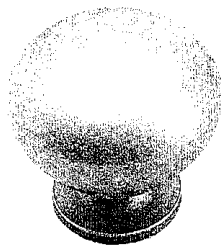

CSI-16



CSI-18

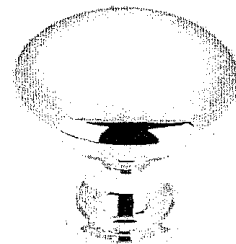

CSI-19

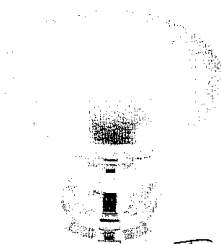

CSI-20

Twin Bath

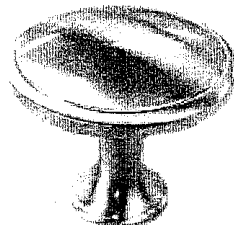

CSI-21

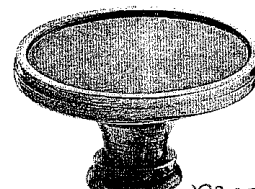

CSI-22

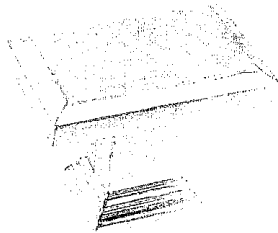
master  
Ens.

CSI-23

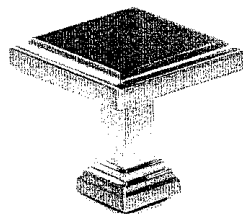

CSI-24

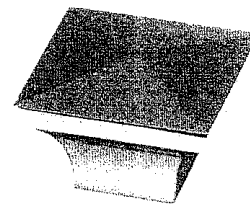

CSI-25

## \*NOTES:

- IMAGES ARE FOR QUICK REFERENCE PURPOSES ONLY
- ACTUAL SIZES AND FINISHES AS PER HARDWARE SAMPLE BOARD PROVIDED TO DECOR CENTRE