

Kleinburg Glen - 8R - 1 - 25-6 Elev.B LINCOLN OPT- GFA2 AND MFA1

APPLIANCES

Inv.685	1 - KITCHEN: RELOCATE FRIDGE AGAINST WALL. PLEASE SEE FLOORPLAN FOR LOCATION
Line9010	Note:
20Jul16 / 3Oct16	

CENTRAL VAC AND WIRING

Inv.685	1 - FAMILY ROOM: CONDUIT PIPE - FOR TELEVISION - CENTERED AT 54" AFF ON FAMILY ROOM/DINING ROOM WALL. TERMINATING ON EAST WALL. PLEASE SEE FLOORPLAN FOR LOCATION
Line9017	Note:
20Jul16 / 3Oct16	

CERAMIC

Inv.901	1 - FOYER / POWDER ROOM / LAUNDRY / KITCHEN - FLOOR TILES: UPG 4 Floor Tile
Line12606	Note:
13Oct16 / 8Dec16	
Inv.901	1 - MASTER ENSUITE FLOOR TILE: UPG 4, *12x24 Volakis Series White Polished
Line12608	Note: Floor, Tub Deck, Tub Skirt, Tub Splash
13Oct16 / 8Dec16	
Inv.901	1 - ENSUITE 4: UPG 2 Floor Tile
Line13390	Note:
13Oct16 / 8Dec16	
Inv.901	1 - MAIN BATH FLOOR TILE: UPG 2 Floor Tile
Line13389	Note:
13Oct16 / 8Dec16	
Inv.901	1 - MAIN BATH: UPG 1 Wall Tile
Line13398	Note:
13Oct16 / 8Dec16	
Inv.901	1 - ENSUITE 2: UPG 1 Tub Wall Tile
Line13399	Note:
13Oct16 / 8Dec16	
Inv.901	1 - ***** DELETE CERAMIC ACCESSORIES THROUGHOUT *****
Line13423	Note:
13Oct16 / 8Dec16	

DRYWALL

Inv.685	1 - SMOOTH CEILINGS - (3 - Story Design) 2ND FLOOR
Line9019	Note: PRICE ADJUSTED PE:875
20Jul16 / 3Oct16	

ELECTRICAL

Inv.685	1 - 200 AMP ELECTRICAL SERVICE
Line9003	Note:
20Jul16 / 3Oct16	
Inv.685	1 - KITCHEN: ADDITIONAL STANDARD FIXTURE WITH SWITCH - OVER ISLAND - RIGHT SIDE
Line9004	Note:
20Jul16 / 3Oct16	

Kleinburg Glen - 8R - 1 - 25-6 Elev.B LINCOLN OPT- GFA2 AND MFA1

Inv.685	1 - KITCHEN: ADDITIONAL STANDARD FIXTURE ON SAME SWITCH OVER ISLAND, RIGHT SIDE. PLEASE SEE FLOORPLAN FOR DETAILS
Line9005	Note:
20Jul16 / 3Oct16	
Inv.685	1 - KITCHEN: 110V WALL RECEPTACLE ON DEDICATED CIRCUIT - GAS FIRED APPLIANCE - FOR AUX. EQUIPMENT - NOT A STOVE PLUG. PLEASE SEE FLOORPLAN FOR LOCATION
Line9006	Note:
20Jul16 / 3Oct16	
Inv.685	1 - KITCHEN: 110V WALL RECEPTACLE ON DEDICATED CIRCUIT - FOR MICROWAVE - MICROWAVE NOT INCLUDED. FOR FUTURE WALL OVEN/MICRO COMBO. PLEASE SEE FLOORPLAN LOCATION
Line9008	Note:
20Jul16 / 3Oct16	
Inv.685	1 - KITCHEN: 220V WALL RECEPTICAL ON DEDICATED CIRCUIT - FOR 4 WIRE BUILT - IN WALL OVEN - FOR FUTURE MICRO/WALL OVEN COMBO. PLEASE SEE FLOORPLAN FOR LOCATION
Line9009	Note:
20Jul16 / 3Oct16	
Inv.685	1 - FAMILY ROOM: 110V WALL RECEPTACLE ON NORMAL CIRCUIT - LOCATED AT 54" AFF CENTERED ON FAMILY ROOM/DINING ROOM WALL. PLEASE SEE FLOORPLAN FOR LOCATION
Line9018	Note:
20Jul16 / 3Oct16	

EXTERIOR COLOURS

Inv.685	1 - EXTERIOR COLOUR PACKAGE 9
Line12201	Note:
20Jul16 / 3Oct16	

FIREPLACE AND MANTLE

Inv.685	1 - FAMILY ROOM / GREAT ROOM: RELOCATE GAS FIREPLACE TO GREAT ROOM. PLEASE SEE FLOORPLAN FOR LOCATION.
Line9014	Note:
20Jul16 / 3Oct16	
Inv.901	1 - GREAT ROOM: UPG Add Hearth to Fireplace Surround
Line13424	Note:
13Oct16 / 8Dec16	

FRAMING

Inv.685	1 - KITCHEN: INCREASE SIDE WALLS BETWEEN KITCHEN AND FAMILY ROOM APPROX 1.5FT TO ACCOMMODATE COUNTER DEPTH FRIDGE
Line9013	Note:
20Jul16 / 3Oct16	
Inv.685	1 - MAIN FLOOR: EXTENDED HEIGHT ARCHWAY (PRICE PER DOORWAY)
Line12210	Note:
20Jul16 / 3Oct16	
Inv.685	1 - MAIN FLOOR: STANDARD DOOR EXTENDED HEIGHT 96 INCH (PRICE PER DOOR)
Line12211	Note:
20Jul16 / 3Oct16	

GRANITE MARBLE QUARTZ

Kleinburg Glen - 8R - 1 - 25-6 Elev.B LINCOLN OPT- GFA2 AND MFA1

Inv.901	1 - KITCHEN COUNTERTOP: UPG 3 Caesarstone 4030
Line12605	Note: Standard FE20 Edge
13Oct16 / 8Dec16	
Inv.901	1 - MASTER ENSUITE VANITY COUNTERTOP: UPG 2 - Polished Granite Andino White
Line12614	Note: Standard FE20 Edge
13Oct16 / 8Dec16	
Inv.901	1 - KITCHEN COUNTERTOP: UPG, Include Cut out for Cooktop
Line13425	Note:
13Oct16 / 8Dec16	

HARDWOOD

Inv.901	1 - MAIN HALL / DEN / DINING ROOM / FAMILY ROOM/ LANDING: UPG 4 *Preverco White Oak RQ Brooklyn Nuance
Line12615	Note:
13Oct16 / 8Dec16	

HVAC

Inv.685	1 - KITCHEN: GAS LINE ROUGH - GROUND FLOOR FOR FUTURE GAS COOKTOP. PLEASE SEE FLOORPLAN FOR LOCATION
Line9007	Note:
20Jul16 / 30Oct16	

INTERIOR TRIM AND DOORS

Inv.685	7 - MAIN FLOOR: EXTENDED HEIGHT ARCHWAY (PRICE PER DOORWAY)
Line9015	Note:
20Jul16 / 30Oct16	
Inv.685	4 - MAIN FLOOR: STANDARD DOOR EXTENDED HEIGHT 96 INCH (PRICE PER DOOR)
Line9016	Note:
20Jul16 / 30Oct16	

KITCHEN AND BATH CABINETRY

Inv.685	1 - KITCHEN: RELOCATE PANTRY TO WINDOW WALL. PLEASE SEE FLOORPLAN FOR LOCATION
Line9012	Note:
20Jul16 / 30Oct16	
Inv.901	1 - MASTER ENSUITE VANITY: UPG 1 - M600 Melamine Mystic
Line12607	Note:
13Oct16 / 8Dec16	
Inv.901	1 - KITCHEN: Built in Wall Oven & Microwave (or double oven) and cooktop
Line12616	Note:
13Oct16 / 8Dec16	
Inv.901	1 - KITCHEN: Waste Basket - 2 Bins with lids, pull out attached to door
Line13392	Note:
13Oct16 / 8Dec16	
Inv.901	1 - KITCHEN: Add Pots & Pan Drawers 2 Deep Drawers, top drawer is falst front due to drop-in cooktop
Line13394	Note:
13Oct16 / 8Dec16	

Kleinburg Glen - 8R - 1 - 25-6 Elev.B LINCOLN OPT- GFA2 AND MFA1

Inv.901	1 - KITCHEN: Add top drawer to Waste Bin Cabinet
Line13393	Note:
13Oct16 / 8Dec16	
Inv.901	1 - KITCHEN: Add Magic corner hardware for base blind corner cabinet
Line13395	Note:
13Oct16 / 8Dec16	
Inv.901	1 - KITCHEN: Add Upper Corner Folding Door
Line13405	Note:
13Oct16 / 8Dec16	

MISC.

Inv.685	1 - Purchaser has attended a Structural appointment at the Decor Centre & has DECLINED any additional upgrades and accepts and acknowledges that there will be no further structural changes/additions/deletions to be made upon signing on July 20, 2016.
Line9023	Note:
20Jul16 / 30Oct16	
Inv.685	1 - Purchasers are aware & accepts that ANY changes made to upgrades after signing this Purchasers Extra Form are subject to a minimum administration fee of \$500. PLUS a 10% holdback fee.
Line9024	Note:
20Jul16 / 30Oct16	
Inv.685	1 - BONUS PACKAGE: \$5,000.00 (INCLUDING TAXES) WORTH OF UPGRADES FROM GOLD PARK HOMES DÉCOR CENTRE IS BEING APPLIED TOWARD THE STRUCTURAL APPOINTMENT. PURCHASER HAS A REMAINING AMOUNT OF \$00 (INCLUDING TAXES) TO BE USED TOWARD THE COLOUR APPOINTMENT.
Line9025	Note:
20Jul16 / 30Oct16	
Inv.685	1 - BALANCE OF \$7,819.85 PAID BY CHEQUE
Line9026	Note:
20Jul16 / 30Oct16	
Inv.901	1 - Purchaser has attended a Structural appointment at the Decor Centre & has DECLINED any additional upgrades and accepts and acknowledges that there will be no further structural changes/additions/deletions to be made upon signing.
Line13426	Note:
13Oct16 / 8Dec16	
Inv.901	1 - STAIRCASE - The purchaser was advised and therefore accepts and acknowledges that the wood species of the staircase and flooring chosen do not match. This difference may result in a stain colour variance.
Line13427	Note: The purchaser agrees that the vendor is to be exempt from any and all claims by the purchaser regarding this colour variance.
13Oct16 / 8Dec16	
Inv.901	1 - Due to the many variables that can affect the pattern, colour and/or design and "pitting" of natural products, granite installed will not be identical to the samples displayed.
Line13429	Note: Every effort is made to provide granite counter tops as close as possible but the vendor is not responsible for results which differ from the sample displayed. All countertop surfaces may have seems & product pattern & shade can change in areas containing seems.
13Oct16 / 8Dec16	
Inv.901	1 - STAIRCASE - The purchaser was advised and therefore accepts and acknowledges that the stain of the staircase and flooring chosen do not match. This difference might result in an undesirable colour variance
Line13428	Note: The purchaser agrees that the vendor is to be exempt from any and all claims by the purchaser regarding this colour variance.
13Oct16 / 8Dec16	
Inv.901	1 - Credit PE:879
Line13588	Note:
13Oct16 / 8Dec16	

PLUMBING

Kleinburg Glen - 8R - 1 - 25-6 Elev.B LINCOLN OPT- GFA2 AND MFA1

Inv.685	1 - KITCHEN: ROUGH - IN - WATERLINE FOR FRIDGE
Line9011	Note:
20Jul16 / 3Oct16	
Inv.901	1 - POWDER ROOM: Delete Standard Pedestal sink and Supply & Install Marleau 24" wall hung vanity combo MAAG2318 Ash Grey
Line13385	Note: Please see spec sheet attached
13Oct16 / 8Dec16	
Inv.901	1 - MASTER ENSUITE: Delete Standard vanity sink and UPG to Minuet Square Vessel Lavatory 13-0024-W
Line13413	Note:
13Oct16 / 8Dec16	
Inv.901	1 - MASTER ENSUITE: UPG Tub 4 Piece Faucet T4786 R4716 Arzo Roman Tub
Line13422	Note: See Spec Sheet attached
13Oct16 / 8Dec16	

STAIRS AND RAILINGS

Inv.901	1 - STAIRS / RAILING: Stain Colour Vintage Pewter
Line12617	Note:
13Oct16 / 8Dec16	
Inv.901	1 - UPG 1 Euroline 1 Black Iron Pickets
Line12618	Note:
13Oct16 / 8Dec16	
Inv.901	1 - UPG 1 V-Groove Handrail
Line12619	Note:
13Oct16 / 8Dec16	

WINDOWS - BASEMENT

Inv.685	1 - BASEMENT WINDOWS - REFUNDED DUE TO LOOKOUT CONDITION
Line9020	Note: PE:875
20Jul16 / 3Oct16	
Inv.685	1 - BASEMENT WINDOWS - REFUNDED DUE TO LOOKOUT BASEMENT
Line9021	Note: PE:875
20Jul16 / 3Oct16	
Inv.685	2 - BASEMENT: REFUNDED DUE TO LOOKOUT BASEMENT
Line9022	Note: PE:875
20Jul16 / 3Oct16	

Purchaser: Leonardo Occhiogrosso

Property: 8R

Telephone Res. / Bus: (416) 464-3784

Project: Burkshire Holdings Inc.

Decor Advisor: Laura Lofaro

Model and Elevation: 25-6 Elev.B LINCOLN OPT- GFA2 AND M

Layout Changes: ☐ Yes ☐ No Sketch Attached: ☒ Yes ☐ No Exterior Colour Scheme:

1. Cabinetry

	Style and Colour	Counter	Hardware
Kitchen / Breakfast	P400 PVC WhtCrystal	*Ceasarstone 4030 Stone Grey FE20	CS1-24
Laundry Room	N/A		
Powder Room	*Marleau MAAG2318		
Gr.FI Powder Room	P400 PVC Silver	Wilsonart Bronzite 4971K-52	CS1-24
Master Ensuite Bathroom	*M600 Melamine Mystic	*Granite Andino White FE20	CS1-24
Second Ensuite Bathroom (If Applicable)	P400 PVC Silver	Wilsonart Calcutta Marble 4925k-07	CS1-24
Main Bath	P400 PVC Wht.Crystal	Formica 8630-58 Elemental Concrete	CS1-24
Dishwasher Cabinet			

Comment

2. Floor Tile

	Selection	Grout	Threshold
Entrance Vestibule	*17.7x17.7 Must Polished Dove Grey		
Main Hall	N/A		
Kitchen / Breakfast	*17.7x17.7 Must Polished Dove Grey		
Laundry Room	*17.7x17.7 Must Polished Dove Grey		
Powder Room	*17.7x17.7 Must Polished Dove Grey		
Master Ensuite Bathroom	*12x24 Volakis Series White Polished		
Second Ensuite Bathroom (If Applicable)	*12x24 Allure Grey		
Lower Landing (If Applicable)			
Main Bath	*12x24 Allure Grey		

Comment

Master Ensuite: 12x24 Volakis Series White Polished - Tub Deck, Tub Skirt, Tub Splash
Powder Room 2 - GROUND FLOOR: STD 13x13 Reese Floor Brown

3. Wall Tile

	Selection	Listello/Inserts	Describe
		<input type="radio"/> Yes <input checked="" type="radio"/> No	
Master Ensuite Bathroom			
Tub Deck	N/A	<input type="radio"/> Yes <input checked="" type="radio"/> No	
Shower Stall	8x10 Weave White	<input type="radio"/> Yes <input checked="" type="radio"/> No	
Bathroom Walls	N/A	<input type="radio"/> Yes <input checked="" type="radio"/> No	
Second Ensuite Bathroom (If Applicable)	*4x16 CDC Silver Grey	<input type="radio"/> Yes <input checked="" type="radio"/> No	
Main Bath	*4x12 Chess Tender Grey Bevelled	<input type="radio"/> Yes <input checked="" type="radio"/> No	

Kitchen Backsplash

☐ Yes ☒ No

Backsplash Behind Fridge

Comment

L.O.

Scheduled Closing Date: September-22-16

Purchaser: Leonardo Occhiogrosso

Property: 8R

Telephone Res. / Bus: (416) 464-3784

Project: Burkshire Holdings Inc.

Decor Advisor: Laura Lofaro

Model and Elevation: 25-6 Elev.B LINCOLN OPT- GFA2 AND M

4. Plumbing Fixtures

<input type="text"/>	Second Ensuite	<input type="text"/>	Powder Room	<input type="text"/>	
Master Ensuite Bathroom	<input type="text"/>	Other Room - Specify	<input type="text"/>	Other Washroom	<input type="text"/>

Comment

UPG Master Vanity Sink
UPG Master Tub 4 Piece Faucet
UPG Main Floor Powder Room Vanity

5. Hardwood Flooring

	Type and Stain		Type and Stain
Main Hall	*Preverco WhtOakRQ BrklynNuan	Upper Landing	N/A
Kitchen / Breakfast	N/A	Upper Hall	N/A
Living Room	N/A	Master Bedroom	N/A
Dining Room	*Preverco WhtOakRQ BrklynNuan	Bedroom #2	N/A
Family Room	*Preverco WhtOakRQ BrklynNuan	Bedroom #3	N/A
Den/Library	*Preverco WhtOakRQ BrklynNuan	Bedroom #4	N/A
Entrance Vestibule	N/A	Bedroom #5	N/A
Lower Landing (If Applicable)	<input type="text"/>	Other Room - Specify	<input type="text"/>

Comment

6. Carpeting

	Upgrade	Description
Main Hall	<input type="checkbox"/>	N/A
Living Room	<input type="checkbox"/>	N/A
Dining Room	<input type="checkbox"/>	N/A
Family Room	<input type="checkbox"/>	N/A
Den/Library	<input type="checkbox"/>	N/A
Upper Hall	<input type="checkbox"/>	T15
Master Bedroom	<input type="checkbox"/>	T15
Bedroom #2	<input type="checkbox"/>	T15
Bedroom #3	<input type="checkbox"/>	T15
Bedroom #4	<input type="checkbox"/>	T15
Bedroom #5	<input type="checkbox"/>	<input type="text"/>
GREAT ROOM	<input type="checkbox"/>	T15
Upper Landing (If Applicable)	<input type="checkbox"/>	<input type="text"/>
Lower Landing (If Applicable)	<input type="checkbox"/>	<input type="text"/>

Upgrade Underpad	Type N/A	Area N/A
Carpet on Stairs	Capped N/A	Runner - *Upgrade N/A

Comment

L.O.

Purchaser: Leonardo Occhiogrosso

Property: 8R

Telephone Res. / Bus: (416) 464-3784

Project: Burkshire Holdings Inc.

Decor Advisor: Laura Lofaro

Model and Elevation: 25-6 Elev.B LINCOLN OPT- GFA2 AND M

7. Fireplace

	Living Room			Family Room			Other Room - Specify <input checked="" type="checkbox"/> Great Room		
	Purchased	As Per Plan	N/A	Purchased	As Per Plan	N/A	Purchased	As Per Plan	N/A
Fireplace Type	<input type="radio"/>	<input type="radio"/>	<input type="radio"/>	<input type="radio"/>	<input type="radio"/>	<input type="radio"/>	<input type="radio"/>	<input checked="" type="radio"/>	<input type="radio"/>
Mantle Type							Standard		
Colour / Stain							Cast Stone		
Surround									
Hearth							*Add Hearth		
Comment									

8. Trim Carpentry

Interior Doors	STD	Front Door Glass Inserts	STD	Door Handles	STD
Interior Trim	STD				
Comment					

9. Plaster Mouldings and Medallions

Entrance Vestibule	N/A		Kitchen/Breakfast	N/A	
Main Hall	N/A		Den/Library	N/A	
Living Room	N/A		Lower Landing	N/A	
Dining Room	N/A		Other Room - Specify	N/A	
Family Room	N/A				
Comment					

10. Railings and Spindles

Railing Package	*Euroline 1 With V-groove Handrail		
Railing Colour	*Vintage Pewter	Spindle Colour	Black
Stringer / Riser	*Vintage Pewter	Treads	*Vintage Pewter
Comment			
	**** STAIN COLOUR TBD*****		

11. Wall Paint

Main & Upper Hall	Cool White	Master Bedroom	Cool White
Living Room	N/A	Bedroom #2	Cool White
Dining Room	Cool White	Bedroom #3	Cool White
Kitchen / Breakfast	Cool White	Bedroom #4	Cool White
Family Room	Cool White	Bedroom #5	
Powder Room	Cool White	Master Ensuite	Cool White
Laundry Room	Cool White		
Den/Library	Cool White	Second Ensuite	Cool White
Trim Paint	White	Main Bath	Cool White
Comment	Smooth Ceilings First Floor		

L.O.

Scheduled Closing Date: September-22-16

Purchaser: Leonardo Occhiogrosso

Property: 8R

Telephone Res. / Bus: (416) 464-3784

Project: Burkshire Holdings Inc.

Decor Advisor: Laura Lofaro

Model and Elevation: 25-6 Elev.B LINCOLN OPT- GFA2 AND M

12. Electrical

Plugs and Switches ☒ White ☐ Ivory

Hood Fan ☐ White ☐ Ivory

Appliances

Built in Cooktop

Built in Oven

Gas Stove

Microwave

☒ Yes ☐ No

☒ Yes ☐ No

☒ Yes ☐ No

☒ Yes ☐ No

Comment

13. Heating and Air Conditioning

Air Conditioning

Gas Provisions Dryer

Comment

Gas Provisions Stove

Gas Provisions Barbecue

14. Additional Comments

15. Disclaimers and Notes

- Colours of all materials are as close as possible to builder's selection, but not necessarily identical due to variances in manufacturing.
- Any extras listed above are null and void unless accompanied by a separate invoice/amendment. Said invoice must be paid in full.
- The Purchaser acknowledges that after Interior Colour Selection form is signed and dated, no further changes will be permitted other than re-selection due to unavailability. L.O. Purchaser's Initials
- The Purchaser acknowledges reading and accepting the "Gold Park Homes Decor Centre Disclaimers" form. This document contains other miscellaneous disclaimers.

This Interior Colour Selection is final and approved by:

Signature: Leonardo Occhiogrosso Date: Nov. 15 - 2016

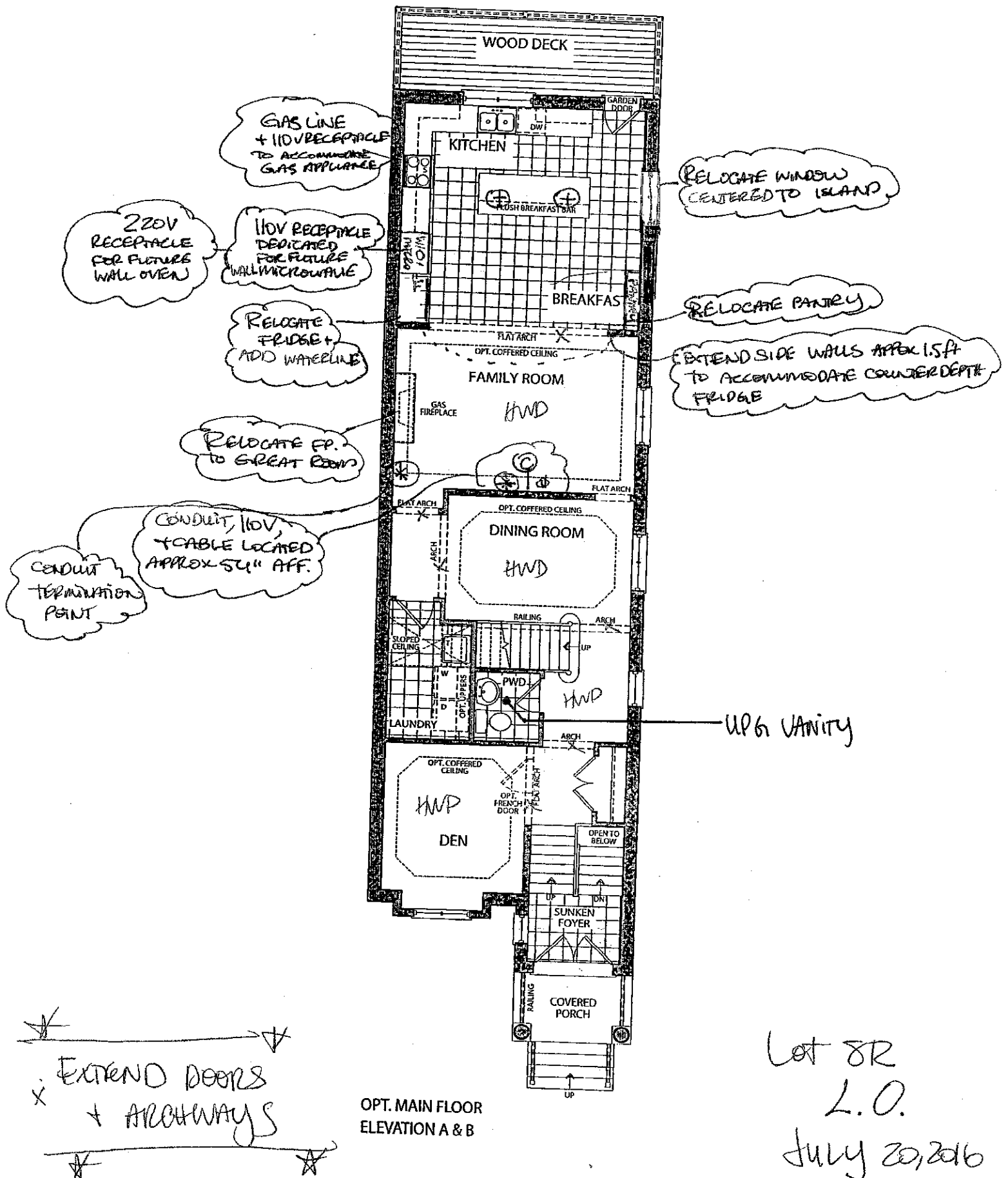

Lot 8R
L.O.
July 20, 2016

(L.O.) (C)

DATE: Nov 15 2016

Elevation A • 3,081 sq.ft.

Elevation B • 3,081 sq.ft.

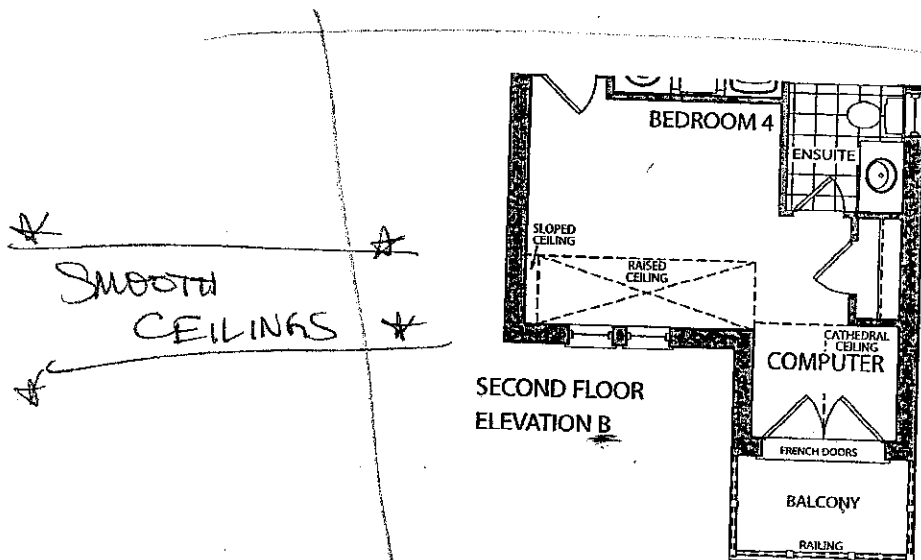
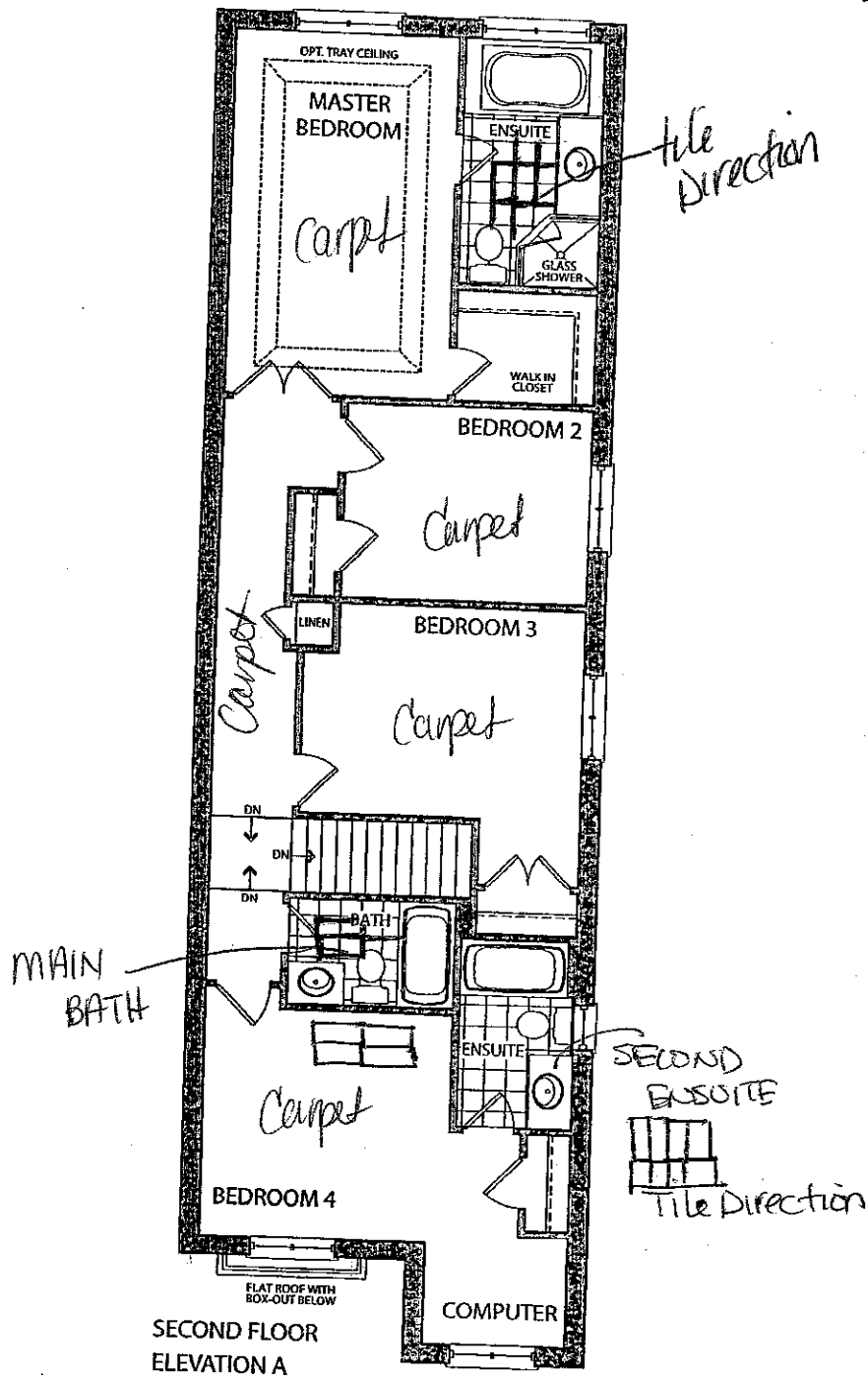

Lot 8R

L.O.

July 20, 2016

DATE: L.O.
Nov 15 2016

the Lincoln

Elevation A • 3,081 sq.ft.

Elevation B • 3,081 sq.ft.

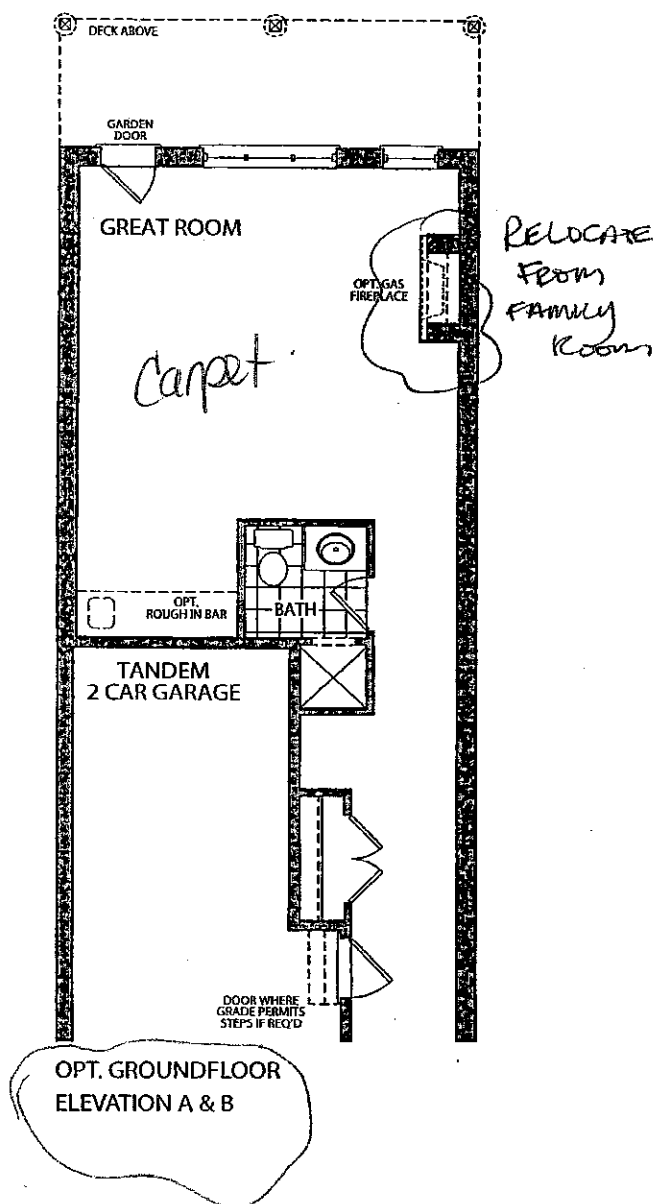
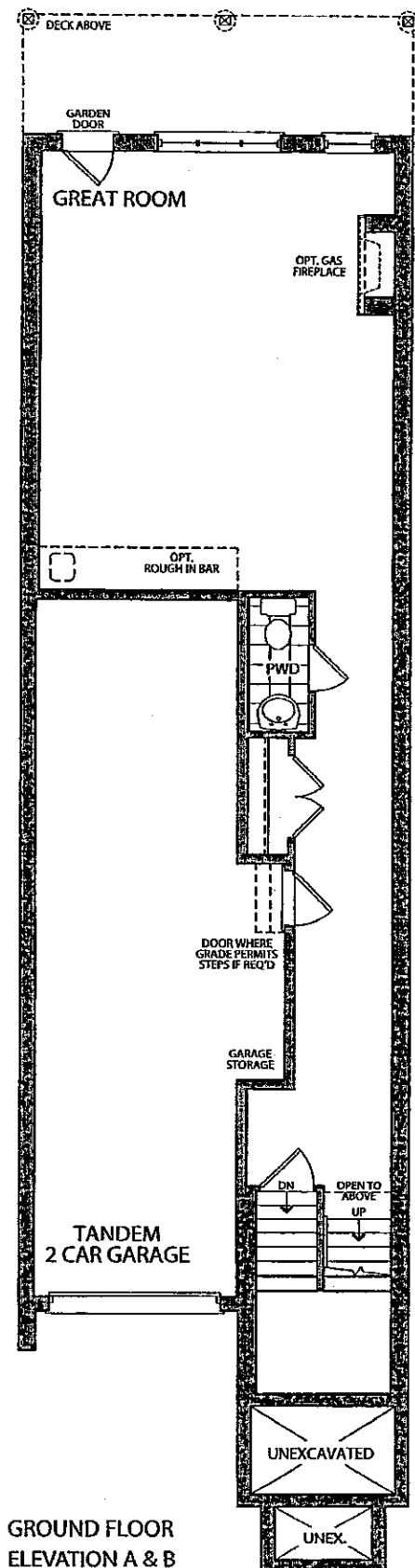

LOT 8R

L.O.

July 20, 2016

DATE:

Nov 15 2016



the *Lincoln*

Elevation A • 3,081 sq.ft.

Elevation B • 3,081 sq.ft.

cannot accommodate windows

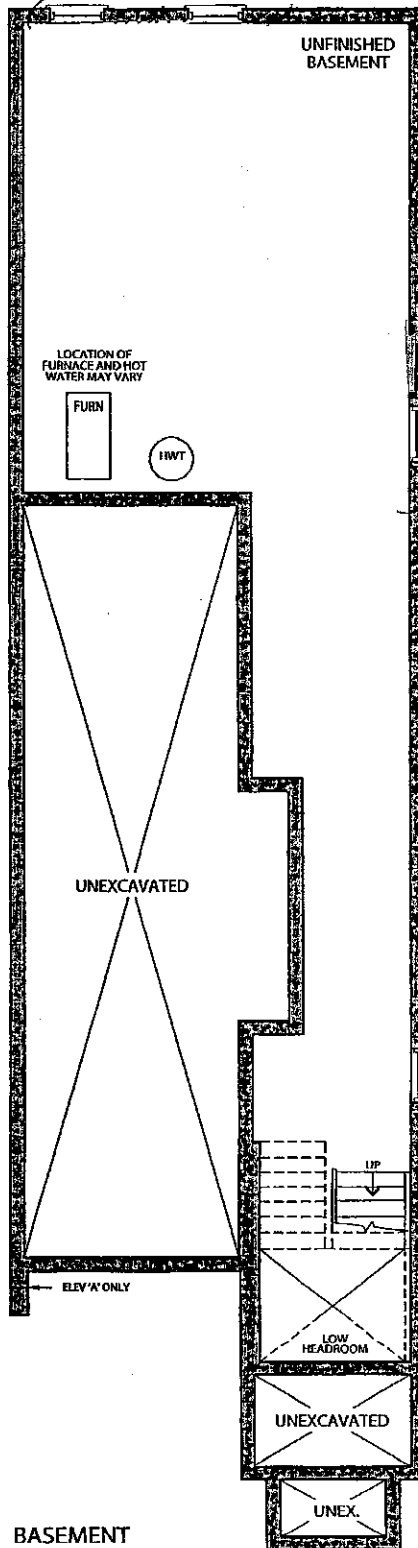

BASEMENT
ELEVATION A & B

*Lot 8R
L.O.
July 29/16*

DATE: Nov 15 2016 L.O.

- Range Hood- NK36K7000WG

Size 36"

Dimensions (W"xH"xD") 35.9" x 19.7" x 15.5"

Weight (kg) 22

- Cooktop- NA36K7750TS

Size - 36"

Dimensions (W"xH"xD")- 36"x 3.12"x 21"

Cutout Dimensions (W"xH"xD")- 33.87" x 3.37" x 19.12"

KUENBURG GLEN
LOT 8R

L.O.

Nov. 15. 2016

Trade Name: Gold Park Homes

Site location:

Model: 25-6

Address:

Project: Kleinburg Glen

Phase:

This layout has been explained to the purchaser by Cortina Kitchens Inc. and is understood by the purchaser.

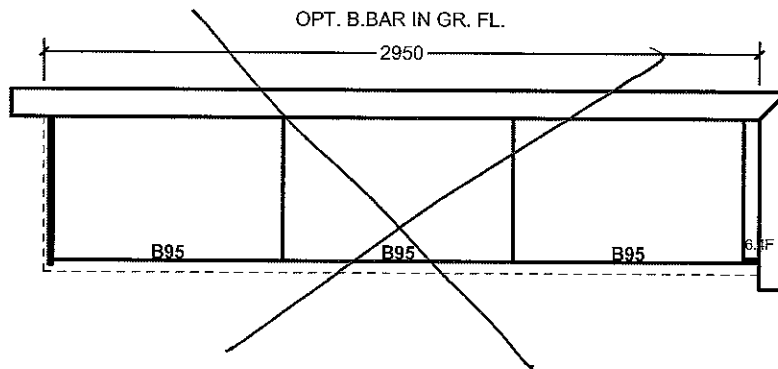
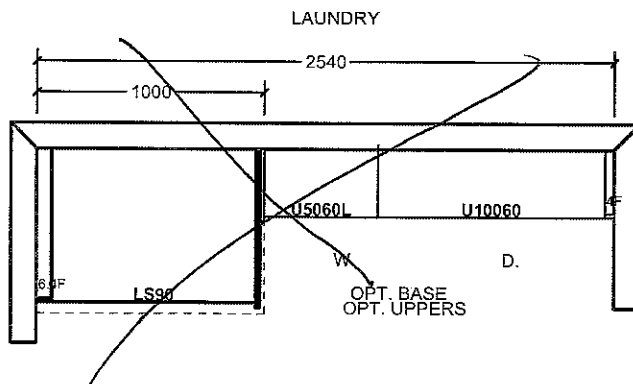
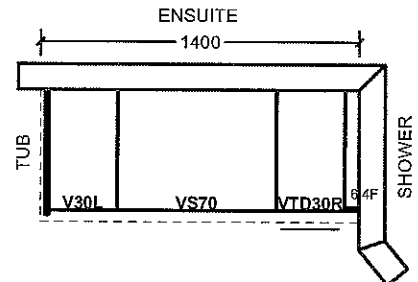
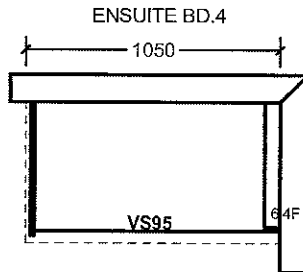
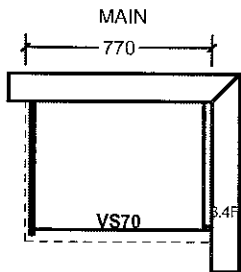

OPT. GROUND FLOOR

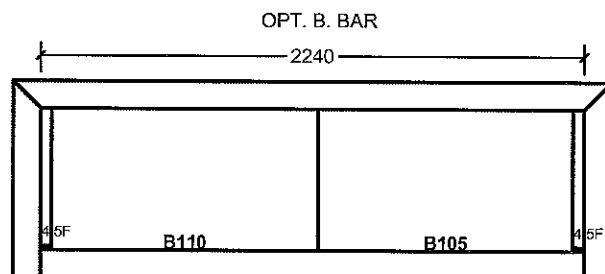
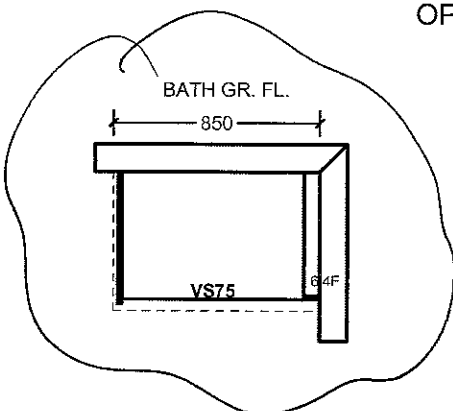

All prices subject to confirmation from head office.
This quotation is subject to the terms & conditions set out

All agreements are contingent upon strikes, accidents, and delays beyond our control.
Please provide our installer with template for sinkholes or \$150.00 will be charged for callback.

ACCEPTED DATE: _____

LOT 8R

L.O.

Item A. Wood grain and colour are characteristics of the product. We cannot guarantee that such grain and colour will always match.
Item B. Cortina Kitchens Inc. reserves the right to alter dimensions and make technical changes without notice.

STANDARD HARDWARE

STANDARD HARDWARE

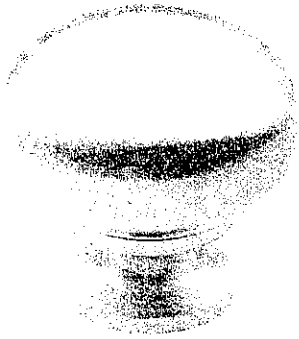

CSI-6

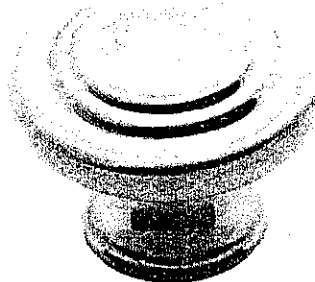

CSI-10



CSI-14



CSI-16



CSI-18

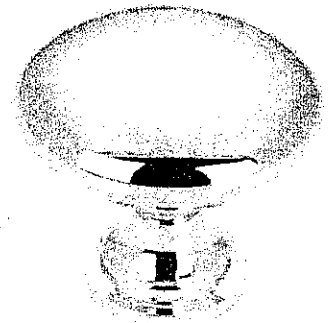

CSI-19

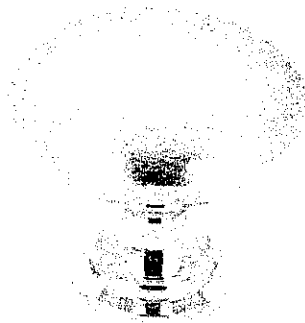

CSI-20

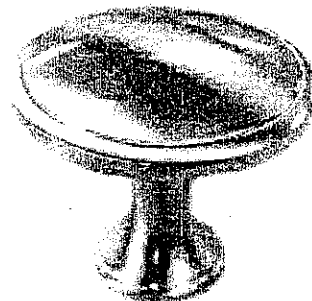

CSI-21

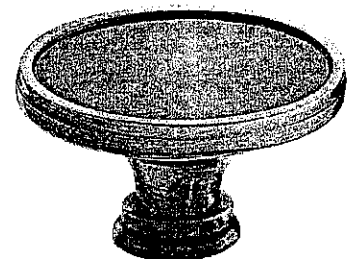

CSI-22

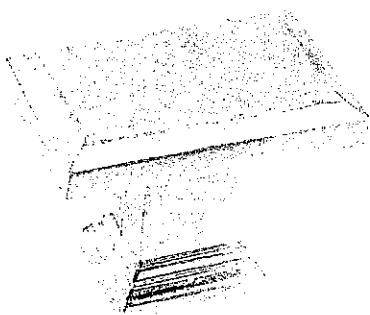

CSI-23

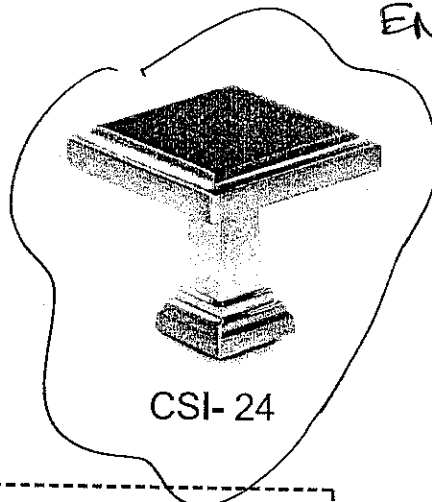

CSI-24

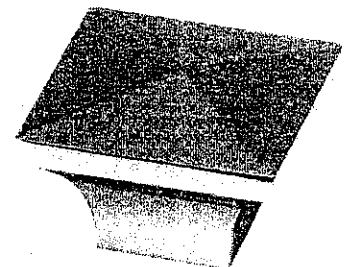

CSI-25

KITCHEN, MASTER ENSUITE,
ENSUITE 4, MAIN BATH

KLEINBURG GLEN

LOT 8R

(L.O.)

DATE: Nov, 15 2016

***NOTES:**

- IMAGES ARE FOR QUICK REFERENCE PURPOSES ONLY
- ACTUAL SIZES AND FINISHES AS PER HARDWARE SAMPLE BOARD PROVIDED TO DECOR CENTRE

KLEINBURG GLEN

LOT 8R

(L.O.)

DATE: Nov. 15 - 2016

MASTER ENSUITE

13-0024-W

Minuet

rectangular vessel lavatory



Finish
Soft white vitreous china
Nano easy clean glaze



Overflow
Rear



Template
Supplied



Faucet drilling
Single hole



Dimensions
19" (W) x 15 1/2" (D) x 6 1/4" (H)

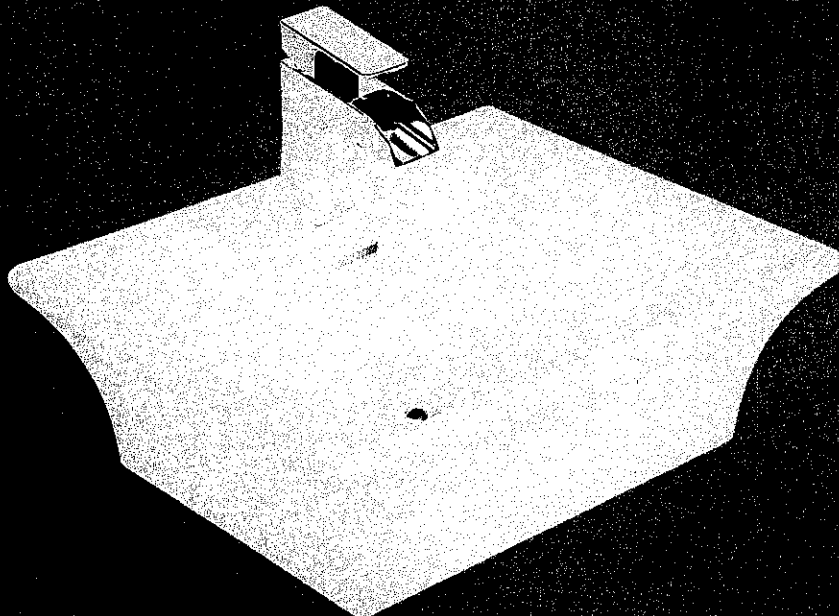

KLEINBURG GLEN
LOT 82

(L.O.)

DATE: NOV. 15 2016
MASTER ENSUITE
BATH TUB.

Arzo® Collection

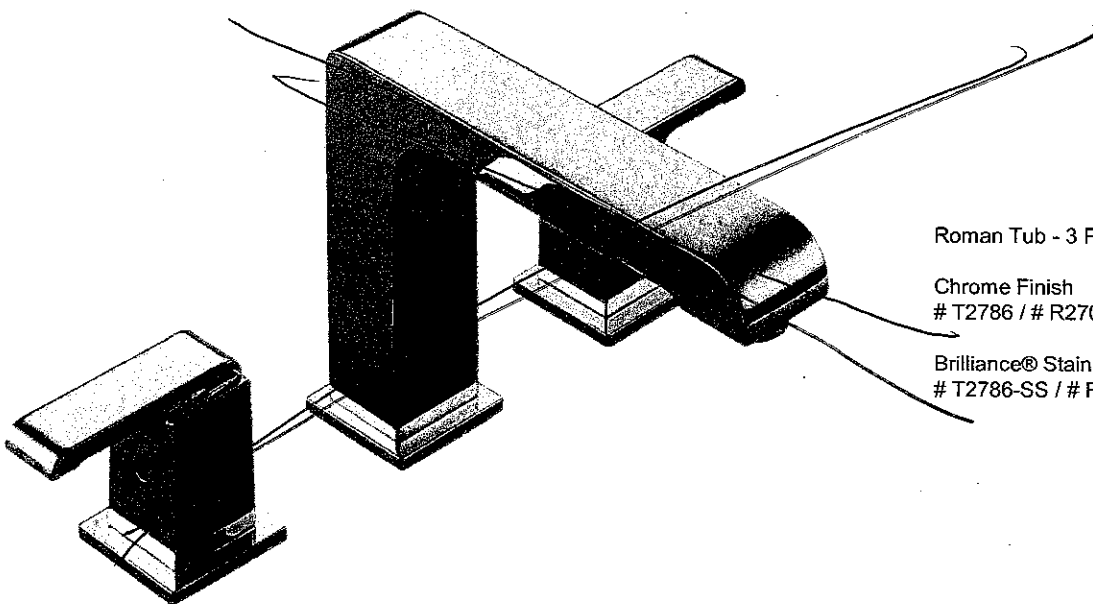

Roman Tub - 3 Piece

Chrome Finish
T2786 / # R2709

Brilliance® Stainless Finish
T2786-SS / # R2709

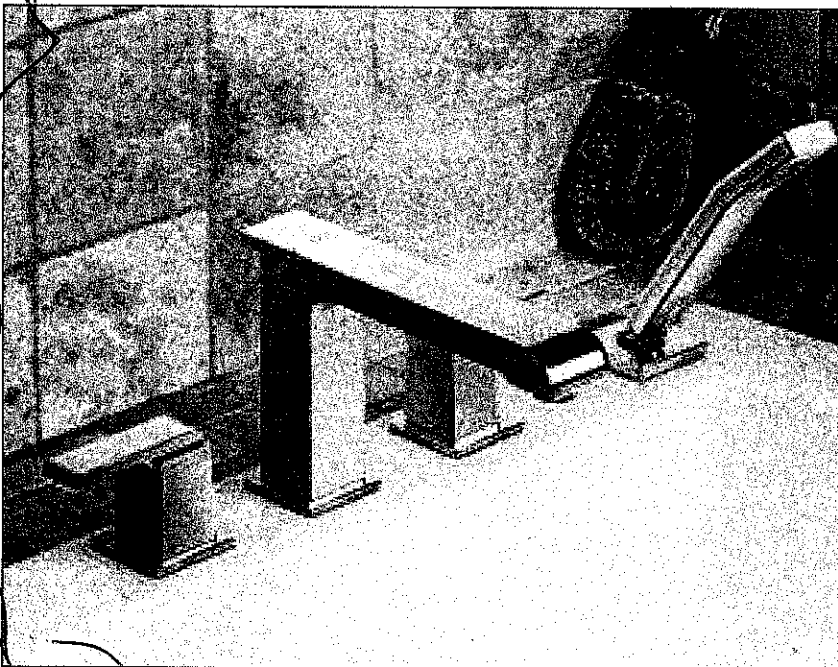

Roman Tub - 4 Piece

Chrome Finish
T4786 / R4716

Brilliance® Stainless Finish
T4786-SS / R4716

Shown in Chrome

Marleau

24" wall hung vanity combo



Finish
Ash Grey / White



Drawers
Two - Slow Close
Carved Drawer Pulls



Vanity
Assembled



Sink
White Vitreous China Sink Included
Single hole drilling



Faucet
Not Included



Dimensions
24" (W) x 18" (D) x 20 3/8" (H)

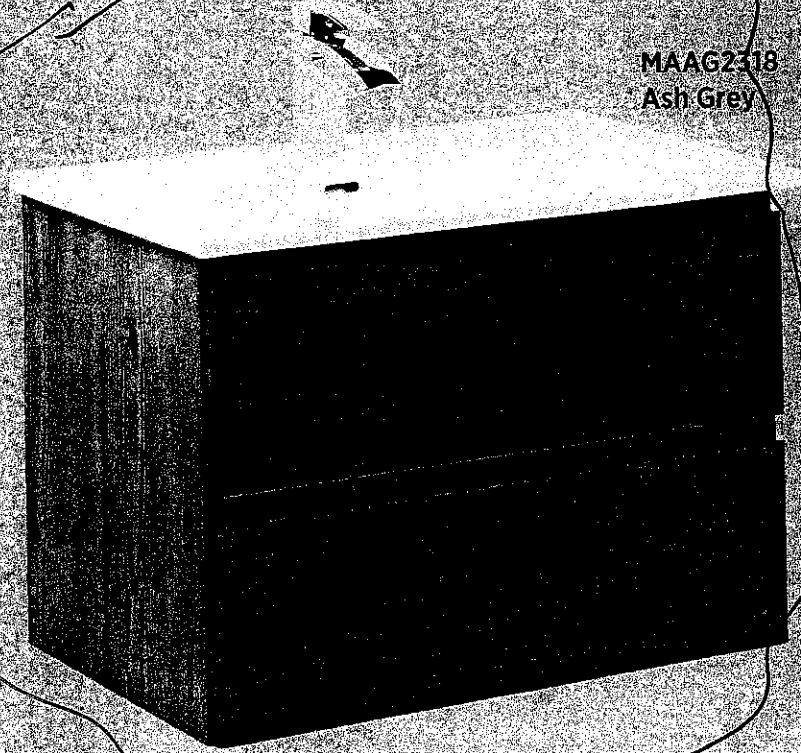

MAAG2318
Ash Grey

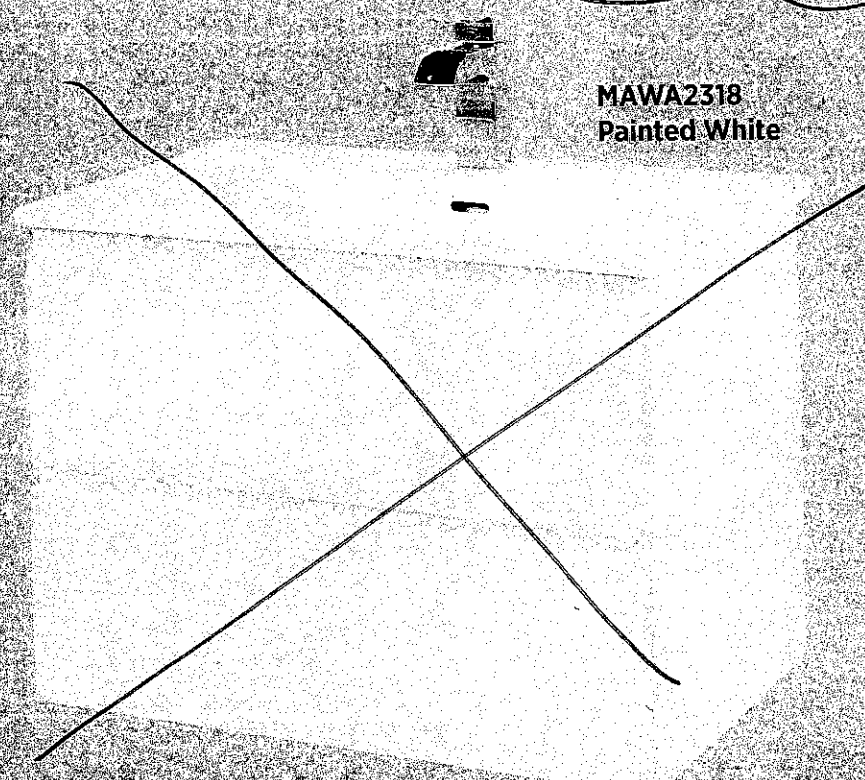

MAWA2318
Painted White

FOREMO

KUENBURG GLEN

LOT 8R

(20)

DATE: Nov. 15 2016

MAIN FLOOR POWDER RM.

RF22KREDBSR

22 cu. ft. Counter-Depth, 4-Door French Door Refrigerator

Features

- 4-Door, Counter-Depth Design
- Food ShowCase Door
- Metal Cooling FlexZone™ Drawer with 4 Temperature Control Settings and Smart Divider
- Twin Cooling Plus®
- High-Efficiency LED Lighting
- Ice Master Ice Maker in the Refrigerator
- Fingerprint-Proof Coating
- ENERGY STAR®-Compliant
- External Filtered Water and Ice Dispenser
- Stainless Steel Accents on Interior Shelving and Door Bins
- EZ-Open Handle™ on Freezer Door and FlexZone™ Drawer
- Two Humidity-Controlled Crispers
- Tempered Glass Spill-Proof Shelves
- Gallon Door Bins

Convenience

- Door Alarm
- Water Filter Indicator



ENERGY STAR®-rated:
663 kWh/yr

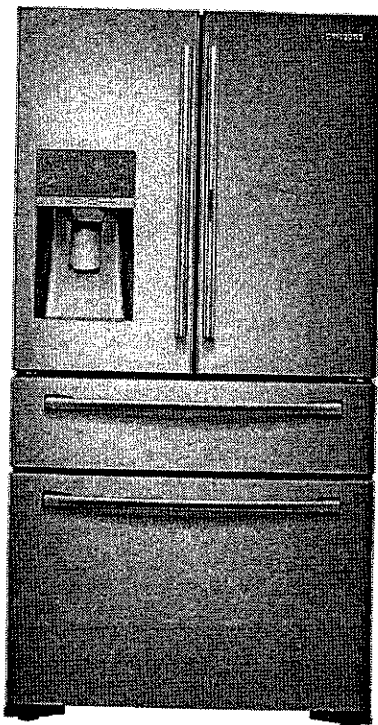

Food ShowCase Door with Metal Cooling

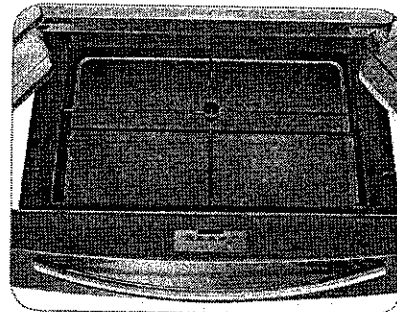

FlexZone™ Drawer with Metal Cooling

Available Colors



Stainless Steel
(shown)



Black Stainless Steel

Signature Features

COUNTER DEPTH

- More capacity, smaller floor space.
- Our 22 cu. ft. capacity 4-Door Flex™ has enough room to fit up to 22 bags of groceries.¹
- Stylish counter-depth design allows for more workable space in the kitchen.

¹Grassby comparison based on each cubic foot of usable space equalling one paper bag.

FOOD SHOWCASE WITH METAL COOLING

- Innovative door-in-door design gives easy access to on-the-go items such as drinks and condiments.
- Stainless steel paneling locks in cold and seals in freshness while maintaining consistent temperature throughout the refrigerator.

FLEXZONE™ DRAWER WITH METAL COOLING

- Counter-height drawer is optimized for family organization with easy access for kids.
- Adjustable Smart Divider and four customizable temperature control settings from Chill to Soft Freeze.

SAMSUNG

KLEINBURG, OHIO

Lot 8R2

(20)

DATE: Nov. 15 2016

RF22KREDBSR

22 cu. ft. Counter-Depth, 4-Door French Door Refrigerator

Installing Your Refrigerator

1. Measure the height, width and depth of the opening, making sure to include baseboards, molding tile, countertop overhang, etc. Check to be sure there is enough room to open the door (consider walls, islands or other obstacles when measuring).
2. Refer to illustration below to determine dimensions.
3. Allow 2" of clearance on hinge side of refrigerator when installing next to a wall where handle may make contact.
4. Allow 1" minimum clearance at rear for proper air circulation and water/electrical connections. Allow a 3/8" minimum clearance at sides and top for ease of installation.
5. Ensure each door and entryway in the home is wide enough for the refrigerator to be moved through easily.

Please note: The following dimension and cutout information is for planning purposes only. For complete installation details, consult manual packed with product, or download manual online at samsung.com.

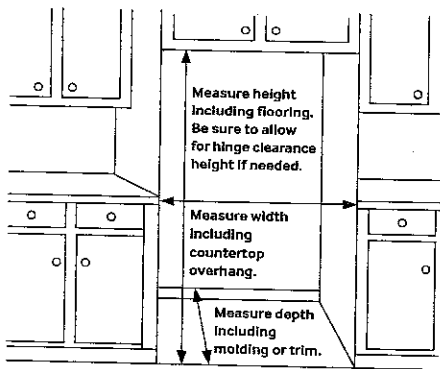

Dimensions

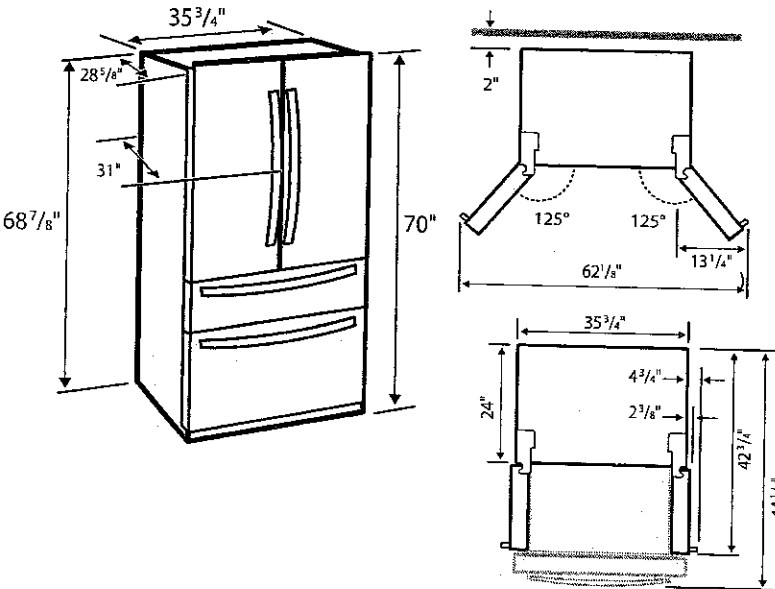

Total Capacity: 22.4 cu. ft.

- Refrigerator: 12.8 cu. ft.
- Premium External Filtered Water and Ice Dispenser (Crushed or Cubed Ice)
 - Ice Master Ice Maker
 - 2 Humidity-Controlled Crispers
 - 6 Door Bins: 3 Gallon, 3 Regular
 - 5 Tempered Glass Spill-Proof Shelves
 - 1 Slide-In
 - 1 Foldable Half
 - 3 Fixed
 - High-Efficiency LED Lighting
- FlexZone™ Drawer: 3.1 cu. ft.
- EZ-Open Handle™
 - 4 Temperature Zones with Smart Divider:
 - Meat/Fish (29°F)
 - Cold Drinks (33°F)
 - Deli/Snacks (37°F)
 - Wine/Party Dishes (42°F)
 - High-Efficiency LED Lighting
- Freezer: 6.5 cu. ft.
- EZ-Open Handle™
 - 1 Drawer Divider
 - 1 Freezer Bin
 - High-Efficiency LED Lighting

Accessories

Water Filter: HAF-CIN/EXP

Warranty

One (1) Year Parts and Labor on Refrigerator
Five (5) Years Parts and Labor on Sealed Refrigeration System Only*
Ten (10) Years Parts and Five (5) Years Labor on Digital Inverter Compressor

*Compressor, evaporator, condenser, drier, connecting tubing.

Product Dimensions & Weight

Dimensions (WxHxD with hinges, handles and doors): 35 3/4" x 70" x 31"

Dimensions (WxHxD without hinges and door): 35 3/4" x 68 7/8" x 24"

Dimensions (WxHxD with hinge and door, no handle): 35 3/4" x 70" x 28 5/8"

Weight: 357.1 lbs.

Shipping Dimensions & Weight (WxHxD)

Dimensions: 38 1/4" x 75 1/2" x 30 5/8"

Weight: 381.3 lbs.

Color	Model #	UPC Code
Stainless Steel	RF22KREDBSR	887276146652
Black Stainless Steel	RF22KREDBSG	887276146546

SAMSUNG

Actual color may vary. Design, specifications, and color availability are subject to change without notice.
Non-metric weights and measurements are approximate.
©2016 Samsung Electronics America, Inc. 85 Challenger Road, Ridgefield Park, NJ 07660. Tel: 800-SAMSUNG, samsung.com. Samsung is a registered trademark of Samsung Electronics Co., Ltd.

KLEINBURG GLEN
LOT 8R
(L.O.)

DATE: Nov, 15 2016

preparing the dishwasher enclosure

PRODUCT DIMENSIONS

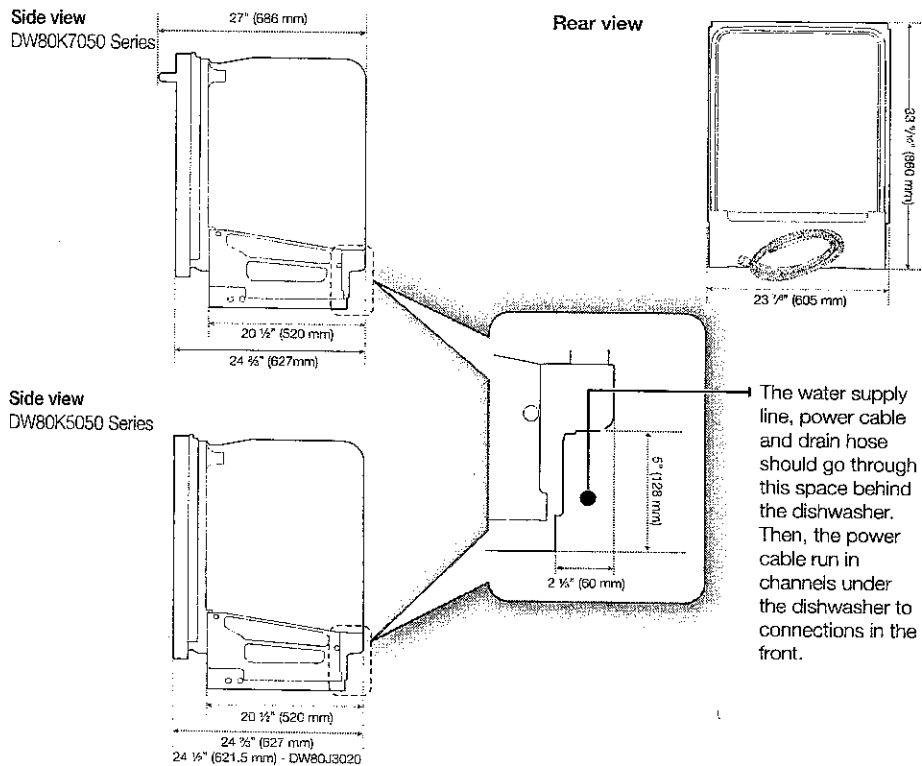

01 PREPARING THE DISHWASHER

ENCLOSURE DIMENSIONS

- This dishwasher is designed to be enclosed on the top and on both sides by a standard residential kitchen cabinet unit.
- The installation enclosure must be clean and free of any obstructions.
- The enclosure must be at least 24 inches wide, 24 inches deep, and 34 1/8 inches high.
- For the front door of the dishwasher to be flush with the leading edge of the counter top, the counter top must be at least 25 inches deep.

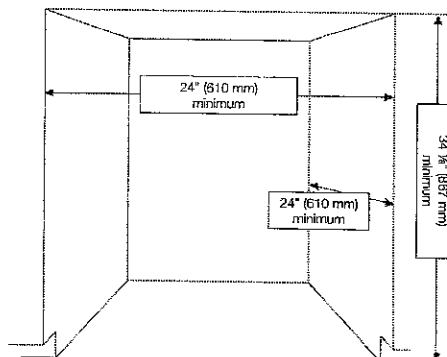

preparing the dishwasher enclosure _5

KLEINBURG GLEN

LOT 812

(L.O.)

DATE: Nov 15 2016

KitchenAid® 27" (68.6 cm) and 30" (76.2 cm) Electric Built-In Microwave/Oven Combination

PRODUCT MODEL NUMBERS

KEMS309E **KOCE500E** KOCE507E

ELECTRICAL CONNECTION

If codes permit and a separate ground wire is used, it is recommended that a qualified electrical installer determine that the ground path and the wire gauge are in accordance with local codes. Check with a qualified electrical installer if you are not sure the oven is properly grounded.

This oven must be connected to a grounded metal, permanent wiring system.

Be sure that the electrical connection and wire size are adequate and in conformance with the National Electrical Code, ANSI/NFPA 70-latest edition or CSA Standards C22.1-94, Canadian Electrical Code, Part 1 and C22.2 No. 0-M91-latest edition, and all local codes and ordinances.

To properly install your oven, you must determine the type of electrical connection you will be using and follow the instructions provided for it here.

- Oven must be connected to the proper electrical voltage and frequency as specified on the model/serial/rating plate. See the following illustration.

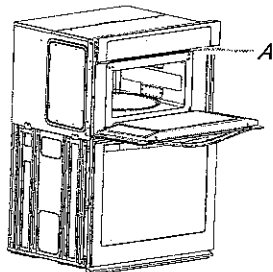

A. Model/serial/rating plate

- Models rated from 7.3 to 9.6 kW at 240 volts (5.4 to 7.4 kW at 208 volts) require a separate 40-amp circuit. Models rated at 4.8 kW and below at 240 volts (3.6 kW and below at 208 volts) require a separate 30-amp circuit.
- A circuit breaker is recommended.
- Connect directly to the fused disconnect (or circuit breaker box) through flexible, armored or nonmetallic sheathed, copper cable (with grounding wire). See "Make Electrical Connection" section.
- Flexible conduit from the oven should be connected directly to the junction box.
- Do not cut the conduit. The length of conduit provided is for serviceability of the oven.
- A UL listed or CSA approved conduit connector must be provided.
- If the house has aluminum wiring, follow the procedure below:
 - Connect a section of solid copper wire to the pigtail leads.
 - Connect the aluminum wiring to the added section of copper wire using special connectors and/or tools designed and UL listed for joining copper to aluminum.

Follow the electrical connector manufacturer's recommended procedure. Aluminum/copper connection must conform with local codes and industry accepted wiring practices.

For power requirements, refer to the following table.

Model	Voltage	Amperage (L1)*	Amperage (L2)*	Rating (W)
KOCE507E/KOCE500E	120/240	32	30	8000
KOCE507E/KOCE500E	120/208	30	28	6600

*Amperage values noted above are for information purposes only: the units are rated in watts.

Because Whirlpool Corporation includes a continues commitment to improve our products, we reserve the right to change materials and specifications without notice.

PRODUCT DIMENSIONS

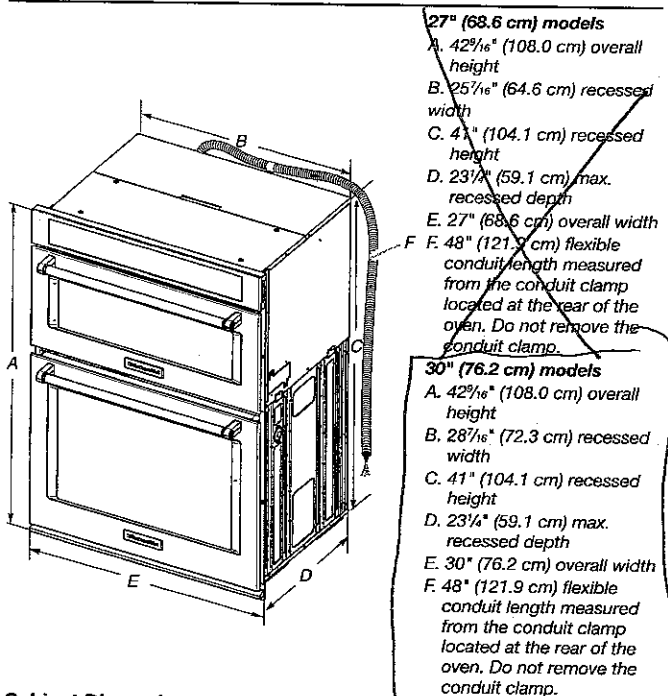

Cabinet Dimensions

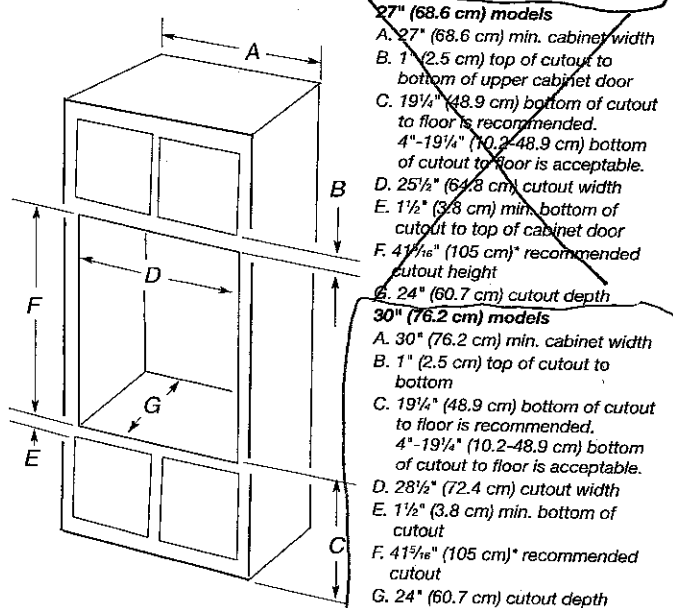

* NOTE: The cabinet height can be between 41" (104.1 cm) and 41¹/₂" (105.6 cm) for microwave/oven combination.

Dimensions are for planning purposes only. For complete details, see Installation Instructions packed with product. Specifications subject to change without notice.

Ref. W10725683B
2/10/15

KUERNBURG GREN
LOT 8R

(L.O.)

DATE Nov 15 2016