



CONSTRUCTION SUMMARY

Kleinburg Glen - 16 - 1 - 42-3 Elev.B CARLTON
CENTRAL VAC AND WIRING

Inv.512	1 - GREAT ROOM: CONDUIT PIPE - FOR TELEVISION - Locate above fireplace, approx 60"A.F.F., terminating right of fireplace by cable location. See plan for location.
Line9514	Note:
20May16 / 7Nov16	

CERAMIC

Inv.1,023	1 - FOYER FLOOR TILE: Upgrade 7 floor tile - 24x24"
Line14751	Note: Grout lines as small as possible, please!
29Nov16 / 15Dec16	
Inv.1,023	1 - KITCHEN FLOOR TILE: Upgrade 7 floor tile - 24x24"
Line14750	Note: Grout lines as small as possible, please!
29Nov16 / 15Dec16	
Inv.1,023	1 - POWDER ROOM FLOOR TILE: Upgrade 7 floor tile - 24x24"
Line14752	Note: Grout lines as small as possible, please!
29Nov16 / 15Dec16	
Inv.1,023	1 - MUD ROOM FLOOR TILE: Upgrade 7 floor tile - 24x24"
Line14753	Note: Grout lines as small as possible, please!
29Nov16 / 15Dec16	

DRYWALL

Inv.512	1 - SMOOTH CEILINGS - (2 - Story Design) 2ND FLOOR
Line9530	Note:
20May16 / 7Nov16	

ELECTRICAL

Inv.512	1 - GREAT ROOM: 110V WALL RECEPTACLE ON NORMAL CIRCUIT Locate approx. 60" A.F.F. above fireplace.
Line9515	Note:
20May16 / 7Nov16	
Inv.512	1 - KITCHEN: ROUGH - IN ceiling OUTLET & SWITCH (WITH COVER PLATE) - DOES NOT INCLUDE FIXTURE - Locate approx. center above island. See plan for location.
Line9517	Note:
20May16 / 7Nov16	
Inv.512	1 - 110V WALL RECEPTACLE ON DEDICATED CIRCUIT - FOR MICROWAVE - MICROWAVE & CABINETRY CUSTOMIZATION NOT INCLUDED. See plan for location.
Line9518	Note:
20May16 / 7Nov16	
Inv.512	1 - KITCHEN: 220V WALL RECEPTICAL ON DEDICATED CIRCUIT - FOR 4 WIRE BUILT - IN WALL OVEN - See plan for location.
Line9519	Note:
20May16 / 7Nov16	
Inv.512	1 - KITCHEN: 110V WALL RECEPTACLE ON DEDICATED CIRCUIT - GAS FIRED APPLIANCE - FOR AUX. EQUIPMENT - NOT A STOVE PLUG
Line9520	Note:
20May16 / 7Nov16	
Inv.512	1 - KITCHEN: 110V WALL RECEPTACLE ON DEDICATED CIRCUIT - for future 600+ cfm hood fan.
Line9523	Note:
20May16 / 7Nov16	

Kleinburg Glen - 16 - 1 - 42-3 Elev.B CARLTON

Inv.512	1 - KITCHEN: 110V WALL RECEPTACLE ON NORMAL CIRCUIT - for future wine fridge (below counter), see plan for location.
Line9524	Note:
20May16 / 7Nov16	
Inv.512	1 - KITCHEN: 110V WALL RECEPTACLE ON NORMAL CIRCUIT - for future built-in coffee machine (above counter height) See plan for location.
Line9525	Note:
20May16 / 7Nov16	
Inv.512	1 - KITCHEN CABINET STRIP VALANCE LIGHTS (UNDER CABINETS) - ROUGH - IN - DOES NOT INCLUDE (AND REQUIRES) KITCHEN UPGRADE PRICING
Line9527	Note:
20May16 / 7Nov16	
Inv.512	1 - BREAKFAST: *NOTE* center standard ceiling light as close as possible to be centered between garden door/archway - see plan for location.
Line9528	Note:
20May16 / 7Nov16	

EXTERIOR COLOURS

Inv.512	1 - EXTERIOR COLOUR PACKAGE 9
Line13511	Note:
20May16 / 7Nov16	

FRAMING

Inv.512	1 - GREAT ROOM: Build out above fireplace to ceiling. See sketch for location.
Line9516	Note:
20May16 / 7Nov16	
Inv.512	1 - KITCHEN: Reduce bulkhead as much as possible to fit behind future furring panel and crown moulding increased to ceiling.
Line9526	Note:
20May16 / 7Nov16	
Inv.512	1 - MAIN FLOOR CEILING 10FT- INCLUDES: TALLER FRONT DOOR WITH TRANSOM, TALLER FRONT AND REAR ELEVATION WINDOWS OR WITH TRANSOM, EXTRA TALL FLAT ARCHES, 8' TALL INTERIOR DOORS, WITH KITCHEN CROWN AND FURRING PANEL,
Line9529	Note:
20May16 / 7Nov16	
Inv.512	2 - 2nd FLOOR: FRAME 2ND FLOOR ARCHES AT 96 INCH -
Line9531	Note:
20May16 / 7Nov16	
Inv.512	1 - GREAT ROOM: create recessed niche for future TV above fireplace. See sketch for size/location.
Line10729	Note:
20May16 / 7Nov16	
Inv.512	19 - 2nd Floor: FRAME DOORS AT 96 INCH - ADDED WITH THE ADDITION OF TALLER INTERIOR DOORS
Line10734	Note:
20May16 / 7Nov16	
Inv.512	1 - MASTER ENSUITE: *DELETE* flat arch in ceiling near tub, see plan for location.
Line10832	Note:
20May16 / 7Nov16	

Kleinburg Glen - 16 - 1 - 42-3 Elev.B CARLTON

Inv.849	1 - MASTER ENSUITE: **DELETE** wall and door at water closet, leaving half-wall at vanity. See plan for location.
Line11830	Note:
22Sep16 / 7Nov16	
Inv.1,023	1 - KITCHEN CABINETRY: **NOTE** DELETE BULKHEAD for stacked cabinetry
Line14749	Note:
29Nov16 / 15Dec16	

HARDWOOD

Inv.1,023	1 - LIVING/DINING ROOM / DEN / GREAT ROOM / LOWER LANDING / UPPER LANDING HARDWOOD FLOOR: Upgrade 5 - Vintage White Oak 5" hand scraped.
Line14754	Note:
29Nov16 / 15Dec16	
Inv.1,023	1 - UPPER HALL HARDWOOD FLOOR: Upgrade 5 - Vintage White Oak 5" hand scraped.
Line14755	Note:
29Nov16 / 15Dec16	

HVAC

Inv.512	1 - KITCHEN: GAS LINE ROUGH - GROUND FLOOR
Line9521	Note:
20May16 / 7Nov16	
Inv.512	1 - KITCHEN: UPGRADE VENTING FOR STOVE TO 8 INCH PIPE EXTERIOR WALL
Line9522	Note:
20May16 / 7Nov16	

INTERIOR TRIM AND DOORS

Inv.512	2 - 2nd FLOOR: EXTENDED HEIGHT ARCHWAY 96" (PRICE PER DOORWAY)
Line9532	Note:
20May16 / 7Nov16	
Inv.512	19 - 2nd Floor: STANDARD DOOR EXTENDED HEIGHT 96 INCH (PRICE PER DOOR) - SECOND FLOOR 2 STOREY 38 FOOT AN 42 FOOT MODELS ONLY
Line10730	Note:
20May16 / 7Nov16	
Inv.512	1 - MAIN FLOOR CEILING 10FT- INCLUDES: TALLER FRONT DOOR WITH TRANSOM, TALLER FRONT AND REAR ELEVATION WINDOWS OR WITH TRANSOM, EXTRA TALL FLAT ARCHES, 8' TALL INTERIOR DOORS, WITH KITCHEN CROWN AND FURRING PANEL,
Line12402	Note:
20May16 / 7Nov16	
Inv.1,023	1 - MAIN FLOOR + 2ND FLOOR: Upgrade trim package 2 thru out. Note: 10' ceiling package
Line14758	Note:
29Nov16 / 15Dec16	

KITCHEN AND BATH CABINETRY

Inv.512	1 - MAIN FLOOR CEILING 10FT- INCLUDES: TALLER FRONT DOOR WITH TRANSOM, TALLER FRONT AND REAR ELEVATION WINDOWS OR WITH TRANSOM, EXTRA TALL FLAT ARCHES, 8' TALL INTERIOR DOORS, WITH KITCHEN CROWN AND FURRING PANEL,
Line12401	Note:
20May16 / 7Nov16	

Kleinburg Glen - 16 - 1 - 42-3 Elev.B CARLTON

Inv.849	1 - KITCHEN: Add prep sink in kitchen, locate on dining room wall. See plan for location. (builder's standard samples)
Line13512	Note:
22Sep16 / 7Nov16	
Inv.1,023	1 - KITCHEN CABINetry: Stacked upper cabinets
Line14834	Note:
29Nov16 / 15Dec16	
Inv.1,023	1 - KITCHEN CABINetry: *DO **NOT** INSTALL crown moulding and furring panel!
Line14835	Note:
29Nov16 / 15Dec16	
Inv.1,023	1 - KITCHEN CABINetry: Double appliance cabinet with drawer below (oven installation is standard, not recessed)
Line14836	Note:
29Nov16 / 15Dec16	
Inv.1,023	1 - KITCHEN CABINetry: Set of pots and pans drawers below range-top (2 drawers)
Line14837	Note:
29Nov16 / 15Dec16	
Inv.1,023	2 - KITCHEN CABINetry: Pots and pans drawers (1 small drawer + 2 deep drawers) - locate on either side of range
Line14838	Note:
29Nov16 / 15Dec16	
Inv.1,023	1 - KITCHEN CABINetry: 59CM deep pantry with finished gables in lieu of 30cm deep pantry - double doors
Line14839	Note:
29Nov16 / 15Dec16	
Inv.1,023	1 - KITCHEN CABINetry: Accomodate built-in coffee machine at double door pantry at wall behind dining room. Standard installation is proud on panel (not flush/integrated)
Line14840	Note:
29Nov16 / 15Dec16	
Inv.1,023	1 - KITCHEN CABINetry: Flush fridge installation.
Line14841	Note:
29Nov16 / 15Dec16	
Inv.1,023	1 - KITCHEN CABINetry: Delete uppers above stove, finish sides of cabinetry - for future chimney-style hood fan. Leave approx. 42" between uppers above 36" range.
Line14842	Note:
29Nov16 / 15Dec16	
Inv.1,023	1 - KITCHEN CABINetry: **NOTE** DELETE BULKHEAD for stacked cabinetry
Line15412	Note:
29Nov16 / 15Dec16	

MISC.

Inv.512	1 - Purchaser has attended a Structural appointment at the Decor Centre & has DECLINED any additional upgrades and accepts and acknowledges that there will be no further structural changes/additions/deletions to be made upon signing on August 30, 2016.
Line10731	Note:
20May16 / 7Nov16	
Inv.512	1 - Purchasers are aware & accepts that ANY changes made to upgrades after signing this Purchasers Extra Form are subject to a minimum administration fee of \$500. PLUS a 10% holdback fee.
Line10732	Note:
20May16 / 7Nov16	

Kleinburg Glen - 16 - 1 - 42-3 Elev.B CARLTON

Inv.512	1 - BONUS PACKAGE: \$10,000.00 (INCLUDING TAXES) WORTH OF UPGRADES FROM GOLD PARK HOMES DÉCOR CENTRE IS BEING APPLIED TOWARD THE STRUCTURAL APPOINTMENT. PURCHASER HAS A REMAINING AMOUNT OF \$00 (INCLUDING TAXES) TO BE USED TOWARD THE COLOUR APPOINTMENT.
Line10733	Note:
20May16 / 7Nov16	
Inv.849	1 - Purchasers are aware & accepts that ANY changes made to upgrades after signing this Purchasers Extra Form are subject to a minimum administration fee of \$500. PLUS a 10% holdback fee.
Line11831	Note:
22Sep16 / 7Nov16	
Inv.1,023	1 - Purchaser has attended a Colour appointment at the Decor Centre & has DECLINED any additional upgrades and accepts and acknowledges that there will be no further changes/additions/deletions to be made upon signing on December 4, 2016.
Line14844	Note:
29Nov16 / 15Dec16	
Inv.1,023	1 - Purchasers are aware & accepts that ANY changes made to upgrades after signing this Purchasers Extra Form are subject to a minimum administration fee of \$500. PLUS a 10% holdback fee.
Line14845	Note:
29Nov16 / 15Dec16	
Inv.1,023	1 - STAIRCASE - The purchaser was advised and therefore accepts and acknowledges that the wood species of the staircase and flooring chosen do not match. This difference may result in a stain colour variance.
Line14846	Note: Stairs will not match hardwood flooring in colour, texture or species.
29Nov16 / 15Dec16	
Inv.1,023	1 - KITCHEN - Purchasers request to NOT INSTALL builder's standard hood fan and standard cabinets above stove. DELETE. Do not supply, install, and/or credit. Purchasers are installing their own hood fan after closing.
Line14847	Note: Purchasers accept and acknowledge that the exhaust fan duct hole may be off-centered with stove in kitchen due to purchasers installing their own hood fan after closing. The vendor is exempt
29Nov16 / 15Dec16	

PAINTING

Inv.1,023	1 - MAIN STAIRS: Stain stairs Vintage "Pewter" Note: stairs will not match hardwood in species, colour or texture
Line14757	Note:
29Nov16 / 15Dec16	

PLUMBING

Inv.512	1 - MASTER ENSUITE: ROUGH - IN FOR RAINSHOWER HEAD - SHOWER HEAD NOT INCLUDED AND MUST BE PURCHASED
Line9534	Note:
20May16 / 7Nov16	
Inv.849	1 - KITCHEN: Add prep sink in kitchen, locate on dining room wall. See plan for location. (builder's standard samples)
Line11829	Note:
22Sep16 / 7Nov16	
Inv.1,023	1 - MASTER ENSUITE: **DELETE** ITEM FROM ORDER PE.512-1 'Rough in for rainshower head' Do not install - leave standard shower.
Line14843	Note:
29Nov16 / 15Dec16	

STAIRS AND RAILINGS

Kleinburg Glen - 16 - 1 - 42-3 Elev.B CARLTON

Inv.1,023	1 - MAIN STAIRS: R6 Wrought Iron + V Groove
Line14756	Note:
29Nov16 / 15Dec16	

WINDOWS - BASEMENT

Inv.512	1 - BASEMENT WINDOWS - UPGRADE EXISTING BASEMENT WINDOW TO 53 INCH X 16 INCH - MAY REQUIRE INSTALLATION OF WINDOW WELL
Line10728	Note:
20May16 / 7Nov16	

WINDOWS AND DOORS

Inv.512	1 - MAIN FLOOR CEILING 10FT- INCLUDES: TALLER FRONT DOOR WITH TRANSOM, TALLER FRONT AND REAR ELEVATION WINDOWS OR WITH TRANSOM, EXTRA TALL FLAT ARCHES, 8' TALL INTERIOR DOORS, WITH KITCHEN CROWN AND FURRING PANEL,
Line12400	Note:
20May16 / 7Nov16	

Scheduled Closing Date: Monday, September 12, 2016

Purchasers: Erika Marie Puopolo & Anthony Nicolas Belpulsi Property: 16

Telephone Res. / Bus: (416) 356-1038

Project: Burkshire Holdings Inc.

Decor Advisor: Yolande Somerville

Model and Elevation: 42-3 Elev.B CARLTON

Layout Changes: ☐ Yes ☒ NoSketch Attached: ☒ Yes ☐ No

Exterior Colour Scheme:

1. Cabinetry

	Style and Colour	Counter	Hardware
Kitchen / Breakfast	Toscana pvc 'antq white'	Granite: Grigio Sardo Edge: FE-20	cs1-24
Laundry Room	n/a	n/a	n/a
Powder Room	Varese pvc 'mystic'	P-lam # P-344-LM 'Inukshuk Grey'	cs1-24
Twin Bathroom	Toscana pvc 'antiq white'	P-lam #4928-38 'Venetian Ivory'	cs1-21
Master Ensuite Bathroom	Varese pvc 'white crystal'	P-lam #P-344-LM 'Inukshuk Grey'	cs1-24
Second Ensuite Bathroom (If Applicable)	Varese pvc 'white crystal'	P-Lam #P344-LM 'Inukshuk Grey'	cs1-25
n/a			
Dishwasher Cabinet	n/a		

Comment

2. Floor Tile

	Selection	Grout	Threshold
Entrance Vestibule	*24x24" Marmi Evolution 'Calacatta' glossy	n/a	n/a
Main Hall	n/a	n/a	n/a
Kitchen / Breakfast	*24x24" Marmi Evolution 'Calacatta' glossy	n/a	n/a
Laundry Room	13x13" Serpentine 'Beyaz-white'	n/a	n/a
Powder Room	*24x24" Marmi Evolution 'Calacatta' glossy	n/a	n/a
Mud Room	*24x24" Marmi Evolution 'Calacatta' glossy	n/a	n/a
Master Ensuite Bathroom	13x13" Serpentine 'Beyaz-white'	n/a	n/a
Second Ensuite Bathroom (If Applicable)	13x13" New Reeds 'Brown'	n/a	n/a
Lower Landing (If Applicable)	n/a	n/a	n/a
Twin Bathroom	13x13" Milieu 'Fog'	n/a	n/a

Comment

3. Wall Tile

	Selection	Listello/Inserts	Describe
		<input type="radio"/> Yes <input checked="" type="radio"/> No	
Master Ensuite Bathroom			
Tub Deck	n/a	<input type="radio"/> Yes <input checked="" type="radio"/> No	
Shower Stall	8x10" Weave 'White'	<input type="radio"/> Yes <input checked="" type="radio"/> No	
Bathroom Walls	n/a	<input type="radio"/> Yes <input checked="" type="radio"/> No	
Second Ensuite Bathroom (If Applicable)	8x10" Weave 'Tender Grey'	<input type="radio"/> Yes <input checked="" type="radio"/> No	
Twin Bathroom	8x10" Weave 'White'	<input type="radio"/> Yes <input checked="" type="radio"/> No	

Kitchen Backsplash ☐ Yes ☒ No

Backsplash Behind Fridge n/a

Comment

EB AB

Purchasers: Erika Marie Puopolo & Anthony Nicolas Belpulsi Property: 16

Telephone Res. / Bus: (416) 356-1038

Project: Burkshire Holdings Inc.

Decor Advisor: Yolande Somerville

Model and Elevation: 42-3 Elev.B CARLTON

4. Plumbing Fixtures

<input type="checkbox"/>	Second Ensuite	<input type="checkbox"/>	Powder Room	<input type="checkbox"/>
Master Ensuite Bathroom	<input type="checkbox"/>	Other Room - Specify	<input type="checkbox"/>	Other Washroom
<input type="text"/>				

Comment

Standard plumbing thru out

5. Hardwood Flooring

Main Hall	Type and Stain *3/4x5" Hand Scraped 'Gotham'	Upper Landing	Type and Stain *3/4x5" Hand Scraped 'Gotham'
Kitchen / Breakfast	n/a	Upper Hall	*3/4x5" Hand Scraped 'Gotham'
Living Room	*3/4x5" Hand Scraped 'Gotham'	Master Bedroom	n/a
Dining Room	*3/4x5" Hand Scraped 'Gotham'	Bedroom #2	n/a
Family Room	*3/4x5" Hand Scraped 'Gotham'	Bedroom #3	n/a
Den/Library	*3/4x5" Hand Scraped 'Gotham'	Bedroom #4	n/a
Entrance Vestibule	n/a	Bedroom #5	n/a
Lower Landing (If Applicable)	*3/4x5" Hand Scraped 'Gotham'	Other Room - Specify	<input type="text"/>
			n/a

Comment

*Hardwood Selection: Vintage 3/4 x 5" White Oak, handscraped 'Gotham'

6. Carpeting

Main Hall	Upgrade <input type="checkbox"/>	Description n/a
Living Room	<input type="checkbox"/>	n/a
Dining Room	<input type="checkbox"/>	n/a
Family Room	<input type="checkbox"/>	n/a
Den/Library	<input type="checkbox"/>	n/a
Upper Hall	<input type="checkbox"/>	n/a
Master Bedroom	<input type="checkbox"/>	T-04
Bedroom #2	<input type="checkbox"/>	T-04
Bedroom #3	<input type="checkbox"/>	T-04
Bedroom #4	<input type="checkbox"/>	T-04
Bedroom #5	<input type="checkbox"/>	n/a
<input type="text"/>	<input type="checkbox"/>	<input type="text"/>
Upper Landing (If Applicable)	<input type="checkbox"/>	n/a
Lower Landing (If Applicable)	<input type="checkbox"/>	n/a

Upgrade Underpad	Type n/a	Area n/a
Carpet on Stairs	Capped n/a	Runner - *Upgrade n/a

Comment

Standard carpet and underpad in bedrooms

EB

AB

Purchasers: Erika Marie Puopolo & Anthony Nicolas Belpulsi Property: 16

Telephone Res. / Bus: (416) 356-1038

Project: Burkshire Holdings Inc.

Decor Advisor: Yolande Somerville

Model and Elevation: 42-3 Elev.B CARLTON

7. Fireplace

	Living Room			Family Room			Other Room - Specify		
	Purchased	As Per Plan	N/A	Purchased	As Per Plan	N/A	Purchased	As Per Plan	N/A
Fireplace Type	<input type="radio"/>	<input type="radio"/>	<input checked="" type="radio"/>	<input type="radio"/>	<input checked="" type="radio"/>	<input type="radio"/>	<input type="radio"/>	<input type="radio"/>	<input checked="" type="radio"/>
Mantle Type				Standard Gas					
Colour / Stain				**none					
Surround				none					
Hearth				none					

Comment

*Delete standard fireplace mantle, leave painted drywall

8. Trim Carpentry

Interior Doors Front Door Glass Inserts Door Handles

Interior Trim

Comment

*96" Doors thru out -standard profile

9. Plaster Mouldings and Medallions

Entrance Vestibule	<input type="text"/>	<input type="text"/>	Kitchen/Breakfast	<input type="text"/>	<input type="text"/>
Main Hall	<input type="text"/>	<input type="text"/>	Den/Library	<input type="text"/>	<input type="text"/>
Living Room	<input type="text"/>	<input type="text"/>	Lower Landing	<input type="text"/>	<input type="text"/>
Dining Room	<input type="text"/>	<input type="text"/>	Other Room - Specify	<input type="text" value="none"/>	<input type="text"/>
Family Room	<input type="text"/>	<input type="text"/>	Thru out	<input type="text"/>	<input type="text"/>

Comment

10. Railings and Spindles

Railing Package

Railing Colour Spindle Colour

Stringer / Riser Treads

Oak Stairs ☒ Yes ☐ No

Comment

11. Wall Paint

Main & Upper Hall	<input type="text"/>	Master Bedroom	<input type="text"/>
Living Room	<input type="text"/>	Bedroom #2	<input type="text"/>
Dining Room	<input type="text"/>	Bedroom #3	<input type="text"/>
Kitchen / Breakfast	<input type="text"/>	Bedroom #4	<input type="text"/>
Family Room	<input type="text"/>	Bedroom #5	<input type="text"/>
Powder Room	<input type="text"/>	Master Ensuite	<input type="text"/>
Laundry Room	<input type="text"/>	Second Ensuite	<input type="text"/>
Den/Library	<input type="text"/>	Thru out	<input type="text" value="Warm Grey"/>
Trim Paint	<input type="text"/>		

Comment Smooth Ceilings First Floor

EB

AB

Scheduled Closing Date: Monday, September 12, 2016

Purchasers: Erika Marie Puopolo & Anthony Nicolas Belpulsi Property: 16

Telephone Res. / Bus: (416) 356-1038

Project: Burkshire Holdings Inc.

Decor Advisor: Yolande Somerville

Model and Elevation: 42-3 Elev.B CARLTON

12. Electrical

Plugs and Switches ☒ White ☐ Ivory Above Kitchen Cabinet Light ☒ Yes ☐ No
Hood Fan ☐ White ☐ Ivory Below Kitchen Cabinet Light ☐ Yes ☒ No
Appliances Built in Cooktop Built in Oven Gas Stove Microwave
☒ Yes ☐ No ☒ Yes ☐ No ☒ Yes ☐ No ☒ Yes ☐ No

Comment
*Future chimney-style hood fan

13. Heating and Air Conditioning

Air Conditioning Gas Provisions Stove
Gas Provisions Dryer Gas Provisions Barbecue

Comment
Standard Gas BBQ line

14. Additional Comments

15. Disclaimers and Notes

- Colours of all materials are as close as possible to builder's selection, but not necessarily identical due to variances in manufacturing.
- Any extras listed above are null and void unless accompanied by a separate invoice/amendment. Said invoice must be paid in full.
- The Purchaser acknowledges that after Interior Colour Selection form is signed and dated, no further changes will be permitted other than re-selection due to unavailability. _____ Purchaser's Initials
- The Purchaser acknowledges reading and accepting the "Gold Park Homes Decor Centre Disclaimers" form. This document contains other miscellaneous disclaimers.

This Interior Colour Selection is final and approved by:

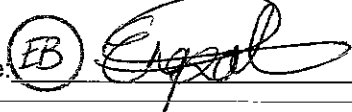
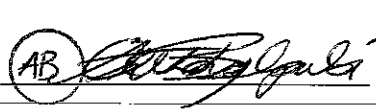
Signature:  Date: _____ Signature:  Date: Dec. 4/16

Elevation B • 3,361 sq.ft.

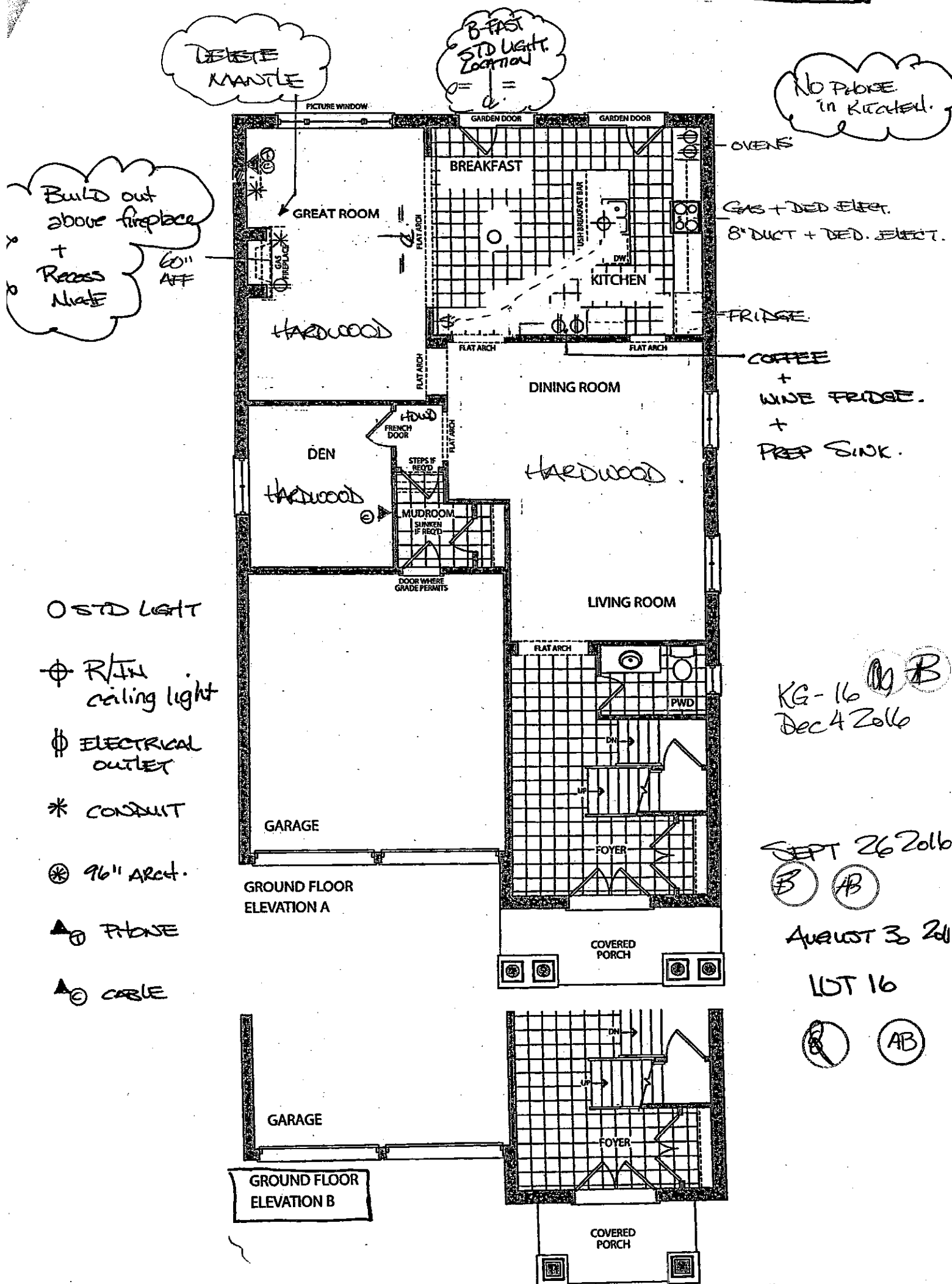

Prices, figures, illustrations, sizes, features and finishes are subject to change without notice. E.&O.E. Areas and dimensions are approximate and actual usable floor space may vary from the stated area. Layout may be reverse of the unit purchased. E. & O.E.

GOLDPARK
HOMES

KG-16 **AB**
Dec 4 2016

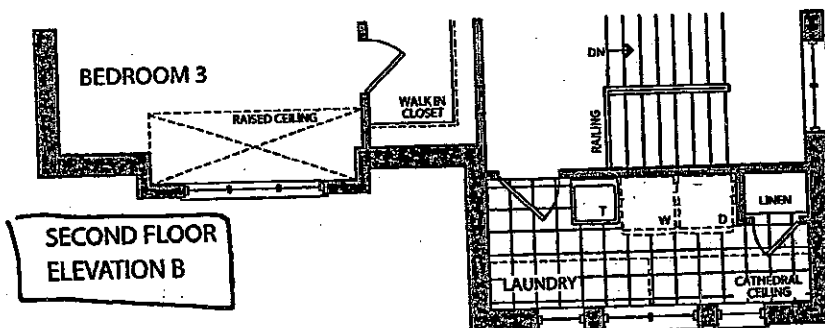
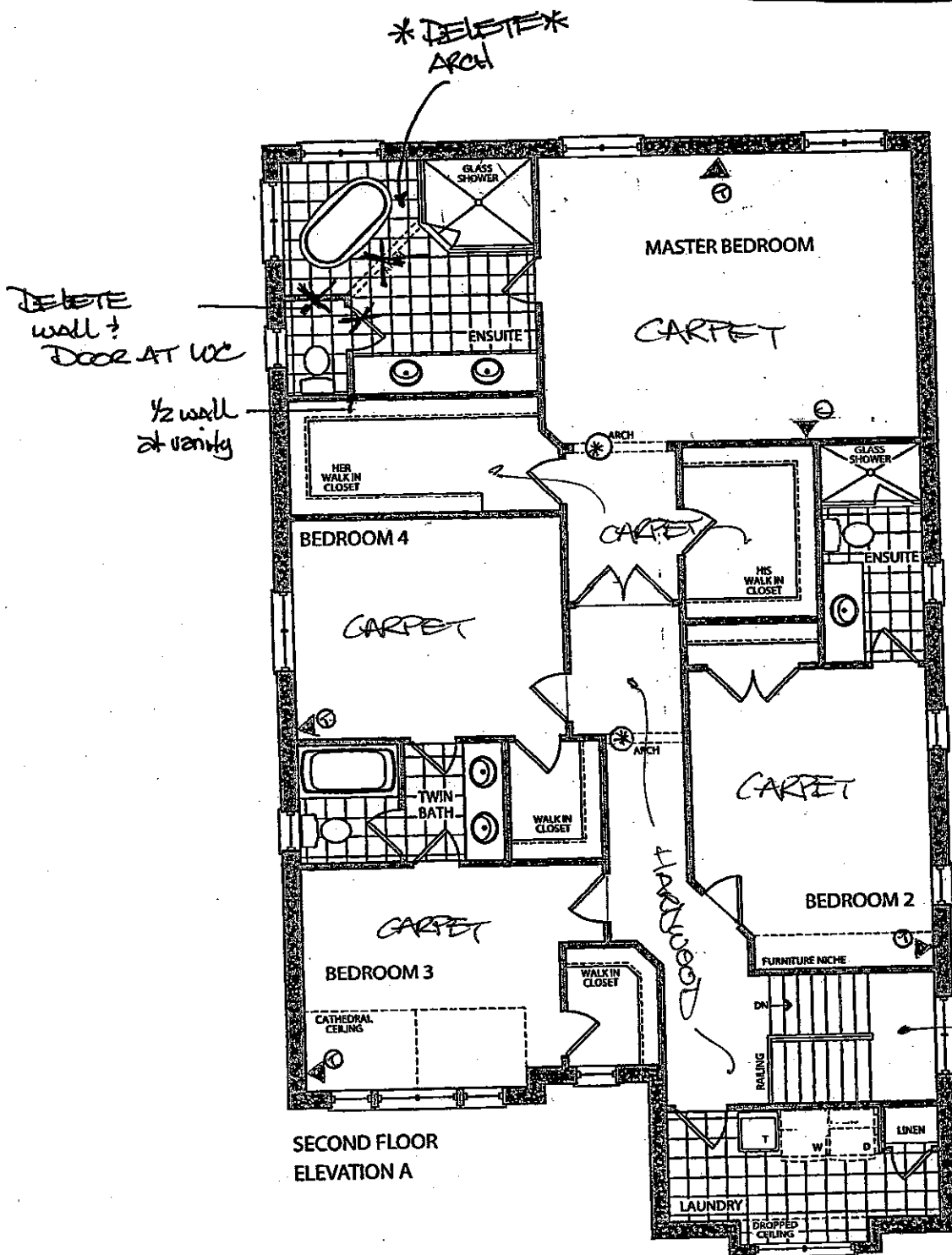

SEPT 26 2016

AB **AB**

AUGUST 30 2016

LOT 16

AB **AB**

Elevation A • 3,354 sq.ft.

Elevation B • 3,361 sq.ft.

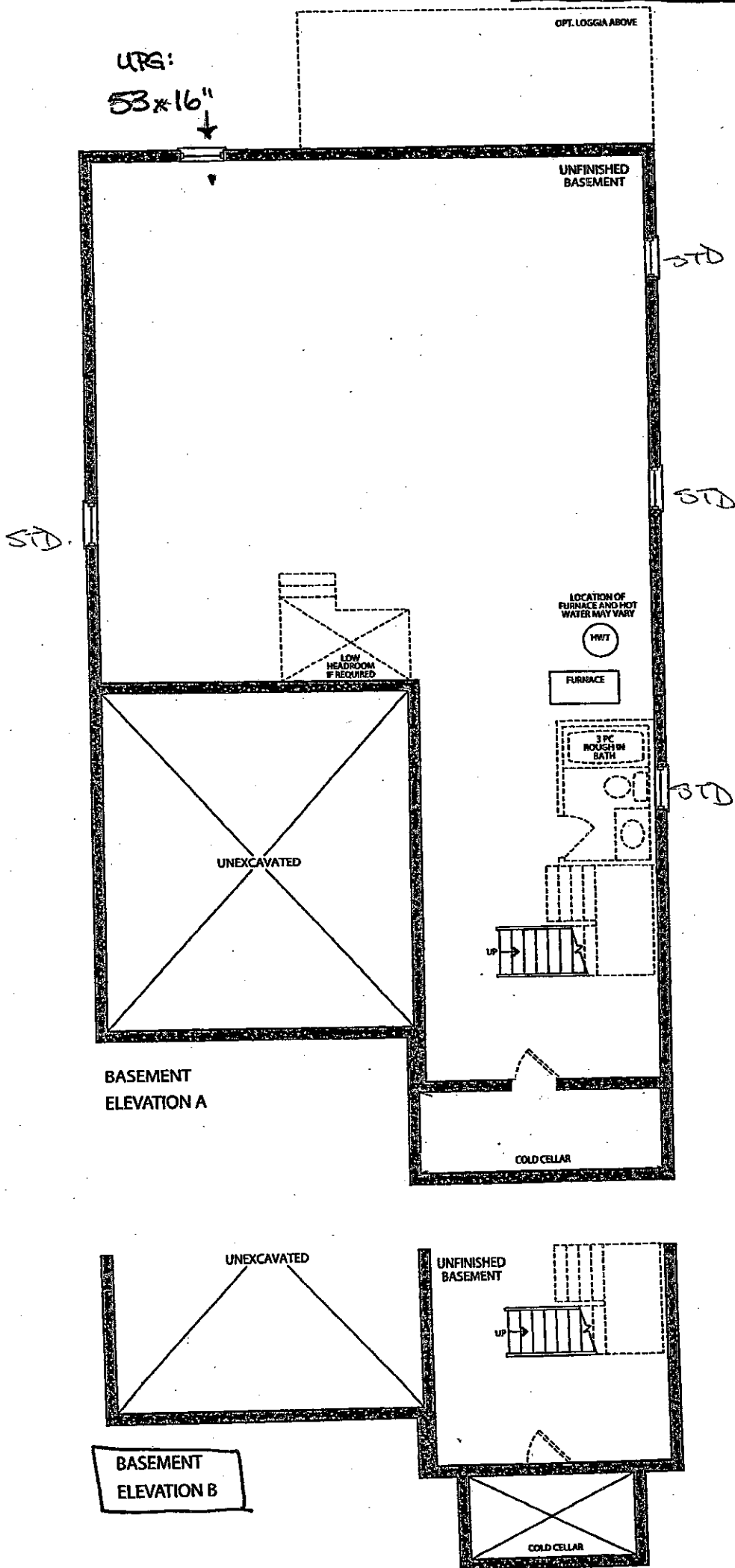

KG-16
Dec 4 2016
B AB

SEPT 26 2016
B AB
AUGUST 30 2016
LOT 16

B AB

CORTINA

KITCHENS INC.

70 Regina Road Woodbridge ON L4L 8L6
905-264-6464

INFORMATION - PVC DOORS

Builder: Gold Park Homes Project: Lot #: 16

All cabinets with PVC (Thermofoil) Doors come with melamine gables, panels and kick. The doors, crown moulding and light valance are PVC wrapped. Open shelves incorporated in design will only be available with melamine interiors. There will be variations in colour shades between the PVC parts (doors, crown and Light valance) and the melamine parts (open shelves, Gables, Panels and Kick) due to the difference in material.

Furring Panel with crown moulding to the ceiling is not available on all PVC door styles due to subtle variations in colour shades between the PVC parts (moulding) and the melamine parts (furring panel) due to the difference in material. Grain directions in wood grain pattern melamine, vary between the furring panel, crown moulding (horizontal) and the PVC doors (vertical).

Thank you for your understanding.

I am well informed of this information, and agree to the purchase of the above.

Purchaser: EB AB

Date: Dec 4 2016

CORTINA

70 Regina Road, Woodbridge, Ontario L4L 8L6
Tel: 905-284-8484 Fax: 905-284-0894
www.CortinaKitchens.com

KG-16

DEC 4 2016

QUOTATION

Date: 29/06/16

Trade Name: Gold Park Homes

Site location:

Model: 42-3

Address:

Project: Kleinburg Glen

Phase:

This layout has been explained to the purchaser by Cortina Kitchens Inc. and is understood by the purchaser.

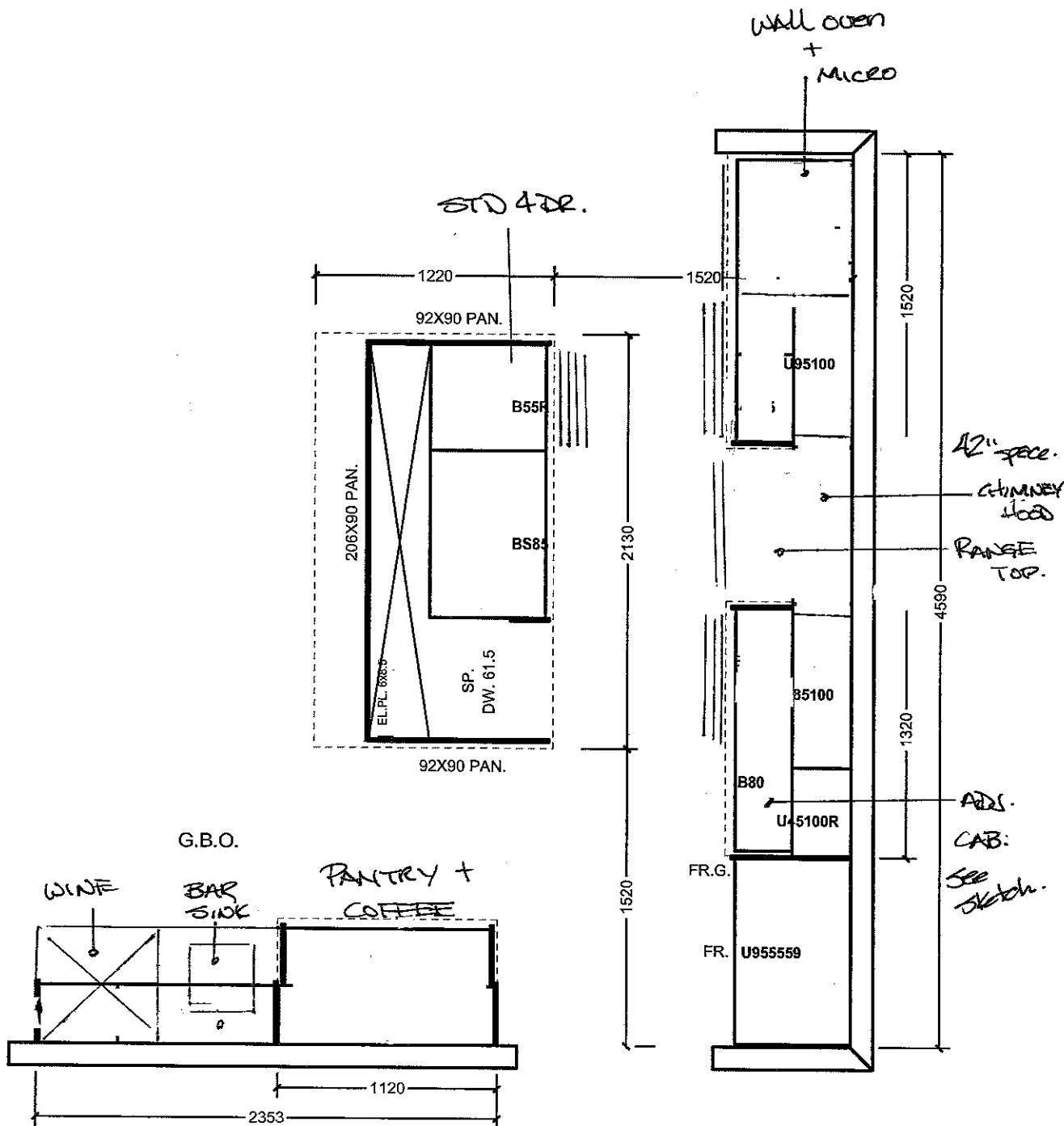

All prices subject to confirmation from head office.
This quotation is subject to the terms & conditions set out

All agreements are contingent upon strikes, accidents, and delays beyond our control.
Please provide our installer with template for sinkholes or \$150.00 will be charged for callback.

ACCEPTED DATE: _____

Item A. Wood grain and colour are characteristics of the product. We cannot guarantee that such grain and colour will always match.
Item B. Cortina Kitchens Inc. reserves the right to alter dimensions and make technical changes without notice.

CORTINA

70 Regina Road, Woodbridge, Ontario L4L 8L6
Tel: 905-284-8484 Fax: 905-284-0864
www.CortinaKitchens.com

KG-16

Dec 4 2016

Q

AB

QUOTATION

Date: 29/06/16

Trade Name: Gold Park Homes

Site location:

Model: 42-3

Address:

Project: Kleinburg Glen

Phase:

This layout has been explained to the purchaser by Cortina Kitchens Inc. and is understood by the purchaser.

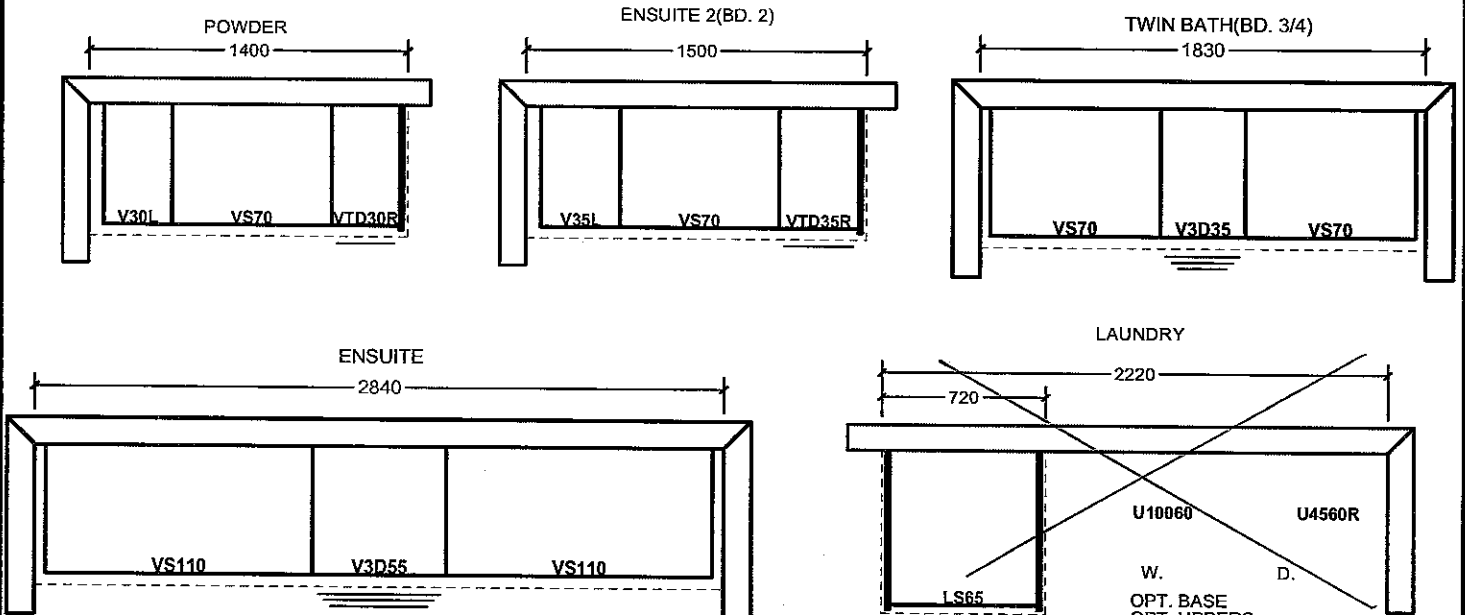

OPT. SECOND FLOOR

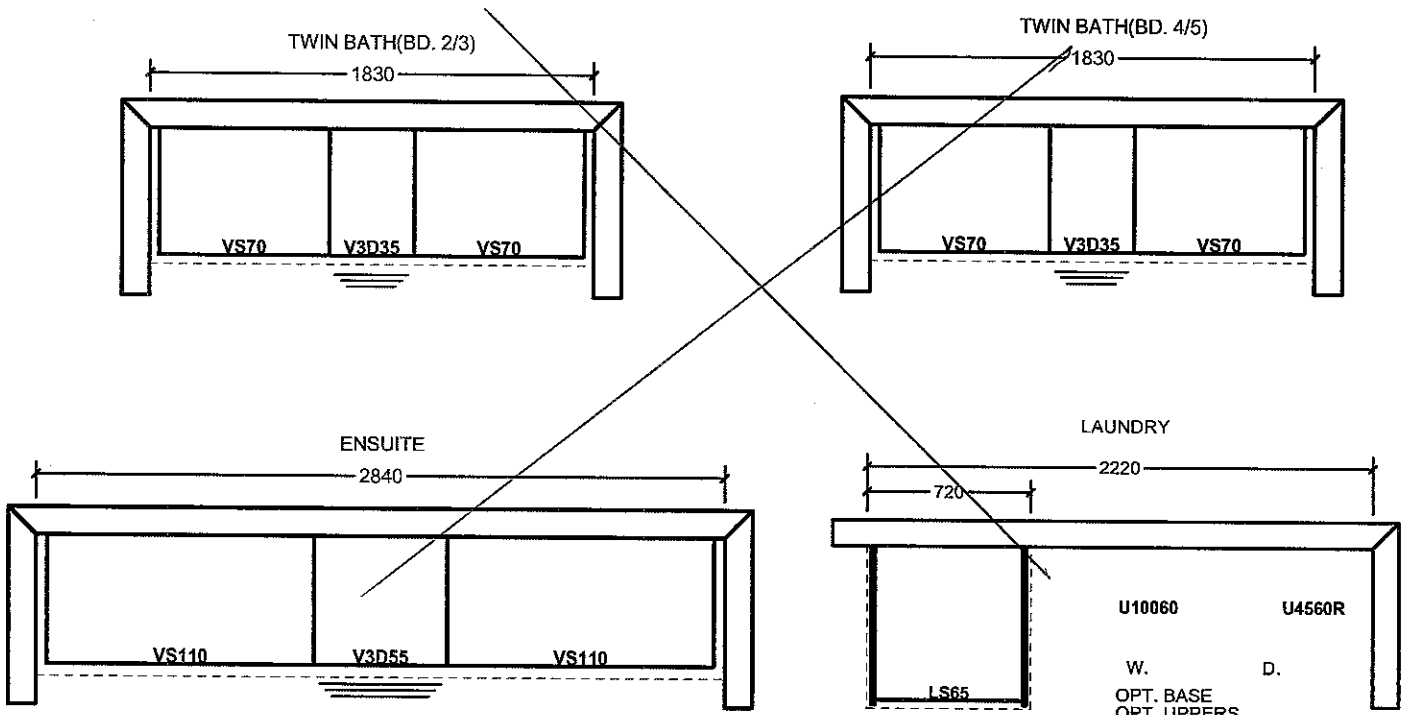

All prices subject to confirmation from head office.
This quotation is subject to the terms & conditions set out

All agreements are contingent upon strikes, accidents, and delays beyond our control.
Please provide our installer with template for sinkholes or \$150.00 will be charged for callback.

ACCEPTED DATE: _____

Item A. Wood grain and colour are characteristics of the product. We cannot guarantee that such grain and colour will always match.
Item B. Cortina Kitchens Inc. reserves the right to alter dimensions and make technical changes without notice.

K5-16
Dec 4 2016 @ AB

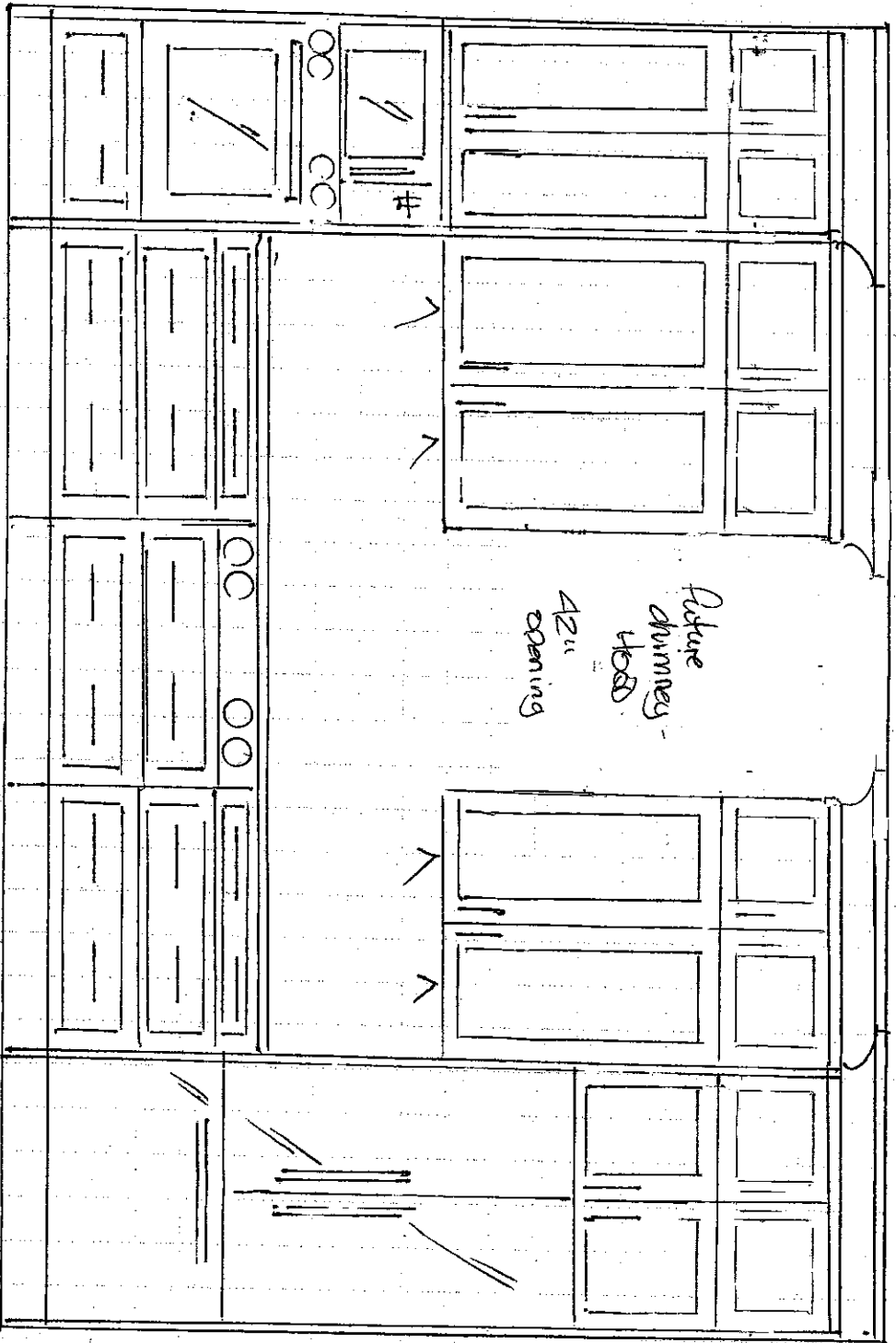

LOT 16 - OFFICIAL. COOK TOP / OVENS / FRIDGE WILL
 UPGRADE 4 - MDF (-WATER)

* SPACED
 UPSTAIRS

10' CEILING

* FOTS & PANS

* CHIMNEY-STYLE
 HOOD.

* Double Appliance
 cabinet is drawer
 below.

* Integrated Fridge

* Fridge top cabinet
 is drawers below

(42-3)

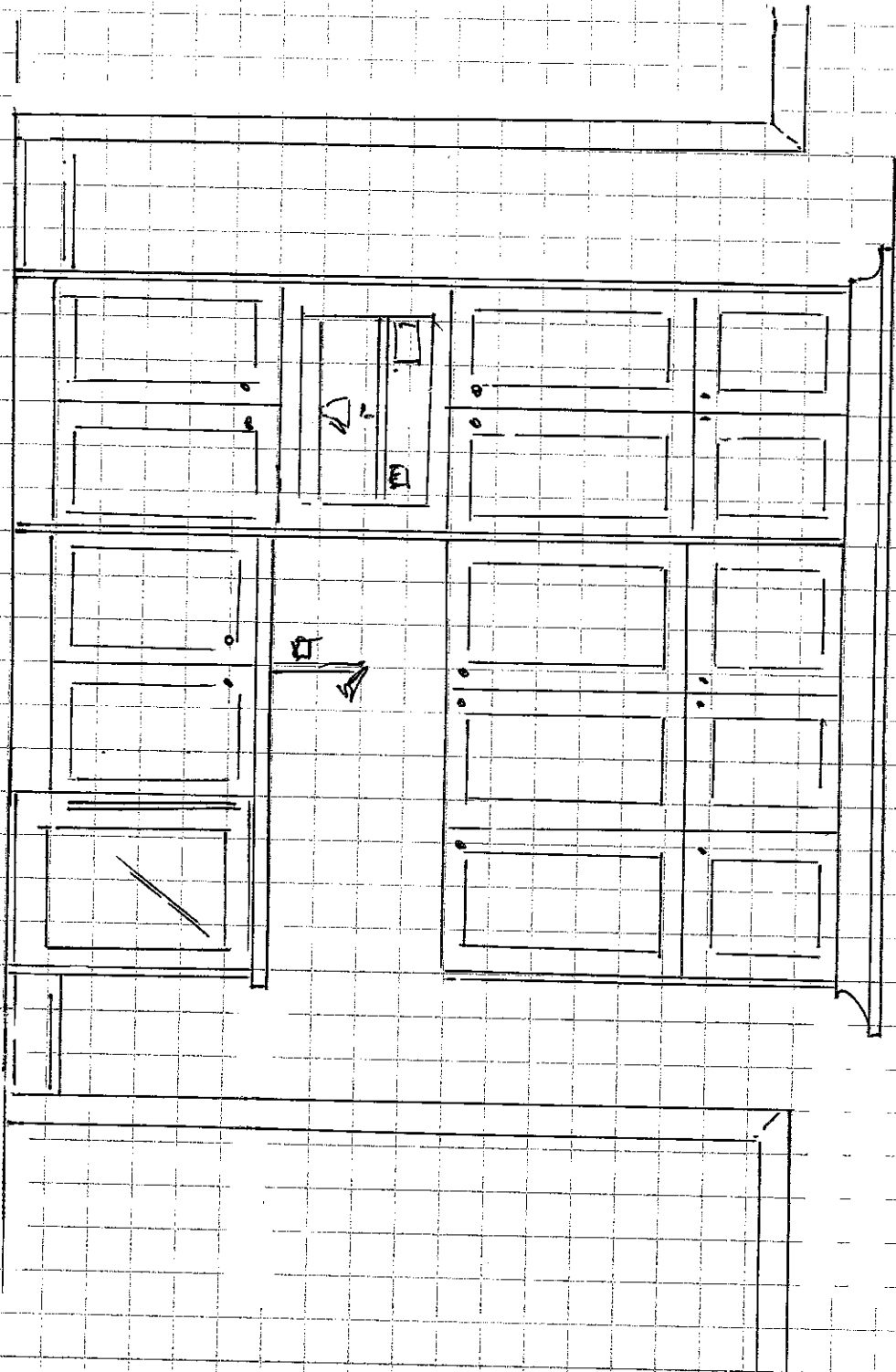

KG-16 COTTAGE + UNDERCABINET + BAR SINK

Dec 4 2016

GOLDPARK
HOMES

KS-16

Dec 4 2016

19

Granite, Marble, Quartz
(Edge Profiles)

KITCHEN

20mm (3/4") Profiles

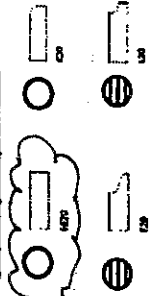

30mm (1 1/4") Profiles

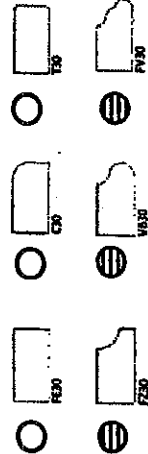

40mm (1 1/2") Profiles

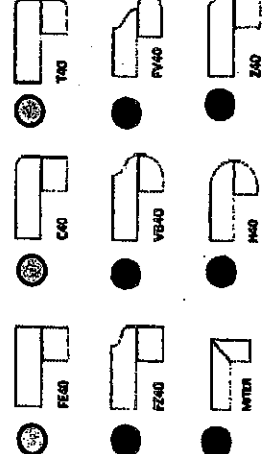

* STANDARD KITCHEN SINK
+ FAUCET

Note: All colours may not be available in 30mm at time ordered.
Vendor reserves the right to use 40mm edges (by limitation process).

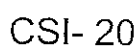
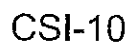

- IMAGES ARE FOR QUICK REFERENCE PURPOSES ONLY
- ACTUAL SIZES AND FINISHES AS PER HARDWARE
SAMPLE BOARD PROVIDED TO DECOR CENTRE

36" FULLY INTEGRATED FRENCH DOOR REFRIGERATOR

(BASE UNIT REQUIRES SUITE-COORDINATING PANEL KIT OR CUSTOM PANELS AND HANDLES)

KG-16.

JF36NXXFXDE – 35¾" x 83⅝" x 24" (without door/handles)

↑
None

PRODUCT DIMENSIONS

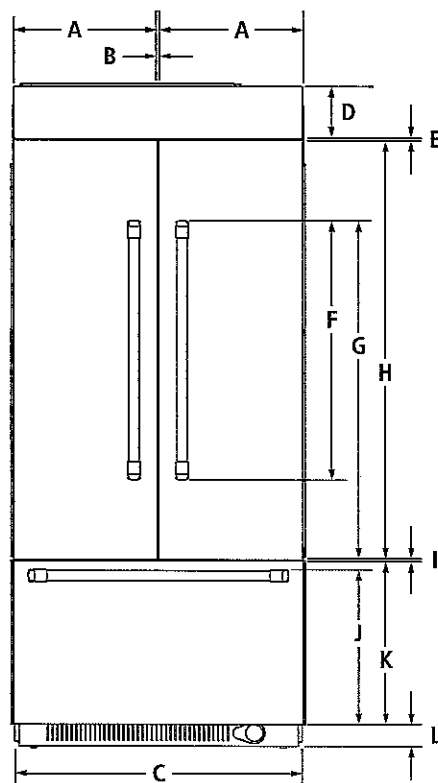

FRONT VIEW

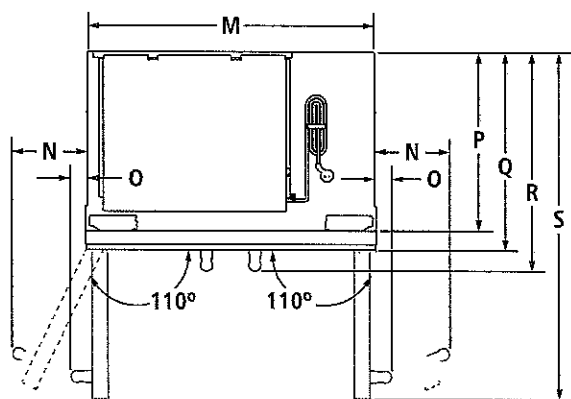

TOP VIEW

MODEL #		JF36NXXFXDE	
		in	cm
A	Width of each door	17⅞	44.8
B	Space between doors	⅞	0.3
C	Overall width	35¾	90.8
D	Height of top grille and bracket	6½	16.5
E	Space between doors and top grille	¾	0.8
F	Height of door handles		
	Pro-Style® Stainless	32⅞	82.2
	Euro-Style Stainless	37⅞	96.0
G	Height to top of door handles		
	Pro-Style® Stainless	42⅞	107.6
	Euro-Style Stainless	44⅞	114.0
H	Height of doors	52⅞	133.0
I	Space between doors and drawer	⅞	0.3
J	Height to top of drawer handle		
	Pro-Style® Stainless	19⅞	49.2
	Euro-Style Stainless	19¼	48.7
K	Height of drawer	20½	52.1
L	Height of bottom grille	3	7.6
M	Width of recessed refrigerator	35	88.9
N	Width from side of refrigerator to handle – door fully open 110°		
	Pro-Style® Stainless	7	17.8
	Euro-Style Stainless	6½	16.5
O	Width from side of refrigerator to handle – door open 90°		
	Pro-Style® Stainless	2	5.1
	Euro-Style Stainless	1½	3.9
P	Depth without door panel kit	24	61.0
Q	Depth with doors		
	Pro-Style® Stainless panel kit	24¾	62.9
	Euro-Style Stainless panel kit	24¾	62.9
	Custom panel (¾"/1.9 cm)	24¾	62.9
R	Depth with handles		
	Pro-Style® Stainless	27⅞	69.5
	Euro-Style Stainless	26⅞	68.3
S	Depth with doors open 90°	41	104.1

IMPORTANT: Dimensional specifications are provided for planning purposes only.

Do not make any cutouts based on this information. Refer to the Installation or Use & Care Guide before selecting cabinetry, verifying electrical/gas connections, making cutouts or beginning installation.

All Jenn-Air® appliances are appropriately UL, CUL or CSA approved.

36" FULLY INTEGRATED FRENCH DOOR REFRIGERATOR

(BASE UNIT REQUIRES SUITE-COORDINATING PANEL KIT OR CUSTOM PANELS AND HANDLES)

JF36NXXFXDE – 35 $\frac{3}{4}$ " x 83 $\frac{3}{8}$ " x 24" (without door/handles)

DIMENSIONS AS INSTALLED

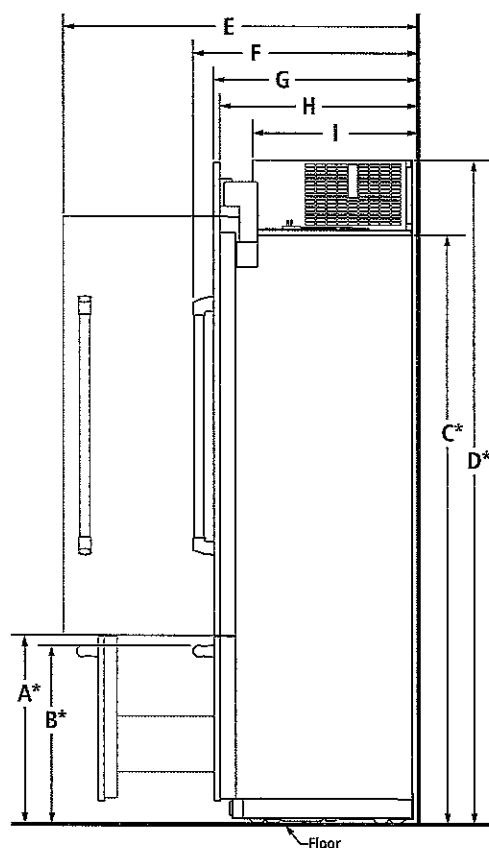

SIDE VIEW

MODEL #		JF36NXXFXDE	
		in	cm
A*	Height to top of drawer (min.)	23 $\frac{1}{2}$	59.7
B*	Height to top of drawer handle (min.)		
	Pro-Style® Stainless	22 $\frac{3}{8}$	56.8
	Euro-Style Stainless	22 $\frac{1}{4}$	56.3
C*	Height to top of doors (min.)	74 $\frac{3}{8}$	188.9
D*	Height to top of grille and bracket (min.)	83 $\frac{3}{8}$	211.1
E	Depth with door open 90° (min.)	41	104.1
	Depth with handles (min.)		
F	Pro-Style® Stainless	27 $\frac{3}{8}$	69.5
	Euro-Style Stainless	26 $\frac{7}{8}$	68.3
G	Depth with doors (min.)		
	Pro-Style® Stainless panel kit	24 $\frac{3}{4}$	62.9
	Euro-Style Stainless panel kit	24 $\frac{3}{4}$	62.9
	Custom panel (3/4"/1.9 cm)	24 $\frac{3}{4}$	62.9
H	Depth without door panel kit (min.)	24	61.0
I	Depth of compressor (min.)	19 $\frac{7}{8}$	50.5

*Add 1 $\frac{1}{4}$ " (3.2 cm) to the height dimension when leveling legs are fully extended.**IMPORTANT:** Dimensional specifications are provided for planning purposes only.

Do not make any cutouts based on this information. Refer to the Installation or Use & Care Guide before selecting cabinetry, verifying electrical/gas connections, making cutouts or beginning installation.

All Jenn-Air® appliances are appropriately UL, CUL or CSA approved.

36" FULLY INTEGRATED FRENCH DOOR REFRIGERATOR

(BASE UNIT REQUIRES SUITE-COORDINATING PANEL KIT OR CUSTOM PANELS AND HANDLES)

JF36NFXDE – 35¾" x 83⅛" x 24" (without door/handles)



3 STYLES FOR DOOR PANEL INSTALLATION

STANDARD INTEGRATED GRILLE INSTALLATION

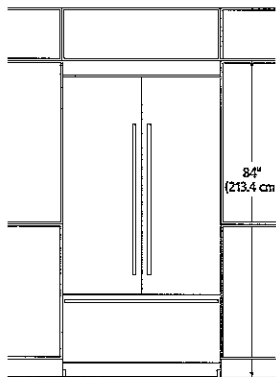

FRONT VIEW

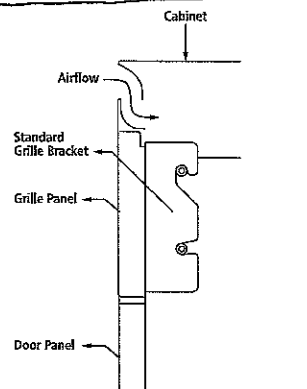
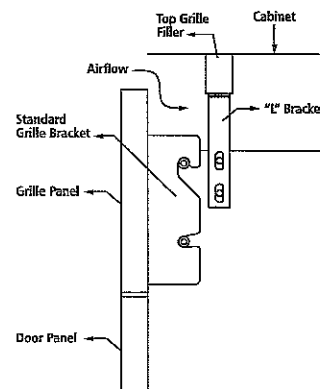
SIDE VIEW – STAINLESS STEEL
PANEL KIT

SIDE VIEW – CUSTOM PANEL

- Attach the standard custom grille with the standard grille bracket provided with the refrigerator.
- The standard grille panel height allows for an air gap critical to refrigerator performance.

FULLY INTEGRATED GRILLE INSTALLATION

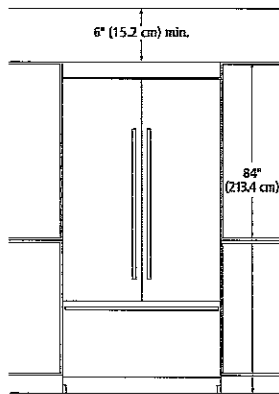
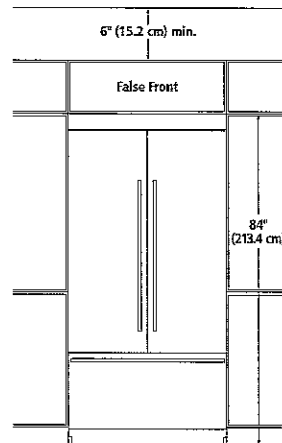
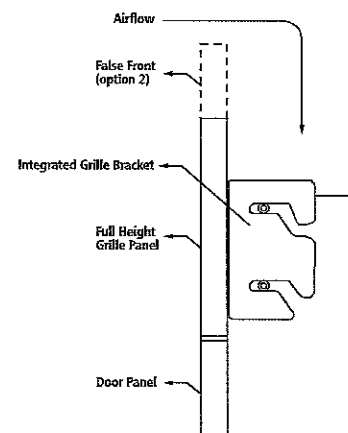
FRONT VIEW – OPEN TO CEILING
(OPTION 1)FRONT VIEW – FALSE FRONT
(OPTION 2)

SIDE VIEW – CUSTOM PANEL

- Attach the full-height grille with the integrated grille bracket provided with the refrigerator.
- Requires a minimum of 6" (15.2 cm) of open space above the refrigerator, which must not be blocked in any way, including soffits.

ARMOIRE-STYLE INSTALLATION*

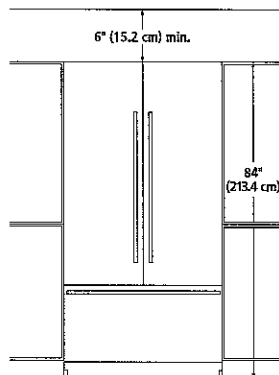
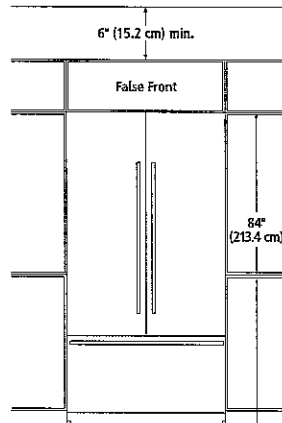
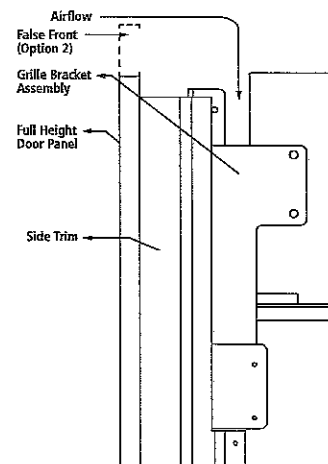
FRONT VIEW – OPEN TO CEILING
(OPTION 1)FRONT VIEW – FALSE FRONT
(OPTION 2)

SIDE VIEW – CUSTOM PANEL

- Attach the grille bracket assembly and grille panel provided in the armoire-style panel kit.
- Requires a minimum of 6" (15.2 cm) of open space above the refrigerator, which must not be blocked in any way, including soffits.

* Refer to the Armoire Kit installation instructions for additional dimensions and installation details.

IMPORTANT: Dimensional specifications are provided for planning purposes only.

Do not make any cutouts based on this information. Refer to the Installation or Use & Care Guide before selecting cabinetry, verifying electrical/gas connections, making cutouts or beginning installation. All Jenn-Air® appliances are appropriately UL, CUL or CSA approved.

36" FULLY INTEGRATED FRENCH DOOR REFRIGERATOR

(BASE UNIT REQUIRES SUITE-COORDINATING PANEL KIT OR CUSTOM PANELS AND HANDLES)

JF36NXFXDE – 35¾" x 83⅛" x 24" (without door/handles)

OPENING/CLEARANCE DIMENSIONS

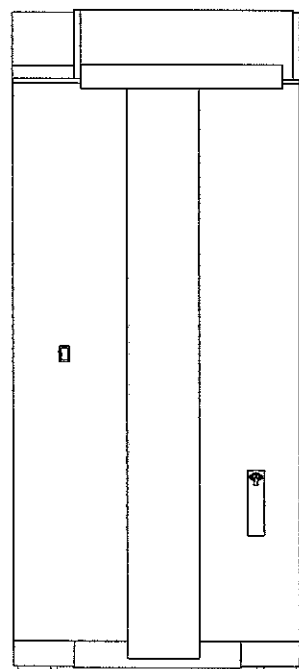
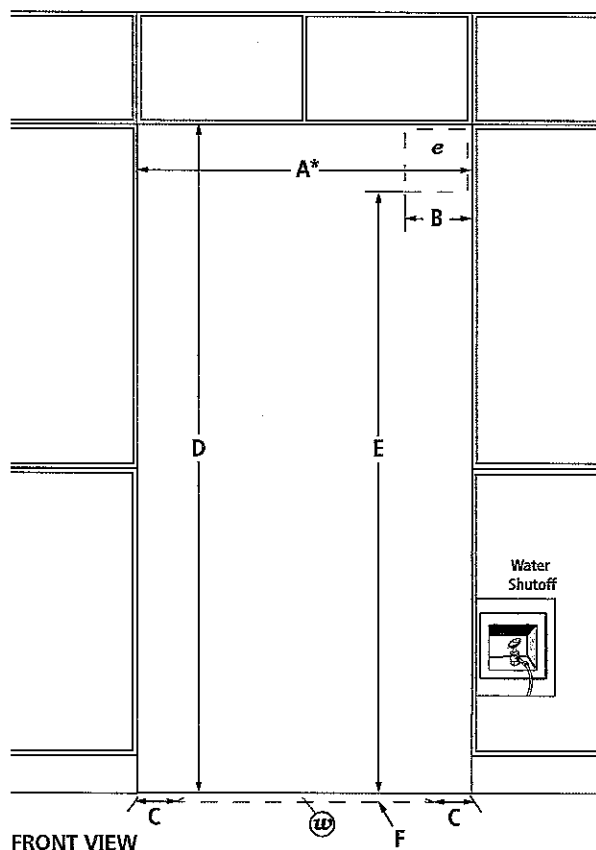

MODEL #	JF36NXFXDE	
	in	cm
A* Width (min.)	36	91.4
B Width of recommended electrical location	4	10.2
C Distance from side of cabinet to recommended water connection location	6	15.2
D Height (min.)	84	213.4
E Height to recommended electrical location	77	195.6
F Depth of recommended water connection location (max.)	1	2.5
e Recommended electrical connection location		
w Recommended water connection location		

*Minimum width must extend behind the face of the cabinet for at least 2" (5.1 cm).

ELECTRICAL REQUIREMENTS

115 volt, 60 Hz, AC only, 15- or 20-amp fused, grounded circuit is required. A dedicated circuit is recommended. Use an outlet that cannot be turned off by a switch. Do not use an extension cord.

WATER PRESSURE REQUIREMENTS

A cold water supply with water pressure between 30 and 120 psi (207 and 827 kPa) is required to operate the ice maker. Call a licensed, qualified plumber with any questions about the water pressure.

Reverse Osmosis Water Supply

IMPORTANT: The pressure of the water coming out of a reverse osmosis system going to the water inlet valve of the refrigerator needs to be between 30 and 120 psi (207 and 827 kPa).

If a reverse osmosis water filtration system is connected to the cold water supply, the water pressure to the reverse osmosis system needs to be a minimum of 40 to 60 psi (276 to 414 kPa).

LOCATION REQUIREMENTS

Floor must be able to support refrigerator (more than 600 lb [272 kg]), door panels and contents of the refrigerator and must be at the same level as flooring in the room.

IMPORTANT: Dimensional specifications are provided for planning purposes only.

Do not make any cutouts based on this information. Refer to the Installation or Use & Care Guide before selecting cabinetry, verifying electrical/gas connections, making cutouts or beginning installation.

All Jenn-Air® appliances are appropriately UL, CUL or CSA approved.

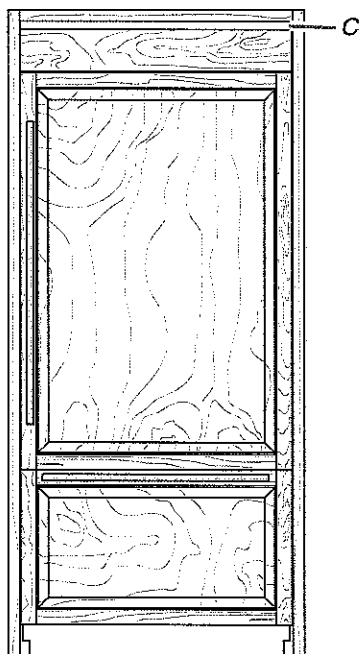

C. Airflow

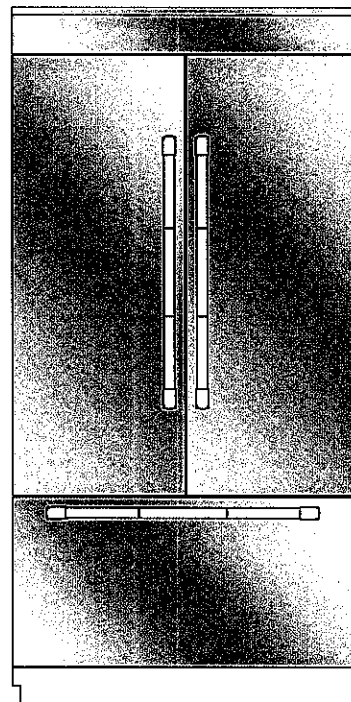

Stainless Steel Panel Kit Installation Requirements

See the "36" Single Door Models" or the "36" or 42" French Door Models" section to see the panel kit options available for your model.

IMPORTANT:

- A panel kit installation can be achieved with either a 24" (60.9 cm) or 25" (63.5 cm) deep opening.
- Refer to the instructions provided with the Stainless Steel Door Panel Kit to install the door panels and standard grille.
- The grille panel height, shown in the "Panel Kit Installation—Side View" graphic, allows for an air gap critical to refrigerator performance.

Panel Kit Installation—Side View

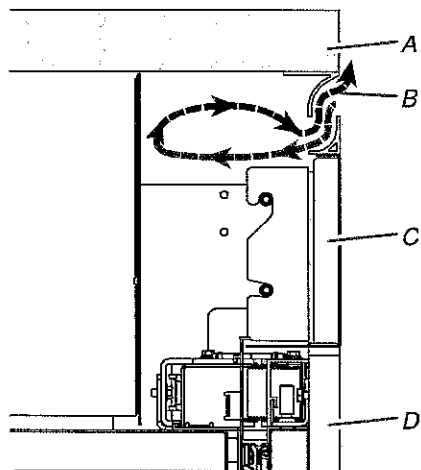

A. Soffit
B. Airflow

C. Grille panel
D. Door panel

Custom Wood Overlay Panel Requirements

Custom wood overlay panels allow you to blend the exterior of your refrigerator into the overall kitchen décor and to use custom handles for additional design flexibility.

In some cases, your cabinet manufacturer may choose to work with one panel routed for the different dimensions. Follow these panel dimension and placement instructions to be sure that the custom wood overlay panels will fit properly.

IMPORTANT:

- For 36" (91.4 cm) Single Door models, the refrigerator door wood overlay panel cannot exceed 60 lbs (27.2 kg) and the freezer drawer overlay panel cannot exceed 25 lbs (11.3 kg).
- For 36" French Door models, the refrigerator door wood overlay panel cannot exceed 38 lbs (17.2 kg) and the freezer drawer overlay panel cannot exceed 25 lbs (11.3 kg).
- For 42" (106.7 cm) French Door models, the refrigerator door wood overlay panel cannot exceed 38 lbs (17.2 kg) and the freezer drawer overlay panel cannot exceed 30 lbs (13.6 kg).
- The weight of the top grille wood overlay panel cannot exceed 7 lbs (3.2 kg) for both models.
- The required thickness for all panels is 3/4" (1.91 cm).
- This installation does not require filler or backer panels.

Custom Wood Overlay Panel Dimensions

36" (91.4 cm) Single Door Model—Door and Drawer Panels

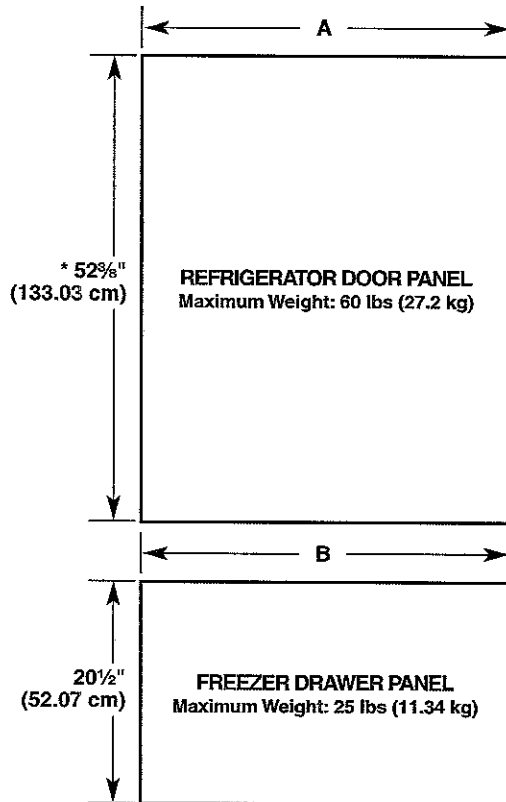

36" (91.4 cm) and 42" (106.7 cm) French Door Models—Door and Drawer Panels

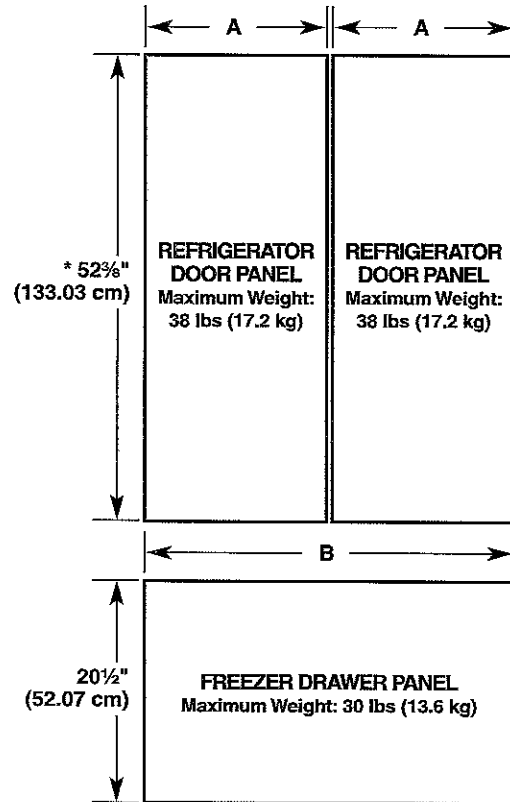

⚠ CAUTION

Pinch Hazard

Installation of door panels with less than a $\frac{3}{8}"$ (0.95 cm) gap between the door panel and the adjacent cabinet increases the risk of potential pinching.

⚠ CAUTION

Pinch Hazard

Installation of door panels with less than a $\frac{3}{8}"$ (0.95 cm) gap between the door panel and the adjacent cabinet increases the risk of potential pinching.

Model	36" Single Door Bottom Mount	
Reveal	$\frac{3}{8}"$	$\frac{1}{8}"$
A	$35\frac{1}{4}"$ (89.54 cm)	$35\frac{3}{4}"$ (90.81 cm)
B	$35\frac{1}{4}"$ (89.54 cm)	$35\frac{3}{4}"$ (90.81 cm)

Model	36" French Door Bottom Mount	
Reveal	$\frac{3}{8}"$	$\frac{1}{8}"$
A	$17\frac{9}{16}"$ (44.6 cm)	$17\frac{13}{16}"$ (45.2 cm)
B	$35\frac{1}{4}"$ (89.5 cm)	$35\frac{3}{4}"$ (90.8 cm)

*For Fully-integrated grille or Standard grille installations.

Model	42" French Door Bottom Mount	
Reveal	$\frac{3}{8}"$	$\frac{1}{8}"$
A	$20\frac{9}{16}"$ (52.23 cm)	$20\frac{13}{16}"$ (52.86 cm)
B	$41\frac{1}{4}"$ (104.78 cm)	$41\frac{3}{4}"$ (106.05 cm)

*For Fully-integrated grille or Standard grille installations.

Grille Panel

Fully-Integrated Installation—Full Height Grille—Open Soffit

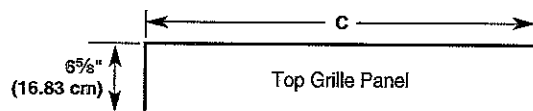

Model	36	42
Reveal	3/8"	1/8"
C	35 1/4" (89.54 cm)	35 3/4" (90.81 cm)
	41 1/4" (104.78 cm)	41 3/4" (106.05 cm)

Standard Integrated Grille Installation—Open or Closed Soffit

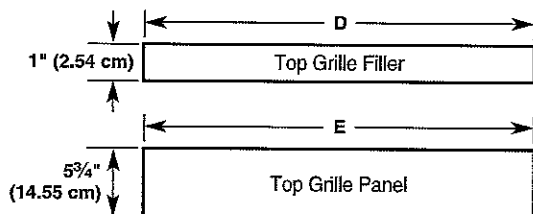

Model	36	42
Reveal	3/8"	1/8"
D	35 1/4" (89.54 cm)	35 3/4" (90.81 cm)
E	41 1/4" (104.78 cm)	41 3/4" (106.05 cm)

IMPORTANT: The grille panel height, shown in the "Standard Integrated Grille Installation" graphic, allows for an air gap critical to refrigerator performance.

Full-Height Door Installation - No Grille - Open Soffit

No grille is used in a full-height door installation. Use an Armoire kit to disguise the cooling system, located on the top of the refrigerator, which is visible when the doors are opened. See the instructions, provided with the Armoire kit, for installation details and custom wood overlay door dimensions.

INSTALLATION INSTRUCTIONS

Unpack the Refrigerator

⚠ WARNING



Tip Over Hazard

Refrigerator is top heavy and tips easily when not completely installed.

Keep doors taped closed until refrigerator is completely installed.

Use two or more people to move and install refrigerator.

Failure to do so can result in death or serious injury.

IMPORTANT:

- Do not remove the film covering until the refrigerator is in its operating location.
 - All four leveling legs must contact the floor to support and stabilize the full weight of the refrigerator.
 - Keep the cardboard shipping piece or plywood under the refrigerator until it is installed in the operating location.
1. Remove and save the literature package and hardware kit located inside the refrigerator. Remove and save the literature, grille, and trim taped to the outside of the refrigerator.

NOTE: Do not remove tape and door bracing until the refrigerator is in its final location.

30" COMBINATION MICROWAVE/WALL OVENS

JMW3430D, JMW2430D – 30" x 43¾" x 25⅝"

KG-16

PRODUCT DIMENSIONS

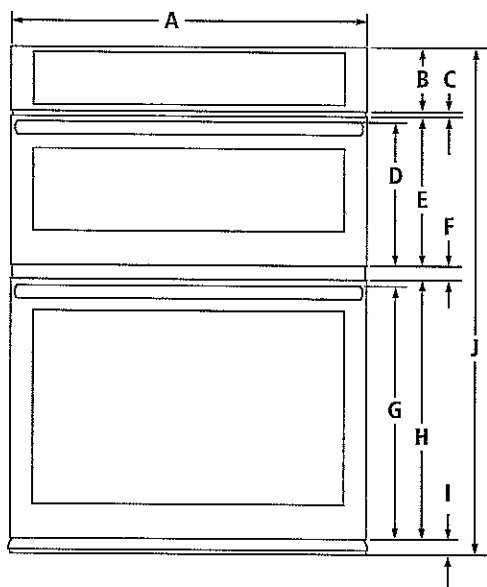

FRONT VIEW

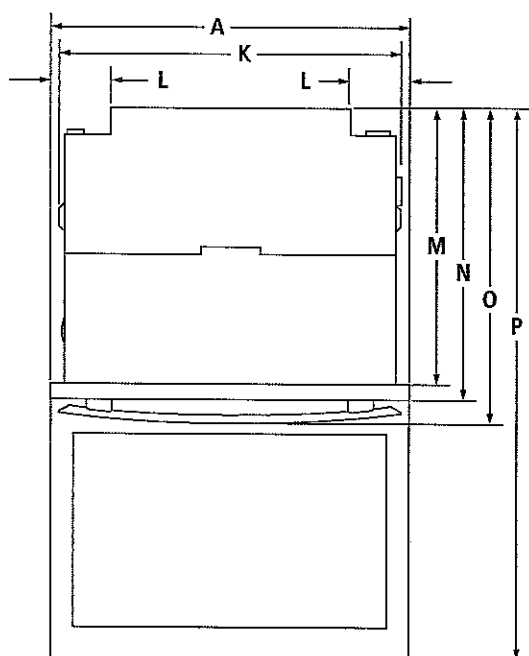

TOP VIEW

MODEL #		JMW3430D JMW2430D	
		in	cm
A	Overall width		
	Pro-Style® Stainless or Euro-Style Stainless	30	76.2
	Floating Glass	29⅛	76.1
B	Height of control panel	5½	14
C	Space between control panel and door	½	1.2
D	Height to top of microwave oven handle		
	Pro-Style® Stainless	12¾	31.0
	Euro-Style (color-coordinating)	12¾	31.0
E	Height of microwave oven door	12⅞	32.3
F	Space between doors	1⅞	2.9
G	Height to top of oven handle		
	Pro-Style® Stainless	21⅞	55.0
	Euro-Style (color-coordinating)	21⅞	54.4
H	Height of oven door	22⅞	56.2
I	Height of trim	1⅞	4.3
J	Overall height	43¾	111.1
K	Width of recessed oven	28⅞	72.2
L	Width of conduit channel	4⅞	12.5
M	Depth of recessed oven	23¼	59.0
N	Depth with doors	24¾	61.9
O	Depth with handles		
	Pro-Style® Stainless	26¾	67.0
	Euro-Style (color-coordinating)	25⅞	64.3
P	Depth with door fully open	45¾	115.3

STD installation

IMPORTANT: Dimensional specifications are provided for planning purposes only.

Do not make any cutouts based on this information. Refer to the Installation Guide before selecting cabinetry, verifying electrical/gas connections, making cutouts or beginning installation.

All Jenn-Air® appliances are appropriately UL, CUL or CSA approved.

30" COMBINATION MICROWAVE/WALL OVENS

JMW3430D, JMW2430D – 30" x 43³/₄" x 25⁵/₁₆"

KG-16

DIMENSIONS AS INSTALLED

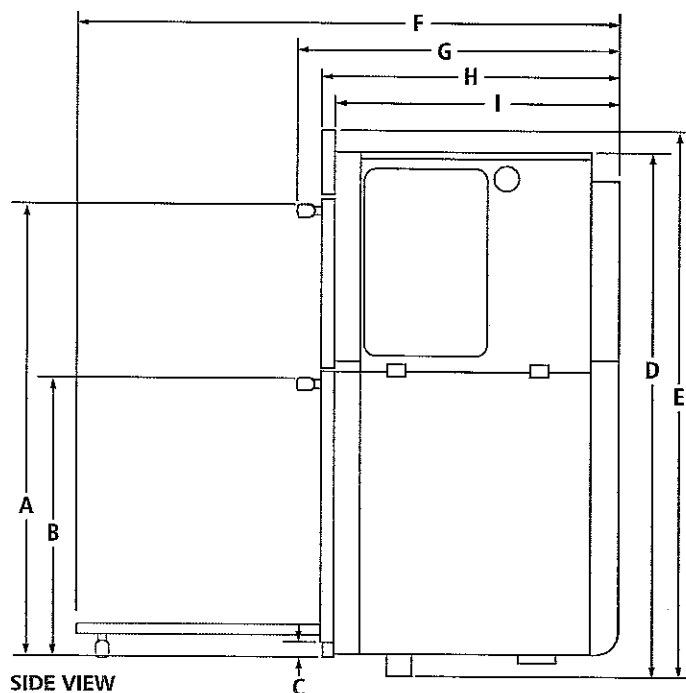

MODEL #		JMW3430D JMW2430D	
		in	cm
A	Height to top of upper handle Pro-Style® Stainless	36 ¹ / ₂	92.7
	Euro-Style (color-coordinating)	36 ¹ / ₂	92.7
B	Height to top of lower handle Pro-Style® Stainless	23 ³ / ₈	59.3
	Euro-Style (color-coordinating)	23 ¹ / ₈	58.7
C	Height of trim extending below cutout	1 ¹ / ₁₆	4.3
D	Height of recessed oven	41	104.2
E	Height to top of control panel	43 ³ / ₄	111.1
F	Depth with door fully open	45 ³ / ₈	115.3
G	Depth with handles Pro-Style® Stainless	26 ³ / ₈	67.0
	Euro-Style (color-coordinating)	25 ⁵ / ₁₆	64.3
H	Depth with doors	24 ³ / ₈	61.9
I	Depth of recessed oven	23 ¹ / ₄	59.0

IMPORTANT: Dimensional specifications are provided for planning purposes only.

Do not make any cutouts based on this information. Refer to the Installation Guide *before* selecting cabinetry, verifying electrical/gas connections, making cutouts or beginning installation. All Jenn-Air® appliances are appropriately UL, CUL or CSA approved.

30" COMBINATION MICROWAVE/WALL OVENS

JMW3430D, JMW2430D – 30" x 43³/₄" x 25⁵/₁₆"

KG-16

OPENING/CLEARANCE DIMENSIONS

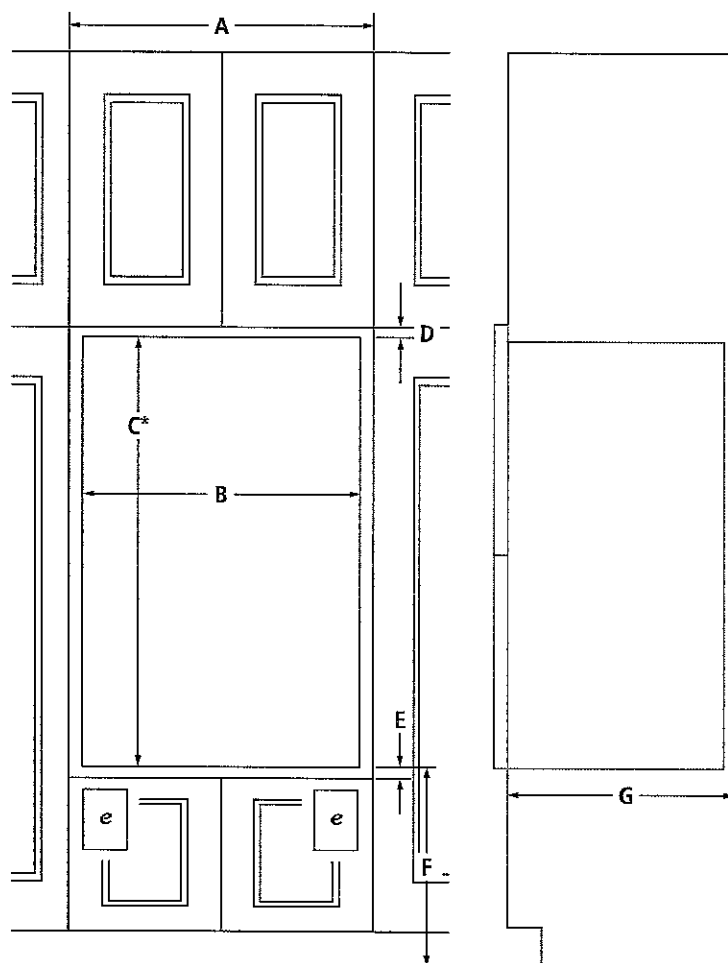

FRONT VIEW

SIDE VIEW

MODEL #		JMW3430D JMW2430D	
		in	cm
A	Width of cabinet (min.)	30	76.2
B	Width of cutout	28 ¹ / ₂	72.4
C*	Height of cutout (recommended)	41 ⁵ / ₁₆	104.9
D	Top of cutout to bottom of upper cabinet door (min.)	2 ¹ / ₄	5.7
E	Bottom of cutout to top of lower cabinet door (min.)	1 ¹ / ₂	3.8
F	Bottom of cutout to floor	4-19 ¹ / ₄	10.2-48.9
G	Depth of cutout (min.)	24	61.0
e	Recommended junction box location		

* Will fit cutout height from 41" (104.1 cm) to 41¹/₂" (105.4 cm).

ELECTRICAL REQUIREMENTS

240 volt, 40-amp fused, grounded circuit is required. A dedicated circuit is required.

The length of conduit provided is for serviceability. Do not cut the conduit. The junction box should be located 3" (7.6 cm) maximum below the support surface. Drill a 1" (2.5 cm) minimum diameter hole in the right rear or left rear corner of the support surface for access to the junction box.

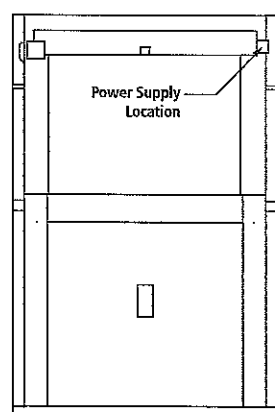

BACK VIEW

STD installation

IMPORTANT: Dimensional specifications are provided for planning purposes only.

Do not make any cutouts based on this information. Refer to the Installation Guide *before* selecting cabinetry, verifying electrical/gas connections, making cutouts or beginning installation. All Jenn-Air® appliances are appropriately UL, CUL or CSA approved.

30" COMBINATION MICROWAVE/WALL OVENS – FLUSH INSTALLATION

JMW3430D, JMW2430D – 30" x 43 $\frac{3}{4}$ " x 24 $\frac{3}{8}$ " (depth without handles)

OPENING/CLEARANCE DIMENSIONS

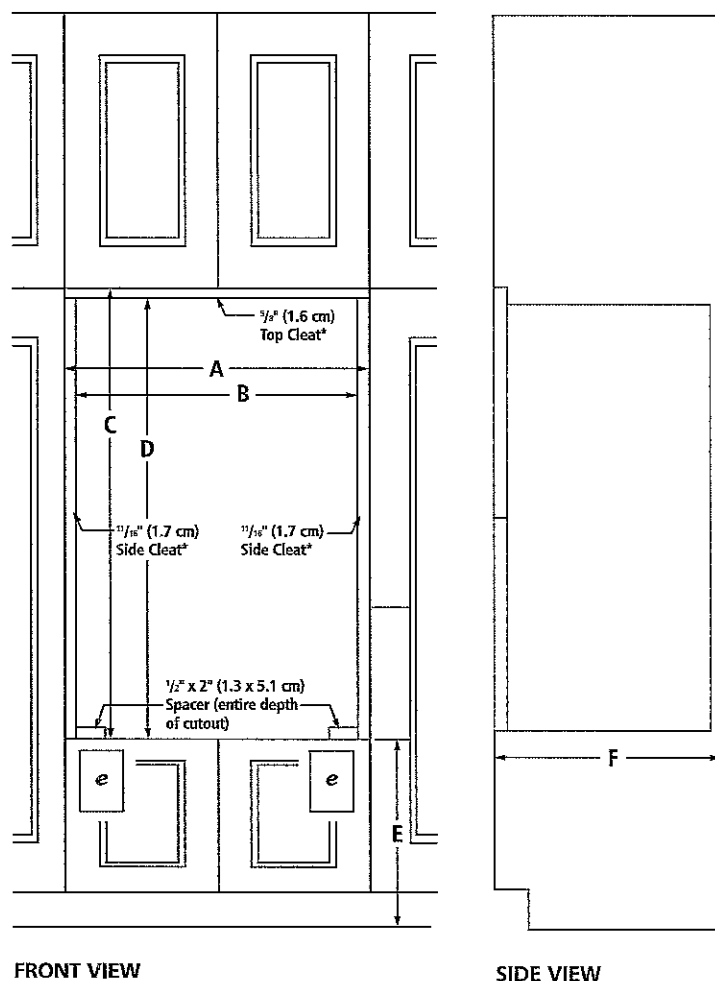

FRONT VIEW

SIDE VIEW

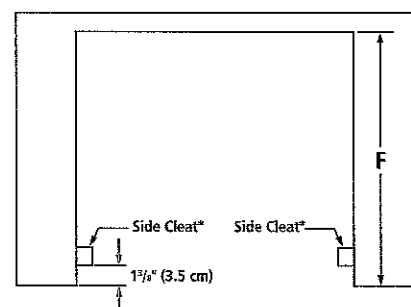

TOP VIEW

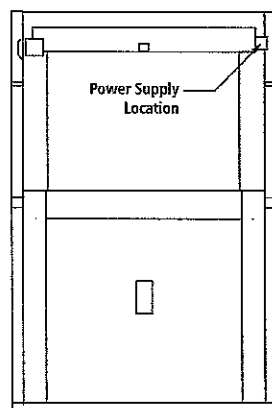

BACK VIEW

* Cleats and spacers must be recessed 1 $\frac{3}{8}$ " (3.5 cm) from the front of the cabinet.

MODEL #		JMW3430D JMW2430D	
		in	cm
A	Width of flush inset cutout (min.)	30 $\frac{3}{4}$	76.8
B	Width of opening (min.)	28 $\frac{7}{8}$	73.3
C	Height of flush inset cutout (min.)	44 $\frac{5}{16}$	112.5
D	Height of opening (min.)	43 $\frac{11}{16}$	110.9
E	Bottom of cutout to floor	4 $\frac{5}{8}$ – 19 $\frac{1}{4}$	11.7– 48.9
F	Depth of cutout (min.)	25	63.5
e	Recommended junction box location		

ELECTRICAL REQUIREMENTS

* 240 volt, 40-amp fused, grounded circuit is required. A dedicated circuit is required.

The length of conduit provided is for serviceability. Do not cut the conduit. The junction box should be located 3" (7.6 cm) maximum below the support surface. Drill a 1" (2.5 cm) minimum diameter hole in the right rear or left rear corner of the support surface for access to the junction box.

FLUSH INSTALLATION REQUIREMENTS

A 25" (63.5 cm) minimum cutout depth is required.

These dimensions will result in a 1/4" (0.6 cm) reveal on the top, a 1/4" (0.6 cm) reveal on the sides and a 1/8" (0.3 cm) reveal on the bottom of the wall oven.

The front face of the cleats and spacers will be visible and should be treated as a finished surface.

IMPORTANT: Dimensional specifications are provided for planning purposes only. Do not make any cutouts based on this information. Refer to the Installation Guide before selecting cabinetry, verifying electrical/gas connections, making cutouts or beginning installation. All Jenn-Air® appliances are appropriately UL, CUL or CSA approved.

INSTALLATION INSTRUCTIONS 24" (59.5 CM) BUILT-IN COFFEE SYSTEM

INSTRUCTIONS D'INSTALLATION SYSTÈME INFUSEUR À CAFÉ INTÉGRÉ DE 24" (59,5 CM)

Table of Contents/Table des matières

BUILT-IN COFFEE SYSTEM SAFETY	1	SÉCURITÉ DU SYSTÈME INFUSEUR À CAFÉ INTÉGRÉ.....	7
INSTALLATION REQUIREMENTS	2	EXIGENCES D'INSTALLATION	8
Tools and Parts	2	Outillage et pièces.....	8
Location Requirements	2	Exigences d'emplacement.....	8
Electrical Requirements	3	Spécifications électriques	9
INSTALLATION INSTRUCTIONS	4	INSTRUCTIONS D'INSTALLATION.....	10
Install the Mounting Brackets	4	Installation des platines de montage	10
Install the Coffee System	5	Installation du système infuseur à café.....	11
Complete Installation	6	Achever l'installation	12

BUILT-IN COFFEE SYSTEM SAFETY

Your safety and the safety of others are very important.

We have provided many important safety messages in this manual and on your appliance. Always read and obey all safety messages.



This is the safety alert symbol.

This symbol alerts you to potential hazards that can kill or hurt you and others.

All safety messages will follow the safety alert symbol and either the word "DANGER" or "WARNING."

These words mean:

⚠ DANGER

You can be killed or seriously injured if you don't immediately follow instructions.

⚠ WARNING

You can be killed or seriously injured if you don't follow instructions.

All safety messages will tell you what the potential hazard is, tell you how to reduce the chance of injury, and tell you what can happen if the instructions are not followed.

IMPORTANT:

Save for local electrical inspector's use.

IMPORTANT :

À conserver pour consultation par l'inspecteur local des installations électriques.

INSTALLATION REQUIREMENTS

KG-16

*

Tools and Parts

Tools Needed

Gather the required tools and parts before starting installation. Read and follow the instructions provided with any tools listed here.

- Measuring tape
- Pencil
- Level
- Masking tape
- T20[®] Torx[®] screwdriver
- Drill
- $\frac{5}{64}$ " (2 mm) drill bit

Parts Supplied

All of the following parts are provided, but some parts may not be used. The location of your coffee system installation will determine which parts you will use.

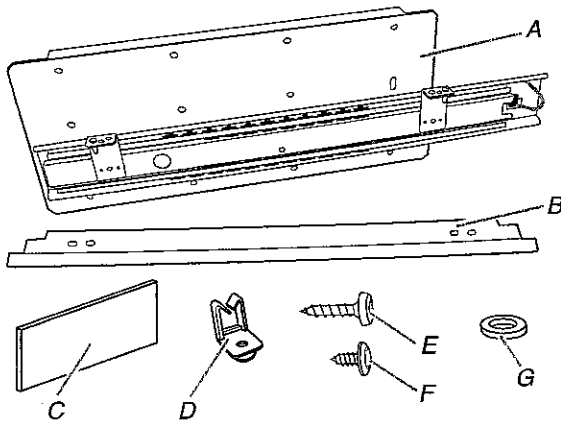

- A. Mounting brackets/runners (2)
- B. Metal trim piece (1)
- C. Bracket spacers (4) (2 - 1 mm thick; 2 - 2 mm thick)
- D. Power supply cord clip (1)
- E. 4.5 x 16 mm T20 screws (19)
- F. 4.2 x 9.5 mm T20 screws (4)
- G. Leveling spacers (8)

Location Requirements

IMPORTANT: Observe all governing codes and ordinances.

- Cabinet opening dimensions that are shown must be used. Given dimensions provide minimum clearance with coffee system.
- The built-in coffee system must be installed in cabinetry with the dimensions provided.
- Follow the installation instructions for any cabinetry used to house the built-in coffee system. Make sure cabinet is securely attached to the wall.
- Follow the installation instructions
- Recessed installation area must provide complete enclosure around the recessed portion of the coffee system.
- Grounded electrical supply is required. See "Electrical Requirements" section.

- Refer to installation instructions for cutout dimensions for any appliances installed above or below the built-in coffee system.

- **IMPORTANT:** To avoid damage to your cabinets, check with your builder or cabinet supplier to make sure that the materials used will not discolor, delaminate or sustain other damage. This coffee system has been designed in accordance with the requirements of UL and CSA International and complies with the maximum allowable wood cabinet temperature of 194°F (90°C).

Product Dimensions

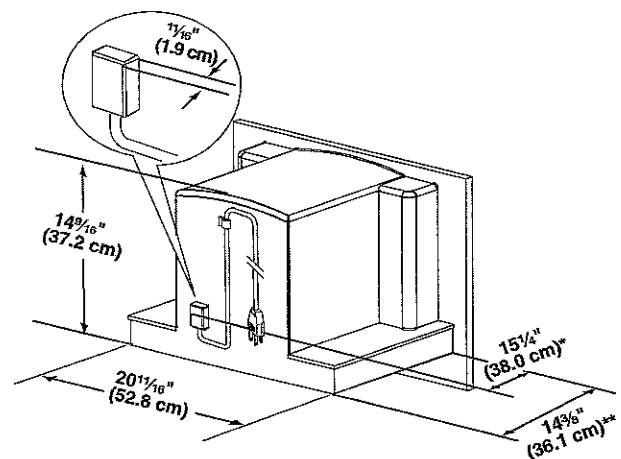
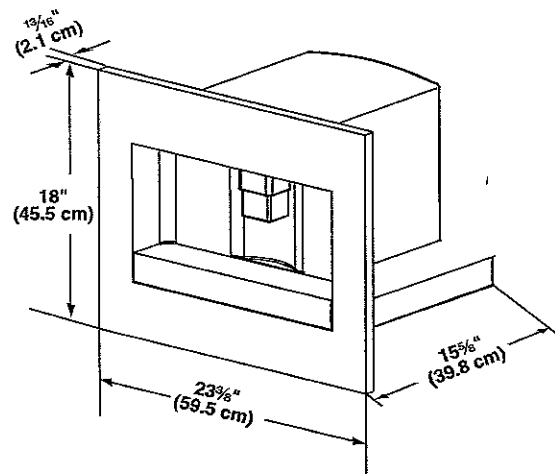

*From front of coffee system cavity to back of electrical box.

**From front corner to rear corner of coffee system cavity.

* STD installation

Cabinet Dimensions

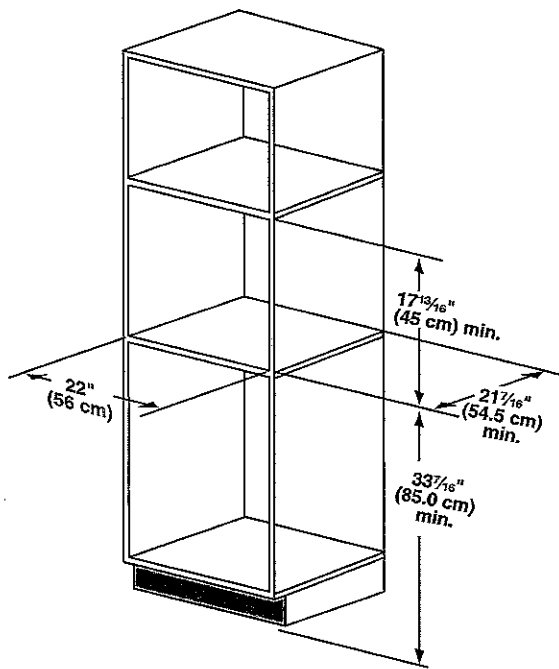

Cutout Top View

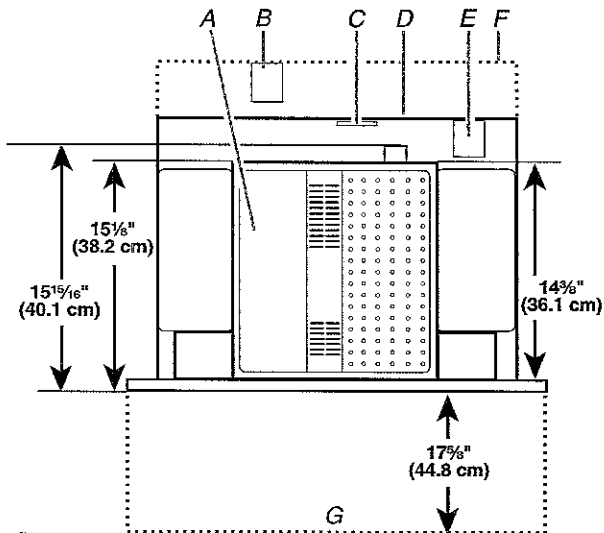

- A. Coffee system
- B. Non-flush receptacle
- C. Flush receptacle
- D. Back of cabinet
- E. Non-flush receptacle located in upper right or upper left corner
- F. Wall behind cabinet
- G. Coffee system with runners fully extended

Electrical Requirements

KG-16

⚠ WARNING



Electrical Shock Hazard

Plug into a grounded 3 prong outlet.

Do not remove ground prong.

Do not use an adapter.

Do not use an extension cord.

Failure to follow these instructions can result in death, fire, or electrical shock.

IMPORTANT: The coffee system must be electrically grounded in accordance with local codes and ordinances, or in the absence of local codes, with the National Electrical Code, ANSI/NFPA 70 or Canadian Electrical Code, CSA C22.1.

If codes permit and a separate ground wire is used, it is recommended that a qualified electrical installer determine that the ground path is adequate.

A copy of the above code standards can be obtained from:

National Fire Protection Association
1 Batterymarch Park
Quincy, MA 02169-7471

CSA International
8501 East Pleasant Valley Road
Cleveland, OH 44131-5575

- A 120 volt, 60 Hz., AC only, 15-amp fused, electrical circuit is required. A time-delay fuse or circuit breaker is also recommended. It is recommended that a separate circuit serving only this coffee system be provided.
- Check that the outlet provides 120-volt power and is correctly grounded.

Install the Mounting Brackets

1. Determine where the mounting brackets will be installed and mark 8 holes through each mounting bracket onto the side cabinet.

IMPORTANT: The front of the mounting bracket must be flush with the outside of the cabinet frame.

NOTE: To accommodate for flush installation with certain custom cabinets, align the front of the mounting brackets $1\frac{3}{16}$ " (2.1 cm) back from the front of the cabinet.

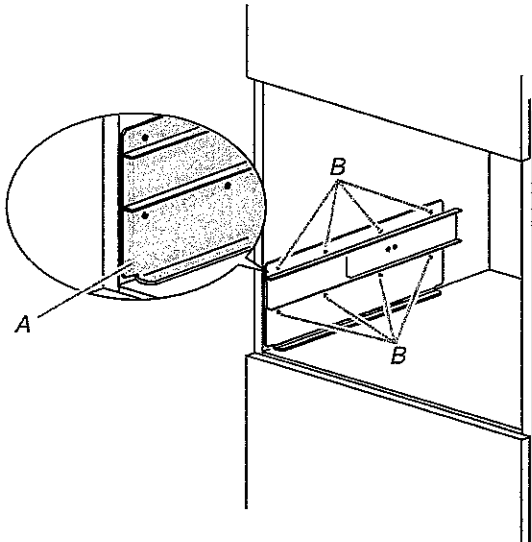

A. Front of mounting bracket flush with outside of cabinet frame
B. Mark 8 screw holes.

2. With the mounting brackets held or taped in place, measure the distance between the two brackets. (Do not measure between the runners.) The distance should be $21\frac{1}{16}$ " (55.1 cm).

NOTE: If the distance between the mounting brackets is greater than $21\frac{1}{16}$ " (55.1 cm), bracket spacers will need to be used. Two 2 mm bracket spacers and two 1 mm bracket spacers are included. See Step 3.

3. **If bracket spacers are needed:** Position the necessary spacer(s) behind the mounting brackets. Continue with Step 4.

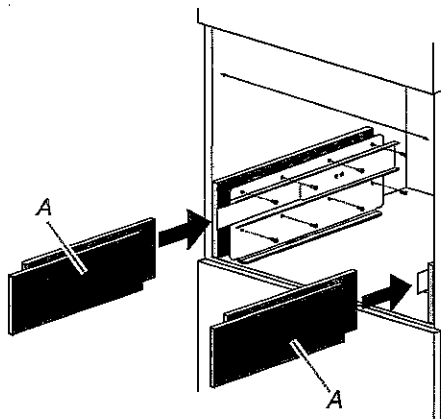

A. Bracket spacers

4. Using a 2 mm drill, drill the holes marked in Step 1.
5. Secure the mounting brackets to the side cabinets with eight 4.5 x 16 mm screws in each bracket.
6. Remove the tape holding the brackets in place.
7. Pull the runners forward until they are fully extended and in the locked position. Place level across the runners and check levelness. Then place the level along the length of each runner and check levelness from front to back. If the runners are not level, uninstall the mounting brackets and raise or lower the mounting brackets as necessary until they are level.

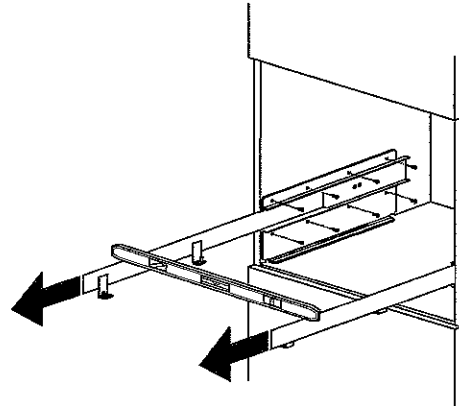

8. If the coffee system is being installed above a wooden cabinet bottom, use two 4.5 x 16 mm screws to install the metal trim piece at the front edge of the cabinet bottom.

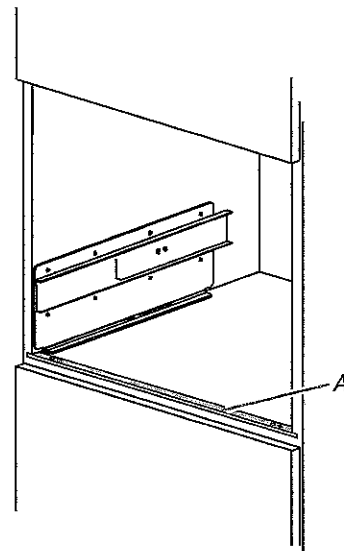

A. Metal trim piece

Install the Coffee System

KG-16

⚠ WARNING

Excessive Weight Hazard

Use two or more people to move and install the built-in coffee system.

Failure to do so can result in back or other injury.

1. Pull the runners forward until they are fully extended and in the locked position.
2. Using 2 or more people, position the coffee system onto the runners, making sure that the 4 pins of the L-brackets fit securely inside the holes on the bottom of the coffee system.

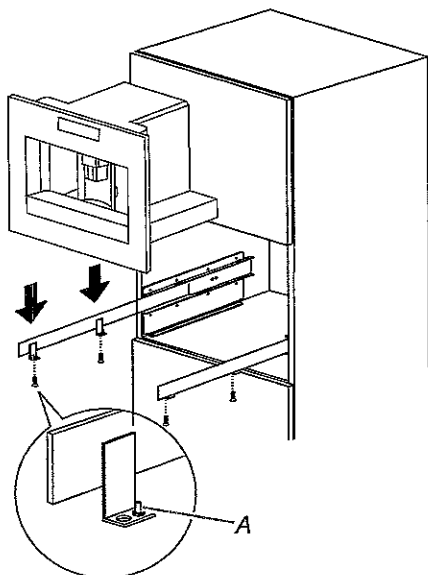

A. Pins

3. Place the level on top of the coffee system and check levelness of the coffee system, first side to side; then front to back.

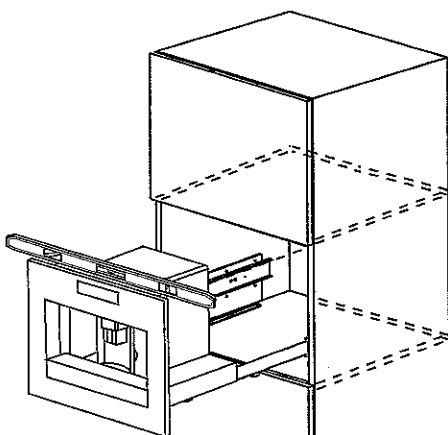

4. If the coffee system is not level: Using 2 or more people, remove the coffee system from the runners. Add the necessary leveling spacers over the pins to help level the coffee system.

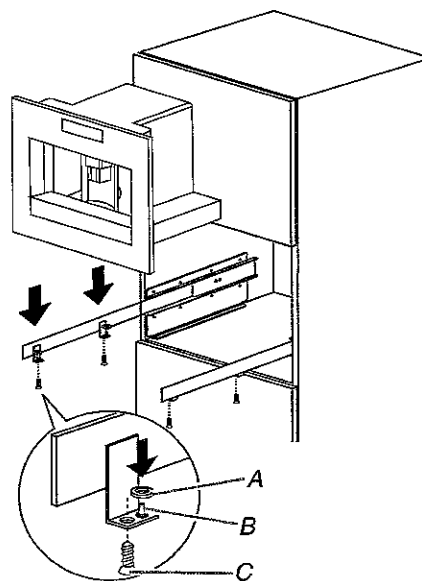

A. Leveling spacers

B. Pins

C. Screws

5. Using 2 or more people, position the coffee system onto the runners, making sure that the 4 pins of the L-brackets fit securely inside the holes on the bottom of the coffee system.
6. Check that the coffee system is level. If it is not level, repeat steps 4 and 5. If it is level, secure the coffee system to the L-brackets with the four 4.2 x 9.5 mm screws.
7. Position the power supply cord clip on the top of the cabinet, approximately 14" (35.6 cm) from the front of the cabinet and centered from left to right. With a pencil, mark the hole through the clip on the top of the cabinet.
8. Using a 2 mm drill, drill the hole marked in Step 7.
9. Using one 4.5 x 16 mm screw, attach the power supply cord clip to the top of the cabinet.

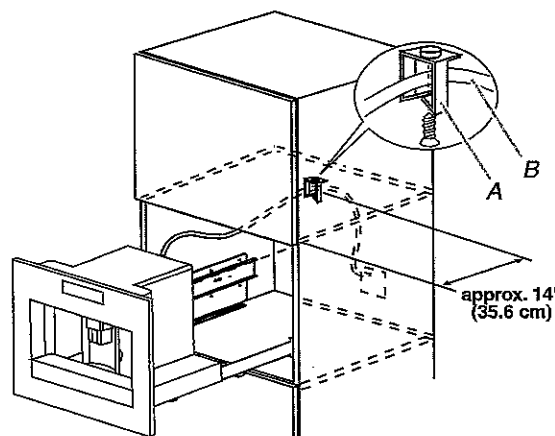

A. Power supply cord clip

B. Power supply cord

10. Secure the power supply cord with the power supply cord clip. Make sure there is enough slack in the power supply cord to allow the coffee system to be pulled completely from the cabinet in order to fill the coffee bean container.

⚠ WARNING



Electrical Shock Hazard

Plug into a grounded 3 prong outlet.

Do not remove ground prong.

Do not use an adapter.

Do not use an extension cord.

Failure to follow these instructions can result in death, fire, or electrical shock.

11. Plug the coffee system into a grounded 3-prong outlet.
12. Push the coffee system back into the housing.
13. Proceed to "Complete Installation" section.

Complete Installation

1. Prepare your coffee system for use by following the directions in "Before Using the Coffee System" in the Use and Care Guide. Then test the coffee system by using one of the coffee system functions.
2. If the coffee system does not operate:
 - Check that a household fuse has not blown, or a circuit breaker tripped. Replace the fuse or reset the circuit breaker. If the problem continues, call an electrician.
 - Check that the power supply cord is plugged into a grounded 3 prong outlet.
 - See the Use and Care Guide for troubleshooting information.

Installation is now complete.

Save these Installation Instructions for future use.

If you need Assistance or Service:

Please reference the "Assistance or Service" section of the Use and Care Guide, or contact the dealer from whom you purchased your coffee system.

KG-16

24" Marvel Beverage Center with Two 60/40 Split Convertible Shelves™

Model # ML24BCG1**



Certified to meet
ENERGY STAR® requirements

- Dynamic Cooling Technology™ delivers rapid cooldown and the industry's best temperature stability
- 60/40 Split Convertible Shelf™— cantilevered glass shelving, wine rack with a Vibration Neutralization System™ or both configurations all in one
- Rollout wine storage
- Solid, black-stained maple shelf fronts (natural maple shelf accessories available)
- MARVEL Intuit™ Integrated Controls ensure precise temperature management from 34°F to 42°F
- Thermal-efficient cabinet ensures optimum food preservation and energy efficiency while maximizing capacity
- Tinted, UV-resistant dual pane glass door protects wine from damaging ultra-violet light
- Two-stage, soft white theatre-style LED lighting and midnight black interior
- Cantilevered, fully adjustable shelving system
- Close Door Assist System™ gently and automatically closes door
- Audible and visual alarms signal when door is left ajar to protect food integrity and energy use
- Vacation/Sabbath mode conserves energy during times when the unit is not in use and complies with Star-K requirements
- Height adjustment up to 1" with leveling legs
- 4" black adjustable toe kick
- 1-year warranty



Storage Capacity

Up to (162) 12-oz cans or (18) wine bottles

Storage Configuration

- (2) cantilevered, full-width 60/40 Split Convertible Shelf™ black steel-framed glass shelf
- (1) roller-glide 4-bottle wine rack

Product Dimensions

23⅞" W x 33¾" minimum H x 25⅞" D (including handle)

Finish/Door Options

Ordering Details	
Stainless Frame Glass Door, Right Hinge	ML24BCG1RS
Stainless Frame Glass Door, Left Hinge	ML24BCG1LS
Panel Overlay Frame Glass Door Integrated Right Hinge	ML24BCF2RP
Panel Overlay Frame Glass Door Integrated Left Hinge	ML24BCF2LP
Panel Overlay Frame Glass Door Integrated Right Hinge	ML24BCP2RP
Panel Overlay Frame Glass Door Integrated Left Hinge	ML24BCP2LP

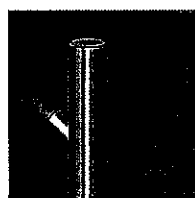

Stainless Steel

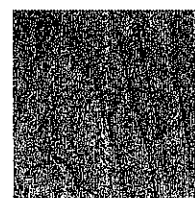

Wood Overlay
(Panel Ready)

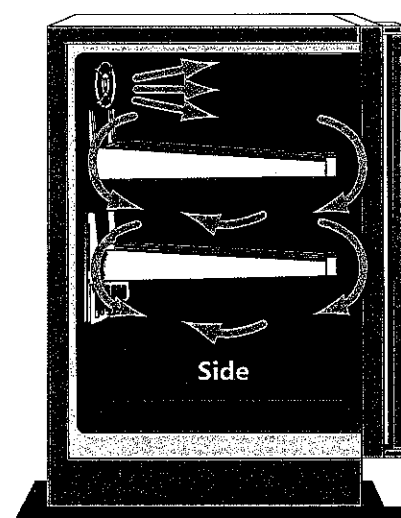
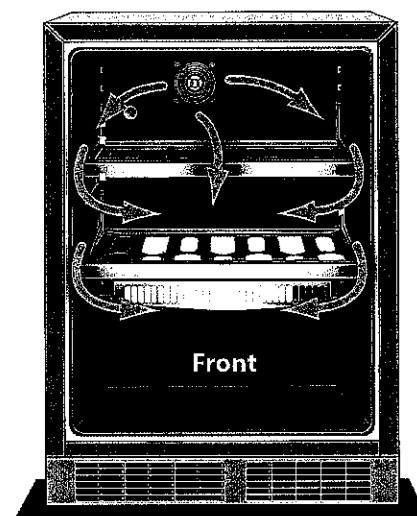
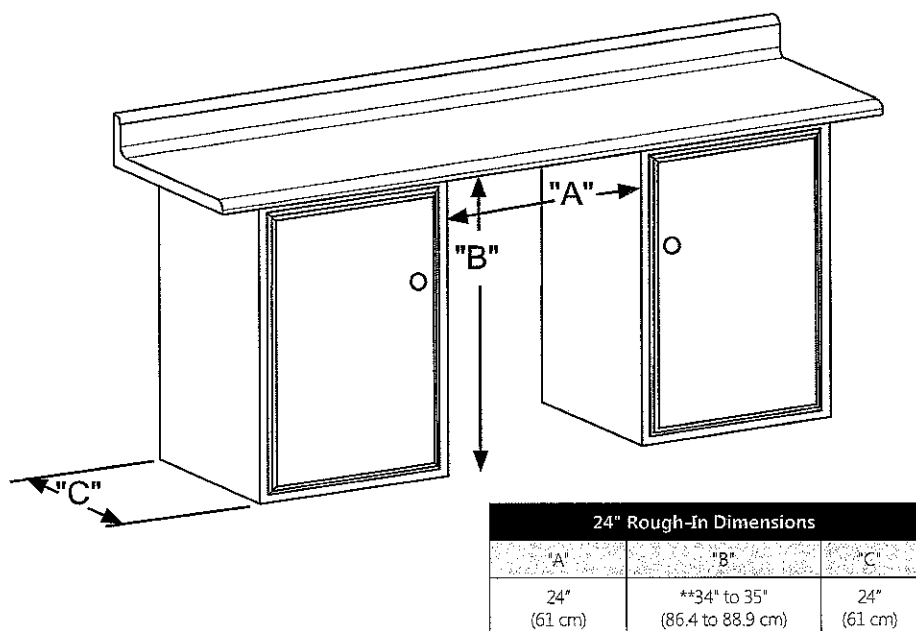

Cabinet Dimensions		
"D"	"E"	"F"
23 7/8" (60.7 cm)	33 3/4" to 34 3/4" (85.7 to 88.3 cm)	23 23/32" (60.2 cm)
"G"	"H"	"J"
25 21/32" (65.2 cm)	46 13/32" (117.9 cm)	25 11/16" (65.2 cm)

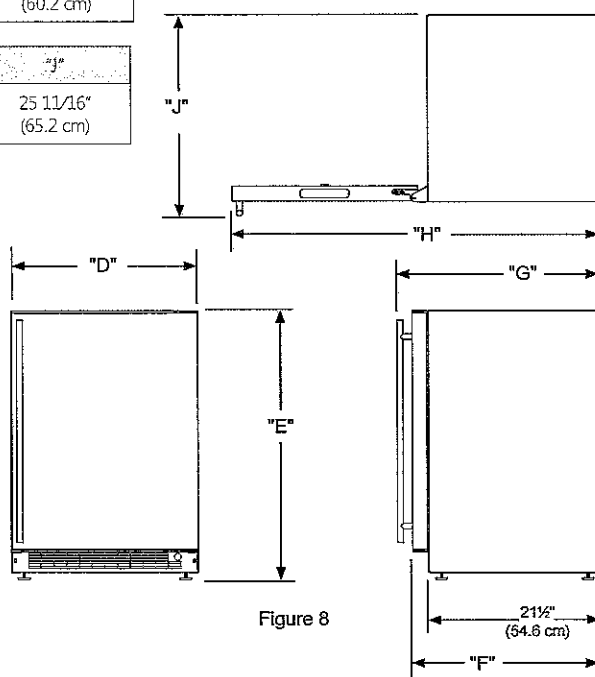

Dynamic Cooling Technology™ delivers rapid cool down and the industry's best temperature stability

The distinctive Marvel design features a thermal-efficient cabinet and door combined with Dynamic Cooling Technology™ for superior temperature stability, faster cooling times and speedy temperature recovery even with high frequency.

Width	23 7/8"
Interior Finish	Black
Capacity	Up to 18 wine bottles or up to 162 12-oz cans
Shelving System	Canilever
Shelf Fronts	Black painted maple
Other Storage	NA
Interior Lighting	2 White LED Pods
Toe Grill Finish	Black
Hinge	Classic Hinge
Handle	Designer

Control Type	Intuit™
Temperature Range	34° - 42° F
Lock	NA
Electrical Requirements	120V / 60Hz / 15A
Length of Power Cord	5'
Product Dimensions	23 7/8" W x 33 3/4" H x 21 1/2" D
Depth to Front of Door	23 23/32"
Depth to Handle	25 21/32"
Depth with door at 90°	46 13/32"
Shipping Weight	160 lbs

Finishes	SS, O
Vacation / Sabbath Mode	Yes
Agency Approvals	CSA
Energy Star Certified	

Finishes Key

SS = Stainless Steel

O = Overlay

36" (914) Sealed Burner Rangetops

MODELS SRT366 / SRT364C / SRT364G

KG-16.

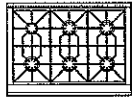

Model SRT366

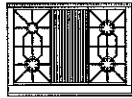

Model SRT364C

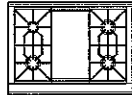

Model SRT364G

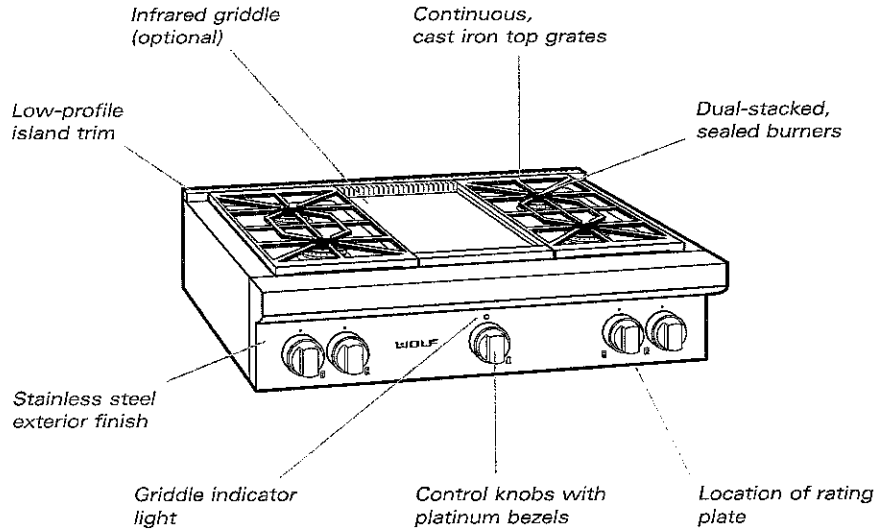

Model SRT364G shown

This appliance is certified by Star-K to meet strict religious regulations in conjunction with specific instructions found on www.star-k.org.

► The Wolf 36" (914) sealed burner rangetop is available in natural or LP gas, with your choice of three top configurations. Model numbers indicate the rangetop features; (C) charbroiler and (G) griddle. The model number followed by (-LP) denotes an LP gas model.

There's a good reason why professional chefs choose gas cooking; control. The patented, dual-stacked sealed gas burners of our new sealed burner rangetop take control to a new level. Two levels, really. The upper-tier burner delivers maximum heat transfer at higher settings; the lower-tier continuous flame ably handles the subtleties of simmering and melting.

Patented features along with the Wolf exclusive infrared charbroiler and infrared griddle ensure this rangetop stands out from the rest in performance and also beauty.

Let Wolf, the corporate companion and kitchen soul mate of Sub-Zero, fuel your passion for cooking and kitchen design.

36" (914) Sealed Burner Rangetops

MODELS SRT366 / SRT364C / SRT364G

KG-16

FEATURES

- ▶ Natural or LP gas models
- ▶ Classic stainless steel exterior finish with island trim
- ▶ Distinctive red or black control knobs
- ▶ Platinum bezels surround all knobs—chrome or brass bezels optional
- ▶ Porcelain-coated cast iron continuous top grates
- ▶ Optional infrared charbroiler and infrared griddle configurations
- ▶ Dual-stacked, sealed surface burners, all with simmer capabilities and automatic reignition at all settings
- ▶ 15,000 Btu/hr (4.4 kW) burners with 950 Btu/hr (.3 kW) delivered at simmer
- ▶ 9,200 Btu/hr (2.7 kW) burner with 325 Btu/hr (.1 kW) delivered at simmer and melt feature
- ▶ Certified by Star-K to meet religious regulations
- ▶ CSA certified for US and Canada
- ▶ Two and five year residential warranty—exclusions apply; warranty information can be found on our website, wolfappliance.com

OVERALL DIMENSIONS ▼

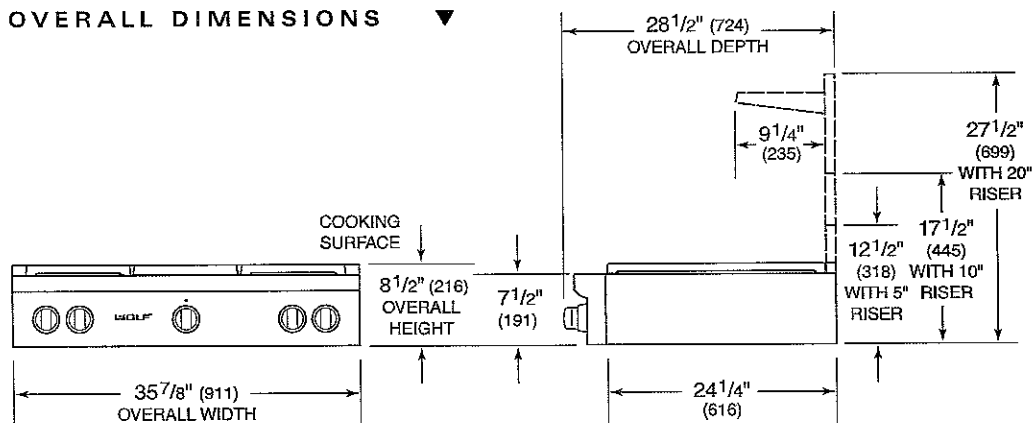

Dimensions may vary by $\pm 1/8"$ (3).

Dimensions in parentheses are in millimeters unless otherwise specified.

36" (914) Sealed Burner Rangetops

MODELS SRT366 / SRT364C / SRT364G

KG-16

MODEL OPTIONS ▼

Six Burners	SRT366
Four Burners/Charbroiler	SRT364C
Four Burners/Griddle	SRT364G

Natural gas model listed, for LP gas add (-LP) to the model number.

VENTILATION OPTIONS

- ▶ 36" (914) Pro wall hood or liner
- ▶ 42" (1067) Pro wall or island hood

Refer to the Wolf Pro Ventilation section of our website, wolfappliance.com for additional information.

ACCESSORIES

- ▶ 5" (127) or 10" (254) classic stainless steel riser
- ▶ 20" (508) classic stainless steel riser with shelf
- ▶ Black control knobs
- ▶ Chrome or brass bezels
- ▶ One-piece wok grate and single burner grate
- ▶ Porcelain-coated cast iron two-burner S-grate
- ▶ Hardwood cutting board (griddle models only)
- ▶ High altitude conversion kits

Accessories are available through your Wolf dealer. To obtain local dealer information, visit the Locator section of our website, wolfappliance.com.

SPECIFICATIONS ▼

Overall Rangetop Width	35 ⁷ / ₈ " (911)
Overall Rangetop Height (to cooking surface)	8 ¹ / ₂ " (216)
Overall Rangetop Depth	28 ¹ / ₂ " (724)

Dual-Stacked Sealed Surface Burners

15,000 Btu/hr (4.4 kW) burners with 950 Btu/hr (.3 kW) delivered at simmer
Single 9,200 Btu/hr (2.7 kW) burner with 325 Btu/hr (.1 kW) delivered at simmer

Infrared Charbroiler	16,000 Btu/hr (4.7 kW)
Infrared Griddle – Natural Gas	15,000 Btu/hr (4.4 kW)
LP Gas	13,000 Btu/hr (3.8 kW)

Electrical Supply Requirements 110/120 V AC, 50/60 Hz
15 amp dedicated circuit

Power Cord 6' (1.8 m) power cord with 3-prong grounded plug

Shipping Weight 190 lbs (86 kg) – 220 lbs (100 kg)

Specifications are subject to change without notice.

IMPORTANT NOTE: A minimum 5" (127) riser is required when installing Model SRT366 against a combustible surface. A minimum 10" (254) riser is required for all charbroiler (C) or griddle (G) models installed against a combustible surface.

36" (914) Sealed Burner Rangetops INSTALLATION

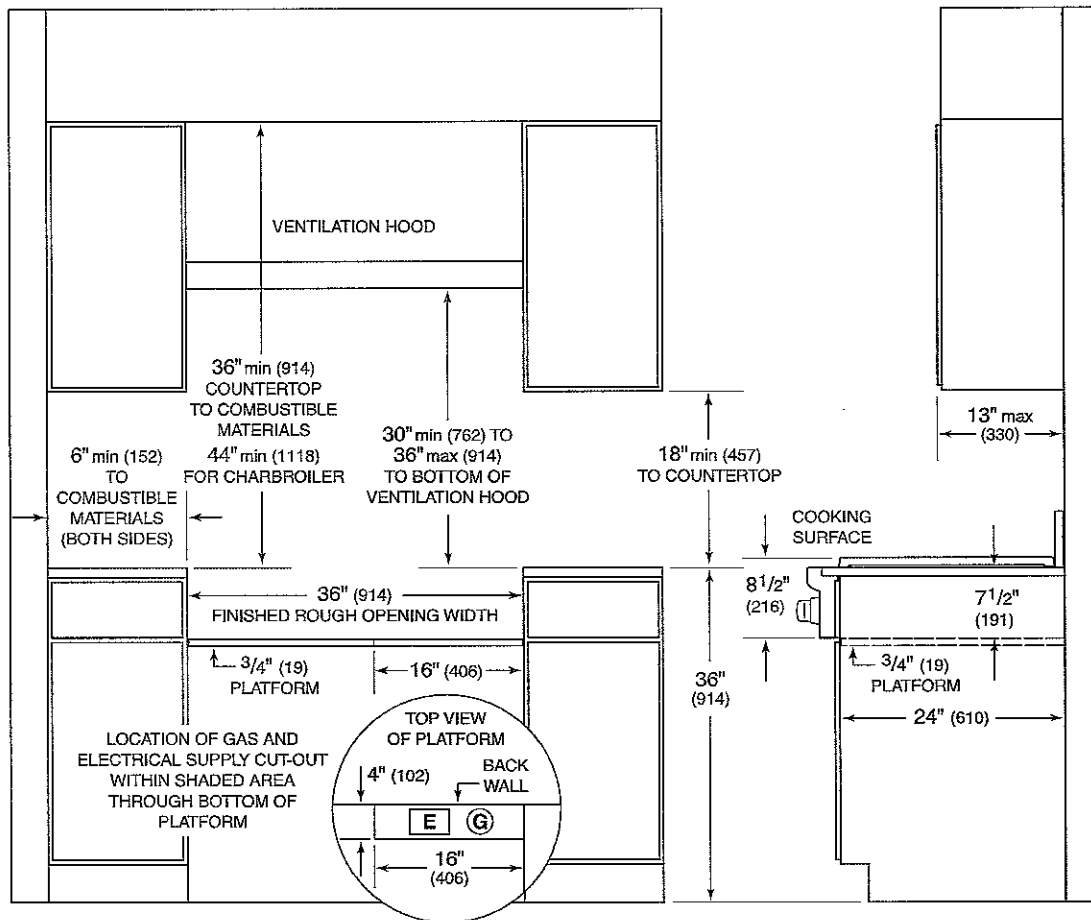

ISLAND INSTALLATIONS: 12" (305) MINIMUM CLEARANCE FROM BACK OF RANGETOP TO COMBUSTIBLE REAR WALL ABOVE COUNTERTOP—0" (0) TO NON-COMBUSTIBLE MATERIALS

DIMENSIONS

Rough Opening Width	36" (914)
Rough Opening Height	7 1/2" (191)
Rough Opening Depth	24" (610)
Location of Electrical and Gas Supply	Within shaded area

See Installation Instructions shipped with unit for detailed specifications.