

Kleinburg Glen - 33L - 1 - 25-2 Elev.B HUDSON

APPLIANCES

Inv.1,060	1 - Purchaser Accepts Standard Appliance Openings: Fridge - 37-1/2"W x 73-1/2" High Approx. Dishwasher - 24" W Approx.
Line15632	Note:
19Dec16 / 12Jan17	

CENTRAL VAC AND WIRING

Inv.696	1 - FAMILY ROOM: CONDUIT PIPE - FOR TELEVISION - Locate approx. 60" A.F.F. ABOVE FIREPLACE, TERMINATING LEFT OF FIREPLACE. See plan for location.
Line9241	Note:
26Jul16 / 20Oct16	
Inv.696	1 - GARAGE ENTRANCE: ROUGH - IN FOR EXTRA SECURITY KEY PAD
Line9238	Note:
26Jul16 / 20Oct16	
Inv.696	1 - CONDUIT PIPE - FROM ATTIC TO ELECTRICAL PANEL - Terminate above laundry.
Line9240	Note:
26Jul16 / 20Oct16	
Inv.696	1 - FAMILY ROOM: ROUGH - IN FIBER OPTIC CABLE - HOME RUN TO ELECTRICAL PANEL - Locate by stairs, see plan for location.
Line9244	Note:
26Jul16 / 20Oct16	
Inv.696	2 - FAMILY ROOM: ROUGH - IN WIRING FOR ONE PAIR OF SPEAKERS - Locate in ceiling approx. 24" from each wall in corners. See plan for location. Terminating by cable location.
Line9248	Note:
26Jul16 / 20Oct16	
Inv.700	1 - FAMILY ROOM: *NOTE* LOCATE speakers in wall approx. 6" from ceiling (approx. 102" A.F.F.)
Line9774	Note:
26Jul16 / 20Oct16	

CERAMIC

Inv.696	1 - THRU OUT: *DELETE* ALL ACCESSORIES AND MIRRORS
Line12409	Note:
26Jul16 / 20Oct16	
Inv.1,060	1 - FOYER & POWDER ROOM FLOOR TILE: Upgrade 5 - 24x24" glossy
Line15499	Note:
19Dec16 / 12Jan17	
Inv.1,060	1 - MASTER ENSUITE FLOOR TILE: Upgrade 4 - 12x24" glossy
Line15501	Note:
19Dec16 / 12Jan17	
Inv.1,060	1 - MASTER ENSUITE FLOOR TILE: Install tile in brick pattern.
Line15502	Note:
19Dec16 / 12Jan17	
Inv.1,060	1 - MASTER ENSUITE WALL TILE: Upgrade 1 wall & ceiling tile - 4x16" Bevelled Glossy (note: revised larger shower)
Line15503	Note:
19Dec16 / 12Jan17	

Kleinburg Glen - 33L - 1 - 25-2 Elev.B HUDSON

Inv.1,060	1 - MASTER ENSUITE: Install shower wall tile in horizontal brick pattern. See sketch for pattern.
Line15504	Note:
19Dec16 / 12Jan17	
Inv.1,060	1 - MASTER ENSUITE SHOWER FLOOR TILE: Upgrade 4 marble mosaic
Line15509	Note:
19Dec16 / 12Jan17	
Inv.1,060	1 - LAUNDRY ROOM FLOOR TILE: Upgrade 2 - 12x24"
Line15510	Note:
19Dec16 / 12Jan17	
Inv.1,060	1 - LAUNDRY ROOM FLOOR TILE: Lay tile in brick pattern. See plan for tile direction.
Line15511	Note:
19Dec16 / 12Jan17	
Inv.1,060	1 - MAIN BATHROOM FLOOR TILE: Upgrade 2 - 12x24"
Line15512	Note:
19Dec16 / 12Jan17	
Inv.1,060	1 - MAIN BATHROOM FLOOR TILE: Lay tile in brick pattern. See plan for tile direction.
Line15513	Note:
19Dec16 / 12Jan17	
Inv.1,060	1 - MAIN BATHROOM WALL TILE: Upgrade 1 - 4x12" - laid in horizontal, stacked pattern.
Line15514	Note:
19Dec16 / 12Jan17	

DRYWALL

Inv.696	1 - SMOOTH CEILINGS - (2 - Story Design) 2ND FLOOR
Line9267	Note:
26Jul16 / 20Oct16	

ELECTRICAL

Inv.696	4 - FRONT ELEVATION: POT LIGHT: 4 INCH LINE VOLTAGE POT LIGHT - (EXTERIOR) - EACH
Line9288	Note:
26Jul16 / 20Oct16	
Inv.696	1 - KITCHEN: POT LIGHT: 4 INCH HALOGEN POT LIGHT - 440 WH - PRICED PER LIGHT - 10 or more POTLIGHTS * locate above kitchen sink (on separate switch)
Line9252	Note:
26Jul16 / 20Oct16	
Inv.696	1 - FAMILY ROOM: 110V WALL RECEPTACLE ON NORMAL CIRCUIT - Locate approx. 60" A.F.F. above fireplace. see plan for location
Line9242	Note:
26Jul16 / 20Oct16	
Inv.696	4 - KITCHEN: POT LIGHT: 4 INCH HALOGEN POT LIGHT - 440 WH - PRICED PER LIGHT - 10 or more POTLIGHTS See plan for location.
Line9249	Note:
26Jul16 / 20Oct16	
Inv.696	1 - KITCHEN: Single pole switch for potlights
Line9251	Note:
26Jul16 / 20Oct16	

Kleinburg Glen - 33L - 1 - 25-2 Elev.B HUDSON

Inv.696	1 - KITCHEN: Single pole switch for potlight above sink.
Line9253	Note:
26Jul16 / 20Oct16	
Inv.696	4 - MAIN HALL: POT LIGHT: 4 INCH HALOGEN POT LIGHT - 440 WH - PRICED PER LIGHT - 10 or more POTLIGHTS *DELETE* builders standard ceiling light, install 4 potlights, see plan for location. Use standard switch.
Line9254	Note:
26Jul16 / 20Oct16	
Inv.696	1 - POWDER ROOM: ROUGH - IN CEILING OUTLET ON SAME SWITCH - DOES NOT INCLUDE FIXTURE - *DELETE BUILDER'S STANDARD light above mirror, use standard switch. Locate approx. center of room.
Line9257	Note:
26Jul16 / 20Oct16	
Inv.696	1 - FOYER: Single pole switch for soffit lights
Line9289	Note:
26Jul16 / 20Oct16	
Inv.696	1 - GARAGE ENTRY: POT LIGHT: 4 INCH HALOGEN POT LIGHT - 440 WH - PRICED PER LIGHT - 10 OR MORE *DELETE* BUILDER'S STANDARD LIGHT, INSTALL POTLIGHT INSTEAD - USING STANDARD SWITCH
Line9255	Note:
26Jul16 / 20Oct16	
Inv.696	1 - MASTER ENSUITE: RELOCATE STANDARD FIXTURE - to center above sink. See plan for location.
Line9260	Note:
26Jul16 / 20Oct16	
Inv.696	1 - MASTER ENSUITE: ROUGH - IN WALL OUTLET ON SAME SWITCH - DOES NOT INCLUDE FIXTURE - Locate above 2nd sink, use same switch as standard. See plan for location.
Line9261	Note:
26Jul16 / 20Oct16	
Inv.696	1 - MASTER BEDROOM: 110V WALL RECEPTACLE ON NORMAL CIRCUIT - Locate approx. 60" A.F.F.
Line9268	Note:
26Jul16 / 20Oct16	
Inv.700	6 - FAMILY ROOM: POT LIGHT: 4 INCH HALOGEN POT LIGHT - 440 WH - PRICED PER LIGHT - 1 - 9 POTLIGHTS - install 6 potlights, see plan for location.
Line9775	Note:
26Jul16 / 20Oct16	
Inv.700	1 - KITCHEN: 110V WALL RECEPTACLE ON DEDICATED CIRCUIT for future 600+ cfm hood fan.
Line9317	Note:
26Jul16 / 20Oct16	
Inv.700	1 - KITCHEN: 110V WALL RECEPTACLE ON DEDICATED CIRCUIT - GAS FIRED APPLIANCE - FOR AUX. EQUIPMENT - NOT A STOVE PLUG
Line9705	Note:
26Jul16 / 20Oct16	
Inv.700	1 - KITCHEN: ROUGH - IN CEILING OUTLET ON SAME SWITCH - DOES NOT INCLUDE FIXTURE - Locate above island, use same switch as standard ceiling light. See plan for location.
Line9706	Note:
26Jul16 / 20Oct16	
Inv.700	1 - FAMILY ROOM: Single pole switch for potlights.
Line9776	Note:
26Jul16 / 20Oct16	

Kleinburg Glen - 33L - 1 - 25-2 Elev.B HUDSON

Inv.700	1 - ADDITIONAL EXTERIOR COACH LIGHT ON SAME SWITCH (BUILDER STANDARD FIXTURE) - In addition to builder's standard coach light, add 1 on opposite side of garage using same switch as standard. See sketch for location.
Line9777	Note:
26Jul16 / 20Oct16	
Inv.1,060	1 - KITCHEN - Purchasers request to NOT INSTALL builder's standard hood fan and standard cabinets above stove. DELETE. Do not supply, install, and/or credit. Purchasers are installing their own hood fan after closing.
Line15631	Note:
19Dec16 / 12Jan17	

EXTERIOR COLOURS

Inv.696	1 - EXTERIOR COLOUR PACKAGE 4
Line12958	Note:
26Jul16 / 20Oct16	

FIREPLACE AND MANTLE

Inv.1,060	1 - FAMILY ROOM: Delete standard fireplace mantle - do NOT install, leave with finished drywall/paint only.
Line15525	Note:
19Dec16 / 12Jan17	

FRAMING

Inv.696	1 - FAMILY ROOM: Build above fireplace to ceiling.
Line9243	Note:
26Jul16 / 20Oct16	
Inv.696	1 - MASTER ENSUITE: **REVISE LAYOUT** Delete tub, move toilet, increase shower to full width, re-center vanity in space. See plan for location.
Line9258	Note:
26Jul16 / 20Oct16	
Inv.696	1 - MASTER ENSUITE: SHOWER STALL SEAT
Line9263	Note:
26Jul16 / 20Oct16	
Inv.696	7 - MAIN FLOOR: FRAME MAIN FLOOR DOORS & ARCHES AT 96 INCH - ADDED WITH THE ADDITION OF TALLER INTERIOR DOORS
Line9274	Note:
26Jul16 / 20Oct16	

GLASS AND MIRROR

Inv.696	1 - THRU OUT: *DELETE* ALL ACCESSORIES AND MIRRORS
Line9239	Note:
26Jul16 / 20Oct16	
Inv.696	1 - MASTER ENSUITE: CONVERT FRAMED SHOWER TO 10MM FRAMELESS SHOWER ENCLOSURE WITH DOOR AND 10MM SIDE PANEL Note: layout revised
Line9259	Note:
26Jul16 / 20Oct16	

GRANITE MARBLE QUARTZ

Inv.1,060	1 - MASTER ENSUITE STONE COUNTER TOP: Upgrade 3 Caesar Stone Edge: FE-20
Line15505	Note:
19Dec16 / 12Jan17	

Kleinburg Glen - 33L - 1 - 25-2 Elev.B HUDSON

Inv.1,060	1 - MAIN BATHROOM VANITY COUNTER TOP: Upgrade 3 Caesar Stone EDGE: FE-20
Line15518	Note:
19Dec16 / 12Jan17	
Inv.1,060	1 - MAIN BATHROOM VANITY STONE COUNTER TOP: Add 3" Splash to vanity
Line15519	Note:
19Dec16 / 12Jan17	
Inv.1,060	1 - KITCHEN CABINETRY: Leave approx. 36" above 30" range for future 30" hood fan.
Line16024	Note:
19Dec16 / 12Jan17	

HARDWOOD

Inv.1,060	1 - KITCHEN HARDWOOD: Upgrade 5 - Vintage 3/4x5" White Oak Hand Scraped
Line15496	Note:
19Dec16 / 12Jan17	
Inv.1,060	1 - FAMILY ROOM / LIVING ROOM / DINING ROOM / LANDING HARDWOOD: Upgrade 5 - Vintage 3/4x5" White Oak Hand Scraped
Line15497	Note:
19Dec16 / 12Jan17	

HVAC

Inv.700	1 - KITCHEN: UPGRADE VENTING FOR STOVE TO 8 INCH PIPE EXTERIOR WALL
Line9318	Note:
26Jul16 / 20Oct16	
Inv.700	1 - KITCHEN: GAS LINE ROUGH - GROUND FLOOR
Line9704	Note:
26Jul16 / 20Oct16	

INTERIOR TRIM AND DOORS

Inv.696	3 - MAIN FLOOR: EXTENDED HEIGHT ARCHWAY (PRICE PER DOORWAY) - 96"
Line9275	Note:
26Jul16 / 20Oct16	
Inv.696	4 - MAIN FLOOR: STANDARD DOOR EXTENDED HEIGHT 96 INCH (PRICE PER DOOR) - GROUND FLOOR 2 STOREY MODELS
Line9276	Note:
26Jul16 / 20Oct16	
Inv.1,060	1 - MAIN FLOOR TRIM: Upgrade 2 trim package *on main floor only* Standard trim on 2nd floor
Line15524	Note:
19Dec16 / 12Jan17	

KITCHEN AND BATH CABINETRY

Inv.696	1 - MASTER ENSUITE: **REVISE LAYOUT** Delete tub, move toilet, increase shower to full width, re-center vanity in space. See plan for location.
Line12960	Note:
26Jul16 / 20Oct16	
Inv.1,060	1 - KITCHEN CABINETRY: Slide-in stove prep
Line15490	Note:
19Dec16 / 12Jan17	

Kleinburg Glen - 33L - 1 - 25-2 Elev.B HUDSON

Inv.1,060	2 - KITCHEN CABINETRY: Pots and Pans drawers - 1 shallow top drawer + 2 deep drawers
Line15492	Note:
19Dec16 / 12Jan17	
Inv.1,060	1 - KITCHEN CABINETRY: Upgrade 4 profile - mdf
Line15489	Note:
19Dec16 / 12Jan17	
Inv.1,060	1 - KITCHEN CABINETRY: Delete uppers, finish sides of cabinetry for future chimney-style hood fan. Leave approx. 36" above 30" range for future 30" hood fan.
Line15491	Note:
19Dec16 / 12Jan17	
Inv.1,060	1 - KITCHEN CABINETRY: Cabinetry crown and Furring Panel
Line15493	Note:
19Dec16 / 12Jan17	
Inv.1,060	6 - KITCHEN CABINETRY: Add dummy panels to rear and ends of island
Line15494	Note:
19Dec16 / 12Jan17	
Inv.1,060	1 - KITCHEN CABINETRY: Raise cabinets 3/4" for hardwood flooring in kitchen
Line15495	Note:
19Dec16 / 12Jan17	
Inv.1,060	1 - MAIN BATHROOM VANITY CABINET: UPGRADE 2 Maple
Line15515	Note:
19Dec16 / 12Jan17	
Inv.1,060	1 - MAIN BATHROOM: Upgrade stain on maple cabinet
Line15516	Note:
19Dec16 / 12Jan17	

MISC.

Inv.696	1 - Purchaser has attended a Structural appointment at the Decor Centre & has DECLINED any additional upgrades and accepts and acknowledges that there will be no further structural changes/additions/deletions to be made upon signing on July 26, 2016.
Line9278	Note:
26Jul16 / 20Oct16	
Inv.696	1 - Purchasers are aware & accepts that ANY changes made to upgrades after signing this Purchasers Extra Form are subject to a minimum administration fee of \$500. PLUS a 10% holdback fee.
Line9279	Note:
26Jul16 / 20Oct16	
Inv.696	1 - BONUS PACKAGE: \$5,000.00 (INCLUDING TAXES) WORTH OF UPGRADES FROM GOLD PARK HOMES DÉCOR CENTRE IS BEING APPLIED TOWARD THE STRUCTURAL APPOINTMENT. PURCHASER HAS A REMAINING AMOUNT OF \$00 (INCLUDING TAXES) TO BE USED TOWARD THE COLOUR APPOINTMENT.
Line9280	Note:
26Jul16 / 20Oct16	
Inv.700	1 - Purchasers are aware & accepts that ANY changes made to upgrades after signing this Purchasers Extra Form are subject to a minimum administration fee of \$500. PLUS a 10% holdback fee.
Line9778	Note:
26Jul16 / 20Oct16	

Kleinburg Glen - 33L - 1 - 25-2 Elev.B HUDSON

Inv.700	1 - Purchaser has attended a Structural appointment at the Decor Centre & has DECLINED any additional upgrades and accepts and acknowledges that there will be no further structural changes/additions/deletions to be made upon signing on July 26, 2016.
Line9789	Note:
26Jul16 / 20Oct16	
Inv.1,060	1 - Purchasers are aware & accepts that ANY changes made to upgrades after signing this Purchasers Extra Form are subject to a minimum administration fee of \$500. PLUS a 10% holdback fee.
Line15629	Note:
19Dec16 / 12Jan17	
Inv.1,060	1 - Purchaser has attended a Colour appointment at the Decor Centre & has DECLINED any additional upgrades and accepts and acknowledges that there will be no further changes/additions/deletions to be made upon signing on December 20, 2016.
Line15628	Note:
19Dec16 / 12Jan17	
Inv.1,060	1 - STAIRCASE - The purchaser was advised and therefore accepts and acknowledges that the wood species of the staircase and flooring chosen do not match. This difference may result in a stain colour variance.
Line15630	Note: The purchaser agrees that the vendor is to be exempt from any and all claims by the purchaser regarding this colour variance.
19Dec16 / 12Jan17	

PAINTING

Inv.1,060	1 - MAIN STAIRS: Stain stairs 'Vintage - Pewter'
Line15523	Note: Stairs will not match hardwood floors in colour, texture or species
19Dec16 / 12Jan17	

PLUMBING

Inv.696	1 - MASTE ENSUITE: TRENCH DRAIN APPROX 27 INCH LINEAR TRENCH DRAIN TILED - ACO 3705/93871 - UPG 1
Line9264	Note:
26Jul16 / 20Oct16	
Inv.696	1 - MASTER ENSUITE: ROUGH - IN FOR RAINSHOWER HEAD - SHOWER HEAD NOT INCLUDED AND MUST BE PURCHASED
Line9265	Note:
26Jul16 / 20Oct16	
Inv.696	1 - KITCHEN: ROUGH - IN - WATERLINE FOR FRIDGE
Line9266	Note:
26Jul16 / 20Oct16	
Inv.696	1 - GARAGE: HOSE BIB - STANDARD TO UPGRADED WITH HOT AND COLD WATER VALVE
Line9273	Note:
26Jul16 / 20Oct16	
Inv.696	1 - MASTER ENSUITE: **REVISE LAYOUT** Delete tub, move toilet, increase shower to full width, re-center vanity in space. See plan for location.
Line12410	Note:
26Jul16 / 20Oct16	
Inv.1,060	2 - MASTER ENSUITE: Contrac 'Collette' rectangular undermount sink
Line15506	Note: Price includes stone cut and polish
19Dec16 / 12Jan17	
Inv.1,060	2 - MASTER ENSUITE: Upgrade to Delta 'Arzo' Single lever, single hole lav faucet (chrome) #586LF-MPU
Line15507	Note:
19Dec16 / 12Jan17	

Kleinburg Glen - 33L - 1 - 25-2 Elev.B HUDSON

Inv.1,060	1 - MASTER ENSUITE SHOWER: Upgrade to Delta 'Arzo' Rain shower + Hand Shower with Slide Bar + 3 Function Diverter Valve (Chrome) #T17T267/50570/51567/T11867/R11000/R10000-UNBXHF
Line15508	Note:
19Dec16 / 12Jan17	
Inv.1,060	1 - MASTER ENSUITE: Contrac 'Collette' rectangular undermount sink
Line15517	Note: Price includes stone cut and polish
19Dec16 / 12Jan17	
Inv.1,060	1 - MAIN BATHROOM: Upgrade to Delta 'Arzo' Single lever, single hole lav faucet (chrome) #586LF-MPU
Line15520	Note:
19Dec16 / 12Jan17	
Inv.1,060	1 - MAIN BATHROOM: Upgrade to Delta Arzo Tub/shower combo #T14467 (chrome
Line15526	Note:
19Dec16 / 12Jan17	

STAIRS AND RAILINGS

Inv.1,060	1 - MAIN STAIRS: Euroline 1 + V Groove
Line15522	Note:
19Dec16 / 12Jan17	

WINDOWS - BASEMENT

Inv.696	1 - BASEMENT WINDOWS - UPGRADE EXISTING BASEMENT WINDOW TO 53 INCH X 12 INCH See plan for location
Line9272	Note:
26Jul16 / 20Oct16	
Inv.696	2 - BASEMENT WINDOWS - UPGRADE EXISTING BASEMENT WINDOW TO 30 INCH X 16 INCH- Rear Windows only
Line9270	Note:
26Jul16 / 20Oct16	

WINDOWS AND DOORS

Inv.696	1 - BREAKFAST: GARDEN DOORS IN LIEU OF PATIO SLIDERS - 6FT X 80 INCH WITH CLEAR GLASS
Line9277	Note:
26Jul16 / 20Oct16	

Purchasers: Anthony Venuto & Vanessa Italiano

Property: 33L

Telephone Res. / Bus: (416) 895-8212

Project: Burkshire Holdings Inc.

Decor Advisor: Yolande Somerville

Model and Elevation: 25-2 Elev.B HUDSON

Layout Changes: ☐ Yes ☒ No

Sketch Attached: ☒ Yes ☐ No

Exterior Colour Scheme:

1. Cabinetry

	Style and Colour	Counter	Hardware
Kitchen / Breakfast	*florentin mdf 'wht matte'	Granite: 'Grigio Sardo' Edge: FE-20	cs1-21
Laundry Room	n/a	n/a	n/a
Powder Room	n/a	n/a	n/a
n/a	n/a	n/a	n/a
Master Ensuite Bathroom	varese pvc 'crystal white'	*Quartz: 'Raven' Edge: FE-20	cs1-23
Second Ensuite Bathroom (If Applicable)	n/a	n/a	n/a
Main Bathroom	*florentin mpl 'charcoal'	*Quartz: 'Organic White' Edge: FE-20	cs1-23
Dishwasher Cabinet	n/a		

Comment

2. Floor Tile

	Selection	Grout	Threshold
Entrance Vestibule	*24x24" Arya 'White Polished'	n/a	n/a
Main Hall	n/a	n/a	n/a
Kitchen / Breakfast	see hardwood	n/a	n/a
Laundry Room	*12x24" Antikas 'Bianco'	n/a	n/a
Powder Room	*24x24" Arya 'White Polished'	n/a	n/a
M. Ens Shower Floor	*marble mosaic 'milas pearl' Herringbone	n/a	n/a
Master Ensuite Bathroom	*12x24" Carrara X 'Glossy white/grey'	n/a	n/a
Second Ensuite Bathroom (If Applicable)	n/a	n/a	n/a
Lower Landing (If Applicable)	see hardwood	n/a	n/a
Main Bathroom	*12x24" Allure 'Grey'	n/a	n/a

Comment

Grout lines as small as possible please!

3. Wall Tile

	Selection	Listello/Inserts	Describe
n/a	n/a	<input type="radio"/> Yes <input checked="" type="radio"/> No	
Master Ensuite Bathroom			
Tub Deck	n/a	<input type="radio"/> Yes <input checked="" type="radio"/> No	
Shower Stall	*4x16" Chess Bevelled 'White'	<input type="radio"/> Yes <input checked="" type="radio"/> No	
Bathroom Walls	n/a	<input type="radio"/> Yes <input checked="" type="radio"/> No	
Second Ensuite Bathroom (If Applicable)	n/a	<input type="radio"/> Yes <input checked="" type="radio"/> No	
Main Bathroom	*4x16" Chess Bevelled 'Tender Grey'	<input type="radio"/> Yes <input checked="" type="radio"/> No	

Kitchen Backsplash ☐ Yes ☒ No

Backsplash Behind Fridge

Comment

Purchasers: Anthony Venuto & Vanessa Italiano

Property: 33L

Telephone Res. / Bus: (416) 895-8212

Project: Burkshire Holdings Inc.

Decor Advisor: Yolande Somerville

Model and Elevation: 25-2 Elev.B HUDSON

4. Plumbing Fixtures

<input type="checkbox"/>	Second Ensuite	<input type="checkbox"/>	Powder Room	<input type="checkbox"/>
Master Ensuite Bathroom	<input type="checkbox"/>	Other Room - Specify	<input type="checkbox"/>	Other Washroom
<input type="checkbox"/>		<input type="checkbox"/>		

Comment

Standard thru out except:
Master Ensuite Shower, lav faucet, sink
Main Bath Tub/shower, lav faucet, sink

5. Hardwood Flooring

	Type and Stain		Type and Stain
Main Hall	n/a	Upper Landing	n/a
Kitchen / Breakfast	*3/4 x 5" White Oak 'Gotham'	Upper Hall	*3/4 x 5" White Oak 'Gotham'
Living Room	*3/4 x 5" White Oak 'Gotham'	Master Bedroom	n/a
Dining Room	*3/4 x 5" White Oak 'Gotham'	Bedroom #2	n/a
Family Room	*3/4 x 5" White Oak 'Gotham'	Bedroom #3	n/a
Den/Library	n/a	Bedroom #4	n/a
Entrance Vestibule	n/a	Bedroom #5	n/a
Lower Landing (If Applicable)	*3/4 x 5" White Oak 'Gotham'	Other Room - Specify	n/a

Comment

6. Carpeting

	Upgrade	Description
Main Hall	<input type="checkbox"/>	n/a
Living Room	<input type="checkbox"/>	n/a
Dining Room	<input type="checkbox"/>	n/a
Family Room	<input type="checkbox"/>	n/a
Den/Library	<input type="checkbox"/>	n/a
Upper Hall	<input type="checkbox"/>	n/a
Master Bedroom	<input type="checkbox"/>	T-04
Bedroom #2	<input type="checkbox"/>	T-04
Bedroom #3	<input type="checkbox"/>	T-04
Bedroom #4	<input type="checkbox"/>	n/a
Bedroom #5	<input type="checkbox"/>	n/a
<input type="checkbox"/>	<input type="checkbox"/>	n/a
Upper Landing (If Applicable)	<input type="checkbox"/>	n/a
Lower Landing (If Applicable)	<input type="checkbox"/>	n/a

Upgrade Underpad	Type n/a	Area n/a
Carpet on Stairs	Capped n/a	Runner - *Upgrade n/a

Comment

Standard carpet and standard underpad in bedrooms

Scheduled Closing Date: Thursday, December 08, 2016

Purchasers: Anthony Venuto & Vanessa Italiano

Property: 33L

Telephone Res. / Bus: (416) 895-8212

Project: Burkshire Holdings Inc.

Decor Advisor: Yolande Somerville

Model and Elevation: 25-2 Elev.B HUDSON

7. Fireplace

	Living Room			Family Room			Other Room - Specify		
	Purchased	As Per Plan	N/A	Purchased	As Per Plan	N/A	Purchased	As Per Plan	N/A
Fireplace Type	<input type="radio"/>	<input type="radio"/>	<input checked="" type="radio"/>	<input type="radio"/>	<input checked="" type="radio"/>	<input type="radio"/>	<input type="radio"/>	<input type="radio"/>	<input checked="" type="radio"/>
Mantle Type				Standard Gas					
Colour / Stain				*none					
Surround				*none					
Hearth				*none					

Comment

Do Not install mantle, leave painted drywall

8. Trim Carpentry

Interior Doors	*Standard	Front Door Glass Inserts	Standard	Door Handles	Standard
Interior Trim	*Package 2 on main floor, standard on 2nd floor				

Comment

9. Plaster Mouldings and Medallions

Entrance Vestibule			Kitchen/Breakfast		
Main Hall			Den/Library		
Living Room			Lower Landing		
Dining Room			Other Room - Specify	none	
Family Room			Thru out		

Comment

10. Railings and Spindles

Railing Package	*Euroline 1 + V Groove		
Railing Colour	*Vintage 'Pewter'	Spindle Colour	*Black
Stringer / Riser	*Vintage 'Pewter'	Treads	*Vintage 'Pewter'
Comment		Oak Stairs	<input checked="" type="radio"/> Yes <input type="radio"/> No

11. Wall Paint

Main & Upper Hall		Master Bedroom	
Living Room		Bedroom #2	
Dining Room		Bedroom #3	
Kitchen / Breakfast		Bedroom #4	
Family Room		Bedroom #5	
Powder Room		Master Ensuite	
Laundry Room			
Den/Library		Second Ensuite	
Trim Paint		Thru out	Warm Grey
Comment	Smooth Ceilings First Floor		

Scheduled Closing Date: Thursday, December 08, 2016

Purchasers: Anthony Venuto & Vanessa Italiano

Property: 33L

Telephone Res. / Bus: (416) 895-8212

Project: Burkshire Holdings Inc.

Decor Advisor: Yolande Somerville

Model and Elevation: 25-2 Elev.B HUDSON

12. Electrical

Plugs and Switches ☒ White ☐ Ivory Above Kitchen Cabinet Light ☐ Yes ☒ No
 Hood Fan ☐ White ☐ Ivory Below Kitchen Cabinet Light ☐ Yes ☒ No
 Appliances Built in Cooktop Built in Oven Gas Stove Microwave
☐ Yes ☒ No ☐ Yes ☒ No ☒ Yes ☐ No ☐ Yes ☒ No
 Comment

13. Heating and Air Conditioning

Air Conditioning Gas Provisions Stove
 Gas Provisions Dryer Gas Provisions Barbecue
 Comment
 Standard Gas BBQ Line

14. Additional Comments

15. Disclaimers and Notes

- 1) Colours of all materials are as close as possible to builder's selection, but not necessarily identical due to variances in manufacturing.
- 2) Any extras listed above are null and void unless accompanied by a separate invoice/amendment. Said invoice must be paid in full.
- 3) The Purchaser acknowledges that after Interior Colour Selection form is signed and dated, no further changes will be permitted other than re-selection due to unavailability. _____ Purchaser's Initials
- 4) The Purchaser acknowledges reading and accepting the "Gold Park Homes Decor Centre Disclaimers" form. This document contains other miscellaneous disclaimers.

This Interior Colour Selection is final and approved by:

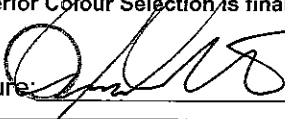
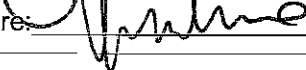
Signature:  Date: _____ Signature:  Date: _____

Elevation A • 1,898 sq.ft.
 Elevation B • 1,898 sq.ft.

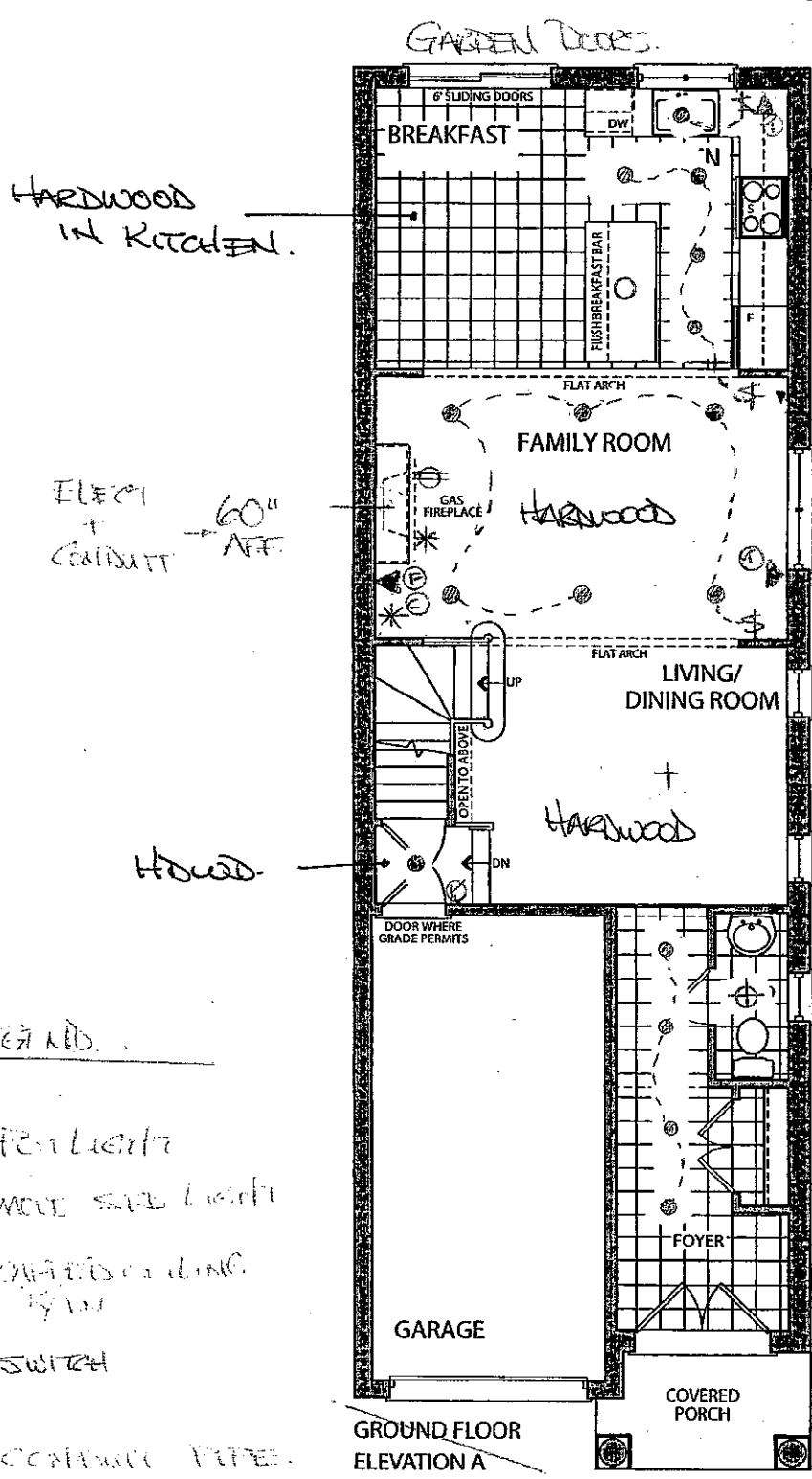

LEGEND:

- Pot Lights
- MOVE SLD LIGHT
- ⊕ CHAINED LING
- | SWITCH
- * CONDUIT TYPED
- ⊙ - HEAVY
- ⊙ FIRE ALARM
- ⊙ CABLE
- ⊙ Telco
- ⊙ HOLE CUTLET
- ⊙ KEY PAD REMOTE

SPEAKER WIRE:
 LOCATE in each corner
 in wall approx 6" from
 ceiling (Living Room).

REQUEST:
 STD CEILING LIGHT
 in line with hall.
 Potlights.

Foyer & Powder
 TILE PATTERN.

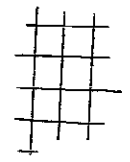

GROUND FLOOR
 ELEVATION A

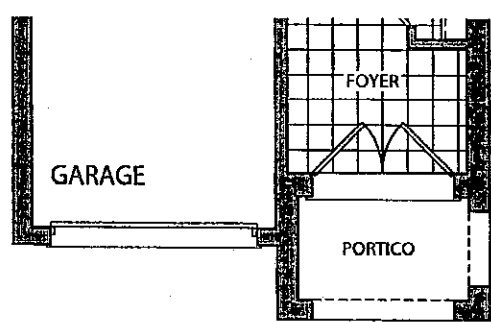

GROUND FLOOR
 ELEVATION B

RG-83L
 Dec 20 2016

LOT 33L

July 26/16

August 4 2016

see attached

Prices, figures, illustrations, sizes, features and finishes are subject to change without notice. E.&O.E. Areas and dimensions are approximate and actual usable floor space may vary from the stated area. Layout may be reverse of the unit purchased. E. & O.E.



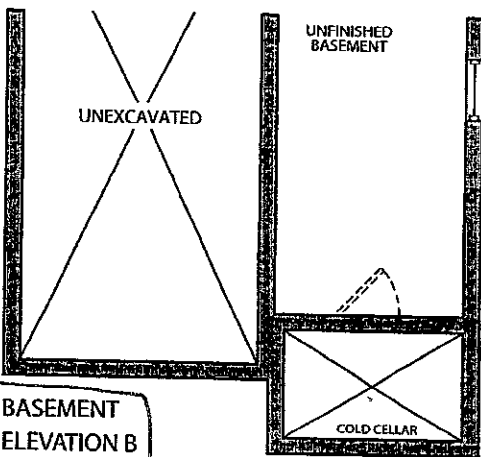

See Attached

GOLDPARK
HOMES

CORTINA

70 Regine Road, Woodbridge, Ontario L4L 8L6
Tel: 905-264-6484 Fax: 905-264-0864
www.CortinaKitchens.com

KG-33L
Dec 20 2016

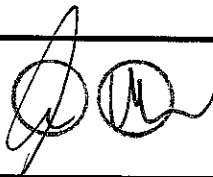

QUOTATION

Date: 28/06/16

Trade Name: Gold Park Homes	Site location:	Model: 25-2
Address:	Project: Kleinburg Glen	Phase:

This layout has been explained to the purchaser by Cortina Kitchens Inc. and is understood by the purchaser.

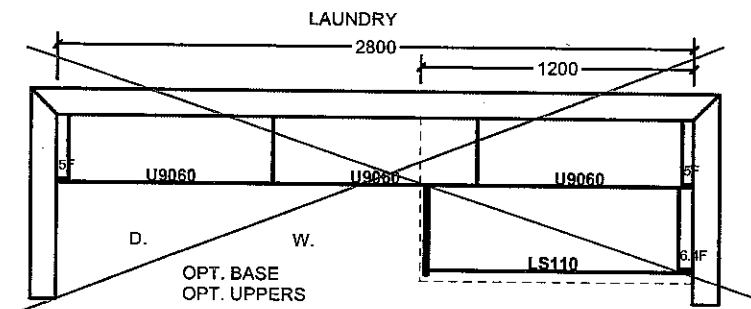
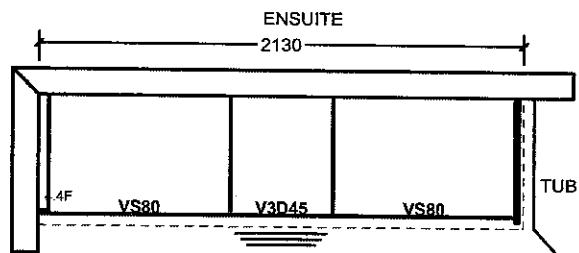
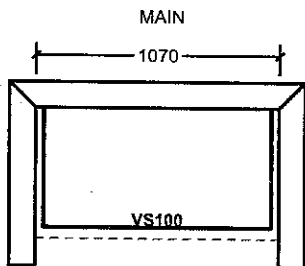
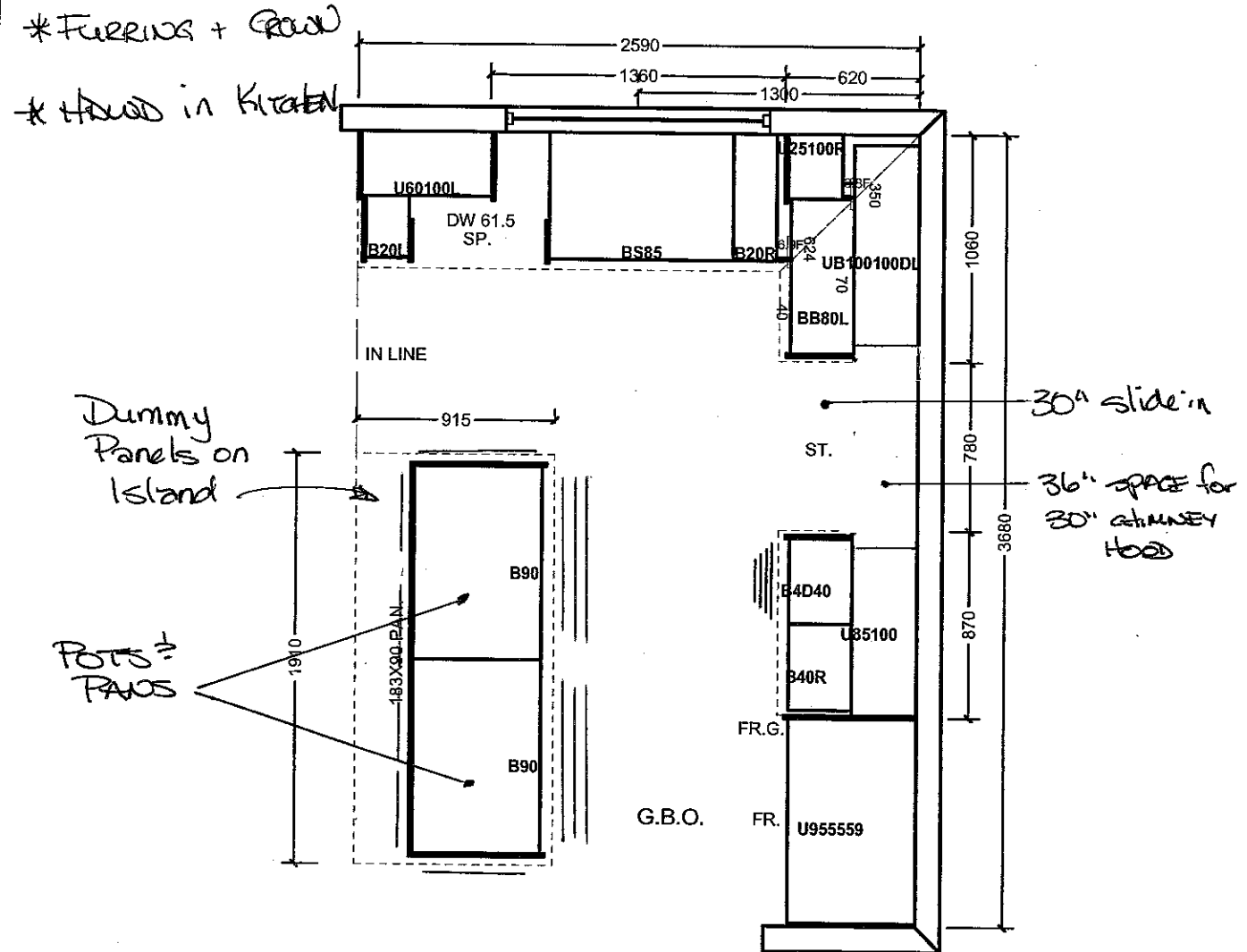

All prices subject to confirmation from head office.
This quotation is subject to the terms & conditions set out

All agreements are contingent upon strikes, accidents, and delays beyond our control.
Please provide our installer with template for sinkholes or \$150.00 will be charged for callback.

ACCEPTED DATE: _____

Item A. Wood grain and colour are characteristics of the product. We cannot guarantee that such grain and colour will always match.
Item B. Cortina Kitchens Inc. reserves the right to alter dimensions and make technical changes without notice.

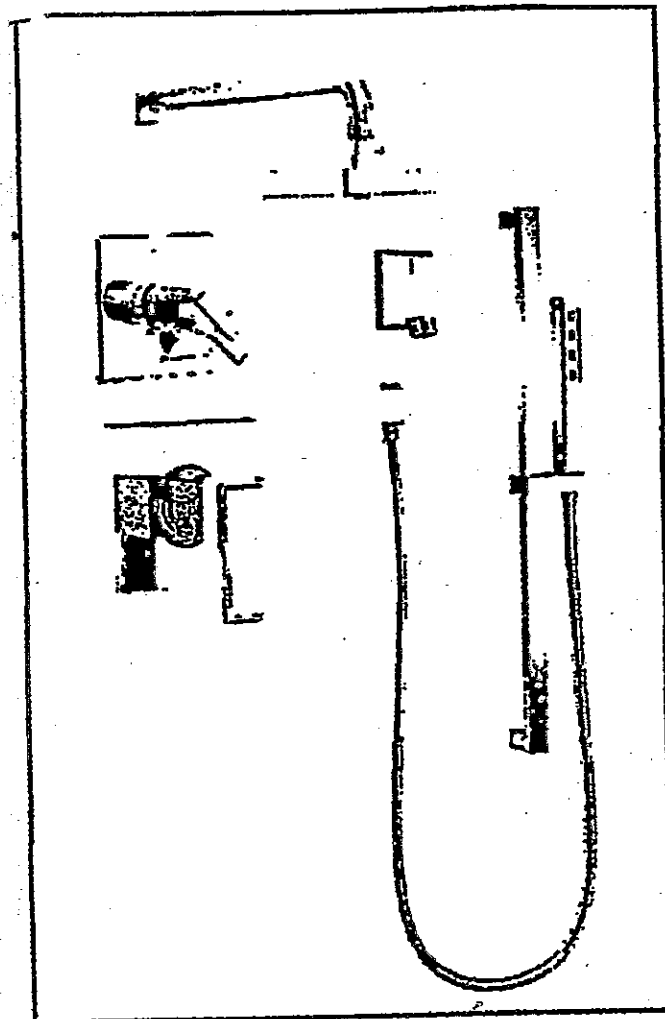

TempAssure® Shower System with 3
Function Diverter & High Flow Rough-in
2.0 GPM Chrome Finish
T17T267 / 50570 / 51567 / T11867 / R1100
/ R10000-UNBXHF

LOT No.: 33L

ROOM: MASTER ENCLITE

DATE: Dec 20 2016

SIGNATURE:

Kleinfelt
CLEAN

GOLDPARK
WORTH MORE™

Collette

4220CIY 21½" Rectangular Undermount Sink

2016 decor center catalogue



FEATURES

Vitreous china

Front overflow hole

Template and mounting hardware supplied

Overall dimensions (W x D x H):

(OD): 21½" x 14" x 7½"

(ID): 19" x 11½" x 5½"

CERTIFICATIONS

IAPMO cUPC

ASME A112.19.2 / CSA B45.1-2008

COLOUR

Soft white

LOT No.: 33L

ROOM: MASTER ENSUITE & MAIN BATH

DATE: Dec 20 2016

SIGNATURE:



GOLDPARK
WORTH MORE

Kleinfurg
2016

Arzo® Collection

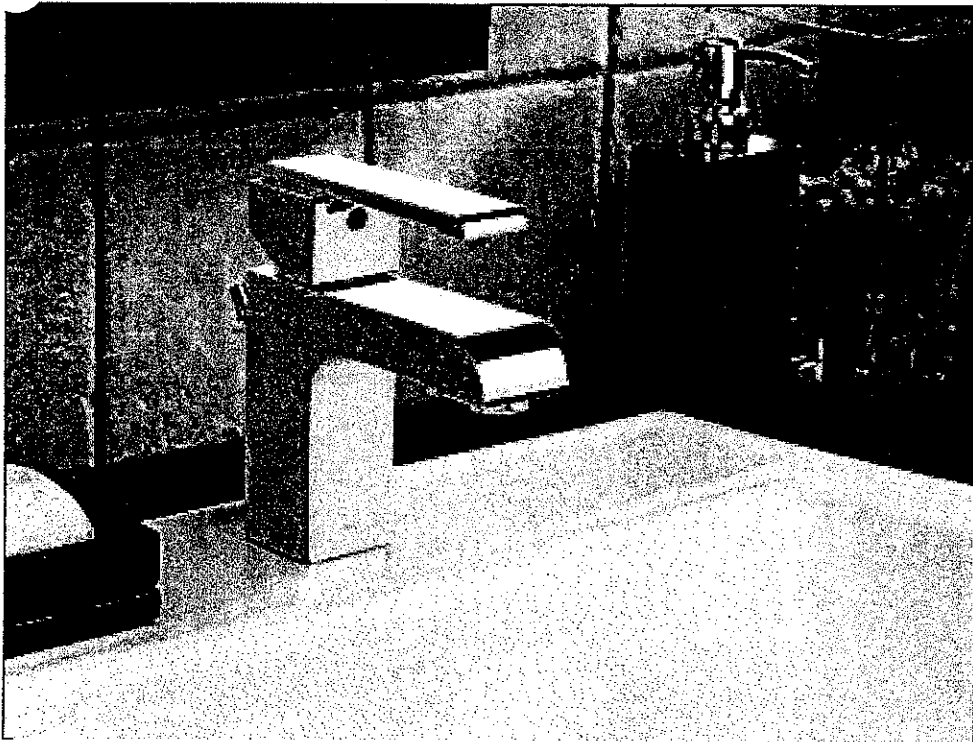

Single Handle Lavatory

Chrome Finish
586LF-MPU

LOT No.: 33L



ROOM: MASTER ENCLITE 1 MAN BATH

DATE: Dec 20 2016

SIGNATURE:

GOLDPARK
WORTH MORE

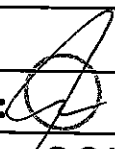
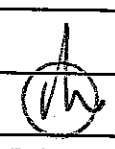
Kleinburg
GLEN

LOT No.: 33L	
ROOM: MAIN BATH	
DATE: Dec. 20 2016	SIGNATURE:  
	 WORTH MORE

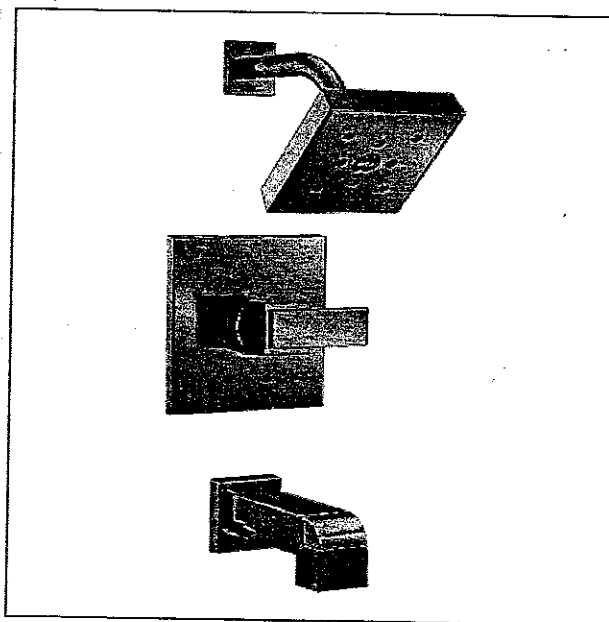

Monitor® 14 Series Tub & Shower with H₂Okinetic®, 2.0 GPM
Water-Efficient Showerhead & Tub Spout 

Chrome Finish
T14467

Shown in Brilliance Stainless

Pricing subject to change without notice.

KG-33L
Doc 20 2db

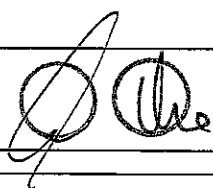

CSI-6

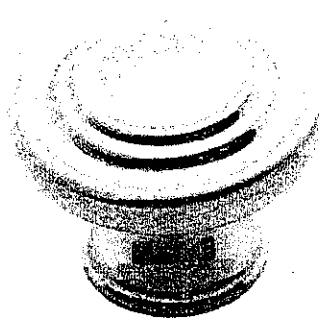

CSI-10

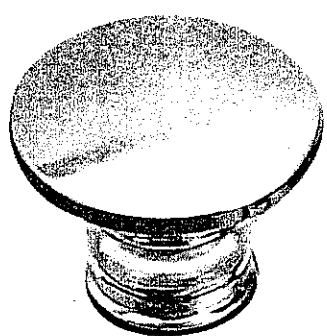

CSI-14



CSI-16

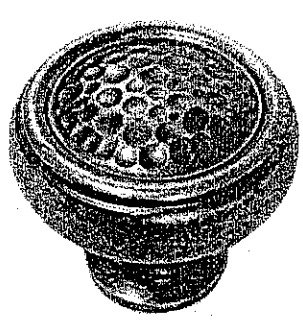

CSI-18

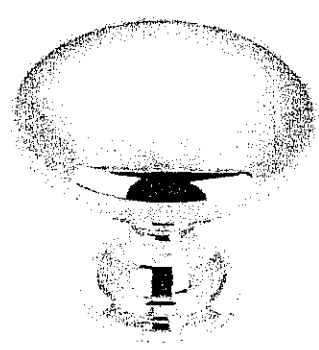

CSI-19

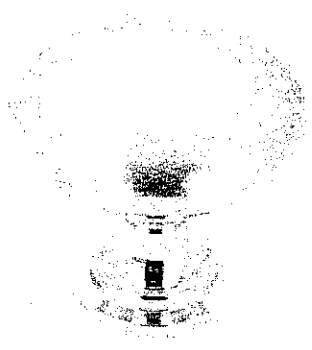

CSI-20

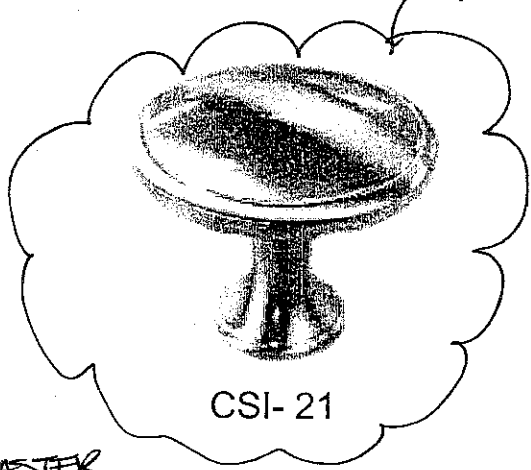

CSI-21

KITCHEN

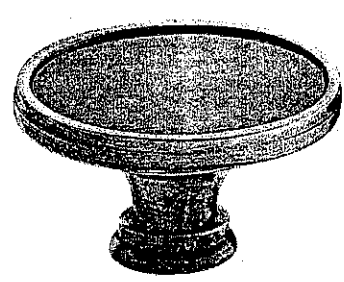

CSI-22

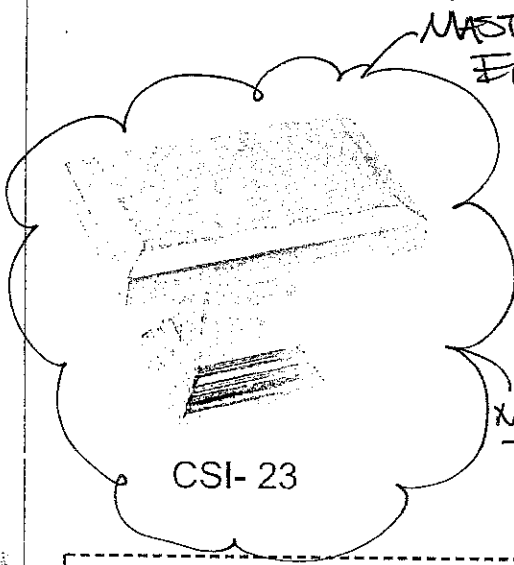

CSI-23

MASTER
ENROUTE

MAIN
BATH

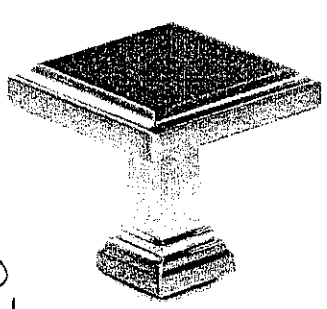

CSI-24

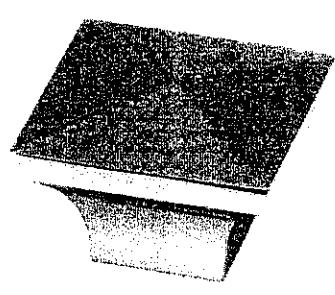

CSI-25

***NOTES:**
- IMAGES ARE FOR QUICK REFERENCE PURPOSES ONLY
- ACTUAL SIZES AND FINISHES AS PER HARDWARE
SAMPLE BOARD PROVIDED TO DECOR CENTRE

GOLDPARK
HOMES

Kleinbaur
STEIN

Granite, Marble,
Engineered Surfaces

KG-33L

19 Dec. 20 2016

KITCHEN
+
M. EARS.
+
Main

- Standard 2CM & 3CM
- Upgrade 1 2CM & 3CM
- Upgrade 1 & 4 CM
- Upgrade 2

20mm (3/4") Profiles

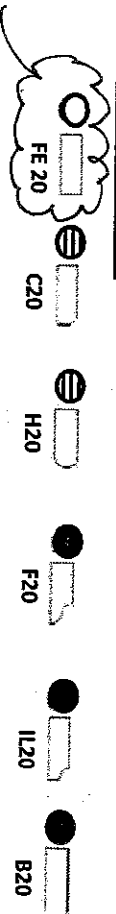

30mm (1-1/4") Profiles

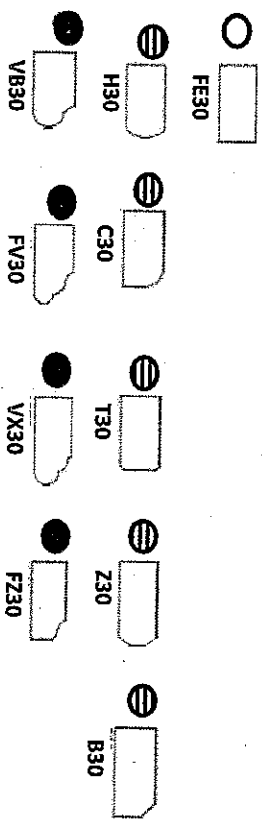

40mm (1-1/2") Profiles

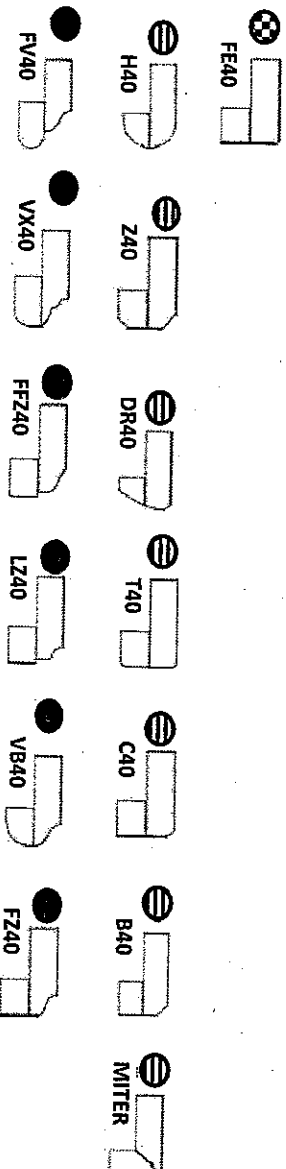

Note: All colours may not be available in 30mm at time ordered. Vendor reserves the right to use 40 mm edges (by lamination process).

*Mitre edge is available in Upgrade 1 for an overall thickness of 2". All other Mitre edge options will be an Upgrade 2 Edge.

BATHROOMS -
UPGRADE SINK ?
FAUCET

KITCHEN - STD SINK
? FAUCET

33L

Dual Fuel Ranges

30" RANGE

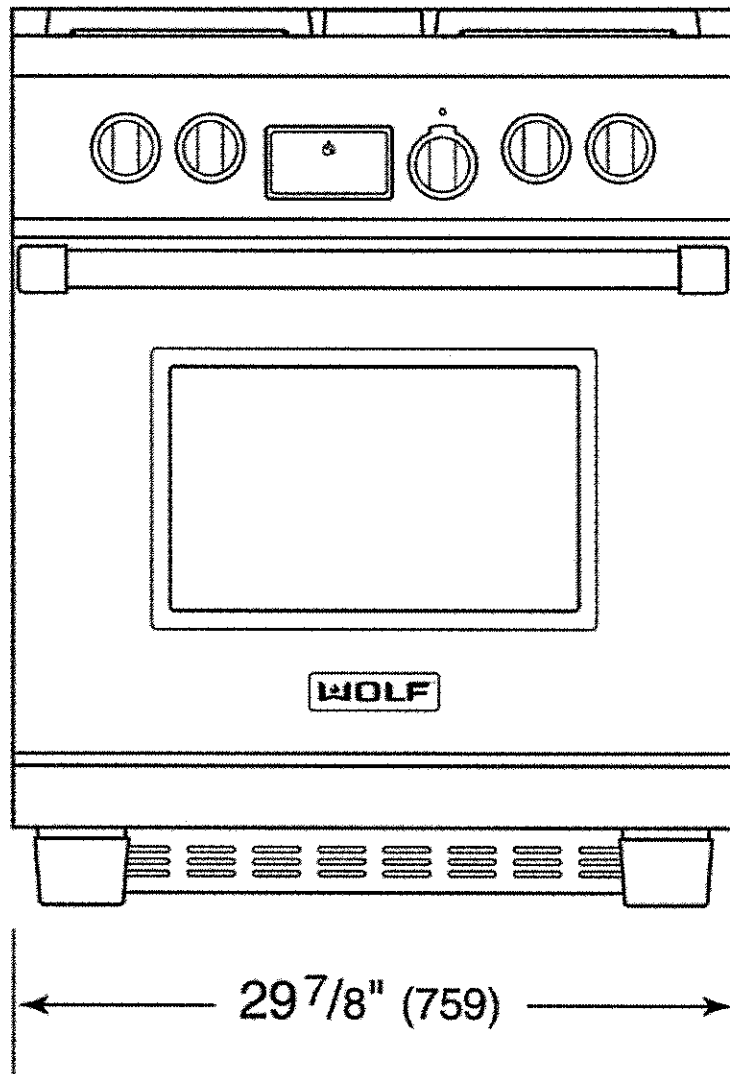

36" RANGE

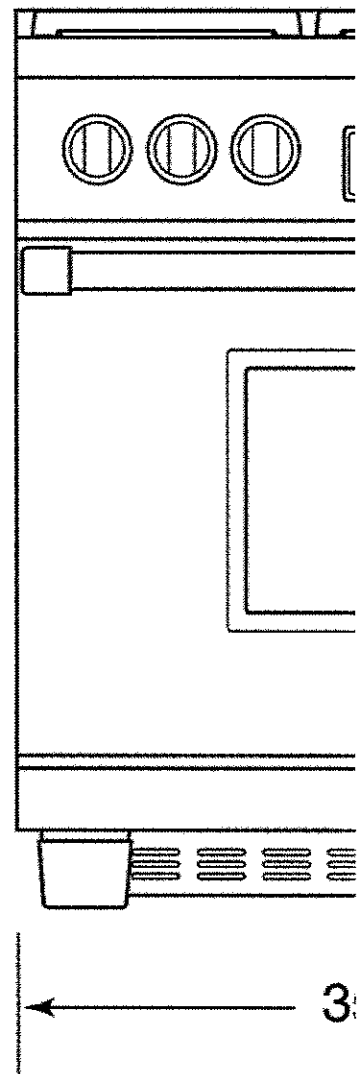

GOLDPARK

WORTH MORE™

Attention: Building Department

Re: Lot # 33L

This is to acknowledge that as the purchaser of the above noted lot, I have asked Gold Park Homes not to install the standard builder's kitchen exhaust hood, as I will be installing my own unit after closing.

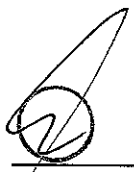

Purchaser

Vendor

Dated this 20th day of December, 2016.

CORTINA

KITCHENS INC.

70 Regina Road Woodbridge ON L4L 8L6
905-264-6464

INFORMATION - PVC DOORS

Builder..Gold Park Homes Project..... Lot #...33L.....

All cabinets with PVC (Thermofoil) Doors come with melamine gables, panels and kick. The doors, crown moulding and light valance are PVC wrapped. Open shelves incorporated in design will only be available with melamine interiors. There will be variations in colour shades between the PVC parts (doors, crown and Light valance) and the melamine parts (open shelves, Gables , Panels and Kick) due to the difference in material.

Furring Panel with crown moulding to the ceiling is not available on all PVC door styles due to subtle variations in colour shades between the PVC parts (moulding) and the melamine parts (furring panel) due to the difference in material. Grain directions in wood grain pattern melamine , vary between the furring panel, crown moulding (horizontal) and the PVC doors (vertical).

Thank you for your understanding.

I am well informed of this information, and agree to the purchase of the above.

Purchaser:  

Date: Dec 20 2016