

Brampton Encore - 34 - 1 - 38-4 Elev.A VIVALDI
CENTRAL VAC AND WIRING

Inv.528	1 - TELEPHONE AND CABLE ROUGH-IN LOCATIONS
Line6375	Note:
31May16 / 20Sep16	
Inv.528	1 - FAMILY ROOM: INSTALL CONDUIT PIPE- FOR TELEVISION- MUST SPECIFY LOCATION AND TERMINATION POINT
Line6376	Note:
31May16 / 20Sep16	

CERAMIC

Inv.1,083	1 - FOYER: INSTALL Floor Upgrade 4 Foyer Vestibule Floor
Line15886	Note:
9Jan17 / 13Jan17	
Inv.1,083	1 - KITCHEN: INSTALL Floor Upgrade 4 Kitchen and Breakfast Floor
Line15887	Note:
9Jan17 / 13Jan17	
Inv.1,083	1 - POWDER ROOM: INSTALL Floor Upgrade 4 Powder Room Floor
Line15888	Note:
9Jan17 / 13Jan17	
Inv.1,083	1 - KITCHEN-BACKSPLASH:
	INSTALL 2ND UPGRADE BACKSPLASH ABOVE COUNTER AND BEHIND STOVE
Line15889	Note:
9Jan17 / 13Jan17	

ELECTRICAL

Inv.528	1 - FAMILY ROOM: INSTALL 110V WALL RECEPTACLE ON DEDICATED CIRCUIT -ABOVE FIREPLACE. SEE SKETCH
Line6377	Note:
31May16 / 20Sep16	
Inv.528	1 - TWIN ENSUITE: INSTALL SHOWER IN LIEU OF TUB- INCLUDES FRAMED GLASS SHOWER ENCLOSURE- TO GO IN TWIN ENSUITE INCLUDES SHOWER POT LIGHT
Line11548	Note:
31May16 / 20Sep16	

EXTERIOR COLOURS

Inv.528	1 - EXTERIOR COLOUR PACKAGE 7
Line11550	Note:
31May16 / 20Sep16	

FORMING

Inv.528	1 - SIDE DOOR- HOME TO EXTERIOR- AS PER PLAN AND GRADE PERMITTING
	GRADE DOES NOT PERMIT SIDE DOOR PER SITING AUGUST 2, 2016
Line6379	Note:
31May16 / 20Sep16	

FRAMING

Brampton Encore - 34 - 1 - 38-4 Elev.A VIVALDI

Inv.528	1 - GARAGE: INSTALL MANDOOR - GARAGE TO HOUSE- AS PER PLAN AND GRADE PERMITING
	GRADE DOES NOT PERMIT MANDOOR PER SITING AUGUST 2, 2016
Line6378	Note: GIVEN IN AGREEMENT OF PURCHASE AND SALE
31May16 / 20Sep16	
Inv.528	1 - TWIN ENSUITE: INSTALL SHOWER IN LIEU OF TUB- INCLUDES FRAMED GLASS SHOWER ENCLOSURE- TO GO IN TWIN ENSUITE
Line6380	Note:
31May16 / 20Sep16	

HARDWOOD

Inv.1,083	1 - DINING ROOM: INSTALL Upgrade 1 LEVEL S, PREVERCO PRO, RED OAK, CAPPUCCINO IN Dining
Line15890	Note:
9Jan17 / 13Jan17	
Inv.1,083	1 - FAMILY ROOM: INSTALL Upgrade 1 LEVEL S, PREVERCO PRO, RED OAK, CAPPUCCINO IN Family
Line15891	Note:
9Jan17 / 13Jan17	
Inv.1,083	1 - LANDING: INSTALL Upgrade 1 LEVEL S, PREVERCO PRO, RED OAK, CAPPUCCINO ON Landing
Line15892	Note:
9Jan17 / 13Jan17	
Inv.1,083	1 - LANDING: INSTALL Upgrade 1 LEVEL S, PREVERCO PRO, RED OAK, CAPPUCCINO ON Main Hall
Line15893	Note:
9Jan17 / 13Jan17	
Inv.1,083	1 - UPPER HALL: INSTALL Upgrade 1 LEVEL S, PREVERCO PRO, RED OAK, CAPPUCCINO ON Upper Hall
Line15894	Note:
9Jan17 / 13Jan17	
Inv.1,083	1 - MASTER BEDROOM: INSTALL Upgrade 1 LEVEL S, PREVERCO PRO, RED OAK, CAPPUCCINO ON Master Bed
Line15895	Note:
9Jan17 / 13Jan17	
Inv.1,083	1 - BEDROOM 2: INSTALL Upgrade 1 LEVEL S, PREVERCO PRO, RED OAK, CAPPUCCINO ON Bed 2
Line15896	Note:
9Jan17 / 13Jan17	
Inv.1,083	1 - BEDROOM 3: INSTALL Upgrade 1 LEVEL S, PREVERCO PRO, RED OAK, CAPPUCCINO ON Bed 3
Line15897	Note:
9Jan17 / 13Jan17	
Inv.1,083	1 - BEDROOM 4: INSTALL Upgrade 1 LEVEL S, PREVERCO PRO, RED OAK, CAPPUCCINO ON Bed 4
Line15898	Note:
9Jan17 / 13Jan17	

HVAC

Inv.528	1 - KITCHEN: INSTALL GAS LINE ROUGH - MAIN FLOOR - (2 STOREY MODELS) FOR STOVE
Line6381	Note:
31May16 / 20Sep16	

Brampton Encore - 34 - 1 - 38-4 Elev.A VIVALDI

KITCHEN AND BATH CABINETRY

Inv.1,083	1 - KITCHEN: INSTALL Oak PVC 59 Upper Corner Diagonal 100cm h, NO GLASS
Line15900	Note:
9Jan17 / 13Jan17	
Inv.1,083	1 - LAUNDRY ROOM: INSTALL UPG 1 GRP III Opt Laundry Uppers
Line15901	Note:
9Jan17 / 13Jan17	

MISC.

Inv.528	1 - BONUS PACKAGE: \$7723.55 (INCLUDING TAXES) WORTH OF UPGRADES FROM GOLD PARK HOMES DÉCOR CENTRE IS BEING APPLIED TOWARD THE STRUCTURAL APPOINTMENT. PURCHASER HAS A REMAINING AMOUNT OF \$7276.45 (INCLUDING TAXES) TO BE USED TOWARD THE COLOUR APPOINTMENT
Line6383	Note:
31May16 / 20Sep16	
Inv.528	1 - Purchaser has attended a Structural appointment at the Decor Centre & has DECLINED any additional upgrades and accepts and acknowledges that there will be no further structural changes/additions/deletions to be made upon signing on May 31, 2016
Line6384	Note:
31May16 / 20Sep16	
Inv.528	1 - Purchasers are aware & accepts that ANY changes made to upgrades after signing this Purchasers Extra Form are subject to a minimum administration fee of \$500. PLUS a 10% holdback fee
Line6385	Note:
31May16 / 20Sep16	
Inv.528	1 - PURCHASER HAD \$15,000.00 IN DECOR DOLLARS FROM APS
Line11537	Note:
31May16 / 20Sep16	
Inv.830	1 - Grading does not permit man door, invoice #528 line 4. No credit due.
Line11552	Note:
20Sep16 / 13Jan17	
Inv.830	1 - Grading does not permit side door, invoice #528 line 5. Credit due to purchaser
Line11553	Note:
20Sep16 / 13Jan17	
Inv.1,083	1 - BONUS PACKAGE: \$7276.45 (INCLUDING TAXES) WORTH OF UPGRADES FROM GOLD PARK HOMES DÉCOR CENTRE IS BEING APPLIED TOWARD THE COLOUR APPOINTMENT
Line15904	Note:
9Jan17 / 13Jan17	
Inv.1,083	1 - Purchaser has attended a Colour appointment at the Decor Centre & has DECLINED any additional upgrades and accepts and acknowledges that there will be no further structural changes/additions/deletions to be made upon signing on January 9, 2017
Line15905	Note:
9Jan17 / 13Jan17	
Inv.1,083	1 - Purchasers are aware & accepts that ANY changes made to upgrades after signing this Purchasers Extra Form are subject to a minimum administration fee of \$500. PLUS a 10% holdback fee
Line15906	Note:
9Jan17 / 13Jan17	

PAINTING

Inv.1,083	1 - STAIRCASE: Stain Staircase 2 Storey Model (Euroline Pickets Charged Separately)
Line15899	Note:
9Jan17 / 13Jan17	



CONSTRUCTION SUMMARY

Brampton Encore - 34 - 1 - 38-4 Elev.A VIVALDI

PLUMBING

Inv.528	1 - KITCHEN: INSTALL ROUGH-IN - WATERLINE FOR FRIDGE
Line6382	Note:
31May16 / 20Sep16	
Inv.528	1 - TWIN ENSUITE: INSTALL SHOWER IN LIEU OF TUB- INCLUDES FRAMED GLASS SHOWER ENCLOSURE- TO GO IN TWIN ENSUITE
Line11549	Note:
31May16 / 20Sep16	

STAIRS AND RAILINGS

Inv.1,083	1 - STAIRCASE: INSTALL 1 34 Inch LOTUS Non Fluted
Line15902	Note:
9Jan17 / 13Jan17	
Inv.1,083	1 - STAIRCASE: INSTALL V Groove Handrail
Line15903	Note:
9Jan17 / 13Jan17	

Scheduled Closing Date:

Purchasers: NAVJOT SAINI & GAGAN PREET

Property: 34 of Plan -

Telephone Res. / Bus: (905) 760-9595

Project: Fieldwalk Investments Inc.

Decor Advisor: Terri Parisani

Model and Elevation: 38-4 Elev.A VIVALDI

Layout Changes: ☒ Yes ☐ NoSketch Attached: ☒ Yes ☐ NoExterior Colour Scheme:

1. Cabinetry

	Style and Colour	Counter	Hardware
Kitchen / Breakfast	Toscana(pvc)ChocMaple	Grigio Sardo Granite Edge: C-20	cs1-24
Laundry Room	*Varese(pvc)ItalianWalnt		cs1-19
Powder Room			
TWIN BATH	Toscana(pvc)AntiqWhite	4726K-52 Milano Quartz Laminate	cs1-6
Master Ensuite Bathroom	Venice(pvc)ChocMaple	6696-46 Carrara Bianco Laminate	cs1-10
Second Ensuite Bathroom (If Applicable)	Varese(pvc) Mystic	1877K-52 Autumn Carnival Laminate	cs1-23
Dishwasher Cabinet			

Comment

2. Floor Tile

	Selection	Grout	Threshold
Entrance Vestibule	*Upg.4, CarraraXSeries, White Polished24x2	N/A	N/A
Main Hall			
Kitchen / Breakfast	*Upg.4, CarraraXSeries, White Polished24x2	N/A	N/A
Laundry Room	Reflex White 13 x 13	N/A	N/A
Powder Room	*Upg.4, CarraraXSeries, White Polished24x2	N/A	N/A
TWIN BATH	Serpentine Krem, 13 x 13	N/A	N/A
Master Ensuite Bathroom	Serpentine Beyaz, 13 x 13	N/A	N/A
Second Ensuite Bathroom (If Applicable)	Reflex Olive, 13 x 13	N/A	N/A
Lower Landing (If Applicable)			

Comment

3. Wall Tile

	Selection	Listello/Inserts	Describe
TWIN BATH	Serpentine Krem, 8 x 10	<input type="radio"/> Yes <input checked="" type="radio"/> No	
Master Ensuite Bathroom			
Tub Deck	Weave White 8 x 10	<input type="radio"/> Yes <input checked="" type="radio"/> No	
Shower Stall	Weave White 8 x 10	<input type="radio"/> Yes <input checked="" type="radio"/> No	
Bathroom Walls	Weave White 8 x 10	<input type="radio"/> Yes <input checked="" type="radio"/> No	
Second Ensuite Bathroom (If Applicable)	Reflection Olive, 8 x 10	<input type="radio"/> Yes <input checked="" type="radio"/> No	
		<input type="radio"/> Yes <input checked="" type="radio"/> No	

Kitchen Backsplash ☒ Yes ☐ NoBacksplash Behind Fridge

Comment

*Upg. 2, SEE NOTES BELOW

KITCHEN BACKSPLASH: *UPG.2, CRISTALLO GLASS MOSAIC, GLOSSY/MATTE BLENDS 0.6" X 1.9"

Scheduled Closing Date:

Purchasers: NAVJOT SAINI & GAGAN PREET
Telephone Res. / Bus: (905) 760-9595
Decor Advisor: Terri Parisani

Property: 34 of Plan -
Project: Fieldwalk Investments Inc.
Model and Elevation: 38-4 Elev.A VIVALDI

4. Plumbing Fixtures

Second Ensuite
Powder Room

Master Ensuite Bathroom
Other Room - Specify
Other Washroom

Comment

ALL FIXTURES TO REMAIN STANDARD THROUGHOUT

5. Hardwood Flooring

	Type and Stain		Type and Stain
Main Hall	*Upg.1 PrevercoPro Cappuccino	Upper Landing	*Upg.1 PrevercoPro Cappuccino
Kitchen / Breakfast	-	Upper Hall	**Upg.1 PrevercoPro Cappuccino
Living Room	-	Master Bedroom	**Upg.1 PrevercoPro Cappuccino
Dining Room	*Upg.1 PrevercoPro Cappuccino	Bedroom #2	**Upg.1 PrevercoPro Cappuccino
Family Room	*Upg.1 PrevercoPro Cappuccino	Bedroom #3	**Upg.1 PrevercoPro Cappuccino
Den/Library	-	Bedroom #4	**Upg.1 PrevercoPro Cappuccino
Entrance Vestibule	-	Bedroom #5	-
Lower Landing (If Applicable)	-	Other Room - Specify	-

Comment

ALL HARDWOOD IS RED OAK

6. Carpeting

	Upgrade	Description
Main Hall	<input type="checkbox"/>	N/A
Living Room	<input type="checkbox"/>	N/A
Dining Room	<input type="checkbox"/>	N/A
Family Room	<input type="checkbox"/>	N/A
Den/Library	<input type="checkbox"/>	N/A
Upper Hall	<input type="checkbox"/>	N/A
Master Bedroom	<input type="checkbox"/>	N/A
Bedroom #2	<input type="checkbox"/>	N/A
Bedroom #3	<input type="checkbox"/>	N/A
Bedroom #4	<input type="checkbox"/>	N/A
Bedroom #5	<input type="checkbox"/>	N/A
<input type="text"/>	<input type="checkbox"/>	<input type="text"/>
Upper Landing (If Applicable)	<input type="checkbox"/>	N/A
Lower Landing (If Applicable)	<input type="checkbox"/>	N/A

	Type	Area
Upgrade Underpad	N/A	<input type="text"/>
	Capped	Runner - *Upgrade
Carpet on Stairs	N/A	N/A

Comment

Scheduled Closing Date:

Purchasers: NAVJOT SAINI & GAGAN PREET

Property: 34 of Plan -

Telephone Res. / Bus: (905) 760-9595

Project: Fieldwalk Investments Inc.

Decor Advisor: Terri Parisani

Model and Elevation: 38-4 Elev.A VIVALDI

7. Fireplace

	Living Room			Family Room			Other Room - Specify		
	Purchased	As Per Plan	N/A	Purchased	As Per Plan	N/A	Purchased	As Per Plan	N/A
Fireplace Type	<input type="radio"/>	<input type="radio"/>	<input checked="" type="radio"/>	<input type="radio"/>	<input checked="" type="radio"/>	<input type="radio"/>	<input type="radio"/>	<input type="radio"/>	<input checked="" type="radio"/>
Mantle Type				STANDARD					
Colour / Stain				NF-24					
Surround				WHITE PAINT-GRADE					
Hearth				BIANCO CARRARA					
Comment				NONE					

8. Trim Carpentry

Interior Doors	STANDARD	Front Door Glass Inserts	STANDARD	Door Handles	STANDARD
Interior Trim	STANDARD				
Comment					

9. Plaster Mouldings and Medallions

Entrance Vestibule	N/A		Kitchen/Breakfast	N/A	
Main Hall	N/A		Den/Library	N/A	
Living Room	N/A		Lower Landing	N/A	
Dining Room	N/A		Other Room - Specify		
Family Room	N/A				
Comment					

10. Railings and Spindles

Railing Package	*1 3/4" LOTUS WITH V-GROOVE HANDRAIL		
Railing Colour	*CAPPUCCINO, RED OAK	Spindle Colour	*CAPPUCCINO, RED OAK
Stringer / Riser	*CAPPUCCINO, RED OAK	Treads	*CAPPUCCINO, RED OAK
Comment	Oak Stairs <input checked="" type="radio"/> Yes <input type="radio"/> No		

11. Wall Paint

Main & Upper Hall	WARM GREY	Master Bedroom	WARM GREY
Living Room	WARM GREY	Bedroom #2	WARM GREY
Dining Room	WARM GREY	Bedroom #3	WARM GREY
Kitchen / Breakfast	WARM GREY	Bedroom #4	WARM GREY
Family Room	WARM GREY	Bedroom #5	
Powder Room	WARM GREY	Master Ensuite	WARM GREY
Laundry Room	WARM GREY	TWIN BATH	WARM GREY
Den/Library	WARM GREY	Second Ensuite	WARM GREY
Trim Paint	WHITE		
Comment	Smooth Ceilings First Floor		

Scheduled Closing Date:

Purchasers: NAVJOT SAINI & GAGAN PREET

Property: 34 of Plan -

Telephone Res. / Bus: (905) 760-9595

Project: Fieldwalk Investments Inc.

Decor Advisor: Terri Parisani

Model and Elevation: 38-4 Elev.A VIVALDI

12. Electrical

Plugs and Switches ☒ White ☐ Ivory

Hood Fan ☐ White ☐ Ivory

Appliances

Built in Cooktop

Built in Oven

Gas Stove

Microwave

☐ Yes ☒ No

☐ Yes ☒ No

☒ Yes ☐ No

☐ Yes ☒ No

Comment

STANDARD HOOD FAN: STAINLESS STEEL

Above Kitchen Cabinet Light ☐ Yes ☒ No

Below Kitchen Cabinet Light ☐ Yes ☒ No

13. Heating and Air Conditioning

Air Conditioning

Gas Provisions Stove

Gas Provisions Dryer

Gas Provisions Barbecue

Comment

GAS LINE FOR STOVE PURCHASED
GAS LINE FOR BBQ IS STANDARD

14. Additional Comments

15. Disclaimers and Notes

- Colours of all materials are as close as possible to builder's selection, but not necessarily identical due to variances in manufacturing.
- Any extras listed above are null and void unless accompanied by a separate invoice/amendment. Said invoice must be paid in full.
- The Purchaser acknowledges that after Interior Colour Selection form is signed and dated, no further changes will be permitted other than re-selection due to unavailability. Purchaser's Initials
- The Purchaser acknowledges reading and accepting the "Gold Park Homes Decor Centre Disclaimers" form. This document contains other miscellaneous disclaimers.

This Interior Colour Selection is final and approved by:

Signature: Navjot Saini

Date: Jan 9th 2017

Signature: Gagan Preet

Date: Jan 9th 2017

Telephone — (T)
Cable — (C)
Electrical — (E)

**The
Vivaldi
38' SERIES**

Elevation A • 2,518 sq.ft. | Elevation B • 2,518 sq.ft.

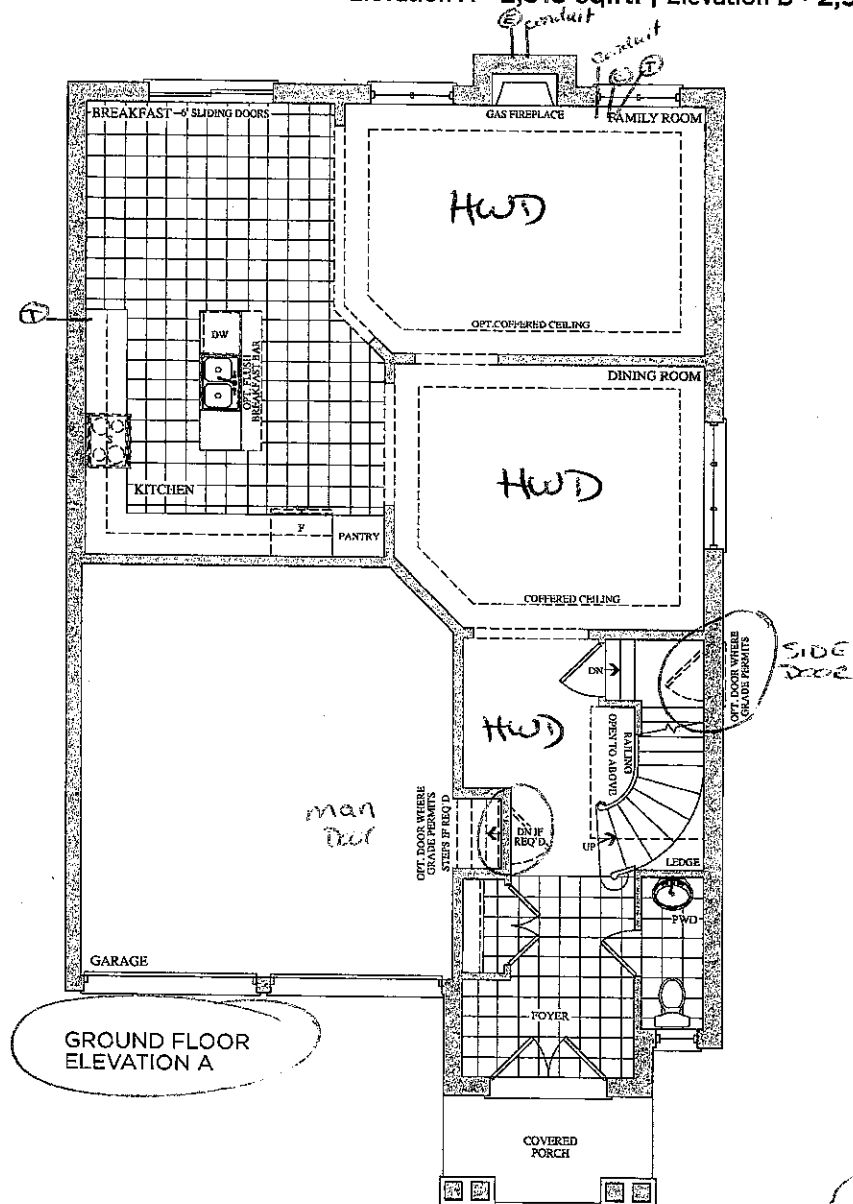

GROUND FLOOR
ELEVATION A

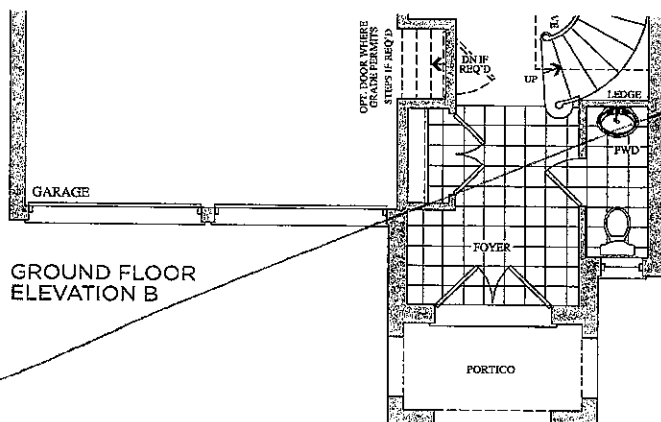

GROUND FLOOR
ELEVATION B

Lot 34

May 31, 16

NS

Lot 34
Jan. 9, 16



GP

Prices, figures, illustrations, sizes, features and finishes are subject to change without notice. E.&O.E. Areas and dimensions are approximate and actual usable floor space may vary from the stated area. Layout may be reverse of the unit purchased. E. & O.E.

GOLDPARK
HOMES

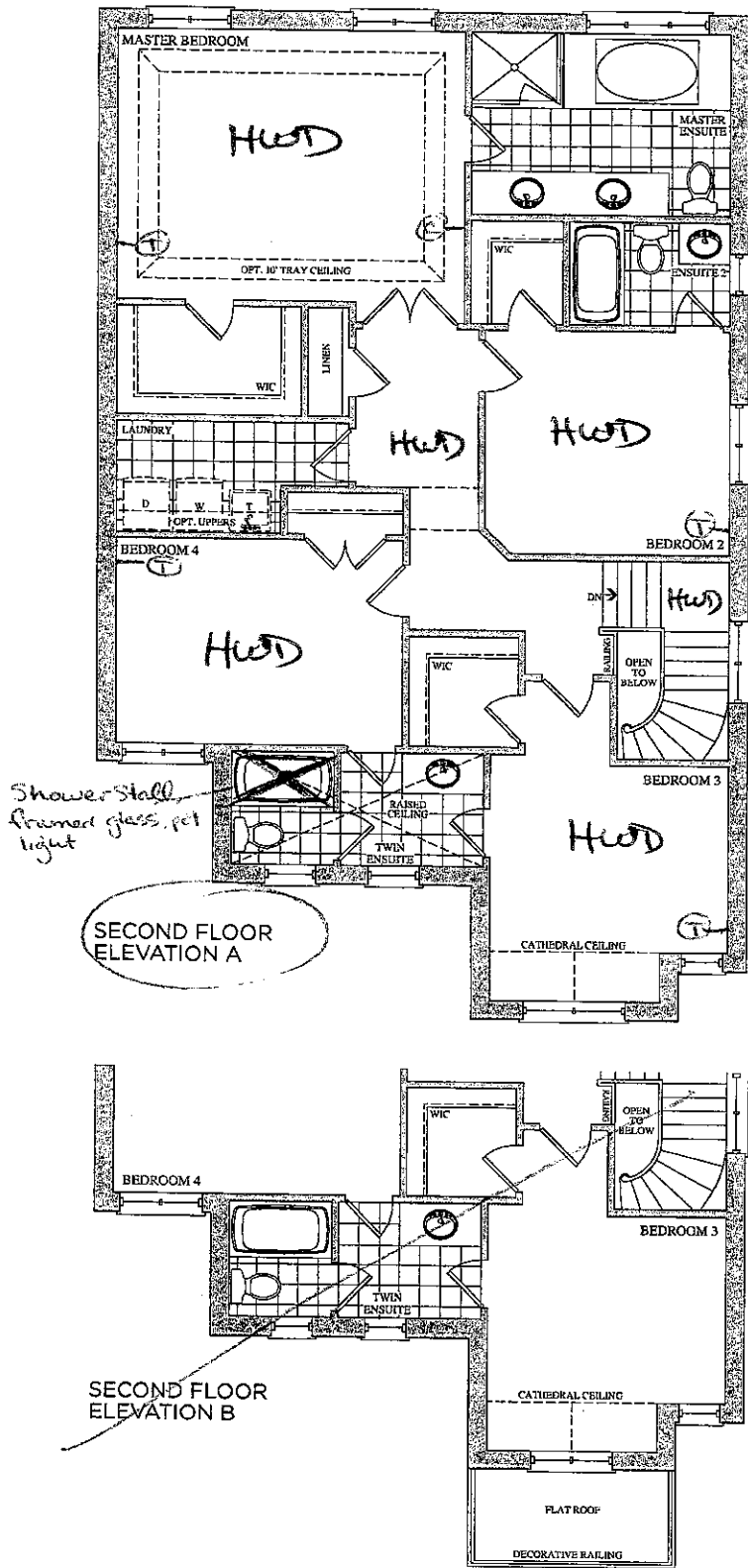

Date: 06/23/16

Trade Name: Gold Park Homes

Site location: Brampton

Model: 38-4

Address:

Project: Encore

Phase:

This layout has been explained to the purchaser by Cortina Kitchens Inc. and is understood by the purchaser.

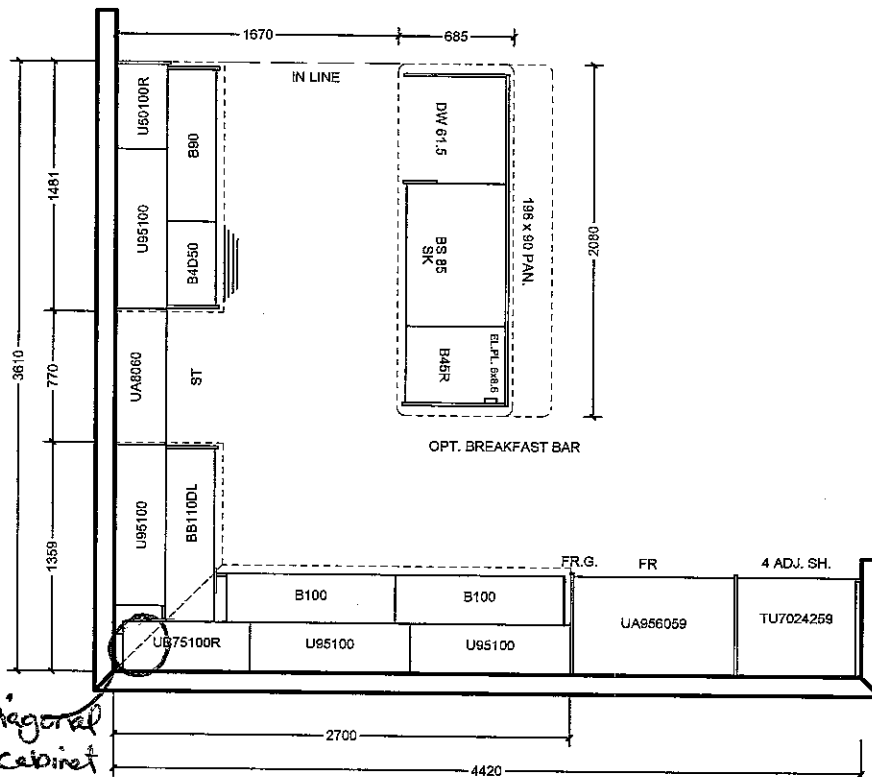

Upper Diagonal
Corner cabinet
(no glass)

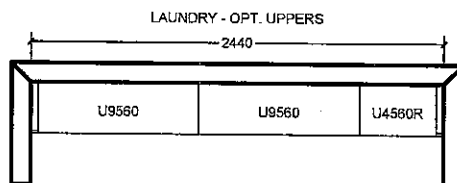
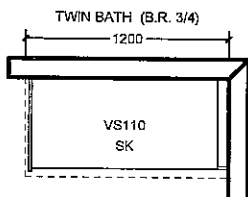
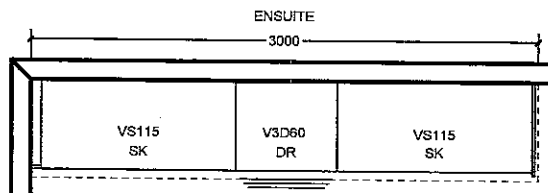
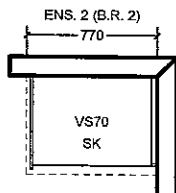

All prices subject to confirmation from head office.
This quotation is subject to the terms & conditions set out
in Cortina's Agreement of Purchase and Sale

All agreements are contingent upon strikes, accidents, and delay beyond our control.
Please provide our installer with template for sinkholes or \$150.00 will be charged for callback.

ACCEPTED DATE: _____

CUSTOMER SIGNATURE _____

SALESPERSON SIGNATURE _____

CORTINA HEAD OFFICE APPROVAL _____

ITEM A. Wood grain and colour are characteristics of the product, we cannot guarantee that such grain and colour will always match.
ITEM B. Cortina Kitchens reserves the right to alter dimensions and make technical changes without notice.

Lot 34
Jan 9, 17

NS

GP

CORTINA

KITCHENS INC.

70 Regina Road Woodbridge ON L4L 8L6
905-264-6464

INFORMATION - PVC DOORS

Builder: Gold Park Homes Project: Encore Lot #: 34

All cabinets with PVC (Thermofoil) Doors come with melamine gables, panels and kick. The doors, crown moulding and light valance are PVC wrapped. Open shelves incorporated in design will only be available with melamine interiors. There will be variations in colour shades between the PVC parts (doors, crown and Light valance) and the melamine parts (open shelves, Gables, Panels and Kick) due to the difference in material.

Furring Panel with crown moulding to the ceiling is not available on all PVC door styles due to subtle variations in colour shades between the PVC parts (moulding) and the melamine parts (furring panel) due to the difference in material. Grain directions in wood grain pattern melamine, vary between the furring panel, crown moulding (horizontal) and the PVC doors (vertical).

Thank you for your understanding.

I am well informed of this information, and agree to the purchase of the above.

Purchaser: Nancy
Kangan Pruthi

Date: Jan 9th 2017

Lot 34
Jan 9, 17

NS GP

MODIFIED: 19/05/16 fd

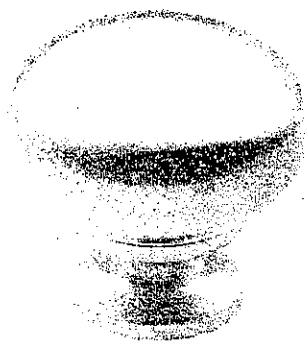

CSI-6

Twin Bath



CSI-10

Master



CSI-14

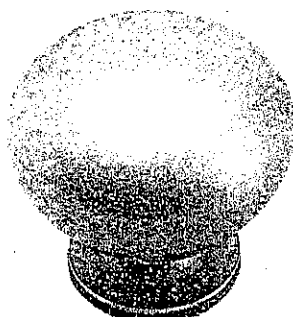

CSI-16

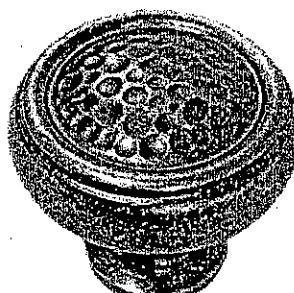

CSI-18

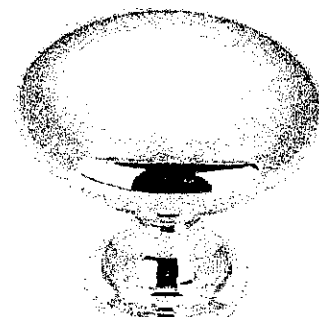

CSI-19

Laundry

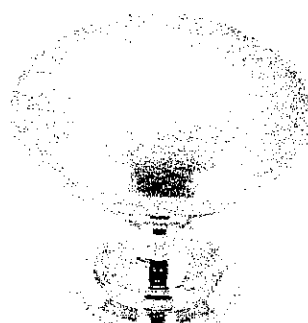

CSI-20

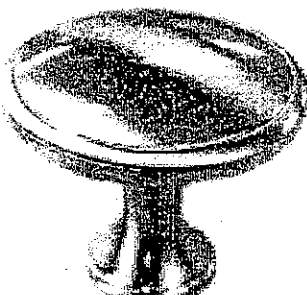

CSI-21



CSI-22

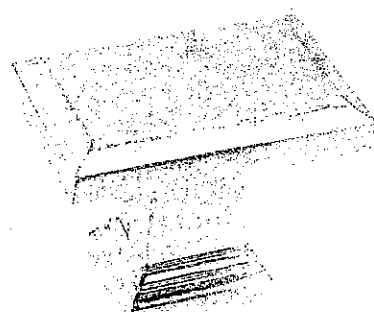

CSI-23

Ens 2

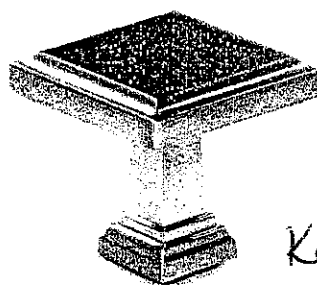

CSI-24

Kitchen

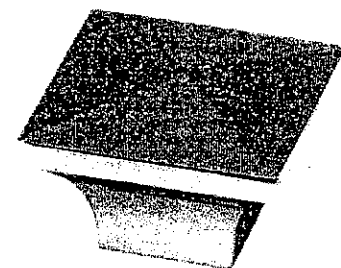

CSI-25

*NOTES:

- IMAGES ARE FOR QUICK REFERENCE PURPOSES ONLY
- ACTUAL SIZES AND FINISHES AS PER HARDWARE SAMPLE BOARD PROVIDED TO DECOR CENTRE

Lot 34
Jan. 9, 17

NS SP

20mm (3/4") Profiles



Standard
Upgrade

Standard & Upgrade Profiles
Offered with a 2 cm Surface

Kitchen

30mm (1 1/4") Profiles

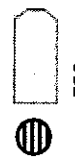
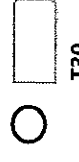

Standard
Upgrade

Standard & Upgrade Profiles
Offered with a 3 cm Surface

40mm (1 1/2") Profiles



Upgrade 1
Upgrade 2

4 mm Upgrade 1 & 2 Profiles
Offered with a 2 cm Surface

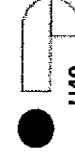

Note: All colours may not be available in 30mm at time ordered.
Vendor reserves the right to use 40mm edges (by lamination process).