

CONSTRUCTION NOTES:

COMPLIANCE PACKAGE J - O.B.C. 2012 - 2015 ENACTMENT

(UNLESS OTHERWISE NOTED)

-ALL CONSTRUCTION TO CONFORM TO THE ONTARIO BUILDING CODE (O.B.C.) AND ALL OTHER CODES AND LOCAL AUTHORITIES HAVING JURISDICTION.

-ALL DIMENSIONS GIVEN FIRST IN IMPERIAL FOLLOWED BY METRIC.

-THERMAL RESISTANCE VALUES BASED ON ZONE 1

FOOTINGS & SLABS:

TYPICAL STRIP FOOTING:

O.B.C. 9.13.5.3.

-BASED ON 14" (356mm) MAX. SUPPORTED JOIST LENGTH

-MIN. 2200psi (15MPa) CONCRETE AFTER 28 DAYS

-SHALL REST ON UNDISTURBED SOIL, ROCK OR COMPACTED GRANULAR FILL

-W/ MIN. 10psi (0.7MPa) BEARING CAPACITY

-F.T.G. TO HAVE CONTINUOUS REIN.

-F.T.G. SIZES MAY BE REDUCED FOR SOILS W/ GREATER BEARING CAPACITY (AS PER SOILS ENGINEERING REPORT)

TYPICAL STRIP FOOTING: EXTERIOR WALLS

O.B.C. 9.13.5.3.3.

-F.T.G. TO EXTEND MIN. 4'-0" (1200mm) BELOW GRADE

BRICK VENEER -1 STOREY -13" X 4" (330mm X 100mm)

-2 STOREY -18" X 6" (450mm X 150mm)

-3 STOREY -24" X 8" (600mm X 200mm)

SIDING-

-1 STOREY -10" X 4" (250mm X 100mm)

-2 STOREY -14" X 6" (350mm X 150mm)

-3 STOREY -18" X 8" (450mm X 200mm)

TYPICAL STRIP FOOTING: INTERIOR BEARING WALLS

O.B.C. 9.13.5.3.4.

-1 STOREY MASONRY -16" X 4" (410mm X 100mm)

-1 STOREY STUD -12" X 4" (300mm X 100mm)

-2 STOREY STUD -16" X 6" (400mm X 200mm)

-2 STOREY STUD -18" X 8" (450mm X 200mm)

-3 STOREY MASONRY -36" X 14" (900mm X 350mm)

-3 STOREY STUD -24" X 8" (600mm X 200mm)

STEP FOOTING:

O.B.C. 9.13.5.3.9.

-22" (560mm) MAX. VERTICAL RISE & 23 5/8" (600mm) MIN. HORIZONTAL RUN.

DRAINAGE SLOPE OR PIPE

O.B.C. 9.14.3.

-4" (100mm) MIN. DIA. LAY ON UNDISTURBED OR WELL COMPACTED SOIL

-W/ TOP OF TILE OR PIPE TO BE BELOW BOTTOM OF FLR. SLAB.

-COVER TOP & SIDES OF TILE OR PIPE W/ 5" (125mm) OF CRUSHED STONE OR OTHER COURSE CLEAN GRANULAR MATERIAL

-W/ MIN. 1" (25mm) OF CRUSHED STONE OR OTHER COURSE CLEAN GRANULAR MATERIAL

-W/ MIN. 1" (25mm) OF CRUSHED STONE OR OTHER COURSE CLEAN GRANULAR MATERIAL

-W/ MIN. 1" (25mm) OF CRUSHED STONE OR OTHER COURSE CLEAN GRANULAR MATERIAL

-W/ MIN. 1" (25mm) OF CRUSHED STONE OR OTHER COURSE CLEAN GRANULAR MATERIAL

-W/ MIN. 1" (25mm) OF CRUSHED STONE OR OTHER COURSE CLEAN GRANULAR MATERIAL

-W/ MIN. 1" (25mm) OF CRUSHED STONE OR OTHER COURSE CLEAN GRANULAR MATERIAL

-W/ MIN. 1" (25mm) OF CRUSHED STONE OR OTHER COURSE CLEAN GRANULAR MATERIAL

-W/ MIN. 1" (25mm) OF CRUSHED STONE OR OTHER COURSE CLEAN GRANULAR MATERIAL

-W/ MIN. 1" (25mm) OF CRUSHED STONE OR OTHER COURSE CLEAN GRANULAR MATERIAL

-W/ MIN. 1" (25mm) OF CRUSHED STONE OR OTHER COURSE CLEAN GRANULAR MATERIAL

-W/ MIN. 1" (25mm) OF CRUSHED STONE OR OTHER COURSE CLEAN GRANULAR MATERIAL

-W/ MIN. 1" (25mm) OF CRUSHED STONE OR OTHER COURSE CLEAN GRANULAR MATERIAL

-W/ MIN. 1" (25mm) OF CRUSHED STONE OR OTHER COURSE CLEAN GRANULAR MATERIAL

-W/ MIN. 1" (25mm) OF CRUSHED STONE OR OTHER COURSE CLEAN GRANULAR MATERIAL

-W/ MIN. 1" (25mm) OF CRUSHED STONE OR OTHER COURSE CLEAN GRANULAR MATERIAL

-W/ MIN. 1" (25mm) OF CRUSHED STONE OR OTHER COURSE CLEAN GRANULAR MATERIAL

-W/ MIN. 1" (25mm) OF CRUSHED STONE OR OTHER COURSE CLEAN GRANULAR MATERIAL

-W/ MIN. 1" (25mm) OF CRUSHED STONE OR OTHER COURSE CLEAN GRANULAR MATERIAL

-W/ MIN. 1" (25mm) OF CRUSHED STONE OR OTHER COURSE CLEAN GRANULAR MATERIAL

-W/ MIN. 1" (25mm) OF CRUSHED STONE OR OTHER COURSE CLEAN GRANULAR MATERIAL

-W/ MIN. 1" (25mm) OF CRUSHED STONE OR OTHER COURSE CLEAN GRANULAR MATERIAL

-W/ MIN. 1" (25mm) OF CRUSHED STONE OR OTHER COURSE CLEAN GRANULAR MATERIAL

-W/ MIN. 1" (25mm) OF CRUSHED STONE OR OTHER COURSE CLEAN GRANULAR MATERIAL

-W/ MIN. 1" (25mm) OF CRUSHED STONE OR OTHER COURSE CLEAN GRANULAR MATERIAL

-W/ MIN. 1" (25mm) OF CRUSHED STONE OR OTHER COURSE CLEAN GRANULAR MATERIAL

-W/ MIN. 1" (25mm) OF CRUSHED STONE OR OTHER COURSE CLEAN GRANULAR MATERIAL

-W/ MIN. 1" (25mm) OF CRUSHED STONE OR OTHER COURSE CLEAN GRANULAR MATERIAL

-W/ MIN. 1" (25mm) OF CRUSHED STONE OR OTHER COURSE CLEAN GRANULAR MATERIAL

-W/ MIN. 1" (25mm) OF CRUSHED STONE OR OTHER COURSE CLEAN GRANULAR MATERIAL

-W/ MIN. 1" (25mm) OF CRUSHED STONE OR OTHER COURSE CLEAN GRANULAR MATERIAL

-W/ MIN. 1" (25mm) OF CRUSHED STONE OR OTHER COURSE CLEAN GRANULAR MATERIAL

-W/ MIN. 1" (25mm) OF CRUSHED STONE OR OTHER COURSE CLEAN GRANULAR MATERIAL

-W/ MIN. 1" (25mm) OF CRUSHED STONE OR OTHER COURSE CLEAN GRANULAR MATERIAL

-W/ MIN. 1" (25mm) OF CRUSHED STONE OR OTHER COURSE CLEAN GRANULAR MATERIAL

-W/ MIN. 1" (25mm) OF CRUSHED STONE OR OTHER COURSE CLEAN GRANULAR MATERIAL

-W/ MIN. 1" (25mm) OF CRUSHED STONE OR OTHER COURSE CLEAN GRANULAR MATERIAL

-W/ MIN. 1" (25mm) OF CRUSHED STONE OR OTHER COURSE CLEAN GRANULAR MATERIAL

-W/ MIN. 1" (25mm) OF CRUSHED STONE OR OTHER COURSE CLEAN GRANULAR MATERIAL

-W/ MIN. 1" (25mm) OF CRUSHED STONE OR OTHER COURSE CLEAN GRANULAR MATERIAL

-W/ MIN. 1" (25mm) OF CRUSHED STONE OR OTHER COURSE CLEAN GRANULAR MATERIAL

-W/ MIN. 1" (25mm) OF CRUSHED STONE OR OTHER COURSE CLEAN GRANULAR MATERIAL

-W/ MIN. 1" (25mm) OF CRUSHED STONE OR OTHER COURSE CLEAN GRANULAR MATERIAL

-W/ MIN. 1" (25mm) OF CRUSHED STONE OR OTHER COURSE CLEAN GRANULAR MATERIAL

-W/ MIN. 1" (25mm) OF CRUSHED STONE OR OTHER COURSE CLEAN GRANULAR MATERIAL

-W/ MIN. 1" (25mm) OF CRUSHED STONE OR OTHER COURSE CLEAN GRANULAR MATERIAL

-W/ MIN. 1" (25mm) OF CRUSHED STONE OR OTHER COURSE CLEAN GRANULAR MATERIAL

-W/ MIN. 1" (25mm) OF CRUSHED STONE OR OTHER COURSE CLEAN GRANULAR MATERIAL

-W/ MIN. 1" (25mm) OF CRUSHED STONE OR OTHER COURSE CLEAN GRANULAR MATERIAL

-W/ MIN. 1" (25mm) OF CRUSHED STONE OR OTHER COURSE CLEAN GRANULAR MATERIAL

-W/ MIN. 1" (25mm) OF CRUSHED STONE OR OTHER COURSE CLEAN GRANULAR MATERIAL

-W/ MIN. 1" (25mm) OF CRUSHED STONE OR OTHER COURSE CLEAN GRANULAR MATERIAL

-W/ MIN. 1" (25mm) OF CRUSHED STONE OR OTHER COURSE CLEAN GRANULAR MATERIAL

-W/ MIN. 1" (25mm) OF CRUSHED STONE OR OTHER COURSE CLEAN GRANULAR MATERIAL

-W/ MIN. 1" (25mm) OF CRUSHED STONE OR OTHER COURSE CLEAN GRANULAR MATERIAL

-W/ MIN. 1" (25mm) OF CRUSHED STONE OR OTHER COURSE CLEAN GRANULAR MATERIAL

-W/ MIN. 1" (25mm) OF CRUSHED STONE OR OTHER COURSE CLEAN GRANULAR MATERIAL

-W/ MIN. 1" (25mm) OF CRUSHED STONE OR OTHER COURSE CLEAN GRANULAR MATERIAL

-W/ MIN. 1" (25mm) OF CRUSHED STONE OR OTHER COURSE CLEAN GRANULAR MATERIAL

-W/ MIN. 1" (25mm) OF CRUSHED STONE OR OTHER COURSE CLEAN GRANULAR MATERIAL

-W/ MIN. 1" (25mm) OF CRUSHED STONE OR OTHER COURSE CLEAN GRANULAR MATERIAL

-W/ MIN. 1" (25mm) OF CRUSHED STONE OR OTHER COURSE CLEAN GRANULAR MATERIAL

-W/ MIN. 1" (25mm) OF CRUSHED STONE OR OTHER COURSE CLEAN GRANULAR MATERIAL

-W/ MIN. 1" (25mm) OF CRUSHED STONE OR OTHER COURSE CLEAN GRANULAR MATERIAL

-W/ MIN. 1" (25mm) OF CRUSHED STONE OR OTHER COURSE CLEAN GRANULAR MATERIAL

-W/ MIN. 1" (25mm) OF CRUSHED STONE OR OTHER COURSE CLEAN GRANULAR MATERIAL

-W/ MIN. 1" (25mm) OF CRUSHED STONE OR OTHER COURSE CLEAN GRANULAR MATERIAL

-W/ MIN. 1" (25mm) OF CRUSHED STONE OR OTHER COURSE CLEAN GRANULAR MATERIAL

-W/ MIN. 1" (25mm) OF CRUSHED STONE OR OTHER COURSE CLEAN GRANULAR MATERIAL

-W/ MIN. 1" (25mm) OF CRUSHED STONE OR OTHER COURSE CLEAN GRANULAR MATERIAL

-W/ MIN. 1" (25mm) OF CRUSHED STONE OR OTHER COURSE CLEAN GRANULAR MATERIAL

-W/ MIN. 1" (25mm) OF CRUSHED STONE OR OTHER COURSE CLEAN GRANULAR MATERIAL

-W/ MIN. 1" (25mm) OF CRUSHED STONE OR OTHER COURSE CLEAN GRANULAR MATERIAL

-W/ MIN. 1" (25mm) OF CRUSHED STONE OR OTHER COURSE CLEAN GRANULAR MATERIAL

-W/ MIN. 1" (25mm) OF CRUSHED STONE OR OTHER COURSE CLEAN GRANULAR MATERIAL

-W/ MIN. 1" (25mm) OF CRUSHED STONE OR OTHER COURSE CLEAN GRANULAR MATERIAL

-W/ MIN. 1" (25mm) OF CRUSHED STONE OR OTHER COURSE CLEAN GRANULAR MATERIAL

-W/ MIN. 1" (25mm) OF CRUSHED STONE OR OTHER COURSE CLEAN GRANULAR MATERIAL

-W/ MIN. 1" (25mm) OF CRUSHED STONE OR OTHER COURSE CLEAN GRANULAR MATERIAL

-W/ MIN. 1" (25mm) OF CRUSHED STONE OR OTHER COURSE CLEAN GRANULAR MATERIAL

-W/ MIN. 1" (25mm) OF CRUSHED STONE OR OTHER COURSE CLEAN GRANULAR MATERIAL

-W/ MIN. 1" (25mm) OF CRUSHED STONE OR OTHER COURSE CLEAN GRANULAR MATERIAL

-W/ MIN. 1" (25mm) OF CRUSHED STONE OR OTHER COURSE CLEAN GRANULAR MATERIAL

-W/ MIN. 1" (25mm) OF CRUSHED STONE OR OTHER COURSE CLEAN GRANULAR MATERIAL

-W/ MIN. 1" (25mm) OF CRUSHED STONE OR OTHER COURSE CLEAN GRANULAR MATERIAL

-W/ MIN. 1" (25mm) OF CRUSHED STONE OR OTHER COURSE CLEAN GRANULAR MATERIAL

-W/ MIN. 1" (25mm) OF CRUSHED STONE OR OTHER COURSE CLEAN GRANULAR MATERIAL

-W/ MIN. 1" (25mm) OF CRUSHED STONE OR OTHER COURSE CLEAN GRANULAR MATERIAL

-W/ MIN. 1" (25mm) OF CRUSHED STONE OR OTHER COURSE CLEAN GRANULAR MATERIAL

-W/ MIN. 1" (25mm) OF CRUSHED STONE OR OTHER COURSE CLEAN GRANULAR MATERIAL

-W/ MIN. 1" (25mm) OF CRUSHED STONE OR OTHER COURSE CLEAN GRANULAR MATERIAL

-W/ MIN. 1" (25mm) OF CRUSHED STONE OR OTHER COURSE CLEAN GRANULAR MATERIAL

-W/ MIN. 1" (25mm) OF CRUSHED STONE OR OTHER COURSE CLEAN GRANULAR MATERIAL

-W/ MIN. 1" (25mm) OF CRUSHED STONE OR OTHER COURSE CLEAN GRANULAR MATERIAL

-W/ MIN. 1" (25mm) OF CRUSHED STONE OR OTHER COURSE CLEAN GRANULAR MATERIAL

-W/ MIN. 1" (25mm) OF CRUSHED STONE OR OTHER COURSE CLEAN GRANULAR MATERIAL

-W/ MIN. 1" (25mm) OF CRUSHED STONE OR OTHER COURSE CLEAN GRANULAR MATERIAL

-W/ MIN. 1" (25mm) OF CRUSHED STONE OR OTHER COURSE CLEAN GRANULAR MATERIAL

-W/ MIN. 1" (25mm) OF CRUSHED STONE OR OTHER COURSE CLEAN GRANULAR MATERIAL

-W/ MIN. 1" (25mm) OF CRUSHED STONE OR OTHER COURSE CLEAN GRANULAR MATERIAL

-W/ MIN. 1" (25mm) OF CRUSHED STONE OR OTHER COURSE CLEAN GRANULAR MATERIAL

-W/ MIN. 1" (25mm) OF CRUSHED STONE OR OTHER COURSE CLEAN GRANULAR MATERIAL

-W/ MIN. 1" (25mm) OF CRUSHED STONE OR OTHER COURSE CLEAN GRANULAR MATERIAL

-W/ MIN. 1" (25mm) OF CRUSHED STONE OR OTHER COURSE CLEAN GRANULAR MATERIAL

-W/ MIN. 1" (25mm) OF CRUSHED STONE OR OTHER COURSE CLEAN GRANULAR MATERIAL

-W/ MIN. 1" (25mm) OF CRUSHED STONE OR OTHER COURSE CLEAN GRANULAR MATERIAL

-W/ MIN. 1" (25mm) OF CRUSHED STONE OR OTHER COURSE CLEAN GRANULAR MATERIAL

-W/ MIN. 1" (25mm) OF CRUSHED STONE OR OTHER COURSE CLEAN GRANULAR MATERIAL

-W/ MIN. 1" (25mm) OF CRUSHED STONE OR OTHER COURSE CLEAN GRANULAR MATERIAL

-W/ MIN. 1" (25mm) OF CRUSHED STONE OR OTHER COURSE CLEAN GRANULAR MATERIAL

-W/ MIN. 1" (25mm) OF CRUSHED STONE OR OTHER COURSE CLEAN GRANULAR MATERIAL

-W/ MIN. 1" (25mm) OF CRUSHED STONE OR OTHER COURSE CLEAN GRANULAR MATERIAL

-W/ MIN. 1" (25mm) OF CRUSHED STONE OR OTHER COURSE CLEAN GRANULAR MATERIAL

-W/ MIN. 1" (25mm) OF CRUSHED STONE OR OTHER COURSE CLEAN GRANULAR MATERIAL

-W/ MIN. 1" (25mm) OF CRUSHED STONE OR OTHER COURSE CLEAN GRANULAR MATERIAL

-W/ MIN. 1" (25mm) OF CRUSHED STONE OR OTHER COURSE CLEAN GRANULAR MATERIAL

-W/ MIN. 1" (25mm) OF CRUSHED STONE OR OTHER COURSE CLEAN GRANULAR MATERIAL

-W/ MIN. 1" (25mm) OF CRUSHED STONE OR OTHER COURSE CLEAN GRANULAR MATERIAL

-W/ MIN. 1" (25mm) OF CRUSHED STONE OR OTHER COURSE CLEAN GRANULAR MATERIAL

-W/ MIN. 1" (25mm) OF CRUSHED STONE OR OTHER COURSE CLEAN GRANULAR MATERIAL

-W/ MIN. 1" (25mm) OF CRUSHED STONE OR OTHER COURSE CLEAN GRANULAR MATERIAL

-W/ MIN. 1" (25mm) OF CRUSHED STONE OR OTHER COURSE CLEAN GRANULAR MATERIAL

DAMP/PROOFING & WATERPROOFING:

DAMP/PROOF THE EXTERIOR FACE OF WALL BELOW GRADE AS PER O.B.C. 9.13.5.2.

-WHERE INSULATION EXTENDS TO MORE THAN 4'-0" (1400mm) BELOW GRADE, A FEN. WALL DRAINAGE LAYER SHALL BE PROVIDED IN CONFORMANCE TO O.B.C. 9.14.2.1.2.(3) (4).

-FINISHED BASEMENTS SHALL HAVE INTERIOR DAMP/PROOFING EXTENDING FROM SLAB TO GRADE LEVEL & SHALL CONFORM TO O.B.C. 9.13.5.3.(3).

-WHERE HYDROSTATIC PRESSURE OCCURS, FEN. WALLS SHALL BE WATERPROOFED AS PER O.B.C. 9.13.3.

-WALLS THAT ARE WATERPROOFED DO NOT REQUIRE DAMP/PROOFING.

FOUNDATION WALLS & UNSUPPORTED OPENINGS:

O.B.C. 9.23.2.

-2-20MM BARS IN TOP PORTION OF WALL (10'-0" TO 10'-0" OPENING)

-W/ MIN. 10psi (0.7MPa) BEARING CAPACITY

-2-20MM BARS IN TOP PORTION OF WALL (10'-0" TO 15'-0" OPENING)

-BARS STAKED VERTICALLY AT INTERIOR FACE OF WALL

-BARS TO HAVE MIN. 1" (25mm) CONCRETE COVER

-BARS TO EXTEND 2'-0" (600mm) BEYOND BOTH SIDES OF OPENING.

FRAME WALL CONSTRUCTION:

O.B.C. 9.23.2.

-SIDING OR STUCCO AS PER ELEVATIONS, MIN. 7/8" (200mm) FROM FINISHED GRADE (O.B.C. 9.28.1.4. & 9.27.2).

-WALL SHEATHING MEMBRANE AS PER O.B.C. 9.23.2.1.

-1/4" (6mm) PLYWOOD (EXTERIOR TYPE) OR EQUIVALENT AS PER O.B.C. 9.23.2.1.

-2" X 6" (38mm X 140mm) WOOD STUDS @ 16" (400mm) O.C.

-MIN. R22 (RSI 3.87) INSULATION (ZONE 1, O.B.C. 1.2.1.1.2.A).

-CONTINUOUS AIR/VAPOR BARRIER IN CONFORMANCE W/ O.B.C. 9.25.3. & 9.25.4.

-NOTE: SUPPORT FOR 2 + 3 FLOORS ABOVE - O.B.C. 1.2.9.23.10.1. =

-FOR 3 FLOORS SUPPORTED ABOVE 2" X 6" (38mm X 140mm) STUDS ARE REQUIRED TO BE SPACED @ 12" (300mm) O.C.

REG. FOR FIRE RATING: LESS THAN 4'-0" LIMITING DISTANCE:

O.B.C. 9.23.3. WALL - EW1B (STC = N/A, FIRE = 45 MIN)

FOR 45 MINUTE FIRE RATED WALL REQUIREMENTS SUBSTITUTE AND/OR ADD THE FOLLOWING MATERIALS:

-REPLACE R22 (RSI 3.87) INSULATION WITH R22 (RSI 3.87) ABSORPTIVE INSULATING MATERIAL WITH A MASS OF AT LEAST 4.8 kg/sq. m.

-REPLACE 1/2" (12.7mm) INTERIOR GYPSUM BOARD W/ 1/2" (12.7mm) TYPE 'X' GYPSUM BOARD.

REG. FOR FIRE RATING: LESS THAN 2'-0" LIMITING DISTANCE:

O.B.C. 9.23.3. WALL - EW1B (STC = N/A, FIRE = 45 MIN)

FOR 45 MINUTE FIRE RATED WALL REQUIREMENTS SUBSTITUTE THE FOLLOWING MATERIALS:

-REPLACE R22 (RSI 3.87) INSULATION WITH R22 (RSI 3.87) ABSORPTIVE INSULATING MATERIAL WITH A MASS OF AT LEAST 4.8 kg/sq. m.

-REPLACE 1/2" (12.7mm) INTERIOR GYPSUM BOARD W/ 1/2" (12.7mm) TYPE 'X' GYPSUM BOARD.

REG. FOR FIRE RATING: LESS THAN 4'-0" LIMITING DISTANCE:

O.B.C. 9.23.3. WALL - EW1B (STC = N/A, FIRE = 45 MIN)

FOR 45 MINUTE FIRE RATED WALL REQUIREMENTS SUBSTITUTE AND/OR ADD THE FOLLOWING MATERIALS:

-REPLACE R22 (RSI 3.87) INSULATION WITH R22 (RSI 3.87) ABSORPTIVE INSULATING MATERIAL WITH A MASS OF AT LEAST 4.8 kg/sq. m.

-REPLACE 1/2" (12.7mm) INTERIOR GYPSUM BOARD W/ 1/2" (12.7mm) TYPE 'X' GYPSUM BOARD.

REG. FOR FIRE RATING: LESS THAN 2'-0" LIMITING DISTANCE:

O.B.C. 9.23.3. WALL - EW1B (STC = N/A, FIRE = 45 MIN)

FOR 45 MINUTE FIRE RATED WALL REQUIREMENTS SUBSTITUTE THE FOLLOWING MATERIALS:

-REPLACE R22 (RSI 3.87) INSULATION WITH R22 (RSI 3.87) ABSORPTIVE INSULATING MATERIAL WITH A MASS OF AT LEAST 4.8 kg/sq. m.

-REPLACE 1/2" (12.7mm) INTERIOR GYPSUM BOARD W/ 1/2" (12.7mm) TYPE 'X' GYPSUM BOARD.

REG. FOR FIRE RATING: LESS THAN 4'-0" LIMITING DISTANCE:

O.B.C. 9.23.3. WALL - EW1B (STC = N/A, FIRE = 45 MIN)

FOR 45 MINUTE FIRE RATED WALL REQUIREMENTS SUBSTITUTE AND/OR ADD THE FOLLOWING MATERIALS:

-REPLACE R22 (RSI 3.87) INSULATION WITH R22 (RSI 3.87) ABSORPTIVE INSULATING MATERIAL WITH A MASS OF AT LEAST 4.8 kg/sq. m.

-REPLACE 1/2" (12.7mm) INTERIOR GYPSUM BOARD W/ 1/2" (12.7mm) TYPE 'X' GYPSUM BOARD.

REG. FOR FIRE RATING: LESS THAN 2'-0" LIMITING DISTANCE:

O.B.C. 9.23.3. WALL - EW1B (STC = N/A, FIRE = 45 MIN)

FOR 45 MINUTE FIRE RATED WALL REQUIREMENTS SUBSTITUTE THE FOLLOWING MATERIALS:

-REPLACE R22 (RSI 3.87) INSULATION WITH R22 (RSI

APPROVED BY: [Signature] DATE: Jan. 17, 2017
This stamp certifies compliance with the applicable
Design Guidelines only and bears no further
professional responsibility.



SIGNATURE:

A circular professional seal for a Licensed Professional Engineer in the Province of Ontario. The seal features a stylized 'E' in the background. Overlaid on the 'E' is the name 'A. KONG' and the license number '100184942'. The text 'LICENSED PROFESSIONAL ENGINEER' is written along the top arc, and 'PROVINCE OF ONTARIO' is written along the bottom arc.

[illegible]

A1

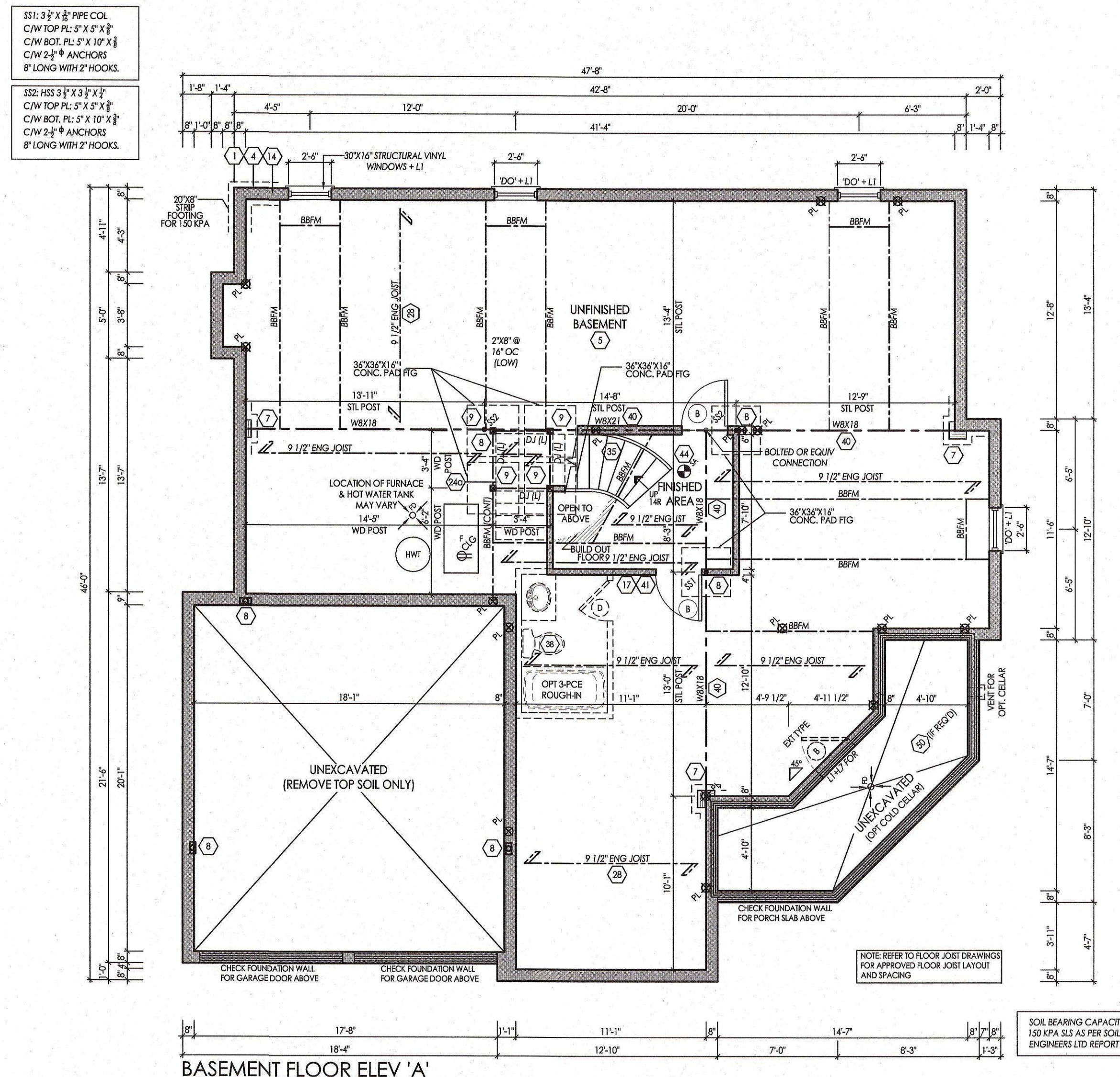

APPROVED BY: [Signature] DATE: Jan. 17, 2017
This stamp certifies compliance with the applicable
Design Guidelines only and bears no further
professional responsibility.

SIGNATURE: _____

client

project

Brampton

model

[illegible]

project # 13098

scale

© 2006 The Authors
Journal compilation © 2006 Blackwell Publishing Ltd

page

A2

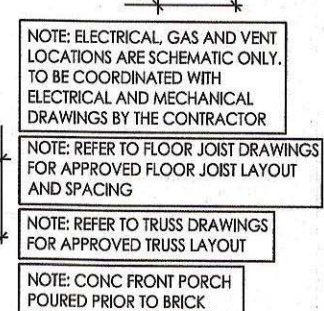

This is to certify that these plans comply with the applicable Architectural Design Guidelines approved by the City of BRAMPTON.

APPROVED BY: [Signature] DATE: Jan. 17, 2017
This stamp certifies compliance with the applicable
Design Guidelines only and bears no further
professional responsibility.



I, JULIO PINZON DECLARE THAT I HAVE REVIEWED AND TAKEN DESIGN RESPONSIBILITY FOR THE DESIGN WORK ON BEHALF OF **RN DESIGN LTD.** UNDER DIVISION C, PART-3 SUBSECTION-3.2.4 OF THE BUILDING CODE. I AM QUALIFIED AND THE FIRM IS REGISTERED IN THE APPROPRIATE CLASSES / CATEGORIES.

QUALIFIED DESIGNER BCIN: 3868
FIRM BCIN: 26995
DATE: 11/13

SIGNATURE: _____

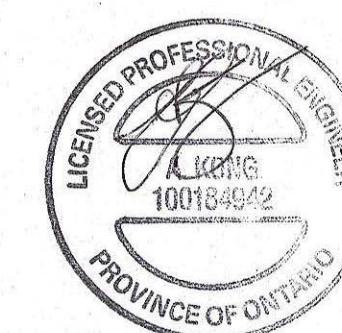

FOR STRUCTURAL ONLY EXCLUDING
ENGINEERED ROOF TRUSS, FLOOR
JOIST & FLOOR LVL BEAM DESIGNS

[illegible]

page

A3

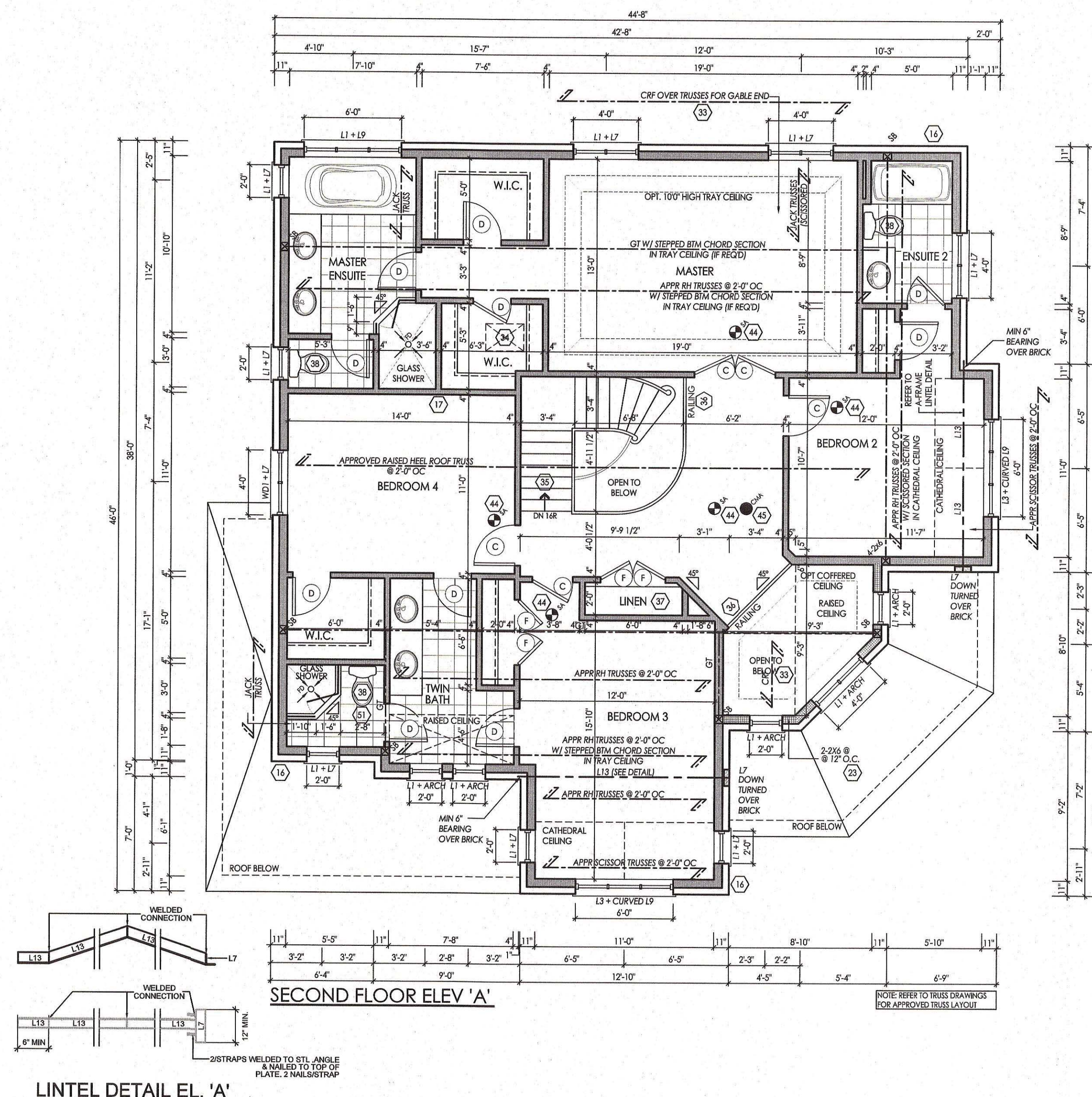



NOTE: REFER TO STREET-SCAPES FOR POSSIBLE MINOR CHANGES DUE TO GRADING CONDITIONS

APPROVED BY: [Signature] DATE: Jan. 17, 2017
This stamp certifies compliance with the applicable
Design Guidelines only and bears no further
professional responsibility.

SIGNATURE:



TOP OF SLAB

TOTAL PERIPHERAL WALL AREA	3439.81	SF	319.56	m²
FRONT GLAZING AREA	134.67	SF	12.51	m²
LEFT SIDE GLAZING AREA	48	SF	4.46	m²
RIGHT SIDE GLAZING AREA	166.70	SF	15.49	m²
REAR GLAZING AREA	219.66	SF	20.41	m²
TOTAL GLAZING AREA	569.03	SF	52.86	m²
TOTAL GLAZING PERCENTAGE	16.54	%		

page

A4

APPROVED BY: [Signature] DATE: Jan. 17, 2017
This stamp certifies compliance with the applicable
Design Guidelines only and bears no further
professional responsibility.

QUALIFIED DESIGNER BOIN: 50600
FIRM BOIN: 20095
DATE: 12/1/94
SIGNATURE: [Signature]

[illegible]

A5

DN (Standard Error) = 0.1466 19000 15000 at 1.250 plus StatSoft Nov 28 2015 8:11:52

This is to certify that these plans comply with the applicable Architectural Design Guidelines approved by the City of BRAMPTON.

APPROVED BY: [Signature] DATE: Jan. 17, 2017
This stamp certifies compliance with the applicable
Design Guidelines only and bears no further
professional responsibility.

QUALIFIED DESIGNER BOIN: _____
FIRM BOIN: _____
DATE: _____

38688
28995

12.17.2

SIGNATURE: _____

[illegible]

A6

This is to certify that these plans comply with the applicable Architectural Design Guidelines approved by the City of BRAMPTON.

APPROVED BY: [Signature] DATE: Jan. 17, 2017
This stamp certifies compliance with the applicable
Design Guidelines only and bears no further
professional responsibility.

QUALIFIED DESIGNER BCIN: 38688
FIRM BCIN: 26895
DATE: 11.17.01
SIGNATURE: _____

[illegible]

A7