



CONSTRUCTION SUMMARY

Brampton Encore - 30 - 1 - 38-4 Elev.A VIVALDI
CENTRAL VAC AND WIRING

Inv.527	1 - GARAGE: INSTALL ROUGH-IN FOR EXTRA SECURITY KEY PAD. TO GO BY MANDOOR.
Line6353	Note:
31May16 / 20Sep16	

CERAMIC

Inv.1,129	1 - TWIN BATH: INSTALL Floor Upgrade 3 Bath 3 4 Floor
Line16614	Note:
24Jan17 / 24Feb17	
Inv.1,129	1 - FOYER: INSTALL Floor Upgrade 4 Foyer Vestibule Floor
Line16587	Note:
24Jan17 / 24Feb17	
Inv.1,129	1 - KITCHEN: INSTALL Floor Upgrade 4 Kitchen and Breakfast Floor
Line16588	Note:
24Jan17 / 24Feb17	
Inv.1,129	1 - POWDER ROOM: INSTALL Floor Upgrade 4 Powder Room Floor
Line16589	Note:
24Jan17 / 24Feb17	
Inv.1,129	1 - MASTER ENSUITE: INSTALL Floor Upgrade 4 Ensuite Bath Floor
Line16590	Note:
24Jan17 / 24Feb17	
Inv.1,129	1 - MASTER ENSUITE: INSTALL Floor Upgrade 2 Ensuite Bath 2 Rows
Line16591	Note: *TO BE LAID HORIZONTALLY, STACKED
24Jan17 / 24Feb17	
Inv.1,129	1 - MASTER ENSUITE: INSTALL Floor Upgrade 2 Ensuite Bath Shower Ceiling
Line16592	Note: *TO BE LAID HORIZONTALLY, STACKED
24Jan17 / 24Feb17	
Inv.1,129	1 - MASTER ENSUITE: INSTALL Floor Upgrade 2 Ensuite Bath Shower Walls
Line16593	Note: *TO BE LAID HORIZONTALLY, STACKED
24Jan17 / 24Feb17	
Inv.1,129	1 - MASTER ENSUITE: INSTALL Floor Upgrade 2 Ensuite Bath Tub Deck Face
Line16594	Note: *TO BE LAID HORIZONTALLY, STACKED
24Jan17 / 24Feb17	
Inv.1,129	1 - MASTER ENSUITE: INSTALL Floor Upgrade 2 Ensuite Bath Tub Deck Top
Line16595	Note: *TO BE LAID HORIZONTALLY, STACKED
24Jan17 / 24Feb17	
Inv.1,129	1 - MASTER ENSUITE: SHOWER STALL- INSTALL 4TH UPG. FEATURE WALL IN SHOWER STALL. TO BE 24" WIDE FROM FINISHED FLOOR TO CEILING, APPROX. 8' FEET HIGH. SEE FLOOR PLAN FOR LOCATION
Line16596	Note:
24Jan17 / 24Feb17	
Inv.1,129	1 - MASTER ENSUITE-SHOWER STALL FLOOR: INSTALL UPG. 2 TILES ON SHOWER FLOOR
Line16597	Note:
24Jan17 / 24Feb17	

Brampton Encore - 30 - 1 - 38-4 Elev.A VIVALDI

Inv.1,129	1 - ENSUITE 2: INSTALL Floor Upgrade 1 Bath 2 Tub with Ceiling
Line16599	Note:
24Jan17 / 24Feb17	
Inv.1,129	1 - ENSUITE 2: INSTALL Floor Upgrade 2 Bath 2 Floor
Line16613	Note:
24Jan17 / 24Feb17	

ELECTRICAL

Inv.527	1 - TELEPHONE AND CABLE ROUGH-IN LOCATIONS
Line6352	Note:
31May16 / 20Sep16	
Inv.527	1 - KITCHEN: INSTALL 220V WALL RECEPTICAL ON DEDICATED CIRCUIT- FOR 4 WIRE BUILT-IN WALL OVEN - FOR FUTURE MICRO/WALL OVEN UNIT. PURCHASER IS AWARE THAT THEY MUST PURCHASE THE APPROPRIATE CABINETRY AT THE TIME OF COLOURS. SEE SKETCH.
Line6354	Note:
31May16 / 20Sep16	
Inv.527	1 - KITCHEN: INSTALL 110V WALL RECEPTACLE ON DEDICATED CIRCUIT - FOR MICROWAVE - MICROWAVE NOT INCLUDED. FOR FUTURE MICRO/WALL OVEN UNIT. PURCHASER IS AWARE THAT THEY MUST PURCHASE THE APPROPRIATE CABINETRY AT THE TIME OF COLOURS. SEE SKETCH
Line6355	Note:
31May16 / 20Sep16	
Inv.527	2 - KITCHEN: ISLAND- INSTALL TWO (X2) 110V RECEPTACLES ON NORMAL CIRCUIT-ON KITCHEN ISLAND. ONE ON EACH END. SEE SKETCH
Line6356	Note:
31May16 / 20Sep16	
Inv.527	1 - DINING ROOM: INSTALL 110V WALL RECEPTACLE ON NORMAL CIRCUIT- IN DINING ROOM, SEE SKETCH
Line6357	Note:
31May16 / 20Sep16	
Inv.527	1 - KITCHEN: RELOCATE STANDARD FIXTURE - TO GO ABOVE KITCHEN ISLAND
Line6358	Note:
31May16 / 20Sep16	
Inv.527	1 - MAIN HALL: INSTALL ROUGH - IN WALL OUTLET & SWITCH (WITH COVER PLATE) - DOES NOT INCLUDE FIXTURE - FOR FUTURE WALL SCONCE. TO GO 5'-6" OFF FINISHED FLOOR. SEE SKETCH FOR LOCATION
Line6359	Note:
31May16 / 20Sep16	
Inv.527	1 - UPPER HALL: INSTALL ROUGH - IN WALL OUTLET & SWITCH (WITH COVER PLATE) - DOES NOT INCLUDE FIXTURE -FOR FUTURE WALL SCONCE. TO GO 5'-6" OFF FINISHED FLOOR. SEE SKETCH FOR LOCATION
Line6360	Note:
31May16 / 20Sep16	
Inv.527	1 - KITCHEN: INSTALL KITCHEN CABINET STRIP VALANCE LIGHTS (UNDER CABINETS) - ROUGH - IN - DOES NOT INCLUDE (AND REQUIRES) KITCHEN UPGRADE PRICING
Line6368	Note:
31May16 / 20Sep16	

Brampton Encore - 30 - 1 - 38-4 Elev.A VIVALDI

Inv.527	1 - KITCHEN: MOVE SINK AND DISHWASHER FROM THE ISLAND INTO THE WALL CABINetry. SEE SKETCH FOR LOCATION.
	PURCHASER MAY MAKE PANTRY SMALLER BY 18" AT THE TIME OF COLOURS. PLEASE PLACE PLUMBING AND ELECTRICAL IN A WAY THAT WILL ALLOW THIS.
Line6370	Note:
31May16 / 20Sep16	

EXTERIOR COLOURS

Inv.527	1 - EXTERIOR COLOUR PACKAGE 9
Line11555	Note:
31May16 / 20Sep16	

FORMING

Inv.527	1 - EXTERIOR: INSTALL SIDE DOOR- HOME TO EXTERIOR- AS PER PLAN AND GRADE PERMITTING
Line6362	Note:
31May16 / 20Sep16	

FRAMING

Inv.527	1 - GARAGE: INSTALL MANDOOR - GARAGE TO HOUSE- AS PER PLAN AND GRADE PERMITTING
Line6361	Note: GIVEN AS PER AGREEMENT OF PURCHASE AND SALE
31May16 / 20Sep16	
Inv.527	1 - MAIN FLOOR: INSTALL FOUR (X4) STANDARD DOORS EXTENDED HEIGHT 96" (PRICE PER DOOR)- GROUND FLOOR 2 STOREY MODELS. TO GO ON POWDER ROOM, CLOSETS AND BASEMENT. SEE SKETCH
Line11557	Note:
31May16 / 20Sep16	
Inv.527	1 - BREAKFAST AREA: INSTALL GARDEN DOORS IN LIEU OF PATIO SLIDERS- 6FT X 80 INCH WITH CLEAR GLASS
Line11560	Note:
31May16 / 20Sep16	
Inv.704	1 - BEDROOM #3: DELETE WALK IN CLOSET IN BED #3 AND BUILD A NEW CLOSET, AS PER DRAWING. SEE SKETCH. ALLOWED AS PER SERGIO.
Line9408	Note:
27Jul16 / 20Sep16	
Inv.704	1 - BEDROOM #3: MOVE DOOR OF BED #3 INTO THE ROOM, AS PER DRAWING. SEE SKETCH. ALLOWED AS PER SERGIO.
Line9410	Note:
27Jul16 / 20Sep16	
Inv.704	1 - UPPER HALL: DELETE WALL IN UPPER HALL CLOSE TO STAIRCASE AND ADD STANDARD RAILING. SEE SKETCH. ALLOWED AS PER SERGIO.
Line9411	Note:
27Jul16 / 20Sep16	

GLASS AND MIRROR

Inv.527	1 - MASTER ENSUITE: CONVERT FRAMED SHOWER TO 10MM FRAMLESS SHOWER ENCLOSURE WITH DOOR AND 10MM SIDE PANEL, IN MASTER ENSUITE
Line6363	Note:
31May16 / 20Sep16	

HARDWOOD

Brampton Encore - 30 - 1 - 38-4 Elev.A VIVALDI

Inv.1,129	1 - DINING ROOM: INSTALL PREVERCO NUANCE, RED OAK 5 1/4" ESPRESSO, Upgrade 2 LEVEL I Dining
Line16602	Note:
24Jan17 / 24Feb17	
Inv.1,129	1 - FAMILY ROOM: INSTALL PREVERCO NUANCE, RED OAK 5 1/4" ESPRESSO, Upgrade 2 LEVEL I Family
Line16603	Note:
24Jan17 / 24Feb17	
Inv.1,129	1 - MAIN HALL: INSTALL PREVERCO NUANCE, RED OAK 5 1/4" ESPRESSO, Upgrade 2 LEVEL I Main Hall
Line16604	Note:
24Jan17 / 24Feb17	
Inv.1,129	1 - UPPER HALL: INSTALL PREVERCO NUANCE, RED OAK 5 1/4" ESPRESSO, Upgrade 2 LEVEL I Upper Hall
Line16605	Note: PRICE INCLUDES ADDITIONAL HARDWOOD ADDED ON 2ND FLOOR HALL FOR CLOSET AREA
24Jan17 / 24Feb17	

HVAC

Inv.527	1 - KITCHEN: INSTALL GAS LINE ROUGH -IN GROUND FLOOR - (2 STOREY MODELS)
Line6365	Note:
31May16 / 20Sep16	

INTERIOR TRIM AND DOORS

Inv.527	4 - MAIN FLOOR: INSTALL FOUR (X4) STANDARD DOORS EXTENDED HEIGHT 96" (PRICE PER DOOR)- GROUND FLOOR 2 STOREY MODELS. TO GO ON POWDER ROOM, CLOSETS AND BASEMENT. SEE SKETCH
Line6366	Note:
31May16 / 20Sep16	
Inv.1,129	1 - MAIN FLOOR: INSTALL BB & Casing Package 2 MF
Line16600	Note:
24Jan17 / 24Feb17	
Inv.1,129	1 - SECOND FLOOR: INSTALL BB & Casing Package 2 SF
Line16601	Note:
24Jan17 / 24Feb17	

KITCHEN AND BATH CABINETRY

Inv.527	1 - KITCHEN: MOVE SINK AND DISHWASHER FROM THE ISLAND INTO THE WALL CABINETRY. SEE SKETCH FOR LOCATION. PURCHASER MAY MAKE PANTRY SMALLER BY 18" AT THE TIME OF COLOURS. PLEASE PLACE PLUMBING AND ELECTRICAL IN A WAY THAT WILL ALLOW THIS.
Line11559	Note:
31May16 / 20Sep16	
Inv.1,129	1 - KITCHEN: NOTE- ELECTRICAL WAS PURCHASED FOR A BUILT-IN OVEN AND MICROWAVE UNIT, HOWEVER CABINETRY EXTRAS HAVE NOT BEEN PURCHASED. ELECTRICAL WILL BE INSTALLED AND ACCESSIBLE IN THE STANDARD CABINETS.
Line16585	Note:
24Jan17 / 24Feb17	
Inv.1,129	1 - KITCHEN: NOTE- ELECTRICAL WAS PURCHASED FOR A LIGHT VALANCE, HOWEVER CABINETRY EXTRAS HAVE NOT BEEN PURCHASED. ELECTRICAL WILL BE INSTALLED AND ACCESSIBLE UNDER THE STANDARD CABINETS
Line16586	Note:
24Jan17 / 24Feb17	

Brampton Encore - 30 - 1 - 38-4 Elev.A VIVALDI
MISC.

Inv.527	1 - BONUS PACKAGE: \$10,000.00 (INCLUDING TAXES) WORTH OF UPGRADES FROM GOLD PARK HOMES DÉCOR CENTRE IS BEING APPLIED TOWARD THE STRUCTURAL APPOINTMENT.
Line6372	Note:
31May16 / 20Sep16	
Inv.527	1 - Purchaser has attended a Structural appointment at the Decor Centre & has DECLINED any additional upgrades and accepts and acknowledges that there will be no further structural changes/additions/deletions to be made upon signing on May 31, 2016
Line6373	Note:
31May16 / 20Sep16	
Inv.527	1 - Purchasers are aware & accepts that ANY changes made to upgrades after signing this Purchasers Extra Form are subject to a minimum administration fee of \$500. PLUS a 10% holdback fee
Line6374	Note:
31May16 / 20Sep16	
Inv.704	1 - Purchaser has attended a Structural appointment at the Decor Centre & has DECLINED any additional upgrades and accepts and acknowledges that there will be no further structural changes/additions/deletions to be made upon signing on July 27, 2016
Line9412	Note:
27Jul16 / 20Sep16	
Inv.1,129	1 - Purchaser has attended a Colour appointment at the Decor Centre & has DECLINED any additional upgrades and accepts and acknowledges that there will be no further structural changes/additions/deletions to be made upon signing on January 24, 2017
Line16615	Note:
24Jan17 / 24Feb17	
Inv.1,129	1 - Purchasers are aware & accepts that ANY changes made to upgrades after signing this Purchasers Extra Form are subject to a minimum administration fee of \$500. PLUS a 10% holdback fee.
Line16616	Note:
24Jan17 / 24Feb17	

PAINTING

Inv.1,129	1 - STAIRCASE: Stain Staircase 2 Storey Model (Euroline Pickets Charged Separately)
Line16606	Note:
24Jan17 / 24Feb17	

PLUMBING

Inv.527	1 - KITCHEN: MOVE SINK AND DISHWASHER FROM THE ISLAND INTO THE WALL CABINETRY. SEE SKETCH FOR LOCATION. PURCHASER MAY MAKE PANTRY SMALLER BY 18" AT THE TIME OF COLOURS. PLEASE PLACE PLUMBING AND ELECTRICAL IN A WAY THAT WILL ALLOW THIS.
Line6369	Note: PURCHASER UNDERSTANDS THAT THERE WILL BE ADDITIONAL CHARGES TO ACCOMODATE THE SINK IN THE STANDARD CABINETRY
31May16 / 20Sep16	
Inv.527	1 - MASTER ENSUITE: INSTALL ROUGH-IN FOR RAINSHOWER HEAD- SHOWER HEAD NOT INCLUDED AND MUST BE PURCHASED AT THE TIME OF COLOUR APPOINTMENT
Line6371	Note:
31May16 / 20Sep16	
Inv.1,129	1 - MASTER ENSUITE: SHOWER HEAD INSTALL 8" SHOWER HEAD- RAINCAN HEAD 8" #RP70172 WITH 6" CEILING MOUNT ARM #RP61058
Line16617	Note:
24Jan17 / 24Feb17	

Brampton Encore - 30 - 1 - 38-4 Elev.A VIVALDI

STAIRS AND RAILINGS

Inv.1,129	1 - STAIRCASE: INSTALL EUROLINE R 6 Black
Line16607	Note: PRICE INCLUDES ADDITIONAL RAILING ADDED ON 2ND FLOOR
24Jan17 / 24Feb17	
Inv.1,129	1 - STAIRCASE: INSTALL V Groove Handrail
Line16608	Note: PRICE INCLUDES ADDITIONAL RAILING ADDED ON 2ND FLOOR
24Jan17 / 24Feb17	

WINDOWS - BASEMENT

Inv.527	4 - BASEMENT: INSTALL FOUR (X4) BASEMENT WINDOWS - UPGRADE EXISTING BASEMENT WINDOW TO 30 INCH X 24 INCH - MAY REQUIRE INSTALLATION OF WINDOW WELL
Line6364	Note:
31May16 / 20Sep16	

WINDOWS AND DOORS

Inv.527	1 - BREAKFAST AREA: INSTALL GARDEN DOORS IN LIEU OF PATIO SLIDERS- 6FT X 80 INCH WITH CLEAR GLASS
Line6367	Note: DOORS OPEN INTO BREAKFAST AREA
31May16 / 20Sep16	

Scheduled Closing Date:

Purchasers: MUHAMMAD AJMAL KURREEMBUKUS & WAR Property: 30 of Plan -

Telephone Res. / Bus: (905) 826-8967 /

Project: Fieldwalk Investments Inc.

Decor Advisor: Terri Parisani

Model and Elevation: 38-4 Elev.A VIVALDI

Layout Changes: ☒ Yes ☐ No Sketch Attached: ☒ Yes ☐ No Exterior Colour Scheme:

1. Cabinetry

	Style and Colour	Counter	Hardware
Kitchen / Breakfast	Varese(pvc)WhiteCrystal	Grigio Sardo Granite Edge: FE-20	cs1-18
Laundry Room			
Powder Room			
TWIN BATH	M500(pvc)VanillaStix	1799K-07 Ebony Fusion Laminate	cs1-23
Master Ensuite Bathroom	Varese(pvc)Mystic	8830-58 Elemental Concrete Laminate	cs1-19
Second Ensuite Bathroom (If Applicable)	P400 (pvc)WhiteCrystal	4926K-07 Black Alicante Laminate	cs1-25
Dishwasher Cabinet			

Comment

2. Floor Tile

	Selection	Grout	Threshold
Entrance Vestibule	*Upg.4 Must Polished, Dove Grey18x18	N/A	N/A
Main Hall			
Kitchen / Breakfast	*Upg.4 Must Polished, Dove Grey18x18	N/A	N/A
Laundry Room	Serpentine Krem 13 x 13	N/A	N/A
Powder Room	*Upg.4 Must Polished, Dove Grey18x18	N/A	N/A
TWIN BATH	*Upg.3 Niagara Falls Black 12 x 24	N/A	N/A
Master Ensuite Bathroom	*Upg.4 CarraraX Series,WhitePolished12x24	N/A	N/A
Second Ensuite Bathroom (If Applicable)	*Upg.2 Piaggio Matte Anthracite 12 x 24	N/A	N/A
Lower Landing (If Applicable)			

Comment

3. Wall Tile

	Selection	Listello/Inserts	Describe
TWIN BATH	Weave Ivory 8 X 10	<input type="radio"/> Yes <input checked="" type="radio"/> No	
Master Ensuite Bathroom			
Tub Deck	*Upg2 LandAnthracite12x24	<input type="radio"/> Yes <input checked="" type="radio"/> No	
Shower Stall	*Upg2 LandAnthracite12x24	<input checked="" type="radio"/> Yes <input type="radio"/> No	SEE NOTES BELOW
Bathroom Walls	*Upg4 CarraraXWhitePolished12x2	<input type="radio"/> Yes <input checked="" type="radio"/> No	
Second Ensuite Bathroom (If Applicable)	*Upg1 Carrara SeriesWhite10x16	<input type="radio"/> Yes <input checked="" type="radio"/> No	
MASTER SHOWER FLOOR	*RegalMosaics2x2CharcoalBlack	<input type="radio"/> Yes <input type="radio"/> No	
Kitchen Backsplash	<input type="radio"/> Yes <input checked="" type="radio"/> No	Backsplash Behind Fridge	

Comment

MASTER ENSUITE SHOWER STALL: FEATURE WALL (ON TUB WALL, SEE SKETCH) 24" WIDE X 8' HIGH
*UPG.4, MARBLE MOSAICS BRICK JOINT MARMARA 0.6" X 1.3" POLISHED

Scheduled Closing Date:

Purchasers: MUHAMMAD AJMAL KURREEMBUKUS & WAR Property: 30 of Plan -

Telephone Res. / Bus: (905) 826-8967 /

Project: Fieldwalk Investments Inc.

Decor Advisor: Terri Parisani

Model and Elevation: 38-4 Elev.A VIVALDI

4. Plumbing Fixtures

<input type="text"/>	Second Ensuite	<input type="text"/>	Powder Room	<input type="text"/>	
Master Ensuite Bathroom	<input type="text"/>	Other Room - Specify	<input type="text"/>	Other Washroom	<input type="text"/>
<input type="text"/>					

Comment

PLUMBING FIXTURES ARE STANDARD THROUGHOUT

5. Hardwood Flooring

	Type and Stain		Type and Stain
Main Hall	*Upg.2 PrevercoNuanceEspresso	Upper Landing	<input type="text"/>
Kitchen / Breakfast	<input type="text"/>	Upper Hall	**Upg.2 PrevercoNuanceEspresso
Living Room	<input type="text"/>	Master Bedroom	<input type="text"/>
Dining Room	*Upg.2 PrevercoNuanceEspresso	Bedroom #2	<input type="text"/>
Family Room	*Upg.2 PrevercoNuanceEspresso	Bedroom #3	<input type="text"/>
Den/Library	<input type="text"/>	Bedroom #4	<input type="text"/>
Entrance Vestibule	<input type="text"/>	Bedroom #5	<input type="text"/>
Lower Landing (If Applicable)	<input type="text"/>	Other Room - Specify	<input type="text"/>

Comment

HARDWOOD TO BE RED OAK

6. Carpeting

	Upgrade	Description
Main Hall	<input type="checkbox"/>	<input type="text"/>
Living Room	<input type="checkbox"/>	<input type="text"/>
Dining Room	<input type="checkbox"/>	<input type="text"/>
Family Room	<input type="checkbox"/>	<input type="text"/>
Den/Library	<input type="checkbox"/>	<input type="text"/>
Upper Hall	<input type="checkbox"/>	<input type="text"/>
Master Bedroom	<input type="checkbox"/>	T-07
Bedroom #2	<input type="checkbox"/>	T-07
Bedroom #3	<input type="checkbox"/>	T-07
Bedroom #4	<input type="checkbox"/>	T-07
Bedroom #5	<input type="checkbox"/>	<input type="text"/>
<input type="text"/>	<input type="checkbox"/>	<input type="text"/>
Upper Landing (If Applicable)	<input type="checkbox"/>	<input type="text"/>
Lower Landing (If Applicable)	<input type="checkbox"/>	<input type="text"/>

Upgrade Underpad	Type	Area
	STANDARD	<input type="text"/>
Carpet on Stairs	Capped	Runner - *Upgrade
	<input type="text"/>	<input type="text"/>

Comment

Scheduled Closing Date:

Purchasers: MUHAMMAD AJMAL KURREEMBUKUS & WAR Property: 30 of Plan -

Telephone Res. / Bus: (905) 826-8967 /

Project: Fieldwalk Investments Inc.

Decor Advisor: Terri Parisani

Model and Elevation: 38-4 Elev.A VIVALDI

7. Fireplace

	Living Room			Family Room			Other Room - Specify		
	Purchased	As Per Plan	N/A	Purchased	As Per Plan	N/A	Purchased	As Per Plan	N/A
Fireplace Type	<input type="radio"/>	<input type="radio"/>	<input checked="" type="radio"/>	<input type="radio"/>	<input checked="" type="radio"/>	<input type="radio"/>	<input type="radio"/>	<input type="radio"/>	<input checked="" type="radio"/>
Mantle Type				STANDARD					
Colour / Stain				NF-23					
Surround				WHITE PAINT-GRADE					
Hearth				NERO MARQUINA					
Comment									

8. Trim Carpentry

Interior Doors	STANDARD	Front Door Glass Inserts	STANDARD	Door Handles	STANDARD
Interior Trim	*UPGRADE 2 THROUGHOUT HOUSE				
Comment					

9. Plaster Mouldings and Medallions

Entrance Vestibule	N/A		Kitchen/Breakfast	N/A	
Main Hall	N/A		Den/Library	N/A	
Living Room	N/A		Lower Landing	N/A	
Dining Room	N/A		Other Room - Specify		
Family Room	N/A				
Comment					

10. Railings and Spindles

Railing Package	*EUROLINE R6 WITH V-GROOVE HANDRAIL		
Railing Colour	*ESPRESSO	Spindle Colour	BLACK
Stringer / Riser	*ESPRESSO	Treads	*ESPRESSO
Comment	Oak Stairs <input checked="" type="radio"/> Yes <input type="radio"/> No		
STAIN STAIR LANDINGS TO MATCH STAIRCASE			

11. Wall Paint

Main & Upper Hall	WARM GREY	Master Bedroom	WARM GREY
Living Room	WARM GREY	Bedroom #2	WARM GREY
Dining Room	WARM GREY	Bedroom #3	WARM GREY
Kitchen / Breakfast	WARM GREY	Bedroom #4	WARM GREY
Family Room	WARM GREY	Bedroom #5	WARM GREY
Powder Room	WARM GREY	Master Ensuite	WARM GREY
Laundry Room	WARM GREY	TWIN BATH	WARM GREY
Den/Library	WARM GREY	Second Ensuite	WARM GREY
Trim Paint	WHITE		
Comment	Smooth Ceilings First Floor		

Scheduled Closing Date:

Purchasers: MUHAMMAD AJMAL KURREEMBUKUS & WAR Property: 30 of Plan -

Telephone Res. / Bus: (905) 826-8967 /

Project: Fieldwalk Investments Inc.

Decor Advisor: Terri Parisani

Model and Elevation: 38-4 Elev.A VIVALDI

12. Electrical

Plugs and Switches ☒ White ☐ Ivory

Hood Fan ☐ White ☐ Ivory

Appliances Built in Cooktop

☐ Yes ☐ No

Built in Oven

☐ Yes ☐ No

Gas Stove

☐ Yes ☐ No

Microwave

☐ Yes ☐ No

Comment

13. Heating and Air Conditioning

Air Conditioning

Gas Provisions Stove

Gas Provisions Dryer

Gas Provisions Barbecue

Comment

14. Additional Comments

15. Disclaimers and Notes

- Colours of all materials are as close as possible to builder's selection, but not necessarily identical due to variances in manufacturing.
- Any extras listed above are null and void unless accompanied by a separate invoice/amendment. Said invoice must be paid in full.
- The Purchaser acknowledges that after Interior Colour Selection form is signed and dated, no further changes will be permitted other than re-selection due to unavailability. Purchaser's Initials
- The Purchaser acknowledges reading and accepting the "Gold Park Homes Decor Centre Disclaimers" form. This document contains other miscellaneous disclaimers.

This Interior Colour Selection is final and approved by:

Signature:



Date:

Jan/24/17

Signature:



Date:

Jan/24/17

Elevation A • 2,518 sq.ft. | Elevation B • 2,518 sq.ft.

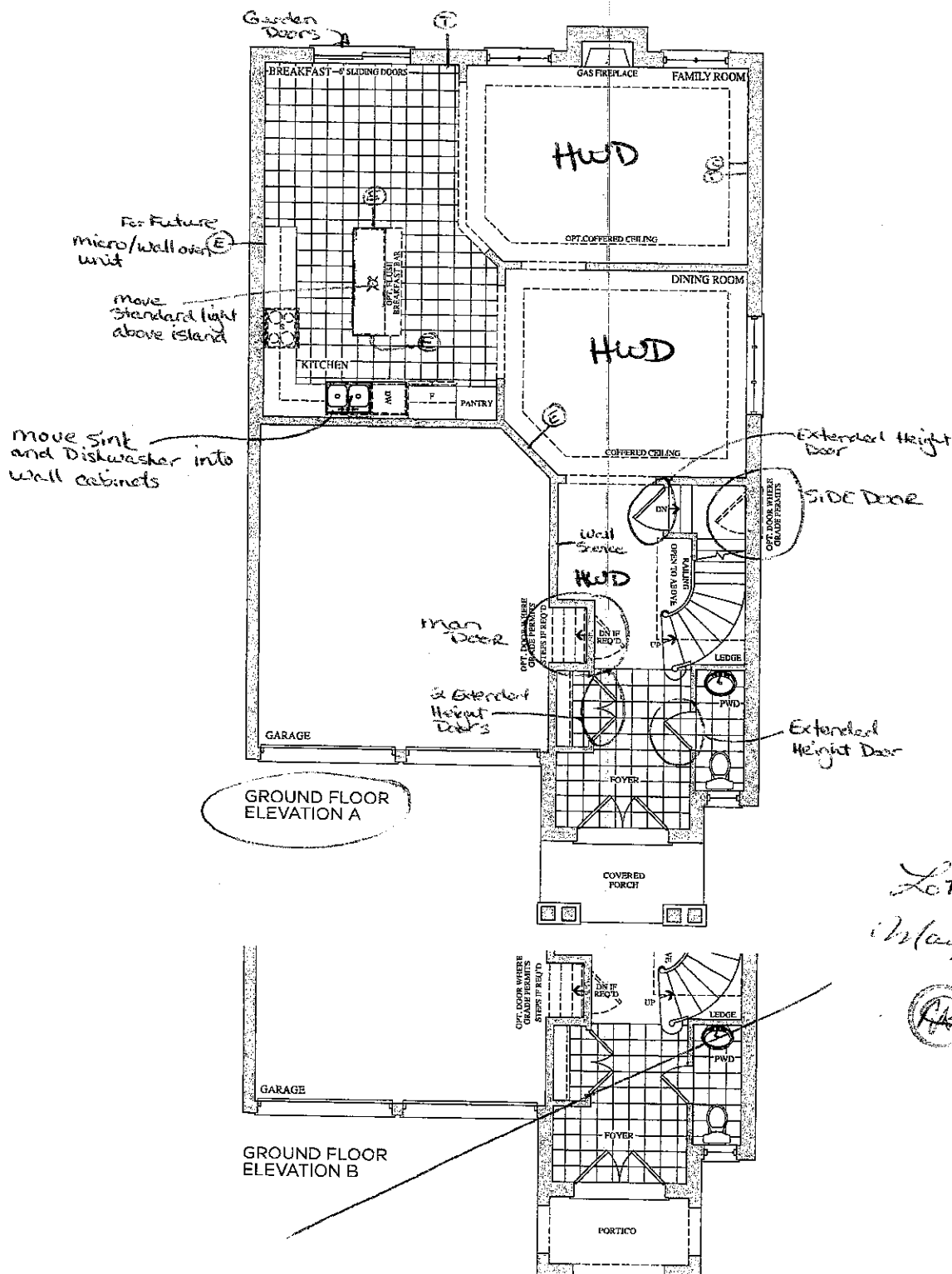

Prices, figures, illustrations, sizes, features and finishes are subject to change without notice. L&O.E. Areas and dimensions are approximate and actual usable floor space may vary from the stated area. Layout may be reverse of the unit purchased. E. & O.E.

GOLD PARK HOMES

Lot 30
Jan 24, 17

2. k_1, k_2, \dots, k_n
 3. k_1, k_2, \dots, k_n
 4. k_1, k_2, \dots, k_n

Elevation A • 2,518 sq.ft. | Elevation B • 2,518 sq.ft.

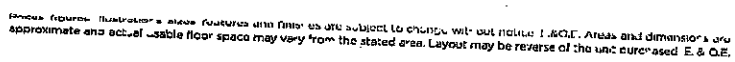
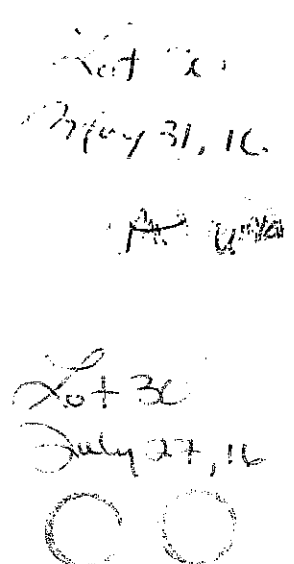

WALD PARK
HOMES

Lot 30
Jan. 24, 17



Lot 30

CORTINA

KITCHENS INC.

70 Regina Road Woodbridge ON L4L 8L6
905-264-6464

INFORMATION - PVC DOORS

Builder: Gold Park Homes Project: Encore Lot #: 30

All cabinets with PVC (Thermofoil) Doors come with melamine gables, panels and kick. The doors, crown moulding and light valance are PVC wrapped. Open shelves incorporated in design will only be available with melamine interiors. There will be variations in colour shades between the PVC parts (doors, crown and Light valance) and the melamine parts (open shelves, Gables, Panels and Kick) due to the difference in material.

Furring Panel with crown moulding to the ceiling is not available on all PVC door styles due to subtle variations in colour shades between the PVC parts (moulding) and the melamine parts (furring panel) due to the difference in material. Grain directions in wood grain pattern melamine, vary between the furring panel, crown moulding (horizontal) and the PVC doors (vertical).

Thank you for your understanding.

I am well informed of this information, and agree to the purchase of the above.

Purchaser: [Signature]
[Signature]

Date: Jan/24th/2017
Jan/24/17.

Trade Name: Gold Park Homes	Site location: Brampton	Model: 38-4
Address:	Project: Encore	Phase:

This layout has been explained to the purchaser by Cortina Kitchens Inc. and is understood by the purchaser.

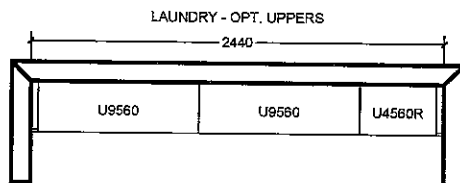
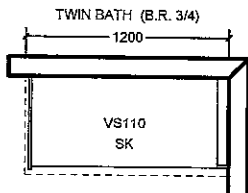
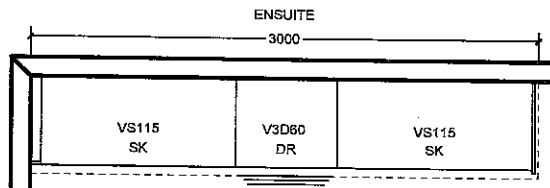
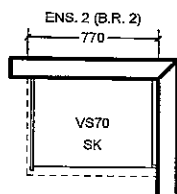
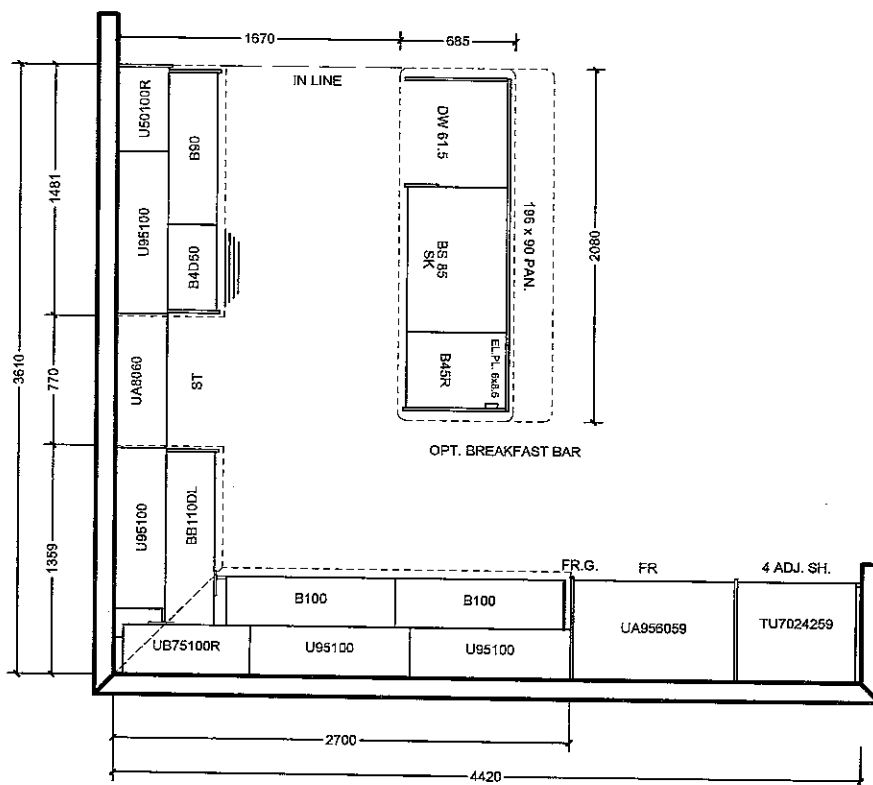

All prices subject to confirmation from head office.
This quotation is subject to the terms & conditions set out
in Cortina's Agreement of Purchase and Sale

All agreements are contingent upon strikes, accidents, and delay beyond our control.
Please provide our installer with template for sinkholes or \$150.00 will be charged for callback.

ACCEPTED DATE: _____

CUSTOMER SIGNATURE _____

SALESPERSON SIGNATURE _____

CORTINA HEAD OFFICE APPROVAL _____

ITEM A. Wood grain and colour are characteristics of the product, we cannot guarantee that such grain and colour will always match
ITEM B. Cortina Kitchens reserves the right to alter dimensions and make technical changes without notice.

No changes

Lot 30
Jan. 24, 17



STANDARD HARDWARE

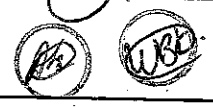

STANDARD HARDWARE



CSI-6



CSI-10

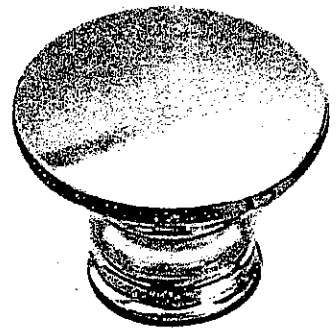

CSI-14

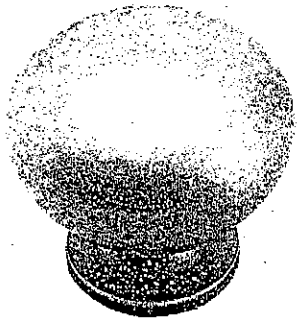

CSI-16

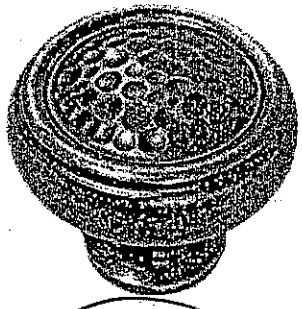

CSI-18 Kitchen

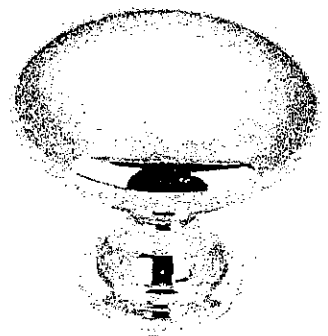

CSI-19 master

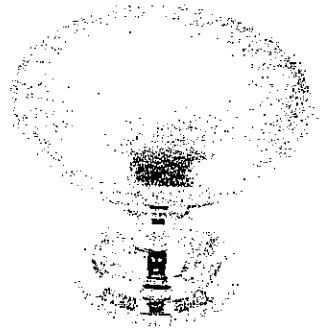

CSI-20

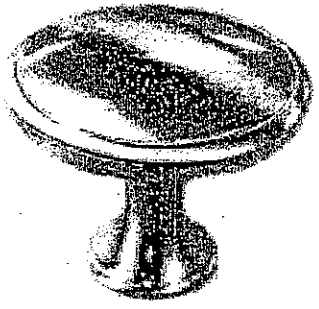

CSI-21



CSI-22

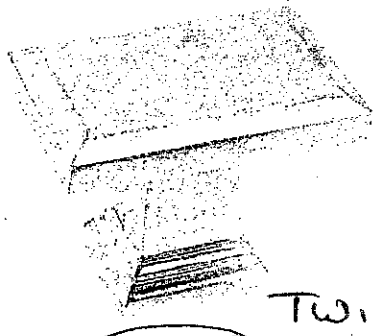

CSI-23 Twin

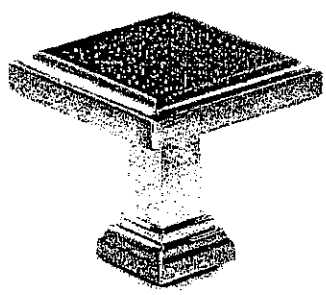

CSI-24

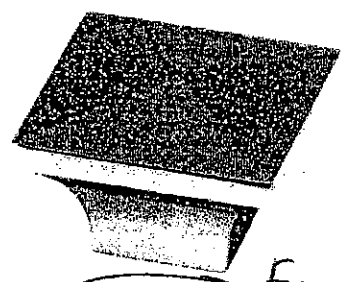

CSI-25 Ens. 2

***NOTES:**
- IMAGES ARE FOR QUICK REFERENCE PURPOSES ONLY
- ACTUAL SIZES AND FINISHES AS PER HARDWARE
SAMPLE BOARD PROVIDED TO DECOR CENTRE

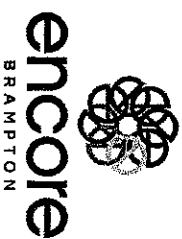

Granite, Marble,
Engineered Surfaces

Lot 30
Jan. 24, 17

- Standard 2CM & 3CM
- Upgrade 1 2CM & 3CM
- Upgrade 1 4 CM
- Upgrade 2

20 mm (3/4") Profiles

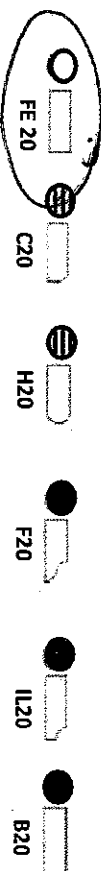

30mm (1-1/4") Profiles

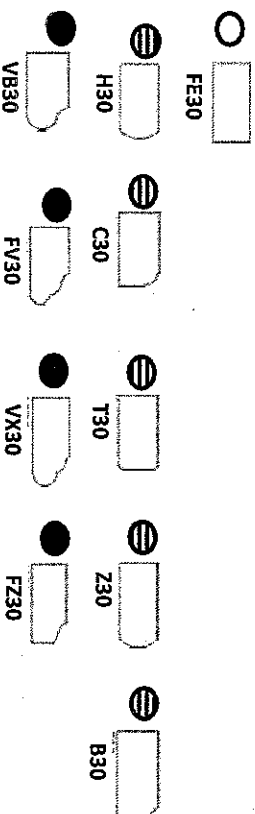

40mm (1-1/2") Profiles

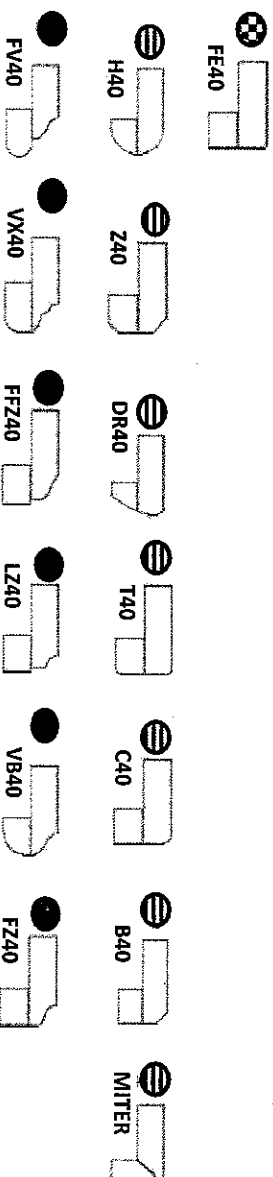

Note: All colours may not be available in 30mm at time ordered. Vendor reserves the right to use 40 mm edges (by lamination process).

*Mitre edge is available in Upgrade 1 for an overall thickness of 2". All other Mitre edge options will be an Upgrade 2 Edge.

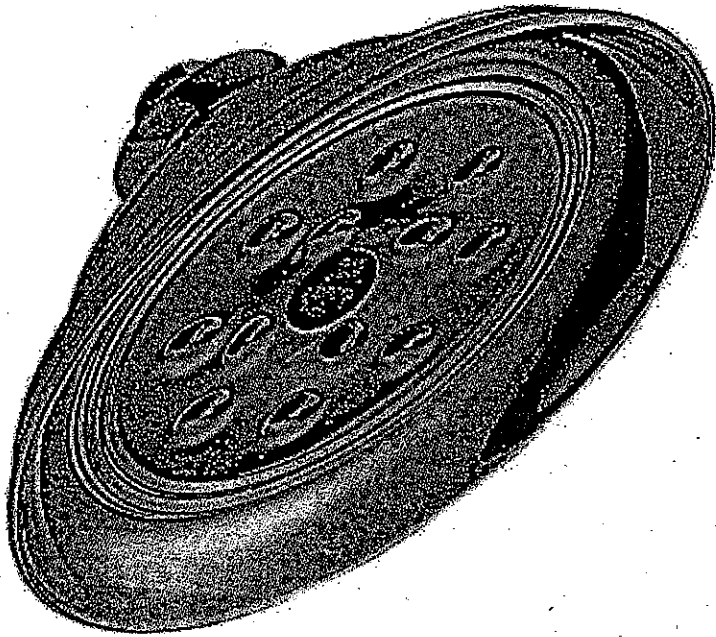

RainCan Head 8" - RP70172

Shower Head
8" wide

\$ 175.00

+ 6" ceiling mount arm
\$ 90.00

6" Ceiling mount arm - RP61058

Lot 30
Jan. 24, 17

(A) (WB)

Master Ensuite
Shower.