

**Brampton Encore - 117 - 1 - 38-4 Elev.A VIVALDI**  
**CENTRAL VAC AND WIRING**

|                   |  |
|-------------------|--|
| Inv.654           | 1 - TELEPHONE AND CABLE ROUGH-IN LOCATIONS |
| Line8297          | Note:                                      |
| 12Jul16 / 26Sep16 |  |

**ELECTRICAL**

|                   |   |
|-------------------|---|
| Inv.654           | 1 - KITCHEN: INSTALL 110V WALL RECEPTACLE ON DEDICATED CIRCUIT - FOR MICROWAVE - MICROWAVE NOT INCLUDED. SEE SKETCH |
| Line8298          | Note:   |
| 12Jul16 / 26Sep16 |   |

**EXTERIOR COLOURS**

|                   |                               |
|-------------------|-------------------------------|
| Inv.654           | 1 - EXTERIOR COLOUR PACKAGE 5 |
| Line11987         | Note:                         |
| 12Jul16 / 26Sep16 |                               |

**FORMING**

|                   |   |
|-------------------|---|
| Inv.654           | 1 - EXTERIOR: INSTALL SIDE DOOR- HOME TO EXTERIOR- AS PER PLAN AND GRADE PERMITTING |
| Line8300          | Note: GRADING PERMITS PER SITING DATED AUGUST 2, 2016                               |
| 12Jul16 / 26Sep16 |   |

**FRAMING**

|   |   |
|---|---|
| Inv.654   | 1 - GARAGE: INSTALL MANDOOR - GARAGE TO HOUSE- AS PER PLAN AND GRADE PERMITTING   |
| Line8299  | Note: GIVEN IN AGREEMENT OF PURCHASE AND SALE   |
| 12Jul16 / 26Sep16 GRADING PERMITS PER SITING DATED AUGUST 2, 2016 |   |
| Inv.729   | 1 - MAIN FLOOR: UPGRADE MAIN FLOOR CEILING TO 10FT INCLUDES TALLER FRONT DOOR W/EXTRA TRANSOMS; 8' INT.DOORS & COORD. CASINGS, EXTRA TALL FLAT ARCHES; TALLER FRONT AND REAR WINDOWS, CROWN AND FURRING PANEL OVER EXT. CABINETS, ADDED STAIRS/PICKETS/RAILINGS |
| Line9855  | Note:   |
| 9Aug16 / 26Sep16  |   |

**HARDWOOD**

|                  |  |
|------------------|--|
| Inv.1,175        | 1 - FAMILY ROOM: INSTALL 4 1/4" PREVERCO ENGINEERED RED OAK IN SIERRA. Upgrade 1 LEVEL S Family    |
| Line17324        | Note:  |
| 9Feb17 / 27Feb17 |  |
| Inv.1,175        | 1 - UPPER HALL: INSTALL 4 1/4" PREVERCO ENGINEERED RED OAK IN SIERRA. Upgrade 1 LEVEL S Upper Hall |
| Line17326        | Note:  |
| 9Feb17 / 27Feb17 |  |
| Inv.1,175        | 1 - DINING ROOM: INSTALL 4 1/4" PREVERCO ENGINEERED RED OAK IN SIERRA. Upgrade 1 LEVEL S Dining    |
| Line17323        | Note:  |
| 9Feb17 / 27Feb17 |  |
| Inv.1,175        | 1 - MAIN HALL: INSTALL 4 1/4" PREVERCO ENGINEERED RED OAK IN SIERRA. Upgrade 1 LEVEL S Main Hall   |
| Line17325        | Note:  |
| 9Feb17 / 27Feb17 |  |

**INTERIOR TRIM AND DOORS**

Brampton Encore - 117 - 1 - 38-4 Elev.A VIVALDI

|                  |   |
|------------------|---|
| Inv.729          | 1 - MAIN FLOOR: UPGRADE MAIN FLOOR CEILING TO 10FT INCLUDES TALLER FRONT DOOR W/EXTRA TRANSOMS; 8' INT.DOORS & COORD. CASINGS, EXTRA TALL FLAT ARCHES; TALLER FRONT AND REAR WINDOWS, CROWN AND FURRING PANEL OVER EXT. CABINETS, ADDED STAIRS/PICKETS/RAILINGS |
| Line11989        | Note:   |
| 9Aug16 / 26Sep16 |   |

KITCHEN AND BATH CABINETRY

|                  |   |
|------------------|---|
| Inv.729          | 1 - MAIN FLOOR: UPGRADE MAIN FLOOR CEILING TO 10FT INCLUDES TALLER FRONT DOOR W/EXTRA TRANSOMS; 8' INT.DOORS & COORD. CASINGS, EXTRA TALL FLAT ARCHES; TALLER FRONT AND REAR WINDOWS, CROWN AND FURRING PANEL OVER EXT. CABINETS, ADDED STAIRS/PICKETS/RAILINGS |
| Line11990        | Note:   |
| 9Aug16 / 26Sep16 |   |
| Inv.1,175        | 1 - KITCHEN: INSTALL Oak PVC 57 Microwave Cabinet with matching interior open shelf 76 and 100 cm high  |
| Line17330        | Note:   |
| 9Feb17 / 27Feb17 |   |

MISC.

|                   |   |
|-------------------|---|
| Inv.654           | 1 - BONUS PACKAGE: \$2457.75 (INCLUDING TAXES) WORTH OF UPGRADES FROM GOLD PARK HOMES DÉCOR CENTRE IS BEING APPLIED TOWARD THE STRUCTURAL APPOINTMENT. PURCHASER HAS A REMAINING AMOUNT OF \$7542.25 (INCLUDING TAXES) TO BE USED TOWARD THE COLOUR APPOINTMENT |
| Line8324          | Note:   |
| 12Jul16 / 26Sep16 |   |
| Inv.654           | 1 - Purchaser has attended a Structural appointment at the Decor Centre & has DECLINED any additional upgrades and accepts and acknowledges that there will be no further structural changes/additions/deletions to be made upon signing on July 12, 2016.      |
| Line8325          | Note:   |
| 12Jul16 / 26Sep16 |   |
| Inv.654           | 1 - Purchasers are aware & accepts that ANY changes made to upgrades after signing this Purchasers Extra Form are subject to a minimum administration fee of \$500. PLUS a 10% holdback fee.  |
| Line8326          | Note:   |
| 12Jul16 / 26Sep16 |   |
| Inv.729           | 1 - BONUS PACKAGE: \$7542.25 (INCLUDING TAXES) WORTH OF UPGRADES FROM GOLD PARK HOMES DÉCOR CENTRE IS BEING APPLIED TOWARD THE STRUCTURAL APPOINTMENT. PURCHASER HAS A REMAINING AMOUNT OF \$00 (INCLUDING TAXES) TO BE USED TOWARD THE COLOUR APPOINTMENT      |
| Line9856          | Note:   |
| 9Aug16 / 26Sep16  |   |
| Inv.729           | 1 - Purchasers are aware & accepts that ANY changes made to upgrades after signing this Purchasers Extra Form are subject to a minimum administration fee of \$500. PLUS a 10% holdback fee   |
| Line9857          | Note:   |
| 9Aug16 / 26Sep16  |   |
| Inv.729           | 1 - ADMINISTRATION FEE TO RE-OPEN FILE  |
| Line9858          | Note:   |
| 9Aug16 / 26Sep16  |   |
| Inv.1,175         | 1 - Purchasers are aware & accepts that ANY changes made to upgrades after signing this Purchasers Extra Form are subject to a minimum administration fee of \$500. PLUS a 10% holdback fee   |
| Line17329         | Note:   |
| 9Feb17 / 27Feb17  |   |

Brampton Encore - 117 - 1 - 38-4 Elev.A VIVALDI

|                  |  |
|------------------|--|
| Inv.1,175        | 1 - Purchaser has attended a Colour appointment at the Decor Centre & has DECLINED any additional upgrades and accepts and acknowledges that there will be no further structural changes/additions/deletions to be made upon signing on February 9, 2017 |
| Line17328        | Note:  |
| 9Feb17 / 27Feb17 |  |

PAINTING

|                  |   |
|------------------|---|
| Inv.1,175        | 1 - STAIRCASE: Stain Staircase 2 Storey Model (Euroline Pickets Charged Separately) |
| Line17327        | Note: STAIN STAIR LANDINGS TO MATCH STAIRS  |
| 9Feb17 / 27Feb17 |   |

STAIRS AND RAILINGS

|                  |   |
|------------------|---|
| Inv.729          | 1 - MAIN FLOOR: UPGRADE MAIN FLOOR CEILING TO 10FT INCLUDES TALLER FRONT DOOR W/EXTRA TRANSOMS; 8' INT.DOORS & COORD. CASINGS, EXTRA TALL FLAT ARCHES; TALLER FRONT AND REAR WINDOWS, CROWN AND FURRING PANEL OVER EXT. CABINETS, ADDED STAIRS/PICKETS/RAILINGS |
| Line11991        | Note:   |
| 9Aug16 / 26Sep16 |   |

WINDOWS AND DOORS

|                  |   |
|------------------|---|
| Inv.729          | 1 - MAIN FLOOR: UPGRADE MAIN FLOOR CEILING TO 10FT INCLUDES TALLER FRONT DOOR W/EXTRA TRANSOMS; 8' INT.DOORS & COORD. CASINGS, EXTRA TALL FLAT ARCHES; TALLER FRONT AND REAR WINDOWS, CROWN AND FURRING PANEL OVER EXT. CABINETS, ADDED STAIRS/PICKETS/RAILINGS |
| Line11988        | Note:   |
| 9Aug16 / 26Sep16 |   |

Scheduled Closing Date:

Purchaser: SATHISKUMAR THIRUHELIVAM

Property: 117 of Plan -

Telephone Res. / Bus: (416) 821-7353

Project: Fieldwalk Investments Inc.

Decor Advisor: Terri Parisani

Model and Elevation: 38-4 Elev.A VIVALDI

Layout Changes: ☒ Yes ☐ No

Sketch Attached: ☒ Yes ☐ No

Exterior Colour Scheme:

### 1. Cabinetry

|   | Style and Colour        | Counter                          | Hardware             |
|---|-------------------------|----------------------------------|----------------------|
| Kitchen / Breakfast                     | Varese(pvc)ChocoMaple   | Crema Caramel Granite Edge: FE20 | cs1-10               |
| Laundry Room                            | <input type="text"/>    | <input type="text"/>             | <input type="text"/> |
| Powder Room                             | <input type="text"/>    | <input type="text"/>             | <input type="text"/> |
| TWIN BATH                               | Carrara(pvc)VanillaStix | 4726K-52 Milano Quartz Laminate  | cs1-10               |
| Master Ensuite Bathroom                 | Carrara(pvc)VanillaStix | 4726K-52 Milano Quartz Laminate  | cs1-10               |
| Second Ensuite Bathroom (If Applicable) | Carrara(pvc)VanillaStix | 4726K-52 Milano Quartz Laminate  | cs1-10               |
| <input type="text"/>                    | <input type="text"/>    | <input type="text"/>             | <input type="text"/> |
| Dishwasher Cabinet                      | <input type="text"/>    |                                  |                      |

Comment

### 2. Floor Tile

|   | Selection                | Grout                | Threshold            |
|---|--------------------------|----------------------|----------------------|
| Entrance Vestibule                      | Serpentine Krem 13 x 13  | N/A                  | N/A                  |
| Main Hall                               | <input type="text"/>     | <input type="text"/> | <input type="text"/> |
| Kitchen / Breakfast                     | Serpentine Krem 13 x 13  | N/A                  | N/A                  |
| Laundry Room                            | New Reeds Silver 13 x 13 | N/A                  | N/A                  |
| Powder Room                             | Serpentine Krem 13 x 13  | N/A                  | N/A                  |
| TWIN BATH                               | New Reeds Silver 13 x 13 | N/A                  | N/A                  |
| Master Ensuite Bathroom                 | New Reeds Silver 13 x 13 | N/A                  | N/A                  |
| Second Ensuite Bathroom (If Applicable) | New Reeds Silver 13 x 13 | N/A                  | N/A                  |
| Lower Landing (If Applicable)           | <input type="text"/>     | <input type="text"/> | <input type="text"/> |
| <input type="text"/>                    | <input type="text"/>     | <input type="text"/> | <input type="text"/> |

Comment

### 3. Wall Tile

|   | Selection            | Listello/Inserts  | Describe             |
|---|----------------------|---|----------------------|
| TWIN BATH                               | Weave Ivory 8 x 10   | <input type="radio"/> Yes <input checked="" type="radio"/> No | <input type="text"/> |
| Master Ensuite Bathroom                 |                      |   |                      |
| Tub Deck                                | Venus Brown 8 x 10   | <input type="radio"/> Yes <input checked="" type="radio"/> No | <input type="text"/> |
| Shower Stall                            | Venus Brown 8 x 10   | <input type="radio"/> Yes <input checked="" type="radio"/> No | <input type="text"/> |
| Bathroom Walls                          | Venus Brown 8 x 10   | <input type="radio"/> Yes <input checked="" type="radio"/> No | <input type="text"/> |
| Second Ensuite Bathroom (If Applicable) | Weave Ivory 8 x 10   | <input type="radio"/> Yes <input checked="" type="radio"/> No | <input type="text"/> |
| <input type="text"/>                    | <input type="text"/> | <input type="radio"/> Yes <input type="radio"/> No            | <input type="text"/> |

Kitchen Backsplash

☐ Yes ☒ No

Backsplash Behind Fridge

Comment

Scheduled Closing Date:

Purchaser: SATHISKUMAR THIRUHCHELVAM

Property: 117 of Plan -

Telephone Res. / Bus: (416) 821-7353

Project: Fieldwalk Investments Inc.

Decor Advisor: Terri Parisani

Model and Elevation: 38-4 Elev.A VIVALDI

#### 4. Plumbing Fixtures

Master Ensuite Bathroom  Second Ensuite  Powder Room   
Other Room - Specify  Other Washroom

Comment

ALL FIXTURES TO REMAIN STANDARD THROUGHOUT

#### 5. Hardwood Flooring

|                               | Type and Stain                 |                      | Type and Stain                 |
|-------------------------------|--------------------------------|----------------------|--------------------------------|
| Main Hall                     | *Upg.1, Preverco 4 1/4" Sierra | Upper Landing        | <input type="text"/>           |
| Kitchen / Breakfast           | <input type="text"/>           | Upper Hall           | *Upg.1, Preverco 4 1/4" Sierra |
| Living Room                   | <input type="text"/>           | Master Bedroom       | <input type="text"/>           |
| Dining Room                   | *Upg.1, Preverco 4 1/4" Sierra | Bedroom #2           | <input type="text"/>           |
| Family Room                   | *Upg.1, Preverco 4 1/4" Sierra | Bedroom #3           | <input type="text"/>           |
| Den/Library                   | <input type="text"/>           | Bedroom #4           | <input type="text"/>           |
| Entrance Vestibule            | <input type="text"/>           | Bedroom #5           | <input type="text"/>           |
| Lower Landing (If Applicable) | <input type="text"/>           | Other Room - Specify | <input type="text"/>           |

Comment

ALL HARDWOOD IS ENGINEERED RED OAK

#### 6. Carpeting

|                               | Upgrade                  | Description          |
|-------------------------------|--------------------------|----------------------|
| Main Hall                     | <input type="checkbox"/> | <input type="text"/> |
| Living Room                   | <input type="checkbox"/> | <input type="text"/> |
| Dining Room                   | <input type="checkbox"/> | <input type="text"/> |
| Family Room                   | <input type="checkbox"/> | <input type="text"/> |
| Den/Library                   | <input type="checkbox"/> | <input type="text"/> |
| Upper Hall                    | <input type="checkbox"/> | <input type="text"/> |
| Master Bedroom                | <input type="checkbox"/> | T-18                 |
| Bedroom #2                    | <input type="checkbox"/> | T-18                 |
| Bedroom #3                    | <input type="checkbox"/> | T-18                 |
| Bedroom #4                    | <input type="checkbox"/> | T-18                 |
| Bedroom #5                    | <input type="checkbox"/> | <input type="text"/> |
| <input type="text"/>          | <input type="checkbox"/> | <input type="text"/> |
| Upper Landing (If Applicable) | <input type="checkbox"/> | <input type="text"/> |
| Lower Landing (If Applicable) | <input type="checkbox"/> | <input type="text"/> |

|                  |                                |   |
|------------------|--------------------------------|---|
| Upgrade Underpad | Type<br>STANDARD               | Area<br><input type="text"/>              |
| Carpet on Stairs | Capped<br><input type="text"/> | Runner - *Upgrade<br><input type="text"/> |

Comment

Scheduled Closing Date:

Purchaser: SATHISKUMAR THIRUHCHELVAM

Property: 117 of Plan -

Telephone Res. / Bus: (416) 821-7353

Project: Fieldwalk Investments Inc.

Decor Advisor: Terri Parisani

Model and Elevation: 38-4 Elev.A VIVALDI

## 7. Fireplace

| Living Room           |                                  |                       | Family Room           |                                  |                       | Other Room - Specify  |                       |                                  |
|-----------------------|----------------------------------|-----------------------|-----------------------|----------------------------------|-----------------------|-----------------------|-----------------------|----------------------------------|
| Purchased             | As Per Plan                      | N/A                   | Purchased             | As Per Plan                      | N/A                   | Purchased             | As Per Plan           | N/A                              |
| <input type="radio"/> | <input checked="" type="radio"/> | <input type="radio"/> | <input type="radio"/> | <input checked="" type="radio"/> | <input type="radio"/> | <input type="radio"/> | <input type="radio"/> | <input checked="" type="radio"/> |

|                |  |                               |
|----------------|--|-------------------------------|
| Fireplace Type | <input type="text" value="STANDARD"/>          | <input type="text" value=""/> |
| Mantle Type    | <input type="text" value="NF-20"/>             | <input type="text" value=""/> |
| Colour / Stain | <input type="text" value="WHITE PAINT-GRADE"/> | <input type="text" value=""/> |
| Surround       | <input type="text" value="NERO MARQUINA"/>     | <input type="text" value=""/> |
| Hearth         | <input type="text" value="NONE"/>              | <input type="text" value=""/> |

Comment

## 8. Trim Carpentry

|                |                                       |                          |                                       |              |                                       |
|----------------|---------------------------------------|--------------------------|---------------------------------------|--------------|---------------------------------------|
| Interior Doors | <input type="text" value="STANDARD"/> | Front Door Glass Inserts | <input type="text" value="STANDARD"/> | Door Handles | <input type="text" value="STANDARD"/> |
| Interior Trim  | <input type="text" value="STANDARD"/> |                          |                                       |              |                                       |

Comment

## 9. Plaster Mouldings and Medallions

|                    |                                  |                               |                      |                                  |                               |
|--------------------|----------------------------------|-------------------------------|----------------------|----------------------------------|-------------------------------|
| Entrance Vestibule | <input type="text" value="N/A"/> | <input type="text" value=""/> | Kitchen/Breakfast    | <input type="text" value="N/A"/> | <input type="text" value=""/> |
| Main Hall          | <input type="text" value="N/A"/> | <input type="text" value=""/> | Den/Library          | <input type="text" value="N/A"/> | <input type="text" value=""/> |
| Living Room        | <input type="text" value="N/A"/> | <input type="text" value=""/> | Lower Landing        | <input type="text" value="N/A"/> | <input type="text" value=""/> |
| Dining Room        | <input type="text" value="N/A"/> | <input type="text" value=""/> | Other Room - Specify | <input type="text" value="N/A"/> | <input type="text" value=""/> |
| Family Room        | <input type="text" value="N/A"/> | <input type="text" value=""/> |                      |                                  |                               |

Comment

## 10. Railings and Spindles

|                  |  |   |
|------------------|--|---|
| Railing Package  | <input type="text" value="STANDARD"/>                                    |   |
| Railing Colour   | <input type="text" value="*SIERRA"/>                                     | Spindle Colour <input type="text" value="*SIERRA"/> |
| Stringer / Riser | <input type="text" value="*SIERRA"/>                                     | Treads <input type="text" value="*SIERRA"/>         |
| Comment          | Oak Stairs <input checked="" type="radio"/> Yes <input type="radio"/> No |   |

\*STAIN LANDINGS TO MATCH STAIRS

## 11. Wall Paint

|                     |   |                |                                     |
|---------------------|---|----------------|-------------------------------------|
| Main & Upper Hall   | <input type="text" value="OYSTER"/>                       | Master Bedroom | <input type="text" value="OYSTER"/> |
| Living Room         | <input type="text" value="OYSTER"/>                       | Bedroom #2     | <input type="text" value="OYSTER"/> |
| Dining Room         | <input type="text" value="OYSTER"/>                       | Bedroom #3     | <input type="text" value="OYSTER"/> |
| Kitchen / Breakfast | <input type="text" value="OYSTER"/>                       | Bedroom #4     | <input type="text" value="OYSTER"/> |
| Family Room         | <input type="text" value="OYSTER"/>                       | Bedroom #5     | <input type="text" value="OYSTER"/> |
| Powder Room         | <input type="text" value="OYSTER"/>                       | Master Ensuite | <input type="text" value="OYSTER"/> |
| Laundry Room        | <input type="text" value="OYSTER"/>                       | TWIN BATH      | <input type="text" value="OYSTER"/> |
| Den/Library         | <input type="text" value="OYSTER"/>                       | Second Ensuite | <input type="text" value="OYSTER"/> |
| Trim Paint          | <input type="text" value="WHITE"/>                        |                |                                     |
| Comment             | Smooth Ceilings First Floor <input type="text" value=""/> |                |                                     |

Scheduled Closing Date:

Purchaser: SATHISKUMAR THIRUHCHELVAM

Property: 117 of Plan -

Telephone Res. / Bus: (416) 821-7353

Project: Fieldwalk Investments Inc.

Decor Advisor: Terri Parisani

Model and Elevation: 38-4 Elev.A VIVALDI

## 12. Electrical

Plugs and Switches ☒ White ☐ Ivory

Hood Fan ☐ White ☐ Ivory

Appliances

Built in Cooktop

Built in Oven

Gas Stove

Microwave

☐ Yes ☒ No

☐ Yes ☒ No

☐ Yes ☒ No

☐ Yes ☒ No

Comment

STANDARD HOOD FAN: STAINLESS STEEL

## 13. Heating and Air Conditioning

Air Conditioning

Gas Provisions Stove

Gas Provisions Dryer

Gas Provisions Barbecue

Comment

GAS LINE FOR BBQ IS STANDARD

## 14. Additional Comments

## 15. Disclaimers and Notes

- Colours of all materials are as close as possible to builder's selection, but not necessarily identical due to variances in manufacturing.
- Any extras listed above are null and void unless accompanied by a separate invoice/amendment. Said invoice must be paid in full.
- The Purchaser acknowledges that after Interior Colour Selection form is signed and dated, no further changes will be permitted other than re-selection due to unavailability. \_\_\_\_\_ Purchaser's Initials
- The Purchaser acknowledges reading and accepting the "Gold Park Homes Decor Centre Disclaimers" form. This document contains other miscellaneous disclaimers.

This Interior Colour Selection is final and approved by:

Signature: \_\_\_\_\_

Date: \_\_\_\_\_

2017/02/09

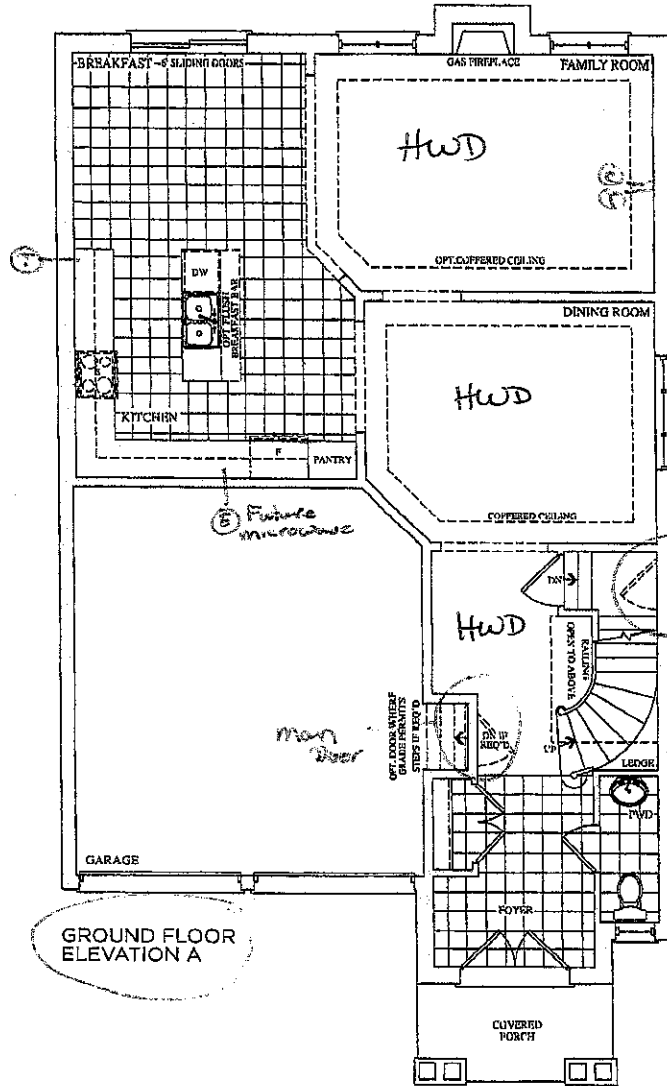

GROUND FLOOR  
ELEVATION A

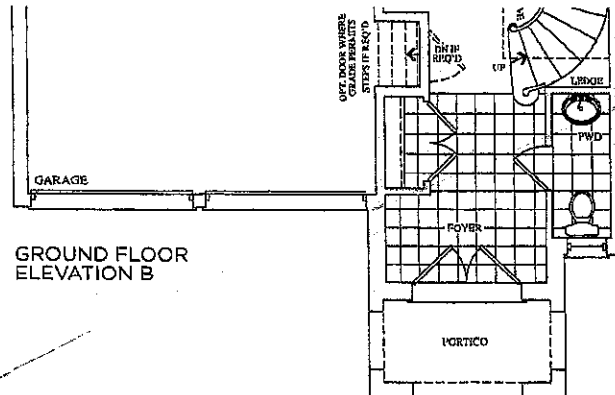

GROUND FLOOR  
ELEVATION B

Lot 117  
July 12, 16

(T-S)

Lot 117  
Feb. 9, 17

(T-S)



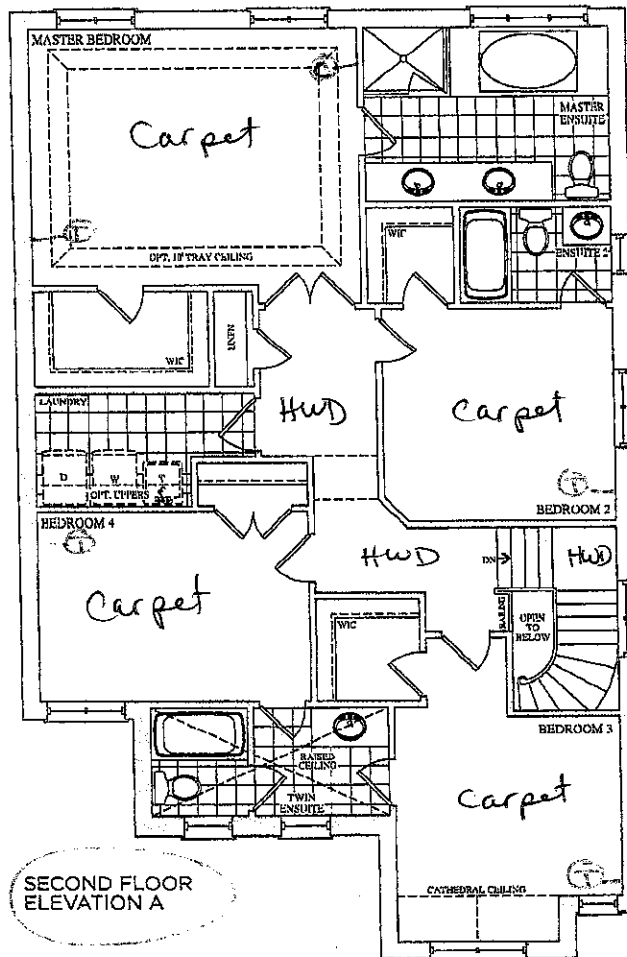

Lot 117  
July 12, 16  
(1.8)

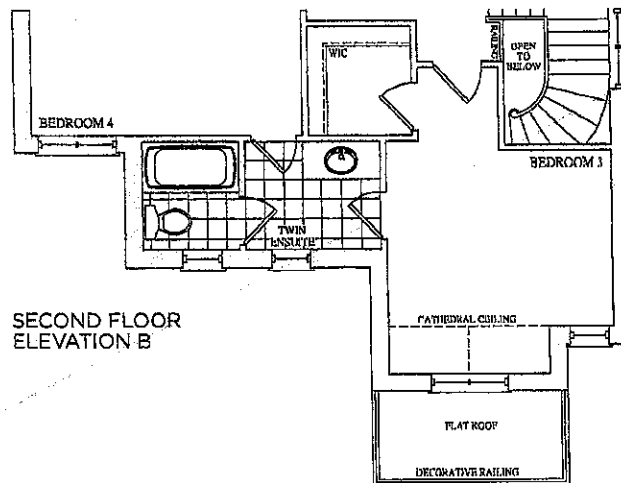

Lot 117  
Feb. 9, 17  
(1.8)



# CORTINA

KITCHENS INC.

70 Regina Road Woodbridge ON L4L 8L6  
905-264-6464

## INFORMATION - PVC DOORS

Builder Gold Park Homes Project Encore Lot # 117

All cabinets with PVC (Thermofoil) Doors come with melamine gables, panels and kick. The doors, crown moulding and light valance are PVC wrapped. Open shelves incorporated in design will only be available with melamine interiors. There will be variations in colour shades between the PVC parts (doors, crown and Light valance) and the melamine parts (open shelves, Gables, Panels and Kick) due to the difference in material.

Furring Panel with crown moulding to the ceiling is not available on all PVC door styles due to subtle variations in colour shades between the PVC parts (moulding) and the melamine parts (furring panel) due to the difference in material. Grain directions in wood grain pattern melamine, vary between the furring panel, crown moulding (horizontal) and the PVC doors (vertical).

Thank you for your understanding.

I am well informed of this information, and agree to the purchase of the above.

Purchaser: T. Smith

Date: 2017/02/09

**GOLDPARK**  
H O M E S



**Granite, Marble,  
Engineered Surfaces**

- Standard 2CM & 3CM
- ◐ Upgrade 1 2CM & 3CM
- ◑ Upgrade 1 4 CM
- Upgrade 2

20 mm (3/4") Profiles



30mm (1 1/4") Profiles

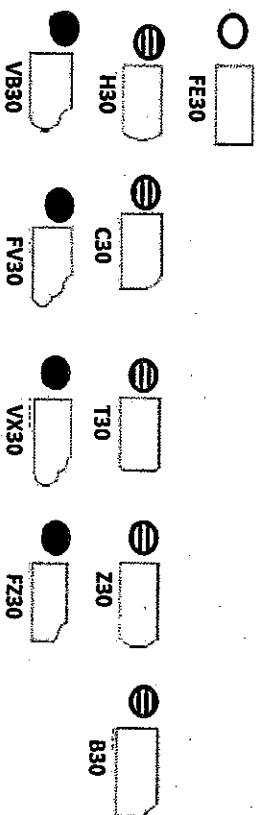

40mm (1 1/2") Profiles

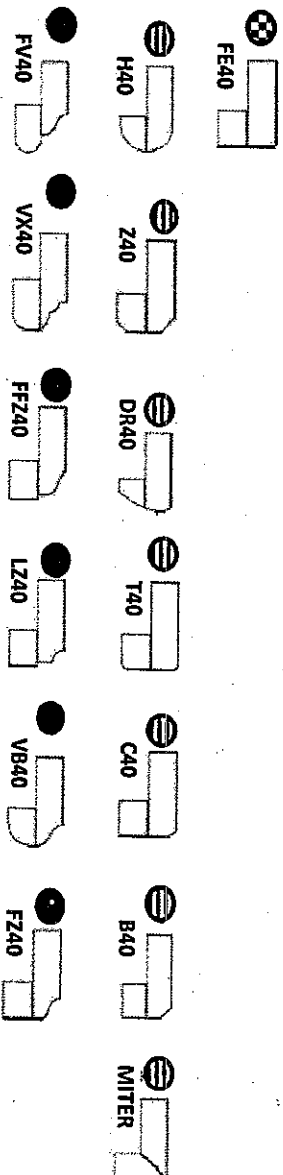

Note: All colours may not be available in 30mm at time ordered. Vendor reserves the right to use 40 mm edges (by lamination process).

\*Mitre edge is available in Upgrade 1 for an overall thickness of 2". All other Mitre edge options will be an Upgrade 2 Edge.

41

2017  
Feb. 9, 17