

Brampton Encore - 130 - 1 - 41-3 Elev.A CHOPIN

CENTRAL VAC AND WIRING

Inv.702	1 - TELEPHONE AND CABLE ROUGH-IN LOCATIONS
Line9330	Note:
27Jul16 / 15Nov16	
Inv.702	1 - FAMILY ROOM: INSTALL CONDUIT PIPE- FOR TELEVISION- MUST SPECIFY LOCATION AND TERMINATION POINT. SEE SKETCH
Line9331	Note:
27Jul16 / 15Nov16	
Inv.702	1 - BEDROOM #2: INSTALL RG 6 CABLE ROUGH-IN IN BED #2. SEE SKETCH
Line9333	Note:
27Jul16 / 15Nov16	
Inv.702	1 - BEDROOM #3: INSTALL RG 6 CABLE ROUGH-IN IN BED #3. SEE SKETCH
Line9334	Note:
27Jul16 / 15Nov16	
Inv.702	1 - BEDROOM #4: INSTALL RG 6 CABLE ROUGH-IN IN BED #4. SEE SKETCH
Line9335	Note:
27Jul16 / 15Nov16	

CERAMIC

Inv.702	1 - LAUNDRY ROOM: MOVE LAUNDRY ROOM TO BASEMENT AND MAKE ROOM INTO A THREE PIECE WASHROOM FOR BEDROOM #4. AS PER SKETCH
Line14017	Note:
27Jul16 / 15Nov16	
Inv.1,149	1 - FOYER: INSTALL Floor Upgrade 4 Foyer Vestibule Floor
Line16988	Note:
31Jan17 / 14Mar17	
Inv.1,149	1 - KITCHEN: INSTALL Floor Upgrade 4 Kitchen and Breakfast Floor
Line16989	Note:
31Jan17 / 14Mar17	
Inv.1,149	1 - POWDER ROOM: INSTALL Floor Upgrade 4 Powder Room Floor
Line16990	Note:
31Jan17 / 14Mar17	

DRYWALL

Inv.702	1 - SECOND FLOOR: INSTALL SMOOTH CEILINGS - (2-Story Design) 2ND FLOOR
Line9341	Note: INCORRECTLY CHARGED-SEE PE:981 FOR CORRECTION
27Jul16 / 15Nov16	

ELECTRICAL

Inv.702	1 - FAMILY ROOM: INSTALL 110V WALL RECEPTACLE ON DEDICATED CIRCUIT - ABOVE FIREPLACE. SEE SKETCH
Line9332	Note:
27Jul16 / 15Nov16	
Inv.702	1 - KITCHEN: INSTALL 110V WALL RECEPTACLE ON DEDICATED CIRCUIT - FOR MICROWAVE - MICROWAVE NOT INCLUDED. FOR FUTURE MICROWAVE/WALL OVEN UNIT. PURCHASER UNDERSTANDS THAT THEY MUST PURCHASE THE APPROPRIATE CABINETRY AT THE TIME OF COLOURS. SEE SKETCH
Line9336	Note:
27Jul16 / 15Nov16	

Brampton Encore - 130 - 1 - 41-3 Elev.A CHOPIN

Inv.702	1 - KITCHEN: INSTALL 220V WALL RECEPTICAL ON DEDICATED CIRCUIT- FOR 4 WIRE BUILT-IN WALL OVEN. FOR FUTURE MICROWAVE/WALL OVEN UNIT. PURCHASER UNDERSTANDS THAT THEY MUST PURCHASE THE APPROPRIATE CABINETRY AT THE TIME OF COLOURS. SEE SKETCH
Line9337	Note:
27Jul16 / 15Nov16	
Inv.702	1 - BASEMENT: INSTALL 200 AMP ELECTRICAL SERVICE
Line9338	Note:
27Jul16 / 15Nov16	
Inv.702	1 - LAUNDRY ROOM: MOVE LAUNDRY ROOM TO BASEMENT AND MAKE ROOM INTO A THREE PIECE WASHROOM FOR BEDROOM #4. AS PER SKETCH
Line14018	Note:
27Jul16 / 15Nov16	
Inv.1,149	1 - KITCHEN CABINETRY: NOTE: ELECTRICAL WAS PURCHASED FOR A BUILT-IN WALL OVEN/ MICROWAVE UNIT, HOWEVER, CABINETRY EXTRAS WERE NOT PURCHASED. ELECTRICAL WILL BE INSTALLED AND ACCESSIBLE IN STANDARD CABINETS
Line18984	Note:
31Jan17 / 14Mar17	

EXTERIOR COLOURS

Inv.702	1 - EXTERIOR COLOUR PACKAGE 9
Line14013	Note:
27Jul16 / 15Nov16	

FORMING

Inv.702	1 - EXTERIOR: DO NOT INSTALL SIDE DOOR- HOME TO EXTERIOR- AS PER PLAN AND GRADE DOES NOT PERMIT
Line9340	Note: REFEND ISSUED ON PE:981
27Jul16 / 15Nov16	

FRAMING

Inv.702	1 - GARAGE: INSTALL MANDOOR - GARAGE TO HOUSE- AS PER PLAN AND GRADE PERMITING
Line9339	Note: GIVEN IN AGREEMENT OF PURCHASE AND SALE
27Jul16 / 15Nov16	
Inv.702	1 - BEDROOM #4/ TWIN ENSUITE: CLOSE ENTRY FROM BED #4 INTO TWIN ENSUITE. SEE SKETCH
Line9348	Note:
27Jul16 / 15Nov16	
Inv.702	1 - BEDROOM #4: MOVE LOCATION OF BED #4'S CLOSET OVER INTO THE MASTER WALK-IN CLOSET, AS PER SKETCH.
Line9351	Note:
27Jul16 / 15Nov16	
Inv.702	1 - LAUNDRY ROOM: MOVE LAUNDRY ROOM TO BASEMENT AND MAKE ROOM INTO A THREE PIECE WASHROOM FOR BEDROOM #4. AS PER SKETCH
Line9359	Note:
27Jul16 / 15Nov16	
Inv.702	1 - MAIN FLOOR: INSTALL SIX (X6) STANDARD DOOR EXTENDED HEIGHT 96" (PRICE PER DOOR)- GROUND FLOOR 2 STOREY MODELS, FOR CLOSETS, POWDER ROOM AND BASEMENT DOORS. SEE SKETCH
Line14019	Note:
27Jul16 / 15Nov16	

Brampton Encore - 130 - 1 - 41-3 Elev.A CHOPIN

HARDWOOD

Inv.1,149	1 - DINING ROOM: INSTALL PREVERCO ENGINEERED RED OAK, 4 1/4" IN KOMOMDO Upgrade 1 LEVEL S Dining
Line16991	Note:
31Jan17 / 14Mar17	
Inv.1,149	1 - FAMILY ROOM: INSTALL PREVERCO ENGINEERED RED OAK, 4 1/4" IN KOMOMDO Upgrade 1 LEVEL S Family
Line16992	Note:
31Jan17 / 14Mar17	
Inv.1,149	1 - MAIN HALL: INSTALL PREVERCO ENGINEERED RED OAK, 4 1/4" IN KOMOMDO Upgrade 1 LEVEL S Main Hall
Line16993	Note:
31Jan17 / 14Mar17	

HVAC

Inv.702	1 - LAUNDRY ROOM: MOVE LAUNDRY ROOM TO BASEMENT AND MAKE ROOM INTO A THREE PIECE WASHROOM FOR BEDROOM #4. AS PER SKETCH
Line14015	Note:
27Jul16 / 15Nov16	

INTERIOR TRIM AND DOORS

Inv.702	6 - MAIN FLOOR: INSTALL SIX (X6) STANDARD DOOR EXTENDED HEIGHT 96" (PRICE PER DOOR)- GROUND FLOOR 2 STOREY MODELS, FOR CLOSETS, POWDER ROOM AND BASEMENT DOORS. SEE SKETCH
Line9343	Note:
27Jul16 / 15Nov16	

KITCHEN AND BATH CABINETRY

Inv.1,149	1 - KITCHEN CABINETRY: NOTE: ELECTRICAL WAS PURCHASED FOR A BUILT-IN WALL OVEN/ MICROWAVE UNIT, HOWEVER, CABINETRY EXTRAS WERE NOT PURCHASED. ELECTRICAL WILL BE INSTALLED AND ACCESSIBLE IN STANDARD CABINETS
Line16997	Note:
31Jan17 / 14Mar17	

MISC.

Inv.702	1 - BONUS PACKAGE: \$10,000.00 (INCLUDING TAXES) WORTH OF UPGRADES FROM GOLD PARK HOMES DÉCOR CENTRE IS BEING APPLIED TOWARD THE STRUCTURAL APPOINTMENT. PURCHASER HAS A REMAINING AMOUNT OF \$00 (INCLUDING TAXES) TO BE USED TOWARD THE COLOUR APPOINTMENT
Line9386	Note:
27Jul16 / 15Nov16	
Inv.702	1 - Purchaser has attended a Structural appointment at the Decor Centre & has DECLINED any additional upgrades and accepts and acknowledges that there will be no further structural changes/additions/deletions to be made upon signing on July 27, 2016.
Line9387	Note:
27Jul16 / 15Nov16	
Inv.702	1 - Purchasers are aware & accepts that ANY changes made to upgrades after signing this Purchasers Extra Form are subject to a minimum administration fee of \$500. PLUS a 10% holdback fee
Line9388	Note:
27Jul16 / 15Nov16	
Inv.981	1 - SMOOTH CEILINGS - (2-Story Design) 2ND FLOOR
Line14012	Note:
15Nov16 / 14Mar17	

**Brampton Encore - 130 - 1 - 41-3 Elev.A CHOPIN**

Inv.981	1 - EXTERIOR SIDE DOOR REFUND- GRADE DOES NOT PERMIT
Line14011	Note:
15Nov16 / 14Mar17	
Inv.1,149	1 - Purchaser has attended a Colour appointment at the Decor Centre & has DECLINED any additional upgrades and accepts and acknowledges that there will be no further structural changes/additions/deletions to be made upon signing on January 31, 2017
Line16998	Note:
31Jan17 / 14Mar17	
Inv.1,149	1 - Purchasers are aware & accepts that ANY changes made to upgrades after signing this Purchasers Extra Form are subject to a minimum administration fee of \$500. PLUS a 10% holdback fee
Line16999	Note:
31Jan17 / 14Mar17	

**PAINTING**

Inv.1,149	1 - STAIRCASE: Stain Staircase 2 Storey Model (Euroline Pickets Charged Separately)
Line16994	Note:
31Jan17 / 14Mar17	

**PLUMBING**

Inv.702	1 - KITCHEN: INSTALL ROUGH-IN - WATERLINE FOR FRIDGE
Line9344	Note:
27Jul16 / 15Nov16	
Inv.702	1 - LAUNDRY ROOM: MOVE LAUNDRY ROOM TO BASEMENT AND MAKE ROOM INTO A THREE PIECE WASHROOM FOR BEDROOM #4. AS PER SKETCH
Line14016	Note:
27Jul16 / 15Nov16	

**STAIRS AND RAILINGS**

Inv.1,149	1 - STAIRCASE: INSTALL 1 34 Inch LOTUS Non Fluted
Line16995	Note:
31Jan17 / 14Mar17	
Inv.1,149	1 - STAIRCASE: INSTALL V Groove Handrail
Line16996	Note:
31Jan17 / 14Mar17	

**WINDOWS - BASEMENT**

Inv.702	3 - BASEMENT: INSTALL THREE (X3) BASEMENT WINDOWS - UPGRADE EXISTING BASEMENT WINDOW TO 30 INCH X 24 INCH - MAY REQUIRE INSTALLATION OF WINDOW WELL
Line9342	Note:
27Jul16 / 15Nov16	

Scheduled Closing Date:

Purchaser: Ya Zhen Chen  
Telephone Res. / Bus: (647) 802-8093  
Decor Advisor: Terri Parisani

Property: 130 of Plan -  
Project: Fieldwalk Investments Inc.  
Model and Elevation: 41-3 Elev.A CHOPIN

Layout Changes: ☐ Yes ☒ No Sketch Attached: ☒ Yes ☐ No Exterior Colour Scheme:

1. Cabinetry

	Style and Colour	Counter	Hardware
Kitchen / Breakfast	Venice(pvc)ChocoMaple	Grigio Sardo Granite Edge: FE20	cs1-18
Laundry Room	-		
Powder Room	-		
TWIN BATH	Carrara(pvc)VanillaStix	6696-46 Bianco Carrara Laminate	cs1-10
Master Ensuite Bathroom	Carrara(pvc)VanillaStix	6696-46 Bianco Carrara Laminate	cs1-10
Second Ensuite Bathroom (If Applicable)	Carrara(pvc)VanillaStix	6696-46 Bianco Carrara Laminate	cs1-10
ENSUITE 3	Carrara(pvc)VanillaStix	6696-46 Bianco Carrara Laminate	cs1-10
Dishwasher Cabinet	-		
Comment			

2. Floor Tile

	Selection	Grout	Threshold
Entrance Vestibule	*Upg.4 CarraraX Series White Polished 12x2	N/A	N/A
Main Hall	-		
Kitchen / Breakfast	*Upg.4 CarraraX Series White Polished 12x2	N/A	N/A
Laundry Room	-	N/A	N/A
Powder Room	*Upg.4 CarraraX Series White Polished 12x2	N/A	N/A
TWIN BATH	Costa Matte White 13 x 13	N/A	N/A
Master Ensuite Bathroom	Costa Matte White 13 x 13	N/A	N/A
Second Ensuite Bathroom (If Applicable)	Costa Matte White 13 x 13	N/A	N/A
Lower Landing (If Applicable)	-		
ENSUITE 3	Costa Matte White 13 x 13	N/A	N/A

Comment

GROUND FLOOR HALL: Serpentine Krem 13 x 13

3. Wall Tile

	Selection	Listello/Inserts	Describe
TWIN BATH	Weave White 8 x 10	<input type="radio"/> Yes <input checked="" type="radio"/> No	
Master Ensuite Bathroom			
Tub Deck	Weave White 8 x 10	<input type="radio"/> Yes <input checked="" type="radio"/> No	
Shower Stall	Weave White 8 x 10	<input type="radio"/> Yes <input checked="" type="radio"/> No	
Bathroom Walls	Weave White 8 x 10	<input type="radio"/> Yes <input checked="" type="radio"/> No	
Second Ensuite Bathroom (If Applicable)	Weave White 8 x 10	<input type="radio"/> Yes <input checked="" type="radio"/> No	
ENSUITE 3		<input type="radio"/> Yes <input type="radio"/> No	

Kitchen Backsplash ☐ Yes ☒ No Backsplash Behind Fridge

Comment

Scheduled Closing Date:

Purchaser: Ya Zhen Chen  
Telephone Res. / Bus: (647) 802-8093  
Decor Advisor: Terri Parisani

Property: 130 of Plan -  
Project: Fieldwalk Investments Inc.  
Model and Elevation: 41-3 Elev.A CHOPIN

4. Plumbing Fixtures

<input type="checkbox"/>	Second Ensuite	<input type="checkbox"/>	Powder Room	<input type="checkbox"/>	
Master Ensuite Bathroom	<input type="checkbox"/>	Other Room - Specify	<input type="checkbox"/>	Other Washroom	<input type="checkbox"/>

Comment

ALL FIXTURES TO REMAIN STANDARD THROUGHOUT

5. Hardwood Flooring

	Type and Stain		Type and Stain
Main Hall	*Upg.1, Preverco 4 1/4" Komodo	Upper Landing	
Kitchen / Breakfast		Upper Hall	
Living Room		Master Bedroom	
Dining Room	*Upg.1, Preverco 4 1/4" Komodo	Bedroom #2	
Family Room	*Upg.1, Preverco 4 1/4" Komodo	Bedroom #3	
Den/Library		Bedroom #4	
Entrance Vestibule		Bedroom #5	
Lower Landing (If Applicable)		Other Room - Specify	

Comment

ALL HARDWOOD IS ENGINEERED RED OAK

6. Carpeting

	Upgrade	Description
Main Hall	<input type="checkbox"/>	
Living Room	<input type="checkbox"/>	
Dining Room	<input type="checkbox"/>	
Family Room	<input type="checkbox"/>	
Den/Library	<input type="checkbox"/>	
Upper Hall	<input type="checkbox"/>	T-13
Master Bedroom	<input type="checkbox"/>	T-13
Bedroom #2	<input type="checkbox"/>	T-13
Bedroom #3	<input type="checkbox"/>	T-13
Bedroom #4	<input type="checkbox"/>	T-13
Bedroom #5	<input type="checkbox"/>	
ROUND FLOOR	<input type="checkbox"/>	
Upper Landing (If Applicable)	<input type="checkbox"/>	
Lower Landing (If Applicable)	<input type="checkbox"/>	

Upgrade Underpad	Type STANDARD	Area
Carpet on Stairs	Capped	Runner - *Upgrade

Comment

Scheduled Closing Date:

Purchaser: Ya Zhen Chen

Property: 130 of Plan -

Telephone Res. / Bus: (647) 802-8093

Project: Fieldwalk Investments Inc.

Decor Advisor: Terri Parisani

Model and Elevation: 41-3 Elev.A CHOPIN

7. Fireplace

	Living Room			Family Room			Other Room - Specify		
	Purchased	As Per Plan	N/A	Purchased	As Per Plan	N/A	Purchased	As Per Plan	N/A
	<input type="radio"/>	<input type="radio"/>	<input checked="" type="radio"/>	<input type="radio"/>	<input checked="" type="radio"/>	<input type="radio"/>	<input type="radio"/>	<input type="radio"/>	<input checked="" type="radio"/>
Fireplace Type	<input type="text"/>			STANDARD			<input type="text"/>		
Mantle Type	<input type="text"/>			NF-20			<input type="text"/>		
Colour / Stain	<input type="text"/>			WHITE PAINT-GRADE			<input type="text"/>		
Surround	<input type="text"/>			BIANCO CARRARA			<input type="text"/>		
Hearth	<input type="text"/>			NONE			<input type="text"/>		
Comment	<input type="text"/>								

8. Trim Carpentry

Interior Doors	STANDARD	Front Door Glass Inserts	STANDARD	Door Handles	STANDARD
Interior Trim	STANDARD				
Comment	<input type="text"/>				

9. Plaster Mouldings and Medallions

Entrance Vestibule	N/A	<input type="text"/>	Kitchen/Breakfast	N/A	<input type="text"/>
Main Hall	N/A	<input type="text"/>	Den/Library	N/A	<input type="text"/>
Living Room	N/A	<input type="text"/>	Lower Landing	N/A	<input type="text"/>
Dining Room	N/A	<input type="text"/>	Other Room - Specify	N/A	<input type="text"/>
Family Room	N/A	<input type="text"/>			
Comment	<input type="text"/>				

10. Railings and Spindles

Railing Package	*LOTUS WITH V-GROOVE HANDRAIL		
Railing Colour	*KOMODO RED OAK	Spindle Colour	*KOMODO RED OAK
Stringer / Riser	*KOMODO RED OAK	Treads	*KOMODO RED OAK
Comment	Oak Stairs		<input checked="" type="radio"/> Yes <input type="radio"/> No
<input type="text"/>			

11. Wall Paint

Main & Upper Hall	WARM GREY	Master Bedroom	WARM GREY
Living Room	WARM GREY	Bedroom #2	WARM GREY
Dining Room	WARM GREY	Bedroom #3	WARM GREY
Kitchen / Breakfast	WARM GREY	Bedroom #4	WARM GREY
Family Room	WARM GREY	Bedroom #5	WARM GREY
Powder Room	WARM GREY	Master Ensuite	WARM GREY
Laundry Room	WARM GREY	TWIN BATH	WARM GREY
Den/Library	WARM GREY	Second Ensuite	WARM GREY
Trim Paint	WHITE	GROUND FLOOR	WARM GREY
Comment	Smooth Ceilings First Floor <input type="text"/>		
<input type="text"/>			

Scheduled Closing Date:

Purchaser: Ya Zhen Chen

Property: 130 of Plan -

Telephone Res. / Bus: (647) 802-8093

Project: Fieldwalk Investments Inc.

Decor Advisor: Terri Parisani

Model and Elevation: 41-3 Elev.A CHOPIN

12. Electrical

Plugs and Switches ☒ White ☐ Ivory

Above Kitchen Cabinet Light ☐ Yes ☒ No

Hood Fan ☐ White ☐ Ivory

Below Kitchen Cabinet Light ☐ Yes ☒ No

Appliances Built in Cooktop

Built in Oven

Gas Stove

Microwave

☐ Yes ☒ No

☐ Yes ☒ No

☐ Yes ☒ No

☐ Yes ☒ No

Comment

STANDARD HOOD FAN: STAINLESS STEEL

13. Heating and Air Conditioning

Air Conditioning

Gas Provisions Stove

Gas Provisions Dryer

Gas Provisions Barbecue

Comment

GAS LINE FOR BBQ IS STANDARD

14. Additional Comments

15. Disclaimers and Notes

- 1) Colours of all materials are as close as possible to builder's selection, but not necessarily identical due to variances in manufacturing.
- 2) Any extras listed above are null and void unless accompanied by a separate invoice/amendment. Said invoice must be paid in full.
- 3) The Purchaser acknowledges that after Interior Colour Selection form is signed and dated, no further changes will be permitted other than re-selection due to unavailability. \_\_\_\_\_ Purchaser's Initials
- 4) The Purchaser acknowledges reading and accepting the "Gold Park Homes Decor Centre Disclaimers" form. This document contains other miscellaneous disclaimers.

This Interior Colour Selection is final and approved by:

Signature: Ya zhen chen Date: JAN 31 2017



Telephone — (T)  
Cable — (C)  
Electrical — (E)

# The Chopin 41' SERIES

Elevation A • 2,858 sq.ft. | Elevation B • 2,870 sq.ft.

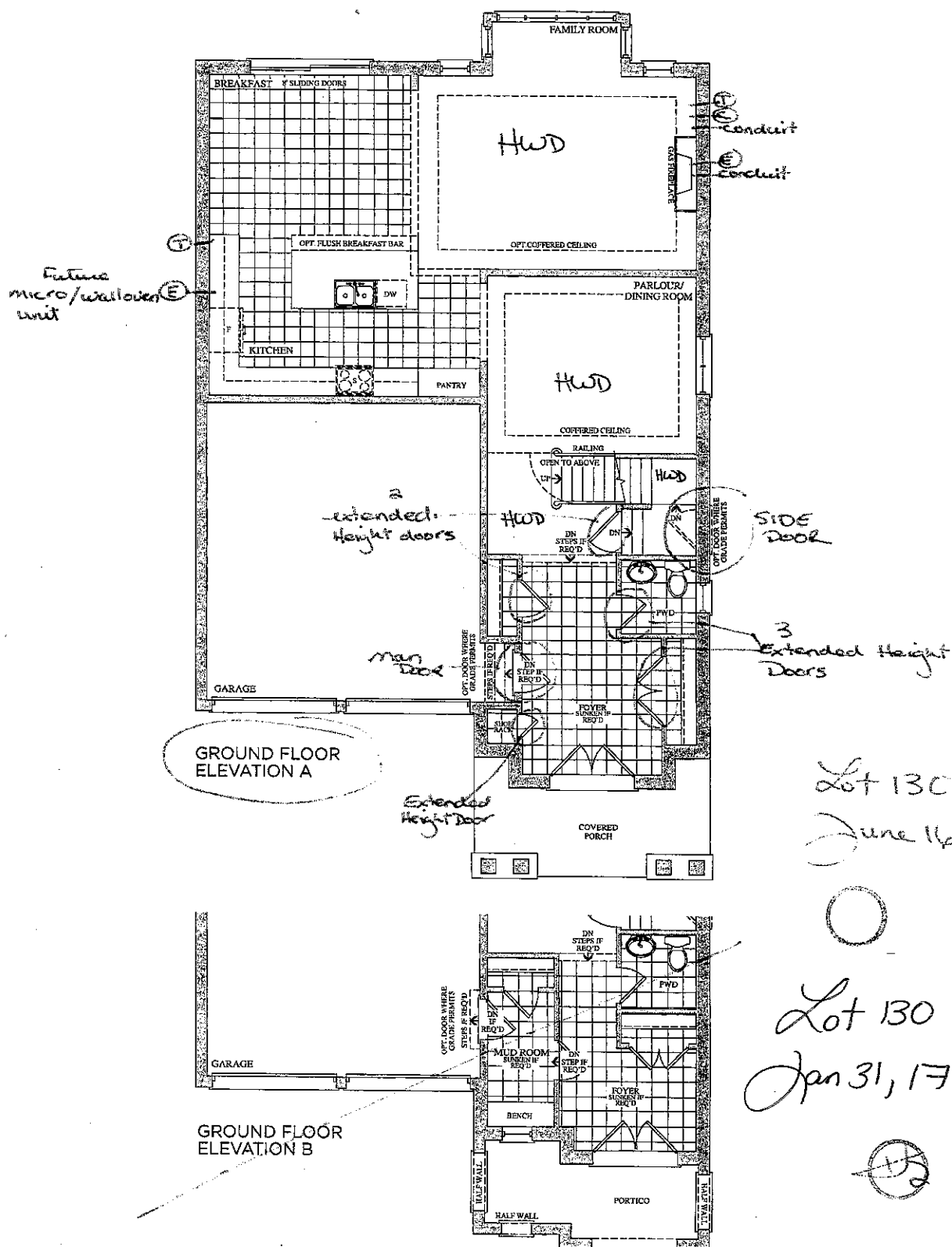

Prices, figures, illustrations, sizes, features and finishes are subject to change without notice. E.&O.E. Areas and dimensions are approximate and actual usable floor space may vary from the stated area. Layout may be reverse of the unit purchased. E. & O.E.

**GOLDPARK**  
HOMES

**GOLD PARK**  
HOMES

This layout has been explained to the purchaser by Cortina Kitchens Inc. and is understood by the purchaser.

The drawing shows a window unit with the following specifications:

- Overall Dimensions:**
  - Top width: 1670
  - Right height: 1220
  - Bottom width: 2630
  - Bottom height: 930
  - Bottom width (with extension): 5590
  - Right height (with extension): 1830
- Front Elevation Labels:**
  - Top left: U5010R, B50R
  - Middle left: U95100, B90
  - Bottom left: U956059, FR.
  - Bottom left (small): B25L, 50, 644, 320
  - Bottom middle: BB135DR, B100
  - Bottom right: U8060, U90100
  - Far right: 4 ADJ. SH., TU8024259, TU4024259
- Side Elevation Labels:**
  - Top: 248X90 PAN.
  - Left: 115X90 PAN.
  - Right: 115X80 PAN.
  - Internal: ELPL 6x6.5, SP., DW 61.5, B75, BS85, B20R
- Other Labels:**
  - IN LINE
  - ST.
  - 2.41
  - 6.41

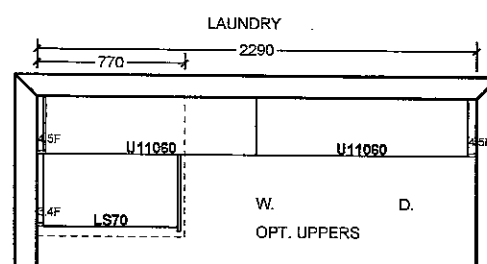
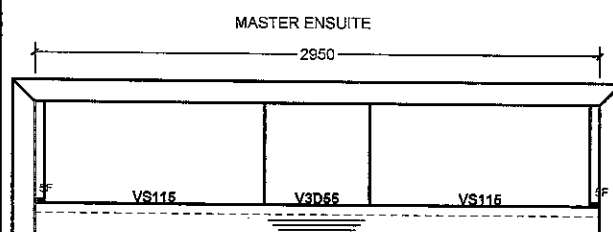
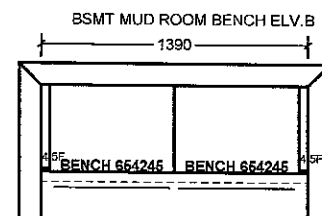
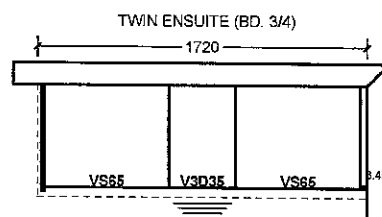
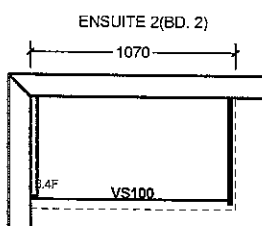

All prices subject to confirmation from head office.  
This quotation is subject to the terms & conditions set out

ACCEPTED DATE:

All agreements are contingent upon strikes, accidents, and delays beyond our control. Please provide our installer with template for sinkholes or \$150.00 will be charged for callback.

Item A. Wood grain and colour are characteristics of the product. We cannot guarantee that such grain and colour will always match.  
Item B. Cortina Kitchens Inc. reserves the right to alter dimensions and make technical changes without notice.

## Standard Plan

Lot 130

Jan 31, 17



# CORTINA

KITCHENS INC.

70 Regina Road Woodbridge ON L4L 8L6  
905-264-6464

## INFORMATION - PVC DOORS

Builder: Gold Park Homes Project: Encore Lot #: 130

All cabinets with PVC (Thermofoil) Doors come with melamine gables, panels and kick. The doors, crown moulding and light valance are PVC wrapped. Open shelves incorporated in design will only be available with melamine interiors. There will be variations in colour shades between the PVC parts (doors, crown and Light valance) and the melamine parts (open shelves, Gables, Panels and Kick) due to the difference in material.

Furring Panel with crown moulding to the ceiling is not available on all PVC door styles due to subtle variations in colour shades between the PVC parts (moulding) and the melamine parts (furring panel) due to the difference in material. Grain directions in wood grain pattern melamine, vary between the furring panel, crown moulding (horizontal) and the PVC doors (vertical).

Thank you for your understanding.

---

I am well informed of this information, and agree to the purchase of the above.

Purchaser: Ya zhen chen

Date: JAN. 31, 2017

GOLDPARK  
HOMES



Granite, Marble,  
Engineered Surfaces

Lot 130

Jan 31, 17



- Standard 2CM & 3CM
- Upgrade 1 2CM & 3CM
- Upgrade 1 4 CM
- Upgrade 2

20mm (3/4") Profiles

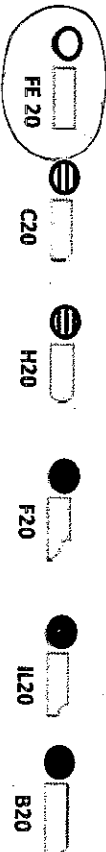

Kitchen

30mm (1 1/4") Profiles

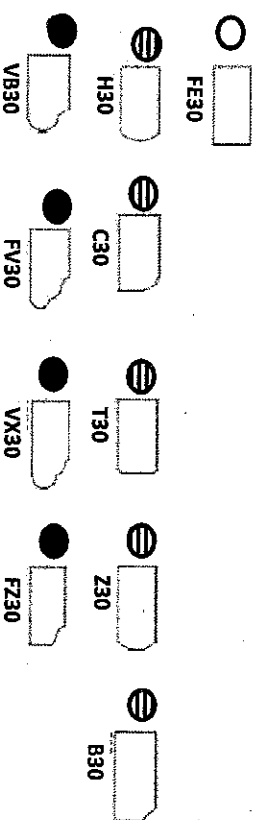

40mm (1 1/2") Profiles

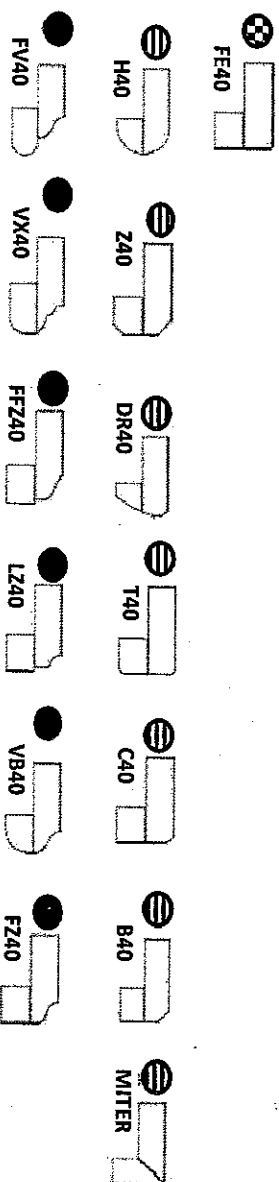

Note: All colours may not be available in 30mm at time ordered. Vendor reserves the right to use 40 mm edges (by lamination process).

\*Mitre edge is available in Upgrade 1 for an overall thickness of 2". All other Mitre edge options will be an Upgrade 2 Edge.

Lot 130  
Jan 31, 17



CSI-6

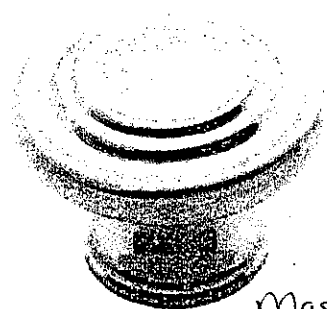

CSI-10

Master  
Twin  
Ens. 2  
Ens. 3

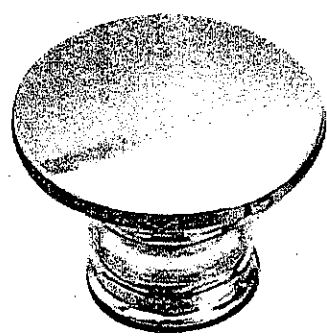

CSI-14



CSI-16

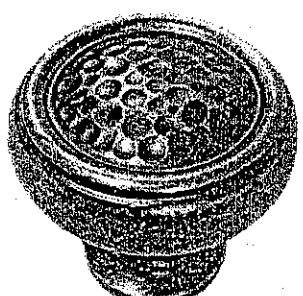

CSI-18

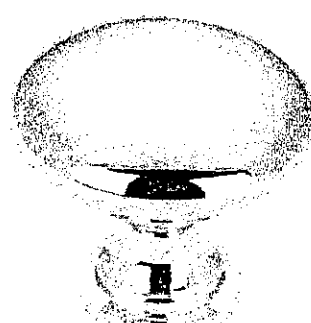

CSI-19

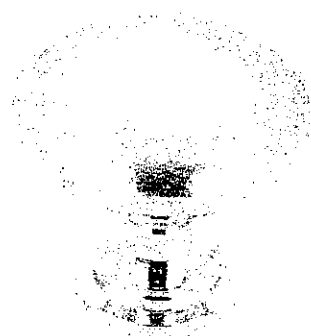

CSI-20

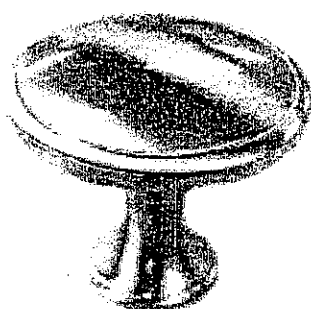

CSI-21

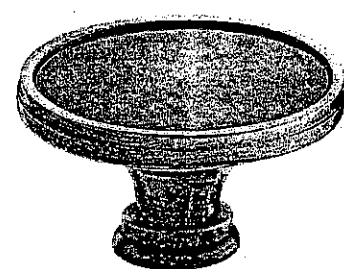

CSI-22

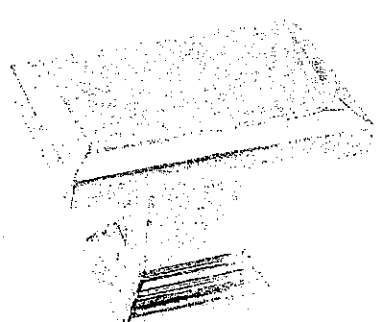

CSI-23

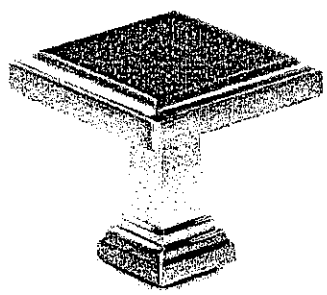

CSI-24

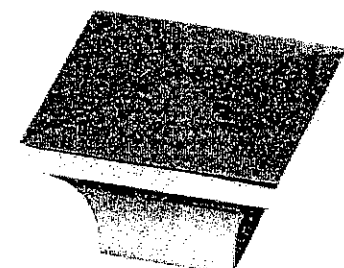

CSI-25

\*NOTES:

- IMAGES ARE FOR QUICK REFERENCE PURPOSES ONLY
- ACTUAL SIZES AND FINISHES AS PER HARDWARE
- SAMPLE BOARD PROVIDED TO DECOR CENTRE