

**Kleinburg Glen - 46 - 2 - 38-1 Elev.A HAMPTON**

**CENTRAL VAC AND WIRING**

Inv.1,232	1 - GREAT ROOM: CONDUIT PIPE - FOR TELEVISION - Above fireplace, approx 66" AFF. Please see floorplan for location
Line18589	Note: Terminating to the right of the fireplace - at standard height
7Mar17 / 29Aug17	
Inv.1,232	1 - INSTALL VAC PAN UNDER KITCHEN SINK
Line18590	Note:
7Mar17 / 29Aug17	
Inv.1,232	2 - EXTERIOR: CAT 6 WIRING - UPGRADE AN OUTLET TO CAT 6 - X2. 1 above front door - right hand side. 1 at read of home - top right side of kitchen window
Line18591	Note: see floorplan for location
7Mar17 / 29Aug17	

**CERAMIC**

Inv.1,276	1 - MAIN FLOOR TILE - Foyer: UPG 5, 24x24"
Line19845	Note:
25Mar17 / 30Aug17	
Inv.1,276	1 - MAIN FLOOR TILE - Kitchen: UPG 5, 24x24"
Line19847	Note:
25Mar17 / 30Aug17	
Inv.1,276	1 - MAIN FLOOR TILE - Powder Room: UPG 5, 24x24"
Line19846	Note:
25Mar17 / 30Aug17	

**ELECTRICAL**

Inv.1,232	1 - GREAT ROOM: Additional Interior Receptacle (not separate cicuit) above fireplace approx 66" AFF. Please see floorplan for location
Line18588	Note:
7Mar17 / 29Aug17	
Inv.1,232	10 - MAIN FLOOR: Pot Light 4" Halogen 440 WH - Price per potlight. Please see floorplan for locations
Line18593	Note:
7Mar17 / 29Aug17	
Inv.1,232	2 - MAIN FLOOR: Additional Interior Switch. 1 - Kitchen Pot lights / 1 - Great Room Pot lights.
Line18594	Note: See floorplan for location
7Mar17 / 29Aug17	
Inv.1,232	1 - KITCHEN: Rough-In ONLY Under Cabinet Valance Lighting - DOES NOT INCLUDE VALANCE
Line18595	Note:
7Mar17 / 29Aug17	
Inv.1,232	1 - SECOND FLOOR HALLWAY Lights: Additional Interior 4 way Switch
Line18596	Note: Both 2nd floor hallway lights to be controlled by 3 switches - one from main floor foyer, one from top of stairs on second floor, one by entrance to master bedroom. Please see floorplan for detail
7Mar17 / 29Aug17	
Inv.1,232	1 - KITCHEN: UPG hood fan to Cyclone SC(B)503
Line18598	Note: See spec sheet attached
7Mar17 / 29Aug17	
Inv.1,232	1 - KITCHEN: Relocate Standard Kitchen ceiling light to centred over island
Line18601	Note: Please see floorplan for new kitchen layout.
7Mar17 / 29Aug17	

Kleinburg Glen - 46 - 2 - 38-1 Elev.A HAMPTON

Inv.1,232	1 - GAS LINE ROUGH - MAIN FLOOR - (2 STOREY MODELS) FOR GAS STOVE- INCLUDES 110V PLUG ON SEPARATE CIRCUIT
Line23996	Note:
7Mar17 / 29Aug17	
Inv.1,276	1 - KITCHEN: Delete Upper cabinets above stove and finish sides for future 30" Chimney hoodfan. Please leave 36" opening.- DO NOT SUPPLY HOOD
Line24003	Note:
25Mar17 / 30Aug17	

Exterior Colours

Inv.1,232	1 - EXTERIOR COLOUR PACKAGE 2
Line23998	Note:
7Mar17 / 29Aug17	

FRAMING

Inv.1,232	1 - MAIN FLOOR: INCREASE DOOR HEIGHTS & ARCHWAYS TO 96"
Line18636	Note:
7Mar17 / 29Aug17	
Inv.1,232	1 - MAIN FLOOR: EXTENDED HEIGHT ARCHWAY (PRICE PER DOORWAY) - INCLUDE FRAMING NOTE
Line23993	Note:
7Mar17 / 29Aug17	
Inv.1,232	1 - STANDARD DOOR EXTENDED HEIGHT 96 INCH (PRICE PER DOOR) - GROUND FLOOR 2 STOREY MODELS
Line23994	Note:
7Mar17 / 29Aug17	
Inv.1,232	1 - MAN DOOR GARAGE TO HOUSE - TALLER HEIGHT 94"
Line23995	Note:
7Mar17 / 29Aug17	
Inv.1,232	1 - KITCHEN: RELOCATE 30" Stove & 6" duct for fan 1.5ft to the right (towards sink). After fridge gable to be approx 2.5ft of countertop space on either side of stove before sink.
Line23997	Note:
7Mar17 / 29Aug17	
Inv.1,276	1 - KITCHEN: To Add Furring panel & Crown Moulding- NO BULK HEAD
Line24000	Note:
25Mar17 / 30Aug17	
Inv.1,276	1 - FUTURE CHIMNEY HOOD
Line24002	Note:
25Mar17 / 30Aug17	

GRANITE MARBLE QUARTZ

Inv.1,276	1 - MASTER ENSUITE COUNTERTOP EDGE: UPG FE40
Line19843	Note:
25Mar17 / 30Aug17	
Inv.1,276	1 - MASTER ENSUITE VANITY COUNTERTOP: UPG 3
Line19842	Note:
25Mar17 / 30Aug17	

HARDWOOD

**Kleinburg Glen - 46 - 2 - 38-1 Elev.A HAMPTON**

Inv.1,276	1 - MAIN FLOOR HARDWOOD - Great Room: UPG 3
Line19849	Note:
25Mar17 / 30Aug17	
Inv.1,276	1 - MAIN FLOOR HARDWOOD - Main Hall: UPG 3
Line19848	Note:
25Mar17 / 30Aug17	
Inv.1,276	1 - MAIN FLOOR HARDWOOD - Dining Room: UPG 3
Line19850	Note:
25Mar17 / 30Aug17	

**HVAC**

Inv.1,232	1 - KITCHEN: RELOCATE 30" Stove & 6" duct for fan 1.5ft to the right (towards sink). After fridge gable to be approx 2.5ft of countertop space on either side of stove before sink.
Line18602	Note: Please see floorplan for detail
7Mar17 / 29Aug17	
Inv.1,232	1 - GAS LINE ROUGH - MAIN FLOOR - (2 STOREY MODELS) FOR GAS STOVE- INCLUDES 110V PLUG ON SEPARATE CIRCUIT
Line18597	Note:
7Mar17 / 29Aug17	
Inv.1,276	1 - KITCHEN: To Add Furring panel & Crown Moulding- NO BULKHEAD
Line24001	Note:
25Mar17 / 30Aug17	

**INTERIOR TRIM AND DOORS**

Inv.1,232	4 - MAIN FLOOR: EXTENDED HEIGHT ARCHWAY (PRICE PER DOORWAY) - INCLUDE FRAMING NOTE
Line18585	Note:
7Mar17 / 29Aug17	
Inv.1,232	4 - STANDARD DOOR EXTENDED HEIGHT 96 INCH (PRICE PER DOOR) - GROUND FLOOR 2 STOREY MODELS
Line18586	Note:
7Mar17 / 29Aug17	

**KITCHEN AND BATH CABINETRY**

Inv.1,276	1 - KITCHEN Cabinetry: UPG Stain Colour - Graphite
Line19841	Note:
25Mar17 / 30Aug17	
Inv.1,276	1 - KITCHEN: Add Light Valance
Line19853	Note:
25Mar17 / 30Aug17	
Inv.1,276	1 - KITCHEN COUNTERTOP Edge: UPG FE40
Line19844	Note:
25Mar17 / 30Aug17	
Inv.1,276	2 - KITCHEN: UPG - Add 2 sets of Pots & Pans drawer
Line19852	Note:
25Mar17 / 30Aug17	

**Kleinburg Glen - 46 - 2 - 38-1 Elev.A HAMPTON**

Inv.1,276	1 - KITCHEN: Add Furring panel & Crown Moulding
Line19854	Note:
25Mar17 / 30Aug17	
Inv.1,276	1 - KITCHEN: Delete Upper cabinets above stove and finish sides for future 30" Chimney hoodfan. Please leave 36" opening.
Line19867	Note:
25Mar17 / 30Aug17	

**MISC.**

Inv.1,232	1 - Purchaser has attended a Structural appointment at the Decor Centre & has DECLINED any additional upgrades and accepts and acknowledges that there will be no further structural changes/additions/deletions to be made upon signing.
Line18605	Note:
7Mar17 / 29Aug17	
Inv.1,232	1 - Purchasers are aware & accepts that ANY changes made to upgrades after signing this Purchasers Extra Form are subject to a minimum administration fee of \$500. PLUS a 10% holdback fee.
Line18606	Note:
7Mar17 / 29Aug17	
Inv.1,232	1 - BONUS PACKAGE: \$20,000.00 (INCLUDING TAXES) WORTH OF UPGRADES FROM GOLD PARK HOMES DÉCOR CENTRE IS BEING APPLIED TOWARD THE STRUCTURAL APPOINTMENT. PURCHASER HAS A REMAINING AMOUNT OF \$6,507.80 (INCLUDING TAXES) TO BE USED TOWARD THE COLOUR APPOINTMENT.
Line18607	Note:
7Mar17 / 29Aug17	
Inv.1,276	1 - Purchaser has attended a Colour appointment at the Decor Centre & has DECLINED any additional upgrades and accepts and acknowledges that there will be no further structural changes/additions/deletions to be made upon signing.
Line19863	Note:
25Mar17 / 30Aug17	
Inv.1,276	1 - TOTAL AFTER BONUS: \$22,455.23 Paid in full.
Line19866	Note:
25Mar17 / 30Aug17	
Inv.1,276	1 - Purchasers are aware & accepts that ANY changes made to upgrades after signing this Purchasers Extra Form are subject to a minimum administration fee of \$500. PLUS a 10% holdback fee.
Line19864	Note:
25Mar17 / 30Aug17	
Inv.1,276	1 - BONUS PACKAGE: \$6,507.80 (INCLUDING TAXES) WORTH OF UPGRADES FROM GOLD PARK HOMES DÉCOR CENTRE IS BEING APPLIED TOWARD THE COLOUR APPOINTMENT. PURCHASER HAS A REMAINING AMOUNT OF \$00 (INCLUDING TAXES) TO BE USED TOWARD THE COLOUR APPOINTMENT.
Line19865	Note:
25Mar17 / 30Aug17	

**PAINTING**

Inv.1,276	1 - STAIRS / RAILING: UPG Stain Colour - Vintage Eclipse
Line19851	Note:
25Mar17 / 30Aug17	

**PLUMBING FIXTURES**

Inv.1,276	2 - MASTER ENSUITE VANITY FAUCET: UPG to Arzo single lever lav faucet (Chrome) #586LF-MPU
Line19857	Note:
25Mar17 / 30Aug17	

**Kleinburg Glen - 46 - 2 - 38-1 Elev.A HAMPTON**

Inv.1,276	<b>1 - MASTER ENSUITE Shower Faucet:</b> UPG to Ara/Arzo Shower Faucet - with toe tester (Chrome) #T14467
Line19859	Note: See spec sheet attached
25Mar17 / 30Aug17	
Inv.1,276	<b>1 - KITCHEN SINK:</b> UPG to Blanco Quatrus R15U Super Single #401518 (Stainless)
Line19856	Note: See spec sheet attached
25Mar17 / 30Aug17	
Inv.1,276	<b>2 - MASTER ENSUITE VANITY Sinks:</b> UPG to Contrac Camden undermount sink (white) #4210CHY
Line19858	Note: See spec sheet attached
25Mar17 / 30Aug17	
Inv.1,276	<b>1 - MASTER ENSUITE Tub Faucet:</b> UPG to Arzo 3 piece Roman Tub (chrome) #T2786/R2709
Line19860	Note:
25Mar17 / 30Aug17	

**STAIRS AND RAILINGS**

Inv.1,276	<b>1 - STAIRS &amp; RAILINGS:</b> UPG to Euroline 1 with V-groove handrail
Line19855	Note:
25Mar17 / 30Aug17	

**WINDOWS - BASEMENT**

Inv.1,232	<b>2 - BASEMENT WINDOWS - UPGRADE EXISTING BASEMENT WINDOW TO 55 INCH X 16 INCH - MAY REQUIRE INSTALLATION OF WINDOW WELL</b>
Line18635	Note: 2 back windows, please see floorplan for location
7Mar17 / 29Aug17	

**WINDOWS AND DOORS**

Inv.1,232	<b>1 - MAN DOOR GARAGE TO HOUSE - TALLER HEIGHT 94"</b>
Line18587	Note:
7Mar17 / 29Aug17	
Inv.1,232	<b>1 - INSTALL MANDOOR- GRADE PERMITS</b>
Line23999	Note:
7Mar17 / 29Aug17	

Scheduled Closing Date:

Purchaser: Hong Li Li

Property: 46

Telephone Res. / Bus: (647) 669-6973 6978

Project: Berkshire Holdings Inc.

Decor Advisor: Laura Lofaro

Model and Elevation: 38-1 Elev.A HAMPTON

Layout Changes: ☐ Yes ☐ NoSketch Attached: ☐ Yes ☐ No

Exterior Colour Scheme:

## 1. Cabinetry

	Style and Colour	Counter	Hardware
Kitchen / Breakfast	FlorentineOak *Graphite	Granite Pol. Grigio Sardo *Edge FE40	CS1-20
Laundry Room	N/A		
Powder Room	N/A		
Master Ensuite Bathroom	FlorentineOakGreystone	*Caesarstone 3141 *Edge FE40	CS1-20
Second Ensuite Bathroom (If Applicable)	Sienna Oak Greystone	Formica Paloma Polar 6698-46	CS1-20
Twin Bath	Sienna Oak Greystone	Formica Paloma Polar 6698-46	CS1-20
Dishwasher Cabinet	N/A		

Comment

## 2. Floor Tile

	Selection	Grout	Threshold
Entrance Vestibule	*24x24 Timeless Series Light Grey Pol.	5th upg	
Main Hall	N/A		
Kitchen / Breakfast	*24x24 Timeless Series Light Grey Pol.	5th upg	
Laundry Room	13x13 Serpentine Beyaz (White)		
Powder Room	*24x24 Timeless Series Light Grey Pol.	5th upg	
Master Ensuite Bathroom	13x13 Serpentine Beyaz (White)		
Second Ensuite Bathroom (If Applicable)	13x13 Serpentine Beyaz (White)		
Lower Landing (If Applicable)	N/A		
Twin Bath	13x13 Serpentine Beyaz (White)		

Comment

See Wall Tile for Tub Skirt / Deck / Splash

## 3. Wall Tile

	Selection	Listello/Inserts	Describe
		<input type="radio"/> Yes <input checked="" type="radio"/> No	
Master Ensuite Bathroom			
Tub Deck	8x10 Weave Tender Grey	<input type="radio"/> Yes <input checked="" type="radio"/> No	
Shower Stall	8x10 Weave Tender Grey	<input type="radio"/> Yes <input checked="" type="radio"/> No	
Bathroom Walls		<input type="radio"/> Yes <input checked="" type="radio"/> No	
Second Ensuite Bathroom (If Applicable)	8x10 Weave Tender Grey	<input type="radio"/> Yes <input checked="" type="radio"/> No	
Twin Bath	8x10 Weave Tender Grey	<input type="radio"/> Yes <input checked="" type="radio"/> No	

Kitchen Backsplash ☐ Yes ☒ No

Backsplash Behind Fridge

Comment

Master Ensuite Tub Skirt / Tub Deck / Tub Splash / Shower wall - 8x10 Weave Tender Grey (Installed horizontally stacked)  
Twin Bath / Ensuite 2: STD Vertical stacked installation

14X

Scheduled Closing Date:

Purchaser: Hong Li Li

Property: 46

Telephone Res. / Bus: (647) 669-6978

Project: Berkshire Holdings Inc.

Decor Advisor: Laura Lofaro

Model and Elevation: 38-1 Elev.A HAMPTON

#### 4. Plumbing Fixtures

Master Ensuite Bathroom  Second Ensuite  Powder Room   
Other Room - Specify  Other Washroom

Comment

\*\*\*See Additional Comments

#### 5. Hardwood Flooring

	Type and Stain		Type and Stain
Main Hall	*Vintage - See Comments	Upper Landing	N/A
Kitchen / Breakfast	N/A	Upper Hall	N/A
Living Room	N/A	Master Bedroom	N/A
Dining Room	*Vintage - See Comments	Bedroom #2	N/A
Family Room	N/A	Bedroom #3	N/A
Den/Library	N/A	Bedroom #4	N/A
Entrance Vestibule	N/A	Bedroom #5	N/A
Lower Landing (If Applicable)	N/A	Other Room - Specify	
		Great Room	*Vintage - See Comments

Comment

\*Vintage Northern Solid Sawn Collection Builder Exclusive Pearl Red Oak 4-3/8" Eclipse

#### 6. Carpeting

	Upgrade	Description
Main Hall	<input type="checkbox"/>	N/A
Living Room	<input type="checkbox"/>	N/A
Dining Room	<input type="checkbox"/>	N/A
Family Room	<input type="checkbox"/>	N/A
Den/Library	<input type="checkbox"/>	N/A
Upper Hall	<input type="checkbox"/>	T03
Master Bedroom	<input type="checkbox"/>	T03
Bedroom #2	<input type="checkbox"/>	T03
Bedroom #3	<input type="checkbox"/>	T03
Bedroom #4	<input type="checkbox"/>	T03
Bedroom #5	<input type="checkbox"/>	N/A
	<input type="checkbox"/>	
Upper Landing (If Applicable)	<input type="checkbox"/>	N/A
Lower Landing (If Applicable)	<input type="checkbox"/>	N/A

Upgrade Underpad Type  Area   
Carpet on Stairs Capped  Runner - \*Upgrade

Comment

*(Signature)*

Scheduled Closing Date:

Purchaser: Hong Li Li

Property: 46

Telephone Res. / Bus: (647) 669-6973

Project: Berkshire Holdings Inc.

Decor Advisor: Laura Lofaro

Model and Elevation: 38-1 Elev.A HAMPTON

## 7. Fireplace

	Living Room			Family Room			Other Room - Specify <b>Great Room</b>		
	Purchased	As Per Plan	N/A	Purchased	As Per Plan	N/A	Purchased	As Per Plan	N/A
Fireplace Type	<input type="radio"/>	<input type="radio"/>	<input type="radio"/>	<input type="radio"/>	<input type="radio"/>	<input type="radio"/>	<input type="radio"/>	<input checked="" type="radio"/>	<input type="radio"/>
Mantle Type							STD Gas		
Colour / Stain							STD		
Surround							STD		
Hearth							N/A		
Comment							STD		

## 8. Trim Carpentry

Interior Doors **STD** Front Door Glass Inserts **STD** Door Handles **STD**

Interior Trim **STD**

Comment

\*8ft Doors Ordered at Structural

## 9. Plaster Mouldings and Medallions

Entrance Vestibule	N/A		Kitchen/Breakfast	N/A	
Main Hall	N/A		Den/Library	N/A	
Living Room	N/A		Lower Landing	N/A	
Dining Room	N/A		Other Room - Specify	N/A	
Family Room	N/A				

Comment

## 10. Railings and Spindles

Railing Package **\*Euroline 1 with V-Groove Handrail**

Railing Colour **\*Vintage - Eclipse**

Stringer / Riser **\*Vintage - Eclipse**

Spindle Colour **\*Black**

Treads **\*Vintage - Eclipse**

Oak Stairs ☒ Yes ☐ No

Comment

## 11. Wall Paint

Main & Upper Hall		Master Bedroom	
Living Room		Bedroom #2	
Dining Room		Bedroom #3	
Kitchen / Breakfast		Bedroom #4	
Family Room		Bedroom #5	
Powder Room		Master Ensuite	
Laundry Room			
Den/Library		Second Ensuite	
Trim Paint	White	Thru-Out	Warm Grey
Comment	Smooth Ceilings First Floor		

*Handwritten signature*



Scheduled Closing Date:

Purchaser: Hong Li Li

Property: 46

Telephone Res. / Bus: (647) 669-6973

Project: Burkshire Holdings Inc.

Decor Advisor: Laura Lofaro

Model and Elevation: 38-1 Elev.A HAMPTON

## 12. Electrical

Plugs and Switches ☐ White ☐ Ivory

Above Kitchen Cabinet Light ☐ Yes ☒ No

Hood Fan ☐ White ☐ Ivory

Below Kitchen Cabinet Light ☒ Yes ☐ No

Appliances Built in Cooktop

Built in Oven

Gas Stove

Microwave

☐ Yes ☒ No

☐ Yes ☒ No

☒ Yes ☐ No

☐ Yes ☒ No

Comment

## 13. Heating and Air Conditioning

Air Conditioning

Gas Provisions Stove

Gas Provisions Dryer

Gas Provisions Barbecue

Comment

## 14. Additional Comments

KITCHEN SINK: UPG to Blanco Quatrus R15U Super Single #401518 (Stainless)

MASTER ENSUITE VANITY FAUCET: UPG to Arzo single lever lav faucet (Chrome) #586LF-MPU

MASTER ENSUITE VANITY Sinks: UPG to Contrac Camden undermount sink (white) #4210CHY

MASTER ENSUITE Tub Faucet: UPG to Arzo 3 piece Roman Tub (chrome) #T2786/R2709

MASTER ENSUITE Shower Faucet: UPG to Ara/Arzo Shower Faucet (Chrome) #T14467

## 15. Disclaimers and Notes

- Colours of all materials are as close as possible to builder's selection, but not necessarily identical due to variances in manufacturing.
- Any extras listed above are null and void unless accompanied by a separate invoice/amendment. Said invoice must be paid in full.
- The Purchaser acknowledges that after Interior Colour Selection form is signed and dated, no further changes will be permitted other than re-selection due to unavailability.  Purchaser's Initials
- The Purchaser acknowledges reading and accepting the "Gold Park Homes Decor Centre Disclaimers" form. This document contains other miscellaneous disclaimers.

This Interior Colour Selection is final and approved by:

Signature: 

Date: March 25, 2017

*Gold Park Homes Décor*

**GOLD PARK**  
WORTH MORE™

## *Centre Disclaimers*

*Through years of doing business, we at Gold Park Homes have encountered issues beyond our control. The following disclaimers apply to all instances of Purchaser's Extras forms and all Interior Colour Scheme forms.*

### **FIREPLACES**

Fireplace Marble: Due to the many variables that can affect the pattern and/or design, frequently the marble installed on the fireplace will not be identical to the samples. We will make every attempt to come as close to the samples as possible, but cannot be responsible for results which differ from the samples.

### **CERAMIC FLOOR TILE**

Many variables including variegation can affect tile colour, pattern and/or design which mean installed tiles may not be identical to the samples. We will make every attempt to come as close as possible, but cannot be responsible for results which differ from the samples.

### **HARDWOOD FLOORING**

The purchaser is advised that cupping and shrinkage are characteristics of hardwood flooring normally appearing after installation, especially when humidity levels are not regulated, and no warranty is provided by the flooring supplier with respect to such cupping and shrinkage. Furthermore, hardwood floors may also heave and warp when located at or close to entrance points of the home, where rain could make its way to the flooring. The vendor agrees to install any hardwood flooring ordered by the purchaser in a good and workmanlike manner, but shall not be responsible for, and is hereby released by the purchaser from responsibility and liability for cupping, shrinkage, heaving and warping of hardwood flooring in the above mentioned circumstances.

### **STAIRCASE VS FLOORING**

#### **WOOD SPECIES DIFFERENCE**

The purchaser is aware and therefore accepts and acknowledges that the wood species of the staircase and flooring chosen do not match. This difference might result in an undesirable colour variance

The purchaser is aware and therefore accepts and acknowledges that though the flooring is of the same species as the staircase the difference in product finishing may result in a stain colour variance.

The purchaser agrees that the vendor is to be exempt from any and all claims by the purchaser regarding this colour variance.

### **RAILINGS**

All railings, pickets, posts, nosing's and stairs come from solid wood and veneered wood materials sourced from multiple locations and sources. As such there will be variations in grains and shades between the various natural components beyond our control. Due to this variance in material, all components will stain with colour or natural finish differently.

Iron pickets are wrought in nature and depending on the manufacturing process will have differences from picket to picket which is normal. Also the finish of the iron pickets is of a powder coated nature. This process can produce minor colour variations or tones. Furthermore, the assembly of the metal pickets can develop a natural rattle over time from vibration in the railing. Minor rattling is normal and is a part of the wrought iron picket assembly.

### **HOUSE EXTERIORS**

Variations in subcontractors across different sites and varying site conditions may result in house exteriors that differ from the artist renderings. We cannot be responsible for results which differ from the artists renderings of elevations.

### **PLASTER MOULDINGS AND MEDALLIONS**

Plaster mouldings will not be installed in open to above areas or areas with 2 storey elements.

### **STAIN COLOURS**

Due to the many variables that can affect the outcome of a stain colour on wood, staircases, railings, and fireplaces, the colour may not be identical to samples. Factors such as density, age, humidity, air temperature, and the uniqueness of each piece of wood can result in wide variations in darkness or lightness. We will make every attempt to come as close to the sample as possible, but cannot be responsible for results which differ from the samples.

Stain on pre-finished hardwood floors will not be an exact match to the stain colours available on stairs, pickets and rails. The purchaser is responsible for choosing the stain on these areas to their satisfaction.

### **IN-WALL CONDUIT FOR AUDIO/VIDEO CABLES**

It is important to note that due to the variation in framing requirements in different parts of your home, conduit lengths and routing can vary. In virtually all instances of ground floor installation (i.e. above a fireplace), conduit will first travel down into the basement below the floor joists, over to the termination point and back up into the main floor. As a result, it is best to measure the length of the conduit after occupancy with a "pull wire" before

1252-46

(12)

MAR. 25  
2017

purchasing your cables. For above-fireplace installations, the conduit wall plate will be installed approximately 10" above the Fireplace Mantle, unless otherwise specified in the Construction Summary.

### APPLIANCE SPECIFICATIONS

All appliance openings are set to builder's standard openings. Please advise Décor Centre at time of your structural appointment if custom sizing of cabinets is required for any built - in appliances. The purchaser is responsible for costs and fees associated with changes to pre-manufactured kitchens made subsequent to colour appointments.

Purchaser accepts & acknowledges that in order to accommodate upgraded appliances, all appliance specifications should be provided at the time of their structural appointment, should this not occur they must be provided to the Décor Center within one (1) week of completion of structural chart. Failure to do so may result in the need to revert to the standard appliance openings or in a delay in construction of your dwelling, as well as a cost of \$500 to re-open your structural file should changes be required. As a result we may be forced to extend the closing of your transaction. Due to failure to complete the above-mentioned selections and at no fault of our own, we reserve our right to hold you responsible for this delayed closing, including charging extra administration cost and interest on the balance due on closing.

Purchasers Accept Standard Appliance Openings (unless otherwise specified):

Fridge - 37-1/2"W x 73-1/2" High Approx.

Range - 30-1/2"D x 31-1/2"W Approx.

Dishwasher - 24" W Approx.

### DELETION OF HOODFAN & CABINETS ABOVE STOVE:

The purchasers are aware that in requesting NOT TO INSTALL builder's standard hood fan and standard cabinets above stove they will receive NO STANDARD HOOD FAN and NO CREDIT. Purchasers are installing their own hood fan after closing and accept that it may waive any warranty associated with such a change.

Purchasers accept and acknowledge that the exhaust fan duct hole may be off-centered with the stove in the kitchen due to purchasers installing their own hood fan after closing. The vendor is exempt from adjusting such openings for the purchasers range hood.

### ELECTRICAL FOR APPLIANCES

Pricing is subject to change based on the appliance specifications provided. Purchasers should provide proper appliance specifications and cut-out sheets in order for Gold Park to price extras accordingly.

### KITCHEN CABINETS

The kitchen you order/purchase will undoubtedly contain slight colour variations. The degree of these variations is virtually impossible to determine before the kitchen is installed in its intended location. The amount of and type of lighting will also affect various highlights in the finish. Note: No two pieces of wood are identical. Variations in colour tone and grain patterns make a perfect colour match virtually impossible. It is generally agreed that these variations add to the natural beauty of a wood kitchen.

### STAIN

Charcoal is a spray stain applied to Oak and Maple products with several characteristics that are important to be aware of when purchasing this product.

1. Shadow lines may be visible at the interior profile edges of a door or drawer front. If movement occurs shadow lines may increase or decrease, depending on the style and/or size of a door or drawer front.
2. Variation and unevenness may be visible in the finish.
3. Hairline cracks at the joints are created over time due to the nature of natural wood, caused by usage, humidity\*\*, or dryness. They tend to be more visible to darker stains, than lighter wood stains.

\*\* Relative humidity is recommended to be between 45% and 55%. Please refer to Cortina Kitchens "Cleaning, Care, Maintenance, & Warranty Information" guide.

Please be advised that Cortina Kitchens will not replace doors and/or parts that exhibit the above characteristics associated with this finish. These characteristics are not avoidable and are a result of the natural characteristics of wood and wood veneer, and the characteristics of darker stains on wood. The Charcoal stain is not available on doors in Group IV, Group IVA, Group V and Group VA.

Cortina Kitchens offers a wide variety of finishes, applied to oak and maple products. The subject finishes include the spray stains Cocoa, Espresso, Graphite as well as wiping stain Ebony.

Due to the very dark stains applied on natural maple and oak doors and joints, several characteristics are important to be noted when purchasing these products.

1. Shadow lines may be visible at the interior profile edges of a door or drawer front. If movement occurs shadow lines may increase or decrease, depending on the style and/or size of a door or drawer front.
2. Variation and unevenness may be visible in the finish.
3. Hairline cracks at the joints are created over time due to the nature of natural wood, caused by usage, humidity, or dryness. They tend to be more visible to darker stains, than lighter wood stains.

Please be advised that Cortina Kitchens will not replace doors nor parts that exhibit the above characteristics associated with this finish. These characteristics are not avoidable and are a result of the natural characteristics of wood and wood veneer, and the characteristics of darker stains on wood.

116246



MAR. 25, 2017

### **CABINETRY DOOR HARDWARE**

Cortina Kitchens' cabinetry doors and drawer fronts will be drilled to accept a standard knob or handle selected from Cortina's hardware boards. This drilling comes standard with the order, and is done ONLY in our shop, not on the job site.

For those not wanting Cortina's hardware drilling, the following applies:

No holes to be drilled on the doors and drawer fronts should be specified in writing on the colour chart and the P.O. If while in production, Cortina Kitchens misses this request, Cortina Kitchens and the Builder will not be held responsible to replace any or all doors and drawer fronts affected, and the customer agrees to accept the product as is. No hardware will be supplied or credited by Cortina Kitchens with this request. No charge will apply for this request.

### **PVC DOORS**

All cabinets with PVC (Thermofoil) Doors come with melamine gables, panels and kick. The doors, crown moulding and light valance are PVC wrapped. Open shelves incorporated in design will only be available with melamine interiors. There will be variations in colour shades between the PVC parts (doors, crown and Light valance) and the melamine parts (open shelves, Gables, Panels and Kick) due to the difference in material.

Furring Panel with crown moulding to the ceiling is not available on all PVC door styles due to subtle variations in colour shades between the PVC parts (moulding) and the melamine parts (furring panel) due to the difference in material. Grain directions in wood grain pattern melamine, vary between the furring panel, crown moulding (horizontal) and the PVC doors (vertical).

### **GRANITE, MARBLE ENGINEERED SURFACES WAIVER**

Granite and marble are naturally occurring products, and due to the many variables that can affect the pattern, colour and/or design and "pitting" of natural products slabs installed will not be identical to the samples displayed. We will make every attempt to come as close to the samples as possible, but cannot be responsible for results which differ from the samples. Every effort is made to provide granite counter tops as close as possible but the vendor is not responsible for results which differ from the sample displayed. All countertop surfaces may have seams & product pattern & shade can change in areas containing seams.

### **RESELECTIONS**

It is not uncommon for flooring, such as tile, to become discontinued prior to its installation. Therefore it may be necessary to make a reselection of certain materials sometime during the build process. We cannot assure you that another choice approximating your selection will be available.

### **PLANS**

Plans are subject to change without notice. Actual usable floor space may vary from the stated floor area. Layout for kitchen, furnace, HWT and laundry tub may vary from plan. Vertical and horizontal bulkhead, which are not shown on plan, may be required for plumbing and heating runs. E.& O.E.

### **PLEASE NOTE:**

In the event the work on the house has progressed beyond the point where the items covered by these invoices cannot be installed without entailing any unusual expense, then this order is to be cancelled and any deposit paid in connection with the same is to be refunded to the purchaser.

The vendor will undertake to incorporate the work covered by the sales extra in the construction of the house but will not be liable to the purchaser in any way, if for any reason the work covered by the extra is not carried out. In that event, any monies paid in connection with the same shall be returned to the purchaser.

It is understood and agreed that if for any reason whatsoever the transaction of Purchase and Sale is not completed, the total cost of extras ordered are not refundable to the Purchaser(s).

Extras or changes will not be processed unless signed by the Vendor.

These extras may not be amended without the written consent of Gold Park Homes.

The purchaser(s) and the builder acknowledge and agree that this "Purchaser's Extra" form shall not be deemed to be part of the agreement of purchase and sale entered into between them, nor an addendum thereto.

No postdated cheques will be accepted.

No estimates or orders will be accepted once construction has commenced.

Should a refund be requested on any extras purchased, an 80% reimbursement of the purchase price will be given. (a \$50.00 minimum charge and a maximum \$250.00 charge will apply)

Estimates will only be considered when resubmitted on a signed Purchaser Extras form, accompanied by payment in full.

All prices are estimates only and may be subject to change. Should a change in price occur Gold Park Homes reserves the right to request from the purchaser an adjustment of the price or a refund limited to that item.

Purchasers are aware & accept that ANY changes made to upgrades after signing the Purchasers Extra Form are subject to a minimum administration fee of \$500. PLUS a 10% holdback fee.

Purchasers are aware that any request to add a percentage of upgrades from the purchaser's extras form will be processed only after the builder receives approval letter from the bank.

K6246

(u)

MARCH 25/2017

Please be advised that your failure to finalize your structural or colour selections may result in a delay in construction of your dwelling and we may have to extend closing of your transaction. Due to failure to complete the above-mentioned selections and at no fault of us, we reserve our right to hold you responsible for a delayed closing, including charging extra administration cost and interest on the balance due on closing.

Purchaser has attended a Colour appointment at the Decor Centre & has DECLINED any additional upgrades and accepts and acknowledges that there will be no further structural changes/additions/deletions to be made upon signing.

I hereby acknowledge reading and understanding the above copy and will not hold Gold Park Homes responsible for any issues in relation to above.

Purchasers Signatures

\_\_\_\_\_

Date

\_\_\_\_\_

\_\_\_\_\_

K62-46

(M)

**GOLDPARK**  
HOMES

**Kleinfur**

**Granite, Marble,  
Engineered Surfaces**

- Standard 2CM & 3CM
- ⊖ Upgrade 1 2CM & 3CM
- ⊗ Upgrade 1 4 CM
- Upgrade 2

20mm (3/4") Profiles



30mm (1-1/4") Profiles

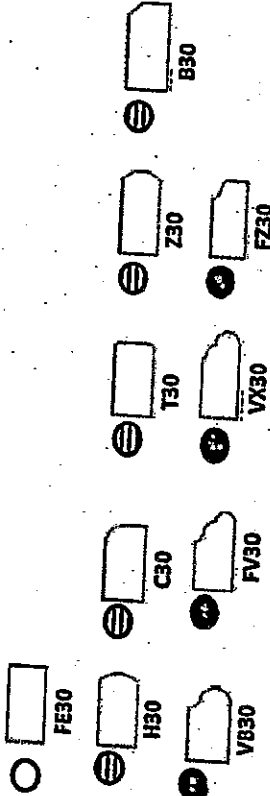

40mm (1-1/2") Profiles

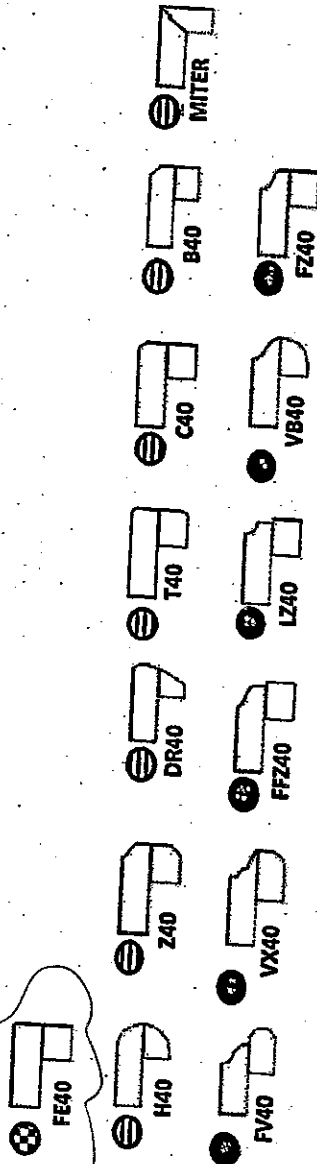

Note: All colours may not be available in 30mm at time ordered. Vendor reserves the right to use 40 mm edges (by lamination process).

\*Mitre edge is available in Upgrade 1 for an overall thickness of 2". All other Mitre edge options will be an Upgrade 2 Edge.

KITCHEN  
+  
MASTER EN SUITE  
(upgraded sinks)

1652-46

(11)

MARCH 25, 2017

STANDARD HARDWARE

STANDARD HARDWARE



CSI-6



CSI-10

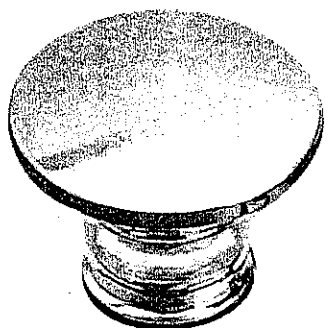

CSI-14



CSI-16

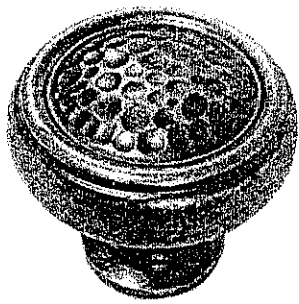

CSI-18

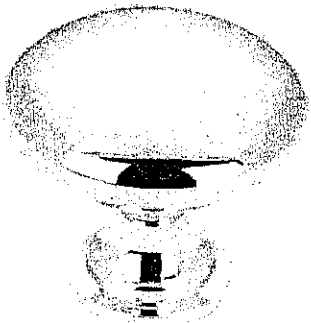

CSI-19

→ MASTER ENSUITE / ENS. 2 / TURN BATH / KITCHEN

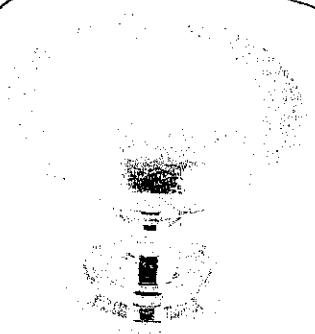

CSI- 20

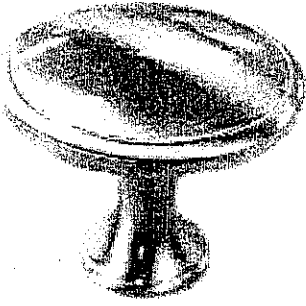

CSI- 21

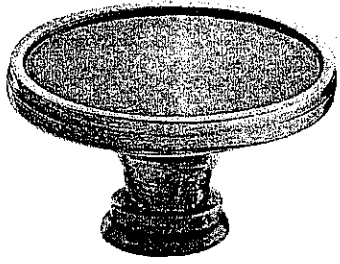

CSI-22

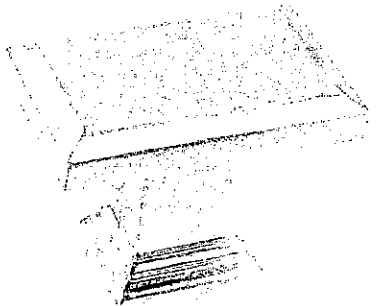

CSI- 23

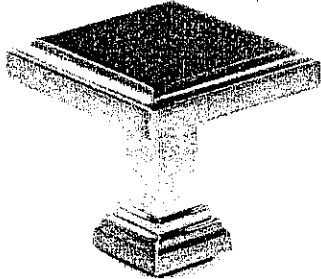

CSI- 24

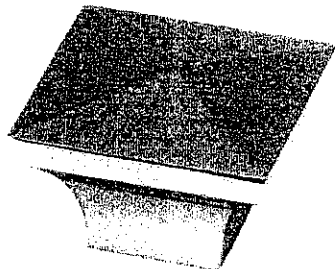

CSI-25

K62-46

(M)

MARCH 25, 2017

**\*NOTES:**  
- IMAGES ARE FOR QUICK REFERENCE PURPOSES ONLY  
- ACTUAL SIZES AND FINISHES AS PER HARDWARE  
SAMPLE BOARD PROVIDED TO DECOR CENTRE

# CORTINA

70 Regina Road, Woodbridge, Ontario L4L 8L8  
Tel: 905-264-6484 Fax: 905-264-0884  
www.CortinaKitchens.com

## QUOTATION

Date: 28/06/16

Trade Name: Gold Park Homes

Site location:

Model: 38-1

Address:

Project: Kleinburg Glen

Phase:

This layout has been explained to the purchaser by Cortina Kitchens Inc. and is understood by the purchaser.

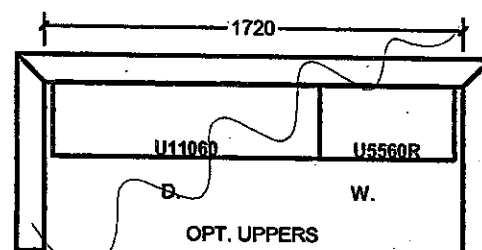
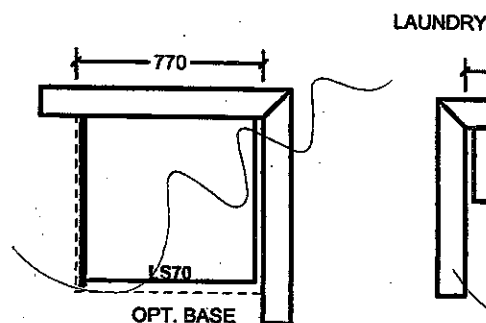
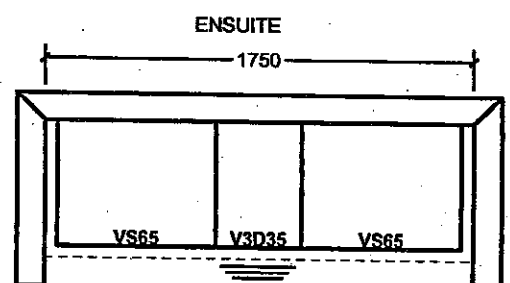
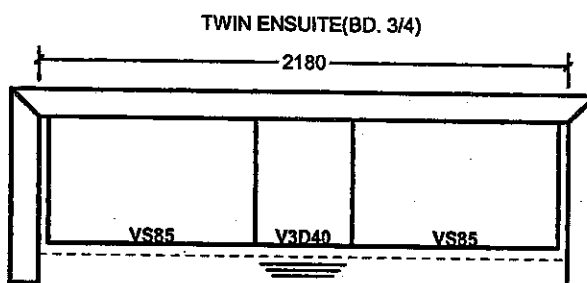
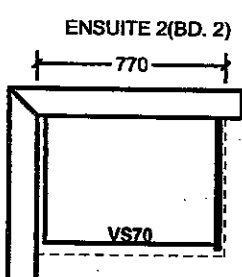
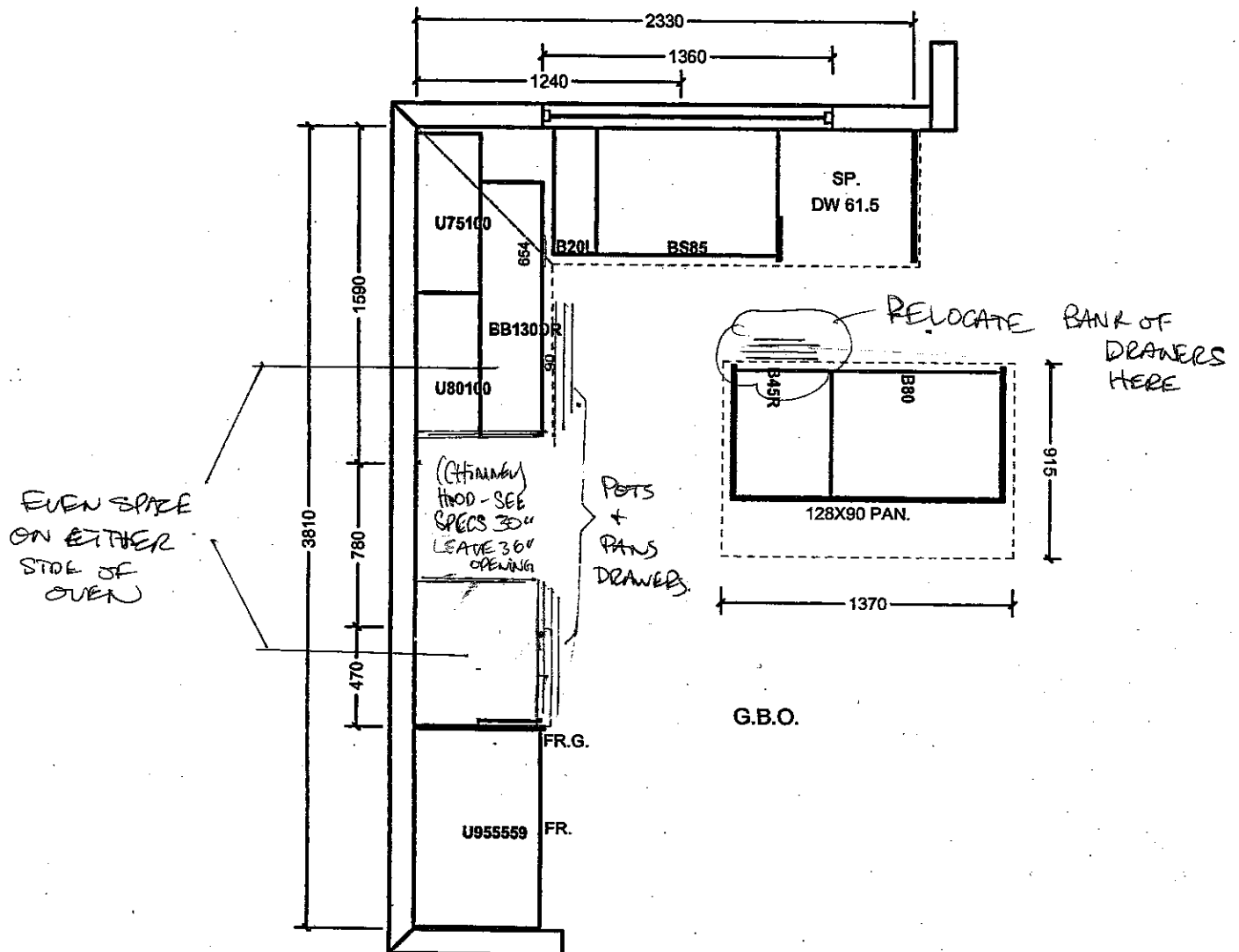

All prices subject to confirmation from head office.  
This quotation is subject to the terms & conditions set out

All agreements are contingent upon strikes, accidents, and delays beyond our control.  
Please provide our installer with template for sinkholes or \$150.00 will be charged for callback.

ACCEPTED DATE: MARCH 25, 2017

K62-46

*[Signature]*

Item A. Wood grain and colour are characteristics of the product. We cannot guarantee that such grain and colour will always match.  
Item B. Cortina Kitchens Inc. reserves the right to alter dimensions and make technical changes without notice.



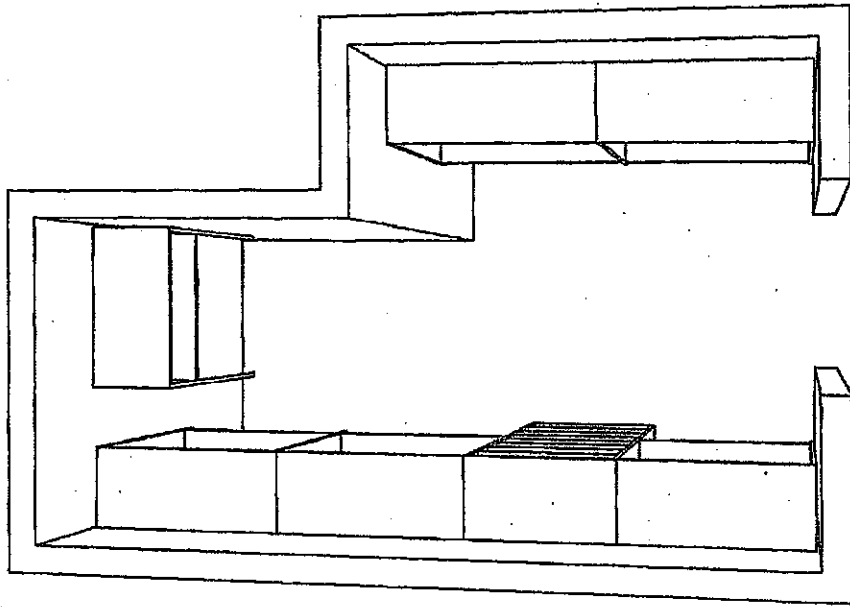

462-46

(12)

MARCH 25, 2017

The Home Organizer <YOUR ADDRESS> <YOUR CITY AND STATE> Phone: <YOUR PHONE NUMBER> Fax: <YOUR FAX NUMBER>	GPH MODEL 38-1	Perspective	
	GPH MODEL 38 -1 Room 1	Current Date: Feb 07, 2017	Scale: NTS

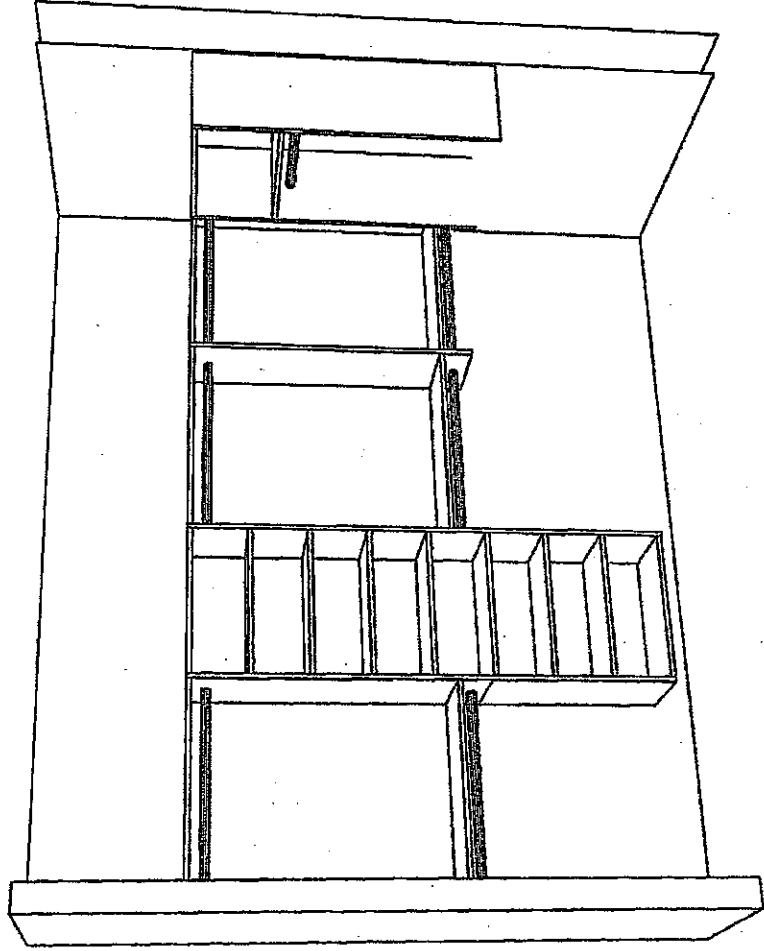

162-46

(162)

MARCH 25, 2017

The Home Organizer <YOUR ADDRESS> <YOUR CITY AND STATE> PHONE <YOUR PHONE NUMBER> FAX <YOUR FAX NUMBER>	GPH MODEL 38-1	Perspective
	GPH MODEL 38-1 Room 1	Current Date: Feb 07, 2017      Scale: NTS

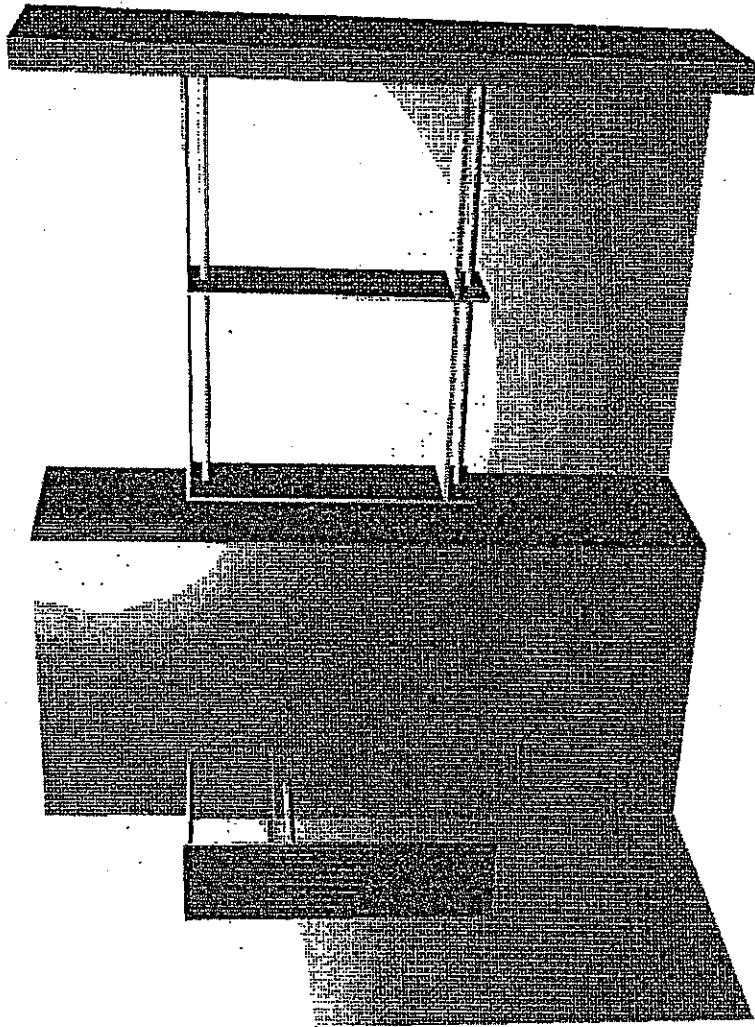

162-46

Box

MARCH 25, 2017

The Home Organizer <YOUR ADDRESS> <YOUR CITY AND STATE> Phone: <YOUR PHONE NUMBER> Fax: <YOUR FAX NUMBER>	GPH MODEL 38-1	Perspective
	GPH MODEL 38 -1 Room 1	Current Date: Feb 07, 2017      Scale: NTS

Blanco Quatrus R15U Super Single kitchen sink #401518 (stainless)

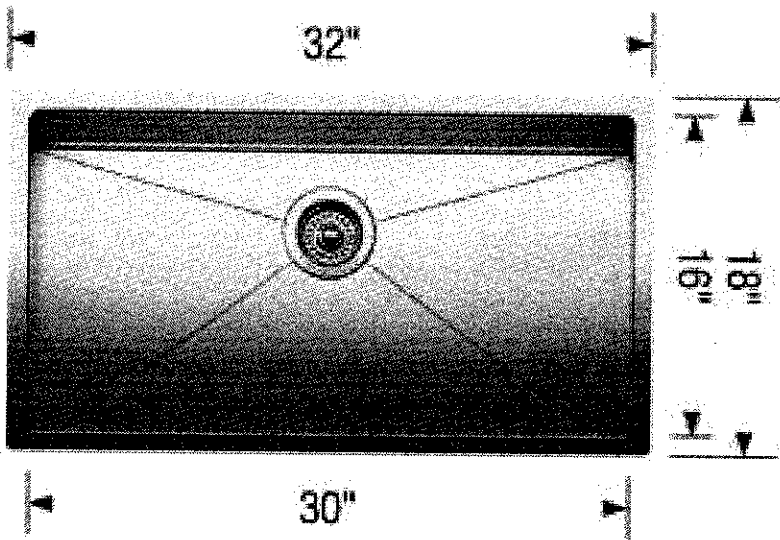
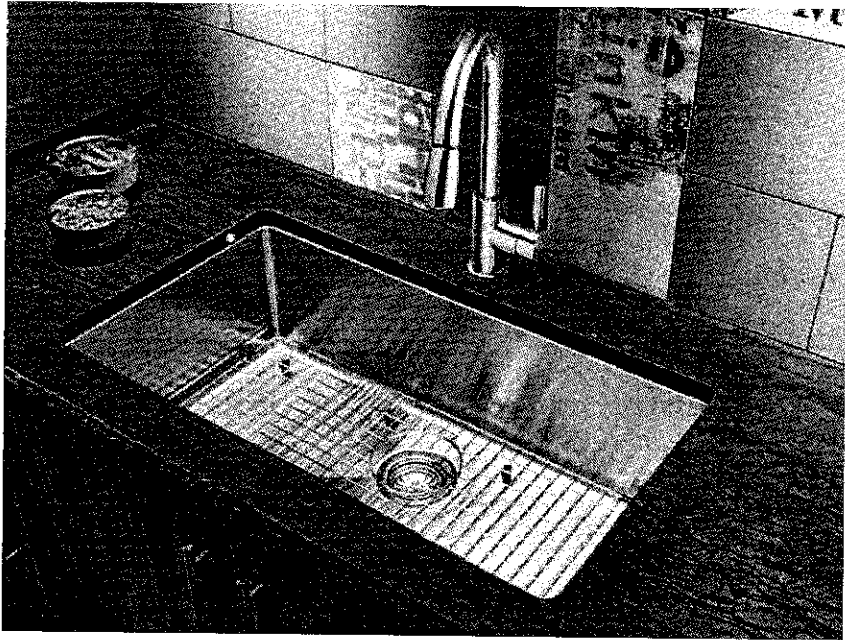

LOT #  
K62-46

ROOM:  
KITCHEN

SIGNATURE:  

DATE:  
MARCH 25, 2017

SIGNATURE:

Arzo single lever lav faucet (chrome) #586LF-MPU

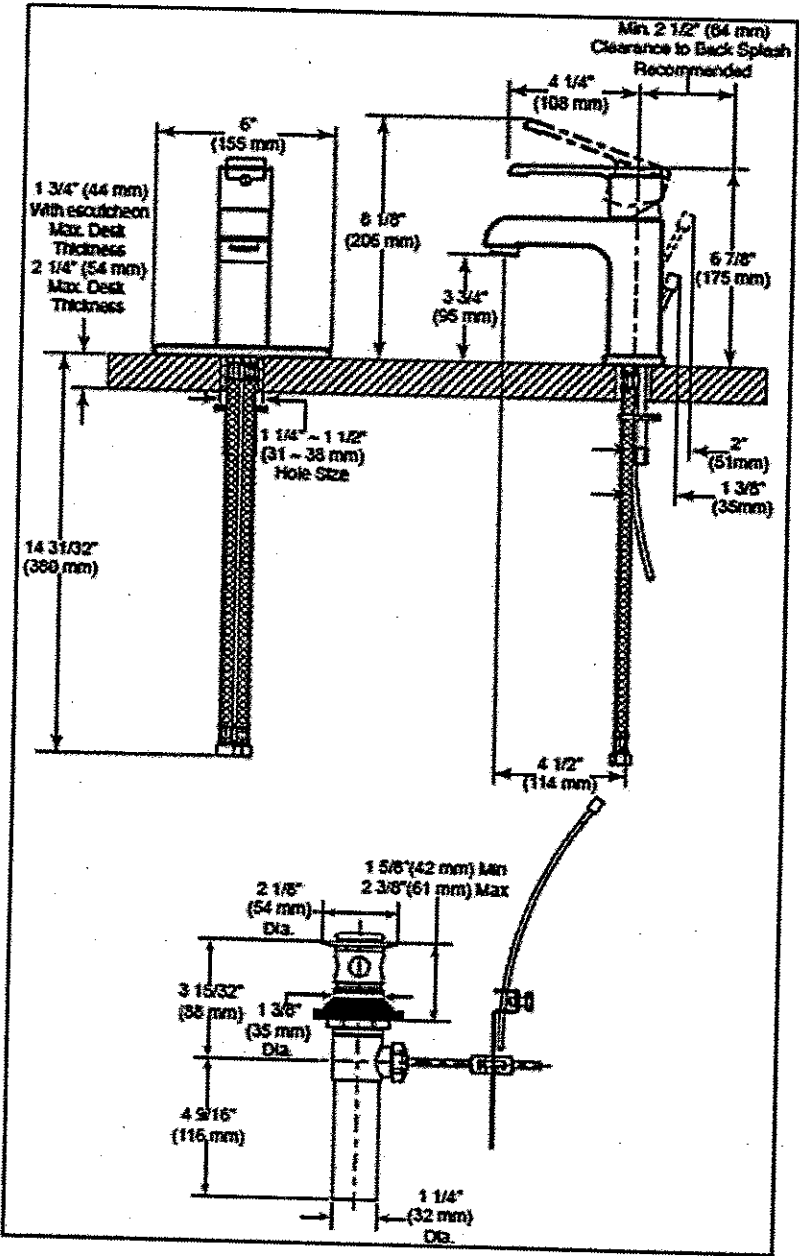
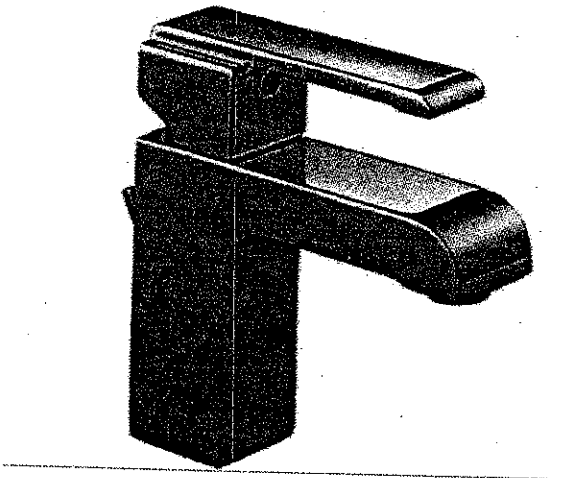

LOT # K62-46	
ROOM: MASTER ENSUITE X2	SIGNATURE: 
DATE: MARCH 25, 2017	SIGNATURE:

Delta Ara tub/shower faucet (chrome) #T14467

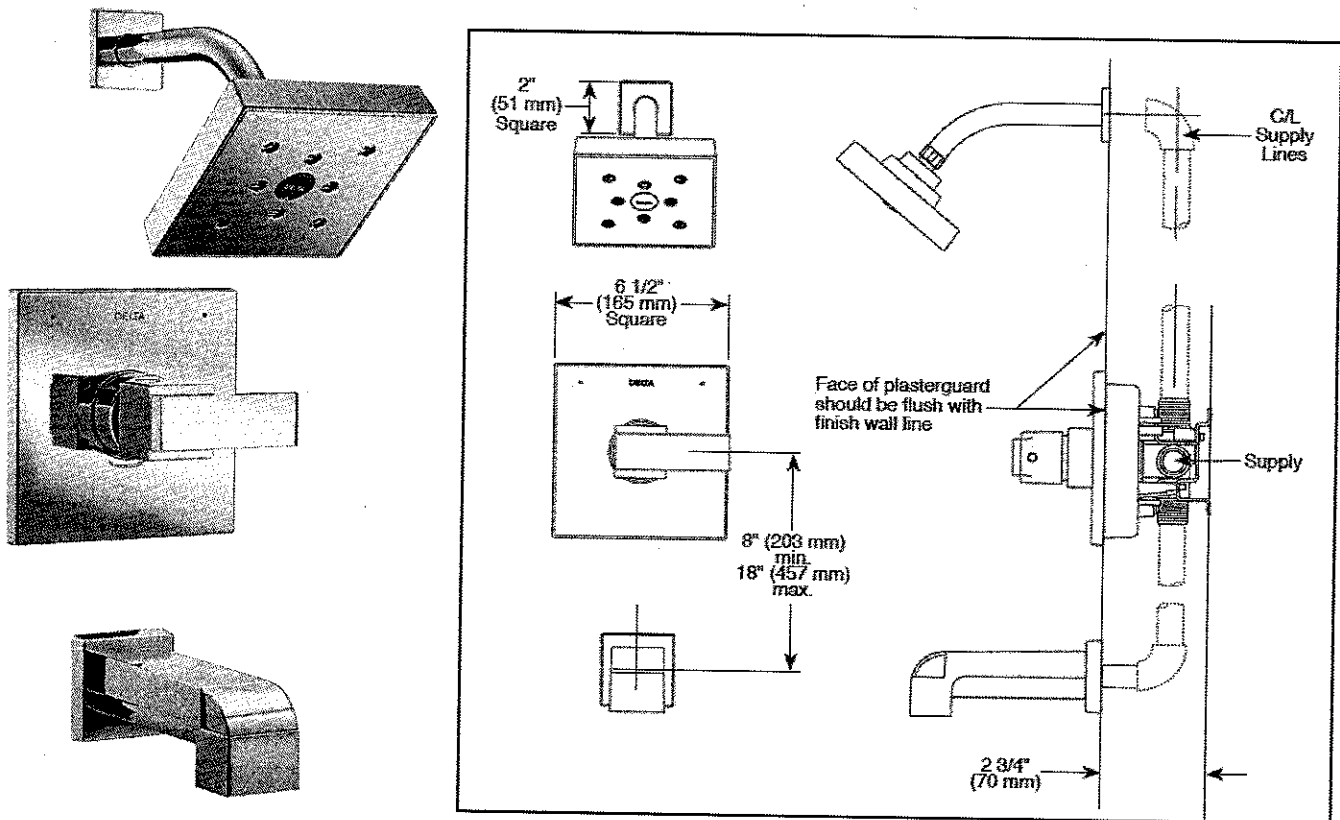

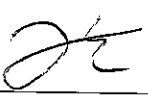
LOT # K62-46		
ROOM: MASTER ENSUITE	SIGNATURE: 	
DATE: MARCH 25, 2017	SIGNATURE:	

Arzo 3 Piece Roman Tub (chrome) #T2786/R2709

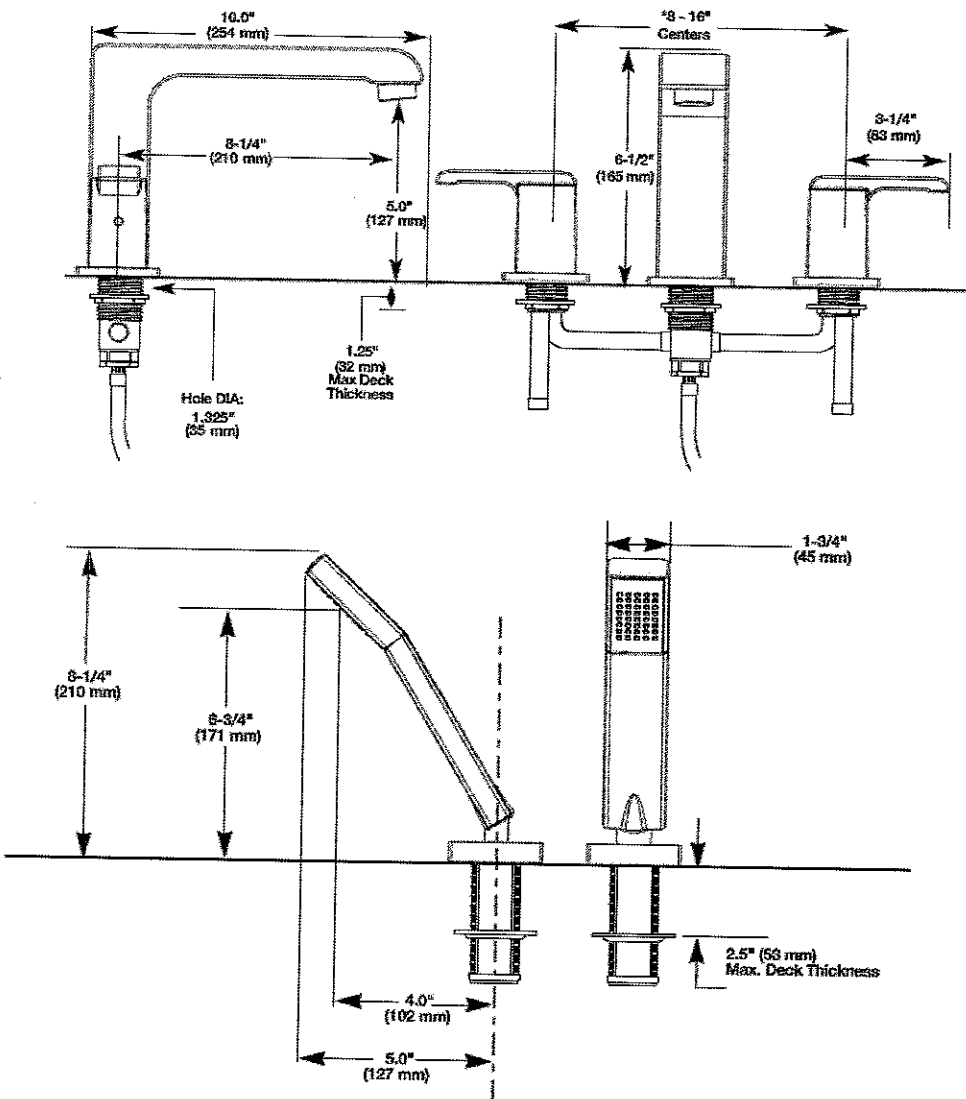
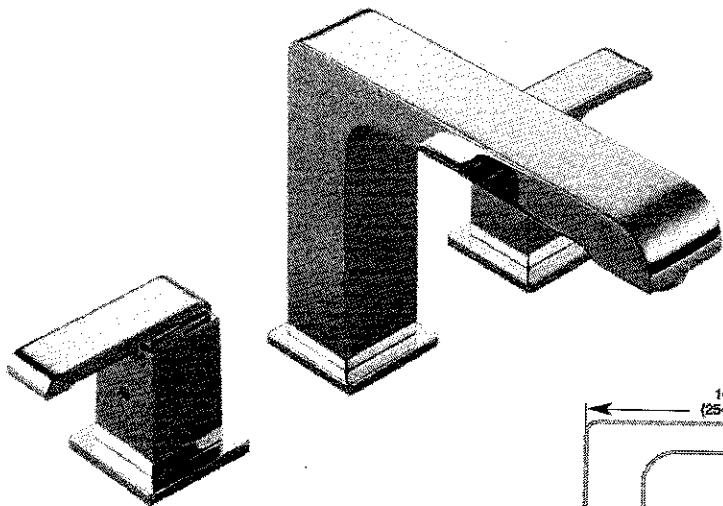

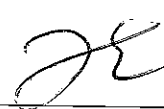
LOT # K62-46.	
ROOM: MASTER ENSUITE	SIGNATURE: 
DATE: MARCH 25, 2017	SIGNATURE:

Contrac 'Camden' square under mount sink (white) #4210CHY

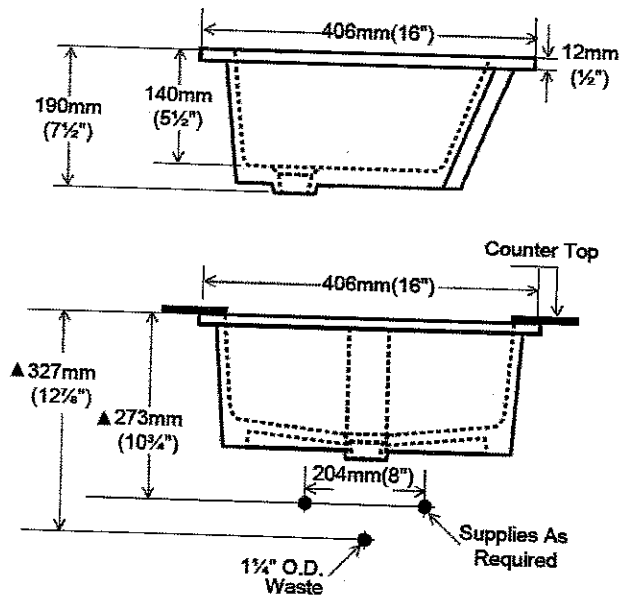
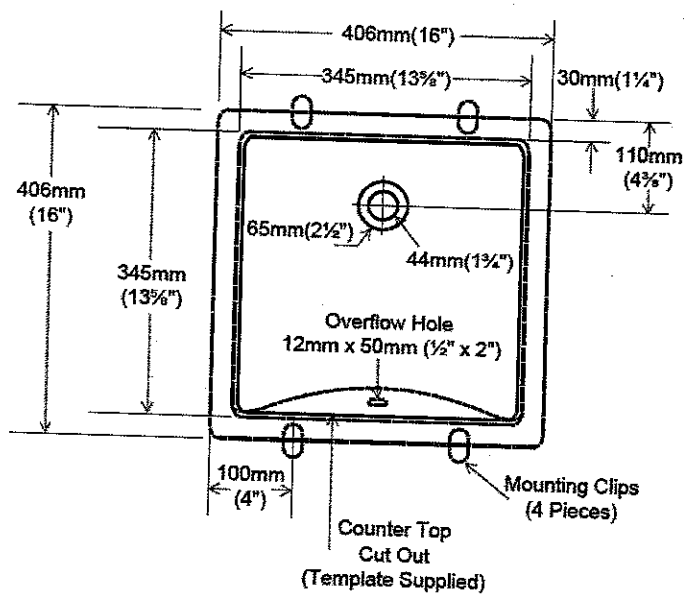
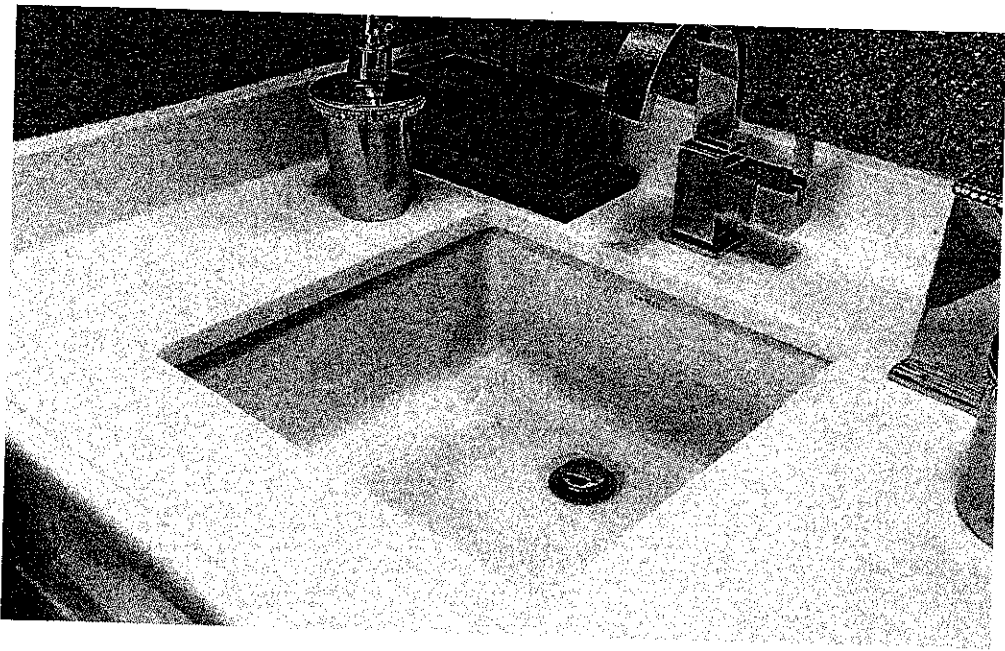

LOT #	K62-46	
ROOM:	MASTER ENSUITE x2	SIGNATURE: 
DATE:	MARCH 25, 2017	SIGNATURE:



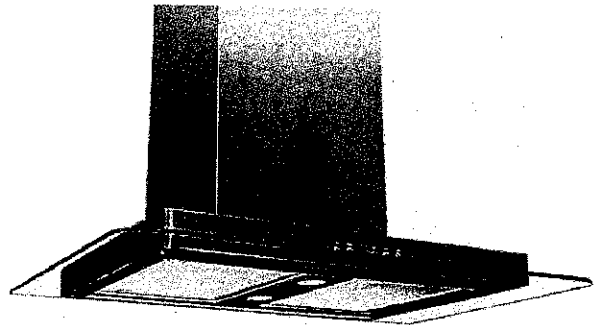
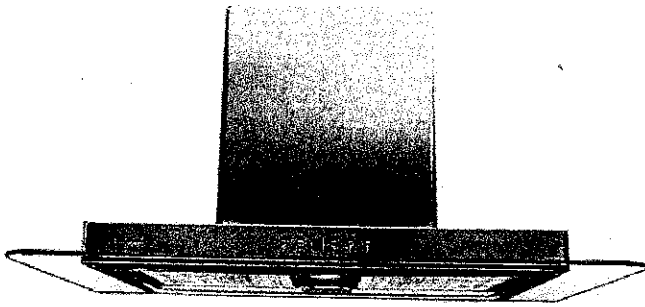

### Wall Mount

Balanced and simple, the understated SC503 is an attractive exhaust fan. The symmetry of the machine and rounded corners of the glass canopy give it a soft, appealing feel. Perfect for those who pursue superior quality and performance over flash and flamboyance. Fitted with time-delay "OFF" options up to nine minutes, bright LED lights spaced for optimum light distribution, and a digital three-speed push button control panel.

### Specifications

Air Flow Volume: 550 CFM  
Electrical Connection: 120V/60Hz  
Electrical Consumption: 200 Watts  
Fan Speed: 1599 RPM  
Finishes: Stainless Steel  
Venting: 6" Round - Top Only  
Dimensions: Width: 30"/36"  
Height: 44 1/2"  
Depth: 19 3/4"  
Sones: Min. 2  
Max. 6

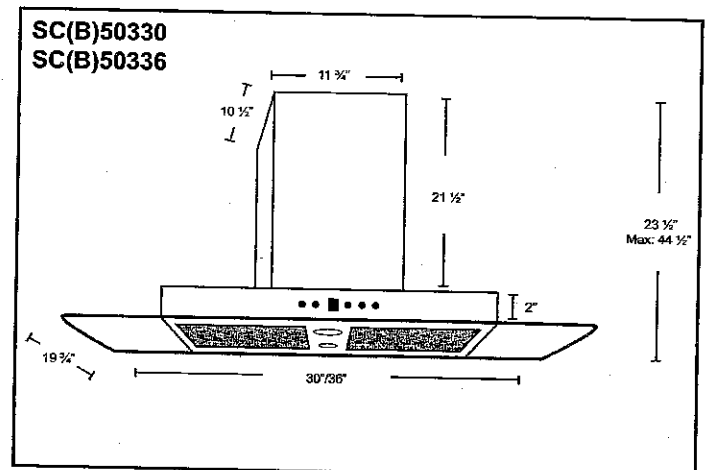

\* B in the model name denotes a model with baffle filters.  
SC503 - Mesh Filters SCB503 - Baffle Filters

Model	Colour	Venting	Size
SC(B)50330	Stainless Steel	6"	30"

STRUCTURAL

Ch

March 7, 2017

CONCRETE

Technical Specifications

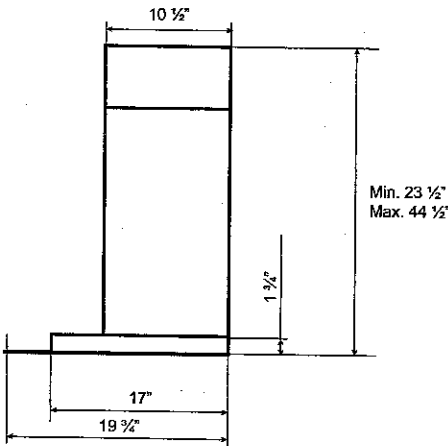

SIDE

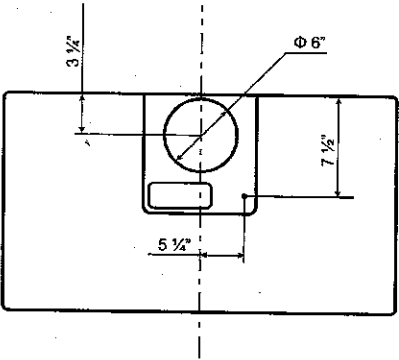

TOP

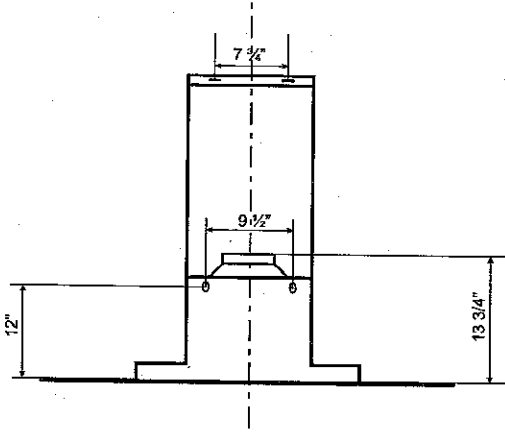

BACK

Features

- Wall mount range hood
- 6" round top ducting
- 550 CFM centrifugal fan
- 3 speed push button control
- Fitted with time-delay options up to nine minutes
- 2 LED light bulbs
- Dishwasher-safe aluminum mesh or baffle filters
- Available sizes: 30", 36"
- Standard chimney fits up to 9 ft. ceiling
- Extended chimney available upon request

Notes

\_\_\_\_\_

\_\_\_\_\_

\_\_\_\_\_

\_\_\_\_\_

\_\_\_\_\_

\_\_\_\_\_

\_\_\_\_\_

\_\_\_\_\_

\_\_\_\_\_

\_\_\_\_\_

Cyclone Range Hoods Inc. 1361 Huntingwood Drive, Unit 16, Toronto, ON, M1S 3J1, Canada  
Toll Free: 1-888-293-5662 Tel: (416) 293-0933 Fax: (416) 293-4793 Website: [www.CycloneRangeHoods.com](http://www.CycloneRangeHoods.com)

STRUCTURAL



MARCH 7, 2017

COLOURS

Elevation A • 2,388 sq.ft.

Elevation B • 2,375 sq.ft.

Adjust Framing  
+ HVAC to accommodate  
crown + furring in kitchen

\*NO TELEPHONE IN  
KITCHEN\*

~ 25ft on  
either side  
of stove.

- RELOCATE 6" DUCT  
FOR CHIMNEY HOOD  
CENTERED TO NEW  
STOVE LOCATION

- GAS LINE W/ DEDICATED  
RECEPTACLE

RELOCATE STD  
KITCHEN LIGHT  
CENTERED ABOVE ISLAND.

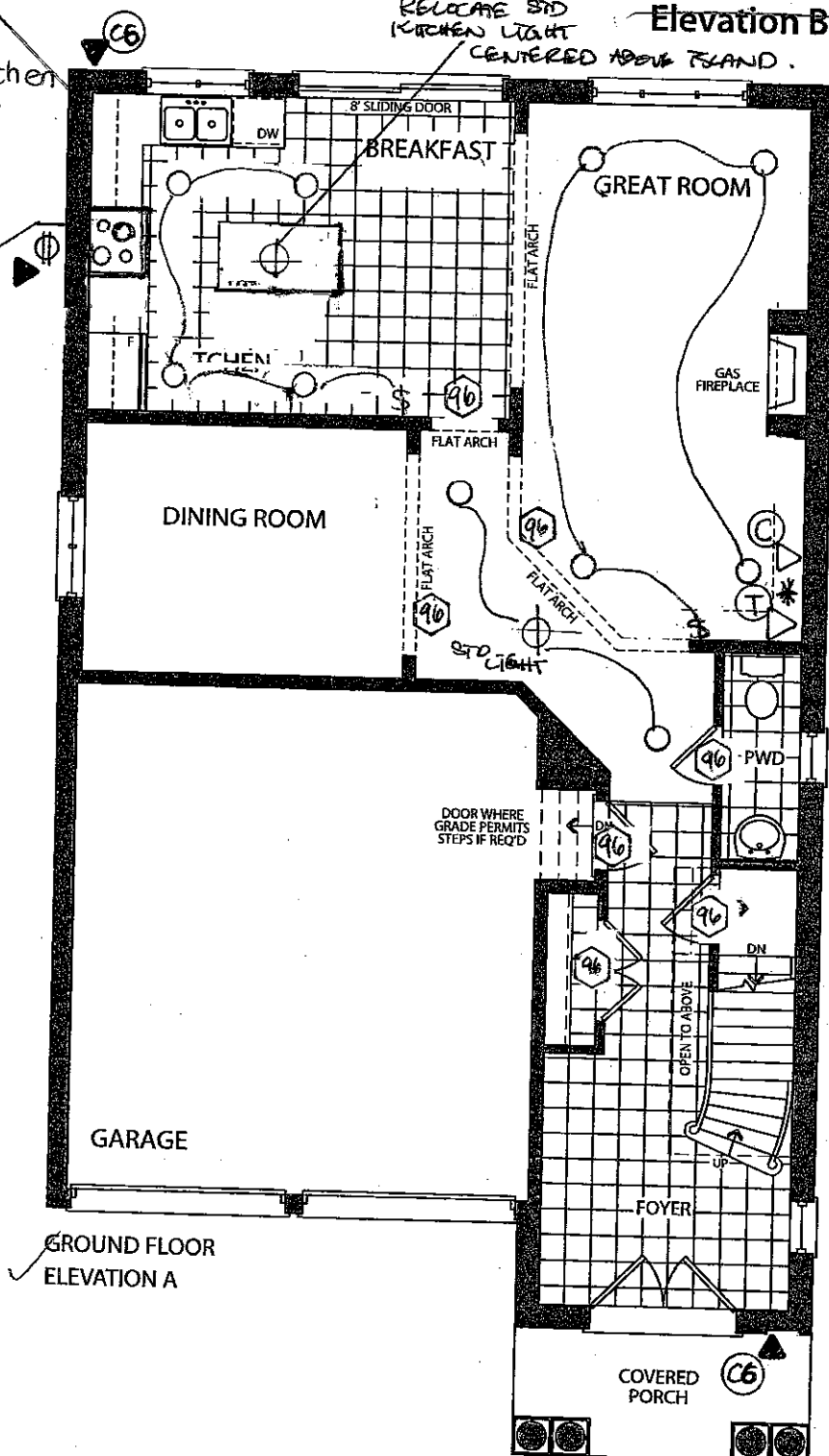

GROUND FLOOR  
ELEVATION A

# LEGEND

- \* - CONDUIT
- \$ - SWITCH
- 96 - 96" ARCHWAY/DOOR
- ⊕ - CEILING LIGHT
- - POT LIGHT
- ▶ - GAS LINE
- Ⓢ - CABLE
- Ⓣ - TELEPHONE
- Ⓢ - CAT 5

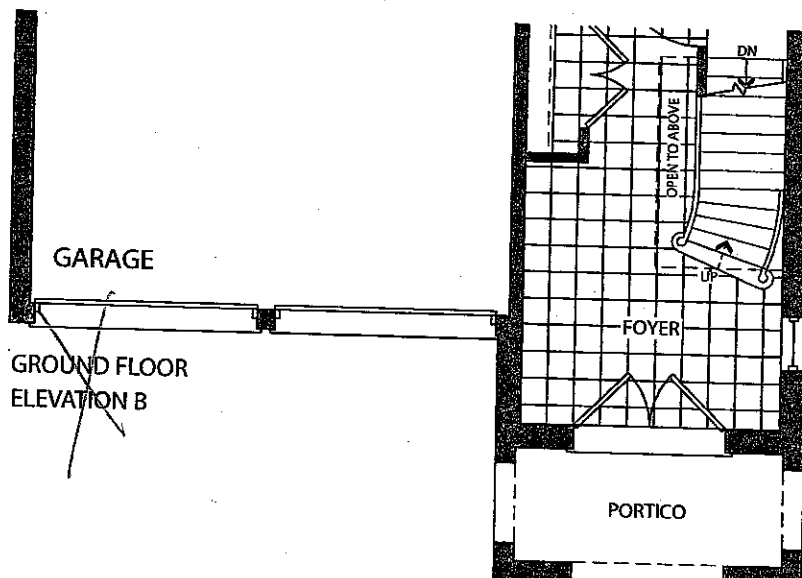

GROUND FLOOR  
ELEVATION B

STRUCTURAL
MARCH 7, 2017
COLORS

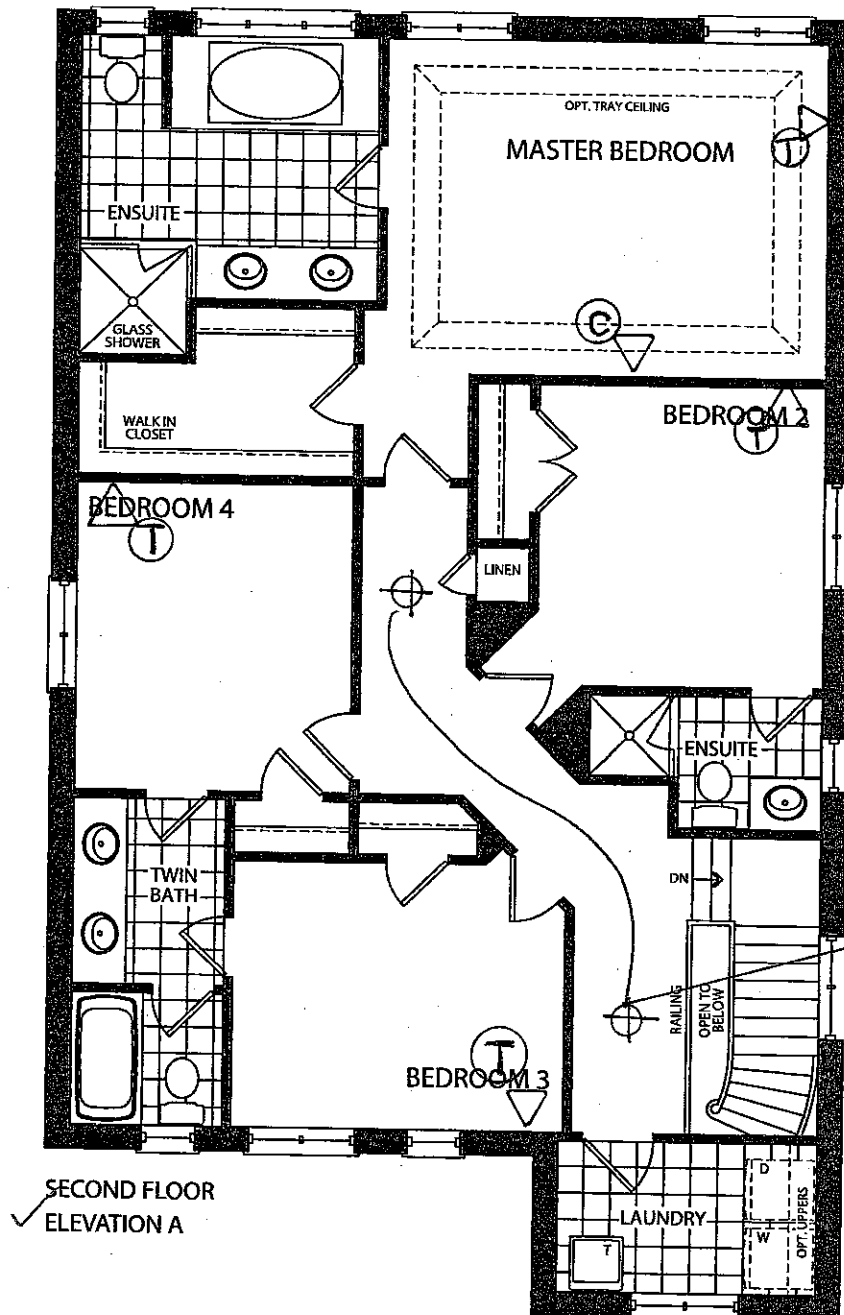

END FLOOR  
HALLWAY LIGHTS  
TO BE ON 4-WAY  
SWITCH:  
1- BY MASTER  
BEDROOM  
1- AT TOP OF  
STEPS  
1- FROM MAIN  
FLOOR ENTRY.

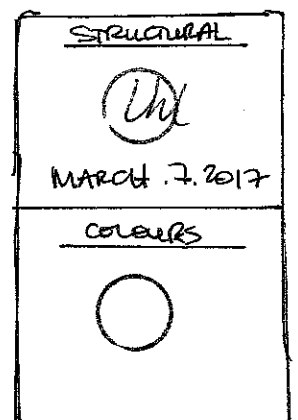
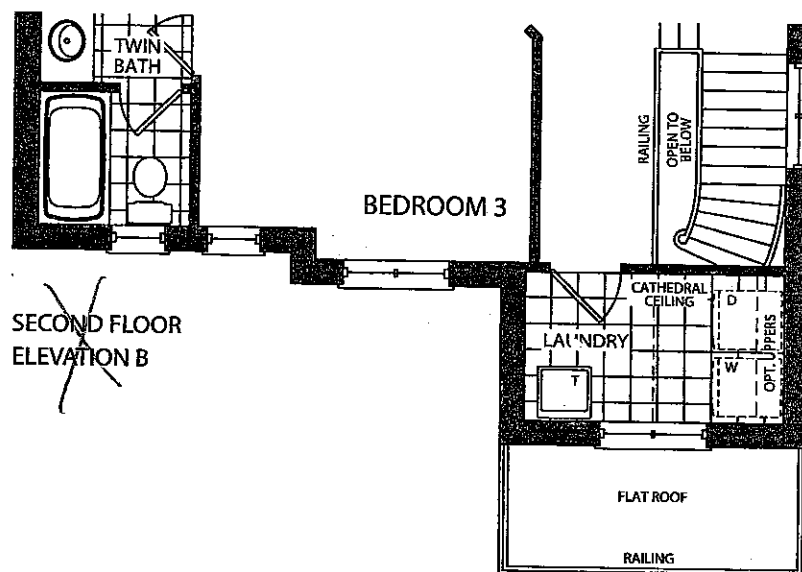

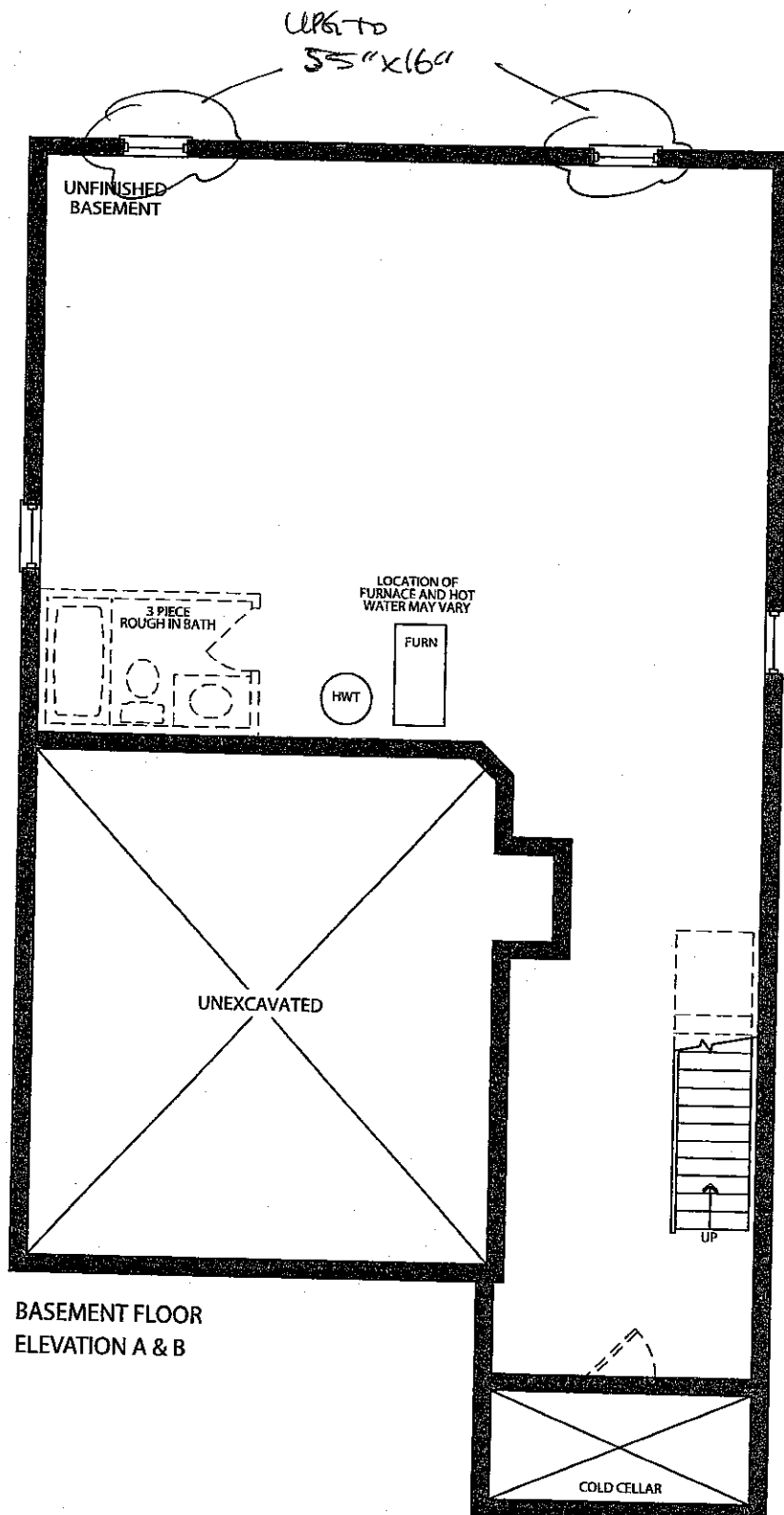

BASEMENT FLOOR  
ELEVATION A & B

