

Brampton Encore - 2 - 2 - 38-6 Elev.B SCARLATTI OPT - OPTG

CENTRAL VAC AND WIRING

Inv.1,373	1 - GREAT ROOM: CONDUIT PIPE- FOR TELEVISION- LOCATE APPROX. 66" A.F.F. ABOVE FIREPLACE, TERMINATING BY CABLE. SEE PLAN FOR LOCATION.
Line21552	Note:
18May17 / 22Sep17	

CERAMIC

Inv.1,577	1 - FOYER FLOOR TILE: UPGRADE 4 - 12X24" LAID IN STRAIGHT, STACKED PATTERN.
Line24701	Note: SEE PLAN FOR TILE DIRECTION
22Sep17 / 31Jan18	
Inv.1,577	1 - POWDER ROOM: FLOOR TILE: UPGRADE 4 - 12X24" LAID IN STRAIGHT, STACKED PATTERN.
Line24702	Note:
22Sep17 / 31Jan18	

CONCRETE AND DRAIN

Inv.1,373	1 - ROUGH-IN - 3PC BASEMENT ROUGH-IN
Line21570	Note:
18May17 / 22Sep17	

ELECTRICAL

Inv.1,373	1 - GREAT ROOM: 110V WALL RECEPTACLE ON NORMAL CIRCUIT - LOCATE ABOVE FIREPLACE, APPROX. 66" A.F.F.
Line21550	Note:
18May17 / 22Sep17	
Inv.1,373	1 - LIVING ROOM: ROUGH - IN CEILING OUTLET & SWITCH (WITH COVER PLATE) - DOES NOT INCLUDE FIXTURE - SEE PLAN FOR LOCATION
Line21555	Note:
18May17 / 22Sep17	
Inv.1,373	1 - LIVING ROOM: POT LIGHT: 4 INCH HALOGEN POT LIGHT - 440 WH- PRICED PER LIGHT- 1-9 POTLIGHTS
Line21556	Note:
18May17 / 22Sep17	
Inv.1,373	1 - LIVING ROOM: SINGLE POLE SWITCH FOR POTLIGHT
Line21557	Note:
18May17 / 22Sep17	
Inv.1,373	1 - LIVING ROOM: POT LIGHT: 4 INCH HALOGEN POT LIGHT - 440 WH- PRICED PER LIGHT- 1-9 POTLIGHTS
Line21558	Note:
18May17 / 22Sep17	
Inv.1,373	1 - GREAT ROOM: SINGLE POLE SWITCH FOR POTLIGHT
Line21559	Note:
18May17 / 22Sep17	
Inv.1,373	1 - DINING ROOM: POT LIGHT: 4 INCH HALOGEN POT LIGHT - 440 WH- PRICED PER LIGHT- 1-9 POTLIGHTS
Line21560	Note:
18May17 / 22Sep17	
Inv.1,373	1 - DINING ROOM: SINGLE POLE SWITCH FOR POTLIGHT
Line21561	Note:
18May17 / 22Sep17	

Brampton Encore - 2 - 2 - 38-6 Elev.B SCARLATTI OPT - OPTG

Inv.1,373	1 - KITCHEN: 240V WALL RECEPTICAL ON DEDICATED CIRCUIT- FOR 4 WIRE BUILT-IN WALL OVEN - SEE PLAN FOR LOCATION
Line21562	Note:
18May17 / 22Sep17	
Inv.1,373	1 - KITCHEN: ROUGH - IN CEILING OUTLET & SWITCH (WITH COVER PLATE) - DOES NOT INCLUDE FIXTURE - LOCATE ABOVE ISLAND, SEE PLAN FOR LOCATION
Line21563	Note:
18May17 / 22Sep17	
Inv.1,373	1 - KITCHEN: ROUGH - IN CEILING OUTLET ON SAME SWITCH - DOES NOT INCLUDE FIXTURE - LOCATE ABOVE ISLAND, USE SAME SWITCH AS OTHER ROUGH-IN ABOVE ISLAND. SEE PLAN FOR LOCATION.
Line21564	Note:
18May17 / 22Sep17	
Inv.1,373	1 - KITCHEN: RELOCATE FRIDGE, SEE PLAN FOR NEW LOCATION
Line24153	Note:
18May17 / 22Sep17	
Inv.1,373	1 - KITCHEN: GAS LINE ROUGH COMPLETE WITH REQUIRED ELECTRICAL 110V PLUG-MAIN FLOOR
Line24155	Note:
18May17 / 22Sep17	
Inv.1,577	1 - KITCHEN: DELETE UPPERS, FINISH SIDES OF CABINETRY - LEAVE APPROX. 42" BETWEEN CABINETS FOR FUTURE 36" CHIMNEY-STYLE HOOD FAN- CLIENT TO SUPPLY AFTER CLOSING
Line25708	Note:
22Sep17 / 31Jan18	

Exterior Colours

Inv.1,373	1 - EXTERIOR COLOUR PACKAGE 7
Line24159	Note:
18May17 / 22Sep17	

FRAMING

Inv.1,373	1 - KITCHEN: RELOCATE FRIDGE, SEE PLAN FOR NEW LOCATION
Line21565	Note:
18May17 / 22Sep17	
Inv.1,373	1 - MANDOOR GARAGE TO HOUSE- GRADE PERMITS
Line24158	Note:
18May17 / 22Sep17	

GRANITE MARBLE QUARTZ

Inv.1,577	1 - KITCHEN: ADD BREAKFAST BAR (STANDARD 2CM EDGE)
Line24708	Note:
22Sep17 / 31Jan18	
Inv.1,577	1 - KITCHEN: ADJUST CABINETS FOR 36" COOK TOP
Line25707	Note:
22Sep17 / 31Jan18	

HVAC

Brampton Encore - 2 - 2 - 38-6 Elev.B SCARLATTI OPT - OPTG

Inv.1,373	1 - KITCHEN: GAS LINE ROUGH COMPLETE WITH REQUIRED ELECTRICAL 110V PLUG-MAIN FLOOR
Line21566	Note:
18May17 / 22Sep17	

KITCHEN AND BATH CABINETRY

Inv.1,373	1 - KITCHEN: RELOCATE FRIDGE, SEE PLAN FOR NEW LOCATION
Line24154	Note:
18May17 / 22Sep17	
Inv.1,577	1 - KITCHEN: DOUBLE APPLIANCE CABINET FOR BUILT-IN OVENS AND COOKTOP
Line24703	Note:
22Sep17 / 31Jan18	
Inv.1,577	1 - KITCHEN: ADJUST CABINETS FOR 36" COOK TOP
Line24706	Note:
22Sep17 / 31Jan18	
Inv.1,577	1 - KITCHEN: DELETE UPPERS, FINISH SIDES OF CABINETRY - LEAVE APPROX. 42" BETWEEN CABINETS FOR FUTURE 36" CHIMNEY-STYLE HOOD FAN
Line24707	Note:
22Sep17 / 31Jan18	

MISC.

Inv.1,373	1 - GRADE DOES NOT PERMIT SIDE DOOR- HOME TO EXTERIOR- TO BE REFUNDED ON PE:
Line21569	Note:
18May17 / 22Sep17	
Inv.1,373	1 - Purchaser has attended an appointment at the Decor Centre & has DECLINED any additional upgrades and accepts and acknowledges that there will be no further changes/additions/deletions to be made upon signing on May 18 2017.
Line21580	Note:
18May17 / 22Sep17	
Inv.1,373	1 - Purchasers are aware & accepts that ANY changes made to upgrades after signing this Purchasers Extra Form are subject to a minimum administration fee of \$500. PLUS a 10% holdback fee.
Line21581	Note:
18May17 / 22Sep17	
Inv.1,373	1 - BONUS PACKAGE: \$10,000.00 (INCLUDING TAXES) WORTH OF UPGRADES FROM GOLD PARK HOMES DÉCOR CENTRE IS BEING APPLIED TOWARD THE STRUCTURAL APPOINTMENT. PURCHASER HAS A REMAINING AMOUNT OF \$112.50 (INCLUDING TAXES) TO BE USED TOWARD THE COLOUR APPOINTMENT.
Line21582	Note:
18May17 / 22Sep17	
Inv.1,577	1 - REFUND FOR SIDE DOOR- GRADE DOES NOT PERMIT
Line24156	Note:
22Sep17 / 31Jan18	
Inv.1,577	1 - Purchaser has attended a Colour appointment at the Decor Centre & has DECLINED any additional upgrades and accepts and acknowledges that there will be no further changes/additions/deletions to be made upon signing on November 20 2017.
Line24709	Note:
22Sep17 / 31Jan18	
Inv.1,577	1 - Purchasers are aware & accepts that ANY changes made to upgrades after signing this Purchasers Extra Form are subject to a minimum administration fee of \$500 per trade. PLUS a 10% holdback fee.
Line24710	Note:
22Sep17 / 31Jan18	

Brampton Encore - 2 - 2 - 38-6 Elev.B SCARLATTI OPT - OPTG

Inv.1,577	1 - BONUS PACKAGE: \$112.50 (INCLUDING TAXES) WORTH OF UPGRADES FROM GOLD PARK HOMES DÉCOR CENTRE IS BEING APPLIED TOWARD THE COLOUR APPOINTMENT. PURCHASER HAS A REMAINING AMOUNT OF \$00 (INCLUDING TAXES).
Line24711	Note:
22Sep17 / 31Jan18	

PLUMBING

Inv.1,373	1 - KITCHEN: ROUGH-IN - WATERLINE FOR FRIDGE
Line21568	Note:
18May17 / 22Sep17	

WINDOWS AND DOORS

Inv.1,373	1 - MANDOOR GARAGE TO HOUSE- GRADE PERMITS
Line24157	Note:
18May17 / 22Sep17	

Purchasers: Mohammad Nazir & Jabeen Fehmida

Property: 2

Telephone Res. / Bus: (416) 220-1913

Project: Brampton Encore - Phase 2

Decor Advisor: Yolande Somerville

Model and Elevation: 38-6 Elev.B SCARLATTI OPT - OPTG

Layout Changes: ☐ Yes ☒ No

Sketch Attached: ☒ Yes ☐ No

Exterior Colour Scheme:

1. Cabinetry

	Style and Colour	Counter	Hardware
Kitchen / Breakfast	Toscana pvc 'Vanilla Stix' ✓	Granite: Crema Caramel EDGE: FE-20 + BBar	cs1-23
Laundry Room	n/a	n/a	n/a
Powder Room	n/a	n/a	n/a
Ground Floor	Toscana pvc 'Antique White' ✓	P-Lam #1877K-52 'Autumn Carnival'	cs1-23
Master Ensuite Bathroom	Varese pvc 'Mystic' ✓	P-Lam #7022-58 'Natural Canvas'	cs1-21
Second Ensuite Bathroom (If Applicable)	Varese pvc 'White Crystal' ✓	P-Lam #7267-58 'Concrete Stone'	cs1-6
Twin 3/4	Varese pvc 'Mystic' ✓	P-Lam #6698-46 'Paloma Polar'	c21-24

Comment

2. Floor Tile

	Selection
Entrance Vestibule	*12x24" Timeless polished 'Light Beige' upg 4
Main Hall	
Kitchen / Breakfast	13x13" New Reeds 'Taupe' std
Laundry Room	13x13" New Reeds 'Taupe' std
Powder Room	*12x24" Timeless polished 'Light Beige' upg 4
Garage Foyer	13x13" New Reeds 'Taupe' std
Master Ensuite Bathroom	13x13" Serpentine 'Krem'
Second Ensuite Bathroom (If Applicable)	13x13" Serpentine 'Beyaz White'
Lower Landing (If Applicable)	13x13" Serpentine 'Charcoal'
Ground Floor Bath	13x13" New Reeds 'Taupe'

Comment

Twin Bath:

3. Wall Tile

	Selection	Listello/Inserts	Describe
M.Ens Tub Skirt/Splash	8x10" Serpentine 'Krem' std	<input type="radio"/> Yes <input checked="" type="radio"/> No	
Master Ensuite Bathroom			
Tub Deck	8x10" Serpentine 'Krem'	<input type="radio"/> Yes <input checked="" type="radio"/> No	
Shower Stall	8x10" Serpentine 'Krem'	<input type="radio"/> Yes <input checked="" type="radio"/> No	
Bathroom Walls	n/a	<input type="radio"/> Yes <input checked="" type="radio"/> No	
Second Ensuite Bathroom (If Applicable)	8x10" Weave 'Tender Grey' std	<input type="radio"/> Yes <input checked="" type="radio"/> No	
Semi 3/4	8x10" Weave 'Taupe' std	<input type="radio"/> Yes <input checked="" type="radio"/> No	
Kitchen Backsplash	<input type="radio"/> Yes <input checked="" type="radio"/> No	Backsplash Behind Fridge	

Comment

Ground Floor Bath Walls: 8x10" Weave 'Tender Grey'

FJ

MN

Purchasers: Mohammad Nazir & Jabeen Fehmida

Property: 2

Telephone Res. / Bus: (416) 220-1913

Project: Brampton Encore - Phase 2

Decor Advisor: Yolande Somerville

Model and Elevation: 38-6 Elev.B SCARLATTI OPT - OPTG

4. Plumbing Fixtures

<input type="checkbox"/>	Second Ensuite	<input type="checkbox"/>	Powder Room	<input type="checkbox"/>	
Master Ensuite Bathroom	<input type="checkbox"/>	Other Room - Specify	<input type="checkbox"/>	Other Washroom	<input type="checkbox"/>

Comment

STANDARD THRU OUT

5. Hardwood Flooring

	Type and Stain		Type and Stain
Main Hall	<input type="text" value="standard natural"/>	Upper Landing	<input type="text" value="n/a"/>
Kitchen / Breakfast	<input type="text" value="n/a"/>	Upper Hall	<input type="text" value="n/a"/>
Living Room	<input type="text" value="standard natural"/>	Master Bedroom	<input type="text" value="n/a"/>
Dining Room	<input type="text" value="standard natural"/>	Bedroom #2	<input type="text" value="n/a"/>
Great Room	<input type="text" value="standard natural"/>	Bedroom #3	<input type="text" value="n/a"/>
Den/Library	<input type="text" value="n/a"/>	Bedroom #4	<input type="text" value="n/a"/>
Entrance Vestibule	<input type="text" value="n/a"/>	Bedroom #5	<input type="text" value="n/a"/>
Lower Landing (If Applicable)	<input type="text" value="n/a"/>	Other Room - Specify	<input type="text"/>

Comment

Standard hardwood in standard locations

6. Carpeting

	Upgrade	Description
Ground Floor	<input type="checkbox"/>	<input type="text" value="Standard #17185 'Soft Cameo'"/>
Second Floor	<input type="checkbox"/>	<input type="text" value="Standard #17185 'Soft Cameo'"/>
<input type="text"/>	<input type="checkbox"/>	<input type="text"/>

Upgrade Underpad	Type <input type="text" value="n/a"/>	Area <input type="text" value="n/a"/>
Carpet on Stairs	Capped <input type="text" value="n/a"/>	Runner - *Upgrade <input type="text" value="n/a"/>

Comment

Standard Under Pad

7. Fireplace

	Living Room			Family Room			Other Room - Specify		
	Purchased	As Per Plan	N/A	Purchased	As Per Plan	N/A	Purchased	As Per Plan	N/A
Fireplace Type	<input type="radio"/>	<input type="radio"/>	<input checked="" type="radio"/>	<input type="radio"/>	<input checked="" type="radio"/>	<input type="radio"/>	<input type="radio"/>	<input type="radio"/>	<input checked="" type="radio"/>
Mantle Type	<input type="text"/>			<input type="text" value="Standard Gas"/>			<input type="text"/>		
Colour / Stain	<input type="text"/>			<input type="text" value="Standard Paint Grade #NF20"/>			<input type="text"/>		
Surround	<input type="text"/>			<input type="text" value="White"/>			<input type="text"/>		
Hearth	<input type="text"/>			<input type="text" value="Standard 'Nero Marquina'"/>			<input type="text"/>		
	<input type="text"/>			<input type="text" value="none"/>			<input type="text"/>		

Comment

F.J. MN

Purchasers: Mohammad Nazir & Jabeen Fehmida

Property: 2

Telephone Res. / Bus: (416) 220-1913

Project: Brampton Encore - Phase 2

Decor Advisor: Yolande Somerville

Model and Elevation: 38-6 Elev.B SCARLATTI OPT - OPTG

8. Trim Carpentry

Interior Doors Front Door Glass Inserts Door Handles

Interior Trim

Comment

9. Plaster Mouldings and Medallions

Standard Throughout ☐ Yes ☒ No ☐ N/A

Entrance Vestibule Kitchen/Breakfast

Main Hall Den/Library

Living Room Lower Landing

Dining Room Other Room - Specify

Family Room thru out

Comment

10. Railings and Spindles

Railing Package

Railing Colour Spindle Colour

Stringer / Riser Treads

Comment

Oak Stairs ☒ Yes ☐ No ☐ N/A

11. Wall Paint / Ceilings

Throughout Finished Areas

Trim Paint

Smooth Ceilings

Ground Floor ☒

Second Floor ☐

Note

Comment

F5 MN

Scheduled Closing Date: Wednesday, March 21, 2018

Purchasers: Mohammad Nazir & Jabeen Fehmida

Property: 2

Telephone Res. / Bus: (416) 220-1913

Project: Brampton Encore - Phase 2

Decor Advisor: Yolande Somerville

Model and Elevation: 38-6 Elev.B SCARLATTI OPT - OPTG

12. Electrical

Hood Fan ☐ White ☐ Stainless ☒ N/A

Above Kitchen Cabinet Light ☐ Yes ☒ No

Below Kitchen Cabinet Light ☐ Yes ☒ No

Standard Appliances ☐

Over The Range Microwave ☐

Chimney Style Fan ☒

Comment

13. Heating and Air Conditioning

Air Conditioning

Gas Provisions Stove

Gas Provisions Dryer

Gas Provisions Barbecue

Comment

14. Additional Comments

15. Disclaimers and Notes

- 1) Colours of all materials are as close as possible to builder's selection, but not necessarily identical due to variances in manufacturing.
- 2) Any extras listed above are null and void unless accompanied by a separate invoice/amendment. Said invoice must be paid in full.
- 3) The Purchaser acknowledges that after Interior Colour Selection form is signed and dated, no further changes will be permitted other than re-selection due to unavailability. _____ Purchaser's Initials
- 4) The Purchaser acknowledges reading and accepting the "Gold Park Homes Decor Centre Disclaimers" form. This document contains other miscellaneous disclaimers.

This Interior Colour Selection is final and approved by:

Signature:

Date:

Fehmida Jabeen

[Signature]

BEZ-2
Nov 20 2017

Elevation A • 3,591 sq.ft. Elevation B • 3,578 sq.ft.



BE2-2.
MAY 18 2017
BE2-2
Nov 20 2017
Elevation A • 3,591 sq.ft. Elevation B • 3,578 sq.ft.

The
Scarlatti
38' SERIES

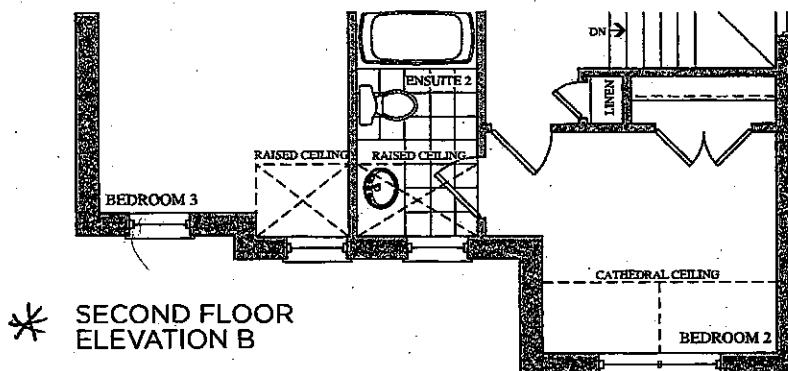
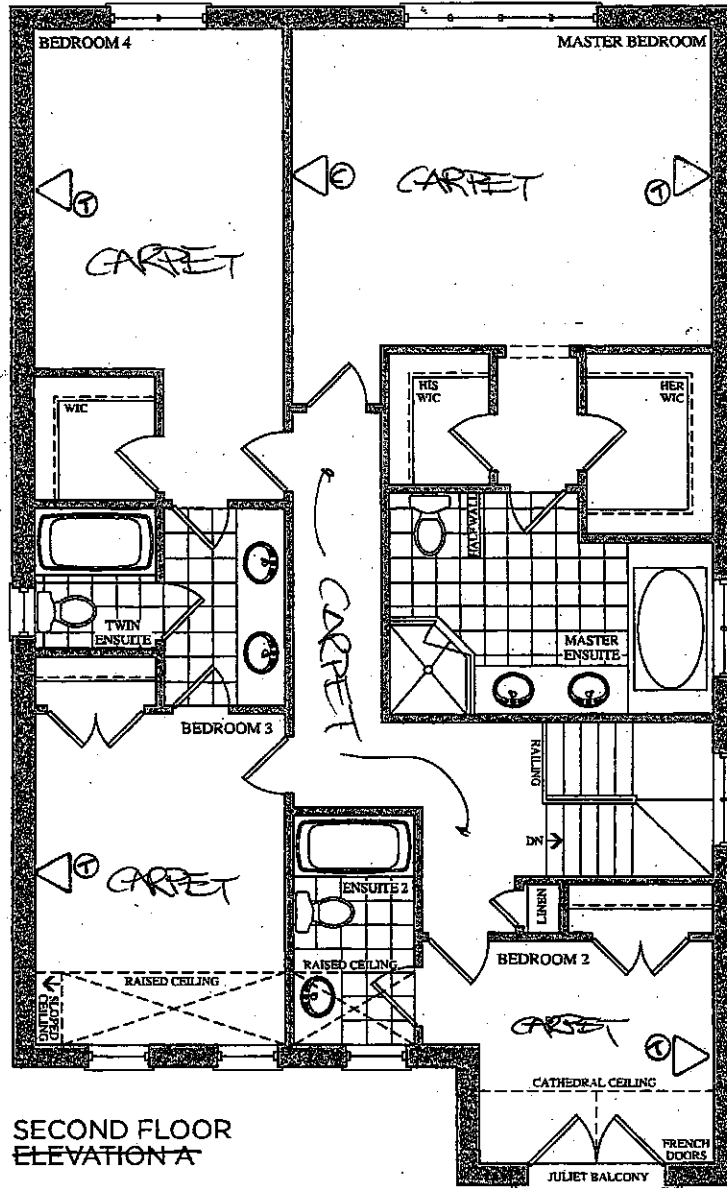

BE2-2
MAY 18 2017

(M) (S)

The
Scarlatti
38' SERIES

BE2-2 (S) (M)
Nov 20 2017 Elevation A • 3,591 sq.ft. Elevation B • 3,578 sq.ft.

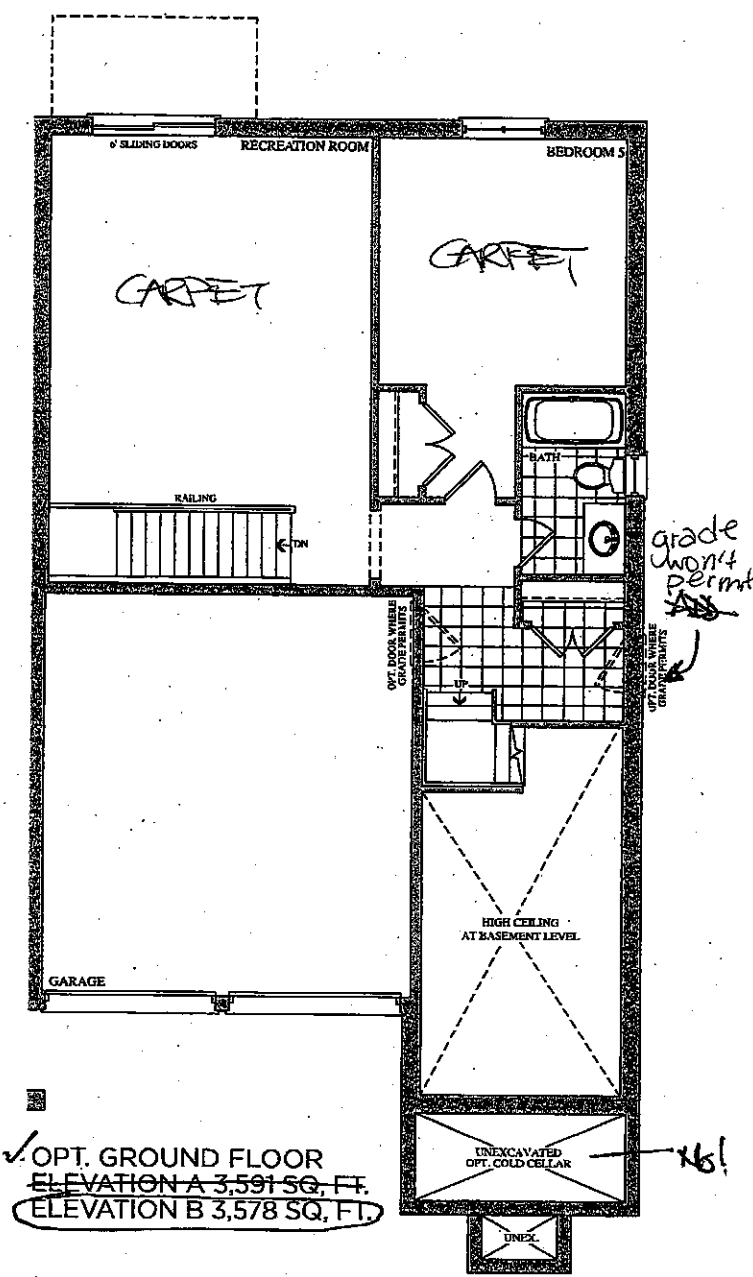
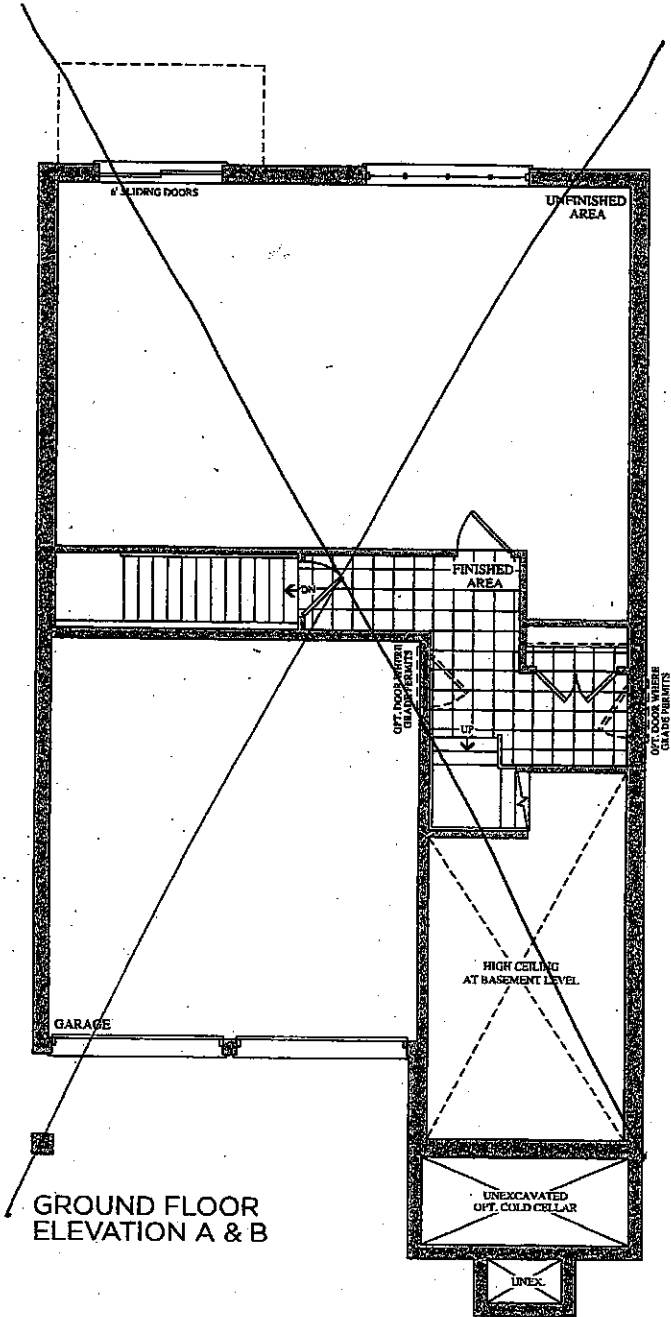

BE2-2.

MAY 18 2017

BE2-2

NOV 20 2017

Elevation A • 3,591 sq.ft.

Elevation B • 3,578 sq.ft.

The
Scarlatti
38' SERIES

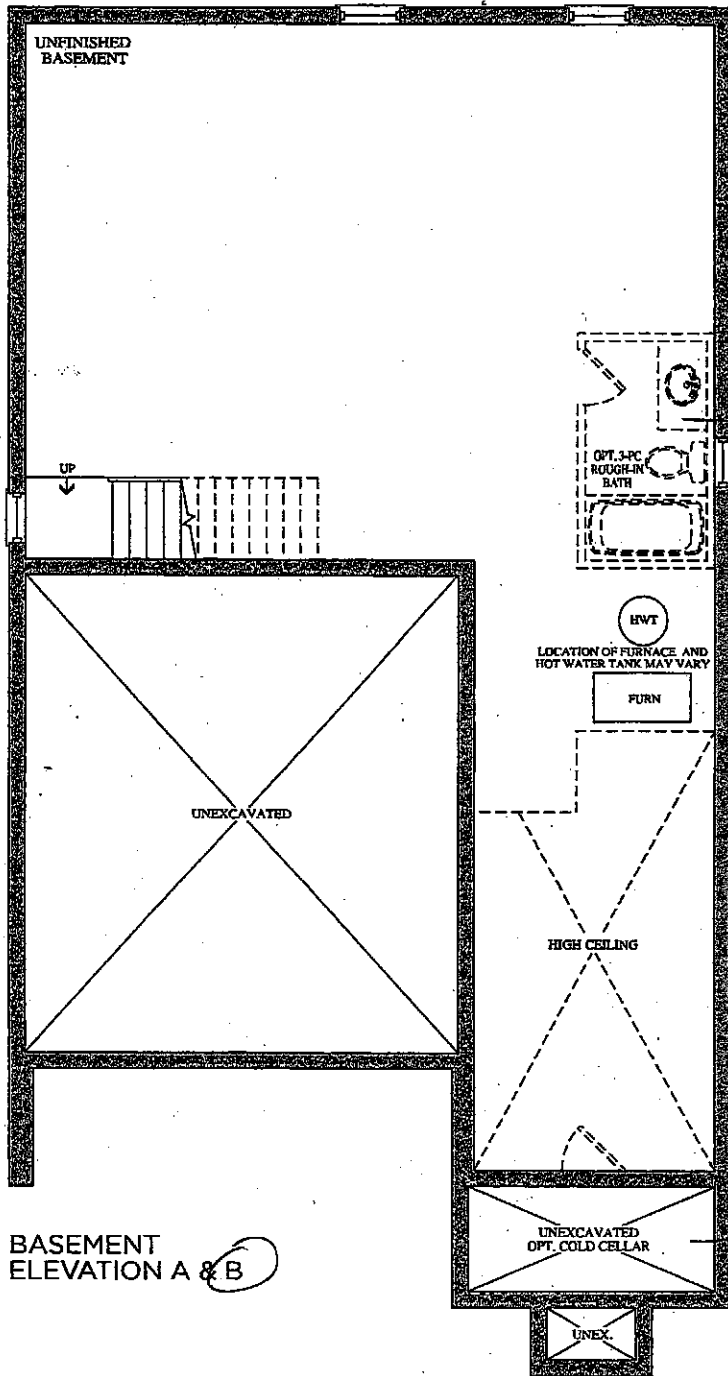

BASEMENT
ELEVATION A & B

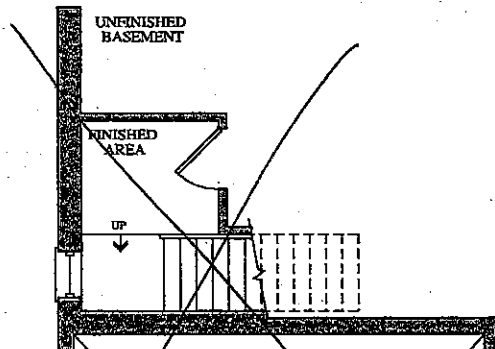

OPT. BASEMENT
ELEVATION A & B

Date: 06/23/16

Phase:

This layout has been explained to the purchaser by Cortina Kitchens Inc. and is understood by the purchaser.

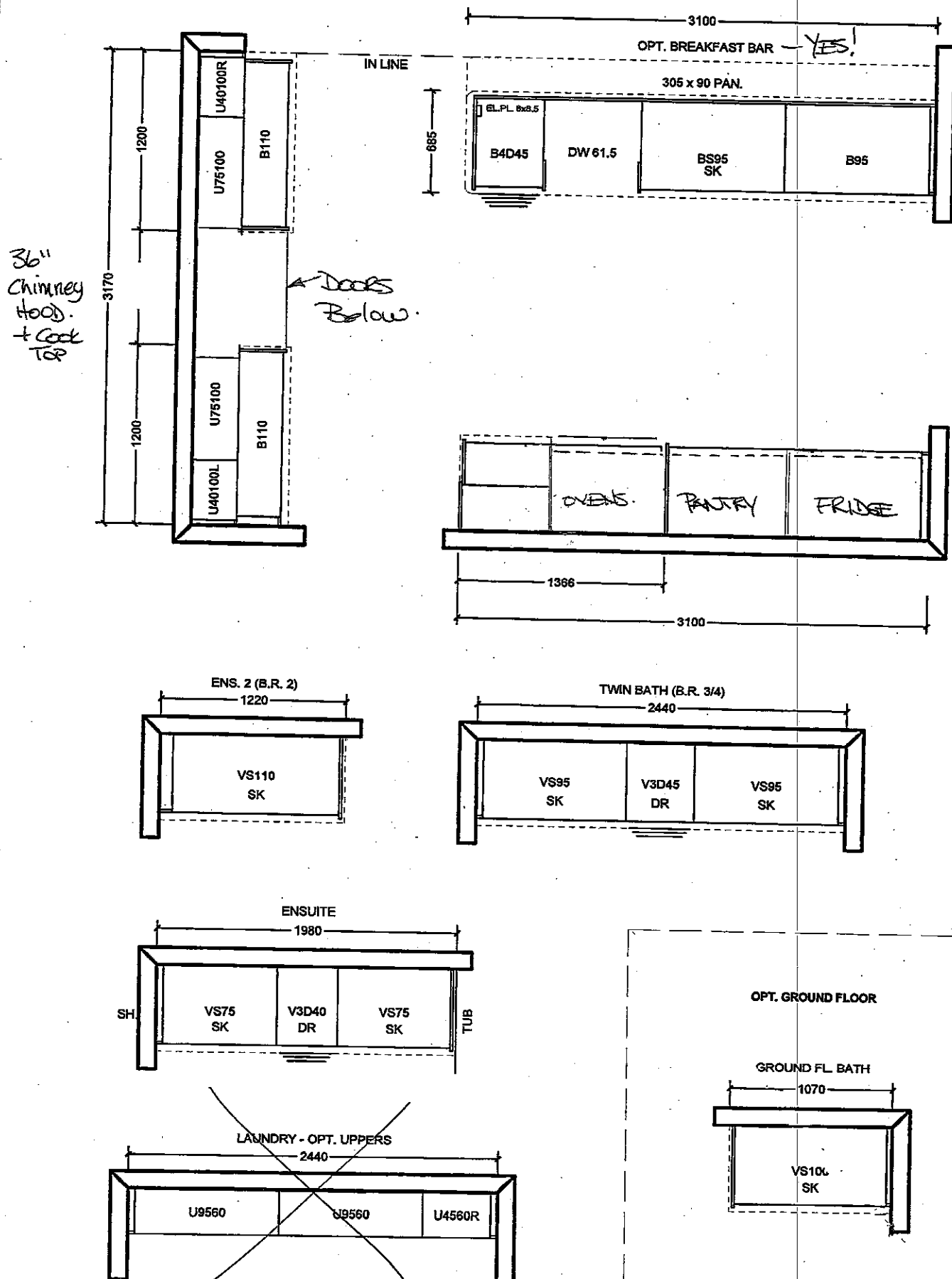

All agreements are contingent upon strikes, accidents, and delay beyond our control. Please provide our installer with template for sinkholes or \$150.00 will be charged for callback.

CORTINA HEAD OFFICE APPROVAL

ITEM A. Wood grain and colour are characteristics of the product, we cannot guarantee that such grain and colour will always match
ITEM B. Cortina Kitchens reserves the right to alter dimensions and make technical changes without notice.

CORTINA

MODIFIED: 19/05/16 fd

STANDARD HARDWARE

STANDARD HARDWARE

BE2-2 Nov 2017

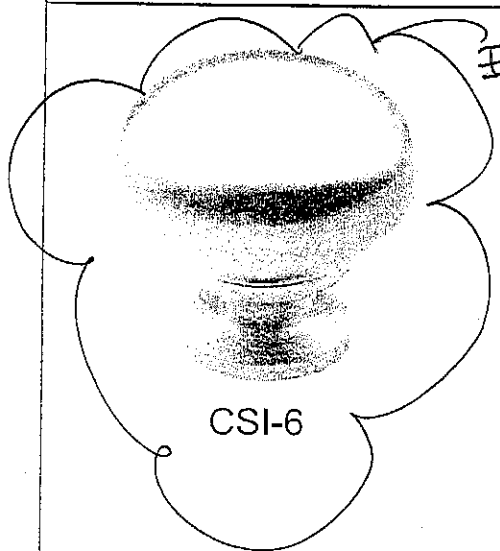

CSI-6

ENB 2.

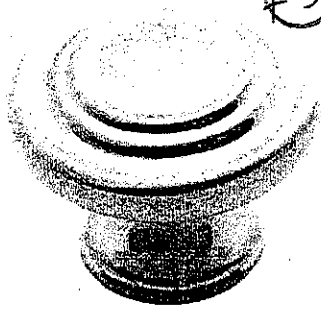

CSI-10

FJ MN

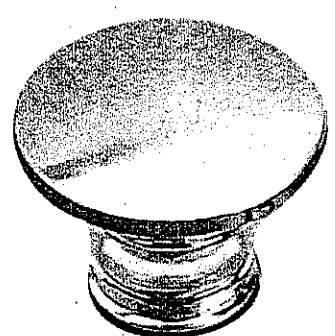

CSI-14

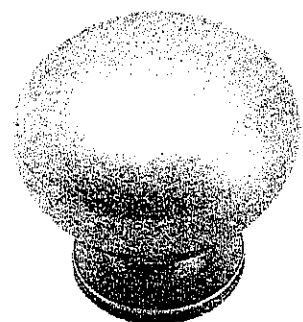

CSI-16



CSI-18

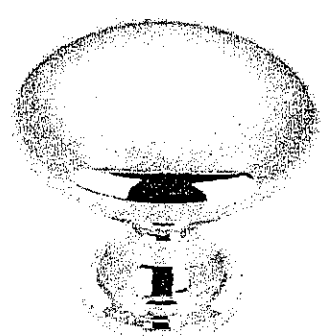

CSI-19

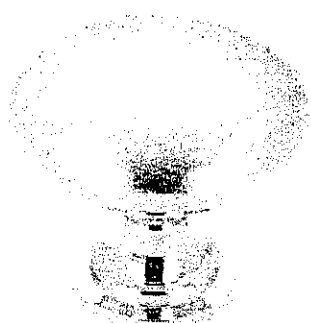

CSI-20

Kitchen + Ground Floor Bath.

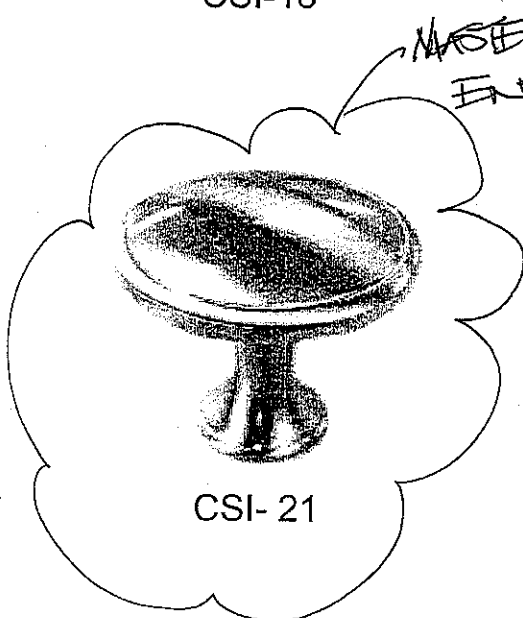

CSI-21

MASTER EN suite

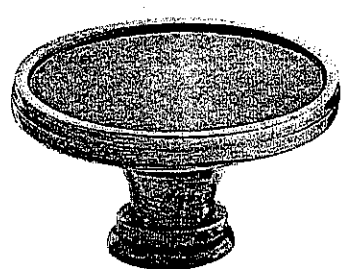

CSI-22

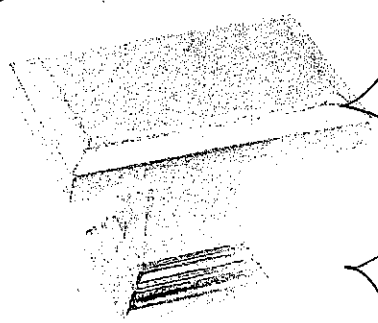

CSI-23

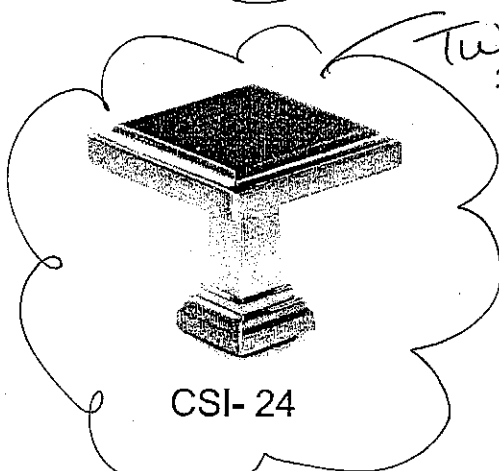

CSI-24

Twin 3/4.

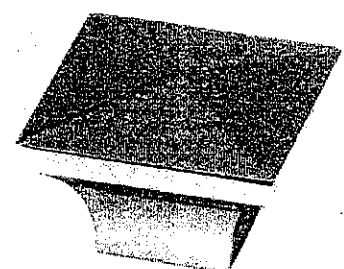

CSI-25

*NOTES:

- IMAGES ARE FOR QUICK REFERENCE PURPOSES ONLY
- ACTUAL SIZES AND FINISHES AS PER HARDWARE SAMPLE BOARD PROVIDED TO DECOR CENTRE

GOLDPARK
WORTH MORE™



**Granite, Marble,
Engineered Surfaces**

~~FE2-2~~
Nov 20 2017



- Standard 2CM @ 3CM
- ⊖ Upgrade 1 2CM @ 3CM
- ⊗ Upgrade 1 4 CM
- Upgrade 2

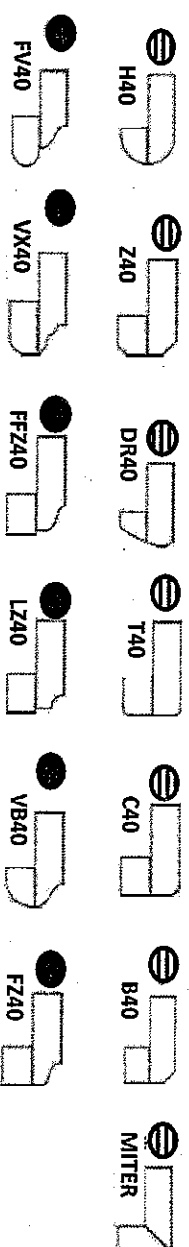
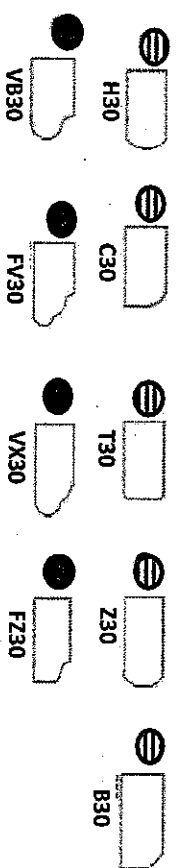
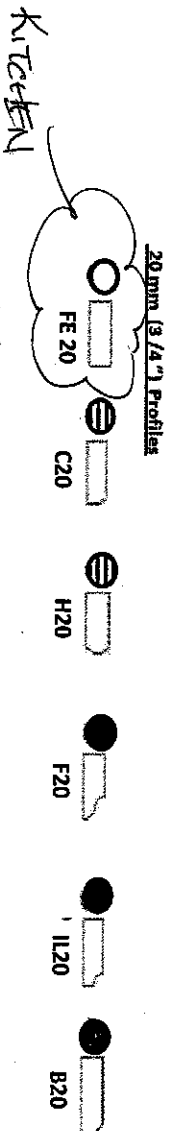

Note: All colours may not be available in 30mm at time ordered. Vendor reserves the right to use 40 mm edges (by lamination process).

*Mitre edge is available in Upgrade 1 for an overall thickness of 2". All other Mitre edge options will be an Upgrade 2 Edge.

* STD SINK & FAUCET

BE2-2



Need Assistance? 1-877-374-3439



Whirlpool WOC95EC0AS Microwave Wall Oven, 30"
Exterior Width, One Compartment Self Clean, One
Compartment Convection, 6.4 cubic ft, Stainless Steel
colour

Brand: Whirlpool
Model # WOC95EC0AS

STANDARD
INSTALLATION.

Product Options

Visit Store For Sale Price! WOC95EC0AS - Stainless Steel

Product Quick Specs

Width: 30
Height: 42 9/16
Depth: 26 7/16
Weight: 0 lbs.
Power Source: Electric Wall Oven
Exterior Width: 30
Self Clean: One Compartment Self Clean
Convection: One Compartment Convection
Capacity (Cu. Ft.): 6.4
Certified Sabbath Mode: Lower Compartment

Product Description

Whirlpool WOC95EC0AS Microwave Wall Oven Combination, 30 in, 5.0 cu.ft, with Convection, SteamClean option, Rapid Preheat, Largest capacity available and Hidden Bake Element

Product Features

AccuBake® Temperature Management System
TimeSaver™ Ultra true convection cooking system
FIT System
SteamClean option
Rapid Preheat
Convection Conversion
Largest capacity available
EasyView™ Extra-Large Oven Window Industry's largest window
Precise Clean® cleaning system
Hidden Bake Element

Product Specifications**Performance**

Fuel Type	Electric
Total Oven Capacity	5.0 Cu. Ft.
Total Microwave Oven Capacity	1.4 Cu. Ft.
Upper Oven Features	
Popcorn	Yes
Add A Minute	Yes
Lower Oven Features	
Cooking System	Convection
Convection	True
Convection Conversion	Convection Conversion

KitchenAid®

FOR THE WAY IT'S MADE.®

Wall-Mount Canopy Range Hood

BE2-2.

F5 M4

PRODUCT MODEL NUMBERS

KVWB400D

KVWB406B

Electrical: A 120-volt, 60 Hz, AC only, 15-amp, fused electrical circuit is required.

PRODUCT DIMENSIONS

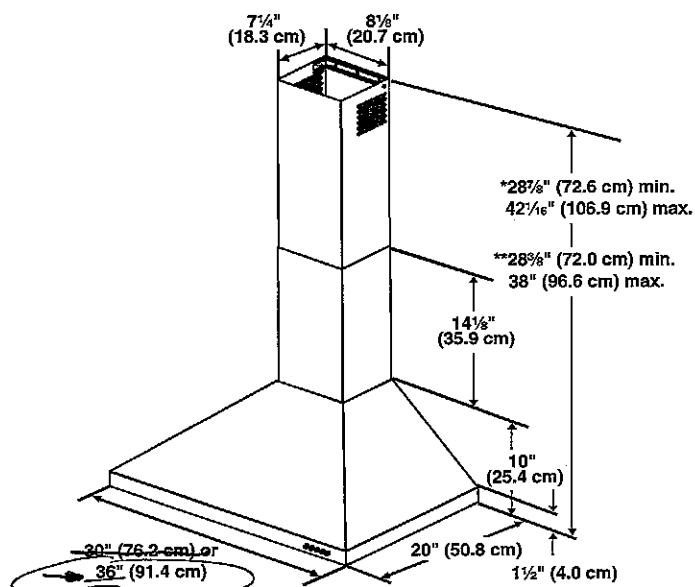

*For non-vented (recirculating) installations

**For vented installations

CABINET DIMENSIONS

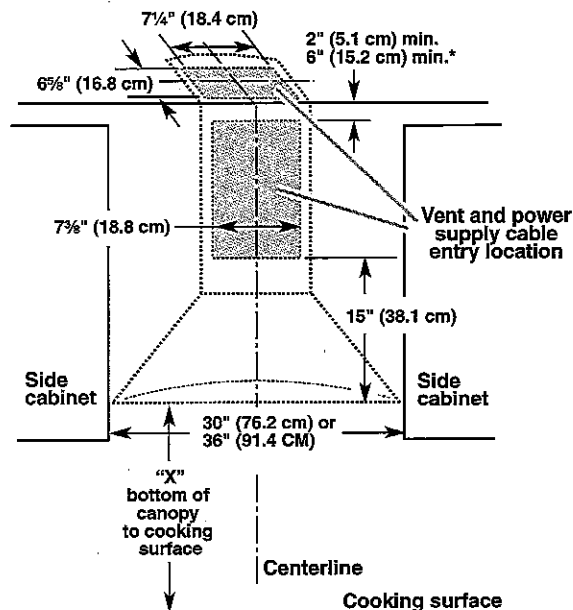

*For non-vented (recirculating) installations

IMPORTANT:

Minimum distance "X": 24" (61.0 cm) from electric cooking surface.

Minimum distance "X": 27" (68.6 cm) from gas cooking surfaces.

Suggested maximum distance "X": 36" (91.4 cm)

The chimneys can be adjusted for different ceiling heights. See the following chart.

Vented Installations		
	Min. ceiling height	Max. ceiling height
Electric cooking surface	7' 5" (2.26 m)	9' 2" (2.79 m)
Gas cooking surface	7' 8" (2.34 m)	9' 2" (2.79 m)
Non-vented (recirculating) Installations		
	Min. ceiling height	Max. ceiling height
Electric cooking surface	7' 5" (2.26 m)	9' 6" (2.9 m)
Gas cooking surface	7' 8" (2.34 m)	9' 6" (2.9 m)

***NOTE:** The range hood chimneys are adjustable and designed to meet varying ceiling or soffit heights depending on the distance "X" between the bottom of the range hood and the cooking surface. For higher ceilings, a Stainless Steel Chimney Extension Kit Part Number W10337357 is available from your dealer or an authorized parts distributor. The chimney extension replaces the upper chimney shipped with the range hood.

GAS COOKTOP INSTALLATION INSTRUCTIONS

(For 30" & 36" Models)

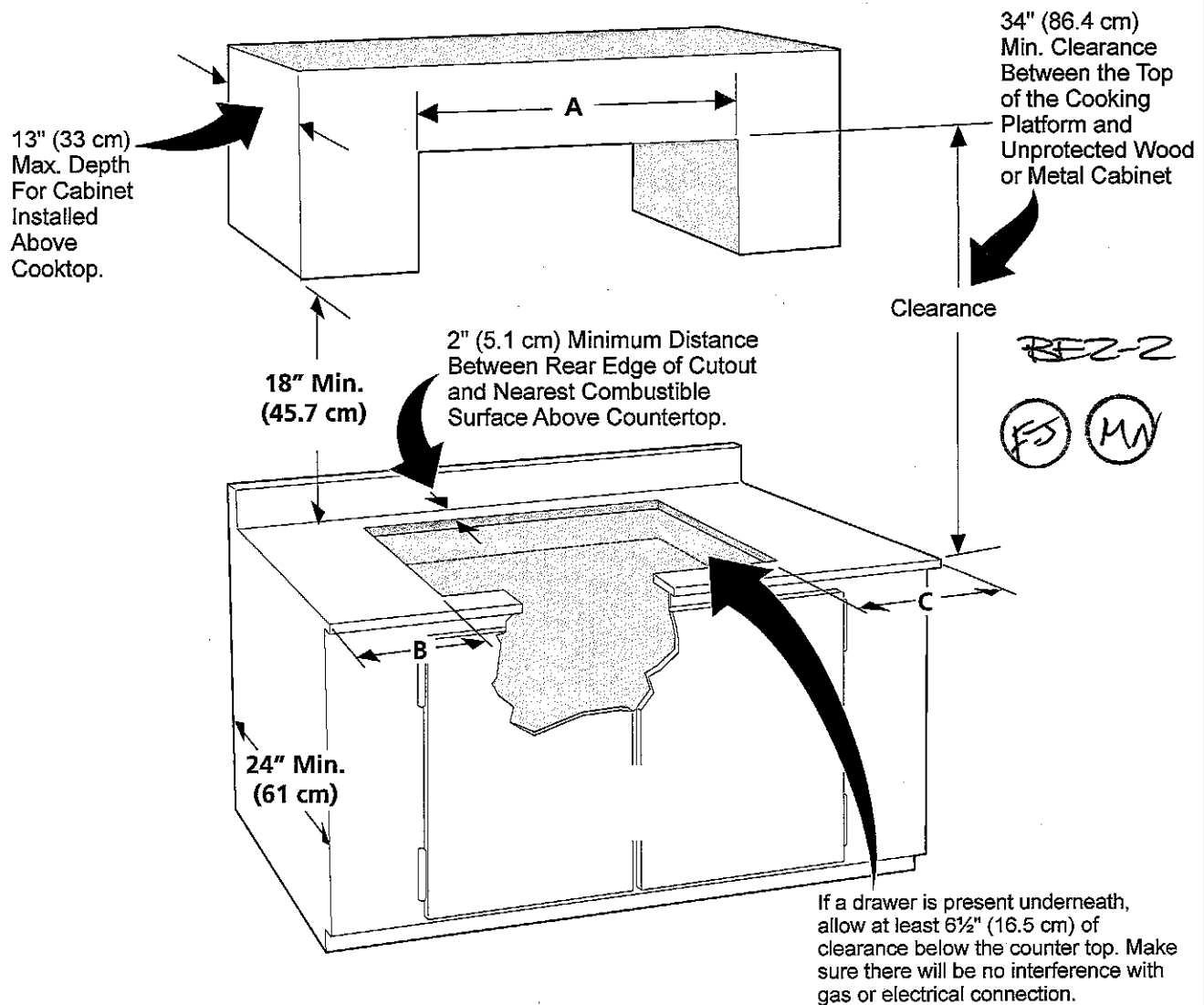

CAUTION To eliminate the risk of burns or fire from reaching over heated surfaces, cabinet storage space located above the cooktop should be avoided. If cabinet storage is provided, risk can be reduced by installing a range hood that projects horizontally a minimum of 5" (12.7 cm) beyond the bottom of the cabinets.

CAUTION Never store flammable products in the drawer.

MODEL	A	B. Minimum Clearance from Left Side	C. Minimum Clearance from Right Side
30" Cooktop	30" (76.2 cm)	12" (30.5 cm)	12" (30.5 cm)
36" Cooktop	36" (91.4 cm)	12" (30.5 cm)	12" (30.5 cm)

Figure 2 – CABINET DESIGN

BE2-2



Need Assistance? 1-877-374-3439

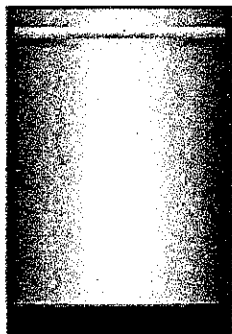

Bosch Ascenta Series SHX3AR75UC Built-In Undercounter Dishwasher, 24" Exterior Width, 6 Wash Cycles, Stainless Steel (Interior), 2 Loading Racks, Fully Integrated, 14 Capacity (Place Settings), 50 Decibel Level, Stainless Steel colour

Brand: Bosch
Model # SHX3AR75UC

Product Options

Visit Store For Sale Price! SHX3AR75UC - Stainless Steel

Product Quick Specs

Width: 23 9/16
Height: 33 7/8
Depth: 22 9/16
Weight: 63 lbs.
Exterior Width: 24
Wash Cycles: 6
Accepts Custom Designed Panels: No
Stainless Steel (Interior): Yes
Loading Racks: 2
Control Style: Fully Integrated
Capacity (Place Settings): 14
Hard Food Disposal: No
Decibel Level: 50

Product Description

Bosch™ SHX3AR75UC Dishwasher - Our Review Dinner parties and family gatherings are wonderful...until it's time to wash all those dishes. With the Bosch™ SHX3AR75UC White Dishwasher, that mountain of dishes will no longer be a problem. This dishwasher has an array of features that will keep all of your dishes sparkling, from your fine china to your flatware to your grimeiest pots and pans. And the Energy Star rating means you can keep all of your dishes clean and save energy and water. The Bosch™ SHX3AR75UC Dishwasher is the quietest dishwasher in its class, with an output of just 50dBA. Its water saving design and cleaning method can save you up to 280 gallons of water each year, which means a lower water bill. It exceeds the Energy Star requirements for water by 69% and its EcoSense reduces energy usage by up to 20%. With 6 wash cycles and 2 options, the Bosch™ SHX3AR75UC Dishwasher means no teacup is too fragile and no baked-on lasagna stands a chance. Wash cycles include PowerScrub, auto, regular, delicate/economy wash, and quick wash. In addition, the Sanitize option eliminates bacteria and enhances drying of your dishes. The variable spray pressure and washing motion means your dishes are thoroughly washed top to bottom and well rinsed. And if you're in a hurry, the quick wash cycle is done in less than thirty minutes. If you don't want to start your Bosch™ SHX3AR75UC Dishwasher right away, the 3, 6, and 9 hour delay wash options give you lots of choices. And while your dishes are washing, the self-latching door stays securely in place. Inside the washer, you'll find room for 14 place settings, so that holiday gathering should be no problem. The 300 Series racks are well constructed with lots of space, and the upper rack is adjustable. Finally, the triple filtration systems ensures clean water and no residue back on your dishes. And all of this cleaning power and efficiency comes with a full Canadian manufacturer's warranty - a 1 year minimum in-home warranty that includes parts and labor. That means great cleaning, great energy savings, and great service.

Product Features**Key Features**

50 dBA- Quietest in its class
Saves up to 280 gallons of water each year
Self-Latching Door Stays Put and Latches
Delicate Wash for Fine China

Design

Stainless Steel TailTub w/ *PP

Performance

50 dBA- Quietest in its class
6 Wash Cycles and 2 Options
Sanitize Option eliminates bacteria and enhances drying results
variable Spray Pressure

BE2-2



Need Assistance? 1-877-374-3439

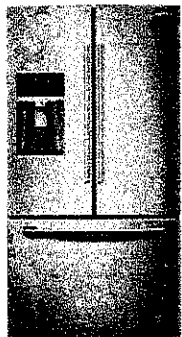

Samsung RF23HCEDBSR French Door Refrigerator, 36" Width, Thru Door Ice Dispenser, Energy Efficient, 22.5 cubic ft, Counter Depth, Exterior Water Dispenser, LED Lighting, Stainless Steel colour

Brand: Samsung
Model # RF23HCEDBSR

Product Options

Visit Store For Sale Price! RF23HCEDBSR - Stainless Steel

Product Quick Specs

Width: 35 3/4
Height: 70
Depth: 31
Weight: 330 lbs.

Product Description

Samsung RF23HCEDBSR Refrigerator - Our Review The Samsung RF23HCEDBSR 36-inch bottom mount French door refrigerator is a forward thinking appliance, perfect for your home. Samsung's innovative Twin Cooling Plus system works to maintain the humidity levels and temperature of both the refrigerator and freezer, for superior results. Its advanced digital touch controls make programming the settings quick and easy. This unit also provides plenty of flexible storage options, allowing you to organize your groceries with ease. The counter-depth design of the Samsung RF23HCEDBSR bottom mount refrigerator, allows you to have more workspace while enhancing your kitchen's look. Its elegant, built-in style blends seamlessly with your cabinetry as it adds style and functionality to your kitchen. Its large 22.5 cubic-foot capacity interior can store up to 23 bags of groceries with ease. The large 15.7 cubic-foot refrigerator compartment is equipped with five fresh food spill-proof glass shelves, two humidity-controlled crispers, and six clear bins. The five spill-proof tempered glass shelves include: slide-in and flip-in shelves to easily accommodate tall food items. Now when you have a large pot or tall multi-layered cake to refrigerator, you will not have a problem. These spill-proof shelves are designed to contain spills and leaks, to prevent them from seeping into the rest of the refrigerator. The Cool Select Pantry features a separate temperature control, making it ideal for large party platters, beverages, desserts, and more. Its humidity-controlled crispers were carefully designed by Samsung to preserve the freshness of fruits and vegetables. This refrigerator also offers six door bins, including three gallon bins to provide more shelf space. There is no need for milk to take up valuable shelf space within Samsung. The 6.8 cubic-foot freezer of the Samsung RF23HCEDBSR features a shelf to help maximize the storage capacity. You can store frozen vegetables, meats, ice cream, and more in this freezer with plenty of space to spare. Samsung design this unit with the innovative Twin Cooling Plus system to deliver high-performance and high-efficiency. The Twin Cooling Plus system uses independent cooling systems for the refrigerator and freezer. Running two separate systems allows for more consistent temperatures, and humidity-control. It is important the refrigerator is held at a higher humidity level than the freezer to keep fresh produce fresher longer. Programming this intelligent refrigerator is a synch with the digital control panel. This black control panel offers a soft blue LED screen to a visual display of temperature settings, filter status, and other information. To make this appliance even better, it is Energy Star qualified. Energy Star qualified appliances exceed the minimum federal energy consumption guidelines by at least 20-% to help reduce the carbon imprint of household appliances on the environment. This is good news for mother nature, and your utility bills. The sleek counter-depth Samsung RF23HCEDBSR bottom-mount French door refrigerator is beautiful forward thinking appliance that bring innovation and superior food preservation right into your kitchen. Its large 23 grocery bag storage capacity is easy to organize with the variety of flexible storage options. This refrigerator does everything Samsung says, and then some.

Product Features

- Energy Star qualified, exceeding federal guidelines for energy efficiency and saving you money
- Premium Wide & Tall external filtered ice and water dispenser delivers fresh, filtered water and crushed or cubed ice directly to your glass, pitcher or sports bottle
- Ice Master ice maker produces an incredible 5.9 lbs. of ice per day and can store 2.9 lbs.
- The slim water filter is NSF 42 and 53 certified and lasts up to 6 months. Conveniently located between the produce crispers, it is easy to change and leaves more space for food storage
- Digital Touch Controls are easy to use and encased in a black control panel with a stainless steel accent; Soft blue LED display keeps you informed of temperature settings, filter status, and more
- Twin Cooling Plus utilizes independent cooling systems for the refrigerator and freezer to maintain higher humidity in the refrigerator so your fruits and vegetables will stay fresher longer
- The refrigerator has 5 Tempered glass and spill-proof shelves; Slide-in and Flip-up shelves accommodate tall items; Cool Select Pantry has separate temperature control, making it perfect for party platters, beverages, etc.
- 2 humidity controlled crispers help preserve the freshness of fruits and vegetables
- Refrigerator door storage has 6 clear bins, including 3 Gallon bins, providing more shelf space
- 22.5 cu. ft. total capacity is enough to store up to 23 bags of groceries. Refrigerator compartment is a 15.7 cu. ft. and freezer is 6.8 cu. ft.
- Easy Open handle makes it easy to open your fully stocked freezer; baskets are solid, molded plastic so that ice crystals don't fall to the floor
- Door alarm notifies you if the refrigerator or freezer is left open. Water filter indicator let's you know when it is time to change the filter. Power Freeze and Power Cool options

GAS COOKTOP INSTALLATION INSTRUCTIONS

(For 30" & 36" Models)



INSTALLATION AND SERVICE MUST BE PERFORMED BY A QUALIFIED INSTALLER.
IMPORTANT: SAVE FOR LOCAL ELECTRICAL INSPECTOR'S USE.
READ AND SAVE THESE INSTRUCTIONS FOR FUTURE REFERENCE.



⚠ WARNING If the information in this manual is not followed exactly, a fire or explosion may result causing property damage, personal injury or death.

FOR YOUR SAFETY:

- Do not store or use gasoline or other flammable vapors and liquids in the vicinity of this or any other appliance.
- **WHAT TO DO IF YOU SMELL GAS:**
 - Do not try to light any appliance.
 - Do not touch any electrical switch; do not use any phone in your building.
 - Immediately call your gas supplier from a neighbor's phone. Follow the gas supplier's instructions.
 - If you cannot reach your gas supplier, call the fire department.
- Installation and service must be performed by a qualified installer, service agency or the gas supplier.

Appliances Installed in the state of Massachusetts:

This Appliance can only be installed in the state of Massachusetts by a Massachusetts licensed plumber or gas fitter. This appliance must be installed with a three (3) foot / 36 in. long flexible gas connector. A "T" handle type manual gas valve must be installed in the gas supply line to this appliance.

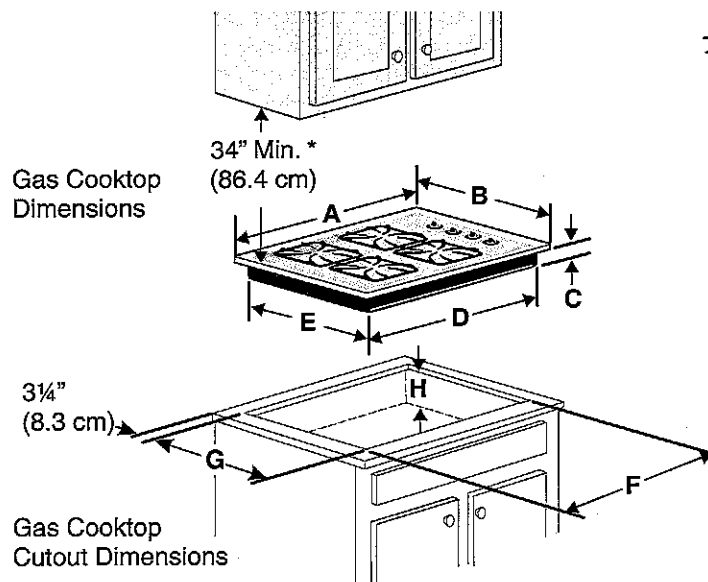

Figure 1

PRODUCT DIMENSIONS					
MODEL	A. WIDTH	B. DEPTH	C. HEIGHT	D. BOX WIDTH	E. BOX DEPTH
30" Gas Cooktop	30 (76.2)	21 3/4 (55.2)	4 1/4 (10.8)	28 (71.1)	19 3/8 (49.2)
36" Gas Cooktop	36 (91.4)	21 3/4 (55.2)	4 1/4 (10.8)	33 5/8 (85.4)	19 (48.3)
CUTOUT DIMENSIONS					
MODEL	F. WIDTH		G. DEPTH		H. HEIGHT BELOW COOKTOP
	MINIMUM	MAXIMUM	MINIMUM	MAXIMUM	
30" Gas Cooktop	28 1/4 (71.8)	28 3/8 (72.7)	19 3/8 (49.2)	19 3/4 (50.2)	8 (20.3)
36" Gas Cooktop	33 7/8 (86)	34 1/4 (87)	19 3/8 (49.2)	19 3/4 (50.2)	8 (20.3)

All dimensions are stated in inches and (cm).

Dimension H includes a 5" (12.7 cm) space underneath the cooktop for connection to gas supply line.

NOTE: Wiring diagrams for this cooktop are enclosed in this booklet

Printed in China

A01705101 (1509) Rev. D

English - pages 1-9

Español - páginas 10-18

Français - pages 19-26

Wiring Diagram 27-28

Product Dimensions

27" (68.6 cm) and 30" (76.2 cm) Ovens

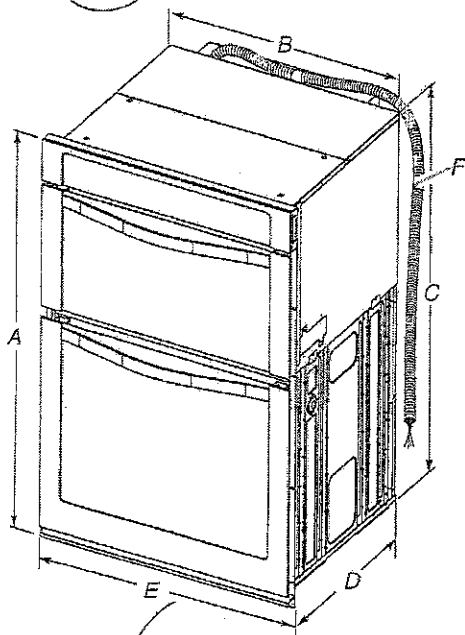

27" (68.6 cm) models

- A. 42 $\frac{15}{16}$ " (108.0 cm) overall height
- B. 25 $\frac{1}{16}$ " (64.6 cm) recessed width
- C. 41" (104.1 cm) recessed height
- D. 23 $\frac{1}{2}$ " (59.1 cm) max. recessed depth
- E. 27" (68.6 cm) overall width
- F. 48" (121.9 cm) Flexible conduit length measured from the conduit clamp located at the rear of the oven. Do not remove the conduit clamp.

30" (76.2 cm) models

- A. 42 $\frac{15}{16}$ " (108.0 cm) overall height
- B. 28 $\frac{1}{2}$ " (72.3 cm) recessed width
- C. 41" (104.1 cm) recessed height
- D. 23 $\frac{1}{2}$ " (59.1 cm) max. recessed depth
- E. 30" (76.2 cm) overall width
- F. 48" (121.9 cm) Flexible conduit length measured from the conduit clamp located at the rear of the oven. Do not remove the conduit clamp.

Cabinet Dimensions

27" (68.6 cm) and 30" (76.2 cm) Ovens

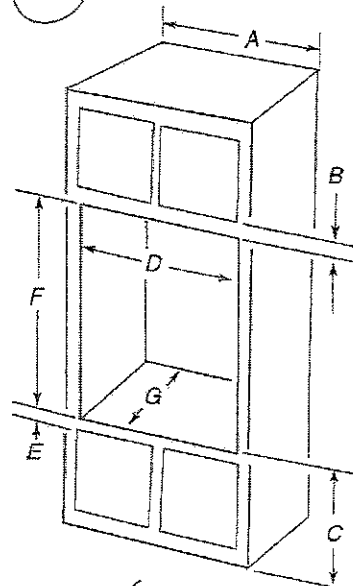

27" (68.6 cm) models

- A. 27" (68.6 cm) min. cabinet width
- B. 1" (2.5 cm) top of cutout to bottom of upper cabinet door
- C. 19 $\frac{1}{4}$ " (48.9 cm) bottom of cutout to floor is recommended. 4"-19 $\frac{1}{4}$ " (10.2-48.9 cm) bottom of cutout to floor is acceptable.
- D. 25 $\frac{1}{8}$ " (64.8 cm) cutout width
- E. 1 $\frac{1}{2}$ " (3.8 cm) min. bottom of cutout to top of cabinet door
- F. 41 $\frac{3}{16}$ " (105 cm)* recommended cutout height
- G. 24" (60.7 cm) cutout depth

30" (76.2 cm) models

- A. 30" (76.2 cm) min. cabinet width
- B. 1" (2.5 cm) top of cutout to bottom of upper cabinet door
- C. 19 $\frac{1}{4}$ " (48.9 cm) bottom of cutout to floor is recommended. 4"-19 $\frac{1}{4}$ " (10.2-48.9 cm) bottom of cutout to floor is acceptable.
- D. 28 $\frac{1}{2}$ " (72.4 cm) cutout width
- E. 1 $\frac{1}{2}$ " (3.8 cm) min. bottom of cutout to top of cabinet door
- F. 41 $\frac{3}{16}$ " (105 cm)* recommended cutout height
- G. 24" (60.7 cm) cutout depth

*NOTE: The cutout height can be between 41" (104.1 cm) and 41 $\frac{1}{2}$ " (105.6 cm) for microwave/oven combination.

BEZ-2.
FEB 1 2018
(confirmed via email)

Gold Park Homes Décor

Centre Disclaimers

Through years of doing business, we at Gold Park Homes have encountered issues beyond our control. The following disclaimers apply to all instances of Purchaser's Extras forms and all Interior Colour Scheme forms.

FIREPLACES

Fireplace Marble: Due to the many variables that can affect the pattern and/or design, frequently the marble installed on the fireplace will not be identical to the samples. We will make every attempt to come as close to the samples as possible, but cannot be responsible for results which differ from the samples.

CERAMIC FLOOR TILE

Many variables including variegation can affect tile colour, pattern and/or design which mean installed tiles may not be identical to the samples. We will make every attempt to come as close as possible, but cannot be responsible for results which differ from the samples.

HARDWOOD FLOORING

The purchaser is advised that cupping and shrinkage are characteristics of hardwood flooring normally appearing after installation, especially when humidity levels are not regulated, and no warranty is provided by the flooring supplier with respect to such cupping and shrinkage. Furthermore, hardwood floors may also heave and warp when located at or close to entrance points of the home, where rain could make its way to the flooring. The vendor agrees to install any hardwood flooring ordered by the purchaser in a good and workmanlike manner, but shall not be responsible for, and is hereby released by the purchaser from responsibility and liability for cupping, shrinkage, heaving and warping of hardwood flooring in the above mentioned circumstances.

STAIRCASE VS FLOORING

WOOD SPECIES DIFFERENCE

The purchaser is aware and therefore accepts and acknowledges that the wood species of the staircase and flooring chosen do not match. This difference might result in an undesirable colour variance.

The purchaser is aware and therefore accepts and acknowledges that though the flooring is of the same species as the staircase the difference in product finishing may result in a stain colour variance.

The purchaser agrees that the vendor is to be exempt from any and all claims by the purchaser regarding this colour variance.

RAILINGS

All railings, pickets, posts, nosing's and stairs come from solid wood and veneered wood materials sourced from multiple locations and sources. As such there will be variations in grains and shades between the various natural components beyond our control. Due to this variance in material, all components will stain with colour or natural finish differently.

Iron pickets are wrought in nature and depending on the manufacturing process will have differences from picket to picket which is normal. Also the finish of the iron pickets is of a powder coated nature. This process can produce minor colour variations or tones. Furthermore, the assembly of the metal pickets can develop a natural rattle over time from vibration in the railing. Minor rattling is normal and is a part of the wrought iron picket assembly.

HOUSE EXTERIORS

Variations in subcontractors across different sites and varying site conditions may result in house exteriors that differ from the artist renderings. We cannot be responsible for results which differ from the artists renderings of elevations.

PLASTER MOULDINGS AND MEDALLIONS

Plaster mouldings will not be installed in open to above areas or areas with 2 storey elements.

STAIN COLOURS

Due to the many variables that can affect the outcome of a stain colour on wood, staircases, railings, and fireplaces, the colour may not be identical to samples. Factors such as density, age, humidity, air temperature, and the uniqueness of each piece of wood can result in wide variations in darkness or lightness. We will make every attempt to come as close to the sample as possible, but cannot be responsible for results which differ from the samples.

Stain on pre-finished hardwood floors will not be an exact match to the stain colours available on stairs, pickets and rails. The purchaser is responsible for choosing the stain on these areas to their satisfaction.

IN-WALL CONDUIT FOR AUDIO/VIDEO CABLES

It is important to note that due to the variation in framing requirements in different parts of your home, conduit lengths and routing can vary. In virtually all instances of ground floor installation (I.e. above a fireplace), conduit will first travel down into the basement below the floor joists, over to the termination point and back up into the main floor. As a result, it is best to measure the length of the conduit after occupancy with a "pull wire" before

CABINETRY DOOR HARDWARE

Cortina Kitchens' cabinetry doors and drawer fronts will be drilled to accept a standard knob or handle selected from Cortina's hardware boards. This drilling comes standard with the order, and is done ONLY in our shop, not on the job site.

For those not wanting Cortina's hardware drilling, the following applies:

No holes to be drilled on the doors and drawer fronts should be specified in writing on the colour chart and the P.O. If while in production, Cortina Kitchens misses this request, Cortina Kitchens and the Builder will not be held responsible to replace any or all doors and drawer fronts affected, and the customer agrees to accept the product as is. No hardware will be supplied or credited by Cortina Kitchens with this request. No charge will apply for this request.

PVC DOORS

All cabinets with PVC (Thermofoil) Doors come with melamine gables, panels and kick. The doors, crown moulding and light valance are PVC wrapped. Open shelves incorporated in design will only be available with melamine interiors. There will be variations in colour shades between the PVC parts (doors, crown and Light valance) and the melamine parts (open shelves, Gables, Panels and Kick) due to the difference in material.

Furring Panel with crown moulding to the ceiling is not available on all PVC door styles due to subtle variations in colour shades between the PVC parts (moulding) and the melamine parts (furring panel) due to the difference in material. Grain directions in wood grain pattern melamine, vary between the furring panel, crown moulding (horizontal) and the PVC doors (vertical).

GRANITE, MARBLE ENGINEERED SURFACES WAIVER

Granite and marble are naturally occurring products, and due to the many variables that can affect the pattern, colour and/or design and "pitting" of natural products slabs installed will not be identical to the samples displayed. We will make every attempt to come as close to the samples as possible, but cannot be responsible for results which differ from the samples. Every effort is made to provide granite counter tops as close as possible but the vendor is not responsible for results which differ from the sample displayed. All countertop surfaces may have seems & product pattern & shade can change in areas containing seems.

RESELECTIONS

It is not uncommon for flooring, such as tile, to become discontinued prior to its installation. Therefore it may be necessary to make a reselection of certain materials sometime during the build process. We cannot assure you that another choice approximating your selection will be available.

PLANS

Plans are subject to change without notice. Actual usable floor space may vary from the stated floor area. Layout for kitchen, furnace, HWT and laundry tub may vary from plan. Vertical and horizontal bulkhead, which are not shown on plan, may be required for plumbing and heating runs. E.& O.E.

PLEASE NOTE:

In the event the work on the house has progressed beyond the point where the items covered by these invoices cannot be installed without entailing any unusual expense, then this order is to be cancelled and any deposit paid in connection with the same is to be refunded to the purchaser.

The vendor will undertake to incorporate the work covered by the sales extra in the construction of the house but will not be liable to the purchaser in any way, if for any reason the work covered by the extra is not carried out. In that event, any monies paid in connection with the same shall be returned to the purchaser.

It is understood and agreed that if for any reason whatsoever the transaction of Purchase and Sale is not completed, the total cost of extras ordered are not refundable to the Purchaser(s).

Extras or changes will not be processed unless signed by the Vendor.

These extras may not be amended without the written consent of Gold Park Homes.

The purchaser(s) and the builder acknowledge and agree that this "Purchaser's Extra" form shall not be deemed to be part of the agreement of purchase and sale entered into between them, nor an addendum thereto.

No postdated cheques will be accepted.

No estimates or orders will be accepted once construction has commenced.

Should a refund be requested on any extras purchased, an 80% reimbursement of the purchase price will be given. (a \$50.00 minimum charge and a maximum \$250.00 charge will apply)

Estimates will only be considered when resubmitted on a signed Purchaser Extras form, accompanied by payment in full.

All prices are estimates only and may be subject to change. Should a change in price occur Gold Park Homes reserves the right to request from the purchaser an adjustment of the price or a refund limited to that item.

Purchasers are aware & accept that ANY changes made to upgrades after signing the Purchasers Extra Form are subject to a minimum administration fee of \$500. PLUS a 10% holdback fee.

Purchasers are aware that any request to add a percentage of upgrades from the purchaser's extras form will be processed only after the builder receives approval letter from the bank.

(FS)

(MN)

purchasing your cables. For above-fireplace installations, the conduit wall plate will be installed approximately 10" above the Fireplace Mantle, unless otherwise specified in the Construction Summary.

APPLIANCE SPECIFICATIONS

All appliance openings are set to builder's standard openings. Please advise Décor Centre at time of your structural appointment if custom sizing of cabinets is required for any built - in appliances. The purchaser is responsible for costs and fees associated with changes to pre-manufactured kitchens made subsequent to colour appointments.

Purchaser accepts & acknowledges that in order to accommodate upgraded appliances, all appliance specifications should be provided at the time of their structural appointment, should this not occur they must be provided to the Décor Center within one (1) week of completion of structural chart. Failure to do so may result in the need to revert to the standard appliance openings or in a delay in construction of your dwelling, as well as a cost of \$500 to re-open your structural file should changes be required. As a result we may be forced to extend the closing of your transaction. Due to failure to complete the above-mentioned selections and at no fault of our own, we reserve our right to hold you responsible for this delayed closing, including charging extra administration cost and interest on the balance due on closing.

Purchasers Accept Standard Appliance Openings (unless otherwise specified):

Fridge - 37-1/2"W x 73-1/2" High Approx.

Range - 30-1/2"D x 31-1/2"W Approx.

Dishwasher - 24" W Approx.

DELETION OF HOODFAN & CABINETS ABOVE STOVE:

The purchasers are aware that in requesting NOT TO INSTALL builder's standard hood fan and standard cabinets above stove they will receive NO STANDARD HOOD FAN and NO CREDIT. Purchasers are installing their own hood fan after closing and accept that it may waive any warranty associated with such a change.

Purchasers accept and acknowledge that the exhaust fan duct hole may be off-centered with the stove in the kitchen due to purchasers installing their own hood fan after closing. The vendor is exempt from adjusting such openings for the purchasers range hood.

ELECTRICAL FOR APPLIANCES

Pricing is subject to change based on the appliance specifications provided. Purchasers should provide proper appliance specifications and cut-out sheets in order for Gold Park to price extras accordingly.

KITCHEN CABINETS

The kitchen you order/purchase will undoubtedly contain slight colour variations. The degree of these variations is virtually impossible to determine before the kitchen is installed in its intended location. The amount of and type of lighting will also affect various highlights in the finish. Note: No two pieces of wood are identical. Variations in colour tone and grain patterns make a perfect colour match virtually impossible. It is generally agreed that these variations add to the natural beauty of a wood kitchen.

STAIN

Charcoal is a spray stain applied to Oak and Maple products with several characteristics that are important to be aware of when purchasing this product.

1. Shadow lines may be visible at the interior profile edges of a door or drawer front. If movement occurs shadow lines may increase or decrease, depending on the style and/or size of a door or drawer front.
2. Variation and unevenness may be visible in the finish.
3. Hairline cracks at the joints are created over time due to the nature of natural wood, caused by usage, humidity**, or dryness. They tend to be more visible to darker stains, than lighter wood stains.

** Relative humidity is recommended to be between 45% and 55%. Please refer to Cortina Kitchens "Cleaning, Care, Maintenance, & Warranty Information" guide.

Please be advised that Cortina Kitchens will not replace doors and/or parts that exhibit the above characteristics associated with this finish. These characteristics are not avoidable and are a result of the natural characteristics of wood and wood veneer, and the characteristics of darker stains on wood. The Charcoal stain is not available on doors in Group IV, Group IVA, Group V and Group VA.

Cortina Kitchens offers a wide variety of finishes, applied to oak and maple products. The subject finishes include the spray stains Cocoa, Espresso, Graphite as well as wiping stain Ebony.

Due to the very dark stains applied on natural maple and oak doors and joints, several characteristics are important to be noted when purchasing these products.

1. Shadow lines may be visible at the interior profile edges of a door or drawer front. If movement occurs shadow lines may increase or decrease, depending on the style and/or size of a door or drawer front.
2. Variation and unevenness may be visible in the finish.
3. Hairline cracks at the joints are created over time due to the nature of natural wood, caused by usage, humidity, or dryness. They tend to be more visible to darker stains, than lighter wood stains.

Please be advised that Cortina Kitchens will not replace doors nor parts that exhibit the above characteristics associated with this finish. These characteristics are not avoidable and are a result of the natural characteristics of wood and wood veneer, and the characteristics of darker stains on wood.

F5 V1

Please be advised that your failure to finalize your structural or colour selections may result in a delay in construction of your dwelling and we may have to extend closing of your transaction. Due to failure to complete the above-mentioned selections and at no fault of us, we reserve our right to hold you responsible for a delayed closing, including charging extra administration cost and interest on the balance due on closing.

Purchaser has attended a Colour appointment at the Decor Centre & has DECLINED any additional upgrades and accepts and acknowledges that there will be no further structural changes/additions/deletions to be made upon signing.

I hereby acknowledge reading and understanding the above copy and will not hold Gold Park Homes responsible for any issues in relation to above.

Purchasers Signatures

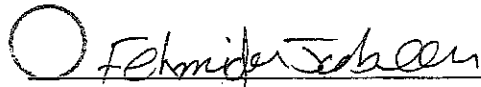
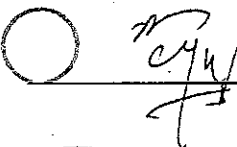
Date Nov 20 2017

BE2-2