

Brampton Encore - 58L - 2 - 28-6 Elev.A Berlio OPT 4

CERAMIC

Inv.1,784	1 - FOYER / POWDER / KITCHEN-BREAKFAST / SIDE ENTRANCE LANDING FLOOR TILE: UPGRADE 2 - 12X24" LAID IN STRAIGHT, STACKED PATTERN. SEE PLAN FOR TILE DIRECTION
Line26205	Note:
6Mar18 / 4Apr18	

CONCRETE AND DRAIN

Inv.1,450	1 - ROUGH-IN - 3PC BASEMENT ROUGH-IN
Line22706	Note:
22Jun17 / 29Nov17	

ELECTRICAL

Inv.1,450	1 - KITCHEN: MOVE STANDARD CEILING OULTET TO ABOVE ISLAND. SEE PLAN FOR LOCATION.
Line22707	Note:
22Jun17 / 29Nov17	
Inv.1,450	1 - KITCHEN: ROUGH - IN CEILING OUTLET ON SAME SWITCH - DOES NOT INCLUDE FIXTURE - LOCATE ABOVE ISLAND, SEE PLAN FOR LOCATION. USE SAME SWITCH AS STANDARD LIGHT
Line22708	Note:
22Jun17 / 29Nov17	

Exterior Colours

Inv.1,450	1 - EXTERIOR COLOUR PACKAGE #1
Line24668	Note:
22Jun17 / 29Nov17	
Inv.1,450	1 - EXTERIOR COLOUR PACKAGE # 1
Line24902	Note:
22Jun17 / 29Nov17	

FORMING

Inv.1,450	1 - SIDE DOOR- HOME TO EXTERIOR- AS PER PLAN AND GRADE PERMITTING
Line22705	Note:
22Jun17 / 29Nov17	

FRAMING

Inv.1,450	1 - MAIN FLOOR: STANDARD ARCHWAY EXTENDED HEIGHT 96" (PRICE PER DOOR)- GROUND FLOOR 2 STOREY MODELS
Line24667	Note:
22Jun17 / 29Nov17	
Inv.1,450	1 - SIDE DOOR- HOME TO EXTERIOR- AS PER PLAN AND GRADE PERMITTING
Line24900	Note:
22Jun17 / 29Nov17	

GRANITE MARBLE QUARTZ

Inv.1,784	1 - KITCHEN: FLUSH BREAKFAST BAR
Line26203	Note:
6Mar18 / 4Apr18	

HARDWOOD

Brampton Encore - 58L - 2 - 28-6 Elev.A Berlio OPT 4

Inv.1,784	1 - UPPER HALL: INSTALL "STANDARD" HARDWOOD IN UPPER HALL
Line26204	Note:
6Mar18 / 4Apr18	

INTERIOR TRIM AND DOORS

Inv.1,450	2 - MAIN FLOOR: STANDARD ARCHWAY EXTENDED HEIGHT 96" (PRICE PER DOOR)- GROUND FLOOR 2 STOREY MODELS
Line22710	Note:
22Jun17 / 29Nov17	

MISC.

Inv.1,450	1 - Purchaser has attended an appointment at the Decor Centre & has DECLINED any additional upgrades and accepts and acknowledges that there will be no further changes/additions/deletions to be made upon signing on June 22 2017.
Line22711	Note:
22Jun17 / 29Nov17	

Inv.1,450	1 - Purchasers are aware & accepts that ANY changes made to upgrades after signing this Purchasers Extra Form are subject to a minimum administration fee of \$500. PLUS a 10% holdback fee.
Line22712	Note:
22Jun17 / 29Nov17	

Inv.1,450	1 - BONUS PACKAGE: \$10,000.00 (INCLUDING TAXES) WORTH OF UPGRADES FROM GOLD PARK HOMES DÉCOR CENTRE IS BEING APPLIED TOWARD THE STRUCTURAL APPOINTMENT. PURCHASER HAS A REMAINING AMOUNT OF \$3677.65 (INCLUDING TAXES) TO BE USED TOWARD THE COLOUR APPOINTMENT
Line22713	Note: \$5000 BONUS + \$5000 BROKER FEE
22Jun17 / 29Nov17	

Inv.1,784	1 - BONUS PACKAGE: \$3677.65 (INCLUDING TAXES) WORTH OF UPGRADES FROM GOLD PARK HOMES DÉCOR CENTRE IS BEING APPLIED TOWARD THIS APPOINTMENT. PURCHASER HAS A REMAINING AMOUNT OF \$00 (INCLUDING TAXES).
Line26209	Note:
6Mar18 / 4Apr18	

Inv.1,784	1 - Purchaser has attended an appt at the Decor Centre & has DECLINED any additional upgrades and accepts and acknowledges that they have checked the order and accepts the attached selections as noted.
Line26207	Note: There will be no further changes/additions/deletions to be made upon signing on March 6, 2018.
6Mar18 / 4Apr18	

WINDOWS - BASEMENT

Inv.1,450	2 - BASEMENT WINDOWS - UPGRADE EXISTING BASEMENT WINDOW TO 30 INCH X 24 INCH - MAY REQUIRE INSTALLATION OF WINDOW WELL
Line22709	Note: SEE PLAN FOR LOCATION
22Jun17 / 29Nov17	

WINDOWS AND DOORS

Inv.1,450	1 - SIDE DOOR- HOME TO EXTERIOR- AS PER PLAN AND GRADE PERMITTING
Line24901	Note:
22Jun17 / 29Nov17	

GOLDPARK

WORTH MORE™

TO: Gold Park Homes

DATE: MARCH 16 2018

SITE: ENCORE 2

LOT: 581

I/We the undersigned, hereby authorize SANJAY PARASHAR
to act on my/our behalf in all matters relating to colour selection and the selection of upgrades
and extras for the above mentioned Lot, including, without limitation, signing of all documents
relating to these matters. Any and all acts carried out by SANJAY PARASHAR
on my/our behalf shall have the same effect as acts of my/our own and are irrevocable.

The authorization is valid under further written notice from the undersigned.

WITNESS

Name:

WITNESS

Name:

PURCHASER

Name: AKHIL SETHI

PURCHASER

Name: SANDEEP KAINTH

Purchasers: Sanjay Parashar, & Akhil Sethi & Sandeep K Property: 58L
Telephone Res. / Bus: (416) 877-7867 Project: Brampton Encore - Phase 2
Decor Advisor: Yolande Somerville Model and Elevation: 28-6 Elev.A Berlio OPT 4

Layout Changes: Yes No Sketch Attached: Yes No Exterior Colour Scheme:

1. Cabinetry

	Style and Colour	Counter	Hardware
Kitchen / Breakfast	Siena oak 'Slate'	Granite: Grigio Sardo	cs1-23
Laundry Room	n/a	n/a	n/a
Powder Room	n/a	n/a	n/a
n/a			
Master Ensuite Bathroom	Siena oak 'Slate'	P-Lam #6697-46	cs1-24
Second Ensuite Bathroom (If Applicable)	n/a	n/a	n/a
Main Bathroom	Siena oak 'Slate'	P-Lam #6697-46	n/a cs1-24

Comment

2. Floor Tile

	Selection
Entrance Vestibule	*12x24" Land 'Bianco'
Main Hall	
Kitchen / Breakfast	*12x24" Land 'Bianco'
Laundry Room	
Powder Room	*12x24" Land 'Bianco'
Side Entrance Landin	*12x24" Land 'Bianco'
Master Ensuite Bathroom	13x13" Serpentine 'Beyaz-white'
Second Ensuite Bathroom (If Applicable)	n/a
Lower Landing (If Applicable)	n/a
Main Bathroom	13x13" Serpentine 'Beyaz-white'

Comment

3. Wall Tile

	Selection	Listello/Inserts	Describe
M. Ens Tub skirt/splash	8x10" Weave 'Tender Grey'	Yes No	
Master Ensuite Bathroom			
Tub Deck	8x10" Weave 'Tender Grey'	Yes No	
Shower Stall	8x10" Weave 'Tender Grey'	Yes No	
Bathroom Walls	n/a	Yes No	
Second Ensuite Bathroom (If Applicable)	n/a	Yes No	
Main Bathroom	8x10" Weave 'White'	Yes No	
Kitchen Backsplash	Yes No	Backsplash Behind Fridge	

Comment



Purchasers:
Sanjay Parashar, & Akhil Sethi & Sandeep K

Property: 58L

Telephone Res. / Bus:
(416) 877-7867

Project:
Brampton Encore - Phase 2

Decor Advisor:
Yolande Somerville

Model and Elevation:
28-6 Elev.A Berlio OPT 4

4. Plumbing Fixtures

Second Ensuite

Powder Room

Master Ensuite Bathroom

Other Room - Specify

Other Washroom

Other Room - Specify

Comment

Standard Thru Out

5. Hardwood Flooring

	Type and Stain		Type and Stain
Main Hall	n/a	Upper Landing	n/a
Kitchen / Breakfast	n/a	Upper Hall	Standard Natural
Living Room	n/a	Master Bedroom	n/a
Dining Room	n/a	Bedroom #2	n/a
Family Room	Standard Natural	Bedroom #3	n/a
Den/Library	n/a	Bedroom #4	n/a
Entrance Vestibule	n/a	Bedroom #5	n/a
Lower Landing (If Applicable)	n/a	Other Room - Specify	Standard Natural
		Formal room	

Comment

6. Carpeting

	Upgrade	Description
Ground Floor	<input type="checkbox"/>	
Second Floor	<input type="checkbox"/>	Standard 'Pearl White' <i>SOFT CARPET</i>
	<input type="checkbox"/>	

	Type	Area
Upgrade Underpad		
	Capped	Runner - *Upgrade
Carpet on Stairs		

Comment

Standard Underpad

7. Fireplace

	Living Room			Family Room			Other Room - Specify		
	Purchased	As Per Plan	N/A	Purchased	As Per Plan	N/A	Purchased	As Per Plan	N/A
	<input type="radio"/>	<input type="radio"/>	<input checked="" type="radio"/>	<input type="radio"/>	<input checked="" type="radio"/>	<input type="radio"/>	<input type="radio"/>	<input type="radio"/>	<input checked="" type="radio"/>
Fireplace Type				Standard Gas					
Mantle Type				NF-24					
Colour / Stain				White					
Surround				Grigio Carnico					
Hearth				none					

Comment



Scheduled Closing Date: Thursday, August 23, 2018

Purchasers: Sanjay Parashar, & Akhil Sethi & Sandeep K Property: 58L

Telephone Res. / Bus: (416) 877-7867

Project: Brampton Encore - Phase 2

Decor Advisor: Yolande Somerville

Model and Elevation: 28-6 Elev.A Berlio OPT 4

8. Trim Carpentry

Interior Doors Front Door Glass Inserts Door Handles
Interior Trim

Comment

9. Plaster Mouldings and Medallions

Standard Throughout ☐ Yes ☐ No ☒ N/A

Entrance Vestibule	<input type="text"/>	<input type="text"/>	Kitchen/Breakfast	<input type="text"/>	<input type="text"/>
Main Hall	<input type="text"/>	<input type="text"/>	Den/Library	<input type="text"/>	<input type="text"/>
Living Room	<input type="text"/>	<input type="text"/>	Lower Landing	<input type="text"/>	<input type="text"/>
Dining Room	<input type="text"/>	<input type="text"/>	Other Room - Specify	<input type="text"/>	<input type="text"/>
Family Room	<input type="text"/>	<input type="text"/>			

Comment

10. Railings and Spindles

Railing Package	<input type="text" value="Standard Oak"/>		
Railing Colour	<input type="text" value="Natural"/>	Spindle Colour	<input type="text" value="none"/>
Stringer / Riser	<input type="text" value="Natural"/>	Treads	<input type="text" value="Natural"/>
Comment	Oak Stairs <input checked="" type="radio"/> Yes <input type="radio"/> No <input type="radio"/> N/A		

11. Wall Paint / Ceilings

Throughout Finished Areas

Trim Paint

Smooth Ceilings

Ground Floor ☐

Second Floor ☐

Note

Comment

18

*** NOTE: This is not an approved document. Document must be locked ***

Scheduled Closing Date: Thursday, August 23, 2018

Purchasers: Sanjay Parashar, & Akhil Sethi & Sandeep K Property: 58L
Telephone Res. / Bus: (416) 877-7867 Project: Brampton Encore - Phase 2
Decor Advisor: Yolande Somerville Model and Elevation: 28-6 Elev.A Berlio OPT 4

12. Electrical

Hood Fan ☐ White ☒ Stainless ☐ N/A

Standard Appliances ☒

Over The Range Microwave ☐

Chimney Style Fan ☐

Above Kitchen Cabinet Light ☐ Yes ☒ No

Below Kitchen Cabinet Light ☐ Yes ☒ No

Comment

13. Heating and Air Conditioning

Air Conditioning

Gas Provisions Stove

Gas Provisions Dryer

Gas Provisions Barbecue

Comment

14. Additional Comments

15. Disclaimers and Notes

- 1) Colours of all materials are as close as possible to builder's selection, but not necessarily identical due to variances in manufacturing.

2) Any extras listed above are null and void unless accompanied by a separate invoice/amendment. Said invoice must be paid in full.

3) The Purchaser acknowledges that after Interior Colour Selection form is signed and dated, no further changes will be permitted other than re-selection due to unavailability. Purchaser's Initials

4) The Purchaser acknowledges reading and accepting the "Gold Park Homes Decor Centre Disclaimers" form. This document contains other miscellaneous disclaimers.

This Interior Colour Selection is final and approved by:

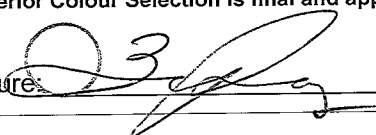
Signature: 

Date:

BE2-58L
June 22 2017
BE2-58L
March 6 2018

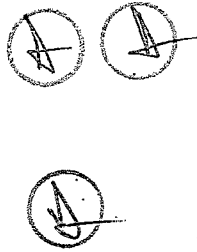

The Berlio

SEMI SERIES

→ Elevation A • 2,047 sq.ft.
Elevation B • 2,037 sq.ft.
Elevation C • 2,037 sq.ft.
Elevation D • 2,047 sq.ft.

LEGEND

- STD CEILING LIGHT
- ⊕ CAPPED CEILING OUTLET
- △ 96" ARCH
- △ ⊕ PHONE
- △ ⊗ CABLE

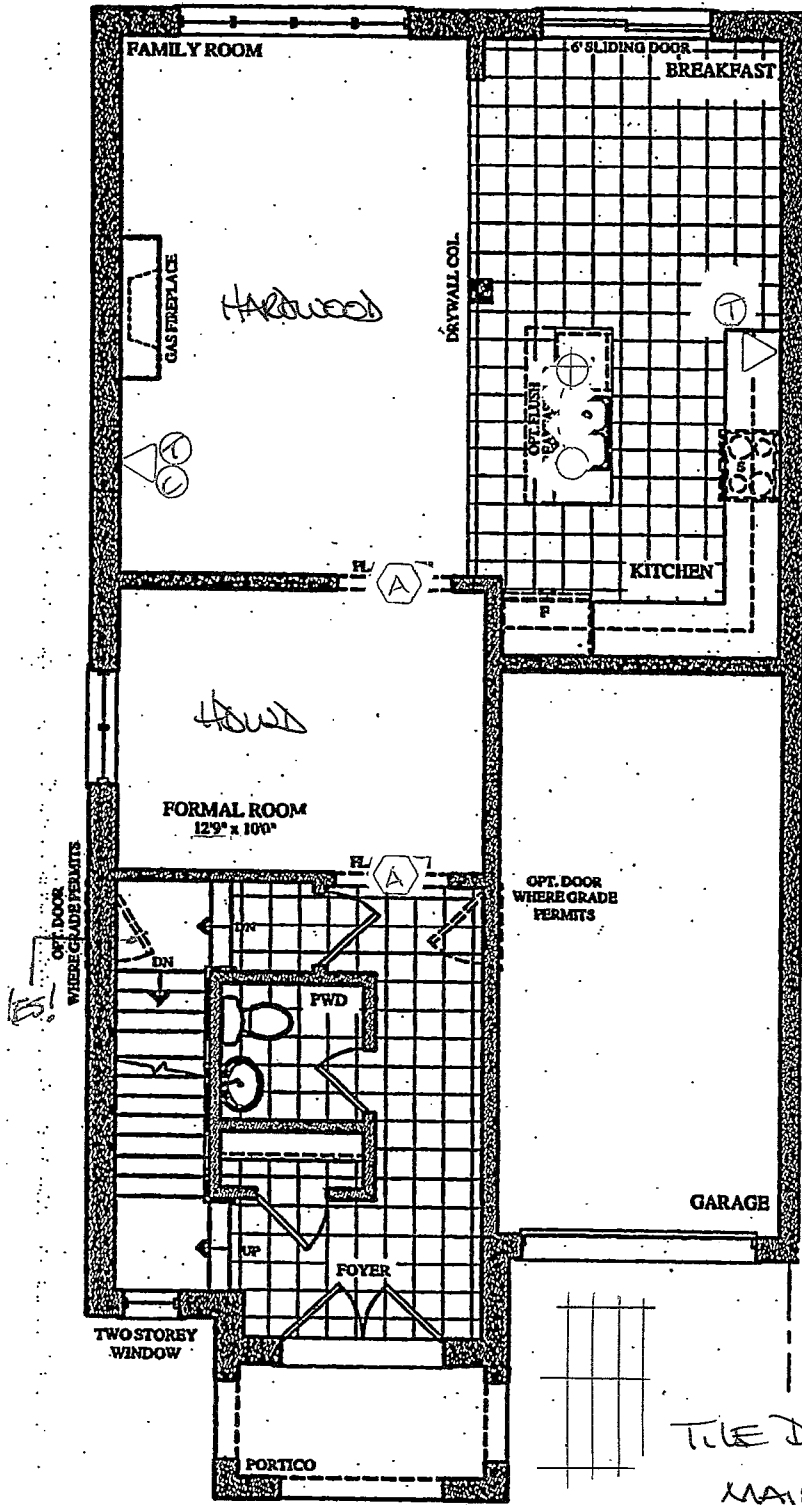

GROUND FLOOR PLAN
ELEV. 'A' & 'B'

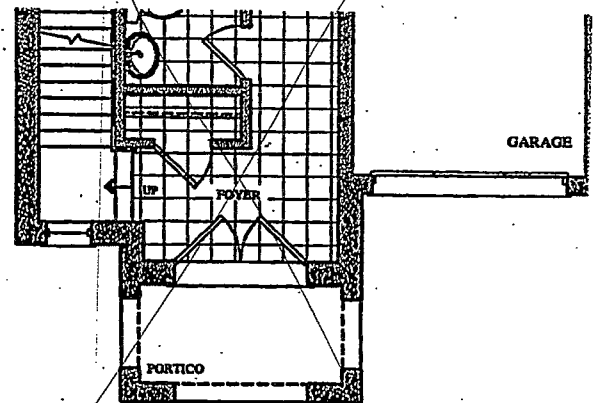

PART. GROUND FLOOR PLAN
ELEV. 'C' & 'D'

BE2-58L

JUNE 22 2017

BE2-58L

MARCH 6 2018

The Berlio

SEMI SERIES

Elevation A • 2,047 sq.ft.

Elevation B • 2,037 sq.ft.

Elevation C • 2,037 sq.ft.

Elevation D • 2,047 sq.ft.

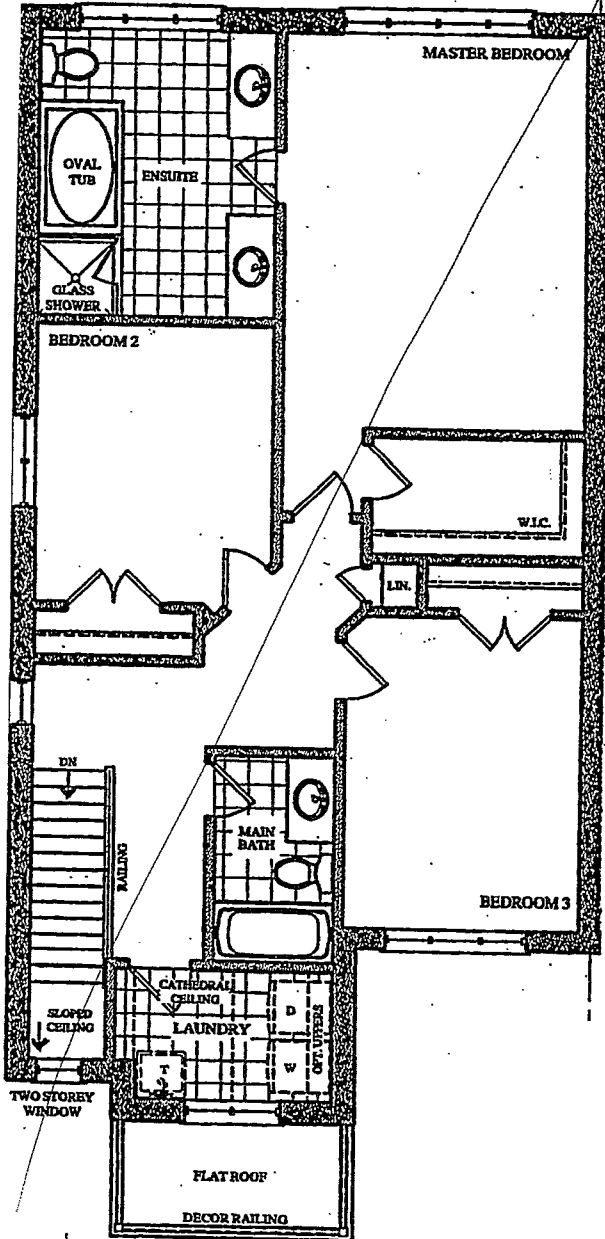

SECOND FLOOR PLAN
ELEV. 'A'

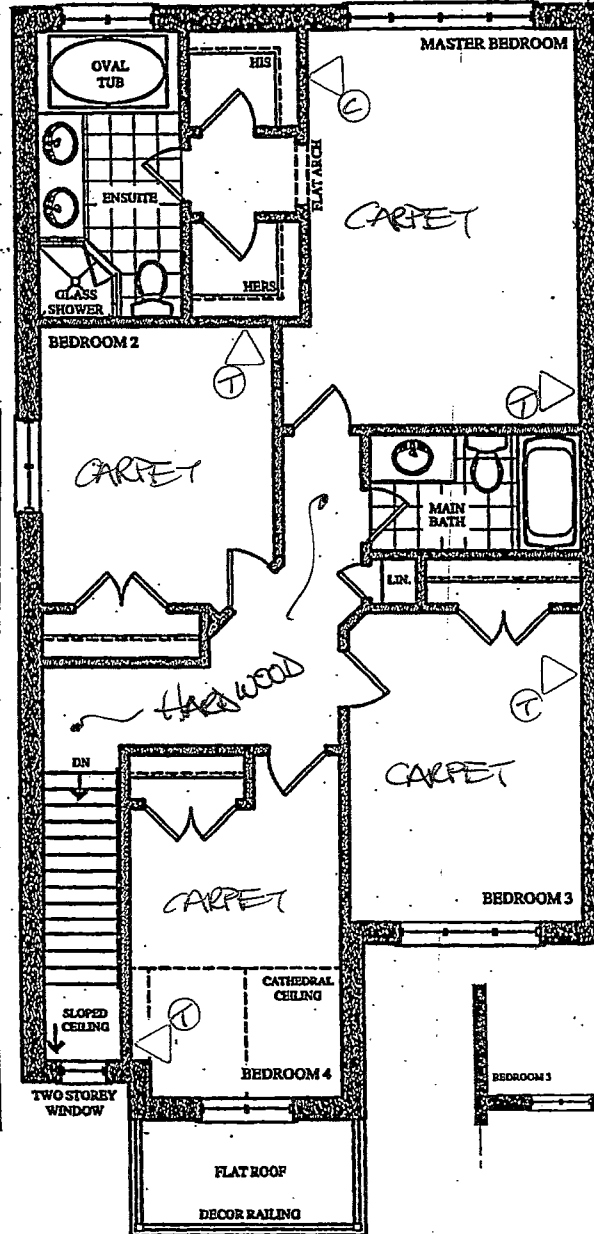

OPT. 4 BED SECOND FLOOR PLAN
ELEV. 'A'

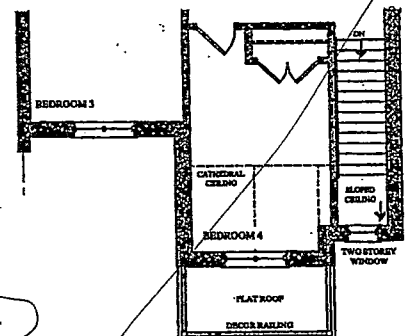

PART. OPT. 4 BED SECOND FLOOR PLAN
ELEV. 'B'

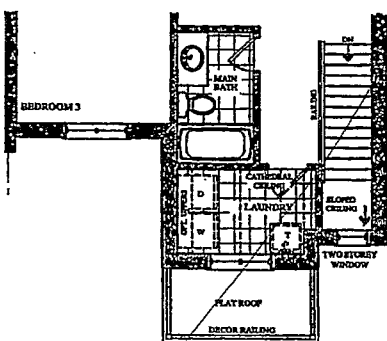

PART. SECOND FLOOR PLAN
ELEV. 'B'

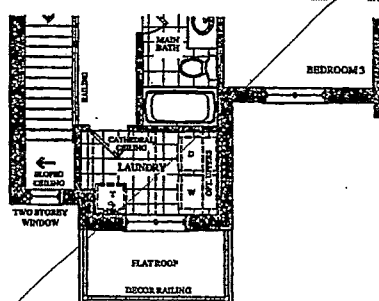

PART. SECOND FLOOR PLAN
ELEV. 'C'

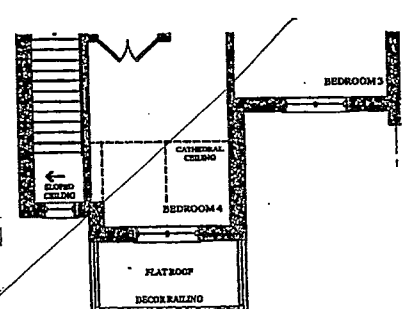

PART. OPT. 4 BED SECOND FLOOR PLAN
ELEV. 'C'

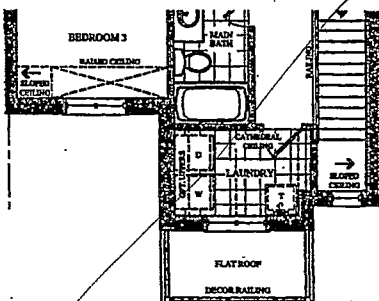

PART. SECOND FLOOR PLAN
ELEV. 'D'

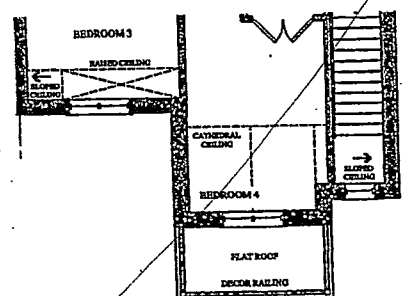

PART. OPT. 4 BED SECOND FLOOR PLAN

BE2-58L
JUNE 22 2017
BE2-58L
MARCH 6 2018

The
Berlio
SEMI SERIES

→ Elevation A • 2,047 sq.ft.
Elevation B • 2,037 sq.ft.
Elevation C • 2,037 sq.ft.
Elevation D • 2,047 sq.ft.

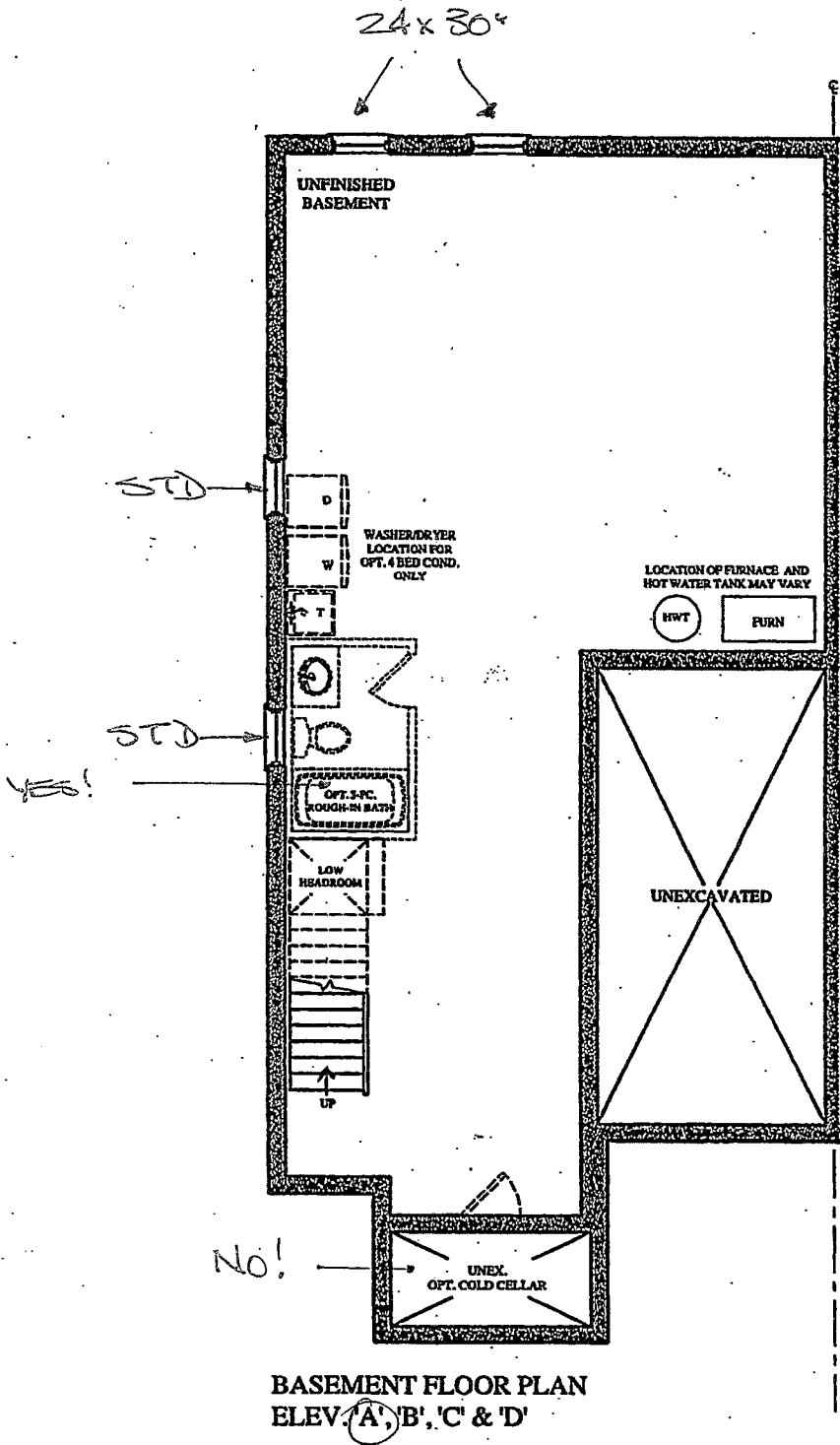

Prices, figures, illustrations, sizes, features and finishes are subject to change without notice. Areas and dimensions are approximate and actual usable floor space may vary from the stated area. Layout may be reverse of the unit purchased. E. & O.E.

GOLDPARK
WORTH MOR

CORTINA
KITCHENS INC.

70 Regina Road, Woodbridge, Ontario L4L 6L6
Tel: 905-284-6484 Fax: 905-284-0884
www.CortinaKitchens.com

BEZ-58L
MARCH 6 2018



QUOTATION

Date: 06/23/16

Trade Name: Gold Park Homes

Site location: Brampton

Model: SD-6

Address:

Project: Encore

Phase:

This layout has been explained to the purchaser by Cortina Kitchens Inc. and is understood by the purchaser.

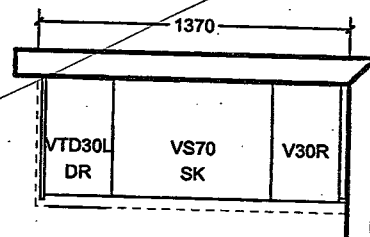
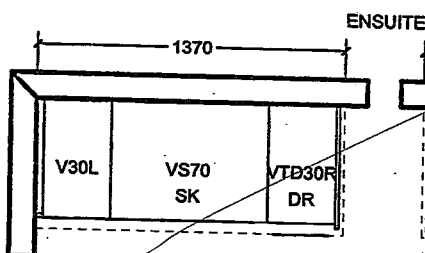
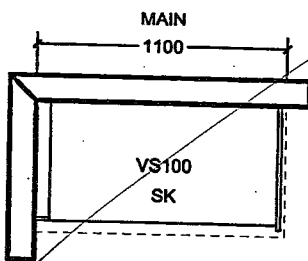
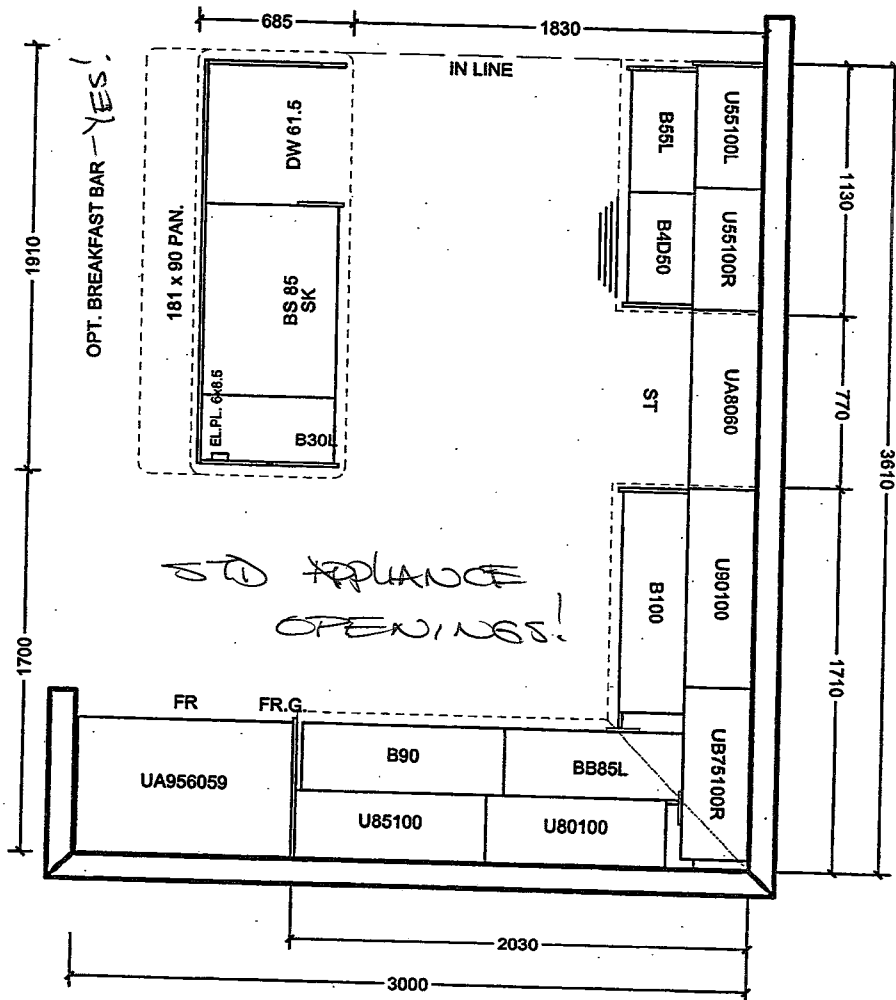

OPT. SECOND FLOOR 4 B.R.

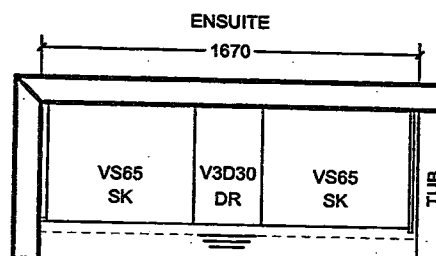
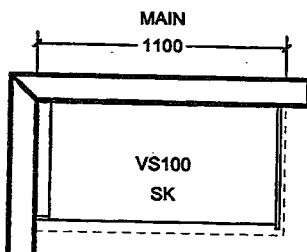

All prices subject to confirmation from head office.
This quotation is subject to the terms & conditions set out
In Cortina's Agreement of Purchase and Sale

All agreements are contingent upon strikes, accidents, and delay beyond our control.
Please provide our installer with template for sinkholes or \$150.00 will be charged for callback.

ACCEPTED DATE: _____

CUSTOMER SIGNATURE

SALESPERSON SIGNATURE

CORTINA HEAD OFFICE APPROVAL

ITEM A. Wood grain and colour are characteristics of the product, we cannot guarantee that such grain and colour will always match
ITEM B. Cortina Kitchens reserves the right to alter dimensions and make technical changes without notice.

REZ - 58L
MAR 6 2018

CSI-6

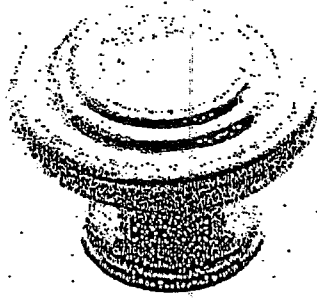

CSI-10

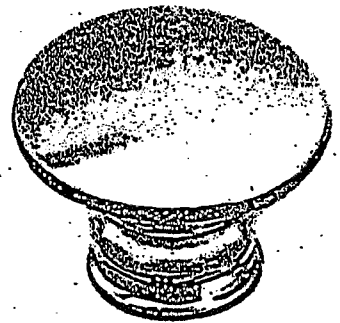

CSI-14

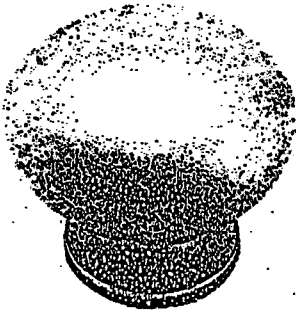

CSI-16

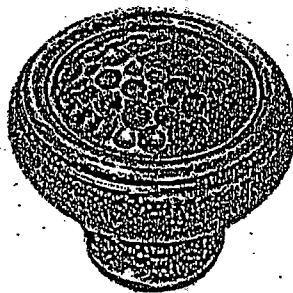

CSI-18

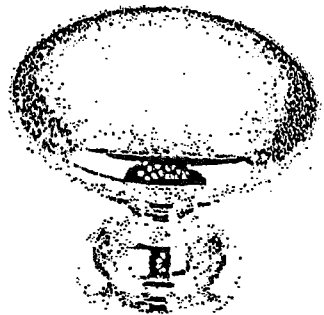

CSI-19



CSI-20

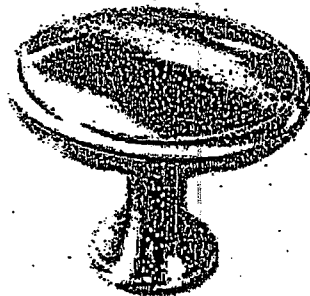

CSI-21



CSI-22

KITCHEN

BATHROOMS

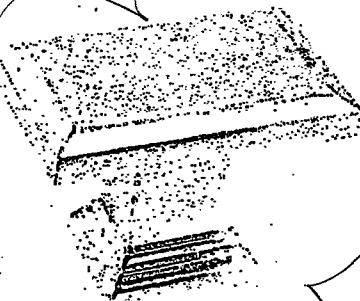

CSI-23



CSI-24

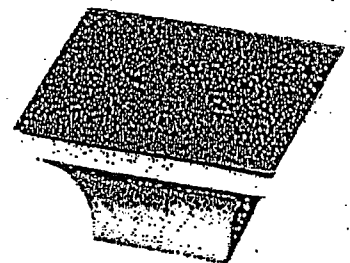

CSI-25

***NOTES:**

- IMAGES ARE FOR QUICK REFERENCE PURPOSES ONLY
- ACTUAL SIZES AND FINISHES AS PER HARDWARE SAMPLE BOARD PROVIDED TO DECOR CENTRE

GOLDPARK

WORTH MORE™



Granite, Marble,
Engineered Surfaces

- Standard 2CM & 3CM
- ⊖ Upgrade 1 2CM & 3CM
- ⊗ Upgrade 1 4 CM
- ⊕ Upgrade 2

20mm (3/4") Profiles

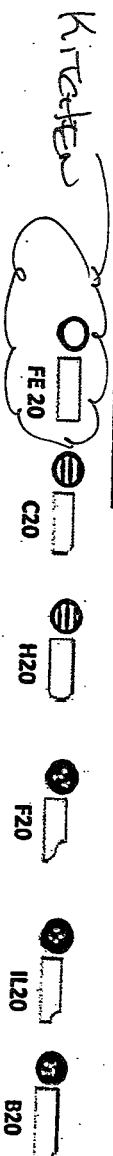

30mm (1 1/4") Profiles

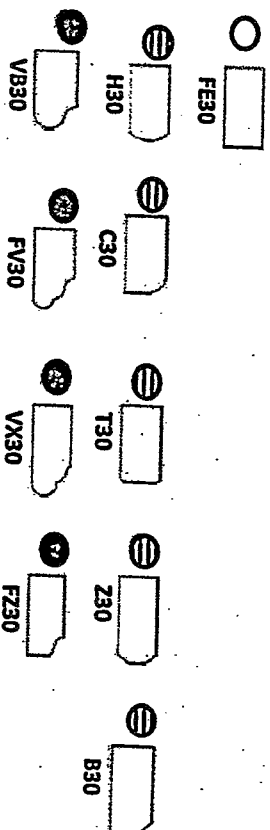

40mm (1 1/2") Profiles

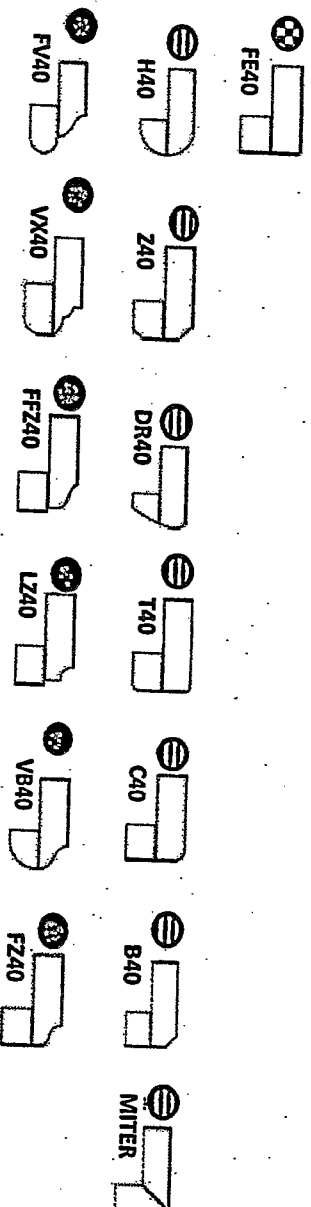

Note: All colours may not be available in 30mm at time ordered. Vendor reserves the right to use 40 mm edges (by lamination process).

*Mitre edge is available in Upgrade 1 for an overall thickness of 2". All other Mitre edge options will be an Upgrade 2 Edge.

BE2-586
March 6 2018

Jaspa Painting & Decorating Inc.

75002 Martin Grove Road, Woodbridge, ON L8L 8C9
T/ 905-850-4096 F/ 905-851-1622

INFORMATION – STAINED OAK RAILING, PICKETS, STAIRS & NOSINGS

Builder: GOLD PARK Project: ENCORE 2 Lot #: 58L

All oak railings, pickets, stairs and nosings are stained after installation, on-site, with an alkyd based wiping stain. In addition to staining, 2 coats of clear satin varnish are applied. **PLEASE NOTE** that the stain colour samples provided to the décor centre are not hardwood flooring colour matches and are formulated to coordinate with and/or compliment the factory finished hardwood floors offered by the builder. Oak railings, pickets, stairs and nosings will vary from our stain samples as a result of the many variables that can affect the outcome of a stain colour. Factors such as density, age, red or white oak colour, grain pattern and the uniqueness of each piece of wood, as well as the on-site temperature and humidity levels during application, can result in a wide variation of stain colour and tone on the finished product.

I am well informed of this information, and agree to purchase the above.

Purchaser:  Date: MARCH 6 2018

Jaspa Painting & Decorating Inc. must receive a signed copy of this form prior to the application of any stain.

Gold Park Homes Décor

GOLD PARK
WORTH MORE™

Centre Disclaimers

Through years of doing business, we at Gold Park Homes have encountered issues beyond our control. The following disclaimers apply to all instances of Purchaser's Extras forms and all Interior Colour Scheme forms.

FIREPLACES

Fireplace Marble: Due to the many variables that can affect the pattern and/or design, frequently the marble installed on the fireplace will not be identical to the samples. We will make every attempt to come as close to the samples as possible, but cannot be responsible for results which differ from the samples.

CERAMIC FLOOR TILE

Many variables including variegation can affect tile colour, pattern and/or design which mean installed tiles may not be identical to the samples. We will make every attempt to come as close as possible, but cannot be responsible for results which differ from the samples.

HARDWOOD FLOORING

The purchaser is advised that cupping and shrinkage are characteristics of hardwood flooring normally appearing after installation, especially when humidity levels are not regulated, and no warranty is provided by the flooring supplier with respect to such cupping and shrinkage. Furthermore, hardwood floors may also heave and warp when located at or close to entrance points of the home, where rain could make its way to the flooring. The vendor agrees to install any hardwood flooring ordered by the purchaser in a good and workmanlike manner, but shall not be responsible for, and is hereby released by the purchaser from responsibility and liability for cupping, shrinkage, heaving and warping of hardwood flooring in the above mentioned circumstances.

STAIRCASE VS FLOORING

WOOD SPECIES DIFFERENCE

The purchaser is aware and therefore accepts and acknowledges that the wood species of the staircase and flooring chosen do not match. This difference might result in an undesirable colour variance.

The purchaser is aware and therefore accepts and acknowledges that though the flooring is of the same species as the staircase the difference in product finishing may result in a stain colour variance.

The purchaser agrees that the vendor is to be exempt from any and all claims by the purchaser regarding this colour variance.

RAILINGS

All railings, pickets, posts, nosing's and stairs come from solid wood and veneered wood materials sourced from multiple locations and sources. As such there will be variations in grains and shades between the various natural components beyond our control. Due to this variance in material, all components will stain with colour or natural finish differently.

Iron pickets are wrought in nature and depending on the manufacturing process will have differences from picket to picket which is normal. Also the finish of the iron pickets is of a powder coated nature. This process can produce minor colour variations or tones. Furthermore, the assembly of the metal pickets can develop a natural rattle over time from vibration in the railing. Minor rattling is normal and is a part of the wrought iron picket assembly.

HOUSE EXTERIORS

Variations in subcontractors across different sites and varying site conditions may result in house exteriors that differ from the artist renderings. We cannot be responsible for results which differ from the artists renderings of elevations.

PLASTER MOULDINGS AND MEDALLIONS

Plaster mouldings will not be installed in open to above areas or areas with 2 storey elements.

STAIN COLOURS

Due to the many variables that can affect the outcome of a stain colour on wood, staircases, railings, and fireplaces, the colour may not be identical to samples. Factors such as density, age, humidity, air temperature, and the uniqueness of each piece of wood can result in wide variations in darkness or lightness. We will make every attempt to come as close to the sample as possible, but cannot be responsible for results which differ from the samples.

Stain on pre-finished hardwood floors will not be an exact match to the stain colours available on stairs, pickets and rails. The purchaser is responsible for choosing the stain on these areas to their satisfaction.

IN-WALL CONDUIT FOR AUDIO/VIDEO CABLES

It is important to note that due to the variation in framing requirements in different parts of your home, conduit lengths and routing can vary. In virtually all instances of ground floor installation (I.e. above a fireplace), conduit will first travel down into the basement below the floor joists, over to the termination point and back up into the main floor. As a result, it is best to measure the length of the conduit after occupancy with a "pull wire" before



purchasing your cables. For above-fireplace installations, the conduit wall plate will be installed approximately 10" above the Fireplace Mantle, unless otherwise specified in the Construction Summary.

APPLIANCE SPECIFICATIONS

All appliance openings are set to builder's standard openings. Please advise Décor Centre at time of your structural appointment if custom sizing of cabinets is required for any built - in appliances. The purchaser is responsible for costs and fees associated with changes to pre-manufactured kitchens made subsequent to colour appointments.

Purchaser accepts & acknowledges that in order to accommodate upgraded appliances, all appliance specifications should be provided at the time of their structural appointment, should this not occur they must be provided to the Décor Center within one (1) week of completion of structural chart. Failure to do so may result in the need to revert to the standard appliance openings or in a delay in construction of your dwelling, as well as a cost of \$500 to re-open your structural file should changes be required. As a result we may be forced to extend the closing of your transaction. Due to failure to complete the above-mentioned selections and at no fault of our own, we reserve our right to hold you responsible for this delayed closing, including charging extra administration cost and interest on the balance due on closing.

 Purchasers Accept Standard Appliance Openings (unless otherwise specified):

Fridge - 37-1/2"W x 73-1/2" High Approx.

Range - 30-1/2"D x 31-1/2"W Approx.

Dishwasher - 24" W Approx.

DELETION OF HOODFAN & CABINETS ABOVE STOVE:

The purchasers are aware that in requesting NOT TO INSTALL builder's standard hood fan and standard cabinets above stove they will receive NO STANDARD HOOD FAN and NO CREDIT. Purchasers are installing their own hood fan after closing and accept that it may waive any warranty associated with such a change.

Purchasers accept and acknowledge that the exhaust fan duct hole may be off-centered with the stove in the kitchen due to purchasers installing their own hood fan after closing. The vendor is exempt from adjusting such openings for the purchasers range hood.

ELECTRICAL FOR APPLIANCES

Pricing is subject to change based on the appliance specifications provided. Purchasers should provide proper appliance specifications and cut-out sheets in order for Gold Park to price extras accordingly.

KITCHEN CABINETS

The kitchen you order/purchase will undoubtedly contain slight colour variations. The degree of these variations is virtually impossible to determine before the kitchen is installed in its intended location. The amount of and type of lighting will also affect various highlights in the finish. Note: No two pieces of wood are identical. Variations in colour tone and grain patterns make a perfect colour match virtually impossible. It is generally agreed that these variations add to the natural beauty of a wood kitchen.

STAIN

Charcoal is a spray stain applied to Oak and Maple products with several characteristics that are important to be aware of when purchasing this product.

1. Shadow lines may be visible at the interior profile edges of a door or drawer front. If movement occurs shadow lines may increase or decrease, depending on the style and/or size of a door or drawer front.
2. Variation and unevenness may be visible in the finish.
3. Hairline cracks at the joints are created over time due to the nature of natural wood, caused by usage, humidity**, or dryness. They tend to be more visible to darker stains, than lighter wood stains.

** Relative humidity is recommended to be between 45% and 55%. Please refer to Cortina Kitchens "Cleaning, Care, Maintenance, & Warranty Information" guide.

Please be advised that Cortina Kitchens will not replace doors and/or parts that exhibit the above characteristics associated with this finish. These characteristics are not avoidable and are a result of the natural characteristics of wood and wood veneer, and the characteristics of darker stains on wood. The Charcoal stain is not available on doors in Group IV, Group IVA, Group V and Group VA.

Cortina Kitchens offers a wide variety of finishes, applied to oak and maple products. The subject finishes include the spray stains Cocoa, Espresso, Graphite as well as wiping stain Ebony.

Due to the very dark stains applied on natural maple and oak doors and joints, several characteristics are important to be noted when purchasing these products.

1. Shadow lines may be visible at the interior profile edges of a door or drawer front. If movement occurs shadow lines may increase or decrease, depending on the style and/or size of a door or drawer front.
2. Variation and unevenness may be visible in the finish.
3. Hairline cracks at the joints are created over time due to the nature of natural wood, caused by usage, humidity, or dryness. They tend to be more visible to darker stains, than lighter wood stains.

Please be advised that Cortina Kitchens will not replace doors nor parts that exhibit the above characteristics associated with this finish. These characteristics are not avoidable and are a result of the natural characteristics of wood and wood veneer, and the characteristics of darker stains on wood.



CABINETRY DOOR HARDWARE

Cortina Kitchens' cabinetry doors and drawer fronts will be drilled to accept a standard knob or handle selected from Cortina's hardware boards. This drilling comes standard with the order, and is done ONLY in our shop, not on the job site.

For those not wanting Cortina's hardware drilling, the following applies:

No holes to be drilled on the doors and drawer fronts should be specified in writing on the colour chart and the P.O. If while in production, Cortina Kitchens misses this request, Cortina Kitchens and the Builder will not be held responsible to replace any or all doors and drawer fronts affected, and the customer agrees to accept the product as is. No hardware will be supplied or credited by Cortina Kitchens with this request. No charge will apply for this request.

PVC DOORS

All cabinets with PVC (Thermofoil) Doors come with melamine gables, panels and kick. The doors, crown moulding and light valance are PVC wrapped. Open shelves incorporated in design will only be available with melamine interiors. There will be variations in colour shades between the PVC parts (doors, crown and Light valance) and the melamine parts (open shelves, Gables, Panels and Kick) due to the difference in material.

Furring Panel with crown moulding to the ceiling is not available on all PVC door styles due to subtle variations in colour shades between the PVC parts (moulding) and the melamine parts (furring panel) due to the difference in material. Grain directions in wood grain pattern melamine, vary between the furring panel, crown moulding (horizontal) and the PVC doors (vertical).

GRANITE, MARBLE ENGINEERED SURFACES WAIVER

* Granite and marble are naturally occurring products, and due to the many variables that can affect the pattern, colour and/or design and "pitting" of natural products slabs installed will not be identical to the samples displayed. We will make every attempt to come as close to the samples as possible, but cannot be responsible for results which differ from the samples. Every effort is made to provide granite counter tops as close as possible but the vendor is not responsible for results which differ from the sample displayed. All countertop surfaces may have seems & product pattern & shade can change in areas containing seems.

RESELECTIONS

It is not uncommon for flooring, such as tile, to become discontinued prior to its installation. Therefore it may be necessary to make a reselection of certain materials sometime during the build process. We cannot assure you that another choice approximating your selection will be available.

PLANS

Plans are subject to change without notice. Actual usable floor space may vary from the stated floor area. Layout for kitchen, furnace, HWT and laundry tub may vary from plan. Vertical and horizontal bulkhead, which are not shown on plan, may be required for plumbing and heating runs. E.& O.E.

PLEASE NOTE:

In the event the work on the house has progressed beyond the point where the items covered by these invoices cannot be installed without entailing any unusual expense, then this order is to be cancelled and any deposit paid in connection with the same is to be refunded to the purchaser.

The vendor will undertake to incorporate the work covered by the sales extra in the construction of the house but will not be liable to the purchaser in any way, if for any reason the work covered by the extra is not carried out. In that event, any monies paid in connection with the same shall be returned to the purchaser.

It is understood and agreed that if for any reason whatsoever the transaction of Purchase and Sale is not completed, the total cost of extras ordered are not refundable to the Purchaser(s).

Extras or changes will not be processed unless signed by the Vendor.

These extras may not be amended without the written consent of Gold Park Homes.

The purchaser(s) and the builder acknowledge and agree that this "Purchaser's Extra" form shall not be deemed to be part of the agreement of purchase and sale entered into between them, nor an addendum thereto.

No postdated cheques will be accepted.

No estimates or orders will be accepted once construction has commenced.

Should a refund be requested on any extras purchased, an 80% reimbursement of the purchase price will be given. (a \$50.00 minimum charge and a maximum \$250.00 charge will apply)

Estimates will only be considered when resubmitted on a signed Purchaser Extras form, accompanied by payment in full.

All prices are estimates only and may be subject to change. Should a change in price occur Gold Park Homes reserves the right to request from the purchaser an adjustment of the price or a refund limited to that item.

Purchasers are aware & accept that ANY changes made to upgrades after signing the Purchasers Extra Form are subject to a minimum administration fee of \$500. PLUS a 10% holdback fee.

Purchasers are aware that any request to add a percentage of upgrades from the purchaser's extras form will be processed only after the builder receives approval letter from the bank.



Please be advised that your failure to finalize your structural or colour selections may result in a delay in construction of your dwelling and we may have to extend closing of your transaction. Due to failure to complete the above-mentioned selections and at no fault of us, we reserve our right to hold you responsible for a delayed closing, including charging extra administration cost and interest on the balance due on closing.

Purchaser has attended a Colour appointment at the Decor Centre & has DECLINED any additional upgrades and accepts and acknowledges that there will be no further structural changes/additions/deletions to be made upon signing.

I hereby acknowledge reading and understanding the above copy and will not hold Gold Park Homes responsible for any issues in relation to above.

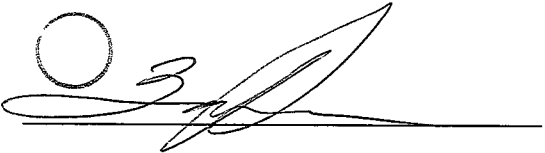
Purchasers Signatures  Date MARCH 6 2018
BEZ-586