

Kleinburg Glen - 15 - 2 - 42-1 Elev.A ROYALTON

CARPET

Inv.1,804	1 - BEDROOM 2 / BEDROOM 3 / BEDROOM 4: UPGRADE CARPET TO CITYVIEW (STANDARD UNDERPAD)
Line26766	Note:
24Mar18 / 4May18	

CENTRAL VAC AND WIRING

Inv.1,570	1 - GREAT ROOM- CONDUIT PIPE - FOR TELEVISION - LOCATE APPROX. 66" AFF ABOVE FIREPLACE, TERMINATING BY CABLE
Line24068	Note:
7Sep17 / 7Sep17	

CERAMIC

Inv.1,804	1 - FOYER / POWDER ROOM / KITCHEN FLOOR TILE: UPGRADE 5 - 24X24"
Line26540	Note:
24Mar18 / 4May18	

Inv.1,804	1 - KITCHEN BACKSPLASH: UPGRADE 4 MARBLE MOSAIC
Line26541	Note: INCLUDES BEHIND HOOD FAN TO CEILING
24Mar18 / 4May18	

Inv.1,804	1 - LAUNDRY ROOM: UPGRADE 4 FLOOR TILE - 12X24" LAID IN STRAIGHT, STACKED PATTERN - SEE PLAN FOR TILE DIRECTION
Line26545	Note:
24Mar18 / 4May18	

Inv.1,804	1 - MASTER ENSUITE: UPGRADE 4 FLOOR TILE
Line26547	Note: 12x24" laid in straight, stacked pattern - see plan for tile direction
24Mar18 / 4May18	

Inv.1,804	1 - MASTER ENSUITE SHOWER WALL/CEILING: UPGRADE 4
Line26548	Note: 12X24" INSTALLED IN HORIZONTAL STACKED PATTERN
24Mar18 / 4May18	

Inv.1,804	1 - ENSUITE 2 FLOOR TILE: UPGRADE 2 - 12X24" LAID IN STRAIGHT, STACKED PATTERN - SEE PLAN FOR TILE DIRECTION
Line26770	Note:
24Mar18 / 4May18	

Inv.1,804	1 - TWIN BATH FLOOR TILE: UPGRADE 2 - 12X24" LAID IN STRAIGHT, STACKED PATTERN - SEE PLAN FOR TILE DIRECTION
Line26771	Note:
24Mar18 / 4May18	

CONCRETE AND DRAIN

Inv.1,570	1 - BACKFLOW PREVENTER VALVE
Line24070	Note:
7Sep17 / 7Sep17	

CROWN MOULDING

Inv.1,719	1 - INSTALL CTR-B07 4 BOX WAFFLE CEILING DETAIL IN DEN- AS PER PLAN PREPARED WITH SITE
Line25599	Note:
24Jan18 / 24Jan18	

Kleinburg Glen - 15 - 2 - 42-1 Elev.A ROYALTON

Inv.1,719	1 - GREAT ROOM: INSTALL CTR-B07 7 BOX WAFFLE CEILING DETAIL IN GREAT ROOM- AS PER PLAN PREPARED WITH SITE
Line25600	Note:
24Jan18 / 24Jan18	

Inv.1,804	1 - FAMILY ROOM: 7 BOX BEAM DETAIL CTR-B07
Line26551	Note:
24Mar18 / 4May18	

DRYWALL

Inv.1,570	1 - SMOOTH CEILINGS - (2 - Story Design) 2ND FLOOR
Line24069	Note:
7Sep17 / 7Sep17	

Inv.1,570	1 - MAIN FLOOR CEILING 10FT, 8FT TALLER INTERIOR DOORS, TALLER FLAT ARCHES, REAR AND FRONT WINDOWS WITH TRANSOM, TALLER KITCHEN CABINETS WITH CROWN AND FURRING PANEL, ADDED STAIRS AND PICKETS
Line24072	Note:
7Sep17 / 7Sep17	

ELECTRICAL

Inv.1,570	1 - GAS LINE ROUGH - MAIN FLOOR - (2 STOREY MODELS) FOR GAS STOVE- INCLUDES 110V PLUG ON SEPARATE CIRCUIT
Line24078	Note:
7Sep17 / 7Sep17	

Inv.1,570	1 - KITCHEN-220V Wall Recepticle on dedicated circuit- FOR FUTURE WALL OVEN AND MICROWAVE COMBO
Line24081	Note:
7Sep17 / 7Sep17	

Inv.1,570	1 - KITCHEN- Under Cabinet Valance strip Lighting - DOES NOT INCLUDE KITCHEN VALANCE-
Line24082	Note:
7Sep17 / 7Sep17	

Inv.1,570	1 - MOVE STANDARD CEILING LIGHT TO ABOVE ISLAND. SEE PLAN FOR LOCATION
Line24083	Note:
7Sep17 / 7Sep17	

Inv.1,570	1 - KITCHEN- ROUGH-IN LIGHT ON EXISTING SWITCH- CAPPED (DOESN'T INLCUDE FIXTURE) USE SAME SWITCH AS STANDARD
Line24084	Note:
7Sep17 / 7Sep17	

Inv.1,719	6 - 6x- POTLIGHTS IN GREAT ROOM ON SEPERATE SWITCH- SEE PLAN FOR LOCATIONS
Line25595	Note:
24Jan18 / 24Jan18	

Inv.1,719	6 - 6X-POTLIGHTS IN DINING ROOM ON SEPERATE SWITCH- AS PER PLAN
Line25596	Note:
24Jan18 / 24Jan18	

Inv.1,719	4 - 4X POTLIGHTS IN BREAKFAST ON SEPERATE SWITCH- SEE PLAN FOR LOCATIONS
Line25597	Note:
24Jan18 / 24Jan18	

Inv.1,719	4 - 4X- POTLIGHTS IN DEN ON SEPERATE SWITCH- DELETE STD - SEE PLAN FOR DETAILS
Line25598	Note:
24Jan18 / 24Jan18	

Kleinburg Glen - 15 - 2 - 42-1 Elev.A ROYALTON

Inv.1,719	1 - GREAT ROOM- Additional Interior Switch FOR POTLIGHTS
Line25601	Note:
24Jan18 / 24Jan18	
Inv.1,719	1 - DINING ROOM- Additional Interior Switch FOR POTLIGHTS
Line25602	Note:
24Jan18 / 24Jan18	
Inv.1,719	1 - BREAKFAST- Additional Interior Switch FOR POTLIGHTS
Line25603	Note:
24Jan18 / 24Jan18	
Inv.1,719	1 - BREAKFAST- Additional Interior Switch FOR POTLIGHTS
Line25604	Note:
24Jan18 / 24Jan18	
Inv.1,719	5 - KITCHEN-5X- POTLIGHTS IN KITCHEN ON SEPERATE SWITCH
Line25605	Note:
24Jan18 / 24Jan18	
Inv.1,719	5 - MAIN HALL- 5X POTLIGHTS IN MAIN HALL ON STD SWITCH
Line25606	Note:
24Jan18 / 24Jan18	
Inv.1,719	3 - LANDINGS-DELETE STD FIXTURES- INSTALL 2X POTLIGHTS- ON UPSTAIRS LANDINGS 1X POLIGHT ON BASEMENT STAIR LANDING - all on std switches
Line25607	Note:
24Jan18 / 24Jan18	
Inv.1,719	1 - POWDER ROOM: DELETE STD WALL FIXTURE AND INSTALL CAPPED FIXTURE IN CEILING USING STD SWITCH
Line25608	Note:
24Jan18 / 24Jan18	
Inv.1,804	1 - KITCHEN: CYCLONE 30" CHIMNEY HOOD FAN #SCB711 STAINLESS
Line26767	Note:
24Mar18 / 4May18	

Exterior Colours

Inv.1,570	1 - EXTERIOR COLOUR PACKAGE # 4
Line24066	Note:
7Sep17 / 7Sep17	

FRAMING

Inv.1,570	1 - MAIN FLOOR CEILING 10FT, 8FT TALLER INTERIOR DOORS, TALLER FLAT ARCHES, REAR AND FRONT WINDOWS WITH TRANSOM, TALLER KITCHEN CABINETS WITH CROWN AND FURRING PANEL, ADDED STAIRS AND PICKETS
Line24071	Note:
7Sep17 / 7Sep17	
Inv.1,570	1 - MAN DOOR GARAGE TO HOUSE - GRADE PERMITS
Line24080	Note:
7Sep17 / 7Sep17	

GRANITE MARBLE QUARTZ

Kleinburg Glen - 15 - 2 - 42-1 Elev.A ROYALTON

Inv.1,804	1 - KITCHEN: UPGRADE 5 COUNTER TOP - 3CM
Line26538	Note:
24Mar18 / 4May18	

Inv.1,804	2 - KITCHEN ISLAND: WATERFALL LEG - 3CM
Line26539	Note:
24Mar18 / 4May18	

Inv.1,804	1 - MASTER ENSUITE: UPGRADE 2 STONE COUNTER TOP
Line26549	Note:
24Mar18 / 4May18	

Inv.1,804	1 - TWIN BATHROOM: UPGRADE 1 STONE COUNTER TOP
Line26554	Note:
24Mar18 / 4May18	

Inv.1,804	1 - ENSUITE 2: UPGRADE 1 STONE COUNTER TOP
Line26555	Note:
24Mar18 / 4May18	

HARDWOOD

Inv.1,804	1 - UPPER HALL and MASTER BEDROOM: UPGRADE 1 HARDWOOD
Line26546	Note:
24Mar18 / 4May18	

HVAC

Inv.1,570	1 - GAS LINE ROUGH - MAIN FLOOR - (2 STOREY MODELS) FOR GAS COOKTOP- INCLUDES 110V PLUG ON SEPARATE CIRCUIT
Line24077	Note:
7Sep17 / 7Sep17	

INTERIOR TRIM AND DOORS

Inv.1,570	1 - MAIN FLOOR CEILING 10FT, 8FT TALLER INTERIOR DOORS, TALLER FLAT ARCHES, REAR AND FRONT WINDOWS WITH TRANSOM, TALLER KITCHEN CABINETS WITH CROWN AND FURRING PANEL, ADDED STAIRS AND PICKETS
Line24073	Note:
7Sep17 / 7Sep17	

KITCHEN AND BATH CABINETRY

Inv.1,570	1 - MAIN FLOOR CEILING 10FT, 8FT TALLER INTERIOR DOORS, TALLER FLAT ARCHES, REAR AND FRONT WINDOWS WITH TRANSOM, TALLER KITCHEN CABINETS WITH CROWN AND FURRING PANEL, ADDED STAIRS AND PICKETS
Line24074	Note:
7Sep17 / 7Sep17	

Inv.1,804	1 - KITCHEN: UPGRADE 4 CABINETRY PROFILE - MDF
Line26529	Note:
24Mar18 / 4May18	

Inv.1,804	2 - KITCHEN: DEEP GABLES FOR OVEN TOWER
Line26531	Note:
24Mar18 / 4May18	

Inv.1,804	1 - KITCHEN: DELETE UPPERS FINISH SIDES OF CABINETS - LEAVE APPROX. 36" FOR FUTURE 30" CHIMNEY-STYLE HOOD FAN
Line26533	Note:
24Mar18 / 4May18	

Kleinburg Glen - 15 - 2 - 42-1 Elev.A ROYALTON

Inv.1,804	1 - KITCHEN: DOUBLE APPLIANCE CABINET WITH DRAWER BELOW
Line26530	Note:
24Mar18 / 4May18	
Inv.1,804	1 - KITCHEN: POTS AND PANS DRAWERS
Line26532	Note:
24Mar18 / 4May18	
Inv.1,804	1 - KITCHEN: WASTE/RECYCLE CABINET
Line26534	Note:
24Mar18 / 4May18	
Inv.1,804	2 - KITCHEN: 2 - TIER SPICE PULL OUT
Line26535	Note:
24Mar18 / 4May18	
Inv.1,804	1 - KITCHEN: UPGRADE HARDWARE
Line26536	Note:
24Mar18 / 4May18	
Inv.1,804	4 - KITCHEN: CLEAR GLASS DOORS
Line26537	Note: STANDARD WHITE INTERIOR
24Mar18 / 4May18	
Inv.1,804	1 - LAUNDRY ROOM: UPPER CABINETS - STANDARD LEVEL
Line26542	Note:
24Mar18 / 4May18	
Inv.1,804	1 - KITCHEN: LIGHT VALANCE
Line26543	Note:
24Mar18 / 4May18	
Inv.1,804	1 - MASTER ENSUITE: UPGRADE 4 PROFILE - MAPLE
Line26768	Note: PRICE INCLUDES PREMIUM STAIN
24Mar18 / 4May18	
Inv.1,804	1 - MASTER ENSUITE: UPGRADE HARDWARE
Line26769	Note:
24Mar18 / 4May18	

PAINT

Inv.1,570	1 - MAIN FLOOR CEILING 10FT, 8FT TALLER INTERIOR DOORS, TALLER FLAT ARCHES, REAR AND FRONT WINDOWS WITH TRANSOM, TALLER KITCHEN CABINETS WITH CROWN AND FURRING PANEL, ADDED STAIRS AND PICKETS
Line24075	Note:
7Sep17 / 7Sep17	
Inv.1,804	1 - MAIN STAIRS: STAIN STAIRS TO MATCH HARDWOOD AS CLOSE AS POSSIBLE
Line26553	Note:
24Mar18 / 4May18	

PLUMBING

Inv.1,804	1 - KITCHEN: UPGRADE KITCHEN SINK BLANCO QUATRUS R15U SUPER SINGLE #401518
Line26544	Note:
24Mar18 / 4May18	

PLUMBING FIXTURES

Kleinburg Glen - 15 - 2 - 42-1 Elev.A ROYALTON

Inv.1,804	2 - MASTER ENSUITE: OVERMOUNT SINKS CONTRAC 'LEXINGTON' #13-0073
Line26550	Note:
24Mar18 / 4May18	

Inv.1,804	1 - ENSUITE 2 - CONTRAC 'CALVIN' OVAL UNDERMOUNT SINK #4220CFY
Line26556	Note:
24Mar18 / 4May18	

Inv.1,804	2 - TWIN BATHROOM: CONTRAC 'CALVIN' OVAL UNDERMOUNT SINK #4220CFY
Line26557	Note:
24Mar18 / 4May18	

Inv.1,804	1 - MAIN STAIRS: EUROLINE 1 + V GROOVE
Line26765	Note: PRICE ON PE.1781
24Mar18 / 4May18	

STAIRS AND RAILINGS

Inv.1,781	1 - MAIN STAIRS - RAILING: EUROLINE 1+ V GROOVE
Line26179	Note:
5Mar18 / 14Mar18	

TRIM AND DOORS

Inv.1,804	1 - THRU OUT: UPGRADE 2 TRIM PACKAGE
Line26772	Note:
24Mar18 / 4May18	

WINDOWS - BASEMENT

Inv.1,570	5 - UPGRADE 5 X BASEMENT WINDOWS - 30" X 16"
Line24067	Note:
7Sep17 / 7Sep17	

WINDOWS AND DOORS

Inv.1,570	1 - MAIN FLOOR CEILING 10FT, 8FT TALLER INTERIOR DOORS, TALLER FLAT ARCHES, REAR AND FRONT WINDOWS WITH TRANSOM, TALLER KITCHEN CABINETS WITH CROWN AND FURRING PANEL, ADDED STAIRS AND PICKETS
Line24076	Note:
7Sep17 / 7Sep17	

Inv.1,570	1 - MAN DOOR GARAGE TO HOUSE - GRADE PERMITS
Line24079	Note:
7Sep17 / 7Sep17	

*** NOTE: This is not an approved document. Document must be locked ***

Scheduled Closing Date:

Purchaser: INVENTORY HOME

Property: 15

Telephone Res. / Bus: (905) 760-9595

Project: Kleinburg Glen - Phase 2

Decor Advisor: Yolande Somerville

Model and Elevation: 42-1 Elev.A ROYALTON

Layout Changes: Yes No Sketch Attached: Yes No Exterior Colour Scheme:

1. Cabinetry

	Style and Colour	Counter	Hardware
Kitchen / Breakfast	*Florentine mdf 'white matte'	*C.S. 'Symphony Grey'	*CH-46
Laundry Room	*Varese pvc 'Crystal White'	n/a	cs1-23
Powder Room	n/a	n/a	n/a
Twin Bathroom	*Varese pvc 'Crystal White'	*Marble 'Bianco Carrara'	cs1-24
Master Ensuite Bathroom	*Windsor maple 'Graphite'	*C.S. 'Ice Snow'	*CH-48
Second Ensuite Bathroom (If Applicable)	*Varese pvc 'Crystal White'	*Marble 'Bianco Carrara'	cs1-24

Comment

2. Floor Tile

	Selection
Entrance Vestibule	*24x24" Carrara X polished 'White/Grey'
Main Hall	n/a
Kitchen / Breakfast	*24x24" Carrara X polished 'White/Grey'
Laundry Room	*12x24" Carrara X polished 'White/Grey'
Powder Room	*24x24" Carrara X polished 'White/Grey'
Twin Bathroom	*12x24 New Byzantine 'Azzuro'
Master Ensuite Bathroom	*12x24" Carrara X polished 'White/Grey'
Second Ensuite Bathroom (If Applicable)	*12x24 New Byzantine 'Azzuro'
Lower Landing (If Applicable)	n/a

Comment

3. Wall Tile

	Selection	Listello/Inserts	Describe
Master Ensuite Bathroom		<input type="radio"/> Yes <input checked="" type="radio"/> No	
Tub Deck	n/a	<input type="radio"/> Yes <input checked="" type="radio"/> No	
Shower Stall	*2x6" Vitro slim pol. 'Light Grey'	<input type="radio"/> Yes <input checked="" type="radio"/> No	
Bathroom Walls	n/a	<input type="radio"/> Yes <input checked="" type="radio"/> No	
Second Ensuite Bathroom (If Applicable)	8x10" Weave 'White'	<input type="radio"/> Yes <input checked="" type="radio"/> No	
Twin Bathroom	8x10" Weave 'White'	<input type="radio"/> Yes <input checked="" type="radio"/> No	
Kitchen Backsplash	<input checked="" type="radio"/> Yes <input type="radio"/> No	Backsplash Behind Fridge	<input type="text"/>
Comment	GM.MIL.PRL.HER.BON		

Scheduled Closing Date:

Purchaser: INVENTORY HOME
Telephone Res. / Bus: (905) 760-9595
Decor Advisor: Yolande Somerville

Property: 15
Project: Kleinburg Glen - Phase 2
Model and Elevation: 42-1 Elev.A ROYALTON

4. Plumbing Fixtures

<input type="checkbox"/>	<input type="checkbox"/>	Second Ensuite	<input type="checkbox"/>	Powder Room	<input type="checkbox"/>
Master Ensuite Bathroom	<input type="checkbox"/>	Other Room - Specify	<input type="checkbox"/>	Other Washroom	<input type="checkbox"/>

Comment

Upgraded sinks thru out

5. Hardwood Flooring

	Type and Stain		Type and Stain
Main Hall	*Red Oak smooth 'Graphite'	Upper Landing	n/a
Kitchen / Breakfast	n/a	Upper Hall	*Red Oak smooth 'Graphite'
Living Room	n/a	Master Bedroom	*Red Oak smooth 'Graphite'
Dining Room	*Red Oak smooth 'Graphite'	Bedroom #2	n/a
Family Room	*Red Oak smooth 'Graphite'	Bedroom #3	n/a
Den/Library	*Red Oak smooth 'Graphite'	Bedroom #4	n/a
Entrance Vestibule	n/a	Bedroom #5	n/a
Lower Landing (If Applicable)	n/a	Other Room - Specify	<input type="text"/>

Comment

6. Carpeting

	Upgrade	Description
Ground Floor	<input type="checkbox"/>	<input type="text"/>
Second Floor	<input checked="" type="checkbox"/>	*Cityview 'Ballgown'
<input type="text"/>	<input type="checkbox"/>	<input type="text"/>

Upgrade Underpad	Type	<input type="text"/>	Area	<input type="text"/>
Carpet on Stairs	Capped	<input type="text"/>	Runner - *Upgrade	<input type="text"/>

Comment

Standard Underpad

7. Fireplace

	Living Room			Family Room			Other Room - Specify		
	Purchased	As Per Plan	N/A	Purchased	As Per Plan	N/A	Purchased	As Per Plan	N/A
Fireplace Type	<input type="radio"/>	<input type="radio"/>	<input checked="" type="radio"/>	<input type="radio"/>	<input checked="" type="radio"/>	<input type="radio"/>	<input type="radio"/>	<input type="radio"/>	<input checked="" type="radio"/>
Mantle Type	<input type="text"/>			Standard Gas			<input type="text"/>		
Colour / Stain	<input type="text"/>			Mediterranean			<input type="text"/>		
Surround	<input type="text"/>			Standard			<input type="text"/>		
Hearth	<input type="text"/>			none			<input type="text"/>		
Hearth	<input type="text"/>			Standard			<input type="text"/>		

Comment

Scheduled Closing Date:

Purchaser: INVENTORY HOME
Telephone Res. / Bus: (905) 760-9595
Decor Advisor: Yolande Somerville

Property: 15
Project: Kleinburg Glen - Phase 2
Model and Elevation: 42-1 Elev.A ROYALTON

8. Trim Carpentry

Interior Doors Front Door Glass Inserts Door Handles

Interior Trim

Comment

10' on main with 96" doors

9. Plaster Mouldings and Medallions

Standard Throughout Yes No N/A

Entrance Vestibule	<input type="text"/>	<input type="text"/>	Kitchen/Breakfast	<input type="text"/>	<input type="text"/>
Main Hall	<input type="text"/>	<input type="text"/>	Den/Library	<input type="text"/>	<input type="text"/>
Living Room	<input type="text"/>	<input type="text"/>	Lower Landing	<input type="text"/>	<input type="text"/>
Dining Room	<input type="text"/>	<input type="text"/>	Other Room - Specify	<input type="text"/>	<input type="text"/>
Family Room	<input type="text" value="*CTR-B07"/>	<input type="text"/>		<input type="text"/>	<input type="text"/>

Comment

10. Railings and Spindles

Railing Package
Railing Colour
Stringer / Riser

Spindle Colour
Treads
Oak Stairs Yes No N/A

Comment

11. Wall Paint / Ceilings

Throughout Finished Areas

Trim Paint

Smooth Ceilings

Ground Floor
Second Floor

Note

Comment

Scheduled Closing Date:

Purchaser: INVENTORY HOME

Property: 15

Telephone Res. / Bus: (905) 760-9595

Project: Kleinburg Glen - Phase 2

Decor Advisor: Yolande Somerville

Model and Elevation: 42-1 Elev.A ROYALTON

12. Electrical

Hood Fan White Stainless N/A

Above Kitchen Cabinet Light Yes No

Below Kitchen Cabinet Light Yes No

Standard Appliances

Over The Range Microwave

Chimney Style Fan

Comment

13. Heating and Air Conditioning

Air Conditioning

Gas Provisions Stove

Gas Provisions Dryer

Gas Provisions Barbecue

Comment

14. Additional Comments

15. Disclaimers and Notes

- 1) Colours of all materials are as close as possible to builder's selection, but not necessarily identical due to variances in manufacturing.
- 2) Any extras listed above are null and void unless accompanied by a separate invoice/amendment. Said invoice must be paid in full.
- 3) The Purchaser acknowledges that after Interior Colour Selection form is signed and dated, no further changes will be permitted other than re-selection due to unavailability. _____ Purchaser's Initials
- 4) The Purchaser acknowledges reading and accepting the "Gold Park Homes Decor Centre Disclaimers" form. This document contains other miscellaneous disclaimers.

This Interior Colour Selection is final and approved by:

Signature: _____ Date: _____

Elevation A • 3,016 sq.ft.

Elevation B • 3,043 sq.ft.

KG2-15.

April 6 2018

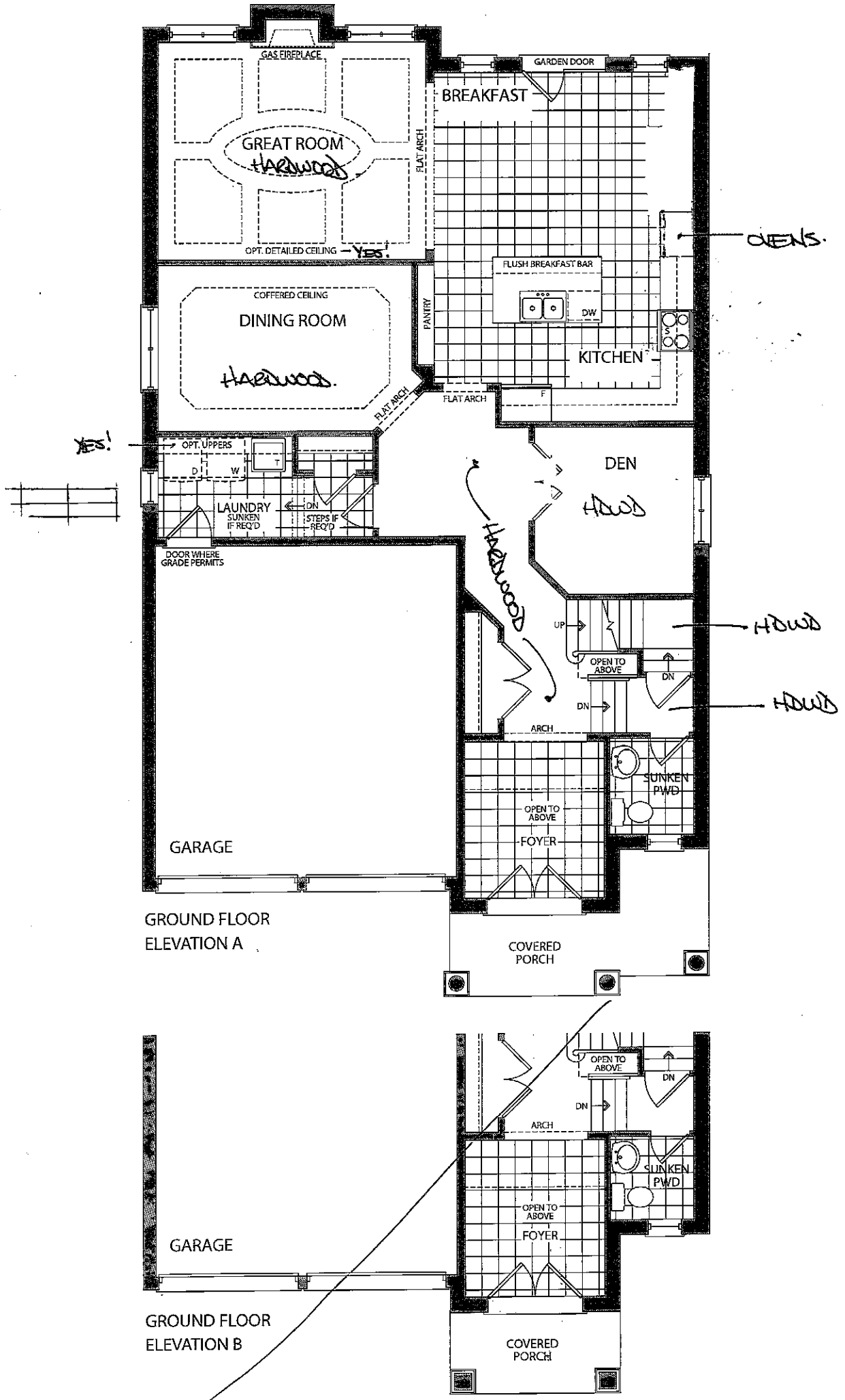

KG-15.
APRIL 10 2018

the *Royalton*

→ Elevation A • 3,016 sq.ft.
Elevation B • 3,043 sq.ft.

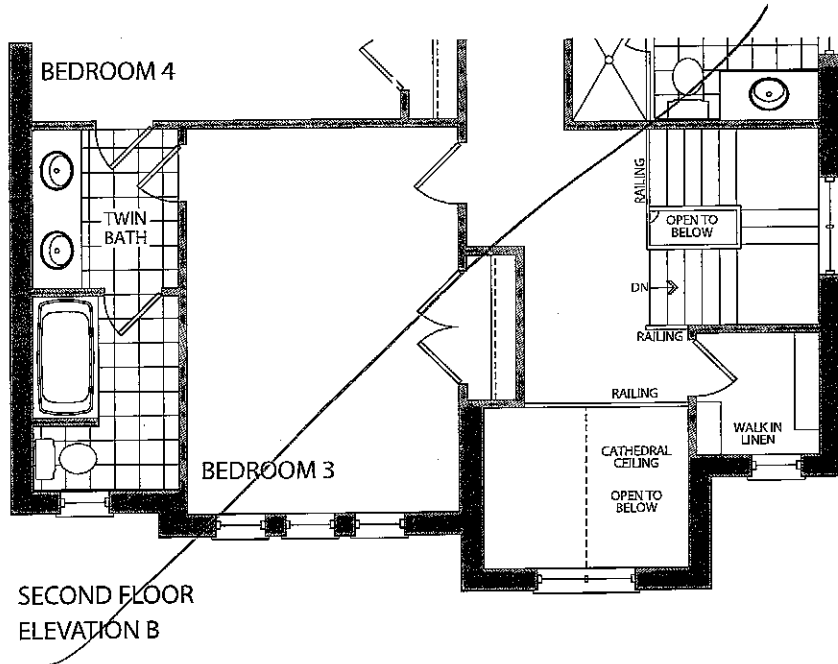
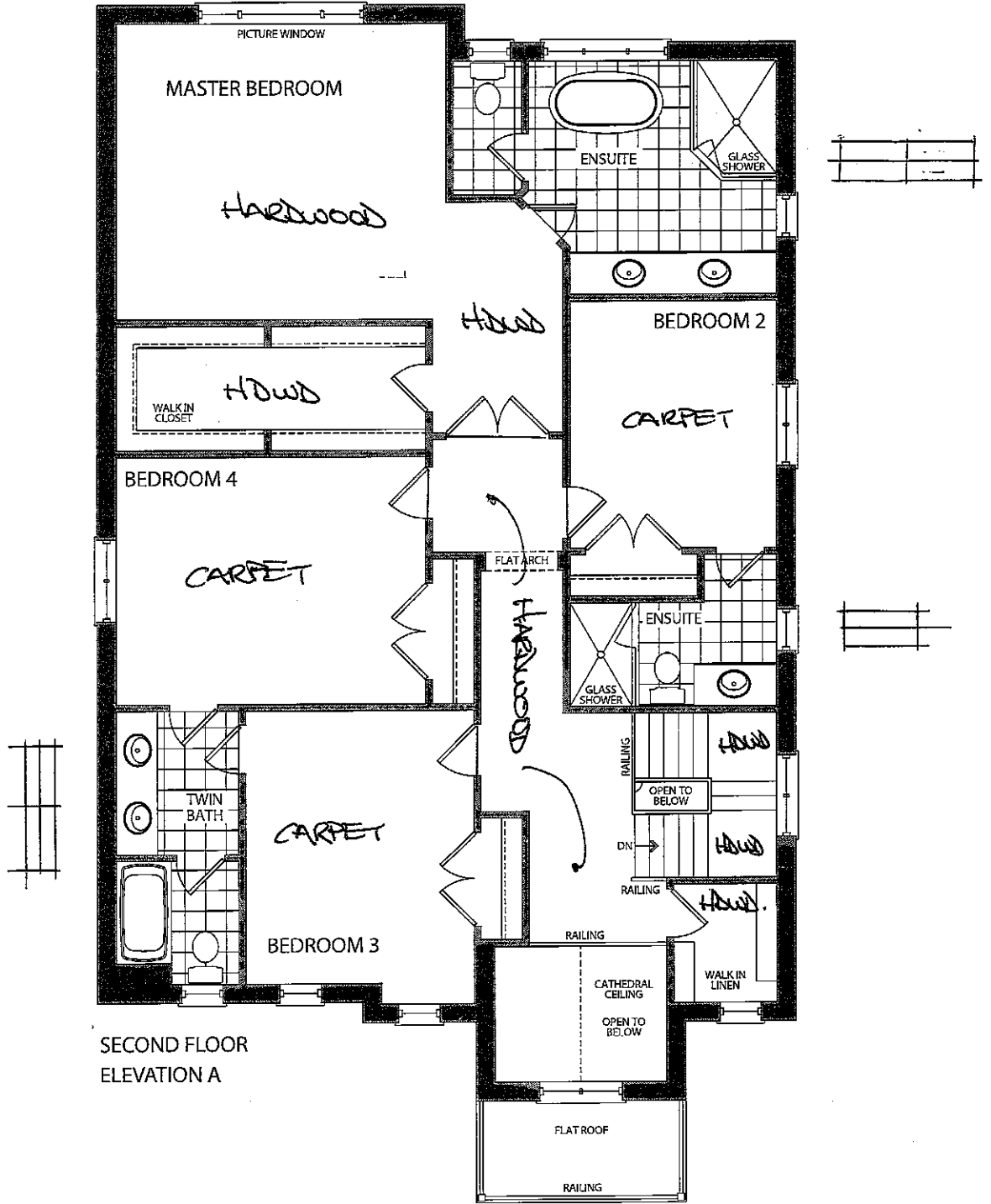

Trade Name: Gold Park Homes	Site location:	Model: 42-1
Address:	Project: Kleinburg Glen	Phase:

This layout has been explained to the purchaser by Cortina Kitchens Inc. and is understood by the purchaser.

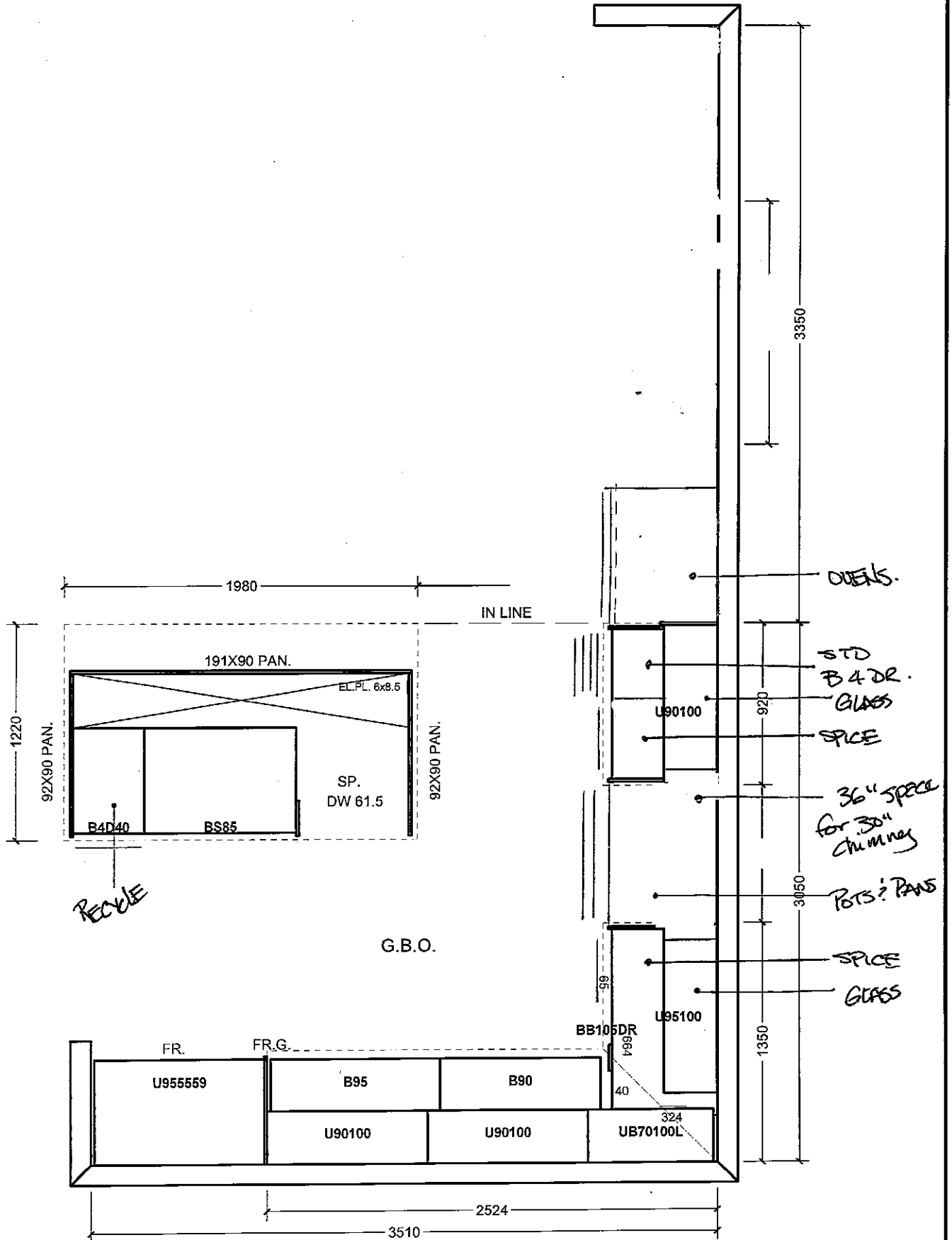

All prices subject to confirmation from head office.
This quotation is subject to the terms & conditions set out

All agreements are contingent upon strikes, accidents, and delays beyond our control.
Please provide our installer with template for sinkholes or \$150.00 will be charged for callback.

ACCEPTED DATE: _____

RG2-15
April 16 2018

Date: 28/06/16

Trade Name: Gold Park Homes	Site location:	Model: 42-1
Address:	Project: Kleinburg Glen	Phase:

This layout has been explained to the purchaser by Cortina Kitchens Inc. and is understood by the purchaser.

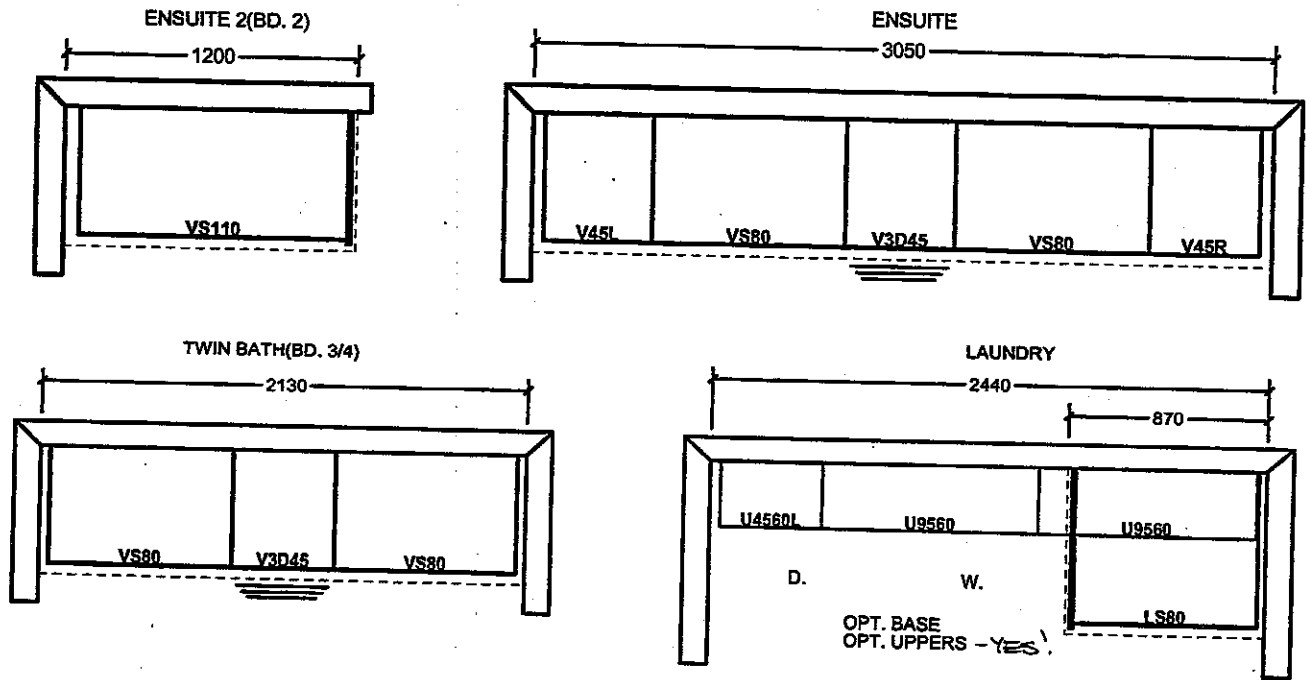

OPT. 5 BED. SECOND FLOOR

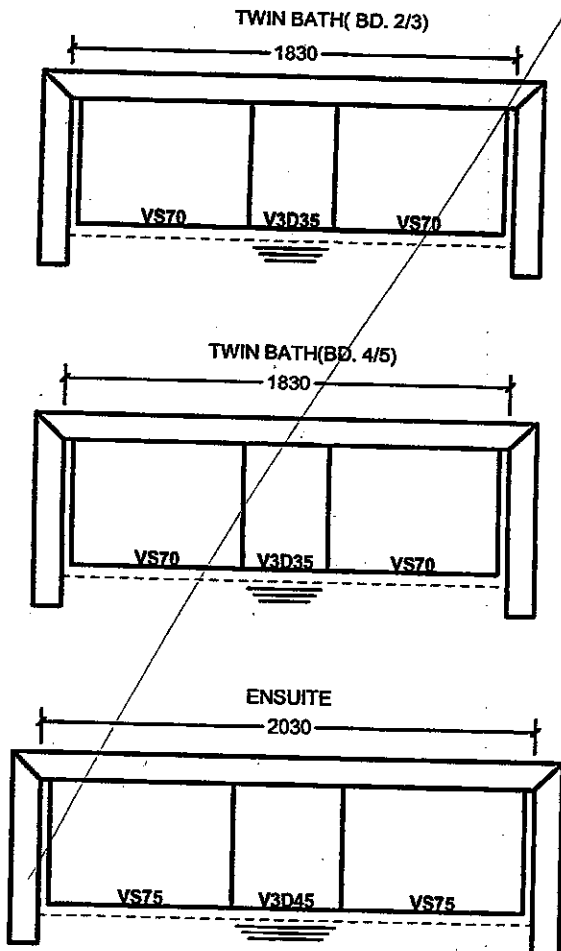

PART OPT. 5 BED. SECOND FLOOR

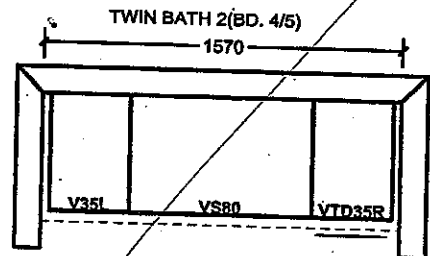

PART SECOND FL. ELV. B

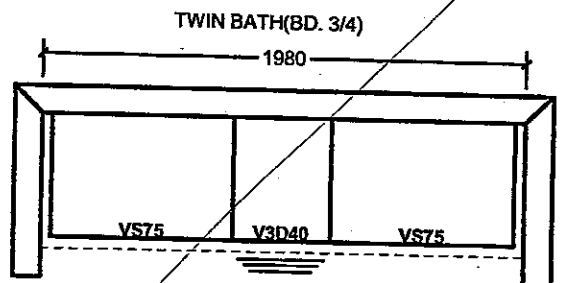

All prices subject to confirmation from head office. This quotation is subject to the terms & conditions set out

ACCEPTED DATE: _____

All agreements are contingent upon strikes, accidents, and delays beyond our control. Please provide our installer with template for sinkholes or \$150.00 will be charged for callback.

Item A. Wood grain and colour are characteristics of the product. We cannot guarantee that such grain and colour will always match.
Item B. Cortina Kitchens Inc. reserves the right to alter dimensions and make technical changes without notice.

GOLDPARK

WORTH MORE



encore
RAMPTON

**Granite, Marble,
Engineered Surfaces**

- Standard 2CM & SCM
- Upgrade 1 2CM & SCM
- Upgrade 1 & CM
- Upgrade 2

KG2-15

April 16 2018

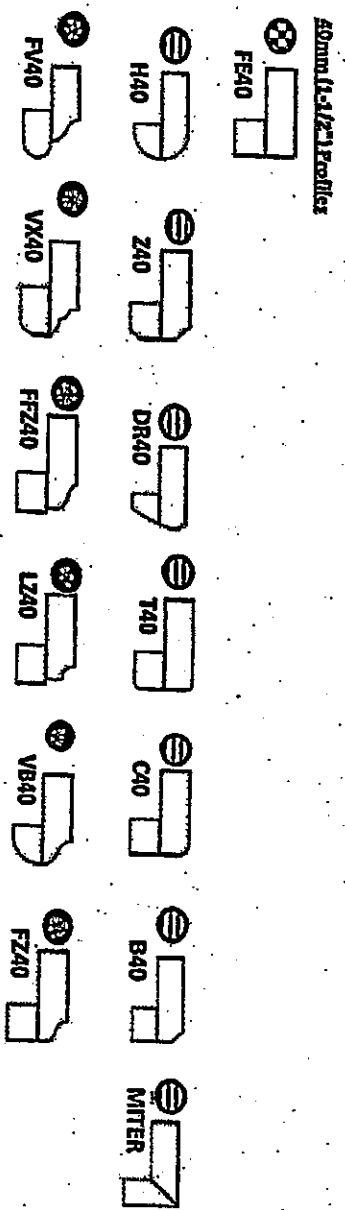
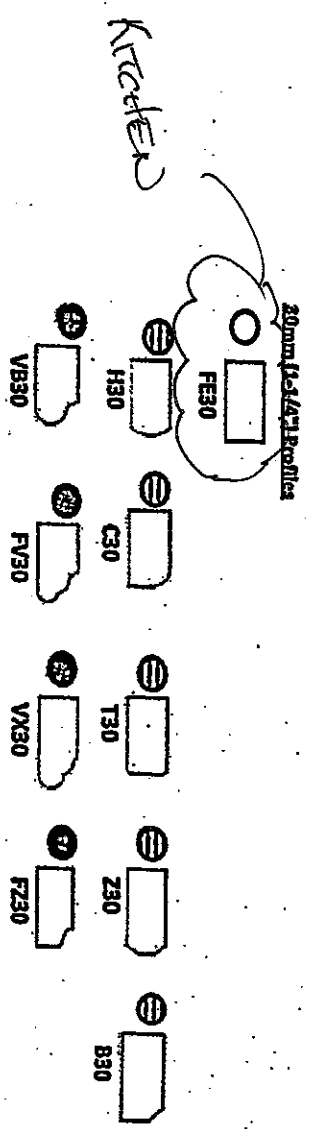
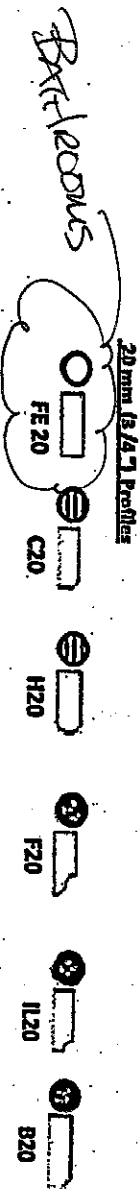

Note: All colours may not be available in 30mm at time ordered. Vendor reserves the right to use 40 mm edges (by lamination process).

*Mitre edge is available in Upgrade 1 for an overall thickness of 2". All other Mitre edge options will be an Upgrade 2 Edge.

CORTINA

MODIFIED: 19/05/16 to

UPGRADE HARDWARE

KG2-15
APRIL 16 2018

UPGRADE HARDWARE



CH-32



CH-38

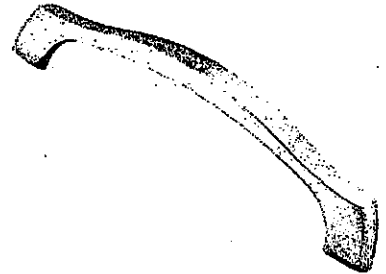

CH-44

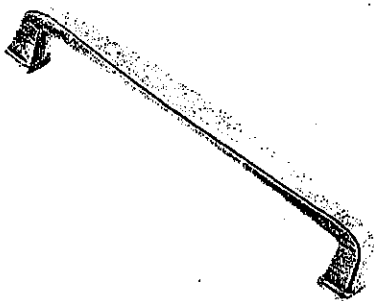

CH-45

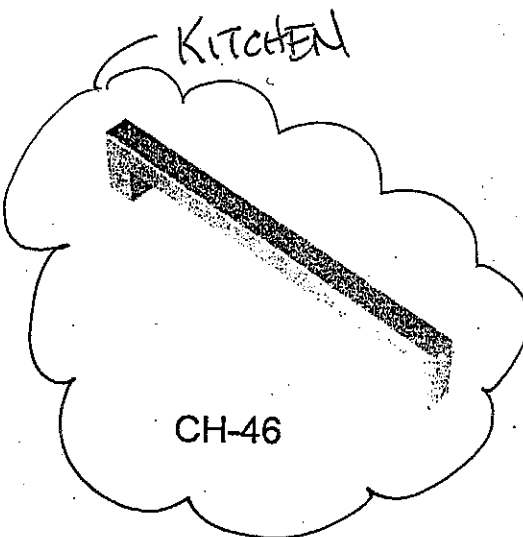

CH-46

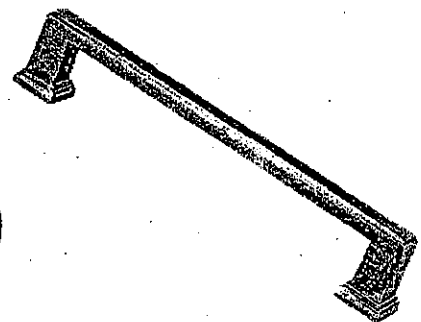

CH-47

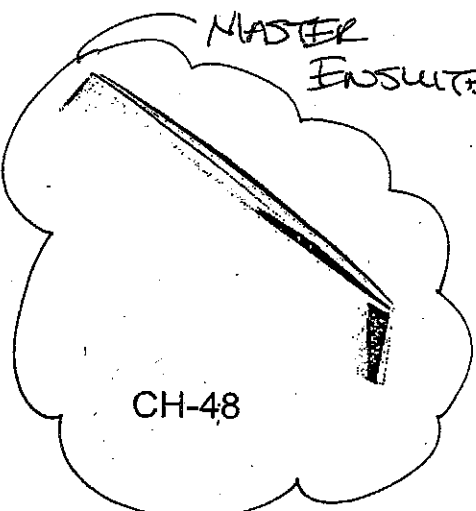

CH-48

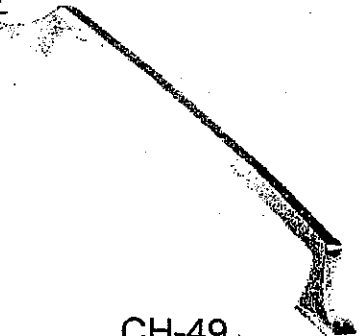

CH-49

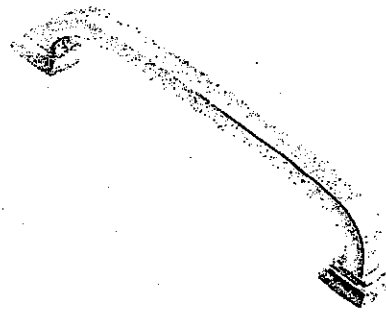

CH-50

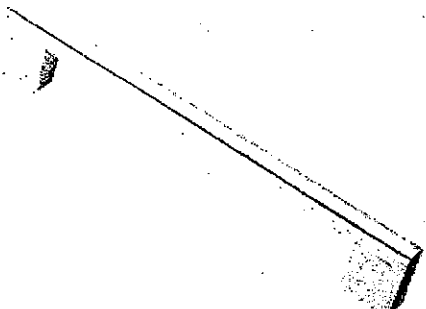

CH-51

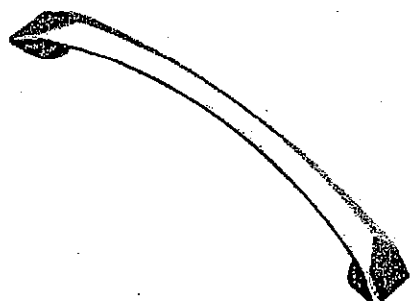

CH-52

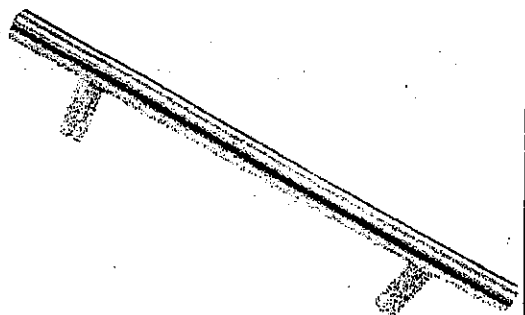

CH-53

***NOTES:**

- IMAGES ARE FOR QUICK REFERENCE PURPOSES ONLY
- ACTUAL SIZES AND FINISHES AS PER HARDWARE SAMPLE BOARD PROVIDED TO DECOR CENTRE

2018/05/16 10:00 AM

CORTINA

STANDARD HARDWARE

KGZ-15
April 16 2018

MODIFIED: 18/05/18

STANDARD HARDWARE



CSI-6



CSI-10



CSI-14



CSI-16

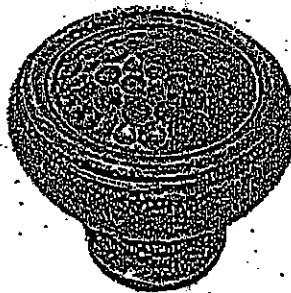

CSI-18

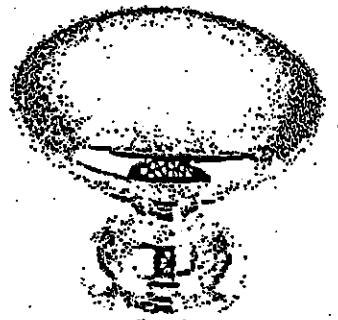

CSI-19



CSI-20

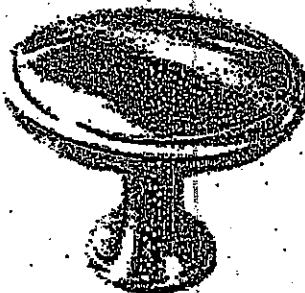

CSI-21



CSI-22

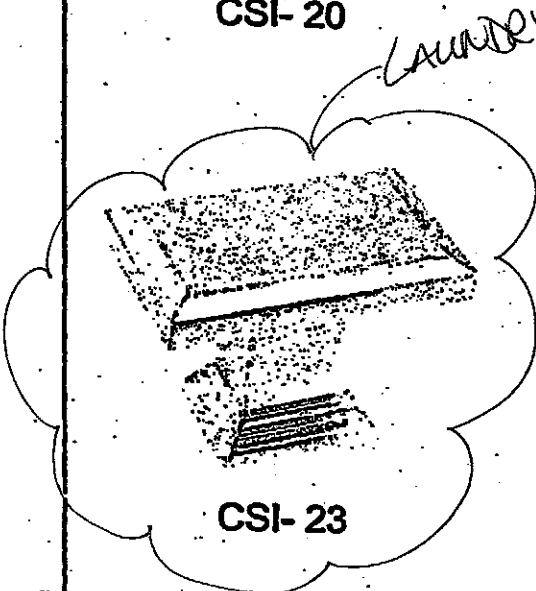

CSI-23

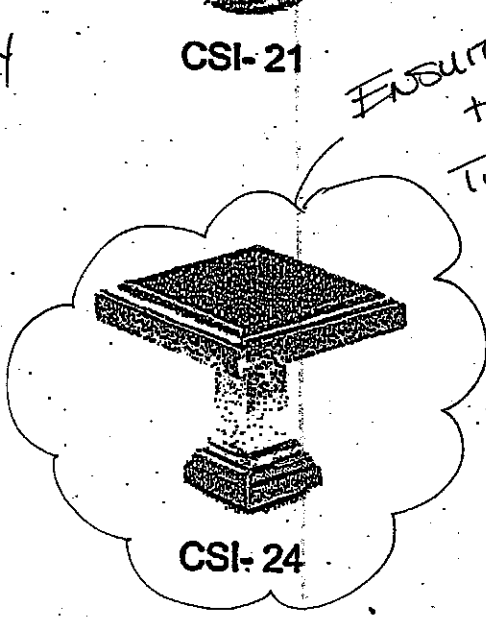

CSI-24

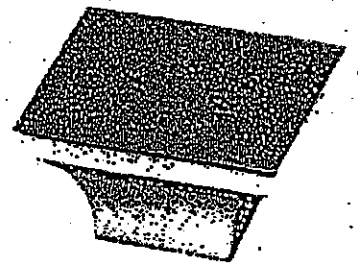

CSI-25

***NOTES:**

- IMAGES ARE FOR QUICK REFERENCE PURPOSES ONLY
- ACTUAL SIZES AND FINISHES AS PER HARDWARE SAMPLE BOARD PROVIDED TO DECOR CENTRE

Blanco Quatrus R15U Super Single kitchen sink #401518 (stainless)

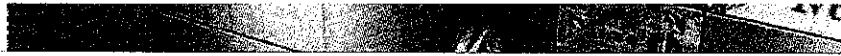

SCB711

Cyclone®
Innovation by Design - Since 1991

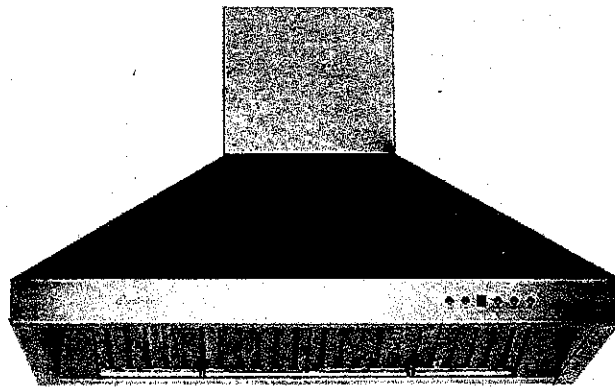

KGZ-15
APRIL 10 2018

Wall Mount

Bold and masculine by design, the professional grade range hood. A three-speed push button control panel gives you complete control of the fan while bright LED lights illuminate the cooking area. Comes with strong, easily removable, dishwasher-safe baffle filters to keep your kitchen clean and to keep you breathing easy.

Specifications

- Air Flow Volume: 650 CFM
- Electrical Connection: 120V/60Hz
- Electrical Consumption: 200 Watts
- Fan Speed: 1299 RPM
- Finishes: Stainless Steel
- Venting: 6" Round - Top Only
- Dimensions: Width: 30"/36"
Height: 50"
Depth: 24"
- Sones: Min. 2
Max. 7

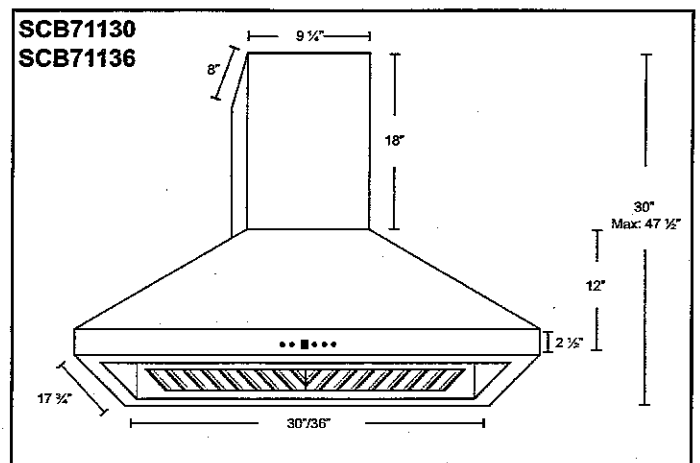

Model	Colour	Venting	Size
→ SCB71130	Stainless Steel	6"	30" ←
SCB71136	Stainless Steel	6"	36"

Contrac 'Lexington' semi-recessed rectangular vessel sink (white) #13-0073



Item to be specified:

Soft White:

- 13-0073-W (Single Hole)
UPC: 721015423751
- 13-0073-4W (4" Center)
UPC: 721015423652
- 13-0073-8W (8" Center)
UPC: 721015424055

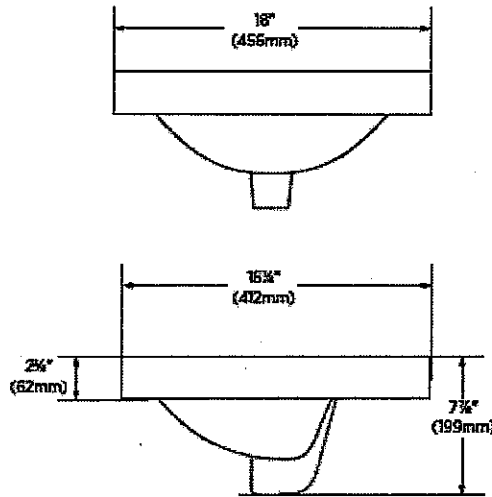
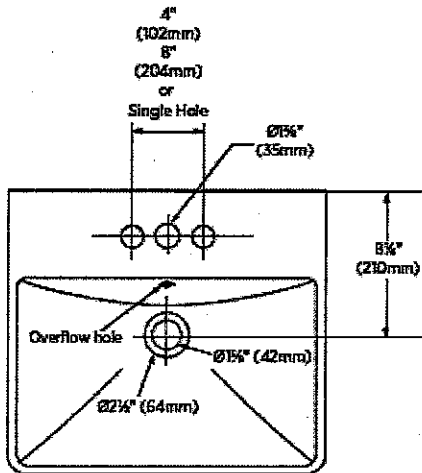

LOT #
15

ROOM:
MASTER ENSUITE

SIGNATURE:

DATE:
APRIL 16 2018

SIGNATURE:

Calvin

19 1/4" Oval
4220CFY Undermount Sink

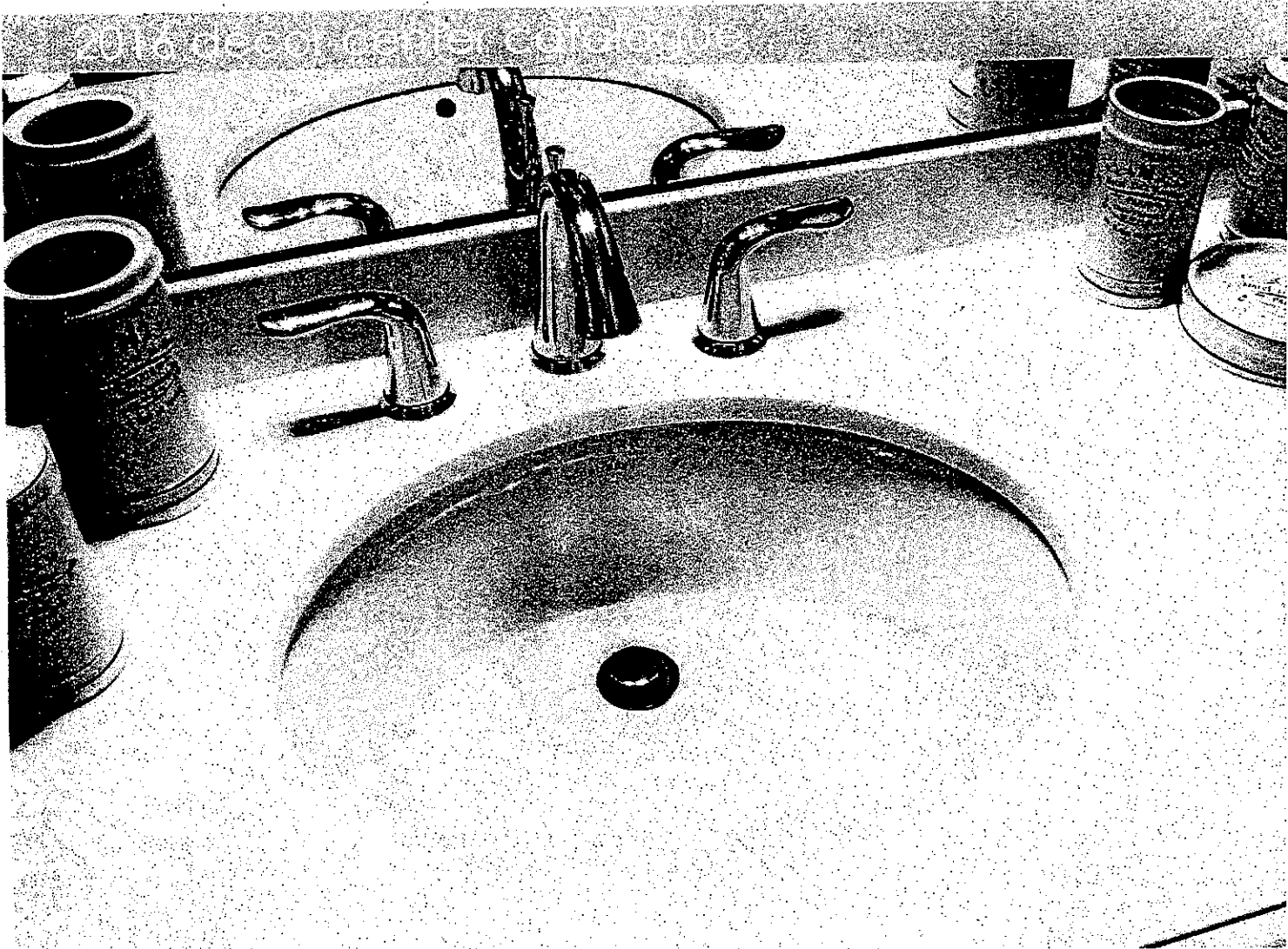

FEATURES

- Vitreous china
- Front overflow hole
- Template and mounting hardware supplied
- Overall dimensions (W x D x H):
(OD): 19 1/4" x 16 1/8" x 7 3/8"
(ID): 17" x 13 3/4" x 5 3/4"

CERTIFICATIONS

- IAPMO cUPC
- ASME A112.19.2 / CSA B45.1-2008

COLOUR

Soft white

LOT #

15

ROOM:

ENS 2 + Twin

SIGNATURE:

DATE:

April 10 2018

SIGNATURE:

GOLD PARK

3,400 sq. ft.

McMurry
RE/MAX

10/11/28

KITCHEN

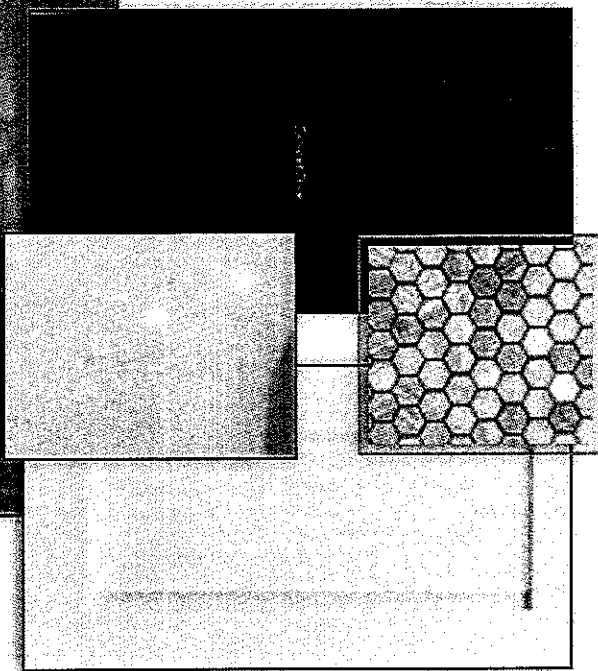

POWDER ROOM

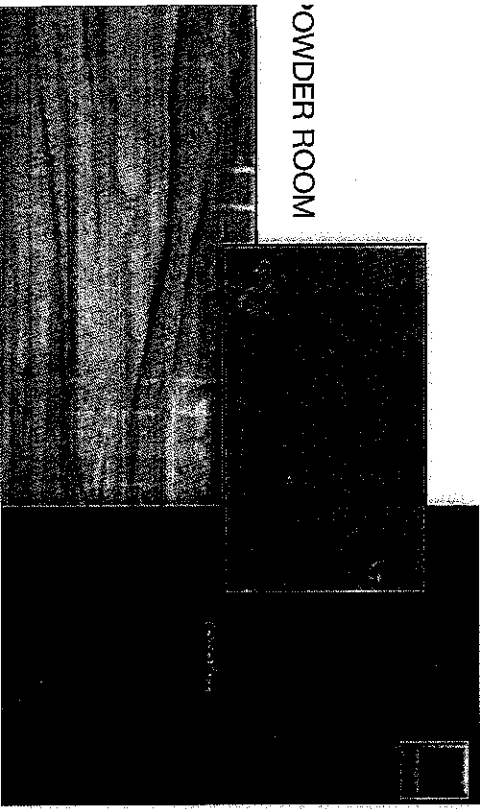

MASTER ENSUITE

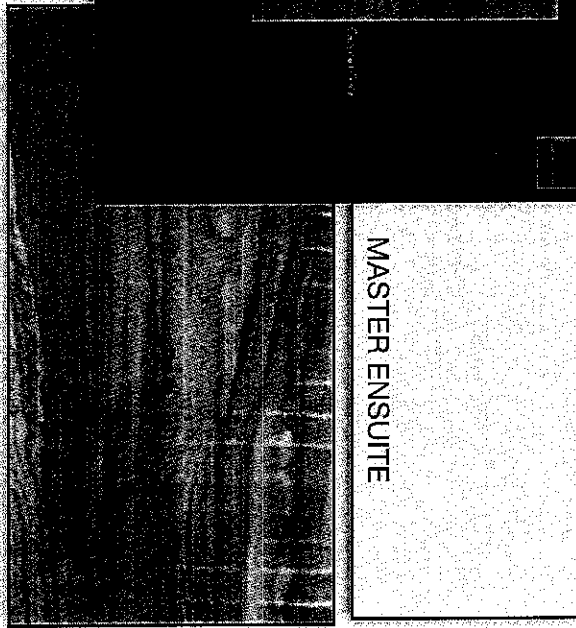

TWIN BATH

