

Kleinburg Glen - BLOCK 51 - 2 - 42-3 Elev.B CARLTON
CERAMIC

Inv.1,824	1 - LAUNDRY ROOM: UPGRADE 2 FLOOR TILE - LAID IN STRAIGHT, STACKED PATTERN SEE PLAN FOR TILE DIRECTION
Line26806	Note:
11Apr18 / 4May18	
Inv.1,824	1 - KITCHEN: UPGRADE 4 BACKSPLASH
Line26785	Note:
11Apr18 / 4May18	
Inv.1,824	1 - FOYER / POWDER / KITCHEN FLOOR TILE: UPGRADE 5 - 24X24" POLISHED
Line26787	Note:
11Apr18 / 4May18	
Inv.1,824	1 - MUDROOM: UPGRADE 4 FLOOR TILE - 12X24" LAID IN STRAIGHT, STACKED PATTERN - SEE PLAN FOR TILE DIRECTION
Line26793	Note:
11Apr18 / 4May18	
Inv.1,824	1 - MASTER ENSUITE: UPGRADE 4 FLOOR TILE - 12X24" LAID IN STRAIGHT, STACKED PATTERN SEE PLAN FOR TILE DIRECTION
Line26798	Note:
11Apr18 / 4May18	
Inv.1,824	1 - MASTER ENSUITE: UPGRADE 1 WALL TILE - 4x12" HORIZONTAL STACKED PATTERN
Line26799	Note:
11Apr18 / 4May18	
Inv.1,824	1 - ENSUITE 2: UPGRADE 2 FLOOR TILE - LAID IN STRAIGHT, STACKED PATTERN SEE PLAN FOR TILE DIRECTION
Line26802	Note:
11Apr18 / 4May18	
Inv.1,824	1 - TWIN BATHROOM: UPGRADE 2 FLOOR TILE - LAID IN STRAIGHT, STACKED PATTERN SEE PLAN FOR TILE DIRECTION
Line26803	Note:
11Apr18 / 4May18	

CONCRETE AND DRAIN

Inv.1,623	1 - BACKFLOW PREVENTER VALVE
Line24505	Note:
25Oct17 / 25Oct17	

CROWN MOULDING

Inv.1,824	1 - FAMILY ROOM: 7-BOX WAFFLE CEILING (UPGRADE TO CTB-702) DIFFERENCE IN PRICE FROM TIC-164 PREVIOUSLY ORDERED
Line26809	Note: **NOT** TIC-164 AS ORDERED ON PE1633
11Apr18 / 4May18	
Inv.1,633	1 - GREAT ROOM: INSTALL WAFFLE CEILING DETAIL AS PER FLOOR PLAN TIC-164
Line25765	Note:
10Nov17 / 2Feb18	
Inv.1,633	1 - DEN: INSTALL WAFFLE CEILING DETAIL AS PER FLOOR PLAN TIC-164
Line25766	Note:
10Nov17 / 2Feb18	

Kleinburg Glen - BLOCK 51 - 2 - 42-3 Elev.B CARLTON

Inv.1,633	1 - DINING ROOM: INSTALL WAFFLE CEILING DETAIL AS PER FLOOR PLAN TIC-164
Line25767	Note:
10Nov17 / 2Feb18	

DRYWALL

Inv.1,623	1 - MAIN FLOOR CEILING 10FT, 8FT TALLER INTERIOR DOORS, TALLER FLAT ARCHES, REAR AND FRONT WINDOWS WITH TRANSOM, TALLER KITCHEN CABINETS WITH CROWN AND FURRING PANEL, ADDED STAIRS AND PICKETS
Line24496	Note:
25Oct17 / 25Oct17	

Inv.1,623	1 - SMOOTH CEILINGS 2ND FLOOR
Line24508	Note:
25Oct17 / 25Oct17	

ELECTRICAL

Inv.1,623	1 - GAS LINE ROUGH - MAIN FLOOR - (2 STOREY MODELS) FOR GAS STOVE- INCLUDES 110V PLUG ON SEPARATE CIRCUIT
Line24502	Note:
25Oct17 / 25Oct17	

Inv.1,623	1 - KITCHEN- FUTURE WALL OVEN- 220V WALL RECEPTICLE ON DEDICATED CIRCUIT
Line24503	Note:
25Oct17 / 25Oct17	

Inv.1,623	1 - UNDER CABINET VALANCE LIGHTING- DOES NOT INCLUDE VALANCE
Line24504	Note:
25Oct17 / 25Oct17	

Inv.1,623	1 - KITCHEN- FOR FUTURE PENDANT LIGHT- Rough-in light on existing switch- Capped (doesn't include fixture)
Line24509	Note:
25Oct17 / 25Oct17	

Inv.1,623	1 - KITCHEN- FOR FUTURE PENDANT LIGHT- Rough-in light on a seperate switch- Capped (doesn't incude fixture)
Line24510	Note:
25Oct17 / 25Oct17	

Inv.1,633	5 - GREAT ROOM: INSTALL 5 POTLIGHTS ON SAME SWITCH- SEPARATE SWITCH FROM STD FIXTURE STANDARD FIXTURE AND SWITCH TO REMAIN SEE FLOORPLAN FOR LOCATIONS
Line25747	Note:
10Nov17 / 2Feb18	

Inv.1,633	1 - GREAT ROOM: Additional Interior Switch FOR 5 POTLIGHTS
Line25748	Note:
10Nov17 / 2Feb18	

Inv.1,633	4 - DEN ROOM: INSTALL 4 POTLIGHTS ON STD SWITCH- DELETE STANDARD FIXTURE STD SWITCH TO REMAIN SEE FLOORPLAN FOR LOCATIONS
Line25749	Note:
10Nov17 / 2Feb18	

Inv.1,633	4 - LIVING ROOM: INSTALL 4 POTLIGHTS ON SAME SWITCH
Line25750	Note:
10Nov17 / 2Feb18	

Kleinburg Glen - BLOCK 51 - 2 - 42-3 Elev.B CARLTON

Inv.1,633	1 - LIVING ROOM: Additional Interior Switch FOR 4 POTLIGHTS
Line25751	Note:
10Nov17 / 2Feb18	
Inv.1,633	4 - DINING ROOM: INSTALL 4 POTLIGHTS ON SAME SWITCH- SEPARATE SWITCH FROM STD FIXTURE
Line25752	STANDARD FIXTURE AND SWITCH TO REMAIN SEE FLOORPLAN FOR LOCATIONS
Note:	
10Nov17 / 2Feb18	
Inv.1,633	1 - DINING ROOM: Additional Interior Switch FOR 4 POTLIGHTS
Line25753	Note:
10Nov17 / 2Feb18	
Inv.1,633	4 - BREAKFAST ROOM: INSTALL 4 POTLIGHTS ON SAME SWITCH- SEPARATE SWITCH FROM STD FIXTURES
Line25754	STANDARD FIXTURES AND SWITCH TO REMAIN SEE FLOORPLAN FOR LOCATIONS
Note:	
10Nov17 / 2Feb18	
Inv.1,633	1 - BREAKFAST ROOM: Additional Interior Switch FOR 4 POTLIGHTS
Line25755	Note:
10Nov17 / 2Feb18	
Inv.1,633	5 - KITCHEN: DELETE STD FIXTURES INSTALL 5 POTLIGHTS ON SAME SWITCH
Line25756	Note:
10Nov17 / 2Feb18	
Inv.1,633	1 - KITCHEN: Additional Interior Switch FOR 5 POTLIGHTS
Line25757	Note:
10Nov17 / 2Feb18	
Inv.1,633	1 - SERVICE HALL: DELETE STD FIXTURES INSTALL 1 POTLIGHTS ON SAME SWITCH
Line25758	Note:
10Nov17 / 2Feb18	
Inv.1,633	2 - POWDER ROOM: DELETE STD WALL FIXTURE INSTALL 2 POTLIGHTS ON SAME STD SWITCH
Line25759	Note:
10Nov17 / 2Feb18	
Inv.1,633	5 - FOYER: INSTALL 5 POTLIGHTS ON SAME SWITCH- SEPARATE SWITCH FROM STD FIXTURE
Line25760	STANDARD FIXTURE AND SWITCH TO REMAIN SEE FLOORPLAN FOR LOCATIONS
Note:	
10Nov17 / 2Feb18	
Inv.1,633	1 - FOYER: Additional Interior Switch FOR 5 POTLIGHTS
Line25761	Note:
10Nov17 / 2Feb18	
Inv.1,633	1 - EXTERIOR SOFFIT LIGHTS: CORNER UPGRADE- 4XPOTLIGHTS IN FRONT SOFFIT 5X POTLIGHTS IN SIDE UPGRADED ELEVATION SOFFIT- SEE ELEVATIONS FOR LOCATIONS
Line25769	Note:
10Nov17 / 2Feb18	

Exterior Colours

Inv.1,623	1 - EXTERIOR COLOUR PACKAGE #9
Line24494	Note:
25Oct17 / 25Oct17	

Kleinburg Glen - BLOCK 51 - 2 - 42-3 Elev.B CARLTON

FRAMING

Inv.1,623	1 - MAIN FLOOR CEILING 10FT, 8FT TALLER INTERIOR DOORS, TALLER FLAT ARCHES, REAR AND FRONT WINDOWS WITH TRANSOM, TALLER KITCHEN CABINETS WITH CROWN AND FURRING PANEL, ADDED STAIRS AND PICKETS
Line24495	Note:
25Oct17 / 25Oct17	
Inv.1,633	1 - GREAT ROOM: COFFER CEILING IN GREAT ROOM FOR FUTURE WAFFLE DETAIL
Line25762	Note:
10Nov17 / 2Feb18	
Inv.1,633	1 - LIVING/DINING ROOM: COFFER CEILING AS PER FLOOR PLAN
Line25763	Note:
10Nov17 / 2Feb18	
Inv.1,633	1 - DEN: COFFER DEN FOR FUTURE WAFFLE
Line25764	Note:
10Nov17 / 2Feb18	

GRANITE MARBLE QUARTZ

Inv.1,824	1 - KITCHEN: COOKTOP CUT OUT
Line26810	Note:
11Apr18 / 4May18	
Inv.1,824	1 - KITCHEN: GROUP 5 COUNTER TOP 3CM
Line26782	Note:
11Apr18 / 4May18	
Inv.1,824	2 - KITCHEN: WATER FALL LEG 3CM
Line26783	Note:
11Apr18 / 4May18	
Inv.1,824	1 - POWDER ROOM: GROUP 5 COUNTER TOP
Line26790	Note:
11Apr18 / 4May18	
Inv.1,824	1 - MASTER ENSUITE: GROUP 3 COUNTER TOP
Line26800	Note:
11Apr18 / 4May18	
Inv.1,824	1 - ENSUITE 2: GROUP 2 COUNTER TOP
Line26804	Note:
11Apr18 / 4May18	
Inv.1,824	1 - TWIN BATH: GROUP 2 COUNTER TOP
Line26805	Note:
11Apr18 / 4May18	

HARDWOOD

Inv.1,824	1 - UPPER HALL: UPGRADE 1 HARDWOOD
Line26794	Note:
11Apr18 / 4May18	

HVAC

Kleinburg Glen - BLOCK 51 - 2 - 42-3 Elev.B CARLTON

Inv.1,623	1 - GAS LINE ROUGH - MAIN FLOOR - (2 STOREY MODELS) FOR GAS STOVE- INCLUDES 110V PLUG ON SEPARATE CIRCUIT
Line24501	Note:
25Oct17 / 25Oct17	

INTERIOR TRIM AND DOORS

Inv.1,623	1 - MAIN FLOOR CEILING 10FT, 8FT TALLER INTERIOR DOORS, TALLER FLAT ARCHES, REAR AND FRONT WINDOWS WITH TRANSOM, TALLER KITCHEN CABINETS WITH CROWN AND FURRING PANEL, ADDED STAIRS AND PICKETS
Line24497	Note:
25Oct17 / 25Oct17	

KITCHEN AND BATH CABINETRY

Inv.1,824	1 - LAUNDRY ROOM: UPPER CABINETS - STANDARD LEVEL
Line26807	Note:
11Apr18 / 4May18	
Inv.1,859	1 - KITCHEN: *DELETE* BUILT-IN DOUBLE WALL OVEN CABINET WITH DRAWER BELOW AND COOKTOP
Line27049	Note: NOT AVAILABLE DUE TO SITE CONDITION
9Jun18 / 11Jun18	
Inv.1,859	1 - KITCHEN: *DELETE* DEEP GABLE AT OVENS
Line27050	Note: NOT REQUIRED
9Jun18 / 11Jun18	
Inv.1,859	1 - KITCHEN: SLIDE-IN STOVE PREP FOR *36" SLIDE IN RANGE* NO SPECS WILL BE PROVIDED
Line27051	Note:
9Jun18 / 11Jun18	
Inv.1,859	1 - KITCHEN: *DELETE* SINGLE DOOR VETRINA
Line27052	Note:
9Jun18 / 11Jun18	
Inv.1,859	1 - KITCHEN: 1 LONG TOP DRAWER IN LIEU OF STANDARD BANK OF DRAWERS (ORIGINALLY PRICED AS 2 TOP DRAWERS)
Line27053	Note:
9Jun18 / 11Jun18	
Inv.1,859	2 - KITCHEN: DELETE 2 TOP DRAWERS FROM INVOICE (USED AS 1 LONG TOP DRAWER IN LIEU OF STANDARD BANK OF DRAWERS)
Line27054	Note:
9Jun18 / 11Jun18	
Inv.1,859	2 - KITCHEN: CLEAR BEVELLED GLASS DOOR
Line27055	Note: LOCATE BESIDE PANTRY
9Jun18 / 11Jun18	
Inv.1,859	1 - KITCHEN: MATCHING INTERIOR - DOUBLE DOOR CABINET
Line27056	Note: LOCATE BESIDE PANTRY
9Jun18 / 11Jun18	
Inv.1,623	1 - MAIN FLOOR CEILING 10FT, 8FT TALLER INTERIOR DOORS, TALLER FLAT ARCHES, REAR AND FRONT WINDOWS WITH TRANSOM, TALLER KITCHEN CABINETS WITH CROWN AND FURRING PANEL, ADDED STAIRS AND PICKETS
Line24498	Note:
25Oct17 / 25Oct17	



CONSTRUCTION SUMMARY

Kleinburg Glen - BLOCK 51 - 2 - 42-3 Elev.B CARLTON

Inv.1,824	1 - KITCHEN: UPGRADE 4 CABINETRY PROFILE MDF
Line26773	Note:
11Apr18 / 4May18	
Inv.1,824	1 - KITCHEN: UPGRADE HARDWARE
Line26774	Note:
11Apr18 / 4May18	
Inv.1,824	1 - KITCHEN: BUILT IN DOUBLE OVEN CABINET WITH DRAWER BELOW AND COOKTOP
Line26775	Note:
11Apr18 / 4May18	
Inv.1,824	1 - KITCHEN: DEEP GABLE AT OVENS
Line26776	Note:
11Apr18 / 4May18	
Inv.1,824	1 - KITCHEN: ADJUST CABINETS FOR 36" COOKTOP
Line26777	Note:
11Apr18 / 4May18	
Inv.1,824	2 - KITCHEN: POTS AND PANS DRAWERS
Line26778	Note:
11Apr18 / 4May18	
Inv.1,824	4 - KITCHEN: TOP DRAWER - LONG TOP DRAWER PRICED AS 2
Line26779	Note:
11Apr18 / 4May18	
Inv.1,824	1 - KITCHEN: VETRINA -DOUBLE DOOR WITH PLAIN CLEAR BLASS AND MATCHING INTERIOR
Line26780	Note:
11Apr18 / 4May18	
Inv.1,824	1 - KITCHEN: VETRINA SINGLE DOOR WITH PLAIN CLEAR GLASS AND MATCHING INTERIOR
Line26781	Note:
11Apr18 / 4May18	
Inv.1,824	1 - KITCHEN: L-SHAPED CANOPY COMPLETE WITH FAN
Line26784	Note:
11Apr18 / 4May18	
Inv.1,824	1 - KITCHEN: RECYCLE CENTER
Line26786	Note:
11Apr18 / 4May18	
Inv.1,824	1 - POWDER ROOM: UPGRADE 2 PROFILE - MAPLE
Line26788	Note: PRICE INCLUDES PREMIUM STAIN
11Apr18 / 4May18	
Inv.1,824	1 - POWDER ROOM: UPGRADE HARDWARE
Line26789	Note:
11Apr18 / 4May18	
Inv.1,824	1 - MASTER ENSUITE: UPGRADE 2 CABINET PROFILE MAPLE
Line26797	Note: PRICE INCLUDES PREMIUM STAIN
11Apr18 / 4May18	

PAINT

Kleinburg Glen - BLOCK 51 - 2 - 42-3 Elev.B CARLTON

Inv.1,824	1 - MAIN STAIRS: STAIN STAIRS TO MATCH HARDWOOD, AS CLOSE AS POSSIBLE
Line26796	Note:
11Apr18 / 4May18	

PLUMBING FIXTURES

Inv.1,824	1 - ENSUITE 2: CONTRAC CALVIN OVAL UNDERMOUNT SINK #4220CFY
Line26815	Note:
11Apr18 / 4May18	

Inv.1,824	2 - TWIN BATH: CONTRAC CALVIN OVAL UNDERMOUNT SINK #4220CFY
Line26816	Note:
11Apr18 / 4May18	

Inv.1,824	1 - POWDER ROOM: CONTRAC CAMDEN SQUARE UNDERMOUNT SINK #4210CHY
Line26791	Note:
11Apr18 / 4May18	

Inv.1,824	1 - KITCHEN: BLANCO SUPER SINGLE UNDERMOUNT SINK #401248
Line26792	Note:
11Apr18 / 4May18	

Inv.1,824	2 - MASTER ENSUITE: CONTRAC LEXINGTON OVERMOUNT SINK #13-0073
Line26801	Note:
11Apr18 / 4May18	

STAIRS AND RAILINGS

Inv.1,623	1 - MAIN FLOOR CEILING 10FT, 8FT TALLER INTERIOR DOORS, TALLER FLAT ARCHES, REAR AND FRONT WINDOWS WITH TRANSOM, TALLER KITCHEN CABINETS WITH CROWN AND FURRING PANEL, ADDED STAIRS AND PICKETS
Line24499	Note:
25Oct17 / 25Oct17	

Inv.1,824	1 - MAIN STAIRS: EUROLINE 2 + V GROOVE
Line26795	Note:
11Apr18 / 4May18	

TRIM AND DOORS

Inv.1,824	1 - MAIN FLOOR: UPGRADE 2 TRIM + 2ND FLOOR: UPGRADE 1 TRIM
Line26808	Note:
11Apr18 / 4May18	

WINDOWS - BASEMENT

Inv.1,623	4 - BASEMENT WINDOWS - UPGRADE EXISTING BASEMENT WINDOW TO 30 INCH X 16 INCH
Line24506	Note:
25Oct17 / 25Oct17	

Inv.1,631	1 - BASEMENT WINDOWS - UPGRADE EXISTING BASEMENT WINDOW TO 30 INCH X 16 INCH
Line24594	Note:
1Nov17 / 1Nov17	

Inv.1,633	1 - BASEMENT WINDOWS - EXTRA BASEMENT WINDOW 30 INCH X 16 INCH
Line24605	Note:
10Nov17 / 2Feb18	

Kleinburg Glen - BLOCK 51 - 2 - 42-3 Elev.B CARLTON

WINDOWS AND DOORS

Inv.1,623	1 - MAIN FLOOR CEILING 10FT, 8FT TALLER INTERIOR DOORS, TALLER FLAT ARCHES, REAR AND FRONT WINDOWS WITH TRANSOM, TALLER KITCHEN CABINETS WITH CROWN AND FURRING PANEL, ADDED STAIRS AND PICKETS
Line24500	Note:
25Oct17 / 25Oct17	
Inv.1,623	1 - INSTALL MANDOOR-GARAGE TO HOUSE- GRADE PERMITS
Line24507	Note:
25Oct17 / 25Oct17	

CORTINA
KITCHENS INC.

70 Regina Road, Woodbridge, Ontario L4L 8L8
Tel: 905-294-0464 Fax: 905-284-0884
www.CortinaKitchens.com

KG2-51
APRIL 10 2018

REVISED
JUNE 9 2018

QUOTATION

Date: 14/10/16

Trade Name: Gold Park Homes

Site location: Kleinburg

Model: 42-3

Address:

Project: Kleinburg Glen

Phase:

This layout has been explained to the purchaser by Cortina Kitchens Inc. and is understood by the purchaser.

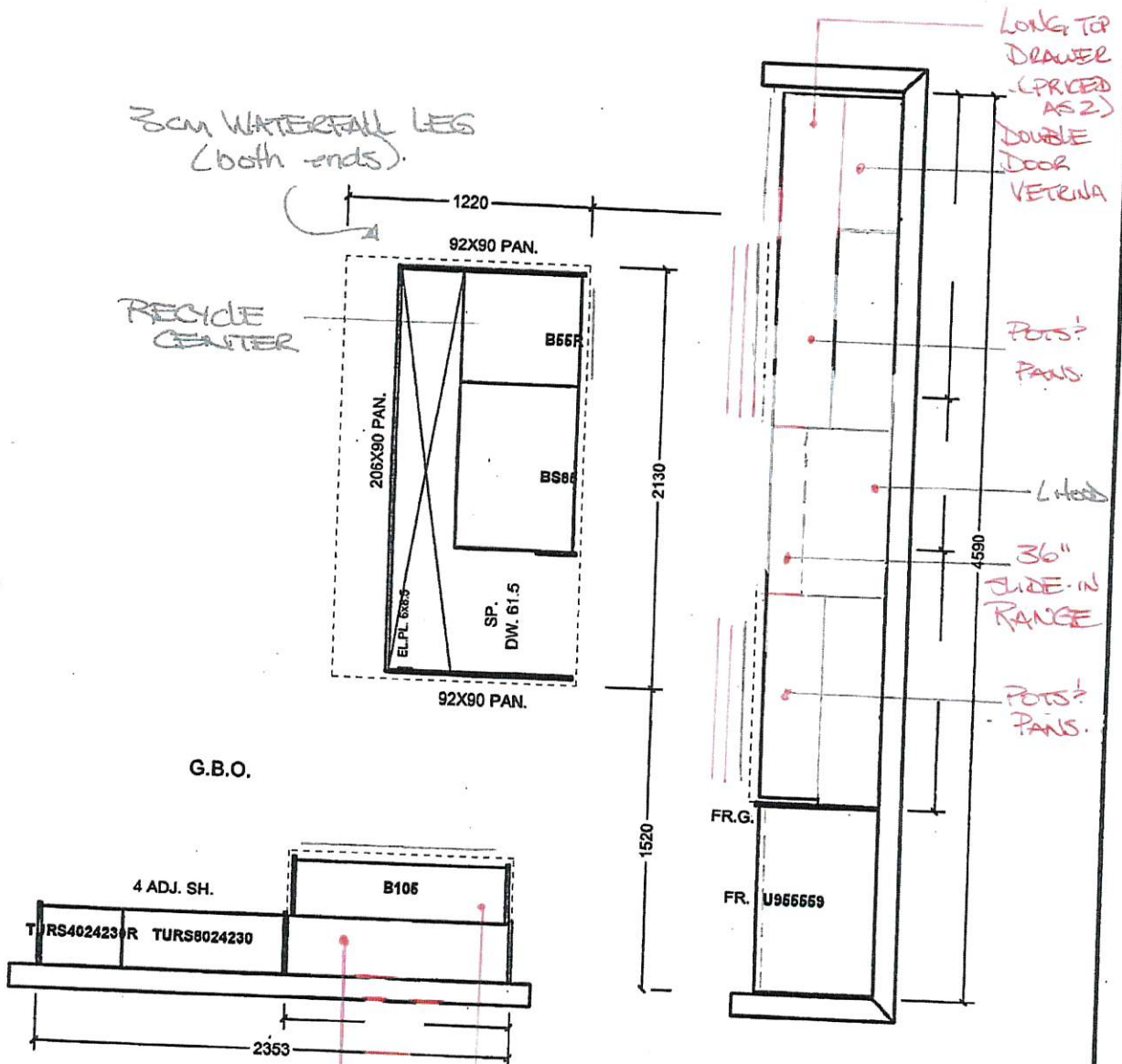

All prices subject to confirmation from head office.
This quotation is subject to the terms & conditions set
out

ACCEPTED DATE: _____

All agreements are contingent upon strikes, accidents, and delays beyond our control.
Please provide our installer with template for sinkholes or \$150.00 will be charged for callback.

Item A. Wood grain and colour are characteristics of the product. We cannot guarantee that such grain and colour will always match.
Item B. Cortina Kitchens Inc. reserves the right to alter dimensions and make technical changes without notice.