



CONSTRUCTION SUMMARY

Lot: 83
Model: 50.04 A BEAUMONT
Project/Phase: Pine Valley Forevergreen / 1

APPLIANCES

Invoice	Qty.	Description
2672 30Mar21 NoCat	1	APPLIANCE HOOD FAN INSERT SPEC ATTACHED - SIGNED COPY

BASEMENT WINDOWS

Invoice	Qty.	Description
2564 72,675 10Mar21	2	BASEMENT WINDOWS - UPGRADE BASEMENT WINDOW SIZE TO 30 " X 24" - 10" FRAME (PINEVALLEY 50 FOOT LOTS ONLY)

CERAMIC

Invoice	Qty.	Description
2564 10Mar21 NoCat	1	MASTER ENSUITE: DELETE LINEN CLOSET, INSTALL ADDITIONAL SINGLE VANITY AND SINK INSTEAD - BASED ON STANDARD FINISHES SEE PLAN FOR DETAILS INCLUDED IN APS
2564 10Mar21 NoCat	1	**CUSTOM LAYOUT** SWITCH LOCATION OF TUB AND SHOWER ENSUITE 2 TO HAVE TUB + ENSUITE 3 TO HAVE SHOWER BASED ON STANDARD FINSIHES
2564 10Mar21 NoCat	1	MASTER ENSUITE: DELETE LINEN PANTRY - ADD 2ND VANITY (BASED ON STANDARD FINISHES) - SEE PLAN FOR LOCATION
2672 37 30Mar21	1	FRONT FOYER: TILE, FLOOR , LEVEL 5 - 24X24" LAID IN STRAIGHT, STACKED PATTERN.
2672 37 30Mar21	1	POWDER ROOM: TILE, FLOOR , LEVEL 5 - 24X24" LAID IN STRAIGHT, STACKED PATTERN.
2672 30Mar21 NoCat	1	FYI - KITCHEN/BREAKFAST: VINTAGE SERIES, 5" RED OAK, NSS ENGINEERED HARDWOOD, 3/4" THK, SCULPTED TEXTURE, UVF FINISH DO NOT SUPPLY / INSTALL CERAMIC IN KITCHEN/BREAKFAST AREA (CREDIT)
2715 32 03Jun21	1	ENSUITE 2: TILE, FLOOR - LEVEL 1 - 12x24" LAID IN STRAIGHT STACKED PATTERN - SEE PLAN FOR DIRECTION
2715 46 03Jun21	1	ENSUITE 2: TILE, WALL - LEVEL 1 - 3x6" LAID IN HORIZONTAL STACKED PATTERN
2715 32 03Jun21	1	ENSUITE 3: TILE, FLOOR - LEVEL 1 - 12x24" LAID IN STRAIGHT STACKED PATTERN - SEE PLAN FOR DIRECTION
2715 46 03Jun21	1	ENSUITE 3: TILE, WALL - LEVEL 1 - 3x6" LAID IN HORIZONTAL STACKED PATTERN



CONSTRUCTION SUMMARY

Lot: 83
Model: 50.04 A BEAUMONT
Project/Phase: Pine Valley Forevergreen / 1

CERAMIC

Invoice	Qty.	Description
2715 32 03Jun21	1	ENSUITE 4: TILE, FLOOR - LEVEL 1 - 12x24" LAID IN STRAIGHT STACKED PATTERN - SEE PLAN FOR DIRECTION
2715 46 03Jun21	1	ENSUITE 4: TILE, WALL - LEVEL 1 - 3x6" LAID IN HORIZONTAL STACKED PATTERN
2715 43 03Jun21	1	MASTER ENSUITE: TILE, SHOWER FLOOR - LEVEL 2 - 2" HEX
2793 46 03Jun21	1	MASTER ENSUITE: TILE, WALL, LEVEL 1 - 4x16" LAID IN HORIZONTAL, STACKED PATTERN.
2798 26 15Jun21	1	MASTER ENSUITE: TILE INSTALLATION UPGRADE, WALL, HORIZONTAL, BRICK (30/70) PATTERN

CONCRETE AND DRAIN

Invoice	Qty.	Description
2564 10Mar21 NoCat	1	BACK-FLOW PREVENTER VALVE



CONSTRUCTION SUMMARY

Lot: 83
Model: 50.04 A BEAUMONT
Project/Phase: Pine Valley Forevergreen / 1

DRYWALL

Invoice	Qty.	Description
2564 10Mar21 NoCat	1	**CUSTOM LAYOUT** DELETE ARCH WAYS BETWEEN LIBRARY AND DINING ROOM
2564 10Mar21 NoCat	1	FYI - KITCHEN: UPGRADE GARDEN DOOR ASSEMBLY TO 96"
2564 10Mar21 NoCat	1	MASTER ENSUITE: DELETE LINEN CLOSET, MAKE DRESSING ROOM AND BEDROOM 4 CLOSETS LARGER
2564 10Mar21 NoCat	1	MASTER ENSUITE: DELETE LINEN CLOSET, INSTALL ADDITIONAL SINGLE VANITY AND SINK INSTEAD - BASED ON STANDARD FINISHES SEE PLANS FOR DETAILS INCLUDED IN APS
2564 10Mar21 NoCat	1	**CUSTOM LAYOUT** SWITCH LOCATION OF TUB AND SHOWER ENSUITE 2 TO HAVE TUB + ENSUITE 3 TO HAVE SHOWER BASED ON STANDARD FINISHES
2564 10Mar21 NoCat	1	THRU OUT: INCREASE HEIGHT OF DOOR TO 8FT SECOND FLOOR - PER DOOR
2564 10Mar21 NoCat	1	MASTER ENSUITE: DELETE LINEN PANTRY - ADD 2ND VANITY (BASED ON STANDARD FINISHES) - SEE PLAN FOR LOCATION



CONSTRUCTION SUMMARY

Lot: 83
Model: 50.04 A BEAUMONT
Project/Phase: Pine Valley Forevergreen / 1

ELECTRICAL

Invoice	Qty.	Description
2564 72,281 10Mar21	1	GREAT ROOM: INTERIOR WALL OUTLET: ADDITIONAL 110V WALL INTERIOR RECEPTACLE ON EXISTING CIRCUIT FOR WALL MOUNTED TV - LOCATE APPROX 66" A.F.F. ABOVE FIREPLACE
2564 72,272 10Mar21	1	KITCHEN: 110V WALL RECEPTACLE ON SEPARATE CIRCUIT - FOR WINE FRIDGE - APPLIANCE NOT INCLUDED SEE PLAN FOR LOCATION
2564 72,306 10Mar21	1	KITCHEN: RELOCATE KITCHEN APPLIANCE FROM STANDARD LOCATION - APPROX. "NEW" LOCATION AS PER ATTACHED DRAWINGS SEE PLAN FOR REVISED FRIDGE LOCATION
2564 72,272 10Mar21	1	KITCHEN: 110V WALL RECEPTACLE ON SEPARATE CIRCUIT - FOR FREEZER - APPLIANCE NOT INCLUDED
2564 72,272 10Mar21	1	SERVERY: 110V WALL RECEPTACLE ON SEPARATE CIRCUIT - FOR MICROWAVE - MICROWAVE NOT INCLUDED
2564 72,289 10Mar21	6	GREAT ROOM: 4" E/S LED INTERIOR POT LIGHT - GROUND FLOOR - EACH - INCLUDED IN APS INCLUDES SWITCH
2564 10Mar21 NoCat	1	MASTER ENSUITE: DELETE LINEN CLOSET, MAKE DRESSING ROOM AND BEDROOM 4 CLOSETS LARGER
2672 30Mar21 NoCat	1	*NOTE* VALANCE LIGHTING NOT PURCHASED - HOME OWNER TO COMPLETE AFTER CLOSING

EXTERIOR COLOURS

Invoice	Qty.	Description
2564 10Mar21 NoCat	1	EXTERIOR COLOUR PACKAGE: BR1



CONSTRUCTION SUMMARY

Lot: 83
Model: 50.04 A BEAUMONT
Project/Phase: Pine Valley Forevergreen / 1

FRAMING

Invoice	Qty.	Description
2564 10Mar21 NoCat	1	**CUSTOM LAYOUT** DELETE ARCH WAYS BETWEEN LIBRARY AND DINING ROOM
2564 10Mar21 NoCat	1	FYI - KITCHEN: UPGRADE GARDEN DOOR ASSEMBLY TO 96"
2564 10Mar21 NoCat	1	MASTER ENSUITE: DELETE LINEN CLOSET, MAKE DRESSING ROOM AND BEDROOM 4 CLOSETS LARGER
2564 10Mar21 NoCat	1	MASTER ENSUITE: DELETE LINEN CLOSET, INSTALL ADDITIONAL SINGLE VANITY AND SINK INSTEAD - BASED ON STANDARD FINISHES SEE PLAN FOR DETAILS INCLUDED IN APS
2564 10Mar21 NoCat	1	**CUSTOM LAYOUT** SWITCH LOCATION OF TUB AND SHOWER ENSUITE 2 TO HAVE TUB + ENSUITE 3 TO HAVE SHOWER BASED ON STANDARD FINISHES
2564 10Mar21 NoCat	1	THRU OUT: INCREASE HEIGHT OF DOOR TO 8FT SECOND FLOOR - PER DOOR
2564 10Mar21 NoCat	1	MASTER ENSUITE: DELETE LINEN PANTRY - ADD 2ND VANITY (BASED ON STANDARD FINISHES) - SEE PLAN FOR LOCATION

GLASS AND MIRROR

Invoice	Qty.	Description
2564 10Mar21 NoCat	1	MASTER ENSUITE: DELETE LINEN CLOSET, INSTALL ADDITIONAL SINGLE VANITY AND SINK INSTEAD - BASED ON STANDARD FINISHES SEE PLAN FOR DETAILS INCLUDED IN APS
2564 10Mar21 NoCat	1	**CUSTOM LAYOUT** SWITCH LOCATION OF TUB AND SHOWER ENSUITE 2 TO HAVE TUB + ENSUITE 3 TO HAVE SHOWER BASED ON STANDARD FINISHES
2564 10Mar21 NoCat	1	MASTER ENSUITE: DELETE LINEN PANTRY - ADD 2ND VANITY (BASED ON STANDARD FINISHES) - SEE PLAN FOR LOCATION
2672 30Mar21 NoCat	1	MASTER ENSUITE: UPGRADE SHOWER DOOR HANDLE AND HINGES - MATTE BLACK



CONSTRUCTION SUMMARY

Lot: 83
Model: 50.04 A BEAUMONT
Project/Phase: Pine Valley Forevergreen / 1

GRANITE MARBLE QUARTZ

Invoice	Qty.	Description
2672 101,930 30Mar21	1	KITCHEN: UPGRADE 2 QUARTA COUNTER TOP
2672 101,930 30Mar21	1	POWDER ROOM: UPGRADE 2 QUARTZ COUNTER TOP
2672 30Mar21 NoCat	1	MASTER ENSUITE: UPGRADE 2 QUARTZ COUNTER TOP 2 VANITIES - PER APS
2672 30Mar21 NoCat	1	ENSUITE 2 + ENSUITE 3 + ENSUITE 4: UPGRADE 2 QUARTZ COUNTER TOP
2715 03Jun21 NoCat	1	KITCHEN: UPGRADE TO 3CM COUNTERTOP THICKNESS

HARDWOOD

Invoice	Qty.	Description
2672 6 30Mar21	1	KITCHEN/BREAKFAST: VINTAGE SERIES, 5" RED OAK, NSS ENGINEERED HARDWOOD, 3/4" THK, SCULPTED TEXTURE, UVF FINISH **DIFFERENCE IN PRICE FROM STANDARD HARDWOOD IN APS**
2672 6 30Mar21	1	THRU OUT STANDARD AREAS - MAIN HALL/ LIBRARY/ DINING/ GREAT ROOM/ UPPER HALL/ MASTER BEDROOM/ BEDROOM 2/ BEDROOM 3/ BEDROOM 4: VINTAGE SERIES, 5" RED OAK, NSS ENGINEERED HARDWOOD, 3/4" THK, SCULPTED TEXTURE, UVF FINISH - LEVEL 4

INTERIOR TRIM AND DOORS

Invoice	Qty.	Description
2564 72,644 10Mar21	15	THRU OUT: INCREASE HEIGHT OF DOOR TO 8FT SECOND FLOOR - PER DOOR
2564 10Mar21 NoCat	1	MASTER ENSUITE: DELETE LINEN CLOSET, MAKE DRESSING ROOM AND BEDROOM 4 CLOSETS LARGER
2564 10Mar21 NoCat	1	MASTER ENSUITE: DELETE LINEN PANTRY - ADD 2ND VANITY (BASED ON STANDARD FINISHES) - SEE PLAN FOR LOCATION



CONSTRUCTION SUMMARY

Lot: 83
Model: 50.04 A BEAUMONT
Project/Phase: Pine Valley Forevergreen / 1

KITCHEN AND BATH CABINETRY

Invoice	Qty.	Description
2564 10Mar21 NoCat	1	MASTER ENSUITE: DELETE LINEN CLOSET, INSTALL ADDITIONAL SINGLE VANITY AND SINK INSTEAD - BASED ON STANDARD FINISHES SEE PLAN FOR DETAILS INCLUDED IN APS
2564 10Mar21 NoCat	1	KITCHEN: RELOCATE KITCHEN APPLIANCE FROM STANDARD LOCATION - APPROX. "NEW" LOCATION AS PER ATTACHED DRAWINGS SEE PLAN FOR RELOCATION OF FRIDGE
2564 10Mar21 NoCat	1	MASTER ENSUITE: DELETE LINEN PANTRY - ADD 2ND VANITY (BASED ON STANDARD FINISHES) - SEE PLAN FOR LOCATION
2672 101,930 30Mar21	1	THRU OUT: SEE ATTACHED CABINETRY SCHEDULE
2672 30Mar21 NoCat	1	FYI - *NOTE* VALANCE LIGHTING NOT PURCHASED - HOME OWNER TO COMPLETE AFTER CLOSING
2715 101,930 03Jun21	1	***REVISED CABINETRY SCHEDULE - JUNE 1 2021*** SEE ATTACHED REVISED CABINETRY SCHEDULE

MASONRY

Invoice	Qty.	Description
2564 10Mar21 NoCat	1	FYI - KITCHEN: UPGRADE GARDEN DOOR ASSEMBLY TO 96"

NETWORK AND WIRING

Invoice	Qty.	Description
2564 72,259 10Mar21	1	GREAT ROOM: CONDUIT PIPE - FOR WALL MOUNT TV - LOCATE APPROX 66" A.F.F. ABOVE FIREPLACE, THRU BASEMENT, TERMINATE AT CABLE LOCATION - SEE PLAN
2564 72,260 10Mar21	1	CONDUIT PIPE - FROM ATTIC TO BASEMENT - ELECTRICAL PANEL IN BASEMENT TO APPROX CENTER OF ATTIC



CONSTRUCTION SUMMARY

Lot: 83
Model: 50.04 A BEAUMONT
Project/Phase: Pine Valley Forevergreen / 1

PAINT

Invoice	Qty.	Description
2564 10Mar21 NoCat	1	**CUSTOM LAYOUT** DELETE ARCH WAYS BETWEEN LIBRARY AND DINING ROOM
2564 10Mar21 NoCat	1	FYI - KITCHEN: UPGRADE GARDEN DOOR ASSEMBLY TO 96"
2564 10Mar21 NoCat	1	MASTER ENSUITE: DELETE LINEN CLOSET, MAKE DRESSING ROOM AND BEDROOM 4 CLOSETS LARGER
2564 10Mar21 NoCat	1	MASTER ENSUITE: DELETE LINEN CLOSET, INSTALL ADDITIONAL SINGLE VANITY AND SINK INSTEAD - BASED ON STANDARD FINISHES SEE PLAN FOR DETAILS INCLUDED IN APS
2564 10Mar21 NoCat	1	**CUSTOM LAYOUT** SWITCH LOCATION OF TUB AND SHOWER ENSUITE 2 TO HAVE TUB + ENSUITE 3 TO HAVE SHOWER BASED ON STANDARD FINISHES
2564 10Mar21 NoCat	1	THRU OUT: INCREASE HEIGHT OF DOOR TO 8FT SECOND FLOOR - PER DOOR
2564 10Mar21 NoCat	1	MASTER ENSUITE: DELETE LINEN PANTRY - ADD 2ND VANITY (BASED ON STANDARD FINISHES) - SEE PLAN FOR LOCATION
2672 30Mar21 NoCat	2	MAIN STAIRS: STAIN STAIRS AND LANDINGS STAIRS AND LANDINGS WILL NOT MATCH HARDWOOD FLOORS IN COLOUR/TEXTURE



CONSTRUCTION SUMMARY

Lot: 83
Model: 50.04 A BEAUMONT
Project/Phase: Pine Valley Forevergreen / 1

PLUMBING

Invoice	Qty.	Description
2564 72,332 10Mar21	1	KITCHEN: ROUGH-IN 1/4" COLD WATER LINE TO FREEZER
2564 10Mar21 NoCat	1	MASTER ENSUITE: DELETE LINEN CLOSET, INSTALL ADDITIONAL SINGLE VANITY AND SINK INSTEAD - BASED ON STANDARD FINISHES SEE PLAN FOR LOCATION INCLUDED IN APS
2564 10Mar21 NoCat	1	**CUSTOM LAYOUT** SWITCH LOCATION OF TUB AND SHOWER ENSUITE 2 TO HAVE TUB + ENSUITE 3 TO HAVE SHOWER BASED ON STANDARD FINISHES
2564 10Mar21 NoCat	1	MASTER ENSUITE: DELETE LINEN PANTRY - ADD 2ND VANITY (BASED ON STANDARD FINISHES) - SEE PLAN FOR LOCATION INCLUDED IN APS
2564 10Mar21 NoCat	1	MASTER ENSUITE: DELETE LINEN CLOSET, MAKE DRESSING ROOM AND BEDROOM 4 CLOSETS LARGER
2672 30Mar21 NoCat	1	KITCHEN SINK: BLANCO QUATRUS R U SUPER SINGLE - SS SERVERY SINK IS STANDARD

STAIR AND RAILINGS

Invoice	Qty.	Description
2672 93,812 30Mar21	2	MAIN STAIRS - BASEMENT TO 2ND FLOOR; UPGRADE - EURONLINE (ALL PLAIN) PICKET, 3" HALF-ROUND W/V-GROOVE HANDRAIL, 3 1/2" ALL SQUARE POST WITH PYRAMID TOP POST CAP - PACKAGE A-2

WINDOWS AND DOORS

Invoice	Qty.	Description
2564 10Mar21 NoCat	1	KITCHEN: UPGRADE GARDEN DOOR ASSEMBLY TO 96"
2564 10Mar21 NoCat	1	THRU OUT: UPGRADE TO BLACK INTERIOR WINDOWS

PV - 83 Cabinetry Schedule

ROOM	DESCRIPTION	PRICE	QTY	TOTAL
KITCHEN	UPGRADE PERIMETER FROM SERIES 2 TO SERIES 5 - <i>MEDIO 6 OYSTER</i>		1	
	NO HARDWARE / HOLES IN KITCHEN			
	RETURN TRIP FOR HARDWOOD		1	
	ADD CABINETRY VALANCE		1	
	ADJUST CABINETRY FOR 48"W RANGE (N/C)		1	
	ADJUST CABINETRY FOR 30"W FRIDGE AND 30"W FREEZER (N/C)		1	
	ADD DÉCOR PANELS FOR FRIDGE/FREEZER		1	
	CONVERT BASE CABINETS TO BASE POTS AND PANS DRAWERS		1	
	RE-LOCATE PANTRY TO CORNER ON FRIDGE WALL (36"W) (N/C)		3	
	ADD DECORATIVE HOOD CABINET - ASPEN MODERN		1	
	CONVERT STD. UPPER INTO HUTCH CABINET WITH 9"/12"H DRAWER COMBINATION IN WHITE 3/4" EXTENSION		1	
	ADD BEVELLED CLEAR GLASS INSERTS TO HUTCH CABINET		1	
	ADJUST BASE CABINETRY FOR 24"W WINE FRIDGE (N/C)		1	
	ADD DÉCOR PANEL FOR WINE FRIDGE (GLASS INSERT)		1	
ISLAND	*NOTE: PLEASE SEE ADJUSTED ISLAND SIZE AND LOCATION*			
	UPGRADE FROM SERIES 2 TO SERIES 6 - <i>MEDIO 6 MIDNIGHT BLUE</i>		1	
	ADD SPICE PULL OUT ACCESSORY TO ISLAND		1	
	ADD 2-BIN RECYCLE CENTRE TO ISLAND		1	
	ADD OVERSIZED DUMMY DOORS TO SIDES OF ISLAND		2	
	ADD PROUD KICK PLATE TO SIDES + REAR ISLAND		1	
SERVERY	UPGRADE FROM SERIES 2 TO SERIES 6 - <i>MEDIO 6 MIDNIGHT BLUE</i>		1	
	ADD BUILT IN MICROWAVE CABINET WITH DRAWER BELOW		1	
POWDER ROOM	UPGRADE FROM SERIES 2 TO SERIES 6 - <i>MEDIO 6 MIDNIGHT BLUE</i>		1	
CABINETRY TOTAL:				

HANDLE PLACEMENT: AT INSTALLERS DISCRETION

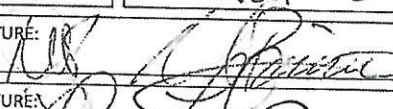
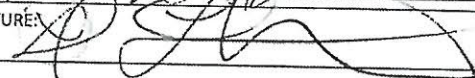
LOT #:	83	DATE:	MAY 20 2021
SIGNATURE:			
SIGNATURE:			

Revised
PV-83

June 1, 2021

GOLD PARK
WORTH MORE

REVISED:
12/18/2020 15:24

PV - 83 Cabinetry Schedule
Amended June 1, 2021

ROOM	DESCRIPTION	PRICE	QTY	TOTAL
KITCHEN	REVISED: ADD DECORATIVE HOOD CABINET - ASPEN MODERN - IN MEDIO 6 'MIDNIGHT BLUE'		1	
	DELETE ITEM: SPICE PULL OUT ACCESSORY		1	
	ADD ITEM: DECORATIVE POST + APPLIED MOULDING TO SIDES OF ISLAND		1	
CABINETS TOTAL:				

HANDLE PLACEMENT: AT INSTALLERS DISCRETION

LOT #: PV-83

DATE: June 1, 2021

SIGNATURE: 

SIGNATURE: 

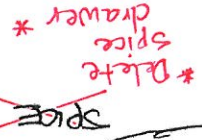

Decorative post + applied moulding (both sides)

→ Good function Weak

83-14

*** Revised ***

74-83

14

2002 DEEP BATTERY (Approx 36")

• उपसर्ग ON

TRAFFIC

345	OFF. ST.
-----	----------

* Hand in Kitchen + Bakery.



PLAN VIEW

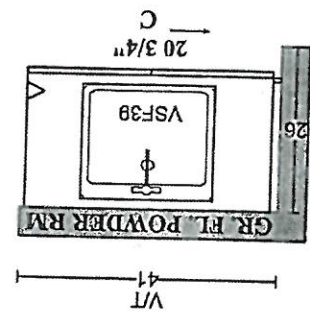
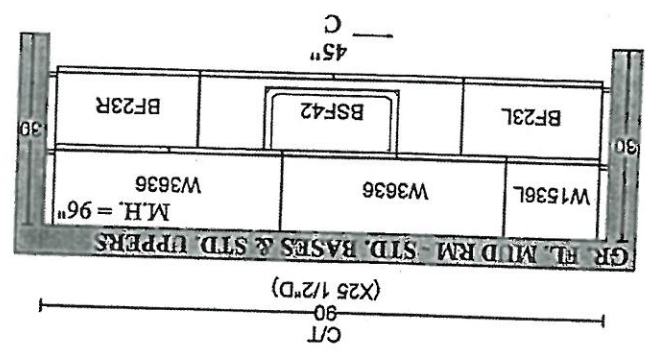
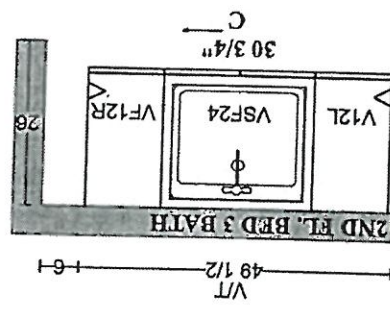
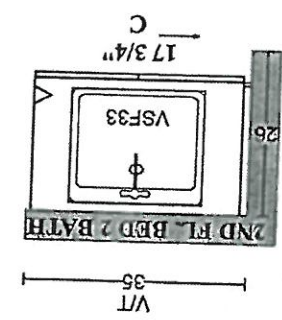
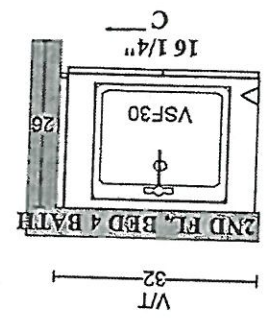
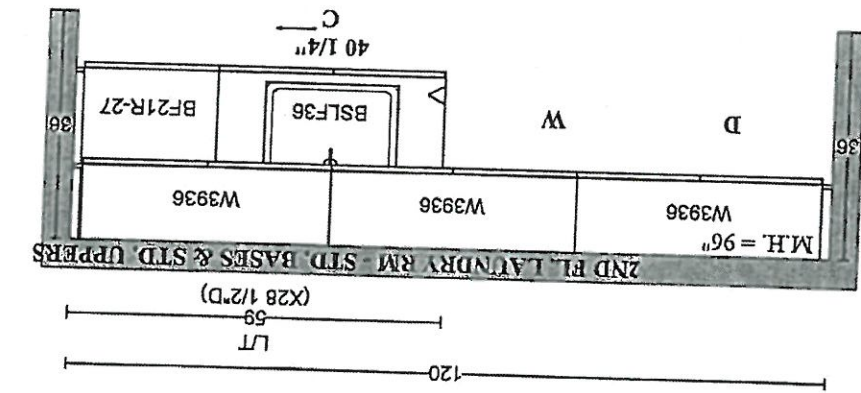
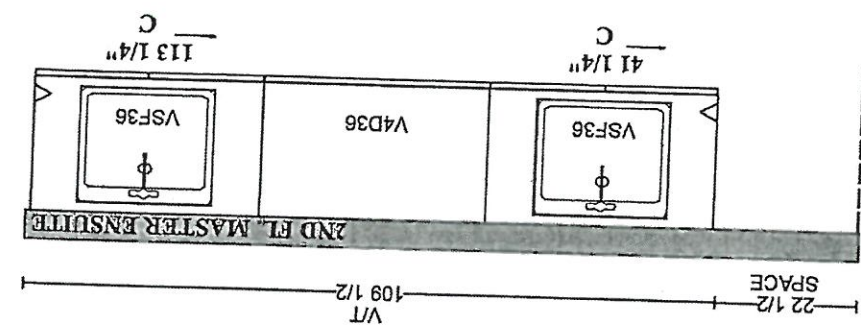

GOLDPARK HOMES
PINE VALLEY
VAUGHAN, ONTARIO
MODEL: (5004) BEAUMONT

SITE STANDARD: WHITE 3/4" EXTENSION
SOFT-CLOSE DRAWERS & STANDARD SLAM DOOR HINGES
TO VANITIES

ONE TOP DRAWER WHERE POSSIBLE THROUGHOUT EACH
VANTY, ONE BANK OF DRAWERS WHERE POSSIBLE
THROUGHOUT EACH MASTER ENSUITE VANTY

PV-83-18
March 29, 2021
PV-83
June 1, 2021

*** NOTE: This is not an approved document. Document must be locked ***

Scheduled Closing Date: Wednesday, August 18, 2021

Purchasers: MICHAEL PAIANO & LAURA, LEE PAIANO

Property: 83 of Plan -

Telephone Res. / Bus: / (416) 459-9282

Project: Pine Valley Forevergreen - Phase 1

Decor Advisor: Amanda Ceresino

Model and Elevation: 50.04 A BEAUMONT

Layout Changes: ☐ Yes ☒ No

Sketch Attached: ☒ Yes ☐ No

Exterior Colour Scheme:

1. Cabinetry

	Style and Colour	Counter	Hardware
Kitchen / Breakfast	2-tone <i>Modena</i>	*Quartz: Organic White	attachd
Laundry Room	Chesapeake 'Classic White'	Std: P-Lam 'White'	attachd
Powder Room	*Medio 6 'Midnight Blue'	*Quartz: Organic White	attachd
Mud Room	Chesapeake 'Classic White'	Std: P-Lam 'White'	attachd
Master Ensuite Bathroom	<i>Modena</i> 'Classic White'	*Quartz: Organic White	attachd
Second Ensuite Bathroom (If Applicable)	Tribeca 'Stello'	*Quartz: Organic White	attachd
Ensuite 3	<i>Modena</i> 'Classic White'	*Quartz: Organic White	attachd

Comment

Kitchen Perimeter: Medio 6 'Oyster' / Kitchen Island + Servery: Medio 6 'Midnight Blue' // Ensuite 4: ~~Tribeca~~ 'Stello' + *Quartz: Organic White
Modena 'Classic White'

2. Floor Tile

	Selection
Entrance Vestibule	*24x24" Volkas polished 'White'
Main Hall	
Kitchen / Breakfast	see hardwood
Laundry Room	13x13" Cambridge matte 'White'
Powder Room	*24x24" Volkas polished 'White'
Mud Room	13x13" Cambridge matte 'White'
Master Ensuite Bathroom	13x13" Cambridge matte 'White' 13x13" Capri 'White'
Second Ensuite Bathroom (If Applicable)	12x12" Construct 'Black' *12x24" Land 'Anthracite'
Lower Landing (If Applicable)	13x13" Cambridge matte 'White'
Ensuite 3	12x12" Construct 'Black' *12x24" Land 'Anthracite'

Comment

Ensuite 4: ~~13x13" 12x12" Construct 'Black'~~ // Shower Floors thru out: std 2x2" white
*12x24" Land 'Anthracite'

*Master Ensuite Shower Floor:
* Ontario HEX. 'Snow White' Matte*

3. Wall Tile

	Selection	Listello/Inserts	Describe
Ensuite 3	8x10" Uniwall 'White' <i>3x6" Chess 'Arctic Bright' White</i>	<input type="radio"/> Yes <input checked="" type="radio"/> No	
Master Ensuite Bathroom			
Tub Deck	<i>4x6" CDC 'Arctic Bright'</i>	<input type="radio"/> Yes <input checked="" type="radio"/> No	
Shower Stall	8x10" Uniwall 'White' <i>White</i>	<input type="radio"/> Yes <input checked="" type="radio"/> No	
Bathroom Walls	<i>3x6" Chess 'Arctic Bright' White</i>	<input type="radio"/> Yes <input checked="" type="radio"/> No	
Second Ensuite Bathroom (If Applicable)	8x10" Uniwall 'White' <i>White</i>	<input type="radio"/> Yes <input checked="" type="radio"/> No	
Ensuite 4	8x10" Uniwall 'White' <i>3x6" Chess 'Arctic Bright' White</i>	<input type="radio"/> Yes <input checked="" type="radio"/> No	
Kitchen Backsplash	<input type="radio"/> Yes <input checked="" type="radio"/> No	Backsplash Behind Fridge	

Comment

** Revised **

June 1, 2021

[Signatures]

[Signature]

*** NOTE: This is not an approved document. Document must be locked ***

Scheduled Closing Date: Wednesday, August 18, 2021

Purchasers: MICHAEL PAIANO & LAURA, LEE PAIANO

Property: 83 of Plan -

Telephone Res. / Bus: / (416) 459-9282

Project: Pine Valley Forevergreen - Phase 1

Decor Advisor: Amanda Ceresino

Model and Elevation: 50.04 A BEAUMONT

4. Plumbing Fixtures

Master Ensuite Bathroom

Second Ensuite

Powder Room

Other Room - Specify

Other Washroom

Comment

See extras

5. Hardwood Flooring

Main Hall

Type and Stain

Kitchen / Breakfast

*3/4x5"red oak sculpted 'Hillside'

Living Room

Dining Room

Family Room

Den/Library

Entrance Vestibule

Lower Landing
(If Applicable)

Upper Landing

Upper Hall

Master Bedroom

Bedroom #2

Bedroom #3

Bedroom #4

Bedroom #5

Other Room - Specify

*Thru out std areas

Type and Stain

*3/4x5"red oak sculpted 'Hillside'

Comment

6. Carpeting

Ground Floor

Upgrade

Description

Second Floor

Upgrade Underpad

Type

Area

Carpet on Stairs

Capped

Runner - *Upgrade

Comment

7. Fireplace

Living Room

Purchased

As Per Plan

N/A

Family Room

Purchased

As Per Plan

N/A

Other Room - Specify

Purchased

As Per Plan

N/A

Fireplace Type

Mantle Type

Colour / Stain

Surround

Hearth

Comment

Standard Gas

Mediterranean

Arctic White

n/a

none

*** NOTE: This is not an approved document. Document must be locked ***

Scheduled Closing Date: Wednesday, August 18, 2021

Purchasers: MICHAEL PAIANO & LAURA, LEE PAIANO

Property: 83 of Plan -

Telephone Res. / Bus: / (416) 459-9282

Project: Pine Valley Forevergreen - Phase 1

Decor Advisor: Amanda Ceresino

Model and Elevation: 50.04 A BEAUMONT

8. Trim Carpentry

Interior Doors Carrara Front Door Glass Inserts Standard Door Handles Standard
Interior Trim Standard Package
Comment

9. Plaster Mouldings and Medallions

Standard Throughout ☐ Yes ☐ No ☒ N/A

Entrance Vestibule			Kitchen/Breakfast		
Main Hall			Den/Library		
Living Room			Lower Landing		
Dining Room			Other Room - Specify		
Family Room					
Comment					

10. Railings and Spindles

Railing Package *A2 package
Railing Colour *Zeus
Stringer / Riser *Zeus
Spindle Colour *Black
Treads *Zeus
Oak Stairs ☒ Yes ☐ No ☐ N/A
Comment

11. Wall Paint / Ceilings

Throughout Finished Areas Warm Grey
Trim Paint White
Smooth Ceilings
Ground Floor ☒
Second Floor ☒
Note

Comment

Purchasers: MICHAEL PAIANO & LAURA, LEE PAIANO

Property: 83 of Plan -

Telephone Res. / Bus: / (416) 459-9282

Project: Pine Valley Forevergreen - Phase 1

Decor Advisor: Amanda Ceresino

Model and Elevation: 50.04 A BEAUMONT

12. Electrical

Hood Fan ☐ White ☐ Stainless ☒ N/A

Above Kitchen Cabinet Light ☐ Yes ☒ No

Standard Appliances ☐

Below Kitchen Cabinet Light ☐ Yes ☒ No

Over The Range Microwave ☐

Chimney Style Fan ☐

Comment

13. Heating and Air Conditioning

Air Conditioning

Gas Provisions Stove

Gas Provisions Dryer

Gas Provisions Barbecue

Comment

14. Additional Comments

15. Disclaimers and Notes

- Colours of all materials are as close as possible to builder's selection, but not necessarily identical due to variances in manufacturing.
- Any extras listed above are null and void unless accompanied by a separate invoice/amendment. Said invoice must be paid in full.
- The Purchaser acknowledges that after Interior Colour Selection form is signed and dated, no further changes will be permitted other than re-selection due to unavailability. Purchaser's Initials
- The Purchaser acknowledges reading and accepting the "Gold Park Homes Decor Centre Disclaimers" form. This document contains other miscellaneous disclaimers.

This Interior Colour Selection is final and approved by:

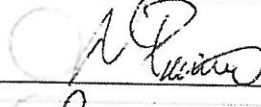
Signature:  Date:

Prices, figures, illustrations, sizes, features and finishes are subject to change without notice. Areas and dimensions are approximate and actual usable floor space may vary from the stated area. Layout may be reverse of the unit purchased. E. & O.E. 5004



SCHEDULE 'F'

PV-83

Feb. 12, 2021

PV-83

March 29, 2021

REVISED

PV-83

June 1, 2021

The Beaumont

50' SERIES

Elevation A • 4,170 sq.ft.
4,315 sq.ft. Opt. Elevator

Elevation B • 4,165 sq.ft.
4,315 sq.ft. Opt. Elevator

Elevation C • 4,250 sq.ft.
4,400 sq.ft. Opt. Elevator

8ft DOORS
THRU OUT
2nd FLOOR

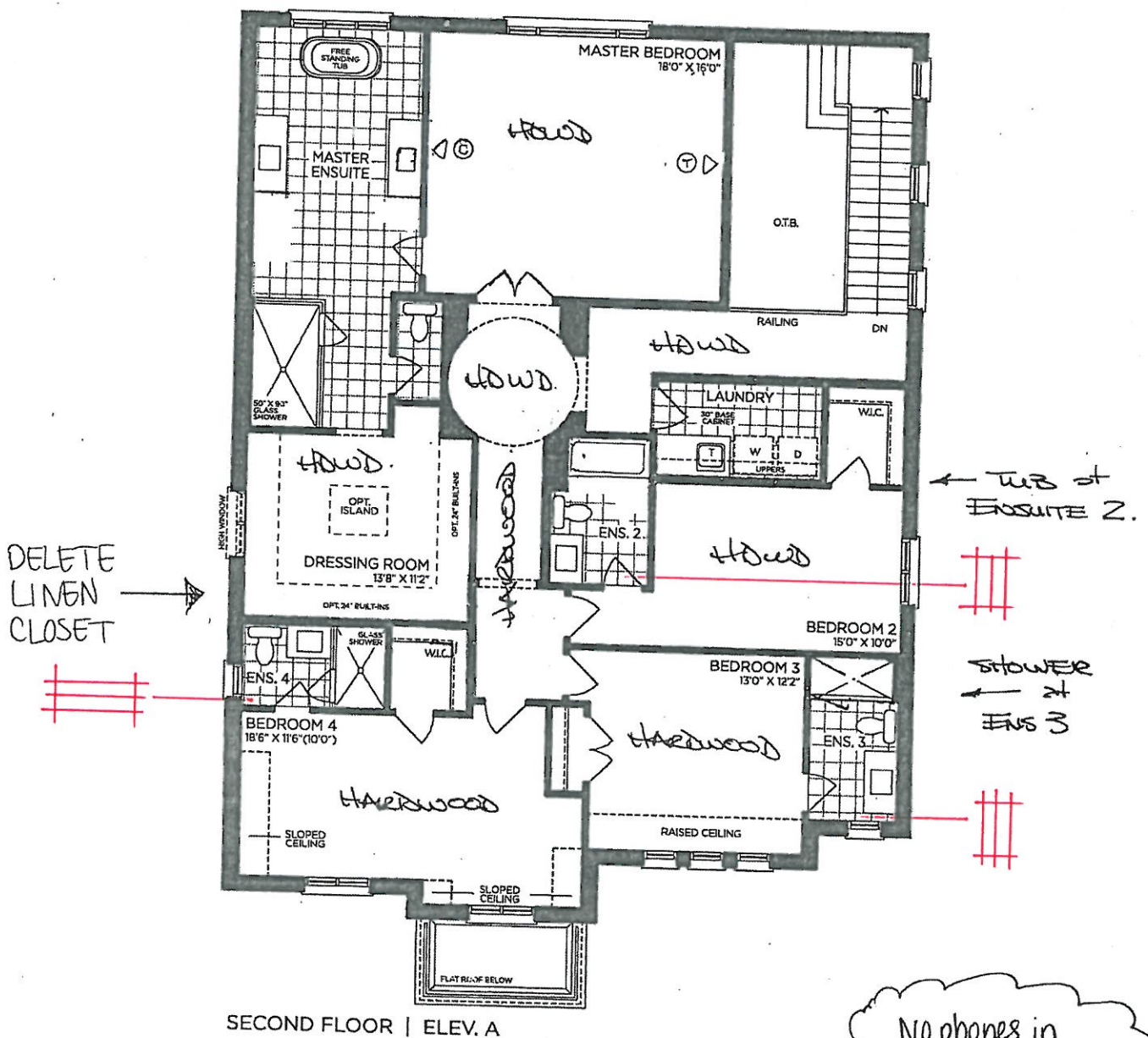

SECOND FLOOR | ELEV. A

No phones in
Bedroom 2/3/4

VENDOR	
PURCHASER	
PURCHASER	

GOLDPARK
WORTH MORE™

Prices, figures, illustrations, sizes, features and finishes are subject to change without notice. Areas and dimensions are approximate and actual usable floor space may vary from the stated area. Layout may be reverse of the unit purchased. E. & O.E. 5004



SCHEDULE 'F'

PV-83 *alalad*
Feb. 12, 2021

PV-83 *MP*
March 29, 2021

PV-83
June 1, 2021 *MP*

The Beaumont

50' SERIES

Elevation A • 4,170 sq.ft.
4,315 sq.ft. Opt. Elevator
Elevation B • 4,165 sq.ft.
4,315 sq.ft. Opt. Elevator
Elevation C • 4,250 sq.ft.
4,400 sq.ft. Opt. Elevator

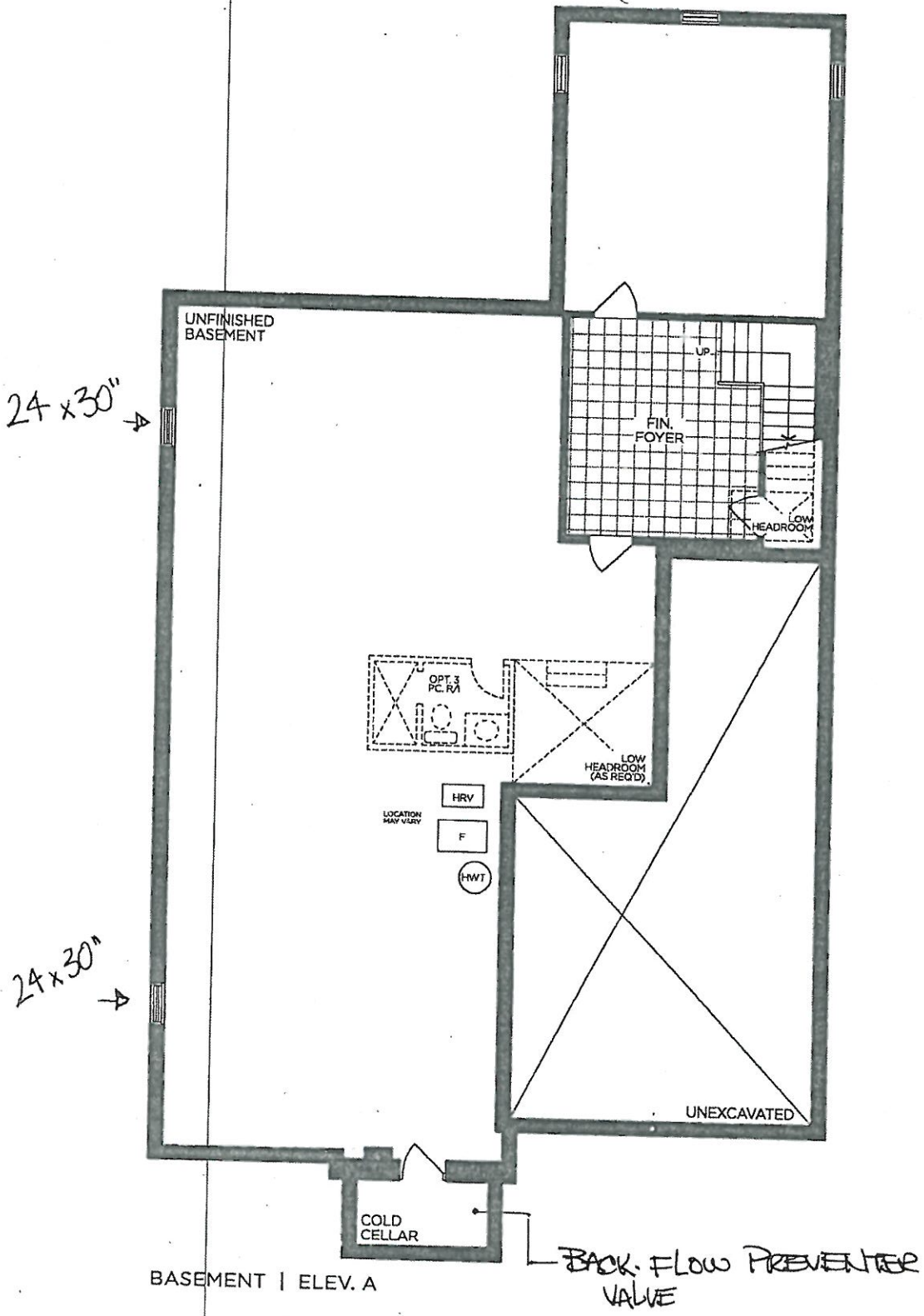

BASEMENT | ELEV. A

VENDOR	
PURCHASER	
PURCHASER	

GOLDPARK

WORTH MORE™

Prices, figures, illustrations, sizes, features and finishes are subject to change without notice. Areas and dimensions are approximate and actual usable floor space may vary from the stated area. Layout may be reverse of the unit purchased. E. & O.E. 5004



PINE VALLEY
FOREVERGREEN

STONE COUNTERTOP EDGE PROFILES



STANDARD 2CM EASED EDGE

LOCATION:

TURN OUT



UPGRADE 3CM EASED EDGE

LOCATION:

Kitchen

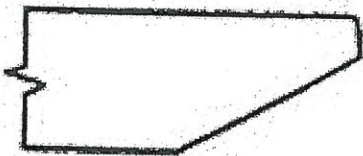

UPGRADE 4CM MITRED EDGE

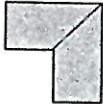

LOCATION:

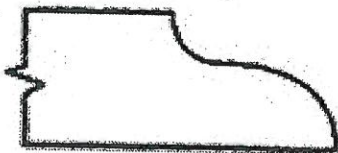

UPGRADE 2CM OGEE EDGE

LOCATION:

LOT #: PV-83

DATE: March 29, 2021

SIGNATURE:

SIGNATURE:

Revised
June 2, 2021

see attach.

GOLDPARK
WORTH MORE



PINE VALLEY
FOREVERGREEN

STONE COUNTERTOP EDGE PROFILES



STANDARD 2CM EASED EDGE

LOCATION:

Turn out

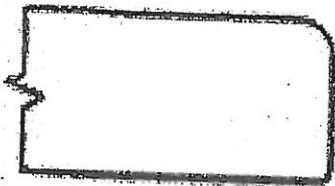

UPGRADE 3CM EASED EDGE

LOCATION:

Kitchen



UPGRADE 4CM MITRED EDGE

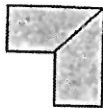

LOCATION:

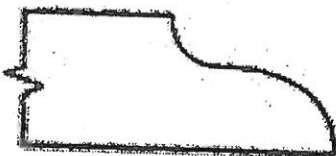

UPGRADE 2CM OGEE EDGE

LOCATION:

LOT #: PV-83

DATE: March 29, 2021

SIGNATURE:

SIGNATURE:

Revised

June 2, 2021

GOLDPARK
NORTH HAVEN



PINE VALLEY
FOREVERGREEN

STONE COUNTERTOP EDGE PROFILES



STANDARD 2CM EASED EDGE

LOCATION:

Turn out

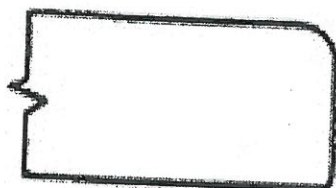

UPGRADE 3CM EASED EDGE

LOCATION:



UPGRADE 4CM MITRED EDGE

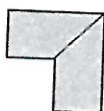

LOCATION:



UPGRADE 2CM OGEE EDGE

LOCATION:

LOT #: PV-83

DATE: March 29, 2021

SIGNATURE:

SIGNATURE:

GOLDPARK
WORTH MORE

STANDARD HARDWARE / KNOBS



☐ K002-02



☐ K002-03



☐ K002-04



☐ K002-06



☒ K002-05
MUD ROOM
LAUNDRY
MASTER
ENS 2
ENS 3
ENS 4



☐ K008-14



☐ K024-03

☒ *NO HARDWARE
Kitchen.
Pantry

☐ *TOUCH-LATCH

LOT # PV-83

DATE: March 29, 2021

SIGNATURE:

SIGNATURE:

UPGRADE KITCHEN SINK



BLANCO - QUATRUS R15 U SUPER SINGLE
Stainless Steel - Undermount
32" x 18" x 9"

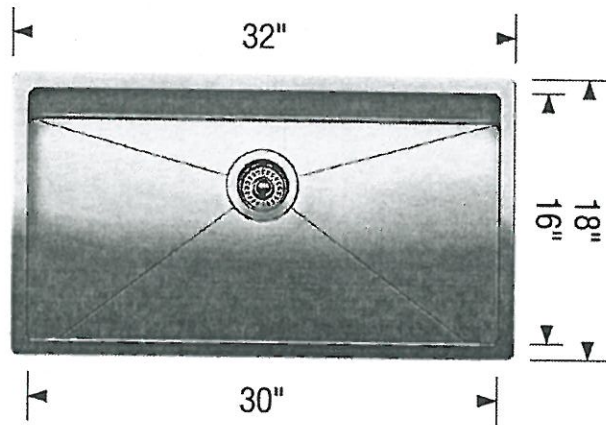
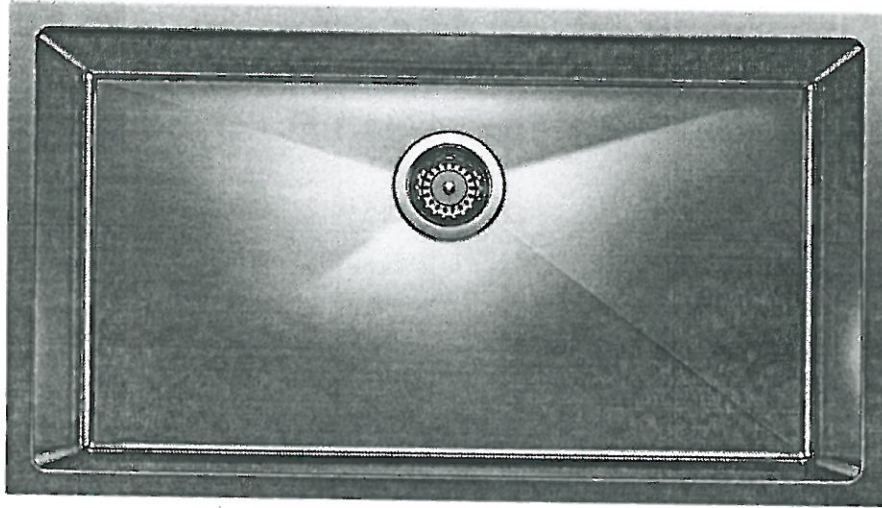

Stainless Steel

☐ GRID *— NO!*

MODEL 401518 Stainless Steel / 406347 Grid

Lot#
83

Room: *Kitchen* Signature: *[Signature]*

Date: *MARCH 29 2021* Signature: *[Signature]*

GOLDPARK
WORTH MORE™

UPGRADE SHOWER HARDWARE



MT6X6

Shower Door Handle

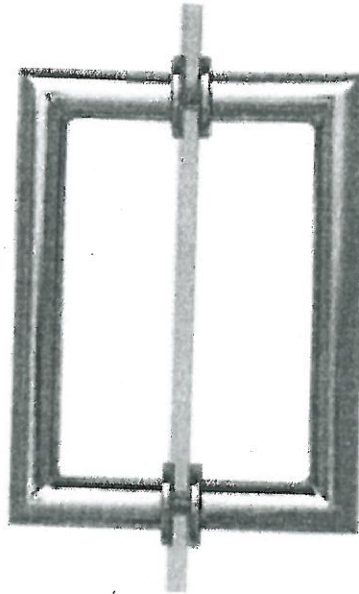

MT6X6
Shower Door Handle

6" x 6" back-to-back
3/4" dia. tube
Cut and mitred corners with
washers
(Also available single sided)

- ☐ CHROME
☒ MATTE BLACK + HINGES
☐ BRUSHED GOLD

Lot# 83	Date: MARCH 20 2022	Room: MASTER ENSUITE
Signature: [Signature]		
Signature: [Signature]		

STANDARD SHOWER HARDWARE



SDK106

Shower Door Knob

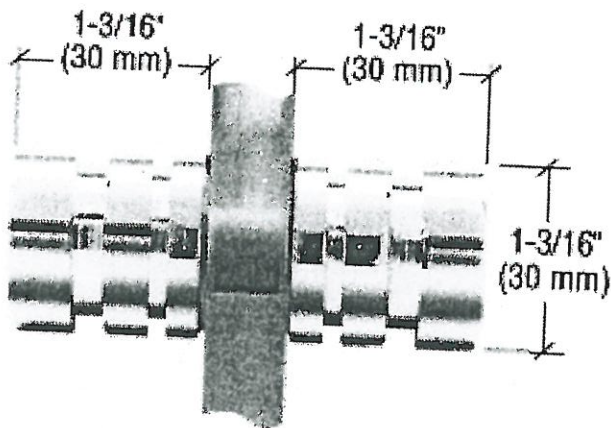

SDK106
Shower Door Knob

1-3/16" dia.
Contemporary Style
(Also available single sided)

CHROME

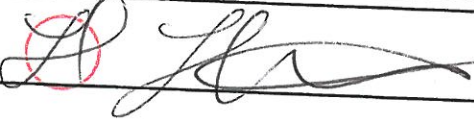
Lot# 1V-83	Date: March 29, 2021	Room: ENSUITE 3 + 4
Signature: 		
Signature: 		

BATHROOM ACCESSORIES



PINE VALLEY
FOREVERGREEN

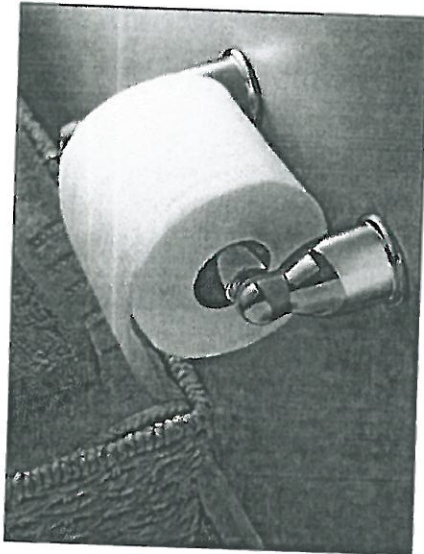

Tissue Holder
Mason - Chrome

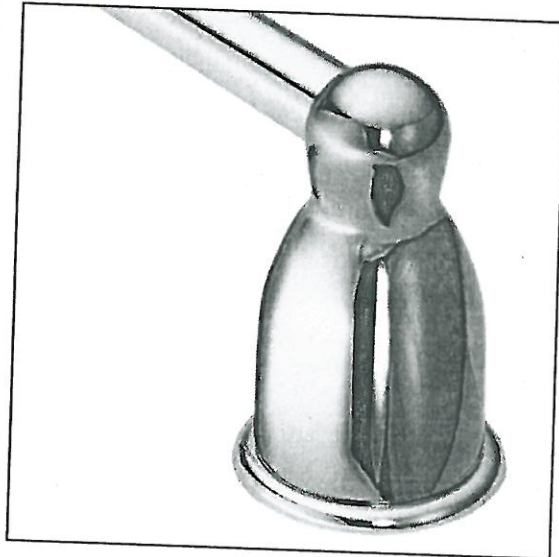

Towel Bar
Mason - Chrome



Please select one of the following:

- ☐ INSTALL STANDARD BATHROOM ACCESSORIES THRU OUT
(tissue holder + towel bar) **location as per vendors discretion**
- ☒ ***DO NOT*** INSTALL STANDARD BATHROOM ACCESSORIES
THRU OUT **tissue holder + towel bar will not be provided**

LOT # PV-83

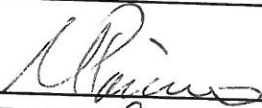
DATE: March 29, 2021

SIGNATURE:  

SIGNATURE:  



PINE VALLEY

FOREVERGREEN

Range Hood - Aspen Modern

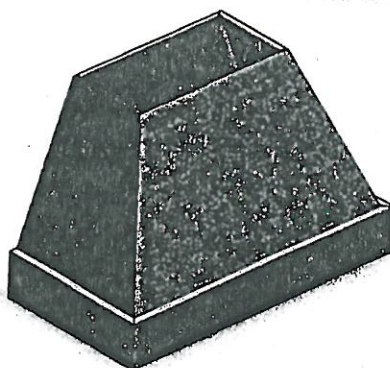

Lot#

88

Room:

Kitchen

Signature:

[Handwritten Signature]

Date:

MARCH 29 2021

Signature:

[Handwritten Signature]

GOLDPARK
WORTH MORE™



Project: Pine Valley

Lot: 83

Purchaser(s): Michael Paiano & Laura Lee

Standard Hood Fan Deletion

We acknowledge that the builder's standard hood fan will not be installed.
Do not supply, install and/or credit. We will install our own hood fan after closing.

Signature:  

Signature:  

Date: March 29, 2021

PV-83
March 29, 2021

AP

AP

VCIN48GWS

48-INCH CUSTOM INSERT

PROFESSIONAL® SERIES

Thermador

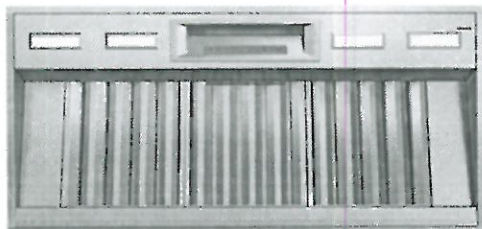

Home Connect

FEATURES & BENEFITS

- Revel in creative freedom with Professional® Series custom inserts that can blend in with cabinetry or make a bold statement
- ★- Equipped with the Thermador Connected Experience by Home Connect™
- Powerfully Quiet® system accepts integral, inline, and remote blowers
- Beautiful illumination with multi-level, vivid LED lights
- Features automatic mode, delay shut-off, and check filter light

ACCESSORIES (OPTIONAL)

25 ft. Blower Connector Cable - EXTNCB25W

For use with the following inline and remote blowers: VTR630W, VTR1030W, VTR1330W, VTI610W, VTI1010W

Roofplates

RFPLT600P - For use with 600 CFM remote blower VTR630W

RFPLT1000P - For use with 1000 CFM remote blower VTR1030W and 1300 CFM blower VTR1330W

VCIN Trim Notes

NOTE: VCIN_GWS series custom insert models include hood trim pieces to complete the installation.

Remote Control Panel

REMCPUW - Ability to vertically install on cabinetry or wall to control hood in a convenient location

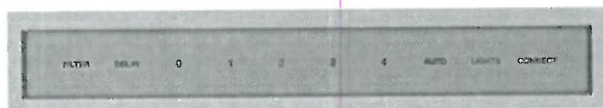

GENERAL PROPERTIES

Features

Multi-Level LED Lights with Fading Transitions, Automatic Mode, Check Filter Reminder Light, Delay Shut-Off

Operating Mode	Ducted
Maximum CFM	Blower Sold Separately
Number of Speed Settings	4-Stage
Number of Lights	4
Bulb Type	LED
Light Lumens	100 – 150
Light Color (°K)	3500 – 4000
Total Power of the Lamps (W)	4.8 W
Damper Included	Yes
Grease Filter Material	Washable Stainless Steel
Grease Filter Type	Stainless-Steel Commercial Style Baffle Filter
Home Connect™ (Wi-Fi Enabled)	Yes

TECHNICAL DETAILS

Watts (W)	See Chart on Page 3
Current (A)	See Chart on Page 3
Volts (V)	120 V
Frequency (Hz)	60 Hz
Plug Type	Fixed Connection
Power Cord / Conduit Length (in)	Direct Wire at Junction Box

DIMENSIONS & WEIGHT

Overall Appliance Dimensions (Width of Canopy Included) (HxWxD) (in)	12 13/16" x 45 3/4" x 22"
Minimum Required Distance Above Gas / Electric Cooking Surface	30" Electric / 30" Gas
Diameter of Air Duct (in.) Top	10"
Net Weight (lbs)	65 lbs

ACCESSORIES (REQUIRED)

Blower (Sold Separately)

BLOWER OPTIONS

Remote Blowers (Mounted to Roof or External Wall)	VTR630W - 600 CFM
	VTR1030W - 1000 CFM
	VTR1330W - 1300 CFM
Inline Blowers (Mounted Between Kitchen and External Wall)	VTI610W - 600 CFM
	VTI1010W - 1000 CFM
Integrated Blower (Mounted in Hood)	VTN630W - 600 CFM
	VTN1090R - 1000 CFM

WARRANTY

Limited Warranty Parts and Labor	2 Year
----------------------------------	--------

★ THERMADOR® EXCLUSIVE

PR-83
March 29, 2021

MP

AP

VCIN48GWS

48-INCH CUSTOM INSERT

PROFESSIONAL® SERIES

Thermador 

HOOD DIMENSIONS

NOTE: VCIN Custom Insert models include hood trim pieces.

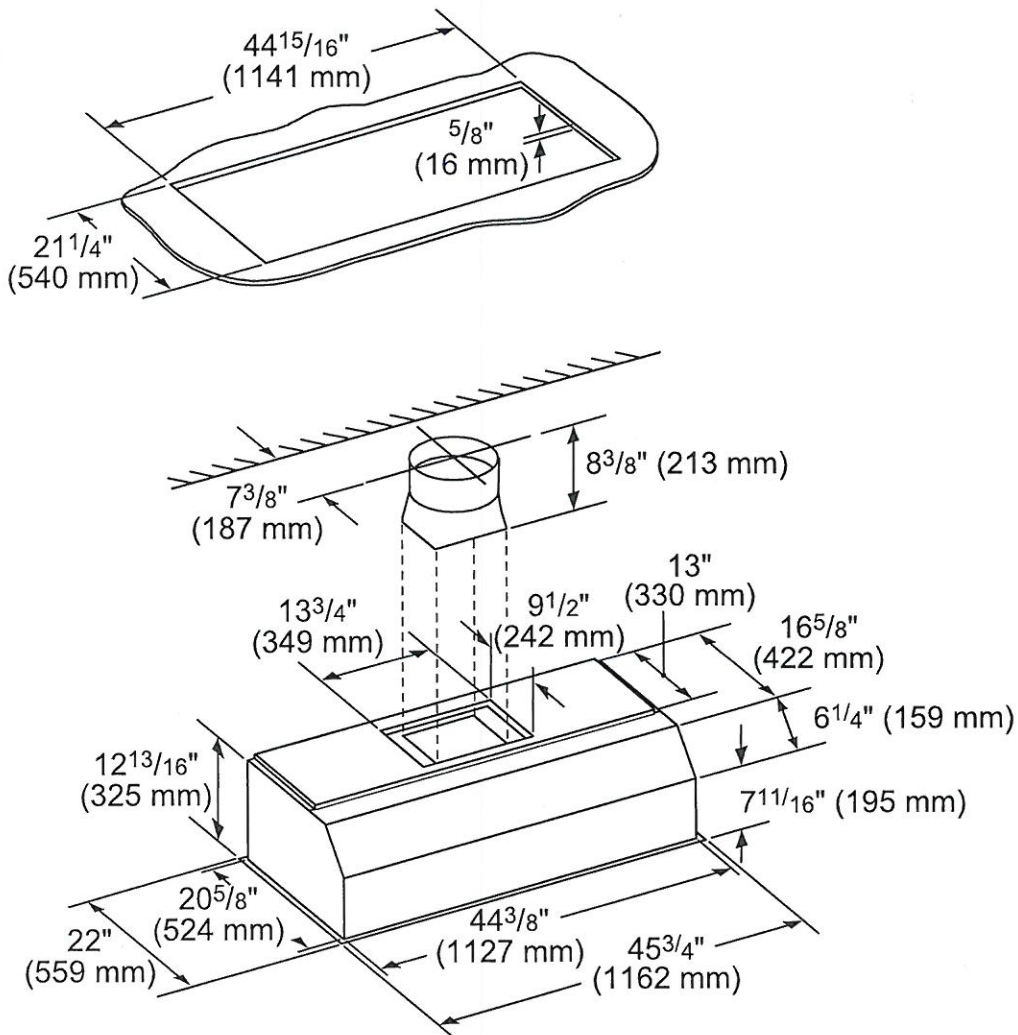

measurements in inches (mm)