



CONSTRUCTION SUMMARY

Lot: 33  
Model: 40.02 B VALLEYVIEW  
Project/Phase: Pine Valley Forevergreen / 1

APPLIANCES

Invoice	Qty.	Description
2663  25Mar21 NoCat	1	APPLIANCE SPECIFICATIONS ATTACHED - SIGNED COPY
2810 72,217 23Jun21 **	1	KITCHEN - UPGRADE TO 8" DUCT ( EXTERIOR WALL) IN LIEU OF STANDARD OFFERING
2810  23Jun21 ** NoCat	1	KITCHEN - UPGRADE TO 8" DUCT ( EXTERIOR WALL) IN LIEU OF STANDARD OFFERING

BASEMENT WINDOWS

Invoice	Qty.	Description
2683 72,351 22Apr21	4	BASEMENT WINDOWS - UPGRADE BASEMENT WINDOW SIZE TO 30 " X 24" - 8" FRAME
2683  22Apr21 ** NoCat	1	BASEMENT WINDOWS - UPGRADE BASEMENT WINDOW SIZE TO 30 " X 24" - 8" FRAME

CERAMIC

Invoice	Qty.	Description
2738  07May21 NoCat	1	FYI - **CUSTOM LAYOUT** MASTER ENSUITE: RELOCATE STANDARD FREE STANDING TUB TO CENTER WITH WINDOW ON SIDE EXTERIOR WALL
2810 37 23Jun21	1	FOYER: TILE, FLOOR - LEVEL 5 - 12x24" LAID IN STRAIGHT STACKED PATTERN - SEE PLAN FOR DIRECTION
2810 37 23Jun21	1	POWDER ROOM: TILE, FLOOR - LEVEL 5 - 12x24" LAID IN STRAIGHT STACKED PATTERN - SEE PLAN FOR DIRECTION
2810 37 23Jun21	1	MASTER ENSUITE: TILE, FLOOR , LEVEL 5 - 12X24" LAID IN STRAIGHT, STACKED PATTERN. SEE PLAN FOR TILE DIRECTION
2810 43 23Jun21	1	MASTER ENSUITE: TILE, SHOWER FLOOR, LEVEL 2 - HEX
2810 50 23Jun21	1	MASTER ENSUITE: TILE, WALL, LEVEL 4 - 16X48" LAID IN VERTICAL STACKED PATTERN.
2810 19 23Jun21	1	MASTER ENSUITE: TILE GROUT UPGRADE, FLOOR , UPG GROUT



CONSTRUCTION SUMMARY

Lot: 33  
Model: 40.02 B VALLEYVIEW  
Project/Phase: Pine Valley Forevergreen / 1

CERAMIC

Invoice	Qty.	Description
2810 35 23Jun21	1	ENSUITE 2: TILE, FLOOR , LEVEL 3 - 12X24" LAID IN STRAIGHT, STACKED PATTERN. SEE PLAN FOR TILE DIRECTION
2810 50 23Jun21	1	ENSUITE 2: TILE, WALL, LEVEL 4 - 10X30" LAID IN VERTICAL STACKED PATTERN.
2810 35 23Jun21	1	SHARED ENSUITE: TILE, FLOOR , LEVEL 3 - 12X24" LAID IN STRAIGHT, STACKED PATTERN. SEE PLAN FOR TILE DIRECTION
2810 36 23Jun21	1	SHARED ENSUITE: TILE, FLOOR , LEVEL 4 - 10X30" LAID IN VERTICAL STACKED PATTERN.
2810  23Jun21 NoCat	1	KITCHEN: VINTAGE SERIES, 5" WHITE OAK, NSS ENGINEERED HARDWOOD, 3/4" THK, SCULPTED TEXTURE, UVF FINISH - LEVEL 4  KITCHEN: DO NOT SUPPLY / INSTALL CERAMIC - CREDIT

CONCRETE AND DRAIN

Invoice	Qty.	Description
2683 101,930 22Apr21	1	BACK FLOW PREVENTER VALVE
2683  22Apr21 NoCat	1	OPTIONAL COLD CELLAR BELOW LOGGIA - SEE PLAN



CONSTRUCTION SUMMARY

Lot: 33  
Model: 40.02 B VALLEYVIEW  
Project/Phase: Pine Valley Forevergreen / 1

DRYWALL

Invoice	Qty.	Description
2683 72,351 22Apr21 **	4	BASEMENT WINDOWS - UPGRADE BASEMENT WINDOW SIZE TO 30 " X 24" - 8" FRAME
2683  22Apr21 NoCat	1	**CUSTOM LAYOUT** LAUNDRY ROOM: DELETE EXISTING CLOSET - SEE PLAN  INCLUDED IN APS
2683  22Apr21 NoCat	1	**CUSTOM LAYOUT** SHARED ENSUITE: DELETE NIB WALLS AND PRIVACY DOOR - SEE PLAN  INCLUDED IN APS
2683  22Apr21 ** NoCat	1	BASEMENT WINDOWS - UPGRADE BASEMENT WINDOW SIZE TO 30 " X 24" - 8" FRAME
2683  22Apr21 NoCat	1	GARAGE: ADD SERVICE STAIRS
2738 07May21 NoCat	1	**CUSTOM LAYOUT** DELETE TWO (2) STANDARD SIDE EXTERIOR WINDOWS
2738 07May21 NoCat	1	**CUSTOM LAYOUT** RELOCATE FOYER CLOSET PER SKETCH - EXTEND FLOOR TILE TO WALL OF POWDER ROOM. RELOCATE STANDARD TRIMMED ARCH TO BE AT WALL OF POWDER ROOM
2738 07May21 NoCat	1	**CUSTOM LAYOUT** INSTALL KNEE WALL APPROX 42" HIGH IN LIEU OF STANDARD FULL HEIGHT WALL AT SERVICE STAIRS - DELETE DOOR TO BASEMENT  IF LAUNDRY ROOM IS SUNKEN - THERE WILL BE A FULL WALL AT STEPS TO MAIN HALL



CONSTRUCTION SUMMARY

Lot: 33  
Model: 40.02 B VALLEYVIEW  
Project/Phase: Pine Valley Forevergreen / 1

ELECTRICAL

Invoice	Qty.	Description
2683 72,351 22Apr21 **	4	BASEMENT WINDOWS - UPGRADE BASEMENT WINDOW SIZE TO 30 " X 24" - 8" FRAME
2683  22Apr21 NoCat	1	**CUSTOM LAYOUT** LAUNDRY ROOM: DELETE EXISTING CLOSET - SEE PLAN  INCLUDED IN APS
2683  22Apr21 NoCat	1	**CUSTOM LAYOUT** SHARED ENSUITE: DELETE NIB WALLS AND PRIVACY DOOR - SEE PLAN  INCLUDED IN APS
2683  22Apr21 NoCat	1	GARAGE: ADD SERVICE STAIRS  INCLUDED IN APS
2683  22Apr21 NoCat	1	OPTIONAL COLD CELLAR BELOW LOGGIA - SEE PLAN
2683  22Apr21 ** NoCat	1	BASEMENT WINDOWS - UPGRADE BASEMENT WINDOW SIZE TO 30 " X 24" - 8" FRAME
2738 07May21 NoCat	1	FRONT FOYER: DELETE STANDARD COACH LIGHT - INSTALL CAPPED CEILING LIGHT ON STANDARD SWITCH - INSTALL APPROX CENTER OF PORCH CEILING
2738 07May21 NoCat	1	FRONT ELEVATION: DELETE TWO (2) STANDARD EXTERIOR GARAGE LIGHTS
2738 72,307 07May21	1	KITCHEN: FIXTURE: RELOCATE STANDARD CEILING MOUNT FIXTURE - LOCATE APPROX CENTER ABOVE ISLAND
2738 07May21 NoCat	1	MASTER ENSUITE: RELOCATE STANDARD SHOWER POT LIGHT TO ACCOMMODATE RAIN SHOWER HEAD
2738 07May21 NoCat	1	REAR EXTERIOR - RELOCATE STANDARD REAR LIGHT - INSTALL CAPPED CEILING LIGHT IN APPROX CENTER OF LOGGIA
2738 07May21 NoCat	2	ENSUITE 2 + ENSUITE 3/4: RELOCATE STANDARD SHOWER POT LIGHT TO ACCOMMODATE RAIN SHOWER HEAD
2738 72,289 07May21	6	KITCHEN: 4" E/S LED INTERIOR POT LIGHT - GROUND FLOOR - EACH - INCLUDES 1 SWITCH  INCLUDED IN APS





CONSTRUCTION SUMMARY

Lot: 33  
Model: 40.02 B VALLEYVIEW  
Project/Phase: Pine Valley Forevergreen / 1

ELECTRICAL

Invoice	Qty.	Description
2738  07May21 NoCat	1	LAUNDRY: CHANGE LAUNDRY TO STACKING
2738  07May21 NoCat	1	**CUSTOM LAYOUT** DELETE TWO (2) STANDARD SIDE EXTERIOR WINDOWS
2738  07May21 NoCat	1	REAR EXTERIOR - RELOCATE STANDARD REAR LIGHT - INSTALL CAPPED CEILING LIGHT IN APPROX CENTER OF LOGGIA
2738  07May21 NoCat	1	**CUSTOM LAYOUT** RELOCATE FOYER CLOSET PER SKETCH - EXTEND FLOOR TILE TO WALL OF POWDER ROOM. RELOCATE STANDARD TRIMMED ARCH TO BE AT WALL OF POWDER ROOM
2738  07May21 NoCat	1	**CUSTOM LAYOUT** INSTALL KNEE WALL APPROX 42" HIGH IN LIEU OF STANDARD FULL HEIGHT WALL AT SERVICE STAIRS - DELETE DOOR TO BASEMENT  IF LAUNDRY ROOM IS SUNKEN - THERE WILL BE A FULL WALL AT STEPS TO MAIN HALL
2738  07May21 NoCat	1	ENSUITE 2: REPLACE STANDARD TUB TO FRAMELESS GLASS SHOWER ENCLOSURE WITH GLASS SHOWER DOOR - COMPLETE WITH BUILDERS STANDARD OFFERINGS
2810  23Jun21 NoCat	1	**NO ELECTRICAL OR GAS PURCHASED** PURCHASER WILL COMPLETE OWN AFTER CLOSING AT OWN EXPENSE AND WARRANTY
2810  23Jun21 NoCat	1	KITCHEN: UPGRADE TO FULL HEIGHT BACKSPLASH - LEVEL 5

EXTERIOR DOORS

Invoice	Qty.	Description
2738 72,363 07May21	1	GARAGE/HOUSE: INCREASED HEIGHT TO MAN DOOR FROM HOUSE TO GARAGE [ 32 X 94] TALL HEIGHT * WOOD FRAME - IF GRADE PERMITS [EACH]



CONSTRUCTION SUMMARY

Lot: 33  
Model: 40.02 B VALLEYVIEW  
Project/Phase: Pine Valley Forevergreen / 1

FORMING

Invoice	Qty.	Description
2683 101,930 22Apr21	1	GARAGE: ADD SERVICE STAIRS  INCLUDED IN APS
2683 72,383 22Apr21	1	MODEL OPTIONS 40.02 - REAR BREAKFAST ROOM - OPT. LOGGIA AS PER PLAN
2683 72,383 22Apr21	1	OPTIONAL COLD CELLAR BELOW LOGGIA - SEE PLAN



CONSTRUCTION SUMMARY

Lot: 33  
Model: 40.02 B VALLEYVIEW  
Project/Phase: Pine Valley Forevergreen / 1

FRAMING

Invoice	Qty.	Description
2683 101,930 22Apr21	1	**CUSTOM LAYOUT** LAUNDRY ROOM: DELETE EXISTING CLOSET - SEE PLAN  INCLUDED IN APS
2683 101,930 22Apr21	1	**CUSTOM LAYOUT** SHARED ENSUITE: DELETE NIB WALLS AND PRIVACY DOOR - SEE PLAN  INCLUDED IN APS
2683  22Apr21 NoCat	1	FYI - GARAGE: ADD SERVICE STAIRS  INCLUDED IN APS
2738  07May21 NoCat	2	**CUSTOM LAYOUT** DELETE TWO (2) STANDARD SIDE EXTERIOR WINDOWS
2738  07May21 NoCat	1	**CUSTOM LAYOUT** INSTALL KNEE WALL APPROX 42" HIGH IN LIEU OF STANDARD FULL HEIGHT WALL AT SERVICE STAIRS - DELETE DOOR TO BASEMENT  IF LAUNDRY ROOM IS SUNKEN - THERE WILL BE A FULL WALL AT STEPS TO MAIN HALL
2738  07May21 NoCat	1	**CUSTOM LAYOUT** RELOCATE FOYER CLOSET PER SKETCH - EXTEND FLOOR TILE TO WALL OF POWDER ROOM. RELOCATE STANDARD TRIMMED ARCH TO BE AT WALL OF POWDER ROOM  BASED ON STANDARD FINISHES
2738  07May21 NoCat	1	FRONT FOYER: DELETE STANDARD COACH LIGHT - INSTALL CAPPED CEILING LIGHT ON STANDARD SWITCH - INSTALL APPROX CENTER OF PORCH CEILING
2738  07May21 NoCat	1	FRONT ELEVATION: DELETE TWO (2) STANDARD EXTERIOR GARAGE LIGHTS
2738  07May21 NoCat	1	ENSUITE 2: REPLACE STANDARD TUB TO FRAMELESS GLASS SHOWER ENCLOSURE WITH GLASS SHOWER DOOR - COMPLETE WITH BUILDERS STANDARD OFFERINGS

GLASS AND MIRROR

Invoice	Qty.	Description
2738  07May21 NoCat	1	ENSUITE 2: REPLACE STANDARD TUB TO FRAMELESS GLASS SHOWER ENCLOSURE WITH GLASS SHOWER DOOR - COMPLETE WITH BUILDERS STANDARD OFFERINGS
2810  23Jun21 NoCat	3	MASTER ENSUITE/ ENSUITE 2/ SHARED ENSUITE: UPGRADE SHOWER DOOR HANDLE



CONSTRUCTION SUMMARY

Lot: 33  
Model: 40.02 B VALLEYVIEW  
Project/Phase: Pine Valley Forevergreen / 1

GRANITE MARBLE QUARTZ

Invoice	Qty.	Description
2810  23Jun21 NoCat	1	KITCHEN: UPGRADE QUARTZ COUNTERTOP - LEVEL 5
2810 74,430 23Jun21	1	QUARTZ, 60" WATERFALL LEG (PRICE PER LEG) - LEVEL 5  60" LEG ONLY AVAILABLE DEPENDING ON MATERIAL SIZE (MUST BE CONFIRMED PRIOR TO PURCHASE)
2810  23Jun21 NoCat	1	KITCHEN: UPGRADE TO FULL HEIGHT BACKSPLASH - LEVEL 5
2810  23Jun21 NoCat	1	POWDER ROOM: UPGRADE 5 QUARTZ COUNTER
2810  23Jun21 NoCat	1	MASTER ENSUITE: UPGRADE 2 QUARTZ COUNTER
2810  23Jun21 NoCat	1	ENSUITE 2: UPGRADE 3 QUARTZ COUNTER
2810  23Jun21 NoCat	1	SHARED ENSUITE: UPGRADE 3 QUARTZ
2810  23Jun21 NoCat	1	KITCHEN: UPGRADE SINK - SUPER SINGLE
2810  23Jun21 ** NoCat	1	QUARTZ, 60" WATERFALL LEG (PRICE PER LEG) - LEVEL 5  60" LEG ONLY AVAILABLE DEPENDING ON MATERIAL SIZE (MUST BE CONFIRMED PRIOR TO PURCHASE)

HARDWOOD

Invoice	Qty.	Description
2810 6 23Jun21	1	KITCHEN: VINTAGE SERIES, 5" WHITE OAK, NSS ENGINEERED HARDWOOD, 3/4" THK, SCULPTED TEXTURE, UVF FINISH - LEVEL 4
2810 6 23Jun21	1	THRU OUT STANDARD AREAS: VINTAGE SERIES, 5" WHITE OAK, NSS ENGINEERED HARDWOOD, 3/4" THK, SCULPTED TEXTURE, UVF FINISH - MAIN HALL, GREAT ROOM, DINING ROOM, UPPER HALL, MASTER BEDROOM, BEDROOM 2, BEDROOM 3, BEDROOM 4 - LEVEL 4



CONSTRUCTION SUMMARY

Lot: 33  
Model: 40.02 B VALLEYVIEW  
Project/Phase: Pine Valley Forevergreen / 1

HVAC

Invoice	Qty.	Description
2738  07May21 NoCat	1	LAUNDRY: CHANGE LAUNDRY TO STACKING
2810 72,217 23Jun21	1	KITCHEN - UPGRADE TO 8" DUCT ( EXTERIOR WALL) IN LIEU OF STANDARD OFFERING
2810  23Jun21 NoCat	1	**NO ELECTRICAL OR GAS PURCHASED** PURCHASER WILL COMPLETE OWN AFTER CLOSING AT OWN EXPENSE AND WARRANTY
2810  23Jun21 ** NoCat	1	KITCHEN - UPGRADE TO 8" DUCT ( EXTERIOR WALL) IN LIEU OF STANDARD OFFERING

INTERIOR TRIM /MOULDINGS

Invoice	Qty.	Description
2683 72,351 22Apr21 **	4	BASEMENT WINDOWS - UPGRADE BASEMENT WINDOW SIZE TO 30 " X 24" - 8" FRAME
2683  22Apr21 ** NoCat	1	BASEMENT WINDOWS - UPGRADE BASEMENT WINDOW SIZE TO 30 " X 24" - 8" FRAME



CONSTRUCTION SUMMARY

Lot: 33  
Model: 40.02 B VALLEYVIEW  
Project/Phase: Pine Valley Forevergreen / 1

INTERIOR TRIM AND DOORS

Invoice	Qty.	Description
2683  22Apr21 NoCat	1	**CUSTOM LAYOUT** LAUNDRY ROOM: DELETE EXISTING CLOSET - SEE PLAN  INCLUDED IN APS
2683  22Apr21 NoCat	1	**CUSTOM LAYOUT** SHARED ENSUITE: DELETE NIB WALLS AND PRIVACY DOOR - SEE PLAN  INCLUDED IN APS
2683  22Apr21 NoCat	1	OPTIONAL COLD CELLAR BELOW LOGGIA - SEE PLAN
2683  22Apr21 NoCat	1	GARAGE: ADD SERVICE STAIRS
2738  07May21 NoCat	1	**CUSTOM LAYOUT** DELETE TWO (2) STANDARD SIDE EXTERIOR WINDOWS
2738  07May21 NoCat	1	**CUSTOM LAYOUT** RELOCATE FOYER CLOSET PER SKETCH - EXTEND FLOOR TILE TO WALL OF POWDER ROOM. RELOCATE STANDARD TRIMMED ARCH TO BE AT WALL OF POWDER ROOM
2738  07May21 NoCat	1	**CUSTOM LAYOUT** INSTALL KNEE WALL APPROX 42" HIGH IN LIEU OF STANDARD FULL HEIGHT WALL AT SERVICE STAIRS - DELETE DOOR TO BASEMENT  IF LAUNDRY ROOM IS SUNKEN - THERE WILL BE A FULL WALL AT STEPS TO MAIN HALL
2810 153,783 23Jun21	1	THRU OUT: HALIFAX LEVER, IRON BLACK INTERIOR DOOR HARDWARE  UPGRADE
2810 155,861 23Jun21	1	THRU OUT: ADD FOR HINGES 3X3 SQUARE FLAT TIP THROUGHOUT  UPGRADE
2810 153,299 23Jun21	1	THRU OUT: UPGRADE 3 1/4" STEP BEVEL BB CASING, 7 1/4" BASE BOARD  UPGRADE
2810 155,213 23Jun21	1	THRU OUT: UPGRADE INTERIOR DOORS TO LOGAN,  UPGRADE



CONSTRUCTION SUMMARY

Lot: 33  
Model: 40.02 B VALLEYVIEW  
Project/Phase: Pine Valley Forevergreen / 1

KITCHEN AND BATH CABINETRY

Invoice	Qty.	Description
2738  07May21 NoCat	1	FYI - LAUNDRY: CHANGE LAUNDRY TO STACKING
2810  23Jun21 NoCat	1	THRU OUT: SEE ATTACHED CABINETRY SCHEDULE
2810 72,217 23Jun21 **	1	KITCHEN - UPGRADE TO 8" DUCT ( EXTERIOR WALL) IN LIEU OF STANDARD OFFERING
2810  23Jun21 NoCat	1	KITCHEN - UPGRADE TO 8" DUCT ( EXTERIOR WALL) IN LIEU OF STANDARD OFFERING

MASONRY

Invoice	Qty.	Description
2738  07May21 NoCat	1	FRONT FOYER: DELETE STANDARD COACH LIGHT - INSTALL CAPPED CEILING LIGHT ON STANDARD SWITCH - INSTALL APPROX CENTER OF PORCH CEILING
2738  07May21 NoCat	1	FRONT ELEVATION: DELETE TWO (2) STANDARD EXTERIOR GARAGE LIGHTS
2738  07May21 NoCat	1	**CUSTOM LAYOUT** DELETE TWO (2) STANDARD SIDE EXTERIOR WINDOWS



CONSTRUCTION SUMMARY

Lot: 33  
Model: 40.02 B VALLEYVIEW  
Project/Phase: Pine Valley Forevergreen / 1

PAINT

Invoice	Qty.	Description
2683  22Apr21 NoCat	1	**CUSTOM LAYOUT** LAUNDRY ROOM: DELETE EXISTING CLOSET - SEE PLAN  INCLUDED IN APS
2683  22Apr21 NoCat	1	**CUSTOM LAYOUT** SHARED ENSUITE: DELETE NIB WALLS AND PRIVACY DOOR - SEE PLAN  INCLUDED IN APS
2683  22Apr21 NoCat	1	OPTIONAL COLD CELLAR BELOW LOGGIA - SEE PLAN
2738  07May21 NoCat	1	**CUSTOM LAYOUT** DELETE TWO (2) STANDARD SIDE EXTERIOR WINDOWS
2738  07May21 NoCat	1	**CUSTOM LAYOUT** RELOCATE FOYER CLOSET PER SKETCH - EXTEND FLOOR TILE TO WALL OF POWDER ROOM. RELOCATE STANDARD TRIMMED ARCH TO BE AT WALL OF POWDER ROOM
2738  07May21 NoCat	1	**CUSTOM LAYOUT** INSTALL KNEE WALL APPROX 42" HIGH IN LIEU OF STANDARD FULL HEIGHT WALL AT SERVICE STAIRS - DELETE DOOR TO BASEMENT  IF LAUNDRY ROOM IS SUNKEN - THERE WILL BE A FULL WALL AT STEPS TO MAIN HALL
2810  23Jun21 NoCat	2	MAIN STAIRS: 2ND FLOOR TO BASEMENT: STAIN STAIRS AND LANDINGS  WILL NOT MATCH HARDWOOD IN COLOUR, SPECIES, OR TEXTURE





CONSTRUCTION SUMMARY

Lot: 33  
Model: 40.02 B VALLEYVIEW  
Project/Phase: Pine Valley Forevergreen / 1

PLUMBING

Invoice	Qty.	Description
2738  07May21 NoCat	1	LAUNDRY: CHANGE LAUNDRY TO STACKING
2738  07May21 NoCat	1	KITCHEN: RELOCATE SINK TO APPROX CENTER OF KITCHEN ISLAND
2738 72,350 07May21	1	ENSUITE 2: REPLACE STANDARD TUB TO FRAMELESS GLASS SHOWER ENCLOSURE WITH GLASS SHOWER DOOR - COMPLETE WITH BUILDERS STANDARD OFFERINGS
2738  07May21 NoCat	1	**CUSTOM LAYOUT** MASTER ENSUITE: RELOCATE STANDARD FREE STANDING TUB TO CENTER WITH WINDOW ON SIDE EXTERIOR WALL
2738  07May21 NoCat	1	MASTER ENSUITE: INSTALL MOEN 'ARRIS' FREE-STANDING TUB FILLER - CHROME
2738  07May21 NoCat	1	MASTER ENSUITE: MOEN 'ARRIS' RAIN SHOWER (from ceiling) + HAND SHOWER/SLIDE BAR
2738  07May21 NoCat	2	ENSUITE 2 + ENSUITE 3/4: UPGRADE TO MOEN 'ARRIS' RAIN SHOWER (from ceiling) + HAND SHOWER/SLIDE BAR - CHROME
2738  07May21 NoCat	1	LAUNDRY: CHANGE LAUNDRY TO STACKING
2810  23Jun21 NoCat	1	KITCHEN: UPGRADE SINK - SUPER SINGLE - BLANCO QUATRUS SUPER SINGLE - 401518

STAIR AND RAILINGS

Invoice	Qty.	Description
2810 93,780 23Jun21	2	MAIN STAIRS: UPGRADE - EURONLINE (ALL PLAIN) PICKET, 3" HALF-ROUND W/V-GROOVE HANDRAIL, 3 1/2" ALL SQUARE POST WITH PYRAMID TOP POST CAP - PACKAGE A-2



CONSTRUCTION SUMMARY

Lot: 33  
Model: 40.02 B VALLEYVIEW  
Project/Phase: Pine Valley Forevergreen / 1

STAIRS AND RAILINGS

Invoice	Qty.	Description
2683	1	GARAGE: ADD SERVICE STAIRS
22Apr21 NoCat		INCLUDED IN APS

WINDOWS AND DOORS

Invoice	Qty.	Description
2683 72,351 22Apr21 **	4	BASEMENT WINDOWS - UPGRADE BASEMENT WINDOW SIZE TO 30 " X 24" - 8" FRAME
2683  22Apr21 ** NoCat	1	BASEMENT WINDOWS - UPGRADE BASEMENT WINDOW SIZE TO 30 " X 24" - 8" FRAME
2738  07May21 NoCat	1	**CUSTOM LAYOUT** DELETE TWO (2) STANDARD SIDE EXTERIOR WINDOWS

PV - 33 Cabinetry Schedule

ROOM	DESCRIPTION	PRICE	QTY	TOTAL
KITCHEN	UPGRADE PERIMETER FROM SERIES 2 TO SERIES 5 - MEDIO 6 'OYSTER'		1	
	RETURN TRIP FOR HARDWOOD		1	
	VALANCE ONLY *NO ELECTRICAL*		1	
	***NOTE: PURCHASER WILL BE DOING OWN ELECTRICAL AND GAS AFTER CLOSING AT THEIR OWN EXPENSE AND WARRANTY			
	ADJUST BASE CABINETRY FOR 36" RANGETOP (N/C)		1	
	ADD POTS AND PANS DRAWERS BELOW RANGETOP		1	
	LEAVE 42" SPACE IN UPPER CABINETS ABOVE RANGETOP FOR FUTURE 36" CHIMNEY (N/C)		1	
	CONVERT STANDARD CABINETRY TO TALL, DEEP BUILT IN OVEN UNIT WITH DRAWER BELOW		1	
	ADD SPICE PULL OUT ACCESSORY TO BASE CABINET ON RIGHT SIDE OF RANGE		1	
	MAKE SMALL SWING DOOR ON LEFT SIDE OF RANGE THE SAME SIZE AS SPICE (N/C)		1	
ISLAND	UPGRADE FROM SERIES 2 TO SERIES 6 - MEDIO 6 'ANTHRACITE'		1	
	ADD TWO BIN RECYCLE CENTRE TO ISLAND		1	
	ADD OVERSIZED DÉCOR PANEL + PROUD FURNITURE KICK TO ONE SIDE OF ISLAND		1	
	ADD PROUD FURNITURE KICK TO REAR ISLAND		1	
POWDER ROOM	UPGRADE FROM SERIES 2 TO SERIES 5 - MEDIO 6 'CLAY'		1	
	UPGRADE HARDWARE: BH-081-03		1	
MASTER ENSUITE	UPGRADE FROM SERIES 2 TO SERIES 5 - MEDIO 6 'OYSTER'		1	
	UPGRADE HARDWARE: BH-081-03		1	
CABINETRY TOTAL:				

\*\*\*NO HARDWARE / NO HOLES THRU OUT - PURCHASER IS RESPONSIBLE FOR THE INSTALLATION OF THEIR OWN HARDWARE AFTER CLOSING AT THEIR OWN EXPENSE AND WARRANTY\*\*\*

LOT #: PV- 33

DATE: June 14, 2021

SIGNATURE:



SIGNATURE:

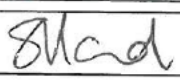

Scheduled Closing Date: November 1, 2021

Purchasers: CRISTIAN VLAD & SANDRA PORCELLI-VLAD Property: 33 of Plan -

Telephone Res. / Bus: /

Project: Pine Valley Forevergreen - Phase 1

Decor Advisor: Angela Phim

Model and Elevation: 40.02 B VALLEYVIEW

Layout Changes: ☒ Yes ☐ No

Sketch Attached: ☒ Yes ☐ No

Exterior Colour Scheme:

## 1. Cabinetry

	Style and Colour	Counter	Hardware
Kitchen / Breakfast	*2-Tone	*Quartz: 'Empira White'	attachd
Laundry Room	Chesapeake 'Classic White'	P-Lam 'White'	attachd
Powder Room	*Medio 6 'Clay'	*Quartz: 'Eternal Statuario'	attachd
Master Ensuite Bathroom	*Medio 6 'Oyster'	*Quartz: 'Blizzard'	attachd
Second Ensuite Bathroom (If Applicable)	Chesapeake 'Classic White'	*Quartz: 'Frosty Carina'	attachd
Ensuite 3/4	Chesapeake 'Classic White'	*Quartz: 'Frosty Carina'	attachd

### Comment

Kitchen Cabinetry: Perimeter: \*Medio 6 'Oyster' + Island: \*Medio 6 'Anthracite'

## 2. Floor Tile

	Selection
Entrance Vestibule	*12x24" Marmorea 'Breccia White' matte
Main Hall	n/a
Kitchen / Breakfast	*See hardwood
Laundry Room	13x13" New Byzantine 'Azzuro Blue'
Powder Room	*12x24" Marmorea 'Breccia White' polished
Master Ensuite Bathroom	*12x24" Marmorea 'Armani Grey' matte + *CHARCOAL GROUT*
Second Ensuite Bathroom (If Applicable)	*12x24" Eterna 'Medium Grey' matte
Lower Landing (If Applicable)	13x13" New Byzantine 'Azzuro Blue'
Ensuite 3/4	*12x24" Eterna 'Medium Grey' matte

### Comment

Master Ensuite Shower Floor: \*Quebec 'Black' HEX +CHARCOAL GREOUT / thru-out shower floors: 2x2 Standard 'White'

## 3. Wall Tile

	Selection	Listello/Inserts	Describe
Master Ensuite Bathroom		<input type="radio"/> Yes <input checked="" type="radio"/> No	
Tub Deck		<input type="radio"/> Yes <input checked="" type="radio"/> No	
Shower Stall	*16x48 3D Bow Tie Bright 'Blanco'	<input type="radio"/> Yes <input checked="" type="radio"/> No	
Bathroom Walls		<input type="radio"/> Yes <input checked="" type="radio"/> No	
Second Ensuite Bathroom (If Applicable)	*10x30" Roma Filo 'Statuario' Decor	<input type="radio"/> Yes <input checked="" type="radio"/> No	
Ensuite 3/4	*10x30" Roma Filo 'Statuario' Decor	<input type="radio"/> Yes <input checked="" type="radio"/> No	
Kitchen Backsplash	<input checked="" type="radio"/> Yes <input type="radio"/> No	Backsplash Behind Fridge	
Comment	*FHBS same as counter		

CU

SA



Scheduled Closing Date: November 1, 2021

Purchasers: CRISTIAN VLAD & SANDRA PORCELLI-VLAD Property: 33 of Plan -

Telephone Res. / Bus: /

Project: Pine Valley Forevergreen - Phase 1

Decor Advisor: Angela Phim

Model and Elevation: 40.02 B VALLEYVIEW

4. Plumbing Fixtures

Master Ensuite Bathroom Second Ensuite Powder Room
Other Room - Specify Other Washroom

Comment

\*see attached upgrade plumbing

5. Hardwood Flooring

Main Hall Kitchen / Breakfast Living Room Dining Room Family Room Den/Library Entrance Vestibule Lower Landing (If Applicable)
Type and Stain
Upper Landing Upper Hall Master Bedroom Bedroom #2 Bedroom #3 Bedroom #4 Bedroom #5 Other Room - Specify thru-out stand areas

Comment

6. Carpeting

Ground Floor Second Floor
Upgrade Description

Upgrade Underpad Type Area
Carpet on Stairs Capped Runner - \*Upgrade

Comment

7. Fireplace

Living Room Family Room Other Room - Specify Great Room
Purchased As Per Plan N/A
Fireplace Type Mantle Type Colour / Stain Surround Hearth

Comment

Handwritten initials and signature

Scheduled Closing Date: November 1, 2021

Purchasers: CRISTIAN VLAD &amp; SANDRA PORCELLI-VLAD Property: 33 of Plan -

Telephone Res. / Bus: /

Project: Pine Valley Forevergreen - Phase 1

Decor Advisor: Angela Phim

Model and Elevation: 40.02 B VALLEYVIEW

## 8. Trim Carpentry

Interior Doors \*Logan Front Door Glass Inserts std Door Handles \*HalifaxBlk+Hinges

Interior Trim \*Board 6

Comment

## 9. Plaster Mouldings and Medallions

Standard Throughout ☐ Yes ☐ No ☐ N/A

Entrance Vestibule

Main Hall

Living Room

Dining Room

Family Room

Kitchen/Breakfast

Den/Library

Lower Landing

Other Room - Specify

Comment

## 10. Railings and Spindles

Railing Package \*Package A-2

Railing Colour \*Vintage: 'Gotham'

Stringer / Riser \*Vintage: 'Gotham'

Spindle Colour \*Black

Treads \*Vintage: 'Gotham'

Comment

Oak Stairs ☒ Yes ☐ No ☐ N/A

## 11. Wall Paint / Ceilings

Throughout Finished Areas Warm Grey

Trim Paint White

Smooth Ceilings

Ground Floor ☒Second Floor ☒

Note

Comment



Scheduled Closing Date: November 1, 2021

Purchasers: CRISTIAN VLAD &amp; SANDRA PORCELLI-VLAD Property: 33 of Plan -

Telephone Res. / Bus: /

Project: Pine Valley Forevergreen - Phase 1

Decor Advisor: Angela Phim

Model and Elevation: 40.02 B VALLEYVIEW

## 12. Electrical

Hood Fan ☐ White ☐ Stainless ☐ N/AAbove Kitchen Cabinet Light ☐ Yes ☒ NoBelow Kitchen Cabinet Light ☐ Yes ☒ NoStandard Appliances ☐Over The Range Microwave ☐Chimney Style Fan ☐

Comment

## 13. Heating and Air Conditioning

Air Conditioning Gas Provisions Stove Gas Provisions Dryer Gas Provisions Barbecue 

Comment

## 14. Additional Comments

## 15. Disclaimers and Notes

- 1) Colours of all materials are as close as possible to builder's selection, but not necessarily identical due to variances in manufacturing.
- 2) Any extras listed above are null and void unless accompanied by a separate invoice/amendment. Said invoice must be paid in full.
- 3) The Purchaser acknowledges that after Interior Colour Selection form is signed and dated, no further changes will be permitted other than re-selection due to unavailability. \_\_\_\_\_ Purchaser's Initials
- 4) The Purchaser acknowledges reading and accepting the "Gold Park Homes Decor Centre Disclaimers" form. This document contains other miscellaneous disclaimers.

This Interior Colour Selection is final and approved by:

Signature:  Date: June 14, 2021





SCHEDULE 'F'

PV-33

April 20, 2021

MAY 2 2021



attach  
PV-33  
June 14, 2021

# The Valleyview

## 40' SERIES

Elevation A • 3,145 sq.ft.  
Elevation B • 3,170 sq.ft.

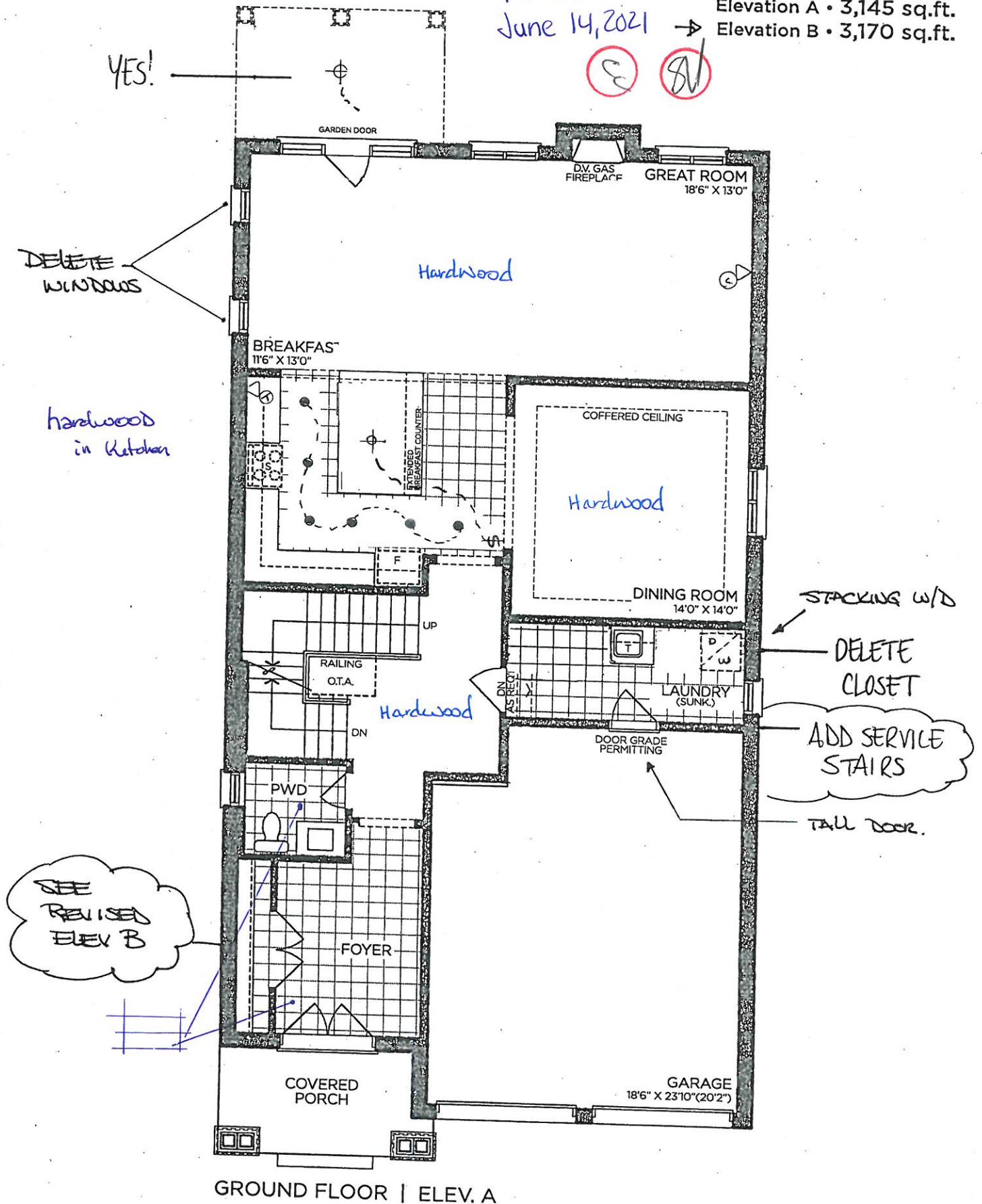

GROUND FLOOR | ELEV. A

VENDOR

PURCHASER

PURCHASER

**GOLDPARK**  
WORTH MORE™

Prices, figures, illustrations, sizes, features and finishes are subject to change without notice. Areas and dimensions are approximate and actual usable floor space may vary from the stated area. Layout may be reverse of the unit purchased. E. & O.E. 4002





SCHEDULE 'F'

PV-33  
April 20, 2021

PV-33  
June 14, 2021

PV-33  
MAY 2 2021

add

# The Valleyview 40' SERIES

Elevation A • 3,145 sq.ft.

→ Elevation B • 3,170 sq.ft.

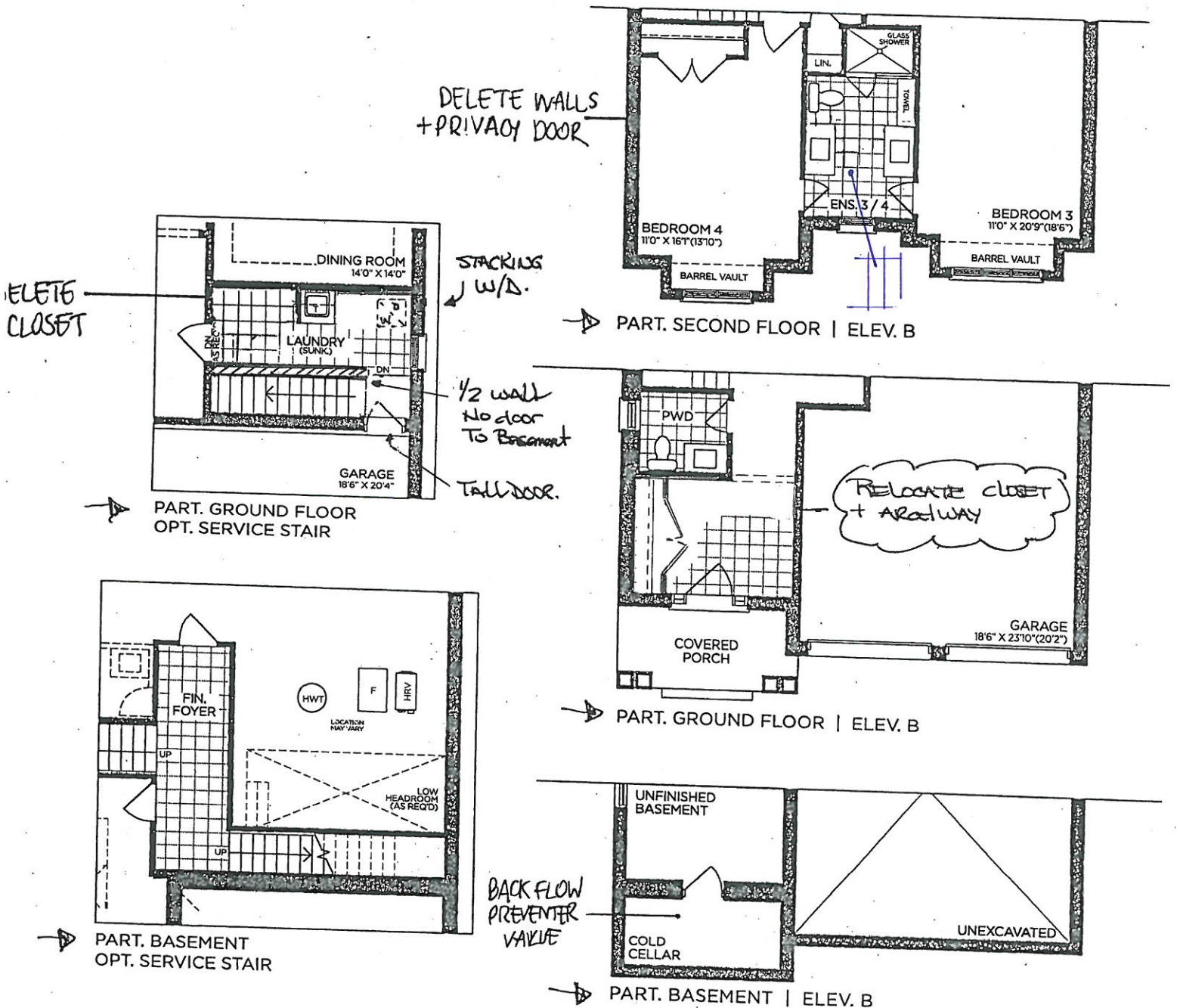

VENDOR

PURCHASER

PURCHASER

**GOLDPARK**  
WORTH MORE™

Prices, figures, illustrations, sizes, features and finishes are subject to change without notice. Areas and dimensions are approximate and actual usable floor space may vary from the stated area. Layout may be reverse of the unit purchased. E. & O.E. 4002



SCHEDULE 'F'

PV-33

April 20, 2021

MAY 2 2021

attad

PV-33

June 14, 2021

# The Valleyview

40' SERIES

Elevation A • 3,145 sq.ft.

Elevation B • 3,170 sq.ft.

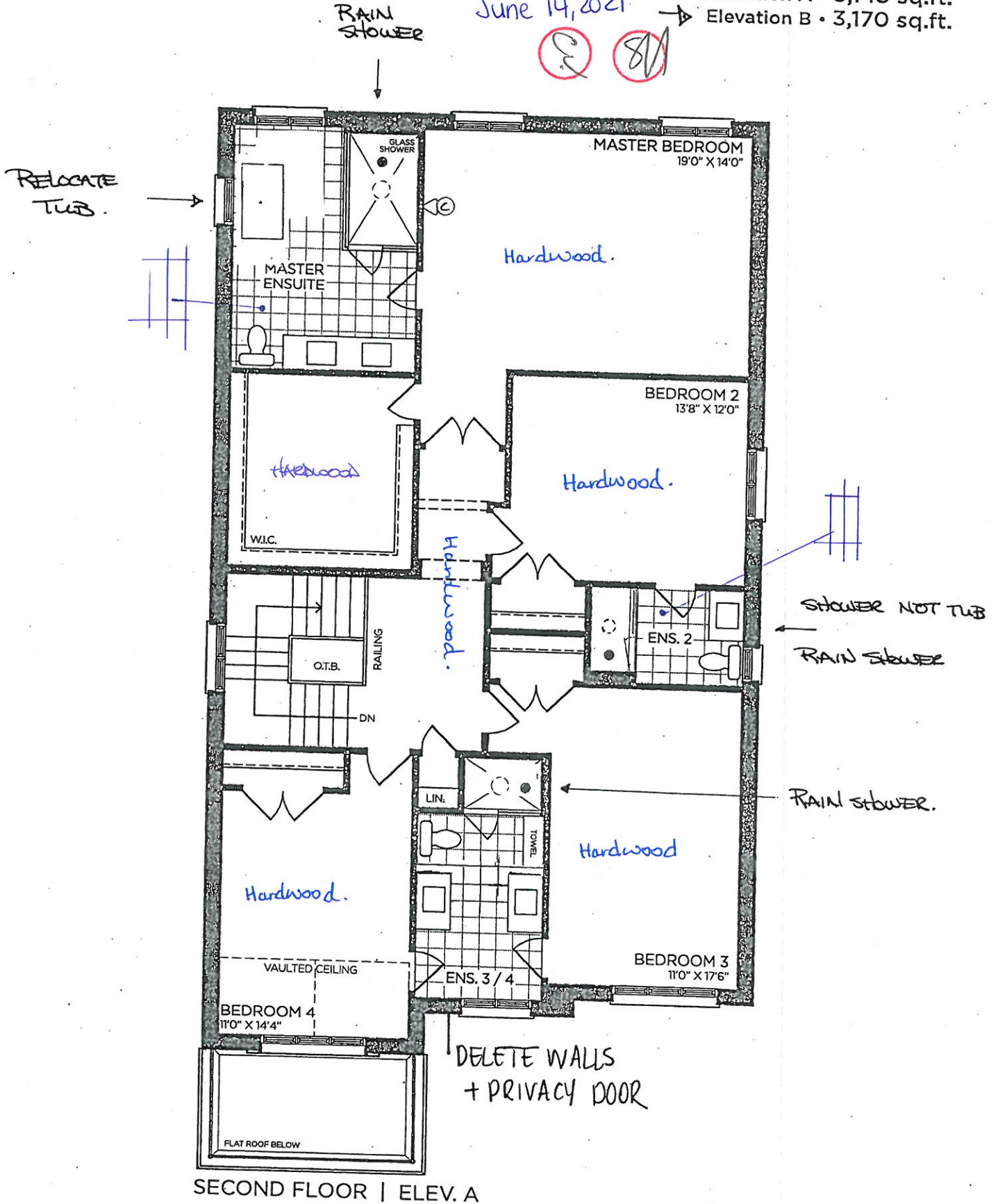

SECOND FLOOR | ELEV. A

VENDOR	
PURCHASER	
PURCHASER	

GOLDPARK  
WORTH MORE™

Prices, figures, illustrations, sizes, features and finishes are subject to change without notice. Areas and dimensions are approximate and actual usable floor space may vary from the stated area. Layout may be reverse of the unit purchased. E. & O.E. 4002





SCHEDULE 'F'

PV-33

at each

April 20, 2021

MAY 2 2021 attached

# The Valleyview

40' SERIES

Elevation A • 3,145 sq.ft.

Elevation B • 3,170 sq.ft.

PV-33

June 14, 2021

OPTIONAL  
COLD CELLAR

24 x 30'

24 x 30'

24 x 30'

UNFINISHED  
BASEMENT

3 PC. R/I

FIN.  
FOYER

UP

LOCATION  
MAY VARY

HWT

F

HRV

LOW  
HEADROOM  
(AS REQ'D)

LOW  
HEADROOM  
(AS REQ'D)

24 x 30'

BACK FLOW  
PREVENTER  
VALVE

COLD  
CELLAR

UNEXCAVATED

BASEMENT | ELEV. A

VENDOR

PURCHASER

PURCHASER

## GOLDPARK

WORTH MORE™

Prices, figures, illustrations, sizes, features and finishes are subject to change without notice. Areas and dimensions are approximate and actual usable floor space may vary from the stated area. Layout may be reverse of the unit purchased. E. & O.E. 4002

Leave  $4\frac{1}{2}$ " space for 36" chimney

- \* Will do our own electric +

- \* Hardwood in kitchen.\*

**GR. FL. KITCHEN**

10' CEILING - 12"H COFFERED CEILING -  
M.H. = 102" + 3 1/4"H CONTEMPORARY  
MOLDING + 5 1/4"H FURRING RAIL  
+ LARGE CORNICE MOLDING TO  
UNDERSIDE OF BOX

## Recycle

5 -

Waterfall Leg

## PLUG

Decor panel  
+ furn kick  
x 2

## PLAN VIEW

PV-33 CC 801  
June 14, 2021

**GOLDPARK HOMES  
PINE VALLEY  
VAUGHAN, ONTARIO  
MODEL: (4002) VALLEYVIEW**

SITE STANDARD: WHITE 3/4" EXTENSION  
SOFT-CLOSE DRAWERS & STANDARD SLAM DOOR HINGES  
TO VANITIES

ONE TOP DRAWER WHERE POSSIBLE THROUGHOUT EACH  
VANITY, ONE BANK OF DRAWERS WHERE POSSIBLE  
THROUGHOUT EACH MASTER ENSUITE VANITY

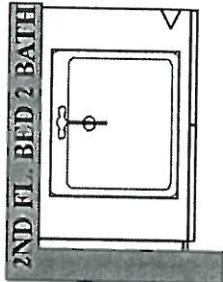
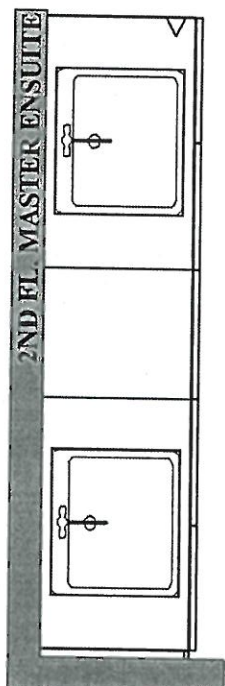
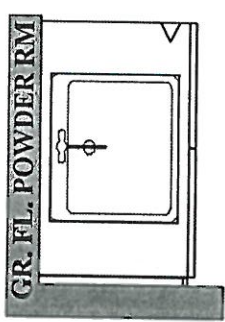
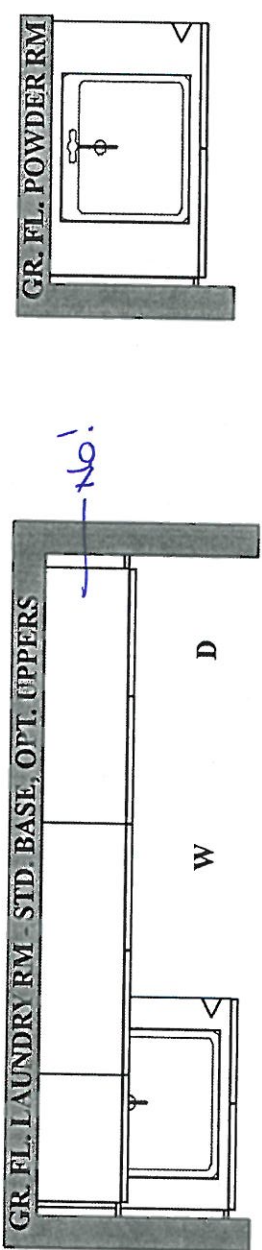

2ND FL. BED 3 & 4 BATH

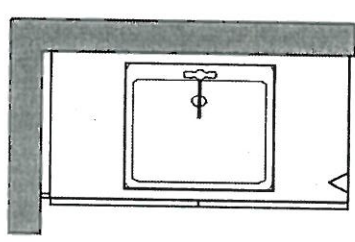
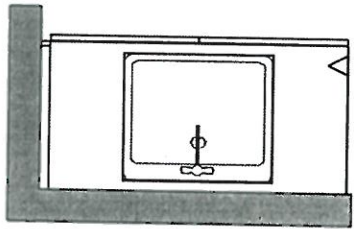

PLAN VIEW





PINE VALLEY  
FOREVERGREEN

STONE COUNTERTOP EDGE PROFILES

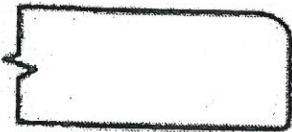

STANDARD 2CM EASED EDGE

LOCATION:

\_\_\_\_\_

\_\_\_\_\_

\_\_\_\_\_

\_\_\_\_\_

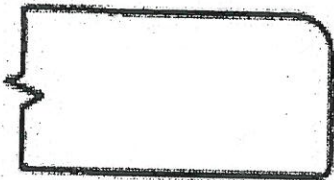

UPGRADE 3CM EASED EDGE

LOCATION:

\_\_\_\_\_

\_\_\_\_\_

\_\_\_\_\_

\_\_\_\_\_

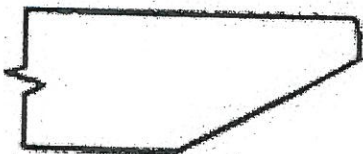

UPGRADE 4CM MITRED EDGE

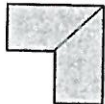

LOCATION:

\_\_\_\_\_

\_\_\_\_\_

\_\_\_\_\_

\_\_\_\_\_

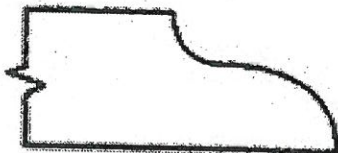

UPGRADE 2CM OGEE EDGE

LOCATION:

\_\_\_\_\_

\_\_\_\_\_

\_\_\_\_\_

\_\_\_\_\_

LOT #:	PV-33	DATE:	June 14, 2021
SIGNATURE:			
SIGNATURE:			



PINE VALLEY  
FOREVERGREEN

STANDARD HARDWARE / HANDLES

☐

H001-02

☐

H001-03

☐

H001-04

☐

H009-03

☐

H009-09

☐

H011-03

☐

H011-05

☐

H011-06

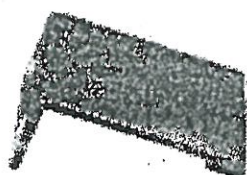
☐

H033-01

☒

H039-03

→ Laundry  
→ Flrs. 2  
→ shared.

☒

\*NO HARDWARE

→ Kitchen

LOT #

PV-33

DATE:

June 14, 2021

SIGNATURE:



*[Signature]*

SIGNATURE:



*[Signature]*

UPGRADE HARDWARE



BH-081-03

7" - Pull - \*Black\*

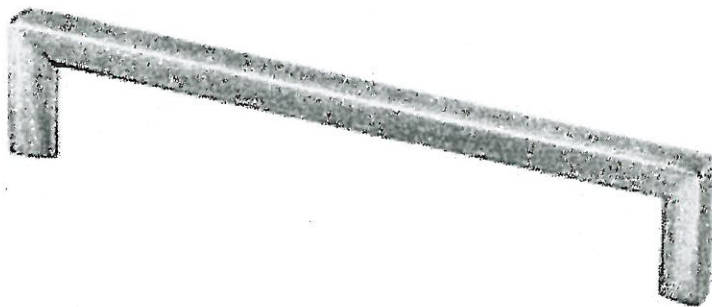

LOCATION:

Master Ensuite, Powder Room

LOT # PV-33

DATE: June 14, 2021

SIGNATURE:

*Sheel*

SIGNATURE:

*[Signature]*



UPGRADE SHOWER HARDWARE

SQ6X6

Shower Door Handle

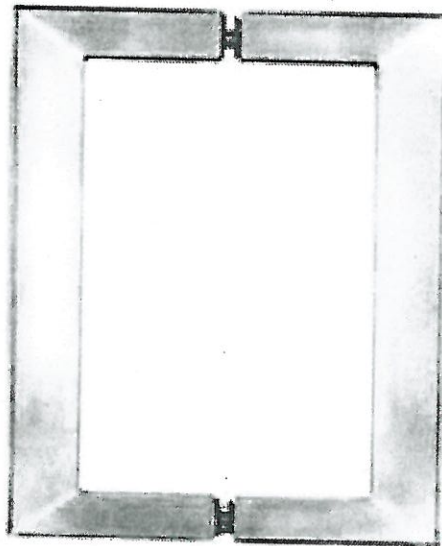

SQ6X6  
Shower Door Handle

6" x 6" back-to-back  
3/4" square tube

☒ CHROME  
☐ MATTE BLACK

Lot# PV-33

Date: June 14, 2021

Room: Master Ensuite, Ensuite 2,  
Shared Ensuite,

Signature:

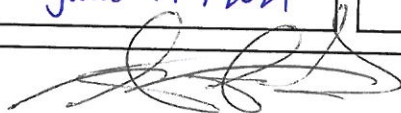

Signature:





PINE VALLEY  
FOREVERGREEN

UPGRADE KITCHEN SINK

**BLANCO - QUATRUS R15 U SUPER SINGLE**  
Stainless Steel - Undermount  
32" x 18" x 9"

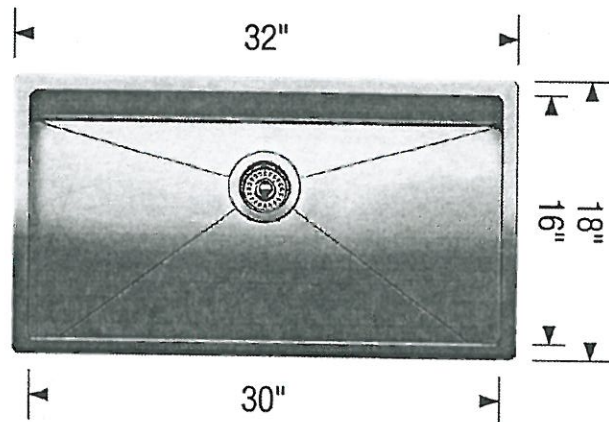
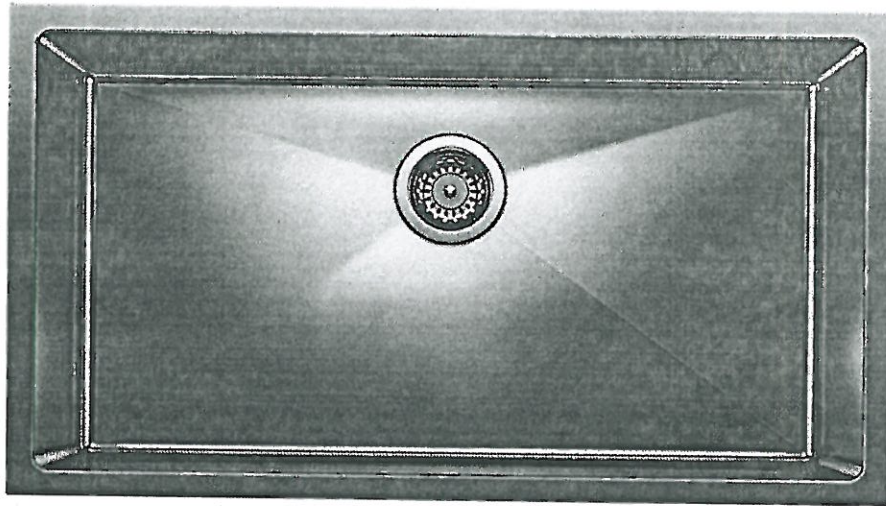

Stainless Steel

MODEL 401518 Stainless Steel

Lot# PV-33

Room: Kitchen

Signature:

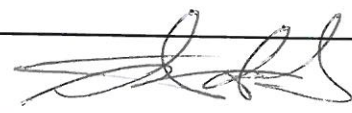
Date: June 14, 2021

Signature:

GOLDPARK  
WORTH MORE™



PINE VALLEY  
FOREVERGREEN

WAIVER

Project: Pine Valley

Purchaser: Cristian Vlad

Purchaser: Sandra Vlad

We acknowledge that kitchen gas + electrical will not be installed.

Do not supply or install. We will arrange for required kitchen gas + electrical  
after closing at our own expense and warranty.

LOT: PV-33

DATE: June 14, 2021

SIGNATURE: [Signature]

SIGNATURE: [Signature]



PLUMBING UPGRADES

MOEN - ARRIS

Posi-Temp Tub/Shower Faucet with 3 Function Transfer Valve/Trim and Slide Bar  
with Handshower



☒ CHROME

\*from CEILING

☐ BRUSHED NICKEL (BN)

☐ MATTE BLACK (BL)

MODEL: TS22002EP / U361CI / UTS23005 / 62320 / 3887EP / A725 / 226651

Lot# PV-33	Date: June 14, 2021	Room: Master Ensuite + Ensuite 2 + Ensuite 3/4
Signature:		
Signature:		



PLUMBING UPGRADES

MOEN - ARRIS

Single Freestanding Tub Filler





☒ CHROME

☐ BRUSHED NICKEL (BN)

\*Not available in BL

MODEL: TS50100 / S93005 / T90331 / 140680

Lot# PV-33	Date: Jun 14, 2021	Room: Master Ensuite
Signature: 		
Signature: 		





PINE VALLEY  
FOREVERGREEN

UPGRADE INTERIOR DOOR

LOGAN DOOR

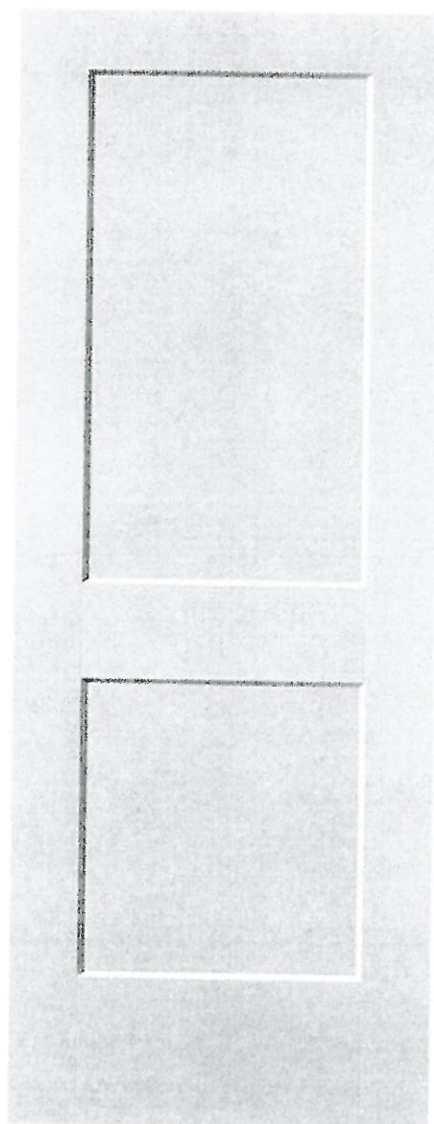

LOCATION:

Three out

LOT #

33

DATE:

JUNE 14 2021

SIGNATURE:

SIGNATURE:

GOLDPARK  
WORTH MORE



PINE VALLEY

FOREVERGREEN

## BATHROOM ACCESSORIES

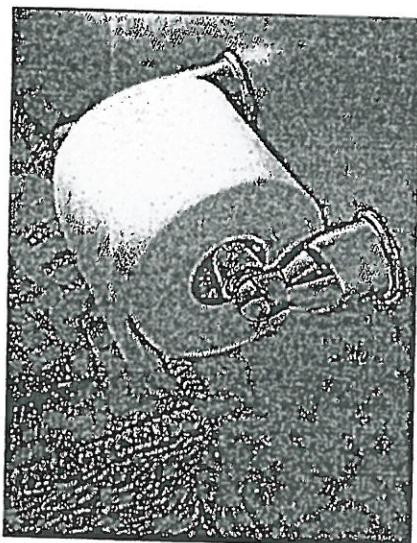

Tissue Holder  
Mason - Chrome

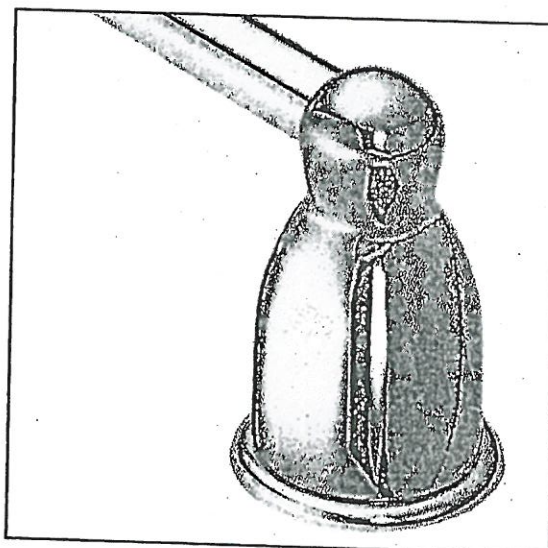

Towel Bar  
Mason - Chrome

**Please select one of the following:**

☒ **INSTALL STANDARD BATHROOM ACCESSORIES THRU OUT**  
(tissue holder + towel bar) *\*location as per vendors discretion\**

☐ **\*DO NOT\* INSTALL STANDARD BATHROOM ACCESSORIES**  
THRU OUT *\*tissue holder + towel bar will not be provided\**

LOT #

PV-33

DATE:

June 14, 2021

SIGNATURE:

SIGNATURE:



Project: Pine Valley

Lot: PV-33

Purchaser(s): Cristian Vlad and Sandra Porcelli-Vlad

Standard Hood Fan Deletion

We acknowledge that the builder's standard hood fan will not be installed.  
Do not supply, install and/or credit. We will install our own hood fan after closing.

Signature: 

Signature: 

Date: June 14, 2021



**MEDS302WS**  
**30-INCH DOUBLE COMBINATION BUILT-IN OVEN**  
**WITH STEAM CONVECTION**  
MASTERPIECE® SERIES

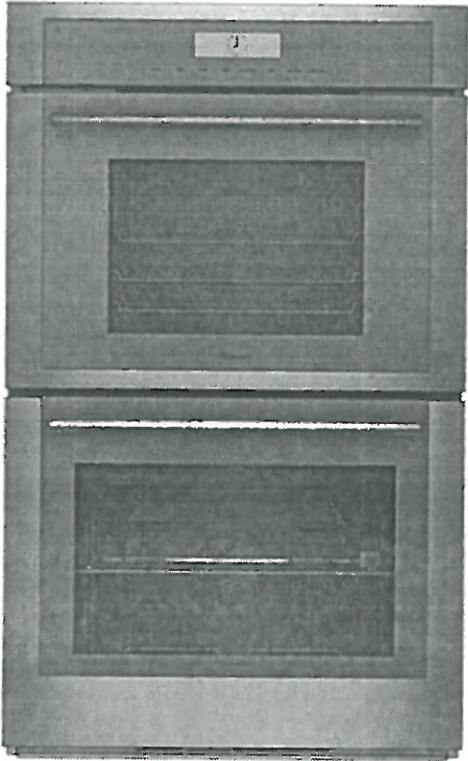

**FEATURES & BENEFITS**

- Specially crafted gray glass on stainless steel for a luxurious look and finish
- Designed for flexibility—standard or flush installation into kitchen cabinets
- Steam and Convection Cooking provides unrivaled taste and quality—food stays moist on the inside and is perfect on the outside
- Steam and Convection Oven offers passionate cooks more cooking solutions - Broil, Steam, True Convection, Steam and Convection
- Large commercial style rotisserie with 12 pound capacity

**ACCESSORIES (INCLUDED)**

Upper Cavity: 3 Telescopic Racks, Multi-point Meat Probe, Broil Pan, 1 Large Pan, 1 Small Pan, 1 Small Perforated Pan; Lower Cavity: 3 Telescopic Racks, Multi-point Meat Probe, Max Broil Pan, Rotisserie

**WARRANTY**

Limited Warranty Parts and Labor      2 Year

PV-33

*SI/CLCA - March 16/21*



**GENERAL PROPERTIES**

Heating Modes – Upper Cavity

(17) Bake, Broil, Roast, Convection Bake, Convection Broil, Convection Roast, Steam Convection, Defrost, Proof, Warm, Pizza, True Convection, Dehydrate, Speed Convection, Slow Roast, Steam, Reheat, Steam Auto Programs

Heating Modes – Lower Cavity

(16) Bake, Broil, Max Broil, Roast, Convection Bake, Convection Broil, Max Convection Broil, Convection Roast, Proof, Warm, Pizza, True Convection, Dehydrate, Speed Convection, Slow Roast, Rotisserie

Sabbath		Yes
Cleaning Type	Upper Cavity	Easy Clean, Ecolytic Clean
	Lower Cavity	Easy Clean and Self Clean
Telescopic Rack(s)		6
Illumination Type	Upper Cavity	LED
	Lower Cavity	Halogen
Interior Lights	Upper Cavity	3 – 1 Top, 2-Sides
	Lower Cavity	2 – Sides with 2 Bulbs Each
Home Connect (Wi-Fi Enabled)		Yes, Upper & Lower

**OVEN PERFORMANCE**

Bake / Broil Element	Upper Cavity	1,420 W / 3,050 W
	Lower Cavity	2,400 / 1,000 / 3,800 W
Convection Element	Upper Cavity	2,300 W
	Lower Cavity	2,000 W

**TECHNICAL DETAILS**

Watts	9,200 W
Circuit Breaker	40 A
Volts; Frequency	240 / 208 V; 60 Hz
Plug Type	Fixed Connection, No Plug
Conduit	60" 4-Wire
Energy Source	Electric

**DIMENSIONS & WEIGHT**

Overall Appliance Dimensions (HxWxD)	48 7/8" x 29 3/4" x 24 1/2"
Trim Overlaps (Top – Sides – Bottom)	3/8" to 1 5/16" – 9/16" – 0"
Required Cutout Size (HxWxD) – Standard	47 3/8" - 48 1/8" x 28 1/2" x 23 1/2"
Required Cutout Size (HxWxD) – Flush	49" x 30" x 24 1/2"
Steam Convection Oven Capacity	2.8 cu. ft.
Oven Capacity	4.5 cu. ft.
Overall Oven Interior Dimensions (HxWxD)	
Upper Cavity	14 1/2" x 18 7/8" x 17 3/8"
Lower Cavity	17 3/4" x 24" x 17 7/8"
Usable Oven Interior Dimensions (HxWxD)	
Upper Cavity	11 1/2" x 15 1/2" x 15 5/8"
Lower Cavity	13 1/2" x 21 5/8" x 16 1/4"
Net Weight	333 lbs

PV-33  
March 16/21

**MEDS302WS**  
**30-INCH DOUBLE COMBINATION BUILT-IN OVEN**  
**WITH STEAM CONVECTION**  
MASTERPIECE® SERIES



30-INCH DOUBLE COMBINATION OVEN

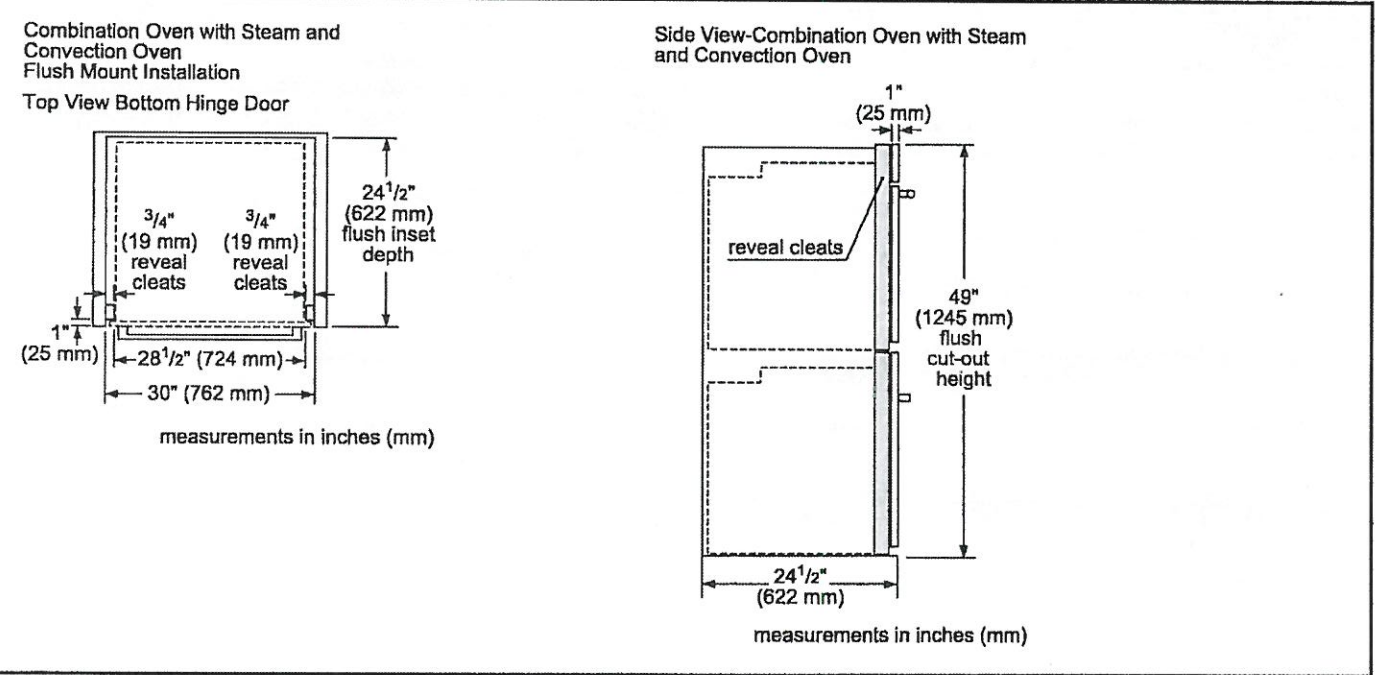
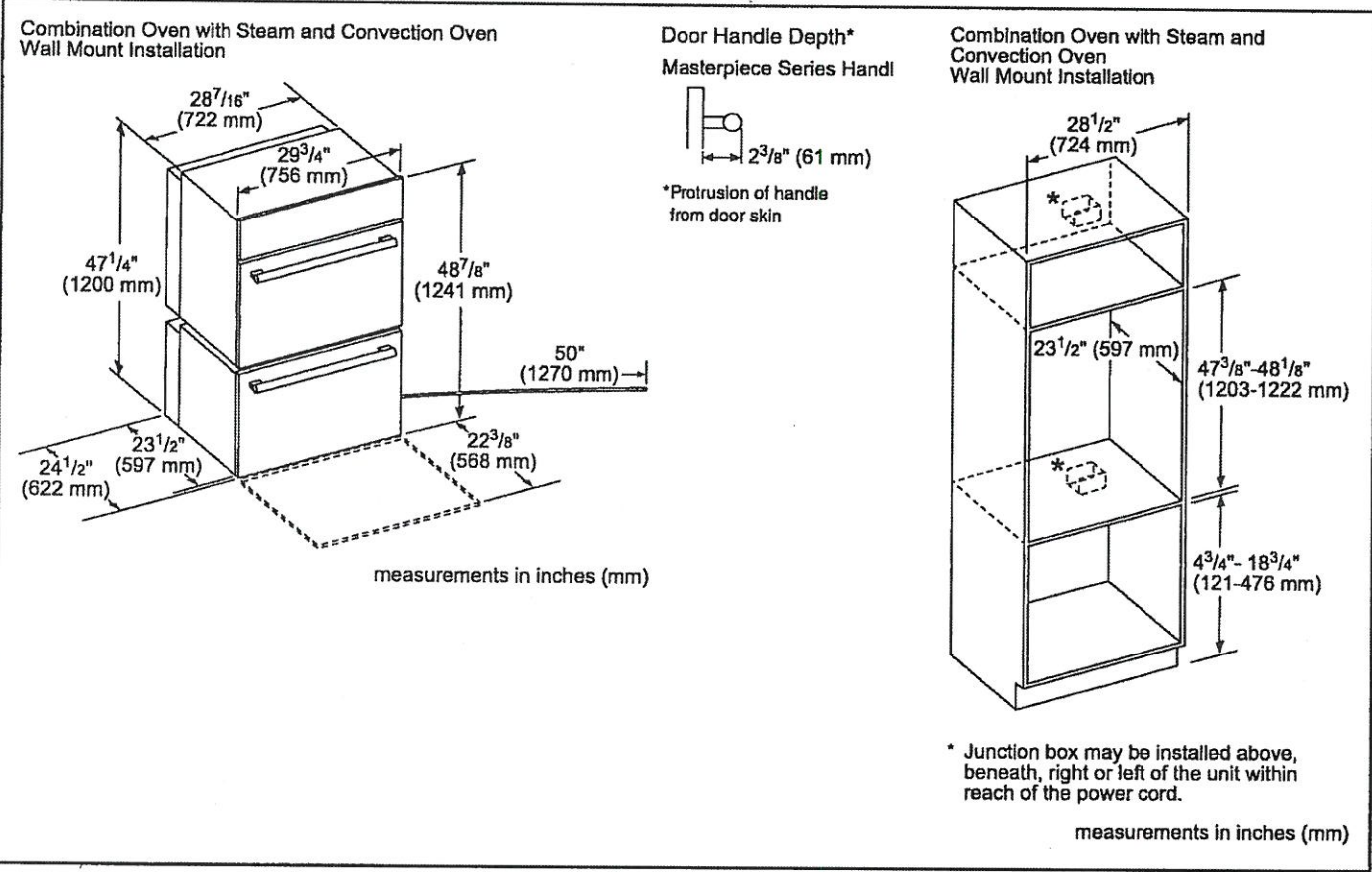



PV-33  
Mar 16/21

MEDS302WS  
30-INCH DOUBLE COMBINATION BUILT-IN OVEN  
WITH STEAM CONVECTION  
MASTERPIECE® SERIES



INSTALLATION DETAILS

Standard installation  
Single oven, double oven or combo oven over warming or storage drawer

\* Wall oven junction box may be located above or to the right or left of the unit within reach or the power cable.

\*\*Electrical hook-up may be located below (depending on space) or next to the drawer within reach of the power cable.

Minimum  $\frac{3}{4}$ " (18 mm) required between cut-outs.

min.  $4\frac{3}{4}$ " (121 mm) max. 18" (457 mm)

measurements in inches (mm)

Flush installation  
Double or combo oven over storage or warming drawer

Side view

Cleats (25 mm)

Double or combo oven cut-out height

\*IMPORTANT: Base has to be able to support the weight of the oven. Please check oven manual for minimum weight requirements.

minimum  $\frac{1}{2}$ " (13 mm) required between cut-out\* Warming drawer

\*\*For WD30W, the installed dimension may differ. This is based on  $\frac{3}{4}$ " (19 mm) thick custom panel.

9  $\frac{9}{16}$ " (243 mm) flush cut-out height

Cleats

\*\*24  $\frac{1}{2}$ " (622 mm)

measurements in inches (mm)

These warranties give you specific legal rights and you may have other rights that vary from state to state. Full warranty and limited warranty from date of installation. For complete warranty details, refer to your Use & Care manual, or ask your dealer.

Specifications are for planning purposes only. Refer to installation instructions and consult your countertop supplier prior to making counter opening. Consult with a heating and ventilation engineer for your specific ventilation requirements. For the most detailed information, refer to installation instructions accompanying product or write to Thermador indicating the model number. Specifications are correct at time of printing. Thermador reserves the right to change product specifications or design without notice. Some models are certified for use in Canada. Thermador is not responsible for products that are transported from the U.S. for use in Canada.

PV-33

81/00 March 16/24



# HPCN36WS

## 36-INCH CHIMNEY WALL HOOD

PROFESSIONAL® SERIES



### FEATURES & BENEFITS

- Professional® Series chimney wall hoods create a crafted, sculpted focal point
- Designed to complete the ultimate cooking system with Thermador ranges
- Powerfully Quiet® system accepts integral, inline, and remote blowers
- Dishwasher-safe stainless steel, commercial-style baffle filters
- Beautiful illumination with multi-level, vivid LED lights

### ACCESSORIES (OPTIONAL)

25 ft. Blower Connector Cable - EXTNCB25W  
For use with the following inline and remote blowers: VTR630W, VTR1030W, VTR1330W, VT1610W, VT11010W

Roofplates

RFPLT600P - For use with 600 CFM remote blower VTR630W

RFPLT1000P - For use with 1000 CFM remote blower VTR1030W and 1300 CFM blower VTR1330W

6" Tall Duct Cover, 36" Wide	CHMHP366W
18" - 35" Tall Duct Cover, 36" Wide	CHMHP36TW
42" - 59" Tall Duct Cover, 36" Wide	CHMHP36XTW

Remote Control Panel

REMCPW - Ability to vertically install on cabinetry or wall to control hood in a convenient location



### GENERAL PROPERTIES

Features

Multi-Level LED Lights with Fading Transitions, Automatic Mode, Check Filter Reminder Light, Delay Shut-Off

Operating Mode	Ducted
Maximum CFM	Blower Sold Separately
Number of Speed Settings	4-Stage
Motor Location	Integral / Inline/ Remote
Number of Lights	2
Bulb Type	LED
Total Power of the Lamps (W)	2.4 W
Damper Included	Yes
Grease Filter Material	Washable Stainless Steel
Grease Filter Type	Stainless-Steel Commercial Style Baffle Filter
Home Connect™ (Wi-Fi Enabled)	No

### TECHNICAL DETAILS

Watts (W)	See Chart on Page 3
Current (A)	See Chart on Page 3
Volts (V)	120 V
Frequency (Hz)	60 Hz
Plug Type	Fixed Connection, No Plug

### DIMENSIONS & WEIGHT

Overall Appliance Dimensions (Width of Canopy Included) (HxWxD) (in)	18" x 35 15/16" x 24"
Height of the Chimney (in)	Duct Covers Sold Separately
Minimum Required Distance Above Gas / Electric Cooking Surface	30" / 30"
Diameter of Air Duct (in) Top	10"
Net Weight (lbs)	70 lbs

### BLOWER OPTIONS

Remote Blower (Mounted to Roof or External Wall)	VTR630W - 600 CFM VTR1030W - 1000 CFM VTR1330W - 1300 CFM
Inline Blower (Mounted Between Kitchen and External Wall)	VT1610W - 600 CFM VT11010W - 1000 CFM
Integrated Blower (Mounted in Hood)	VTN630W - 600 CFM VTN1090R - 1000 CFM

### WARRANTY

Limited Warranty Parts and Labor	2 Year
----------------------------------	--------



PV-33  
Mar 16/21

**HPCN36WS**  
**36-INCH CHIMNEY WALL HOOD**  
 PROFESSIONAL® SERIES



**HOOD DIMENSIONS**

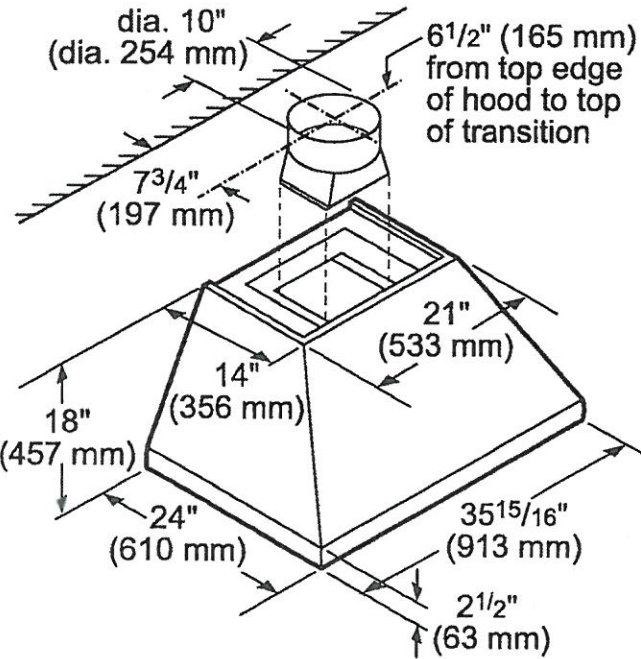

**OPTIONAL ACCESSORIES**

**6" TALL DUCT COVER**  
**CHMHP366W**

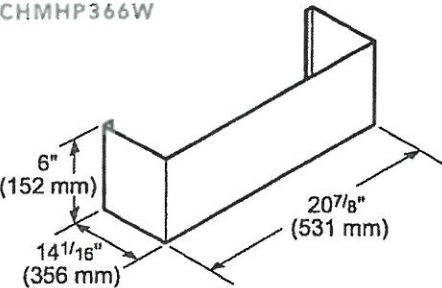

Standard duct cover for up to 8-foot ceiling heights



**18" – 35" TALL**  
**TELESCOPING**  
**DUCT COVER**  
**CHMHP36TW**

Telescoping design for extension up to 9-foot to 10-foot ceiling heights



**42" – 59" TALL**  
**TELESCOPING**  
**DUCT COVER**  
**CHMHP36XTW**

Telescoping design for extension up to 11-foot to 12-foot ceiling heights

**REMOTE CONTROL PANEL**  
**RE MCPW**



Convenience at your fingertips: The remote control accessory offers the freedom to extend your hood controls to a more reachable spot

PV-33

81/CULed

March 16/2

Thermador

PCG366W  
36-INCH GAS RANGETOP  
PROFESSIONAL SERIES, PORCELAIN COOKTOP SURFACE

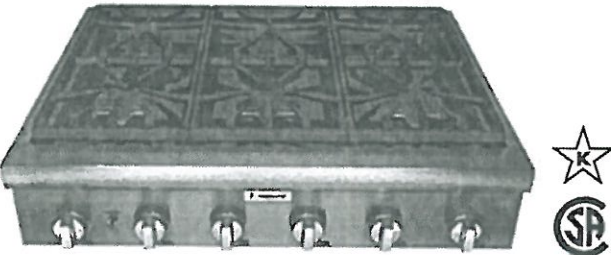

FEATURES & BENEFITS

- ★ Patented Pedestal Star® Burner with QuickClean Base® designed for easy surface cleaning and superior heat spread for any size pan
- ★ Precision simmering capabilities as low as 100°F (375 BTU) with 2 ExtraLow® Simmer burners
- ★ LED Downlighting—hidden discreetly above the control panel provides functional and stylish illumination

GENERAL PROPERTIES	
Controls	Metal Knobs
Sealed Burners	Yes
Grate Material	Cast Iron
BURNER PERFORMANCE	
Total Number of Cooktop Burners	6
Power of Front Left Burner (NG)	18,000 and XLO (NG)
Power of Back Left Burner (NG)	15,000 and XLO (NG)
Power of Back Center Burner (NG)	15,000 (NG)
Power of Front Center Burner (NG)	18,000 (NG)
Power of Center 12" Electric Griddle (W)	N/A
Power of Center 12" Electric Grill (W)	N/A
Power of Back Right Burner (NG)	15,000 (NG)
Power of Front Right Burner (NG)	18,000 (NG)
TECHNICAL DETAILS	
Circuit Breaker (A)	15 A
Volts (V)	120 V
Frequency (Hz)	60 Hz
Plug Type / Receptacle	120V-3 Prong NEMA 5-15
Power Cord Length (in)	65"
Energy Source	Gas
Gas Type	Natural Gas 6" Water Column (14.9 mb) Min. (USA)
Alternative Gas Type	LP 11" Water Column (27.4 mb) Min. (USA)
Convertible To LP (Kit Required)	Yes
DIMENSIONS & WEIGHT	
Overall Appliance Dimensions (HxWxD) (in)	8 1/8" x 35 15/16" x 25 13/16"
Required Cutout Size (HxWxD) (in)	7 11/16" x 35 1/8" x 22 13/16"
Minimum Distance From Rear Wall (in)	6" Min. to Combustible Surface
Net Weight (lbs)	142 lbs
WARRANTY	
Limited Warranty, Entire Appliance, Parts and Labor	2 Year

PV-33  
Mar 16/21

**PCG366W**  
**36-INCH GAS RANGETOP**  
PROFESSIONAL SERIES, PORCELAIN COOKTOP SURFACE



ACCESSORIES (OPTIONAL)

	<b>PAGRIDDLE</b> Griddle Sits on Top of Grates Over 2 Star Burners		<b>PA12CHPBLK</b> 12" Cutting Board		<b>PWOKRINGHC</b> Wok Ring
	<b>PA36WLBC</b> 10" Low Backguard		<b>PAKNOBLUWR</b> Metallic Blue Knob Kit		<b>PALPKITHW</b> LP Conversion Kit, Pro Rangetops (4 & 6 Burners)

36" RANGETOP SIDE VIEW

measurements in inches (mm)

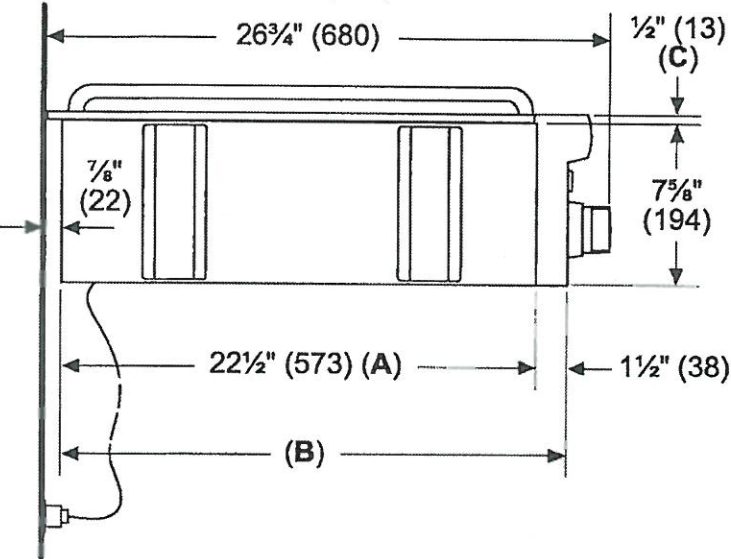

- A: Cabinet face for installation with projecting control panel.  
B: Cabinet face for installation with flush control panel.  
C: Side flange



PV-33  
Mar 16/21

**PCG366W**  
**36-INCH GAS RANGETOP**  
PROFESSIONAL SERIES, PORCELAIN COOKTOP SURFACE



**36-INCH RANGETOP CUTOUT DIMENSIONS**

\* Minimum recommended hood width equals that of the range or cooktop.

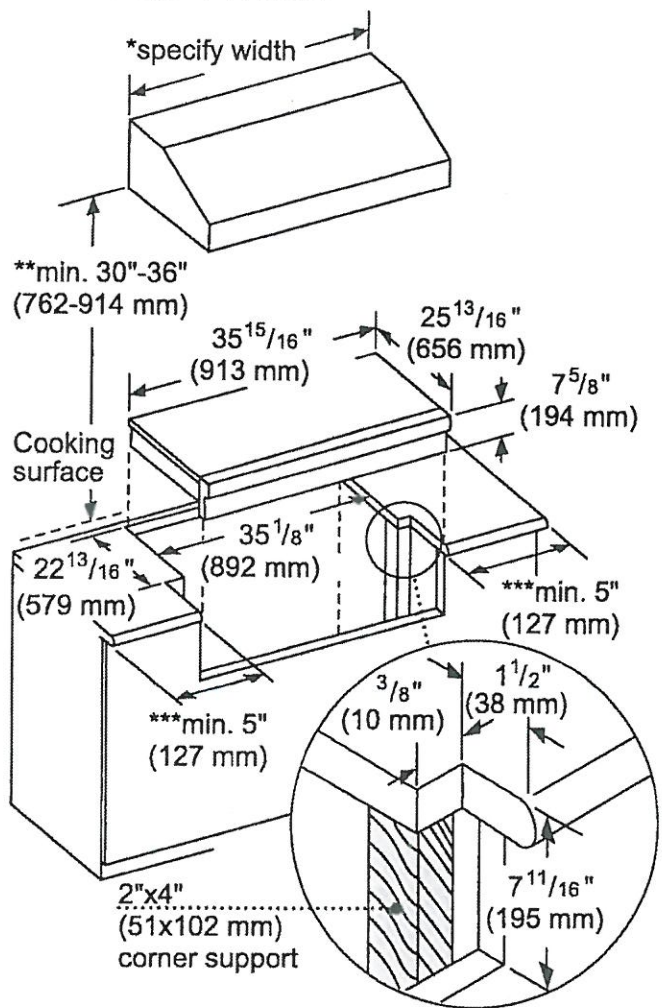

\*\* 36" minimum clearance from cooking surface to combustible surfaces.  
\*\*\* 5" minimum clearance from cooking surface to combustible side wall.  
Note: Most hoods contain combustible components that must be considered when planning the installation.

measurements in inches (mm)



**PCG366W**  
**36-INCH GAS RANGETOP**  
PROFESSIONAL SERIES, PORCELAIN COOKTOP SURFACE



**36-INCH RANGETOP GAS LOCATION**

The gas and electrical supply must be located in an area that is accessible without requiring removal of the rangetop. The appliance electrical power cord and gas pipe connection are located on the left rear underside of the rangetop.

The junction box must be located within 3 feet (~900 mm) of the rangetop connection.

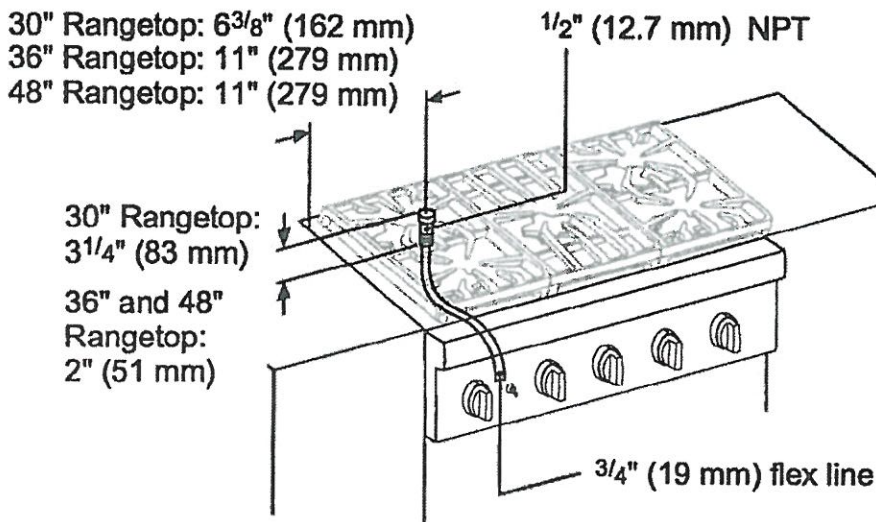

A manual valve must be installed to the appliance, in an accessible location from the front, for the purpose of shutting off the gas supply.

measurements in inches (mm)

**NATURAL GAS REQUIREMENTS:**

Inlet Connection: 1/2" NPT (min. 3/4" dia. flex line)  
Supply Pressure: 6" min. to 14" max. water column (14.9 mb to 34.9 mb)  
Manifold Pressure: 5" water column (12.5 mb)

**PROPANE GAS REQUIREMENTS:**

Inlet Connection: 1/2" NPT (min. 3/4" dia. flex line)  
Supply Pressure: 11" min. to 14" max. water column (27.4 mb to 34.9 mb)  
Manifold Pressure: 10" water column (24.9 mb)

**ELECTRICAL SUPPLY**

**IMPORTANT:** The cord supplied with all-burner gas rangetops requires a NEMA 5-15 receptacle as shown here. Local codes may require a different wiring method.



**WARNING:** This appliance is equipped with a three-prong grounding plug for protection against shock hazard and should be plugged directly into a properly grounded receptacle. DO NOT cut or remove the grounding prong from this plug. DO NOT ALTER THIS PLUG.



PV-33  
Mar. 16/21

## PCG366W 36-INCH GAS RANGETOP

PROFESSIONAL SERIES, PORCELAIN COOKTOP SURFACE

**Thermador** ★

### 36-INCH RANGETOP CLEARANCES

The shaded area behind the rangetop indicates an opportunity to discolor the back wall under certain cooking conditions.

See the Ventilation Planning Guide for recommended hood options

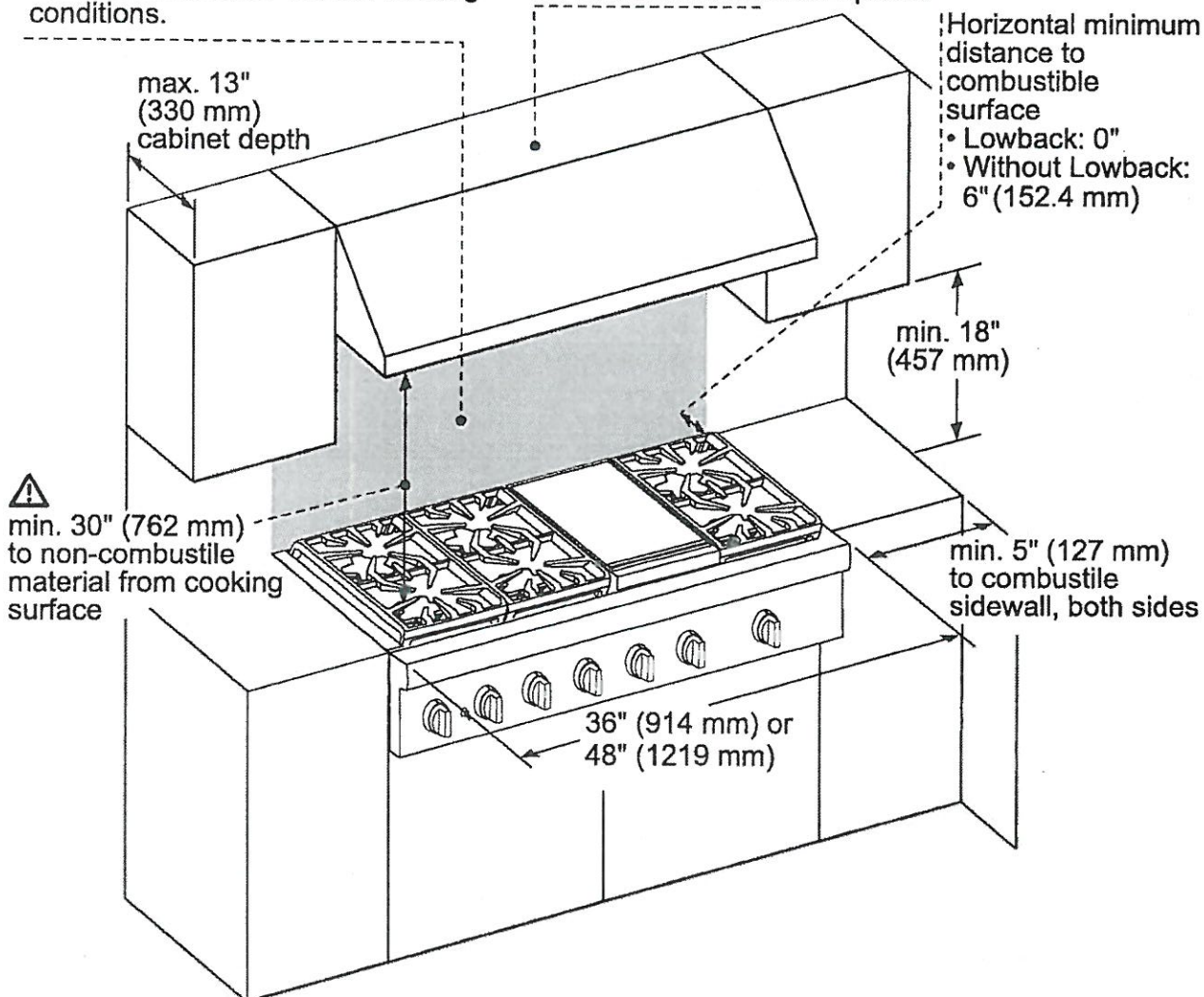

⚠ As defined in the "National Fuel Gas Code" (ANSI Z223.1, Current Edition). Clearances from non-combustible materials are not part of the ANSI Z21.1 scope and are not certified by CSA. Clearances must be approved by the local codes and/or by the local authority having jurisdiction.

measurements in inches (mm)

**NOTE:** A 36-inch minimum clearance is required between the top of the cooking surface and the bottom of an unprotected cabinet. A 30-inch clearance can be used when the bottom of the wood or metal cabinet is protected by not less than 1/4 inch of a flame retardant material covered with not less than No. 28 MSG sheet steel, 0.015 inch (0.4 mm) thick stainless steel, 0.024 inch (0.6 mm) aluminum, or 0.020 inch (0.5 mm) thick copper.

These warranties give you specific legal rights and you may have other rights that vary from state to state. Full warranty and limited warranty from date of installation. For complete warranty details, refer to your Use & Care manual, or ask your dealer.

Specifications are for planning purposes only. Refer to installation instructions and consult your countertop supplier prior to making counter opening. Consult with a heating and ventilation engineer for your specific ventilation requirements. For the most detailed information, refer to installation instructions accompanying product or write to Thermador indicating the model number. Specifications are correct at time of printing. Thermador reserves the right to change product specifications or design without notice. Some models are certified for use in Canada. Thermador is not responsible for products that are transported from the U.S. for use in Canada.

1 800 735 4328 | USA THERMADOR.COM | CANADA THERMADOR.CA | ©2019 BSH HOME APPLIANCES CORPORATION. ALL RIGHTS RESERVED.



PV-33

*Mad / Alad*

**Thermador** ★

March 16/

**T36BB915SS**  
**36-INCH STAINLESS STEEL BUILT-IN 2-DOOR**  
**BOTTOM FREEZER, PRE-ASSEMBLED**  
 FREEDOM® COLLECTION, MASTERPIECE® SERIES HANDLES

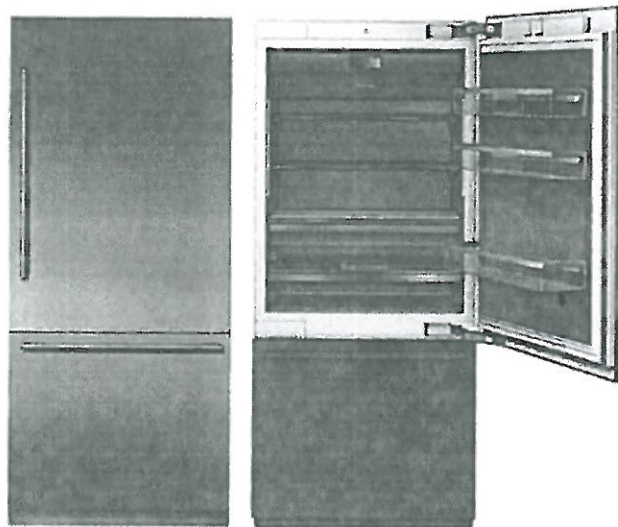

Also Available In:  
 T36BB925SS – Professional Series Handles

**FEATURES & BENEFITS**

- Full Stainless Steel Inner Liner
- Freedom® Hinge enables true flush design
- Auto Door Opening provides the opening of the door with just a slight push or pull
- ThermaFresh System, Humidity and Temperature controlled drawers
- SoftClose® Drawers for easy and controlled storage
- Sleek clean design for the perfect symmetry when paired with additional columns
- TFT control panel managing all your columns functions

**TEMPERATURE RANGES**

Refrigerator	36°F (2°C) to 46°F (8°C)
Deli Drawer	Just above 32°F (0°C)
SuperCool	36°F (2°C) for approximately 6 hours
Energy Saving (Economy) Mode	Refrigerator: 45°F (7°C) Freezer: 3°F (-16°C)
Freezer	-11°F (-24°C) to 7°F (-14°C)
SuperFreeze®	-22°F (-30°C) for approximately 52 hours

**GENERAL PROPERTIES**

Home Connect™ (Wi-Fi Enabled)	Yes
Reversible Door Swing	Yes
SoftClose® Door	Yes
SoftClose® Drawers	Yes
Carbon Air Filter	Yes
Lighting	LED Sidewall and Theater Lighting
Refrigerator Shelves	3
Adjustable Shelves – Refrigerator	2
Shelf Material	Glass w/Aluminum Profile
Full Extension Drawers @ 115° Door Opening Angle	Yes
Full Extension Drawers @ 90° Door Opening Angle	Yes
Adjustable Temperature Drawer	1
Humidity Managed Drawer	1
Door Bins – Refrigerator	2
Gallon Door Bins – Refrigerator	1
Defrost Process – Freezer	Frost-Free
Freezer Baskets	2
Ice Maker with Diamond Ice System	Yes
Door Open Alarms	Yes
Open Door Assist	Yes
SuperCool	Yes
SuperFreeze®	Yes
Special Modes	Sabbath, Economy, Vacation

**CAPACITY**

Total Capacity (cu. ft.)	19.6 cu. ft.
Refrigerator Capacity (cu. ft.)	14.0 cu. ft.
Freezer Capacity (cu. ft.)	5.6 cu. ft.

**TECHNICAL DETAILS**

Watts (W)	350 W
Current (A)	15 A
Volts (V)	110-120 V
Frequency (Hz)	60 Hz
Power Cord Length (in.)	118
Plug Type	120V-3 Prong

**DIMENSIONS & WEIGHT**

Appliance Dimensions (H x W x D) (in.)	83 3/4" x 35 3/4" x 24 3/4"
Required Cutout Size (H x W x D) (in.)	84" x 36" x 25"
Net / Gross Weight (lbs)	537 / 584 lbs

**EFFICIENCY**

ENERGY STAR® Qualified	Yes
Annual Energy Consumption	504 kWh

\*Height adjustable + / - 1/2" (+ / - 13 mm)

PV-33  
Mar 16/21

**T36BB915SS**  
**36-INCH STAINLESS STEEL BUILT-IN 2-DOOR**  
**BOTTOM FREEZER, PRE-ASSEMBLED**  
FREEDOM® COLLECTION, MASTERPIECE® SERIES HANDLES

**Thermador** ★

**WARRANTY**

Limited, Entire Appliance, Parts and Labor on Any Part of the Refrigerator that Fails Because of a Manufacturing Defect	2 Year
Limited Warranty for Sealed Refrigeration System*; Parts and Labor	3rd to 6th Year
Limited Warranty for Sealed Refrigeration System*; Parts Only	7th to 12th Year
Limited Warranty for Stainless Steel Rust-Through	Lifetime

\*Sealed refrigeration system includes compressor, evaporator, condenser, dryer / strainer and connection tubing

**CUTOUT DIMENSIONS**

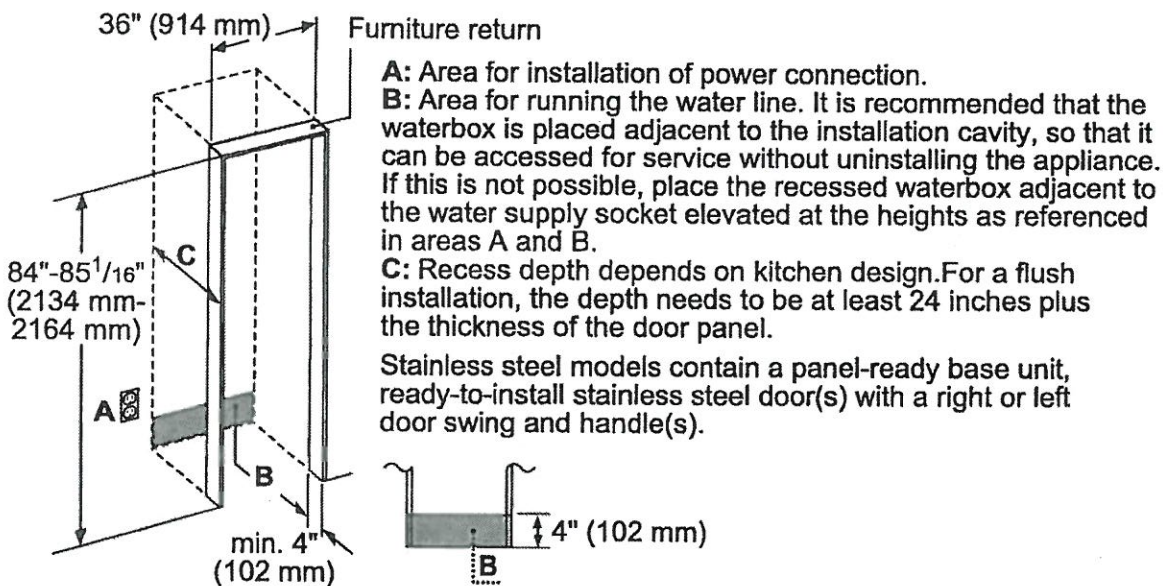

**TOP VIEW CLEARANCE**

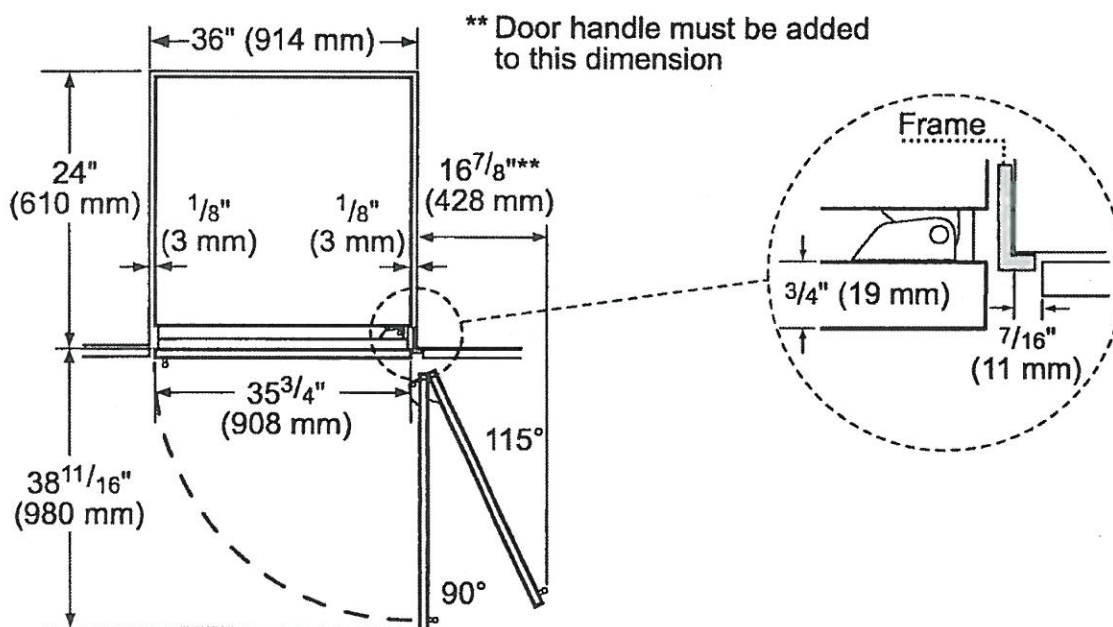



PV-33  
Mar 16/21

FREEDOM® COLLECTION, MASTERPIECE® SERIES HANDLES

**Thermador.** 

[illegible]

## STORAGE



## FILTERS

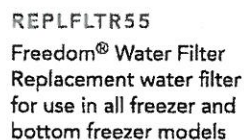

## FRAMEKIT10

**Freedom® Frame Kit**  
For any custom column installation in 24-inch deep cutouts. With two metal side trims whose placement between the interior cutout wall and the appliance helps overcome the challenge of unfinished cabinet returns.

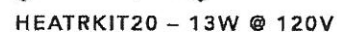

**Freedom® Heater Kit**  
When two appliances are installed side-by-side a sealing kit must be used. For combinations that involve a freezer column, this sealing kit is included. For all other (non-traditional, i.e. two wine columns, two bottom freezers, etc.) side-by-side combinations or instances where any appliances are installed less than 6-inches (152 mm) apart from one another but not connected side-by-side, purchase this kit. This kit is recommended for use with any installation in areas that are subject to humidity, or located next to an outside wall.

Specifications are for planning purposes only. Refer to installation instructions and consult your countertop supplier prior to making counter opening. Consult with a heating and ventilation engineer for your specific ventilation requirements. For the most detailed information, refer to installation instructions accompanying product or write to Thermador indicating the model number. Specifications are correct at time of printing. Thermador reserves the right to change product specifications or design without notice. Some models are certified for use in Canada. Thermador is not responsible for products that are transported from the U.S. for use in Canada.



DWHD770WFM  
SAPPHIRE® 7-PROGRAM DISHWASHER  
MASTERPIECE® SERIES HANDLE

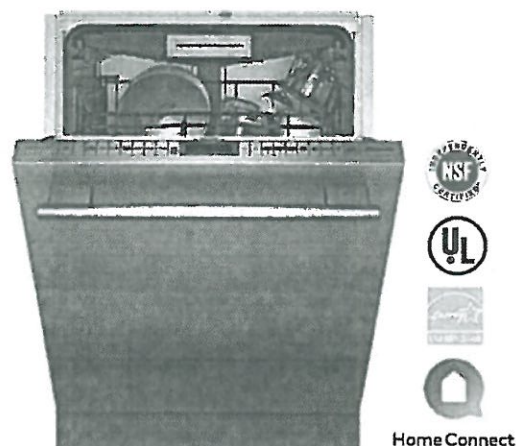

Also Available In:  
DWHD770WFP – Flat Stainless Steel Panel with  
Professional Series Handle  
DWHD770WPR – Custom Panel

FEATURES & BENEFITS

- ★ - StarDry™ — No one dries better. Star Dry with Zeolite: the ultra-powerful program that dries dishes better so place settings, glassware, and even sturdy plastics and containers with hard-to-reach crevices are ready for use immediately after each cycle
- ★ - Push to Open dishwasher opens with either a push or pull, so loading is easier, even when your hands are full
- ★ - Sapphire Glow® light illuminates with the sparkling blue light when the dishwasher is open
  - Adjustable Chef's Tool Drawer® delivers added loading capacity as well as flexibility to accommodate larger or smaller items, wider ends and utensil handles
  - Flexible folding tines fold down to accommodate larger pots, pans, and dishes and add flexibility to hold items twice as wide as previous models and significantly wider than competitor
  - Exceptionally Quiet—42 dBA for a peaceful kitchen experience
  - Thermador Connected Experience by Home Connect brings exclusive dish features that keep you connected. Always.

ACCESSORIES (OPTIONAL)

Dishwasher Supply and Drainage Hose Extension 76 3/4"	SGZ1010UC
Dishwasher Accessory Kit	SMZ5000
Fine Silverware Carafe	SMZ5002UC
Junction Box	SMZPCJB1UC



Accessory Kit includes Extra-Tall-Item Sprinkler, Vase / Bottle Holder, 3 Plastic Item Clips and Small Item Basket

Fine Silverware Carafe

★ THERMADOR® EXCLUSIVE

PV-33  
8/11/21  
March 16/21

Thermador.★

GENERAL PROPERTIES

Number Of Wash Cycles	7
Number Of Options	7
NSF®-Certified* Sanitize Option	Yes
dBA	42
Third Rack	Adjustable Chef's Tool Drawer®
Rack Adjustability	Rackmatic 3-Stage
Tub Material	Stainless Steel
Control Type	Premium Touch Control
Concealed Water Heating Element	Yes
Leak Protection System	24/7 AquaStop®
Water Softener	Yes
Five-Level Wash	Yes
Childlock	No
Home Connect (Wi-Fi Enabled)	Yes

EFFICIENCY

Water Usage Per Cycle (g)	3.5 g
Energy Efficiency Class	Tier 1
ENERGY STAR® Certified	Yes
Total Annual Energy Consumption (kWh)	269 kWh
Total Annual Water Consumption (g)	623.5 g

CAPACITY

Number Of Place Settings	16
--------------------------	----

TECHNICAL DETAILS

Watts (W)	1,440 W
Current (A)	12 A
Volts (V)	120 V
Frequency (Hz)	60 Hz
Power Cord Length (in)	67"
Power Cord Install Length from Corner of Unit when Facing the Door (in)**	Left - 45" Right - 56"
Minimum Water Pressure (lb/sin)	14
Max. Temperature for Water Intake	140° F
Length Inlet Hose (in)	N/A
Length Outlet Hose (in)	79"

DIMENSIONS & WEIGHT

Overall Appliance Dimensions (HxWxD) (in)	33 7/8" x 23 9/16" x 23 3/4"
Required Cutout Size (HxWxD) (in)	33 7/8" Min. x 23 5/8" Min. x 24"
Adjustable Feet	Yes
Net Weight (lbs)	108 lbs

\*Certification to NSF/ANSI Standard 184 for residential dishwashers

\*\*September 2020 running production change to remove adhesive routing clips for power cord. These clips and the edge protector are now included in the dishwasher accessory kit #SMZEPCC1UC.

PV-33  
Mar. 16/21

DWHD770WFM  
SAPPHIRE® 7-PROGRAM DISHWASHER  
MASTERPIECE® SERIES HANDLE



WARRANTY	
Limited Warranty, Entire Appliance, Parts and Labor	2 Year
Limited Warranty for Microprocessor or Printed Circuit Board; Parts Only	3rd to 5th Year
Limited Warranty for Racks (Does Not Include Rack Components); Parts Only	3rd to 5th Year
Limited Warranty for Rust-through On Inner Tub Liner; Parts Only	Lifetime

DISHWASHER & CUTOUT DIMENSIONS

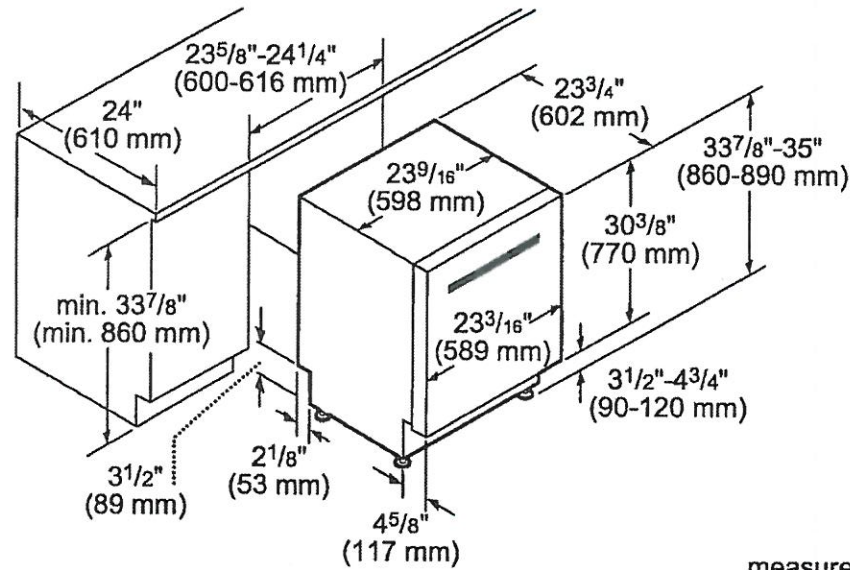

measurements in inches and mm

These warranties give you specific legal rights and you may have other rights that vary from state to state. Full warranty and limited warranty from date of installation. For complete warranty details, refer to your Use & Care manual, or ask your dealer.

Specifications are for planning purposes only. Refer to installation instructions and consult your countertop supplier prior to making counter opening. Consult with a heating and ventilation engineer for your specific ventilation requirements. For the most detailed information, refer to installation instructions accompanying product or write to Thermador indicating the model number. Specifications are correct at time of printing. Thermador reserves the right to change product specifications or design without notice. Some models are certified for use in Canada. Thermador is not responsible for products that are transported from the U.S. for use in Canada.