



CONSTRUCTION SUMMARY

Lot: 21
Model: 40.03 A BROOKSIDE
Project/Phase: Pine Valley Forevergreen / 1

APPLIANCES

Invoice	Qty.	Description
2845 16Jul21 NoCat	1	APPLIANCE SPECIFICATIONS ATTACHED - SIGNED COPY.

BASEMENT WINDOWS

Invoice	Qty.	Description
2813 72,351 21Jun21 **	3	BASEMENT WINDOWS - UPGRADE BASEMENT WINDOW SIZE TO 30 " X 24" - 8" FRAME

CERAMIC

Invoice	Qty.	Description
2813 21Jun21 NoCat	1	**CUSTOM LAYOUT** DINING ROOM / POWDER ROOM: DELETE BUFFET NICHE IN DINING ROOM, EXTEND POWDER ROOM INTO NICHE SPACE VANITY SIZE AND STYLE TO BE DETERMINED AT COLOURS APPOINTMENT
2845 37 16Jul21	1	FOYER: TILE, FLOOR - LEVEL 5 - 12x24" LAID IN STRAIGHT STACKED PATTERN - SEE PLAN FOR DIRECTION
2845 37 16Jul21	1	POWDER ROOM: TILE, FLOOR - LEVEL 5 - 12x24" LAID IN STRAIGHT STACKED PATTERN - SEE PLAN FOR DIRECTION
2845 37 16Jul21	1	MUD ROOM: TILE, FLOOR , LEVEL 5 - 12X24" LAID IN STRAIGHT, STACKED PATTERN. SEE PLAN FOR TILE DIRECTION
2845 35 16Jul21	1	BASEMENT FOYER: TILE, FLOOR , LEVEL 3 - 12X24" LAID IN STRAIGHT, STACKED PATTERN. SEE PLAN FOR TILE DIRECTION.
2845 37 16Jul21	1	ENSUITE 2: TILE, FLOOR , LEVEL 3 - 12X24" LAID IN STRAIGHT, STACKED PATTERN. SEE PLAN FOR TILE DIRECTION
2845 46 16Jul21	1	ENSUITE 2: TILE, WALL, LEVEL 2 - 3X12" LAID IN HORIZONTAL.
2845 26 16Jul21	1	ENSUITE 2: TILE INSTALLATION UPGRADE, WALL- BRICK PATTERN
2845 37 16Jul21	1	MASTER ENSUITE: TILE, FLOOR , LEVEL 5 - 12X24" LAID IN STRAIGHT, STACKED PATTERN. SEE PLAN FOR TILE DIRECTION
2845 44 16Jul21	1	MASTER ENSUITE: TILE, SHOWER FLOOR, LEVEL 3 - PENNY ROUND



CONSTRUCTION SUMMARY

Lot: 21

Model: 40.03 A BROOKSIDE

Project/Phase: Pine Valley Forevergreen / 1

CERAMIC

Invoice	Qty.	Description
2845 51 16Jul21	1	MASTER ENSUITE: TILE, WALL, LEVEL 5 - 10X30" LAID IN VERTICAL STACKED PATTERN
2845 37 16Jul21	1	SHARED ENSUITE: TILE, FLOOR , LEVEL 3 - 12X24" LAID IN STRAIGHT, STACKED PATTERN. SEE PLAN FOR TILE DIRECTION
2845 44 16Jul21	1	SHARED ENSUITE: TILE, SHOWER FLOOR, LEVEL 3 - PENNY ROUND
2845 51 16Jul21	1	SHARED ENSUITE: TILE, WALL, LEVEL 5 - 12X24" LAID IN HORIZONTAL STACKED PATTERN.
2845 16Jul21 NoCat	1	KITCHEN/BREAKFAST: VINTAGE SERIES, 5" WHITE OAK, NSS ENGINEERED HARDWOOD, 3/4" THK, SCULPTED TEXTURE, UVF FINISH - LEVEL 4 KITCHE/BREAKFAST: DO NOT SUPPLY/ INSTALL CERAMIC - CREDIT

CONCRETE AND DRAIN

Invoice	Qty.	Description
2813 21Jun21 NoCat	1	BACK FLOW PREVENTER VALVE



CONSTRUCTION SUMMARY

Lot: 21
Model: 40.03 A BROOKSIDE
Project/Phase: Pine Valley Forevergreen / 1

DRYWALL

Invoice	Qty.	Description
2813 72,351 21Jun21 **	3	BASEMENT WINDOWS - UPGRADE BASEMENT WINDOW SIZE TO 30 " X 24" - 8" FRAME
2813 72,324 21Jun21 **	2	GARAGE DOOR OPENER (CHAMBERLAIN BELT DRIVE) - WITH 1 REMOTE - PRICE IS PER DOOR
2813 72,690 21Jun21 **	1	DELETE KITCHEN BULKHEAD, IF POSSIBLE, SITE APPROVAL REQUIRED
2813 21Jun21 NoCat	1	**CUSTOM LAYOUT** DINING ROOM / POWDER ROOM: DELETE BUFFET NICHE IN DINING ROOM, EXTEND POWDER ROOM INTO NICHE SPACE VANITY SIZE AND STYLE TO BE DETERMINED AT COLOURS APPOINTMENT
2813 21Jun21 NoCat	1	KITCHEN: INSTALL 6 FOOT WIDE PATIO SLIDING DOOR WITH NO GRILLS - APPROX. 8 FOOT HIGH - IN LIEU OF STANDARD DOUBLE FRENCH DOORS SMALL TRANSOM ABOVE TO REMAIN
2813 21Jun21 NoCat	1	FRONT EXTERIOR: ADDITIONAL EXTERIOR COACH LIGHT ON SAME SWITCH (BUILDERS STANDARD FIXTURE)
2813 21Jun21 NoCat	1	REAR EXTERIOR: ADDITIONAL EXTERIOR COACH LIGHT ON SAME SWITCH (BUILDERS STANDARD FIXTURE)
2813 21Jun21 ** NoCat	1	DELETE KITCHEN BULKHEAD, IF POSSIBLE, SITE APPROVAL REQUIRED
2813 21Jun21 ** NoCat	1	DELETE KITCHEN BULKHEAD, IF POSSIBLE, SITE APPROVAL REQUIRED
2813 21Jun21 NoCat	1	DELETE KITCHEN BULKHEAD, IF POSSIBLE, SITE APPROVAL REQUIRED
2813 21Jun21 ** NoCat	1	DELETE KITCHEN BULKHEAD, IF POSSIBLE, SITE APPROVAL REQUIRED
2813 21Jun21 ** NoCat	1	DELETE KITCHEN BULKHEAD, IF POSSIBLE, SITE APPROVAL REQUIRED
2813 21Jun21 NoCat	1	THRU OUT 2ND FLOOR: INCREASE HEIGHT OF DOOR TO 8FT SECOND FLOOR - PER DOOR



CONSTRUCTION SUMMARY

Lot: 21

Model: 40.03 A BROOKSIDE

Project/Phase: Pine Valley Forevergreen / 1

DRYWALL

Invoice	Qty.	Description
2813 21Jun21 NoCat	1	BEDROOM 4: RELOCATE DOOR OF WIC TO BEDROOM 3 - SEE PLAN
2813 21Jun21 NoCat	1	BEDROOM 3: DELETE STANDARD CLOSET AND FURNITURE NICHE
2813 21Jun21 NoCat	1	**CUSTOM LAYOUT** KITCHEN: DELETE STANDARD ENTRANCE FROM KITCHEN TO DINING ROOM - INSTALL FULL HEIGHT WALL



CONSTRUCTION SUMMARY

Lot: 21
Model: 40.03 A BROOKSIDE
Project/Phase: Pine Valley Forevergreen / 1

ELECTRICAL

Invoice	Qty.	Description
2813 72,351 21Jun21 **	3	BASEMENT WINDOWS - UPGRADE BASEMENT WINDOW SIZE TO 30 " X 24" - 8" FRAME
2813 72,268 21Jun21	1	GARAGE: INTERIOR WALL OUTLET: 110V WALL INTERIOR RECEPTACLE ON EXISTING CIRCUIT - SEE PLAN FOR LOCATION
2813 72,281 21Jun21	1	GREAT ROOM: INTERIOR WALL OUTLET: ADDITIONAL 110V WALL INTERIOR RECEPTACLE ON EXISTING CIRCUIT FOR WALL MOUNTED TV - ABOVE FIREPLACE, APPROX. 66" A.F.F.
2813 72,292 21Jun21	1	FRONT EXTERIOR: ADDITIONAL EXTERIOR COACH LIGHT ON SAME SWITCH (BUILDERS STANDARD FIXTURE)
2813 72,292 21Jun21	1	REAR EXTERIOR: ADDITIONAL EXTERIOR COACH LIGHT ON SAME SWITCH (BUILDERS STANDARD FIXTURE)
2813 72,272 21Jun21	1	KITCHEN: 110V WALL RECEPTACLE ON SEPARATE CIRCUIT - FOR MICROWAVE @ ISLAND - MICROWAVE NOT INCLUDED
2813 72,280 21Jun21	2	KITCHEN: INSTALL CAPPED CEILING LIGHT FIXTURE ON CEILING ABOVE KITCHEN ISLAND - SEE PLAN FOR APPROX. LOCATION
2813 72,278 21Jun21	1	KITCHEN: ADDITIONAL INTERIOR SWITCH FOR LIGHTS ABOVE ISLAND
2813 72,289 21Jun21	6	GREAT ROOM: 4" E/S LED INTERIOR POT LIGHT - GROUND FLOOR - EACH - INCLUDES ONE SWITCH INCLUDED IN APS // DELETE STANDARD CEILING LIGHT FIXTURE
2813 72,307 21Jun21	1	UPPER HALL: FIXTURE: RELOCATE STANDARD CEILING MOUNT FIXTURE TO APPROX. CENTRE ON CEILING AT OTB
2813 72,273 21Jun21	1	KITCHEN: 110V WALL RECEPTACLE ON SEPARATE CIRCUIT - GAS FIRED APPLIANCE - FOR AUX. EQUIPMENT - NOT A STOVE PLUG
2813 21Jun21 NoCat	1	STUDY: DELETE STANDARD CEILING FIXTURE AND SWITCH
2813 21Jun21 NoCat	1	MASTER ENSUITE: DELETE STANDARD CEILING FIXTURE(S) AND SWITCH - VANITY LIGHT FIXTURE AND SWITCH TO REMAIN



CONSTRUCTION SUMMARY

Lot: 21
Model: 40.03 A BROOKSIDE
Project/Phase: Pine Valley Forevergreen / 1

ELECTRICAL

Invoice	Qty.	Description
2813 21Jun21 NoCat	1	**CUSTOM LAYOUT** DINING ROOM / POWDER ROOM: DELETE BUFFET NICHE IN DINING ROOM, EXTEND POWDER ROOM INTO NICHE SPACE VANITY SIZE AND STYLE TO BE DETERMINED AT COLOURS APPOINTMENT
2813 21Jun21 NoCat	1	KITCHEN: INSTALL 6 FOOT WIDE PATIO SLIDING DOOR WITH NO GRILLS - APPROX. 8 FOOT HIGH - IN LIEU OF STANDARD DOUBLE FRENCH DOORS SMALL TRANSOM ABOVE TO REMAIN
2813 21Jun21 NoCat	1	KITCHEN: CONVERT STANDARD BASE CABINET ON ISLAND INTO BUILT-IN MICROWAVE CABINET WITH DRAWER BELOW
2813 21Jun21 NoCat	1	THRU OUT 2ND FLOOR: INCREASE HEIGHT OF DOOR TO 8FT SECOND FLOOR - PER DOOR
2813 21Jun21 NoCat	1	BEDROOM 4: RELOCATE DOOR OF WIC TO BEDROOM 3 - SEE PLAN
2813 21Jun21 NoCat	1	BEDROOM 3: DELETE STANDARD CLOSET AND FURNITURE NICHE
2845 16Jul21 NoCat	1	APPLIANCE SPECIFICATIONS ATTACHED - SIGNED COPY.

EXTERIOR DOORS

Invoice	Qty.	Description
2813 72,363 21Jun21	1	GARAGE: INCREASED HEIGHT TO MAN DOOR FROM HOUSE TO GARAGE - TALL HEIGHT * WOOD FRAME - IF GRADE PERMITS [EACH]
2813 72,359 21Jun21	1	KITCHEN: INSTALL 6 FOOT WIDE PATIO SLIDING DOOR WITH NO GRILLS - APPROX. 8 FOOT HIGH - IN LIEU OF STANDARD DOUBLE FRENCH DOORS SMALL TRANSOM ABOVE TO REMAIN



CONSTRUCTION SUMMARY

Lot: 21
Model: 40.03 A BROOKSIDE
Project/Phase: Pine Valley Forevergreen / 1

FRAMING

Invoice	Qty.	Description
2813 21Jun21 NoCat	1	**CUSTOM LAYOUT** DINING ROOM / POWDER ROOM: DELETE BUFFET NICHE IN DINING ROOM, EXTEND POWDER ROOM INTO NICHE SPACE VANITY SIZE AND STYLE TO BE DETERMINED AT COLOURS APPOINTMENT
2813 72,690 21Jun21	1	DELETE KITCHEN BULKHEAD, IF POSSIBLE, SITE APPROVAL REQUIRED
2813 21Jun21 NoCat	1	BEDROOM 4: RELOCATE DOOR OF WIC TO BEDROOM 3 - SEE PLAN
2813 21Jun21 NoCat	1	BEDROOM 3: DELETE STANDARD CLOSET AND FURNITURE NICHE
2813 21Jun21 NoCat	1	**CUSTOM LAYOUT** KITCHEN: DELETE STANDARD ENTRANCE FROM KITCHEN TO DINING ROOM - INSTALL FULL HEIGHT WALL
2813 21Jun21 NoCat	1	KITCHEN: INSTALL 6 FOOT WIDE PATIO SLIDING DOOR WITH NO GRILLS - APPROX. 8 FOOT HIGH - IN LIEU OF STANDARD DOUBLE FRENCH DOORS SMALL TRANSOM ABOVE TO REMAIN
2813 21Jun21 NoCat	1	FRONT EXTERIOR: ADDITIONAL EXTERIOR COACH LIGHT ON SAME SWITCH (BUILDERS STANDARD FIXTURE)
2813 21Jun21 NoCat	1	REAR EXTERIOR: ADDITIONAL EXTERIOR COACH LIGHT ON SAME SWITCH (BUILDERS STANDARD FIXTURE)
2813 21Jun21 ** NoCat	1	DELETE KITCHEN BULKHEAD, IF POSSIBLE, SITE APPROVAL REQUIRED
2813 21Jun21 ** NoCat	1	DELETE KITCHEN BULKHEAD, IF POSSIBLE, SITE APPROVAL REQUIRED
2813 21Jun21 ** NoCat	1	DELETE KITCHEN BULKHEAD, IF POSSIBLE, SITE APPROVAL REQUIRED
2813 21Jun21 ** NoCat	1	DELETE KITCHEN BULKHEAD, IF POSSIBLE, SITE APPROVAL REQUIRED
2813 21Jun21 ** NoCat	1	DELETE KITCHEN BULKHEAD, IF POSSIBLE, SITE APPROVAL REQUIRED



CONSTRUCTION SUMMARY

Lot: 21
Model: 40.03 A BROOKSIDE
Project/Phase: Pine Valley Forevergreen / 1

FRAMING

Invoice	Qty.	Description
2813	1	THRU OUT 2ND FLOOR: INCREASE HEIGHT OF DOOR TO 8FT SECOND FLOOR - PER DOOR
21Jun21 NoCat		

GARAGE DOORS

Invoice	Qty.	Description
2813 72,324 21Jun21	2	GARAGE DOOR OPENER (CHAMBERLAIN BELT DRIVE) - WITH 1 REMOTE - PRICE IS PER DOOR

GLASS AND MIRROR

Invoice	Qty.	Description
2845 16Jul21 NoCat	2	MASTER ENSUITE + SHARED ENSUITE: UPGRADE SHOWER DOOR HARDWARE - CHROME

GRANITE MARBLE QUARTZ

Invoice	Qty.	Description
2813 21Jun21 NoCat	1	SHARED ENSUITE: DELETE ONE STANDARD VANITY SINK, RELOCATE SINGLE SINK TO APPROX. CENTRE OF VANITY
2845 16Jul21 NoCat	1	KITCHEN: UPGRADE QUARTZ COUNTERTOP - LEVEL 6 **INCLUDES AT FORMER OPENING TO DINING ROOM**
2845 74,429 16Jul21	2	KITCHEN: QUARTZ, 48" WATERFALL LEG (PRICE PER LEG) - LEVEL 6
2845 16Jul21 NoCat	1	POWDER ROOM: UPGRADE 6 QUARTZ COUNTER
2845 16Jul21 NoCat	1	ENSUITE 2: UPGRADE 5 QUARTZ COUNTER
2845 16Jul21 NoCat	1	MASTER ENSUITE: UPGRADE 6 QUARTZ COUNTER
2845 16Jul21 NoCat	1	SHARED ENSUITE: UPGRADE 6 QUARTZ



CONSTRUCTION SUMMARY

Lot: 21

Model: 40.03 A BROOKSIDE

Project/Phase: Pine Valley Forevergreen / 1

HARDWOOD

Invoice	Qty.	Description
2845 7 16Jul21	1	KITCHEN/BREAKFAST: VINTAGE SERIES, 5" WHITE OAK, NSS ENGINEERED HARDWOOD, 3/4" THK, SCULPTED TEXTURE, UVF FINISH - LEVEL 4
2845 7 16Jul21	1	THRU OUT STANDARD AREAS: MAIN HALL, DINING ROOM, STUDY, GREAT ROOM, UPPER HALL, MASTER BEDROOM, BEDROOM 2, BEDROOM 3, BEDROOM 4, LOWER MEDIA ROOM - VINTAGE SERIES, 5" WHITE OAK, NSS ENGINEERED HARDWOOD, 3/4" THK, SCULPTED TEXTURE, UVF FINISH - LEVEL 4



CONSTRUCTION SUMMARY

Lot: 21
Model: 40.03 A BROOKSIDE
Project/Phase: Pine Valley Forevergreen / 1

HVAC

Invoice	Qty.	Description
2813 72,239 21Jun21	1	3.5 TON AC - WITH LOW VOLTAGE WIRING & WALL BRACKETS (14ACX)
2813 72,215 21Jun21	1	FURNACE - LENNOX 2 STAGE VARIABLE SPEED FURNACE (90,000 TO 110,000 BTU FOOT S) IN LIEU OF STANDARD OFFERING - (PINE VALLEY SITE ONLY - REFERENCE MODEL SPECIFIC FOR FURANCE UPGRADE EXTRA)
2813 72,690 21Jun21 **	1	DELETE KITCHEN BULKHEAD, IF POSSIBLE, SITE APPROVAL REQUIRED
2813 72,224 21Jun21	1	KITCHEN: GAS LINE ROUGH-IN - MAIN FLOOR FOR APPLIANCE - SEE PLAN FOR APPROX. LOCATION FINAL LOCATION, ORIENTATION AND CONNECTION TO BE COMPLETED BY A LICENSED GAS FITTER AND ARRANGED BY HOMEOWNER AFTER CLOSING AT THEIR OWN EXPENSE AND WARRANTY
2813 21Jun21 ** NoCat	1	3.5 TON AC - WITH LOW VOLTAGE WIRING & WALL BRACKETS (14ACX)
2813 21Jun21 ** NoCat	1	FURNACE - LENNOX 2 STAGE VARIABLE SPEED FURNACE (90,000 TO 110,000 BTU FOOT S) IN LIEU OF STANDARD OFFERING - (PINE VALLEY SITE ONLY - REFERENCE MODEL SPECIFIC FOR FURANCE UPGRADE EXTRA) VANITY SIZE AND STYLE TO BE DETERMINED AT COLOURS APPOINTMENT
2813 21Jun21 NoCat	1	DELETE KITCHEN BULKHEAD, IF POSSIBLE, SITE APPROVAL REQUIRED
2813 21Jun21 ** NoCat	1	DELETE KITCHEN BULKHEAD, IF POSSIBLE, SITE APPROVAL REQUIRED
2813 21Jun21 ** NoCat	1	DELETE KITCHEN BULKHEAD, IF POSSIBLE, SITE APPROVAL REQUIRED
2813 21Jun21 ** NoCat	1	DELETE KITCHEN BULKHEAD, IF POSSIBLE, SITE APPROVAL REQUIRED
2813 21Jun21 ** NoCat	1	DELETE KITCHEN BULKHEAD, IF POSSIBLE, SITE APPROVAL REQUIRED



CONSTRUCTION SUMMARY

Lot: 21

Model: 40.03 A BROOKSIDE

Project/Phase: Pine Valley Forevergreen / 1

INTERIOR TRIM AND DOORS

Invoice	Qty.	Description
2813 72,644 21Jun21	14	THRU OUT 2ND FLOOR: INCREASE HEIGHT OF DOOR TO 8FT SECOND FLOOR - PER DOOR
2813 21Jun21 NoCat	1	**CUSTOM LAYOUT** DINING ROOM / POWDER ROOM: DELETE BUFFET NICHE IN DINING ROOM, EXTEND POWDER ROOM INTO NICHE SPACE VANITY SIZE AND STYLE TO BE DETERMINED AT COLOURS APPOINTMENT
2813 21Jun21 NoCat	1	BEDROOM 4: RELOCATE DOOR OF WIC TO BEDROOM 3 - SEE PLAN
2813 21Jun21 NoCat	1	BEDROOM 3: DELETE STANDARD CLOSET AND FURNITURE NICHE
2813 21Jun21 NoCat	1	**CUSTOM LAYOUT** KITCHEN: DELETE STANDARD ENTRANCE FROM KITCHEN TO DINING ROOM - INSTALL FULL HEIGHT WALL
2845 153,300 16Jul21	1	THRU OUT: UPGRADE 3 1/4" STEP BEVEL BB CASING, 7 1/4" BASE BOARD UPGRADE



CONSTRUCTION SUMMARY

Lot: 21

Model: 40.03 A BROOKSIDE

Project/Phase: Pine Valley Forevergreen / 1

KITCHEN AND BATH CABINETRY

Invoice	Qty.	Description
2813 72,272 21Jun21	1	KITCHEN: CONVERT STANDARD BASE CABINET ON ISLAND INTO BUILT-IN MICROWAVE CABINET WITH DRAWER BELOW
2813 72,690 21Jun21 **	1	DELETE KITCHEN BULKHEAD, IF POSSIBLE, SITE APPROVAL REQUIRED
2813 21Jun21 NoCat	1	MUD ROOM: INSTALL OPTIONAL STANDARD UPPER LAUNDRY CABINETS (BUILDERS STANDARD OFFERING)
2813 21Jun21 ** NoCat	1	DELETE KITCHEN BULKHEAD, IF POSSIBLE, SITE APPROVAL REQUIRED
2813 21Jun21 ** NoCat	1	DELETE KITCHEN BULKHEAD, IF POSSIBLE, SITE APPROVAL REQUIRED
2813 21Jun21 ** NoCat	1	DELETE KITCHEN BULKHEAD, IF POSSIBLE, SITE APPROVAL REQUIRED
2813 21Jun21 ** NoCat	1	DELETE KITCHEN BULKHEAD, IF POSSIBLE, SITE APPROVAL REQUIRED
2813 21Jun21 NoCat	1	DELETE KITCHEN BULKHEAD, IF POSSIBLE, SITE APPROVAL REQUIRED
2813 21Jun21 NoCat	1	SHARED ENSUITE: DELETE ONE STANDARD VANITY SINK, RELOCATE SINGLE SINK TO APPROX. CENTRE OF VANITY
2845 16Jul21 NoCat	1	THRU OUT: SEE ATTACHED CABINETRY SCHEDULE
2845 16Jul21 NoCat	1	APPLIANCE SPECIFICATIONS ATTACHED - SIGNED COPY.



CONSTRUCTION SUMMARY

Lot: 21
Model: 40.03 A BROOKSIDE
Project/Phase: Pine Valley Forevergreen / 1

MASONRY

Invoice	Qty.	Description
2813 21Jun21 NoCat	1	KITCHEN: INSTALL 6 FOOT WIDE PATIO SLIDING DOOR WITH NO GRILLS - APPROX. 8 FOOT HIGH - IN LIEU OF STANDARD DOUBLE FRENCH DOORS SMALL TRANSOM ABOVE TO REMAIN
2813 21Jun21 NoCat	1	FRONT EXTERIOR: ADDITIONAL EXTERIOR COACH LIGHT ON SAME SWITCH (BUILDERS STANDARD FIXTURE)
2813 21Jun21 NoCat	1	REAR EXTERIOR: ADDITIONAL EXTERIOR COACH LIGHT ON SAME SWITCH (BUILDERS STANDARD FIXTURE)

NETWORK AND WIRING

Invoice	Qty.	Description
2813 72,259 21Jun21	1	GREAT ROOM: CONDUIT PIPE - FOR WALL MOUNT TV - APPROX. 66" A.F.F., ABOVE FIREPLACE, THRU BASEMENT, TERMINATE AT STD OUTLET
2813 72,281 21Jun21	1	GREAT ROOM: STANDARD CABLE TO BE INSTALLED ABOVE FIREPLACE, APPROX. 66" A.F.F.

PAINT

Invoice	Qty.	Description
2813 21Jun21 NoCat	1	KITCHEN: INSTALL 6 FOOT WIDE PATIO SLIDING DOOR WITH NO GRILLS - APPROX. 8 FOOT HIGH - IN LIEU OF STANDARD DOUBLE FRENCH DOORS SMALL TRANSOM ABOVE TO REMAIN
2813 21Jun21 NoCat	1	THRU OUT 2ND FLOOR: INCREASE HEIGHT OF DOOR TO 8FT SECOND FLOOR - PER DOOR
2813 21Jun21 NoCat	1	BEDROOM 3: DELETE STANDARD CLOSET AND FURNITURE NICHE
2813 21Jun21 NoCat	1	**CUSTOM LAYOUT** KITCHEN: DELETE STANDARD ENTRANCE FROM KITCHEN TO DINING ROOM - INSTALL FULL HEIGHT WALL
2845 16Jul21 NoCat	2	MAIN STAIRS - 2ND FLOOR TO BASEMENT: STAIN STAIRS AND LANDINGS WILL NOT MATCH HARDWOOD IN COLOUR, SPECIES, OR TEXTURE



CONSTRUCTION SUMMARY

Lot: 21
Model: 40.03 A BROOKSIDE
Project/Phase: Pine Valley Forevergreen / 1



CONSTRUCTION SUMMARY

Lot: 21

Model: 40.03 A BROOKSIDE

Project/Phase: Pine Valley Forevergreen / 1



CONSTRUCTION SUMMARY

Lot: 21
Model: 40.03 A BROOKSIDE
Project/Phase: Pine Valley Forevergreen / 1

PLUMBING

Invoice	Qty.	Description
2813 21Jun21 NoCat	1	SHARED ENSUITE: DELETE ONE STANDARD VANITY SINK, RELOCATE SINGLE SINK TO APPROX. CENTRE OF VANITY
2813 75,845 21Jun21	1	MASTER ENSUITE: UPGRADE TO MOEN ARRIS SHOWER FAUCET W/ HANDSHOWER AND SLIDE BAR - CHROME
2813 75,845 21Jun21	1	SHARED ENSUITE: UPGRADE TO MOEN ARRIS SHOWER FAUCET W/ HANDSHOWER AND SLIDE BAR - CHROME
2813 75,841 21Jun21	1	MASTER ENSUITE: UPGRADE TO MOEN ARRIS FREE-STANDING TUB FILLER - INCLUDES TUB DRAIN HALF KIT - CHROME
2813 21Jun21 NoCat	1	**CUSTOM LAYOUT** DINING ROOM / POWDER ROOM: DELETE BUFFET NICHE IN DINING ROOM, EXTEND POWDER ROOM INTO NICHE SPACE VANITY SIZE AND STYLE TO BE DETERMINED AT COLOURS APPOINTMENT
2845 16Jul21 NoCat	1	KITCHEN: UPGRADE SINK

STAIR AND RAILINGS

Invoice	Qty.	Description
2845 93,781 16Jul21	2	MAIN STAIRS: UPGRADE - EURONLINE (ALL PLAIN) PICKET, 3" HALF-ROUND W/V-GROOVE HANDRAIL, 3 1/2" ALL SQUARE POST WITH PYRAMID TOP POST CAP - PACKAGE A-2

PV - 21 Cabinetry Schedule

ROOM	DESCRIPTION	PRICE	QTY	TOTAL
KITCHEN	UPGRADE FROM SERIES 2 TO SERIES 5 - MEDIO 6 OYSTER		1	
	UPGRADE HARDWARE - H050-21		1	
	ADD DECORATIVE HOOD CANOPY - CLASSIC		1	
	ADJUST BASE CABINETRY FOR 36" RANGE (N/C)		1	
	ADD CABINETRY VALANCE ONLY (NO ELECTRICAL)		1	
	CONVERT BASE CABINETS TO BASE POTS AND PANS DRAWERS		2	
	CLOSE OPENING BETWEEN DINING ROOM AND KITCHEN, ADD UPPERS AND BASE CABINETS TO ACCOMMODATE		1	
	RETURN TRIP FOR HARDWOOD		1	
	REDUCE UPPERS AND ADD 18"H MINI STACKED UPPERS WITH CROWN MOULDING (ADJUST CABINETRY DEPTH TO ACCOMMODATE DUCT WORK/ PIPING/ ELECTRICAL AS REQUIRED)		1	
ISLAND	UPGRADE FROM SERIES 2 TO SERIES 5 - MEDIO 6 OYSTER		1	
	ADD PROUD FURNITURE KICK TO REAR ISLAND ONLY		1	
	CONVERT STD CABINETRY TO BUILT IN MICROWAVE CABINET WITH DRAWER BELOW (PURCHASED ON STRUCTURAL ORDER)		1	
	RELOCATE STANDARD BANK OF 4 DRAWERS TO ISLAND (N/C)		1	
	NOTE: NO PLUG ON ISLAND			
CABINETRY TOTAL:				

HARDWARE: HORIZONTAL ON DRAWERS, VERTICAL ON DOORS

LOT #:

PV- 21

DATE:

July 13 , 2021

SIGNATURE:



SIGNATURE:

PV-Z1

July 13, 2021

5.6

- * No plug on island.
- * Hardwood in kitchen
- * Stacked mini uppers

GOLDPARK HOMES
PINE VALLEY
VAUGHAN, ONTARIO
MODEL: (4003)
BROOKSIDE

SITE STANDARD: WHITE 3/4" EXTENSION
SOFT-CLOSE DRAWERS & SOFT-CLOSE
HINGES TO KITCHEN AREA

10' CEILING - 12"H COFFERED CEILING -
M.H. = 102" + 3/4"H CONTEMPORARY
MOLDING + 5 1/4"H FURRING RAIL
+ LARGE CORNICE MOLDING TO
UNDERSIDE OF BOX

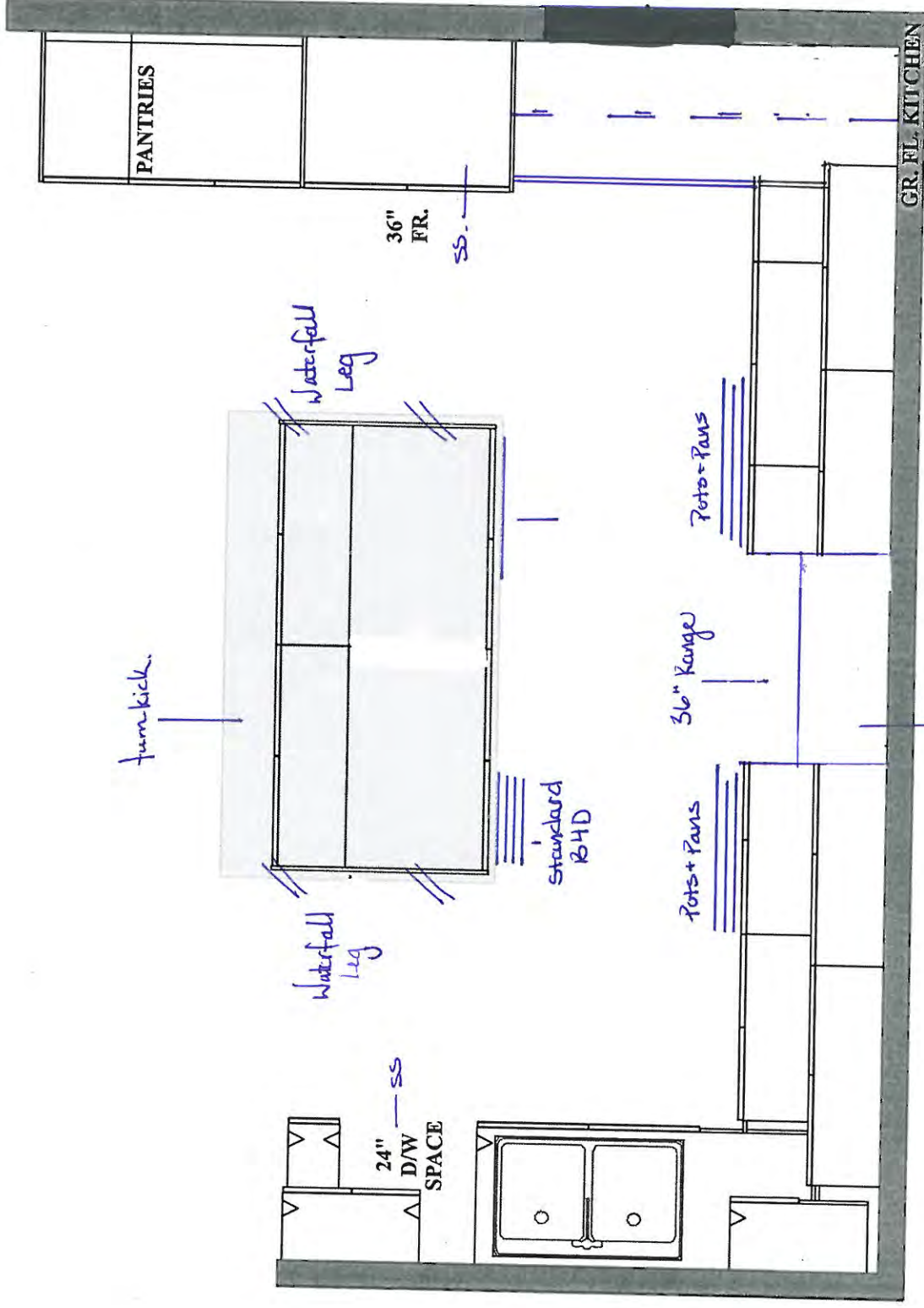

PLAN VIEW

'Classic' Decorative Curved Head Cabinet

PR-21
July 13, 2021
IG.

**GOLDPARK HOMES
PINE VALLEY
VAUGHAN, ONTARIO
MODEL: (4003) BROOKSIDE**

SITE STANDARD: WHITE 3/4" EXTENSION
SOFT-CLOSE DRAWERS & STANDARD SLAM DOOR HINGES
TO VANITIES

ONE TOP DRAWER WHERE POSSIBLE THROUGHOUT EACH
VANITY, ONE BANK OF DRAWERS WHERE POSSIBLE
THROUGHOUT EACH MASTER ENSUITE VANITY

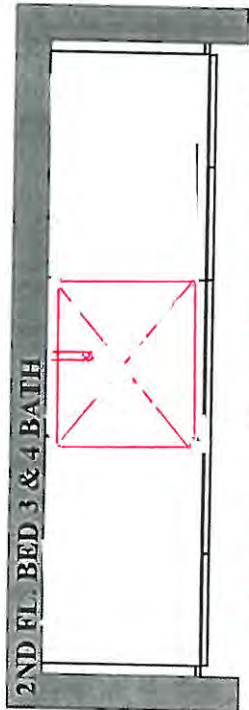

* Revised on floor plan - one sink

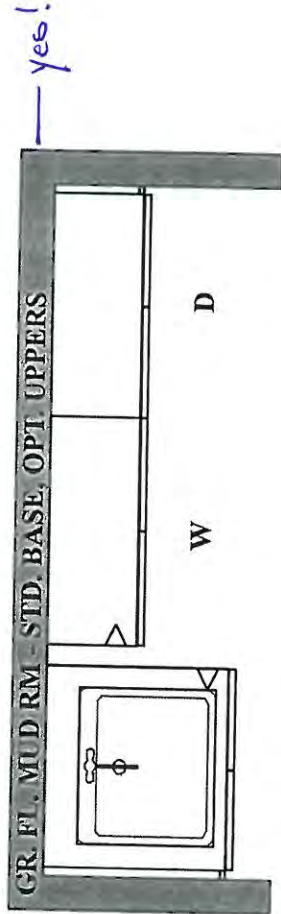
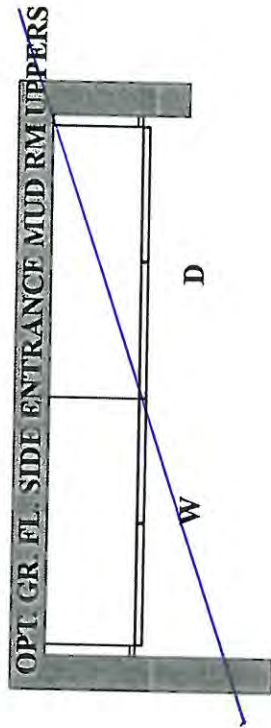
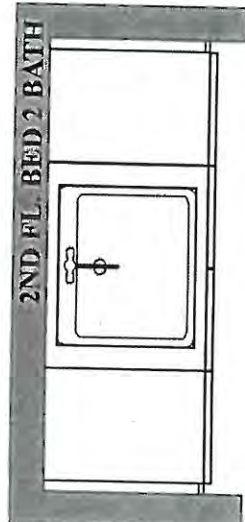

yes!

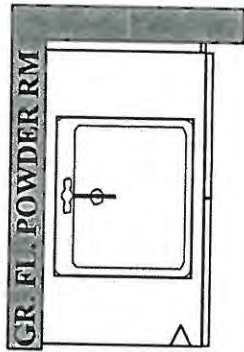
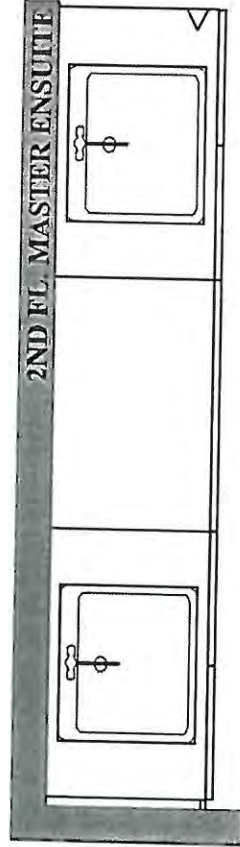

PLAN VIEW

Purchaser: INESSA GOLD

Property: 21 of Plan -

Telephone Res. / Bus: (416) 768-2677 / (416) 768-2677

Project: Pine Valley Forevergreen - Phase 1

Decor Advisor: Angela Phim

Model and Elevation: 40.03 A BROOKSIDE

Layout Changes: ☒ Yes ☐ No

Sketch Attached: ☒ Yes ☐ No

Exterior Colour Scheme:

1. Cabinetry

	Style and Colour	Counter	Hardware
Kitchen / Breakfast	*Medio 'Oyster'	*Quartz: 'Bianco Calacatta'	attachd
Laundry Room	n/a	n/a	n/a
Powder Room	Monterey 'Storm Grey OAK'	*Quartz: 'Calacatta Gold'	attachd
Mud Room	Bowery 'Avenza'	P-Lam 'White'	attachd
Master Ensuite Bathroom	Monterey 'Storm Grey OAK'	*Quartz: 'Calacatta Gold'	attachd
Second Ensuite Bathroom (If Applicable)	Chesapeake 'Classic White'	*Quartz: 'Empira White'	attachd
Ensuite 3/4	Monterey 'Storm Grey OAK'	*Quartz: 'Calacatta Gold'	attachd

Comment

REVISED
July 21, 2021
see attached

2. Floor Tile

	Selection
Entrance Vestibule	*12x24" Mamorea 'Bianco Calacatta' polished
Main Hall	n/a
Kitchen / Breakfast	*see hardwood
Laundry Room	n/a
Powder Room	*12x24" Mamorea 'Bianco Calacatta' polished
Mud Room	*12x24" Mamorea 'Bianco Calacatta' polished
Master Ensuite Bathroom	*12x24" Mamorea 'Bianco Calacatta' polished
Second Ensuite Bathroom (If Applicable)	*12x24" Carrara X 'White' polished
Lower Landing (If Applicable)	*12x24" Timeless 'Taupe' matte (basement foyer)
Ensuite 3/4	*12x24" Mamorea 'Bianco Calacatta' polished

Comment

Master Ensuite + Ensuite 3/4 Shower Floor: *Penny Round 'white' polished

3. Wall Tile

	Selection	Listello/Inserts	Describe
Master Ensuite Bathroom		<input type="radio"/> Yes <input checked="" type="radio"/> No	
Tub Deck		<input type="radio"/> Yes <input checked="" type="radio"/> No	
Shower Stall	*10x30" Inspire Art 'Calacatta'	<input type="radio"/> Yes <input checked="" type="radio"/> No	
Bathroom Walls		<input type="radio"/> Yes <input checked="" type="radio"/> No	
Second Ensuite Bathroom (If Applicable)	*3x6" Chess 'Arctic White'	<input type="radio"/> Yes <input checked="" type="radio"/> No	
Ensuite 3/4	*see comment	<input type="radio"/> Yes <input checked="" type="radio"/> No	
Kitchen Backsplash	<input type="radio"/> Yes <input checked="" type="radio"/> No	Backsplash Behind Fridge	

Comment

Ensuite 3/4 Wall Tile: 12x24" Marmorea 'Bianco Calacatta' polished

16

Purchaser: INESSA GOLD

Property: 21 of Plan -

Telephone Res. / Bus: (416) 768-2677 / (416) 768-2677

Project: Pine Valley Forevergreen - Phase 1

Decor Advisor: Angela Phim

Model and Elevation: 40.03 A BROOKSIDE

4. Plumbing Fixtures

Master Ensuite Bathroom Second Ensuite Powder Room
Other Room - Specify Other Washroom

Comment

*see attached

5. Hardwood Flooring

	Type and Stain		Type and Stain
Main Hall	<input type="text"/>	Upper Landing	<input type="text"/>
Kitchen / Breakfast	*5" WhiteOak, Sculpted, 'Apollo'	Upper Hall	<input type="text"/>
Living Room	<input type="text"/>	Master Bedroom	<input type="text"/>
Dining Room	<input type="text"/>	Bedroom #2	<input type="text"/>
Family Room	<input type="text"/>	Bedroom #3	<input type="text"/>
Den/Library	<input type="text"/>	Bedroom #4	<input type="text"/>
Entrance Vestibule	<input type="text"/>	Bedroom #5	<input type="text"/>
Lower Landing (If Applicable)	<input type="text"/>	Other Room - Specify thru-out standard areas	*5" WhiteOak, Sculpted, 'Apollo'

Comment

6. Carpeting

	Upgrade	Description
Ground Floor	<input type="checkbox"/>	<input type="text"/>
Second Floor	<input type="checkbox"/>	<input type="text"/>
<input type="text"/>	<input type="checkbox"/>	<input type="text"/>

	Type	Area
Upgrade Underpad	<input type="text"/>	<input type="text"/>
Carpet on Stairs	Capped <input type="text"/>	Runner - *Upgrade <input type="text"/>

Comment

7. Fireplace

	Living Room			Family Room			Other Room - Specify <input checked="" type="checkbox"/> Great Room		
	Purchased	As Per Plan	N/A	Purchased	As Per Plan	N/A	Purchased	As Per Plan	N/A
Fireplace Type	<input type="radio"/>	<input type="radio"/>	<input type="radio"/>	<input type="radio"/>	<input type="radio"/>	<input type="radio"/>	<input type="radio"/>	<input checked="" type="radio"/>	<input type="radio"/>
Mantle Type	<input type="text"/>	<input type="text"/>	<input type="text"/>	<input type="text"/>	<input type="text"/>	<input type="text"/>	<input type="text"/>	<input type="text"/>	<input type="text"/>
Colour / Stain	<input type="text"/>	<input type="text"/>	<input type="text"/>	<input type="text"/>	<input type="text"/>	<input type="text"/>	<input type="text"/>	<input type="text"/>	<input type="text"/>
Surround	<input type="text"/>	<input type="text"/>	<input type="text"/>	<input type="text"/>	<input type="text"/>	<input type="text"/>	<input type="text"/>	<input type="text"/>	<input type="text"/>
Hearth	<input type="text"/>	<input type="text"/>	<input type="text"/>	<input type="text"/>	<input type="text"/>	<input type="text"/>	<input type="text"/>	<input type="text"/>	<input type="text"/>

Comment

July 21, 2021

see attached

16

Purchaser: INESSA GOLD

Property: 21 of Plan -

Telephone Res. / Bus: (416) 768-2677 / (416) 768-2677

Project: Pine Valley Forevergreen - Phase 1

Decor Advisor: Angela Phim

Model and Elevation: 40.03 A BROOKSIDE

8. Trim Carpentry

Interior Doors Front Door Glass Inserts Door Handles
 Interior Trim
 Comment

9. Plaster Mouldings and Medallions

Standard Throughout ☐ Yes ☐ No ☐ N/A

Entrance Vestibule	<input type="text"/>	<input type="text"/>	Kitchen/Breakfast	<input type="text"/>	<input type="text"/>
Main Hall	<input type="text"/>	<input type="text"/>	Den/Library	<input type="text"/>	<input type="text"/>
Living Room	<input type="text"/>	<input type="text"/>	Lower Landing	<input type="text"/>	<input type="text"/>
Dining Room	<input type="text"/>	<input type="text"/>	Other Room - Specify	<input type="text"/>	<input type="text"/>
Family Room	<input type="text"/>	<input type="text"/>		<input type="text"/>	<input type="text"/>

Comment

10. Railings and Spindles

Railing Package
 Railing Colour Spindle Colour
 Stringer / Riser Treads
 Oak Stairs ☒ Yes ☐ No ☐ N/A
 Comment

11. Wall Paint / Ceilings

Throughout Finished Areas

 Trim Paint
 Smooth Ceilings
 Ground Floor ☒
 Second Floor ☒
 Note

Comment

July 21, 2021

see attached

I.6

Scheduled Closing Date: November 25, 2021

Purchaser: INESSA GOLD

Property: 21 of Plan -

Telephone Res. / Bus: (416) 768-2677 / (416) 768-2677

Project: Pine Valley Forevergreen - Phase 1

Decor Advisor: Angela Phim

Model and Elevation: 40.03 A BROOKSIDE

12. Electrical

Hood Fan ☐ White ☐ Stainless ☒ N/A

Above Kitchen Cabinet Light ☐ Yes ☒ No

Below Kitchen Cabinet Light ☐ Yes ☒ No

Standard Appliances ☐

Over The Range Microwave ☐

Chimney Style Fan ☐

Comment

13. Heating and Air Conditioning

Air Conditioning

Gas Provisions Stove

Gas Provisions Dryer

Gas Provisions Barbecue

Comment

14. Additional Comments

15. Disclaimers and Notes

- 1) Colours of all materials are as close as possible to builder's selection, but not necessarily identical due to variances in manufacturing.
- 2) Any extras listed above are null and void unless accompanied by a separate invoice/amendment. Said invoice must be paid in full.
- 3) The Purchaser acknowledges that after Interior Colour Selection form is signed and dated, no further changes will be permitted other than re-selection due to unavailability. ☒ Purchaser's Initials
- 4) The Purchaser acknowledges reading and accepting the "Gold Park Homes Decor Centre Disclaimers" form. This document contains other miscellaneous disclaimers.

This Interior Colour Selection is final and approved by:

Signature:

Date: July 14, 2021

see attached July 21, 2021

GOLDPARK

WORTH MORE

INTERIOR COLOUR SCHEME

*** NOTE: This is not an approved document. Document must be locked ***

Scheduled Closing Date: November 25, 2021

Purchaser: INESSA GOLD

Property: 21 of Plan -

Telephone Res. / Bus: (416) 768-2677 / (416) 768-2677

Project: Pine Valley Forevergreen - Phase 1

Decor Advisor: Angela Philm

Model and Elevation: 40.03 A BROOKSIDE

Layout Changes: ☒ Yes ☐ No

Sketch Attached: ☒ Yes ☐ No

Exterior Colour Scheme:

1. Cabinetry

	Style and Colour	Counter	Hardware
Kitchen / Breakfast	*Medio 'Oyster'	*Quartz: 'Blanco Calacatta'	attachd
Laundry Room	n/a	n/a	n/a
Powder Room	Monterey 'Storm Grey OAK'	*Quartz: 'Calacatta Gold'	attachd
Mud Room	Bowery 'Avenza'	P-Lam 'White'	attachd
Master Ensuite Bathroom	Monterey 'Storm Grey OAK'	*Quartz: 'Calacatta Gold'	attachd
Second Ensuite Bathroom (If Applicable)	Cresapeake 'Classic White'	*Quartz: 'Empira White'	attachd
Ensuite 3/4	Monterey 'Storm Grey OAK'	*Quartz: 'Calacatta Gold'	attachd

Comment

REVISED
July 21, 2021
J.G.

2. Floor Tile

	Selection
Entrance Vestibule	*12x24" Marmorea 'Blanco Calacatta' polished
Main Hall	n/a
Kitchen / Breakfast	*see hardwood
Laundry Room	n/a
Powder Room	*12x24" Marmorea 'Blanco Calacatta' polished
Mud Room	*12x24" Marmorea 'Blanco Calacatta' polished
Master Ensuite Bathroom	*12x24" Marmorea 'Blanco Calacatta' polished
Second Ensuite Bathroom (If Applicable)	*12x24" Carrara X 'White' polished
Lower Landing (If Applicable)	*12x24" Timeless 'Taupe' matte (basement foyer)
Ensuite 3/4	*12x24" Marmorea 'Blanco Calacatta' polished

Comment

Master Ensuite + Ensuite 3/4 Shower Floor: *Penny Round 'white' polished

3. Wall Tile

	Selection	Listello/Inserts	Describe
Master Ensuite Bathroom		<input type="radio"/> Yes <input checked="" type="radio"/> No	
Tub Deck		<input type="radio"/> Yes <input checked="" type="radio"/> No	
Shower Stall	*10x30" Inspire Art 'Calacatta'	<input type="radio"/> Yes <input checked="" type="radio"/> No	
Bathroom Walls		<input type="radio"/> Yes <input checked="" type="radio"/> No	
Second Ensuite Bathroom (If Applicable)	*3x6" Chess 'Arctic White'	<input type="radio"/> Yes <input checked="" type="radio"/> No	
Ensuite 3/4	*see comment	<input type="radio"/> Yes <input checked="" type="radio"/> No	
Kitchen Backsplash	<input type="radio"/> Yes <input checked="" type="radio"/> No	Backsplash Behind Fridge	

Comment

Ensuite 3/4 Wall Tile: 12x24" Marmorea 'Blanco Calacatta' polished

J.G.

GOLDPARK

WORTH MORE

INTERIOR COLOUR SCHEME

*** NOTE: This is not an approved document. Document must be locked ***

Scheduled Closing Date: November 25, 2021

Purchaser: INESSA GOLD

Property: 21 of Plan -

Telephone Res. / Bus: (416) 768-2677 / (416) 768-2677

Project: Pine Valley Forevergreen - Phase 1

Decor Advisor: Angela Phim

Model and Elevation: 40.03 A BROOKSIDE

4. Plumbing Fixtures

Master Ensuite Bathroom

Second Ensuite

Powder Room

Other Room - Specify

Other Washroom

Comment

Fee attached

5. Hardwood Flooring

Main Hall

Type and Stain

Upper Landing

Type and Stain

Kitchen / Breakfast

"5" WhiteOak, Sculpted, 'Apollo'

Upper Hall

Living Room

Master Bedroom

Dining Room

Bedroom #2

Family Room

Bedroom #3

Den/Library

Bedroom #4

Entrance Vestibule

Bedroom #5

Lower Landing
(If Applicable)

Other Room - Specify

thru-out standard areas

"5" WhiteOak, Sculpted, 'Apollo'

Comment

6. Carpeting

Ground Floor

Upgrade

☐

Description

Second Floor

☐☐

Upgrade Underpad

Type

Area

Carpet on Stairs

Capped

Runner - "Upgrade.

Comment

7. Fireplace

Living Room

Purchased

As Per Plan

N/A

Family Room

Purchased

As Per Plan

N/A

Other Room - Specify

Great Room

Purchased

As Per Plan

N/A

Fireplace Type

Standard Gas

Mantle Type

Mediterranean

Colour / Stain

Apollo White

Surround

n/a

Hearth

n/a

Comment

July 21, 2021

16

16

GOLDPARK

WORTH MORE

INTERIOR COLOUR SCHEME

*** NOTE: This is not an approved document. Document must be locked ***

Scheduled Closing Date: November 25, 2021

Purchaser: INESSA GOLD

Property: 21 of Plan -

Telephone Res. / Bus: (416) 768-2677 / (416) 768-2677

Project: Pine Valley Forevergreen - Phase 1

Decor Advisor: Angela Phin

Model and Elevation: 40.03 A BROOKSIDE

8. Trim Carpentry

Interior Doors Carrara Front Door Glass Inserts Standard Door Handles Standard

Interior Trim *Board 6

Comment

9. Plaster Mouldings and Medallions

Standard Throughout ☐ Yes ☐ No ☐ N/A

Entrance Vestibule	<u></u>	<u></u>	Kitchen/Breakfast	<u></u>	<u></u>
Main Hall	<u></u>	<u></u>	Den/Library	<u></u>	<u></u>
Living Room	<u></u>	<u></u>	Lower Landing	<u></u>	<u></u>
Dining Room	<u></u>	<u></u>	Other Room - Specify	<u></u>	<u></u>
Family Room	<u></u>	<u></u>			

Comment

10. Railings and Spindles

Railing Package *Package A-2

Railing Colour *Mirage 'Hopscotch' Spindle Colour *Black

Stringer / Riser *Mirage 'Hopscotch' Treads *Mirage 'Hopscotch'

Comment Oak Stairs ☒ Yes ☐ No ☐ N/A

11. Wall Paint / Ceilings

Throughout Finished Areas Warm Grey

Trim Paint White

Smooth Ceilings

Ground Floor ☒

Second Floor ☒

Note

Comment

July 21, 2021

I.G.

I.G.

GOLDPARK

WORTH MORE

INTERIOR COLOUR SCHEME

*** NOTE: This is not an approved document. Document must be locked ***

Scheduled Closing Date: November 25, 2021

Purchaser: INESSA GOLD

Property: 21 of Plan -

Telephone Res. / Bus: (416) 768-2677 / (416) 768-2677

Project: Pine Valley Forevergreen - Phase 1

Decor Advisor: Angela Phlm

Model and Elevation: 40.03 A BROOKSIDE

12. Electrical

Hood Fan ☐ White ☐ Stainless ☒ N/A

Above Kitchen Cabinet Light ☐ Yes ☒ No

Standard Appliances ☐

Below Kitchen Cabinet Light ☐ Yes ☒ No

Over The Range Microwave ☐

Chimney Style Fan ☐

Comment

13. Heating and Air Conditioning

Air Conditioning

Gas Provisions Stove

Gas Provisions Dryer

Gas Provisions Barbecue

Comment

14. Additional Comments

15. Disclaimers and Notes

- 1) Colours of all materials are as close as possible to builder's selection, but not necessarily identical due to variances in manufacturing.
- 2) Any extras listed above are null and void unless accompanied by a separate invoice/amendment. Said invoice must be paid in full.
- 3) The Purchaser acknowledges that after Interior Colour Selection form is signed and dated, no further changes will be permitted other than re-selection due to unavailability. I.S. Purchaser's Initials
- 4) The Purchaser acknowledges reading and accepting the "Gold Park Homes Decor Centre Disclaimers" form. This document contains other miscellaneous disclaimers.

This Interior Colour Selection is final and approved by:

Signature: I.S.

Date: July 14, 2021



SCHEDULE 'F'

PV-21

June 17, 2021

attached

PV-21

July 13, 2021

(I6.)

The Brookside 40' SERIES

Elevation A • 3,380 sq.ft.
Elevation B • 3,350 sq.ft.

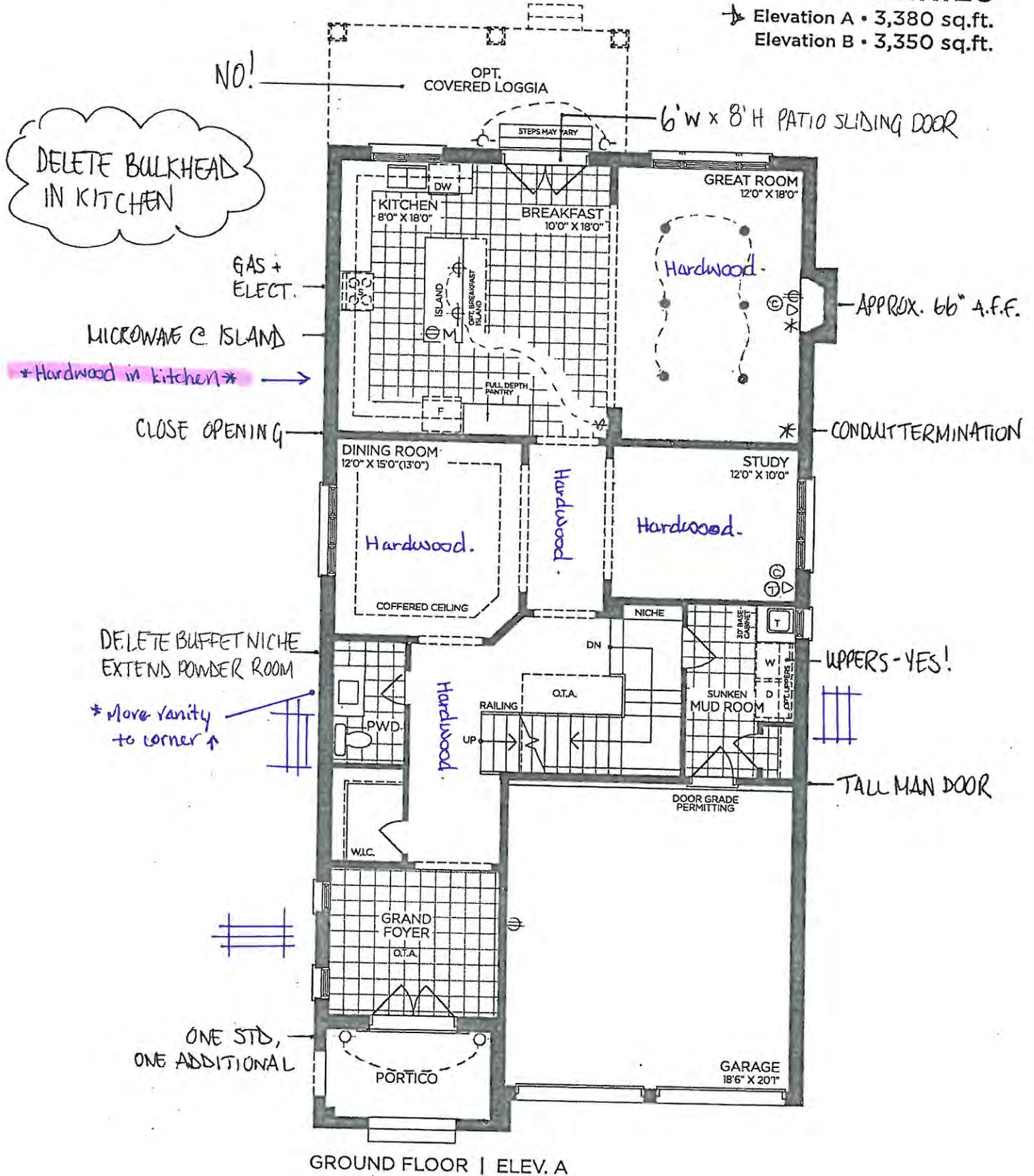

GROUND FLOOR | ELEV. A

VENDOR	
PURCHASER	
PURCHASER	

GOLDPARK
WORTH MORE™

Prices, figures, illustrations, sizes, features and finishes are subject to change without notice. Areas and dimensions are approximate and actual usable floor space may vary from the stated area. Layout may be reverse of the unit purchased. E. & O.E. 4003



8' DOORS
THRU OUT

SCHEDULE 'F'
PV-21
June 17, 2021
PV-21
July 13, 2021

attached

16

The Brookside 40' SERIES

Elevation A • 3,380 sq.ft.
Elevation B • 3,350 sq.ft.

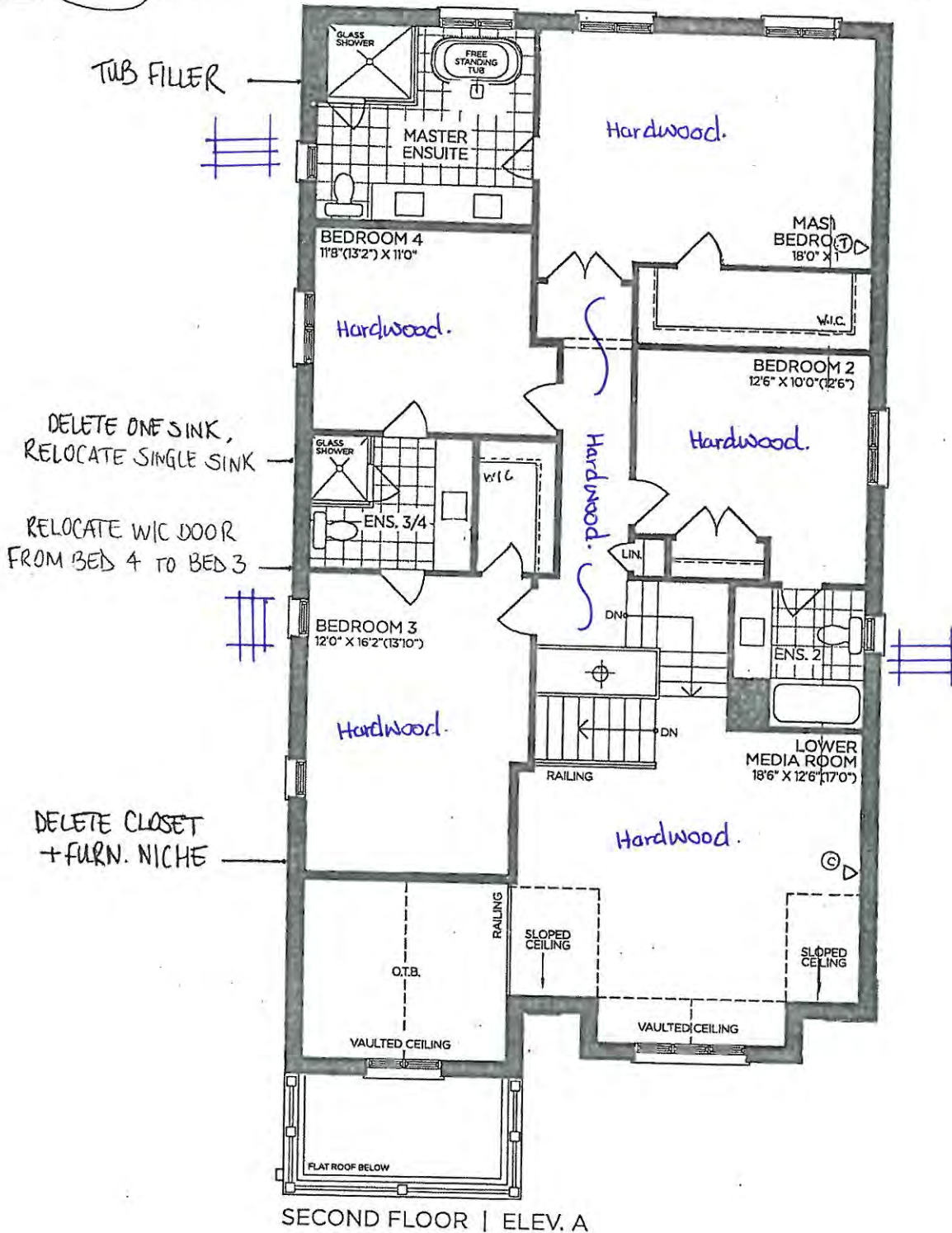

VENDOR	
PURCHASER	
PURCHASER	

GOLDPARK
WORTH MORE™

Prices, figures, illustrations, sizes, features and finishes are subject to change without notice. Areas and dimensions are approximate and actual usable floor space may vary from the stated area. Layout may be reverse of the unit purchased. E. & O.E. 4003



SCHEDULE 'F'

PV-21

June 17, 2021

attached

PV-21

July 13, 2021

E.G.

The Brookside

40' SERIES

Elevation A • 3,380 sq.ft.
Elevation B • 3,350 sq.ft.

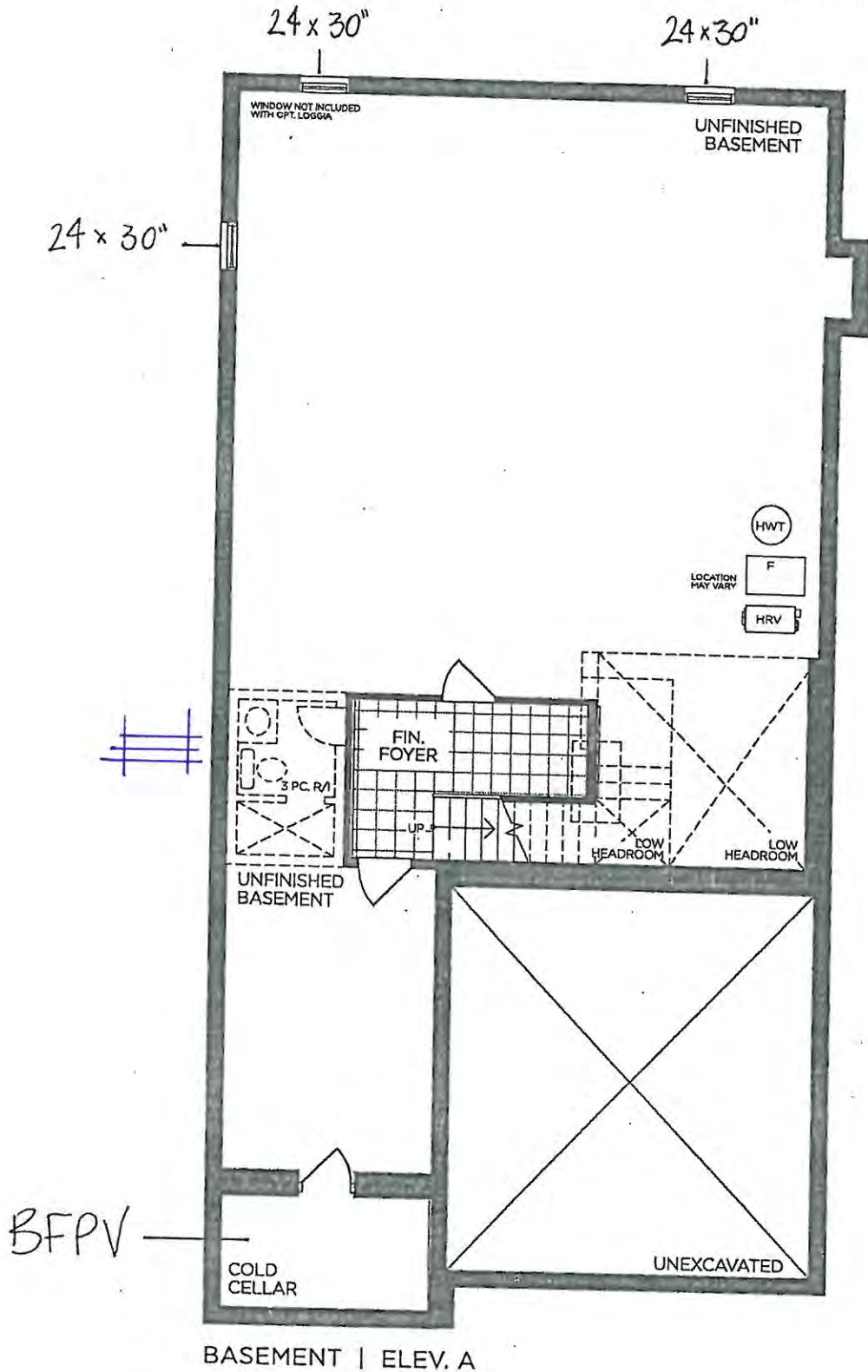

BASEMENT | ELEV. A

VENDOR	<input type="text"/>
PURCHASER	<input type="text"/>
PURCHASER	<input type="text"/>

GOLDPARK
WORTH MORE™

Prices, figures, illustrations, sizes, features and finishes are subject to change without notice. Areas and dimensions are approximate and actual usable floor space may vary from the stated area. Layout may be reverse of the unit purchased. E. & O.E. 4003



PINE VALLEY
FOREVERGREEN

STONE COUNTERTOP EDGE PROFILES

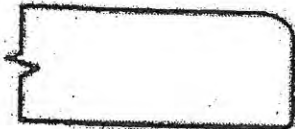

STANDARD 2CM EASED EDGE

LOCATION:

thru-out

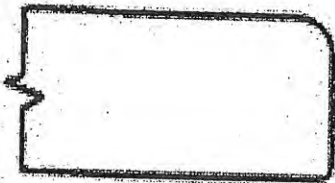

UPGRADE 3CM EASED EDGE

LOCATION:



UPGRADE 4CM MITRED EDGE



LOCATION:



UPGRADE 2CM OGEE EDGE

LOCATION:

LOT #: PV-21

DATE: July 13, 2021

SIGNATURE:

I.G.

SIGNATURE:

I.G.



PINE VALLEY

FOREVERGREEN

STANDARD HARDWARE / KNOBS

☐

K002-02

☒

K002-03

→ Powder Room → Master Ensuite
→ Ensuite 2 → Ensuite 3/4

☐

K002-04

☐

K002-06

☐

K002-05

☐

K008-14

☐

K024-03

☐

*NO HARDWARE

☐

TOUCH-LATCH

*DISCLAIMER: NO HARDWARE OR HOLES THRU-OUT: HOMEOWNER IS RESPONSIBLE FOR THE INSTALLATION OF THEIR OWN HARDWARE AFTER CLOSING AT THEIR OWN EXPENSE AND WARRANTY.

LOT #

PV-21

DATE:

July 13, 2021

SIGNATURE:

I.G.

SIGNATURE:

I.G.



PINE VALLEY
FOREVERGREEN

STANDARD HARDWARE / HANDLES

☐

H001-02

☐

H001-03

☐

H001-04

☐

H009-03

☐

H009-09

☐

TOUCH-LATCH

☐

H011-03

☐

H011-05

☐

H011-06

☐

H033-01

☒

H039-03

→ Mud Room

☐

*NO HARDWARE

*DISCLAIMER: NO HARDWARE OR HOLES THRU-OUT: HOMEOWNER IS RESPONSIBLE FOR THE INSTALLATION OF THEIR OWN HARDWARE AFTER CLOSING AT THEIR OWN EXPENSE AND WARRANTY.

LOT # 8V-21

DATE: July 13, 2021

SIGNATURE:

S.G.

SIGNATURE:

S.G.

H050-21

Pull - 'Antiqued Nickel'





LOCATION:

→ Kitchen

LOT #
PV-21

DATE:
July 13, 2021

SIGNATURE: 

SIGNATURE: 



PINE VALLEY
FOREVERGREEN

UPGRADE KITCHEN SINK

BLANCO - QUATRUS R15 U 2
Stainless Steel - Undermount
32" x 18" x 9"

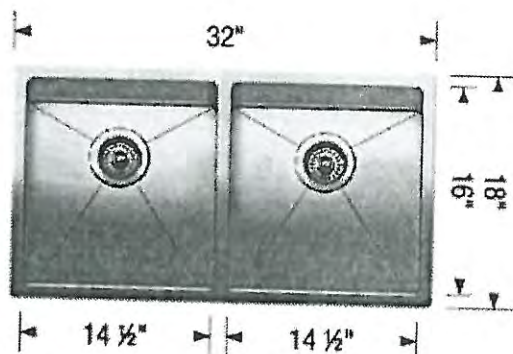

Stainless Steel

MODEL 401519 Stainless Steel /

Lot#

PV-21

Room:

Kitchen

Signature:

Date:

July 13, 2021

Signature:

GOLDPARK
WORTH MORE™

UPGRADE SHOWER HARDWARE

SQ6X6

Shower Door Handle

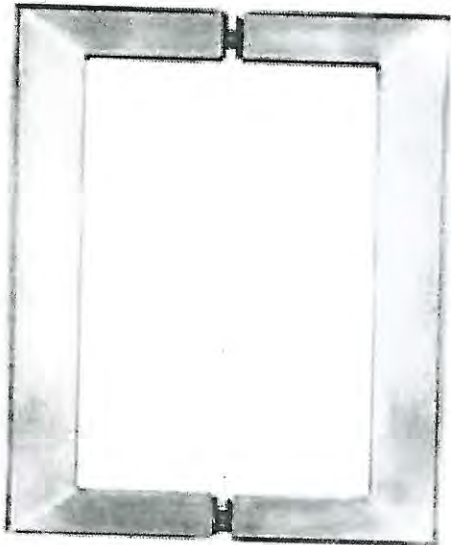

SQ6X6
Shower Door Handle

6" x 6" back-to-back
3/4" square tube

- ☒ CHROME
- ☐ MATTE BLACK

Lot# PY-21	Date: July 13, 2021	Room: Master Ensuite + Ensuite 3/4
Signature: I.B.		
Signature:		

BATHROOM ACCESSORIES

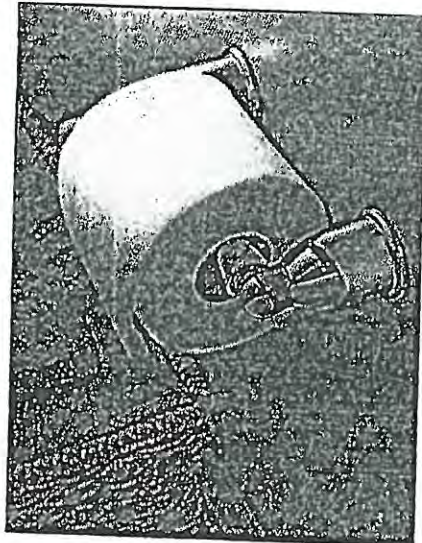

Tissue Holder
Mason - Chrome

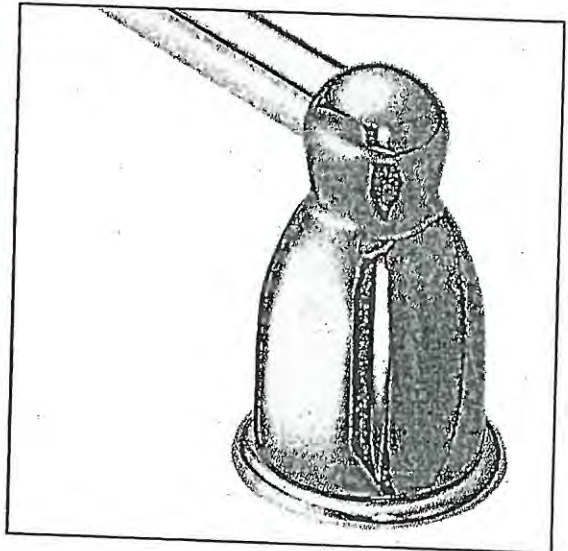

Towel Bar
Mason - Chrome

Please select one of the following:

☐ INSTALL STANDARD BATHROOM ACCESSORIES THRU OUT
(tissue holder + towel bar) **location as per vendors discretion**

☒ ***DO NOT*** INSTALL STANDARD BATHROOM ACCESSORIES
THRU OUT **tissue holder + towel bar will not be provided**

LOT #

PV-21

DATE:

July 13, 2021

SIGNATURE:

I.6

SIGNATURE:

I.6



Project: Pine Valley

Lot: 21

Purchaser(s): NESSA GOLD

Standard Hood Fan Deletion

We acknowledge that the builder's standard hood fan will not be installed.
Do not supply, install and/or credit. We will install our own hood fan after closing.

Signature:

I.G.

Signature:

Date:

July 13, 2021

UPGRADE KITCHEN EXTRA



CLASSIC RANGE HOOD

(Insert fan not included)

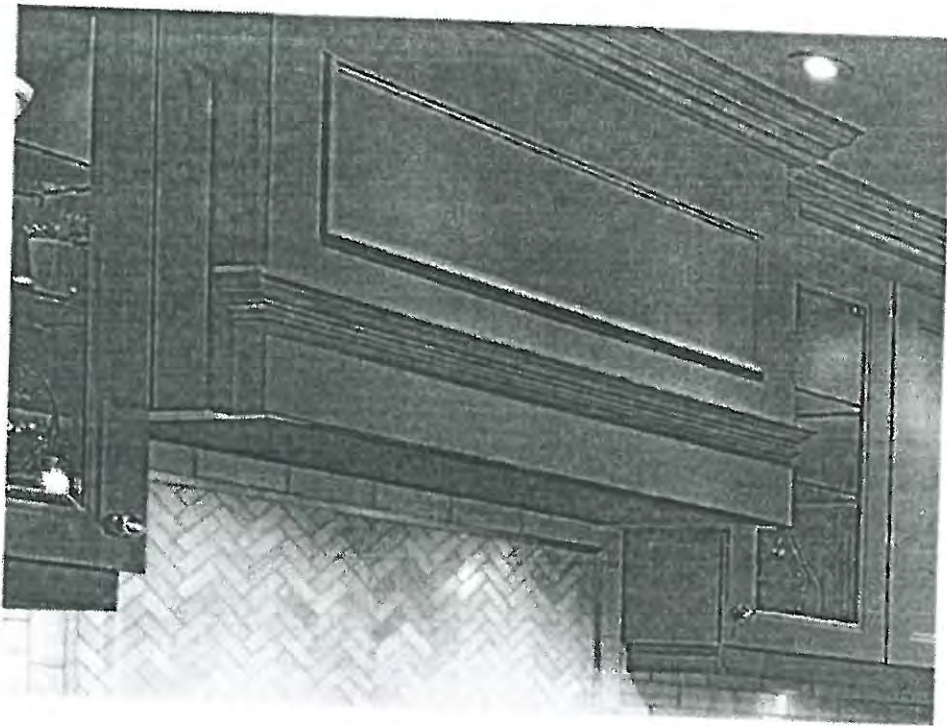

LOT # *PV-21*

ROOM: *Kitchen*

DATE: *July 13, 2021*

SIGNATURE:

H. G.

SIGNATURE:



PINE VALLEY
FOREVERGREEN

PLUMBING UPGRADES

MOEN - ARRIS

Posi-Temp Tub/Shower Faucet with 3 Function Transfer Valve/Trim and Slide Bar
with Handshower



☒ CHROME

*from CEILING

☐ BRUSHED NICKEL (BN)

☐ MATTE BLACK (BL)

MODEL: TS22002EP / U361CI / UTS23005 / 62320 / 3887EP / A725 / 226651

Lot# PV-21	Date: June 17, 2021	Room: Master Ensuite, Shared Ensuite
Signature: attached		
Signature:		



PLUMBING UPGRADES

MOEN - ARRIS

Single Freestanding Tub Filler



☒ CHROME

☐ BRUSHED NICKEL (BN)

MODEL: TS50100 / S93005 / T90331 / 140680

Lot# PV-21	Date: June 17, 2021	Room: Master Ensuite
Signature: attached		
Signature:		

PLUMBING UPGRADES



MOEN - ARRIS

Posi-Temp Tub/Shower Faucet with 3 Function Transfer Valve/Trim and Slide Bar with Handshower

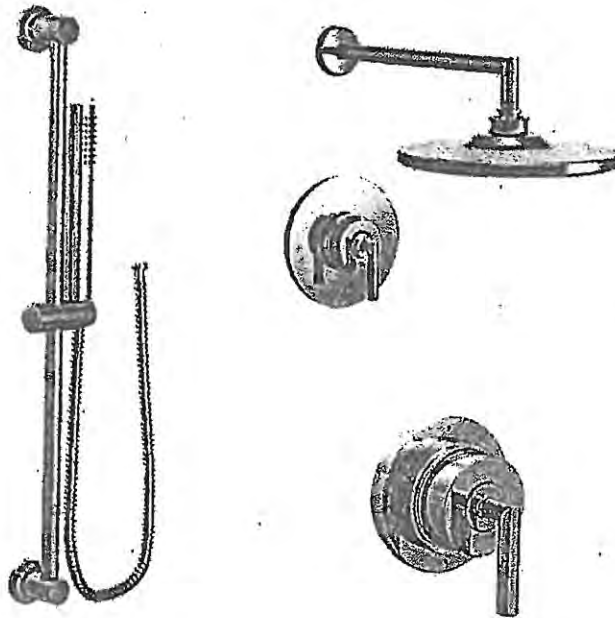

☒ CHROME

☐ BRUSHED NICKEL (BN)

☐ MATTE BLACK (BL)

*from CEILING

MODEL: TS22002EP / U361CI / UTS23005 / 62320 / 3887EP / A725 / 226651

Lot# PV-21	Date: June 17, 2021	Room: Master Ensuite, Shared Ensuite
Signature: 		
Signature:		

GOLDPARK
WORKS

PLUMBING UPGRADES



MOEN - ARRIS
Single Freestanding Tub Filler



- ☒ CHROME
- ☐ BRUSHED NICKEL (BN)

MODEL: TS50100 / S99005 / T90331 / 140680

Lot# PV-21	Date: June 17, 2021	Room: Master Ensuite
Signature:		
Signature:		

PV-ZI
July 13 2021
I.G.

DIMENSIONS

1 of 30

COMMERCIAL-STYLE RANGES

PRODUCT DIMENSIONS

*

MODEL #	30" (76.2 cm) RANGES DUAL-FUEL/GAS KFDC300J/KFGC300J		36" (91.4 cm) RANGES DUAL-FUEL/GAS KFDC360J/KFGC360J	
	in	cm	in	cm
Overall Width (A)	29 $\frac{7}{8}$	75.9	35 $\frac{7}{8}$	91.1
Bullnose Height (B)	2 $\frac{3}{16}$	5.6	2 $\frac{3}{16}$	5.6
Control Panel Height (C)	5 $\frac{5}{16}$	13.5	5 $\frac{5}{16}$	13.5
Door Height (D)	20 $\frac{1}{16}$	52.6	20 $\frac{1}{16}$	52.6
Door Bottom to Handle Top (E)	20	50.8	20	50.8
Toe-Kick Height (F)	5 $\frac{1}{2}$	14	5 $\frac{1}{2}$	14

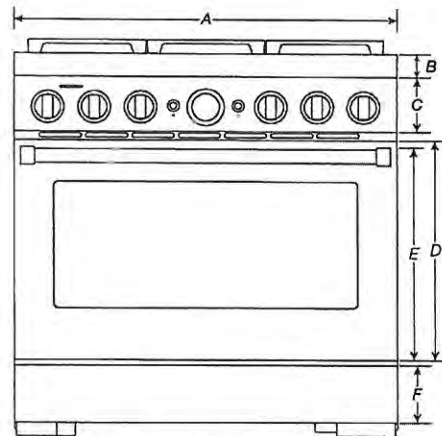

FRONT VIEW

IMPORTANT: Dimensional specifications are provided for planning purposes only. Do not make any cutouts based on this information. Refer to the Installation Guide before selecting cabinetry, verifying electrical/gas connections, making cutouts or beginning installation. All KitchenAid® appliances are appropriately UL, CUL or CSA approved.

KitchenAid®

W11255637A

PV-Z1

July 13, 2021

Σ.6

DIMENSIONS

3 of 30

COMMERCIAL-STYLE RANGES

PRODUCT DIMENSIONS

MODEL #	30" (76.2 cm) RANGES DUAL-FUEL/GAS KFD0500J/KFG0500J		36" (91.4 cm) RANGES DUAL-FUEL/GAS KFD0506J/KFG0506J	
	in	cm	in	cm
Depth with Control Panel Overhang (G)	27 ³ / ₄	70.5	27 ³ / ₄	70.5
Depth with Handle (H)	30 ¹ / ₄	76.9	30 ¹ / ₄	76.9
Depth with Door Fully Open (I)	46 ¹ / ₂	118.1	46 ¹ / ₂	118.1

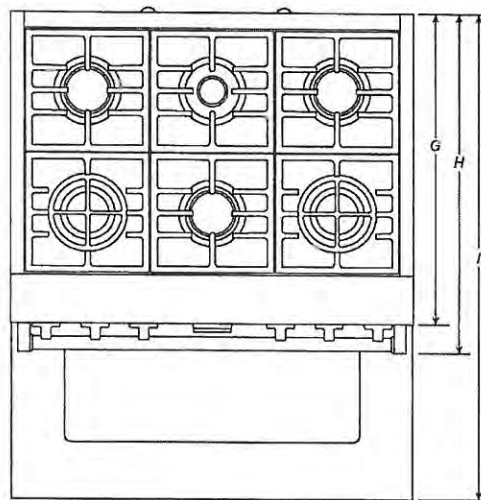

TOP VIEW

IMPORTANT: Dimensional specifications are provided for planning purposes only. Do not make any cutouts based on this information. Refer to the Installation Guide before selecting cabinetry, verifying electrical/gas connections, making cutouts or beginning installation. All KitchenAid® appliances are appropriately UL, CUL or CSA approved.

KitchenAid®

PV-21

July 13 2021

1-6

DIMENSIONS

5 of 30

COMMERCIAL-STYLE RANGES

PRODUCT DIMENSIONS

*

MODEL #	30" (76.2 cm) RANGES DUAL-FUEL/GAS KFDG500J/KFDG500J1		36" (91.4 cm) RANGES DUAL-FUEL/GAS KFDG500J/KFDG500J1		48" (121.9 cm) RANGES DUAL-FUEL/GAS KFDG558J/KFDG558J1	
	in	cm	in	cm	in	cm
Grates Top Height (A)	37 $\frac{3}{16}$	94.5	37 $\frac{3}{16}$	94.5	37 $\frac{3}{16}$	94.5
Cooking Surface Top Height (B)	36	91.4	36	91.4	36	91.4
Door Top Height (C)	27 $\frac{7}{8}$	70.8	27 $\frac{7}{8}$	70.8	27 $\frac{7}{8}$	70.8
Handle Top Height (D)	27 $\frac{7}{8}$	68.9	27 $\frac{7}{8}$	68.9	27 $\frac{7}{8}$	68.9
Toe-Kick Height (E)	6 $\frac{5}{8}$	16.9	6 $\frac{5}{8}$	16.9	6 $\frac{5}{8}$	16.9
OTHER DIMENSIONS						
Maximum Feet Extension Height*	1 $\frac{1}{2}$	3.8	1 $\frac{1}{2}$	3.8	1 $\frac{1}{2}$	3.8

* IMPORTANT: Minimum height dimensions are at the lowest point of the height adjustment range. When the leveling legs are fully extended, all heights have 1 $\frac{1}{2}$ " (3.8 cm) of added height.

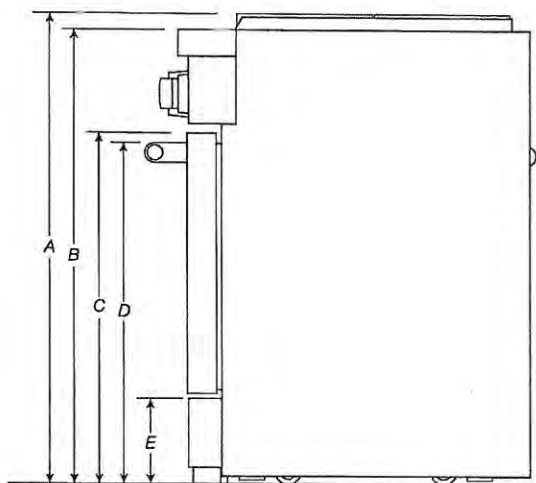

SIDE VIEW

IMPORTANT: Dimensional specifications are provided for planning purposes only. Do not make any cutouts based on this information. Refer to the Installation Guide before selecting cabinetry, verifying electrical/gas connections, making cutouts or beginning installation. All KitchenAid® appliances are appropriately UL, CUL or CSA approved.

KitchenAid®

PV-Z1
July 13 2021

5.6

DIMENSIONS

6 of 30

COMMERCIAL-STYLE RANGES

PRODUCT DIMENSIONS



MODEL #	30" (76.2 cm) RANGES DUAL-FUEL/GAS KFGC500J/KFGC506J		36" (91.4 cm) RANGES DUAL-FUEL/GAS KFGC506J/KFGC506J		48" (121.9 cm) RANGES DUAL-FUEL/GAS KFGC558J/KFGC558J	
	in	cm	in	cm	in	cm
Depth with Door Fully Open (F)	46½	118.1	46½	118.1	46½	118.1
Depth with Handle (G)	30¼	76.9	30¼	76.9	30¼	76.9
Depth with Control Panel Overhang (H)	27¾	70.5	27¾	70.5	27¾	70.5
Depth to Toe-Kick with Door (I)	27	68.6	27	68.6	27	68.6
Depth with Door (J)	27	68.6	27	68.6	27	68.6
OTHER DIMENSIONS						
Gas Vent Height (K)*	39	99.1	39	99.1	39	99.1

*Gas Units only: KFGC500J, KFGC506J and KFGC558J.

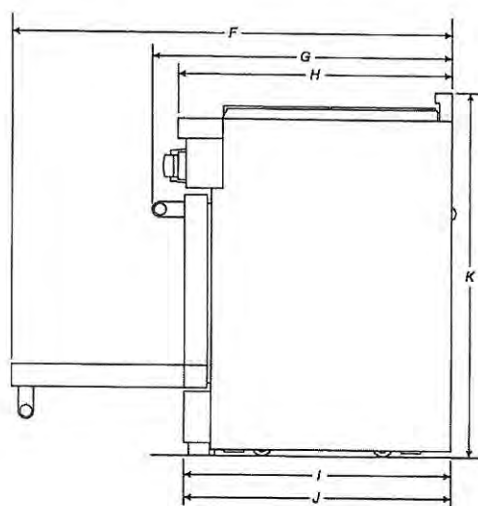

SIDE VIEW

IMPORTANT: Dimensional specifications are provided for planning purposes only. Do not make any cutouts based on this information. Refer to the Installation Guide before selecting cabinetry, verifying electrical/gas connections, making cutouts or beginning installation. All KitchenAid® appliances are appropriately UL, CUL or CSA approved.

KitchenAid®

PV-21

July 13 2021

I-6

DIMENSIONS

COMMERCIAL-STYLE RANGES

7 of 30

OPENING/CLEARANCE DIMENSIONS

*

MODEL #	30" (76.2 cm) RANGES DUAL-FUEL/GAS KFDG500J/KFGC500J		36" (91.4 cm) RANGES DUAL-FUEL/GAS KFDG500J/KFGC500J		48" (121.9 cm) RANGES DUAL-FUEL/GAS KFDG550J/KFGC550J	
	in	cm	in	cm	in	cm
Combustible Area above Cooking Surface Width (min.) (A)	30	76.2	36	91.4	48	121.9
Bottom of Cabinet Height above Cooking Surface (min.) (B)*	42	106.7	58	147.3	58	147.3
Bottom of Cabinet Height above Countertop (min.) (C)	18	45.7	18	45.7	18	45.7
Distance to Fixed Wall or Combustible Material (min.) (D)	12	30.5	12	30.5	12	30.5
Opening Width (min.) (E)	30	76.2	36	91.4	48	121.9

* If installing a hood or hood liner above the range, follow the hood or hood liner instructions for dimensional clearances above the cooking surface.

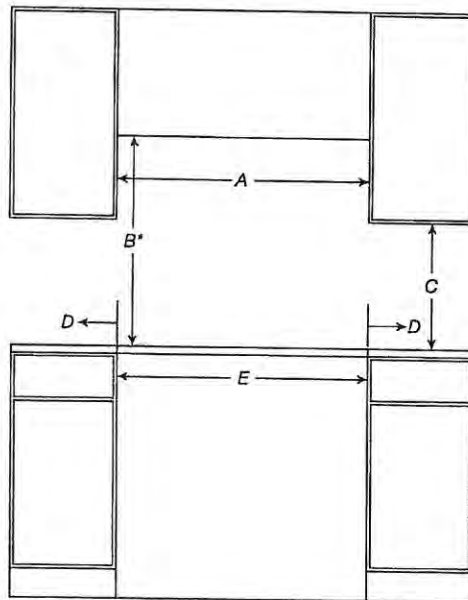

FRONT VIEW

IMPORTANT: Dimensional specifications are provided for planning purposes only. Do not make any cutouts based on this information. Refer to the Installation Guide before selecting cabinetry, verifying electrical/gas connections, making cutouts or beginning installation. All KitchenAid® appliances are appropriately UL, CUL or CSA approved.

KitchenAid®

PV-21

July 13 2021

5-6-

DIMENSIONS

COMMERCIAL-STYLE RANGES

8 of 30

OPENING/CLEARANCE DIMENSIONS

*

MODEL #	30" (76.2 cm) RANGES DUAL-FUEL/GAS KFDL500J/KFGC500J		36" (91.4 cm) RANGES DUAL-FUEL/GAS KFDG506J/KFGC506J		48" (121.9 cm) RANGES DUAL-FUEL/GAS KFDG558J/KFGC558J	
	IN	CM	IN	CM	IN	CM
Upper Cabinet Depth (max.) (F)	13	33	13	33	13	33
Depth from Wall to Grates (G)*	1½	3.9	1½	3.9	1½	3.9
Depth from Wall to back of Unit**	0	0	0	0	0	0

* If the back wall is constructed of a combustible material and a backsplash is not installed a 7½" (19.1 cm) minimum clearance is required.

** If the back wall is constructed of a combustible material and a backsplash is not installed a 6" (15.2 cm) minimum clearance is required.

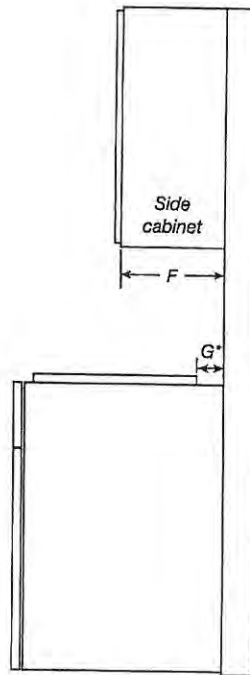

SIDE VIEW

IMPORTANT: Dimensional specifications are provided for planning purposes only. Do not make any cutouts based on this information. Refer to the Installation Guide before selecting cabinetry, verifying electrical/gas connections, making cutouts or beginning installation. All KitchenAid® appliances are appropriately UL, CUL or CSA approved.

KitchenAid®

PV-21

July 13 2021

F-9

DIMENSIONS

COMMERCIAL-STYLE RANGES

9 of 30

ELECTRICAL REQUIREMENTS

*

MODEL #	30" (76.2 cm) RANGES DUAL-FUEL/GAS KFDG500J/KFPG500J		36" (91.4 cm) RANGES DUAL-FUEL/GAS KFDG506J/KFPG506J		48" (121.9 cm) RANGES DUAL-FUEL/GAS KFDG558J/KFPG558J	
	IN	CM	IN	CM	IN	CM
Electrical Zone Width (A)	22	55.9	28	71.1	40	101.6
Electrical Zone Height (B)	15	38.1	15	38.1	15	38.1
Electrical Zone Depth (C)	5	12.7	5	12.7	5	12.7

ELECTRIC REQUIREMENTS CHECKLIST	
<input type="checkbox"/>	A 240 V, 60 Hz, fused, grounded circuit is required.
<input type="checkbox"/>	For 30" (76.2 cm) and 36" (91.4 cm) ranges, use a 40 A circuit.
<input type="checkbox"/>	For 48" (121.9 cm) ranges, use a 50 A circuit.
<input type="checkbox"/>	A dedicated circuit is recommended.

RECOMMENDED ELECTRICAL ZONE

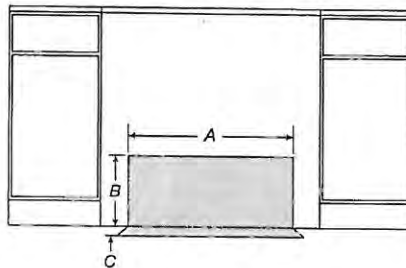

FRONT VIEW

WIDTH TO ELECTRICAL CONDUIT

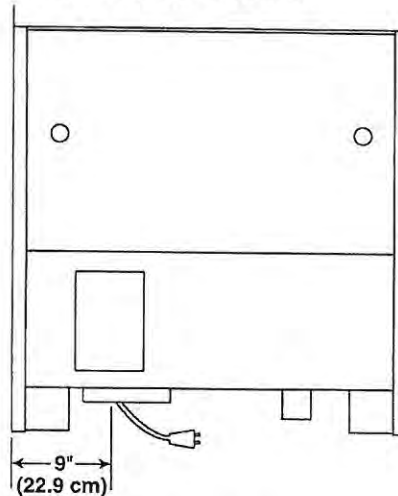

BACK VIEW

NOTE: If you have questions about your electrical supply, call a licenced, qualified electrician.

IMPORTANT: Dimensional specifications are provided for planning purposes only. Do not make any cutouts based on this information. Refer to the Installation Guide before selecting cabinetry, verifying electrical/gas connections, making cutouts or beginning installation. All KitchenAid® appliances are appropriately UL, CUL or CSA approved.

KitchenAid®

PV-Z1

July 13 2021

5.9

DIMENSIONS

COMMERCIAL-STYLE RANGES

10 of 30

GAS REQUIREMENTS

*

MODEL #	30" (76.2 cm) RANGES DUAL-FUEL/GAS KFDCC500J/KFGC500J		36" (91.4 cm) RANGES DUAL-FUEL/GAS KFDCC506J/KFGC506J		48" (121.9 cm) RANGES DUAL-FUEL/GAS KFDCC558J/KFGC558J	
	in	cm	in	cm	in	cm
Gas Opening Width (A)	6	15.2	14	35.6	24	61
Gas Opening Height (B)	3	7.6	3	7.6	3	7.6
Gas Opening Depth (C)	5	12.7	5	12.7	5	12.7
Distance from Side Cabinet to Gas Opening (D)	9	22.9	9	22.9	9	22.9
Width to Gas Inlet (E)	12 $\frac{3}{4}$	32.4	12 $\frac{3}{4}$	32.4	12 $\frac{3}{4}$	32.4

RECOMMENDED GAS ZONE

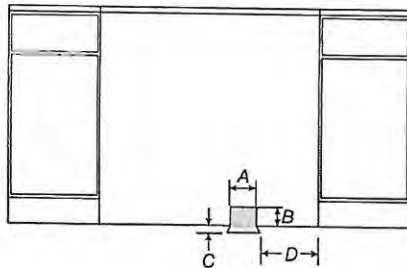

FRONT VIEW

WIDTH TO GAS INLET

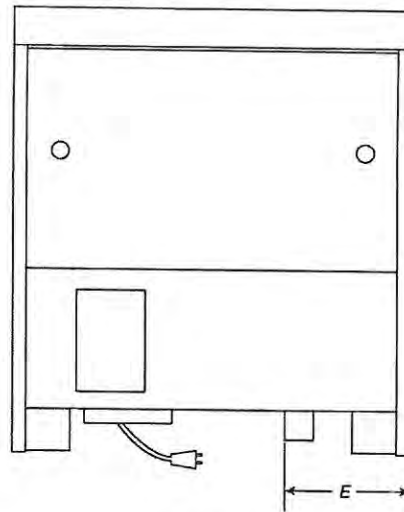

BACK VIEW

NOTE: If you have questions about your gas supply, call a licenced, qualified service technician.

IMPORTANT: Dimensional specifications are provided for planning purposes only. Do not make any cutouts based on this information. Refer to the Installation Guide before selecting cabinetry, verifying electrical/gas connections, making cutouts or beginning installation. All KitchenAid® appliances are appropriately UL, CUL or CSA approved.

KitchenAid®
W11255637A

PV-21
July 13 2021



KitchenAid®

*
24" (61.0 CM) MICROWAVE DRAWER
INSTALLATION INSTRUCTIONS

INSTRUCTIONS D'INSTALLATION DU TIROIR À
MICRO-ONDES DE 24 PO (61,0 CM)

Table of Contents/Table des matières

MICROWAVE DRAWER SAFETY	2	SÉCURITÉ DU TIROIR À MICRO-ONDES	9
INSTALLATION REQUIREMENTS	3	EXIGENCES D'INSTALLATION	10
Tools and Parts	3	Outils et pièces	10
Location Requirements	3	Exigences d'emplacement	10
Minimum Dimensions	3	Dimensions minimales	10
Electrical Requirements	4	Spécifications électriques	11
24" (61.0 CM) STANDARD MOUNT	5	SUPPORT STANDARD DE 24 PO (61,0 CM)	11
Cabinet Preparation	5	Préparation de l'armoire	11
INSTALLATION INSTRUCTIONS	6	INSTRUCTIONS D'INSTALLATION	12
Install the Anti-Tip Block	6	Installation de la cale de bride anti-basculement	12
Install the Microwave Drawer	6	Installation du tiroir à micro-ondes	12
Complete Installation	7	Terminer l'installation	13
ASSISTANCE	7	ASSISTANCE	13

IMPORTANT:

Installer: Leave installation instructions with the homeowner.
Homeowner: Keep installation instructions for future reference.

IMPORTANT:

Save for local electrical inspector's use.

IMPORTANT :

Installateur : Remettre les instructions d'installation au propriétaire.

Propriétaire : Conserver les instructions d'installation pour référence ultérieure.

IMPORTANT :

À conserver pour consultation par l'inspecteur local des installations électriques.

PV-21

July 13 2021



INSTALLATION REQUIREMENTS

These installation instructions cover different models. The appearance of your particular model may differ slightly from the illustrations in these Installation Instructions.

Tools and Parts

Gather the required tools and parts before starting installation. Read and follow the instructions provided with any tools listed here.

Tools needed

- Tape measure
- 1/8" (3.17 mm) drill bit
- #2 Phillips screwdriver
- Marker or pencil
- Drill

Parts supplied

The Microwave Drawer is preassembled.

- 1" (2.5 cm) mounting screws (4)

Verification needed

- Installer must confirm presence of anti tip block. Refer to the anti-tip block section in the manual.
- Check local codes. Check existing electrical supply. See "Electrical Requirements".
- It is required that all electrical connections be made by a licensed, qualified electrical installer.

Location Requirements

This product is suitable for use below electric or gas built-in ovens. This product is not suitable for use below cooktops. The Microwave Drawer may be located in a cabinet or below the counter, and/or below a built-in oven. Check the opening where the Microwave Drawer will be installed. The location must provide:

IMPORTANT: Observe all governing codes and ordinances.

- Wood cabinetry.
- Cutout opening that is plumb and square. See "Minimum Cutout Dimensions" in the "Minimum Dimensions" section.
- Cutout floor that is solid, level, and flush with bottom of cabinet cutout.
- Support for weight of at least 100 lbs (45.4 kg), which includes Microwave Drawer and items placed inside.
- Grounded electrical outlet. See the "Electrical Requirements" section.
- Minimum installation clearances for installation location. See the "Minimum Dimensions" section.
- Complete enclosure around the recessed portion of the Microwave Drawer.

Minimum Dimensions

Minimum Wall Oven Combination Installation Clearances

For proper installation, the following minimum clearances must exist above and below the cutout opening.

NOTE : Upper oven must have heat deflector kit installed to direct exhaust away from microwave console (Refer to Wall Oven Manual for Deflector Kit Installation)

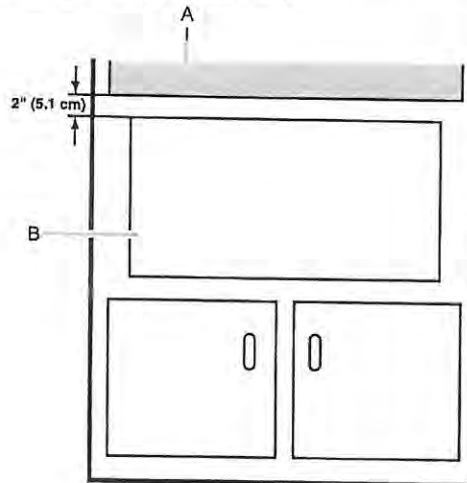

A. Upper oven cutout

B. Microwave drawer cutout

PV-21
July 13 2021

1.9

Electrical Requirements

⚠ WARNING



Electrical Shock Hazard

Plug into a grounded 3 prong outlet.
Do not remove ground prong.
Do not use an adapter.
Do not use an extension cord.
Failure to follow these instructions can result in death, fire, or electrical shock.

IMPORTANT: Observe all governing codes and ordinances.

Required:

- A 120 V, 60 Hz, AC-only, 15 or 20 A electrical supply with a fuse or circuit breaker.

Recommended:

- A time-delay fuse or time-delay circuit breaker
- A separate circuit serving only this Microwave Drawer

GROUNDING INSTRUCTIONS

- **For all cord connected appliances:**
The microwave oven must be grounded. In the event of an electrical short circuit, grounding reduces the risk of electric shock by providing an escape wire for the electric current. The microwave oven is equipped with a cord having a grounding wire with a grounding plug. The plug must be plugged into an outlet that is properly installed and grounded.

WARNING: Improper use of the grounding plug can result in a risk of electric shock. Consult a qualified electrician or serviceman if the grounding instructions are not completely understood, or if doubt exists as to whether the microwave oven is properly grounded.

Do not use an extension cord. If the power supply cord is too short, have a qualified electrician or serviceman install an outlet near the microwave oven. A short power supply cord is provided to reduce the risks resulting from becoming entangled in or tripping over a longer cord.

SAVE THESE INSTRUCTIONS

Product Dimensions

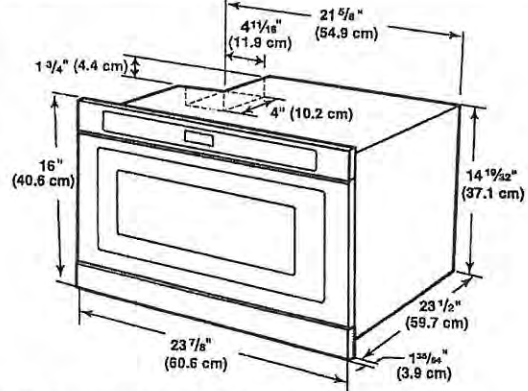

The drawer opens $15\frac{1}{4}"$ (38.7 cm).

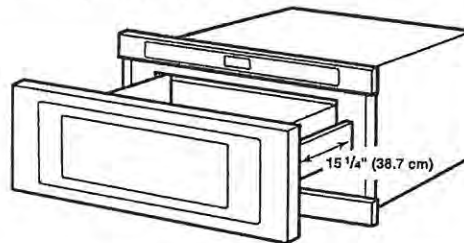

PV-21
July 13 2021

F.S.

24" (61.0 CM) STANDARD MOUNT

Cabinet Preparation

Cabinet Dimensions

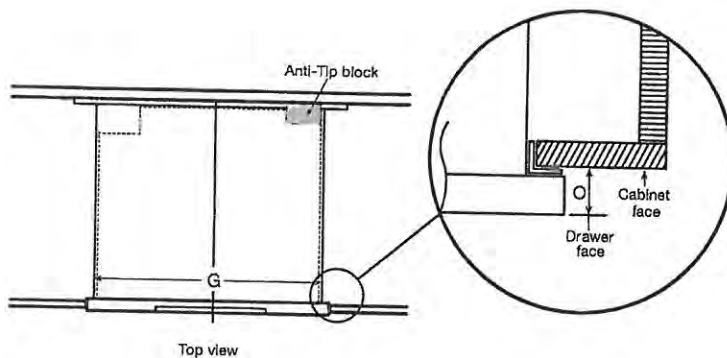
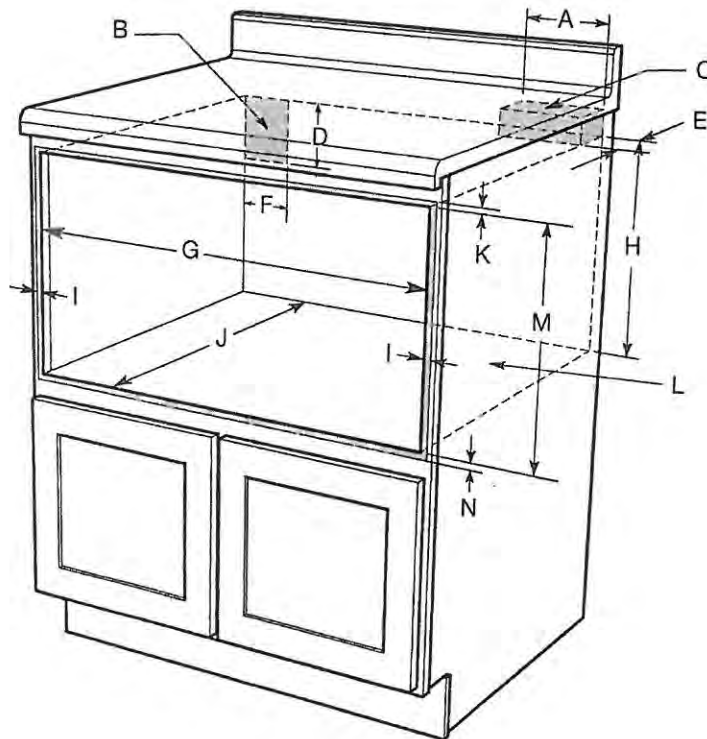

- A. 6" (15.2 cm) minimum
16" (40.6 cm) maximum
- B. Suggested electrical receptacle location
- C. Anti-Tip block
- D. 3" (7.6 cm)
- E. 3 1/2" (8.9 cm)
- F. 4.5" (11.4 cm)
- G. 22 1/8" (61.4 cm) opening
- H. 14 13/16" (37.6 cm) to bottom of Anti-Tip block
- I. Allow 7/8" (2.2 cm) overlap
- J. 24" (61.0 cm) minimum depth
- K. Allow 1/16" (5.6 mm)
- L. Platform must support 100 lb (45.4 kg)
- M. 15 9/16" (39.5 cm) opening
- N. Allow 7/8" (1.9 cm) overlap
- O. 1 3/4" (3.9 cm)

PV-21

July 13 2021

IG

INSTALLATION INSTRUCTIONS

Install the Anti-Tip Block

⚠ WARNING



Crush Hazard

Microwave drawer can tip and fall out of opening.
Install anti-tip block to wall per installation instructions.
Failure to do so can result in serious injury or burns.

To reduce the risk of tipping of the drawer, the Anti-Tip block must be properly installed located $14\frac{13}{16}$ " (37.6 cm) above the floor on which the Microwave Drawer will sit. If the Microwave Drawer is ever moved to a different location, the Anti-Tip block must also be moved and installed.

1. Measure $14\frac{13}{16}$ " (37.6 cm) from the cutout floor where the Microwave Drawer will sit and mark a line on the wall.
2. Position the bottom of the anti-tip block on the line marked on the wall and attach the anti-tip block to the wall with screws. Make sure the screws are secured to wood or metal studs.

NOTES:

- The anti-tip block is required before installing the Microwave Oven Drawer.
- The anti-tip block is to be provided by the installer.
- When fastening, be sure that the screws do not penetrate electrical wiring or plumbing.

Anti-Tip Block Dimensions.

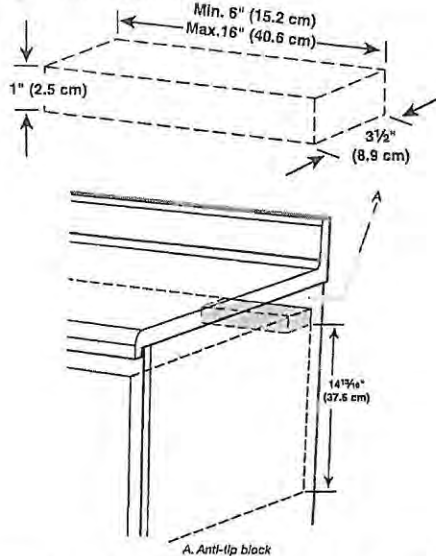

Using sturdy wood screws (installer to provide), securely install the anti-tip block in the upper-right corner of the cutout, making sure the block is completely stable. The bottom of the block must be $14\frac{13}{16}$ " (37.6 cm) from the cutout floor.

Install the Microwave Drawer

⚠ WARNING

Excessive Weight Hazard

Use two or more people to move and install microwave oven.

Failure to do so can result in back or other injury.

1. Empty Microwave Drawer of any loose contents.
2. Using two or more people, slide Microwave Drawer all the way into the opening, and center the Microwave Drawer.
3. Open the Microwave Drawer, and mark the four holes in the mounting flange.

NOTE: The screw holes in the mounting flange of both sides must be fully over the wood of the wall or cabinet.

4. Remove Microwave Drawer.
5. Using $\frac{1}{8}$ " (3.17 mm) drill, drill four pilot holes into the cabinet through the marks made in Step 3.
6. Prepare the holes by installing a 1" (2.5 cm) screw in and out of each pilot hole.

⚠ WARNING



Electrical Shock Hazard

Plug into a grounded 3 prong outlet.

Do not remove ground prong.

Do not use an adapter.

Do not use an extension cord.

Failure to follow these Instructions can result in death, fire, or electrical shock.

7. With the Microwave Drawer near the opening, plug the Microwave Drawer into the grounded 3 prong outlet.
8. Reinsert Microwave Drawer into the opening, open the drawer, and align holes in mounting flange with pilot holes in the cabinet.

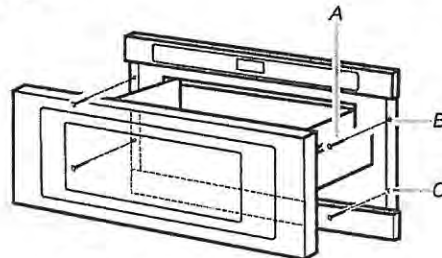

A. 1" (2.5 cm) mounting screws (4)

B. Mounting flange screw holes

C. Mounting flange

PV-21
July 13 2021
I.6

KitchenAid® French Door Bottom Mount Refrigerator

PRODUCT MODEL NUMBER:

KRFF507H

ELECTRICAL AND WATER REQUIREMENTS:

Electrical: A 115 volt, 60 Hz, AC only 15 or 20 A fused, grounded electrical supply is required. It is recommended that a separate circuit serving only your refrigerator and approved accessories be provided. Use an outlet that cannot be turned off by a switch. Do not use an extension cord.

Water: A cold water supply with water pressure between 35 and 120 psi (241 and 827 kPa) is required to operate the water dispenser and ice maker. If you have questions about your water pressure, call a licensed, qualified plumber.

NOTE: If the water pressure is less than what is required, the flow of water from the water dispenser could decrease or ice cubes could be hollow or irregular shaped.

Reverse Osmosis Water Supply

IMPORTANT: The pressure of the water supply coming out of a reverse osmosis system going to the water inlet valve of the refrigerator needs to be between 35 and 120 psi (241 and 827 kPa).

If a reverse osmosis water filtration system is connected to your cold water supply, the water pressure to the reverse osmosis system needs to be a minimum of 40 to 60 psi (276 to 414 kPa).

PRODUCT DIMENSIONS:

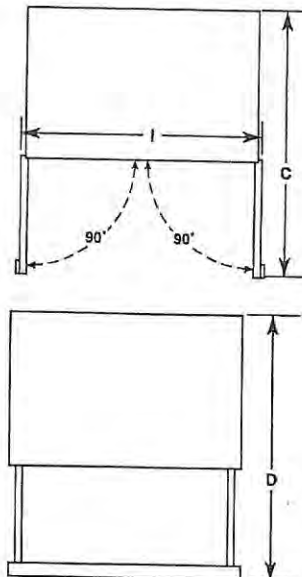
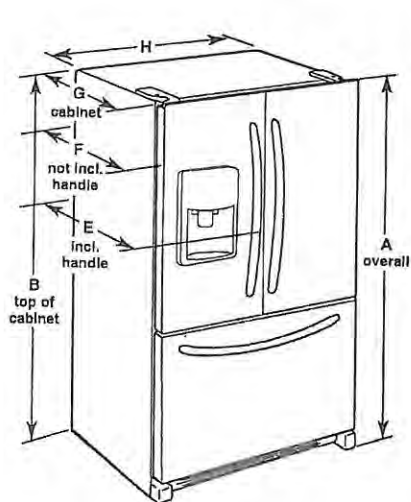

Model Number	KRFF507H
Model Size	27 cu. ft. (764.6 L)
Height - Overall "A"	70 1/4" (178.1 cm)
Height - Top of Cabinet "B"	68 3/4" (174.6 cm)
Depth - Doors Open 90° "C"	48 5/8" (123.5 cm)
Depth - Drawer Open With Handles "D"	54 1/4" (137.8 cm)
Depth - With Handles "E"	36" (91.4 cm)
Depth - Without Handles "F"	33 3/4" (85.7 cm)
Depth - Cabinet Only "G"	29 5/8" (75.2 cm)
Width - Cabinet Only "H"	35 1/8" (90.5 cm)
Width - Doors Open 90° "I"	38 3/4" (97.5 cm)

LOCATION REQUIREMENTS:

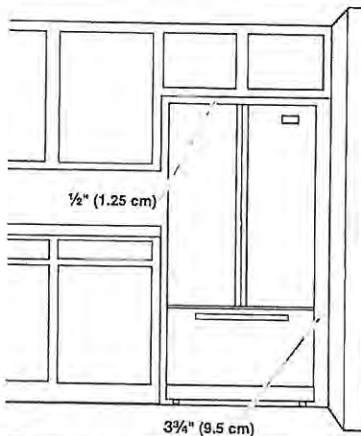

To ensure proper ventilation for your refrigerator, allow for a 1/2" (1.25 cm) of space on each side and at the top. Allow for a 1" (2.54 cm) space behind the refrigerator. If your refrigerator has an ice maker, allow extra space at the back for the water line connections. When installing your refrigerator next to a fixed wall, leave a 3 3/4" (9.5 cm) minimum space between the refrigerator and wall to allow the door to swing open.

NOTE: This refrigerator is intended for use in a location where the temperature ranges from a minimum of 55°F (13°C) to a maximum of 110°F (43°C). The preferred room temperature range for optimum performance, which reduces electricity usage and provides superior cooling, is between 60°F (15°C) and 90°F (32°C). It is recommended that you do not install the refrigerator near a heat source, such as an oven or radiator.

KitchenAid
Model # KDTM604 KPS

PV-21
July 13 2021

Y. S.

PRODUCT AND CABINET OPENING DIMENSIONS:

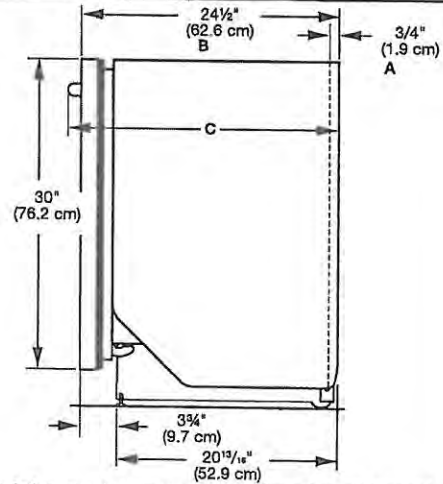
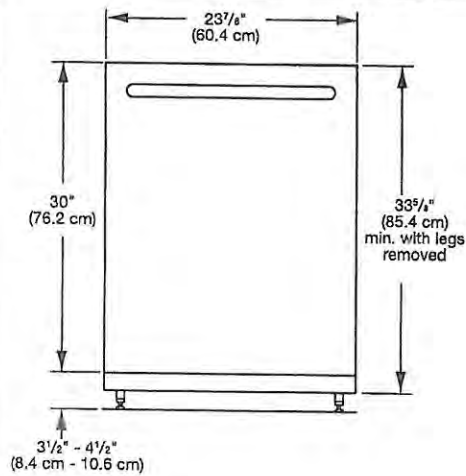

- A. Insulation may be compressed (not used on all models).
 B. For panel-ready models, dishwasher depth is $24"$ (61.0 cm), not including the $\frac{3}{4}"$ (1.9 cm) custom door panel.
 C. Door handles may protrude forward of the face of the dishwasher, varies by model.

Check that all surfaces have no protrusions that would prohibit dishwasher installation.

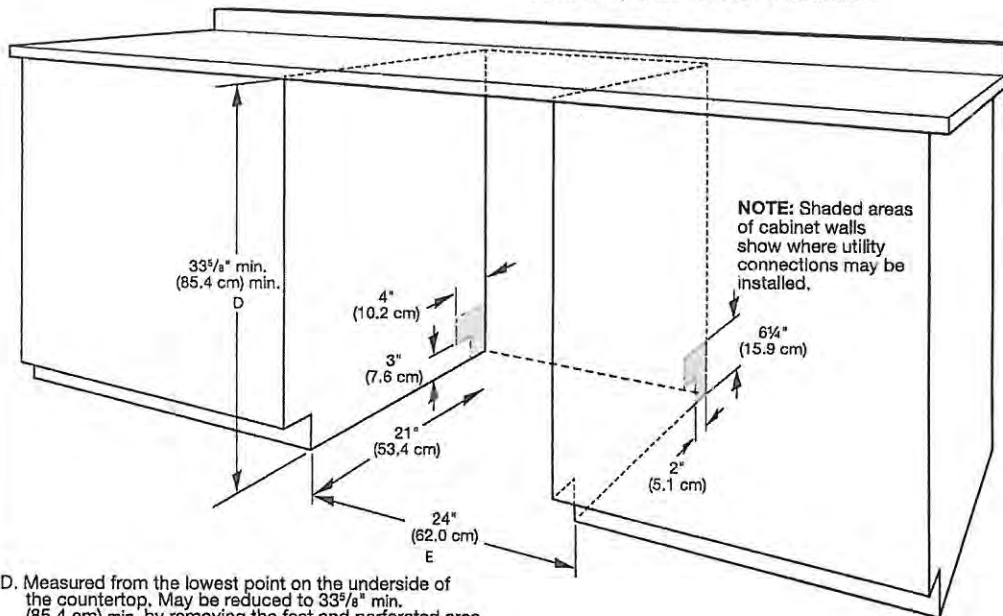

NOTE: Shaded areas of cabinet walls show where utility connections may be installed.

- D. Measured from the lowest point on the underside of the countertop. May be reduced to $33\frac{5}{8}"$ min. (85.4 cm) min. by removing the feet and perforated area of insulation (blanket) on dishwasher.
 E. Minimum, measured from narrowest point of opening.

Toronto

User Manual

VRH-BC02-30/36/42SS



Vesta
Simple Kitchen Solutions

www.vesta.kitchen

Vesta Simple Kitchen Solutions

Contact Us

If you need any assistance, please contact us at **+1 905-727-8688** or **info@vesta.kitchen** . Please have your order number and model of the range hood ready. This information will help us better respond to your request.

If you need replacement parts, we recommend that you only use genuine parts. Our accessories and parts are engineered and designed specifically for this series of range hood, each is rigorously tested assuring the utmost in durability and reliability, providing a factory match, factory-installed appearance and functionality tailored to each individual range hood model.

Table of Contents

Important Safety Notice	4
Tools Needed	9
Parts Supplied	10
Venting Requirements	11
Height & Clearance	13
Calculating Vent System Length	16
Venting Methods	17
Electrical Requirements	18
Installation	20
Operations	22
Wiring Diagram	23
Product Dimension	24
Troubleshooting	25
Use and Care Information	27
Specifications	29
Maintenance	30
Warranty	34
Disclaimer	37
Contact Us	38

Important Safety Notice

READ ALL INSTRUCTIONS BEFORE INSTALLING AND OPERATING THIS APPLIANCE

- The installation in this manual is intended for qualified installers, service technicians or persons with similar qualified background. Installation and electrical wiring must be done by qualified professionals and in accordance with all applicable codes and standards, including fire-rated construction.
- DO NOT attempt to install this appliance yourself. Injury could result from installing the unit due to lack of appropriate electrical and technical background.
- Range hood may have very sharp edges; please wear protective gloves if it is necessary to remove any parts for installing, cleaning or servicing.
- Activating any switch ON before completing installation may cause ignition or an explosion.
- Due to the size and weight of this range hood, two people installation is recommended.

TO REDUCE THE RISK OF FIRE, ELECTRIC SHOCK, OR INJURY TO PERSONS:

- For general ventilating use only. DO NOT use to exhaust hazardous or explosive materials and vapors.
- The combustion air flow needed for safe operation of fuel-burning equipment may be affected by this unit's operation. Follow the heating equipment manufacturer's guideline and safety standards such as those published by the National

Disclaimer

Carefully inspect all items for damages before accepting delivery. Note any damages on the freight bill or express receipt. Request name and signature of the carrier's agent and keep copy to support your claim. Upon acceptance of items, owner assumes responsibility for its safe arrival. Report damages to the carrier and file a claim immediately. Failure to do so may result in the denial of your claim. The carrier will furnish you with necessary forms for filing a claim.

Damages caused during transit are not covered under our warranty. Please contact us to file an insurance claim.

Please inspect contents of package(s) carefully upon receiving! We must be notified of any damages and/or missing parts within five (5) days upon your receipt of package(s). Claims will not be accepted after five (5) days. NOTE: Items were thoroughly tested and carefully packed in our factory before shipping.

Products must be returned in good working condition with ALL original parts and documentation packed in ALL original cartons, fillers and shipping cartons. A restocking fee of 15% will be charged for all approved return(s). Exchanges or returns may not be accepted if any packaging is missing.

Make sure to inspect the hood for damages and defects before installation. Appearance flaws of the hood found after installation and not affecting hood performance is not covered under our warranty for returns or exchanges. Service visits not covered under warranty will carry a service charge.

Before Installation: Return for exchange or refund (please see above for acceptable returns). After Installation: NO exchange or refund.

purchaser and does not extend to subsequent owners of this product. Any applicable implied warranties, including the warranty of merchantability, are limited in duration to a period of express warranty as provided herein beginning with the date of original purchase at retail and, no warranties, whether express or implied, shall apply to this product thereafter.

To obtain warranty service, you may contact your local reseller from which you purchased this product. Please confirm the terms of your local reseller's policies prior to contacting. Typically, you must include product identification information, including model number and serial number with a detailed description of the problem you are experiencing. You must also include proof of the date of original retail purchase as evidence that the product is within the applicable warranty period.

Fire Protection Association (NFPA), and the American Society of Heating, Refrigeration and Air Conditioning Engineers (ASHRAE), and the local code authorities.

- Before servicing or cleaning unit, switch power OFF at service panel and lock service panel to prevent power from being switched ON accidentally.
- Clean grease laden surfaces frequently. To reduce the risk of fire and to disperse air properly, make sure to vent air outside. DO NOT vent exhaust into spaces between walls, crawl spaces, ceiling, attics or garages.
- Ducted fans MUST always be vented to the outdoors.
- Use only metal ductwork and this unit MUST be grounded.
- Sufficient air is needed for proper combustion and exhausting of gases through the duct to prevent back drafting.
- When cutting or drilling into wall or ceiling, be careful not to damage electrical wiring or other hid- den utilities.
- All electrical wiring must be properly installed, insulated and grounded.
- Old duct work should be cleaned or replaced if necessary to avoid the possibility of a grease fire.
- Check all joints on duct work to insure proper connection and all joints should be properly taped.
- Use this unit only in the manner intended by the manufacturer. If you have questions, contact the vendor,

TO REDUCE THE RISK OF A STOVE TOP GREASE FIRE:

- Keep all fan, baffle, spaces, filter, grease tunnel, oil container and grease-laden surfaces clean. Grease should not be allowed to accumulate on fan, baffle, spaces, filter, grease tunnel and oil container.
- Always turn range hood ON when cooking at high heat or when cooking flaming foods.
- Use high settings on cooking range only when necessary.
- Never leave surface units unattended at high settings. Boil overs cause smoking and greasy spillovers that may ignite. Heat oils slowly on low or medium settings.
- Clean ventilating fan frequently.
- Always use appropriate cookware and utensils size.
- Always use cookware appropriate for the size of the surface element.

TO REDUCE THE RISK OF INJURY TO PERSONS IN THE EVENT OF A STOVE TOP GREASE FIRE:

- **SMOTHER FLAMES** with a close-fitting lid, cookie sheet, or metal tray, then turn OFF the burner. **BE CAREFUL TO PREVENT BURNS. NEVER PICK UP A FLAMING PAN**—you may be burned. **KEEP FLAMMABLE OR COMBUSTIBLE MATERIAL AWAY FROM FLAMES.** If the flames **DO NOT** go out immediately, **EVACUATE AND CALL THE FIRE DEPARTMENT** or dial your local emergency service immediately.
- **DO NOT USE WATER**, including wet dishcloths or towels — a violent steam explosion will result.

Who is Covered

This warranty is extended to the original purchaser for products purchased for ordinary home use.

This Warranty Will Be Voided When:

Product damaged through negligence, improper installation, accident, abuse, misuse, natural disaster, insufficient or excessive electrical supply, abnormal mechanical or environmental conditions, or any unauthorized disassembly, repair, modification, or failure to follow installation instructions. When product is used commercially or other than its intended purpose. Damaged because of improper connection with equipment of other manufacturers. Repaired or modified by anyone other than your local reseller's authorized agents. This limited warranty also does not apply to any product on which the original identification information has been altered, obliterated or removed, has not been handled or packaged correctly or has been sold as second-hand.

What is Not Covered:

Consumable parts such as light bulbs, metal and charcoal filters. The natural wear of finish, and wear due to improper maintenance, use of corrosive and abrasive cleaning products, pads, and oven cleaner products. Chips, dents or cracks due to abuse, misuse, freight damage, or improper installation. Damage of product caused by accident, fire, floods or act of God. The manufacturer and/or distributor/reseller is not liable for, and does not cover under warranty, any loss of properties or any costs associated with removing, servicing, installing, or determining the source of problems with this product.

This warranty is valid in the country of the original purchase at retail. It is non-transferable and applies only to the original

Warranty

TO OBTAIN SERVICE UNDER WARRANTY:

You must present proof of original purchase date.

Please provide an original dated proof of purchase (sales receipt / invoice) in order to obtain service under warranty.

Lifetime Motor Warranty

The motor, which is covered by lifetime warranty, should be provided free of charge by your local reseller given it failed due to manufacturing defects. Subject to the conditions and limitations set forth below, your local reseller should, at its option, either repair or replace it with new or refurbished motor to be functionally equivalent to new. The consumer is responsible for all shipping costs.

One Year Parts Warranty

For one year from the date of original purchase, your local reseller will provide free of charge, non-consumable replacement parts or components that failed due to manufacturing defects. Subject to the conditions and limitations set forth below, your local reseller will, at its option, either repair or replace any part of its products that prove defective by reason of improper workmanship or materials. Repaired parts or replacement products will be provided by your local reseller on an exchange basis, and will be either new or refurbished to be functionally equivalent to new. The consumer is responsible for all shipping costs. Consumable parts not covered by this warranty include but not limited to: Light bulbs, metal, aluminum and charcoal filters.

- Use an extinguisher ONLY if:
- You know you have a Class A, B, C extinguisher, and you already know how to operate it.
- The fire is small and contained in the area where it is started.
- The fire department is being called.
- You can fight the fire with your back to an exit.

TO REDUCE THE RISK OF INJURY TO PERSONS IN THE EVENT OF A GAS LEAKS:

- Extinguish any open flame.
- DO NOT turn on the range hood fan or any type of ventilator.
- DO NOT turn on the lights or any type of appliance.
- Open all doors and windows to disperse the gas. If you still smell gas, call the gas company and fire department, or dial your local emergency service immediately.
- Your safety and the safety of others is very important. We have provided many important safety messages in this manual and on your appliance. Always read and obey all safety messages. All safety messages will tell you what the potential hazard is, tell you how to reduce the chance of injury, and tell you what can happen if the instructions are not followed.



This is the safety alert symbol. This symbol alerts you to potential hazards that can hurt you and others. All safety messages will follow the safety alert symbol and the word "WARNING".

The manufacturer and/or distributor/reseller declines all responsibility in the event of failure to observe the instructions given here for installation, maintenance and suitable use of the product.

The manufacturer and/or distributor/reseller further declines all responsibility for injury due to negligence and the warranty of the unit automatically expires due to improper maintenance.

The manufacturer and/or distributor/reseller will not be held responsible for any damages to personal property or real estate or any bodily injuries whether caused directly or indirectly by the range hood.

Figure 1



Figure 2



Replacing LED Light Fixture

This range hood uses LED light fixture: 3W Max 12V LED

Make sure the range hood is unplugged or turn OFF breaker and the lights are cool to touch.

Place a flat-head screwdriver between light housing and hood body, gently pry up the light housing and search for the metal clip.

Apply force to the metal clip and pull out the light fixture. Disconnect the power cable and discard the old light fixture.

Reverse the steps to install a new halogen light fixture. Turn ON breaker and range hood to test for operation.

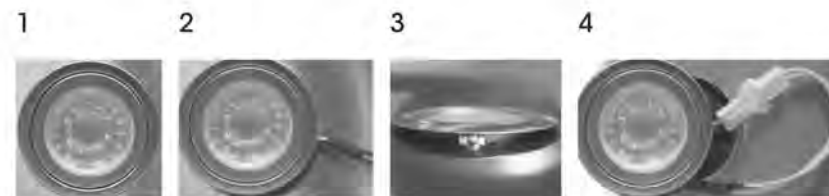

- USA/Canada: LED 3W 12V

Make sure the range hood is unplugged or turn OFF breaker.

Make sure the lights are cool to touch, carefully align the arrow on the inner ring with the arrow on the outer ring where it says OPEN. The inner ring will loosen and the light bulb will be available for removal. Install a new halogen light bulb and reverse the steps.



Align arrows on both rings

Replacing the Light Bulb Using the Inner Ring Opener

Make sure the range hood is unplugged or turn OFF breaker

Make sure the lights are cool to touch, carefully align the arrow on the inner ring with the arrow on the outer ring where it says OPEN with the Inner Ring Opener as shown in Figure 1.

The inner ring will loosen and the light bulb will be available for removal as shown in Figure 2.

Install a new light bulb and reverse the steps. Turn ON breaker and range hood to test for operation.

Tools Needed

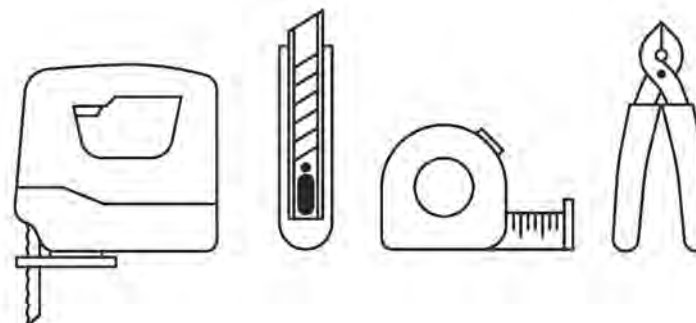
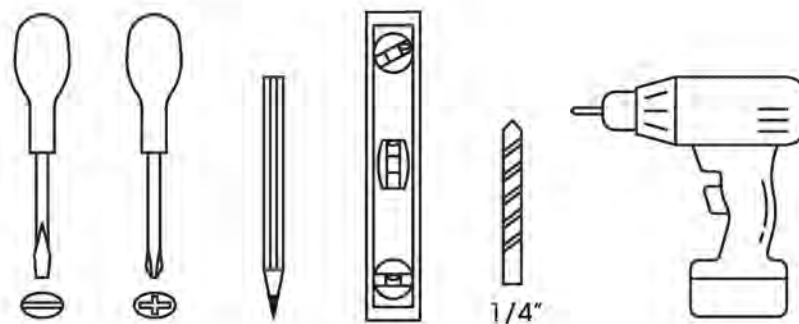

Parts Supplied



Range Hood
x1

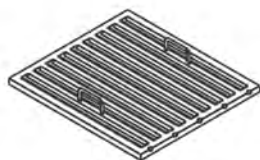

Baffle Filters



A
x4

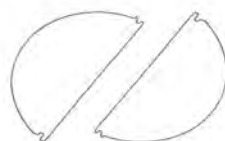

Flappers
x1

DO NOT allow salt solutions, disinfectants, bleaches, or cleaning compounds to remain in contact with stainless steel for extended periods. Many of these compounds contain chemicals, which may be harmful. Rinse with water after exposure and wipe dry with a clean cloth.

Cleaning Filters

IMPORTANT: Drain oil from oil containers before oil and residue overflow!

The metal filters fitted by the factory are intended to filter out residue and grease from cooking. It need not be replaced on a regular basis but are required to be kept clean.

Filters should be cleaned after every 30 hours of use.

Remove and clean by hand or dishwasher. Spray "Formula 409®" or equivalent degreasing detergent and leave to soak if heavily soiled. Dry filters and re-install before using hood.

Replacing Filters

Should aluminum grease filters wear out due to age and prolonged use, please contact your local reseller for replacement filters. (Note: Also replace damaged filter that has punctured or broken mesh, bent or broken frame.)

Replacing the light bulb



WARNING

Light bulb become extremely hot when turned on. DO NOT touch bulb until switched off and cooled. Touching hot bulbs could cause serious burns.

This range hood uses LED or halogen bulb:

- USA/Canada: Halogen 35W Type GU10 120V (Europe: 220V)

Maintenance

SAFETY WARNING: Never put your hand into area housing the fan while the fan is operating!

For optimal operation, clean range hood and all baffle/spacer/filter/grease tunnel/oil container regularly. Regular care will help preserve the appearance of the range hood.

Cleaning Exterior surfaces

Clean periodically with hot soapy water and clean cotton cloth. Do not use corrosive or abrasive detergent (e.g. Comet Power Scrub®, EZ-Off® oven cleaner), or steel wool/scoring pads, which will scratch and damage the stainless steel surface. For heavier soil use liquid degrease such as "Formula 409®" or "Fantastic®" brand cleaner.

If hood looks splotchy (stainless steel hood), use a stainless steel cleaner to clean the surface of the hood. Avoid getting cleaning solution onto or into the control panel. Follow directions of the stainless steel cleaner. **CAUTION: Do not leave on too long as this may cause damage to hood finish.** Use soft towel to wipe off the cleaning solution, gently rub off any stubborn spots. Use dry soft towel to dry the hood.

After cleaning, you may use non abrasive stainless steel polish such as 3M® or ZEP®, to polish and buff out the stainless luster and grain. Always scrub lightly, with clean cotton cloth, and with the grain.

DO NOT allow deposits to accumulate or remain on the hood.

DO NOT use ordinary steel wool or steel brushes. Small bits of steel may adhere to the surface and cause rusting.

Venting Requirements

Vent system must terminate to the outside (roof or side wall).

DO NOT terminate the vent system in an attic or other enclosed area.

DO NOT use 4" (10.2 cm) laundry-type wall caps.

Use metal/aluminum vent only. Rigid metal/aluminum vent is recommended.

DO NOT use plastic vent.

Always keep the duct clean to ensure proper airflow.

Calculate the following figures before installation;

1. Distance from the floor to the ceiling.
2. Distance between the floor to the countertop/stove (US Standard: 36").
3. Distance between the countertop/stove to the range hood (recommend* 28" to 36").
4. Height of hood and duct cover.

For the most efficient & quiet operation:

It is recommended that the range hood be vented vertically through the roof through 8" (20.32 cm) or bigger round metal/aluminum vent work.

The size of the vent should be uniform.

Use no more than three 90° elbows.

Make sure there is a minimum of 24" (61 cm) of straight vent between the elbows if more than one elbow is used.

DO NOT install two elbows together.

The length of vent system and number of elbows should be kept to a minimum to provide efficient performance.

The vent system must have a damper. If roof or wall cap has a damper, DO NOT use damper (if supplied) on top of the range hood.

Use duct tape to seal all joints in the vent system.

Specifications

Body	Stainless Steel
Power Rating	220V/50Hz or 120V/60Hz (USA & Canada standard)
General Input Power	120W + # of Light x Voltage of Light
Motor Input Power	120 W
Motor Revolution	600 RPM ($\pm 10\%$) to 1300 RPM ($\pm 10\%$)
Levels Of Speed Control	4
Maximum Airflow	1000 CFM
Air Pressure	150 Pa (200 Pa Maximum)
Noise Level (dB / sone)	Approximately 35 / 0.7 to 67 / 6.5 (Lowest to highest Speed)
Motor Type	Double Chamber Ultra Quiet
Fan Type	Centrifugal / Sirocco
Control Type	Mechanical Push Button
Filtration Type	Baffle Filter
Illumination	LED 3W 12V or Halogen 35W Type GU10 120V (220V for Europe)
Venting Size	Top, 8 inches Round
Interference Protection	Radio Frequency Interference Protected

* Subject to change without notice, please contact your local reseller for details.

turn off the burner. BE CAREFUL TO PREVENT BURNS. If the flames do not go out immediately, EVACUATE AND CALL THE FIRE DEPARTMENT. NEVER

PICK UP A FLAMING PAN— you may be burned.

DO NOT USE WATER, including wet dishcloths or towels — a violent steam explosion will result. Use an extinguisher ONLY if:

You know you have a Class ABC extinguisher, and you already know how to operate it.

The fire is small and contained in the area where it is started.

The fire department is being called. You can fight the fire with your back to an exit.

Height & Clearance

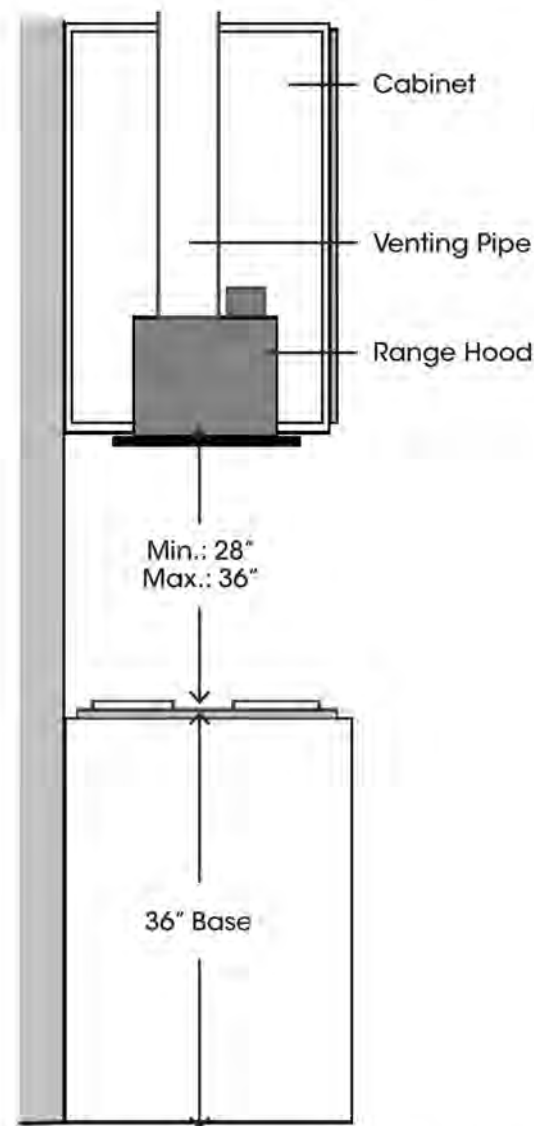

Maximum ceiling clearance 110" at 36" hood mounting height above countertop/stove (may vary with different model). Chimney extensions available for higher ceilings.

Important

A minimum of 8" round (standard for this range hood) must be used to maintain maximum airflow efficiency.

Always use rigid type metal/aluminum ducts if available to maximize airflow when connecting to provided duct.

Please use Duct Run Calculation below to compute total available duct run when using elbows, transitions and caps.

ALWAYS, when possible, reduce the number of transitions and turns. If long duct run is required, increase duct size from 8" to 9 or 10". If a reducer is used, install a long reducer instead of a pancake reducer. Reducing duct size will restrict airflow and decrease airflow, thus reduce duct size as far away from opening as possible.

If turns or transitions are required: Install as far away from opening and as far apart, between 2, as possible.

Minimum mount height between range top to hood bottom should be no less than 24".

Maximum mount height should be no higher than 36"

It is important to install the hood at the proper mounting height. Hoods mounted too low could result in heat damage and fire hazard; while hoods mounted too high will be hard to reach and will lose its performance and efficiency.

If available, also refer to manufacturer's height clearance requirements and recommended hood mounting height above range.

Use and Care Information

WARNING — TO REDUCE THE RISK OF FIRE, ELECTRIC SHOCK, OR INJURY TO PERSONS, OBSERVE

THE FOLLOWING: Use this unit only in the manner intended by the manufacturer. If you have questions, contact the manufacturer. Before servicing or cleaning unit, switch power off at service panel and lock switch power off at service panel and lock service panel to prevent power from being switched on accidentally. When the service disconnecting means cannot be blocked, securely fasten prominent warning device such as a tag to the service panel.

CAUTION: For general ventilating use only. Do not use to exhaust hazardous or explosive materials and vapors.

WARNING — TO REDUCE THE RISK OF A RANGE

TOP GREASE FIRE: Never leave surface units unattended at high settings. Boil overs cause smoking and greasy spillovers that may ignite. Heat oils slowly on low or medium settings.

Always turn hood ON when cooking at high heat or when cooking flaming foods.

Clean ventilating fans frequently. Grease should not be allowed to accumulate on fan or filter.

Use proper pan size. Always use cookware appropriate for the size of the surface element.

WARNING — TO REDUCE THE RISK OF INJURY TO PERSONS IN THE EVENT OF A RANGE TOP GREASE FIRE, OBSERVE THE FOLLOWING: SMOTHER

FLAMES with a close-fitting lid, cookie sheet, or metal tray, then

The lights work but the blower is not spinning at all, is stuck or is rattling

The blower might be jammed or scraping the bottom due to shipping damage. Please contact us immediately.

The hood is not venting out properly

- Make sure the distance between the stove top and the bottom of the hood is within * 28" and 36" in distance. *Due to different ceiling height configurations, recommended height may not be applicable.
- Reduce the number of elbows and length of duct work. Check if all joints are properly connected, sealed, and taped.
- Make sure the power is on high speed for heavy cooking.

Purpose of the slots/holes/openings near the top of the upper chimney:

- These slots/holes/openings are used to exhaust cleaned air with optional re-circulating kit. If you did not install one, you do not need them.

NOTE: For all other inquiries, please contact your local reseller.

Minimum Duct Size:

Round - 8" minimum

Calculating Vent System Length

To calculate the length of the system you need, deduct the equivalent feet for each vent piece used in the system from the recommended maximum duct run.

DUCT RUN CALCULATION:	
Recommended maximum run	
8" duct	50 ft
Vent piece deduction	
Each 90 elbow used	9 ft
Each 45 elbow used	5 ft
Each 8" to 3-1/4 x 10" transition used	7 ft
Side wall cap with damper	0 ft
Roof cap	0 ft

DUCT RUN CALCULATION EXAMPLE:

One roof cap, two 90° elbow, and one 45° elbow used: 0ft + 9ft + 9ft + 5ft = 23ft used.

Deduct 23ft from 50ft, 27ft maximum available for straight duct run.

Troubleshooting



If the range hood or halogen light does not work after installation

- Check if the range hood has been plugged in, make sure that all power has been turned back ON, fused not blown and all electrical wiring are properly connected.
- Swap out light assembly to working ones to determine whether it is caused by defective bulbs. See *Replacing the light bulbs* on Page 31-33.

The range hood vibrates when the blower is on

- The range hood might not have been secured properly on to the ceiling or wall. Check with your installer

The blower or fan seems weak

- Check that the duct sized used is at least 8" or 3-1/4 x 10". Range hood WILL NOT function efficiently with insufficient duct size. For example: 8" duct over 8" hole and loosely secured.
- Check if duct is clogged or if damper unit (half-circular flapper) is not installed correctly or opening properly. A tight mesh on a side wall cap unit might also cause restriction to the air flow.

Product Dimension

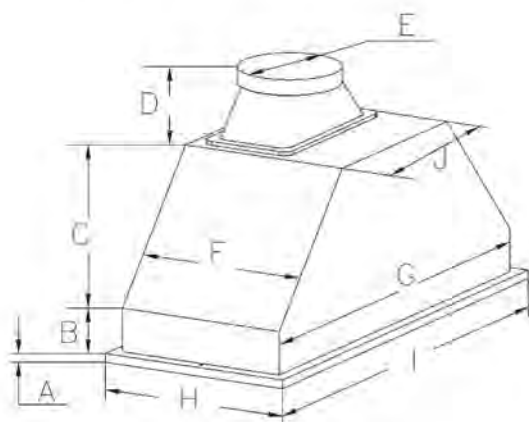

Model	VRH-BC02-30SS	VRH-BC02-36SS
A	1 1/2"	1 1/2"
B	2 1/2"	2 1/2"
C	7 7/8"	7 7/8"
D	3 3/4"	3 3/4"
E	5 7/8"	5 7/8"
F	15 1/4"	15 1/4"
G	28"	33 7/8"
H	16 1/4"	16 1/4"
I	28 1/2"	34 1/2"
J	11 3/4"	11 3/4"

Venting Methods

This range hood is factory set for venting through the roof or wall.

Vent work can terminate either through the roof or wall. To vent through a wall, a 90° elbow is needed.

IMPORTANT:

NEVER exhaust air or terminate duct work into spaces between walls, crawl spaces, ceiling, attics or garages. All exhaust must be ducted to the outside.

Use metal/aluminum duct work only.

Fasten all connections with sheet metal screws and tape all joints with certified Silver Tape or Duct Tape.

Use caulking to seal exterior wall or roof opening around the cap.

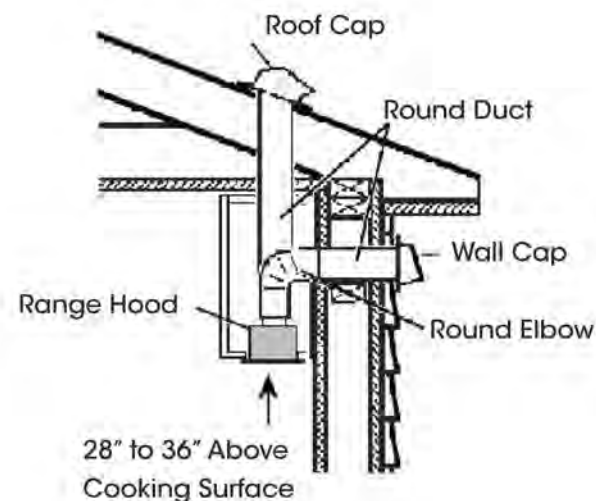

Electrical Requirements

IMPORTANT: Observe all governing codes and ordinances.
(Please consult with a qualified electrician for 220-Volt 50 Hz voltage)

IT IS THE CUSTOMER'S RESPONSIBILITY:

To contact a qualified electrical installer.

To assure that the electrical installation is adequate and in conformance with National Electrical Code, ANSI/ NFPA 70 — latest edition*, or CSA Standards C22. 1-94, Canadian Electrical Code, Part 1 and C22. 2 No. 0-M91- latest edition** and all local codes and ordinances.

If codes permit and a separate ground wire is used, it is recommended that a qualified electrician determine that the ground path is adequate.

A 120-volt, 60 Hz, AC-only, fused electrical supply is required on a separate 15-amp circuit, fused on both sides of the line.

Do not ground to a gas pipe.

Do not have a fuse in the neutral or ground circuit.

RISK OF ELECTRICAL SHOCK. This range hood must be properly grounded. Check with a qualified electrician if you are not sure whether the range hood is properly grounded.

The range hood should be connected directly to the fused disconnect (or circuit breaker) box through flexible armored or non-metallic sheathed copper cable. A U.L. - or C.S.A. - listed strain relief must be provided at each end of the power supply cable. Do not use extension cord or adapter plug with this appliance.

Wiring Diagram

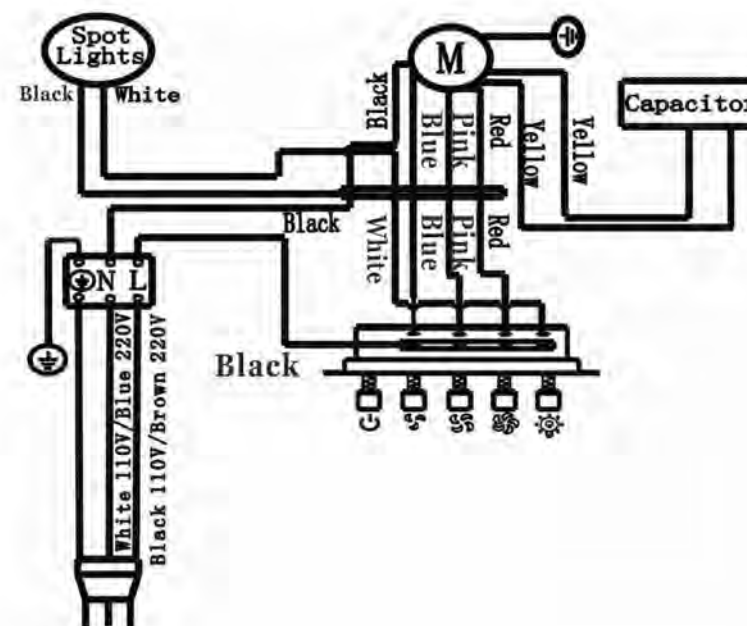

Operations

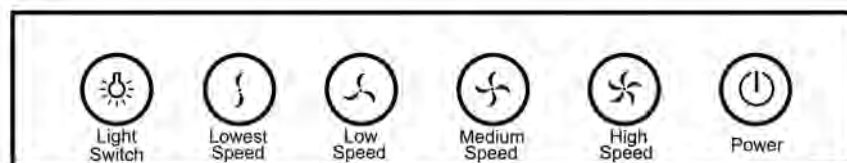

Turn On

- Press the speed control (Low Speed, Medium Speed, High Speed) switch to select the desired level of power. Once button is pressed, the previous speed mode will cancel.
- Press the Light Switch to power on the lights.

Turn Off

- Press the Power Switch to turn off the power.
- Press the Light Switch to power off the lights

The range hood must be connected with copper wire/plug only.

Always use plug provided. If not possible, connect three wires according to its color (black to hot, white to neutral, and green to ground) to house wires and cap with wire connectors:



WARNING

Hood may have very sharp edges. Please wear protective gloves if it is necessary to remove any parts for installing, cleaning or servicing.



WARNING

Hazard of electrical shock! Electrical wiring must be done by qualified person.

Wire sizes (copper wire only) and connections must conform with the rating of the appliance as specified on the model/serial rating label. Wire sizes must conform to the requirements of the National Electrical Code ANSI/NFPA 70 — latest edition*, or CSA Standards C22. 1-94, Canadian Electrical Code Part 1 and C22. 2 No. 0-M91 - latest edition** and all local codes and ordinances. A U.L. - or C.S.A. - listed conduit connector must be provided at each end of the power supply cable (at the range hood and at the junction box).

Copies of the standards listed may be obtained from:

National Fire Protection Association
Batterymarch Park Road
Quincy, Massachusetts 02269

** CSA International
8501 East Pleasant Valley
Cleveland, Ohio 44131-5575

Installation



WARNING: EXCESSIVE WEIGHT

Require two or more person to move and install this range hood. Spinal or other bodily injuries could occur if it is not followed.

NOTE: DO NOT INSTALL THIS POWER PACK RANGE HOOD INSERT BEFORE RUNNING A TEST AND MAKE SURE THE UNIT IS IN GOOD CONDITION. MECHANICAL DAMAGE MIGHT HAVE OCCURRED DURING TRANSPORTATION.

1. Remove the decorative panel from the power pack range hood.
2. Cut an opening in the bottom of the cabinet, using the dimensions shown in the table below (ref. to Fig. A).
3. Insert the range hood in the cabinet and secure with the (4) mounting screws from the inner side of the range hood (Fig. B). Note: Wood blocking might need to be built if it's not available in order to secure the mounting screws.
4. Connect the duct and power cord.
5. Replace the decorative panel.

Model	X	Y
VRH-BC02-30SS	27 1/2"	15 1/4"
VRH-BC02-36SS	33 1/2"	15 1/4"
VRH-BC02-42SS	39 1/2"	15 1/4"

Cut a hole in the bottom of the cabinet

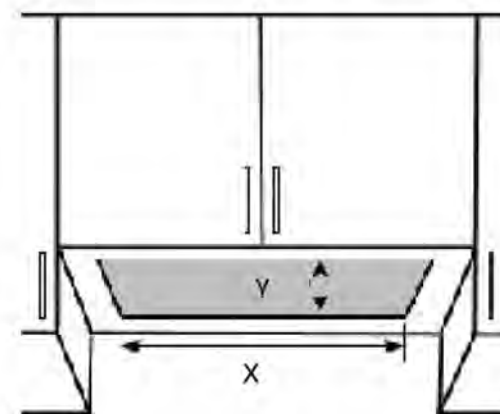

Fig. A

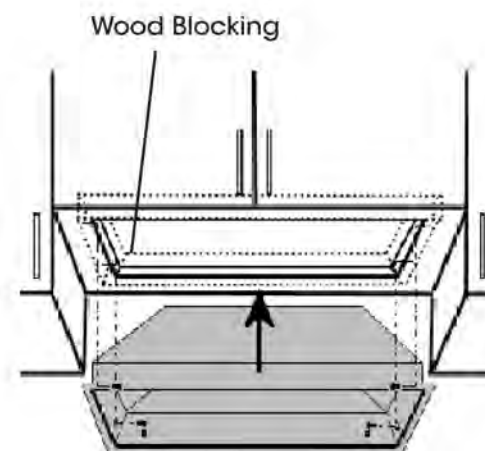

Fig. B