



CONSTRUCTION SUMMARY

Lot: 36
Model: 42.03 A FORESTCREST
Project/Phase: Pine Valley Forevergreen / 1

APPLIANCES

Invoice	Qty.	Description
2833 27Jul21 NoCat	1	KITCHEN: APPLIANCE SPECIFICATIONS ATTACHED - SIGNED COPY

BASEMENT WINDOWS

Invoice	Qty.	Description
2796 72,351 09Jun21 **	2	BASEMENT WINDOWS - UPGRADE BASEMENT WINDOW SIZE TO 30 " X 24" - 8" FRAME

CENTRAL VAC AND WIRING

Invoice	Qty.	Description
2796 72,261 09Jun21 **	1	INSTALL VAC PAN UNDER KITCHEN SINK
2796 09Jun21 ** NoCat	1	INSTALL VAC PAN UNDER KITCHEN SINK
2796 09Jun21 ** NoCat	1	INSTALL VAC PAN UNDER KITCHEN SINK

CERAMIC

Invoice	Qty.	Description
2833 32 27Jul21	1	ENSUITE 2: TILE, FLOOR - LEVEL 1 - 12x24" LAID IN STRAIGHT STACKED PATTERN - SEE PLAN FOR TILE DIRECTION
2833 32 27Jul21	1	ENSUITE 3: TILE, FLOOR - LEVEL 1 - 12x24" LAID IN STRAIGHT STACKED PATTERN - SEE PLAN FOR TILE DIRECTION
2833 32 27Jul21	1	ENSUITE 4: TILE, FLOOR - LEVEL 1 - 12x24" LAID IN STRAIGHT STACKED PATTERN - SEE PLAN FOR TILE DIRECTION
2833 36 27Jul21	1	MASTER ENSUITE: TILE, FLOOR - LEVEL 4 - 30x30" LAID IN STRAIGHT STACKED PATTERN

DRYWALL

Invoice	Qty.	Description
2796 72,351 09Jun21 **	2	BASEMENT WINDOWS - UPGRADE BASEMENT WINDOW SIZE TO 30 " X 24" - 8" FRAME
2796 72,494 09Jun21	1	MASTER BEDROOM: MODEL OPTIONS 42.03.A OR B - MASTER BEDROOM - OPT. 10 FOOT TRAY CEILING AS PER PLAN
2796 72,261 09Jun21 **	1	INSTALL VAC PAN UNDER KITCHEN SINK
2796 72,690 09Jun21 **	1	DELETE KITCHEN BULKHEAD, IF POSSIBLE, SITE APPROVAL REQUIRED PURCHASER IS AWARE THERE WILL BE A GAP TO CEILING IF NO ADDITIONAL CABINETRY IS PURCHASED AT THE TIME OF COLOURS APPOINTMENT
2796 09Jun21 NoCat	1	KITCHEN/BREAKFAST: UPGRADE TO 96" TALL GARDEN DOOR INCLUDING SIDE LITE
2796 09Jun21 NoCat	1	THRU OUT SECOND FLOOR: INCREASE HEIGHT OF DOOR TO 8FT SECOND FLOOR - PER DOOR
2796 09Jun21 ** NoCat	1	INSTALL VAC PAN UNDER KITCHEN SINK
2796 09Jun21 ** NoCat	1	INSTALL VAC PAN UNDER KITCHEN SINK
2796 09Jun21 NoCat	1	**CUSTOM LAYOUT** BEDROOM 2: EXPAND ROOM SPACE BY DELETING LINEN CLOSET BACKING ONTO BEDROOM 2 + DELETING STANDARD CLOSET IN BEDROOM 2 INCLUDING ALL STD DOORS, SHELVING, WALLS - SEE PLAN
2796 09Jun21 NoCat	1	**CUSTOM LAYOUT** MASTER BEDROOM/BEDROOM 2: RE-LOCATE DOOR TO "HIS WIC" IN MASTER BEDROOM, TO BEDROOM 2 - SEE PLAN STANDARD SHELVING TO ACCOMMODATE REVISION
2796 09Jun21 NoCat	1	DELETE KITCHEN BULKHEAD, IF POSSIBLE, SITE APPROVAL REQUIRED PURCHASER IS AWARE THERE WILL BE A GAP TO CEILING IF NO ADDITIONAL CABINETRY IS PURCHASED AT THE TIME OF COLOURS APPOINTMENT
2796 09Jun21 ** NoCat	1	DELETE KITCHEN BULKHEAD, IF POSSIBLE, SITE APPROVAL REQUIRED PURCHASER IS AWARE THERE WILL BE A GAP TO CEILING IF NO ADDITIONAL CABINETRY IS PURCHASED AT THE TIME OF COLOURS APPOINTMENT
2796 09Jun21 ** NoCat	1	DELETE KITCHEN BULKHEAD, IF POSSIBLE, SITE APPROVAL REQUIRED PURCHASER IS AWARE THERE WILL BE A GAP TO CEILING IF NO ADDITIONAL CABINETRY IS PURCHASED AT THE TIME OF COLOURS APPOINTMENT

ELECTRICAL

Invoice	Qty.	Description
2796 72,351 09Jun21 **	2	BASEMENT WINDOWS - UPGRADE BASEMENT WINDOW SIZE TO 30 " X 24" - 8" FRAME
2796 72,292 09Jun21	1	FRONT EXTERIOR: ADDITIONAL COACH LIGHT ON SAME SWITCH (BUILDERS STANDARD FIXTURE)
2796 72,280 09Jun21	1	LIVING ROOM: ADDITIONAL REINFORCED CEILING LIGHT FIXTURE WITH SWITCH - SEE PLAN
2796 72,289 09Jun21	6	GREAT ROOM: 4" E/S LED INTERIOR POT LIGHT - GROUND FLOOR - EACH - INCLUDES ONE SWITCH INCLUDED IN APS
2796 72,289 09Jun21	2	GREAT ROOM: 4" E/S LED INTERIOR POT LIGHT - GROUND FLOOR - EACH - ON EXISTING SWITCH STANDARD CEILING LIGHT FIXTURE TO REMAIN
2796 72,281 09Jun21	1	GREAT ROOM: INTERIOR WALL OUTLET: ADDITIONAL 110V WALL INTERIOR RECEPTACLE ON EXISTING CIRCUIT FOR WALL MOUNTED TV - ABOVE FIREPLACE, APPROX. 64" A.F.F.
2796 72,280 09Jun21	1	REAR EXTERIOR: ADDITIONAL REINFORCED CEILING MOUNT FIXTURE - APPROX. CENTRE ON CEILING IN LOGGIA - WITH SEPARATE SWITCH
2796 72,307 09Jun21	1	UPPER HALL: FIXTURE: RELOCATE STANDARD CEILING MOUNT FIXTURE TO APPROX. CENTRE ON CEILING AT OTB
2796 09Jun21 NoCat	1	OPTIONAL COLD CELLAR BELOW LOGGIA
2796 09Jun21 NoCat	1	KITCHEN/BREAKFAST: UPGRADE TO 96" TALL GARDEN DOOR INCLUDING SIDE LITE
2796 09Jun21 NoCat	1	THRU OUT SECOND FLOOR: INCREASE HEIGHT OF DOOR TO 8FT SECOND FLOOR - PER DOOR
2796 09Jun21 NoCat	1	**CUSTOM LAYOUT** BEDROOM 2: EXPAND ROOM SPACE BY DELETING LINEN CLOSET BACKING ONTO BEDROOM 2 + DELETING STANDARD CLOSET IN BEDROOM 2 INCLUDING ALL STD DOORS, SHELVING, WALLS - SEE PLAN
2796 09Jun21 NoCat	1	**CUSTOM LAYOUT** MASTER BEDROOM/BEDROOM 2: RE-LOCATE DOOR TO "HIS WIC" IN MASTER BEDROOM, TO BEDROOM 2 - SEE PLAN STANDARD SHELVING TO ACCOMMODATE REVISION



CONSTRUCTION SUMMARY

Lot: 36
Model: 42.03 A FORESTCREST
Project/Phase: Pine Valley Forevergreen / 1

ELECTRICAL

Invoice	Qty.	Description
2833	1	KITCHEN: APPLIANCE SPECIFICATIONS ATTACHED - SIGNED COPY
27Jul21 NoCat		

EXTERIOR DOORS

Invoice	Qty.	Description
2796 72,357 09Jun21	1	KITCHEN/BREAKFAST: UPGRADE TO 96" TALL GARDEN DOOR INCLUDING SIDE LITE

FORMING

Invoice	Qty.	Description
2796 72,483 09Jun21	1	MODEL OPTIONS 42.03 - KITCHEN - OPT. COVERED LOGGIA AS PER PLAN
2796 09Jun21 NoCat	1	OPTIONAL COLD CELLAR BELOW LOGGIA
2796 72,208 09Jun21	1	PINE VALLEY MODEL 42.03 FORESTCREST ELEV A - 9 FOOT BASEMENT CEILING HEIGHT IN LIEU OF STANDARD 8 FOOT CEILING. INCLUDED IN APS
2796 09Jun21 ** NoCat	1	MODEL OPTIONS 42.03 - KITCHEN - OPT. COVERED LOGGIA AS PER PLAN
2796 09Jun21 ** NoCat	1	MODEL OPTIONS 42.03 - KITCHEN - OPT. COVERED LOGGIA AS PER PLAN
2796 09Jun21 ** NoCat	1	PINE VALLEY MODEL 42.03 FORESTCREST ELEV A - 9 FOOT BASEMENT CEILING HEIGHT IN LIEU OF STANDARD 8 FOOT CEILING. INCLUDED IN APS
2796 09Jun21 ** NoCat	1	PINE VALLEY MODEL 42.03 FORESTCREST ELEV A - 9 FOOT BASEMENT CEILING HEIGHT IN LIEU OF STANDARD 8 FOOT CEILING. INCLUDED IN APS
2796 09Jun21 ** NoCat	1	PINE VALLEY MODEL 42.03 FORESTCREST ELEV A - 9 FOOT BASEMENT CEILING HEIGHT IN LIEU OF STANDARD 8 FOOT CEILING. INCLUDED IN APS



CONSTRUCTION SUMMARY

Lot: 36
Model: 42.03 A FORESTCREST
Project/Phase: Pine Valley Forevergreen / 1

FRAMING

Invoice	Qty.	Description
2796 101,930 09Jun21	1	**CUSTOM LAYOUT** BEDROOM 2: EXPAND ROOM SPACE BY DELETING LINEN CLOSET BACKING ONTO BEDROOM 2 + DELETING STANDARD CLOSET IN BEDROOM 2 INCLUDING ALL STD DOORS, SHELVING, WALLS - SEE PLAN
2796 101,930 09Jun21	1	**CUSTOM LAYOUT** MASTER BEDROOM/BEDROOM 2: RE-LOCATE DOOR TO "HIS WIC" IN MASTER BEDROOM, TO BEDROOM 2 - SEE PLAN STANDARD SHELVING TO ACCOMMODATE REVISION
2796 72,690 09Jun21	1	DELETE KITCHEN BULKHEAD, IF POSSIBLE, SITE APPROVAL REQUIRED PURCHASER IS AWARE THERE WILL BE A GAP TO CEILING IF NO ADDITIONAL CABINETRY IS PURCHASED AT THE TIME OF COLOURS APPOINTMENT
2796 09Jun21 NoCat	1	KITCHEN/BREAKFAST: UPGRADE TO 96" TALL GARDEN DOOR INCLUDING SIDE LITE
2796 09Jun21 NoCat	1	MASTER BEDROOM: MODEL OPTIONS 42.03.A OR B - MASTER BEDROOM - OPT. 10 FOOT TRAY CEILING AS PER PLAN
2796 09Jun21 NoCat	1	THRU OUT SECOND FLOOR: INCREASE HEIGHT OF DOOR TO 8FT SECOND FLOOR - PER DOOR
2796 09Jun21 ** NoCat	1	DELETE KITCHEN BULKHEAD, IF POSSIBLE, SITE APPROVAL REQUIRED PURCHASER IS AWARE THERE WILL BE A GAP TO CEILING IF NO ADDITIONAL CABINETRY IS PURCHASED AT THE TIME OF COLOURS APPOINTMENT
2796 09Jun21 ** NoCat	1	DELETE KITCHEN BULKHEAD, IF POSSIBLE, SITE APPROVAL REQUIRED PURCHASER IS AWARE THERE WILL BE A GAP TO CEILING IF NO ADDITIONAL CABINETRY IS PURCHASED AT THE TIME OF COLOURS APPOINTMENT
2796 09Jun21 ** NoCat	1	DELETE KITCHEN BULKHEAD, IF POSSIBLE, SITE APPROVAL REQUIRED PURCHASER IS AWARE THERE WILL BE A GAP TO CEILING IF NO ADDITIONAL CABINETRY IS PURCHASED AT THE TIME OF COLOURS APPOINTMENT

GRANITE MARBLE QUARTZ

Invoice	Qty.	Description
2833 27Jul21 NoCat	1	MASTER ENSUITE: UPGRADE QUARTZ COUNTERTOP - LEVEL 4

HARDWOOD

Invoice	Qty.	Description
2833 13 27Jul21	1	THRU OUT STANDARD AREAS: MAIN HALL/LIVING ROOM, GREAT ROOM, DINING ROOM, STUDY, UPPER HALL, MASTER BEDROOM, BEDROOM 2, BEDROOM 3, BEDROOM 4, STUDY LOFT: MIRAGE, 5" MAPLE, TRUE BALANCE ENGINEERED HDWD, 3/4" THK, IMAGINE TEXTURE, DURAMATT FINISH - LEVEL 5

HVAC

Invoice	Qty.	Description
2796 72,690 09Jun21 **	1	DELETE KITCHEN BULKHEAD, IF POSSIBLE, SITE APPROVAL REQUIRED PURCHASER IS AWARE THERE WILL BE A GAP TO CEILING IF NO ADDITIONAL CABINETRY IS PURCHASED AT THE TIME OF COLOURS APPOINTMENT
2796 09Jun21 ** NoCat	1	DELETE KITCHEN BULKHEAD, IF POSSIBLE, SITE APPROVAL REQUIRED PURCHASER IS AWARE THERE WILL BE A GAP TO CEILING IF NO ADDITIONAL CABINETRY IS PURCHASED AT THE TIME OF COLOURS APPOINTMENT
2796 09Jun21 ** NoCat	1	DELETE KITCHEN BULKHEAD, IF POSSIBLE, SITE APPROVAL REQUIRED PURCHASER IS AWARE THERE WILL BE A GAP TO CEILING IF NO ADDITIONAL CABINETRY IS PURCHASED AT THE TIME OF COLOURS APPOINTMENT
2796 09Jun21 ** NoCat	1	DELETE KITCHEN BULKHEAD, IF POSSIBLE, SITE APPROVAL REQUIRED PURCHASER IS AWARE THERE WILL BE A GAP TO CEILING IF NO ADDITIONAL CABINETRY IS PURCHASED AT THE TIME OF COLOURS APPOINTMENT

INTERIOR TRIM AND DOORS

Invoice	Qty.	Description
2796 72,644 09Jun21	16	THRU OUT SECOND FLOOR: INCREASE HEIGHT OF DOOR TO 8FT SECOND FLOOR - PER DOOR
2796 09Jun21 NoCat	1	OPTIONAL COLD CELLAR BELOW LOGGIA
2796 09Jun21 NoCat	1	**CUSTOM LAYOUT** BEDROOM 2: EXPAND ROOM SPACE BY DELETING LINEN CLOSET BACKING ONTO BEDROOM 2 + DELETING STANDARD CLOSET IN BEDROOM 2 INCLUDING ALL STD DOORS, SHELVING, WALLS - SEE PLAN
2796 09Jun21 NoCat	1	**CUSTOM LAYOUT** MASTER BEDROOM/BEDROOM 2: RE-LOCATE DOOR TO "HIS WIC" IN MASTER BEDROOM, TO BEDROOM 2 - SEE PLAN STANDARD SHELVING TO ACCOMMODATE REVISION
2833 153,428 27Jul21	1	THRU OUT: UPGRADE 3 1/4" STEP BEVEL BB CASING, 7 1/4" BASE BOARD UPGRADE



CONSTRUCTION SUMMARY

Lot: 36
Model: 42.03 A FORESTCREST
Project/Phase: Pine Valley Forevergreen / 1

KITCHEN AND BATH CABINETRY

Invoice	Qty.	Description
2796 72,261 09Jun21 **	1	INSTALL VAC PAN UNDER KITCHEN SINK
2796 72,690 09Jun21 **	1	DELETE KITCHEN BULKHEAD, IF POSSIBLE, SITE APPROVAL REQUIRED PURCHASER IS AWARE THERE WILL BE A GAP TO CEILING IF NO ADDITIONAL CABINETRY IS PURCHASED AT THE TIME OF COLOURS APPOINTMENT
2833 27Jul21 NoCat	1	THRU OUT: SEE ATTACHED CABINETRY SCHEDULE

MASONRY

Invoice	Qty.	Description
2796 09Jun21 NoCat	1	KITCHEN/BREAKFAST: UPGRADE TO 96" TALL GARDEN DOOR INCLUDING SIDE LITE



CONSTRUCTION SUMMARY

Lot: 36
Model: 42.03 A FORESTCREST
Project/Phase: Pine Valley Forevergreen / 1

NETWORK AND WIRING

Invoice	Qty.	Description
2796 72,259 09Jun21	1	GREAT ROOM: CONDUIT PIPE - FOR WALL MOUNT TV - ABOVE FIREPLACE, APPROX. 64" A.F.F. THRU BASEMENT, TERMINATE AT STANDARD ELECTRICAL OUTLET
2796 72,260 09Jun21	1	CONDUIT PIPE - FROM ATTIC TO BASEMENT - BESIDE ELECTRICAL PANEL IN BASEMENT TO APPROX. CENTRE IN ATTIC
2796 72,261 09Jun21	1	INSTALL VAC PAN UNDER KITCHEN SINK

PAINT

Invoice	Qty.	Description
2796 09Jun21 NoCat	1	KITCHEN/BREAKFAST: UPGRADE TO 96" TALL GARDEN DOOR INCLUDING SIDE LITE
2796 09Jun21 NoCat	1	MASTER BEDROOM: MODEL OPTIONS 42.03.A OR B - MASTER BEDROOM - OPT. 10 FOOT TRAY CEILING AS PER PLAN
2796 09Jun21 NoCat	1	THRU OUT SECOND FLOOR: INCREASE HEIGHT OF DOOR TO 8FT SECOND FLOOR - PER DOOR
2796 09Jun21 NoCat	1	**CUSTOM LAYOUT** BEDROOM 2: EXPAND ROOM SPACE BY DELETING LINEN CLOSET BACKING ONTO BEDROOM 2 + DELETING STANDARD CLOSET IN BEDROOM 2 INCLUDING ALL STD DOORS, SHELVING, WALLS - SEE PLAN
2796 09Jun21 NoCat	1	**CUSTOM LAYOUT** MASTER BEDROOM/BEDROOM 2: RE-LOCATE DOOR TO "HIS WIC" IN MASTER BEDROOM, TO BEDROOM 2 - SEE PLAN STANDARD SHELVING TO ACCOMMODATE REVISION
2833 27Jul21 NoCat	2	MAIN STAIRS 2ND FLOOR TO BASEMENT: STAIN STAIRS AND LANDINGS WILL NOT MATCH HARDWOOD IN COLOUR, SPECIES OR TEXTURE
2796 72,690 09Jun21 **	1	DELETE KITCHEN BULKHEAD, IF POSSIBLE, SITE APPROVAL REQUIRED PURCHASER IS AWARE THERE WILL BE A GAP TO CEILING IF NO ADDITIONAL CABINetry IS PURCHASED AT THE TIME OF COLOURS APPOINTMENT



CONSTRUCTION SUMMARY

Lot: 36
Model: 42.03 A FORESTCREST
Project/Phase: Pine Valley Forevergreen / 1

PLUMBING

Invoice	Qty.	Description
2833	1	KITCHEN: APPLIANCE SPECIFICATIONS ATTACHED - SIGNED COPY
27Jul21 NoCat		

PV - 36 Cabinetry Schedule

ROOM	DESCRIPTION	PRICE		TOTAL
MASTER ENSUITE	UPGRADE FROM SERIES 2 TO SERIES 4 - LANCASTER JAVA MAPLE	632.40	1	
			\$	
		CABINETRY TOTAL:		

HANDLE PLACEMENT: VERTICAL ON DOORS, HORIZONTAL ON DRAWERS

LOT #: PV-36

DATE: July 27, 2021

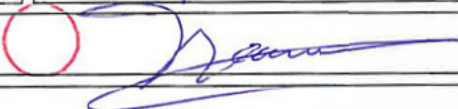
SIGNATURE: 

SIGNATURE:

Scheduled Closing Date: December 1, 2021

Purchaser: TRANG, DOAN TRAN
Telephone Res. / Bus: (647) 889-2948 / (647) 889-2948
Decor Advisor: Amanda Ceresino

Property: 36 of Plan -
Project: Pine Valley Forevergreen - Phase 1
Model and Elevation: 42.03 A FORESTCREST

Layout Changes: ☒ Yes ☐ No
Sketch Attached: ☒ Yes ☐ No
Exterior Colour Scheme:

1. Cabinetry

	Style and Colour	Counter	Hardware
Kitchen / Breakfast	Vermont 'Slate Grey Maple'	Granite: Arctic White	attachd
Laundry Room	Monterey 'Slate Grey Maple'	P-Lam: White	attachd
Powder Room	Monterey 'Slate Grey Maple'	Quartz: Ice Snow	attachd
Mud Room	Monterey 'Slate Grey Maple'	P-Lam: White	attachd
Master Ensuite Bathroom	*Lancaster 'Java Maple'	*Quartz: Vivid White	attachd
Second Ensuite Bathroom (If Applicable)	Bowery 'Capri'	Quartz: Ice Snow	attachd
Ensuite 3	Bowery 'Capri'	Quartz: Ice Snow	attachd

Comment

Ensuite 4: Bowery 'Capri' + Quartz: Ice Snow

2. Floor Tile

	Selection
Entrance Vestibule	13x13" Capri 'White'
Main Hall	n/a
Kitchen / Breakfast	13x13" Capri 'White'
Laundry Room	13x13" Capri 'White'
Powder Room	13x13" Capri 'White'
Mud Room	13x13" Capri 'White'
Master Ensuite Bathroom	*30x30" Marmorea 'Port Laurent' + charcoal grout
Second Ensuite Bathroom (If Applicable)	*12x24" New Byzantine 'Azzuro Blue'
Lower Landing (If Applicable)	13x13" Capri 'White' (basement foyer)
Ensuite 3	*12x24" New Byzantine 'Azzuro Blue'

Comment

ENSUITE 4: *12x24" New Byzantine 'Azzuro Blue' // SHOWER FLOORS THRU OUT: 2x2 std white

3. Wall Tile

	Selection	Listello/Inserts	Describe
Ensuite 4	8x10" Weave 'White'	<input type="radio"/> Yes <input checked="" type="radio"/> No	
Master Ensuite Bathroom		<input type="radio"/> Yes <input checked="" type="radio"/> No	
Tub Deck		<input type="radio"/> Yes <input checked="" type="radio"/> No	
Shower Stall	8x10" Weave 'White'	<input type="radio"/> Yes <input checked="" type="radio"/> No	
Bathroom Walls		<input type="radio"/> Yes <input checked="" type="radio"/> No	
Second Ensuite Bathroom (If Applicable)	8x10" Weave 'White'	<input type="radio"/> Yes <input checked="" type="radio"/> No	
Ensuite 3	8x10" Weave 'White'	<input type="radio"/> Yes <input checked="" type="radio"/> No	
Kitchen Backsplash	<input type="radio"/> Yes <input checked="" type="radio"/> No	Backsplash Behind Fridge	

Comment



2/20/21 Revised: June 29, 2022

Scheduled Closing Date: December 1, 2021

Purchaser: TRANG, DOAN TRAN

Property: 36 of Plan -

Telephone Res. / Bus: (647) 889-2948 / (647) 889-2948

Project: Pine Valley Forevergreen - Phase 1

Decor Advisor: Amanda Ceresino

Model and Elevation: 42.03 A FORESTCREST

4. Plumbing Fixtures

Master Ensuite Bathroom Second Ensuite Powder Room
Other Room - Specify Other Washroom

Comment

standard thru out

5. Hardwood Flooring

	Type and Stain		Type and Stain
Main Hall	<input type="text"/>	Upper Landing	<input type="text"/>
Kitchen / Breakfast	<input type="text"/>	Upper Hall	<input type="text"/>
Living Room	<input type="text"/>	Master Bedroom	<input type="text"/>
Dining Room	<input type="text"/>	Bedroom #2	<input type="text"/>
Family Room	<input type="text"/>	Bedroom #3	<input type="text"/>
Den/Library	<input type="text"/>	Bedroom #4	<input type="text"/>
Entrance Vestibule	<input type="text"/>	Bedroom #5	<input type="text"/>
Lower Landing (If Applicable)	<input type="text"/>	Other Room - Specify thru out standard areas	<input 'rock="" cliff'"="" maple="" type="text" value="3/4x5"/>

Comment

6. Carpeting

	Upgrade	Description
Ground Floor	<input type="checkbox"/>	<input type="text"/>
Second Floor	<input type="checkbox"/>	<input type="text"/>
<input type="text"/>	<input type="checkbox"/>	<input type="text"/>

	Type	Area
Upgrade Underpad	<input type="text"/>	<input type="text"/>
Carpet on Stairs	<input type="text"/>	<input type="text"/>

Comment

7. Fireplace

	Living Room			Family Room			Other Room - Specify		
	Purchased	As Per Plan	N/A	Purchased	As Per Plan	N/A	Purchased	As Per Plan	N/A
Fireplace Type	<input type="radio"/>	<input type="radio"/>	<input type="radio"/>	<input type="radio"/>	<input checked="" type="radio"/>	<input type="radio"/>	<input type="radio"/>	<input type="radio"/>	<input type="radio"/>
Mantle Type	<input type="text"/>			<input type="text" value="Standard Gas"/>			<input type="text"/>		
Colour / Stain	<input type="text"/>			<input type="text" value="Mediterranean"/>			<input type="text"/>		
Surround	<input type="text"/>			<input type="text" value="Arctic White"/>			<input type="text"/>		
Hearth	<input type="text"/>			<input type="text" value="N/A"/>			<input type="text"/>		
	<input type="text"/>			<input type="text" value="None"/>			<input type="text"/>		

Comment

Purchaser: TRANG, DOAN TRAN

Property: 36 of Plan -

Telephone Res. / Bus: (647) 889-2948 / (647) 889-2948

Project: Pine Valley Forevergreen - Phase 1

Decor Advisor: Amanda Ceresino

Model and Elevation: 42.03 A FORESTCREST

8. Trim Carpentry

Interior Doors Front Door Glass Inserts Door Handles

Interior Trim

Comment

9. Plaster Mouldings and Medallions

Standard Throughout ☐ Yes ☐ No ☐ N/A

Entrance Vestibule	<input type="text"/>	<input type="text"/>	Kitchen/Breakfast	<input type="text"/>	<input type="text"/>
Main Hall	<input type="text"/>	<input type="text"/>	Den/Library	<input type="text"/>	<input type="text"/>
Living Room	<input type="text"/>	<input type="text"/>	Lower Landing	<input type="text"/>	<input type="text"/>
Dining Room	<input type="text"/>	<input type="text"/>	Other Room - Specify	<input type="text"/>	<input type="text"/>
Family Room	<input type="text"/>	<input type="text"/>		<input type="text"/>	<input type="text"/>

Comment

10. Railings and Spindles

Railing Package

Railing Colour

Spindle Colour

Stringer / Riser

Treads

Comment

Oak Stairs ☒ Yes ☐ No ☐ N/A

11. Wall Paint / Ceilings

Throughout Finished Areas

Trim Paint

Smooth Ceilings

Ground Floor ☒

Second Floor ☒

Note

Comment



attach revised: June 29, 2022

Scheduled Closing Date: December 1, 2021

Purchaser: TRANG, DOAN TRAN

Property: 36 of Plan -

Telephone Res. / Bus: (647) 889-2948 / (647) 889-2948

Project: Pine Valley Forevergreen - Phase 1

Decor Advisor: Amanda Ceresino

Model and Elevation: 42.03 A FORESTCREST

12. Electrical

Hood Fan ☐ White ☒ Stainless ~~N/A~~ *see attached. revised June 29, 2021*

Above Kitchen Cabinet Light ☐ Yes ☒ No

Standard Appliances ☐

Below Kitchen Cabinet Light ☐ Yes ☒ No

Over The Range Microwave ☐

Chimney Style Fan ☒

Comment

13. Heating and Air Conditioning

Air Conditioning

Gas Provisions Stove

Gas Provisions Dryer

Gas Provisions Barbecue

Comment

14. Additional Comments

15. Disclaimers and Notes

- Colours of all materials are as close as possible to builder's selection, but not necessarily identical due to variances in manufacturing.
- Any extras listed above are null and void unless accompanied by a separate invoice/amendment. Said invoice must be paid in full.
- The Purchaser acknowledges that after Interior Colour Selection form is signed and dated, no further changes will be permitted other than re-selection due to unavailability. T-T Purchaser's Initials
- The Purchaser acknowledges reading and accepting the "Gold Park Homes Decor Centre Disclaimers" form. This document contains other miscellaneous disclaimers.

This Interior Colour Selection is final and approved by:

Signature: T-T Date: July 27, 2021

attach Revised: June 29, 2021

Scheduled Closing Date: December 1, 2021

Purchaser: TRANG, DOAN TRAN

Property: 36 of Plan -

Telephone Res. / Bus: (647) 889-2948 / (647) 889-2948

Project: Pine Valley Forevergreen - Phase 1

Decor Advisor: Amanda Ceresino

Model and Elevation: 42.03 A FORESTCREST

12. Electrical

Hood Fan ☐ White ☐ Stainless ☒ N/AAbove Kitchen Cabinet Light ☐ Yes ☒ NoBelow Kitchen Cabinet Light ☐ Yes ☒ NoStandard Appliances ☐Over The Range Microwave ☐Chimney Style Fan ☐

Comment

13. Heating and Air Conditioning

Air Conditioning none

Gas Provisions Stove none

Gas Provisions Dryer none

Gas Provisions Barbecue std

Comment

14. Additional Comments

15. Disclaimers and Notes

- 1) Colours of all materials are as close as possible to builder's selection, but not necessarily identical due to variances in manufacturing.
- 2) Any extras listed above are null and void unless accompanied by a separate invoice/amendment. Said invoice must be paid in full.
- 3) The Purchaser acknowledges that after Interior Colour Selection form is signed and dated, no further changes will be permitted other than re-selection due to unavailability. T-T Purchaser's Initials
- 4) The Purchaser acknowledges reading and accepting the "Gold Park Homes Decor Centre Disclaimers" form. This document contains other miscellaneous disclaimers.

This Interior Colour Selection is final and approved by:

Signature: T-TDate: July 27, 2021

PV-36

July 27, 2024

1.5

* Standard Appliance Openings *

GOLDPARK HOMES

PINE VALLEY

VAUGHAN, ONTARIO

MODEL: (4203) FORESTCREST

SITE STANDARD: WHITE 3/4" EXTENSION
SOFT-CLOSE DRAWERS & SOFT-CLOSE
HINGES TO KITCHEN AREA

10' CEILING - 12"H COFFERED CEILING -
M.H. = 102" + 3/4"H CONTEMPORARY
MOLDING + 5 1/4"H FURRING RAIL
+ LARGE CORNICE MOLDING TO
UNDERSIDE OF BOX

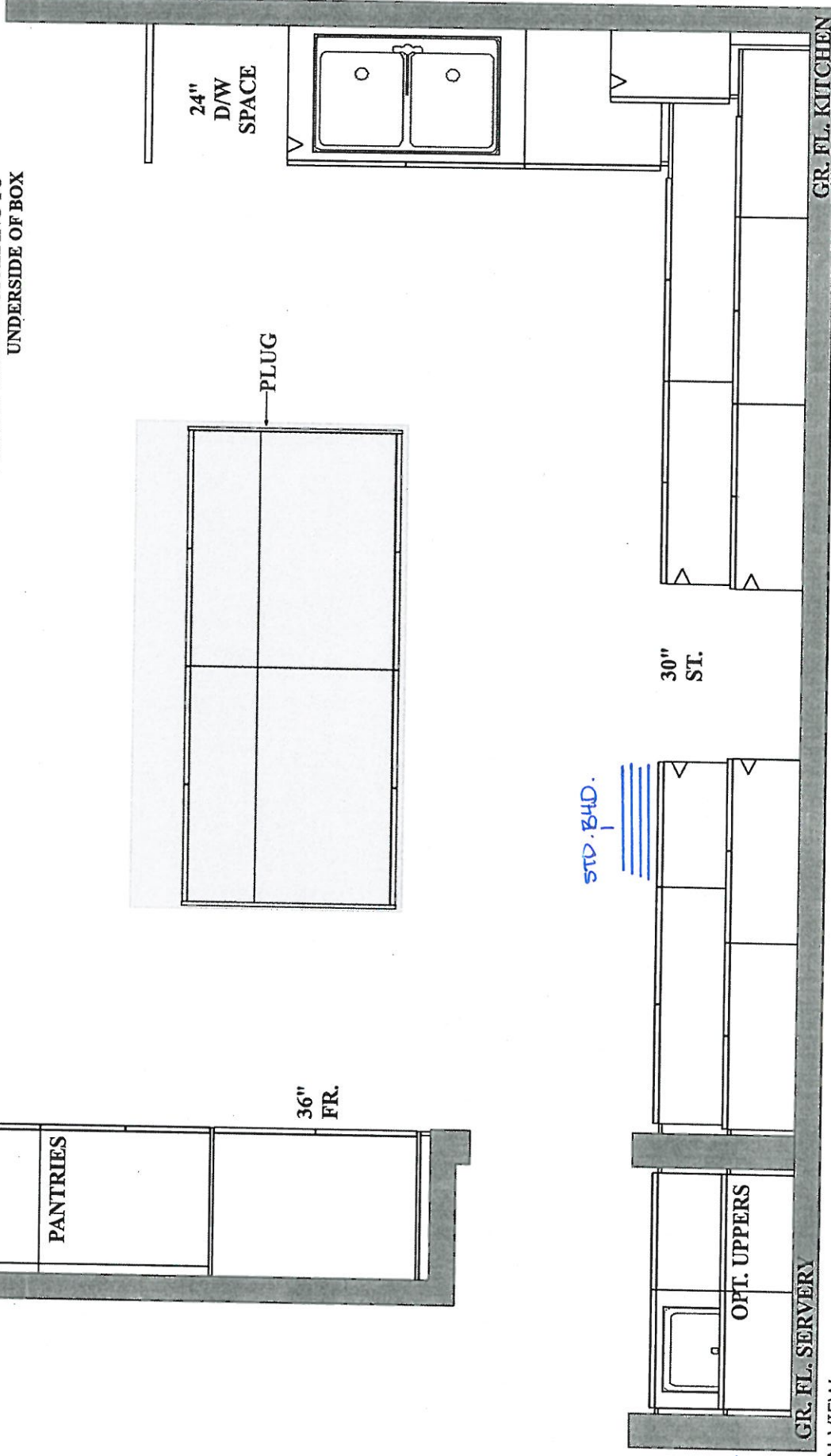
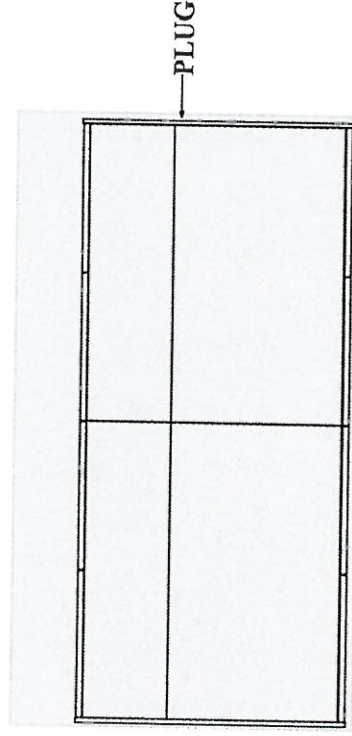
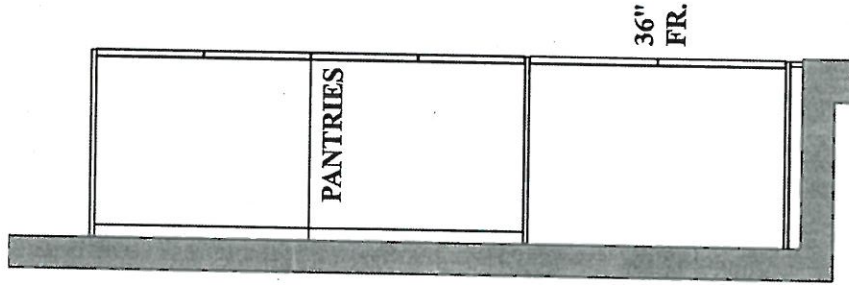

PLAN VIEW

PV-36
July 27, 2021

T-1

No!

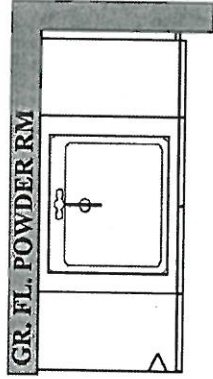
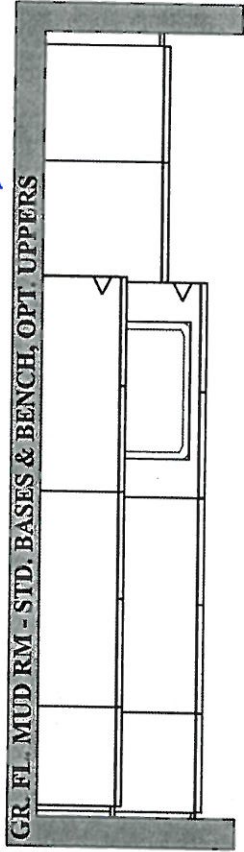

No!

GOLDPARK HOMES
PINE VALLEY
VAUGHAN, ONTARIO
MODEL: (4203) FORESTCREST

SITE STANDARD: WHITE 3/4" EXTENSION
SOFT-CLOSE DRAWERS & STANDARD SLAM DOOR HINGES
TO VANITIES

ONE TOP DRAWER WHERE POSSIBLE THROUGHOUT EACH
VANITY, ONE BANK OF DRAWERS WHERE POSSIBLE
THROUGHOUT EACH MASTER ENSUITE VANITY

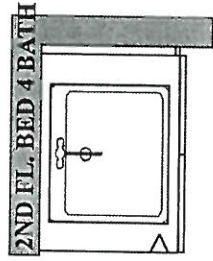
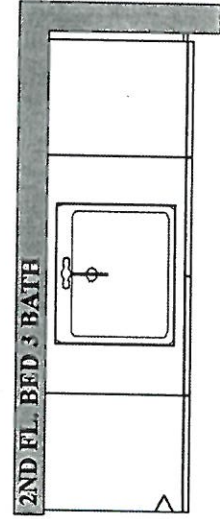
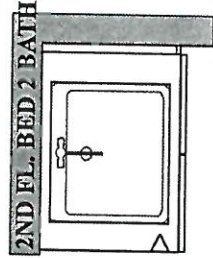
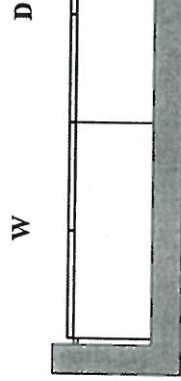
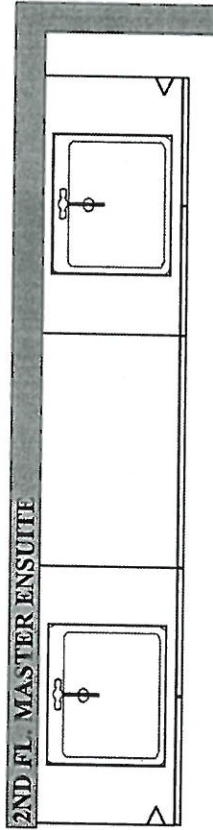
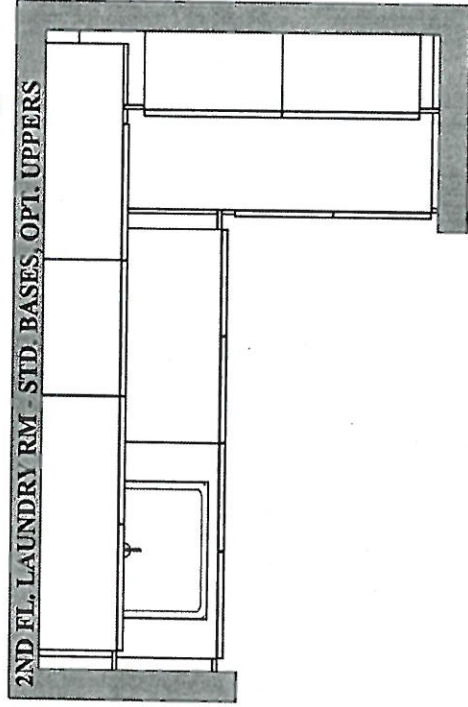

PLAN VIEW



SCHEDULE 'F'

PV-36
June 4, 2021



PV-36
July 27, 2021



The Forestcrest

42' SERIES

Elevation A • 3,800 sq.ft.

Elevation B • 3,785 sq.ft.

Elevation C • 3,800 sq.ft.

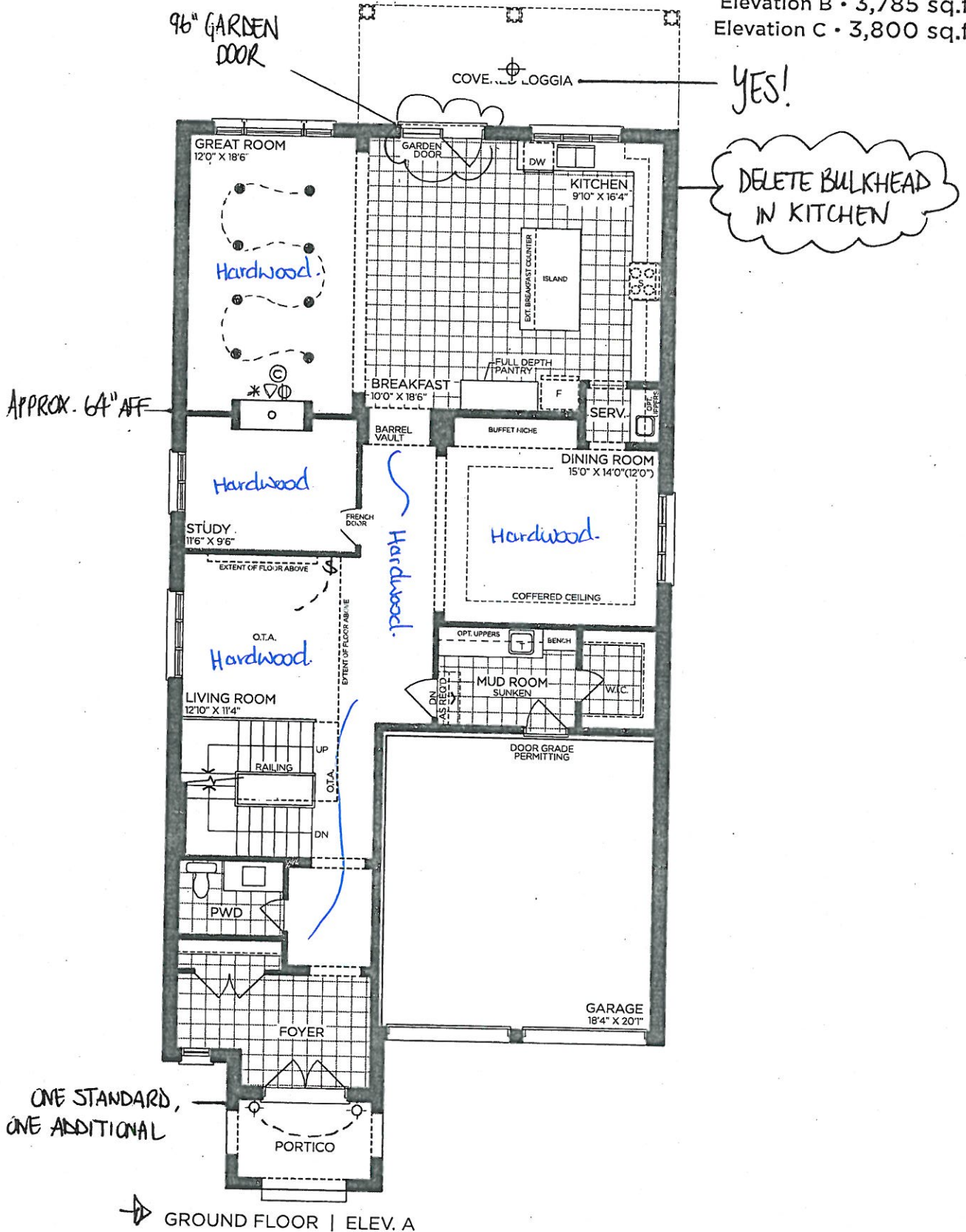

VENDOR

PURCHASER

PURCHASER

GOLDPARK
WORTH MORE™

Prices, figures, illustrations, sizes, features and finishes are subject to change without notice. Areas and dimensions are approximate and actual usable floor space may vary from the stated area. Layout may be reverse of the unit purchased. E. & O.E. 4203



8' DOORS
THRU OUT

SCHEDULE 'F'

PV-36
June 4, 2021 (J.T.)

PV-36
July 27, 2021 (J.T.)

The Forestcrest 42' SERIES

Elevation A • 3,800 sq.ft.

Elevation B • 3,785 sq.ft.

Elevation C • 3,800 sq.ft.

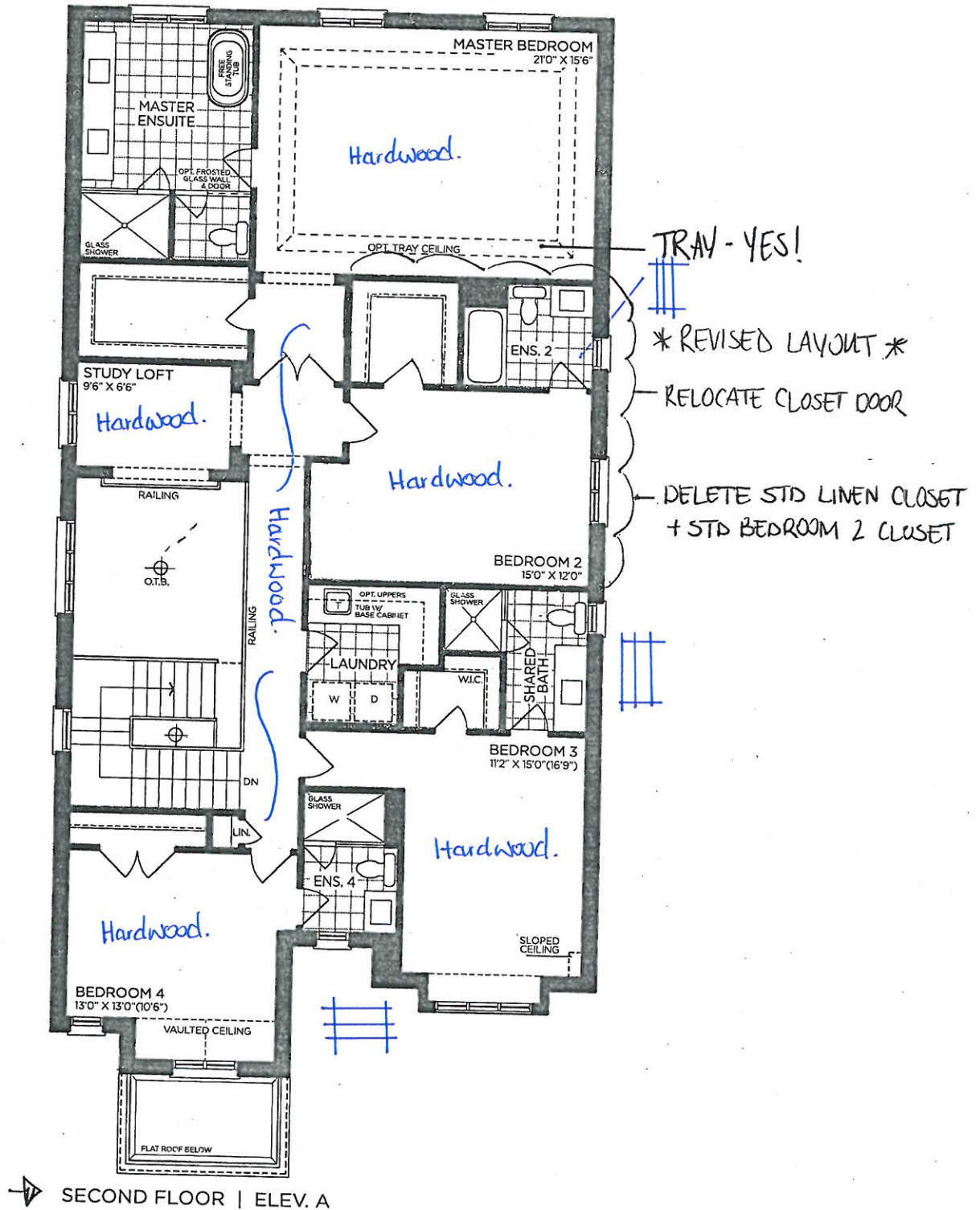

VENDOR

PURCHASER

PURCHASER

GOLDPARK
WORTH MORE™

Prices, figures, illustrations, sizes, features and finishes are subject to change without notice. Areas and dimensions are approximate and actual usable floor space may vary from the stated area. Layout may be reverse of the unit purchased. E. & O.E. 4203



9' CEILING

SCHEDULE 'F'

PV-36
June 4, 2021 (T-T)
PV-36
July 27, 2021 (T-T)

The
Forestcrest
42' SERIES

Elevation A • 3,800 sq.ft.
Elevation B • 3,785 sq.ft.
Elevation C • 3,800 sq.ft.

OPTIONAL COLD CELLAR

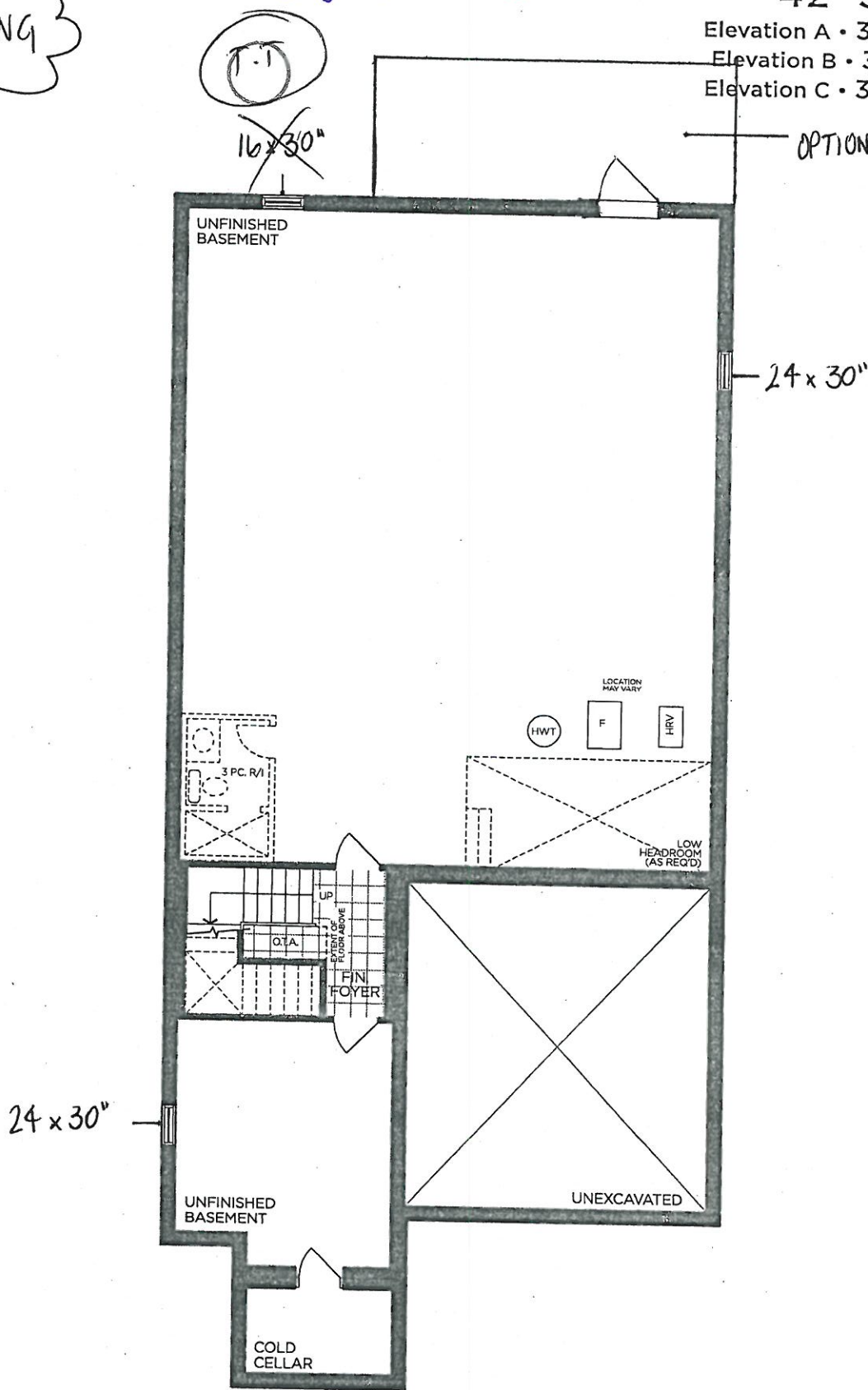

→ BASEMENT | ELEV. A

VENDOR

PURCHASER

PURCHASER

GOLDPARK
WORTH MORE™

Prices, figures, illustrations, sizes, features and finishes are subject to change without notice. Areas and dimensions are approximate and actual usable floor space may vary from the stated area. Layout may be reverse of the unit purchased. E. & O.E. 4203



PINE VALLEY
FOREVERGREEN

STONE COUNTERTOP EDGE PROFILES

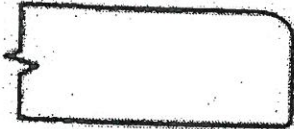

STANDARD 2CM EASED EDGE

LOCATION:

* thru-out *



UPGRADE 3CM EASED EDGE

LOCATION:



UPGRADE 4CM MITRED EDGE

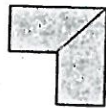

LOCATION:



UPGRADE 2CM OGEE EDGE

LOCATION:

LOT #: PV-36

DATE: July 27, 2021

SIGNATURE:

T.J.

SIGNATURE:

GOLDPARK
WITH MORE



PINE VALLEY
FOREVERGREEN

STANDARD HARDWARE / HANDLES

☐

H001-02

☐

H001-03

☐

H001-04

☐

H009-03

☐

H009-09

☐

H011-03

☐

H011-05

☐

H011-06

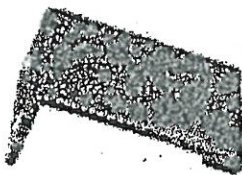
☐

H033-01

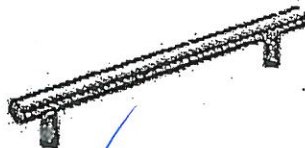
☒

H039-03

* thru-out *

☐

*NO HARDWARE

LOT # *pv-36*

DATE: *July 27, 2021*

SIGNATURE:

T-T

SIGNATURE:

GOLDPARK
WORTH MORE



PINE VALLEY
FOREVERGREEN

STANDARD SHOWER HARDWARE

SDK106

Shower Door Knob

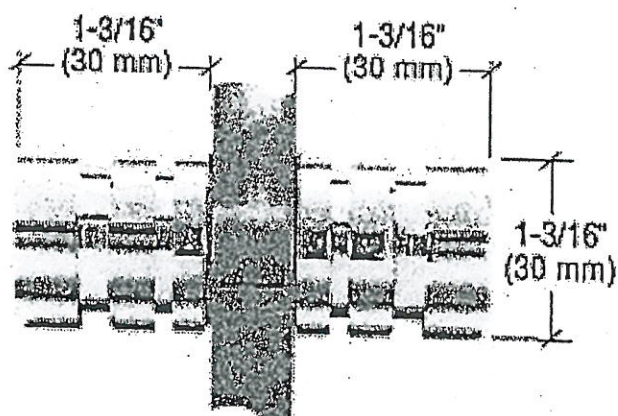

SDK106

Shower Door Knob

1-3/16" dia.
Contemporary Style

CHROME

Lot# PV-36	Date: July 27, 2021	Room: *thru-out*
Signature: 		
Signature:		

BATHROOM ACCESSORIES

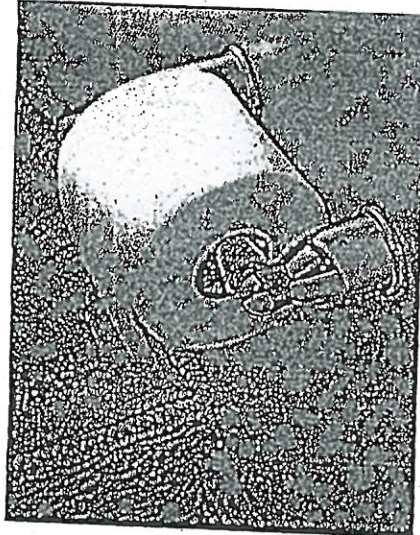

Tissue Holder
Mason - Chrome

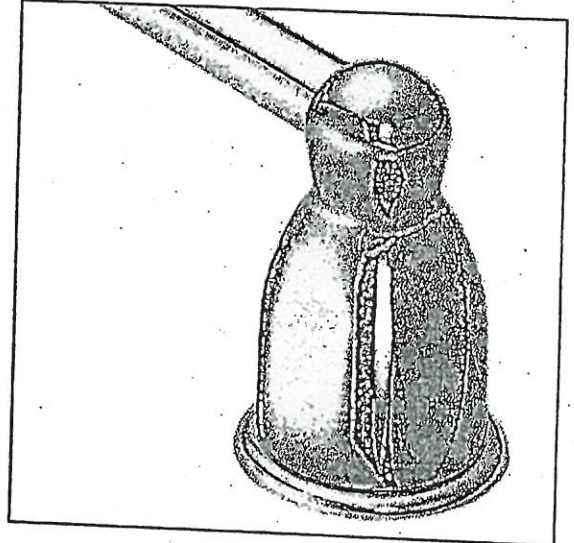

Towel Bar
Mason - Chrome

Please select one of the following:

☒ INSTALL STANDARD BATHROOM ACCESSORIES THRU OUT
(tissue holder + towel bar) **location as per vendors discretion**

☐ ***DO NOT*** INSTALL STANDARD BATHROOM ACCESSORIES
THRU OUT **tissue holder + towel bar will not be provided**

LOT # PV-36

DATE: July 27, 2021

SIGNATURE:



SIGNATURE:

PV-36
July 27, 2021



NE63T8951SS

SAMSUNG

6.3 cu. ft. Smart Slide-In Induction Range
with Flex Duo™, Smart Dial & Air Fry

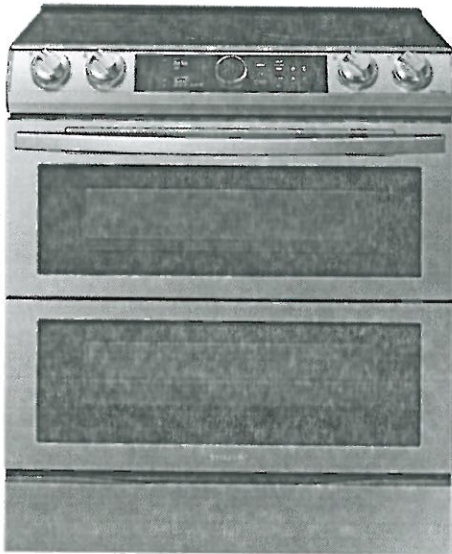

Signature Features

Smart Dial

- The new Smart Dial simplifies oven settings in a single dial and intuitively learns based on your cooking preferences.

Air Fry

- Cooking with a crunch just got healthier with Air Fry.* Using little to no oil, you can quickly prepare favorite fried foods right in your oven. No preheating required.

*As compared to deep frying. Air fry tray included with purchase.

Flex Duo™

- The Flex Duo™ range is for the ultimate multi-tasker who wants to be efficient in the kitchen. Use the full oven, or split it into two separate smaller ovens to suit your needs.

Available Colors

 Fingerprint Resistant
Stainless Steel (shown)

 Fingerprint Resistant
Black Stainless Steel



Smart Dial



Air Fry

Features

- Smart Dial
- Air Fry, Tray Included
- Flex Duo™
- Convection+
- Illuminated Knobs
- Fingerprint Resistant Finish
- Virtual Flame™
- Large Oven Capacity – 6.3 cu. ft.
- Ready2Fit™ Guarantee
- Temperature Probe
- Gliding Rack
- Soft Close Door
- Storage Drawer

- Flexible Cooktop:
Four Burner Cooktop
- 11" 2400 W, Boost 4200 W,
Virtual Flame™
- 7" 1800 W, Boost 2300 W (2)
- 6" 1200 W, Boost 2000 W

Convenience

- Wi-Fi Connectivity
- Voice-Enabled
- Convection Auto Conversion
- Self & Steam Clean
- Hidden Bake Element
- Child Safety Lock
- Delay Start
- Auto Oven Light
- Kitchen Timer
- Sabbath Mode



Ready2Fit™



7-1

NE63T8951SS

6.3 cu. ft. Smart Slide-In Induction Range with Flex Duo,[™] Smart Dial & Air Fry

Installation Specifications

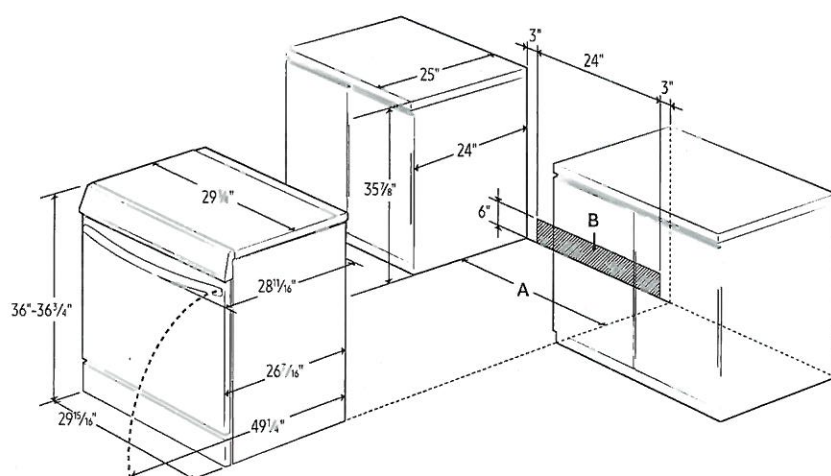

A: Cabinet opening min 30"
B: Acceptable electrical outlet area

IMPORTANT: If your cabinets are over 36³/₄" high, you must install this range on a hard, heat-resistant support that raises the surface of the range so that it is about even with the countertop.

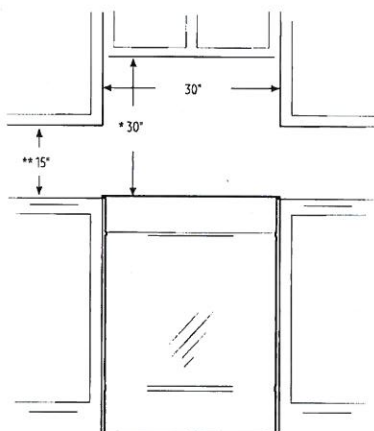

* 30" minimum clearance between the top of the cooking surface and the bottom of an unprotected wood or metal cabinet; or 24" minimum when the bottom of the wood or metal cabinet is protected by not less than 1/4" of flame retardant millboard covered with not less than no.28 MSG sheet steel, 0.015" stainless steel, 0.024" aluminum, or 0.020" copper.

**15" minimum between the countertop and the adjacent cabinet bottom.

IMPORTANT: Consult with Installation Manual for detailed instructions before installing. All ranges must be installed with the Anti-Tip device that is included.

Power Source

240V/208V/60 Hz/40A

Induction Cooktop

- Right Front: 11" 2400 W, Boost 4200 W, Virtual Flame™
- Left Front: 7" 1800 W, Boost 2300 W
- Right Rear: 7" 1800 W, Boost 2300 W
- Left Rear: 6" 1200 W, Boost 2000 W

Dual Oven

- Upper Capacity: 3.4 cu. ft.
- Lower Capacity: 2.7 cu. ft.
- Convection Element/Heater
- Convection Bake
- Convection Roast
- Bake
- Variable Broil: Low/High
- Air Fry
- Bread Proof
- Dehydrate

Warranty

One (1) Year Parts and Labor

Product Dimensions & Weight (WxHxD)

Oven Interior Dimensions:

24¹³/₁₆" x 22⁷/₁₆" x 19³/₄"

Outside Net Dimensions:

29¹⁵/₁₆" x 36-36³/₄" (Adjustable) x 28¹¹/₁₆"

Weight: 216 lbs

Shipping Dimensions & Weight (WxHxD)

Dimensions:

33¹/₁₆" x 41³/₄" x 30⁵/₁₆"

Weight: 239 lbs

Color

Fingerprint Resistant

Stainless Steel

Model #

UPC Code

NE63T8951SS 887276415086

Fingerprint Resistant

Black Stainless Steel NE63T8951SG 887276415062



Actual color may vary. Design, specifications, and color availability are subject to change without notice. Non-metric weights and measurements are approximate.

©2021 Samsung Electronics America, Inc. 85 Challenger Road, Ridgefield Park, NJ 07660. Tel: 800-SAMSUNG. samsung.com. Samsung is a registered trademark of Samsung Electronics Co. Ltd.

PV-36
July 27, 2021
T-1

RF28R7551SR

SAMSUNG

28 cu. ft. 4-Door French Door Refrigerator
with 21.5" Connected Touchscreen Family Hub™

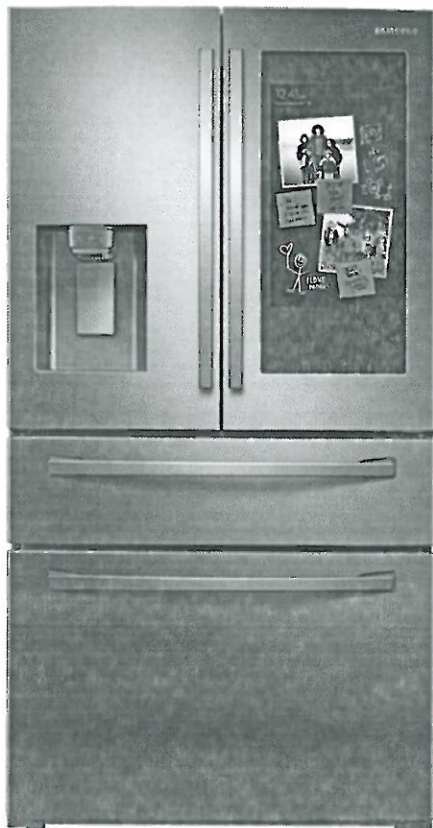

Signature Features

Food

- See inside your refrigerator from anywhere, with 3 built-in cameras.
- Create and share shopping lists, plan meals based on the food inside your refrigerator and automatically set expiration dates.

Family

- Create your own home screen with Family Board, by adding personalized pictures, stickers and handwritten notes.
- Customize your screen saver with picture slide show, weather and animations.

Fun

- Stream your favorite music service directly on your Family Hub™ screen.
- Mirror your Samsung TV or Samsung phone, right on your Family Hub™.



Your Home

- Access your smart devices and Samsung appliances from your Family Hub™ screen; set lights, hear and speak to someone at your front door, monitor your baby's room and receive laundry end-of-cycle notifications.
- Receive Wi-Fi updates so your fridge stays up to date with the latest features and apps.

Bixby Voice 2.0

- Intelligent voice assistant allows hands-free navigation.
- Recognizes user's voice and provides a personalized experience.

Available Colors

-  Fingerprint Resistant Stainless Steel (shown)
-  Fingerprint Resistant Black Stainless Steel
-  Fingerprint Resistant Tuscan Stainless Steel



Family Hub™

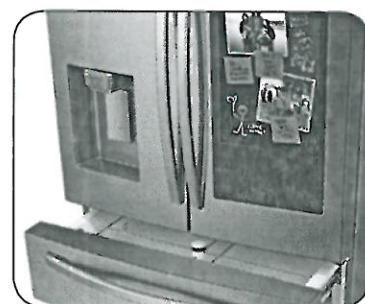

FlexZone™ Drawer

Convenience

- FlexZone™ Drawer with 4 Temperature Settings and Smart Divider
- Wi-Fi and Bixby Enabled
- Adjustable Shelves for Tall Oversized Items
- Auto Pull-Out Upper Freezer Drawer
- Water Filter Indicator

Design

- Fingerprint Resistant Finish
- Modern External Filtered Water and Ice Dispenser
- High Efficiency LED Lighting
- EZ-Open Handle™ on Freezer Door and FlexZone™ Drawer
- Tempered Glass Spill-Proof Shelves
- Gallon Door Bins
- Dispenser Light

Performance

- Twin Cooling Plus®
- Metal Cooling
- 25W Built-In Speaker
- Ice Max - Stores up to 4.2 lbs of ice
- ENERGY STAR® Compliant
- Power Freeze and Power Cool Options
- Two Humidity-Controlled Crispers
- CoolTight Door
- Door Alarm

Rating



ENERGY STAR® rated:
755 kWh/yr

PV-36
July 27, 2021
T.I

RF28R7551SR

SAMSUNG

28 cu. ft. 4-Door French Door Refrigerator with 21.5" Connected Touchscreen Family Hub™

Installation Specifications

1. Measure the height, width and depth of the opening, making sure to include baseboards, molding tile, countertop overhang, etc. Check to be sure there is enough room to open the door (consider walls, islands or other obstacles when measuring).
2. Refer to illustration below to determine dimensions.
3. Allow 2.5" of clearance on hinge side of refrigerator when installing next to a wall where handle may make contact.
4. Allow 1" minimum clearance at rear for proper air circulation and water/electrical connections. Allow a 3/8" minimum clearance at sides and top for ease of installation.
5. Ensure each door and entryway in the home is wide enough for the refrigerator to be moved through easily.

For optimal usage and to be able to open refrigerator doors completely, do not install next to a wall.

Please note: The following dimension and cutout information is for planning purposes only. For complete installation details, consult manual packed with product, or download manual online at [samsung.com](https://www.samsung.com).

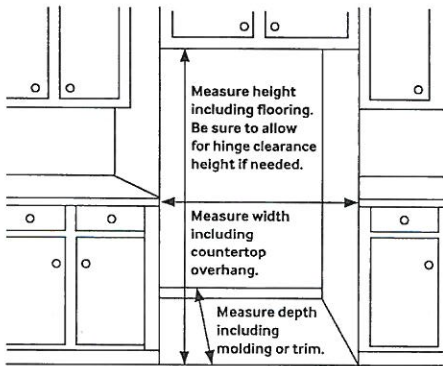

Total Capacity: 27.7 cu. ft.

Refrigerator: 15.6 cu. ft.

- 2 Humidity-Controlled Crispers
- 5 Tempered Glass Spill-Proof Shelves
 - 1 Slide-In
 - 1 Slide-Out
 - 1 Foldable Half
 - 2 Fixed
- 6 Door Bins
 - Right Door: 3 Door Bins
 - Left Door: 3 Regular Bins
- Metal Cooling
- High Efficiency LED Lighting

FlexZone™ Drawer: 3.8 cu. ft.

- EZ-Open Handle™
- 4 Temperature Zones with Smart Divider
 - Meat/Fish (29°F)
 - Cold Drinks (33°F)
 - Deli/Snacks (37°F)
 - Wine/Party Dishes (42°F)

Freezer: 8.3 cu. ft.

- EZ-Open Handle™
- Take Out Box
- 1 Drawer Divider
- High Efficiency LED Lighting

Warranty

One (1) Year Parts and Labor on Refrigerator
Five (5) Years Parts and Labor on Sealed Refrigeration System Only*
Ten (10) Years Parts and Five (5) Years Labor on Digital Inverter Compressor

*Compressor, evaporator, condenser, drier and connecting tubing.

Product Dimensions & Weight

Dimensions (WxHxD with hinges, handles and doors):
35 3/4" x 70" x 36 1/2"

Dimensions (WxHxD without hinges and door):
35 3/4" x 68 7/8" x 29 1/2"

Dimensions (WxHxD with hinge and door, no handle):
35 3/4" x 70" x 34"

Weight: 346 lbs

Shipping Dimensions & Weight (WxHxD)

Dimensions: 38 1/4" x 75 3/4" x 36 1/4"

Weight: 368 lbs

Color	Model #	UPC Code
Fingerprint Resistant Stainless Steel	RF28R7551SR	887276345321
Fingerprint Resistant Black Stainless Steel	RF28R7551SG	887276345314
Fingerprint Resistant Tuscan Stainless Steel	RF28R7551DT	887276345307

Dimensions

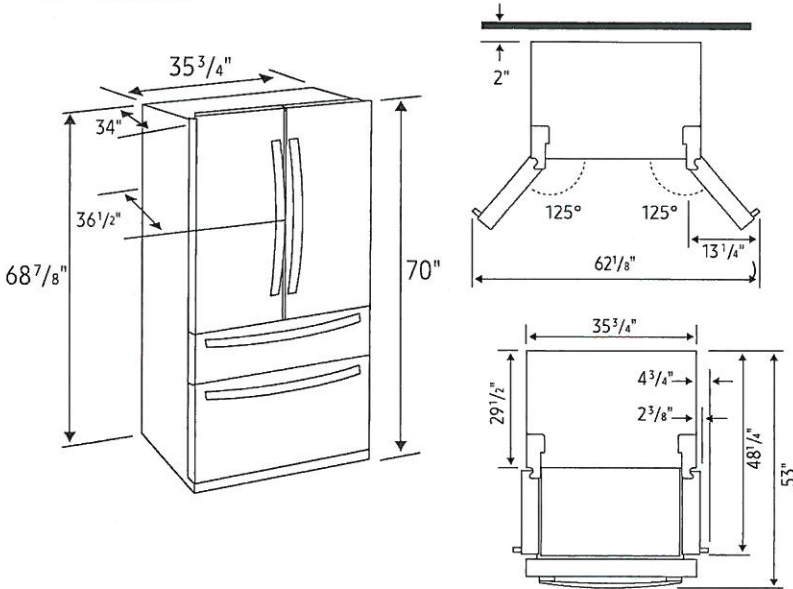

Actual color may vary. Design, specifications, and color availability are subject to change without notice. Non-metric weights and measurements are approximate.
©2019 Samsung Electronics America, Inc., 85 Challenger Road, Ridgefield Park, NJ 07660. Tel: 800-SAMSUNG. [samsung.com](https://www.samsung.com). Samsung is a registered trademark of Samsung Electronics Co., Ltd.

PV-36
July 27, 2021
T.I.

DW80R9950

SAMSUNG

Samsung Linear Wash 39 dBA Dishwasher

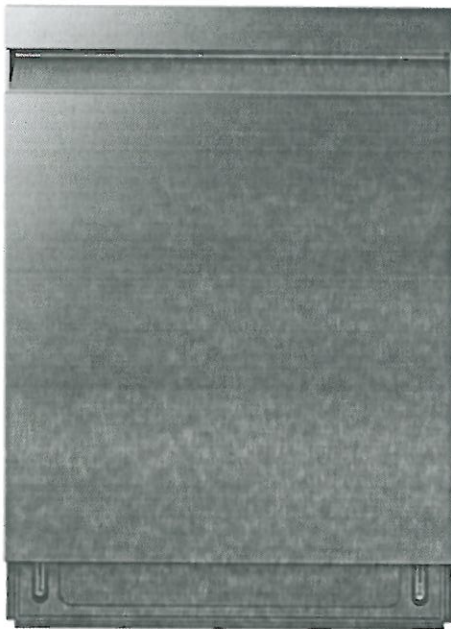

Signature Features

Linear Wash System

- AquaBlast™ jets provide corner to corner coverage for superior cleaning.



Whisper Quiet Cleaning

- Less noise and less disturbance with virtually silent wash cycles at 39 dBA.

AutoRelease™ Door

- At the end of a cycle, the door automatically opens to circulate air and improve drying performance.

Available Colors

-  Fingerprint Resistant Stainless Steel (shown)
-  Fingerprint Resistant Black Stainless Steel
-  Fingerprint Resistant Tuscan Stainless Steel

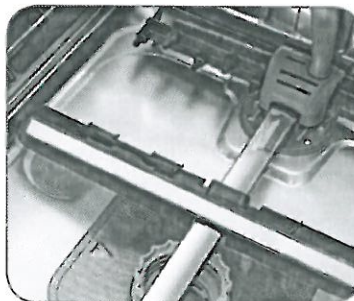

Linear Wash System

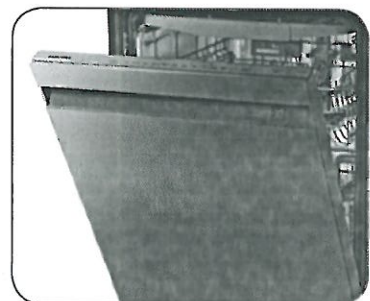

AutoRelease™ Door

Features

- Flexible 3rd Rack
- Fingerprint Resistant Stainless Finish
- Zone Booster™
- Touch Control
- Quiet Operation: 39 dBA
- Wi-Fi Connectivity
- 7 Wash Cycles
- 8 Options
- Half-Load Cycle
- Express Cycle: 60 Minutes
- One-Touch Adjustable Racking System
- Full Stainless Steel Interior
- 15 Place Settings
- 3 Spray Wash Arms (Upper, Middle, Lower)

Convenience

- LED Time Display
- Control Lock
- Delay Start
- Digital Leak Sensor

Rating

ENERGY STAR®-rated:
239 kWh/yr

PY-36
July 27, 2021



DW80R9950

Samsung Linear Wash 39 dBA Dishwasher

SAMSUNG

Installation Specifications

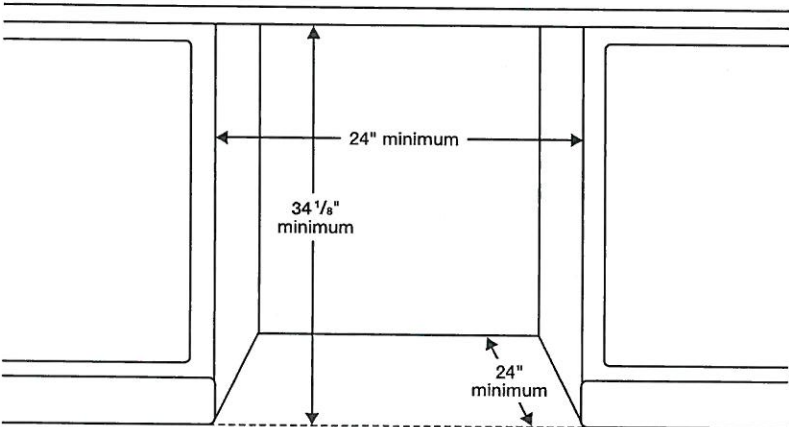

Features

- 7 Wash Cycles: Auto, Normal, Heavy, Delicate, Express 60, Rinse Only, Self Clean
- 8 Options: Half-Load Wash (Lower Rack), Zone Booster™ (Left), Speed Booster, Hi-Temp Wash, Sanitize (Anti-bacterial – NSF), Delay Start, Control Lock, Smart Control (Wi-Fi App)
- AutoRelease™ Door
- Hidden Heat Element
- Stainless Steel Interior Tub

Convenience

- Control Lock
- Digital Water Leakage Sensor
- Flexible Third Rack
- One-Touch Adjustable Racking System
- Silverware Basket
- Upper Rack: Foldable Cup Shelves, 2 Adjustable Tines
- Lower Rack: Fold-Down Tines

Warranty

One (1) Year All Parts and Labor
Five (5) Year Limited on Printed Circuit Board and Interior Nylon Racks

Dimensions

Side View

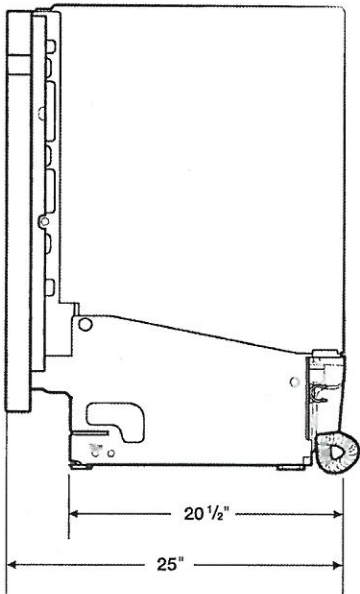

Rear View

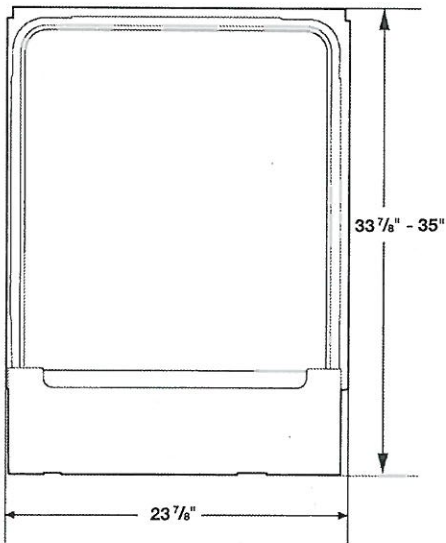

Product Dimensions & Weight (WxHxD)

Dimensions (height is adjustable):
23 7/8" x 33 7/8" – 35" x 25"

Weight: 95 lbs

Shipping Dimensions & Weight (WxHxD)

Dimensions:
26" x 34 3/4" x 29 3/4"

Weight: 101 lbs

Color	Model #	UPC Code
Fingerprint Resistant Stainless Steel	DW80R9950US	887276296647
Fingerprint Resistant Black Stainless Steel	DW80R9950UG	887276296623
Fingerprint Resistant Tuscan Stainless Steel	DW80R9950UT	887276320137