



CONSTRUCTION SUMMARY

Lot: 88
Model: 40.06 A LILAC
Project/Phase: Pine Valley Forevergreen / 1

CENTRAL VAC AND WIRING

Invoice	Qty.	Description
1974 72,189 04Nov19	1	CONDUIT PIPE TO BE RUN IN A STRAIGHT LINE FROM ATTIC TO ELECTRICAL PANEL AS CLOSE TO CENTER OF ATTIC AS POSSIBLE

CERAMIC

Invoice	Qty.	Description
2178 37 08Jun22	1	FOYER: TILE, FLOOR , LEVEL 5 - 12X24" LAID IN STRAIGHT, STACKED PATTERN. SEE PLAN FOR TILE DIRECTION.
2178 19 08Jun22	1	FRONT FOYER: TILE GROUT UPGRADE, FLOOR
2178 37 08Jun22	1	MUD ROOM: TILE, FLOOR , LEVEL 5 - 12X24" LAID IN STRAIGHT, STACKED PATTERN. SEE PLAN FOR TILE DIRECTION
2178 19 08Jun22	1	MUD ROOM: TILE GROUT UPGRADE, FLOOR
2178 37 08Jun22	1	BASEMENT FOYER: TILE, FLOOR , LEVEL 3 - 12X24" LAID IN STRAIGHT, STACKED PATTERN. SEE PLAN FOR TILE DIRECTION
2178 19 08Jun22	1	BASEMENT FOYER: TILE GROUT UPGRADE, FLOOR
2178 37 08Jun22	1	POWDER ROOM: TILE, FLOOR , LEVEL 5 - 12X24" LAID IN STRAIGHT, STACKED PATTERN. SEE PLAN FOR TILE DIRECTION
2178 19 08Jun22	1	POWDER ROOM: TILE GROUT UPGRADE, FLOOR
2178 35 08Jun22	1	LAUNDRY FLOOR: TILE, FLOOR , LEVEL 5 - 12X24" LAID IN STRAIGHT, STACKED PATTERN. SEE PLAN FOR TILE DIRECTION
2178 37 08Jun22	1	MASTER ENSUITE: TILE, FLOOR , LEVEL 5 - 12X24" LAID IN STRAIGHT, STACKED PATTERN. SEE PLAN FOR TILE DIRECTION
2178 51 08Jun22	1	MASTER ENSUITE: TILE, WALL, LEVEL 5 - 12X24" LAID IN HORIZONTAL, STACKED PATTERN.



CONSTRUCTION SUMMARY

Lot: 88
Model: 40.06 A LILAC
Project/Phase: Pine Valley Forevergreen / 1

CERAMIC

Invoice	Qty.	Description
2178 44 08Jun22	1	SHARED ENSUITE 3/4: TILE, SHOWER FLOOR, LEVEL 3 - PENNY ROUND
2178 34 08Jun22	1	ENSUITE 2: TILE, FLOOR , LEVEL 3 - 12X24" LAID IN STRAIGHT, STACKED PATTERN. SEE PLAN FOR TILE DIRECTION
2178 46 08Jun22	1	SHARED ENSUITE 3/4: TILE, WALL, LEVEL 2 - 2X16" CDC LAID IN VERTICAL STACKED PATTERN
2178 21 08Jun22	1	ENSUITE 2: TILE GROUT UPGRADE, WALL, UPG GROUT
2178 19 08Jun22	1	ENSUITE 2: TILE GROUT UPGRADE, FLOOR , UPG GROUT
2178 20 08Jun22	1	SHARED ENSUITE 3/4: TILE GROUT UPGRADE, SHOWER FLOOR, UPG GROUT
2178 35 08Jun22	1	ENSUITE 2: TILE, WALL, LEVEL 1 - 3X6" LAID IN HORIZONTAL, STACKED PATTERN.
2178 46 08Jun22	1	SHARED ENSUITE 3/4: TILE, FLOOR LEVEL 3 - 12X24" LAID STRAIGHT, STACKED, SEE PLAN FOR DIRECTION
2178 19 08Jun22	1	SHARED ENSUITE 3/4: TILE GROUT UPGRADE, FLOOR , UPG GROUT
2178 20 08Jun22	1	SHARED ENSUITE 3/4: TILE GROUT UPGRADE, SHOWER FLOOR, UPG GROUT
2178 21 08Jun22	1	SHARED ENSUITE 3/4: TILE GROUT UPGRADE, WALL, UPG GROUT
2178 08Jun22 NoCat	1	KITCHEN/BREAKFAST: VINTAGE SERIES, 5" WHITE OAK, NSS ENGINEERED HARDWOOD, 3/4" THK, WIREBRUSH TEXTURE, UV OIL FINISH - CORNER - LEVEL 3 CREDIT - DO NOT SUPPLY / INSTALL CERAMIC IN KITCHEN/BREAKFAST



CONSTRUCTION SUMMARY

Lot: 88
Model: 40.06 A LILAC
Project/Phase: Pine Valley Forevergreen / 1

CROWN MOULDING

Invoice	Qty.	Description
1974 72,182 04Nov19	1	GREAT ROOM: UPGRADE TO COFERRED CEILING - GREAT ROOM
1974 04Nov19 NoCat	1	GREAT ROOM: UPGRADE TO 9 BOX WAFFLE CEILING CTR-B07
1974 72,181 04Nov19	1	LIBRARY: UPGRADE TO COFERRED CEILING
1974 04Nov19 NoCat	1	LIBRARY: UPGRADE TO WAFFLE CEILING - 4 SQUARES
2178 08Jun22 NoCat	1	GREAT ROOM: UPGRADE MANTLE TO 'CAPRI'

DRYWALL

Invoice	Qty.	Description
1974 72,149 04Nov19	1	UPGRADE TO SMOOTH CEILINGS - THROUGHOUT SECOND FLOOR



CONSTRUCTION SUMMARY

Lot: 88
Model: 40.06 A LILAC
Project/Phase: Pine Valley Forevergreen / 1

ELECTRICAL

Invoice	Qty.	Description
1974 72,158 04Nov19	8	GREAT ROOM: ADD INTERIOR POT LIGHT - GROUND FLOOR
1974 72,151 04Nov19	1	GREAT ROOM: ADD A SEPARATE SWITCH - FOR LIGHTING PURPOSES FOR POTLIGHTS
1974 72,158 04Nov19	4	LIBRARY: ADD INTERIOR POT LIGHT - GROUND FLOOR
1974 72,151 04Nov19	1	LIBRARY: ADD A SEPARATE SWITCH - FOR LIGHTING PURPOSES FOR POTLIGHTS
1974 72,161 04Nov19	1	KITCHEN: RELOCATE ONLY - STANDARD CEILING LIGHT - RELOCATE TO ABOVE ISLAND, SEE PLAN FOR LOCATION
1974 04Nov19 NoCat	1	KITCHEN: ADD CAPPED CEILING ROUGH-IN FOR FUTURE INTERIOR LIGHT, FIXTURE NOT INCLUDED. LOCATE ABOVE ISLAND, USE SAME SWITCH AS STANDARD CEILING LIGHT
1974 72,157 04Nov19	1	KITCHEN: ADD FULL ELECTRICAL VALANCE LIGHTING UNDER UPPER CABINETS IN KITCHEN ON A SEPARATE SWITCH - REQUIRES PURCHASE OF VALANCE CABINETRY
1974 72,184 04Nov19	1	KITCHEN: ADD A 240V RECEPTICE ON A SEPARATE SWITCH - FOR FUTURE 'COMBO' WALL OVEN/MICROWAVE - WALL OVEN NOT INCLUDED - DOES NOT INCLUDE BREAKER THAT IS TO BE INSTALLED BY LICENSED ELECTRICIAN AND ARRANGED BY HOMEOWNER AFTER CLOSING SEE PLAN FOR LOCATION
1974 72,158 04Nov19	7	KITCHEN: ADD INTERIOR POT LIGHT - GROUND FLOOR
1974 72,151 04Nov19	1	KITCHEN: ADD A SEPARATE SWITCH - FOR LIGHTING PURPOSES FOR POTLIGHTS
1974 72,159 04Nov19	4	DRESSING ROOM: ADD INTERIOR POT LIGHT - SECOND FLOOR
1974 72,151 04Nov19	1	DRESSING ROOM: ADD A SEPARATE SWITCH - FOR LIGHTING PURPOSES FOR POTLIGHTS
1974 72,153 04Nov19	1	MASTER ENSUITE: ADD CAPPED CEILING ROUGH-IN (ON SEPARATE SWITCH) FOR FUTURE INTERIOR LIGHT FIXTURE - FIXTURE NOT INCLUDED LOCATE ABOVE TUB



CONSTRUCTION SUMMARY

Lot: 88
Model: 40.06 A LILAC
Project/Phase: Pine Valley Forevergreen / 1

ELECTRICAL

Invoice	Qty.	Description
1974 72,159 04Nov19	4	MASTER BEDROOM: ADD INTERIOR POT LIGHT - SECOND FLOOR
1974 72,151 04Nov19	1	MASTER BEDROOM: ADD A SEPARATE SWITCH - FOR LIGHTING PURPOSES FOR POTLIGHTS
1974 72,156 04Nov19	1	FRONT ELEVATION & GARAGE ELEVATION: ADD EXTERIOR POT LIGHTS 4 AT FRONT ELEVATION 4 AT GARAGE SIDE ELEVATION
1974 72,151 04Nov19	1	FOYER: ADD A SEPARATE SWITCH - FOR LIGHTING PURPOSES FOR EXTERIOR SOFFIT LIGHTS
1974 04Nov19 NoCat	1	FRONT ELEVATION: IN ADDITION TO STANDARD HOLIDAY LIGHT, ADD ANOTHER FOR A TOTAL OF 2: **1 AT GARAGE SOFFIT + 1 AT PORCH SOFFIT** both on same switch, switch located in foyer closet
2178 08Jun22 NoCat	2	DECORA TIMER SWITCH FOR EXTERIOR SOFFIT LIGHTS
2178 08Jun22 NoCat	1	Info only - KITCHEN: FULL HEIGHT SLAB BACKSPLASH - LEVEL 6 QUARTZ
2178 08Jun22 NoCat	1	Information only - GREAT ROOM: UPGRADE MANTLE TO 'CAPRI'

EXTERIOR COLOURS

Invoice	Qty.	Description
1955 27,676 09Jan19	1	EXTERIOR COLOUR PACKAGE BR.1

FIREPLACE

Invoice	Qty.	Description
2178 08Jun22 NoCat	1	GREAT ROOM: UPGRADE MANTLE TO 'CAPRI'

FORMING

Invoice	Qty.	Description
1955 72,168 09Jan19 **	1	ADD OPTIONAL TRAY CEILING IN MASTER BEDROOM



CONSTRUCTION SUMMARY

Lot: 88
Model: 40.06 A LILAC
Project/Phase: Pine Valley Forevergreen / 1

FRAMING

Invoice	Qty.	Description
1974 04Nov19 NoCat	1	GREAT ROOM / KITCHEN: REDUCE WIDTH OF ARCH, LEAVE APPROX. 30" NIB WALLS AT EACH SIDE OF ARCH. SEE PLAN FOR LOCATION
1974 04Nov19 NoCat	18	2ND FLOOR: UPGRADE TO 96" DOORS THRU OUT 2ND FLOOR
1974 04Nov19 NoCat	1	2ND FLOOR: UPGRADE TO 96" ARCHWAY
1974 04Nov19 NoCat	1	**NOTE** COFFERED CEILING IN GREAT ROOM & LIBRARY

GLASS AND MIRROR

Invoice	Qty.	Description
1974 72,169 04Nov19	1	MASTER ENSUITE: UPGRADE FROM FRAMED GLASS SHOWER TO FRAMELESS
1974 72,169 04Nov19	1	ENSUITE 2: UPGRADE FROM FRAMED GLASS SHOWER TO FRAMELESS
1974 72,169 04Nov19	1	SEMI ENSUITE: 3/4: UPGRADE FROM FRAMED GLASS SHOWER TO FRAMELESS
2178 08Jun22 NoCat	2	MASTER ENSUITE + SHARED ENSUITE: UPGRADE SHOWER DOOR HANDLE AND HINGE - MATTE BLACK



CONSTRUCTION SUMMARY

Lot: 88
Model: 40.06 A LILAC
Project/Phase: Pine Valley Forevergreen / 1

GRANITE MARBLE QUARTZ

Invoice	Qty.	Description
2178 08Jun22 NoCat	1	POWDER ROOM: UPGRADE COUNTER LEVEL 5 QUARTZ
2178 08Jun22 NoCat	1	KITCHEN: UPGRADE 6 QUARTZ COUNTER
2178 08Jun22 NoCat	1	KITCHEN: FULL HEIGHT SLAB BACKSPLASH - LEVEL 6 QUARTZ
2178 08Jun22 NoCat	1	LAUNDRY ROOM: ADD QUARTZ COUNTER LEVEL 1 + OVER MACHINES
2178 08Jun22 NoCat	1	MASTER ENSUITE: UPGRADE 3 QUARTZ COUNTER
2178 08Jun22 NoCat	1	ENSUITE 2: UPGRADE COUNTER TOP LEVEL 1
2178 08Jun22 NoCat	1	SHARED ENSUITE: UPGRADE COUNTER TOP - LEVEL 4
2178 08Jun22 NoCat	1	KITCHEN: COOKTOP CUT OUT

HARDWOOD

Invoice	Qty.	Description
2178 3 08Jun22	1	THRU OUT STANDARD AREAS - MAIN HALL/ GREAT ROOM/ LIBRARY/ DINING ROOM/ UPPER HALL/ MASTER BEDROOM/ BEDROOM 2/ BEDROOM 3/ BEDROOM 4: VINTAGE SERIES, 5" WHITE OAK, NSS ENGINEERED HARDWOOD, 3/4" THK, WIREBRUSH TEXTURE, UV OIL FINISH - CORNER - LEVEL 3
2178 5 08Jun22	1	KITCHEN/BREAKFAST: VINTAGE SERIES, 5" WHITE OAK, NSS ENGINEERED HARDWOOD, 3/4" THK, WIREBRUSH TEXTURE, UV OIL FINISH - CORNER - LEVEL 3



CONSTRUCTION SUMMARY

Lot: 88
Model: 40.06 A LILAC
Project/Phase: Pine Valley Forevergreen / 1

HVAC

Invoice	Qty.	Description
1974 72,186 04Nov19	1	KITCHEN: ADD GASLINE FOR FUTURE COOKTOP - COOKTOP NOT INCLUDED - NEW 110V RECEPTICLE REQUIRED & INCLUDED WITH THIS PURCHASE
1974 04Nov19 NoCat	1	AIR CONDITIONER - LENNOX 13 SEER MODEL #13ACX060 - 5.0 TON
1974 04Nov19 NoCat	1	HUMIDIFIER: LENNOX #WB3-17

INTERIOR TRIM AND DOORS

Invoice	Qty.	Description
2178 08Jun22 NoCat	1	THRU OUT: UPGRADE INTERIOR DOOR HARDWARE TO HALIFAX MATTE BLACK + SQUARE HINGES

KITCHEN AND BATH CABINETRY

Invoice	Qty.	Description
2178 08Jun22 NoCat	1	THRU OUT: SEE ATTACHED CABINETRY SCHEDULE

PAINT

Invoice	Qty.	Description
2178 08Jun22 NoCat	2	MAIN STAIRS: STAIN STAIRS AND LANDINGS STAIRS AND LANDINGS WILL NOT MATCH HARDWOOD FLOORS IN COLOUR/TEXTURE/SPECIES
2178 08Jun22 NoCat	1	FYI - MAIN STAIRS: ADD FOR GLASS PANEL IN LIEU OF PICKETS - UPG - GLASS PANEL Information only - MAIN STAIRS: ADD FOR GLASS PANEL IN LIEU OF PICKETS - UPG - GLASS PANEL



CONSTRUCTION SUMMARY

Lot: 88
Model: 40.06 A LILAC
Project/Phase: Pine Valley Forevergreen / 1

PLUMBING

Invoice	Qty.	Description
1974 72,174 04Nov19	1	KITCHEN: ADD WATERLINE FOR FRIDGE
2178 08Jun22 NoCat	1	POWDER ROOM: UPGRADE SINK + FAUCET + TOILET
2178 08Jun22 NoCat	1	KITCHEN: UPGRADE SINK AND FAUCET
2178 08Jun22 NoCat	1	LAUNDRY ROOM: UPGRADE SINK AND FAUCET
2178 08Jun22 NoCat	1	MASTER ENSUITE: MOEN 'RIZON' - UPGRADE TO MATTE BLACK FINISH + 7" RAIN SHOWER HEAD + TUB FILLER + 8" LAV FAUCETx2
2178 08Jun22 NoCat	1	SHARED ENSUITE 3/4: UPGRADE SHOWER TRIM + LAV (x2) TO MOEN 'RIZON' MATTE BLACK
2178 08Jun22 NoCat	1	ENSUITE 2: UPGRADE SHOWER TRIM + LAV TO MOEN 'RIZON' MATTE BLACK

STAIR AND RAILINGS

Invoice	Qty.	Description
2178 100,227 08Jun22	1	MAIN STAIRS: ADD FOR GLASS PANEL IN LIEU OF PICKETS - UPG - GLASS PANEL

WINDOWS - BASEMENT

Invoice	Qty.	Description
1955 72,177 09Jan19	2	UPGRADE EXISTING WINDOW TO 30X24 INCHES Upgrade both the existing standard windows from 30x16 to 30x24, may require window wells.

Scheduled Closing Date:

Purchaser: PRE-OPENING INVENTORY HOME PH1 LOT 8 Property: 88 of Plan -

Telephone Res. / Bus: (905) 760-9595

Project: Pine Valley Forevergreen - Phase 1

Decor Advisor: Yolande Somerville

Model and Elevation: 40.06 A LILAC

Layout Changes: ☐ Yes ☒ No Sketch Attached: ☒ Yes ☐ No Exterior Colour Scheme:

1. Cabinetry

	Style and Colour	Counter	Hardware
Kitchen / Breakfast	*2-tone	*Calacatta Gold	attached
Laundry Room	Bowery Avenza	*Jet Black	attached
Powder Room	*Manhattan Glazed Clay	*Eternal Noire	attached
Master Ensuite Bathroom	*Manhattan Glazed Clay	*Calacatta Gold	attached
Second Ensuite Bathroom (If Applicable)	Tribeca Ariss	*Jet Black	attached
Shared Ensuite	*Manhattan Pitch Black	*Granite: Titanium	attached

Comment

Kitchen perimeter: *Base: Manhattan oak Cashew // Upper + Tall + Island: *Kensington Pitch Black

white oak natural

2. Floor Tile

	Selection
Entrance Vestibule	*12x24" Marmorea 'Port Laurent' matte + charcoal grout
Main Hall	
Kitchen / Breakfast	hardwood
Laundry Room	*12x24" Marmorea 'Port Laurent' matte + charcoal grout
Powder Room	*12x24" Marmorea 'Port Laurent' matte + charcoal grout
Mud Room	*12x24" Marmorea 'Port Laurent' matte + charcoal grout
Master Ensuite Bathroom	*12x24" Marmorea 'Port Laurent' matte + charcoal grout
Second Ensuite Bathroom (If Applicable)	*12x24" Regal matte 'Shell White' + Bone grout
Lower Landing (If Applicable)	*12x24" Regal matte 'Shell White' + Bone grout
Shared Ensuite	*12x24" Chambray 'Taupe' + Bone grout

Comment

Shower Floor Tile: Master Ensuite - Penny Round black + charcoal grout // Shared Ensuite: Penny Round Taupe + Bone Grout

2nd Ensuite: 2x2 Quebec Arctic white + Bone Grout.

matte

Revised: Sept. 14, 2022

3. Wall Tile

	Selection	Listello/Inserts	Describe
		<input type="radio"/> Yes <input checked="" type="radio"/> No	
Master Ensuite Bathroom			
Tub Deck		<input type="radio"/> Yes <input checked="" type="radio"/> No	
Shower Stall	*12x24" Marm B. Calcta pol + bone gr	<input type="radio"/> Yes <input checked="" type="radio"/> No	
Bathroom Walls		<input type="radio"/> Yes <input checked="" type="radio"/> No	
Second Ensuite Bathroom (If Applicable)	*3x6" CDC matte blk + charcoal gr	<input type="radio"/> Yes <input checked="" type="radio"/> No	
Shared Ensuite	*2x16" CDC matte Taupe + bone gr	<input type="radio"/> Yes <input checked="" type="radio"/> No	
Kitchen Backsplash	<input checked="" type="radio"/> Yes <input type="radio"/> No	Backsplash Behind Fridge	
Comment	*FHBS same as perimeter counter		

see attached

Revised: Sept. 14, 2022

Scheduled Closing Date:

Purchaser: PRE-OPENING INVENTORY HOME PH1 LOT 8 Property: 88 of Plan -

Telephone Res. / Bus: (905) 760-9595

Project: Pine Valley Forevergreen - Phase 1

Decor Advisor: Yolande Somerville

Model and Elevation: 40.06 A LILAC

4. Plumbing Fixtures

Master Ensuite Bathroom Second Ensuite Powder Room
Other Room - Specify Other Washroom

Comment

see extras

5. Hardwood Flooring

	Type and Stain		Type and Stain
Main Hall	<input type="text"/>	Upper Landing	<input type="text"/>
Kitchen / Breakfast	*3/4x5" wht oak wirebrush 'Orion'	Upper Hall	<input type="text"/>
Living Room	<input type="text"/>	Master Bedroom	<input type="text"/>
Dining Room	<input type="text"/>	Bedroom #2	<input type="text"/>
Family Room	<input type="text"/>	Bedroom #3	<input type="text"/>
Den/Library	<input type="text"/>	Bedroom #4	<input type="text"/>
Entrance Vestibule	<input type="text"/>	Bedroom #5	<input type="text"/>
Lower Landing (If Applicable)	<input type="text"/>	Other Room - Specify	<input type="text"/>
		Thru out standard areas	*3/4x5" wht oak wirebrush 'Orion'

Comment

6. Carpeting

	Upgrade	Description
Ground Floor	<input type="checkbox"/>	<input type="text"/>
Second Floor	<input type="checkbox"/>	<input type="text"/>
<input type="text"/>	<input type="checkbox"/>	<input type="text"/>

	Type	Area
Upgrade Underpad	<input type="text"/>	<input type="text"/>
	Capped	Runner - *Upgrade
Carpet on Stairs	<input type="text"/>	<input type="text"/>

Comment

7. Fireplace

	Living Room			Family Room			Other Room - Specify		
	Purchased	As Per Plan	N/A	Purchased	As Per Plan	N/A	Purchased	As Per Plan	N/A
Fireplace Type	<input type="radio"/>	<input type="radio"/>	<input checked="" type="radio"/>	<input type="radio"/>	<input checked="" type="radio"/>	<input type="radio"/>	<input type="radio"/>	<input type="radio"/>	<input checked="" type="radio"/>
Mantle Type	<input type="text"/>			standard gas			<input type="text"/>		
Colour / Stain	<input type="text"/>			*capri			<input type="text"/>		
Surround	<input type="text"/>			arctic white			<input type="text"/>		
Hearth	<input type="text"/>			n/a			<input type="text"/>		
	<input type="text"/>			none			<input type="text"/>		

Comment

see station revised: sept. 14, 2000

Scheduled Closing Date:

Purchaser:	PRE-OPENING INVENTORY HOME PH1 LOT 8	Property:	88 of Plan -
Telephone Res. / Bus:	(905) 760-9595	Project:	Pine Valley Forevergreen - Phase 1
Decor Advisor:	Yolande Somerville	Model and Elevation:	40.06 A LILAC

8. Trim Carpentry

Interior Doors	Carrara	Front Door Glass Inserts	std	Door Handles	*Halifax blk + hng
Interior Trim	Standard Trim Package				
Comment					

9. Plaster Mouldings and Medallions

Standard Throughout ☐ Yes ☐ No ☒ N/A

Entrance Vestibule			Kitchen/Breakfast		
Main Hall			Den/Library	*CTR-B07	
Living Room			Lower Landing		
Dining Room			Other Room - Specify		
Family Room	*CTR-B07				
Comment					

10. Railings and Spindles

Railing Package	*Glass Railing				
Railing Colour	*Pharoah	Spindle Colour	*Glass		
Stringer / Riser	*Pharoah	Treads	*Pharoah		
Comment		Oak Stairs	<input checked="" type="radio"/> Yes <input type="radio"/> No <input type="radio"/> N/A		

11. Wall Paint / Ceilings

Throughout Finished Areas	Cool White
Trim Paint	White
Smooth Ceilings	
Ground Floor	<input checked="" type="checkbox"/>
Second Floor	<input checked="" type="checkbox"/>
Note	
Comment	

see attached raised: Sept. 14, 2022

Scheduled Closing Date:

Purchaser: PRE-OPENING INVENTORY HOME PH1 LOT 8 Property: 88 of Plan -

Telephone Res. / Bus: (905) 760-9595

Project: Pine Valley Forevergreen - Phase 1

Decor Advisor: Yolande Somerville

Model and Elevation: 40.06 A LILAC

12. Electrical

Hood Fan ☐ White ☐ Stainless ☐ N/A

Above Kitchen Cabinet Light ☐ Yes ☒ No

Below Kitchen Cabinet Light ☒ Yes ☐ No

Standard Appliances ☐

Over The Range Microwave ☐

Chimney Style Fan ☐

Comment

13. Heating and Air Conditioning

Air Conditioning

Gas Provisions Stove

Gas Provisions Dryer

Gas Provisions Barbecue

Comment

14. Additional Comments

15. Disclaimers and Notes

- 1) Colours of all materials are as close as possible to builder's selection, but not necessarily identical due to variances in manufacturing.
- 2) Any extras listed above are null and void unless accompanied by a separate invoice/amendment. Said invoice must be paid in full.
- 3) The Purchaser acknowledges that after Interior Colour Selection form is signed and dated, no further changes will be permitted other than re-selection due to unavailability. _____ Purchaser's Initials
- 4) The Purchaser acknowledges reading and accepting the "Gold Park Homes Decor Centre Disclaimers" form. This document contains other miscellaneous disclaimers.

This Interior Colour Selection is final and approved by:

see attached. Revised: Sept. 14, 2022

Signature: _____ Date: _____

PURCHASER'S EXTRAS QUOTATION
Pine Valley Forevergreen - Phase 1

PURCHASER: PRE-OPENING INVENTORY HOME PHI LOT 88

TEL: RES.: 905-760-9595

LOT NUMBER	PHASE	HOUSE TYPE
88	1	40.06 A LILAC

ITEM	EXTRA / CHANGE	QTY	UNIT PRICE	EXTENDED
1 51530	ENSUITE 2: UPGRADE 2 SHOWER FLOOR TILE + UPGRADED GROUT	1	\$720.00	\$720.00

\$720.00 Sub Total
\$93.60 HST
\$813.60 Total

This is your direction to install the above extras in accordance with the following terms and conditions:

- In the event the work on the house has progressed beyond the point where the items covered by this extra cannot be installed without entailing any unusual expense, then this order is to be cancelled and any deposit paid in connection with the same is to be refunded to the purchaser.
- The Vendor will undertake to incorporate the work covered by the sales extra in the construction of the house but will not be liable to the purchaser in any way, if for any reason the work covered by the extra is not carried out. In that event, any monies paid in connection with the same shall be returned to the purchaser.
- It is understood and agreed that if for any reason whatsoever the transaction of Purchase and Sale is not completed, the total cost of extras ordered are not refundable to the Purchaser(s).
- Extras or changes will not be processed unless signed by the Vendor.
- These extras may not be amended without the written consent of GOLDPARK (PINE VALLEY) INC.
- The purchaser(s) and the builder acknowledge and agree that this "Purchaser's Extra" form shall not be deemed to be part of the agreement of purchase and sale entered into between them, nor an addendum thereto.
- Prices are estimates only and guaranteed for a period of 5 days only.
- No post dated cheques will be accepted.
- No Estimates or orders will be accepted once construction has commenced.
- All extras/selections are final with signature. All enquiries to re-open a file and/or request changes to any extras/selections is subject to a fee of \$500.00 (five hundred dollars).
- No estimates will be considered official orders until resubmitted on a signed Purchaser Extras Form, accompanied by payment in full.

Payment Summary

<u>Paid By</u>	<u>Amount</u>
Total Payment:	

Bonus Summary

Bonus Package offering (includes taxes) from Gold Park Homes Décor Centre is being applied to this order.
Any remaining balance(s) will be applied accordingly to extras purchased.

Bonus Package Offering

<u>Invoice Number</u>	<u>Date</u>	<u>Amount</u>
-----------------------	-------------	---------------

Total Bonus Used:

Remaining Balance:

Initials: 

CONSTRUCTION SCHEDULING APPROVAL	
PER:	_____
DATE:	_____

PURCHASER'S EXTRAS QUOTATION

Pine Valley Forevergreen - Phase 1

PURCHASER: PRE-OPENING INVENTORY HOME PH1 LOT 88

TEL: RES.: 905-760-9595

LOT NUMBER	PHASE	HOUSE TYPE
88	1	40.06 A LILAC

ITEM	EXTRA / CHANGE	QTY	UNIT PRICE	EXTENDED
------	----------------	-----	------------	----------

PURCHASER:

see attached

PRE-OPENING INVENTORY HOME
PH1 LOT 88

14-Sep-22

DATE

VENDOR:

PER: GOLDPARK (PINE VALLEY) INC.

CONSTRUCTION SCHEDULING APPROVAL

PER: _____

DATE: _____

Yolande Somerville

From: Mellina Plener <Mellina@mosconetile.com>
Sent: September 14, 2022 9:02 AM
To: Yolande Somerville
Cc: Michael Pilato; Ben Moscone
Subject: GOL101-0088

Importance: High

Hi Chanel,

Can you confirm the **Ensuite 2 Bathroom**. We believe it is a shower instead of a tub and if so we will require the **shower floor selection**. We do not have that information.

Thank you.

Prices, figures, illustrations, sizes, features and finishes are subject to change without notice. Areas and dimensions are approximate and actual usable floor space may vary from the stated area. Layout may be reverse of the unit purchased. E. & O.E. 4006

SCHEDULE 'F'



TV-88
MAY 25 2022

The Lilac

40' SERIES

Elevation A • 3,425 sq.ft.
Elevation B • 3,385 sq.ft.

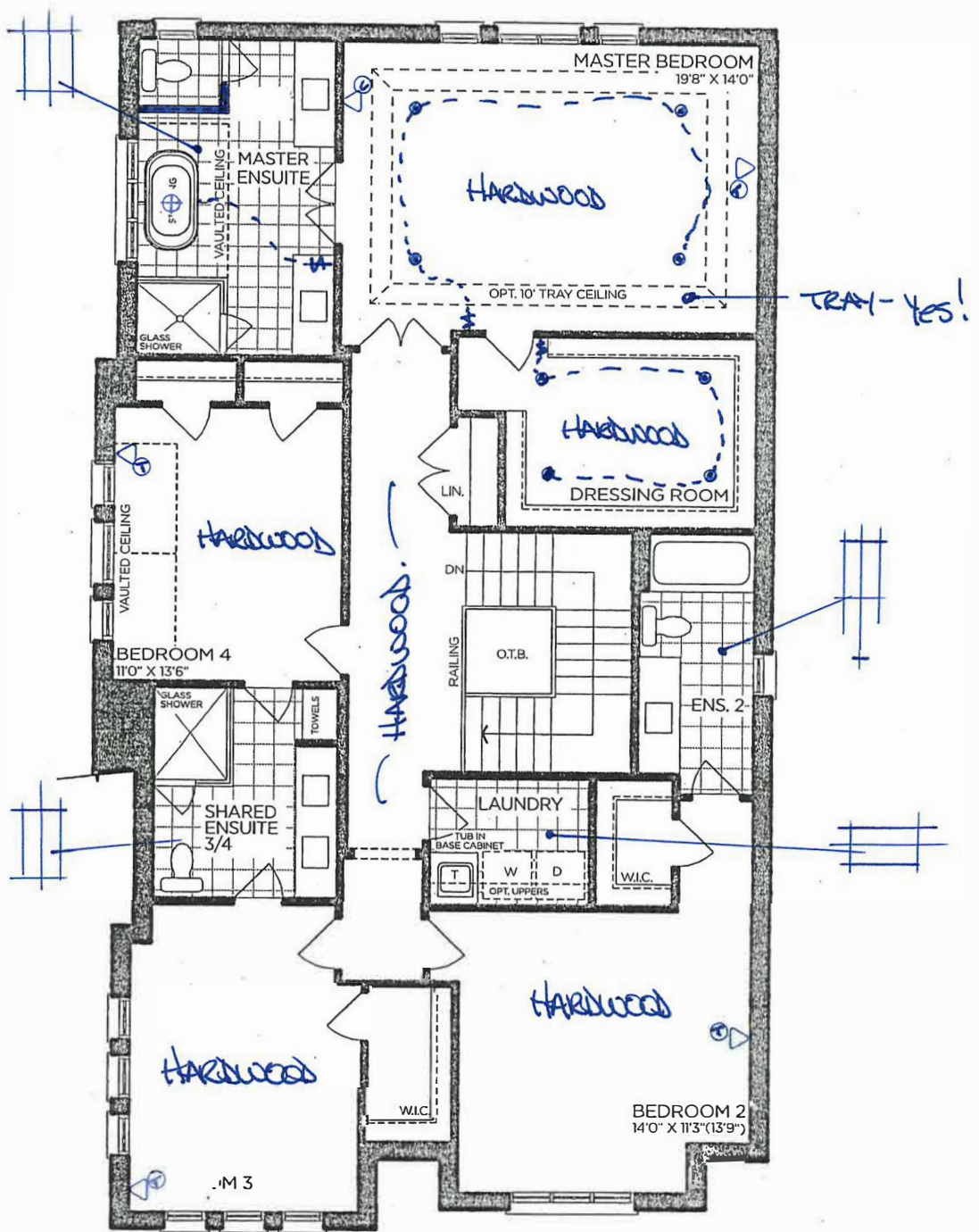

SECOND FLOOR | ELEV. A

VENDOR

PURCHASER

PURCHASER

GOLDPARK
WORTH MORE™

Prices, figures, illustrations, sizes, features and finishes are subject to change without notice. Areas and dimensions are approximate and actual usable floor space may vary from the stated area. Layout may be reverse of the unit purchased. E. & O.E. 4006

SCHEDULE 'F'

PV-88
MAY 25 2022



The Lilac

40' SERIES

→ Elevation A • 3,425 sq.ft.
Elevation B • 3,385 sq.ft.

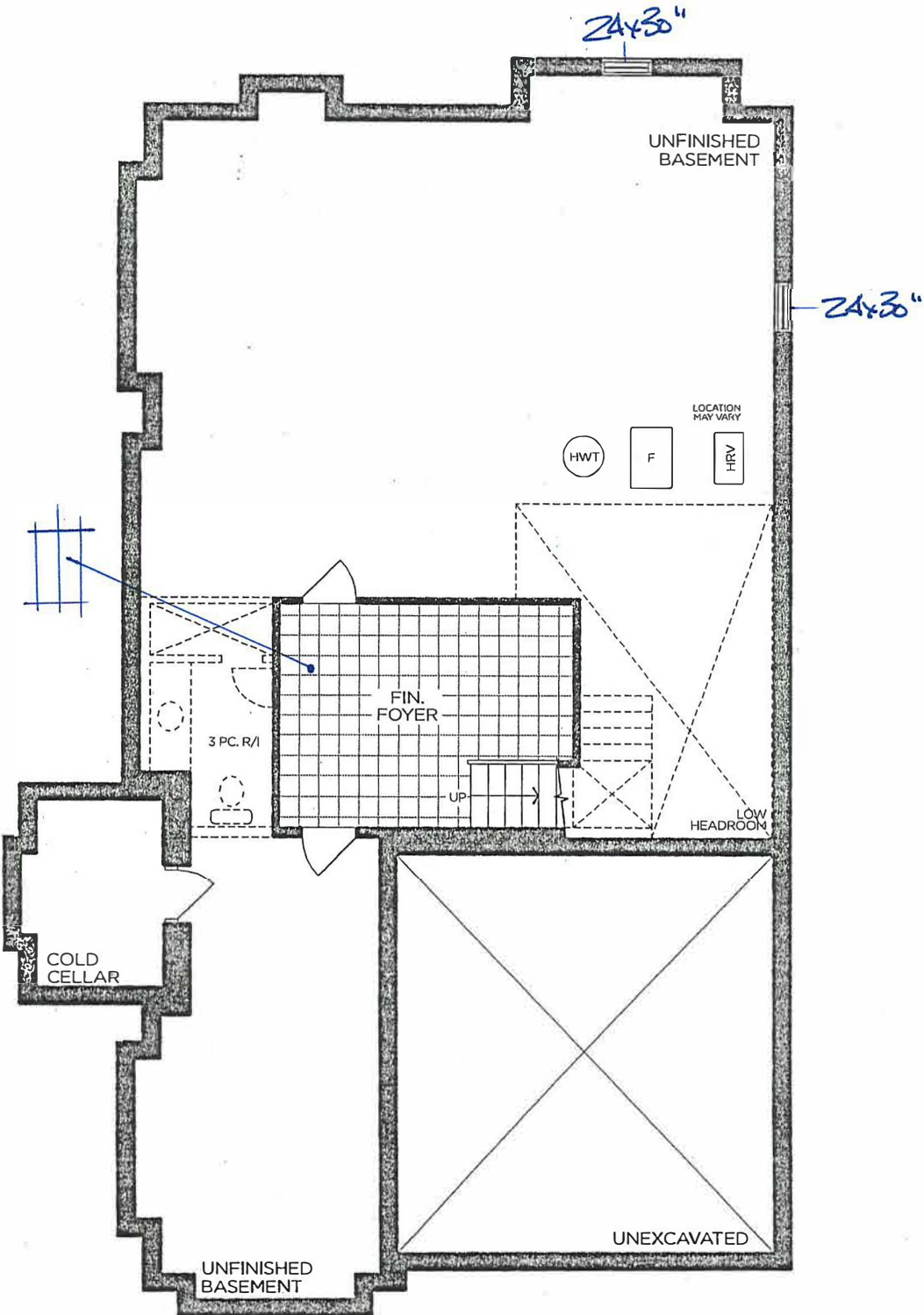

BASEMENT | ELEV. A

VENDOR	<div></div>
PURCHASER	<div></div>
PURCHASER	<div></div>

GOLDPARK
WORTH MORE™

Prices, figures, illustrations, sizes, features and finishes are subject to change without notice. Areas and dimensions are approximate and actual usable floor space may vary from the stated area. Layout may be reverse of the unit purchased. E. & O.E. 4006

PV-88
MAY 26 2022

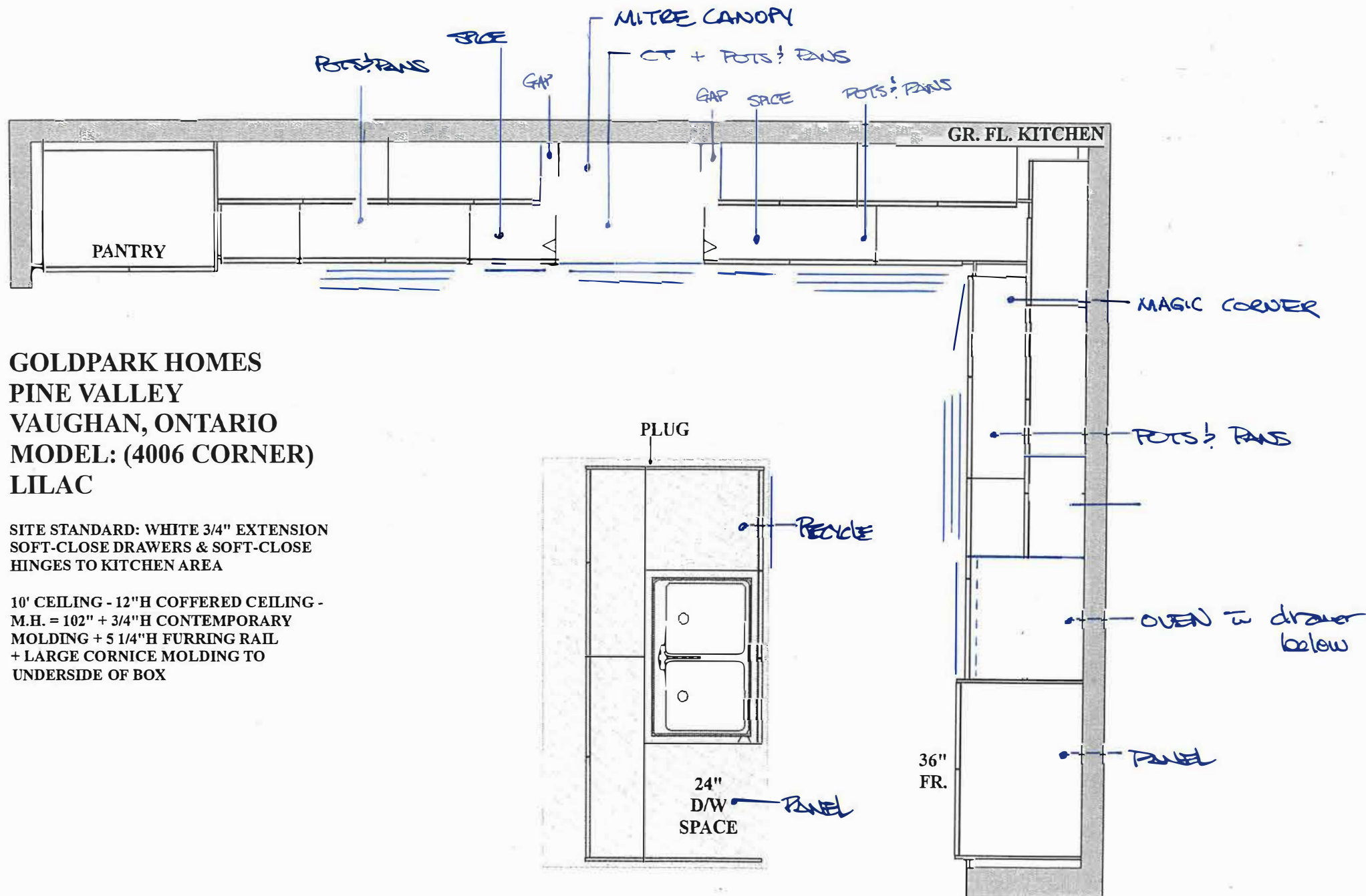

**GOLDPARK HOMES
PINE VALLEY
VAUGHAN, ONTARIO
MODEL: (4006 CORNER)
LILAC**

SITE STANDARD: WHITE 3/4" EXTENSION
SOFT-CLOSE DRAWERS & SOFT-CLOSE
HINGES TO KITCHEN AREA

10' CEILING - 12"H COFFERED CEILING -
M.H. = 102" + 3/4"H CONTEMPORARY
MOLDING + 5 1/4"H FURRING RAIL
+ LARGE CORNICE MOLDING TO
UNDERSIDE OF BOX



PLAN VIEW

PV-88
MAY 26 2022

**GOLDPARK HOMES
PINE VALLEY
VAUGHAN, ONTARIO
MODEL: (4006 CORNER) LILAC**

SITE STANDARD: WHITE 3/4" EXTENSION
SOFT-CLOSE DRAWERS & STANDARD SLAM DOOR HINGES
TO VANITIES

ONE TOP DRAWER WHERE POSSIBLE THROUGHOUT EACH
VANITY, ONE BANK OF DRAWERS WHERE POSSIBLE
THROUGHOUT EACH MASTER ENSUITE VANITY

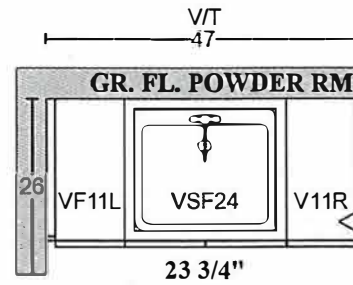

BLACK METAL LEGS

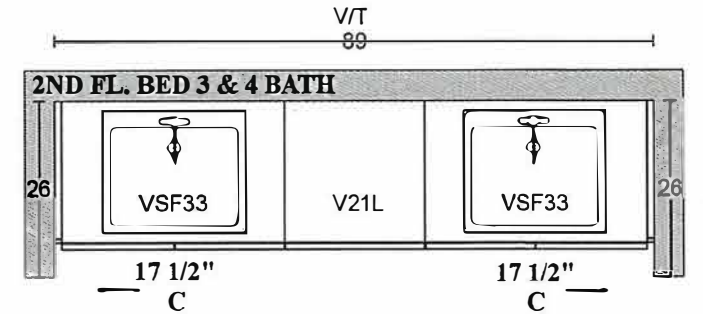
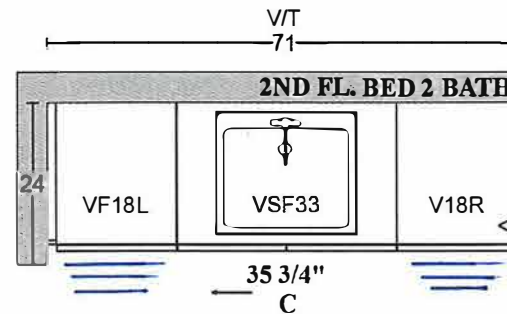
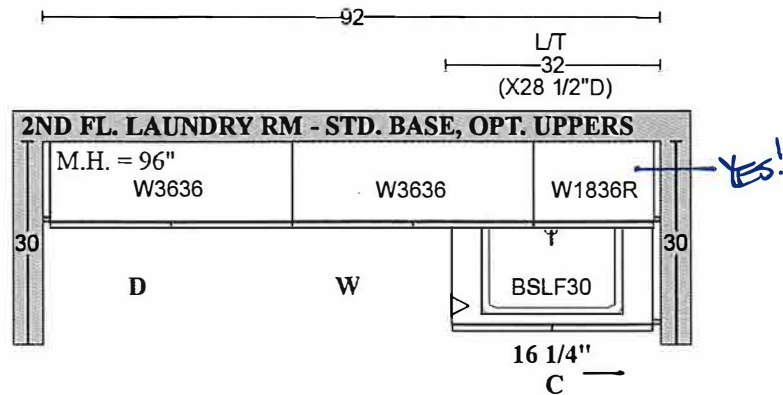
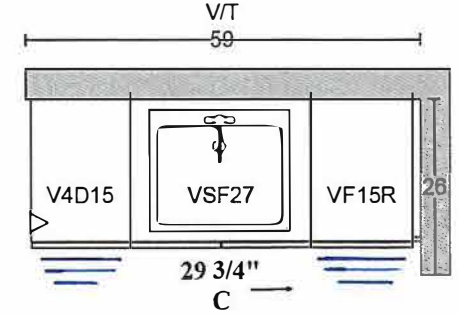
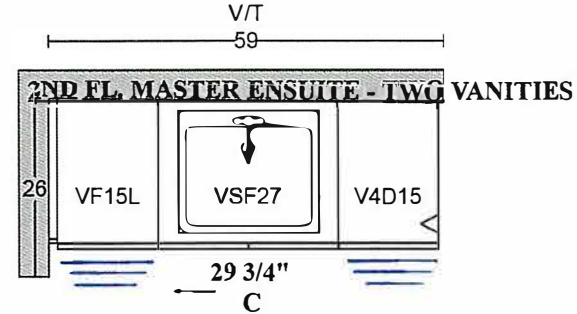

PLAN VIEW

#: AKOWALTCHUK-0032-20 (V1.02)

Page# 18/22

UPGRADE HARDWARE



BAH-083-03

Appliance Pull

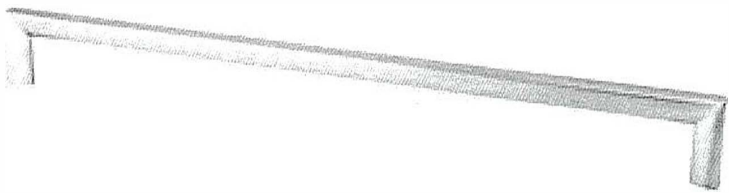

- ☐ BRUSHED NICKEL
- ☒ MATTE BLACK
- ☐ MODERN BRONZE

LOCATION:

KITCHEN FRIDGE/FREEZER

LOT # 88	DATE: MAY 27 2022
-------------	----------------------

SIGNATURE:

SIGNATURE:



UPGRADE HARDWARE

BH-081-03

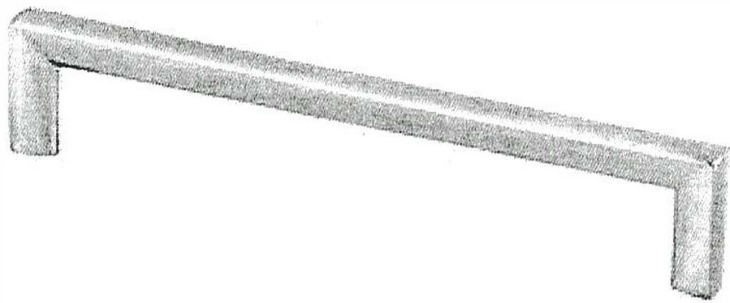

- ☐ BRUSHED NICKEL
☒ MATTE BLACK
☐ MODERN BRONZE

LOCATION:

KITCHEN
POWDER
MASTER
ENSUITE 2
SHARED ENSUITE

LOT # 88	DATE: MAY 27 2022
-------------	----------------------

SIGNATURE:

SIGNATURE:

CONTEMPORARY 9696

Aluminum Edge Pull - 'Brushed Black'
Length: 6"

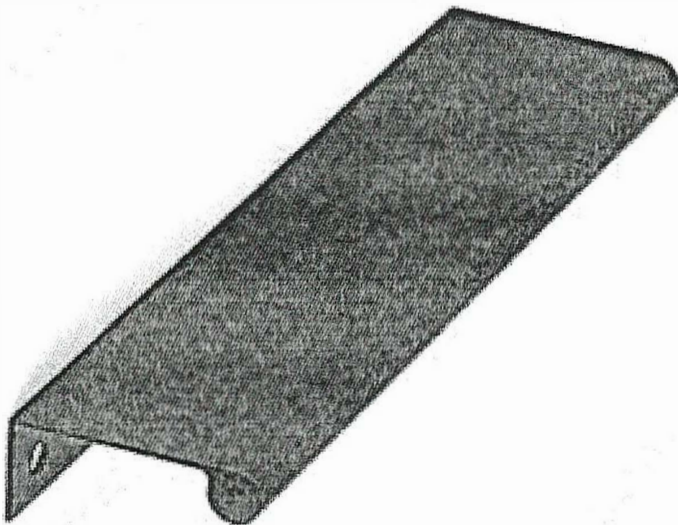

LOCATION:

LAUNDRY

LOT #

88

DATE:

MAY 26 2022

SIGNATURE:

SIGNATURE:



PINE VALLEY

FOREVERGREEN

Range Hood - Mitred Square

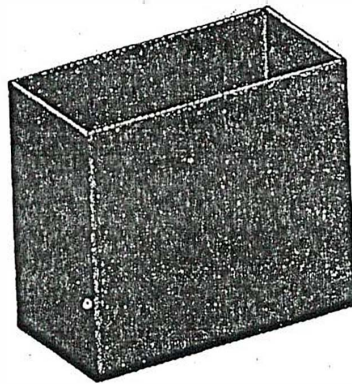

Lot#
88

Room:
KITCHEN

Signature:

Date:
MAY 27 2022

Signature:



PINE VALLEY

FOREVERGREEN

UPGRADE KITCHEN SINK

BLANCO - PRECIS U SUPER SINGLE

Silgranit - Undermount Sink
32" x 19" x 9-1/2"

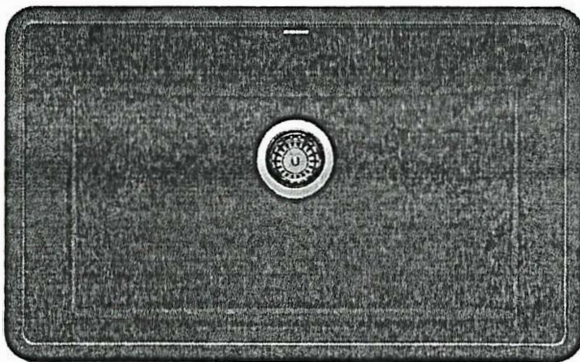

Anthracite

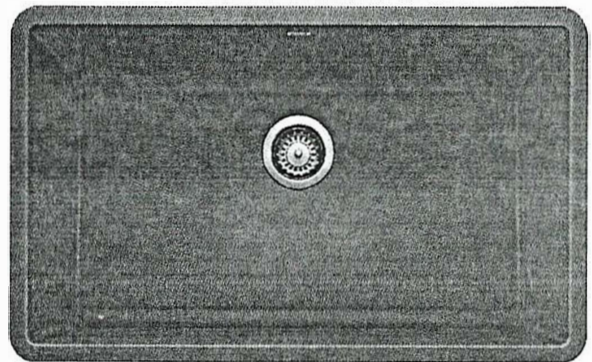

Concrete Grey

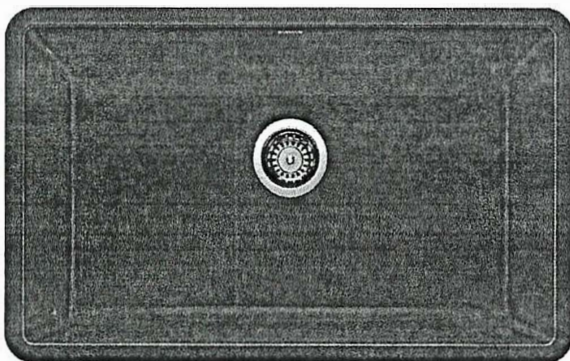

Metallic Grey

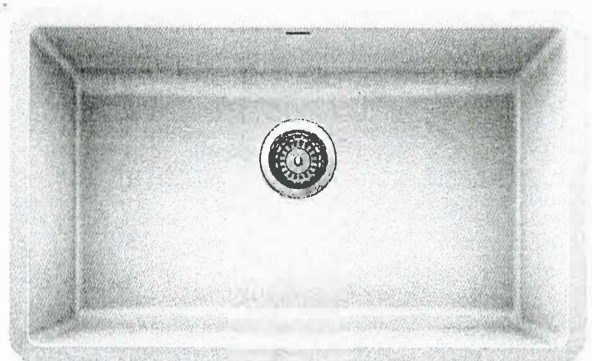

White

- ☐ ANTHRACITE
- ☐ CONCRETE GREY
- ☐ METALLIC GREY
- ☒ WHITE
- ☐ CINDER

MODEL 400890 Anthracite / 402266 Concrete Grey / 401683 Metallic Grey / 401820 White / 401397 Cinder

Lot# 88	Date: MAY 26 2022	Room: KITCHEN
Signature:		
Signature:		



PINE VALLEY
FOREVERGREEN

UPGRADE KITCHEN FAUCET

MOEN - NIO

One-Handle Pulldown Kitchen Faucet

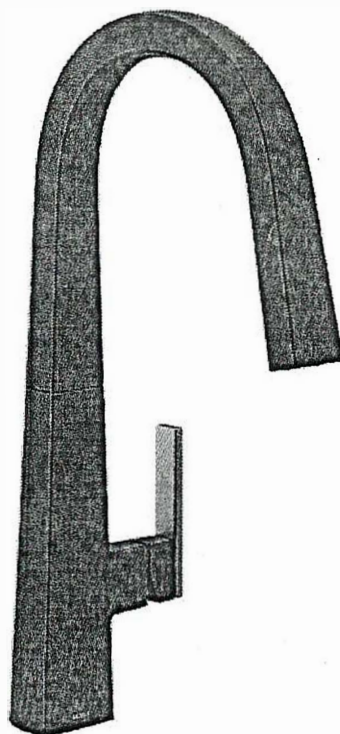

- ☐ CHROME
- ☒ MATTE BLACK / BRUSHED GOLD (BL)
- ☐ SPOT RESIST STAINLESS (SRS)

MODEL: S75005 Chrome / S75005BL Matte Black / S75005SRS Spot Resist Stainless

Lot# 88	Date: MAY 26 2022	Room: KITCHEN
Signature:		
Signature:		

VANITY SINK UPGRADES

21" Wetstyle Undermount Sink
OVAL

21" x 15" x 4"

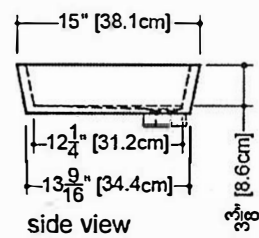
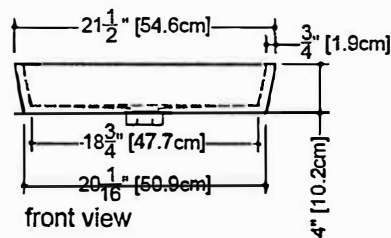
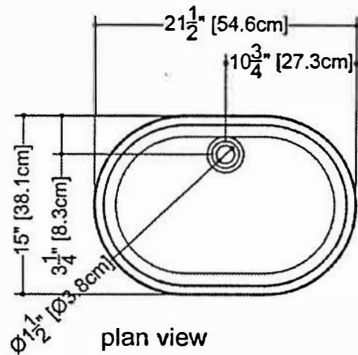
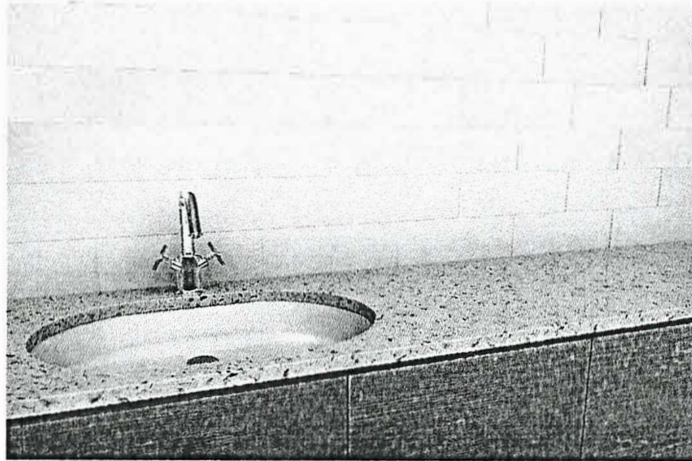

VOV 821U

MODEL: VOV 821U-MA

Lot# 98	Date: MAY 26 2022	Room: POWDER
Signature:		
Signature:		

FAUCET NOT INCLUDED



PLUMBING UPGRADES

MOEN - RIZON

Single-Handle Lav Faucet with Lift Rod Drain

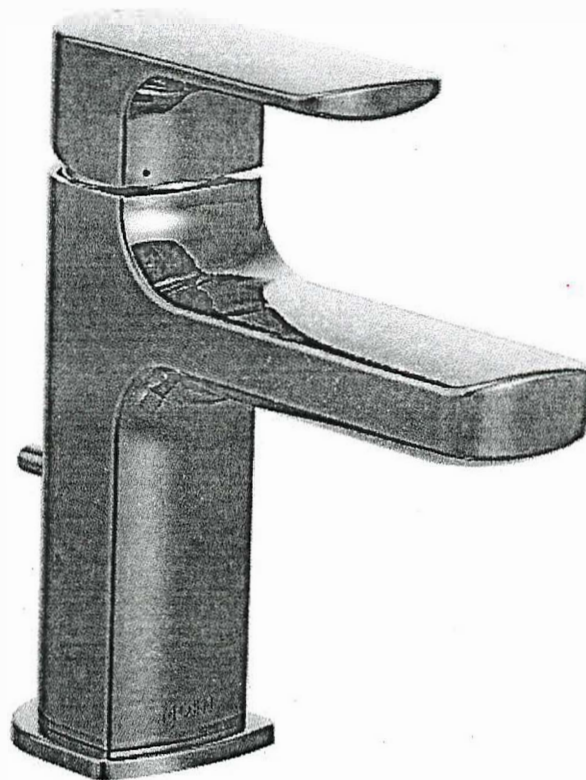

CHROME - STANDARD

☐ BRUSHED NICKEL (BN)

☒ MATTE BLACK (BL)

MODEL: 6900

Lot# 88	Date: MAY 26 2022.	Room: MASTER ENSUITE / ENS 2 / SHABEN ENS
------------	-----------------------	---

Signature:

Signature:



PINE VALLEY

FOREVERGREEN

PLUMBING UPGRADES

MOEN - RIZON

Eco-Performance Posi-Temp Tub/Shower Faucet



- ☐ CHROME
- ☐ BRUSHED NICKEL (BN)
- ☒ MATTE BLACK (BL)

MODEL: T2813EP / 62320

Lot# 88	Date: MAY 26 2022	Room: MASTER ENS / ENS 2 / SHARED ENS.
Signature:		
Signature:		



PINE VALLEY
FOREVERGREEN

PLUMBING UPGRADES

MOEN - ALIGN

Two-Handle Adjustable Widespread Lav Faucet with Lift Rod Drain

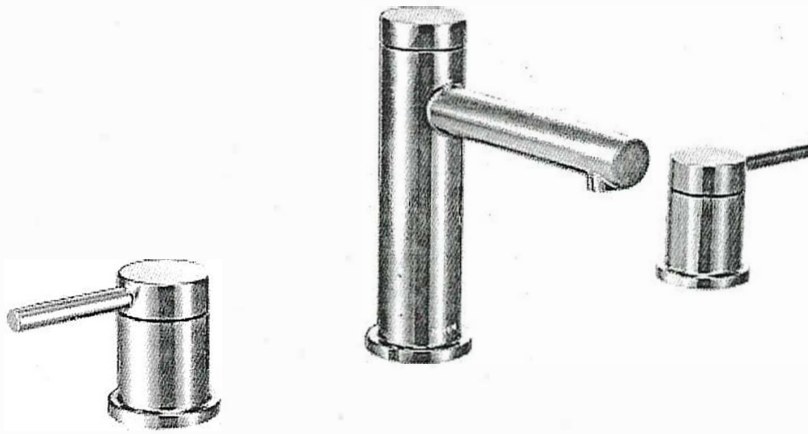

- ☐ CHROME
- ☐ BRUSHED NICKEL (BN)
- ☐ BRUSHED GOLD (BG)
- ☒ MATTE BLACK (BL)

MODEL: T6193 / 69000

Lot# 88	Date: MAY 26 2022	Room: POWDER
Signature:		
Signature:		

UPGRADE TOILET

CILA

Contrac
Soft White

1 Piece Elongated Bowl w/ Concealed Skirted Trap-Way

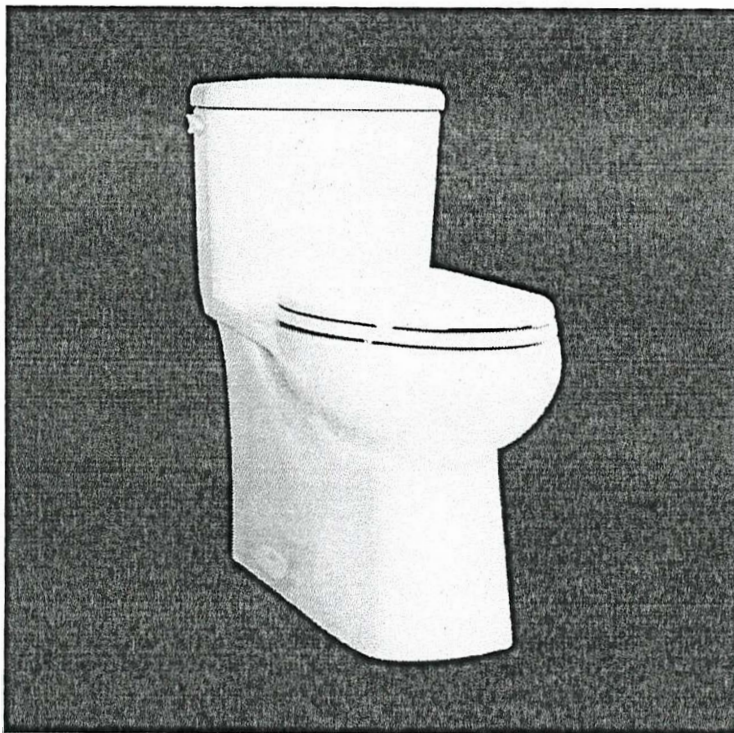

DESCRIPTION: Soft White, 17" plus height for greater comfort, Soft white tank lever

DIMENSIONS: 15 3/8" W x 28 1/2" D x 30 1/8" H

MODEL: 4710BOXU

Lot# 88	Date: MAY 26 2022	Room: BOWER
Signature:		
Signature:		



UPGRADE SINK + FAUCET

BLANCO - QUATRUS R15 LAUNDRY SINK
+
MOEN - SLEEK SINGLE HANDLE PULLOUT FAUCET

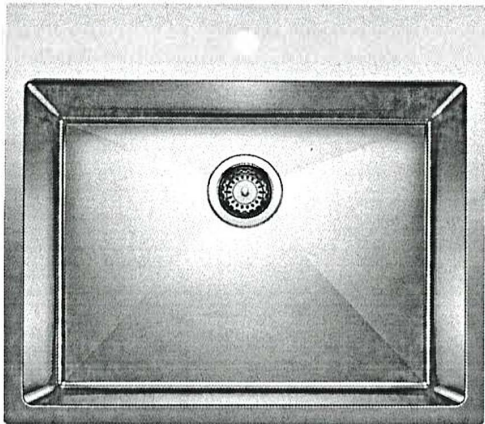
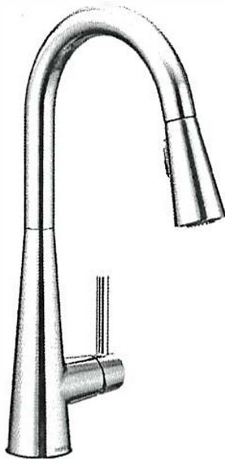

*CHROME ONLY + STAINLESS STEEL

MODEL: 7864 Faucet / 401802 Stainless Steel Sink

Lot# 88	Date: MAY 26 2022	Room: LAUNDRY
Signature:		
Signature:		



STONE COUNTERTOP EDGE PROFILES

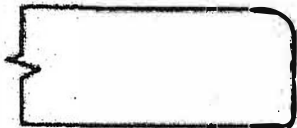

STANDARD 2CM EASED EDGE

LOCATION: THRU OUT



UPGRADE 3CM EASED EDGE

LOCATION: _____

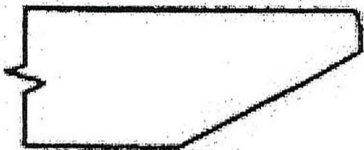

UPGRADE 4CM MITRED EDGE

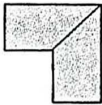

LOCATION: _____

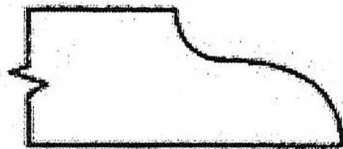

UPGRADE 2CM OGEE EDGE

LOCATION: _____

LOT #: <u>88</u>	DATE: <u>MAY 26 2022</u>
SIGNATURE: _____	
SIGNATURE: _____	



PINE VALLEY
FOREVERGREEN

UPGRADE SHOWER HARDWARE

SQ6X6

Shower Door Handle

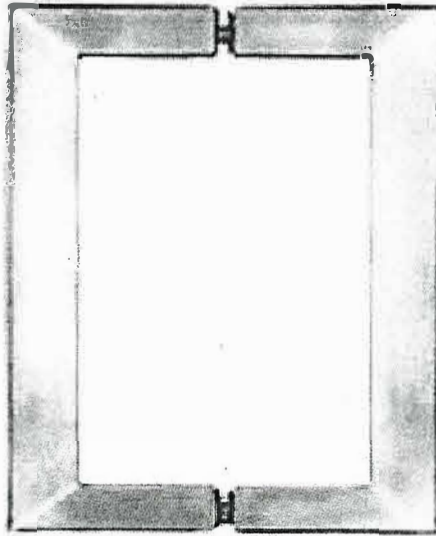

SQ6X6
Shower Door Handle

6" x 6" back-to-back
3/4" square tube

☐ CHROME

☒ MATTE BLACK

Lot#

88

Date:

MAY 26 2022

Room:

MASTER + GAVEN ENCLITE

Signature:

Signature:



FIREPLACE MANTLE UPGRADE

CAPRI

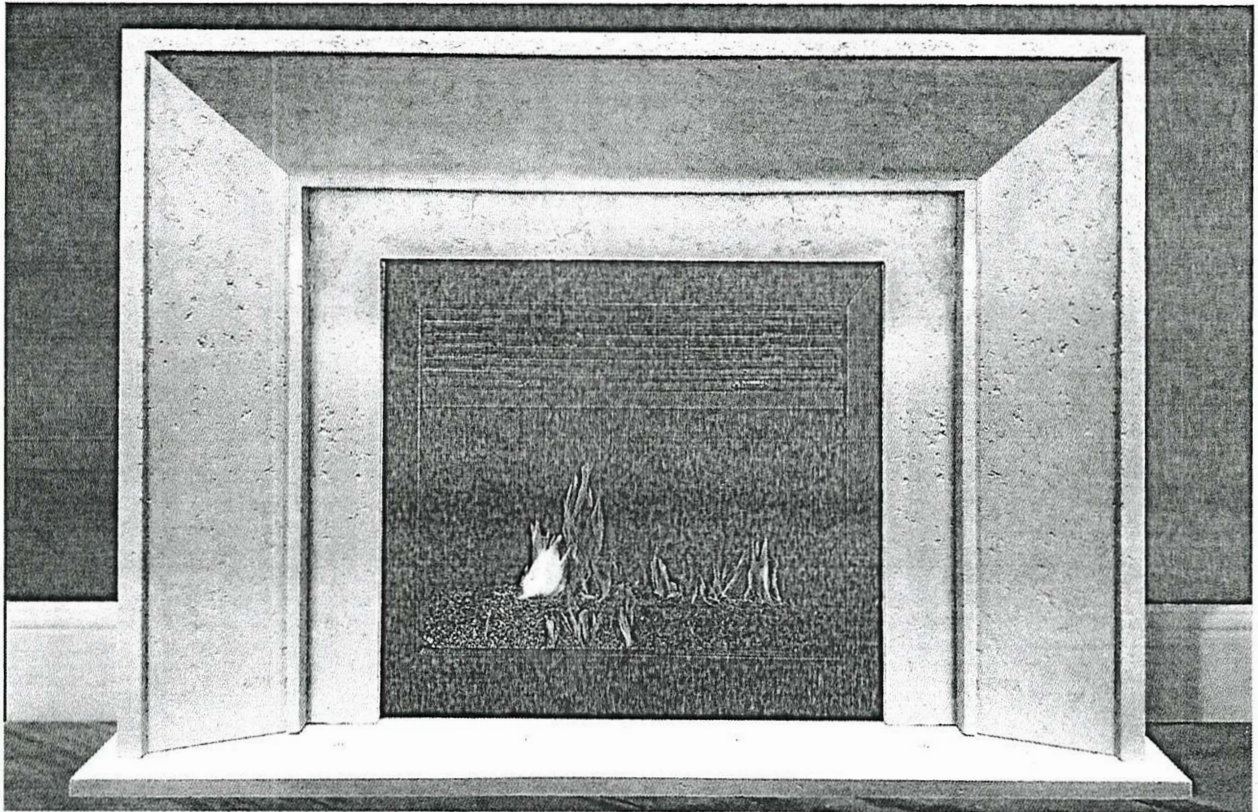

TOP VIEW



SIDE VIEW

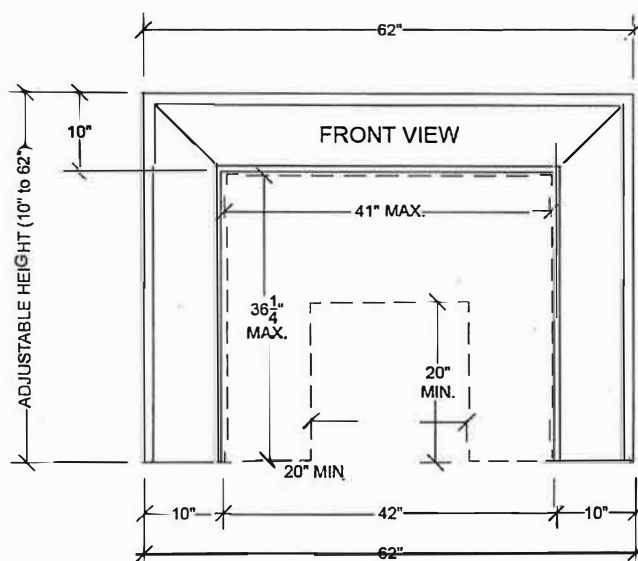

OR MEASUREMENT OR DESCRIPTION

LOT #: 88	DATE: MAY 26 2022	LOCATION: GREAT ROOM
SIGNATURE:		
SIGNATURE:		



BATHROOM ACCESSORIES

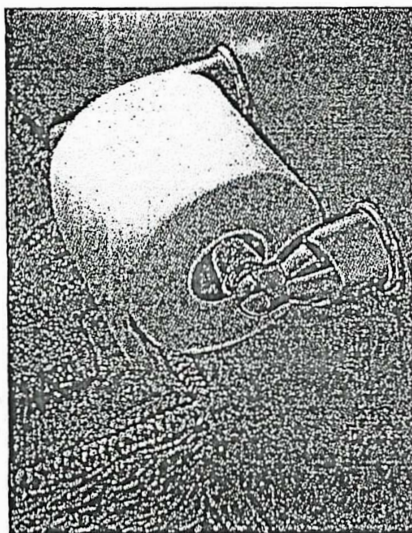

Tissue Holder
Mason - Chrome

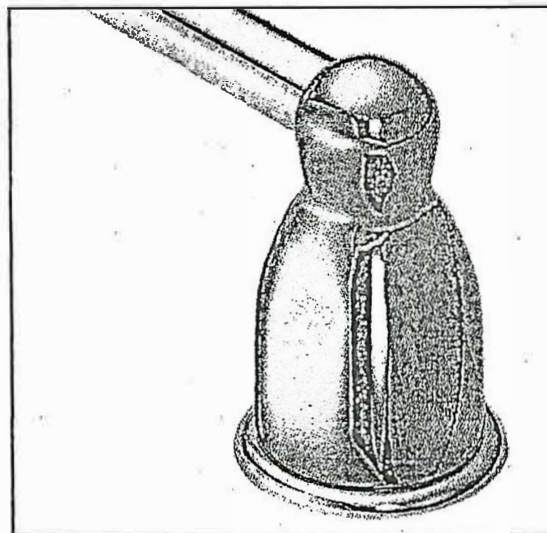

Towel Bar
Mason - Chrome

Please select one of the following:

☐ INSTALL STANDARD BATHROOM ACCESSORIES THRU OUT
(tissue holder + towel bar) **location as per vendors discretion**

☒ ***DO NOT*** INSTALL STANDARD BATHROOM ACCESSORIES
THRU OUT **tissue holder + towel bar will not be provided**

LOT #

88

DATE:

MAY 27 2022

SIGNATURE:

SIGNATURE:



Project: PINE VALLEY

Lot: 88

Purchaser(s): INVENTORY

Standard Hood Fan Deletion

We acknowledge that the builder's standard hood fan will not be installed.
Do not supply, install and/or credit. We will install our own hood fan after closing.

Signature:  _____

Signature: _____

Date: MAY 26 2022



KITCHEN



POWDER ROOM



MASTER ENSUITE



SECOND ENSUITE



SHARED ENSUITE



LAUNDRY





PV-88

APRIL 1 2019

The Lilac

*REVISED - JUNE 10 2019.



→ Elevation A - 3,440 sq.ft.

↗ SOFFIT LIGHT LOCATION

36" GAS COOKTOP

JGC7636B – 36" x 5¼" x 21"

PRODUCT DIMENSIONS

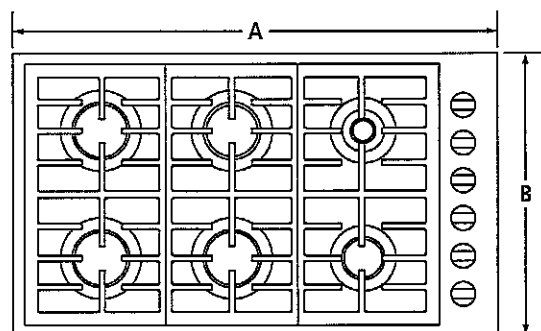

TOP VIEW

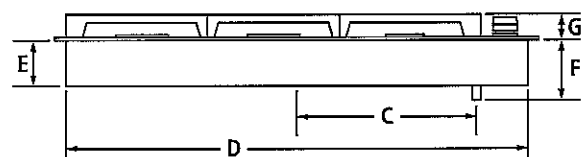

FRONT VIEW

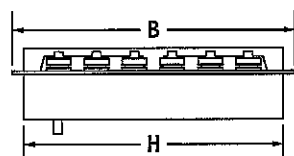

SIDE VIEW

MODEL #		JGC7636B	
		in	cm
A	Overall width	36	91.4
B	Depth of cooktop	21	53.3
C	Center of cooktop to center of gas inlet	13½	34.3
D	Width of recessed cooktop	35¼	89.5
E	Height of recessed cooktop	3¼	8.3
F	Height from gas inlet to countertop	5¼	13.3
G	Height with grates	1¼	3.2
H	Depth of recessed cooktop	20¼	51.4

IMPORTANT: Dimensional specifications are provided for planning purposes only.

Do not make any cutouts based on this information. Refer to the Installation Guide *before* selecting cabinetry, verifying electrical/gas connections, making cutouts or beginning installation.

All Jenn-Air® appliances are appropriately UL, CUL or CSA approved.

36" GAS COOKTOP

JGC7636B – 36" x 5¼" x 21"

OPENING/CLEARANCE DIMENSIONS

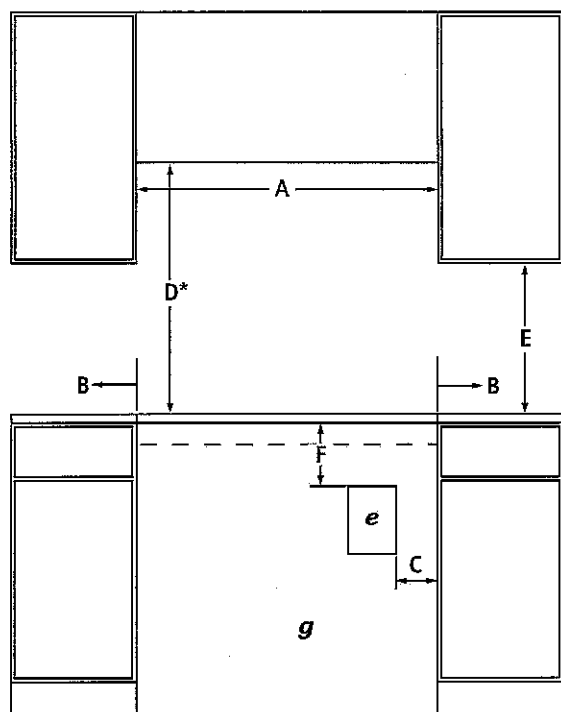

FRONT VIEW

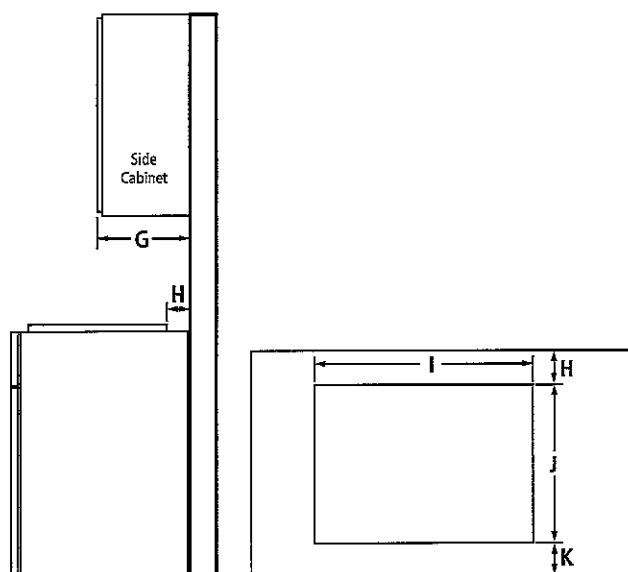

SIDE VIEW

TOP VIEW – CUTOUT

MODEL #		JGC7636B	
		in	cm
A	Width of combustable area above cooking surface (min.)	36	91.4
B	Width from cooktop to fixed wall or other combustable material (min.)	6	15.2
C	Width to outer edge of outlet (max.)	24	61.0
D*	Height to bottom of uncovered wood or metal cabinet above cooking surface (min.)	30	76.2
E	Height to bottom of uncovered wood or metal cabinet (min.)	18	45.7
F	Height to top edge of outlet (min.)	5½	14.0
G	Depth of upper cabinet (recommended)	13	33.0
H	Depth from cutout to wall (min.)	2⅞	5.9
I	Width of cutout	35⅜	89.9
J	Depth of cutout	20⅜	51.8
K	Depth from cutout to front of countertop	2⅞	5.9
e	Recommended electrical access location		
g	Recommended gas supply line location		

*Dimension can be reduced by 6" (15.2 cm) when bottom of wood or metal cabinet is covered by not less than ¼" (0.6 cm) flame retardant millboard covered with not less than No. 28 MSG sheet metal, 0.015" (0.4 mm) stainless steel, 0.024" (0.6 mm) aluminum or 0.020" (0.5 mm) copper. If installing a hood or microwave hood combination above the cooktop, follow the hood or microwave hood combination instructions for dimensional clearances above the cooking surface.

GAS REQUIREMENTS

Natural Gas

This cooktop is factory-set for use with natural gas.

LP Gas Conversion

Conversion must be done by a qualified service technician. To convert to LP gas, use an LP gas conversion kit.

ELECTRICAL REQUIREMENTS

120 volt, 60 Hz, AC only, 15-amp fused, electrical circuit is required. A time-delay fuse or dedicated circuit is recommended.

LOCATION REQUIREMENTS

- To ensure cooktop base clearance, cabinet side walls need to be wider than the cutout.
- If cabinet has a drawer, allow a 4" (10.2 cm) minimum clearance between countertop and top of drawer. Drawer depth may need to be shortened to avoid interfering with the regulator.

IMPORTANT: Dimensional specifications are provided for planning purposes only.

Do not make any cutouts based on this information. Refer to the Installation Guide *before* selecting cabinetry, verifying electrical/gas connections, making cutouts or beginning installation.

All Jenn-Air® appliances are appropriately UL, CUL or CSA approved.

SINGLE WALL OVEN AND COOKTOP COMBINATIONS

For the approved model number combinations, refer to the under counter label located on top of the oven chassis and on the bottom of the cooktop burner box.

APPROVED MODEL NUMBER COMBINATIONS

SINGLE WALL OVENS

30-Inch: JJW3430D, JJW2430D

27-Inch: JJW2427D

INDUCTION COOKTOPS

36-Inch: JIC4536X

30-Inch: JIC4430X

GAS COOKTOPS

36-Inch: JGC7636B, JGC1536B

30-Inch: JGC7530B, JGC1530B

ELECTRIC COOKTOPS

36-Inch: JEC4536B, JEC3536B

30-Inch: JEC4430B, JEC3430B

OPENING/CLEARANCE DIMENSIONS

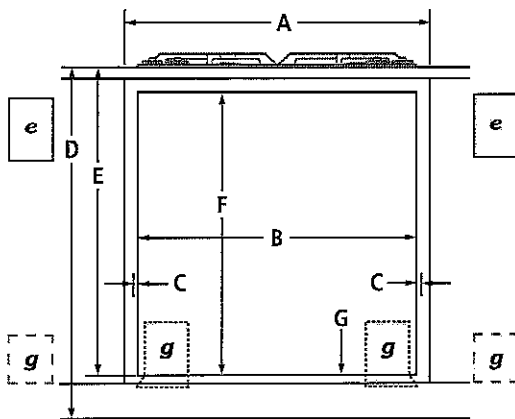

**FRONT VIEW –
UNDER COUNTER INSTALLATION**
(with cooktop installed above)

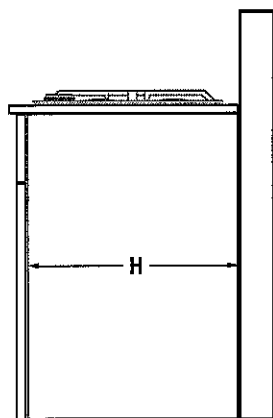

**SIDE VIEW –
UNDER COUNTER INSTALLATION**
(with cooktop installed above)

MODEL #		JJW3430D JJW2430D		JJW2427D	
		in	cm	in	cm
A	Width of cabinet (min.)	30	76.2	27	68.6
B	Width of cutout (recommended)	28½	72.4	25½	64.8
C	Oven trim overlap	⅝	1.6	⅝	1.6
D	Top of countertop to floor	36	91.4	36	91.4
E	Top of countertop to bottom of cutout				
	Induction cooktop combination	31⅜	79.7	31⅜	79.7
	Gas cooktop combination	31⅜	79.7	31⅜	79.7
	Electric cooktop combination	31⅜	79.7	31⅜	79.7
F	Height of cutout (recommended)	27¾	70.5	27¾	70.5
G	Bottom of cutout to floor				
	Induction cooktop combination	4⅝	11.7	4⅝	11.7
	Gas cooktop combination	4⅝	11.7	4⅝	11.7
	Electric cooktop combination	4⅝	11.7	4⅝	11.7
H	Depth of cabinet (min.)	24	61.0	24	61.0
E	Recommended junction box location				
G	Recommended gas supply line location for gas cooktop				

NOTE: For under counter installation, the junction box should be located in the adjacent right or left cabinet. Drill a 1" (2.5 cm) minimum diameter hole in an upper corner of the side wall for access to the junction box.

CABINET REQUIREMENTS

NOTE: When using under counter installation, check cabinet manufacturer's specifications to verify fit.

IMPORTANT: Dimensional specifications are provided for planning purposes only.

Do not make any cutouts based on this information. Refer to the Installation Guide *before* selecting cabinetry, verifying electrical/gas connections, making cutouts or beginning installation. All Jenn-Air® appliances are appropriately UL, CUL or CSA approved.

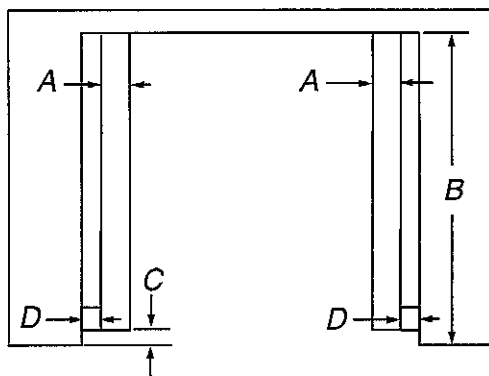

Top View

27" (68.6 cm) models

- A. 1/2" x 2" (1.3 cm x 5.1 cm) spacer the entire depth of the cutout*
- B. 25" (63.5 cm) depth of cutout
- C. 1 1/8" (3.5 cm) recess from front of cabinet
- D. 11/16" (1.7 cm) side cleat*

30" (76.2 cm) models

- A. 1/2" x 2" (1.3 cm x 5.1 cm) spacer the entire depth of the cutout*
- B. 25" (63.5 cm) depth of cutout
- C. 1 1/8" (3.5 cm) recess from front of cabinet
- D. 11/16" (1.7 cm) side cleat*

* Cleats and spacers must be recessed 1 3/8" (3.5 cm) from the front of the cabinet.

Electrical Requirements

If codes permit and a separate ground wire is used, it is recommended that a qualified electrical installer determine that the ground path and the wire gauge are in accordance with local codes.

Check with a qualified electrical installer if you are not sure the oven is properly grounded.

This oven must be connected to a grounded metal, permanent wiring system.

Be sure that the electrical connection and wire size are adequate and in conformance with the National Electrical Code, ANSI/NFPA 70-latest edition or CSA Standards C22.1-94, Canadian Electrical Code, Part 1 and C22.2 No. O-M91-latest edition, and all local codes and ordinances.

A copy of the above code standards can be obtained from:

National Fire Protection Association
1 Batterymarch Park
Quincy, MA 02169-7471

CSA International
8501 East Pleasant Valley Road
Cleveland, OH 44131-5575

Electrical Connection

To properly install your oven, you must determine the type of electrical connection you will be using and follow the instructions provided for it here.

- Oven must be connected to the proper electrical voltage, amperage, and frequency as specified on the model/serial/rating plate. See the following illustration.

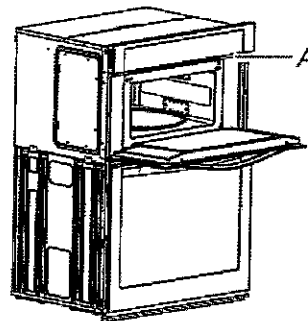

A. Model/serial/rating plate

- Models rated from 7.3 to 9.6 kW at 240 V (6.3 to 8.3 kW at 208 V) require a separate 40 A circuit. Models rated from 4.9 to 7.2 kW at 240 V (4.3 to 6.2 kW at 208 V) require a separate 30 A circuit. Models rated at 4.8 kW and below at 240 V (4.2 kW and below at 208 V) require a separate 20 A circuit.
- A circuit breaker is recommended.
- Connect directly to the fused disconnect (or circuit breaker box) through flexible, armored or nonmetallic sheathed, copper cable (with grounding wire). See the "Make Electrical Connection" section.
- Flexible conduit from the oven should be connected directly to the junction box.
- Do not cut the conduit. The length of conduit provided is for serviceability of the oven.
- A UL listed or CSA approved conduit connector must be provided.
- If the house has aluminum wiring, follow the procedure below: Connect the aluminum wiring using special connectors and/or tools designed and UL listed for joining copper to aluminum. Follow the electrical connector manufacturer's recommended procedure. Aluminum/copper connection must conform with local codes and industry accepted wiring practices. Be sure that the electrical connection and wire size are adequate and in conformance with the National Electrical Code, ANSI/NFPA 70-latest edition or CSA Standards C22.1-94, Canadian Electrical Code, Part 1 and C22.2 No. O-M91-latest edition, and all local codes and ordinances. A copy of the above code standards can be obtained from: National Fire Protection Association 1 Batterymarch Park Quincy, MA 02169-7471 CSA International 8501 East Pleasant Valley Road Cleveland, OH 44131-5575.

Cabinet Dimensions — Built-in Microwave/Oven Combination

Standard Installation

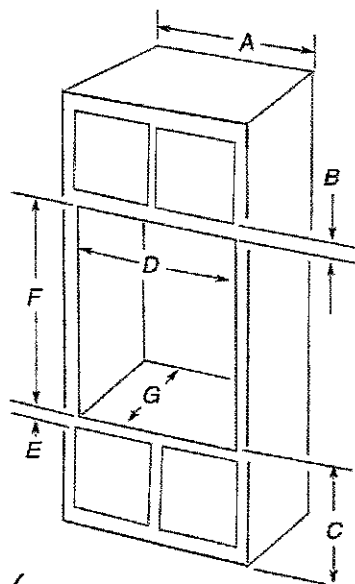

27" (68.6 cm) models

- A. 27" (68.6 cm) minimum cabinet width
- B. 2¹/₄" (5.7 cm) top of cutout to bottom of upper cabinet door
- C. 19¹/₄" (48.9 cm) bottom of cutout to floor is recommended.
7"-19¹/₄" (17.8-48.9 cm) bottom of cutout to floor is acceptable.
- D. 25¹/₂" minimum (64.8 cm) cutout width
- E. 1¹/₂" (3.8 cm) minimum bottom of cutout to top of cabinet door
- F. 41⁵/₁₆" (105 cm)* recommended cutout height
- G. 24" (60.7 cm) cutout depth

* 30" (76.2 cm) models

- A. 30" (76.2 cm) minimum cabinet width
- B. 2¹/₄" (5.7 cm) top of cutout to bottom of upper cabinet door
- C. 19¹/₄" (48.9 cm) bottom of cutout to floor is recommended.
7"-19¹/₄" (17.8-48.9 cm) bottom of cutout to floor is acceptable.
- D. 28¹/₂" (72.4 cm) minimum cutout width
- E. 1¹/₂" (3.8 cm) minimum bottom of cutout to top of cabinet door
- F. 41⁵/₁₆" (105 cm)* recommended cutout height
- G. 24" (60.7 cm) cutout depth

***NOTE:** The cutout height can be between 41⁵/₁₆" (104.5 cm) and 41¹/₂" (105.6 cm) for microwave/oven combination.

Flush Installation

A 25" (63.5 cm) minimum cutout depth is required.

These dimensions will result in a 1/4" (6 mm) reveal on the top, a 1/4" (6 mm) reveal on the sides, and a 1/8" (3 mm) reveal on the bottom of the wall oven.

The front face of the cleats and platform will be visible and should be treated as a finished surface.

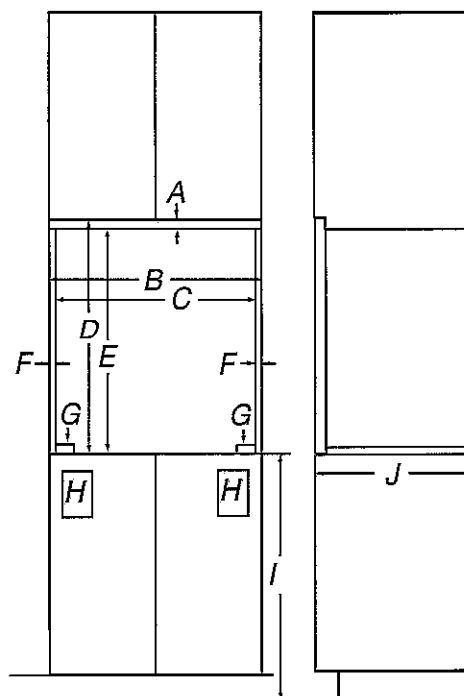

Front View

Side View

27" (68.6 cm) models

- A. 5/8" (1.6 cm) top cleat*
- B. 27¹/₄" (69.2 cm) minimum width of flush inset cutout
- C. 25⁷/₈" (65.7 cm) minimum width of opening
- D. 43¹/₂" (110 cm) minimum height of flush inset cutout
- E. 42¹/₂" (107.9 cm) recommended cutout height
- F. 11/16" (1.7 cm) side cleat*
- G. 1/2" x 2" (1.3 cm x 5.1 cm) spacer the entire depth of the cutout*
- H. Recommended junction box location
- I. 4⁵/₈"-19¹/₄" (11.7 - 48.9 cm) bottom of cutout to floor
- J. 25" (63.5 cm) minimum depth of cutout

30" (76.2 cm) models

- A. 5/8" (1.6 cm) top cleat*
- B. 30¹/₄" (76.8 cm) minimum width of flush inset cutout
- C. 28⁷/₈" (73.3 cm) minimum width of opening
- D. 43¹/₈" (110 cm) minimum height of flush inset cutout
- E. 42¹/₂" (107.9 cm) recommended cutout height
- F. 11/16" (1.7 cm) side cleat*
- G. 1/2" x 2" (1.3 cm x 5.1 cm) spacer the entire depth of the cutout*
- H. Recommended junction box location
- I. 4⁵/₈"-19¹/₄" (11.7 - 48.9 cm) bottom of cutout to floor
- J. 25" (63.5 cm) minimum depth of cutout

* Cleats and spacers must be recessed 1³/₈" (3.5 cm) from the front of the cabinet.

36" FULLY INTEGRATED FRENCH DOOR REFRIGERATOR

(BASE UNIT REQUIRES SUITE-COORDINATING PANEL KIT OR CUSTOM PANELS AND HANDLES)JF36NXXFXDE – 35³/₄" x 83¹/₈" x 24" (without door/handles)

PRODUCT DIMENSIONS

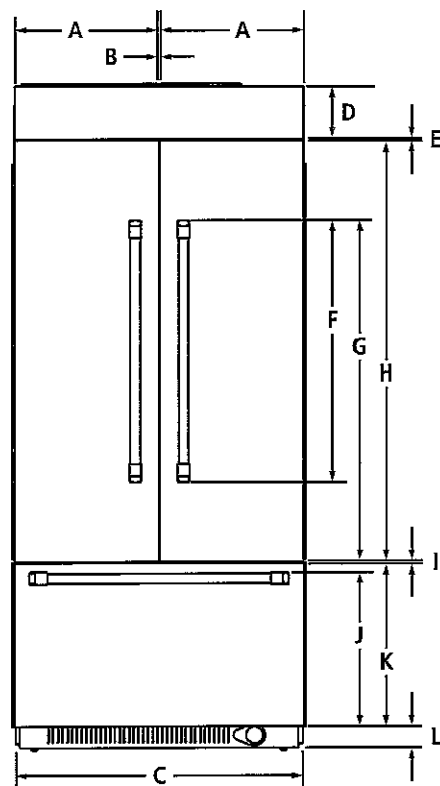

FRONT VIEW

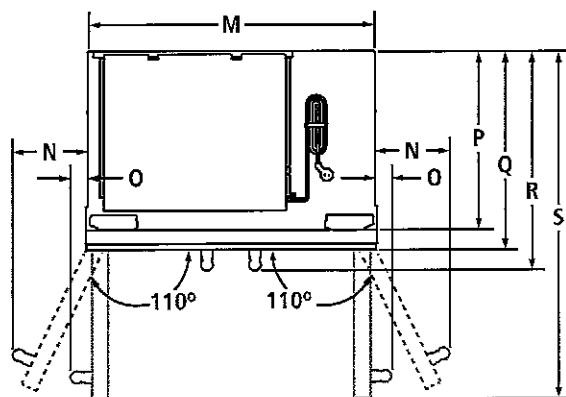

TOP VIEW

MODEL #		JF36NXXFXDE	
		in	cm
A	Width of each door	17 ³ / ₈	44.8
B	Space between doors	¹ / ₈	0.3
C	Overall width	35 ³ / ₄	90.8
D	Height of top grille and bracket	6 ¹ / ₂	16.5
E	Space between doors and top grille	³ / ₈	0.8
F	Height of door handles		
	Pro-Style® Stainless	32 ³ / ₈	82.2
	Euro-Style Stainless	37 ⁷ / ₈	96.0
G	Height to top of door handles		
	Pro-Style® Stainless	42 ³ / ₈	107.6
	Euro-Style Stainless	44 ⁷ / ₈	114.0
H	Height of doors	52 ³ / ₈	133.0
I	Space between doors and drawer	¹ / ₈	0.3
J	Height to top of drawer handle		
	Pro-Style® Stainless	19 ³ / ₈	49.2
	Euro-Style Stainless	19 ¹ / ₄	48.7
K	Height of drawer	20 ¹ / ₂	52.1
L	Height of bottom grille	3	7.6
M	Width of recessed refrigerator	35	88.9
N	Width from side of refrigerator to handle – door fully open 110°		
	Pro-Style® Stainless	7	17.8
	Euro-Style Stainless	6 ¹ / ₂	16.5
O	Width from side of refrigerator to handle – door open 90°		
	Pro-Style® Stainless	2	5.1
	Euro-Style Stainless	1 ¹ / ₂	3.9
P	Depth without door panel kit	24	61.0
Q	Depth with doors		
	Pro-Style® Stainless panel kit	24 ³ / ₄	62.9
	Euro-Style Stainless panel kit	24 ³ / ₄	62.9
	Custom panel (¾"/1.9 cm)	24 ³ / ₄	62.9
R	Depth with handles		
	Pro-Style® Stainless	27 ³ / ₈	69.5
	Euro-Style Stainless	26 ⁷ / ₈	68.3
S	Depth with doors open 90°	41	104.1

IMPORTANT: Dimensional specifications are provided for planning purposes only.

Do not make any cutouts based on this information. Refer to the Installation or Use & Care Guide before selecting cabinetry, verifying electrical/gas connections, making cutouts or beginning installation.

All Jenn-Air® appliances are appropriately UL, CUL or CSA approved.

36" FULLY INTEGRATED FRENCH DOOR REFRIGERATOR

(BASE UNIT REQUIRES SUITE-COORDINATING PANEL KIT OR CUSTOM PANELS AND HANDLES)

JF36NFXDE – 35 $\frac{3}{4}$ " x 83 $\frac{1}{8}$ " x 24" (without door/handles)

DIMENSIONS AS INSTALLED

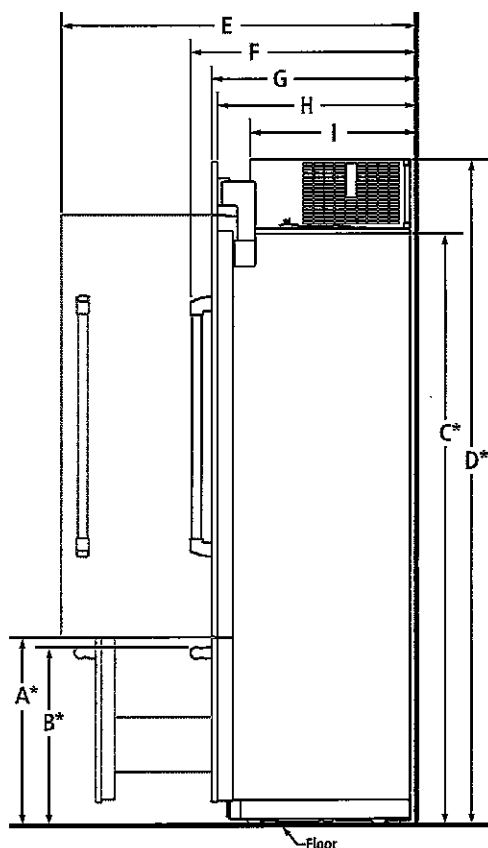

SIDE VIEW

MODEL #		JF36NFXDE	
		in	cm
A*	Height to top of drawer (min.)	23 $\frac{1}{2}$	59.7
	Height to top of drawer handle (min.)		
B*	Pro-Style® Stainless	22 $\frac{3}{8}$	56.8
	Euro-Style Stainless	22 $\frac{1}{4}$	56.3
C*	Height to top of doors (min.)	74 $\frac{3}{8}$	188.9
D*	Height to top of grille and bracket (min.)	83 $\frac{1}{8}$	211.1
E	Depth with door open 90° (min.)	41	104.1
	Depth with handles (min.)		
F	Pro-Style® Stainless	27 $\frac{3}{8}$	69.5
	Euro-Style Stainless	26 $\frac{7}{8}$	68.3
G	Depth with doors (min.)		
	Pro-Style® Stainless panel kit	24 $\frac{3}{4}$	62.9
	Euro-Style Stainless panel kit	24 $\frac{3}{4}$	62.9
	Custom panel (¾"/1.9 cm)	24 $\frac{3}{4}$	62.9
H	Depth without door panel kit (min.)	24	61.0
I	Depth of compressor (min.)	19 $\frac{7}{8}$	50.5

*Add 1 $\frac{1}{2}$ " (3.2 cm) to the height dimension when leveling legs are fully extended.**IMPORTANT:** Dimensional specifications are provided for planning purposes only.

Do not make any cutouts based on this information. Refer to the Installation or Use & Care Guide before selecting cabinetry, verifying electrical/gas connections, making cutouts or beginning installation. All Jenn-Air® appliances are appropriately UL, CUL or CSA approved.

36" FULLY INTEGRATED FRENCH DOOR REFRIGERATOR

(BASE UNIT REQUIRES SUITE-COORDINATING PANEL KIT OR CUSTOM PANELS AND HANDLES)

JF36NFXDE – 35¾" x 83⅞" x 24" (without door/handles)

3 STYLES FOR DOOR PANEL INSTALLATION

STANDARD INTEGRATED GRILLE INSTALLATION

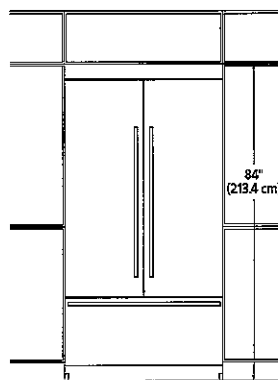

FRONT VIEW

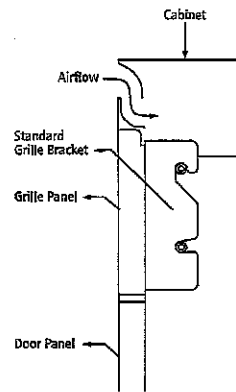
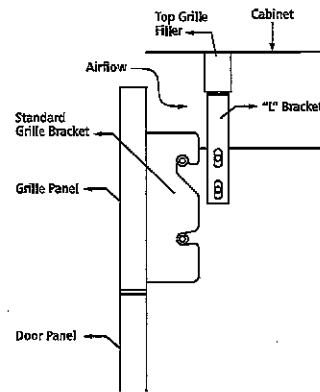
SIDE VIEW – STAINLESS STEEL
PANEL KIT

SIDE VIEW – CUSTOM PANEL

- Attach the standard custom grille with the standard grille bracket provided with the refrigerator.
- The standard grille panel height allows for an air gap critical to refrigerator performance.

FULLY INTEGRATED GRILLE INSTALLATION

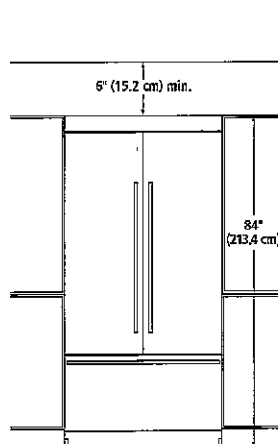
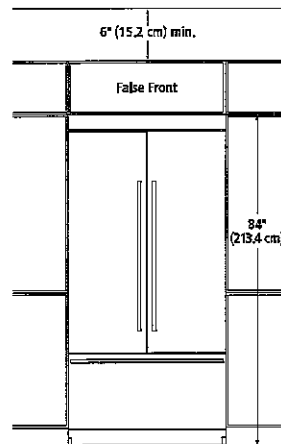
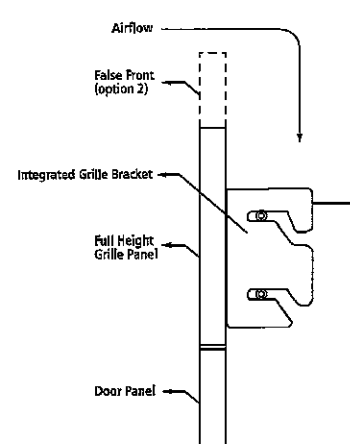
FRONT VIEW – OPEN TO CEILING
(OPTION 1)FRONT VIEW – FALSE FRONT
(OPTION 2)

SIDE VIEW – CUSTOM PANEL

- Attach the full-height grille with the integrated grille bracket provided with the refrigerator.
- Requires a minimum of 6" (15.2 cm) of open space above the refrigerator, which must not be blocked in any way, including soffits.

* ARMOIRE-STYLE INSTALLATION*

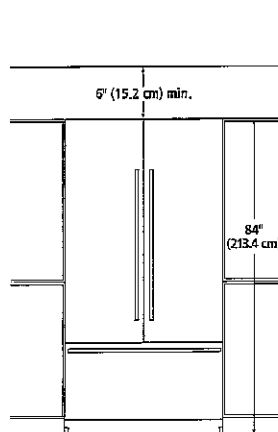
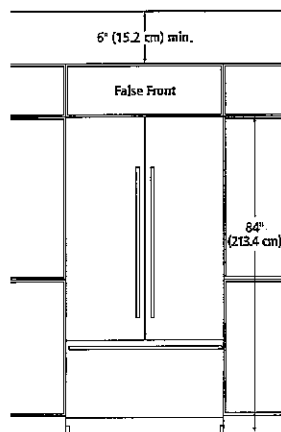
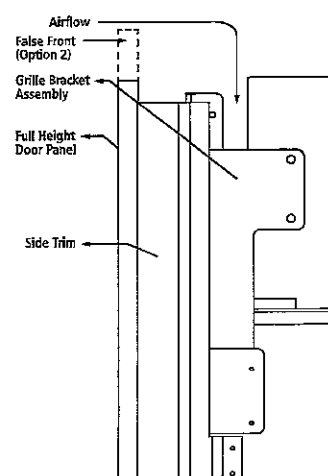
FRONT VIEW – OPEN TO CEILING
(OPTION 1)FRONT VIEW – FALSE FRONT
(OPTION 2)

SIDE VIEW – CUSTOM PANEL

- Attach the grille bracket assembly and grille panel provided in the armoire-style panel kit.
- Requires a minimum of 6" (15.2 cm) of open space above the refrigerator, which must not be blocked in any way, including soffits.

* Refer to the Armoire Kit installation instructions for additional dimensions and installation details.

IMPORTANT: Dimensional specifications are provided for planning purposes only.

Do not make any cutouts based on this information. Refer to the Installation or Use & Care Guide before selecting cabinetry, verifying electrical/gas connections, making cutouts or beginning installation. All Jenn-Air® appliances are appropriately UL, CUL or CSA approved.

36" FULLY INTEGRATED FRENCH DOOR REFRIGERATOR

(BASE UNIT REQUIRES SUITE-COORDINATING PANEL KIT OR CUSTOM PANELS AND HANDLES)

JF36NFXDE – 35¾" x 83⅞" x 24" (without door/handles)

OPENING/CLEARANCE DIMENSIONS

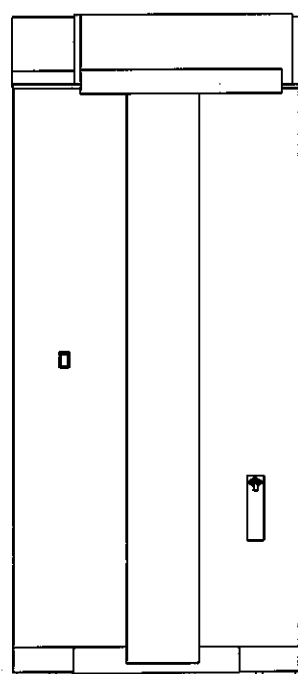
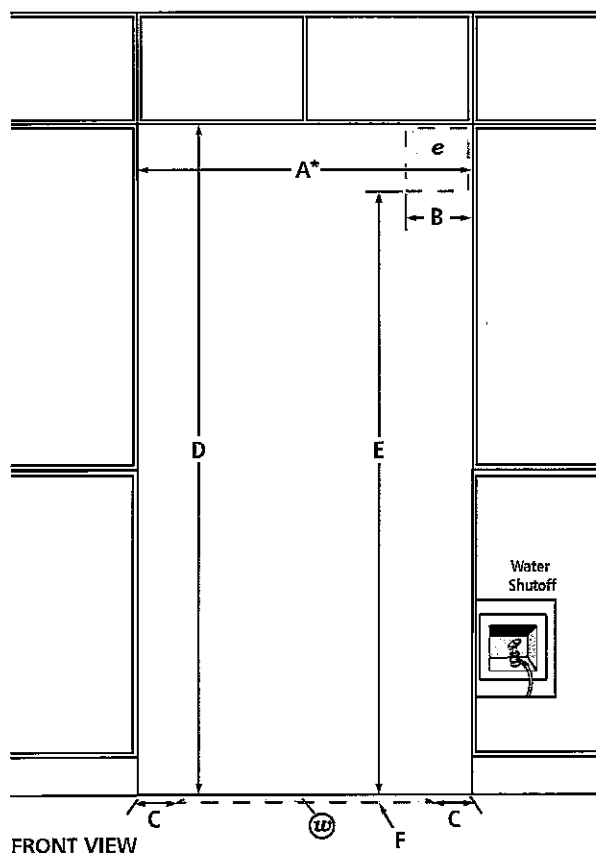

MODEL #		JF36NFXDE	
		in	cm
A*	Width (min.)	36	91.4
B	Width of recommended electrical location	4	10.2
C	Distance from side of cabinet to recommended water connection location	6	15.2
D	Height (min.)	84	213.4
E	Height to recommended electrical location	77	195.6
F	Depth of recommended water connection location (max.)	1	2.5
e	Recommended electrical connection location		
W	Recommended water connection location		

*Minimum width must extend behind the face of the cabinet for at least 2" (5.1 cm).

ELECTRICAL REQUIREMENTS

115 volt, 60 Hz, AC only, 15- or 20-amp fused, grounded circuit is required. A dedicated circuit is recommended. Use an outlet that cannot be turned off by a switch. Do not use an extension cord.

WATER PRESSURE REQUIREMENTS

A cold water supply with water pressure between 30 and 120 psi (207 and 827 kPa) is required to operate the ice maker. Call a licensed, qualified plumber with any questions about the water pressure.

Reverse Osmosis Water Supply

IMPORTANT: The pressure of the water coming out of a reverse osmosis system going to the water inlet valve of the refrigerator needs to be between 30 and 120 psi (207 and 827 kPa).

If a reverse osmosis water filtration system is connected to the cold water supply, the water pressure to the reverse osmosis system needs to be a minimum of 40 to 60 psi (276 to 414 kPa).

LOCATION REQUIREMENTS

Floor must be able to support refrigerator (more than 600 lb [272 kg]), door panels and contents of the refrigerator and must be at the same level as flooring in the room.

IMPORTANT: Dimensional specifications are provided for planning purposes only.

Do not make any cutouts based on this information. Refer to the Installation or Use & Care Guide before selecting cabinetry, verifying electrical/gas connections, making cutouts or beginning installation. All Jenn-Air® appliances are appropriately UL, CUL or CSA approved.

INSTALLATION INSTRUCTIONS FOR CUSTOM PANEL UNDERCOUNTER DISHWASHER STAINLESS STEEL TUB

IMPORTANT: Before installing your dishwasher, please use this instruction sheet as a supplement to the installation instructions.

Custom Panel Models Only

Gather these additional tools and parts before starting attachment of the custom panel. Read and follow the instructions provided in this instruction sheet.

Additional Tools Needed:

- 3/32" drill bit
- Torx[®] T15 screwdriver

Additional Parts Supplied with Custom Panel Models:

- 4 – Plastic studs (attached to each other by runners)
- 4 – Short screws (10-16 hex-head screw)
- 4 – Long screws (8-18 Torx head screws)
- 1 – Template (located inside Use and Care Guide bag assembly)
- 1 – Instruction sheet (located inside Use and Care Guide bag assembly)

NOTE: The screws supplied are used for only 3/4" (19 mm) thick wooden panel. If the wooden panel is less than 3/4" (19 mm) thick, customer must purchase screws locally.

Make sure all these parts are included in the literature package.

If parts are not included, call 1-800-422-1230.

In Canada, call 1-800-807-6777.

Follow Steps Below:

A customer supplied door panel and handle (together) must weigh no more than 16 lbs (7.3 kg) and must be made to specific dimensions. It is recommended that a cabinetmaker cut the customer panel because of the precise dimensions needed.

NOTES:

- The handle for the custom panel is not included.
- All mounting hardware supplied is for a 3/4" (19 mm) thick wood panel. If a thinner wood panel or materials other than wood are used, it is the customer's responsibility to obtain the proper length screws and adjust the pilot holes accordingly.

⚠ WARNING

Excessive Weight Hazard

Use two or more people to move and install dishwasher.

Failure to do so can result in back or other injury.

Install Custom Panel

Custom panel dimensions

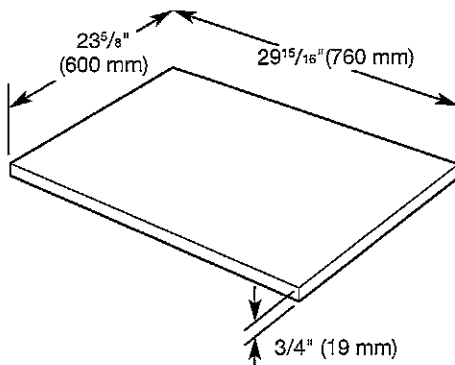

NOTE: Make sure that the custom panel is as per the recommended dimensions. Deviation from the dimensions may result in blockage of the vent duct outlet.

Stand dishwasher upright

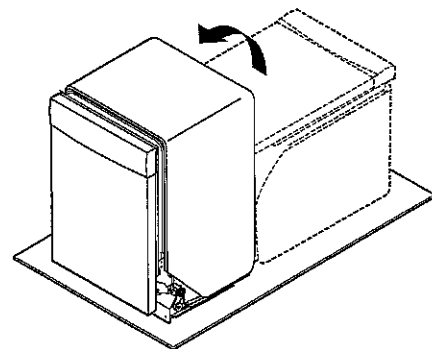

Using 2 or more people, stand the dishwasher up.

Installation Dimensions

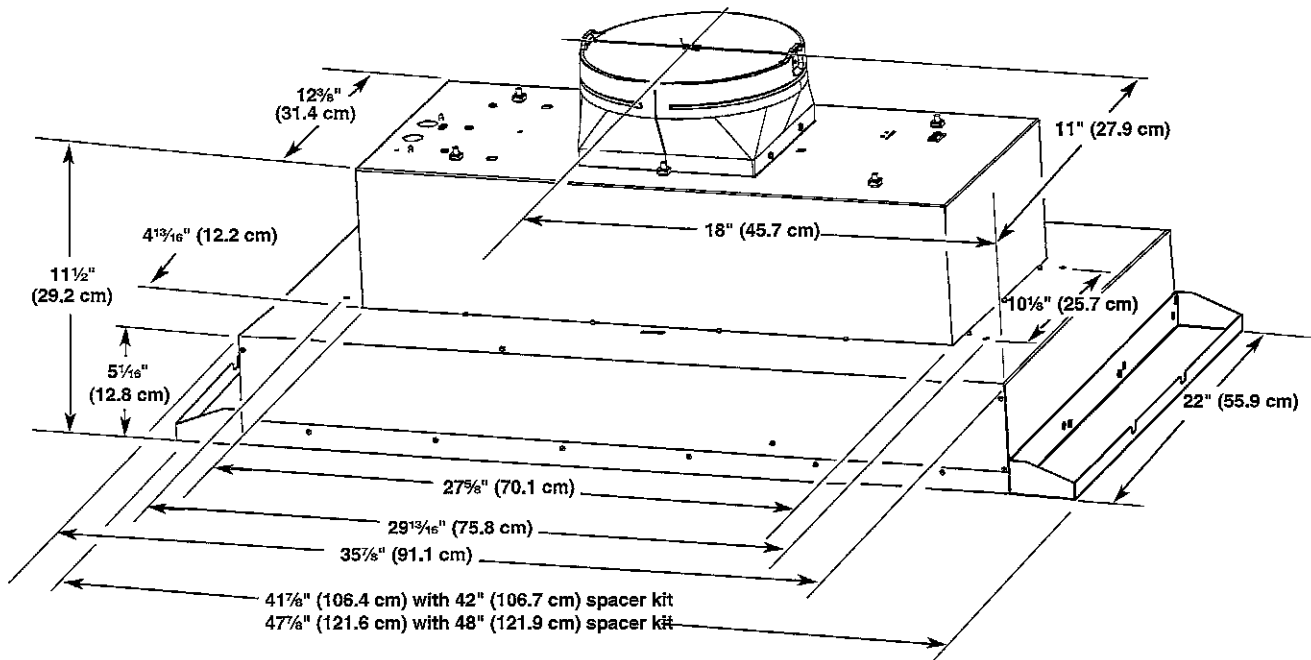

Venting Requirements

- Vent system must terminate to the outdoors.
- Do not terminate the vent system in an attic or other enclosed area.
- Do not use 4" (10.2 cm) laundry-type wall caps.
- Use metal vent only. Rigid metal vent is recommended. Plastic or metal foil vent is not recommended.
- The length of vent system and number of elbows should be kept to a minimum to provide efficient performance.

For the most efficient and quiet operation:

- Use no more than three 90° elbows.
- Make sure there is a minimum of 24" (61.0 cm) of straight vent between the elbows if more than 1 elbow is used.
- Do not install 2 elbows together.
- Use vent clamps to seal all joints in the vent system.
- Use caulking to seal exterior wall or roof opening around the cap.
- The size of the vent should be uniform.

Cold weather installations

An additional back draft damper should be installed to minimize backward cold air flow and a thermal break should be installed to minimize conduction of outside temperatures as part of the vent system. The damper should be on the cold air side of the thermal break.

The break should be as close as possible to where the vent system enters the heated portion of the house.

Makeup air

Local building codes may require the use of makeup air systems when using ventilation systems greater than specified CFM of air movement. The specified CFM varies from locale to locale. Consult your HVAC professional for specific requirements in your area.

Venting Methods

Typical Internal Blower Motor System Venting Installations

A 10" (25.4 cm) round vent system is needed for installation (not included). The hood exhaust opening is 10" (25.4 cm) round.

NOTE: Flexible vent is not recommended. Flexible vent creates back pressure and air turbulence that greatly reduce performance.

Vent system can terminate either through the roof or wall. To vent through the wall, a 90° elbow is needed.

Roof Venting

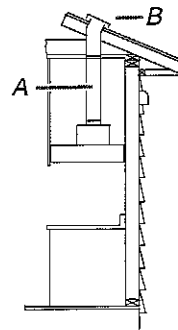

A. 10" (25.4 cm) round vent
B. Roof cap

Wall Venting

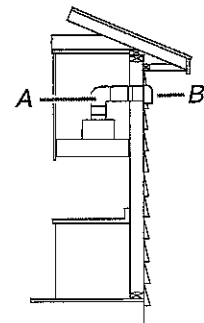

A. 10" (25.4 cm) round vent
B. Wall cap