



CONSTRUCTION SUMMARY

Saddle Ridge (G) - Lecco Ridge Developments Inc.

PURCHASERS: SAFWAT SALIB SADEK and GEHANE KAMAL SOBHI

TEL:

LOT / PHASE Block 331 TH 1 / 1	REG. PLAN # 20M-1184	HOUSE TYPE Ivy 11 Elev 2		
-----------------------------------	-------------------------	-----------------------------	--	--

CABINETRY

1 - CABINETRY - UPGRADE 3 - POWDER ROOM 16Apr18 Note:	
1 - LIGHT VALENCE - KITCHEN 16Apr18 Note: NO ELECTRICAL	

CABINETRY ACCESSORIES

1 - PANTRY UNIT UPGRADE - TO GO FROM 300MM TO 600MM DEEP - PRICE IS PER FOOT - STANDARD 16Apr18 Note:	
1 - KITCHEN CABINETRY UPPER - FULL DEPTH ABOVE FRIDGE - WITH GABLES - 600MM - PRICE IS EACH - STANDARD 16Apr18 Note:	
2 - PANTRY UNIT - 600MM DEEP - PRICE IS PER FOOT - STANDARD 16Apr18 Note:	
1 - KITCHEN CABINETRY BASE - SLIDE IN RANGE PROVISION 16Apr18 Note: Specs. Attached	
1 - KITCHEN CABINETRY BASE - PIE CUT CORNER CABINET - BASE CABINETRY - STANDARD 16Apr18 Note:	
1 - KITCHEN CABINETRY BASE - POT/PAN DRAWERS (CABINET) - STANDARD 16Apr18 Note:	

RECEIVED APR 24 2018

CERAMIC TILE

1 - PRICE IS FOR LABOUR ONLY - INSTALL TILE AT A 45 DEGREE ANGLE FOYER 16Apr18 Note:	
1 - TILE - UPGRADE 1 FLOOR TILE - - ENSUITE BATHROOM - FLOOR 16Apr18 Note:	
1 - TILE - UPGRADE 1 FLOOR TILE - - MAIN BATHROOM FLOOR 16Apr18 Note:	
1 - DELETE ALL CERAMIC BATHROOM ACCESSORIES - DELETE TOWEL BAR, PAPER HOLDER & SOAP DISH THROUGHOUT 16Apr18 Note:	
1 - TILE - UPGRADE 1 FLOOR TILE - - SIDE ENTRANCE 16Apr18 Note:	
1 - TILE - UPGRADE 1 FLOOR TILE - - POWDER ROOM 16Apr18 Note:	
1 - TILE - UPGRADE 1 FLOOR TILE - - KITCHEN 16Apr18 Note:	
1 - TILE - UPGRADE 1 FLOOR TILE - - FOYER 16Apr18 Note:	

COUNTER TOP

1 - HARD SURFACE COUNTERTOP - ENSUITE 16Apr18 Note:	
1 - HARD SURFACE COUNTERTOP - MAIN BATHROOM 16Apr18 Note:	
1 - HARD SURFACE COUNTERTOP - POWDER ROOM 16Apr18 Note:	

RECEIVED APR 17 2018

CONSTRUCTION SUMMARY

Saddle Ridge (G) - Lecco Ridge Developments Inc.

PURCHASERS: SAFWAT SALIB SADEK and GEHANE KAMAL SOBHI

TEL:

LOT / PHASE Block 331 TH 1 / 1	REG. PLAN # 20M-1184	HOUSE TYPE Ivy 11 Elev 2		
-----------------------------------	-------------------------	-----------------------------	--	--

1 - HARD SURFACE COUNTERTOP - KITCHEN
16Apr18 Note:

DOORS AND TRIM

1 - DOOR HANDLES - PRIVACY LOCK IN LIEU OF PASSAGE
16Apr18 Note: MASTER BEDROOM

ELECTRICAL

1 - PLUG - ELECTRICAL PLUG - TO BE INSTALLED OVER STOVE FOR FUTURE MICROWAVE/HOOD FAN
16Apr18 Note:

1 - RELOCATE STANDARD KITCHEN LIGHT TO BE CENTERED OVER ISLAND
07Feb18 Note:

1 - POT LIGHT - EXTERIOR - SOFFIT MOUNT - REGULAR VOLTAGE
07Feb18 Note:

See Additional sketch attached

RECEIVED APR 24 2018

1 - LIGHT - EXTERIOR WITH INTERIOR SWITCH
07Feb18 Note:

See Additional sketch attached

RECEIVED APR 24 2018

1 - PLUG - ELECTRICAL PLUG
07Feb18 Note:

FAMILY ROOM - 5' FROM FLOOR FOR FUTURE TV

1 - PLUG - ELECTRICAL PLUG WITH GFI AND SWITCH - FOR FESTIVE LIGHTING
07Feb18 Note:

See additional sketch attached.

RECEIVED APR 24 2018

1 - 200 AMP ELECTRICAL SERVICE
07Feb18 Note:

HARDWOOD FLOORING

1 - HARDWOOD - PROMO SERIES 4 7/16 INCH - - UPPER HALL
16Apr18 Note:

1 - HARDWOOD - PROMO SERIES 4 7/16 INCH - - FIRST FLOOR COMPLETE
16Apr18 Note:

MISCELLANEOUS

1 - FURTHER DISCOUNT AS PER VENDOR
16Apr18 Note:

PLUMBING

1 - ALL BATHROOMS - INSTALL VANITY PLUMBING FROM WALL IN LIEU OF STANDARD INSTALLATION FROM FLOOR
16Apr18 Note: ***IF CONSTRUCTION PERMITS***

2 - SINK - UNDERMOUNT SINK - CONTRAC EMERY #4220CGY
16Apr18 Note: POWDER ROOM & MAIN BATHROOM

1 - SINK - UNDERMOUNT SINK - CONTRAC CATENA #4210CIY
16Apr18 Note: MASTER ENSUITE BATHROOM

1 - SINK - UNDERMOUNT SINK - BLANCO HORIZON U2 8" #401234
16Apr18 Note:

1 - WATER LINE FOR FRIDGE - ROUGH-IN ONLY
16Apr18 Note:

1 - MASTER ENSUITE BATHROOM - VIERA TOILET - #4792BOV/4791BOVU
16Apr18 Note:

RECEIVED APR 17 2018

CONSTRUCTION SUMMARY

Saddle Ridge (G) - Lecco Ridge Developments Inc.

PURCHASERS: SAFWAT SALIB SADEK and GEHANE KAMAL SOBHI

TEL:

LOT / PHASE	REG. PLAN #	HOUSE TYPE		
Block 331 TH 1 / 1	20M-1184	Ivy 11 Elev 2		
1 - 5 FOOT SHOWER WITH SLIDING GLASS CHROME DOORS IN LIEU OF TUB 07Feb18 Note:				
1 - WASHROOM - 3 PIECE ROUGH-IN IN BASEMENT 06Apr17 Note:				

PROMOTIONAL

1 - LESS BALANCE OF CREDIT FROM PURCHASER EXTRA SHEET IN OFFER 16Apr18 Note:	
1 - LESS BALANCE OF CREDIT FROM PURCHASER EXTRA SHEET IN OFFER 07Feb18 Note: balance \$4360.00 less \$3595 new balance \$765.00	
1 - PARTIAL REDEMPTION OF PROMOTIONAL PACKAGE \$\$\$\$\$\$ BALANCE FORWARD TO BE USED AT A LATER DATE. ORIGINAL PROMOTIONAL PACKAGE OF \$\$\$\$ AS PER SCHEDULE PE DATED MMDDYYYY. 06Apr17 Note:	

STAIRS AND RAILINGS

1 - STAINED HANDRAIL, TREADS, RISERS AND STRINGER EXCLUDING PICKETS (FOR IRON PICKETS) - STANDARD STAIRCASE - PRICE IS PER SET 16Apr18 Note:	
1 - EUROLINE 1 16Apr18 Note: STAIRCASE - IRON PICKETS BLACK	

EXTRAS AS PER OFFER

Five (5) White Appliances as per PE Appliances Worksheet Note:	
The Vendor agrees that notwithstanding any other term or provision in this Agreement included in the Purchase Price and in addition to those items detailed in Schedule GP to the Agreement of Purchase and Sale, the Purchaser is entitled to a credit of Fiv Worksheet Note:	
The Purchaser acknowledges that the Purchase Price is inclusive of all credits and promotional packages available at the time of purchase. Worksheet Note:	
Lot Premium Worksheet Note:	

This Document is Extremely Time Sensitive - Printed 16 Apr 18 at 16:29

Purchasers:SAFWAT SALIB SADEK & GEHANE KAMAL SOI

Property:Block 331 TH 1

Telephone Res. / Bus: /

Project:Lecco Ridge Developments Inc.

Decor Advisor:Candace Forza

Model and Elevation:Ivy 11 Elev 2

Lock Date:16-Apr-18

16-Apr-18

Plan #:20M-1184

Layout Changes:☐ Yes☒ No

Sketch Attached:☒ Yes☐ No

Exterior Colour Scheme:

1. Cabinetry

	Style and Colour	Hardware
Kitchen / Breakfast	HASTING CHOCOLATE	2002
Laundry Room	ELISSE	Standard
Powder Room	LEGACY L662XZ4	2002
Master Ensuite Bathroom	EVEREST WHITE	2002
Main Bathroom	EVEREST WHITE	2002
	N/A	N/A
	N/A	N/A
	N/A	N/A
	N/A	N/A

Appliances:

Built In Appliances☐ Yes☒ No

Slide In Stove☒ Yes☐ No

Dishwasher Cabinet

☐ Closed☒ Open

41" Upper Cabinets☒ Yes☐ No

Please NOTE: Standard Cabinet Height is 30"

Stove Opening

NOTE: If not specified, opening will be set to builder's standard opening of approximately 30" width

Fridge Opening

NOTE: If not specified, opening will be set to builder's standard opening of approximately 37" width x 74" height

** Refer to Construction Summary

2. Counters

	Counter	Edge
Kitchen / Breakfast	QUARTZITE-DOLCE VITA	#320 PENCIL ROUND EDGE
Laundry Room	N/A	
Powder Room	GRANITE-TITANIUM BLACK	#320 PENCIL ROUND EDGE
Master Ensuite Bathroom	MARBLE-EMPERADOR DARK	#320 PENCIL ROUND EDGE
Main Bathroom	QUARTZ-BOTTICINO CREMATO	#320 PENCIL ROUND EDGE
	N/A	
	N/A	
	N/A	
	N/A	

** Refer to Construction Summary

Initials: SF GS

Purchasers:	SAFWAT SALIB SADEK & GEHANE KAMAL SOI		Property:	Block 331 TH 1
Telephone Res. / Bus:	/		Project:	Lecco Ridge Developments Inc.
Decor Advisor:	Candace Forza		Model and Elevation:	Ivy 11 Elev 2
Lock Date:	16-Apr-18	16-Apr-18	Plan #:	20M-1184

3. Ceramic Flooring

		At a 45	Threshold-If App.
Entrance Vestibule	TILE-FM45GL003S GLOSSY BEIGE-18X18	<input checked="" type="checkbox"/>	METAL STRIP
Main Hall	STRIP	<input type="checkbox"/>	
Kitchen / Breakfast	TILE-FM45GL003S GLOSSY BEIGE-18X18	<input type="checkbox"/>	METAL STRIP
Laundry Room	TILE-BEACHES IVORY-13X13	<input type="checkbox"/>	METAL STRIP
Powder Room	TILE-FM45GL003S GLOSSY BEIGE-18X18	<input type="checkbox"/>	
Master Ensuite Bathroom	TILE-FM45GL003S GLOSSY BEIGE-18X18	<input type="checkbox"/>	METAL STRIP
Main Bathroom	TILE-FM45GL003S GLOSSY BEIGE-18X18	<input type="checkbox"/>	METAL STRIP
GARAGE ENTRY	TILE-FM45GL003S GLOSSY BEIGE-18X18	<input type="checkbox"/>	
	N/A	<input type="checkbox"/>	
	N/A	<input type="checkbox"/>	
	N/A	<input type="checkbox"/>	

** Refer to Construction Summary

4. Ceramic Wall Tile

Master Ensuite Bathroom	Selection	Describe
Tub Deck Wall	TILE-EXPORT BEIGE-8X10	***LAID HORIZONTALLY***
Tub Deck	N/A	
Tub Deck Skirt	N/A	
Shower Stall	TILE-EXPORT BEIGE-8X10	***LAID HORIZONTALLY***
Bathtub Enclosure Walls	N/A	
	N/A	
Main Bathroom	TILE-EXPORT BEIGE-8X10	***LAID HORIZONTALLY***
	N/A	
	N/A	
	N/A	
Kitchen Backsplash	N/A	

**** Refer to Construction Summary - STANDARD GROUT THROUGHOUT UNLESS SPECIFIED**

5. Plumbing Fixtures

All Bathrooms	White	Whirlpool
N/A		N/A <input type="radio"/> Yes <input checked="" type="radio"/> No
N/A		
N/A		Dishwasher Rough-In <input checked="" type="radio"/> Yes <input type="radio"/> No
N/A		Waterline for Fridge <input checked="" type="radio"/> Yes <input type="radio"/> No
N/A		

**** Refer to Construction Summary**

6. Trim Carpentry

Interior Doors	CLASSIQUE
Interior Trim	2 3/4" CASING WITH 4 1/4" BASEBOARD - COLONIAL
Door Handles	As Per Construction Specifications
Exterior Front Door Handle	As Per Construction Specifications

**** Refer to Construction Summary**

Initials:

5F

GS

Purchasers: SAFWAT SALIB SADEK & GEHANE KAMAL SOI
Telephone Res. / Bus: /
Decor Advisor: Candace Forza
Lock Date: 16-Apr-18
Property: Block 331 TH 1
Project: Lecco Ridge Developments Inc.
Model and Elevation: Ivy 11 Elev 2
Plan #: 20M-1184

7. Other Flooring

Main Hall	STRIP-MIRAGE-ALIVE-RED OAK-CASHMERE-KNOWLTON-4 7/16"	
Living Room	N/A	
Dining Room	STRIP-MIRAGE-ALIVE-RED OAK-CASHMERE-KNOWLTON-4 7/16"	
Family Room	STRIP-MIRAGE-ALIVE-RED OAK-CASHMERE-KNOWLTON-4 7/16"	
Den / Library / Study	STRIP-MIRAGE-ALIVE-RED OAK-CASHMERE-KNOWLTON-4 7/16"	
Basement Landing(If Applies)	N/A	
Lower Landing (If Applies)	STRIP-MIRAGE-ALIVE-RED OAK-CASHMERE-KNOWLTON-4 7/16"	
Upper Landing	STRIP-MIRAGE-ALIVE-RED OAK-CASHMERE-KNOWLTON-4 7/16"	
Upper Hall	STRIP-MIRAGE-ALIVE-RED OAK-CASHMERE-KNOWLTON-4 7/16"	
Master Bedroom	CARPET-SHAW - E0949 NEWBERN CLASSIC - DOVE 55700	
Bedroom #2	CARPET-SHAW - E0949 NEWBERN CLASSIC - DOVE 55700	
Bedroom #3	CARPET-SHAW - E0949 NEWBERN CLASSIC - DOVE 55700	
Bedroom #4	CARPET-SHAW - E0949 NEWBERN CLASSIC - DOVE 55700	
Bedroom #5	N/A	
	N/A	
	N/A	
	N/A	
Underpad	Type	Area
	STANDARD	BEDROOMS ONLY

**** Refer to Construction Summary****8. Railings and Pickets**

Railing Type	As Per Construction Specifications	Colour	MIRAGE KNOWLTON
Picket Type	EUROLINE 1	Colour	BLACK
Stringer / Riser	As Per Construction Specifications	Colour	MIRAGE KNOWLTON
Treads	As Per Construction Specifications	Colour	MIRAGE KNOWLTON
Red Oak Stairs with Semi Gloss Finish		<input checked="" type="radio"/> Yes <input type="radio"/> No	

**** Refer to Construction Summary****9. Wall Paint Flat Finish**

Main & Upper Hall	25 OYSTER	Master Bedroom	25 OYSTER
Living Room	N/A	Bedroom #2	25 OYSTER
Dining Room	25 OYSTER	Bedroom #3	25 OYSTER
Kitchen / Breakfast	25 OYSTER	Bedroom #4	25 OYSTER
Family Room	25 OYSTER	Bedroom #5	N/A
Powder Room	25 OYSTER	Master Ensuite	25 OYSTER
Laundry Room	25 OYSTER	Main Bathroom	25 OYSTER
Den/Library	25 OYSTER	GARAGE ENTRY	25 OYSTER
Trim Paint-Semi Gloss	BIRCH WHITE		N/A
	N/A		N/A
	N/A		N/A

Smooth Ceilings First Floor ☐ Yes ☒ No**** Refer to Construction Summary**

Initials:

SF

GS

Purchasers: SAFWAT SALIB SADEK & GEHANE KAMAL SOI **Property:** Block 331 TH 1
Telephone Res. / Bus: / **Project:** Lecco Ridge Developments Inc.
Decor Advisor: Candace Forza **Model and Elevation:** Ivy 11 Elev 2
Lock Date: 16-Apr-18 16-Apr-18 **Plan #:** 20M-1184

10. Plaster Mouldings and Medallions

Entrance Vestibule	N/A	N/A	Kitchen/Breakfast	N/A	N/A
Main Hall	N/A	N/A	Den/Library	N/A	N/A
Living Room	N/A	N/A	Lower Landing	N/A	N/A
Dining Room	N/A	N/A		N/A	N/A
Family Room	N/A	N/A		N/A	N/A

** Refer to Construction Summary

11. Fireplace

	Living Room			Family Room			Other Room - Specify		
	Purchased	As Per Plan	N/A	Purchased	As Per Plan	N/A	Purchased	As Per Plan	N/A
Fireplace Type	<input type="radio"/>	<input type="radio"/>	<input checked="" type="radio"/>	<input type="radio"/>	<input type="radio"/>	<input checked="" type="radio"/>	<input type="radio"/>	<input type="radio"/>	<input checked="" type="radio"/>
Mantle Type	N/A			N/A			N/A		
Colour / Stain	N/A			N/A			N/A		
Surround	N/A			N/A			N/A		
Hearth	N/A			N/A			N/A		

** Refer to Construction Summary

12. Heating and Air Conditioning

Air Conditioning	NO	Gas Provisions Stove	NO
Gas Provisions Dryer	NO	Gas Provisions Barbecue	NO
Comment			

** Refer to Construction Summary

13. Electrical

Plugs and Switches	<input checked="" type="radio"/> White	DECOR	Above Kitchen Cabinet Light	<input type="radio"/> Yes	<input checked="" type="radio"/> No
Hood Fan	STANDARD WHITE		Below Kitchen Cabinet Light	<input type="radio"/> Yes	<input checked="" type="radio"/> No
Appliances	Built in Cooktop	Built in Oven	Gas Stove	<input type="radio"/> Yes	<input checked="" type="radio"/> No
	<input type="radio"/> Yes <input checked="" type="radio"/> No	<input type="radio"/> Yes <input checked="" type="radio"/> No	Microwave	<input checked="" type="radio"/> Yes	<input type="radio"/> No
Dishwasher Rough-in	Yes				

KITCHEN - PLUG ABOVE STOVE FOR FUTURE MICRO/HOOD COMBO



** Refer to Construction Summary

14. General Comments

** Refer to Construction Summary

Disclaimers and Notes

- Colours of all materials are as close as possible to builder's selection, but not necessarily identical due to variances in manufacturing.
- Any extras listed above are null and void unless accompanied by a separate invoice/amendment. Said invoice must be paid in full.
- The Purchaser agrees that this colour selection is final and that no changes will be permitted, unless required by the Vendor.
- The Purchaser acknowledges reading and accepting document which contains other miscellaneous disclaimers.

Signature:  Date: April 16, 2018
 Signature:  Date: April 16th 2018

- Light Variance.

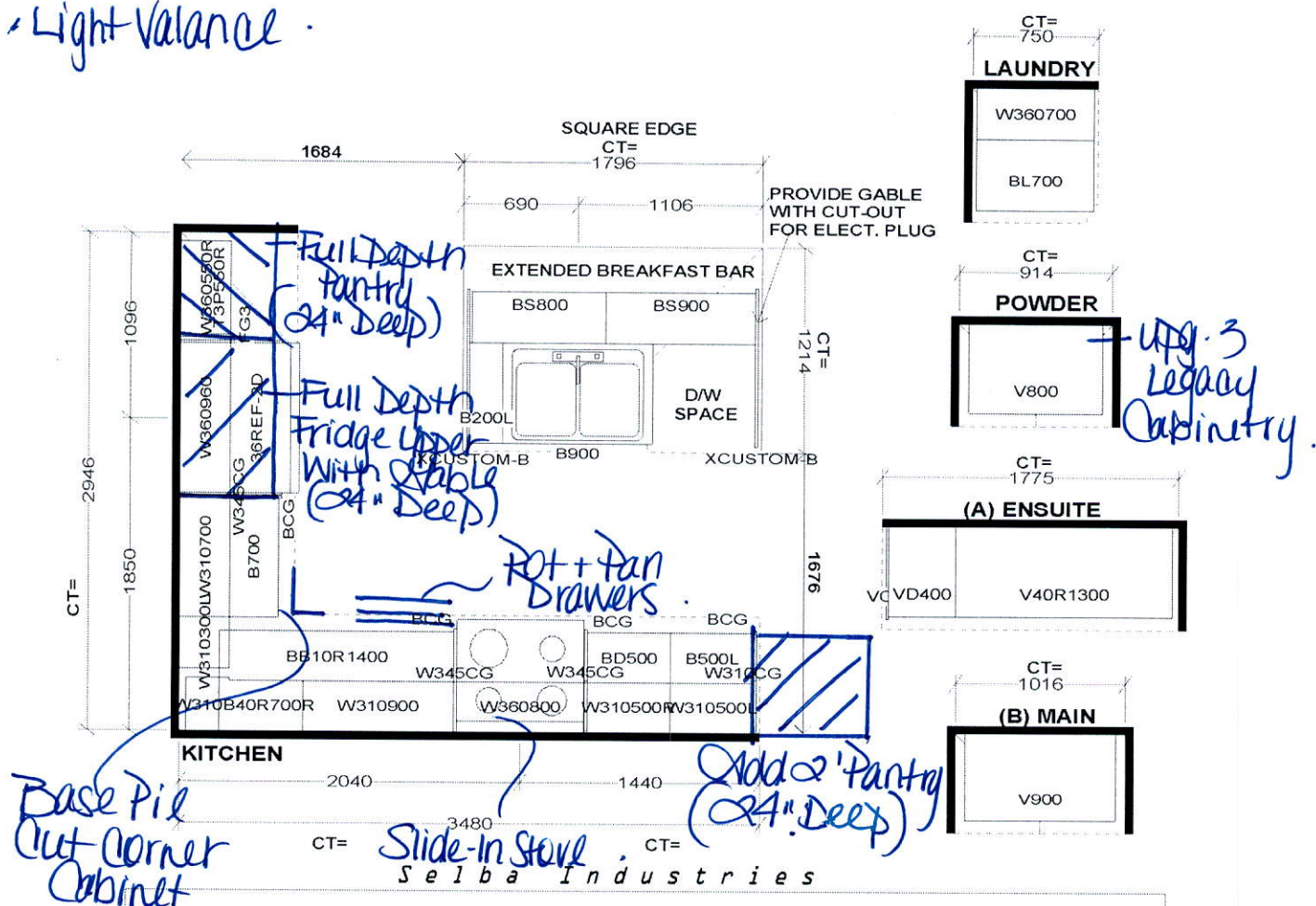

*This drawing is the intellectual property of
SELBA INDUSTRIES INC. and is an
original design which must not be released
or copied unless applicable fee has been
paid or job order placed.*

JOB NUMBER:
BUILDER: GREENPARK HOMES
SITE NAME: LECCO RIDGE, Milton
MODEL: IVY 11X ELEV 1,2,3
LOT #:
DESIGNER: KS
DATE: FEB 13 17

SF

GS

WY 11 2,259 SQ.FT.

Pot Light - Exterior

Additional Exterior Light
with interior switch —

Festive Lighting
Plug.

Relocate standard kitchen
Light to be centered over island

BLK 33
TH 1

A hand-drawn floor plan of a kitchen island. The island is rectangular and filled with a grid pattern. A central light fixture is indicated by a circle with a crosshair. The island is labeled 'KITCHEN ISLAND' in the center. To the right of the island, there is a red curved line and the text 'BLK 33' and 'TH 1'. Above the island, there is handwritten text in red: 'Relocate standard kitchen' and 'Light to be centered over island'.

Ada Plug
Above
Stove For
Future
micro/Hood
Combo.

Copyright © 2011 Pearson Education, Inc. All rights reserved. This publication is protected by copyright. Any unauthorized distribution or reproduction of this work is prohibited. All rights reserved. Printed in the United States of America. This book is printed on acid-free paper. 10 9 8 7 6 5 4 3 2 1

SF

GS

Safwat
Feb. 07, 2018

BLK 331
LECCO RIDGE

IVY 11
ELEV. 2

NOTES:

1. STANDARD FLANKAGE
ELEVATION NOT SHOWN ON
BROCHURE

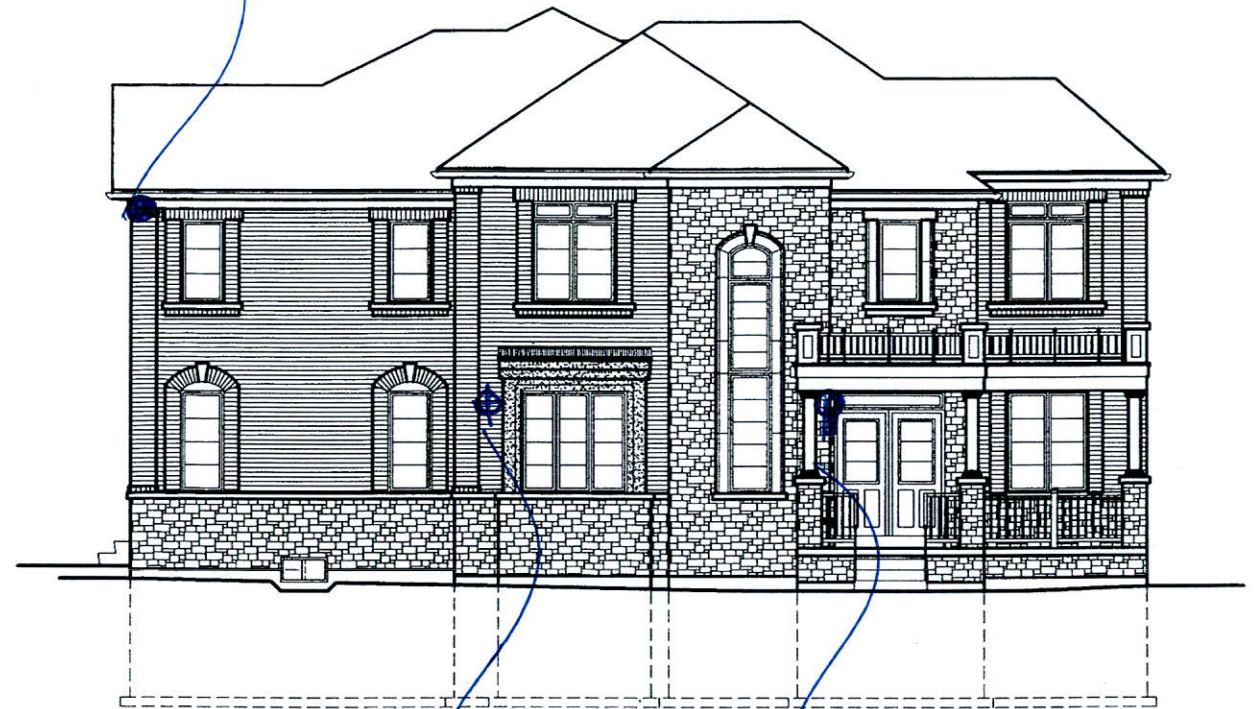

331-1 IVY-11
ELEV. '2'

LEFT SIDE ELEVATION

DISCLAIMERS: SKETCH NOT TO SCALE. DIMENSIONS, SPECIFICATIONS AND ARCHITECTURAL DETAILS SUBJECT TO MODIFICATION BY THE VENDOR. SKETCH IS ONLY FOR THE PURPOSE OF ILLUSTRATING REVISIONS REQUESTED BY THE PURCHASER AND ALL REVISIONS ARE SUBJECT TO VENDOR'S FINAL APPROVAL. ONLY REVISIONS ACCEPTED IN WRITING BY THE PURCHASER AND VENDOR ON A PURCHASER'S EXTRA SHEET WILL BE INCORPORATED INTO THE PLANS FILED WITH THE MUNICIPALITY. E. & O.E.

REGION DESIGN NO.	SCALE		N.T.S.
	BY MB	PAGE No. 1 OF 1	



RECEIVED APR 24 2018

CHECKING THE INSTALLATION SITE

Clearances and dimensions

To install the range, refer to the following figure.

CAUTION This range has been designed to comply with the maximum allowable wood cabinet temperatures of 194 °F. Make sure the wall covering, countertops, and cabinets around the range can withstand the heat (up to 194 °F) generated by the range. If not, discoloration, delamination, or melting may occur.

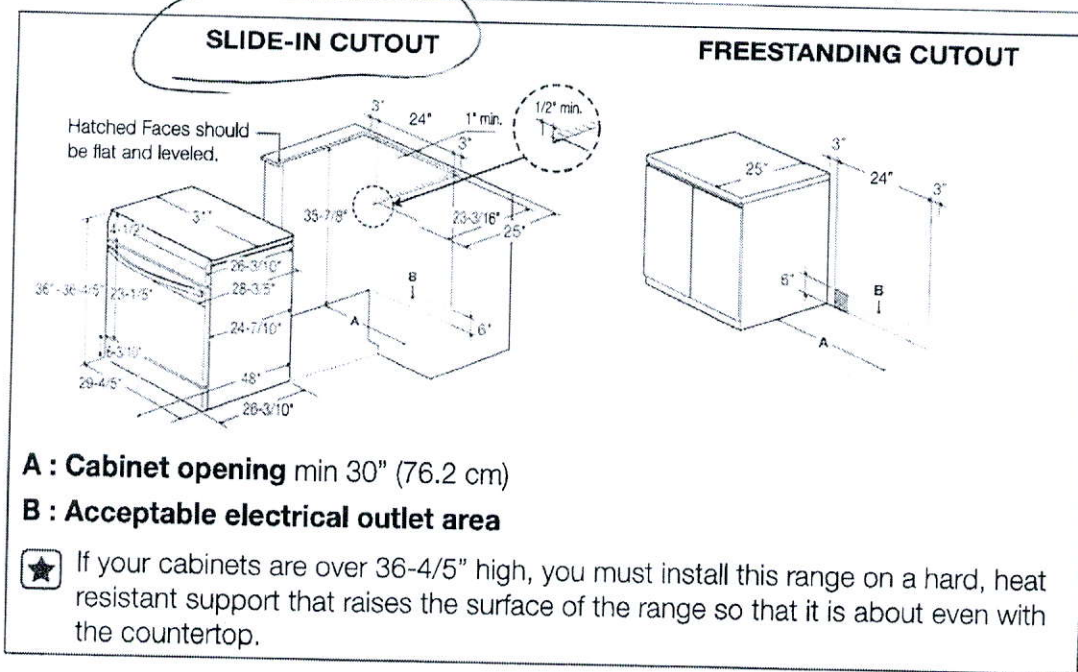

CAUTION You must use the rear filler kit to install the range in a freestanding cutout cabinet. For more information, see "Optional rear filler kit" as shown below.

Optional rear filler kit

Used to fill gap between the range back and wall. Adds a filler strip to the rear of the range. This kit can only be used when the opening in the countertop is 25" deep.

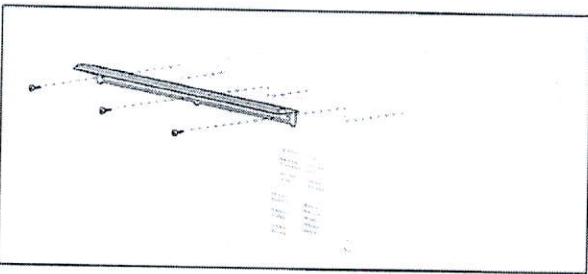

✍ If the countertop depth is greater than 25", there will be a gap between the filler kit and the back wall.

01 PREPARING TO INSTALL THE RANGE

Minimum dimensions

★ IMPORTANT To eliminate the risk of burns or fire caused by reaching over heated surface units, avoid having cabinet storage space located above the surface units. If you have cabinet storage space over the heating elements, you can reduce the risk by installing a range hood that projects horizontally a minimum of 5 inches beyond the bottom of the cabinets.

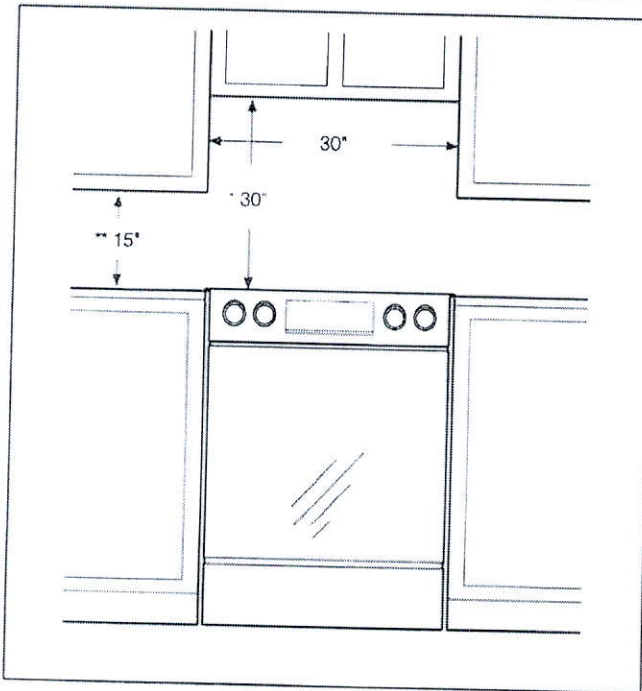

- * A minimum of 30" is required between the top of the cooking surface and the bottom of an unprotected wood or metal cabinet; a minimum of 24" is required if the bottom of the wood or metal cabinet is protected by not less than 1/4" of flame retardant millboard covered with not less than no.28 MSG of sheet steel, 0.015" of stainless steel, 0.024" of aluminum, or 0.020" of copper.
- ** A minimum of 15" is required between the countertop and the adjacent cabinet bottom.

connecting the power

STEP 1. MEETING ELECTRICAL CONNECTION REQUIREMENTS



CAUTION For personal safety, do not use an extension cord with this appliance. Remove the house fuse or open the circuit breaker before beginning installation.

This appliance must be supplied with the proper voltage and frequency, and be connected to an individual, properly grounded branch circuit, protected by a circuit breaker or fuse having amperage as specified on the rating plate. The rating plate is located above the drawer on the oven frame. (Fig. 1 or Fig. 2)

We recommend you have the electrical wiring and hookup of your range connected by a qualified electrician. After installation, have the electrician show you where your main range disconnect is located.

Check with your local utilities for electrical codes which apply in your area. Failure to wire your oven according to governing codes could result in a hazardous condition. If there are no local codes, your range must be wired and fused to meet the requirements of the National Electrical Code, ANSI/NFPA No. 70-Latest Edition. You can get a copy by writing:

National Fire Protection Association
Batterymarch Park
Quincy, MA 02269



(Fig. 1)

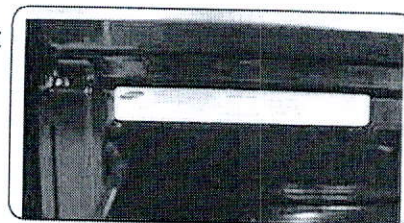

(Fig. 2)

Effective January 1, 1996, the National Electrical Code requires that new construction (not existing) utilize a 4-conductor connection to an electric range.

When installing an electric range in new construction, follow Steps 2 and 3 for a 4-wire connection.

You must use a 3-wire or 4-wire, single-phase A.C. 208Y/120 Volt or 240/120 Volt, 60 hertz electrical system.

If the electrical service provided does not meet the above specifications, have a licensed electrician install an approved outlet.

Use only a 3-conductor or a 4-conductor UL-listed range cord. These cords may be provided with ring terminals on the wire and a strain relief device.

A range cord rated at 40 amps with 125/250 minimum volt range is required. A 50 amp range cord is not recommended but if used, it should be marked for use with nominal 1 3/8" diameter connection openings. Care should be taken to center the cable and strain relief within the knockout hole to keep the edge from damaging the cable.

- Because range terminals are not accessible after the range is in position, a flexible service conduit or cord must be used.

NOTE If conduit is being used, go to Step 4 on page 12.



ALL NEW BRANCH-CIRCUIT CONSTRUCTIONS, MOBILE HOMES, RECREATIONAL VEHICLES, AND INSTALLATIONS WHERE LOCAL CODES DO NOT ALLOW GROUNDING THROUGH NEUTRAL, REQUIRE A 4-CONDUCTOR UL-LISTED RANGE CORD.

STEP 2. ACCESSING THE POWER CORD CONNECTION

Loosen and then remove the rear access cover screw with a screwdriver. Remove the rear access cover by lifting it up and then out. The terminal block will then be accessible.

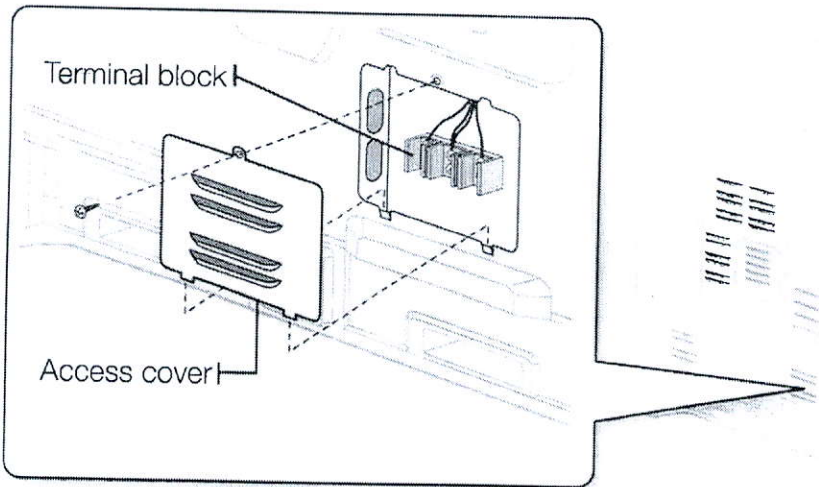

Specified power-supply-cord kit rating

Range rating, watts		Specified rating of power-supply-cord kit, amperes	Diameter (inches) of range connection opening	
120/240 volts 3-wire	120/208 volts 3-wire		Power cord	Conduit
8750 - 16500	7801 - 12500	40 or 50 A	1 3/8"	1 1/8"

For power cord installations, go to page 10. For conduit installations, go to page 12.

STEP 3. INSTALLING THE POWER CORD

For power cord installations, hook the strain relief over the power cord hole (1 $\frac{3}{8}$ ") located below the rear of the drawer body. Insert the power cord through the strain relief and tighten the device.

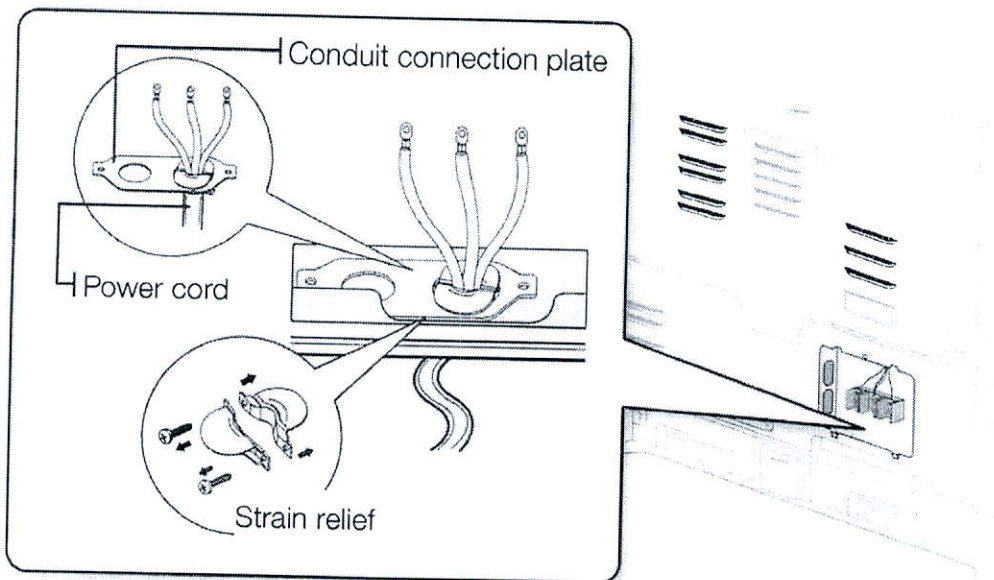

- You must install the power cord with a strain relief.
- Attach the strain relief to the 1 $\frac{3}{8}$ " opening in the conduit connection plate.

Installing a 3-wire power cord



WARNING

WARNING The neutral or ground wire of the power cord must be connected to the neutral terminal located in the center of the terminal block. The power leads must be connected to the lower left and the lower right terminals of the terminal block.

1. Remove the 3 lower terminal screws from the terminal block.
2. Insert the 3 terminal screws through each power cord terminal ring and into the lower terminals of the terminal block. Be certain that the center wire (white/neutral) is connected to the center lower position of the terminal block.
3. Tighten screws securely to the terminal block. **DO NOT remove the ground strap connection.**
4. Go to **Step 5** on page 15 to continue with the installation.

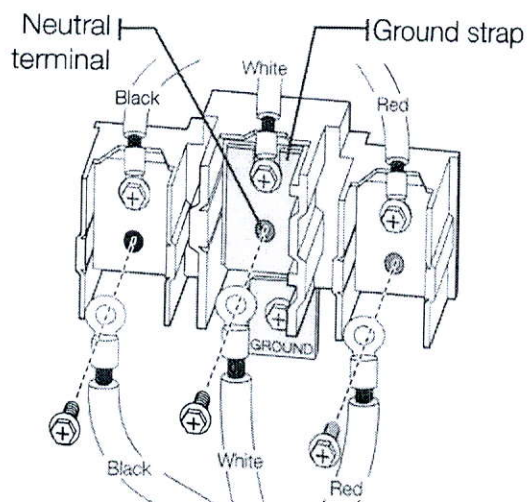

English - 10