



CONSTRUCTION SUMMARY

Saddle Ridge (G) - Lecco Ridge Developments Inc.

PURCHASERS: AMARENDER REDDY ARUTLA and MAHESHWARI ARUTLA // VENKAT ARUTLA

TEL: RES.: 416-722-9485

LOT / PHASE	REG. PLAN #	HOUSE TYPE		
Block 326 TH 2 / 1	20M-1184	Ivy 4 Elev 3		

CABINETRY

1 - KITCHEN - MONACO CABINETRY WITH UPGRADE STAIN 25Apr18 Note:	
--	--

CERAMIC TILE

1 - DELETE ALL CERAMIC BATHROOM ACCESSORIES - DELETE TOWEL BAR, PAPER HOLDER & SOAP DISH THROUGHOUT 25Apr18 Note:	
--	--

HARDWOOD FLOORING

1 - LAMINATE - PARK LANE SERIES - - UPPER HALL 25Apr18 Note:	
---	--

PLUMBING

3 - MOEN BATHROOM ACCESSORIES - MASON CHROME - TOWEL BAR 24" #YB8094/YB8000 - PRICE IS EACH 25Apr18 Note: ALL BATHROOMS	
3 - MOEN BATHROOM ACCESSORIES - MASON CHROME - PAPER HOLDER #YB8099/YB8000 - PRICE IS EACH 25Apr18 Note: ALL BATHROOMS	
2 - TOE TESTER - ADD TOE TESTER TO SHOWER 14Mar18 Note: main and master ensuite shower add toe testers	
1 - 5 FOOT SHOWER WITH SLIDING GLASS CHROME DOORS IN LIEU OF TUB 14Mar18 Note: main bath ---	
1 - WASHROOM - 3 PIECE ROUGH-IN IN BASEMENT 09Mar17 Note:	

PROMOTIONAL

1 - LESS BALANCE OF CREDIT FROM PURCHASER EXTRA SHEET IN OFFER 25Apr18 Note:	
1 - PARTIAL REDEMPTION OF PROMOTIONAL PACKAGE \$\$\$\$\$\$ BALANCE FORWARD TO BE USED AT A LATER DATE. ORIGINAL PROMOTIONAL PACKAGE OF \$\$\$\$\$\$ AS PER SCHEDULE PE DATED MMMDDYYYY. 14Mar18 Note: BALANCE \$2260.00 TO BE USED AT A FURTHER DATE	
1 - PARTIAL REDEMPTION OF PROMOTIONAL PACKAGE \$640.00 BALANCE (\$4,360.00) FORWARD TO BE USED AT A LATER DATE. ORIGINAL PROMOTIONAL PACKAGE OF \$5,000.00 AS PER SCHEDULE PE. 09Mar17 Note:	

EXTRAS AS PER OFFER

The Vendor agrees that notwithstanding any other term or provision in this Agreement included in the Purchase Price and in addition to those items detailed in Schedule GP to the Agreement of Purchase and Sale, the Purchaser is entitled to a credit of Five (5) White Appliances as per PE Appliances Worksheet Note:	
The Purchaser acknowledges that the Purchase Price is inclusive of all credits and promotional packages available at the time of purchase. Worksheet Note:	
Complete Central Air Conditioning Worksheet Note:	

Purchasers:

Telephone Res. / Bus:

Decor Advisor:

Lock Date:

Layout Changes:

AMARENDER REDDY ARUTLA & MAHESHWAR

(416) 722-9485 /

Candace Forza

25-Apr-18

☐ Yes ☒ No

Property:

Project:

Model and Elevation:

Plan #:

Exterior Colour Scheme:

Block 326 TH 2

Lecco Ridge Developments Inc.

Ivy 4 Elev 3

20M-1184

Sketch Attached:

Yes ☒ No ☐

1. Cabinetry

	Style and Colour	Hardware
Kitchen / Breakfast	MONACO W823XZ4	2002
Laundry Room	ELISSE	Standard
Powder Room	MODENA WHITE	2004
Master Ensuite Bathroom	MODENA WHITE	2004
Main Bathroom	MODENA WHITE	2004
	N/A	N/A
	N/A	N/A
	N/A	N/A
	N/A	N/A
	N/A	N/A

Appliances:

Built In Appliances

Yes ☒ No ☐

Slide In Stove

Yes ☒ No ☐

Dishwasher Cabinet

☐ Closed ☒ Open

41" Upper Cabinets

☒ Yes ☐ No

Please NOTE: Standard Cabinet Height is 30"

Stove Opening

NOTE: If not specified, opening will be set to builder's standard opening of approximately 30" width

Fridge Opening

NOTE: If not specified, opening will be set to builder's standard opening of approximately 37" width x 74" height

\*\* Refer to Construction Summary

2. Counters

	Counter	Edge
Kitchen / Breakfast	LAMINATE-ARGENTO ROMANO 6697-46	
Laundry Room	N/A	
Powder Room	LAMINATE-INUK SHUK GREY P-344 LM	
Master Ensuite Bathroom	LAMINATE-INUK SHUK GREY P-344 LM	
Main Bathroom	LAMINATE-INUK SHUK GREY P-344 LM	
	N/A	
	N/A	
	N/A	
	N/A	

\*\* Refer to Construction Summary

Initials:

A.M.

V.A.



Purchasers:

Telephone Res. / Bus:

Decor Advisor:

Lock Date:

AMARENDER REDDY ARUTLA & MAHESHWAR

(416) 722-9485 /

Candace Forza

25-Apr-18

Property:

Project:

Model and Elevation:

Plan #:

Block 326 TH 2

Lecco Ridge Developments Inc.

Ivy 4 Elev 3

20M-1184

3. Ceramic Flooring

Entrance Vestibule	TILE-SIENA GREY-13X13	
Main Hall	LAMINATE	
Kitchen / Breakfast	TILE-SIENA GREY-13X13	
Laundry Room	TILE-BEACH LIGHT GREY-13X13	METAL STRIP
Powder Room	TILE-SIENA GREY-13X13	METAL STRIP
Master Ensuite Bathroom	TILE-BEACH LIGHT GREY-13X13	METAL STRIP
Main Bathroom	TILE-BEACH LIGHT GREY-13X13	METAL STRIP
GARAGE ENTRY	TILE-SIENA GREY-13X13	METAL STRIP
	N/A	
	N/A	
	N/A	

\*\* Refer to Construction Summary

4. Ceramic Wall Tile

Master Ensuite Bathroom	Selection	Describe
Tub Deck Wall	TILE-NATURALE GRIGIO-8X10	
Tub Deck	N/A	
Tub Deck Skirt	N/A	
Shower Stall	TILE-NATURALE GRIGIO-8X10	
Bathtub Enclosure Walls	N/A	
	N/A	
Main Bathroom	TILE-NATURALE GRIGIO-8X10	
	N/A	
	N/A	
	N/A	
Kitchen Backsplash	N/A	

\*\* Refer to Construction Summary - STANDARD GROUT THROUGHOUT UNLESS SPECIFIED

5. Plumbing Fixtures

All Bathrooms	White	Whirlpool	
	N/A		N/A Yes No
	N/A		
	N/A		
	N/A		Dishwasher Rough-In Yes No
	N/A		Waterline for Fridge Yes No

\*\* Refer to Construction Summary

6. Trim Carpentry

Interior Doors	CLASSIQUE
Interior Trim	2 3/4" CASING WITH 4 1/4" BASEBOARD - COLONIAL
Door Handles	As Per Construction Specifications
Exterior Front Door Handle	As Per Construction Specifications

\*\* Refer to Construction Summary

7. Other Flooring

Purchasers:

Telephone Res. / Bus:

Decor Advisor:

Lock Date:

AMARENDER REDDY ARUTLA & MAHESHWAR

(416) 722-9485 /

Candace Forza

25-Apr-18

Property:

Project:

Model and Elevation:

Plan #:

Block 326 TH 2

Lecco Ridge Developments Inc.

Ivy 4 Elev 3

20M-1184

7. Other Flooring

Main Hall	LAMINATE-MANHATTAN - EARL GREY OAK TL-15012	
Living Room	LAMINATE-MANHATTAN - EARL GREY OAK TL-15012	
Dining Room	LAMINATE-MANHATTAN - EARL GREY OAK TL-15012	
Family Room	LAMINATE-MANHATTAN - EARL GREY OAK TL-15012	
Den / Library / Study	N/A	
Basement Landing(If Applies)	N/A	
Lower Landing (If Applies)	N/A	
Upper Landing	LAMINATE-MANHATTAN - EARL GREY OAK TL-15012	
Upper Hall	LAMINATE-MANHATTAN - EARL GREY OAK TL-15012	
Master Bedroom	CARPET-SHAW - E0949 NEWBERN CLASSIC - ANTIQUE SILK 00131	
Bedroom #2	CARPET-SHAW - E0949 NEWBERN CLASSIC - ANTIQUE SILK 00131	
Bedroom #3	CARPET-SHAW - E0949 NEWBERN CLASSIC - ANTIQUE SILK 00131	
Bedroom #4	N/A	
Bedroom #5	N/A	
	N/A	
	N/A	
	N/A	
	N/A	
Underpad	Type	Area
	STANDARD	BEDROOMS ONLY

\*\* Refer to Construction Summary

8. Railings and Pickets

Railing Type	As Per Construction Specifications	Colour	TORLYS EARL GREY OAK
Picket Type	As Per Construction Specifications	Colour	TORLYS EARL GREY OAK
Stringer / Riser	As Per Construction Specifications	Colour	TORLYS EARL GREY OAK
Treads	As Per Construction Specifications	Colour	TORLYS EARL GREY OAK
Red Oak Stairs with Semi Gloss Finish			<input checked="" type="radio"/> Yes <input type="radio"/> No

\*\* Refer to Construction Summary

9. Wall Paint Flat Finish

Main & Upper Hall	22 WARM GREY	Master Bedroom	22 WARM GREY
Living Room	22 WARM GREY	Bedroom #2	22 WARM GREY
Dining Room	22 WARM GREY	Bedroom #3	22 WARM GREY
Kitchen / Breakfast	22 WARM GREY	Bedroom #4	N/A
Family Room	22 WARM GREY	Bedroom #5	N/A
Powder Room	22 WARM GREY	Master Ensuite	22 WARM GREY
Laundry Room	22 WARM GREY	Main Bathroom	22 WARM GREY
Den/Library	N/A		N/A
Trim Paint-Semi Gloss	BIRCH WHITE		N/A
	N/A		N/A
	N/A		N/A

Smooth Ceilings First Floor

Yes

☒ No

\*\* Refer to Construction Summary

Initials:

A.M.

V.A.



Purchasers:AMARENDER REDDY ARUTLA & MAHESHWAR

Telephone Res. / Bus: (416) 722-9485 /

Decor Advisor: Candace Forza

Lock Date: 25-Apr-18

Property: Block 326 TH 2

Project: Lecco Ridge Developments Inc.

Model and Elevation: Ivy 4 Elev 3

25-Apr-18

Plan #: 20M-1184

10. Plaster Mouldings and Medallions

Entrance Vestibule	N/A	N/A	Kitchen/Breakfast	N/A	N/A
Main Hall	N/A	N/A	Den/Library	N/A	N/A
Living Room	N/A	N/A	Lower Landing	N/A	N/A
Dining Room	N/A	N/A		N/A	N/A
Family Room	N/A	N/A			

\*\* Refer to Construction Summary

11. Fireplace

Living Room			Family Room			Other Room - Specify		
	Purchased	As Per Plan		Purchased	As Per Plan		Purchased	As Per Plan
Fireplace Type	N/A		N/A			N/A		
Mantle Type	N/A		N/A			N/A		
Colour / Stain	N/A		N/A			N/A		
Surround	N/A		N/A			N/A		
Hearth	N/A		N/A			N/A		

\*\* Refer to Construction Summary

12. Heating and Air Conditioning

Air Conditioning	YES		Gas Provisions Stove	NO
Gas Provisions Dryer	NO		Gas Provisions Barbecue	NO
Comment				

\*\* Refer to Construction Summary

13. Electrical

Plugs and Switches	White	DECOR	Above Kitchen Cabinet Light	Yes	No
Hood Fan	STANDARD WHITE		Below Kitchen Cabinet Light	Yes	No
Appliances	Built in Cooktop	Built in Oven	Gas Stove	Yes	No
	Yes	Yes	Microwave	Yes	No
Dishwasher Rough-in	Yes				

\*\* Refer to Construction Summary

14. General Comments

\*\* Refer to Construction Summary

Disclaimers and Notes

- 1) Colours of all materials are as close as possible to builder's selection, but not necessarily identical due to variances in manufacturing.
- 2) Any extras listed above are null and void unless accompanied by a separate invoice/amendment. Said invoice must be paid in full.
- 3) The Purchaser agrees that this colour selection is final and that no changes will be permitted, unless required by the Vendor.
- 4) The Purchaser acknowledges reading and accepting document which contains other miscellaneous disclaimers.

Signature: A Maheshwari

Date: 25 April 2018

Signature: Verma

Date: 25 April 2018

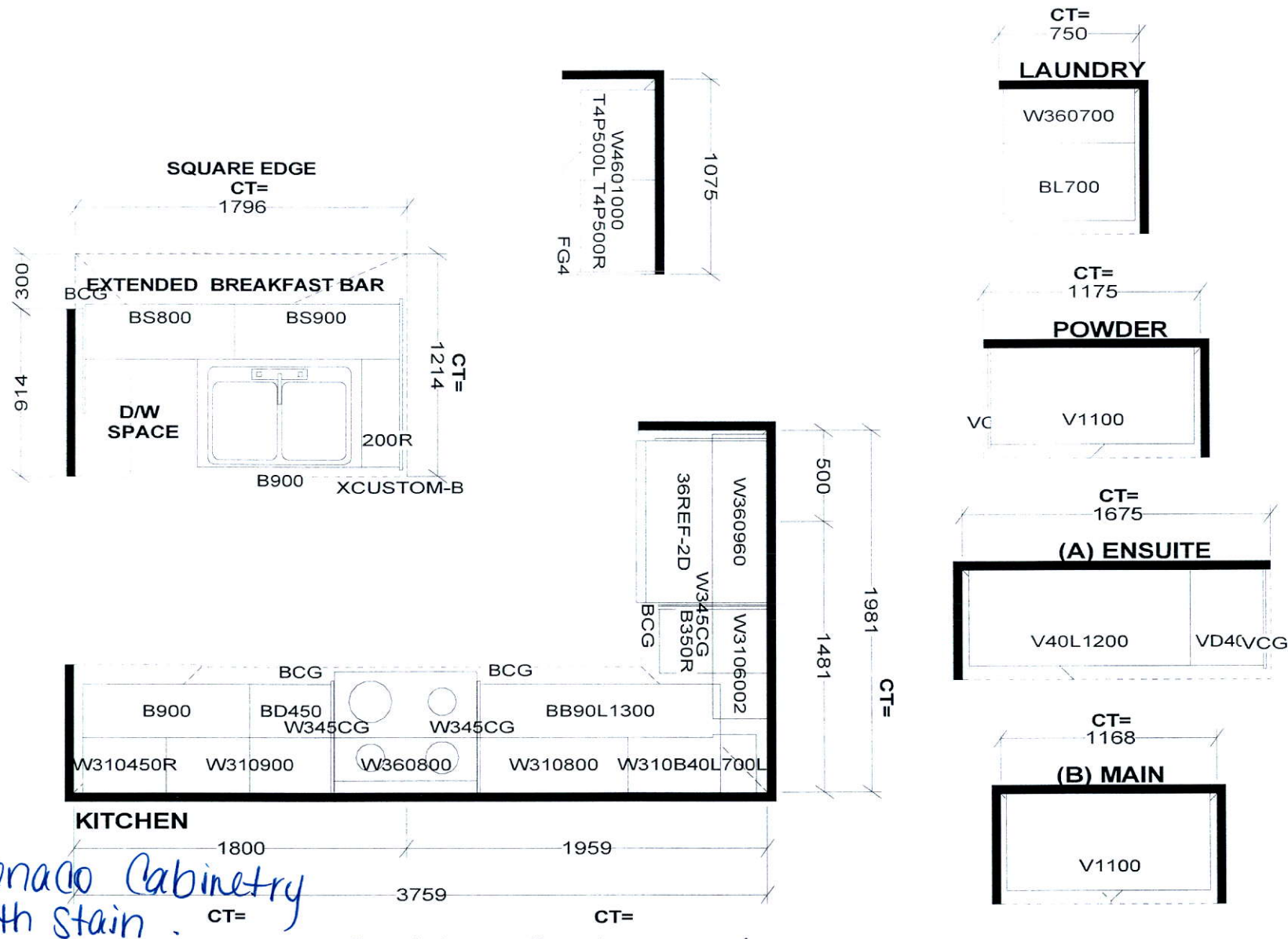

Monaco Cabinetry  
With Stain

Selba Industries

STANDARD FEATURES:

9' CEILINGS WITH D/C BOX  
1040MM HIGH UPPER CABINETS  
DISHWASHER SPACE  
DUMMY DOORS ON EXPOSED BACKS  
LAMINATE KITCHEN & VANITY COUNTERTOPS

This drawing is the intellectual property of SELBA INDUSTRIES INC. and is an original design which must not be released or copied unless applicable fee has been paid or job order placed.



JOB NUMBER:  
BUILDER: GREENPARK HOMES  
SITE NAME: LECCO RIDGE, Milton  
MODEL: IVY 4X ELEV 1, 1A, 2, 3  
LOT #:  
DESIGNER: KS  
DATE: FEB 13 17

A.M.

VA.



# IVY 4 1,846 SQ.FT.

AVAILABLE IN BLOCK: 323, 326, 327, 328, 330, 331, 333, 336, 337, 343, 344, 345, 346, 348 & 349

