



CONSTRUCTION SUMMARY

Saddle Ridge (G) - Lecco Ridge Developments Inc.

PURCHASERS: HANY BESTAOROUS and HANAN GHALY G GHALY

TEL:

LOT / PHASE Block 332 TH 1 / 1	REG. PLAN # 20M-1184	HOUSE TYPE Ivy 6E Elev 3		
-----------------------------------	-------------------------	-----------------------------	--	--

CABINETRY ACCESSORIES

1 - KITCHEN CABINETY BASE - POT/PAN DRAWERS (CABINET) - STANDARD 24Apr18 Note:	
1 - KITCHEN CABINETY UPPER - FULL DEPTH ABOVE FRIDGE - WITH GABLES - 600MM - PRICE IS EACH - STANDARD 24Apr18 Note:	
1 - KITCHEN CABINETY BASE - PIE CUT CORNER CABINET - BASE CABINETY - STANDARD 24Apr18 Note:	

CERAMIC TILE

1 - DELETE ALL CERAMIC BATHROOM ACCESSORIES - DELETE TOWEL BAR, PAPER HOLDER & SOAP DISH THROUGHOUT 24Apr18 Note:	
--	--

FIREPLACE AND ACCESSORIES

1 - GAS LINE ROUGH-IN FOR STOVE (INCLUDES ELECTRICAL OUTLET) - FIRST FLOOR 24Apr18 Note:	
---	--

MISCELLANEOUS

1 - FURTHER DISCOUNT AS PER VENDOR 24Apr18 Note:	
---	--

PLUMBING

3 - MOEN BATHROOM ACCESSORIES - MASON CHROME - TOWEL BAR 24" #YB8094/YB8000 - PRICE IS EACH 24Apr18 Note: ALL BATHROOMS	
3 - MOEN BATHROOM ACCESSORIES - MASON CHROME - PAPER HOLDER #YB8099/YB8000 - PRICE IS EACH 24Apr18 Note: ALL BATHROOMS	
1 - WASHROOM - 3 PIECE ROUGH-IN IN BASEMENT 31Mar17 Note:	

PROMOTIONAL

1 - LESS BALANCE OF CREDIT FROM PURCHASER EXTRA SHEET IN OFFER 24Apr18 Note:	
1 - PARTIAL REDEMPTION OF PROMOTIONAL PACKAGE \$\$\$\$\$\$ BALANCE FORWARD TO BE USED AT A LATER DATE. ORIGINAL PROMOTIONAL PACKAGE OF \$\$\$\$\$\$ AS PER SCHEDULE PE DATED MMMDDYYYY. 31Mar17 Note: ORIGINAL PROMOTIONAL PACKAGE \$5,000.00 BALANCE FORWARD \$4,360.00	

STAIRS AND RAILINGS

1 - STAINED STAIRS, RAILING AND PICKETS – STANDARD STAIRCASE - PRICE IS PER SET 24Apr18 Note:	
--	--

RECEIVED MAY 02 2018

CONSTRUCTION SUMMARY

Saddle Ridge (G) - Lecco Ridge Developments Inc.

PURCHASERS: HANY BESTAOROUS and HANAN GHALY G GHALY

TEL:

LOT / PHASE Block 332 TH 1 / 1	REG. PLAN # 20M-1184	HOUSE TYPE Ivy 6E Elev 3		
-----------------------------------	-------------------------	-----------------------------	--	--

EXTRAS AS PER OFFER

Five (5) White Appliances as per PE Appliances <i>Worksheet</i> Note:	
The Vendor agrees that notwithstanding any other term or provision in this Agreement included in the Purchase Price and in addition to those items detailed in Schedule GP to the Agreement of Purchase and Sale, the Purchaser is entitled to a credit of Fiv <i>Worksheet</i> Note:	
The Purchaser acknowledges that the Purchase Price is inclusive of all credits and promotional packages available at the time of purchase. <i>Worksheet</i> Note:	
LOT PREMIUM <i>Worksheet</i> Note:	

This Document is Extremely Time Sensitive - Printed 24 Apr 18 at 10:47

Purchasers:

HANY BESTAOROUS & HANAN GHALY G GH

Telephone Res. / Bus:

/

Decor Advisor:

Candace Forza

Lock Date:

24-Apr-18

Layout Changes:

☐ Yes ☒ No

Property:

Block 332 TH 1

Project:

Lecco Ridge Developments Inc.

Model and Elevation:

Ivy 6E Elev 3

24-Apr-18

Plan #:

20M-1184

Sketch Attached:

☒ Yes ☐ No

Exterior Colour Scheme:

1. Cabinetry

	Style and Colour	Hardware
Kitchen / Breakfast	HASTING CHOCOLATE	2002
Laundry Room	ELISSE	Standard
Powder Room	HASTING CHOCOLATE	2002
Master Ensuite Bathroom	EVEREST WHITE	2002
Main Bathroom	EVEREST WHITE	2002
	N/A	N/A
	N/A	N/A
	N/A	N/A
	N/A	N/A

Appliances:

Built In Appliances ☐ Yes ☒ No

Slide In Stove ☐ Yes ☒ No

Dishwasher Cabinet

☐ Closed ☒ Open

41" Upper Cabinets ☒ Yes ☐ No

Please NOTE: Standard Cabinet Height is 30"

Stove Opening

NOTE: If not specified, opening will be set to builder's standard opening of approximately 30" width

Fridge Opening

NOTE: If not specified, opening will be set to builder's standard opening of approximately 37" width x 74" height

** Refer to Construction Summary

2. Counters

	Counter	Edge
Kitchen / Breakfast	LAMINATE-MILANO QUARTZ 4726K-52	
Laundry Room	N/A	
Powder Room	LAMINATE-TRAVERTINE 3526-58	
Master Ensuite Bathroom	LAMINATE-ELEMENTAL CONCRETE 8830-58	
Main Bathroom	LAMINATE-ELEMENTAL CONCRETE 8830-58	
	N/A	
	N/A	
	N/A	
	N/A	

** Refer to Construction Summary



Initials: _____

Purchasers:

Telephone Res. / Bus:

Decor Advisor:

Lock Date:

HANY BESTAOROUS & HANAN GHALY G GHAP
/
Candace Forza
24-Apr-18

Property:

Project:

Model and Elevation:

Plan #:

Block 332 TH 1
Lecco Ridge Developments Inc.
Ivy 6E Elev 3
20M-1184

3. Ceramic Flooring

		At a 45 Threshold-If App.
Entrance Vestibule	TILE-BEACH IVORY-13X13	
Main Hall	LAMINATE	
Kitchen / Breakfast	TILE-BEACH IVORY-13X13	METAL STRIP
Laundry Room	TILE-BEACH LIGHT GREY-13X13	METAL STRIP
Powder Room	TILE-BEACH IVORY-13X13	METAL STRIP
Master Ensuite Bathroom	TILE-BEACH LIGHT GREY-13X13	METAL STRIP
Main Bathroom	TILE-BEACH LIGHT GREY-13X13	METAL STRIP
	N/A	
	N/A	
	N/A	
	N/A	

** Refer to Construction Summary

4. Ceramic Wall Tile

Master Ensuite Bathroom	Selection	Describe
	Tub Deck Wall TILE-GOLF GRIGIO-8X10	
	Tub Deck N/A	
	Tub Deck Skirt N/A	
	Shower Stall TILE-GOLF GRIGIO-8X10	
Bathtub Enclosure Walls	N/A	
	N/A	
Main Bathroom	TILE-GOLF GRIGIO-8X10	
	N/A	
	N/A	
	N/A	
Kitchen Backsplash	N/A	

** Refer to Construction Summary - STANDARD GROUT THROUGHOUT UNLESS SPECIFIED

5. Plumbing Fixtures

All Bathrooms	White	Whirlpool	
	N/A		N/A <input type="radio"/> Yes <input checked="" type="radio"/> No
	N/A		
	N/A	Dishwasher Rough-In	<input checked="" type="radio"/> Yes <input type="radio"/> No
	N/A	Waterline for Fridge	<input type="radio"/> Yes <input checked="" type="radio"/> No
	N/A		

** Refer to Construction Summary

6. Trim Carpentry

Interior Doors	CLASSIQUE
Interior Trim	2 3/4" CASING WITH 4 1/4" BASEBOARD - COLONIAL
Door Handles	As Per Construction Specifications
Exterior Front Door Handle	As Per Construction Specifications

** Refer to Construction Summary

Purchasers:

Telephone Res. / Bus:

Decor Advisor:

Lock Date:

7. Other Flooring

HANY BESTAOROUS & HANAN GHALY G GH

/

Candace Forza

24-Apr-18

Property: Block 332 TH 1

Project: Lecco Ridge Developments Inc.

Model and Elevation: Ivy 6E Elev 3

Plan #: 20M-1184

Main Hall	LAMINATE-PARK LANE - CHOCOLATE WALNUT TL- U1222	
Living Room	LAMINATE-PARK LANE - CHOCOLATE WALNUT TL- U1222	
Dining Room	LAMINATE-PARK LANE - CHOCOLATE WALNUT TL- U1222	
Family Room	LAMINATE-PARK LANE - CHOCOLATE WALNUT TL- U1222	
Den / Library / Study	N/A	
Basement Landing(If Applies)	N/A	
Lower Landing (If Applies)	LAMINATE-PARK LANE - CHOCOLATE WALNUT TL- U1222	
Upper Landing	LAMINATE-PARK LANE - CHOCOLATE WALNUT TL- U1222	
Upper Hall	CARPET-SHAW - E0949 NEWBERN CLASSIC - PLASTER 55752	
Master Bedroom	CARPET-SHAW - E0949 NEWBERN CLASSIC - PLASTER 55752	
Bedroom #2	CARPET-SHAW - E0949 NEWBERN CLASSIC - PLASTER 55752	
Bedroom #3	CARPET-SHAW - E0949 NEWBERN CLASSIC - PLASTER 55752	
Bedroom #4	CARPET-SHAW - E0949 NEWBERN CLASSIC - PLASTER 55752	
Bedroom #5	N/A	
	N/A	
	N/A	
	N/A	
Underpad	Type	Area
	STANDARD	SECOND FLOOR

** Refer to Construction Summary

8. Railings and Pickets

Railing Type	As Per Construction Specifications	Colour	TORLYS CHOCOLATE WALNUT
Picket Type	As Per Construction Specifications	Colour	TORLYS CHOCOLATE WALNUT
Stringer / Riser	As Per Construction Specifications	Colour	TORLYS CHOCOLATE WALNUT
Treads	As Per Construction Specifications	Colour	TORLYS CHOCOLATE WALNUT
Red Oak Stairs with Semi Gloss Finish			<input checked="" type="radio"/> Yes <input type="radio"/> No

** Refer to Construction Summary

9. Wall Paint Flat Finish

Main & Upper Hall	25 OYSTER	Master Bedroom	43 BIRCH WHITE
Living Room	25 OYSTER	Bedroom #2	43 BIRCH WHITE
Dining Room	25 OYSTER	Bedroom #3	43 BIRCH WHITE
Kitchen / Breakfast	25 OYSTER	Bedroom #4	43 BIRCH WHITE
Family Room	25 OYSTER	Bedroom #5	N/A
Powder Room	25 OYSTER	Master Ensuite	43 BIRCH WHITE
Laundry Room	43 BIRCH WHITE	Main Bathroom	43 BIRCH WHITE
Den/Library	N/A		N/A
Trim Paint-Semi Gloss	BIRCH WHITE		N/A
	N/A		N/A
	N/A		N/A
Smooth Ceilings First Floor	<input type="radio"/> Yes		<input checked="" type="radio"/> No

** Refer to Construction Summary

Purchasers: HANY BESTAOROUS & HANAN GHALY G GHAP

Property: Block 332 TH 1

Telephone Res. / Bus: /

Project: Lecco Ridge Developments Inc.

Decor Advisor: Candace Forza

Model and Elevation: Ivy 6E Elev 3

Lock Date: 24-Apr-18

24-Apr-18

Plan #: 20M-1184

10. Plaster Mouldings and Medallions

Entrance Vestibule	N/A	N/A	Kitchen/Breakfast	N/A	N/A
Main Hall	N/A	N/A	Den/Library	N/A	N/A
Living Room	N/A	N/A	Lower Landing	N/A	N/A
Dining Room	N/A	N/A		N/A	N/A
Family Room	N/A	N/A			

** Refer to Construction Summary

11. Fireplace

Living Room			Family Room			Other Room - Specify		
	Purchased	As Per Plan		Purchased	As Per Plan		Purchased	As Per Plan
		<input checked="" type="radio"/>			<input checked="" type="radio"/>			<input checked="" type="radio"/>
Fireplace Type	N/A		N/A			N/A		
Mantle Type	N/A		N/A			N/A		
Colour / Stain	N/A		N/A			N/A		
Surround	N/A		N/A			N/A		
Hearth	N/A		N/A			N/A		

** Refer to Construction Summary

12. Heating and Air Conditioning

Air Conditioning	NO	Gas Provisions Stove	YES
Gas Provisions Dryer	NO	Gas Provisions Barbecue	NO
Comment			

** Refer to Construction Summary

13. Electrical

Plugs and Switches	<input checked="" type="radio"/> White	DECOR	Above Kitchen Cabinet Light	<input type="radio"/> Yes <input checked="" type="radio"/> No
Hood Fan	STANDARD WHITE		Below Kitchen Cabinet Light	<input type="radio"/> Yes <input checked="" type="radio"/> No
Appliances	Built in Cooktop	Built in Oven	Gas Stove	Microwave
	Yes <input checked="" type="radio"/> No	<input type="radio"/> Yes <input checked="" type="radio"/> No	<input checked="" type="radio"/> Yes <input type="radio"/> No	<input type="radio"/> Yes <input checked="" type="radio"/> No
Dishwasher Rough-in	Yes			

** Refer to Construction Summary

14. General Comments

** Refer to Construction Summary

Disclaimers and Notes

- 1) Colours of all materials are as close as possible to builder's selection, but not necessarily identical due to variances in manufacturing.
- 2) Any extras listed above are null and void unless accompanied by a separate invoice/amendment. Said invoice must be paid in full.
- 3) The Purchaser agrees that this colour selection is final and that no changes will be permitted, unless required by the Vendor.
- 4) The Purchaser acknowledges reading and accepting document which contains other miscellaneous disclaimers.

Signature:  _____

Date: _____

Signature: _____

Date: _____

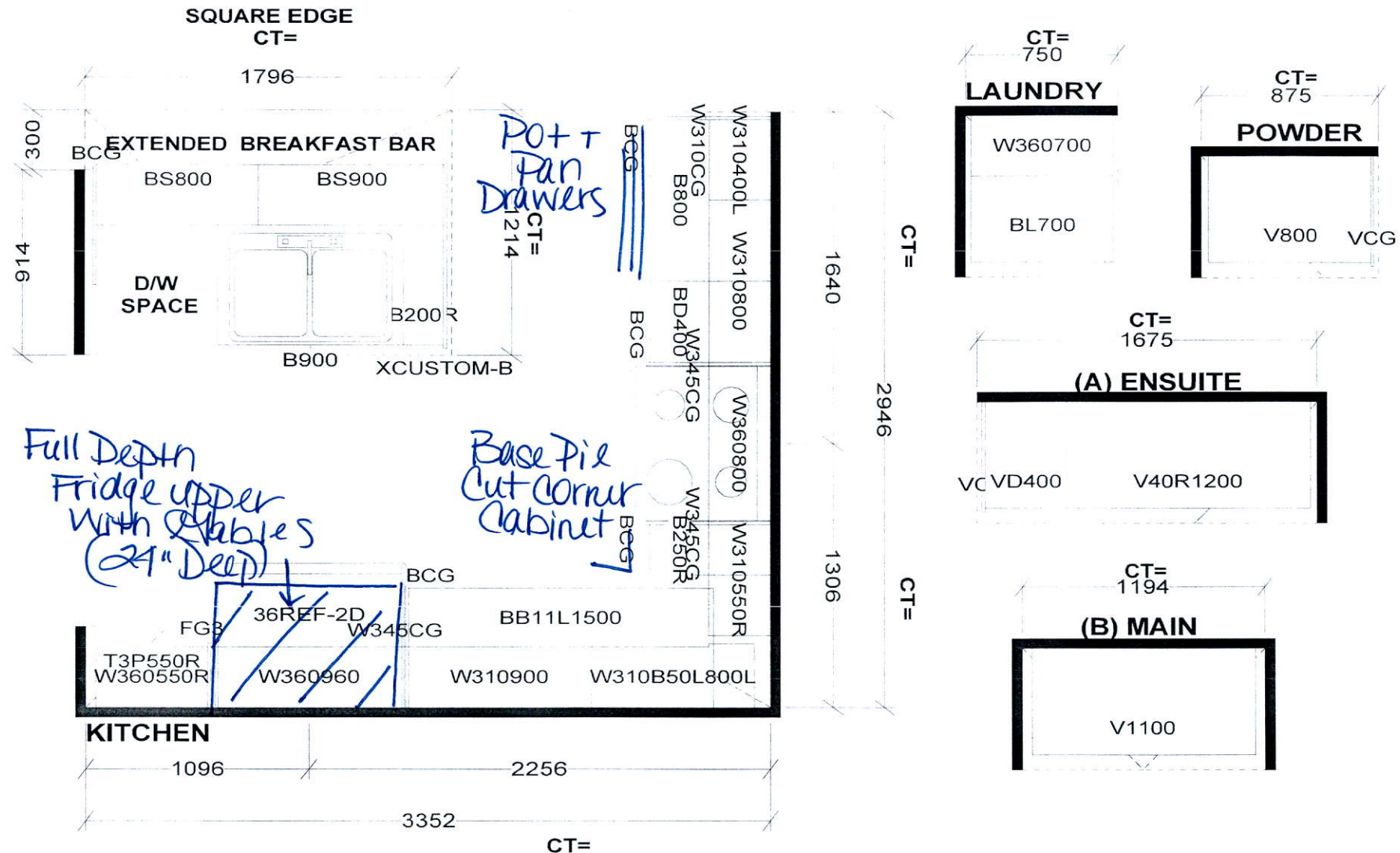

S e l b a I n d u s t r i e s

STANDARD FEATURES:
 9' CEILINGS WITH D/C BOX
 1040MM HIGH UPPER CABINETS
 DISHWASHER SPACE
 DUMMY DOORS ON EXPOSED BACKS
 LAMINATE KITCHEN & VANITY COUNTERTOPS

This drawing is the intellectual property of SELBA INDUSTRIES INC. and is an original design which must not be copied or copied unless applicable fee has been paid or job order placed.



JOB NUMBER:
BUILDER: GREENPARK HOMES
SITE NAME: LECCO RIDGE, Milton
MODEL: IVY 6EX ELEV 1,2,3
LOT #:
DESIGNER: KS
DATE: FEB 13-17

IVY 6E 2,133 SQ.FT.

AVAILABLE IN BLOCK: 323, 332, 333, 334, 335, 336, 337, 341, 342, 343 & 344

