



CONSTRUCTION SUMMARY

Saddle Ridge (G) - Lecco Ridge Developments Inc.

PURCHASERS: Remon S HANNA and Lilianne HANNA

TEL:

LOT / PHASE 243 / 1	REG. PLAN # 20M-1184	HOUSE TYPE Juniper 7 Elev 2		
------------------------	-------------------------	--------------------------------	--	--

CABINETS

1 - KITCHEN - UPGRADE 1 HARDWARE 06Oct17 Note:	
1 - VANITIES - MONACO CABINETS STAIN WITH UPGRADE STAIN - PRICE IS FOR ONE OR ALL BATHS - DETACHED 06Oct17 Note:	
1 - KITCHEN - LIGHT VALANCE 06Oct17 Note: LS2	
1 - KITCHEN - CROWN MOULDING WITH HEADER 06Oct17 Note: cm3	
1 - KITCHEN - MINI STACKED UPPER CABINETS - INCLUDES ABOVE CHIMNEY HOOD 06Oct17 Note:	
1 - KITCHEN - UPGRADE 3 CABINETS 06Oct17 Note:	

CABINETS ACCESSORIES

1 - FOR CONFIRMATION PURPOSES - KITCHEN - INSTALL 2 HANDLES ON EACH POT DRAWER 06Oct17 Note:	
1 - CABINETS FEE FOR FLUSH CUTOUT ON WALL OVEN/MICROWAVE COMBO CABINET ONLY 06Oct17 Note: NEW SPECS. ATTACHED - RECEIVED MAY 31 2018	
1 - KITCHEN - ADD 3' OF CUSTOM UPPIERS ABOVE DESK 06Oct17 Note:	
1 - KITCHEN - ADD 3' DESK WITH 2 TOP DRAWERS 06Oct17 Note:	
1 - KITCHEN - FULL DEPTH PANTRY - 24" DEEP 06Oct17 Note:	
1 - KITCHEN - FULL DEPTH FRIDGE UPPER WITH GABLE - 24" DEEP 06Oct17 Note:	
1 - KITCHEN - BUILT-IN MICRO/OVEN CABINETS PROVISIONS 06Oct17 Note:	
1 - KITCHEN - COOKTOP CABINETS PROVISIONS 06Oct17 Note:	
2 - KITCHEN - PULL-OUT SPICE RACK 06Oct17 Note:	
4 - KITCHEN - POT AND PAN DRAWERS 06Oct17 Note:	
1 - KITCHEN - 4-BIN PULL-OUT RECYCLE CENTRE 06Oct17 Note:	
1 - KITCHEN- PIE CUT BASE CORNER CABINET 06Oct17 Note:	
1 - KITCHEN - ADD 2 FEET OF UPPER AND BASE CABINETS ON SINK CABINETS RUN 06Oct17 Note:	
1 - KITCHEN - HORIZONTAL WINE RACK 06Oct17 Note:	

CONSTRUCTION SUMMARY

Saddle Ridge (G) - Lecco Ridge Developments Inc.

PURCHASERS: Remon S HANNA and Lilianne HANNA

TEL:

LOT / PHASE	REG. PLAN #	HOUSE TYPE		
243 / 1	20M-1184	Juniper 7 Elev 2		
1 - KITCHEN - LARGE WINDOW VALANCE DECOR #4 06Oct17 Note:				
1 - KITCHEN - ANGLED UPPER CORNER CABINET 06Oct17 Note:				

CERAMIC TILE

1 - THROUGHOUT - LAY TILES WITH TIGHT JOINTS 06Oct17 Note:	
1 - TILE - UPGRADE 2 WALL TILE - - ENSUITE WALL TILE - SHOWER 06Oct17 Note:	
1 - TILE - UPGRADE 2 FLOOR TILE - - ENSUITE BATHROOM - FLOOR 06Oct17 Note:	
1 - TILE - UPGRADE 1 FLOOR TILE - - BATHROOM 3/4 - FLOOR 06Oct17 Note:	
1 - TILE - UPGRADE 1 FLOOR TILE - - BATHROOM 2 - FLOOR 06Oct17 Note:	
1 - DELETE ALL CERAMIC BATHROOM ACCESSORIES 06Oct17 Note:	
1 - TILE - UPGRADE 5 FLOOR TILE - - SIDE HALL 06Oct17 Note: MUD ROOM	
1 - TILE - UPGRADE 5 FLOOR TILE - - POWDER ROOM 06Oct17 Note:	
1 - TILE - UPGRADE 5 FLOOR TILE - - KITCHEN 06Oct17 Note:	
1 - TILE - UPGRADE 5 FLOOR TILE - - FOYER AND MAIN HALL 06Oct17 Note:	

CONSTRUCTION

1 - SMOOTH CEILINGS ON FIRST FLOOR ONLY 23Jun17 Note:	
1 - KITCHEN - DELETE BULKHEAD - IF CONSTRUCTION PERMITS 23Jun17 Note:	
1 - FAMILY ROOM - WAFFLE CEILING - 9 BOXES - SMOOTH FINISH 23Jun17 Note: waffle by Update Precast Moulding	
1 - PLEASE NOTE THAT NO FURTHER STRUCTURAL CHANGES WILL BE PERMITTED. 09Dec16 Note:	
1 - FIRST FLOOR INCREASE CEILING HEIGHT FROM 9 FEET TO 10 FEET 09Dec16 Note: The ceiling height is measured from the top of the unfinished subfloor to underside of the unfinished ceiling above before finishes and excluding bulkheads and drop ceilings as per plan.	

DOORS AND TRIM

1 - THROUGHOUT - CARRARA SMOOTH INTERIOR DOORS 06Oct17 Note:	
-----------------------------------------------------------------	--

ELECTRICAL

1 - PLUG - 240V ELECTRICAL PLUG IN GARAGE FOR FUTURE ELECTRIC CAR - 50 AMP 02Mar18 Note:	
---------------------------------------------------------------------------------------------	--

RECEIVED MAR 07 2018

NEW



CONSTRUCTION SUMMARY

Saddle Ridge (G) - Lecco Ridge Developments Inc.

PURCHASERS: Remon S HANNA and Lilianne HANNA

TEL:

LOT / PHASE	REG. PLAN #	HOUSE TYPE		
243 / 1	20M-1184	Juniper 7 Elev 2		
1 - ***DELETE PAYMENT FOR DECOR SWITCHES - STANDARD AS PER OFFER 18Oct17 Note:				
2 - ***DELETE - 2 PUCK LIGHTS FOR DESK*** 16Oct17 Note:				
1 - KITCHEN - COMPLETE FLORESCENT LIGHTING FOR LIGHT VALANCE 06Oct17 Note:				
1 - PLUG - ELECTRICAL PLUG 23Jun17 Note: KITCHEN - INSTALL PLUG UNDER SINK				
2 - POT LIGHT - HOCKEY PUCK 23Jun17 Note: KITCHEN - BELOW OPEN SHELVES ABOVE DESK				
1 - BUILT IN OVEN AND COOKTOP PROVISION - PROVISION ONLY - ELECTRICAL ONLY 23Jun17 Note:				
1 - PLUG - ELECTRICAL PLUG - TO BE INSTALLED OVER FIREPLACE 23Jun17 Note:				
2 - KITCHEN - DIMMER SWITCHES FOR POTLIGHTS ONLY 23Jun17 Note:				
9 - POT LIGHT - LOW VOLTAGE LED - FIRST FLOOR INSTALLATION 23Jun17 Note: KITCHEN - WIRED TO 2 SEPERATE SWITCHES				
1 - RELOCATE STANDARD KITCHEN LIGHT TO BE CENTERED OVER ISLAND 23Jun17 Note:				
2 - LIVING/DINING ROOM - DIMMER SWITCH 23Jun17 Note:				
6 - POT LIGHT - LOW VOLTAGE LED - FIRST FLOOR INSTALLATION 23Jun17 Note: LIVING/DINING ROOM - WIRED TO A SEPERATE SWITCH FROM STANDARD LIGHT				
1 - STANDARD DINING ROOM LIGHT TO BE CENTERED BETWEEN LIVING AND DINING ROOM 23Jun17 Note:				
1 - FAMILY ROOM - DIMMER SWITCH FOR POTLIGHTS 23Jun17 Note:				
8 - POT LIGHT - LOW VOLTAGE LED - FIRST FLOOR INSTALLATION 23Jun17 Note: FAMILY ROOM - LED - WIRED TO SEPERATE SWITCH FROM STANDARD LIGHT				
1 - PLUG - ELECTRICAL PLUG WITH GFI AND SWITCH - FOR FESTIVE LIGHTING 23Jun17 Note:				
1 - DÉCOR SWITCHES AND PLUGS (THROUGHOUT HOUSE) 23Jun17 Note:				
1 - 200 AMP ELECTRICAL SERVICE 23Jun17 Note:				

FIREPLACE AND ACCESSORIES

1 - GAS LINE ROUGH-IN FOR BARBECUE 23Jun17 Note:	
--------------------------------------------------------	--

HARDWOOD FLOORING

1 - FIRST FLOOR - STANDARD NON-TILED AREAS - 5" STAINED ETCHED ENGINEERED HARDWOOD FLOORING IN LIEU OF STANDARD AS PER OFFER 06Oct17 Note:	
--------------------------------------------------------------------------------------------------------------------------------------------------	--

CONSTRUCTION SUMMARY

Saddle Ridge (G) - Lecco Ridge Developments Inc.

PURCHASERS: Remon S HANNA and Lilianne HANNA

TEL:

LOT / PHASE 243 / 1	REG. PLAN # 20M-1184	HOUSE TYPE Juniper 7 Elev 2		
------------------------	-------------------------	--------------------------------	--	--

MIRRORS AND GLASS

1 - ***DELETE - MASTER ENSUITE BATHROOM - FRAMELESS GLASS SHOWER ENCLOSURE WITH D-RING AND TOWEL BAR*** 08Aug17 Note:	
1 - FRAMELESS GLASS SHOWER ENCLOSURE 23Jun17 Note: MASTER ENSUITE BATHROOM - CHROME D-RING AND TOWEL BAR Deleted	

MISCELLANEOUS

1 - FURTHER DISCOUNT AS PER VENDOR 06Oct17 Note:	
1 - FURTHER DISCOUNT AS PER VENDOR 06Oct17 Note:	

PLUMBING

1 - ALL BATHROOMS - MOEN MASON CHROME ACCESSORIES POWDER ROOM - TOWEL RING & TOILET PAPER HOLDER ENSUITE 3/4 & MASTER BATHROOMS - 24 " TOWEL BAR, TOWEL RING (X2) & TOILET PAPER HOLDER ENSUITE 2 BATHROOM - 24 " TOWEL BAR, TOWEL RING & TOILET PAPER HOLDER 06Oct17 Note:	
1 - POWDER ROOM - CONTRAC VIEIRA PEDESTAL SINK - #4390DHX / 4389DHX - STANDARD FAUCET 06Oct17 Note:	
1 - WATER LINE FOR FRIDGE - ROUGH-IN ONLY 23Jun17 Note:	

PROMOTIONAL

1 - LESS CREDIT FROM PURCHASER EXTRA SHEET IN OFFER 23Jun17 Note:	
----------------------------------------------------------------------	--

STAIRS AND RAILINGS

1 - UPPER HALL - ADD 3 POSTS TO STAIRCASE 06Oct17 Note:	
1 - V GROOVE HANDRAIL 06Oct17 Note: STAIRCASE	
1 - STAINED HANDRAIL - TREADS, RISERS AND STRINGER EXCLUDING PICKETS FIRST TO SECOND FLOOR - STANDARD STAIRCASE 06Oct17 Note:	
1 - EUROLINE 1 06Oct17 Note: STAIRCASE - IRON PICKETS - BLACK	

EXTRAS AS PER OFFER

The Vendor agrees that notwithstanding any other term or provision in this Agreement included in the Purchase Price and in addition to those items detailed in Schedule GP to the Agreement of Purchase and Sale, the Purchaser is entitled to a credit of Ten Worksheet Note:	
The Purchaser acknowledges that the Purchase Price is inclusive of all credits and promotional packages available at the time of purchase. Worksheet Note:	



INTERIOR COLOUR SCHEME

Purchasers:

Telephone Res. / Bus:

Decor Advisor:

Lock Date:

Remon S HANNA & Lilianne HANNA

/

Candace Forza

6-Oct-17

Property: 243

Project: Lecco Ridge Developments Inc.

Model and Elevation: Juniper 7 Elev 2

Plan #: 20M-1184

Layout Changes:

Sketch Attached:

Exterior Colour Scheme:

☒ Yes ☐ No

☒ Yes ☐ No

1. Cabinetry

	Style and Colour	Hardware
Kitchen / Breakfast	BANCROFT W823XZ3	428SB
Laundry Room	ELISSE	Standard
Powder Room	PEDESTAL	N/A
Master Ensuite Bathroom	MONACO W823XZ4	2002
Ensuite Bath - Bedroom 2	MONACO W821XZ4	2002
Ensuite Bath - Bedroom 3/4	MONACO W821XZ4	2002
	N/A	N/A
	N/A	N/A
	N/A	N/A

Appliances:

Dishwasher Cabinet

Stove Opening

Fridge Opening

Built In Appliances

☐ Closed ☒ Open

41" Upper Cabinets

☒ Yes ☐ No

Slide In Stove

☐ Yes ☒ No

NOTE: If not specified, opening will be set to builder's standard opening of approximately 30" width

NOTE: If not specified, opening will be set to builder's standard opening of approximately 37" width x 74" height



Please NOTE: Standard Cabinet Height is 30"

** Refer to Construction Summary

2. Counters

	Counter	Edge
Kitchen / Breakfast	LAMINATE-WHITE CARRARA-4924-38	
Laundry Room	N/A	
Powder Room	N/A	
Master Ensuite Bathroom	LAMINATE-WHITE TIGRIS-4783-60	
Ensuite Bath - Bedroom 2	LAMINATE-INUKSHUK GREY-P344-LM	
Ensuite Bath - Bedroom 3/4	LAMINATE-INUKSHUK GREY-P344-LM	
	N/A	
	N/A	
	N/A	

** Refer to Construction Summary

Initials:  

Purchasers: Remon S HANNA & Lilianne HANNA

Property: 243

Telephone Res. / Bus: /

Project: Lecco Ridge Developments Inc.

Decor Advisor: Candace Forza

Model and Elevation: Juniper 7 Elev 2

Lock Date: 6-Oct-17

6-Oct-17

Plan #: 20M-1184

3. Ceramic Flooring

At a 45 Threshold-If App.

Entrance Vestibule	TILE-GOTHA DIAMOND LUX-24X24	<input type="checkbox"/>	METAL STRIP
Main Hall	STRIP	<input type="checkbox"/>	
Kitchen / Breakfast	TILE-GOTHA DIAMOND LUX-24X24	<input type="checkbox"/>	METAL STRIP
Laundry Room	TILE-RAINBOW LIGHT GREY-13X13	<input type="checkbox"/>	METAL STRIP
Powder Room	TILE-GOTHA DIAMOND LUX-24X24	<input type="checkbox"/>	
Master Ensuite Bathroom	TILE-MARMANI BIANCO-12X24	<input type="checkbox"/>	METAL STRIP
Ensuite Bath - Bedroom 2	TILE-FM45GL001S GLOSSY WHITE-18X18	<input type="checkbox"/>	METAL STRIP
Ensuite Bath - Bedroom 3/4	TILE-FM45GL001S GLOSSY WHITE-18X18	<input type="checkbox"/>	METAL STRIP
	N/A	<input type="checkbox"/>	
	N/A	<input type="checkbox"/>	
	N/A	<input type="checkbox"/>	

** Refer to Construction Summary

4. Ceramic Wall Tile

Master Ensuite Bathroom	Selection	Describe
Tub Deck Wall	N/A	
Tub Deck	N/A	
Tub Deck Skirt	N/A	
Shower Stall	TILE-MARMANI BIANCO-12X24	***LAID HORIZONTALLY***
Bathtub Enclosure Walls	N/A	
	N/A	
Ensuite Bath - Bedroom 2	TILE-STARDUST BIANCO-8X16	***LAID HORIZONTALLY***
Ensuite Bath - Bedroom 3/4	TILE-STARDUST BIANCO-8X16	***LAID HORIZONTALLY***
	N/A	
	N/A	
Kitchen Backsplash	N/A	

** Refer to Construction Summary - STANDARD GROUT THROUGHOUT UNLESS SPECIFIED

5. Plumbing Fixtures

All Bathrooms

White

N/A

N/A

N/A

N/A

N/A

Whirlpool

N/A ☐ Yes ☒ No

Dishwasher Rough-In

☒ Yes ☐ No

Waterline for Fridge

☒ Yes ☐ No

** Refer to Construction Summary

6. Trim Carpentry

Interior Doors	CARRARA 2 PANEL - SMOOTH
Interior Trim	As Per Construction Specifications
Door Handles	SATIN CHROME LEVER
Exterior Front Door Handle	SATIN CHROME CHELSEA

** Refer to Construction Summary

Initials: 

Purchasers: Remon S HANNA & Lilianne HANNA

Property: 243

Telephone Res. / Bus: /

Project: Lecco Ridge Developments Inc.

Decor Advisor: Candace Forza

Model and Elevation: Juniper 7 Elev 2

Lock Date: 6-Oct-17

6-Oct-17

Plan #: 20M-1184

7. Other Flooring

Main Hall	STRIP-VINTAGE-NSS-MAPLE-ETCHED ESTATE-UV OIL-TAHITI05"	
Living Room	STRIP-VINTAGE-NSS-MAPLE-ETCHED ESTATE-UV OIL-TAHITI05"	
Dining Room	STRIP-VINTAGE-NSS-MAPLE-ETCHED ESTATE-UV OIL-TAHITI05"	
Family Room	STRIP-VINTAGE-NSS-MAPLE-ETCHED ESTATE-UV OIL-TAHITI05"	
Den / Library / Study	STRIP-VINTAGE-NSS-MAPLE-ETCHED ESTATE-UV OIL-TAHITI05"	
Basement Landing(If Applies)	N/A	
Lower Landing (If Applies)	N/A	
Upper Landing	STRIP-VINTAGE-NSS-MAPLE-ETCHED ESTATE-UV OIL-TAHITI05"	
Upper Hall	LAMINATE-TORLYS-PARK LANE-GREY VARNISHED OAK-TL-U1305	
Master Bedroom	LAMINATE-TORLYS-PARK LANE-GREY VARNISHED OAK-TL-U1305	
Bedroom #2	LAMINATE-TORLYS-PARK LANE-GREY VARNISHED OAK-TL-U1305	
Bedroom #3	LAMINATE-TORLYS-PARK LANE-GREY VARNISHED OAK-TL-U1305	
Bedroom #4	LAMINATE-TORLYS-PARK LANE-GREY VARNISHED OAK-TL-U1305	
Bedroom #5	N/A	
	N/A	
	N/A	
	N/A	
Underpad	Type	Area
	N/A	N/A

** Refer to Construction Summary

8. Railings and Pickets

Railing Type	3 1/4 V-GROOVE	Colour	VINTAGE TAHITI
Picket Type	EURO LINE 1 BLACK	Colour	BLACK
Stringer / Riser	AS PER CONSTRUCTION SPECS	Colour	VINTAGE TAHITI
Treads	AS PER CONSTRUCTION SPECS	Colour	VINTAGE TAHITI
Red Oak Stairs with Semi Gloss Finish		<input checked="" type="radio"/> Yes <input type="radio"/> No	

** Refer to Construction Summary

9. Wall Paint Flat Finish

Main & Upper Hall	22 WARM GREY	Master Bedroom	22 WARM GREY
Living Room	22 WARM GREY	Bedroom #2	22 WARM GREY
Dining Room	22 WARM GREY	Bedroom #3	22 WARM GREY
Kitchen / Breakfast	22 WARM GREY	Bedroom #4	22 WARM GREY
Family Room	22 WARM GREY	Bedroom #5	N/A
Powder Room	22 WARM GREY	Master Ensuite	22 WARM GREY
Laundry Room	22 WARM GREY	Ensuite Bath - Bedroom 2	22 WARM GREY
Den/Library	22 WARM GREY	Ensuite Bath - Bedroom 3/4	22 WARM GREY
Trim Paint-Semi Gloss	BIRCH WHITE	MUD ROOM	22 WARM GREY
	N/A		N/A
	N/A		N/A

Smooth Ceilings First Floor ☒ Yes ☐ No

** Refer to Construction Summary

Purchasers: Remon S HANNA & Lilianne HANNA

Property: 243

Telephone Res. / Bus: /

Project: Lecco Ridge Developments Inc.

Decor Advisor: Candace Forza

Model and Elevation: Juniper 7 Elev 2

Lock Date: 6-Oct-17

6-Oct-17

Plan #: 20M-1184

10. Plaster Mouldings and Medallions

Entrance Vestibule	N/A	N/A	Kitchen/Breakfast	N/A	N/A
Main Hall	N/A	N/A	Den/Library	N/A	N/A
Living Room	N/A	N/A	Lower Landing	N/A	N/A
Dining Room	N/A	N/A		N/A	N/A
Family Room	N/A	N/A			

** Refer to Construction Summary

11. Fireplace

	Living Room			Family Room			Other Room - Specify		
	Purchased	As Per Plan	N/A	Purchased	As Per Plan	N/A	Purchased	As Per Plan	N/A
	<input type="radio"/>	<input type="radio"/>	<input checked="" type="radio"/>	<input type="radio"/>	<input checked="" type="radio"/>	<input type="radio"/>	<input type="radio"/>	<input type="radio"/>	<input checked="" type="radio"/>
Fireplace Type	N/A			FLAT ON WALL			N/A		
Mantle Type	N/A			MANTLE M2-STANDARD			N/A		
Colour / Stain	N/A			AS PER CONSTRUCTION SPECIFICATIONS			N/A		
Surround	N/A			GRIGIO CARNICO			N/A		
Hearth	N/A			NO			N/A		

** Refer to Construction Summary

12. Heating and Air Conditioning

Air Conditioning	NO	Gas Provisions Stove	NO
Gas Provisions Dryer	NO	Gas Provisions Barbecue	YES
Comment			

** Refer to Construction Summary

13. Electrical

Plugs and Switches	<input checked="" type="radio"/> White	DECOR	Above Kitchen Cabinet Light	<input type="radio"/> Yes	<input checked="" type="radio"/> No
Hood Fan	STANDARD		Below Kitchen Cabinet Light	<input checked="" type="radio"/> Yes	<input type="radio"/> No
Appliances	Built in Cooktop	Built in Oven	Gas Stove	Microwave	
	<input checked="" type="radio"/> Yes <input type="radio"/> No	<input checked="" type="radio"/> Yes <input type="radio"/> No	<input type="radio"/> Yes <input checked="" type="radio"/> No	<input checked="" type="radio"/> Yes <input type="radio"/> No	
Dishwasher Rough-in	Yes				

** Refer to Construction Summary

14. General Comments

** Refer to Construction Summary

Disclaimers and Notes

1) Colours of all materials are as close as possible to builder's selection, but not necessarily identical due to variances in manufacturing.

2) Any extras listed above are null and void unless accompanied by a separate invoice/amendment. Said invoice must be paid in full.

3) The Purchaser agrees that this colour selection is final and that no changes will be permitted, unless required by the Vendor.

4) The Purchaser acknowledges reading and accepting document which contains other miscellaneous disclaimers.

Signature:  Date: 001.6/17

Signature:  Date: Oct 6/17

SEP 15 17 FB
SEP 20 17 FB

LECCO 243
PROTOTYPE FOR EXTRAS

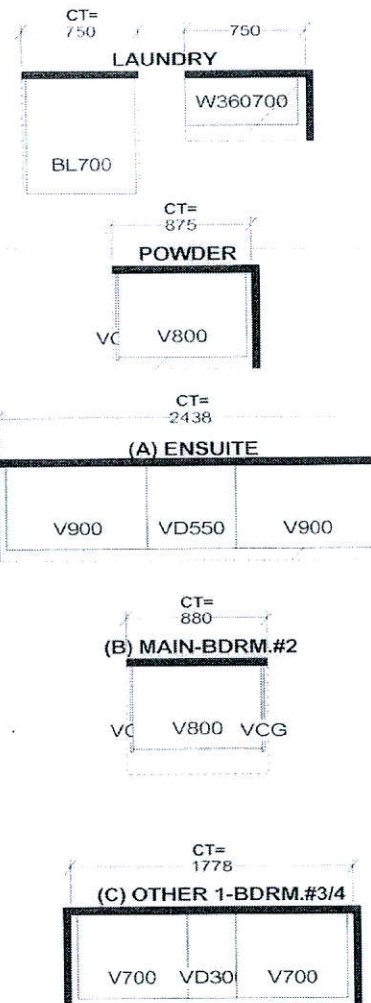

Add
mini Stacked
Uppers
Above Hood-

- CM-3 moulding.
- LS2 - Valance.

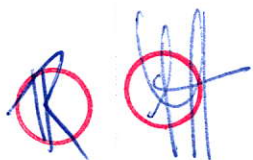

* Fridge IS Not Built-In *

THIS IS NOT
A FINAL LAYOUT

Selba Industries

W WIDTH	W HGHT	W CNT	FL HGHT	DWY H	ST CENT	2X4	VENT BOX COVER
STANDARD FEATURES:				This drawing is the intellectual property of SELBA INDUSTRIES INC. and is an original design which must not be released or copied unless significant fee has been paid for pots/insert placed		JOB NUMBER:	
9' CEILINGS WITH D/C BOX 1040MM HIGH UPPER CABINETS DISHWASHER SPACE DUMMY DOORS ON EXPOSED BACKS LAMINATE KITCHEN & VANITY COUNTERTOPS						BUILDER: GREENPARK HOMES SITE NAME: ELEGCO RIVER, Milton MODEL: JUNIPER 7X ELEG 1,2 LOT #: 243 DESIGNER: KS DATE: FEB 13 17	

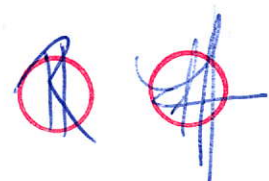
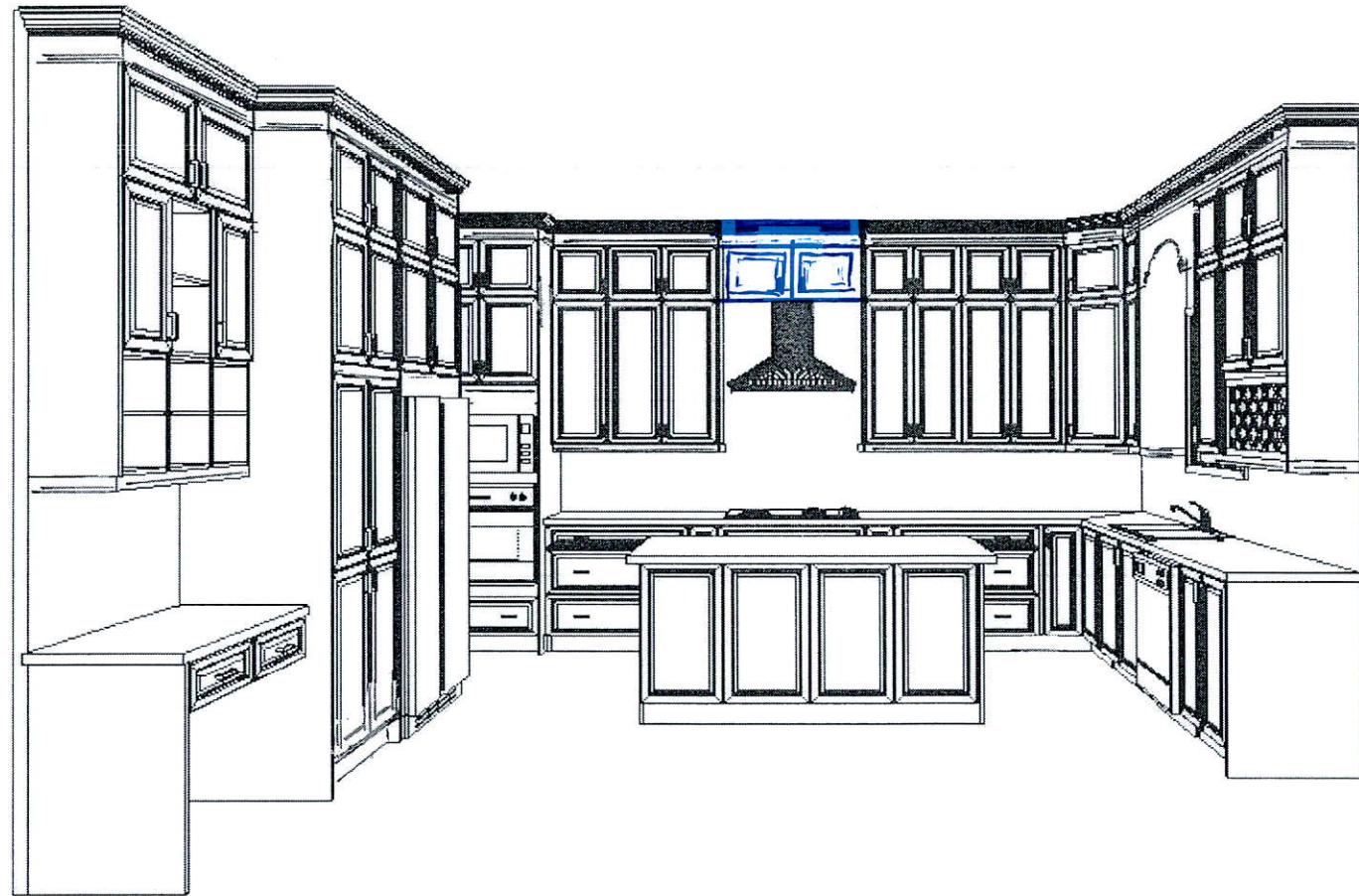

THIS IS NOT
A FINAL LAYOUT

This drawing is the intellectual property of SELBA INDUSTRIES INC. and is an artistic interpretation of the general appearance of the design. It is not meant to be an exact rendition.

Selba
Kitchen + Bath Designs

Designed: 9/15/2017
Printed: 9/20/2017

LECCO 243.kit

LECCO 243.kit Drawing #: 1

CU3)

MINI STACKED
UPPERS

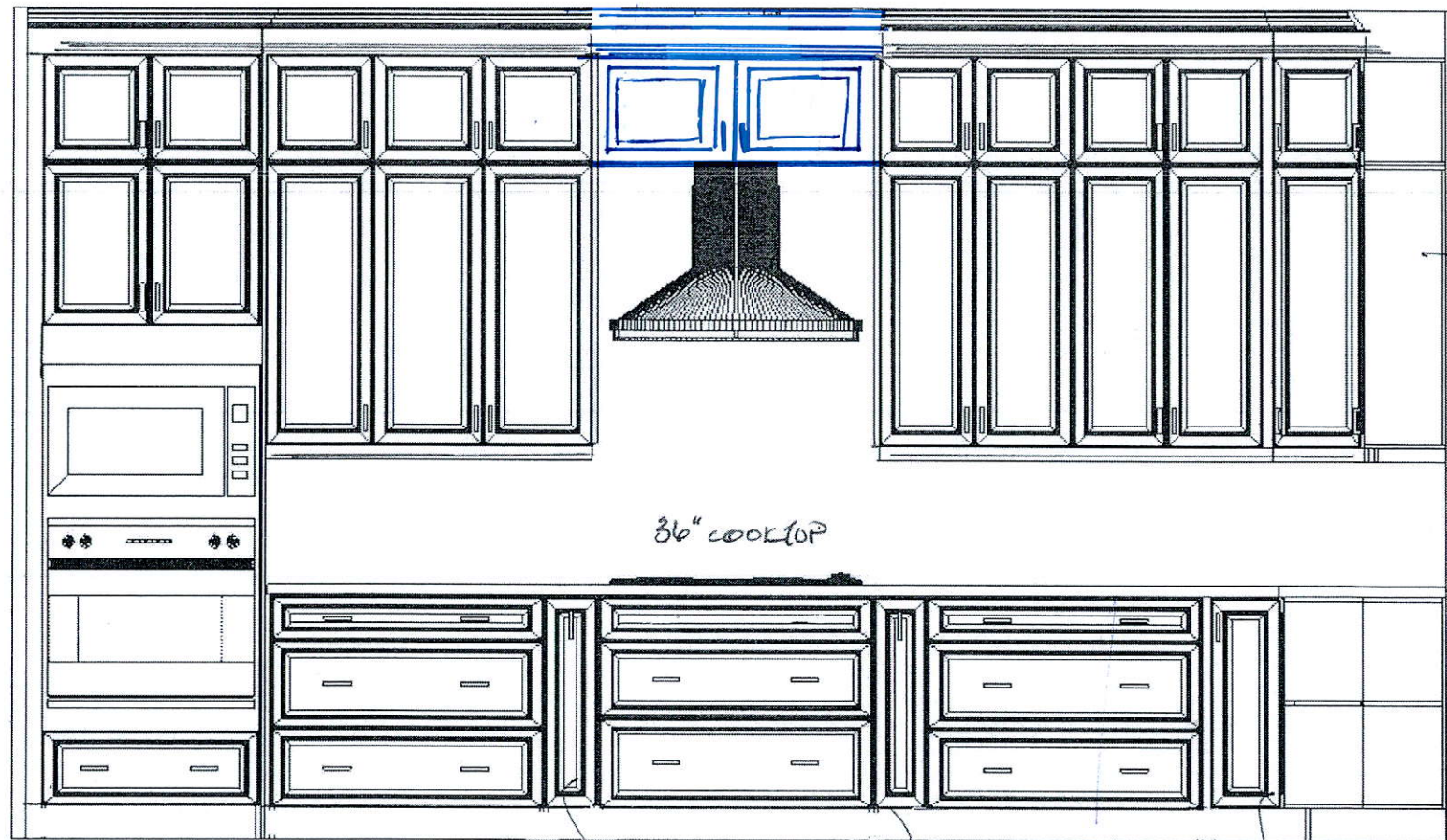

ANGLE
CORNER

36" COOKTOP

BUILT IN
OVEN/MICRO

SPICE DRAWERS
x 2

DIE CUT
BASE

THIS IS NOT
A FINAL LAYOUT

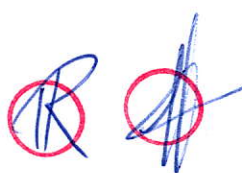

This drawing is the intellectual property of SELBA INDUSTRIES INC. and is an artistic interpretation of the general appearance of the design. It is not meant to be an exact rendition.



Designed: 9/15/2017
Printed: 9/20/2017

LECCO 243.kit

LECCO 243.kit

Drawing #: 1

DECOR WINDOW
VALANCE X 4

ANGLE
CORNER
UPPER

MINI STACKED
UPPERS

WINE RACK

PIE CUT
BASE

THIS IS NOT
A FINAL LAYOUT

This drawing is the intellectual property of
SELBA INDUSTRIES INC. and is an
artistic interpretation of the general
appearance of the design. It is not meant to
be an exact rendition.

Selba

Kitchen + Bath Designs

Designed: 9/15/2017
Printed: 9/20/2017

LECCO 243.kit

LECCO 243.kit

Drawing #: 1

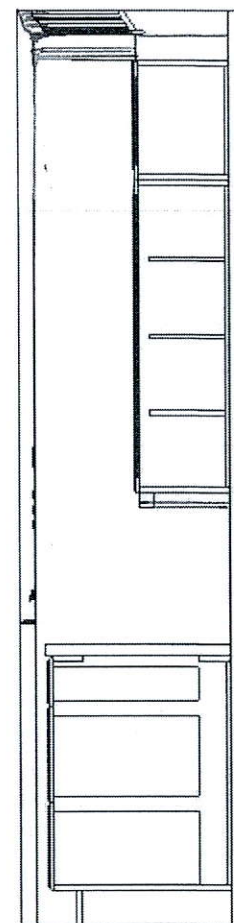
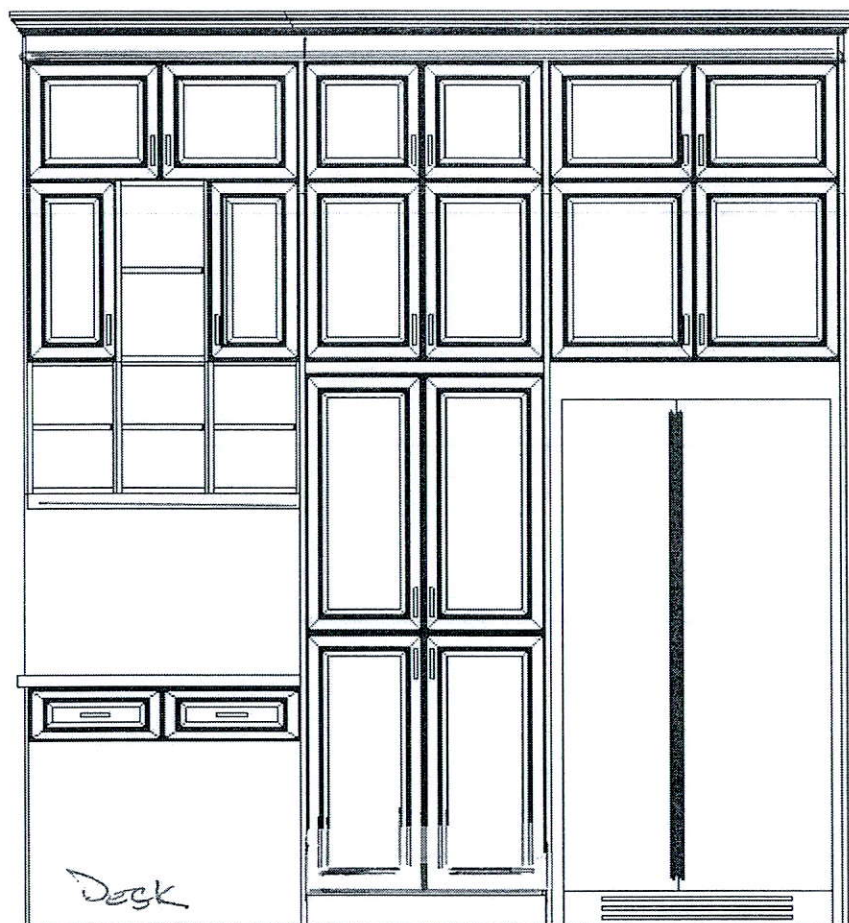

PANTRY STD. 36" REF

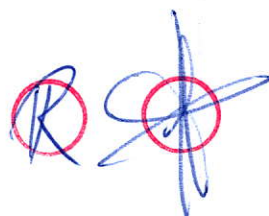

THIS IS NOT
A FINAL LAYOUT

This drawing is the intellectual property of SELBA INDUSTRIES INC. and is an artistic interpretation of the general appearance of the design. It is not meant to be an exact rendition.



Designed: 9/15/2017
Printed: 9/20/2017

LECCO 243.kit

LECCO 243.kit

Drawing #: 1

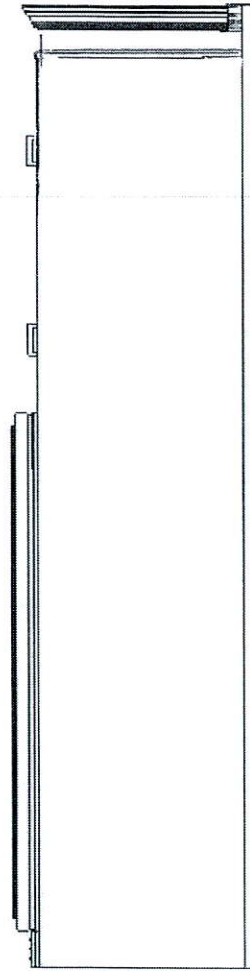
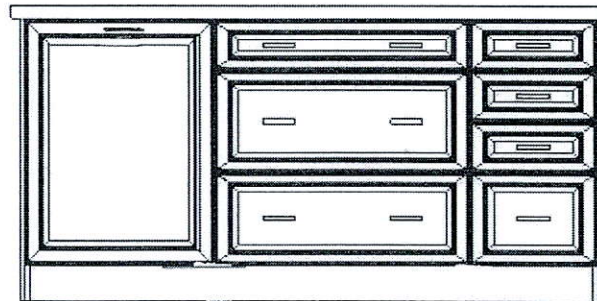
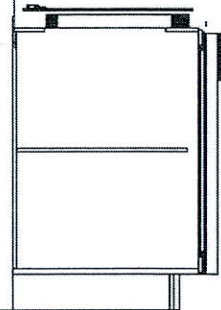
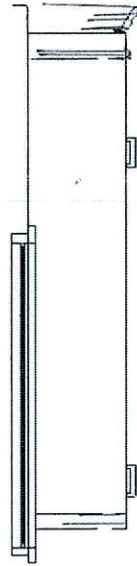

4 BIN
WASTE
RECYCLE

POTS + PAN

BANK
DRAWERS

THIS IS NOT
A FINAL LAYOUT

This drawing is the intellectual property of SELBA INDUSTRIES INC. and is an artistic interpretation of the general appearance of the design. It is not meant to be an exact rendition.

Selba

Kitchen + Bath Designs

Designed: 9/15/2017
Printed: 9/20/2017

LECCO 243.kit

LECCO 243.kit

Drawing #: 1

NEW

JENN-AIR® DETAILED PLANNING DIMENSIONS

30" COMBINATION MICROWAVE/WALL OVENS

JMW3430D, JMW2430D – 30" x 43¾" x 25⅝"

PRODUCT DIMENSIONS

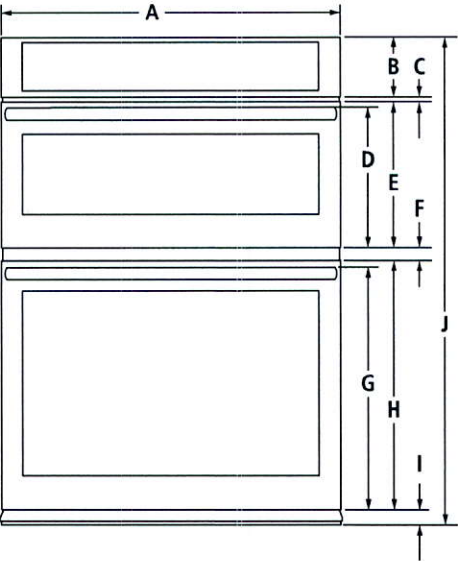

FRONT VIEW

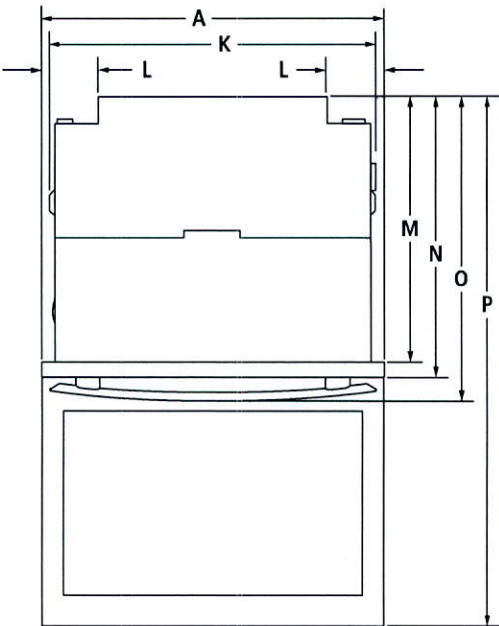

TOP VIEW

MODEL #		JMW3430D JMW2430D	
		in	cm
A	Overall width		
	Pro-Style® Stainless or Euro-Style Stainless	30	76.2
	Floating Glass	29⅞	76.1
B	Height of control panel	5½	14
C	Space between control panel and door	½	1.2
D	Height to top of microwave oven handle		
	Pro-Style® Stainless	12¾	31.0
	Euro-Style (color-coordinating)	12¾	31.0
E	Height of microwave oven door	12⅞	32.3
F	Space between doors	1⅞	2.9
G	Height to top of oven handle		
	Pro-Style® Stainless	21⅞	55.0
	Euro-Style (color-coordinating)	21⅞	54.4
H	Height of oven door	22⅞	56.2
I	Height of trim	1⅞	4.3
J	Overall height	43¾	111.1
K	Width of recessed oven	28⅞	72.2
L	Width of conduit channel	4⅞	12.5
M	Depth of recessed oven	23¼	59.0
N	Depth with doors	24⅞	61.9
O	Depth with handles		
	Pro-Style® Stainless	26⅞	67.0
	Euro-Style (color-coordinating)	25⅞	64.3
P	Depth with door fully open	45⅞	115.3

IMPORTANT: Dimensional specifications are provided for planning purposes only.
Do not make any cutouts based on this information. Refer to the Installation Guide before selecting cabinetry, verifying electrical/gas connections, making cutouts or beginning installation. All Jenn-Air® appliances are appropriately UL, CUL or CSA approved.



8610AdZw915

RECEIVED MAY 31 2018

NEW

JENN-AIR® DETAILED PLANNING DIMENSIONS

30" COMBINATION MICROWAVE/WALL OVENS

JMW3430D, JMW2430D – 30" x 43¾" x 25⅝"

DIMENSIONS AS INSTALLED

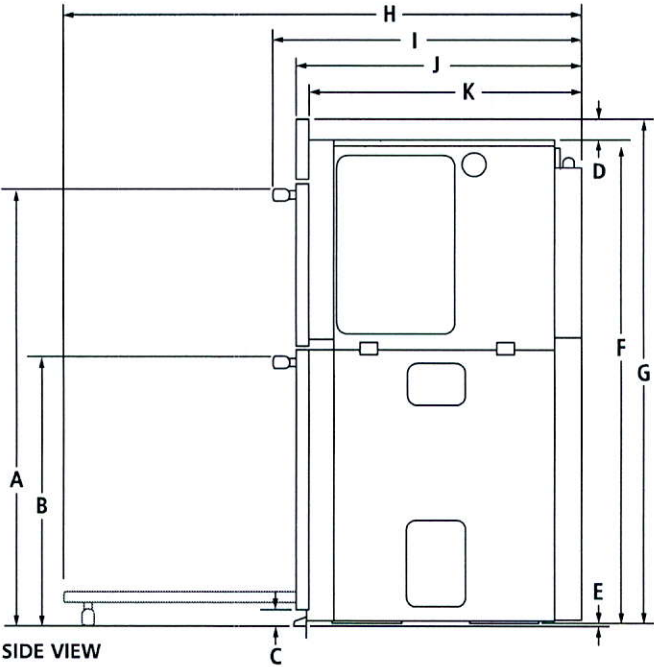

MODEL #		JMW3430D JMW2430D	
		in	cm
A	Height to top of upper handle Pro-Style® Stainless	36½	92.7
	Euro-Style (color-coordinating)	36½	92.7
B	Height to top of lower handle Pro-Style® Stainless	23¾	59.3
	Euro-Style (color-coordinating)	23¾	58.7
C	Height of trim extending below cutout	1⅞	4.3
D	Height from top of recessed oven to top of control panel JMW3430D	2½	6.3
	JMW2430D	2⅞	7.4
E	Height from bottom of recessed oven foot to bottom of oven vent	¾	0.5
F	Height of recessed oven	41	104.2
G	Height to top of control panel	43¾	111.1
H	Depth with door fully open	45¾	115.3
I	Depth with handles Pro-Style® Stainless	26¾	67.0
	Euro-Style (color-coordinating)	25⅞	64.3
J	Depth with doors	24¾	61.9
K	Depth of recessed oven	23¼	59.0

IMPORTANT: Dimensional specifications are provided for planning purposes only.
Do not make any cutouts based on this information. Refer to the Installation Guide before
selecting cabinetry, verifying electrical/gas connections, making cutouts or beginning installation.
All Jenn-Air® appliances are appropriately UL, CUL or CSA approved.



8610AdZw915

RECEIVED MAY 31 2018

30" COMBINATION MICROWAVE/WALL OVENS – FLUSH INSTALLATION

JMW3430D, JMW2430D – 30" x 43¾" x 24⅜" (depth without handles)

OPENING/CLEARANCE DIMENSIONS

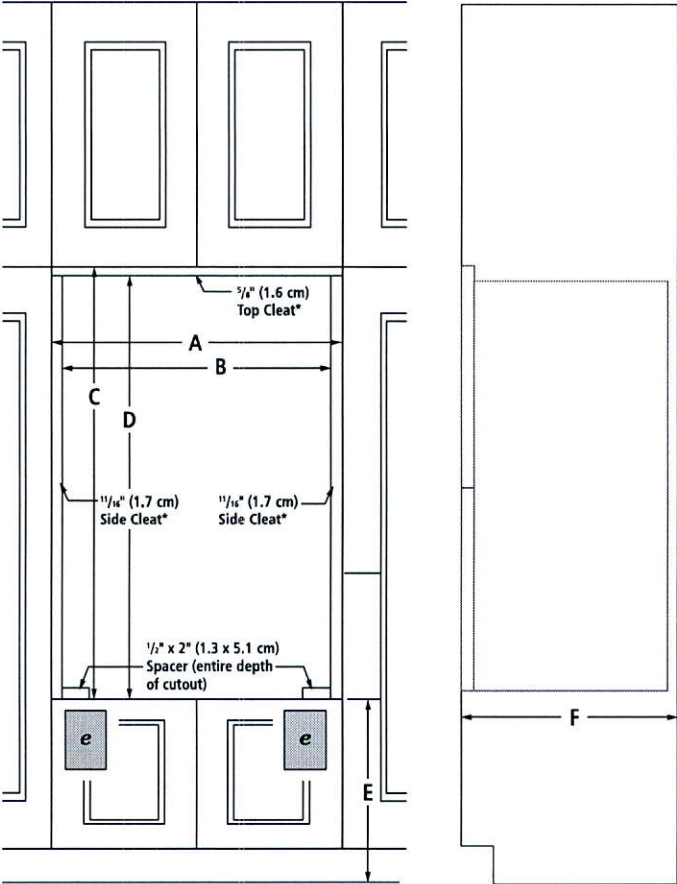

FRONT VIEW

SIDE VIEW

MODEL #		JMW3430D JMW2430D	
		in	cm
A	Width of flush inset cutout (min.)	30¼	76.8
B	Width of opening (min.)	28⅞	73.3
C	Height of flush inset cutout (min.)	44⅝	112.5
D	Height of opening (min.)	43⅞	110.9
E	Bottom of cutout to floor	4⅝-19¼	11.7-48.9
F	Depth of cutout (min.)	25	63.5
e	Recommended junction box location		

ELECTRICAL REQUIREMENTS

240 volt, 40-amp fused, grounded circuit is required. A dedicated circuit is required.

The length of conduit provided is for serviceability. Do not cut the conduit. The junction box should be located 3" (7.6 cm) maximum below the support surface. Drill a 1" (2.5 cm) minimum diameter hole in the right rear or left rear corner of the support surface for access to the junction box.

FLUSH INSTALLATION REQUIREMENTS

A 25" (63.5 cm) minimum cutout depth is required.

These dimensions will result in a ¼" (0.6 cm) reveal on the top, a ¼" (0.6 cm) reveal on the sides and a ⅛" (0.3 cm) reveal on the bottom of the wall oven.

The front face of the cleats and spacers will be visible and should be treated as a finished surface.

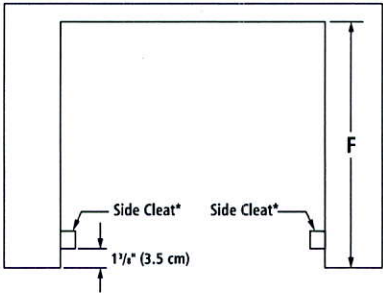

TOP VIEW

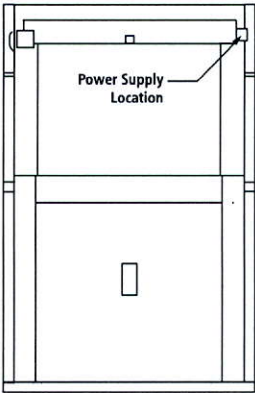

BACK VIEW

* Cleats and spacers must be recessed 1⅜" (3.5 cm) from the front of the cabinet.

IMPORTANT: Dimensional specifications are provided for planning purposes only. Do not make any cutouts based on this information. Refer to the Installation Guide before selecting cabinetry, verifying electrical/gas connections, making cutouts or beginning installation. All Jenn-Air® appliances are appropriately UL, CUL or CSA approved.



8610AdZw915

RECEIVED MAY 31 2018

KitchenAid® 30" (76.2 CM) AND 36" (91.4 CM) ELECTRIC INDUCTION COOKTOP

PRODUCT MODEL NUMBERS

KICU569X

ELECTRICAL REQUIREMENTS:

Before You Make the Electrical Connection:

Before You Make the Electrical Connection:
To properly install your cooktop, you must determine the type of electrical connection you will be using and follow the instructions provided for it here.

- A 4-wire or 3-wire, single phase, 240 volt, 60 Hz., AC only electrical supply is required on a separate, 50-amp circuit (36" [91.4 cm] models) or 40-amp circuit (30" [76.2 cm] models), fused on both sides of the line.
- The cooktop must be connected directly to the junction box through flexible, armored or nonmetallic sheathed, copper cable. The flexible, armored cable extending from the fuse box or circuit breaker box should be connected directly to the junction box.
- Locate the junction box to allow as much slack as possible between the junction box and the cooktop so that the cooktop can be moved if servicing becomes necessary in the future.
- Do not cut the conduit. The length of conduit provided is for serviceability of the cooktop.
- A UL listed or CSA approved conduit connector must be provided at each end of the power supply cable (at the cooktop and at the junction box). A listed conduit connector is already provided at the cooktop.
- If the house has aluminum wiring, follow the procedure below:
 1. Connect a section of solid copper wire to the pigtail leads.
 2. Connect the aluminum wiring to the added section of copper wire using special connectors and/or tools designed and UL listed for joining copper to aluminum.

Follow the electrical connector manufacturer's recommended procedure. Aluminum/copper connection must conform with local codes and industry accepted wiring practices.

PRODUCT DIMENSIONS

30" (76.2 cm) Cooktop

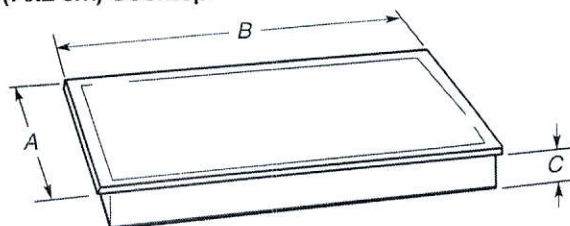

Model JIC4430	Model KICU509
A. 21 $\frac{3}{16}$ " (54.1 cm)	A. 21 $\frac{3}{16}$ " (54.1 cm)
B. 30 $\frac{3}{16}$ " (77.0 cm)	B. 30 $\frac{3}{16}$ " (78.2 cm)
C. 3 $\frac{1}{8}$ " (8.0 cm)	C. 3 $\frac{1}{8}$ " (8.0 cm)

36" (91.4 cm) Cooktop

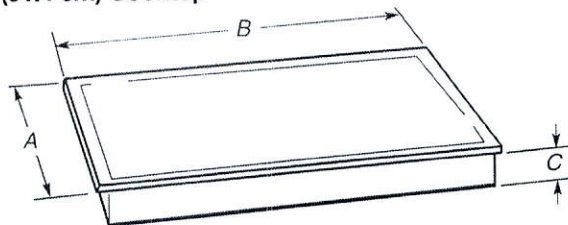

Models JIC4536 and KICU569

A. $21\frac{5}{16}$ " (54.1 cm)
B. $36\frac{5}{16}$ " (92.0 cm)
C. $3\frac{1}{8}$ " (8.0 cm)

Because Whirlpool Corporation policy includes a continuous commitment to improve our products, we reserve the right to change materials and specifications without notice.

CABINET DIMENSIONS

IMPORTANT: If installing a range hood or microwave hood combination above the range, follow the range hood or microwave hood combination installation instructions for dimensional clearances above the cooktop surface.

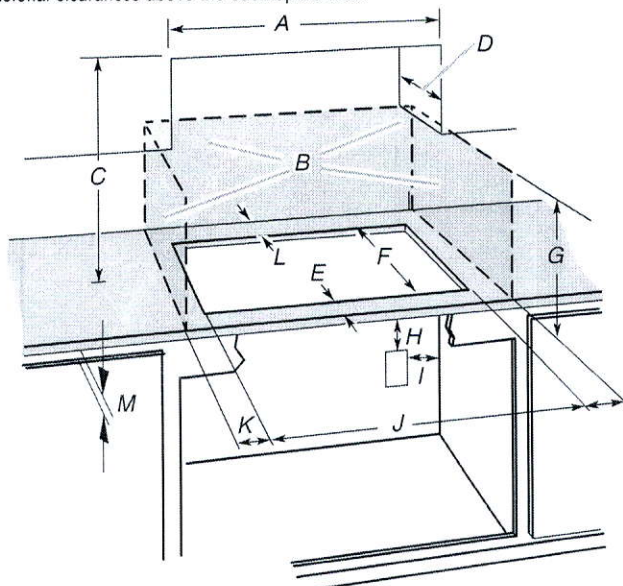

- A. 29½" (75.0 cm) on 30" (76.2 cm) models
33 ⅞" (84.0 cm) on 36" (91.4 cm) models
- B. Combustible area above countertop (shown by dashed box above)
- C. 30" (76.2 cm) minimum clearance between top of cooktop platform and bottom of uncovered wood or metal cabinet (24" [61 cm] minimum clearance if bottom of wood or metal cabinet is covered by not less than ¼" [0.6 cm] flame retardant millboard covered with not less than No. 28 MSG sheet steel, 0.015" [0.04 cm] stainless steel, or 0.024" [0.06 cm] aluminum or 0.020" [0.05 cm] copper)
- D. 13" (33.0 cm) recommended upper cabinet depth
- E. 2" (5.1 cm)
- F. 19 ⅜" (49.0 cm)
- G. 18" (45.7 cm) minimum clearance from upper cabinet to countertop within minimum horizontal clearances to cooktop
- H. Junction box or outlet; 12" (30.5 cm) minimum from bottom of countertop
- I. Junction box or outlet; 10" (25.4 cm) from right-hand side of cabinet
- J. 29½" (75.0 cm) on 30" (76.2 cm) models
33 ⅞" (84.0 cm) on 36" (91.4 cm) models
- K. 1" (2.5 cm) minimum distance to nearest left and right side combustible surface above cooktop
- L. 1" (2.5 cm) minimum clearance between back wall and countertop
- M. **IMPORTANT:** For proper ventilation, provide a vent of ⅜" (5 mm) under the countertop, in the front of the cabinet. The ventilation opening is to extend the full length of the cooktop cutout. See the following illustration.

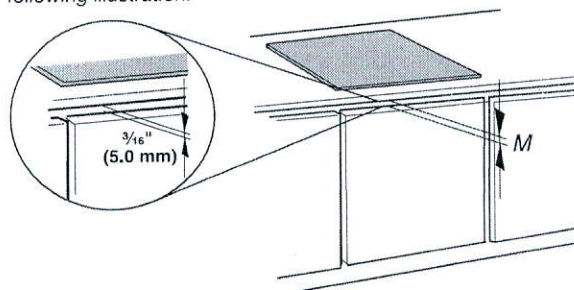

NOTES: After you make the countertop cutout, some installations may require notching down the base cabinet side walls to clear the cooktop base. To avoid this modification, use a base cabinet with sidewalls wider than the cutout.

If cabinet has a drawer, a 5½" (13 cm) depth clearance from the countertop to the top of the drawer (or other obstruction) in base cabinet is required.

Dimensions are for planning purposes only. For complete details, see Installation Instructions packed with product. Specifications subject to change without notice.

Ref. 501961902036B
4/21/11



PRODUCT MODEL NUMBERS

KRMF606E KRMF706E

Electrical: A 115 volt, 60 Hz, AC only, 15- or 20-amp fused, grounded electrical supply is required. It is recommended that a separate circuit serving only your refrigerator be provided. Use an outlet that cannot be turned off by a switch. Do not use an extension cord.

Water: A cold water supply with water pressure between 35 and 120 psi (241 and 827 kPa) is required to operate the water dispenser and ice maker. If you have questions about your water pressure, call a licensed, qualified plumber.

NOTE: If the water pressure is less than what is required, the flow of water from the water dispenser could decrease or ice cubes could be hollow or irregular shaped.

Reverse Osmosis Water Supply:

IMPORTANT: The pressure of the water supply coming out of a reverse osmosis system going to the water inlet valve of the refrigerator needs to be between 35 and 120 psi (241 and 827 kPa).

If a reverse osmosis water filtration system is connected to your cold water supply, the water pressure to the reverse osmosis system needs to be a minimum of 40 to 60 psi (276 to 414 kPa).

Bottom Mount Refrigerator

PRODUCT DIMENSIONS

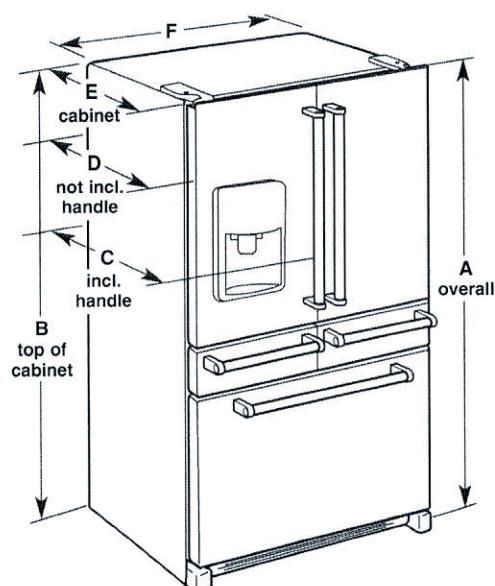

Model Size	Height - Overall "A"	Height - Top of Cabinet "B"	Depth - With Handles "C"	Depth - Without Handles "D"	Depth - Cabinet Only "E"	Width - Cabinet "F"
25.8	70 1/8" (178.1 cm)	68 3/8" (173.7 cm)	36 1/4" (92.1 cm)	34 1/2" (87.7 cm)	29" (73.7 cm)	36" (91.4 cm)

LOCATION REQUIREMENTS

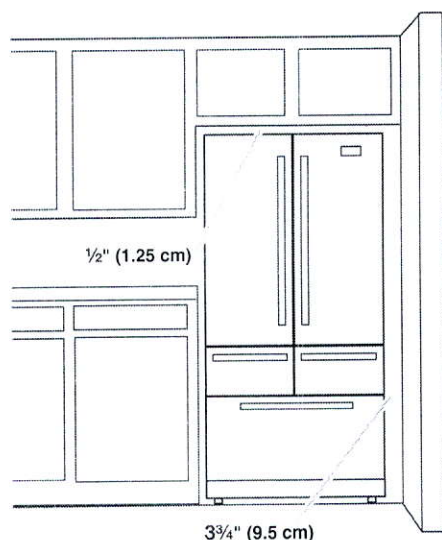

IMPORTANT: This refrigerator is designed for indoor, household use only.

To ensure proper ventilation for your refrigerator, allow for a 1/2" (1.25 cm) of space on each side and at the top. Allow for a 1" (2.54 cm) space behind the refrigerator. If your refrigerator has an ice maker, allow extra space at the back for the water line connections. When installing your refrigerator next to a fixed wall, leave a 3 3/4" (9.5 cm) minimum space between the refrigerator and wall to allow the door to swing open.

NOTE: This refrigerator is intended for use in a location where the temperature ranges from a minimum of 55°F (13°C) to a maximum of 110°F (43°C). The preferred room temperature range for optimum performance, which reduces electricity usage and provides superior cooling, is between 60°F (15°C) and 90°F (32°C). It is recommended that you do not install the refrigerator near a heat source, such as an oven or radiator.

PRODUCT MODEL NUMBERS

KVWB600D KVWB606D

Electrical: A 120 volt, 60 Hz., AC only, 15-amp, fused electrical circuit is required.

VENTING METHODS

This canopy range hood is factory set for venting through the roof or through the wall.

A 6" (15.2 cm) round vent system is needed for installation (not included). The hood exhaust opening is 6" (15.2 cm) round.

NOTE: Flexible vent is not recommended. Flexible vent creates back pressure and air turbulence that greatly reduce performance.

Vent system can terminate either through the roof or wall. To vent through a wall, a 90° elbow is needed.

Rear Discharge

A 90° elbow may be installed immediately above the hood.

For Non-Vented (Recirculating) Installations

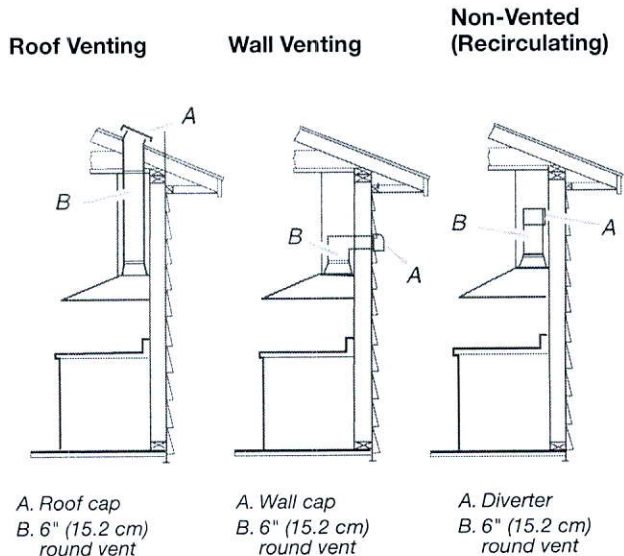

If it is not possible to vent cooking fumes and vapors to the outside, the hood can be used in the non-vented (recirculating) version, using a Recirculation Kit (which includes charcoal filters and a deflector). To order, see the "Assistance or Service" section.



Calculating Vent System Length

To calculate the length of the system you need, add the equivalent feet (meters) for each vent piece used in the system.

Vent System

Vent Piece	6" (15.2 cm) Round	
45° elbow	2.5 ft (0.8 m)	
90° elbow	5.0 ft (1.5 m)	

Maximum equivalent vent length is 35 ft (10.7 m).

Example Vent System

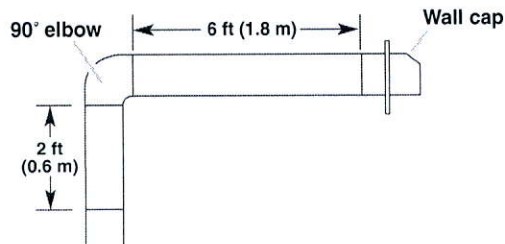

The following example falls within the maximum recommended vent length of 35 ft (10.7 m).

1 - 90° elbow	= 5.0 ft (1.5 m)
1 - wall cap	= 0.0 ft (0.0 m)
8 ft (2.4 m) straight	= 8.0 ft (2.4 m)
Length of system	= 13.0 ft (3.9 m)

PRODUCT DIMENSIONS

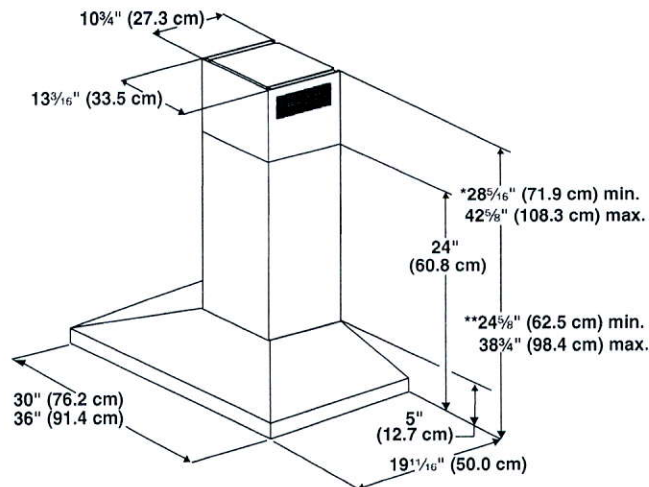

*For non-vented (recirculating) installations

**For vented installations

CABINET DIMENSIONS

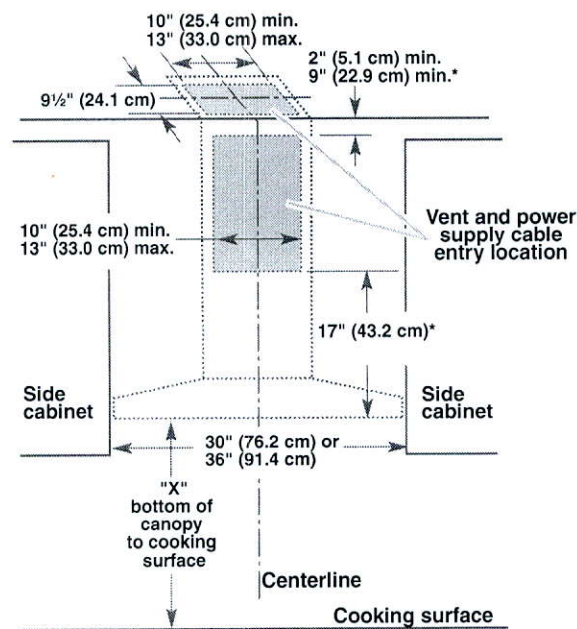

*For non-vented (recirculating) installations

IMPORTANT:

- Minimum distance "X": 24" (61.0 cm) from electric cooking surface.
- Minimum distance "X": 27" (68.6 cm) from gas cooking surfaces.
- Suggested maximum distance "X": 36" (91.4 cm)

The chimneys can be adjusted for different ceiling heights. See the following chart.

Vented Installations		
	Min. ceiling height	Max. ceiling height
Electric cooking surface	7' 1" (2.16 m)	9' 2" (2.79 m)
Gas cooking surface	7' 4" (2.23 m)	9' 2" (2.79 m)

Non-vented (recirculating) Installations		
	Min. ceiling height	Max. ceiling height
Electric cooking surface	7' 1" (2.16 m)	9' 6" (2.9 m)
Gas cooking surface	7' 4" (2.23 m)	9' 6" (2.9 m)

***NOTE:** The range hood chimneys are adjustable and designed to meet varying ceiling or soffit heights depending on the distance "X" between the bottom of the range hood and the cooking surface. For higher ceilings, a Chimney Extension Kit is available from your dealer or an authorized parts distributor. The chimney extension replaces the chimney shipped with the range hood. To order, see the "Assistance or Service" section.

FOR THE WAY IT'S MADE.®

Undercounter Dishwasher

PRODUCT MODEL NUMBERS

KDFE204E, KDTE104E, KDTE204E, KDTE254E, KDTM354E,
KDTM384E, KDTM404E, KDTM504E, KDTM704E, KDTM804E

Electrical Requirements: 120-volt, 60 Hz, AC-only, 15- or 20-amp. fused electrical supply. Copper wire only. A time delay fuse or circuit breaker and separate circuit is recommended.

If direct wiring dishwasher: Use flexible, armored or nonmetallic, sheathed copper wire with grounding wire that meets the wiring requirements for your home and local codes and ordinances.



Use a UL Listed or CSA Approved conduit connector.

If connecting dishwasher with a power supply cord:

Use power supply cord kit (Part Number 4317824) marked for use with dishwashers. Follow the kit instructions for installing the power supply cord.

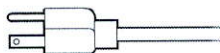

Power supply cord must plug into a grounded three-prong outlet located in the cabinet next to the dishwasher opening. Outlet must meet all local codes and ordinances.

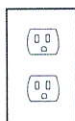

Water Supply Requirements: A hot water line with 20 to 120 psi (138 to 862 kPa) water pressure. Water temperature must be 120°F (49°C) water at dishwasher. Use 3/8" O.D. copper tubing with compression fitting or flexible braided water supply line

Note: 1/2" minimum plastic tubing is not recommended.

Use a 90° elbow with $\frac{3}{4}$ " hose connection with rubber washer (part number W10273460). Do not solder within 6" (15.2 cm) from water inlet valve.

Drain Requirements: A new drain hose is supplied with your dishwasher. If this is not long enough, use a new drain hose with a maximum length of 12' (3.7 m) (Part No. 3385556) that meets all current AHAM/IAPMO test standards, is resistant to heat and detergent, and fits the 1" (2.5 cm) drain connector of the dishwasher.

Make sure to connect the drain hose to waste tee or disposer inlet above drain trap in house plumbing and 20" (50.8 cm) minimum above the floor. It is recommended

that the drain hose either be looped up and securely fastened to the underside of the counter, or be connected to an air gap.

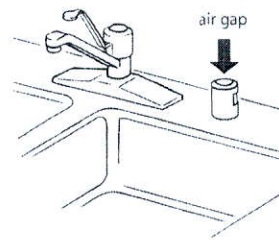

Make sure to use an air gap if the drain hose is connected to house plumbing lower than 20" (50.8 cm) above subfloor or

floor.

Use 1/2" (1.3 cm) minimum I.D. drain line fittings.

If required, the air gap should be installed in accordance with the air gap installation instructions. When connecting the air gap a rubber hose (not provided) will be needed to connect to the waste tee or disposer inlet.

PRODUCT DIMENSIONS

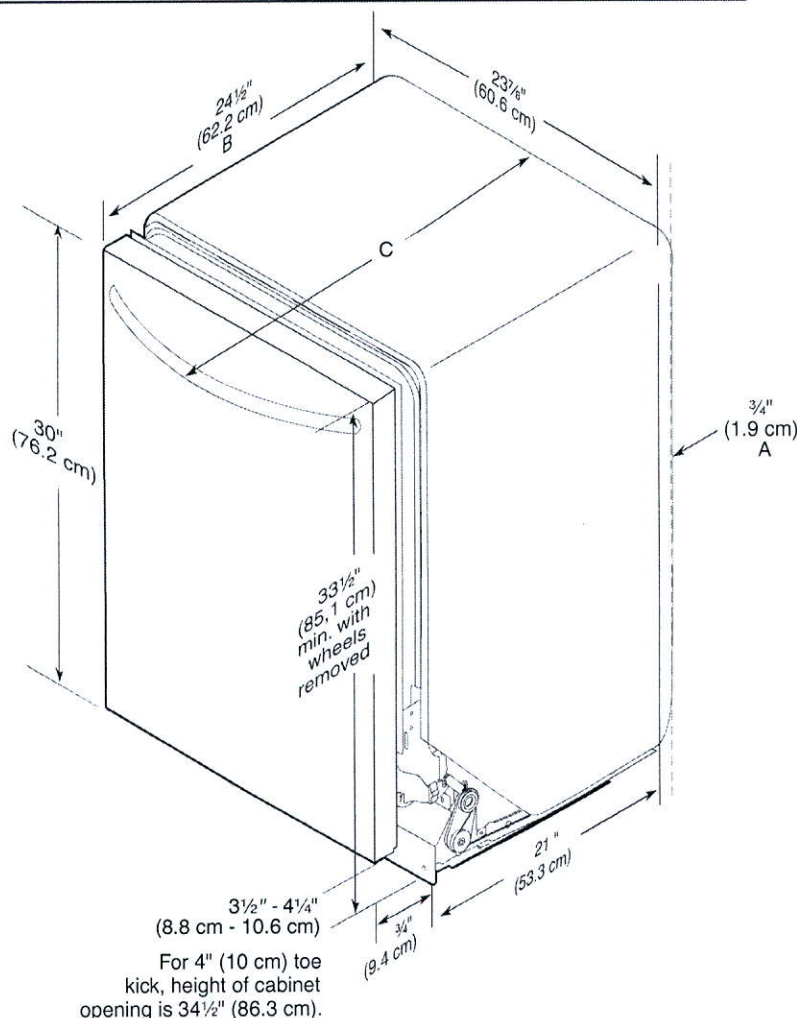

A. Insulation may be compressed (not used on all models).

B. For panel-ready models, dishwasher depth is 24" (60 cm) not including the 3/4" (1.9 cm) custom door panel.

C. Door handles may protrude forward of the face of the dishwasher; varies by model.

CABINET CUTOUT DIMENSIONS

NOTE: Shaded areas of cabinet walls show where utility connections may be installed.

*Measure from the lowest point on the underside of the countertop. May be reduced to 33½" (85.1 cm) by removing the rear leveling legs from dishwasher.

**Minimum, measured from narrowest point of opening.

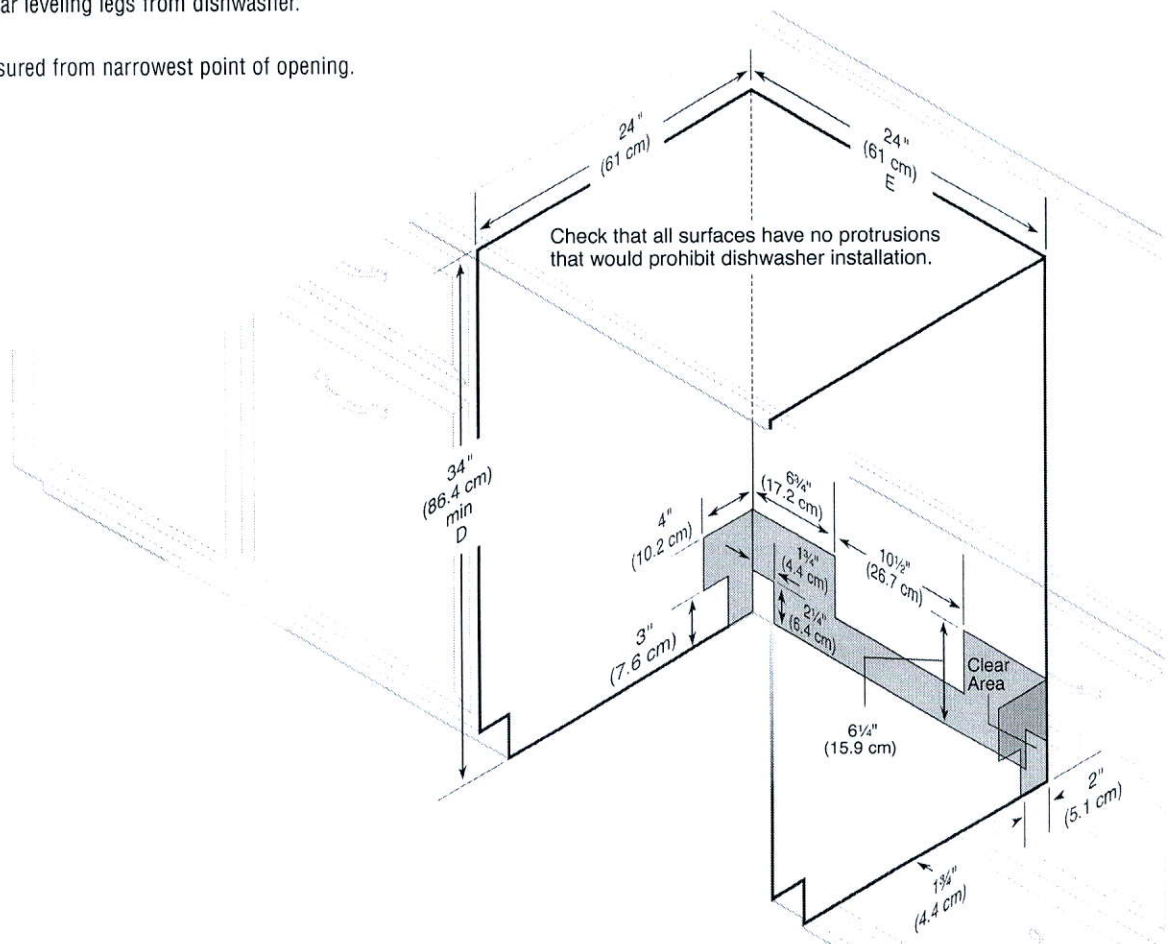

Moen Bathroom Accessories



Moen Mason Towel Ring

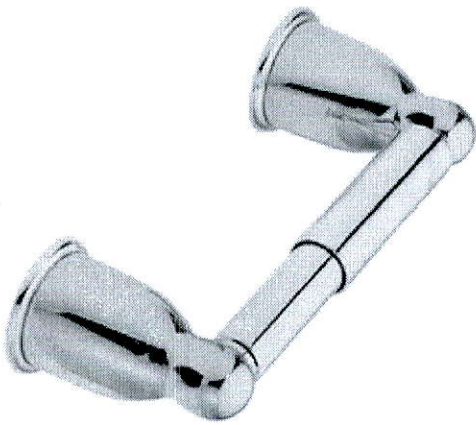

Moen Mason Toilet Paper Holder

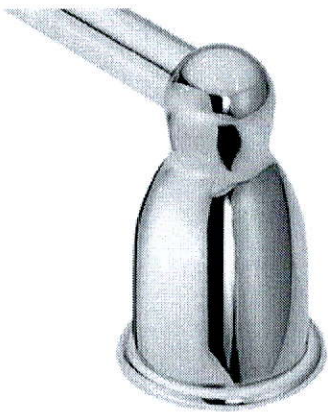

Moen Mason 18" Towel Bar

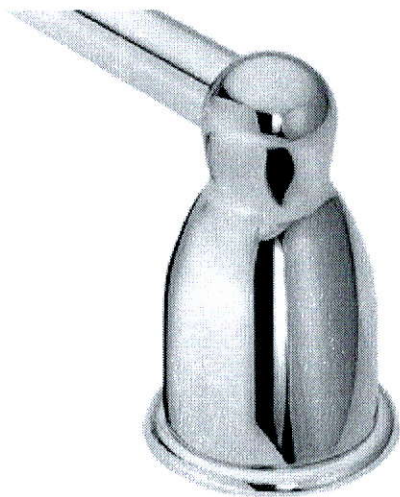

Moen Mason 24" Towel Bar

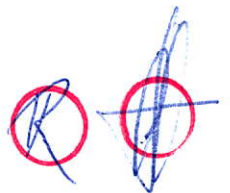

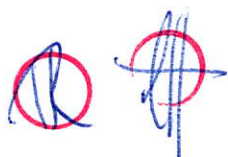

JUNIPER 7
3,093 sq.ft.

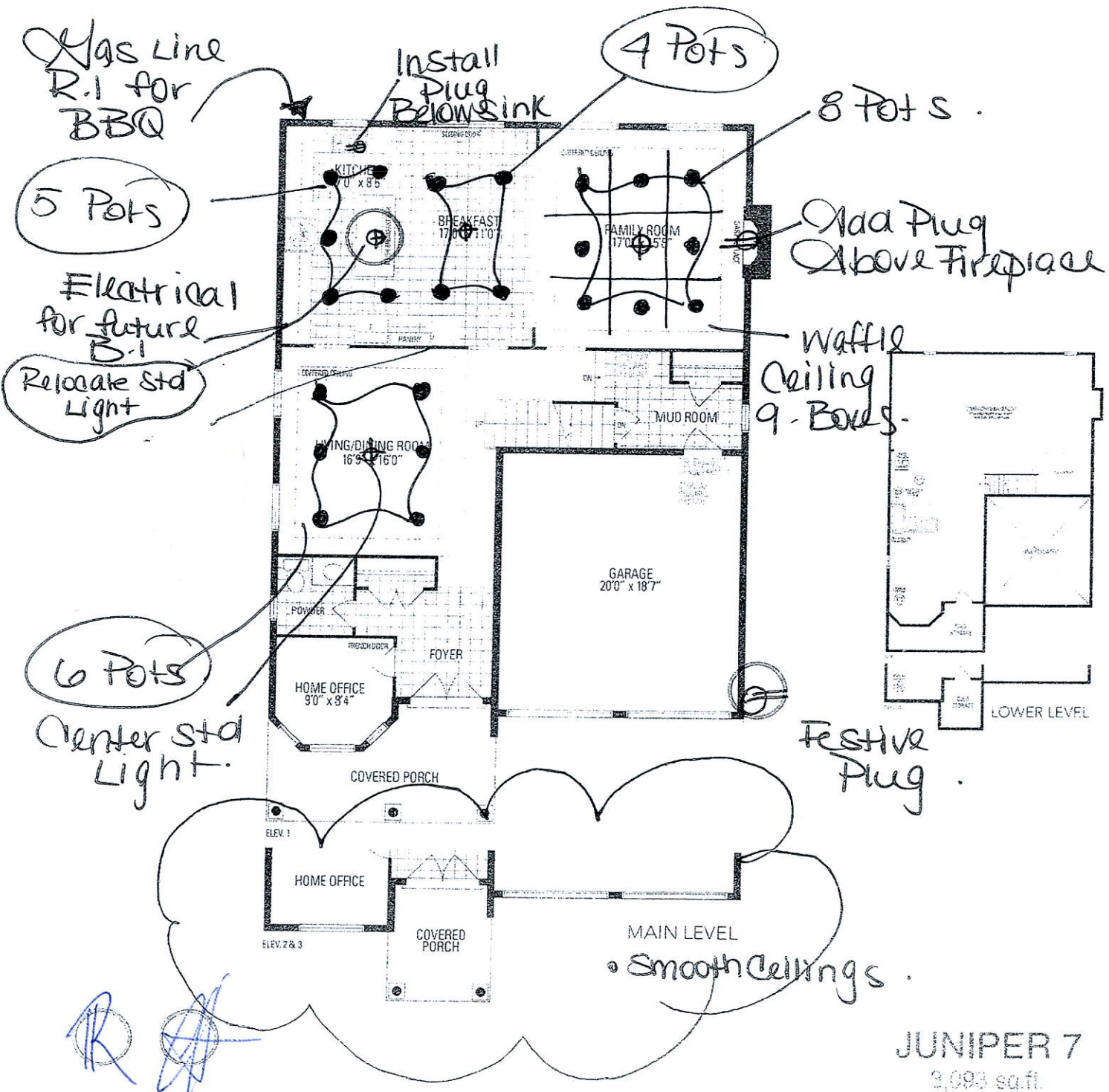

JUNIPER 7
3,093 sq.ft.



Orientation of units may be reversed upon purchase. Buyer agrees to accept the same. Steps and porches may vary at any exterior entrance walls due to grading variance. Actual usable floor space may vary from the stated floor area. All renderings are artist's concept. Dimensions, specifications and architectural detailing subject to minor modifications. Final location of stair pump is based on site conditions. Outline and adjoining model types may vary. © 2013 LEC Juniper 7 • Copyright 2013

LOT 243

LECCO RIDGE

JUNIPER 7

REVISION:

1. ADD WAFFLE CEILING TO FAMILY ROOM.

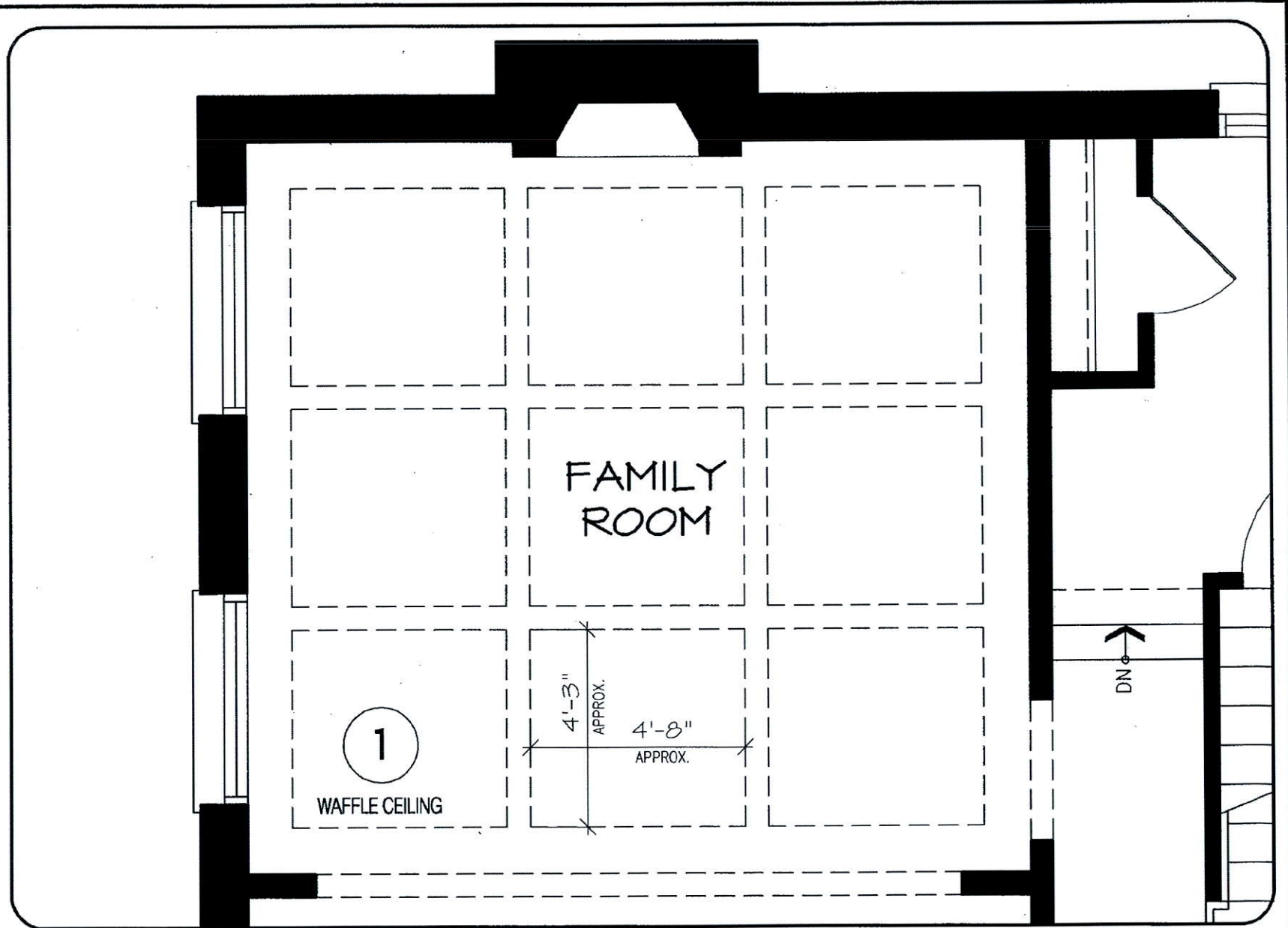

OCT 11 2017

MAIN LEVEL

DISCLAIMERS: SKETCH NOT TO SCALE. DIMENSIONS, SPECIFICATIONS AND ARCHITECTURAL DETAILS SUBJECT TO MODIFICATION BY THE VENDOR. SKETCH IS ONLY FOR THE PURPOSE OF ILLUSTRATING REVISIONS REQUESTED BY THE PURCHASER AND ALL REVISIONS ARE SUBJECT TO VENDOR'S FINAL APPROVAL. ONLY REVISIONS ACCEPTED IN WRITING BY THE PURCHASER AND VENDOR ON A PURCHASER'S EXTRA SHEET WILL BE INCORPORATED INTO THE PLANS FILED WITH THE MUNICIPALITY. E. & O.E.

REGION
DESIGN
INC.

SCALE
BY
MB

N.T.S.
PAGE No.
1 OF 2

Greenpark

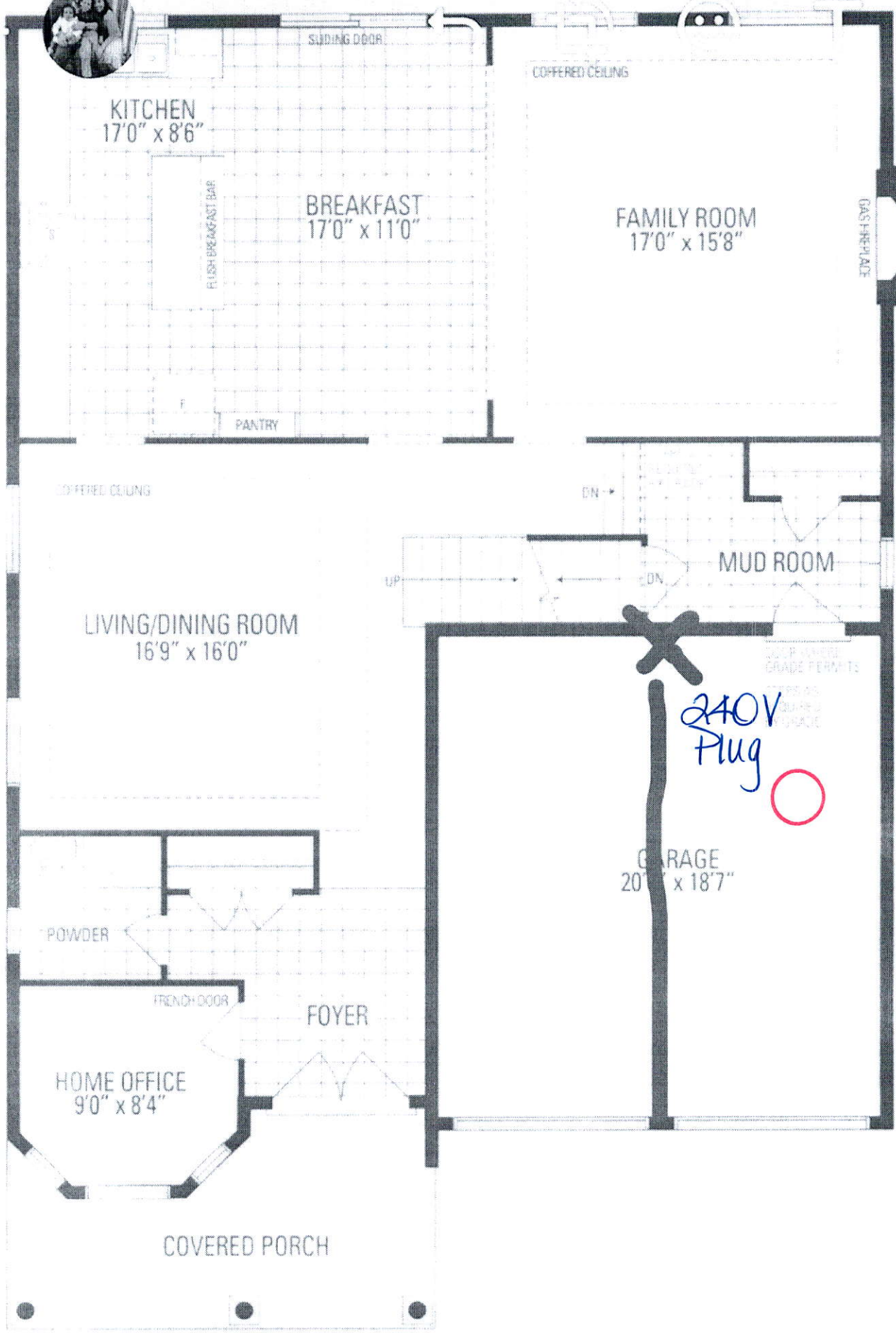
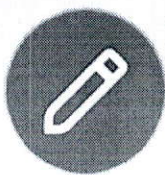

ELEV. 1

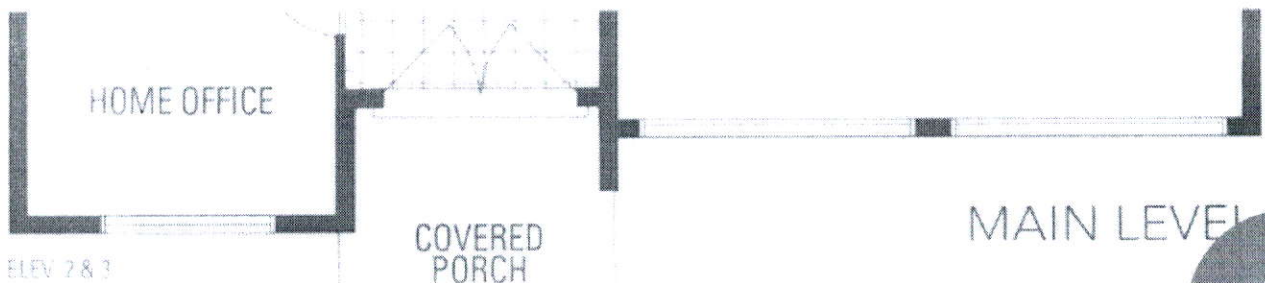

MAIN LEVEL

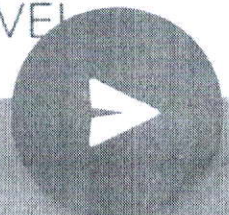

Add a caption...