

CONSTRUCTION SUMMARY

Mountainview Heights (G) - Russell Gardens Building Ltd.



PURCHASERS: SARAH LOREA BRADT and CHARLES E BRADT

TEL:

LOT / PHASE Block 201 TH 3 / 2	REG. PLAN # 62M-1238	HOUSE TYPE Highgrove 2 Elev 2		
-----------------------------------	-------------------------	----------------------------------	--	--

CABINETRY

1 - CABINETRY - KITCHEN - LIGHT VALENCE 12Jun18 Note:	
--	--

CABINETRY ACCESSORIES

1 - KITCHEN CABINETRY UPPER - ANGLED CORNER CABINET - FITS TALL UPPER CABINETS - PER UNIT - STANDARD 12Jun18 Note:	
1 - KITCHEN CABINETRY UPPER - FULL DEPTH ABOVE FRIDGE - WITH GABLES - 600MM - PRICE IS EACH - STANDARD 12Jun18 Note:	

CERAMIC TILE

1 - DELETE ALL CERAMIC BATHROOM ACCESSORIES - DELETE TOWEL BAR, PAPER HOLDER & SOAP DISH THROUGHOUT 12Jun18 Note:	
--	--

COUNTER TOP

1 - HARD SURFACE COUNTERTOP - KITCHEN 12Jun18 Note:	
--	--

ELECTRICAL

3 - POT LIGHT - EXTERIOR - SOFFIT MOUNT - REGULAR VOLTAGE 12Jun18 Note:	
--	--

HARDWOOD FLOORING

1 - LAMINATE -UPGRADE TO LEXINGTON SERIES IN LIEU OF STANDARD LAMINATE 12Jun18 Note:	
1 - LAMINATE - LEXINGTON SERIES - - UPPER HALL 12Jun18 Note:	

MIRRORS AND GLASS

1 - FRAMELESS GLASS SHOWER DOOR- WITH CHROME KNOB - MASTER ENSUITE 12Jun18 Note:	
---	--

PLUMBING

1 - SINK - UNDERMOUNT SINK - BLANCO ESSENTIAL U2 #400008- KITCHEN 12Jun18 Note:	
1 - WASHROOM - 3 PIECE ROUGH-IN IN BASEMENT 10Apr18 Note:	

PROMOTIONAL

1 - LESS CREDIT FROM PURCHASER EXTRA SHEET IN OFFER 12Jun18 Note:	
1 - PARTIAL REDEPTION OF PROMOTIONAL PACKAGE \$640.00 BALANCE (\$6,860) FORWARD TO BE USED AT A LATER DATE. ORIGINAL PROMOTIONAL PACKAGE OF \$7,500 AS PER SCHEDULE PE DATED -FEBRUARY 27, 2018 10Apr18 Note:	

STAIRS AND RAILINGS

1 - STAINED HANDRAIL, TREADS, RISERS AND STRINGER EXCLUDING PICKETS (FOR IRON PICKETS) - STANDARD STAIRCASE - PRICE IS PER SET 12Jun18 Note:	
1 - EUROLINE 1 12Jun18 Note:	

RECEIVED JUN 13 2018

CONSTRUCTION SUMMARY

Mountainview Heights (G) - Russell Gardens Building Ltd.

PURCHASERS: SARAH LOREA BRADT and CHARLES E BRADT

TEL:

LOT / PHASE Block 201 TH 3 / 2	REG. PLAN # 62M-1238	HOUSE TYPE Highgrove 2 Elev 2		
-----------------------------------	-------------------------	----------------------------------	--	--

EXTRAS AS PER OFFER

Five (5) White Appliances as per PE Appliances <i>Worksheet</i> Note:	
The Vendor agrees that notwithstanding any other term or provision in this Agreement included in the Purchase Price and in addition to those items detailed in Schedule GP to the Agreement of Purchase and Sale, the Purchaser is entitled to a credit of Sev <i>Worksheet</i> Note:	
The Purchaser acknowledges that the Purchase Price is inclusive of all credits and promotional packages available at the time of purchase. <i>Worksheet</i> Note:	

This Document is Extremely Time Sensitive - Printed 12 Jun 18 at 11:35

Purchasers:

Telephone Res. / Bus:

Decor Advisor:

Lock Date:

SARAH LOREA BRADT & CHARLES E BRADT

/

Natalie Mancuso

12-Jun-18

Property: Block 201 TH 3

Project: Russell Gardens Building Ltd.

Model and Elevation: Highgrove 2 Elev 2

Plan #: 62M-1238

Layout Changes:

Sketch Attached:

Exterior Colour Scheme:

☐ Yes ☒ No

☒ Yes ☐ No

1. Cabinetry

	Style and Colour	Hardware
Kitchen / Breakfast	MONACO W350XZ4	2002
Laundry Room	ELISSE	Standard
Powder Room	MODENA WHITE	2002
Master Ensuite Bathroom	MODENA WHITE	2002
Main Bathroom	MODENA WHITE	2002

Appliances:

Built In Appliances

Slide In Stove

Dishwasher Cabinet

Stove Opening

Fridge Opening

☐ Yes ☒ No

☐ Closed ☒ Open

41" Upper Cabinets ☒ Yes ☐ No

☐ Yes ☒ No

NOTE: If not specified, opening will be set to builder's standard opening of approximately 30" width

NOTE: If not specified, opening will be set to builder's standard opening of approximately 37" width x 74" height

Please NOTE: Standard Cabinet Height is 30"

** Refer to Construction Summary

2. Counters

	Counter	Edge
Kitchen / Breakfast	GRANITE- ANTIQUE BROWN LEATHERED	#320 PENCIL
Laundry Room	N/A	
Powder Room	LAMINATE-INUK SHUK GREY P-344 LM	
Master Ensuite Bathroom	LAMINATE-INUK SHUK CARBON P-346 LM	
Main Bathroom	LAMINATE-PALOMA DARK GREY 6366-46	

** Refer to Construction Summary

Purchasers:

SARAH LOREA BRADT & CHARLES E BRADT

Property:

Block 201 TH 3

Telephone Res. / Bus:

/

Project:

Russell Gardens Building Ltd.

Decor Advisor:

Natalie Mancuso

Model and Elevation:

Highgrove 2 Elev 2

Lock Date:

12-Jun-18

12-Jun-18

Plan #:

62M-1238

3. Ceramic Flooring

At a 45

Threshold-If App.

Entrance Vestibule	TILE- RAINBOW WHITE 13X13	<input type="checkbox"/>	METAL STRIP THROUGHOUT
Main Hall	LAMINATE	<input type="checkbox"/>	
Kitchen / Breakfast	TILE- RAINBOW WHITE 13X13	<input type="checkbox"/>	
Laundry Room	TILE- RAINBOW WHITE 13X13	<input type="checkbox"/>	
Powder Room	TILE- RAINBOW WHITE 13X13	<input type="checkbox"/>	
Master Ensuite Bathroom	TILE- RAINBOW WHITE 13X13	<input type="checkbox"/>	
Main Bathroom	TILE- RAINBOW WHITE 13X13	<input type="checkbox"/>	
		<input type="checkbox"/>	
		<input type="checkbox"/>	
		<input type="checkbox"/>	
		<input type="checkbox"/>	

** Refer to Construction Summary

4. Ceramic Wall Tile

Master Ensuite Bathroom	Selection	Describe
Tub Deck Wall	TILE- NATURALE NERO 8X10	
Tub Deck		
Tub Deck Skirt		
Shower Stall	TILE- NATURALE NERO 8X10	
Bathtub Enclosure Walls		
Main Bathroom	TILE- NATURALE GRIGIO 8X10	
Kitchen Backsplash		

** Refer to Construction Summary - STANDARD GROUT THROUGHOUT UNLESS SPECIFIED

5. Plumbing Fixtures

All Bathrooms

White

Whirlpool

☐ Yes ☒ No

Dishwasher Rough-In

☒ Yes ☐ No

Waterline for Fridge



☐ Yes ☒ No

** Refer to Construction Summary

6. Trim Carpentry

Interior Doors	CLERMONT
Interior Trim	2 3/4" CASING WITH 4 1/4" BASEBOARD - COLONIAL
Door Handles	As Per Construction Specifications
Exterior Front Door Handle	As Per Construction Specifications

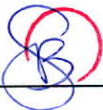
** Refer to Construction Summary

Initials:  

Purchasers:

Telephone Res. / Bus:

Decor Advisor:

Lock Date:

SARAH LOREA BRADT & CHARLES E BRADT

/

Natalie Mancuso

12-Jun-18

Property: Block 201 TH 3

Project: Russell Gardens Building Ltd.

Model and Elevation: Highgrove 2 Elev 2

Plan #: 62M-1238

7. Other Flooring

Main Hall

Living Room

Dining Room

Family Room

Den / Library / Study

Basement Landing(If Applies)

Lower Landing (If Applies)

Upper Landing

Upper Hall

Master Bedroom

Bedroom #2

Bedroom #3

Bedroom #4

Bedroom #5

LAMINATE-LEXINGTON - HAZELWOOD OAK TL21016 - M

LAMINATE-LEXINGTON - HAZELWOOD OAK TL21016 - M

LAMINATE-LEXINGTON - HAZELWOOD OAK TL21016 - M

LAMINATE-LEXINGTON - HAZELWOOD OAK TL21016 - M

LAMINATE-LEXINGTON - HAZELWOOD OAK TL21016 - M

LAMINATE-LEXINGTON - HAZELWOOD OAK TL21016 - M

LAMINATE-LEXINGTON - HAZELWOOD OAK TL21016 - M

CARPET- BEAULIEU-A4447 WEBSTER SDN- ATMOSPHERE GREY #87935

CARPET- BEAULIEU-A4447 WEBSTER SDN- ATMOSPHERE GREY #87935

CARPET- BEAULIEU-A4447 WEBSTER SDN- ATMOSPHERE GREY #87935

Underpad

Type

Area

STANDARD

BEDROOMS

** Refer to Construction Summary

8. Railings and Pickets

Railing Type

Picket Type

Stringer / Riser

Treads

AS PER CONSTRUCTION SPECIFICATIONS

EUROLINE 1

As Per Construction Specifications

As Per Construction Specifications

Colour

Colour

Colour

Colour

TORLYS- HAZELWOOD OAK

BLACK

TORLYS- HAZELWOOD OAK

TORLYS- HAZELWOOD OAK

Red Oak Stairs with Semi Gloss Finish

☒ Yes

☐ No

** Refer to Construction Summary

9. Wall Paint Flat Finish

Main & Upper Hall

Living Room

Dining Room

Kitchen / Breakfast

Family Room

Powder Room

Laundry Room

Den/Library

Trim Paint-Semi Gloss

22 WARM GREY

22 WARM GREY

22 WARM GREY

22 WARM GREY

22 WARM GREY

22 WARM GREY

22 WARM GREY

BIRCH WHITE

Master Bedroom

Bedroom #2

Bedroom #3

Bedroom #4

Bedroom #5

Master Ensuite

Main Bathroom

22 WARM GREY

22 WARM GREY

22 WARM GREY

22 WARM GREY

22 WARM GREY

Smooth Ceilings First Floor

☐ Yes

☒ No

** Refer to Construction Summary

Initials:

Page 3 of 4

Printed 6/12/2018 11:34:31

Purchasers:

Telephone Res. / Bus:

Decor Advisor:

Lock Date:

SARAH LOREA BRADT & CHARLES E BRADT

/

Natalie Mancuso

12-Jun-18

Property: Block 201 TH 3

Project: Russell Gardens Building Ltd.

Model and Elevation: Highgrove 2 Elev 2

12-Jun-18

Plan #: 62M-1238

10. Plaster Mouldings and Medallions

Entrance Vestibule			Kitchen/Breakfast		
Main Hall			Den/Library		
Living Room			Lower Landing		
Dining Room					
Family Room					

** Refer to Construction Summary

11. Fireplace

	Living Room			Family Room			Other Room - Specify		
	Purchased	As Per Plan	N/A	Purchased	As Per Plan	N/A	Purchased	As Per Plan	N/A
	<input type="radio"/>	<input type="radio"/>	<input checked="" type="radio"/>	<input type="radio"/>	<input type="radio"/>	<input checked="" type="radio"/>	<input type="radio"/>	<input type="radio"/>	<input checked="" type="radio"/>
Fireplace Type									
Mantle Type									
Colour / Stain									
Surround									
Hearth									

** Refer to Construction Summary

12. Heating and Air Conditioning

Air Conditioning	NO	Gas Provisions Stove	NO
Gas Provisions Dryer	NO	Gas Provisions Barbecue	NO
Comment			

** Refer to Construction Summary

13. Electrical

Plugs and Switches	<input checked="" type="radio"/> White	DECOR	Above Kitchen Cabinet Light	<input type="radio"/> Yes	<input checked="" type="radio"/> No
Hood Fan	STANDARD WHITE		Below Kitchen Cabinet Light	<input type="radio"/> Yes	<input checked="" type="radio"/> No
Appliances	Built in Cooktop	Built in Oven	Gas Stove	Microwave	
	<input type="radio"/> Yes <input checked="" type="radio"/> No	<input type="radio"/> Yes <input checked="" type="radio"/> No	<input type="radio"/> Yes <input checked="" type="radio"/> No	<input type="radio"/> Yes	<input checked="" type="radio"/> No
Dishwasher Rough-in	Yes				

** Refer to Construction Summary

14. General Comments

** Refer to Construction Summary

Disclaimers and Notes

1) Colours of all materials are as close as possible to builder's selection, but not necessarily identical due to variances in manufacturing.

2) Any extras listed above are null and void unless accompanied by a separate invoice/amendment. Said invoice must be paid in full.

3) The Purchaser agrees that this colour selection is final and that no changes will be permitted, unless required by the Vendor.

4) The Purchaser acknowledges reading and accepting document which contains other miscellaneous disclaimers.

Signature: Bradt

Date: 12/6/18

Signature: [Signature]

Date:

light
valance

Upper
angled
corner

Full
depth
Fridge

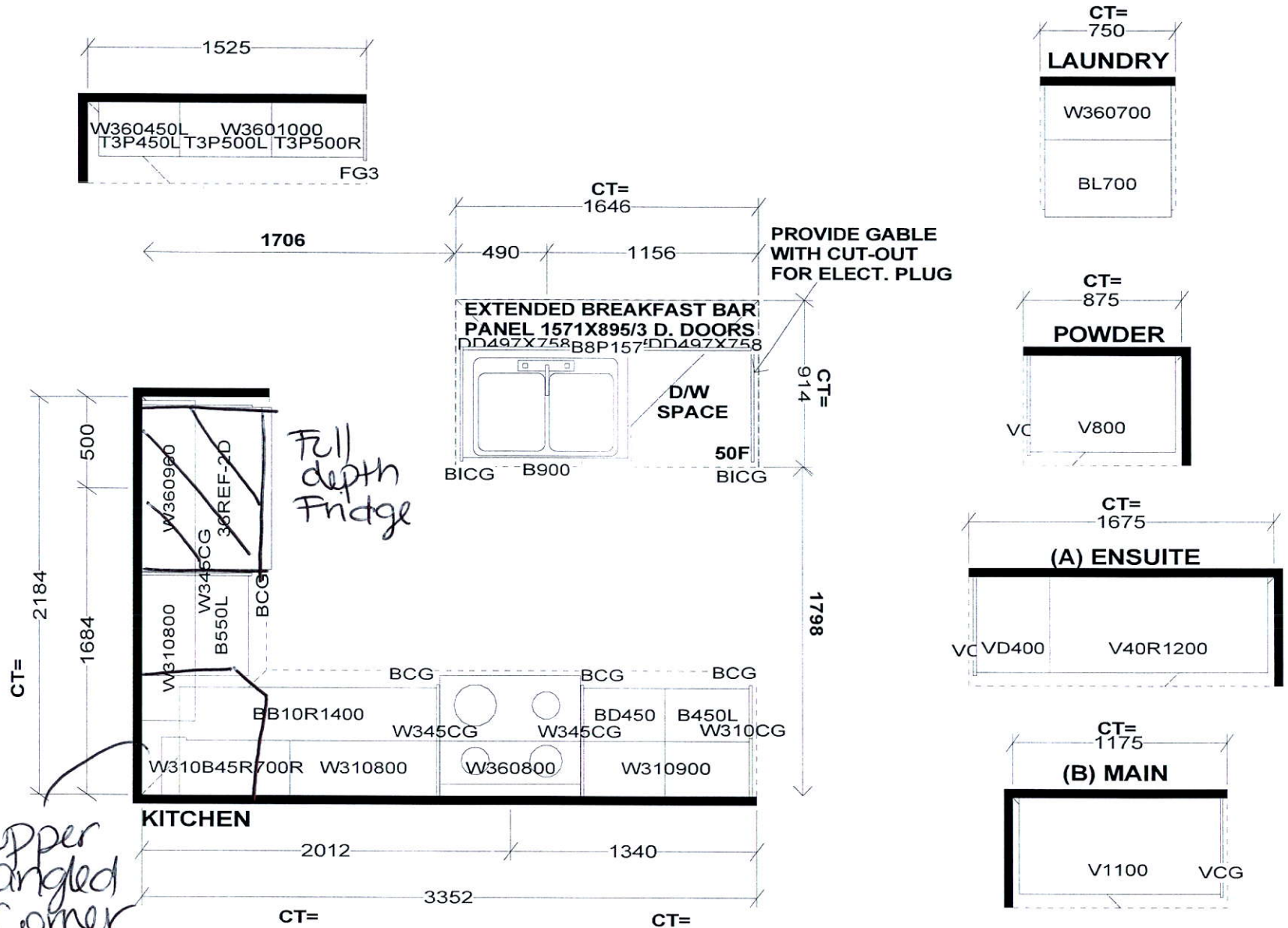

Selba Industries

W	WDTH	W	HGHT	W	CNT	FL	HGHT	DWY	H	ST	CENT	2X4	VENT BOX COVER
STANDARD FEATURES:													
1040MM HIGH UPPERS (9' Ceiling-No D/C Box)													
DUMMY DOORS													
D/W SPACE													
LAMINATE KITCHEN & VANITY COUNTERTOPS													
This drawing is the intellectual property of SELBA INDUSTRIES INC. and is an original design which must not be released or copied unless applicable fee has been paid or job order placed.									GHA FED		JOB NUMBER: BUILDER: GREENPARK SITE NAME: RUSSEL GARDENS MODEL: HIGHGROVE 2X ELEV 1,2,3 LOT #: DESIGNER: KS DATE: SEPT 13 17		

AVAILABLE IN BLOCK: 200, 201, 202, 205, 206, 207, 208, 211, 216 & 217

AVAILABLE IN BLOCK: 200, 201, 202, 205, 206, 207, 208, 211, 216 & 217



UPPER LEVEL
exterior.
3 pots
1 switch