

CONSTRUCTION SUMMARY

Mayfield Village 2 (G) - Minnisale Homes Corp.

PURCHASERS: MONICA MCKENZIE and YVETTE .E DIXON // HUGH LAWSON JUNIOR LY

TEL: RES.: 416-384-0983

LOT / PHASE 37L / 2	REG. PLAN # 43M-2060	HOUSE TYPE Hemlock 3 Elev 2 (4 Bedroom Plan)		
------------------------	-------------------------	---	--	--

CABINETRY ACCESSORIES

1 - KITCHEN CABINETY BASE - BANK OF DRAWERS - STANDARD 20Feb19 Note:	
1 - KITCHEN CABINETY UPPER - GLASS DOOR - GLK340 CORD GLASS - FINISHED INTERIOR - FITS TALL UPPER CABINETS ONLY - PRICE IS PER DOOR - STANDARD 20Feb19 Note:	
1 - KITCHEN CABINETY UPPER - MICROWAVE SHELF STANDARD - 700MM WIDE - STANDARD 20Feb19 Note:	
1 - KITCHEN CABINETY UPPER - FULL DEPTH ABOVE FRIDGE - WITH GABLES - 600MM - PRICE IS EACH - STANDARD 20Feb19 Note:	
1 - KITCHEN CABINETY UPPER - ANGLED CORNER CABINET - FITS TALL UPPER CABINETS - PER UNIT - STANDARD 20Feb19 Note:	
1 - KITCHEN CABINETY BASE - PIE CUT CORNER CABINET - BASE CABINETY - STANDARD 20Feb19 Note:	
1 - KITCHEN CABINETY BASE - POT/PAN DRAWERS (CABINET) - STANDARD 20Feb19 Note:	

DOORS AND TRIM

1 - DOORS - CLOSET - MIRROR SLIDER IN LIEU OF STANDARD STYLE INTERIOR DOORS - BEDROOM 2 20Feb19 Note:	
--	--

ELECTRICAL

1 - LIGHT AND SWITCH - NO FIXTURE INCLUDED - LIVING ROOM 20Feb19 Note:	
1 - PLUG - ELECTRICAL PLUG - FOR MICROWAVE SHELF 20Feb19 Note:	

HARDWOOD FLOORING

1 - LAMINATE - MANHATTAN SERIES - - UPPER HALL 20Feb19 Note:	
---	--

PLUMBING

3 - VIEIRA 2 PC TOILET #4792BOV/4791BOVU (UNLINED TANK) WITH SMOOTH CLOSE TOILET SEAT 20Feb19 Note:	
1 - WATER LINE FOR FRIDGE - ROUGH-IN ONLY 20Feb19 Note:	

PROMOTIONAL

1 - PURCHASER FOREFITS REMAINDER OF UPGRADE CREDIT 20Feb19 Note:	
1 - LESS BALANCE OF CREDIT FROM PURCHASER EXTRA SHEET IN OFFER 20Feb19 Note:	

STAIRS AND RAILINGS

1 - UPGRADE PICKETS - 1 3/4 COLONIAL STYLE 20Feb19 Note:	
1 - STAINED STAIRS, RAILING AND PICKETS - STANDARD STAIRCASE - PRICE IS PER SET 20Feb19 Note:	

RECEIVED MAR 28 2019

CONSTRUCTION SUMMARY

Mayfield Village 2 (G) - Minnisale Homes Corp.

PURCHASERS: MONICA MCKENZIE and YVETTE ,E DIXON // HUGH LAWSON JUNIOR LY

TEL: RES.: 416-384-0983

LOT / PHASE 37L / 2	REG. PLAN # 43M-2060	HOUSE TYPE Hemlock 3 Elev 2 (4 Bedroom Plan)		
------------------------	-------------------------	---	--	--

EXTRAS AS PER OFFER

Five (5) White Appliances as per PE Appliances Worksheet Note:	
The Purchaser acknowledges that the Purchase Price is inclusive of all credits and promotional packages available at the time of purchase. Worksheet Note:	
(10) The Vendor agrees that notwithstanding any other term or provision in this Agreement included in the Purchase Price and in addition to those items detailed in Schedule GP to the Agreement of Purchase and Sale, the Purchaser is entitled to a credit o Worksheet Note:	

This Document is Extremely Time Sensitive - Printed 20 Feb 19 at 15:16

Purchasers: MONICA MCKENZIE & YVETTE ,E DIXON // HU

Property: 37L

Telephone Res. / Bus: (416) 384-0983 /

Project: Minnisale Homes Corp.

Decor Advisor: Natalie Mancuso

Model and Elevation: Hemlock 3 Elev 2 (4 Bedroom Plan)

Lock Date: 20-Feb-19

20-Feb-19

Plan #: 43M-2060

Layout Changes: ☐ Yes ☒ No

Sketch Attached: ☒ Yes ☐ No

Exterior Colour Scheme:

1. Cabinetry

	Style and Colour	Hardware
Kitchen / Breakfast	HASTING CHOCOLATE	2002
Laundry Room	N/A	N/A
Powder Room	EVEREST WHITE	2002
Master Ensuite Bathroom	CONTINENTAL 814 DARK CHOCOLATE	2002
Main Bathroom	CONTINENTAL 814 DARK CHOCOLATE	2002

Appliances:

Dishwasher Cabinet

Built In Appliances ☐ Yes ☒ No

Slide In Stove ☐ Yes ☒ No

Stove Opening

☐ Closed ☒ Open

41" Upper Cabinets ☒ Yes ☐ No

Please NOTE: Standard Cabinet Height is 30"

Fridge Opening

NOTE: If not specified, opening will be set to builder's standard opening of approximately 37" width x 74" height

** Refer to Construction Summary

2. Counters

	Counter	Edge
Kitchen / Breakfast	LAMINATE-INUK SHUK TAUPE P-345 LM	
Laundry Room	N/A	
Powder Room	LAMINATE-BRONZITE 4971-52	
Master Ensuite Bathroom	LAMINATE-CARRARA BIANCO 6696-46	
Main Bathroom	LAMINATE-CARRARA BIANCO 6696-46	

** Refer to Construction Summary

Initials: MM

Purchasers: MONICA MCKENZIE & YVETTE ,E DIXON // HU

Telephone Res. / Bus: (416) 384-0983 /

Decor Advisor: Natalie Mancuso

Lock Date: 20-Feb-19

Property: 37L

Project: Minnisale Homes Corp.

Model and Elevation: Hemlock 3 Elev 2 (4 Bedroom Plan)

Plan #: 43M-2060

3. Ceramic Flooring

		At a 45°	Threshold-If App.
Entrance Vestibule	TILE- ESSENZE GRIGIO 13X13	<input type="checkbox"/>	Metal Strip Where Applicable
Main Hall	LAMINATE	<input type="checkbox"/>	
Kitchen / Breakfast	TILE- ESSENZE GRIGIO 13X13	<input type="checkbox"/>	
Laundry Room	N/A	<input type="checkbox"/>	
Powder Room	TILE- ESSENZE GRIGIO 13X13	<input type="checkbox"/>	
Master Ensuite Bathroom	TILE- RAINBOW LIGHT GREY 13X13	<input type="checkbox"/>	
Main Bathroom	TILE- RAINBOW WHITE 13X13	<input type="checkbox"/>	
SIDE ENTRANCE	TILE- ESSENZE GRIGIO 13X13	<input type="checkbox"/>	
		<input type="checkbox"/>	
		<input type="checkbox"/>	
		<input type="checkbox"/>	

** Refer to Construction Summary

4. Ceramic Wall Tile

	Selection	Describe
Master Ensuite Bathroom		
Tub Deck Wall	TILE- NATURALE GRIGIO 8X10	
Tub Deck		
Tub Deck Skirt		
Shower Stall	TILE- NATURALE GRIGIO 8X10	
Bathtub Enclosure Walls		
Main Bathroom	TILE- NATURALE GRIGIO 8X10	
SIDE ENTRANCE		
Kitchen Backsplash		

** Refer to Construction Summary - STANDARD GROUT THROUGHOUT UNLESS SPECIFIED

5. Plumbing Fixtures

All Bathrooms

White

Whirlpool

☐ Yes ☒ No

Dishwasher Rough-In

☒ Yes ☐ No

Waterline for Fridge

☒ Yes ☐ No

** Refer to Construction Summary

6. Trim Carpentry

Interior Doors	CARRARA
Interior Trim	2 3/4" CASING WITH 4 1/4" BASEBOARD - COLONIAL
Door Handles	KNOB - SATIN NICKEL
Exterior Front Door Handle	As Per Construction Specifications

** Refer to Construction Summary

Initials: MM

Purchasers:

MONICA MCKENZIE & YVETTE ,E DIXON // HU

Telephone Res. / Bus:

(416) 384-0983 /

Decor Advisor:

Natalie Mancuso

Lock Date:

20-Feb-19

Property: 37L

Project: Minnisale Homes Corp.

Model and Elevation: Hemlock 3 Elev 2 (4 Bedroom Plan)

Plan #:

43M-2060

7. Other Flooring

Main Hall	LAMINATE-MANHATTAN - BOARDWALK ACACIA TL-15019	
Living Room	LAMINATE-MANHATTAN - BOARDWALK ACACIA TL-15019	
Dining Room	LAMINATE-MANHATTAN - BOARDWALK ACACIA TL-15019	
Family Room	LAMINATE-MANHATTAN - BOARDWALK ACACIA TL-15019	
Den / Library / Study		
Basement Landing(If Applies)		
Lower Landing (If Applies)	LAMINATE-MANHATTAN - BOARDWALK ACACIA TL-15019	
Upper Landing	LAMINATE-MANHATTAN - BOARDWALK ACACIA TL-15019	
Upper Hall	LAMINATE-MANHATTAN - BOARDWALK ACACIA TL-15019	
Master Bedroom	CARPET-BEAULIEU - A4447 WEBSTER SDN - VELVETY BISTRE 18925	
Bedroom #2	CARPET-BEAULIEU - A4447 WEBSTER SDN - VELVETY BISTRE 18925	
Bedroom #3	CARPET-BEAULIEU - A4447 WEBSTER SDN - VELVETY BISTRE 18925	
Bedroom #4	CARPET-BEAULIEU - A4447 WEBSTER SDN - VELVETY BISTRE 18925	
Bedroom #5		
Underpad	Type	Area
	STANDARD UNDERPAD	BEDROOMS

** Refer to Construction Summary

8. Railings and Pickets

Railing Type	AS PER CONSTRUCTION SPECIFICATIONS	Colour	TORLYS- BOARDWALK ACACIA
Picket Type	1 3/4 PICKETS COLONIAL	Colour	TORLYS- BOARDWALK ACACIA
Stringer / Riser	AS PER CONSTRUCTION SPECIFICATIO	Colour	TORLYS- BOARDWALK ACACIA
Treads	AS PER CONSTRUCTION SPECIFICATIO	Colour	TORLYS- BOARDWALK ACACIA
Red Oak Stairs with Semi Gloss Finish		<input checked="" type="radio"/> Yes <input type="radio"/> No	

** Refer to Construction Summary

9. Wall Paint Flat Finish

Main & Upper Hall	22 WARM GREY	Master Bedroom	22 WARM GREY
Living Room	22 WARM GREY	Bedroom #2	22 WARM GREY
Dining Room	22 WARM GREY	Bedroom #3	22 WARM GREY
Kitchen / Breakfast	22 WARM GREY	Bedroom #4	22 WARM GREY
Family Room	22 WARM GREY	Bedroom #5	
Powder Room	22 WARM GREY	Master Ensuite	22 WARM GREY
Laundry Room		Main Bathroom	22 WARM GREY
Den/Library			
Trim Paint-Semi Gloss	BIRCH WHITE		

Smooth Ceilings First Floor ☐ Yes ☒ No

** Refer to Construction Summary

Initials: 

Purchasers:

MONICA MCKENZIE & YVETTE E DIXON // HU

Telephone Res. / Bus:

(416) 384-0983 /

Decor Advisor:

Natalie Mancuso

Lock Date:

20-Feb-19

Property: 37L

Project: Minnisale Homes Corp.

Model and Elevation: Hemlock 3 Elev 2 (4 Bedroom Plan)

Plan #:

43M-2060

10. Plaster Mouldings and Medallions

Entrance Vestibule			Kitchen/Breakfast		
Main Hall			Den/Library		
Living Room			Lower Landing		
Dining Room					
Family Room					

** Refer to Construction Summary

11. Fireplace

	Living Room			Family Room			Other Room - Specify		
	Purchased	As Per Plan	N/A	Purchased	As Per Plan	N/A	Purchased	As Per Plan	N/A
Fireplace Type	<input type="radio"/>	<input type="radio"/>	<input checked="" type="radio"/>	<input type="radio"/>	<input type="radio"/>	<input checked="" type="radio"/>	<input type="radio"/>	<input type="radio"/>	<input checked="" type="radio"/>
Mantle Type									
Colour / Stain									
Surround									
Hearth									

** Refer to Construction Summary

12. Heating and Air Conditioning

Air Conditioning	NO	Gas Provisions Stove	NO
Gas Provisions Dryer	NO	Gas Provisions Barbecue	NO
Comment			

** Refer to Construction Summary

13. Electrical

Plugs and Switches	<input checked="" type="radio"/> White	DECOR	Above Kitchen Cabinet Light	<input type="radio"/> Yes	<input checked="" type="radio"/> No
Hood Fan	STANDARD WHITE		Below Kitchen Cabinet Light	<input type="radio"/> Yes	<input checked="" type="radio"/> No
Appliances	Built in Cooktop	Built in Oven	Gas Stove	Microwave	
	<input type="radio"/> Yes <input checked="" type="radio"/> No	<input type="radio"/> Yes <input checked="" type="radio"/> No	<input type="radio"/> Yes <input checked="" type="radio"/> No	<input checked="" type="radio"/> Yes <input type="radio"/> No	
Dishwasher Rough-in	Yes				

** Refer to Construction Summary

14. General Comments

** Refer to Construction Summary

Disclaimers and Notes

- 1) Colours of all materials are as close as possible to builder's selection, but not necessarily identical due to variances in manufacturing.
- 2) Any extras listed above are null and void unless accompanied by a separate invoice/amendment. Said invoice must be paid in full.
- 3) The Purchaser agrees that this colour selection is final and that no changes will be permitted, unless required by the Vendor.
- 4) The Purchaser acknowledges reading and accepting document which contains other miscellaneous disclaimers.

Signature: 

Date: Feb 20, 2019

Signature: _____

Date: _____

PROTOTYPE FOR EXTRAS

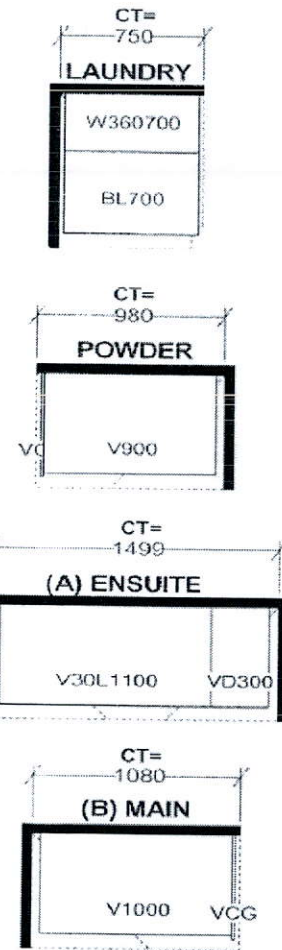

W W D T H	W H G H T	W C N T	FL H G H T	D W Y H	ST C E N T	2 X 4	VENT BOX COVER
<p><i>This drawing is the intellectual property of SELBA INDUSTRIES INC. and is an original design which must not be released or copied unless applicable fee has been paid or job order placed.</i></p>				<p>JOB NUMBER: BUILDER: GREENPARK SITE NAME: MINNISALE, Brampton MODEL: HEMLOCK 3X 3 BDRM ELEV 1.2 LOT #: DESIGNER: KS DATE: AUG 8 18</p>			

/

