



CONSTRUCTION SUMMARY				
Saddle Ridge (G) - Lecco Ridge Developments Inc.				
PURCHASER: INVENTORY HOME_B340_TH5				TEL:
LOT / PHASE Block 340 TH 5 / 1	REG. PLAN # 20M-1184	HOUSE TYPE Ivy 3 Elev 2		

CABINETRY ACCESSORIES

1 - KITCHEN CABINENTRY UPPER - FULL DEPTH ABOVE FRIDGE - WITH GABLES - 600MM - PRICE IS EACH - STANDARD 07Jun19    Note:	
---	--

CERAMIC TILE

1 - TILE - UPGRADE 1 FLOOR TILE - - SIDE HALL 07Jun19    Note:	
1 - TILE - UPGRADE 1 FLOOR TILE - - POWDER ROOM 07Jun19    Note:	
1 - TILE - UPGRADE 1 FLOOR TILE - - FOYER 07Jun19    Note:	
1 - TILE - UPGRADE 1 FLOOR TILE - - KITCHEN 07Jun19    Note:	

HARDWOOD FLOORING

1 - LAMINATE - PARK LANE SERIES - - SECOND FLOOR COMPLETE 07Jun19    Note:	
---	--

STAIRS AND RAILINGS

1 - STAINED STAIRS, RAILING AND PICKETS – STANDARD STAIRCASE - PRICE IS PER SET 07Jun19    Note:	
---	--

This Document is Extremely Time Sensitive - Printed 7 Jun 19 at 13:58

RECEIVED JUN 10 2019

Layout Changes: ☐ Yes ☒ No

Sketch Attached: ☒ Yes ☐ No

Exterior Colour Scheme:

1. Cabinetry

	Style and Colour	Hardware
Kitchen / Breakfast	CONTINENTAL 814 DARK CHOCOLATE	447SA
Laundry Room	ELISSE	Standard
Powder Room	MONACO W821XZ4	431SA
Master Ensuite Bathroom	MONACO W823XZ4	431SA
Main Bathroom	MONACO W823XZ4	431SA

Appliances:

Built In Appliances ☐ Yes ☒ No

Slide In Stove ☐ Yes ☒ No

Dishwasher Cabinet ☐ Closed ☒ Open

41" Upper Cabinets ☒ Yes ☐ No

Please NOTE: Standard Cabinet Height is 30"

Stove Opening

NOTE: If not specified, opening will be set to builder's standard opening of approximately 30" width

Fridge Opening

NOTE: If not specified, opening will be set to builder's standard opening of approximately 37" width x 74" height

\*\* Refer to Construction Summary

2. Counters

	Counter	Edge
Kitchen / Breakfast	LAMINATE-PALOMA POLAR 6698-46	
Laundry Room	N/A	
Powder Room	LAMINATE-CALCUTTA MARBLE 4925K-07	
Master Ensuite Bathroom	LAMINATE-INUK SHUK GREY P-344 LM	
Main Bathroom	LAMINATE-WHITE TIGRIS 4783-60	

\*\* Refer to Construction Summary



Purchaser:

INVENTORY HOME\_B340\_TH5

Telephone Res. / Bus:

/

Decor Advisor:

Natalie Mancuso

Lock Date:

7-Jun-19

Property:

Block 340 TH 5

Project:

Lecco Ridge Developments Inc.

Model and Elevation:

Ivy 3 Elev 2

Plan #:

20M-1184

3. Ceramic Flooring

		At a 45	Threshold-If App.
Entrance Vestibule	TILE- STONE BEIGE 12 1/4 X 24 1/4	<input type="checkbox"/>	Metal Strip Where Applic.
Main Hall	LAMINATE	<input type="checkbox"/>	
Kitchen / Breakfast	TILE- STONE BEIGE 12 1/4 X 24 1/4	<input type="checkbox"/>	
Laundry Room	TILE- CEMENTI WHITE 12X12	<input type="checkbox"/>	
Powder Room	TILE- STONE BEIGE 12 1/4 X 24 1/4	<input type="checkbox"/>	
Master Ensuite Bathroom	TILE- HABITAT SILVER GREY 12X12	<input type="checkbox"/>	
Main Bathroom	TILE- HABITAT SILVER GREY 12X12	<input type="checkbox"/>	
SIDE HALL	TILE- STONE BEIGE 12 1/4 X 24 1/4	<input type="checkbox"/>	
		<input type="checkbox"/>	
		<input type="checkbox"/>	
		<input type="checkbox"/>	

\*\* Refer to Construction Summary

4. Ceramic Wall Tile

Master Ensuite Bathroom	Selection	Describe
Tub Deck Wall	TILE- MATTE WHITE 8X8	
Tub Deck		
Tub Deck Skirt		
Shower Stall	TILE- MATTE WHITE 8X8	
Bathtub Enclosure Walls		
Main Bathroom	TILE- MATTE WHITE 8X8	
Kitchen Backsplash		

\*\* Refer to Construction Summary - STANDARD GROUT THROUGHOUT UNLESS SPECIFIED

5. Plumbing Fixtures

All Bathrooms

White

Whirlpool

☐ Yes ☒ No

Dishwasher Rough-In

☒ Yes ☐ No

Waterline for Fridge

☐ Yes ☒ No

\*\* Refer to Construction Summary

6. Trim Carpentry

Interior Doors	800 SERIES
Interior Trim	2 3/4" CASING WITH 4 1/4" BASEBOARD - COLONIAL
Door Handles	As Per Construction Specifications
Exterior Front Door Handle	As Per Construction Specifications

\*\* Refer to Construction Summary



Purchaser:

INVENTORY HOME\_B340\_TH5

Telephone Res. / Bus:

/

Decor Advisor:

Natalie Mancuso

Lock Date:

7-Jun-19

Property:

Block 340 TH 5

Project:

Lecco Ridge Developments Inc.

Model and Elevation:

Ivy 3 Elev 2

Plan #:

20M-1184

7. Other Flooring

Main Hall	LAMINATE-PARK LANE - NEWCASTLE OAK DARK TL-EL3581
Living Room	LAMINATE-PARK LANE - NEWCASTLE OAK DARK TL-EL3581
Dining Room	LAMINATE-PARK LANE - NEWCASTLE OAK DARK TL-EL3581
Family Room	LAMINATE-PARK LANE - NEWCASTLE OAK DARK TL-EL3581
Den / Library / Study	
Basement Landing(If Applies)	
Lower Landing (If Applies)	LAMINATE-PARK LANE - NEWCASTLE OAK DARK TL-EL3581
Upper Landing	LAMINATE-PARK LANE - NEWCASTLE OAK DARK TL-EL3581
Upper Hall	LAMINATE-PARK LANE - NEWCASTLE OAK DARK TL-EL3581
Master Bedroom	LAMINATE-PARK LANE - NEWCASTLE OAK DARK TL-EL3581
Bedroom #2	LAMINATE-PARK LANE - NEWCASTLE OAK DARK TL-EL3581
Bedroom #3	LAMINATE-PARK LANE - NEWCASTLE OAK DARK TL-EL3581
Bedroom #4	
Bedroom #5	
Underpad	TypeArea

\*\* Refer to Construction Summary

8. Railings and Pickets

Railing Type	AS PER CONSTRUCTION SPECIFICATIONS	Colour	TORLYS- NEW CASTLE OAK DARK
Picket Type	1 5/16 PICKETS SQUARE CHAMFERED	Colour	TORLYS- NEW CASTLE OAK DARK
Stringer / Riser	AS PER CONSTRUCTION SPECIFICATIO	Colour	TORLYS- NEW CASTLE OAK DARK
Treads	Standard	Colour	TORLYS- NEW CASTLE OAK DARK
Red Oak Stairs with Semi Gloss Finish		<input checked="" type="radio"/> Yes <input type="radio"/> No	

\*\* Refer to Construction Summary

9. Wall Paint Flat Finish

Main & Upper Hall	43 BIRCH WHITE	Master Bedroom	43 BIRCH WHITE
Living Room	43 BIRCH WHITE	Bedroom #2	43 BIRCH WHITE
Dining Room	43 BIRCH WHITE	Bedroom #3	43 BIRCH WHITE
Kitchen / Breakfast	43 BIRCH WHITE	Bedroom #4	
Family Room	43 BIRCH WHITE	Bedroom #5	
Powder Room	43 BIRCH WHITE	Master Ensuite	43 BIRCH WHITE
Laundry Room	43 BIRCH WHITE	Main Bathroom	43 BIRCH WHITE
Den/Library			
Trim Paint-Semi Gloss	43 BIRCH WHITE		

Smooth Ceilings First Floor

☐ Yes

☒ No

\*\* Refer to Construction Summary



Purchaser:INVENTORY HOME\_B340\_TH5

Property:Block 340 TH 5

Telephone Res. / Bus: /

Project:Lecco Ridge Developments Inc.

Decor Advisor:Natalie Mancuso

Model and Elevation:Ivy 3 Elev 2

Lock Date:7-Jun-197-Jun-19

Plan #:20M-1184

10. Plaster Mouldings and Medallions

Entrance Vestibule			Kitchen/Breakfast		
Main Hall			Den/Library		
Living Room			Lower Landing		
Dining Room					
Family Room					

\*\* Refer to Construction Summary

11. Fireplace

	Living Room			Family Room			Other Room - Specify		
	Purchased	As Per Plan	N/A	Purchased	As Per Plan	N/A	Purchased	As Per Plan	N/A
	<input type="radio"/>	<input type="radio"/>	<input checked="" type="radio"/>	<input type="radio"/>	<input type="radio"/>	<input checked="" type="radio"/>	<input type="radio"/>	<input type="radio"/>	<input checked="" type="radio"/>
Fireplace Type									
Mantle Type									
Colour / Stain									
Surround									
Hearth									

\*\* Refer to Construction Summary

12. Heating and Air Conditioning

Air Conditioning	NO	Gas Provisions Stove	NO
Gas Provisions Dryer	NO	Gas Provisions Barbecue	NO
Comment			

\*\* Refer to Construction Summary

13. Electrical

Plugs and Switches	<input checked="" type="radio"/> White	DECOR	Above Kitchen Cabinet Light	<input type="radio"/> Yes	<input checked="" type="radio"/> No	
Hood Fan	STANDARD WHITE		Below Kitchen Cabinet Light	<input type="radio"/> Yes	<input checked="" type="radio"/> No	
Appliances	Built in Cooktop		Built in Oven		Gas Stove	
	<input type="radio"/> Yes	<input checked="" type="radio"/> No	<input type="radio"/> Yes	<input checked="" type="radio"/> No	<input type="radio"/> Yes	<input checked="" type="radio"/> No
					Microwave	
					<input type="radio"/> Yes	<input checked="" type="radio"/> No
Dishwasher Rough-in	Yes					

\*\* Refer to Construction Summary

14. General Comments

\*\* Refer to Construction Summary

Disclaimers and Notes

1) Colours of all materials are as close as possible to builder's selection, but not necessarily identical due to variances in manufacturing.

2) Any extras listed above are null and void unless accompanied by a separate invoice/amendment. Said invoice must be paid in full.

3) The Purchaser agrees that this colour selection is final and that no changes will be permitted, unless required by the Vendor.

4) The Purchaser acknowledges reading and accepting document which contains other miscellaneous disclaimers.

Signature:\_\_\_\_\_Date:\_\_\_\_\_

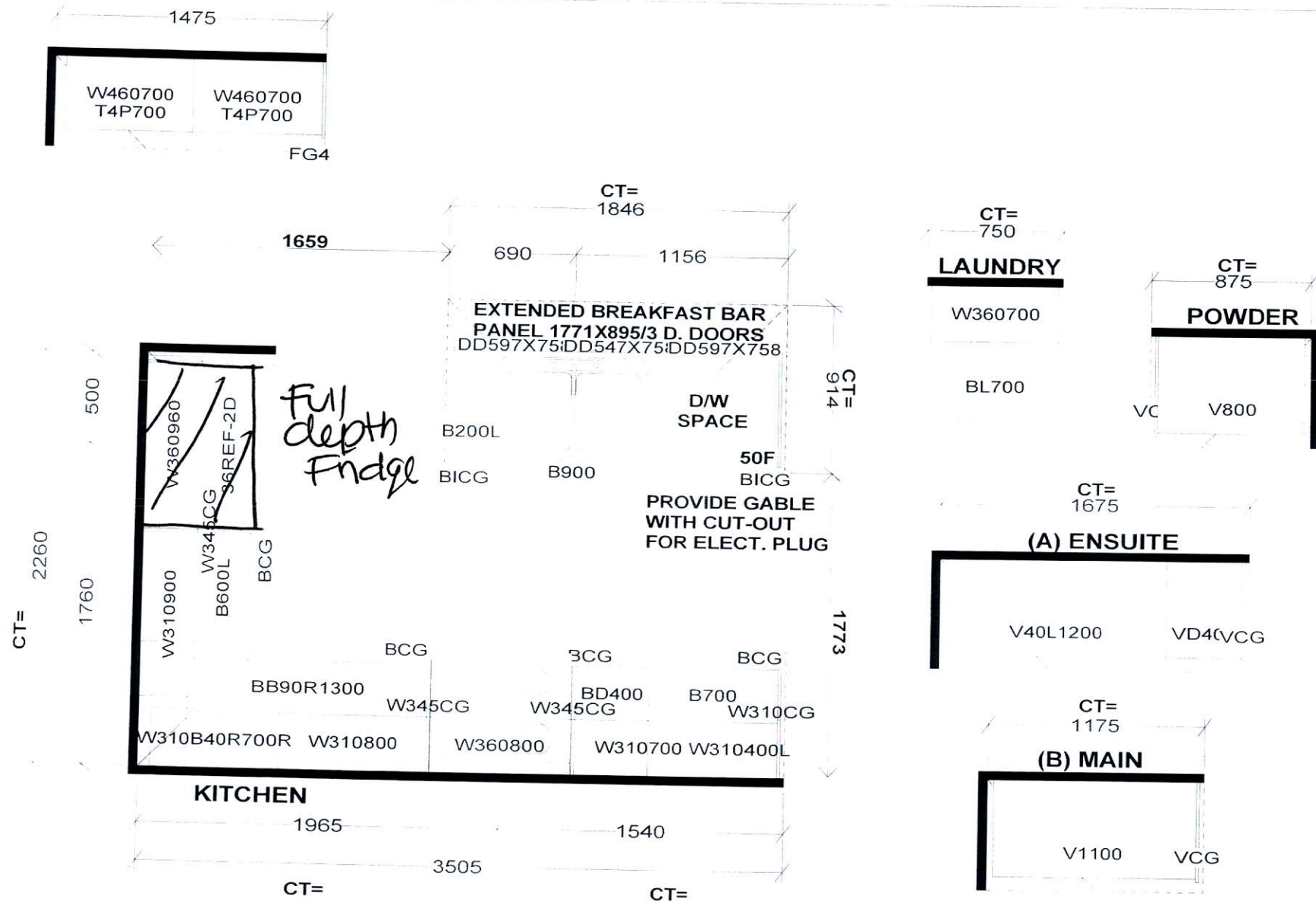

Selba Industries

**STANDARD FEATURES:**  
 9' CEILINGS WITH D/C BOX  
 1040MM HIGH UPPER CABINETS  
 DISHWASHER SPACE  
 DUMMY DOORS ON EXPOSED BACKS  
 LAMINATE KITCHEN & VANITY COUNTERTOPS

This drawing is the intellectual property of SELBA INDUSTRIES INC. and is an original design which must not be released or copied unless applicable fee has been paid or job order placed.



**JOB NUMBER:**  
**BUILDER:** GREENPARK HOMES  
**SITE NAME:** LECCO RIDGE, Milton  
**MODEL:** IVY 3X ELEV 1,2,3  
**LOT #:**  
**DESIGNER:** KS  
**DATE:** FEB 13 17



# IVY 3

1,883 SQ.FT.

AVAILABLE IN BLOCK: 324, 330, 332, 334, 335, 338,  
339, 340, 342, 343, 344, 347 & 348

