

CONSTRUCTION SUMMARY

Lotus Pointe 2 (G) - Lamberts Lane Home Corp.

PURCHASERS: RAVNEET KAUR AULAKH and PARMJIT KAUR AULAKH

TEL:

LOT / PHASE Block 92 Unit 1 / 2	REG. PLAN # 43M-2071	HOUSE TYPE Urban Two Elev 3		
------------------------------------	-------------------------	--------------------------------	--	--

CABINETRY

1 - CABINETRY - KITCHEN - UPGRADE 1 19Dec19 Note:	
--	--

CABINETRY ACCESSORIES

1 - KITCHEN CABINETRY UPPER - FULL DEPTH ABOVE FRIDGE - WITH GABLES - 600MM - PRICE IS EACH - UPGRADE 1 19Dec19 Note:	
--	--

MISCELLANEOUS

1 - PURCHASER DECLINES CREDIT- 19Dec19 Note:	
---	--

PLUMBING

1 - TOE TESTER - ADD TOE TESTER TO SHOWER 19Dec19 Note:	
--	--

PROMOTIONAL

1 - LESS CREDIT FROM PURCHASER EXTRA SHEET IN OFFER 19Dec19 Note:	
--	--

EXTRAS AS PER OFFER

(5) The Vendor agrees that notwithstanding any other term or provision in this Agreement included in the Purchase Price and in addition to those items detailed in Schedule GP to the Agreement of Purchase and Sale, the Purchaser is entitled to a credit of Worksheet Note:	
Five (5) White Appliances as per PE Appliances Worksheet Note:	
The Purchaser acknowledges that the Purchase Price is inclusive of all credits and promotional packages available at the time of purchase. Worksheet Note:	

This Document is Extremely Time Sensitive - Printed 19 Dec 19 at 11:37

RECEIVED DEC 19 2019

Purchasers:RAVNEET KAUR AULAKH & PARMJIT KAUR ALProperty: Block 92 Unit 1

Telephone Res. / Bus: /Project: Lamberts Lane Home Corp.

Decor Advisor: Anne FedericoModel and Elevation: Urban Two Elev 3

Lock Date: 19-Dec-1919-Dec-19Plan #: 43M-2071

Layout Changes: ☐ Yes ☐ NoSketch Attached: ☐ Yes ☐ NoExterior Colour Scheme:

1. Cabinetry

	Style and Colour	Hardware
Kitchen / Breakfast	DORAL H3078 HACIENDA WHITE	431SA
Laundry Room	ELISSE	Standard
Powder Room	HASTING CHOCOLATE	113SB
Master Ensuite Bathroom	CONTINENTAL 823 DRIFTWOOD	114SB
Main Bathroom	CONTINENTAL 823 DRIFTWOOD	114SB

Appliances:

Built In Appliances ☐ Yes ☒ NoSlide In Stove ☐ Yes ☒ No

Dishwasher Cabinet ☐ Closed ☒ Open41" Upper Cabinets ☒ Yes ☐ NoPlease NOTE: Standard Cabinet Height is 30"

Stove OpeningNOTE: If not specified, opening will be set to builder's standard opening of approximately 30" width

Fridge OpeningNOTE: If not specified, opening will be set to builder's standard opening of approximately 37" width x 74" height

\*\* Refer to Construction Summary

2. Counters

	Counter	Edge
Kitchen / Breakfast	LAMINATE-CALCUTTA MARBLE 4925K-07	
Laundry Room		
Powder Room	LAMINATE-CALCUTTA MARBLE 4925K-07	
Master Ensuite Bathroom	LAMINATE-CALCUTTA MARBLE 4925K-07	
Main Bathroom	LAMINATE-WHITE CARRARA 4924-38	

\*\* Refer to Construction Summary



Purchasers:

Telephone Res. / Bus: /

Decor Advisor:

Lock Date:

RAVNEET KAUR AULAKH & PARMJIT KAUR AL

Anne Federico

19-Dec-19

Property:

Project:

Model and Elevation:

Plan #:

Block 92 Unit 1

Lamberts Lane Home Corp.

Urban Two Elev 3

43M-2071

3. Ceramic Flooring

Entrance Vestibule	TILE-GHAIA GRIGIO 13X13	<input type="checkbox"/>	At a 45 Threshold-If App.
Main Hall	CARPET	<input type="checkbox"/>	METAL STRIP
Kitchen / Breakfast	TILE-RAINBOW WHITE 13X13	<input type="checkbox"/>	
Laundry Room	TILE-GHAIA GRIGIO 13X13	<input type="checkbox"/>	
Powder Room	TILE-RAINBOW WHITE 13X13	<input type="checkbox"/>	
Master Ensuite Bathroom	TILE-ESSENSE GRIGIO 13X13	<input type="checkbox"/>	
Main Bathroom	TILE-GAT2J156 NEO GREY 12X12	<input type="checkbox"/>	
Garage Entrance	TILE-GHAIA GRIGIO 13x13	<input type="checkbox"/>	
		<input type="checkbox"/>	
		<input type="checkbox"/>	
		<input type="checkbox"/>	

\*\* Refer to Construction Summary

4. Ceramic Wall Tile

Master Ensuite Bathroom	Selection	Describe
Tub Deck Wall		
Tub Deck		
Tub Deck Skirt		
Shower Stall	TILE-UNIVERSAL GREY GLOSS 8X10	
Bathtub Enclosure Walls		
Main Bathroom	TILE-NATURALE GRIGIO 8X10	
Kitchen Backsplash		

\*\* Refer to Construction Summary - STANDARD GROUT THROUGHOUT UNLESS SPECIFIED

5. Plumbing Fixtures

All Bathrooms

White

Whirlpool

☐ Yes ☒ No

Dishwasher Rough-In

☒ Yes ☐ No

Waterline for Fridge

☒ Yes ☐ No

\*\* Refer to Construction Summary

6. Trim Carpentry

Interior Doors	As Per Construction Specifications
Interior Trim	As Per Construction Specifications
Door Handles	As Per Construction Specifications
Exterior Front Door Handle	As Per Construction Specifications

\*\* Refer to Construction Summary

Initials: RA



Purchasers:

Telephone Res. / Bus:

Decor Advisor:

Lock Date:

RAVNEET KAUR AULAKH & PARMJIT KAUR AL

/

Anne Federico

19-Dec-19

Property:

Project:

Model and Elevation:

Plan #:

Block 92 Unit 1

Lamberts Lane Home Corp.

Urban Two Elev 3

43M-2071

7. Other Flooring

Main Hall	CARPET-SHAW - E9954 CABANA BAY SOLID - ICE 00520
Living Room	CARPET-SHAW - E9954 CABANA BAY SOLID - ICE 00520
Dining Room	CARPET-SHAW - E9954 CABANA BAY SOLID - ICE 00520
Family Room	CARPET-SHAW - E9954 CABANA BAY SOLID - ICE 00520
Den / Library / Study	CARPET-SHAW - E9954 CABANA BAY SOLID - ICE 00520
Basement Landing(If Applies)	
Lower Landing (If Applies)	LAMINATE-MANHATTAN - RED OAK NATURAL TL-15004
Upper Landing	LAMINATE-MANHATTAN - RED OAK NATURAL TL-15004
Upper Hall	CARPET-SHAW - E9954 CABANA BAY SOLID - ICE 00520
Master Bedroom	CARPET-SHAW - E9954 CABANA BAY SOLID - ICE 00520
Bedroom #2	CARPET-SHAW - E9954 CABANA BAY SOLID - ICE 00520
Bedroom #3	CARPET-SHAW - E9954 CABANA BAY SOLID - ICE 00520
Bedroom #4	
Bedroom #5	

Underpad	Type	Area
	STANDARD UNDERPAD	THROUGHOUT

\*\* Refer to Construction Summary

8. Railings and Pickets

Railing Type	AS PER CONSTRUCTION SPECIFICATIONS	Colour	NATURAL
Picket Type	NATURAL	Colour	NATURAL
Stringer / Riser	AS PER CONSTRUCTION SPECIFICATIO	Colour	NATURAL
Treads	AS PER CONSTRUCTION SPECIFICATIO	Colour	NATURAL
Red Oak Stairs with Semi Gloss Finish		<input checked="" type="radio"/> Yes <input type="radio"/> No	

\*\* Refer to Construction Summary THE STAIN COLOURS OR FINISH AVAILABLE ON RISERS, TREADS, PICKETS AND RAILS (STAIRCASES), WILL NOT BE AN EXACT MATCH TO PREFINISHED HARDWOOD OR LAMINATE FLOORS.

9. Wall Paint Flat Finish

Main & Upper Hall	22 WARM GREY	Master Bedroom	22 WARM GREY
Living Room	22 WARM GREY	Bedroom #2	22 WARM GREY
Dining Room	22 WARM GREY	Bedroom #3	22 WARM GREY
Kitchen / Breakfast	22 WARM GREY	Bedroom #4	
Family Room	22 WARM GREY	Bedroom #5	
Powder Room	22 WARM GREY	Master Ensuite	22 WARM GREY
Laundry Room	22 WARM GREY	Main Bathroom	22 WARM GREY
Den/Library	22 WARM GREY		
Trim Paint-Semi Gloss	BIRCH WHITE		

Smooth Ceilings First Floor ☐ Yes ☒ No

\*\* Refer to Construction Summary

Initials: POA



Purchasers: RAVNEET KAUR AULAKH & PARMJIT KAUR AL

Telephone Res. / Bus: /

Decor Advisor: Anne Federico

Lock Date: 19-Dec-19

Property: Block 92 Unit 1

Project: Lamberts Lane Home Corp.

Model and Elevation: Urban Two Elev 3

19-Dec-19

Plan #: 43M-2071

10. Plaster Mouldings and Medallions

Entrance Vestibule			Kitchen/Breakfast		
Main Hall			Den/Library		
Living Room			Lower Landing		
Dining Room					
Family Room					

\*\* Refer to Construction Summary

11. Fireplace

	Living Room			Family Room			Other Room - Specify		
	Purchased	As Per Plan	N/A	Purchased	As Per Plan	N/A	Purchased	As Per Plan	N/A
Fireplace Type	<input type="radio"/>	<input type="radio"/>	<input type="radio"/>	<input type="radio"/>	<input type="radio"/>	<input checked="" type="radio"/>	<input type="radio"/>	<input type="radio"/>	<input type="radio"/>
Mantle Type									
Colour / Stain									
Surround									
Hearth									

\*\* Refer to Construction Summary

12. Heating and Air Conditioning

Air Conditioning	NO	Gas Provisions Stove	NO
Gas Provisions Dryer	NO	Gas Provisions Barbecue	NO
Comment			

\*\* Refer to Construction Summary

13. Electrical

Plugs and Switches	<input checked="" type="radio"/> White	DECOR	Above Kitchen Cabinet Light	<input type="radio"/> Yes	<input checked="" type="radio"/> No
Hood Fan	STANDARD WHITE		Below Kitchen Cabinet Light	<input type="radio"/> Yes	<input checked="" type="radio"/> No
Appliances	Built in Cooktop	Built in Oven	Gas Stove	Microwave	
	<input type="radio"/> Yes <input checked="" type="radio"/> No	<input type="radio"/> Yes <input checked="" type="radio"/> No	<input type="radio"/> Yes <input checked="" type="radio"/> No	<input type="radio"/> Yes <input checked="" type="radio"/> No	
Dishwasher Rough-in	Yes				

\*\* Refer to Construction Summary

14. General Comments

\*\* Refer to Construction Summary

Disclaimers and Notes

- 1) Colours of all materials are as close as possible to builder's selection, but not necessarily identical due to variances in manufacturing.
- 2) Any extras listed above are null and void unless accompanied by a separate invoice/amendment. Said invoice must be paid in full.
- 3) The Purchaser agrees that this colour selection is final and that no changes will be permitted, unless required by the Vendor.
- 4) The Purchaser acknowledges reading and accepting document which contains other miscellaneous disclaimers.

Signature: \_\_\_\_\_ Date: \_\_\_\_\_

Signature: Parmjit K. Aulakh Date: 19 Dec/2019

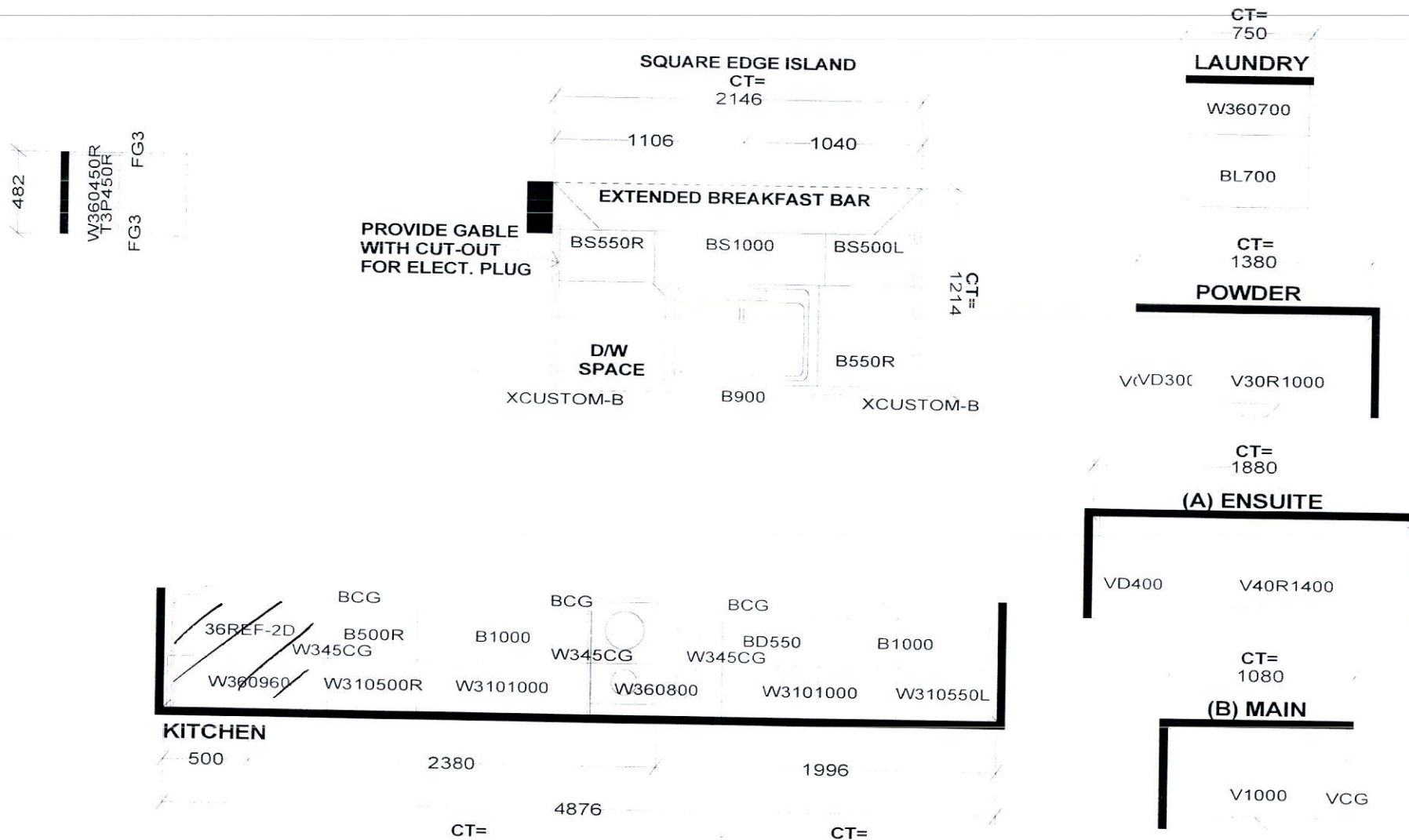

*Selba Industries* J# \_\_\_\_\_

This drawing is the intellectual property of SELBA INDUSTRIES INC. and is an original design which must not be released or copied unless applicable fee has been paid or job order placed.

W WIDTH \_\_\_\_\_ W HGHT \_\_\_\_\_ W CNT \_\_\_\_\_

FLOOR HGHT \_\_\_\_\_ DOOR HGHT \_\_\_\_\_

ST. CENT \_\_\_\_\_ 2X4 \_\_\_\_\_ VENT BOX COVER \_\_\_\_\_

DESIGNER: KS  
DATE: MAR 12 19

JOB NUMBER:  
BUILDER: GREENPARK  
SITE: LAMBERTS LANE PH.2  
MODEL: URBAN 2X EL 1,2,2A,3,4,5  
LOT #:

HA  
G B  
F C  
ED



Urban TWO | 28' LOT • 2,081 SQ.FT.



ELEVATION 1



ELEVATION 2 & 2A



ELEVATION 3



ELEVATION 4



ELEVATION 5



Orientation of home may be reversed and purchaser agrees to accept the same. Steps and porches may vary at any exterior entrance ways due to grading variance. Actual usable floor space may vary from the stated floor areas. All renderings are artist's concept. Dimensions, specifications and architectural details are subject to modifications. Roofline and adjoining model types may vary due to timing. E, & O, E, March 2016.



Urban TWO

Orientation of home may be reversed and purchaser agrees to accept the same. Steps and porches may vary at any exterior entrance ways due to grading variance. Actual usable floor space may vary from the stated floor areas. All renderings are artist's concept. Dimensions, specifications and architectural details are subject to modifications. Roofline and adjoining model types may vary due to timing. E, & O, E, March 2016.