

CONSTRUCTION SUMMARY

Mountainview Heights 3 (G) - Russell Gardens Building Ltd.

PURCHASERS: Andres BASURTO ESCOBAR and Blanca Elizabeth BOBADILLA ADAMS

TEL: RES.: 289-689-7721

LOT / PHASE 57 / 3	REG. PLAN # 62M-1266	HOUSE TYPE Valleycreek Two Elev 2		
-----------------------	-------------------------	--------------------------------------	--	--

CABINETRY

1 - CABINETRY - KITCHEN - LIGHT VALENCE - NO ELECTRICAL 01Dec20 Note:	
1 - CABINETRY - KITCHEN - UPGRADE 2 01Dec20 Note:	

CABINETRY ACCESSORIES

1 - CABINETRY FEE FOR FLUSH CUTOUT ON WALL OVEN/MICROWAVE COMBO CABINET ONLY 21Dec20 Note:	
1 - KITCHEN CABINETRY BASE - POT/PAN DRAWERS (CABINET) - UPGRADE 2 01Dec20 Note: ON ISLAND	
1 - KITCHEN CABINETRY BASE - COOKTOP CABINET WITH POT DRAWERS (2 DRAWERS) - UPGRADE 2 01Dec20 Note:	
1 - KITCHEN - DELETE PANTRY AND RELOCATE FRIDGE TO ACCOMMODATE BUILT-IN OVEN/MICRO 01Dec20 Note:	
1 - KITCHEN CABINETRY UPPER - FULL DEPTH ABOVE FRIDGE - WITH GABLES - 600MM - PRICE IS EACH - UPGRADE 2 01Dec20 Note:	
1 - KITCHEN CABINETRY BASE - PIE CUT CORNER CABINET - BASE CABINETRY - UPGRADE 2 01Dec20 Note:	
1 - KITCHEN CABINETRY - BUILT-IN MICROWAVE/OVEN COMBO - UPGRADE 2 01Dec20 Note:	

CERAMIC TILE

1 - DELETE ALL CERAMIC BATHROOM ACCESSORIES - DELETE TOWEL BAR, PAPER HOLDER & SOAP DISH THROUGHOUT 01Dec20 Note:	
1 - TILE - UPGRADE 3 FLOOR TILE - - POWDER ROOM 01Dec20 Note:	
1 - TILE - UPGRADE 3 FLOOR TILE - - KITCHEN 01Dec20 Note:	
1 - TILE - UPGRADE 3 FLOOR TILE - - FOYER 01Dec20 Note:	

CONSTRUCTION

1 - SMOOTH CEILINGS ON FIRST FLOOR ONLY - DET 01Dec20 Note:	
--	--

ELECTRICAL

1 - PLUG - ELECTRICAL PLUG - TO BE INSTALLED OVER FIREPLACE 01Dec20 Note:	
1 - SWITCH - DIMMER SWITCH IN LIEU OF EXISTING SWITCH - PRICE IS EACH - FAMILY ROOM FOR POTLIGHTS ONLY 01Dec20 Note:	

RECEIVED

JAN 19 2021

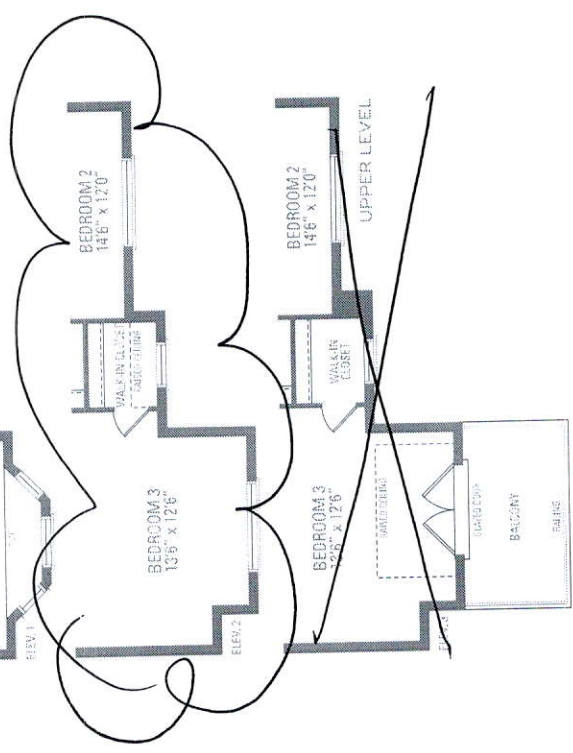

**VALLEY CREEK TWO**  
ELEV. 1 • 2,602 sq.ft. | ELEV. 2 + 3 • 2,624 sq.ft.

Differences in volume may be reversed and our observations to accept the same. Steps and penalties may vary at any expense entrance ways due to global variance. Actual usable floor space may vary from the stated figure across. All measurements are artist's concept. Dimensional specifications are for technical detailing subject to modifications. Roofline and adjoining model types may vary due to siting. E.O. E. May 2020



Kitchen  
• Upgrade of  
Sana Cabinetry  
• Light + Varnish -  
No Electrical

Built-in  
Oven/Micro

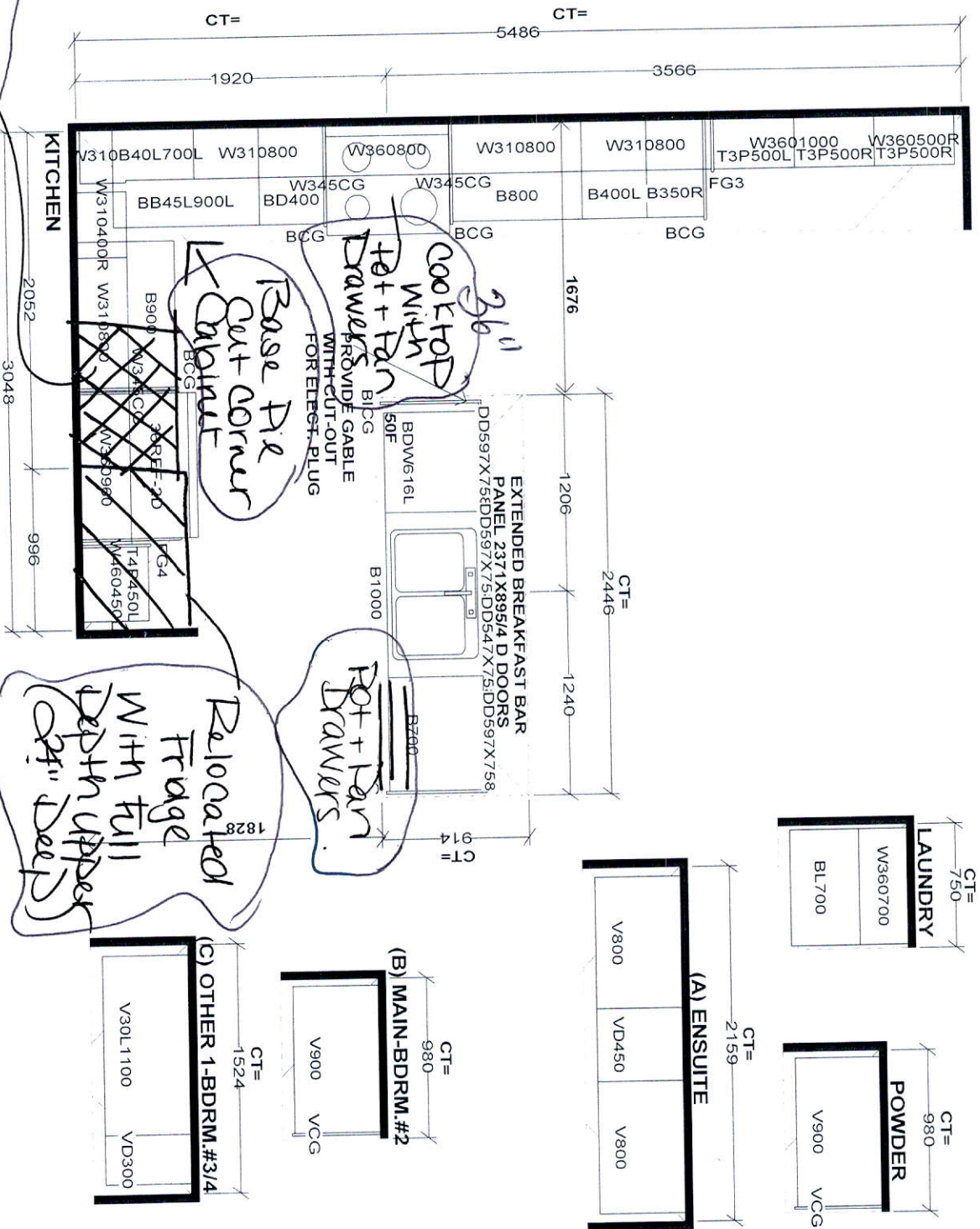

**S e l b a I n d u s t r i e s J #**

Title drawing is the intellectual property of SELBA INDUSTRIES INC. and is an original design which must not be released or copied unless applicable fee has been paid or job order placed.

DESIGNER: KS DATE: MAY 13 20

JOB NUMBER: BUILDER: GREENPARK SITE: RUSSELL GARDENS PH.3 MODEL: VALLEYCREEK 2X EL 1,2,3 LOT #:

W WIDTH W HGT W CNT FLOOR HGT DOOR HGT ST CENT 2X4 VENT BOX COVER

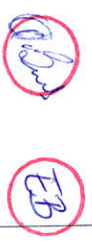

Purchasers:

Andres BASURTO ESCOBAR & Blanca Elizabeth

Telephone Res. / Bus:

(289) 689-7721 /

Decor Advisor:

Candace Forza

Lock Date:

1-Dec-20

Property:

57

Project:

Russell Gardens Building Ltd.

Model and Elevation:

Valleycreek Two Elev 2

Plan #:

62M-1266

Layout Changes:

☐ Yes ☒ No

Sketch Attached:

☒ Yes ☐ No

Exterior Colour Scheme:

1. Cabinetry

	Style and Colour	Hardware
Kitchen / Breakfast	SONATA SATIN SNOW	431SA
Laundry Room	ELISSE	Standard
Powder Room	MONACO 821 INDUSTRIAL GRAPHITE	412SB
Master Ensuite Bathroom	MONACO 814 DARK CHOCOLATE	412SB
Ensuite Bath - Bedroom 2	DORAL W-500	412SB
Ensuite Bath - Bedroom 3/4	MONACO 823 DRIFTWOOD	412SB
	N/A	N/A
	N/A	N/A
	N/A	N/A

Appliances:

Built In Appliances ☒ Yes ☐ No

Slide In Stove ☐ Yes ☒ No

Dishwasher Cabinet ☐ Closed ☒ Open

41" Upper Cabinets ☒ Yes ☐ No

Please NOTE: Standard Cabinet Height is 30"

Stove Opening

36"

NOTE: If not specified, opening will be set to builder's standard opening of approximately 30" width

Fridge Opening

NOTE: If not specified, opening will be set to builder's standard opening of approximately 37" width x 74" height

\*\* Refer to Construction Summary

2. Counters

	Counter	Edge
Kitchen / Breakfast	LAMINATE-WHITE TIGRIS 4783-60	
Laundry Room	N/A	
Powder Room	LAMINATE-PALOMA POLAR 6698-46	
Master Ensuite Bathroom	LAMINATE-CARRARA BIANCO 6696-46	
Ensuite Bath - Bedroom 2	LAMINATE-WHITE CARRARA 4924-38	
Ensuite Bath - Bedroom 3/4	LAMINATE-WHITE CARRARA 4924-38	
	N/A	
	N/A	
	N/A	

\*\* Refer to Construction Summary

Initials: 

EB



3. Ceramic Flooring

		At a 45	Threshold-If App.
Entrance Vestibule	TILE-LITIUM PEARL POLISHED-24X24	<input type="checkbox"/>	metal strip where applicable
Main Hall	STRIP	<input type="checkbox"/>	
Kitchen / Breakfast	TILE-LITIUM PEARL POLISHED-24X24	<input type="checkbox"/>	
Laundry Room	TILE-RAINBOW WHITE-13X13	<input type="checkbox"/>	
Powder Room	TILE-LITIUM PEARL POLISHED-12X24	<input type="checkbox"/>	
Master Ensuite Bathroom	TILE-RAINBOW LIGHT GREY-13X13	<input type="checkbox"/>	
Ensuite Bath - Bedroom 2	TILE-RAINBOW WHITE-13X13	<input type="checkbox"/>	
Ensuite Bath - Bedroom 3/4	TILE-ESSENZE GRIGIO-13X13	<input type="checkbox"/>	
	N/A	<input type="checkbox"/>	
	N/A	<input type="checkbox"/>	
	N/A	<input type="checkbox"/>	

\*\* Refer to Construction Summary

4. Ceramic Wall Tile

Master Ensuite Bathroom	Selection	Describe
Tub Deck Wall	N/A	
Tub Deck	N/A	
Tub Deck Skirt	N/A	
Shower Stall	TILE-LUC BLANC GROENLANDIA-8X16	
Bathtub Enclosure Walls	N/A	
Ensuite Bath - Bedroom 2	TILE-BIANCO LUCIDO-8X16	
Ensuite Bath - Bedroom 3/4	TILE-LUC BLANC GROENLANDIA-8X16	
	N/A	
	N/A	
	N/A	
Kitchen Backsplash	N/A	

\*\* Refer to Construction Summary - STANDARD GROUT THROUGHOUT UNLESS SPECIFIED

5. Plumbing Fixtures

All Bathrooms

White

N/A

N/A

N/A

N/A

N/A

Whirlpool

N/A

☐ Yes

☒ No

Dishwasher Rough-In

☒ Yes

☐ No

Waterline for Fridge

☒ Yes

☐ No

\*\* Refer to Construction Summary

6. Trim Carpentry

Interior Doors	CARRARA-SMOOTH
Interior Trim	As Per Construction Specifications
Door Handles	As Per Construction Specifications
Exterior Front Door Handle	As Per Construction Specifications

\*\* Refer to Construction Summary



Purchasers:

Andres BASURTO ESCOBAR & Blanca Elizabeth

Telephone Res. / Bus:

(289) 689-7721 /

Decor Advisor:

Candace Forza

Lock Date:

1-Dec-20

Property: 57

Project: Russell Gardens Building Ltd.

Model and Elevation: Valleycreek Two Elev 2

Plan #: 62M-1266

7. Other Flooring		
Main Hall	5"	STRIP-VINTAGE-NOTHERN SOLID SAWN-WIRE BRUSHED-CHARACTER-UV URETHANE OIL-RED OAK-PEWTER
Living Room		N/A
Dining Room	5"	STRIP-VINTAGE-NOTHERN SOLID SAWN-WIRE BRUSHED-CHARACTER-UV URETHANE OIL-RED OAK-PEWTER
Family Room	5"	STRIP-VINTAGE-NOTHERN SOLID SAWN-WIRE BRUSHED-CHARACTER-UV URETHANE OIL-RED OAK-PEWTER
Den / Library / Study		N/A
Basement Landing(If Applies)		N/A
Lower Landing (If Applies)	5"	STRIP-VINTAGE-NOTHERN SOLID SAWN-WIRE BRUSHED-CHARACTER-UV URETHANE OIL-RED OAK-PEWTER
Upper Landing	5"	STRIP-VINTAGE-NOTHERN SOLID SAWN-WIRE BRUSHED-CHARACTER-UV URETHANE OIL-RED OAK-PEWTER
Upper Hall		LAMINATE-PARK LANE-NEWCASTLE OAK DARK-TL-EL3581
Master Bedroom		LAMINATE-PARK LANE-NEWCASTLE OAK DARK-TL-EL3581
Bedroom #2		LAMINATE-PARK LANE-NEWCASTLE OAK DARK-TL-EL3581
Bedroom #3		LAMINATE-PARK LANE-NEWCASTLE OAK DARK-TL-EL3581
Bedroom #4		LAMINATE-PARK LANE-NEWCASTLE OAK DARK-TL-EL3581
Bedroom #5		N/A
		N/A
		N/A
		N/A
Underpad	Type	Area
	N/A	N/A

\*\* Refer to Construction Summary

8. Railings and Pickets

Railing Type

V-GROOVE

Picket Type

1 3/4" SQUARE PICKETS

Stringer / Riser

AS PER CONSTRUCTION SPECIFICATIO

Treads

AS PER CONSTRUCTION SPECIFICATIO

Colour

VINTAGE PEWTER RED OAK

Colour

VINTAGE PEWTER RED OAK

Colour

VINTAGE PEWTER RED OAK

Colour

VINTAGE PEWTER RED OAK

Red Oak Stairs with Semi Gloss Finish

☒ Yes

☐ No

\*\* Refer to Construction Summary

THE STAIN COLOURS OR FINISH AVAILABLE ON RISERS, TREADS, PICKETS AND RAILS (STAIRCASES), WILL NOT BE AN EXACT MATCH TO PREFINISHED HARDWOOD OR LAMINATE FLOORS.

9. Wall Paint Flat Finish

Main & Upper Hall

22 WARM GREY

Living Room

N/A

Dining Room

22 WARM GREY

Kitchen / Breakfast

22 WARM GREY

Family Room

22 WARM GREY

Powder Room

22 WARM GREY

Laundry Room

22 WARM GREY

Den/Library

N/A

Trim Paint-Semi Gloss

BIRCH WHITE

N/A

N/A

Master Bedroom

22 WARM GREY

Bedroom #2

22 WARM GREY

Bedroom #3

22 WARM GREY

Bedroom #4

22 WARM GREY

Bedroom #5

N/A

Master Ensuite

22 WARM GREY

Ensuite Bath - Bedroom 2

22 WARM GREY

Ensuite Bath - Bedroom 3/4

22 WARM GREY

N/A

N/A

N/A

Smooth Ceilings First Floor

☒ Yes

☐ No

\*\* Refer to Construction Summary



Purchasers: Andres BASURTO ESCOBAR & Blanca Elizabeth

Property: 57

Telephone Res. / Bus: (289) 689-7721 /

Project: Russell Gardens Building Ltd.

Decor Advisor: Candace Forza

Model and Elevation: Valleycreek Two Elev 2

Lock Date: 1-Dec-20

1-Dec-20

Plan #: 62M-1266

10. Plaster Mouldings and Medallions

Entrance Vestibule	N/A	N/A	Kitchen/Breakfast	N/A	N/A
Main Hall	N/A	N/A	Den/Library	N/A	N/A
Living Room	N/A	N/A	Lower Landing	N/A	N/A
Dining Room	N/A	N/A		N/A	N/A
Family Room	N/A	N/A			

\*\* Refer to Construction Summary

11. Fireplace

Living Room	Family Room	Other Room - Specify
<div>Purchased As Per Plan N/A</div>	<div>Purchased As Per Plan N/A</div>	<div>Purchased As Per Plan N/A</div>
Fireplace Type	FLAT ON WALL	N/A
Mantle Type	MANTLE M2-STANDARD	N/A
Colour / Stain	AS PER CONSTRUCTION SPECIFICATIONS	N/A
Surround	GRIGIO CARNICO	N/A
Hearth	NO	N/A

\*\* Refer to Construction Summary

12. Heating and Air Conditioning

Air Conditioning	NO	Gas Provisions Stove	YES
Gas Provisions Dryer	NO	Gas Provisions Barbecue	NO
Comment			

\*\* Refer to Construction Summary

13. Electrical

Plugs and Switches	White DECOR	Above Kitchen Cabinet Light	Yes No
Hood Fan	STANDARD WHITE	Below Kitchen Cabinet Light	Yes No
Appliances	Built in Cooktop	Built in Oven	Gas Stove
	Yes No	Yes No	Yes No
Dishwasher Rough-in	Yes		

\*\* Refer to Construction Summary

14. General Comments

\*\* Refer to Construction Summary

Disclaimers and Notes

1) Colours of all materials are as close as possible to builder's selection, but not necessarily identical due to variances in manufacturing.

2) Any extras listed above are null and void unless accompanied by a separate invoice/amendment. Said invoice must be paid in full.

3) The Purchaser agrees that this colour selection is final and that no changes will be permitted, unless required by the Vendor.

4) The Purchaser acknowledges reading and accepting document which contains other miscellaneous disclaimers.

Signature:  Date: Dec 1st, 2020

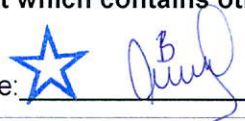
Signature:  Date: Dec 1st, 2020



# 30" Microwave Combination Oven

500 Series – Stainless Steel HBL57M52UC



-Flush Installation

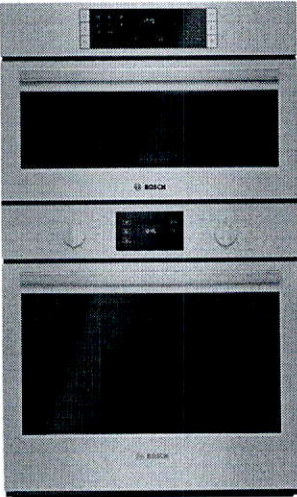

HBL57M52UC  
Stainless Steel

**Built-In Microwave Design  
Matched for Use in  
Combination with Bosch  
Wall Oven.**

**Features & Benefits**

Bosch wall ovens are compatible with most competitor's cutouts.

The wall oven is designed to be installed flush with cabinetry.

**General Properties**

Cooking modes – upper cavity	Microwave; 10 Sensor Cooking Programs (including Baked Potato, Sweet Potato, Fresh Vegetable, Frozen Vegetable, Ground Meat, Fish/Seafood, Brown Rice, White Rice, Frozen Entrees, Reheat), Popcorn, Beverage, Melt/Softens, Defrost
Cooking modes – lower cavity	Bake, Variable Broil (hi & low), Roast, Warm, Sabbath, Proof Dough, Convection Bake, Convection Broil, Convection Roast, Pizza, Multi Rack Genuine European Convection, Convection Conversion
Cleaning type – lower	Self Clean
Telescopic rack	0
Illumination type	LED (Upper) / Halogen (Lower)
Interior lights	1 Upper / 1 Lower

**Oven Performance**

Microwave power – upper cavity	950 W
Bake / broil element wattages – upper cavity	N/A
Bake / broil element wattages – lower cavity	2,400 / 3,800 W
Convection element wattages – lower cavity	2,000 W

**Technical Details**

Watts (W)	9,600 W
Circuit breaker (A)	40 A
Volts (V); Frequency (Hz)	240 / 208 V; 60 Hz
Power cord length (in)	50"
Plug type	Fixed Connection, No Plug
Energy source	Electric

**Dimensions & Weight**

Overall appliance dimensions (HxWxD)(in)	49" x 29 3/4" x 24 1/2"
Required cutout size – Standard (HxWxD) (in)	48 5/8" x 28 1/2" x 23 1/2"
Required cutout size – Flush (HxWxD) (in)	49 1/8" x 30" x 24 1/2"
Oven cavity size – upper	1.6 cu. ft.
Overall upper oven interior dimensions (HxWxD) (in.)	9 7/8" x 16 1/2" x 16 1/2"
Turntable – Glass Max. Cookware – upper	14 1/8" dia.
Oven cavity size – lower	4.6 cu. ft.
Overall lower oven interior dimensions (HxWxD) (in)	17 13/16" x 24 1/8" x 18"
Usable lower oven interior dimensions (HxWxD) (in)	12 5/16" x 23 1/4" x 15 1/4"
Net weight (lbs)	259 lbs

**Accessories—Included**

Upper Oven: Glass Turntable  
Lower Oven: 3 Standard Racks

**Accessories—Optional**

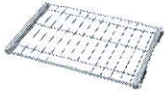

HEZTR301  
30" Telescopic Rack



**Accessories:** To purchase Bosch accessories, cleaners & parts please visit [www.bosch-home.com/us/store](http://www.bosch-home.com/us/store) or call 1-800-944-2904 (Mon to Fri 5 am to 6 pm PST, Sat 6 am to 3 pm PST).

**Notes:** All height, width and depth dimensions are shown in inches. BSH reserves the absolute and unrestricted right to change product materials and specifications, at any time, without notice. Consult the product's installation instructions for final dimensional data and other details prior to making cutout.

**Warranties:** Please see Use & Care manual or Bosch website for statement of limited warranty.

**For more information on our entire line of products, go to [www.bosch-home.com/us](http://www.bosch-home.com/us) or call 1-800-944-2904**

© BSH Home Appliances Corporation. All rights reserved. Bosch is a registered trademark of Robert Bosch GmbH.



# 30" Microwave Combination Oven

500 Series – Stainless Steel HBL57M52UC



## Installation Details

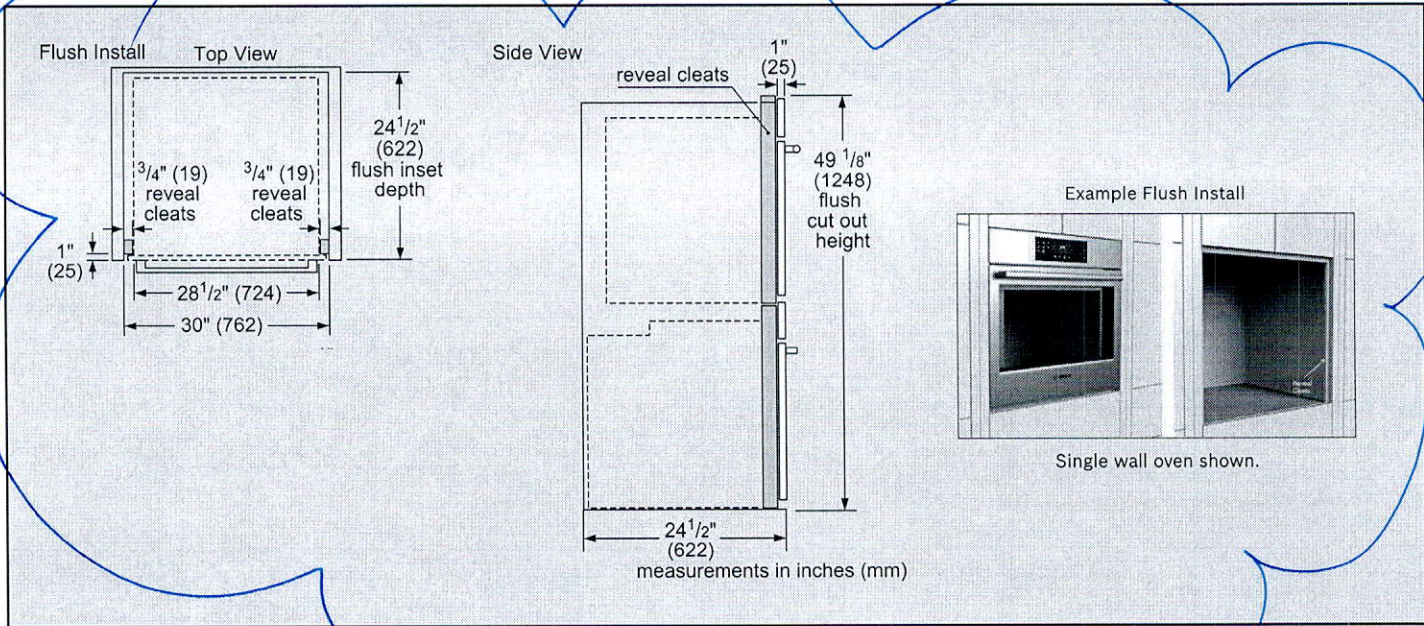
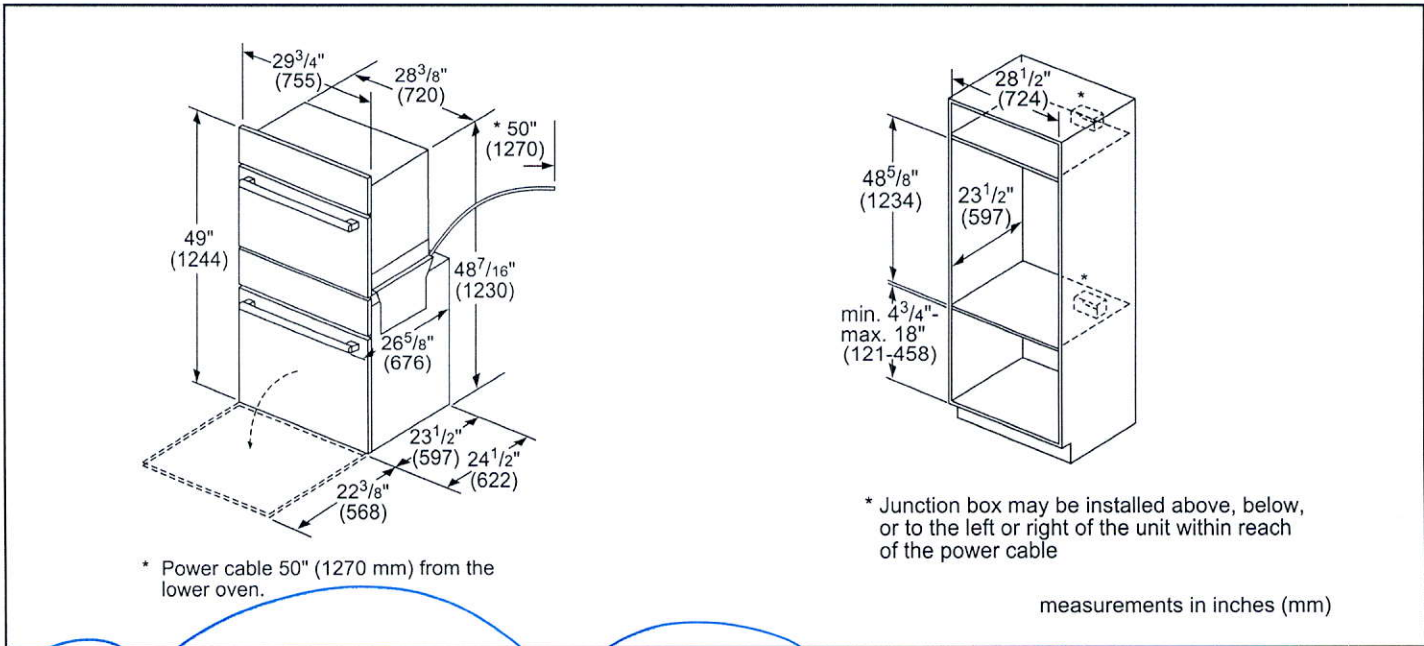

**Accessories:** To purchase Bosch accessories, cleaners & parts please visit [www.bosch-home.com/us/store](http://www.bosch-home.com/us/store) or call 1-800-944-2904 (Mon to Fri 5 am to 6 pm PST, Sat 6 am to 3 pm PST).

**Notes:** All height, width and depth dimensions are shown in inches. BSH reserves the absolute and unrestricted right to change product materials and specifications, at any time, without notice. Consult the product's installation instructions for final dimensional data and other details prior to making cutout.

**Warranties:** Please see Use & Care manual or Bosch website for statement of limited warranty.

**For more information on our entire line of products, go to [www.bosch-home.com/us](http://www.bosch-home.com/us) or call 1-800-944-2904**

© BSH Home Appliances Corporation. All rights reserved. Bosch is a registered trademark of Robert Bosch GmbH.



# 30" Microwave Combination Oven

500 Series – Stainless Steel HBL57M52UC



## Installation Details

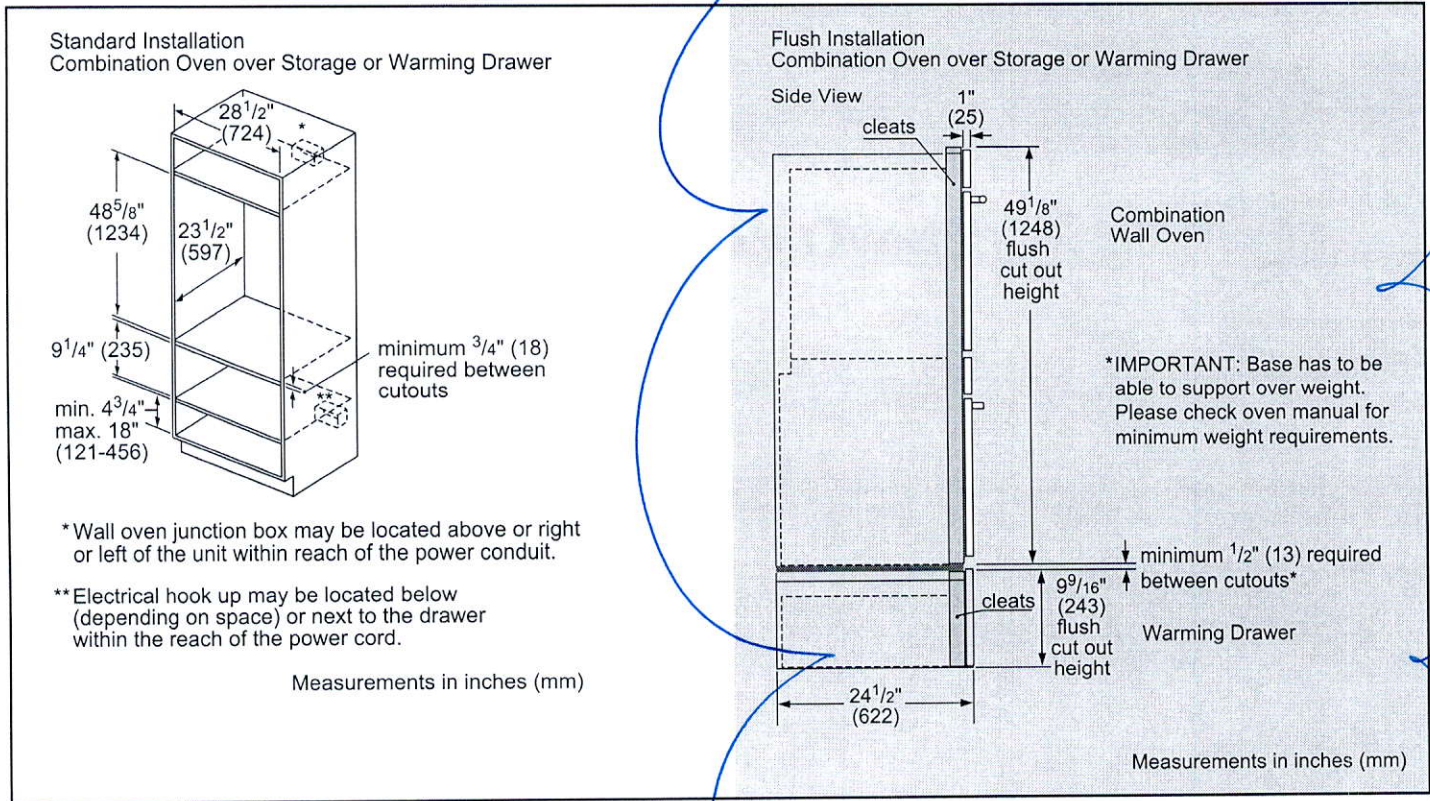

**Accessories:** To purchase Bosch accessories, cleaners & parts please visit [www.bosch-home.com/us/store](http://www.bosch-home.com/us/store) or call 1-800-944-2904 (Mon to Fri 5 am to 6 pm PST, Sat 6 am to 3 pm PST).

**Notes:** All height, width and depth dimensions are shown in inches. BSH reserves the absolute and unrestricted right to change product materials and specifications, at any time, without notice. Consult the product's installation instructions for final dimensional data and other details prior to making cutout.

**Warranties:** Please see Use & Care manual or Bosch website for statement of limited warranty.

**For more information on our entire line of products, go to [www.bosch-home.com/us](http://www.bosch-home.com/us) or call 1-800-944-2904**

© BSH Home Appliances Corporation. All rights reserved. Bosch is a registered trademark of Robert Bosch GmbH.



# 36" Counter-Depth Side-by-Side Refrigerator

300 Series – Stainless Steel B20CS30SNS

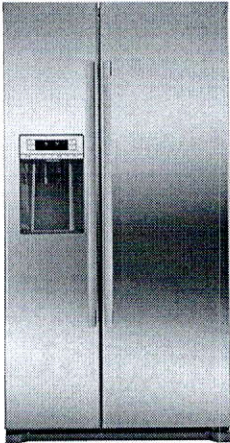

**B20CS30SNS**  
Stainless Steel

This counter-depth Side-by-Side refrigerator installs nearly flush in a freestanding cutout, offering uninterrupted stainless steel luxury.

**Features & Benefits**

Easy clean stainless steel resists smudges and cleans easily.

MultiAirflow™ cooling system boosts air circulation for even temperature throughout.

ENERGY STAR® qualified for energy efficiency.

LED lighting and transparent storage provide ideal visibility throughout.

Dispenses fresh-tasting filtered water, crushed ice and cubed ice.

General Properties	
Easy Clean Stainless Steel	Yes
Water filter	Yes
Lighting	LED
Defrost process refrigerator section	Frost-free
Number of shelves - refrigerator	4
Adjustable shelves - refrigerator	1
Shelf material - refrigerator	Tempered glass
Type of shelves - refrigerator	Framed Tempered Glass
Gallon storage bins	3
Defrost process freezer section	Automatic
Number of drawers - freezer	2
Adjustable shelves - freezer	3
Shelf material - freezer	Tempered glass
Type of shelves - freezer	Framed Tempered Glass
Ice maker	Yes
Capacity	
Total unit capacity (cu. ft.) – AHAM	20.2
Refrigerator capacity (cu. ft.)	13.2
Freezer capacity (cu. ft.)	6.96



Technical Details	
Current (A)	15 A
Volts (V)	115 V
Frequency (Hz)	60 Hz
Power cord length (in.)	76.8
Plug type	120V-3 prong
Dimensions & Weight	
Appliance dimensions (H x W x D) (in.)	69 11/16" x 35 15/16" x 27 1/2"
Required cutout size (H x W x D) (in.)	70" x 36" x 25.9"
Net weight (lbs)	245 lbs
Efficiency	
Energy consumption (kWh/yr)	594 kWh
Accessories—Included	
Included	Egg tray 1 Water Filter
Accessories—Optional	

**BORPLFTR10**  
Replacement water filter (P/N 00740570)

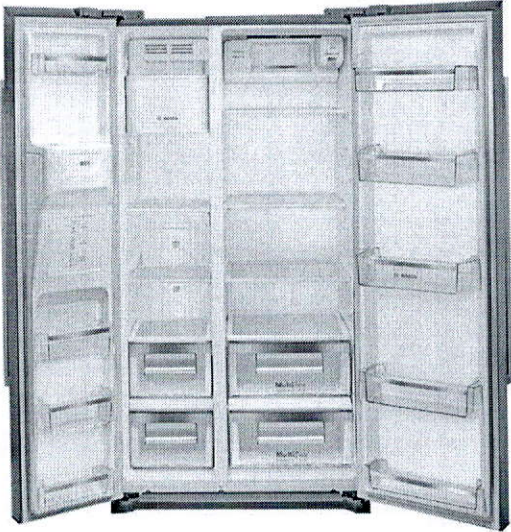

**Accessories:** To purchase Bosch accessories, cleaners & parts please visit [www.bosch-home.com/us/store](http://www.bosch-home.com/us/store) or call 1-800-944-2904 (Mon to Fri 5 am to 6 pm PST, Sat 6 am to 3 pm PST).

**Notes:** All height, width and depth dimensions are shown in inches. BSH reserves the absolute and unrestricted right to change product materials and specifications, at any time, without notice. Consult the product's installation instructions for final dimensional data and other details prior to making cutout.

**Warranties:** Please see Use & Care manual or Bosch website for statement of limited warranty.

For more information on our entire line of products, go to [www.bosch-home.com/us](http://www.bosch-home.com/us) or call 1-800-944-2904

© BSH Home Appliances Corporation. All rights reserved. Bosch is a registered trademark of Robert Bosch GmbH.



# 36" Counter-Depth Side-by-Side Refrigerator



**BOSCH**  
Invented for life

300 Series – Stainless Steel B20CS30SNS

Installation Details

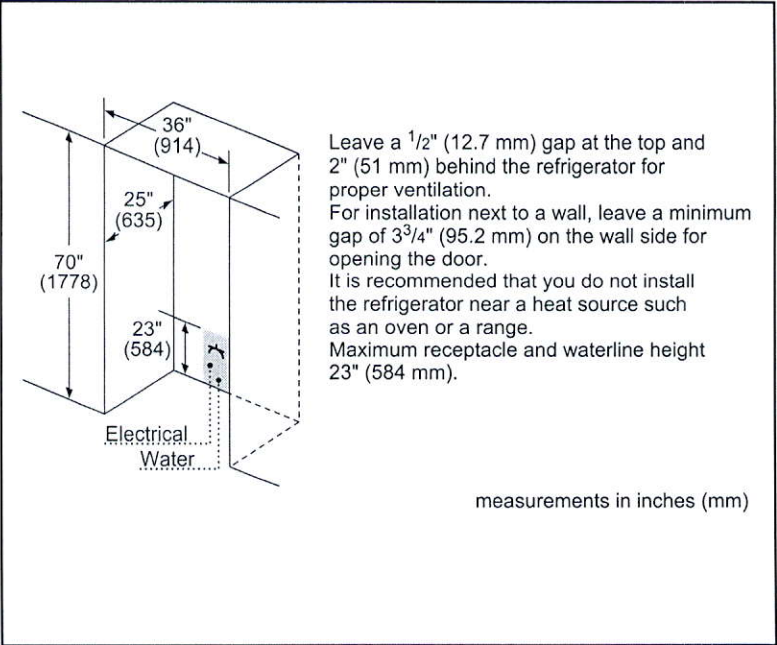
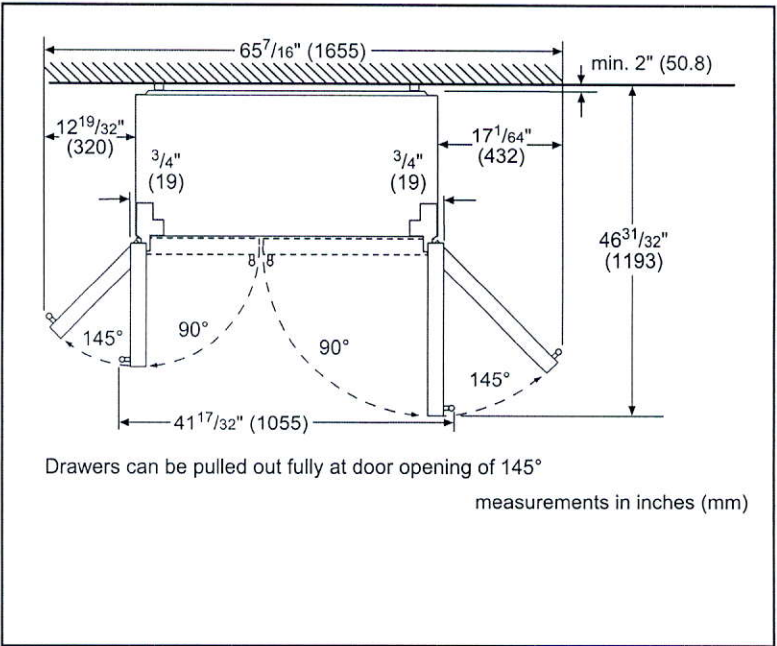
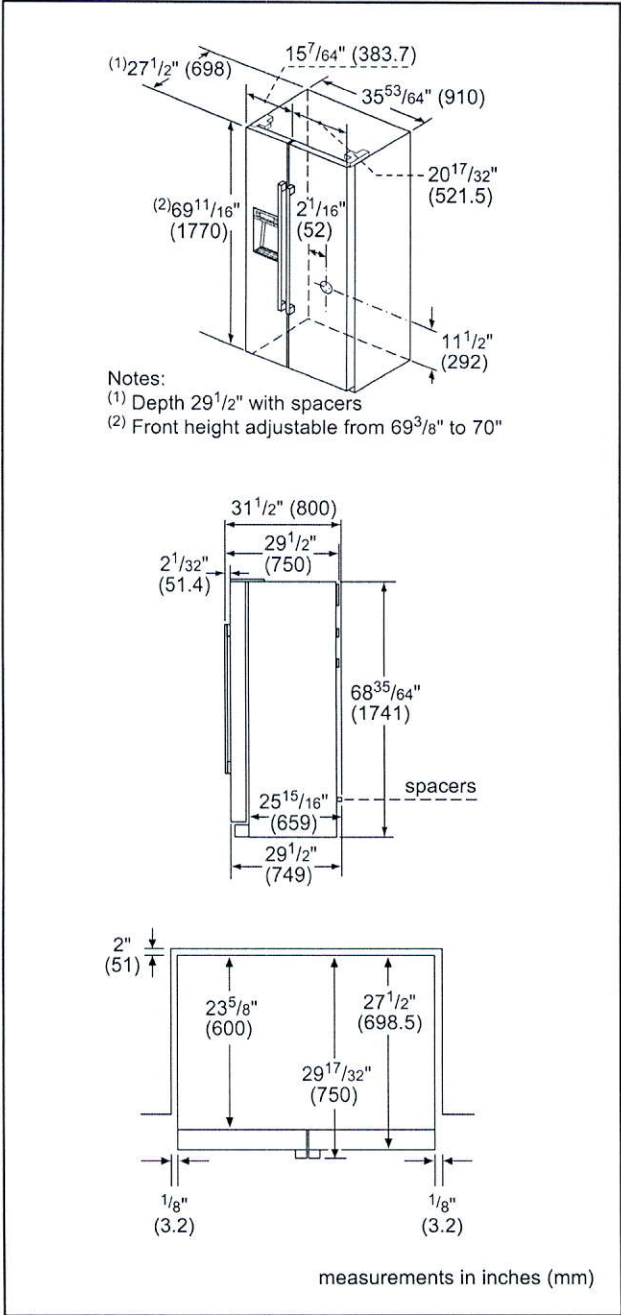

**Accessories:** To purchase Bosch accessories, cleaners & parts please visit [www.bosch-home.com/us/store](http://www.bosch-home.com/us/store) or call 1-800-944-2904 (Mon to Fri 5 am to 6 pm PST, Sat 6 am to 3 pm PST).

**Notes:** All height, width and depth dimensions are shown in inches. BSH reserves the absolute and unrestricted right to change product materials and specifications, at any time, without notice. Consult the product's installation instructions for final dimensional data and other details prior to making cutout.

**Warranties:** Please see Use & Care manual or Bosch website for statement of limited warranty.

**For more information on our entire line of products, go to [www.bosch-home.com/us](http://www.bosch-home.com/us) or call 1-800-944-2904**

© BSH Home Appliances Corporation. All rights reserved. Bosch is a registered trademark of Robert Bosch GmbH.

10/19



# 36" Gas Cooktop

800 Series – Stainless Steel NGM8656UC

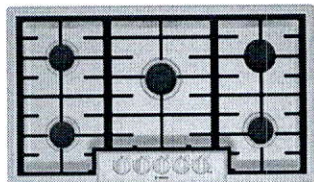

NGM8656UC  
Stainless Steel

Also available in:  
Black w/Black NGM8646UC  
Stainless  
Knobs

Bosch gas cooktops are engineered to perform precisely, offering high heat and low simmer options for optimal cooking flexibility.

Features & Benefits
Powerful 19,000 BTU burner for boiling, searing and stir-frying
OptiSim® Burner – simmer delicate sauces and melt chocolate without scorching
Electronic re-ignition will automatically re-ignite the burner in case the flame goes out
Continuous grates make moving heavy pots easier
Distinctive red LED light indicates burners are on

General Properties	
Knob material	Metal
Sealed burners	Yes
Grate material	Cast iron
Element Performance	
Total BTU load (NG / LP)	58,500 / 47,300
Power of front left burner (NG / LP)	12,000 / 9,100
Power of back left burner (NG / LP)	10,000 / 9,100
Power of center burner (NG / LP)	19,000 / 15,000
Power of back right burner (NG / LP)	5,500 / 5,000
Power of front right burner (NG / LP)	12,000 / 9,100
Technical Details	
Watts	360 W
Circuit breaker	15 A
Volts	120 V
Frequency	60 Hz
Plug type	3 prong
Power cord length	60"
Energy source	Gas
Convertible to LP (kit required)	Yes



Dimensions & Weight	
Overall appliance dimensions (HxWxD)	3 13/16" x 37" x 21 1/4"
Required cutout size (HxWxD)	3 13/16" x 34 15/16" x 19 1/8"
Minimum distance from counter front	1 7/8"
Minimum distance from rear wall	3"
Net weight	39 lbs
Accessories – Included	
Included	LP conversion kit
Accessories – Optional	



HEZ298102  
Wok ring



HEZ27751  
Cooktop control knob kit, black stainless steel

† To be fully ADA compliant, these units must be installed according to ADA guidelines. Please check current ADA requirements for guidance on installation.

**Accessories:** To purchase Bosch accessories, cleaners & parts please visit [www.bosch-home.com/us/store](http://www.bosch-home.com/us/store) or call 1-800-944-2904 (Mon to Fri 5 am to 6 pm PST, Sat 6 am to 3 pm PST).

**Notes:** All height, width and depth dimensions are shown in inches. BSH reserves the absolute and unrestricted right to change product materials and specifications, at any time, without notice. Consult the product's installation instructions for final dimensional data and other details prior to making cutout.

**Warranties:** Please see Use & Care manual or Bosch website for statement of limited warranty.

**For more information on our entire line of products, go to [www.bosch-home.com/us](http://www.bosch-home.com/us) or call 1-800-944-2904**

© BSH Home Appliances Corporation. All rights reserved. Bosch is a registered trademark of Robert Bosch GmbH.



# 36" Gas Cooktop

800 Series – Stainless Steel NGM8656UC



## Installation Details

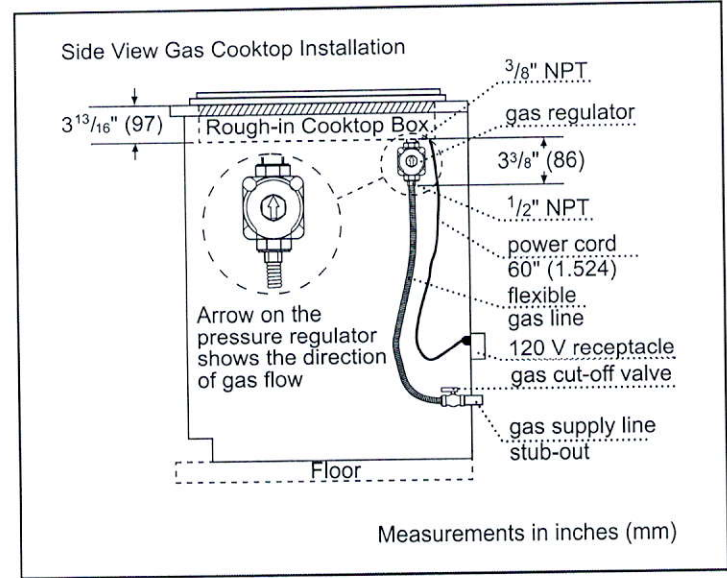
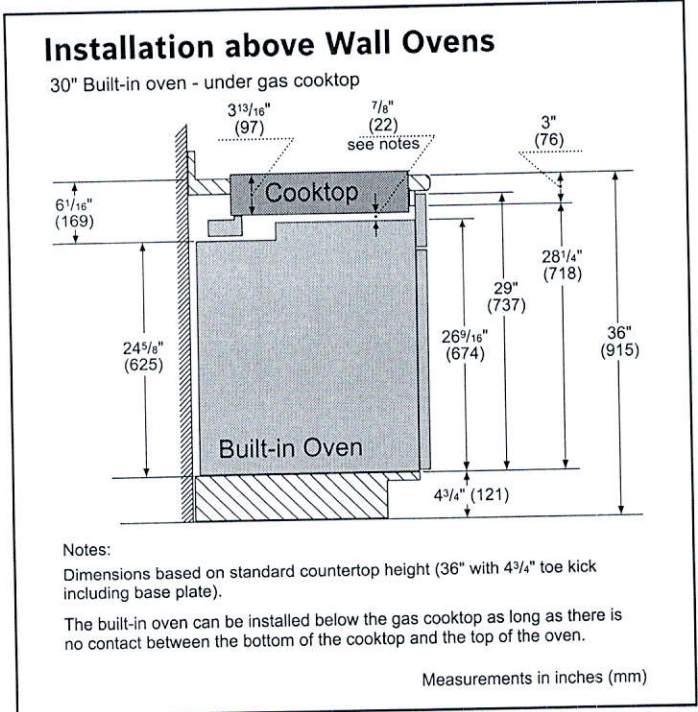
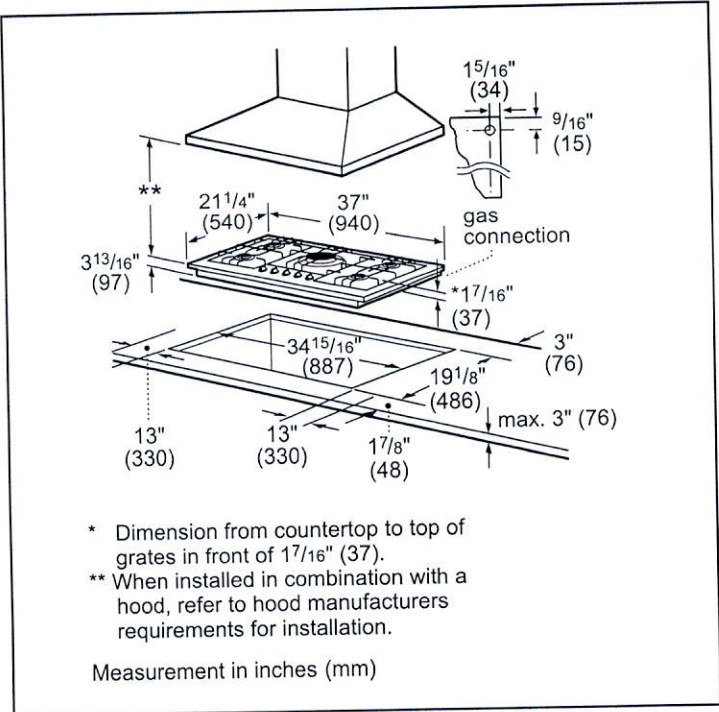

**Accessories:** To purchase Bosch accessories, cleaners & parts please visit [www.bosch-home.com/us/store](http://www.bosch-home.com/us/store) or call 1-800-944-2904 (Mon to Fri 5 am to 6 pm PST, Sat 6 am to 3 pm PST).

**Notes:** All height, width and depth dimensions are shown in inches. BSH reserves the absolute and unrestricted right to change product materials and specifications, at any time, without notice. Consult the product's installation instructions for final dimensional data and other details prior to making cutout.

**Warranties:** Please see Use & Care manual or Bosch website for statement of limited warranty.

**For more information on our entire line of products, go to [www.bosch-home.com/us](http://www.bosch-home.com/us) or call 1-800-944-2904**

© BSH Home Appliances Corporation. All rights reserved. Bosch is a registered trademark of Robert Bosch GmbH.



# 36" Gas Cooktop

800 Series – Stainless Steel NGM8656UC



## Installation Details

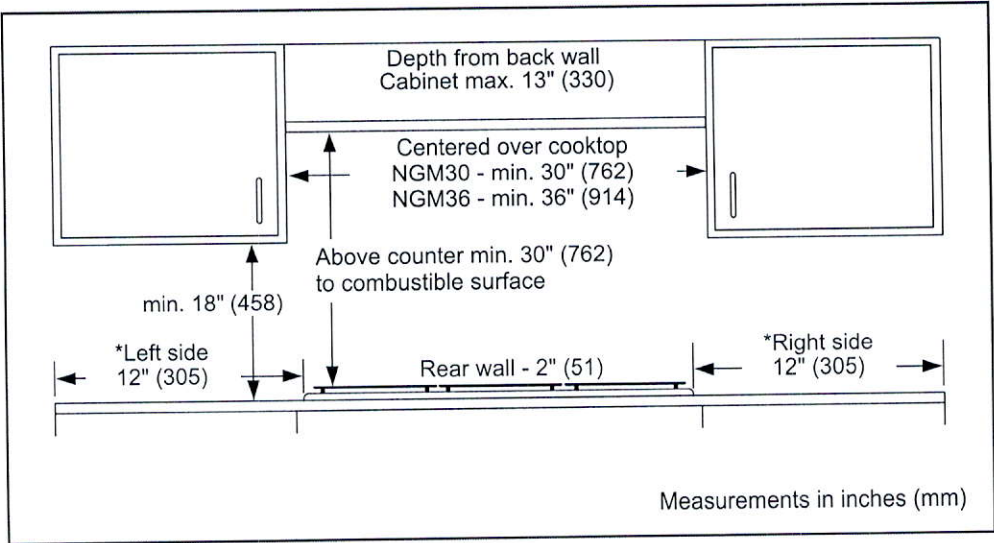

**Accessories:** To purchase Bosch accessories, cleaners & parts please visit [www.bosch-home.com/us/store](http://www.bosch-home.com/us/store) or call 1-800-944-2904 (Mon to Fri 5 am to 6 pm PST, Sat 6 am to 3 pm PST).

**Notes:** All height, width and depth dimensions are shown in inches. BSH reserves the absolute and unrestricted right to change product materials and specifications, at any time, without notice. Consult the product's installation instructions for final dimensional data and other details prior to making cutout.

**Warranties:** Please see Use & Care manual or Bosch website for statement of limited warranty.

**For more information on our entire line of products, go to [www.bosch-home.com/us](http://www.bosch-home.com/us) or call 1-800-944-2904**

© BSH Home Appliances Corporation. All rights reserved. Bosch is a registered trademark of Robert Bosch GmbH.



36" Gas Cooktop

800 Series – Stainless Steel NGM8656UC



Bosch Cooktop over Built-In Oven Approved Combination Guide

The following OVENS, COOKTOPS AND DRAWERS are approved to be installed in combination and the installation has been certified by CSA.

Built-in ovens		Cooktops		
Conventional ovens (1)	Steam ovens	Induction	Electric	Gas (1) *
HBL5351UC, HBL5354UC	HSLP451UC, HSLP454UC	NIT5068UC	NET8068UC	NGM8046UC
HBL5451UC, HBL5344UC		NIT5668UC, NIT5469UC	NET8068SUC	NGM5656UC
HBL8443UC, HBL5454UC		NIT8068UC, NIT8068SUC	NET8668UC	NGMP656UC
HBL8453UC, HBL8444UC		NIT8668UC, NIT8668SUC	NET8668SUC	NGM8656UC
HBL8451UC, HBL8444LUC		NITP068UC, NITP068SUC	NETP068SUC	NGM8646UC
HBL8463UC, HBL8444RUC		NITP668UC, NITP668SUC	NETP668SUC	NGM5656UC
HBL8461UC, HBL8454UC		NIT8069UC, NIT8069SUC	NEM5066UC	NGMP056UC
HBL8442UC, HBLP454UC		NIT8669UC, NIT8669SUC	NEM5666UC	NGM8056UC
HBLP451UC, HBLP454LUC		NITP069UC, NITP069SUC		Gas (2) *
HBLP451LUC, HBLP454RUC		NITP669UC, NITP669SUC		NGM5456UC
HBLP451RUC, HBN8454UC				Gas (3) *
HBN5451UC, HBN8451UC				NGMP077UC
Conventional ovens (2)				NGMP677UC
HBE5451UC				NGM8657UC
Conventional ovens (3)				NGM8057UC
HBE5452UC				

The following OVENS, COOKTOPS AND DRAWERS are approved by BSH Home Appliances Corporation to be installed in combination. These products, identified in the table below, may be installed in combination. The suitability of the combination has not been evaluated by CSA.

Built-in ovens		Cooktops		
Conventional ovens (2)	Speed oven (1)	Induction (1)	Electric (1)	Gas (1) *
HBE5453UC	HMCP0252UC, HMCP0254UC	NIT5068UC	NET8068UC	NGM8046UC
Built-In microwave	HMC80242UC, HMC80244UC	NIT5668UC, NIT5469UC	NET8068SUC	NGM5656UC
HMB57152UC	HMC80252UC, HMC80254UC	NIT8068UC, NIT8068SUC	NET8668UC	NGMP656UC
HMB50162UC	HMC87152UC, HMC87154UC	NIT8668UC, NIT8668SUC	NET8668SUC	NGM8656UC
HMB50152UC	HMC80152UC, HMC50154UC	NITP068UC, NITP068SUC	NETP068SUC	NGM8646UC
HMB87154UC		NITP668UC, NITP668SUC	NETP668SUC	NGM5656UC
HMB50154UC		NIT8069UC, NIT8069SUC	NEM5066UC	NGMP056UC
Storage drawer	Speed oven (2)	NIT8669UC, NIT8669SUC	NEM5666UC	NGM8056UC
HSD5051UC	HMC54151UC	NITP069UC, NITP069SUC		Gas (2) *
Drawer microwave	HMC54152UC	NITP669UC, NITP669SUC		NGM5456UC
HMD8053UC	HMC54154UC			Gas (3) *
HMD8451UC				NGMP077UC
Warming drawers				NGMP677UC
HWD5051UC				NGM8657UC
HWD5751UC				NGM8057UC

\*Gas cooktops may require a 3/8" street elbow (not provided) at the regulator outlet for installation above built-in oven. COOKTOPS that are not listed above must be approved under local codes and/or by the local authority having jurisdiction. Please note: For the latest updates to the approved oven/cooktop combination refer to the website listed in your appliance's installation instructions.

Accessories: To purchase Bosch accessories, cleaners & parts please visit [www.bosch-home.com/us/store](http://www.bosch-home.com/us/store) or call 1-800-944-2904 (Mon to Fri 5 am to 6 pm PST, Sat 6 am to 3 pm PST). Notes: All height, width and depth dimensions are shown in inches. BSH reserves the absolute and unrestricted right to change product materials and specifications, at any time, without notice. Consult the product's installation instructions for final dimensional data and other details prior to making cutout. Warranties: Please see Use & Care manual or Bosch website for statement of limited warranty. For more information on our entire line of products, go to [www.bosch-home.com/us](http://www.bosch-home.com/us) or call 1-800-944-2904 © BSH Home Appliances Corporation. All rights reserved. Bosch is a registered trademark of Robert Bosch GmbH.



# 36" Gas Cooktop

800 Series – Stainless Steel NGM8656UC



**Cooktop over built-in oven combination installation**  
Refer to the product installation guide for all other measurements.

Oven installation requirements				Cooktop installation requirements (wall spacing)				
When installing an oven or oven with a drawer in combination with a cooktop, a minimum distance between the cabinet floor and countertop (B) is required. Reference the table for dimensions. Refer to the oven installation guide for all other measurements.								
Oven type	A Inches (mm)	B min. Inches (mm)	C max. Inches (mm)	Gas cooktop (1) min. Inches (mm)	Gas cooktop (2) min. Inches (mm)	Gas cooktop (3) min. Inches (mm)	Electric cooktop	Induction cooktop
Conventional oven (1)	28 1/4 (718)	31 1/4 (794)	4 3/4 (121)	D: 24 (610) E: 24 (610)	D: 3 (76) E: 4 (102)	D: 24 (610) E: 24 (610)	Reference Product Installation Instructions	
Conventional oven (2)	23 (584)	27 3/4 (705)	8 1/4 (210)	D: 24 (610) E: 24 (610)	D: 3 (76) E: 4 (102)	D: 24 (610) E: 24 (610)	Reference Product Installation Instructions	
Conventional oven (3)	23 1/16 (585)	27 13/16 (707)	8 3/16 (208)	D: 24 (610) E: 24 (610)	D: 3 (76) E: 4 (102)	D: 24 (610) E: 24 (610)	Reference Product Installation Instructions	
Steam oven	19 1/4 (488)	23 3/8 (594)	12 5/8 (321)	D: 24 (610) E: 24 (610)	D: 3 (76) E: 4 (102)	D: 24 (610) E: 24 (610)	Reference Product Installation Instructions	
Steam oven with 4" storage drawer								
Speed oven (2)	17 3/4 (450)	22 1/2 (572)	13 1/2 (343)	D: 24 (610) E: 24 (610)	D: 3 (76) E: 4 (102)	Reference Product Installation Instructions		
Microwave speed oven (1)	19 1/4 (488)	24 (609)	12 (306)	D: 24 (610) E: 24 (610)	D: 3 (76) E: 4 (102)	Reference Product Installation Instructions		
Microwave speed oven (1) with warming drawer	28 1/4 (718)	31 1/4 (794)	4 3/4 (121)	D: 24 (610) E: 24 (610)	D: 3 (76) E: 4 (102)	Reference Product Installation Instructions		
Drawer microwave	14 13/16 (376)	20 (508)	16 (406)	D: 24 (610) E: 24 (610)	D: 3 (76) E: 4 (102)	Reference Product Installation Instructions		

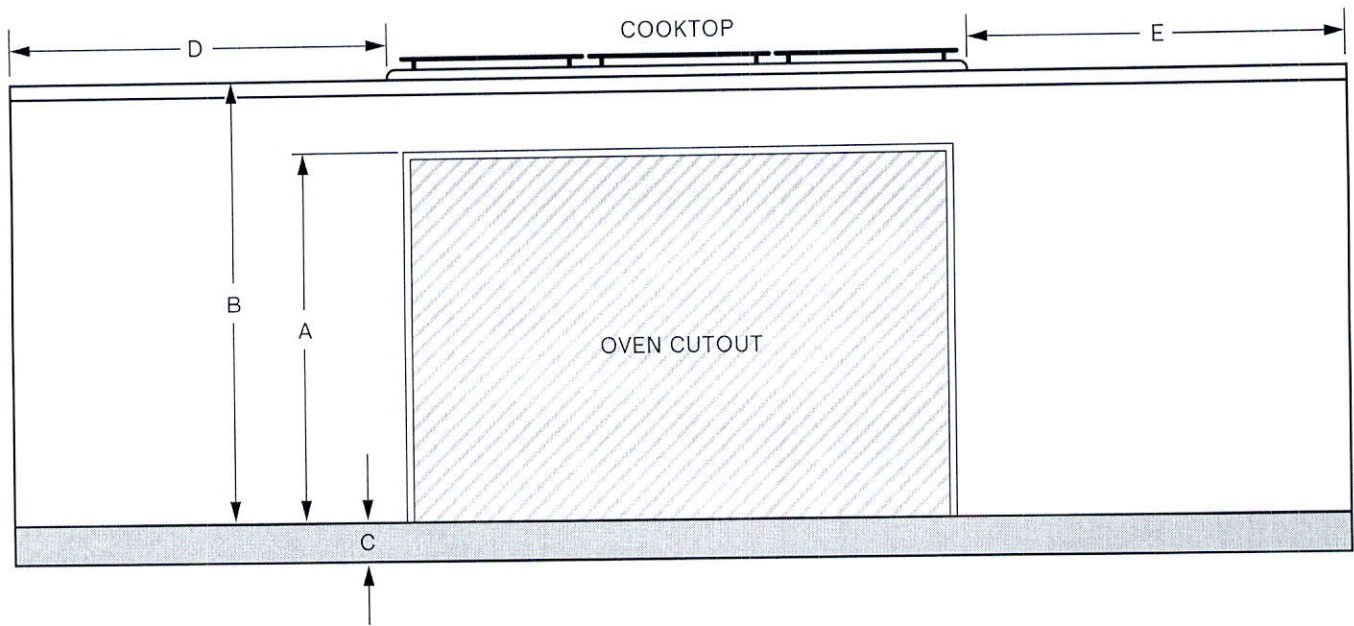

**Accessories:** To purchase Bosch accessories, cleaners & parts please visit [www.bosch-home.com/us/store](http://www.bosch-home.com/us/store) or call 1-800-944-2904 (Mon to Fri 5 am to 6 pm PST, Sat 6 am to 3 pm PST).

**Notes:** All height, width and depth dimensions are shown in inches. BSH reserves the absolute and unrestricted right to change product materials and specifications, at any time, without notice. Consult the product's installation instructions for final dimensional data and other details prior to making cutout.

**Warranties:** Please see Use & Care manual or Bosch website for statement of limited warranty.

For more information on our entire line of products, go to [www.bosch-home.com/us](http://www.bosch-home.com/us) or call 1-800-944-2904

© BSH Home Appliances Corporation. All rights reserved. Bosch is a registered trademark of Robert Bosch GmbH.