

CONSTRUCTION SUMMARY				APR 21 2021
Mountainview Heights 3 (G) - Russell Gardens Building Ltd.				TEL:
PURCHASER: Momal FAREED				
LOT / PHASE	REG. PLAN #	HOUSE TYPE		
308 / 3	62M-1266	Valleycreek Three Elev 3		

CABINETRY ACCESSORIES

1 - KITCHEN CABINETRY UPPER - FULL DEPTH ABOVE FRIDGE - WITH GABLES - 600MM - PRICE IS EACH - STANDARD 08Apr21 Note:	
1 - KITCHEN CABINETRY BASE - BUILT-IN - MICROWAVE BASE CABINET WITH SINGLE POT DRAWER - 800MM WIDE - PRICE IS EACH - STANDARD 08Apr21 Note:	

CERAMIC TILE

1 - TILE - UPGRADE 2 FLOOR TILE - - KITCHEN 08Apr21 Note:	
1 - DELETE ALL CERAMIC BATHROOM ACCESSORIES - DELETE TOWEL BAR, PAPER HOLDER & SOAP DISH THROUGHOUT 08Apr21 Note:	
1 - TILE - UPGRADE 2 FLOOR TILE - - POWDER ROOM 08Apr21 Note:	
1 - TILE - UPGRADE 2 FLOOR TILE - - LANDING 08Apr21 Note:	
1 - TILE - UPGRADE 2 FLOOR TILE - - FOYER 08Apr21 Note:	

CONSTRUCTION

1 - SMOOTH CEILINGS ON FIRST FLOOR ONLY - DET 08Apr21 Note:	
--	--

COUNTER TOP

1 - KITCHEN - FULL HEIGHT QUARTZ BACKSPLASH 08Apr21 Note:	
1 - COUNTER TOP - UPGRADE - KITCHEN COUNTER TOP 08Apr21 Note:	

ELECTRICAL

1 - PLUG - ELECTRICAL PLUG - FOR BUILT-IN MICROWAVE 08Apr21 Note:	
2 - FAN - BATHROOM EXHAUST FAN - ENERGY STAR 80 CFM - IN LIEU OF STANDARD FAN - MASTER ENSUITE & ENSUITE 4 BATHROOM 08Apr21 Note:	
1 - PLUG - ELECTRICAL PLUG - INSTALLED 5' FROM FLOOR - BEDROOM 4 08Apr21 Note:	
1 - PLUG - ELECTRICAL PLUG WITH GFI AND SWITCH - FOR FESTIVE LIGHTING 08Apr21 Note:	
1 - PLUG - ELECTRICAL PLUG - TO BE INSTALLED OVER FIREPLACE 08Apr21 Note:	

CONSTRUCTION SUMMARY
Mountainview Heights 3 (G) - Russell Gardens Building Ltd.

PURCHASER: Momal FAREED

TEL:

LOT / PHASE	REG. PLAN #	HOUSE TYPE		
308 / 3	62M-1266	Valleycreek Three Elev 3		

1 - ABOVE KITCHEN ISLAND - ADD LIGHT AND SWITCH - NO FIXTURE INCLUDED

08Apr21 Note:

FIREPLACE AND ACCESSORIES

1 - GAS LINE ROUGH-IN FOR STOVE (INCLUDES ELECTRICAL OUTLET) - FIRST FLOOR

08Apr21 Note:

HARDWOOD FLOORING

1 - HARDWOOD - GROUP B SERIES 5 INCH - IN LIEU OF 2 1/4 INCH NATURAL RED OAK - - FAMILY ROOM

08Apr21 Note:

1 - HARDWOOD - GROUP B SERIES 5 INCH - IN LIEU OF 2 1/4 INCH NATURAL RED OAK - - DINING ROOM

08Apr21 Note:

MIRRORS AND GLASS

1 - MASTER ENSUITE – FRAMELESS GLASS SHOWER ENCLOSURE – INCLUDES CHROME KNOB AND HINGES

08Apr21 Note:

PLUMBING

1 - KITCHEN - MOEN ALIGN SINGLE HANDLE PULL-DOWN FAUCET - MATTE BLACK - #7565 - BL

08Apr21 Note:

1 - SINK - UNDERMOUNT SINK - TECO KITCHEN #602

08Apr21 Note:

2 - HOT WATER VALVE NEXT TO TOILET - MASTER ENSUITE BATHROOM & SHARED ENSUITE BATHROOM

08Apr21 Note:

1 - WATER LINE FOR FRIDGE - ROUGH-IN ONLY

08Apr21 Note:

PROMOTIONAL

1 - LESS CREDIT FROM PURCHASER EXTRA SHEET IN OFFER

08Apr21 Note:

STAIRS AND RAILINGS

1 - STAINED STAIRS – STANDARD STAIRCASE - PRICE IS PER SET

08Apr21 Note:

1 - STAIRCASE - EUROLINE 1 IRON PICKETS - BLACK

08Apr21 Note:

CONSTRUCTION SUMMARY				
Mountainview Heights 3 (G) - Russell Gardens Building Ltd.				
PURCHASER: Momal FAREED				TEL:
LOT / PHASE	REG. PLAN #	HOUSE TYPE		
308 / 3	62M-1266	Valleycreek Three Elev 3		

EXTRAS AS PER OFFER

The Vendor agrees that notwithstanding any other term or provision in this Agreement included in the Purchase Price and in addition to those items detailed in Schedule GP to the Agreement of Purchase and Sale, the Purchaser is entitled to a credit of Two <i>Worksheet Note:</i>	
4 LARGER BASEMENT WINDOWS. <i>Worksheet Note:</i>	
PURCHASER(S) ACKNOWLEDGES THAT THE PURCHASE PRICE IS INCLUSIVE OF ALL CREDITS AND PROMOTIONAL PACKAGES AVAILABLE AT TIME OF PURCHASE. <i>Worksheet Note:</i>	
MAIN LEVEL 10 FOOT CEILING. <i>Worksheet Note:</i>	

This Document is Extremely Time Sensitive - Printed 8 Apr 21 at 13:15

Purchaser: Momal FAREED

Telephone Res. / Bus: /

Decor Advisor: Candace Forza

Lock Date: 8-Apr-21

Property: 308

Project: Russell Gardens Building Ltd.

Model and Elevation: Valleycreek Three Elev 3

Plan #: 62M-1266

Layout Changes: ☒ Yes ☐ No

Sketch Attached: ☒ Yes ☐ No

Exterior Colour Scheme:

1. Cabinetry

	Style and Colour	Hardware
Kitchen / Breakfast	MONACO 350 PLATINUM SILVER	447SA
Laundry Room	ELISSE	Standard
Powder Room	DORAL K38 RIVERSIDE	447SA
Master Ensuite Bathroom	DORAL H3081 HACIENDA BLACK	447SA
Ensuite Bath - Bedroom 2/3	DORAL H3078 HACIENDA WHITE	447SA
Ensuite Bath - Bedroom 4	DORAL K44 TITAN GREY	431SA
	N/A	N/A
	N/A	N/A
	N/A	N/A

Appliances:

☐ Closed ☒ Open

☐ Yes ☐ No

☐ Closed ☒ Open

☐ Yes ☐ No

41" Upper Cabinets

☒ Yes ☐ No

Slide In Stove

☐ Yes ☒ No

Please NOTE: Standard Cabinet Height is 30"

Dishwasher Cabinet

NOTE: If not specified, opening will be set to builder's standard opening of approximately 30" width

Stove Opening

NOTE: If not specified, opening will be set to builder's standard opening of approximately 37" width x 74" height

Fridge Opening

BUILT-IN MICROWAVE ONLY ** Refer to Construction Summary

2. Counters

	Counter	Edge
Kitchen / Breakfast	QUARTZ-ARABESCATO NUOVO	#300 EDGE - DOUBLE BULLNOSE
Laundry Room	N/A	
Powder Room	LAMINATE-PALOMA POLAR 6698-46	
Master Ensuite Bathroom	LAMINATE-PALOMA POLAR 6698-46	
Ensuite Bath - Bedroom 2/3	LAMINATE-INUK SHUK GREY P-344 LM	
Ensuite Bath - Bedroom 4	LAMINATE-WHITE TIGRIS 4783-60	
	N/A	
	N/A	
	N/A	

** Refer to Construction Summary

Purchaser:	Momal FAREED
Telephone Res. / Bus:	/
Decor Advisor:	Candace Forza
Lock Date:	8-Apr-21

Property: 308
Project: Russell Gardens Building Ltd.
Elevation: Valleycreek Three Elev 3
Plan #: 62M-1266

—3. Ceramic Flooring

At a 45 Threshold-If App.

Entrance Vestibule	TILE-CRES CAPE GRACE-12X24	<input type="checkbox"/>	metal strip where applicable
Main Hall	N/A	<input type="checkbox"/>	
Kitchen / Breakfast	TILE-CRES CAPE GRACE-12X24	<input type="checkbox"/>	
Laundry Room	TILE-SN PASTELLO WHITE-13X13	<input type="checkbox"/>	
Powder Room	TILE-CRES CAPE GRACE-12X24	<input type="checkbox"/>	
Master Ensuite Bathroom	TILE-SN PASTELLO WHITE-13X13	<input type="checkbox"/>	
Ensuite Bath - Bedroom 2/3	TILE-GAT2J156 NEO GREY-12X12	<input type="checkbox"/>	
Ensuite Bath - Bedroom 4	TILE-GAT2J156 NEO GREY-12X12	<input type="checkbox"/>	
LOWER LANDING	TILE-CRES CAPE GRACE-12X24	<input type="checkbox"/>	
	N/A	<input type="checkbox"/>	
	N/A	<input type="checkbox"/>	

** Refer to Construction Summary

4. Ceramic Wall Tile

4. Ceramic Wall Tile		
Master Ensuite Bathroom	Selection	Describe
Tub Deck Wall	N/A	
Tub Deck	N/A	
Tub Deck Skirt	N/A	
Shower Stall	TILE-LUC AFRICA-8X16	
Bathtub Enclosure Walls	N/A	
Ensuite Bath - Bedroom 2/3	TILE-CONCEPT PLUS DARK GREY-8X16	
Ensuite Bath - Bedroom 4	TILE-LUC BLANC GROENLANDIA-8X16	
LOWER LANDING	N/A	
	N/A	
	N/A	
Kitchen Backsplash	QUARTZ-ARABESCATO NUOVO	FULL HEIGHT

**** Refer to Construction Summary - STANDARD GROUT THROUGHOUT UNLESS SPECIFIED**

5. Plumbing Fixtures

All Bathrooms	White
	N/A
	N/A
	N/A
	N/A
	N/A

- Whirlpool

N/A ☐ Yes ☒ No

Dishwasher Rough-In ☒ Yes ☐ No

Waterline for Fridge ☒ Yes ☐ No

**** Refer to Construction Summary**

6. Trim Carpentry

Interior Doors	CARRARA-SMOOTH
Interior Trim	As Per Construction Specifications
Door Handles	As Per Construction Specifications
Exterior Front Door Handle	As Per Construction Specifications

**** Refer to Construction Summary**

Initial: 

Purchaser: Momal FAREED

Telephone Res. / Bus: /

Decor Advisor: Candace Forza

Lock Date: 8-Apr-21

Property: 308

Project: Russell Gardens Building Ltd.

Model and Elevation: Valleycreek Three Elev 3

Plan #: 62M-1266

7. Other Flooring		
Main Hall	N/A	
Living Room	N/A	
Dining Room	STRIP-MIRAGE-TRUBALANCE-IMAGINE-CHARACTER-RED OAK-DURAMATT-DRIFTWOOD-5"	
Family Room	STRIP-MIRAGE-TRUBALANCE-IMAGINE-CHARACTER-RED OAK-DURAMATT-DRIFTWOOD-5"	
Den / Library / Study	N/A	
Basement Landing(If Applies)	N/A	
Lower Landing (If Applies)	TILE	
Upper Landing	STRIP-MIRAGE-TRUBALANCE-IMAGINE-CHARACTER-RED OAK-DURAMATT-DRIFTWOOD-5"	
Upper Hall	LAMINATE-LEXINGTON-ROCHEFORT OAK-TL-LW1317	
Master Bedroom	LAMINATE-LEXINGTON-ROCHEFORT OAK-TL-LW1317	
Bedroom #2	LAMINATE-LEXINGTON-ROCHEFORT OAK-TL-LW1317	
Bedroom #3	LAMINATE-LEXINGTON-ROCHEFORT OAK-TL-LW1317	
Bedroom #4	LAMINATE-LEXINGTON-ROCHEFORT OAK-TL-LW1317	
Bedroom #5	N/A	
	N/A	
	N/A	
	N/A	
Underpad	Type	Area
	N/A	N/A

** Refer to Construction Summary

8. Railings and Pickets

Railing Type

Picket Type

Stringer / Riser

Treads

AS PER CONSTRUCTION SPECIFICATIONS

EUROLINE 1

AS PER CONSTRUCTION SPECIFICATIO

AS PER CONSTRUCTION SPECIFICATIO

Colour

Colour

Colour

Colour

MIRAGE DRIFTWOOD RED OAK

BLACK

MIRAGE DRIFTWOOD RED OAK

MIRAGE DRIFTWOOD RED OAK

Red Oak Stairs with Semi Gloss Finish

☒ Yes

☐ No

** Refer to Construction Summary

THE STAIN COLOURS OR FINISH AVAILABLE ON RISERS, TREADS, PICKETS AND RAILS (STAIRCASES), WILL NOT BE AN EXACT MATCH TO PREFINISHED HARDWOOD OR LAMINATE FLOORS.

9. Wall Paint Flat Finish

Main & Upper Hall

Living Room

Dining Room

Kitchen / Breakfast

Family Room

Powder Room

Laundry Room

Den/Library

Trim Paint-Semi Gloss

22 WARM GREY

N/A

22 WARM GREY

22 WARM GREY

22 WARM GREY

22 WARM GREY

22 WARM GREY

N/A

BIRCH WHITE

Master Bedroom

Bedroom #2

Bedroom #3

Bedroom #4

Bedroom #5

Master Ensuite

Ensuite Bath - Bedroom 2/3

Ensuite Bath - Bedroom 4

22 WARM GREY

22 WARM GREY

22 WARM GREY

22 WARM GREY

N/A

22 WARM GREY

22 WARM GREY

22 WARM GREY

Smooth Ceilings First Floor

☒ Yes

☐ No

** Refer to Construction Summary

Purchaser: Momal FAREED
Telephone Res. / Bus: /
Decor Advisor: Candace Forza
Lock Date: 8-Apr-21

Property: 308
Project: Russell Gardens Building Ltd.
Model and Elevation: Valleycreek Three Elev 3
Plan #: 62M-1266

10. Plaster Mouldings and Medallions

Entrance Vestibule	N/A	N/A	Kitchen/Breakfast	N/A	N/A
Main Hall	N/A	N/A	Den/Library	N/A	N/A
Living Room	N/A	N/A	Lower Landing	N/A	N/A
Dining Room	N/A	N/A		N/A	N/A
Family Room	N/A	N/A			

** Refer to Construction Summary

11. Fireplace

	Living Room			Family Room			Other Room - Specify		
	Purchased	As Per Plan	N/A	Purchased	As Per Plan	N/A	Purchased	As Per Plan	N/A
	<input type="radio"/>	<input type="radio"/>	<input checked="" type="radio"/>	<input type="radio"/>	<input checked="" type="radio"/>	<input type="radio"/>	<input type="radio"/>	<input type="radio"/>	<input checked="" type="radio"/>
Fireplace Type	N/A			FLAT ON WALL			N/A		
Mantle Type	N/A			MANTLE M1-STANDARD			N/A		
Colour / Stain	N/A			AS PER CONSTRUCTION SPECIFICATIONS			N/A		
Surround	N/A			GRIGIO CARNICO			N/A		
Hearth	N/A			NO			N/A		

** Refer to Construction Summary

12. Heating and Air Conditioning

Air Conditioning	NO	Gas Provisions Stove	YES
Gas Provisions Dryer	NO	Gas Provisions Barbecue	NO
Comment			

** Refer to Construction Summary

13. Electrical

Plugs and Switches	<input checked="" type="radio"/> White	DECOR	Above Kitchen Cabinet Light	<input type="radio"/> Yes	<input checked="" type="radio"/> No
Hood Fan	STANDARD WHITE		Below Kitchen Cabinet Light	<input type="radio"/> Yes	<input checked="" type="radio"/> No
Appliances	Built in Cooktop		Built in Oven		Gas Stove
	<input type="radio"/> Yes	<input checked="" type="radio"/> No	<input type="radio"/> Yes	<input checked="" type="radio"/> No	<input checked="" type="radio"/> Yes
Dishwasher Rough-in	Yes				Microwave
					<input checked="" type="radio"/> Yes

** Refer to Construction Summary

14. General Comments

** Refer to Construction Summary

Disclaimers and Notes

- 1) Colours of all materials are as close as possible to builder's selection, but not necessarily identical due to variances in manufacturing.
- 2) Any extras listed above are null and void unless accompanied by a separate invoice/amendment. Said invoice must be paid in full.
- 3) The Purchaser agrees that this colour selection is final and that no changes will be permitted, unless required by the Vendor.
- 4) The Purchaser acknowledges reading and accepting document which contains other miscellaneous disclaimers.

Signature:  Date: 08/04/21

FRIGIDAIRE
PROFESSIONAL

FPMO3077TF

MICROWAVE
30" BUILT-IN WITH CONVECTION

Smudge-Proof
Stainless Steel

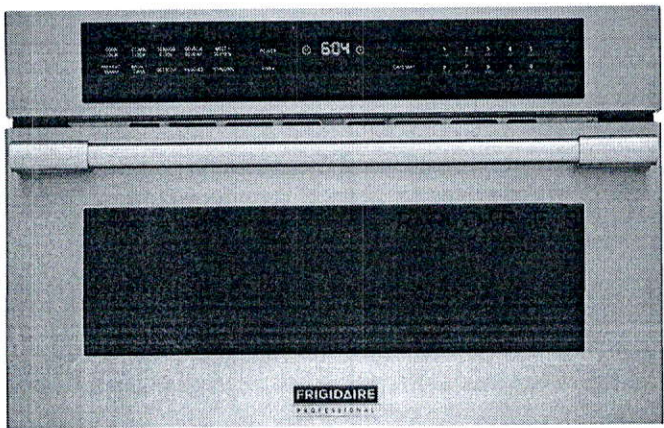

AVAILABLE COLORS



Stainless

SIGNATURE FEATURES

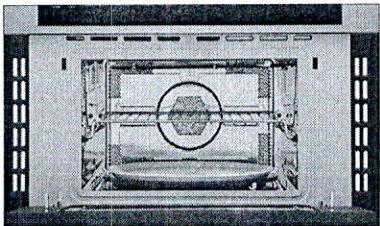

PowerPlus™ 2-in-1 Convection
Oven or Microwave

Get the great-tasting results of a conventional convection oven combined with the speed of microwave technology with the PowerPlus™ 2-in-1 Convection Microwave Oven.

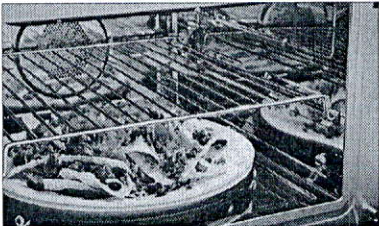

PowerSense™ Cooking Technology

Results you can trust. PowerSense™ Cooking Technology automatically senses ideal time and power levels.

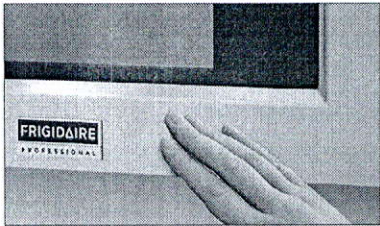

Smudge-Proof™ Stainless Steel

Resists fingerprints and cleans easily.

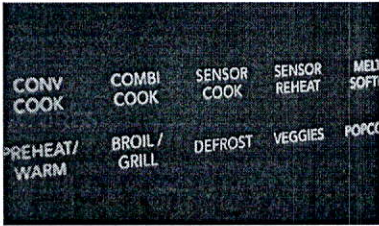

PowerSense™ Auto Defrost

Take the guesswork out of defrosting meat, poultry, or fish with PowerSense™ Auto Defrost.

PRODUCT DIMENSIONS

Height	19"
Width	29-13/16"
Depth	23"

MORE EASY-TO-USE FEATURES

PowerSense™ Broil & Grill

Grill fresh or frozen pizza at the touch of a button.

PowerBright® LED Lighting

See the power. See the results in action. LED interior microwave light stays on while your dish cooks.

Keep Warm

Consistently keep your dishes warm, for up to 90 minutes, until everything and everyone is ready.

Drop-Down Door

Faster, easier access to what you are cooking with Drop-Down Door configuration.

Adjustable Timer

Now you can adjust the cooking time of your dish while it's cooking. The adjustable timer allows you to add 30 seconds on the timer.

FPMO3077TF
MICROWAVE
30" BUILT-IN WITH CONVECTION

FRIGIDAIRE
PROFESSIONAL

FEATURES

Control/Timing System	Pro-Select*
Exterior Door Finish	Smudge-Proof™ Stainless Steel
Handle Design	Stainless Steel
Microwave Capacity (Cu.Ft.)	1.6
PowerPlus™ Convection	Yes
Watts (IEC-705 Test Procedure)	1,000
Interior LED Light	Yes
Interior Color	Stainless Steel
Turntable Diameter	14-3/16"
Control Lock	Yes
Clock	Yes
Touch Pad Buttons	28
Power Levels	High (1-9)
Accessory Metal Rack	Yes

MICROWAVE CONTROL OPTIONS

Popcorn Button	Yes
Sensor Cook Button	Yes
Sensor Reheat Button	Yes
Broil/Grill	Yes
Preheat/Warm	Yes
Melt & Soften Options	4
Auto Defrost Options	3
Multi-Stage Cooking Option	Yes
Keep Warm	Yes
Add 30 Seconds	Yes
Sensor Cooking Options	5
Sensor Reheat Options	5
Vegetable Cook Sensor	Yes
User Preferences	Yes
Adjustable Timer	Yes

POWER RATINGS

Frequency (MHz)	2,450
Watts @ 120 Volts	1,750
Amps @ 120 Volts	15.5

SPECIFICATIONS

Oven Interior (HxWxD)	9-27/32" x 16-1/2" x 16-1/2"
Power Supply Connection Location	Right Top Rear
Voltage Rating	120V/60Hz/20A
Connected Load (kW Rating) @ 120 Volts¹	1.75
Minimum Circuit Required (Amps)	20
Plug Type (NEMA)	LCDI (5-20P)
Shipping Weight (Approx.)	100 Lbs.

¹For use on adequately wired 120V dedicated circuit having 2-wire service with a separate ground wire. Appliance must be grounded for safe operation.

PRODUCT DIMENSIONS

A - Height	19"
B - Width	29-13/16"
C - Depth	23"

CUTOUT DIMENSIONS

Height (Min. - Max.)	17-3/4" - 18"
Width (Min. - Max.)	28" - 28-3/8"
Depth (Min.)	22"

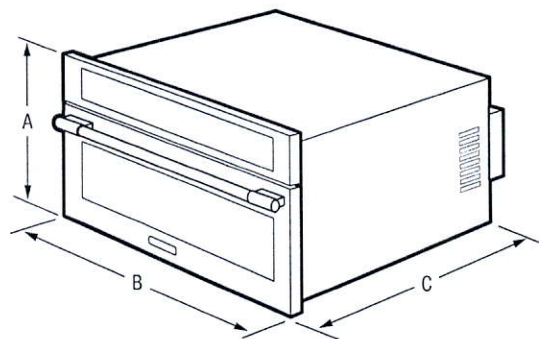

Note: For planning purposes only. Always consult local and national electric, gas and plumbing codes. Refer to Product Installation Guide for detailed installation instructions on the web at frigidaire.com / frigidaire.ca. Specifications subject to change. Accessories information available on the web at frigidaire.com / frigidaire.ca

FRIGIDAIRE
USA • 10200 David Taylor Drive • Charlotte, NC 28262 • 1-800-FRIGIDAIRE • frigidaire.com
CANADA • 5855 Terry Fox Way • Mississauga, ON L5V 3E4 • 1-800-265-8352 • frigidaire.ca

FPMO3077T 10/18
© 2017 Electrolux Home Products, Inc.

FPMO3077TF
MICROWAVE
30" BUILT-IN WITH CONVECTION

FRIGIDAIRE
PROFESSIONAL.

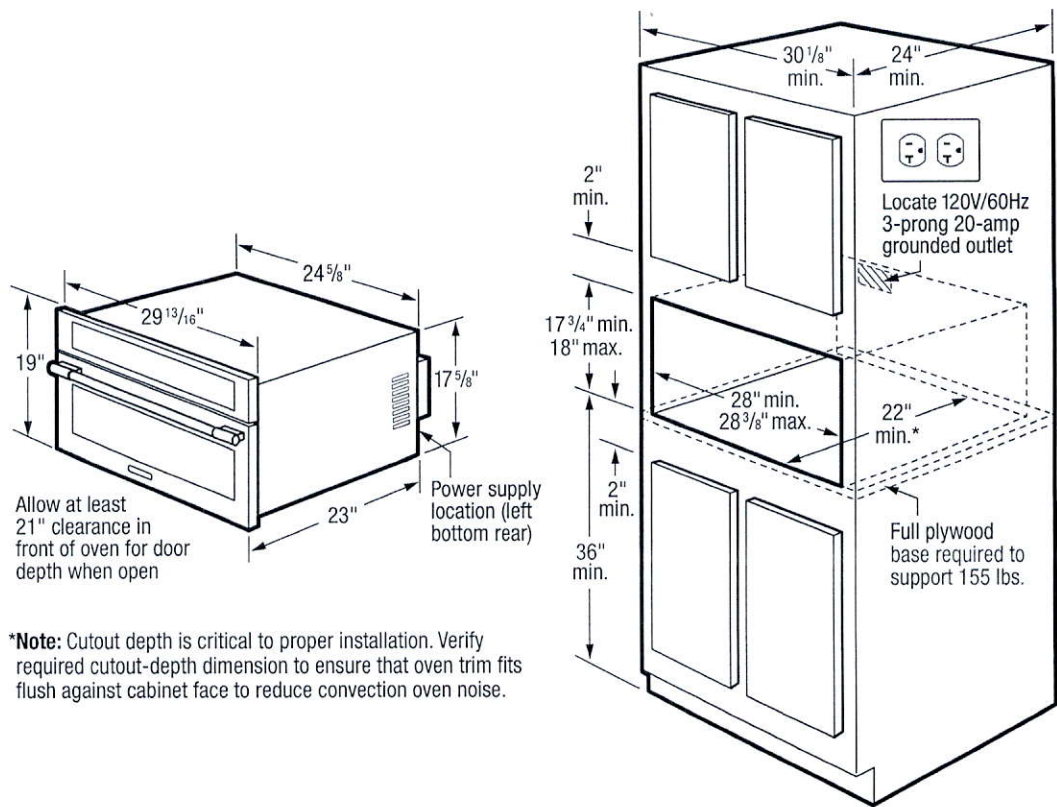

INSTALLATION SPECIFICATIONS

- Product Shipping Weight (Approx.) - 100 Lbs.
- Voltage Rating - 120V/60 Hz/20 Amps
- Connected Load (kW Rating) @ 120 Volts = 1.75 kW
(For use on adequately wired 120V, dedicated circuit having 2-wire service with a separate ground wire. Appliance must be grounded for safe operation.)
- Amps @ 120 Volts = 20 Amps
- Always consult local and national electric codes.
- Microwave can stand alone on countertop or be built in with optional 30" or 27" Trim Kit (ordered by individual part number) which includes Bottom Duct Assembly - shipped in separate box.
- Allow 21" minimum clearance for 90° door swing.
- Minimum 22" deep oven cutout dimension is critical for proper installation for oven and faceplate to fit flush against cabinet front.
- Consult local building code, in the event that cutout opening may be required to be enclosed with sides, ceiling and rear partition.
- Full oven base of solid plywood or similar material required, capable of supporting 155 Lbs.
- Base must be level and front of cabinet square for proper operation.
- Can NOT be installed above any gas wall oven.
- Built-In Microwave is approved to be used in combination with any Frigidaire® Electric Single Wall Oven and/or Warmer Drawer. (Refer to model-specific Combination Installation Specification pages on web.)
- When used in combination with another Frigidaire® built-in product, a minimum clearance of 2" is required from the bottom of the microwave cutout to the top edge of the companion product's faceplate. Please refer to companion product's installation instructions for cutout dimensions.



FRIGIDAIRE
USA • 10200 David Taylor Drive • Charlotte, NC 28262 • 1-800-FRIGIDAIRE • frigidaire.com
CANADA • 5855 Terry Fox Way • Mississauga, ON L5V 3E4 • 1-800-265-8352 • frigidaire.ca

Note: For planning purposes only. Always consult local and national electric, gas and plumbing codes. Refer to Product Installation Guide for detailed installation instructions on the web at frigidaire.com / frigidaire.ca.

Specifications subject to change. Accessories information available on the web at frigidaire.com / frigidaire.ca

FPMO3077T 10/18
© 2017 Electrolux Home Products, Inc.

NX60T8311SS

SAMSUNG

Samsung Front Control Slide-in Gas Range with Convection

6.0 cu. ft. Capacity



Signature Features

Convection

- Powerful convection saves you time by cooking food fast and more evenly. Perfect for baking and roasting.

Ready2Fit™ Guarantee

- If your Samsung Front Control Slide-In Range doesn't fit your 30" Freestanding Range cutout, enjoy \$100* on us to cover any countertop modification costs.

*Visit samsungpromotions.com/SlideInReady2Fit for details.

Fingerprint Resistant Finish

- Fingerprint resistant, for an everyday beautiful finish.

Available Colors



Fingerprint Resistant
Stainless Steel (shown)



Fingerprint Resistant
Black Stainless Steel

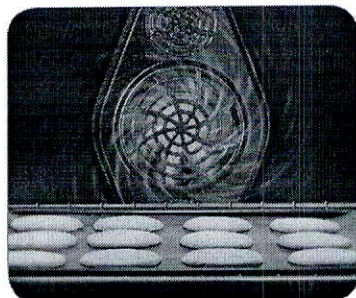

Convection



Ready2Fit™ Guarantee

Features

- Convection
- Ready2Fit™ Guarantee
- Fingerprint Resistant Finish
- 2 Power Burners
- Integrated Cast-Iron Griddle
- Large Oven Capacity – 6.0 cu. ft.
- Glass Touch Controls
- Edge-to-Edge Grates
- Storage Drawer

- Flexible Cooktop:
 - Right Front: 17K BTU
 - Left Front: 16K BTU
 - Right Rear: 5K BTU
 - Left Rear: 9.5K BTU
 - Center (Oval): 10K BTU

Convenience

- Wi-Fi Connectivity
- Voice-Enabled
- Self Clean
- Child Safety Lock
- Delay Start
- Auto Oven Light
- Kitchen Timer
- Sabbath Mode



NX60T8311SS

SAMSUNG

Samsung Front Control Slide-in Gas Range with Convection

6.0 cu. ft. Capacity

Installing Your Range

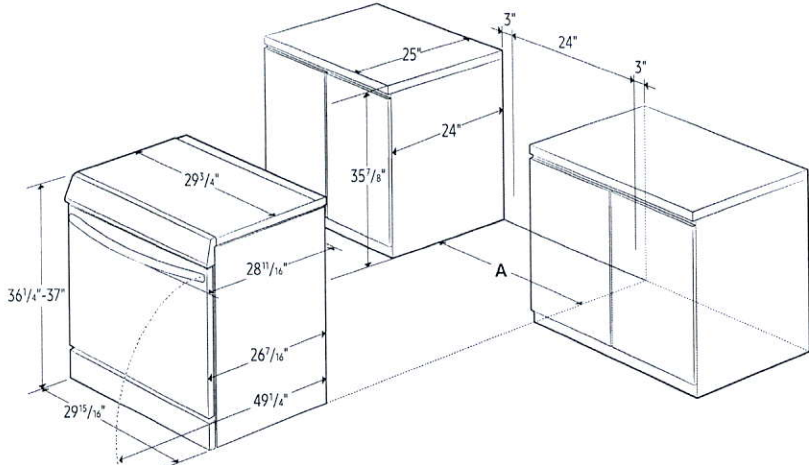

A: Cabinet opening 30"

IMPORTANT: If your cabinets are over 37" high, you must install this range on a hard, heat-resistant support that raises the surface of the range so that it is about even with the countertop.

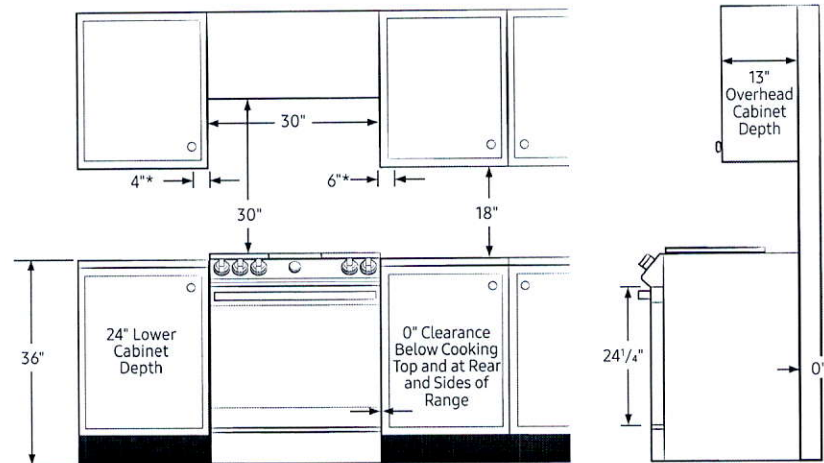

*Side clearance above cooking surface to any objects, i.e., wall.

IMPORTANT: Consult with Installation Manual for detailed instructions before installing.
All ranges must be installed with the Anti-Tip device that is included.

Recommended Locations for Gas Piping and Electrical Outlets

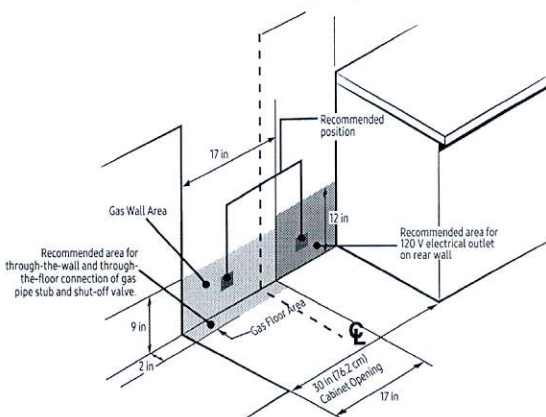

Actual color may vary. Design, specifications, and color availability are subject to change without notice. Non-metric weights and measurements are approximate.

©2020 Samsung Electronics America, Inc. 85 Challenger Road, Ridgefield Park, NJ 07660. Tel: 800-SAMSUNG. samsung.com. Samsung is a registered trademark of Samsung Electronics Co. Ltd.

Power Source
120V/60Hz/20A

Total Power (BTU)
57,500 BTU

- Black Enamel 5-Burner Cooktop
- Right Front: 17K BTU
 - Left Front: 16K BTU
 - Right Rear: 5K BTU
 - Left Rear: 9.5K BTU
 - Center (Oval): 10K BTU

- Oven
- Capacity: 6.0 cu. ft.
 - Convection Bake
 - Convection Roast
 - Bake
 - Variable Broil: Low/High
 - Bread Proof
 - Dehydrate

Warranty
One (1) Year Parts and Labor

Product Dimensions & Weight (WxHxD)
Oven Interior Dimensions:
24¹³/₁₆" x 21⁵/₈" x 19⁵/₈"
Outside Dimensions:
29¹⁵/₁₆" x 36¹/₄"-37" (Adjustable) x 28¹¹/₁₆"
Weight: 205 lbs

Shipping Dimensions & Weight (WxHxD)
Dimensions:
33¹/₁₆" x 41³/₄" x 30⁵/₁₆"
Weight: 230 lbs

Color	Model #	UPC Code
Fingerprint Resistant Stainless Steel	NX60T8311SS	887276409214
Fingerprint Resistant Black Stainless Steel	NX60T8311SG	887276409207



RF32FMQDBSR

32 cu. ft. 4-Door Refrigerator with Convertible Zone

Features

- Ultra-High Capacity — 32 cu. ft.
- Convertible Zone with 4 Temperature Control Settings
- Triple Cooling System
- Ice Master Ice Maker in the Refrigerator
- High-Efficiency LED Lighting
- Stainless-Look Display
- Stainless Steel Accents on Interior Shelving and Door Bins
- Fingerprint Resistant Coating
- EZ Slide-Out Shelf in Refrigerator
- Tempered Glass Spill-Proof Shelves
- EZ Slide-Out Shelves in Freezer and Convertible Zone
- Flip-Up Shelf
- Gallon Door Bins

Convenience

- Door Alarm
- Water Filter Indicator



ENERGY STAR® rated:
Rated CEE Tier 1: More Efficient
570 kWh/yr

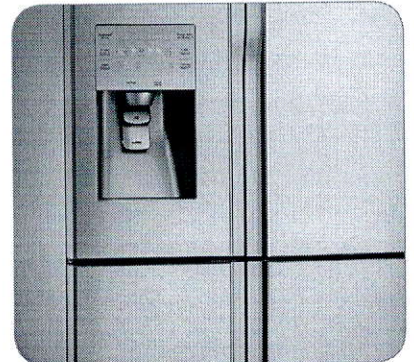
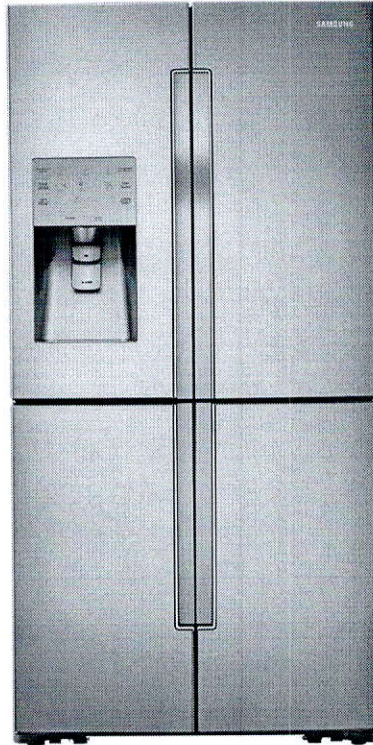

Clean, Modern Design

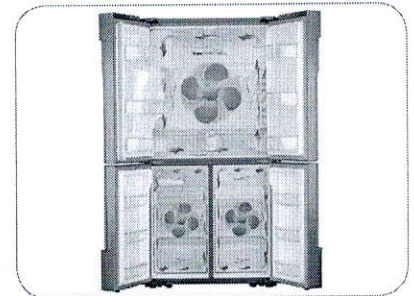

Triple Cooling System

Available Color



Stainless Steel

Signature Features

CLEAN, MODERN DESIGN

- Artful and symmetric design expresses individuality.
- Beautifully appointed stainless steel body and interior trim.

THE MOST FRESH FOOD STORAGE AND ULTIMATE FLEXIBILITY

- Flexible, bottom right door can be a fridge or freezer, maximizing fresh food storage space.
- The most fresh food storage available in its class at 25.6 cu. ft.,¹ when the convertible zone is used as a refrigerator.

¹ Among consumer-grade freestanding refrigerators

ULTRA-HIGH CAPACITY SAVES YOU TRIPS TO THE MARKET

- Our largest French Door refrigerator has enough room to fit up to 32 bags of groceries.²
- 32 cu. ft.³ makes this refrigerator the largest French Door refrigerator in its class.⁴

² Grocery comparison based on each cubic foot of usable space equaling one paper bag.

³ Actual size = 31.7 cu. ft.

⁴ Features the largest capacity refrigerator in Samsung's current lineup.



Ranked **"Highest in Customer Satisfaction with Refrigerators"**
by J.D. Power and Associates.

SAMSUNG

RF32FMQDBSR

32 cu. ft. 4-Door Refrigerator with Convertible Zone

Installing Your Refrigerator

1. Measure the height, width and depth of the opening, making sure to include baseboards, molding tile, countertop overhang, etc. Check to be sure there is enough room to open the door (consider walls, islands or other obstacles when measuring).
2. Refer to illustration below to determine dimensions.
3. Allow 2" of clearance on hinge side of refrigerator when installing next to a wall where handle may make contact.
4. Allow 1" minimum clearance at rear for proper air circulation and water/electrical connections. Allow a 3/8" minimum clearance at sides and top for ease of installation.
5. Ensure each door and entry way in the home is wide enough for the refrigerator to be moved through easily.

Please note: The following dimension and cutout information is for planning purposes only. For complete installation details consult manual packed with product, or download manual on-line at samsung.com.

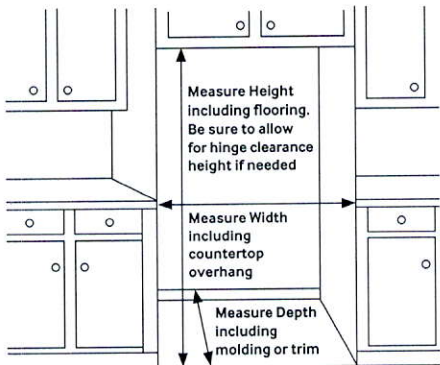

Dimensions

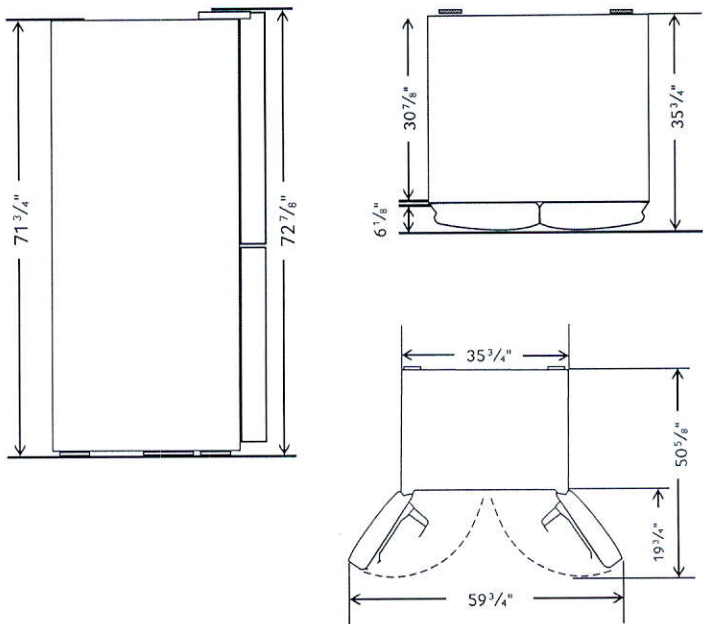

Total Capacity: 32 cu. ft.

Refrigerator: 19.5 cu. ft.

- Premium External Filtered Water and Ice Dispenser (Crushed or Cubed Ice)
- Ice Master Ice Maker
- High-Efficiency LED Lighting
- 4 Tempered Glass Spill-Proof Shelves
 - 1 EZ Slide-Out
 - 1 Flip-Up
 - 1 Foldable
 - 1 Fixed

Convertible Zone: 6.1 cu. ft.

- 1 EZ Slide-Out Shelf
- 2 Drawers
- 4 Temperature Zones:
 - 41°F
 - 30°F
 - 23°F
 - -9°F ~ 1°F
- High-Efficiency LED Lighting

Freezer: 6.1 cu. ft.

- 1 EZ Slide-Out Shelf
- 2 Freezer Drawers
- High-Efficiency LED Lighting

Accessories

Water Filter: HAF-CIN

Warranty

One (1) Year All Parts and Labor
Five (5) Years Sealed System Parts and Labor

Product Dimensions & Weight

Dimensions (WxHxD with hinges, handles and doors):
35 3/4" x 72 7/8" x 35 3/4"

Dimensions (WxHxD without hinges and door):
35 3/4" x 71 3/4" x 30 7/8"

Dimensions (WxHxD with hinge and door, no handle):
35 3/4" x 72 7/8" x 35 3/4"

Weight: 405.1 lbs.

Shipping Dimensions & Weight (WxHxD)

Dimensions: 38 1/4" x 79 1/2" x 38 1/4"

Weight: 434.5 lbs.

Color	Model #	UPC Code
Stainless Steel	RF32FMQDBSR/AA	0887276983356

SAMSUNG

Samsung received the highest numerical score for refrigerators in the proprietary J.D. Power and Associates 2012 Kitchen Appliance Study.SM Study based on 12,615 total responses measuring 17 brands and measures opinions of consumers about their refrigerator obtained new in the past 24 months. Proprietary study results are based on experiences and perceptions of consumers surveyed in January-February 2012. Your experiences may vary. Visit jdpower.com.

Actual color may vary. Design, specifications, and color availability are subject to change without notice. Non-metric weights and measurements are approximate.

©2013 Samsung Electronics America, Inc. 85 Challenger Road, Ridgefield Park, NJ 07660. Tel: 800-SAMSUNG. samsung.com. Samsung is a registered trademark of Samsung Electronics Co. Ltd.

Add Light Above Island

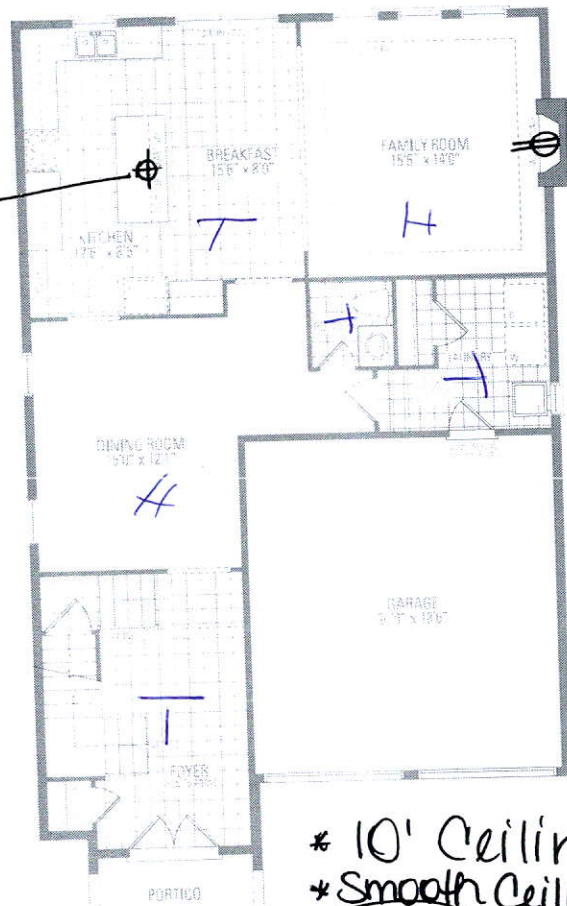

Add Plug Above Fireplace

Add Plug 5' from floor

Larger Basement Windows

Handless class first.

* 10' Ceiling
* Smooth Ceiling

Restive Plug

DP

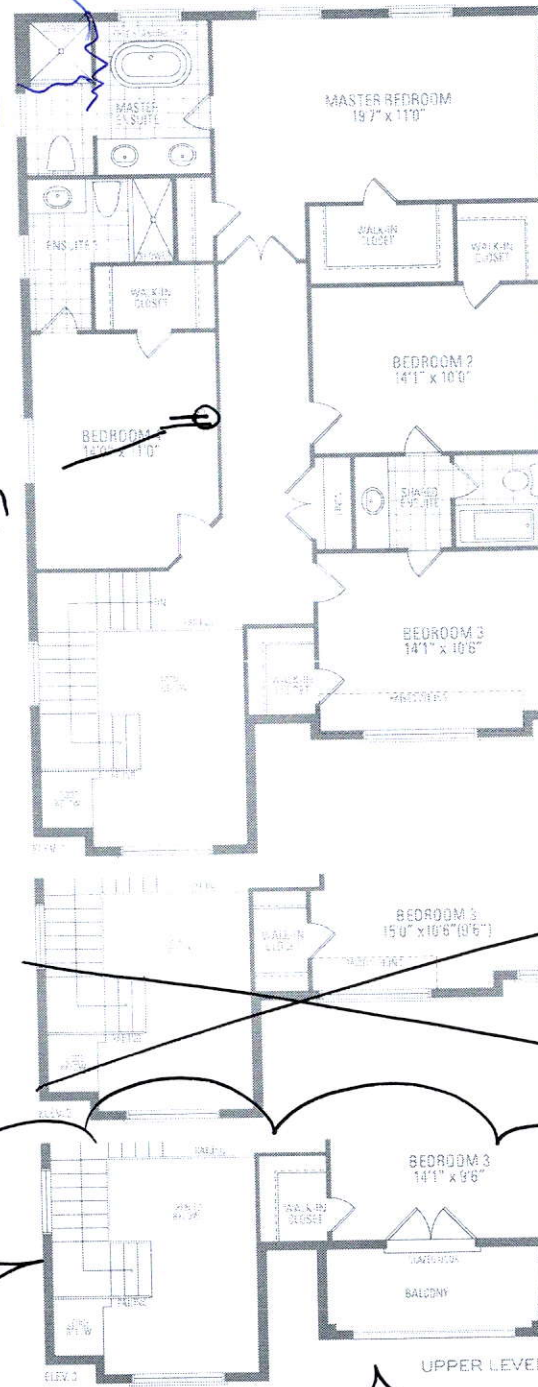

Lot 308 Russell Gardens III
VALLEYCREEK THREE ELEV. 1 • 2,772 sq.ft. | ELEV. 2 • 2,773 sq.ft. | ELEV. 3 • 2,758 sq.ft.

Orientation or layout may be reversed and purchaser agrees to accept the same. Steps and porches may vary at any exterior entrance ways due to grading variations. Actual usable floor space may vary from the stated floor areas. All measurements are a field's estimate. Dimensions, specifications and architectural detailing subject to change without notice. E. & D. E. May 2020