

CONSTRUCTION SUMMARY

Mountainview Heights 3 (G) - Russell Gardens Building Ltd.

PURCHASERS: Suggam KHANNA and Supriyaa KHANNA

TEL:

LOT / PHASE 268 / 3	REG. PLAN # 62M-1266	HOUSE TYPE Mountainash Five (4 Bedroom) Elev 2		
------------------------	-------------------------	---	--	--

CABINETRY

1 - CABINETRY - KITCHEN - CM11 CROWN MOULDING 20Apr21 Note:	
1 - CABINETRY - KITCHEN - LIGHT VALENCE - NO ELECTRICAL 20Apr21 Note:	
1 - CABINETRY - KITCHEN - HARDWARE UPGRADE 2 20Apr21 Note:	
1 - CABINETRY - KITCHEN - UPGRADE 2 20Apr21 Note:	
1 - KITCHEN CABINETRY - DIFFERENT COLOUR ISLAND - FLAT FEE 20Apr21 Note:	
1 - VANITY - POWDER ROOM - HARDWARE UPGRADE 1 20Apr21 Note:	
1 - VANITY - POWDER ROOM - UPGRADE 2 20Apr21 Note:	
1 - VANITY - ENSUITE BATHROOM - UPGRADE 2 20Apr21 Note:	
1 - CABINETRY PROVISION - PROVISION FOR PLUG ON ISLAND (PLUG EXTRA ORDERED SEPARATELY) 20Apr21 Note:	

CABINETRY ACCESSORIES

4 - KITCHEN CABINETRY UPPER – GLASS DOOR FOR MINI UPPER – GROUP 2 GLASS - GLC342 JARROT SANDBLAST - PRICE IS PER DOOR – UPGRADE 2 CABINETRY 10May21 Note:	
4 - KITCHEN CABINETRY UPPER - GLASS DOOR - GROUP 2 GLASS - GLC342 JARROT SANDBLAST - FINISHED INTERIOR - FITS TALL UPPER CABINETS - PRICE IS PER DOOR - UPGRADE 2 10May21 Note:	
1 - KITCHEN CABINETRY UPPER - GLASS DOOR - GROUP 2 GLASS - GLC342 JARROT SANDBLAST - FINISHED INTERIOR - FITS TALL UPPER CABINETS - PRICE IS PER DOOR - UPGRADE 2 CABINETRY 10May21 Note:	
1 - KITCHEN HOOD CABINETS - CONTEMPORARY WOOD HOOD – UPGRADE 2 10May21 Note:	
1 - KITCHEN - ADD BLU MOTION DRAWER TO COFFEE SYSTEM - SEE ELEVATION 10May21 Note:	
1 - KITCHEN CABINETRY UPPER - GLASS DOOR FOR MINI UPPER – GROUP 2 GLASS - GLC342 JARROT SANDBLAST - PRICE IS PER DOOR – UPGRADE 2 CABINETRY 10May21 Note:	
1 - KITCHEN CABINETRY UPPER - GLASS DOOR - GROUP 2 GLASS - GLC342 JARROT SANDBLAST - FINISHED INTERIOR - FITS TALL UPPER CABINETS - PRICE IS PER DOOR - UPGRADE 2 CABINETRY 10May21 Note:	
1 - KITCHEN - REMOVE PANTRY TO ACCOMMODATE FRIDGE 20Apr21 Note:	

CONSTRUCTION SUMMARY				
Mountainview Heights 3 (G) - Russell Gardens Building Ltd.				
PURCHASERS: Suggam KHANNA and Supriyaa KHANNA				TEL:
LOT / PHASE 268 / 3	REG. PLAN # 62M-1266	HOUSE TYPE Mountainash Five (4 Bedroom) Elev 2		
1 - CABINETRY DECORATIVE ITEMS - WINDOW VALANCE - STRAIGHT WITH PROFILE 20Apr21 Note:				
1 - VANITY CABINETRY - RAISE VANITY TO 36" HIGH VANITY IN LIEU OF STANDARD HEIGHT - ENSUITE 4 BATHROOM 20Apr21 Note:				
1 - VANITY CABINETRY - RAISE VANITY TO 36" HIGH VANITY IN LIEU OF STANDARD HEIGHT - ENSIOTE 2 BATHROOM 20Apr21 Note:				
1 - VANITY CABINETRY - RAISE VANITY TO 36" HIGH VANITY IN LIEU OF STANDARD HEIGHT - MASTER ENSUITE BATHROOM 20Apr21 Note:				
1 - VANITY CABINETRY - RAISE VANITY TO 36" HIGH VANITY IN LIEU OF STANDARD HEIGHT - POWDER ROOM 20Apr21 Note:				
1 - KITCHEN - BLU MOTION DRAWERS 20Apr21 Note:				
1 - KITCHEN CABINETRY - FULL DEPTH ABOVE FRIDGE - WITH GABLES - 600MM - PRICE IS EACH - UPGRADE 2 20Apr21 Note:				
1 - KITCHEN CABINETRY - FULL DEPTH ABOVE FRIDGE - WITH GABLES - 600MM - PRICE IS EACH - UPGRADE 2 20Apr21 Note:				
1 - KITCHEN CABINETRY – MINI STACKED UPPER CABINETS – PRICE IS PER FOOT – UPGRADE 2 CABINETRY 20Apr21 Note:				
1 - KITCHEN CABINETRY ACCESSORY - MAGIC CORNER MECHANISM - RECONFIGURE CABINETRY TO ACCOMMODATE - STANDARD 20Apr21 Note:				
1 - KITCHEN CABINETRY BASE - PULLOUT RECYCLE 4 BIN - PRICE IS EACH 20Apr21 Note:				
1 - KITCHEN CABINETRY BASE - POT/PAN DRAWERS (CABINET) - UPGRADE 2 20Apr21 Note:				
1 - KITCHEN - RELOCATE STANDARD BANK OF DRAWERS TO ISLAND 20Apr21 Note:				
2 - KITCHEN CABINETRY BASE - PULLOUT WIRE SPICE RACK - PRICE IS EACH 20Apr21 Note:				
1 - KITCHEN CABINETRY - BUILT-IN FRIDGE CABINET - PRICE IS EACH 20Apr21 Note:				
1 - KITCHEN CABINETRY UPPER - FULL DEPTH ABOVE FRIDGE - WITH GABLES - 600MM - PRICE IS EACH - UPGRADE 2 20Apr21 Note:				
1 - KITCHEN CABINETRY - BUILT-IN COFFEE SYSTEM - INSTALLED AT EYE LEVEL - UPGRADE 2 20Apr21 Note:				
1 - KITCHEN CABINETRY - BUILT-IN COFFEE SYSTEM - INSTALLED AT EYE LEVEL - UPGRADE 2 20Apr21 Note:				

CONSTRUCTION SUMMARY				
Mountainview Heights 3 (G) - Russell Gardens Building Ltd.				
PURCHASERS: Suggam KHANNA and Supriyaa KHANNA				TEL:

LOT / PHASE	REG. PLAN #	HOUSE TYPE		
268 / 3	62M-1266	Mountainash Five (4 Bedroom) Elev 2		
1 - KITCHEN CABINETRY - APPLIANCE DOOR PANELS - FRIDGE DOOR PANELS - SUPPLY ONLY - 42"-48" WIDE FRIDGES - UPGRADE 2 20Apr21 Note:				
1 - KITCHEN - CREATE OPENING IN CABINETRY FOR BEVERAGE FRIDGE BELOW BUILT-IN COFFEE SYSTEM 20Apr21 Note:				
1 - KITCHEN CABINETRY BASE - COOKTOP CABINET WITH POT DRAWERS (2 DRAWERS) - UPGRADE 2 20Apr21 Note:				
1 - CABINETRY FEE FOR FLUSH CUTOUT ON WALL OVEN/MICROWAVE COMBO CABINET ONLY 20Apr21 Note:				
1 - KITCHEN CABINETRY - BUILT-IN MICROWAVE/OVEN COMBO - UPGRADE 2 20Apr21 Note:				
1 - KITCHEN CABINETRY - APPLIANCE DOOR PANELS - 24" DISHWASHER DOOR PANEL (SUPPLY ONLY) - UPGRADE 2 20Apr21 Note:				
1 - CABINETRY - KITCHEN - HARDWARE UPGRADE 2 FOR FIRDGE AND DISHWASHER APPLIANCES PANELS 20Apr21 Note:				

CERAMIC TILE

1 - TILE - UPGRADE 1 WALL TILE - - BATHROOM 3/4 - SHOWER 22Apr21 Note:				
1 - TILE - UPGRADE 1 FLOOR TILE - - BATHROOM 3/4 - FLOOR 22Apr21 Note:				
1 - TILE - UPGRADE 3 WALL TILE - - BATHROOM 2 - SHOWER 20Apr21 Note:				
1 - TILE - UPGRADE 3 FLOOR TILE - - BATHROOM 2 - FLOOR 20Apr21 Note:				
1 - DELETE ALL CERAMIC BATHROOM ACCESSORIES - DELETE TOWEL BAR, PAPER HOLDER & SOAP DISH THROUGHOUT 20Apr21 Note:				
1 - TILE - UPGRADE 4 FLOOR TILE - - POWDER ROOM 20Apr21 Note:				
1 - TILE - UPGRADE 4 FLOOR TILE - - MUD ROOM 20Apr21 Note:				
1 - TILE - UPGRADE 4 FLOOR TILE - - KITCHEN 20Apr21 Note:				
1 - TILE - UPGRADE 4 FLOOR TILE - - FOYER 20Apr21 Note:				
1 - TILE - UPGRADE 3 WALL TILE - - ENSUITE WALL TILE - SHOWER 20Apr21 Note:				
1 - TILE - UPGRADE 3 FLOOR TILE - - ENSUITE BATHROOM - FLOOR 20Apr21 Note:				

<div>CONSTRUCTION SUMMARY</div> <div>Mountainview Heights 3 (G) - Russell Gardens Building Ltd.</div> <div>PURCHASERS: Suggam KHANNA and Supriyaa KHANNA<div>TEL:</div></div>				
---	--	--	--	--

LOT / PHASE	REG. PLAN #	HOUSE TYPE		
268 / 3	62M-1266	Mountainash Five (4 Bedroom) Elev 2		

CONSTRUCTION

<div>1 - KITCHEN – PROVISIONS FOR POT FILLER</div> <div>20Apr21 Note:</div>	
<div>1 - PROVISION FOR SHAMPOO NICHE APPROX. 24” WIDE X 20” HIGH AS PER SKETCH – IF CONSTRUCTION PERMITS - MASTER ENSUITE BATHROOM</div> <div>20Apr21 Note:</div>	
<div>2 - PROVISION FOR SHAMPOO NICHE APPROX. 14” WIDE X 20” HIGH AS PER SKETCH – IF CONSTRUCTION PERMITS - ENSUITE 2 & ENSUITE 3/4 BATHROOMS</div> <div>20Apr21 Note:</div>	
<div>1 - SMOOTH CEILINGS ON FIRST FLOOR ONLY - DET</div> <div>20Apr21 Note:</div>	
<div>1 - SHARED ENSUITE BEDROOM 3/4 - 5 FOOT SHOWER WITH SLIDING GLASS CHROME DOORS IN LIEU OF TUB</div> <div>23Jul20 Note:</div>	
<div>1 - MASTER ENSUITE SHOWER - FRAMELESS GLASS SHOWER DOOR & FRONT WALL AT SEAT INCLUDES CHROME KNOB & HINGES</div> <div>23Jul20 Note: IF CONSTRUCTION PERMITS</div>	

COUNTER TOP

<div>1 - SHAMPOO NICHE 24” WIDE X 20” HIGH AS PER SKETCH – MARBLE, GRANITE OR QUARTZ – IF CONSTRUCTION PERMITS - REQUIRES PROVISION FROM CONSTRUCTION - MASTER ENSUITE BATHROOM</div> <div>20Apr21 Note: SUPPLY & INSTALL</div>	
<div>2 - SHAMPOO NICHE 14” WIDE X 20” HIGH AS PER SKETCH – MARBLE, GRANITE OR QUARTZ – IF CONSTRUCTION PERMITS - REQUIRES PROVISION FROM CONSTRUCTION - ENSUITE 2 & ENSUITE 3/4 BATHROOMS</div> <div>20Apr21 Note: SUPPLY & INSTALL</div>	

DOORS AND TRIM

<div>1 - TRIM - UPGRADE 2- 7-¼” BASEBOARD AND 3” CASING</div> <div>20Apr21 Note:</div>	
---	--

ELECTICAL

<div>1 - PLUG – ROUGH-IN FOR ELECTRIC CAR PLUG IN GARAGE – FOR FUTURE ELECTRIC CAR – 240V / 40-50 AMPS</div> <div>20Apr21 Note: SPECIFICATIONS REQUIRED</div>	
--	--

ELECTRICAL

<div>1 - POT LIGHT - EXTERIOR - SOFFIT MOUNT - REGULAR VOLTAGE - REAR ELEVATION ON SEPERATE SWITCH</div> <div>10May21 Note:</div>	
<div>3 - POT LIGHT - EXTERIOR - SOFFIT MOUNT - REGULAR VOLTAGE - FRONT ELEVATION ON ONE SWITCH SEPERATE FROM STANDARD LIGHTS</div> <div>10May21 Note:</div>	
<div>1 - PLUG - ELECTRICAL PLUG - FOR BUILT-IN COFFEE SYSTEM</div> <div>20Apr21 Note:</div>	
<div>1 - PLUG - ELECTRICAL PLUG - FOR BEVERAGE FRIDGE</div> <div>20Apr21 Note:</div>	
<div>1 - BUILT IN OVEN AND COOKTOP PROVISION - PROVISION ONLY - ELECTRICAL ONLY</div> <div>20Apr21 Note:</div>	

CONSTRUCTION SUMMARY				
Mountainview Heights 3 (G) - Russell Gardens Building Ltd.				
PURCHASERS: Suggam KHANNA and Supriyaa KHANNA				TEL:
LOT / PHASE 268 / 3	REG. PLAN # 62M-1266	HOUSE TYPE Mountainash Five (4 Bedroom) Elev 2		
3 - FAN - BATHROOM EXHAUST FAN - ENERGY STAR 80 CFM - IN LIEU OF STANDARD FAN - ALL ENSUITE BATHROOMS 20Apr21 Note:				
1 - PLUG - ELECTRICAL PLUG - INSTALLED 5' FROM FLOOR - FLEX ROOM 20Apr21 Note:				
1 - PLUG - ELECTRICAL PLUG WITH GFI AND SWITCH - FOR FESTIVE LIGHTING 20Apr21 Note:				
1 - PLUG - ELECTRICAL PLUG - TO BE INSTALLED OVER FIREPLACE 20Apr21 Note:				
1 - PLUG - ELECTRICAL PLUG - ADD TO ISLAND 20Apr21 Note:				
1 - POT LIGHT - LED - FIRST FLOOR INSTALLATION - INSTALLED ON SEPERATE SWITCH FROM STANDARD LIGHT - KITCHEN WORKSPACE 20Apr21 Note:				
1 - POT LIGHT - LED - FIRST FLOOR INSTALLATION - INSTALLED ON SEPERATE SWITCH FROM STANDARD LIGHT - KITCHEN BREAKFAST 20Apr21 Note:				
1 - POT LIGHT - LED - FIRST FLOOR INSTALLATION - INSTALLED ON SEPERATE SWITCH FROM STANDARD LIGHT - FAMILY ROOM 20Apr21 Note:				
1 - POT LIGHT - LED - FIRST FLOOR INSTALLATION - INSTALLED ON SEPERATE SWITCH FROM STANDARD LIGHT - DINING ROOM 20Apr21 Note:				
1 - POT LIGHT - LED - FIRST FLOOR INSTALLATION - INSTALLED ON SEPERATE SWITCH FROM STANDARD LIGHT - LIVING ROOM 20Apr21 Note:				
1 - RELOCATE STANDARD KITCHEN LIGHT TO BE CENTERED OVER ISLAND 20Apr21 Note:				
1 - LIGHT AND SWITCH - NO FIXTURE INCLUDED - LIVING ROOM 20Apr21 Note:				

FIREPLACE AND ACCESSORIES

1 - MANTEL - PAINTED - M6 - IN LIEU OF STANDARD MANTEL 20Apr21 Note:	
1 - GAS LINE ROUGH-IN FOR STOVE (INCLUDES ELECTRICAL OUTLET) - FIRST FLOOR 20Apr21 Note:	

HARDWOOD FLOORING

1 - HARDWOOD - GROUP B SERIES 5 INCH - IN LIEU OF 2 1/4 INCH NATURAL RED OAK - - MAIN HALL 20Apr21 Note:	
1 - HARDWOOD - GROUP B SERIES 5 INCH - IN LIEU OF 2 1/4 INCH NATURAL RED OAK - - LIVING AND DINING ROOM 20Apr21 Note:	

CONSTRUCTION SUMMARY				
Mountainview Heights 3 (G) - Russell Gardens Building Ltd.				
PURCHASERS: Suggam KHANNA and Supriyaa KHANNA				TEL:
LOT / PHASE	REG. PLAN #	HOUSE TYPE		
268 / 3	62M-1266	Mountainash Five (4 Bedroom) Elev 2		
1 - HARDWOOD - GROUP B SERIES 5 INCH - IN LIEU OF 2 1/4 INCH NATURAL RED OAK - - LIBRARY/DEN				
20Apr21 Note:				
1 - HARDWOOD - GROUP B SERIES 5 INCH - IN LIEU OF 2 1/4 INCH NATURAL RED OAK - - FAMILY ROOM				
20Apr21 Note:				

MIRRORS AND GLASS

1 - SHOWER DOOR HANDLE - CHROME D-RING WITH TOWEL BAR - MASTER ENSUITE BATHROOM	
20Apr21 Note:	

MISCELLANEOUS

1 - NO FURTHER CHANGES PERMITTED	
22Apr21 Note:	

PLUMBING

1 - KITCHEN – POT FILLER – MOEN MODERN TWO HANDLE POT FILLER FAUCET WITH DUAL SHUT OFFS – #S665BL - MATTE BLACK	
10May21 Note:	
1 - *** DELETE - KITCHEN – POT FILLER – MOEN MODERN TWO HANDLE POT FILLER FAUCET WITH DUAL SHUT OFFS – #S665SRS - STAINLESS	
10May21 Note:	
1 - KITCHEN - RELOCATE BAR SINK TO ACCOMMODATE BUILT-IN APPLIANCES	
20Apr21 Note:	
1 - KITCHEN – POT FILLER – MOEN MODERN TWO HANDLE POT FILLER FAUCET WITH DUAL SHUT OFFS – #S665SRS - STAINLESS	
20Apr21 Note:	
2 - ENSUITE 3/4 BATHROOM - CHROME GRAB BAR	
20Apr21 Note:	
2 - HOT WATER VALVE NEXT TO TOILET - MASTER ENSUITE BATHROOM & ENSUITE 3/4 BATHROOM	
20Apr21 Note:	
1 - WATER LINE FOR FRIDGE - ROUGH-IN ONLY	
20Apr21 Note:	
3 - TOE TESTER - ADD TOE TESTER TO SHOWER - ALL SHOWERS	
23Jul20 Note:	

PROMOTIONAL

1 - LESS BALANCE OF CREDIT FROM PURCHASER EXTRA SHEET IN OFFER	
20Apr21 Note:	
1 - PARTIAL REDEMPTION OF PROMOTIONAL PACKAGE \$4,950.00 BALANCE (\$12,050.00) FORWARD TO BE USED AT A LATER DATE. ORIGINAL PROMOTIONAL PACKAGE OF \$17,000.00 AS PER SCHEDULE PE DATED 07/06/2020.	
23Jul20 Note:	

STAIRS AND RAILINGS

1 - STAIRCASE - 4 X 4 POSTS	
20Apr21 Note:	

CONSTRUCTION SUMMARY				
Mountainview Heights 3 (G) - Russell Gardens Building Ltd.				
PURCHASERS: Suggam KHANNA and Supriyaa KHANNA				TEL:
LOT / PHASE 268 / 3	REG. PLAN # 62M-1266	HOUSE TYPE Mountainash Five (4 Bedroom) Elev 2		
1 - STAIRCASE - V GROOVE HANDRAIL 20Apr21 Note:				
1 - STAINED STAIRS – STANDARD STAIRCASE - PRICE IS PER SET 20Apr21 Note:				
1 - STAIRCASE - EUROLINE 2 IRON PICKETS - BLACK 20Apr21 Note:				

EXTRAS AS PER OFFER

lower level pour 8 foot 6 Worksheet Note:	
200 AMPS Worksheet Note:	
3 Larger basement windows - subject to Engineering Approval Worksheet Note:	
The Vendor agrees that notwithstanding any other term or provision in this Agreement included in the Purchase Price and in addition to those items detailed in Schedule GP to the Agreement of Purchase and Sale, the Purchaser is entitled to a credit of Sev Worksheet Note:	
MAIN FLOOR 10 FOOT CEILING Worksheet Note:	

This Document is Extremely Time Sensitive - Printed 10 May 21 at 15:29

Purchasers:

Suggam KHANNA & Supriyaa KHANNA

Property: 268

Telephone Res. / Bus:

/

Project: Russell Gardens Building Ltd.

Decor Advisor:

Candace Forza

Model and Elevation: Mountainash Five (4 Bedroom) Elev 2

Lock Date:

10-May-21

20-Apr-21

Plan #: 62M-1266

Layout Changes:

☒ Yes ☐ No

Sketch Attached:

☒ Yes ☐ No

Exterior Colour Scheme:

1. Cabinetry

	Style and Colour	Hardware
Kitchen / Breakfast	PERIMETER-SONATA SATIN SNOW***ISLAND-SONATA FOSSIL	See Below
Laundry Room	ELISSE	Standard
Powder Room	HAMPTON 350 PLATINUM SILVER	451SB
Master Ensuite Bathroom	ARUBA 614 CRISP WHITE	431SA
Ensuite Bath - Bedroom 2	MONACO 350 PLATINUM SILVER	431SA
Ensuite Bath - Bedroom 3/4	DORAL K44 TITAN GREY	431SA
	N/A	N/A
	N/A	N/A
	N/A	N/A

Appliances:

Built In Appliances ☒ Yes ☐ No

Slide In Stove ☐ Yes ☒ No

Dishwasher Cabinet

☐ Closed ☒ Open

41" Upper Cabinets ☒ Yes ☐ No

Please NOTE: Standard Cabinet Height is 30"

Stove Opening

30" Cooktop

NOTE: If not specified, opening will be set to builder's standard opening of approximately 30" width

Fridge Opening

42"

NOTE: If not specified, opening will be set to builder's standard opening of approximately 37" width x 74" height

KITCHEN - 953SC WITH MATCHING APPLIANCE PULLS

** Refer to Construction Summary

2. Counters

	Counter	Edge
Kitchen / Breakfast	LAMINATE-WHITE CARRARA 4924-38	
Laundry Room	N/A	
Powder Room	LAMINATE-WHITE CARRARA 4924-38	
Master Ensuite Bathroom	LAMINATE-PALOMA BISQUE 6729-46	
Ensuite Bath - Bedroom 2	LAMINATE-PALOMA BISQUE 6729-46	
Ensuite Bath - Bedroom 3/4	LAMINATE-PALOMA BISQUE 6729-46	
	N/A	
	N/A	
	N/A	

** Refer to Construction Summary

3. Ceramic Flooring

At a 45 Threshold-If App.

Entrance Vestibule	TILE-CALACATTA POLISHED (CA6083P)-24X24	<input type="checkbox"/>	metal strip where applicable
Main Hall	STRIP	<input type="checkbox"/>	
Kitchen / Breakfast	TILE-CALACATTA POLISHED (CA6083P)-24X24	<input type="checkbox"/>	
Laundry Room	TILE-RAINBOW LIGHT GREY-13X13	<input type="checkbox"/>	
Powder Room	TILE-CALACATTA POLISHED (CA6083P)-24X24	<input type="checkbox"/>	
Master Ensuite Bathroom	TILE-LITIUM PEARL POLISHED-24X24	<input type="checkbox"/>	
Ensuite Bath - Bedroom 2	TILE-VARENNA CARRARA-24X24	<input type="checkbox"/>	
Ensuite Bath - Bedroom 3/4	TILE-MARMORE CARRARA-12X24	<input type="checkbox"/>	
MUD ROOM	TILE-CALACATTA POLISHED (CA6083P)-24X24	<input type="checkbox"/>	
	N/A	<input type="checkbox"/>	
	N/A	<input type="checkbox"/>	

** Refer to Construction Summary

4. Ceramic Wall Tile

Master Ensuite Bathroom	Selection	Describe
Tub Deck Wall	N/A	
Tub Deck	N/A	
Tub Deck Skirt	N/A	
Shower Stall	TILE-LITIUM PEARL POLISHED-12X24	NICHE-QUARTZ-GREYCALE
Bathtub Enclosure Walls	N/A	
Ensuite Bath - Bedroom 2	TILE-VARENNA CARRARA-12X24	NICHE-QUARTZ-ISTRIA
Ensuite Bath - Bedroom 3/4	TILE-MARMORE CARRARA-12X24	NICHE-QUARTZ-ISTRIA
MUD ROOM	N/A	
	N/A	
	N/A	
Kitchen Backsplash	QUARTZ-MISTRAL	FULL HEIGHT

** Refer to Construction Summary - STANDARD GROUT THROUGHOUT UNLESS SPECIFIED

5. Plumbing Fixtures

All Bathrooms

White

N/A

N/A

N/A

N/A

N/A

Whirlpool

N/A ☐ Yes ☒ No

Dishwasher Rough-In ☒ Yes ☐ No

Waterline for Fridge ☒ Yes ☐ No

** Refer to Construction Summary

6. Trim Carpentry

Interior Doors	CARRARA-SMOOTH
Interior Trim	3" BB CASING WITH 7 1/4" BASEBOARD - COLONIAL
Door Handles	As Per Construction Specifications
Exterior Front Door Handle	As Per Construction Specifications

** Refer to Construction Summary

Purchasers:

Suggam KHANNA & Supriyaa KHANNA

Telephone Res. / Bus:

/

Decor Advisor:

Candace Forza

Lock Date:

22-Apr-21

Property: 268

Project: Russell Gardens Building Ltd.

Model and Elevation: Mountainash Five (4 Bedroom) Elev 2

Plan #: 62M-1266

7. Other Flooring		
Main Hall	STRIP-MIRAGE-TRUBALANCE-IMAGINE-CHARACTER-RED OAK-DURAMATT-DRIFTWOOD-5"	
Living Room	STRIP-MIRAGE-TRUBALANCE-IMAGINE-CHARACTER-RED OAK-DURAMATT-DRIFTWOOD-5"	
Dining Room	STRIP-MIRAGE-TRUBALANCE-IMAGINE-CHARACTER-RED OAK-DURAMATT-DRIFTWOOD-5"	
Family Room	STRIP-MIRAGE-TRUBALANCE-IMAGINE-CHARACTER-RED OAK-DURAMATT-DRIFTWOOD-5"	
Den / Library / Study	N/A	
Basement Landing(If Applies)	N/A	
Lower Landing (If Applies)	STRIP-MIRAGE-TRUBALANCE-IMAGINE-CHARACTER-RED OAK-DURAMATT-DRIFTWOOD-5"	
Upper Landing	STRIP-MIRAGE-TRUBALANCE-IMAGINE-CHARACTER-RED OAK-DURAMATT-DRIFTWOOD-5"	
Upper Hall	LAMINATE-LEXINGTON-ROCHEFORT OAK-TL-LW1317	
Master Bedroom	LAMINATE-LEXINGTON-ROCHEFORT OAK-TL-LW1317	
Bedroom #2	LAMINATE-LEXINGTON-ROCHEFORT OAK-TL-LW1317	
Bedroom #3	LAMINATE-LEXINGTON-ROCHEFORT OAK-TL-LW1317	
Bedroom #4	LAMINATE-LEXINGTON-ROCHEFORT OAK-TL-LW1317	
Bedroom #5	N/A	
	N/A	
	N/A	
	N/A	
Underpad	Type	Area
	N/A	N/A

** Refer to Construction Summary

8. Railings and Pickets			
Railing Type	V-GROOVE & 4X4 POSTS	Colour	MIRAGE DRIFTWOOD
Picket Type	EUROLINE 2	Colour	BLACK
Stringer / Riser	AS PER CONSTRUCTION SPECIFICATIO	Colour	MIRAGE DRIFTWOOD
Treads	AS PER CONSTRUCTION SPECIFICATIO	Colour	MIRAGE DRIFTWOOD
Red Oak Stairs with Semi Gloss Finish		<input checked="" type="radio"/> Yes <input type="radio"/> No	

** Refer to Construction Summary THE STAIN COLOURS OR FINISH AVAILABLE ON RISERS, TREADS, PICKETS AND RAILS (STAIRCASES), WILL NOT BE AN EXACT MATCH TO PREFINISHED HARDWOOD OR LAMINATE FLOORS.

9. Wall Paint Flat Finish			
Main & Upper Hall	22 WARM GREY	Master Bedroom	22 WARM GREY
Living Room	22 WARM GREY	Bedroom #2	22 WARM GREY
Dining Room	22 WARM GREY	Bedroom #3	22 WARM GREY
Kitchen / Breakfast	22 WARM GREY	Bedroom #4	22 WARM GREY
Family Room	22 WARM GREY	Bedroom #5	N/A
Powder Room	22 WARM GREY	Master Ensuite	22 WARM GREY
Laundry Room	22 WARM GREY	Ensuite Bath - Bedroom 2	22 WARM GREY
Den/Library	22 WARM GREY	Ensuite Bath - Bedroom 3/4	22 WARM GREY
Trim Paint-Semi Gloss	BIRCH WHITE	Mud Room	22 WARM GREY
	N/A		N/A
	N/A		N/A

Smooth Ceilings First Floor ☒ Yes ☐ No

** Refer to Construction Summary

Purchasers:

Telephone Res. / Bus:

Decor Advisor:

Lock Date:

Suggam KHANNA & Supriyaa KHANNA

/

Candace Forza

22-Apr-21

Property: 268

Project: Russell Gardens Building Ltd.

Model and Elevation: Mountainash Five (4 Bedroom) Elev 2

Plan #: 62M-1266

20-Apr-21

10. Plaster Mouldings and Medallions

Entrance Vestibule	N/A	N/A	Kitchen/Breakfast	N/A	N/A
Main Hall	N/A	N/A	Den/Library	N/A	N/A
Living Room	N/A	N/A	Lower Landing	N/A	N/A
Dining Room	N/A	N/A		N/A	N/A
Family Room	N/A	N/A			

** Refer to Construction Summary

11. Fireplace

	Living Room			Family Room			Other Room - Specify		
	Purchased	As Per Plan	N/A	Purchased	As Per Plan	N/A	Purchased	As Per Plan	N/A
	<input type="radio"/>	<input type="radio"/>	<input checked="" type="radio"/>	<input type="radio"/>	<input type="radio"/>	<input type="radio"/>	<input type="radio"/>	<input type="radio"/>	<input checked="" type="radio"/>
Fireplace Type	N/A			FLAT ON WALL			N/A		
Mantle Type	N/A			MANTLE M6			N/A		
Colour / Stain	N/A			AS PER CONSTRUCTION SPECIFICATIONS			N/A		
Surround	N/A			NERO			N/A		
Hearth	N/A			NO			N/A		

** Refer to Construction Summary

12. Heating and Air Conditioning

Air Conditioning	NO	Gas Provisions Stove	YES
Gas Provisions Dryer	NO	Gas Provisions Barbecue	NO
Comment			

** Refer to Construction Summary

13. Electrical

Plugs and Switches	<input checked="" type="radio"/> White	DECOR	Above Kitchen Cabinet Light	<input type="radio"/> Yes	<input checked="" type="radio"/> No
Hood Fan	STANDARD WHITE TEMP.		Below Kitchen Cabinet Light	<input type="radio"/> Yes	<input checked="" type="radio"/> No
Appliances	Built in Cooktop	Built in Oven	Gas Stove	Microwave	
	<input checked="" type="radio"/> Yes <input type="radio"/> No	<input checked="" type="radio"/> Yes <input type="radio"/> No	<input checked="" type="radio"/> Yes <input type="radio"/> No	<input checked="" type="radio"/> Yes <input type="radio"/> No	
Dishwasher Rough-in	Yes				

** Refer to Construction Summary

14. General Comments

** Refer to Construction Summary

Disclaimers and Notes

- 1) Colours of all materials are as close as possible to builder's selection, but not necessarily identical due to variances in manufacturing.
- 2) Any extras listed above are null and void unless accompanied by a separate invoice/amendment. Said invoice must be paid in full.
- 3) The Purchaser agrees that this colour selection is final and that no changes will be permitted, unless required by the Vendor.
- 4) The Purchaser acknowledges reading and accepting document which contains other miscellaneous disclaimers.

Signature:_____

Date:_____

Signature:_____

Date:_____

FILE NAME:
RUSSELL GARDENS LOT 268

RUSSELL GARDENS LOT 268
PROTOTYPE FOR EXTRAS

MAY 4 21 FB
THIS LAYOUT CONTAINS EXTRAS
THAT ARE NOT PART OF CONTRACT

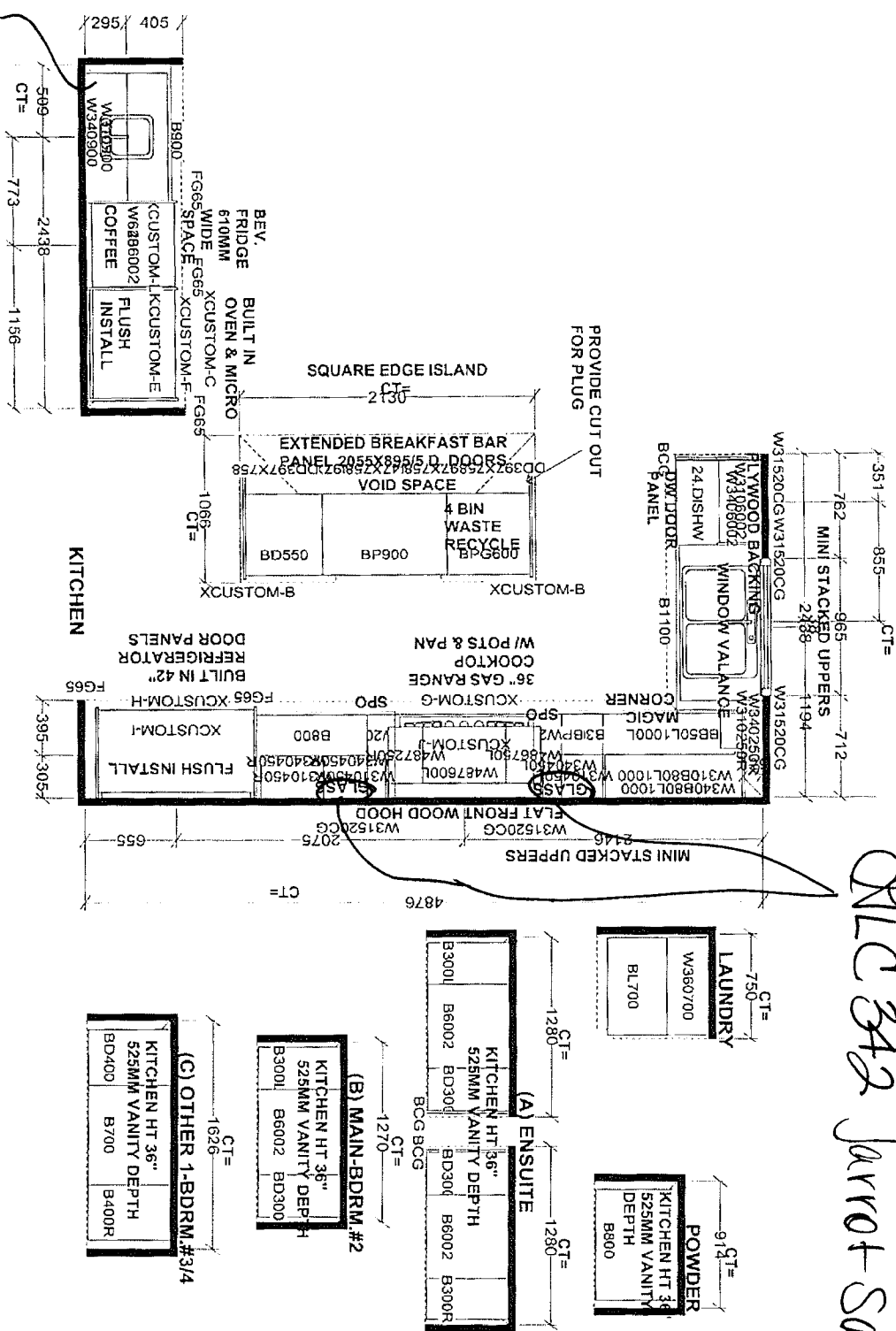

ALC 342 Jarro+ Sandblast

ALC 342
Jarro+ Sandblast

Selba Industries

Job Number: J #

Builder: GREENPARK

Site: RUSSELL GARDENS PH.3

Model: MOUNTAINASH SX FL 1,2,3

Lot #: 268

ST. CENT 2x4 VENT BOX COVER

GLASS UPERS - MLC 342 Jarot Sandblast.
 WOOD STRUCTURES
 FLAT FRONT. wood head

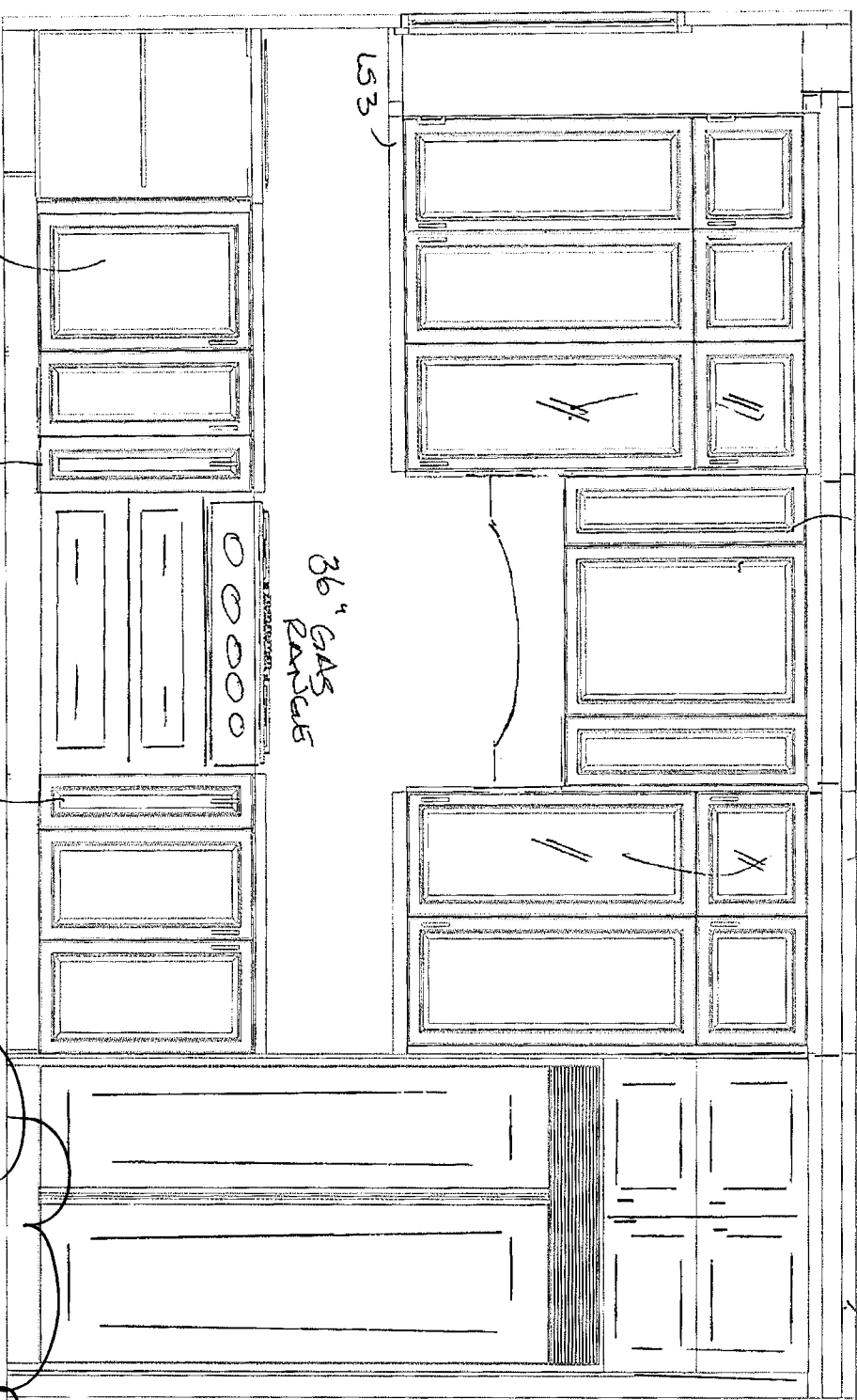

153

36" GLASS
 PANELS

LA
 MAJORS

SPACE PULL
 OUT & 2

42" BUILT IN
 REFRIGERATOR
 DOOR PANELS

This drawing is the intellectual property of
 SELBA INDUSTRIES INC. and is an
 artistic
 interpretation of the general
 appearance of the design. It is
 not meant to be an exact rendition.

Designed: 4/30/2021
 Printed: 5/3/2021

RUSSELLGARDENS LOT 268 PH3

LAYOUT

Drawing #: 1

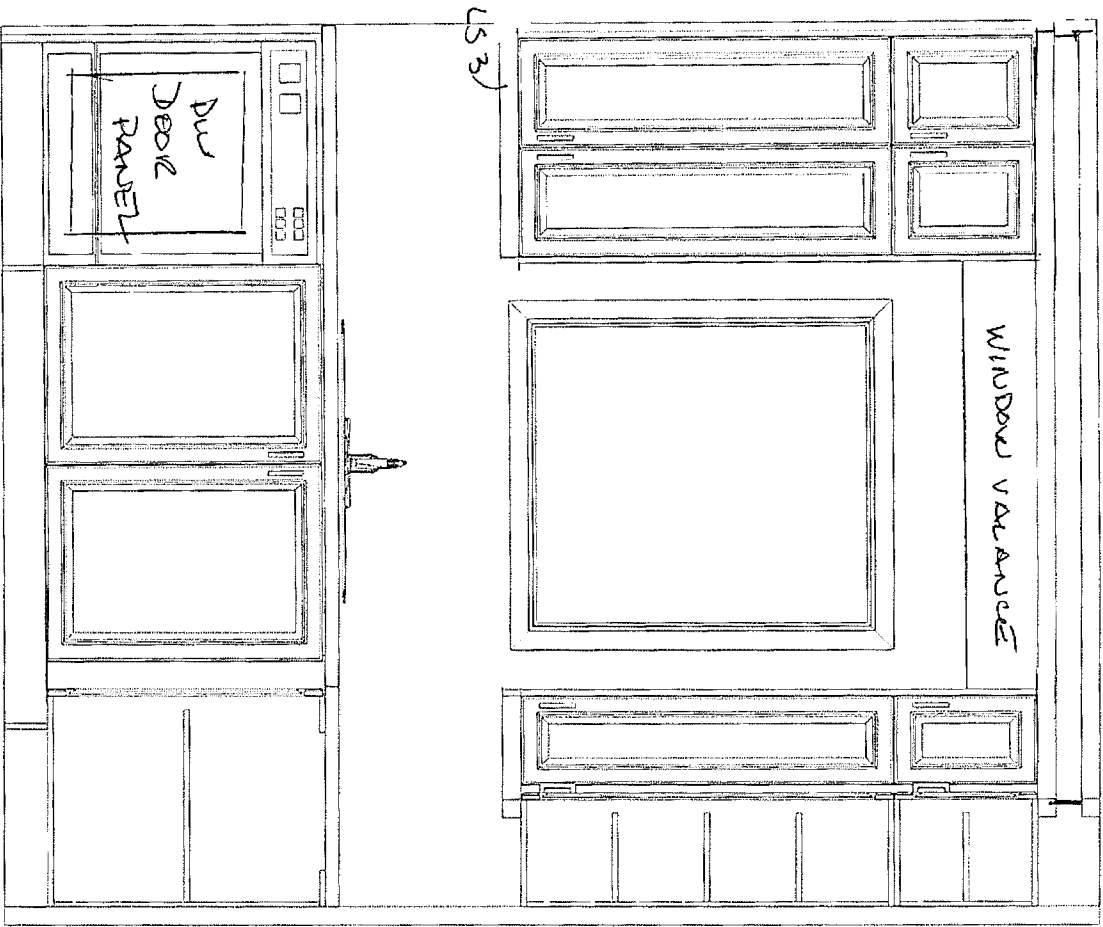

This drawing is the intellectual property of
SELBA INDUSTRIES INC. and is an
artistic
interpretation of the general
appearance of the design. It is
not meant to be an exact rendition.

RUSSELLGARDENS LOT 268 PH3



Designed: 4/30/2021
Printed: 5/3/2021

LAYOUT

Drawing #: 1

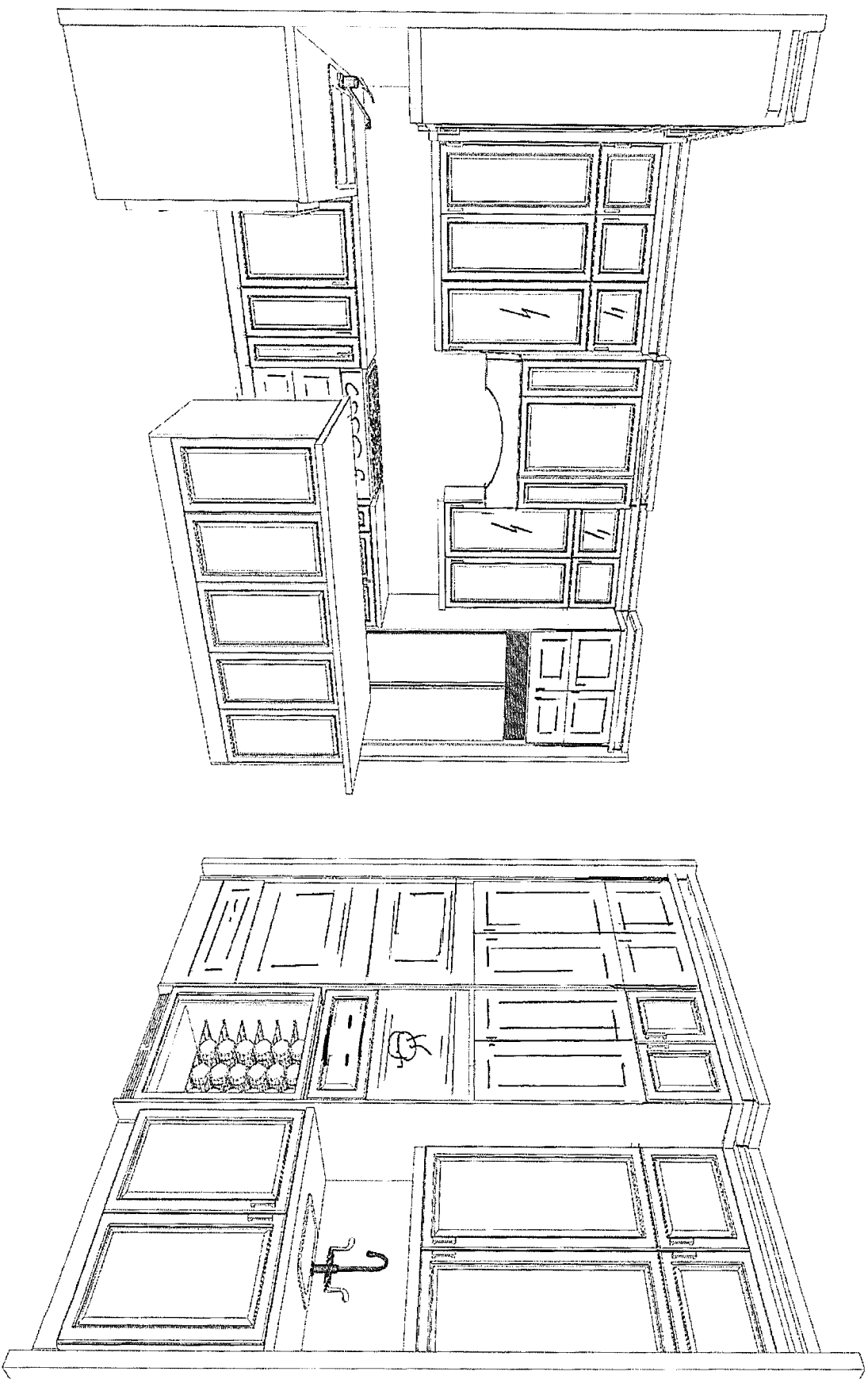

This drawing is the intellectual property of
SELBA INDUSTRIES INC. and is an
artistic
interpretation of the general
appearance of the design. It is
not meant to be an exact rendition.



Designed: 4/30/2021
Printed: 5/3/2021

RUSSELLGARDENS LOT 268 PH3

LAYOUT

Drawing #: 1

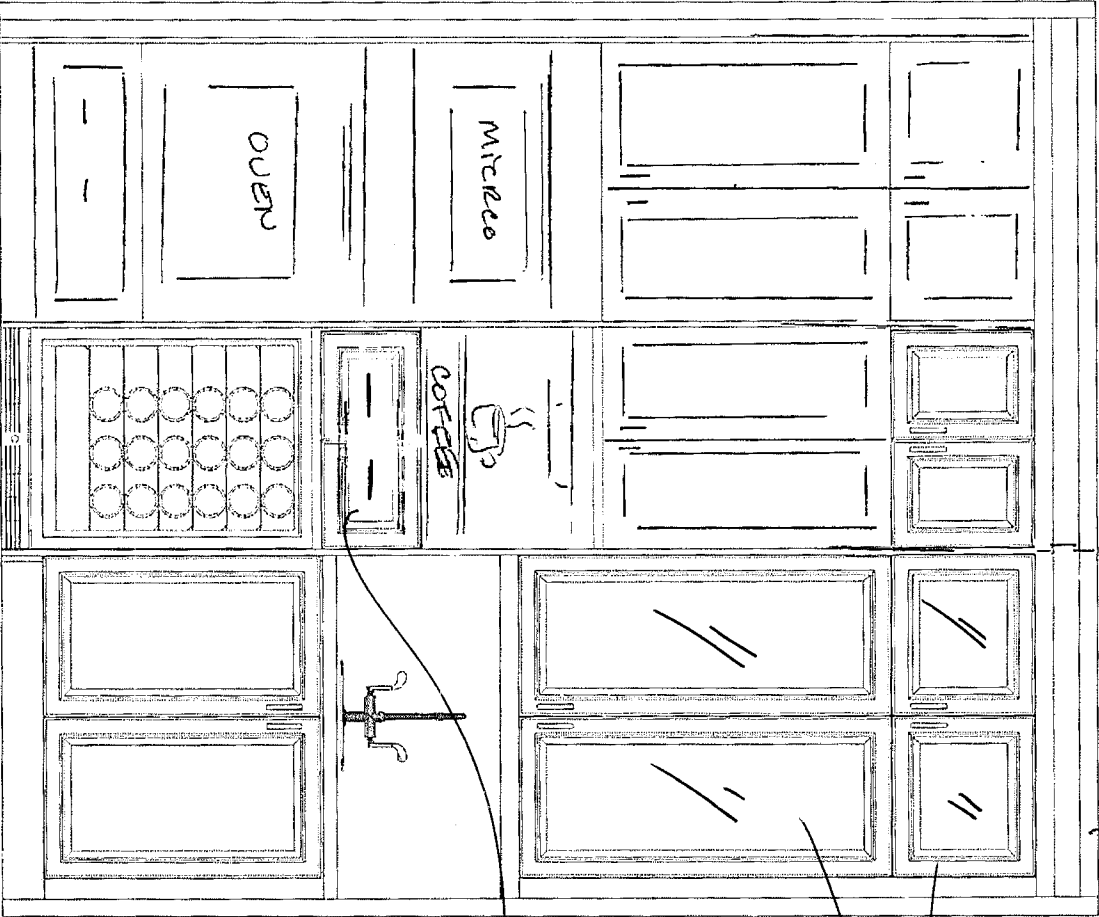

CHILL

QALC 342
Jarrot Sandblast
QMass

Blue motion
Drawer

FLUSH
INSTALL

24" BAR REF

This drawing is the intellectual property of
SELBA INDUSTRIES INC. and is an
artistic
interpretation of the general
appearance of the design. It is
not meant to be an exact rendition.

20
TECHNOLOGIES

Designed: 4/30/2021
Printed: 5/3/2021

RUSSELLGARDENS LOT 268 PH3

LAYOUT

Drawing #: 1

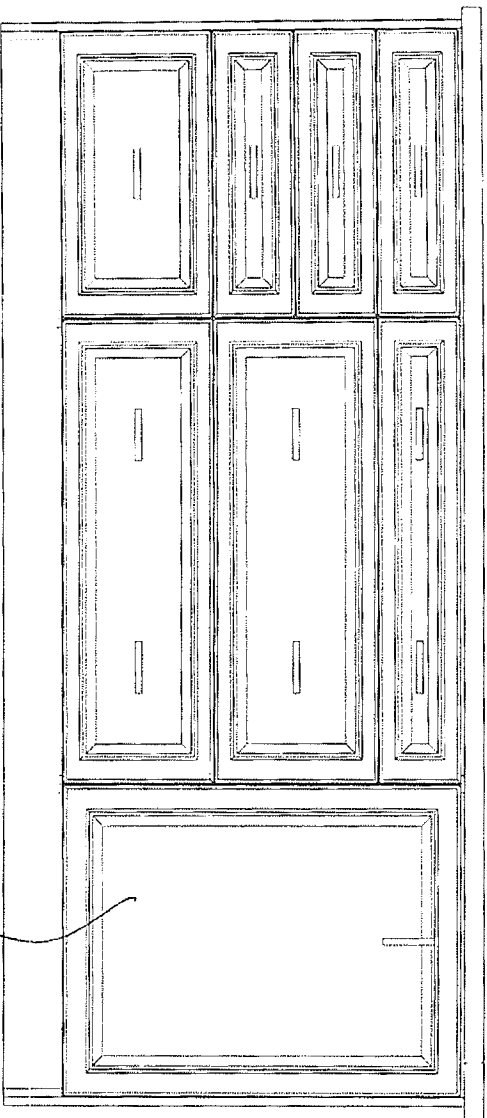

1 STAND

4 BIN

WASTE RECYCLE

This drawing is the intellectual property of
SELBA INDUSTRIES INC. and is an
artistic
interpretation of the general
appearance of the design. It is
not meant to be an exact rendition.



Designed: 4/30/2021
Printed: 5/3/2021

RUSSELLGARDENS LOT 268 PH3

LAYOUT

Drawing #: 1

Ada Plug
Above
Fireplace

1 Potlight

1. Intelligent

1 Potignt

1st light

1 Potlight

~~Ad~~
Flug
On Island

- Large Basement Windows.

Relocate
Bar Sink

Relocate
Sta. Light

above
Island

Electrical
for Mr
Migro
plus

Boys' Bridge

Electrical
for Car
Charger

Built-in Fee System

Festival Plug

- Fotlignt

- * 10' ceiling
- * Smooth Dr

200 AMP

Shove

-Xaa Plug
5' from
floor

— Frameless
Shower Door + Front
Wall at Seat.

1 Pear
Exterior Tight
Separate SM. Hdr.

3 Front
Exterior
Fog lights
On / Switch

Potlight

The figure consists of 15 small, vertically stacked diagrams showing the progression of a cell through mitosis. The stages are as follows: 1. A cell with a central nucleus. 2. Chromosomes beginning to condense within the nucleus. 3. Chromosomes more condensed. 4. Chromosomes further condensed. 5. Chromosomes highly condensed. 6. Spindle fibers beginning to form. 7. Spindle fibers more developed. 8. Spindle fibers further developed. 9. Spindle fibers highly developed. 10. Chromosomes aligned at the equator. 11. Chromosomes aligned at the equator. 12. Chromosomes aligned at the equator. 13. Chromosomes aligned at the equator. 14. Chromosomes aligned at the equator. 15. Two daughter cells formed, each with its own nucleus.

Lot 268 Russell Gardens 11

ELEV. 1 • 3,288 sq.ft. | ELEV. 2 • 3,291 sq.ft. | ELEV. 3 • 3,298 sq.ft.

42" CLASSIC FRENCH DOOR REFRIGERATOR/FREEZER WITH INTERNAL DISPENSER -
PANEL READY

SUB-ZERO

PRODUCT SPECIFICATIONS

Model	BI-42UFDID/O
Dimensions	42"W x 84"H x 24"D
Door Clearance	22 1/4"
Drawer Clearance	23 5/8"
Refrigerator Capacity	17.9 cu. ft.
Freezer Capacity	6.3 cu. ft.
Electrical Supply	115 VAC, 60 Hz
Electrical Service	15 amp dedicated circuit
Plumbing Supply	1/4" OD copper, braided stainless steel or PEX tubing
Plumbing Pressure	35–120 psi
Receptacle	3-prong grounding-type

ELECTRICAL

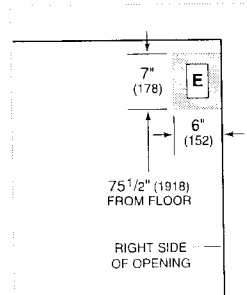

PLUMBING

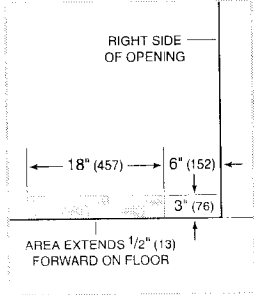

PANEL SPECIFICATIONS For complete panels specifications including width/height, weight requirements, thickness requirements and offset details visit subzero-wolf.com/builtinconfigurator.

NOTE: Dimensions in parenthesis are in millimeters unless otherwise specified

INTERIOR VIEW

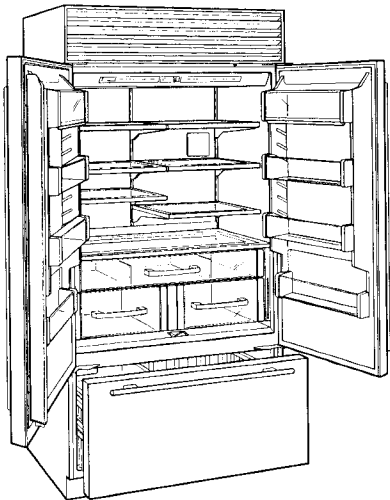

This illustration is intended for interior reference only and may not represent the exterior of the model being specified.

DIMENSIONS

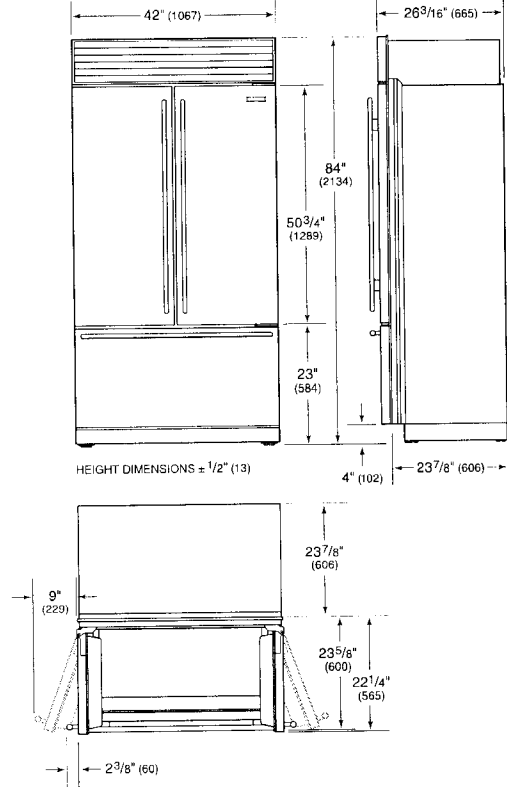

FLUSH INSET INSTALLATION

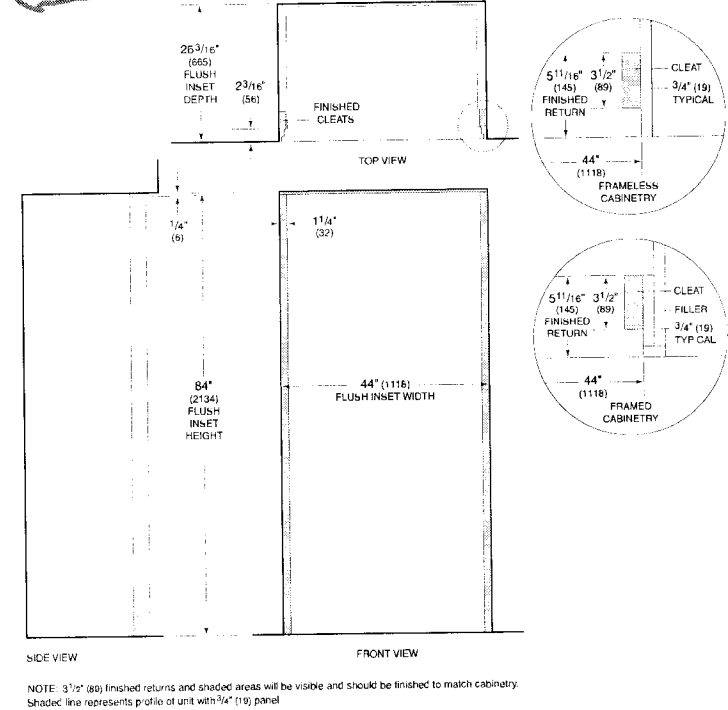

NOTE: 3 1/2" (89) finished returns and shaded areas will be visible and should be finished to match cabinetry. Shaded line represents profile of unit with 3/4" (19) panel

36" SEALED BURNER RANGETOP - 4 BURNERS AND INFRARED GRIDDLE

WOLF

SRT364G



FEATURES

Maintain control with four dual-stacked burners that go from 20,000 Btu down to a mere breath of flame

Simmer and melt sauces, soups, and marinades easily with the lower tier of the dual-stacked burner

Match other Sub-Zero, Wolf, and Cove products with heavy-gauge stainless steel and signature red infinite control knobs

Sear in seconds with the additional 15,000 Btu infrared griddle

Cleanup is a snap as sealed, seamless burner pans contain splashes and spills

Move pots and pans effortlessly across the continuous cast-iron grates

Reignites flame automatically with spark ignition system

ACCESSORIES

- 11" Cutting Board
- 2-Burner Wok Grate
- Black Knobs
- Filler Trim
- Griddle Cleaning Kit
- Griddle Cleaning Pads
- Griddle Cleaning Solution
- Red Knobs
- S-Grates
- Stainless Steel Knobs
- Stainless steel, brass or chrome bezels
- High altitude conversion kits available
- 5" and 10" stainless steel risers, and 20" riser with shelf

Accessories available through an authorized dealer.
For local dealer information, visit subzero-wolf.com/locator.

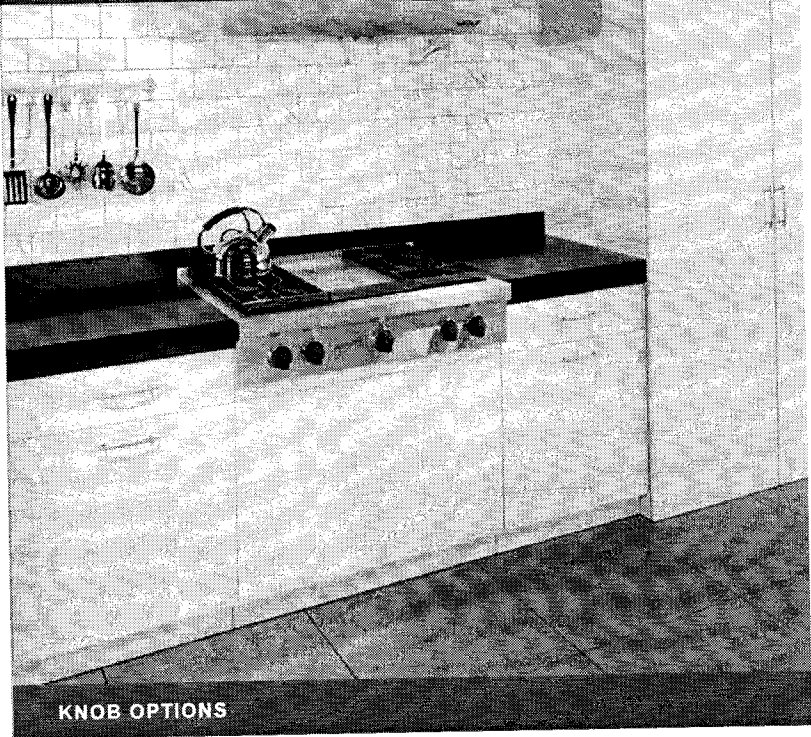

KNOB OPTIONS



TOP CONFIGURATION

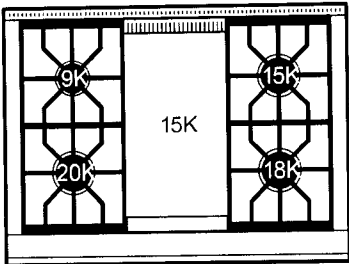

RANGETOP SPECIFICATIONS

- Stainless-steel island trim (included)
- Stainless-steel bezels
- 1 - 9,200 Btu burner
- 1 - 15,000 Btu burner
- 1 - 18,000 Btu burner
- 1 - 20,000 Btu burner
- 1- Infrared 15,000 Btu (13,000 Btu LP) griddle

Specifications are subject to change without notice. This information was generated on March 11, 2021. Verify specifications prior to finalizing your cabinetry/enclosures.

36" SEALED BURNER RANGETOP - 4 BURNERS AND INFRARED GRIDDLE



PRODUCT SPECIFICATIONS

Model	SRT364G
Dimensions	35 7/8"W x 8 1/2"H x 28 1/2"D
Electrical Supply	120 VAC, 60 Hz
Electrical Service	15 amp dedicated circuit
Gas Supply	3/4" ID line
Gas Inlet	1/2" NPT female
Receptacle	3-prong grounding-type

ELECTRICAL

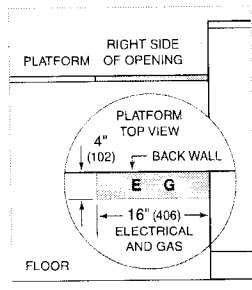

GAS

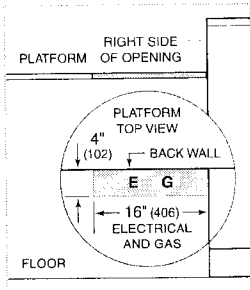

NOTE: Dimensions in parenthesis are in millimeters unless otherwise specified

DIMENSIONS

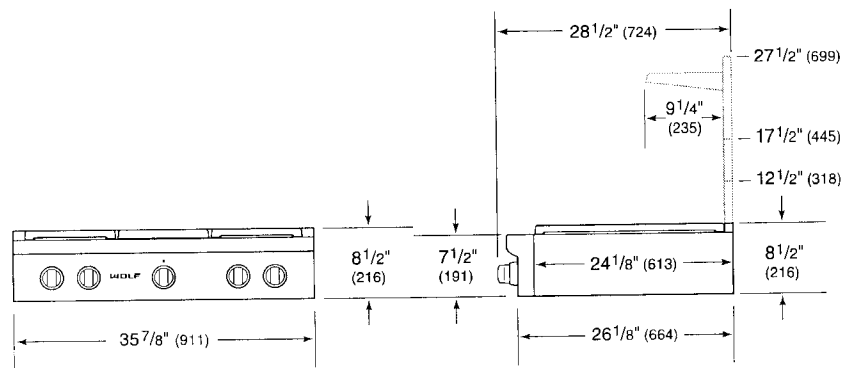

STANDARD INSTALLATION

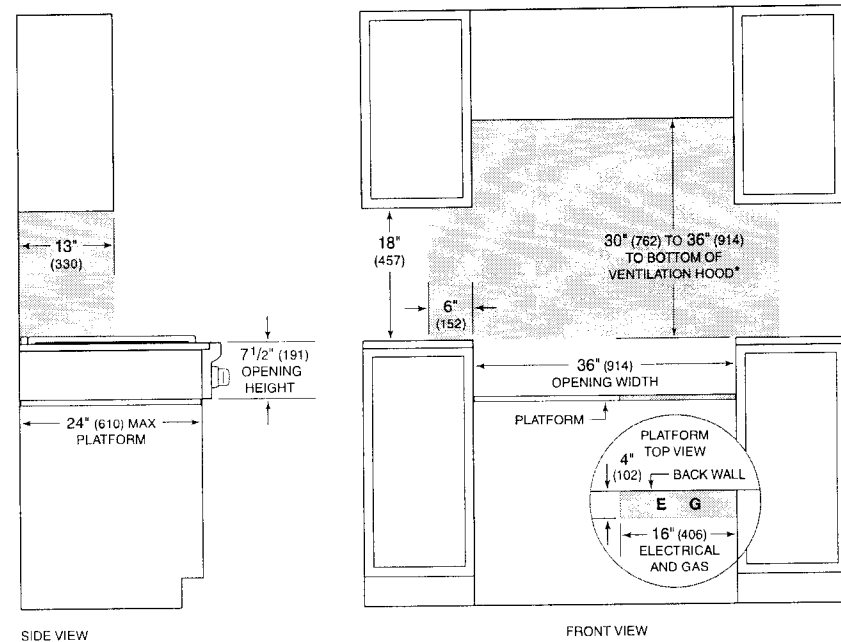

*Without ventilation hood, 36" (914) minimum clearance countertop to combustible materials, 44" (1118) for charbroiler.
NOTE: Shaded area above countertop indicates minimum clearance to combustible surfaces, combustible materials cannot be located within this area.
Electrical and gas supply located through bottom of platform.
For island installation, 12" (305) minimum clearance back of range to combustible rear wall above countertop.



30" SINGLE WALL OVEN WITH MULTIMODE® CONVECTION SYSTEM

Signature Features

MULTIMODE® CONVECTION SYSTEM

Steady heat produced by three elements is circulated by whirling metal blades, weaving around every flat tine. Wield your cooking prowess from marbled meats to succulent roasts.

MY CREATIONS

Curate recipe presets at will. Bake for 30 minutes, broil for 4 and keep dishes warm until you're ready to dine—all without lifting a finger.

IRRESISTIBLE INTERIOR

Captivation cloaked in black. Beyond a dark glass expanse, cinematic lighting illuminates smooth racks, flat tines, and an enticing jet black interior.

Feature Listing

DESIGN & CRAFTSMANSHIP

- Irresistible Interior
- 4.3-Inch Full Color LCD Display
- Cinematic Lighting
- Seamless Touches
- Glide Rack
- Smooth Close Door
- 5.0 Cu. Ft. Capacity

PERFORMANCE

- MultiMode® Convection System
- My Creations
- Closed Door Broiling
- Versatile Modes
- 3,200-Watt Convection Element
- 2,800-Watt Hidden Bake Element
- 4,000-Watt Broil Element
- 8-Pass Reflective Broil Element
- Temperature Probe

ADDITIONAL FEATURES

- Keep Warm™ Option
- Auto Convection Conversion
- Auto Convection Modes
- Manual Convection Modes
- Rapid Preheat
- Proofing Option
- Control Lock
- Sabbath Mode
- ADA Compliant
- Badasses at the Ready
- Serviced by a Select Few

Specifications

- Shipping Weight (lbs) 184
- Volts 240
- Amps 20
- Capacity (Cu. Ft.) 5.0

Dimensions

- Overall Dimensions 30" x 29(7/8)" x 25(5/16)"
- Opening / Clearance Dimensions (Traditional Installation) 28(1/2)" x 28" x 24"
- Opening / Clearance Dimensions (Flush Installation) 30(1/4)" x 30(7/16)" x 25"
- Do not make any cutouts based on this information

JJW2430I

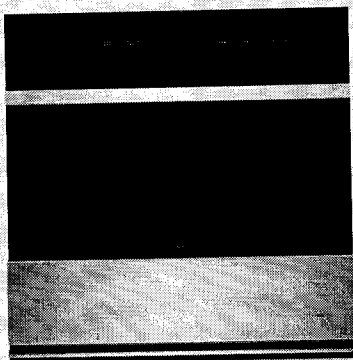

Style Options

- RISE™
JJW2430IL
- NOIR™
JJW2430IM



LIMITED
WARRANTY

Bold = Top Features

JENNAIR®

SINGLE WALL OVENS

~~JJW2427I – 27" x 29-7/8" x 25-5/16"~~

JJW2430I, ~~JJW3430I~~ – 30" x 29-7/8" x 25-5/16"

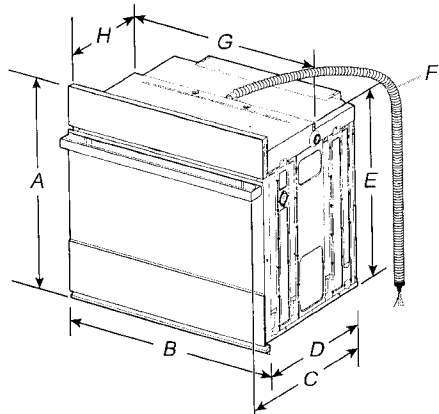

PRODUCT DIMENSIONS – SINGLE OVENS

~~27" (68.6 CM) MODELS~~

- ~~A. 29-7/8" (75.8 cm) max. overall height~~
- ~~B. 27" (68.6 cm) overall width~~
- ~~C. JJW2427IM – 26-3/8" (67 cm)
JJW2427IL – 27-3/16" (69 cm)~~
- ~~D. 23-1/4" (59.1 cm) max. recessed depth~~
- ~~E. 27-3/16" (69 cm) recessed height~~
- ~~F. 48" (121.9 cm) flexible conduit length~~
- ~~G. 25-7/16" (64.6 cm) max. recessed width~~
- ~~H. 12" (30.5 cm) from back of control panel to start of strain relief~~

30" (76.2 CM) MODELS

- A. 29-7/8" (75.8 cm) max. overall height
- B. 30" (76.2 cm) overall width
- C. JJW2430IM – 26-3/8" (67 cm)
JJW2430IL – 27-3/16" (69 cm)
JJW3430IM – 26-3/8" (67 cm)
JJW3430IL – 27-3/16" (69 cm)
- D. 23-1/4" (59.1 cm) max. recessed depth
- E. 27-3/16" (69 cm)
- F. 48" (121.9 cm) flexible conduit length
- G. 28-7/16" (72.2 cm) max. recessed width
- H. 12" (30.5 cm) from back of control panel to start of strain relief

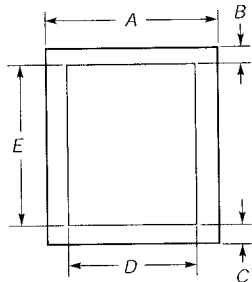

UNDERCOUNTER CABINET DIMENSIONS – SINGLE OVENS

~~27" (68.6 CM) MODELS~~

- ~~A. 27" (68.6 cm) min. cabinet width~~
- ~~B. 1-1/2" (3.8 cm) min. top of cutout to underside of countertop~~
- ~~C. 5-1/4" (13.3 cm) bottom of cutout to floor~~
- ~~D. 25-1/2" (64.8 cm) cutout width~~
- ~~E. 28" (71.2 cm) min. cutout height~~

30" (76.2 CM) MODELS

- A. 30" (76.2 cm) min. cabinet width
- B. 1-1/2" (3.8 cm) min. top of cutout to underside of countertop
- C. 5-1/4" (13.3 cm) bottom of cutout to floor
- D. 28-1/2" (72.4 cm) cutout width
- E. 28" (71.2 cm) min. cutout height

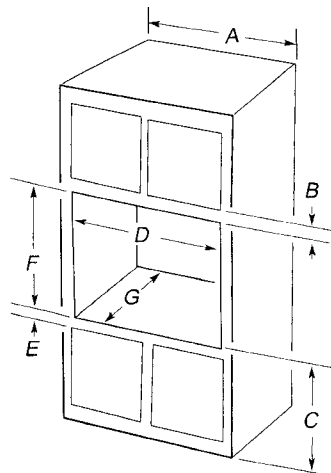

SINGLE OVENS INSTALLED IN CABINET

~~27" (68.6 CM) MODELS~~

- ~~A. 27" (68.6 cm) min. cabinet width~~
- ~~B. 2-3/16" (5.5 cm) top of cutout to bottom of upper cabinet door~~
- ~~C. 32" (81.3 cm) bottom of cutout to floor~~
- ~~D. 25-1/2" (64.8 cm) cutout width~~
- ~~E. 1-1/2" (3.8 cm) min. bottom of cutout to top of cabinet door~~
- ~~F. 28" (71.2 cm)* recommended cutout height~~
- ~~G. 24" (60.7 cm) cutout depth~~

~~*NOTE: The cutout height can be between 27-1/4" (69.2cm) and 29-7/16" (74.8 cm) for 27" single ovens.~~

30" (76.2 CM) MODELS

- A. 30" (76.2 cm) min. cabinet width
- B. 2-3/16" (5.5 cm) top of cutout to bottom of upper cabinet door
- C. 32" (81.3 cm) bottom of cutout to floor
- D. 28-1/2" (72.4 cm) cutout width
- E. 1-1/2" (3.8 cm) min. bottom of cutout to top of cabinet door
- F. 28" (71.2 cm)* recommended cutout height
- G. 24" (60.7 cm) cutout depth

*NOTE: The cutout height can be between 27-1/4" (69.2 cm) and 29-7/16" (74.8 cm) for 30" single ovens.

IMPORTANT: Dimensional specifications are provided for planning purposes only. Do not make any cutouts based on this information. Refer to the Installation or Use & Care Guide before selecting cabinetry, verifying electrical/gas connections, making cutouts or beginning installation. All JennAir® appliances are appropriately UL, CUL or CSA approved.



Panel Specifications

Single Model: BI-42UFDID/O

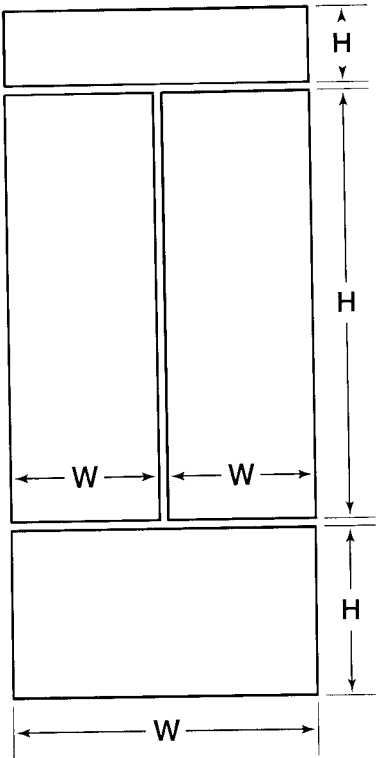

PANEL	FRONT	SPACER	BACKER	MAX WEIGHT
Door (2)	21 ³ / ₈ " W	20" W	20 ⁵ / ₈ " W	50 lbs
	50 ¹ / ₈ " H	49 ⁵ / ₁₆ " H	49 ¹⁵ / ₁₆ " H	
Drawer	43" W	41 ¹ / ₈ " W	41 ³ / ₄ " W	50 lbs
	19" H	18 ¹ / ₁₆ " H	18 ¹¹ / ₁₆ " H	
Grille	43" W	41 ¹ / ₈ " W	41 ³ / ₄ " W	13 lbs
	9 ¹ / ₄ " H	8 ⁵ / ₁₆ " H	8 ¹⁵ / ₁₆ " H	

Miele

24" Whole Bean Coffee System

CVA 6401 CVA 6800



Shown: CVA 6800 over ESW 6214
Please note: This information is subject to change

 mieleusa.com
Specification Sheet TRS 04232020



24" Whole Bean Coffee System

INSTALLATION SPECIFICATIONS

Front View

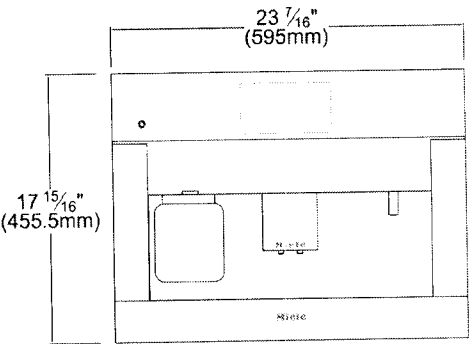

Side View

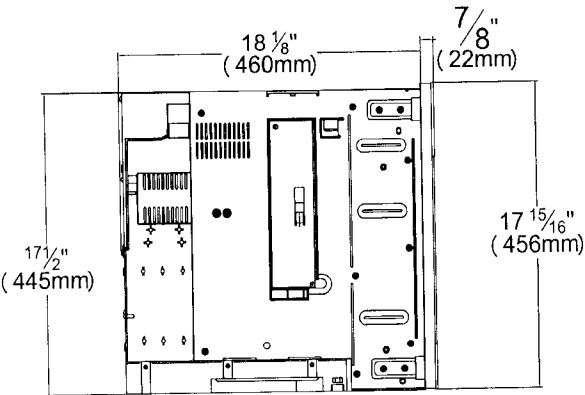

Rear View

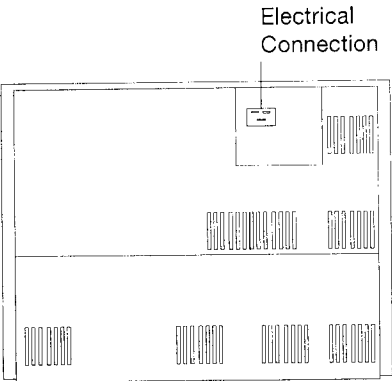

Top View, Door Open

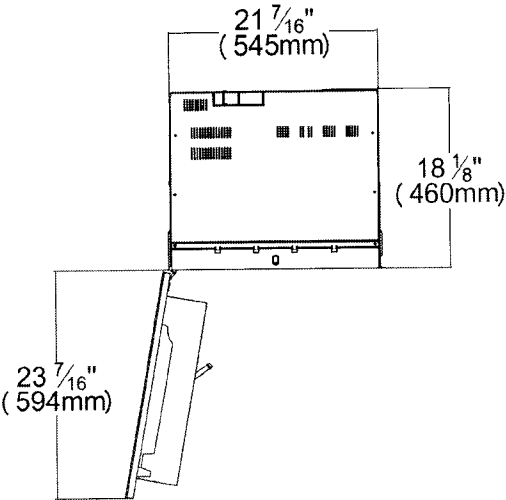



24" Whole Bean Coffee System

SPECIFICATIONS	
Overall Unit Dimensions - Excluding Fascia Dimension	21 ⁷ / ₁₆ " (545 mm) W x 17 ¹ / ₂ " (445 mm) H x 18 ¹ / ₈ " (496 mm) D
Overall Fascia Dimensions	23 ⁷ / ₁₆ " (595 mm) W x 17 ¹⁵ / ₁₆ " (455.5 mm) H x 1 ³ / ₁₆ " (22 mm) D
Door Depth When Open	23 ⁷ / ₁₆ " (594 mm)
Built-In	
Minimum Cabinet Opening Dimensions	22 ¹ / ₁₆ " (560 mm)W x 17 ¹¹ / ₁₆ " (450 mm) H x 21 ⁵ / ₈ " (550 mm) D
Minimum Base Support	62 lbs
Additional Cut-outs Required	Venting: 19 ¹¹ / ₁₆ " (500 mm) x 1 ⁹ / ₁₆ " (40 mm) or 31" in ² (200 cm ²)
Electrical	
Electrical Requirements	120V, 60Hz, 15A
Power Cord	Molded NEMA 5-15A plug, 6 ft (1.8 m)
Shipping	
Shipping Weight	66 lbs (29.94 kg)
Shipping Dimensions	23 ⁵ / ₈ " (600 mm) W x 22 ¹ / ₁₆ " (560 mm) H x 26" (660 mm) L
Support	
Call Miele	(800) 999-1360
Miele Website	www.mieleusa.com
20/20 Link	2020technologies.com

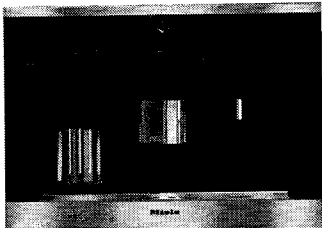

CVA 6401
Material# 9676900

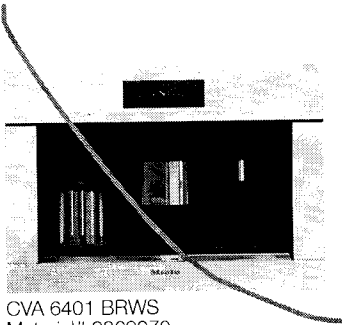

CVA 6401 BRWS
Material# 9869070

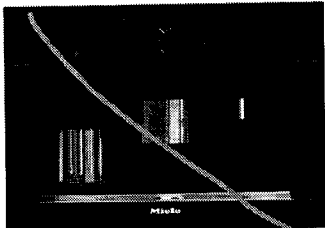

CVA 6401 OBSW
Material# 9869050

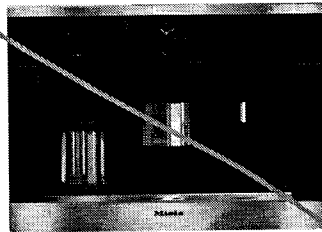

CVA 6800
Material# 9676920



24" Whole Bean Coffee System

INSTALLATION SPECIFICATIONS

Solo Installation

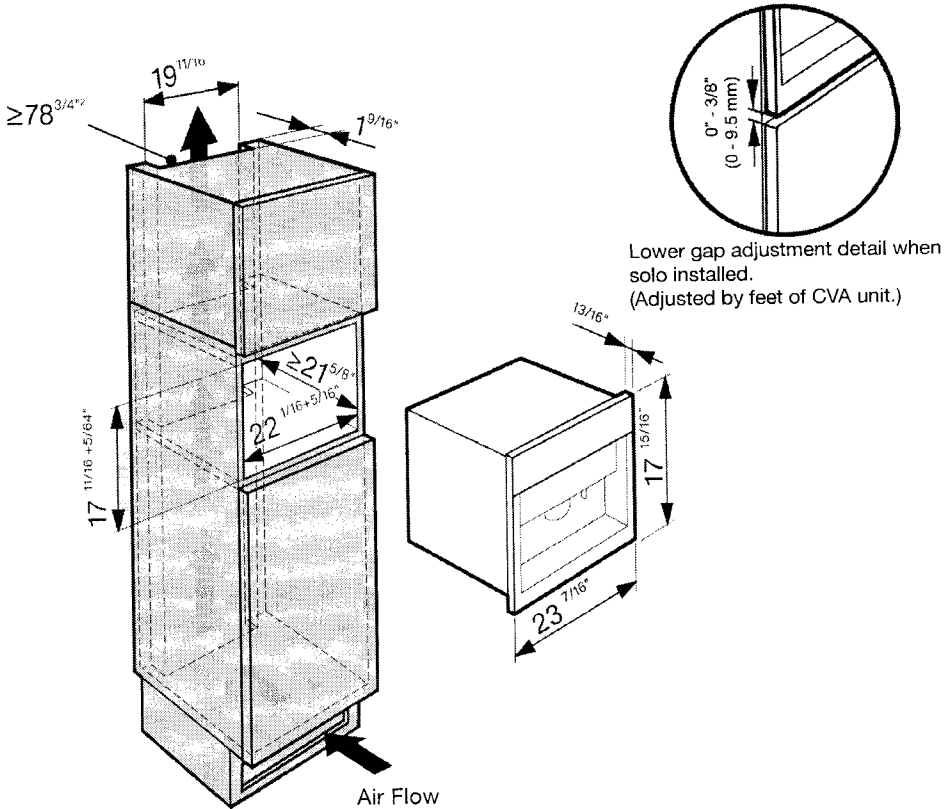

VENTILATION REQUIREMENTS

PLEASE NOTE:
Condensation water can damage the coffee system or surrounding cabinets. The specified ventilation cross-sections absolutely must be observed.

VENTILATION OPTIONS:

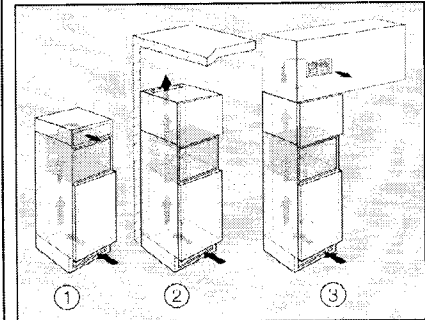

- ① Directly above the coffee system with a ventilation grille (free airflow of at least 31 square inches / 200 cm²)
- ② Between the surrounding cabinets and the ceiling
- ③ Through a suspended ceiling

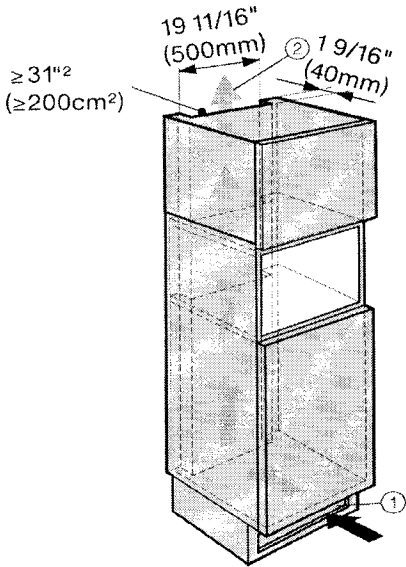

Air intake ① occurs via the plinth at the bottom of the appliance and the air escapes at the top ② at the rear of the surrounding cabinets.

SU90934X
~~SU90946X~~
~~SU90955X~~

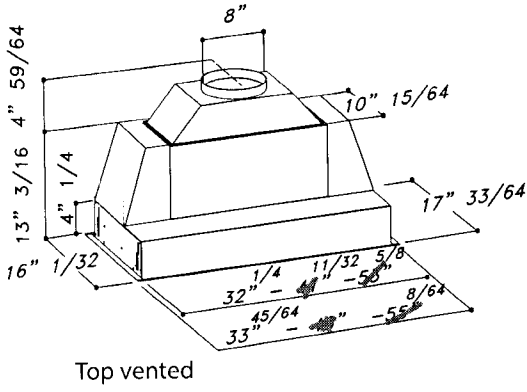
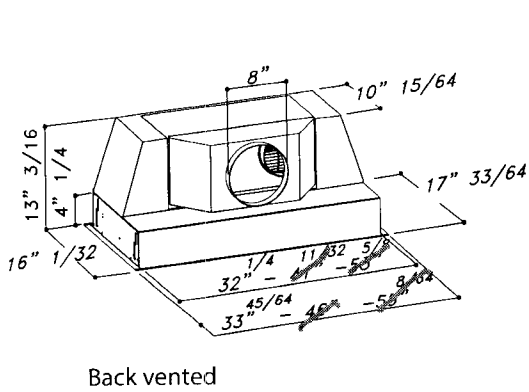

MOTOR	Dual Motor Aluminium die-cast housing 1100 CFM Pressure: 800 Pa Noise level: 66 dBA/5.1 sones
LIGHTING	2x1W Led spot for 34" and 46" 4x1W Led spot for 55"
CONTROL PANEL	Chromed push button 4 Speeds + timer +light
GREASE FILTER	Commercial style baffle filters
AIR OUTLET	8"
DISCHARGE	Vertical and horizontal
CUT OUT	32"15/32 x 16"1/8 SU909 34" version 44"23/32 x 16"1/8 SU909 46" version 53"3/4 x 16"1/8 SU909 55" version
ACCESSORIES	Charcoal filters: KF7 (Order 2 pcs for SU909 34" version) KF7 (Order 3 pcs for SU909 46"/55" version) Cod. 60080477002

24" Custom Panel Dishwasher

800 Series – Custom Panel SHVM78Z53N

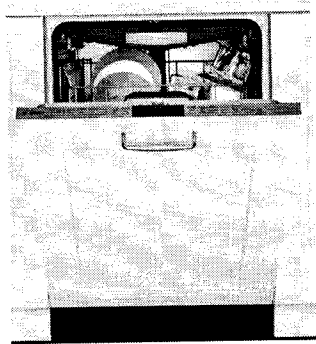

SHVM78Z53N
Custom Panel

Patented CrystalDry™ technology transforms moisture into heat to get dishes, including plastics, 60% drier.¹

Features & Benefits

- 42 dBA: dishwasher runs quietly so your kitchen conversations aren't interrupted.
- The Flexible 3rd Rack with fold down sides adds 30% more² loading area, perfect for utensils and ramekins.
- Touch Control Technology allows for quick cycle programming.
- The AquaStop® leak protection system contains leaks through a precisely engineered system. If a leak occurs, the system contains it by shutting down operation and pumping out water. So you have the ultimate peace of mind whether you are away or at home.



¹Based on aggregate average drying performance of Bosch Dishwashers with CrystalDry on combined household load including plastics, glass, steel, and porcelain as compared to Bosch Dishwashers with PureDry. Drying performance may vary by dish type.
²Compared to a Bosch dishwasher with 2 racks.
³Certification to NSF/ANSI Standard 184 for residential dishwashers.
⁴September 2020 running production change to remove adhesive routing clips for power cord. These clips and the edge protector are now included in the dishwasher accessory kit # SMZEPCC1UC.

General Properties	
Number of wash cycles	6
Number of options	5
dBA	42
Drying system	CrystalDry™ option
Third rack	Flexible 3rd Rack
Rack adjustability	Rackmatic®
Tub material	Stainless Steel
Control type	Touch Control
Concealed water heating element	Yes
Leak protection system	24/7 AquaStop®
NSF®-certified ³ sanitize option	Yes
Water softener	No
Five-level wash	Yes
ChildLock	No
Special features	InfoLight®
Efficiency	
Water usage per cycle	3.5
Energy efficiency class	Tier 1
ENERGY STAR® qualified	Yes
Total annual energy consumption (kWh)	269
Total annual water consumption (g)	623.5
Capacity	
Number of place settings	16

Technical Details	
Watts (W)	1440 W
Current (A)	12 Amps
Volts (V)	120 V
Frequency (Hz)	60 Hz
Power cord full length	67"
Power cord install length from edge of unit when facing the door (in) ⁴	Left – 45" Right – 56"
Minimum water pressure (lb/sin)	14
Length outlet hose (in)	79"
Dimensions & Weight	
Overall appliance dimensions (HxWxD) (in)	33 7/8" x 23 9/16" x 23 1/16"
Required cutout size (HxWxD) (in)	33 7/8" x 23 5/8" x 24"
Adjustable feet	Yes
Net weight (lbs)	99 lbs
Accessories—Optional	
Junction Box	SMZPCJB1UC
Bosch Dishwasher Water Supply Hose	SMZSH002UC
Drain Hose Extension Kit	SGZ1010UC
Dishwasher Accessory Kit	SMZ5000
Anti-Tarnish Silverware Cassette	SMZ5002UC
Edge Protector + Power Cord Clip Install Kit	SMZEPCC1UC
Stainless Steel Straight Bosch Bar Handle	SMZ1007UC

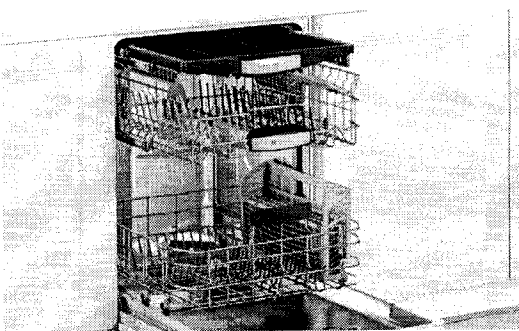

Accessories: To purchase Bosch accessories, cleaners & parts please visit www.bosch-home.com/us/store or call 1-800-944-2904 (Mon to Fri 5 am to 6 pm PST, Sat 6 am to 3 pm PST).

Notes: All height, width and depth dimensions are shown in inches. BSH reserves the absolute and unrestricted right to change product materials and specifications, at any time, without notice. Consult the product's installation instructions for final dimensional data and other details prior to making cutout.

Warranties: Please see Use & Care manual or Bosch website for statement of limited warranty.

For more information on our entire line of products, go to www.bosch-home.com/us or call 1-800-944-2904

© BSH Home Appliances Corporation. All rights reserved. Bosch is a registered trademark of Robert Bosch GmbH.

LORRAINE

SPRBC047D1SS

Silhouette
PROFESSIONAL™

www.silhouetteappliances.com

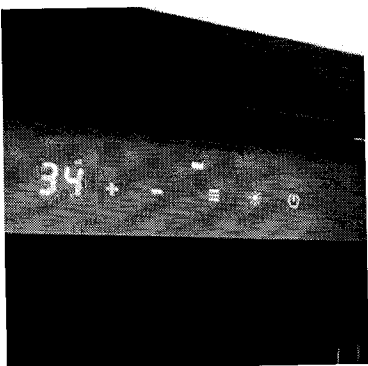
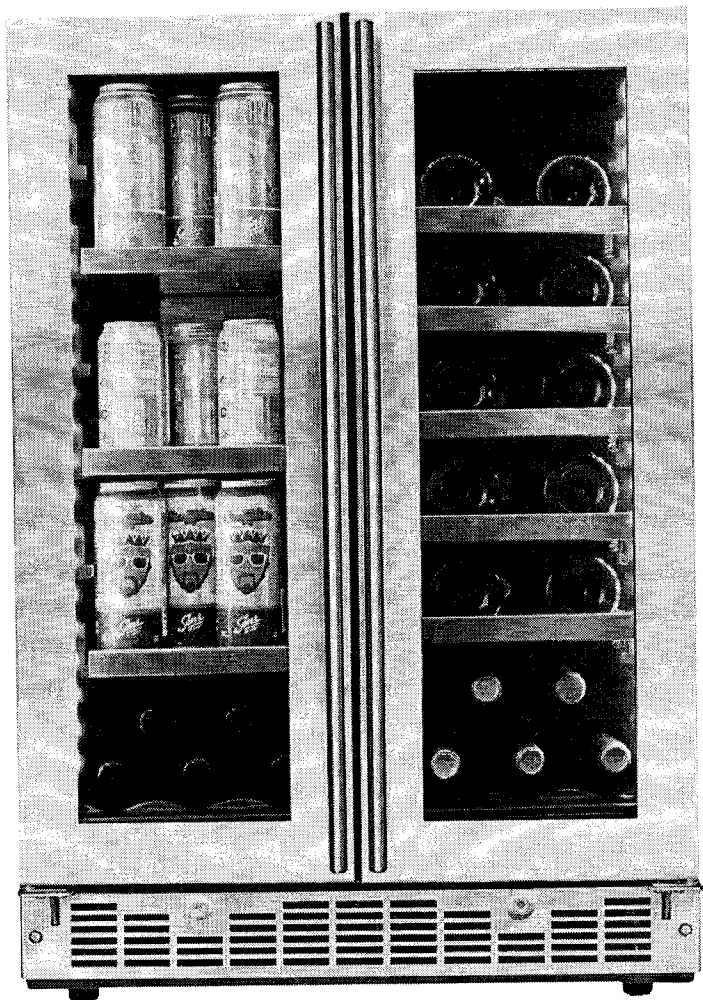

*Seamless Capacitive
Touch Controls*

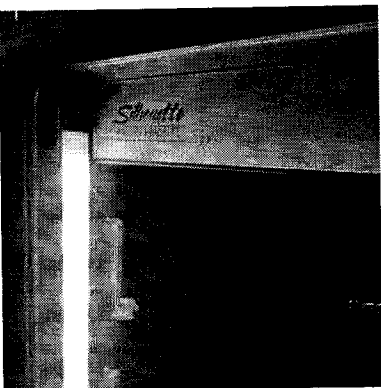

*LED Perimetrical
Lighting*

PRODUCT FEATURES



Pro-vection Cooling

Our fan forced cooling system incorporates AO (always on) fans to continually circulate the air. Multiple sensors are used to continually adjust and provide a stable internal temperature.



Pro Security

Integrated door lock secures the contents



Pro Luminosity

Perimetrical lighting down the sides casts a warm glow and includes 3 different light settings



Quiet operation

LORRAINE

SPRBC047D1SS

Silhouette
PROFESSIONAL™

www.silhouetteappliances.com

BENEFITS

Model #	SPRBC047D1SS
Capacity-Wine Compartment	Stores up 61 beverage cans and 21 bottles of wine
Volume	4.7 cu. ft.
Temperature Range	34F – 50F (1C-10C)
Noise	39 db
Door Frame	304 grade seamless stainless steel
Cabinet	Matte black textured steel
Interior Finish	Matte black
Door Style	French door design
Door Hinge	Hidden for flush fit installation
Door Glass	Low E, dual pane argon filled
Door Handle	Pro-style, 20% longer than previous model
Door Lock	Yes
Shelving	Pro-glide, anti-vibration 100% extension for wine compartment
Shelving Material	3 adjustable clear glass shelves
Lighting Option 1	On/Off with door opening
Lighting Option 2	On 100% illumination for 2 hours
Lighting Option 3	On 50% illumination for 2 hours
Light Colours	Choose between Arctic white or Azure blue
Controls	Digital seamless capacitive touch
Temperature Recall	Yes reverts to last set temperature after power outage
Alarm	Yes, temperature and door ajar
Sabbath Mode	Yes

PRODUCT SPECIFICATIONS

UPC 067638024440

Unit Dimensions

Width 23.8" in.
Min. Height 34" in.
Max. Height 34.7" in.
Depth 23.8" in.
(DOES NOT INCLUDE HANDLE)

Installation

Gross Weight: 150 lbs.
Built-in under counter or free standing
Refrigerator: R600
Size: Min 24" wide opening required

AC Power

115V, 60Hz at MAX 1.5A
Power cord length: 6.5 ft.

Platinum Warranty

2 year parts and labor coverage

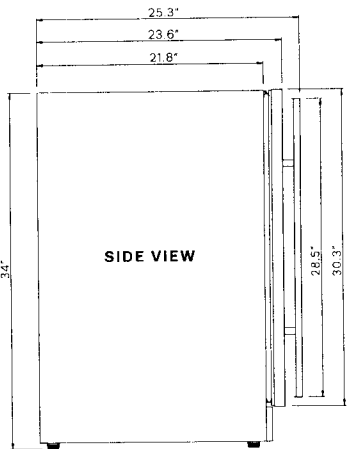
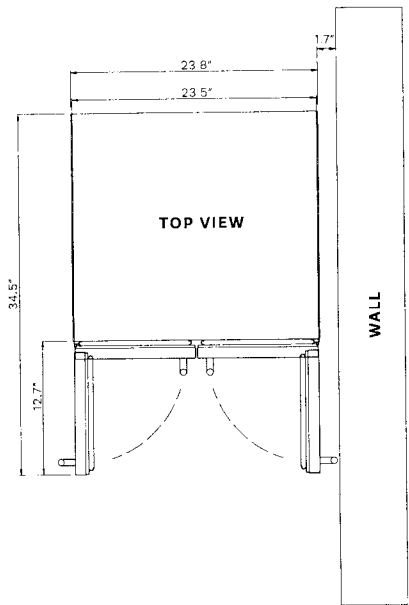
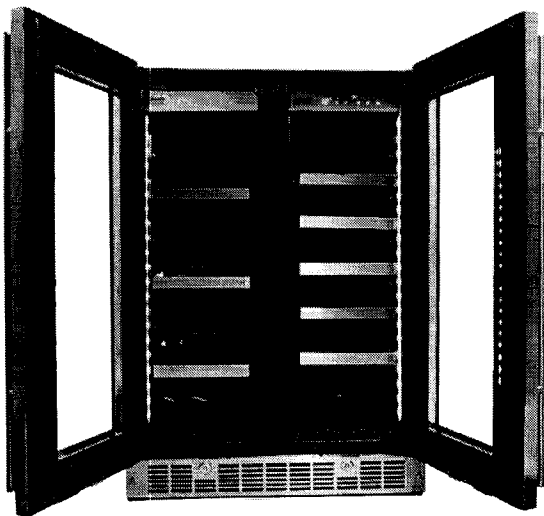

*based on standard 750ml bordeaux style bottle

Danby USA 1-866-649-3309 Danby Canada 1-800-461-4492
03.09.20-V4

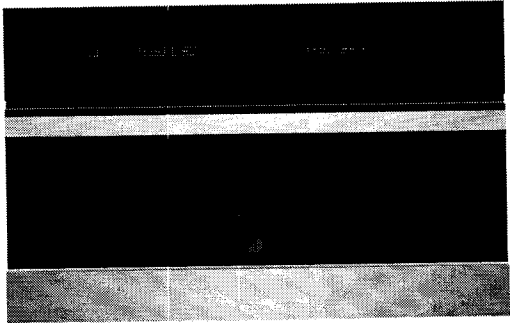

JennAir® NOIR™ 30" BUILT-IN MICROWAVE OVEN WITH SPEED-COOK

JMC2430IM

Available Finishes/Colours



JMC2430IM
FA

Let your appetite run wild with microwave and convection energy. With curated recipes and full-color doneness images, an intelligent culinary experience awaits your touch.

- Top Features
- 4.3-Inch Full Color LCD Display
- Seamless Touches
- Stainless Steel Microwave Interior

Manuals & Literature:

-  [Use and Care](#)
-  [Installation Instructions](#)
-  [Warranty](#)



Because Whirlpool Corporation policy includes a continuous commitment to improve our products, we reserve the right to change materials and specifications without notice. Dimensions are for planning purposes only. For complete details, see Installation Instructions packed with product. Specifications subject to change without notice.

Cabinet Dimensions - Flush Installation

A 23 1/4" (59 cm) minimum cutout depth is required. These dimensions will result in a 1/4" (6.3 mm) reveal on the top, a 1/4" (6.3 mm) reveal on the sides, and a 1/8" (3.1 mm) reveal on the bottom of the microwave oven. The front face of the cleats and platform will be visible and should be treated as a finished surface.

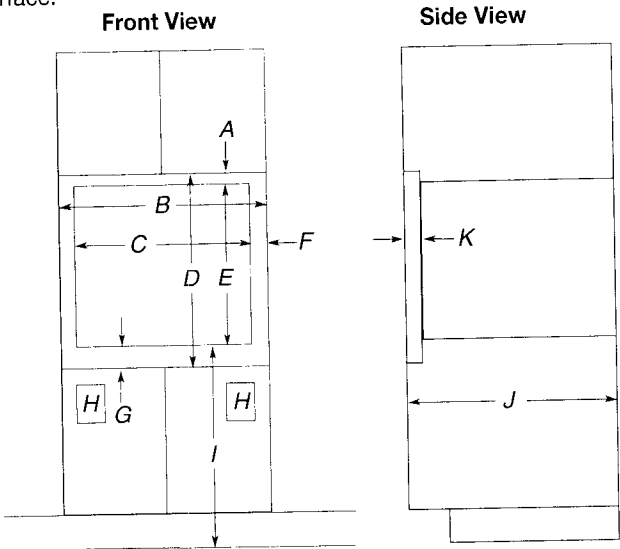

27" (68.6 cm) Models

- A. 1 3/16" (4.7 cm) top cleat*
- B. 27 1/4" (69.2 cm) minimum width of flush inset cutout
- C. 25 7/8" (65.7 cm) minimum width of opening
- D. 20 3/16" (51.3 cm) minimum height of flush inset cutout
- E. 17 5/8" (44.7 cm) recommended cutout height
- F. 1 1/16" (1.7 cm) side cleat*
- G. 3/4" (1.9 cm) bottom cleat*
- H. Recommended junction box location
- I. 40" (101.6 cm) bottom of cutout to floor (recommended)
- J. 23 1/4" (59.0 cm) minimum depth of cutout
- K. 1 3/8" (3.5 cm) recess from front of cabinet

30" (76.2 cm) Models

- A. 1 3/16" (4.7 cm) top cleat*
- B. 30 1/4" (76.8 cm) minimum width of flush inset cutout
- C. 28 7/8" (70.8 cm) minimum width of opening
- D. 20 3/16" (51.3 cm) minimum height of flush inset cutout
- E. 17 5/8" (44.7 cm) recommended cutout height
- F. 1 1/16" (1.7 cm) side cleat*
- G. 3/4" (1.9 cm) bottom cleat*
- H. Recommended junction box location
- I. 40" (101.6 cm) bottom of cutout to floor (recommended)
- J. 23 1/4" (59.0 cm) minimum depth of cutout
- K. 1 3/8" (3.5 cm) recess from front of cabinet

*Cleats must be recessed 1 3/8" (3.5 cm) from the front of the cabinet.

Minimum Installation Clearances

For proper installation, the following minimum clearances must exist below the cabinet opening.

Installation Above Single Built-In Oven

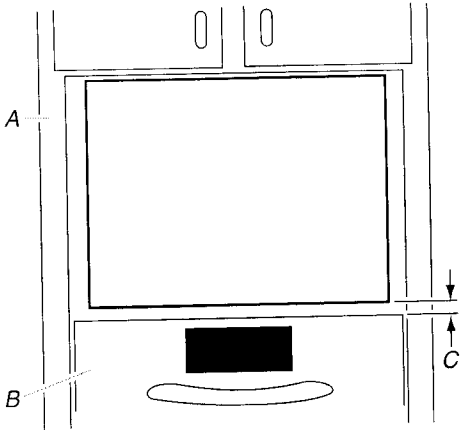

- A. Upper cabinet
- B. Lower single oven*
- C. 1" (2.5 cm) from top of oven