

CONSTRUCTION SUMMARY

Mountainview Heights 3 (G) - Russell Gardens Building Ltd.

PURCHASERS: Rekha KONDURU and Vamsee Krishna SANGARAJU

TEL: RES.: 647-919-6625

LOT / PHASE 257 / 3	REG. PLAN # 62M-1266	HOUSE TYPE Mountainash Six (5 Bedroom) Elev 3		
------------------------	-------------------------	--	--	--

CABINETRY

1 - KITCHEN - DELETE CABINETS ABOVE STOVE - VENDOR WILL SUPPLY 6 INCH VENT AS PER CONSTRUCTION SPECIFICATIONS AND VENT MAY NOT BE IN THE APPROPRIATE LOCATION FOR INSTALLATION OF PURCHASER SUPPLIED VENT - PURCHASER TO SUPPLY OWN FAN AFTER CLOSING 04May21 Note: TEMPORARY HOOD FAN MAY BE PROVIDED	
---	--

CABINETRY ACCESSORIES

1 - KITCHEN CABINETRY BASE - COOKTOP CABINET WITH POT DRAWERS (2 DRAWERS) - STANDARD 04May21 Note:	
<del>1 - DELETE KITCHEN CABINETRY BASE - COOKTOP CABINET WITH FULL HEIGHT DOORS - STANDARD</del> 04May21 Note:	
1 - KITCHEN - SERVERY - CREATE OPENING FOR FUTURE WINE FRIDGE 04May21 Note:	
1 - KITCHEN CABINETRY UPPER - FULL DEPTH ABOVE FRIDGE - WITH GABLES - 600MM - PRICE IS EACH - STANDARD 04May21 Note:	
1 - PANTRY UNIT UPGRADE - TO GO FROM 300MM TO 600MM DEEP - PRICE IS PER FOOT - STANDARD 04May21 Note:	
1 - KITCHEN CABINETRY - BUILT-IN MICROWAVE/OVEN COMBO - STANDARD 04May21 Note:	
<del>1 - KITCHEN CABINETRY BASE - COOKTOP CABINET WITH FULL HEIGHT DOORS - STANDARD</del> 04May21 Note:	

CERAMIC TILE

1 - DELETE ALL CERAMIC BATHROOM ACCESSORIES - DELETE TOWEL BAR, PAPER HOLDER & SOAP DISH - MASTER ENSUITE BATHROOM ONLY 04May21 Note:	
--	--

CONSTRUCTION

4 - ENLARGE BASEMENT WINDOWS (MAY REQUIRE WINDOW WELLS) - WINDOW IS 30 INCHES X 24 INCHES 04Aug20 Note: IF CONSTRUCTION PERMITS	
--	--

ELECTRICAL

1 - LIGHT AND SWITCH - NO FIXTURE INCLUDED - LIVING ROOM 04May21 Note:	
<del>1 - ***DELETE - STANDARD DINING ROOM LIGHT TO BE CENTERED BETWEEN LIVING AND DINING ROOMS</del> 04May21 Note:	
1 - PLUG - ELECTRICAL PLUG - FOR WINE FRIDGE 04May21 Note:	
1 - KITCHEN - CANOPY HOOD FAN - 36" CYCLONE 550 CFM #SC51336 04May21 Note:	
1 - BUILT IN OVEN AND COOKTOP PROVISION - PROVISION ONLY - ELECTRICAL ONLY 04May21 Note:	



CONSTRUCTION SUMMARY

Mountainview Heights 3 (G) - Russell Gardens Building Ltd.

PURCHASERS: Rekha KONDURU and Vamsee Krishna SANGARAJU

TEL: RES.: 647-919-6625

LOT / PHASE 257 / 3	REG. PLAN # 62M-1266	HOUSE TYPE Mountainash Six (5 Bedroom) Elev 3		
------------------------	-------------------------	--	--	--

1 - PLUG - ELECTRICAL PLUG - TO BE INSTALLED OVER FIREPLACE 04May21 Note:	
1 - ABOVE KITCHEN ISLAND - ADD LIGHT AND SWITCH - NO FIXTURE INCLUDED 04May21 Note:	
1 - STANDARD DINING ROOM LIGHT - TO BE CENTERED BETWEEN LIVING AND DINING ROOM 04May21 Note:	
1 - 200 AMP ELECTRICAL SERVICE 04Aug20 Note:	

FIREPLACE AND ACCESSORIES

1 - GAS LINE ROUGH-IN FOR STOVE (INCLUDES ELECTRICAL OUTLET) - FIRST FLOOR 04May21 Note:	
---	--

HARDWOOD FLOORING

1 - HARDWOOD - PROMO SERIES 4 7/16 INCH - IN LIEU OF 2 1/4 INCH NATURAL RED OAK - - LIVING AND DINING ROOM 04May21 Note:	
1 - HARDWOOD - PROMO SERIES 4 7/16 INCH - IN LIEU OF 2 1/4 INCH NATURAL RED OAK - - LIBRARY/DEN 04May21 Note:	
1 - HARDWOOD - PROMO SERIES 4 7/16 INCH - IN LIEU OF 2 1/4 INCH NATURAL RED OAK - - FAMILY ROOM 04May21 Note:	

MIRRORS AND GLASS

1 - MASTER ENSUITE- ADD FRAMELESS GLASS SHOWER DOOR AND FRONT WALL AT SEAT-INCLUDES CHROME KNOB AND HINGES 15Sep20 Note:	
---	--

MISCELLANEOUS

1 - GARAGE DOOR OPENER – LIFEMASTER 8355 WITH BELT DRIVE – INLCUDES 1 KEYPAD & 2 HANDHELD CONTROL - CLOSEST TO MAIN FLOOR 04May21 Note:	
--	--

PLUMBING

2 - ENSUITE 4/5 BATHROOM - CHROME GRAB BAR 04May21 Note:	
1 - MOEN BATHROOM ACCESSORIES - MASON CHROME - TOWEL BAR 24" #YB8094/YB8000- MASTER ENSUITE BATHROOM ONLY 04May21 Note:	
1 - MOEN BATHROOM ACCESSORIES - MASON CHROME - PAPER HOLDER #YB8099/YB8000- MASTER ENSUITE BATHROOM ONLY 04May21 Note:	
1 - WATER LINE FOR FRIDGE - ROUGH-IN ONLY 04May21 Note:	
2 - TOE TESTER - ADD TOE TESTER TO SHOWER - ALL SHOWERS 04Aug20 Note:	

CONSTRUCTION SUMMARY

Mountainview Heights 3 (G) - Russell Gardens Building Ltd.

PURCHASERS: Rekha KONDURU and Vamsee Krishna SANGARAJU

TEL: RES.: 647-919-6625

LOT / PHASE 257 / 3	REG. PLAN # 62M-1266	HOUSE TYPE Mountainash Six (5 Bedroom) Elev 3		
------------------------	-------------------------	--	--	--

PROMOTIONAL

I - LESS BALANCE OF CREDIT FROM PURCHASER EXTRA SHEET IN OFFER 04May21 Note:	
I - LESS CREDIT FROM PURCHASER EXTRA SHEET IN OFFER 15Sep20 Note: PROMO BALANCE \$8895.00 LESS \$2500.00 NEW PROMO BALANCE \$6395.00 4	
I - PARTIAL REDEMPTION OF PROMOTIONAL PACKAGE \$3,105.00 BALANCE (\$8,895.00) FORWARD TO BE USED AT A LATER DATE. ORIGINAL PROMOTIONAL PACKAGE OF \$12,000.00 AS PER SCHEDULE PE DATED 07/18/2020. 04Aug20 Note:	

STAIRS AND RAILINGS

I - STAIRCASE - EUROLINE 1 IRON PICKETS - BLACK 04May21 Note:	
I - STAINED STAIRS – STANDARD STAIRCASE - PRICE IS PER SET 04May21 Note:	

EXTRAS AS PER OFFER

RECESSED STEP IN FRONT AS REQUIRED BY GRADE. Upgrade Note:	
SUNKEN FOYER AS PER GRADE CONDITION Upgrade Note:	
LOW HEADROOM UNDER SUNKEN FOYER Upgrade Note:	
INSERT SKETCH DATED OCTOBER 20, 2020. Upgrade Note:	
The Vendor agrees that notwithstanding any other term or provision in this Agreement included in the Purchase Price and in addition to those items detailed in Schedule GP to the Agreement of Purchase and Sale, the Purchaser is entitled to a credit of Two Worksheet Note:	
WALK-UP BASEMENT, SUBJECT TO ENGINEERING APPROVAL. Worksheet Note:	
PURCHASER(S) ACKNOWLEDGES THAT THE PURCHASE PRICE IS INCLUSIVE OF ALL CREDITS AND PROMOTIONAL PACKAGES AVAILABLE AT TIME OF PURCHASE. Worksheet Note:	

This Document is Extremely Time Sensitive - Printed 4 May 21 at 16:15

Purchasers:      Rekha KONDURU & Vamsee Krishna SANGARA

Telephone Res. / Bus:      (647) 919-6625 /

Decor Advisor:      Candace Forza

Lock Date:      4-May-21

Property: 257

Project: Russell Gardens Building Ltd.

Model and Elevation: Mountainash Six (5 Bedroom) Elev 3

Plan #:      62M-1266

Layout Changes: ☒ Yes ☐ No      Sketch Attached: ☒ Yes ☐ No      Exterior Colour Scheme: 

1. Cabinetry

	Style and Colour	Hardware
Kitchen / Breakfast	CONTINENTAL 823 DRIFT WOOD	431SA
Laundry Room	ELISSE	Standard
Powder Room	MONACO 350 PLATINUM SILVER	431SA
Master Ensuite Bathroom	MONACO 823 DRIFT WOOD	431SA
Ensuite Bath - Bedroom 2/3	DORAL K44 TITAN GREY	431SA
Ensuite Bath - Bedroom 4/5	DORAL H3453 LAVA GREY FLEETWOOD	446SA
	N/A	N/A
	N/A	N/A
	N/A	N/A

Appliances:

Dishwasher Cabinet

Stove Opening

Fridge Opening

Built In Appliances ☒ Yes ☐ No

☐ Closed ☒ Open

41" Upper Cabinets ☒ Yes ☐ No

Slide In Stove ☐ Yes ☒ No

NOTE: If not specified, opening will be set to builder's standard opening of approximately 30" width

NOTE: If not specified, opening will be set to builder's standard opening of approximately 37" width x 74" height

Please NOTE: Standard Cabinet Height is 30"

\*\* Refer to Construction Summary

2. Counters

	Counter	Edge
Kitchen / Breakfast	LAMINATE-CARRARA BIANCO 6696-46	
Laundry Room	N/A	
Powder Room	LAMINATE-PALOMA POLAR 6698-46	
Master Ensuite Bathroom	LAMINATE-CARRARA BIANCO 6696-46	
Ensuite Bath - Bedroom 2/3	LAMINATE-WHITE CARRARA 4924-38	
Ensuite Bath - Bedroom 4/5	LAMINATE-WHITE TIGRIS 4783-60	
	N/A	
	N/A	
	N/A	

\*\* Refer to Construction Summary

Initials:



Purchasers:           Rekha KONDURU & Vamsee Krishna SANGARA

Telephone Res. / Bus:   (647) 919-6625 /

Decor Advisor:        Candace Forza

Lock Date:            4-May-21

Property: 257

Project: Russell Gardens Building Ltd.

Model and Elevation: Mountainash Six (5 Bedroom) Elev 3

Plan #:   62M-1266

3. Ceramic Flooring

		At a 45	Threshold-If App.
Entrance Vestibule	TILE-RAINBOW WHITE-13X13	<input type="checkbox"/>	metal strip where applicable
Main Hall	N/A	<input type="checkbox"/>	
Kitchen / Breakfast	TILE-RAINBOW WHITE-13X13	<input type="checkbox"/>	
Laundry Room	TILE-ESSENZE GRIGIO-13X13	<input type="checkbox"/>	
Powder Room	TILE-RAINBOW WHITE-13X13	<input type="checkbox"/>	
Master Ensuite Bathroom	TILE-RAINBOW WHITE-13X13	<input type="checkbox"/>	
Ensuite Bath - Bedroom 2/3	TILE-ESSENZE GRIGIO-13X13	<input type="checkbox"/>	
Ensuite Bath - Bedroom 4/5	TILE-STRATA GRIGIO-13X13	<input type="checkbox"/>	
GARAGE / SIDE ENTRY	TILE-RAINBOW WHITE-13X13	<input type="checkbox"/>	
	N/A	<input type="checkbox"/>	
	N/A	<input type="checkbox"/>	

\*\* Refer to Construction Summary

4. Ceramic Wall Tile

Master Ensuite Bathroom	Selection	Describe
Tub Deck Wall	N/A	
Tub Deck	N/A	
Tub Deck Skirt	N/A	
Shower Stall	TILE-EXTRA WHITE/GREY-8X16	
Bathtub Enclosure Walls	N/A	
Ensuite Bath - Bedroom 2/3	TILE-LUC CONCEPT NEVE-8X16	
Ensuite Bath - Bedroom 4/5	TILE-LUC BLANC GROENLANDIA-8X16	
GARAGE / SIDE ENTRY	N/A	
	N/A	
	N/A	
Kitchen Backsplash	N/A	

\*\* Refer to Construction Summary - STANDARD GROUT THROUGHOUT UNLESS SPECIFIED

5. Plumbing Fixtures

All Bathrooms

White

N/A

N/A

N/A

N/A

N/A

Whirlpool

N/A

☐ Yes

☒ No

Dishwasher Rough-In

☒ Yes

☐ No

Waterline for Fridge

☒ Yes

☐ No

\*\* Refer to Construction Summary

6. Trim Carpentry

Interior Doors	CARRARA-SMOOTH
Interior Trim	As Per Construction Specifications
Door Handles	As Per Construction Specifications
Exterior Front Door Handle	As Per Construction Specifications

\*\* Refer to Construction Summary

Initials:  

Purchasers:                   Rekha KONDURU & Vamsee Krishna SANGARA

Telephone Res. / Bus: (647) 919-6625 /

Decor Advisor:               Candace Forza

Lock Date:                   4-May-21

Property: 257

Project: Russell Gardens Building Ltd.

Model and Elevation: Mountainash Six (5 Bedroom) Elev 3

Plan #:     62M-1266

7. Other Flooring

Main Hall	N/A	
Living Room	STRIP-MIRAGE-TRUBALANCE-ADMIRATION-RED OAK-CASHMERE-RIO-4 7/16"	
Dining Room	STRIP-MIRAGE-TRUBALANCE-ADMIRATION-RED OAK-CASHMERE-RIO-4 7/16"	
Family Room	STRIP-MIRAGE-TRUBALANCE-ADMIRATION-RED OAK-CASHMERE-RIO-4 7/16"	
Den / Library / Study	STRIP-MIRAGE-TRUBALANCE-ADMIRATION-RED OAK-CASHMERE-RIO-4 7/16"	
Basement Landing(If Applies)	N/A	
Lower Landing (If Applies)	N/A	
Upper Landing	STRIP-MIRAGE-TRUBALANCE-ADMIRATION-RED OAK-CASHMERE-RIO-4 7/16"	
Upper Hall	LAMINATE-MANHATTAN-DRIFTWOOD OAK-TL-15020	
Master Bedroom	LAMINATE-MANHATTAN-DRIFTWOOD OAK-TL-15020	
Bedroom #2	LAMINATE-MANHATTAN-DRIFTWOOD OAK-TL-15020	
Bedroom #3	LAMINATE-MANHATTAN-DRIFTWOOD OAK-TL-15020	
Bedroom #4	LAMINATE-MANHATTAN-DRIFTWOOD OAK-TL-15020	
Bedroom #5	LAMINATE-MANHATTAN-DRIFTWOOD OAK-TL-15020	
	N/A	
	N/A	
	N/A	
Underpad	Type	Area
	N/A	N/A

\*\* Refer to Construction Summary

8. Railings and Pickets

Railing Type	AS PER CONSTRUCTION SPECIFICATIONS	Colour	MIRAGE RIO RED OAK
Picket Type	EUROLINE 1	Colour	BLACK
Stringer / Riser	AS PER CONSTRUCTION SPECIFICATIO	Colour	MIRAGE RIO RED OAK
Treads	AS PER CONSTRUCTION SPECIFICATIO	Colour	MIRAGE RIO RED OAK
Red Oak Stairs with Semi Gloss Finish		<input checked="" type="radio"/> Yes <input type="radio"/> No	

\*\* Refer to Construction Summary    THE STAIN COLOURS OR FINISH AVAILABLE ON RISERS, TREADS, PICKETS AND RAILS (STAIRCASES), WILL NOT BE AN EXACT MATCH TO PREFINISHED HARDWOOD OR LAMINATE FLOORS.

9. Wall Paint Flat Finish

Main & Upper Hall	22 WARM GREY	Master Bedroom	22 WARM GREY
Living Room	22 WARM GREY	Bedroom #2	22 WARM GREY
Dining Room	22 WARM GREY	Bedroom #3	22 WARM GREY
Kitchen / Breakfast	22 WARM GREY	Bedroom #4	22 WARM GREY
Family Room	22 WARM GREY	Bedroom #5	22 WARM GREY
Powder Room	22 WARM GREY	Master Ensuite	22 WARM GREY
Laundry Room	22 WARM GREY	Ensuite Bath - Bedroom 2/3	22 WARM GREY
Den/Library	22 WARM GREY	Ensuite Bath - Bedroom 4/5	22 WARM GREY
Trim Paint-Semi Gloss	BIRCH WHITE		N/A
	N/A		N/A
	N/A		N/A

Smooth Ceilings First Floor    ☐ Yes                    ☒ No

\*\* Refer to Construction Summary

Initials:





Purchasers:      Rekha KONDURU & Vamsee Krishna SANGARA

Telephone Res. / Bus:      (647) 919-6625 /

Decor Advisor:      Candace Forza

Lock Date:      4-May-21

Property: 257

Project: Russell Gardens Building Ltd.

Model and Elevation: Mountainash Six (5 Bedroom) Elev 3

4-May-21

Plan #: 62M-1266

10. Plaster Mouldings and Medallions

Entrance Vestibule	N/A	N/A	Kitchen/Breakfast	N/A	N/A
Main Hall	N/A	N/A	Den/Library	N/A	N/A
Living Room	N/A	N/A	Lower Landing	N/A	N/A
Dining Room	N/A	N/A		N/A	N/A
Family Room	N/A	N/A			

\*\* Refer to Construction Summary

11. Fireplace

Living Room			Family Room			Other Room - Specify		
Purchased	As Per Plan	N/A	Purchased	As Per Plan	N/A	Purchased	As Per Plan	N/A
<input type="radio"/>	<input type="radio"/>	<input checked="" type="radio"/>	<input type="radio"/>	<input checked="" type="radio"/>	<input type="radio"/>	<input type="radio"/>	<input type="radio"/>	<input checked="" type="radio"/>
Fireplace Type	N/A		FLAT ON WALL			N/A		
Mantle Type	N/A		MANTLE M2-STANDARD			N/A		
Colour / Stain	N/A		AS PER CONSTRUCTION SPECIFICATIONS			N/A		
Surround	N/A		GRIGIO CARNICO			N/A		
Hearth	N/A		NO			N/A		

\*\* Refer to Construction Summary

12. Heating and Air Conditioning

Air Conditioning	NO	Gas Provisions Stove	YES
Gas Provisions Dryer	NO	Gas Provisions Barbecue	NO
Comment			

\*\* Refer to Construction Summary

13. Electrical

Plugs and Switches	<input checked="" type="radio"/> White	DECOR	Above Kitchen Cabinet Light	<input type="radio"/> Yes	<input checked="" type="radio"/> No
Hood Fan	CYCLONE CHIMNEY 36" #SC51336		Below Kitchen Cabinet Light	<input type="radio"/> Yes	<input checked="" type="radio"/> No
Appliances	Built in Cooktop	Built in Oven	Gas Stove	Microwave	
	<input checked="" type="radio"/> Yes <input type="radio"/> No	<input checked="" type="radio"/> Yes <input type="radio"/> No	<input checked="" type="radio"/> Yes <input type="radio"/> No	<input checked="" type="radio"/> Yes <input type="radio"/> No	
Dishwasher Rough-in	Yes				

\*\* Refer to Construction Summary

14. General Comments

\*\* Refer to Construction Summary

Disclaimers and Notes

- 1) Colours of all materials are as close as possible to builder's selection, but not necessarily identical due to variances in manufacturing.
- 2) Any extras listed above are null and void unless accompanied by a separate invoice/amendment. Said invoice must be paid in full.
- 3) The Purchaser agrees that this colour selection is final and that no changes will be permitted, unless required by the Vendor.
- 4) The Purchaser acknowledges reading and accepting document which contains other miscellaneous disclaimers.

Signature:  Date: \_\_\_\_\_

Signature:  Date: May 04/21







Model# HRT3618U  
Thor Kitchen 36-inch Professional Range Top

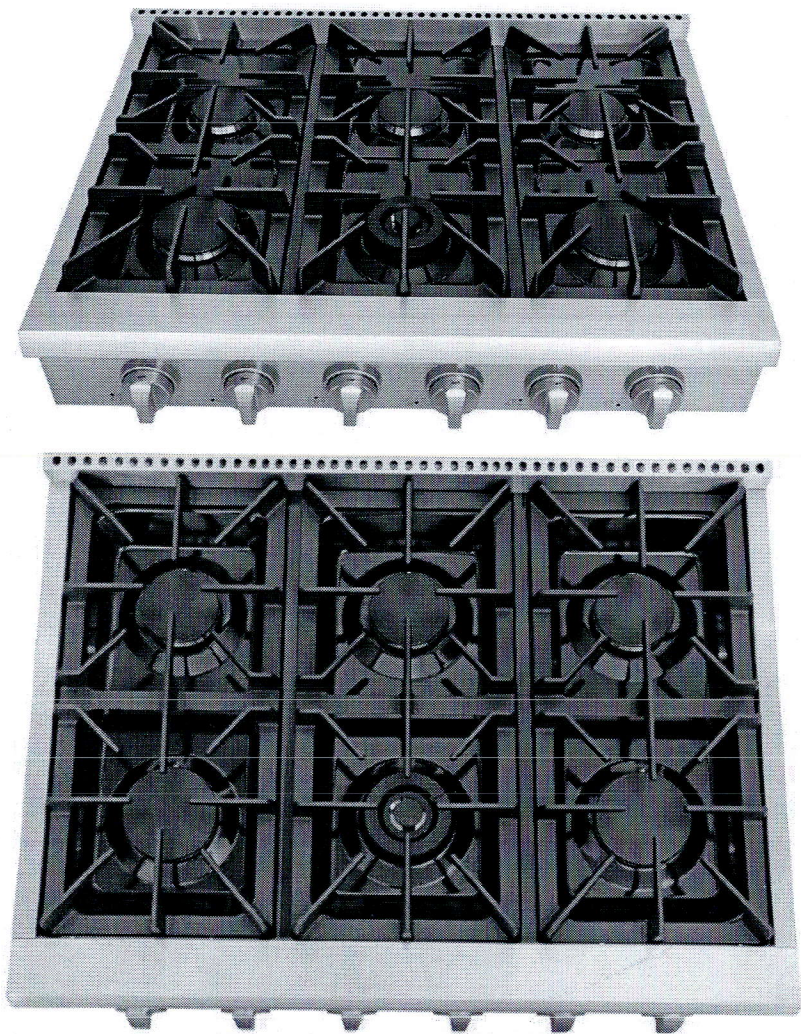

FEATURES			
Black Porcelain Drip Pan On Cook Top	12K	12K	12K
Heavy Duty Continuous Cast Iron Cooking Grates			
Automatic Re-Ignition Safety Feature			
Blue LED Control Panel Light	18K	15K (650 BTU Simmer)	18K
Zinc Alloy Controller Knobs			
304 Stainless Steel Control Panel			
BURNER PERFORMANCE			
Total Number of Range Top Burners	6 Burners		
Front Right (Single)	18,000 BTU		
Front Middle (Dual burner with simmer function)	15,000 BTU (650 BTU for Simmer)		
Front Left (Single)	18,000 BTU		
3 Rear Burners (Single)	12,000 BTU		
TECHNICAL DETAILS			
Fuel Type	Natural Gas / LP Convertible		
Electrical Requirements	120V		
Circuit Breaker (A)	15 or 20 A		
Frequency (Hz)	60 Hz		
DIMENSION & WEIGHT			
Product Dimension (W x D x H) (in)	36"W x 28.38"D x 8.72"H		
Required Cutout Size (W x D x H) (in)	36 1/8"W x 24.77"D x 7.3"H		
Product Net Weight	90 lbs.		
Adjustable Range Legs	1/2"		
ACCESSORIES (NOT INCLUDED)			
LPKHRT3618U	Liquid Propane Gas Conversion Kit		
RG1022	Cast Iron Reversible Gridde		
RG1032	Cast Iron Range Griddle		



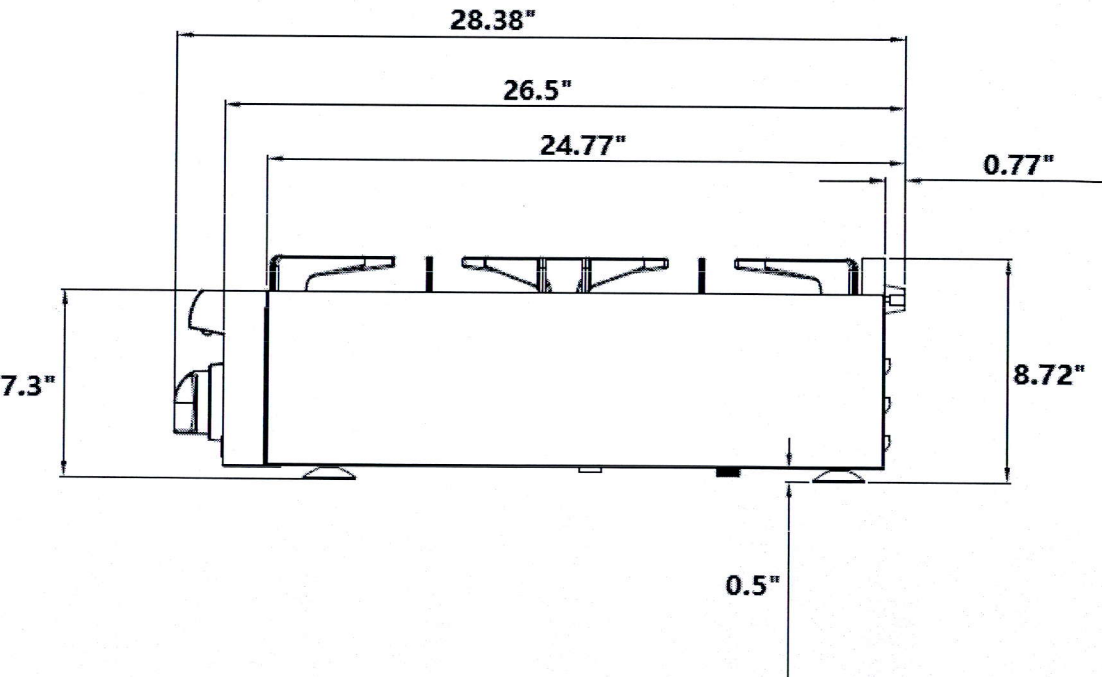
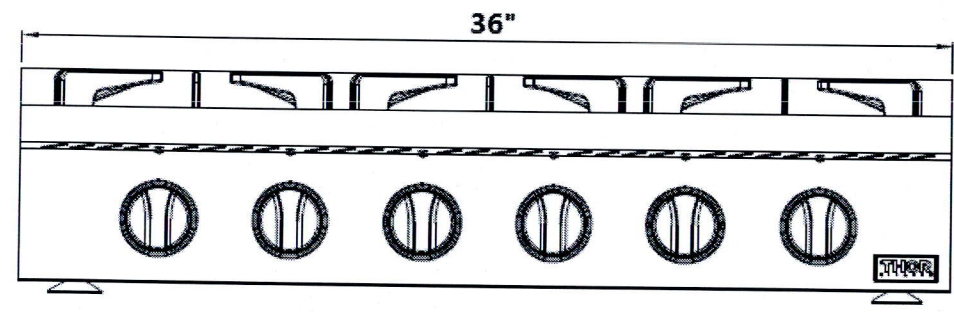
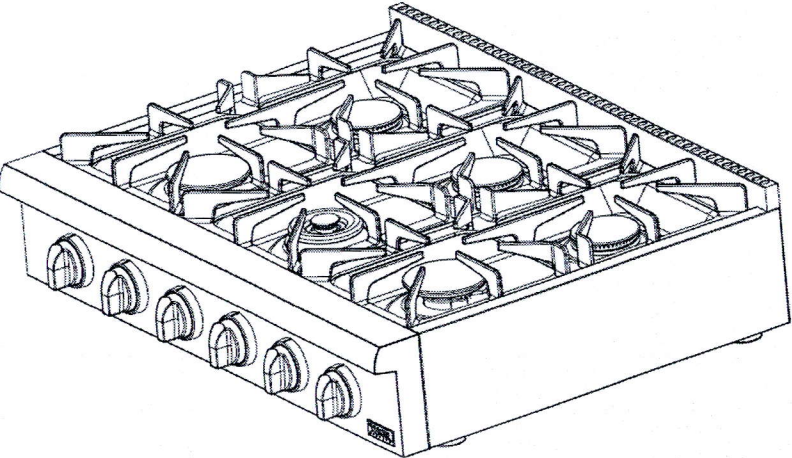
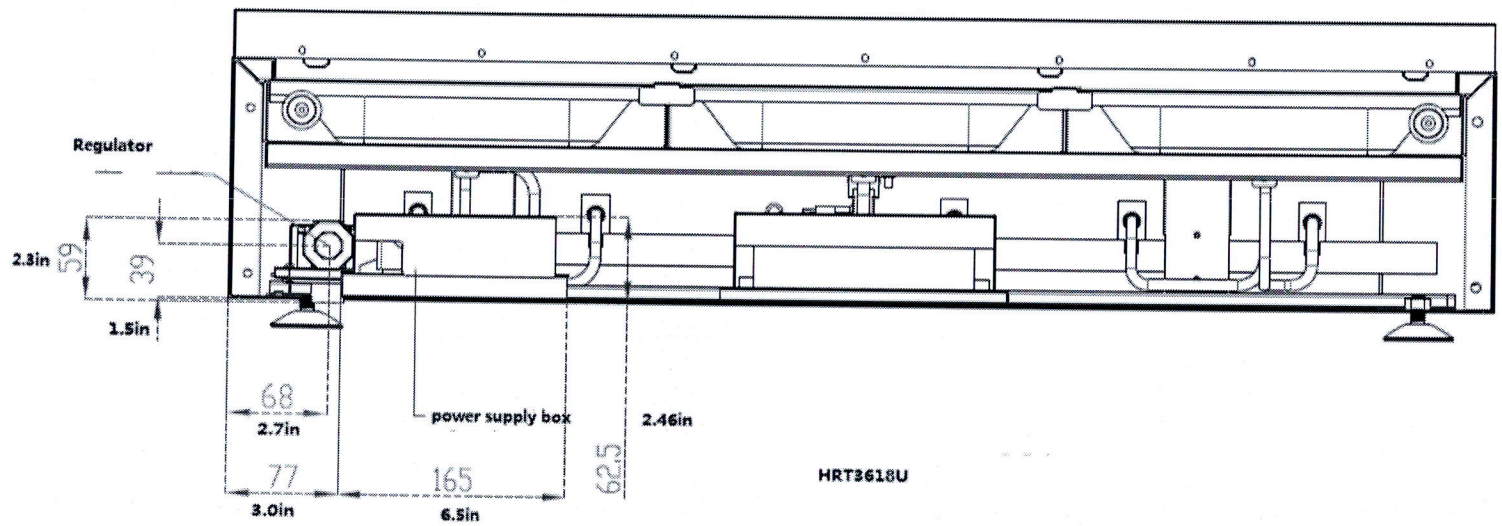

DIMENSIONES

OPENING/CLEARANCE DIMENSIONS

MODEL #	SLIM TRIM KIT MODELS		STANDARD TRIM KIT MODELS	
	YWMT50011K / YKMBT5011K		YWMT55511K / YKMBT5511K	
Unit of Measurement	in	cm	in	cm
Width of cabinet opening (min.)* (A)	30	76.2	30	76.2
Width of cutout (B)	28 <sup>1</sup> / <sub>2</sub>	72.4	28 <sup>1</sup> / <sub>2</sub>	72.4
Height of cutout (C)	12	30.5	17 <sup>1</sup> / <sub>8</sub>	43.5
Top of cutout to bottom of upper cabinet door (min.) (D)	2	5.1	2	5.1
Bottom of cutout to top of lower cabinet door (min.) (E)	1 <sup>9</sup> / <sub>16</sub>	4	1 <sup>9</sup> / <sub>16</sub>	4
Depth of cutout (min.) (F)	21 <sup>3</sup> / <sub>4</sub>	55.2	21 <sup>3</sup> / <sub>4</sub>	55.2
Bottom of cutout to floor (min.) (G)	36	91.4	36	91.4
Back of the microwave oven to the surface of junction box (H)	4" (10.2 cm) < H < 40" (102 cm)			
Recommended junction box location (e)	Upper right quadrant			
Can this product be installed flush? Flush refers to the appliance not protruding past the cabinet depth. (Y/N) (J)	N			

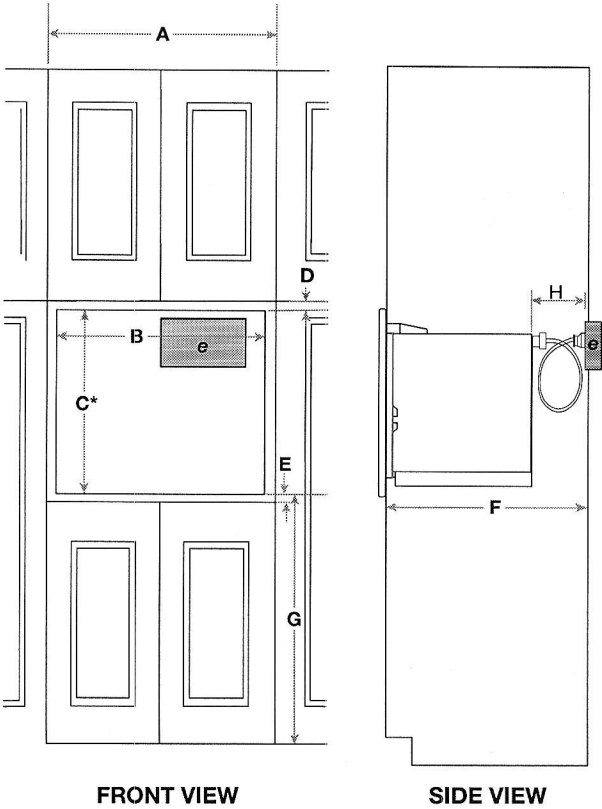

ELECTRICAL REQUIREMENTS

120 V, 60 Hz, AC only, 15 or 20 A fused, electrical supply is required. A time-delay fuse or dedicated circuit is recommended. Use a grounded 3 prong outlet. Do not use an extension cord.

LOCATION REQUIREMENTS

- This is a built-in appliance. Do not use as countertop microwave oven.
- Minimum of 36" from the floor to cut-out floor.
- Complete enclosure around the recessed portion of the microwave oven.
- This microwave oven must be installed into a wood cabinetry. The location must provide:
  1. Cutout opening that is plumb and square.
  2. Cutout floor that is solid, level and flush with bottom of cabinet cutout.
  3. Support for weight of at least 150 lbs (68 kg), which includes microwave oven and items placed inside.

**IMPORTANT:** Dimensional specifications are provided for planning purposes only.  
**Do not make any cutouts based on this information.** Refer to the Installation Guide before selecting cabinetry, verifying electrical/gas connections, making cutouts or beginning installation.  
All Whirlpool® appliances are appropriately UL, CUL or CSA approved.

# 27" (68.6 CM) AND 30" (76.2 CM) ELECTRIC SINGLE AND DOUBLE BUILT-IN OVEN

## PRODUCT MODEL NUMBERS

KODE300E	KODT100E	KOST100E
KODE307E	KODT107E	KOST107E
KODE500E	KOSE500E	KEBS109E
KODE507E	KOSE507E	KEBS209E

**Electrical:** To properly install your oven, you must determine the type of electrical connection you will be using and follow the instructions provided for it here.

- Oven must be connected to the proper electrical voltage and frequency as specified on the model/serial number rating plate. The model/serial number rating plate is located under the control panel on single ovens and under the control panel on the upper oven cavity on double ovens. See the following illustrations.

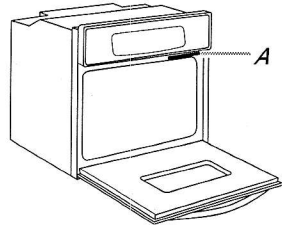

**Single Oven**

A. Model/serial number plate

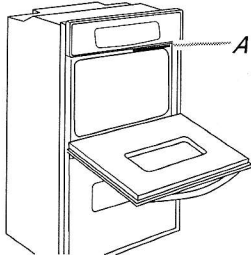

**Double Oven**

A. Model/serial number plate

- Models rated from 7.3 to 9.6 kW at 240 volts (5.4 to 7.4 kW at 208 volts) require a separate 40-amp circuit. Models rated at 4.8 kW and below at 240 volts (3.6 kW and below at 208 volts) require a separate 20-amp circuit.
- A circuit breaker is recommended.
- Connect directly to the circuit breaker box (or fused disconnect) through flexible, armored or nonmetallic sheathed, copper cable (with grounding wire). See "Make Electrical Connection" section.
- Flexible conduit from the oven should be connected directly to the junction box.
- Fuse both sides of the line.
- Do not cut the conduit. The length of conduit provided is for serviceability of the oven.
- A UL listed or CSA approved conduit connector must be provided.
- If the house has aluminum wiring, follow the procedure below:
  - Connect a section of solid copper wire to the ends of the flexible conduit leads.
  - Connect the aluminum wiring to the added section of copper wire using special connectors and/or tools designed and UL listed for joining copper to aluminum.

Follow the electrical connector manufacturer's recommended procedure. Aluminum/copper connection must conform with local codes and industry accepted wiring practices.

For power requirements for models KOST107E, KOST100E, KOSE507E, KOSE500E, KODE307E, KODE300E, KODE507E, KODE500E, KODT100E and KODT107E, refer to the following table.

Voltage	Single Thermal	Single Convect	Double Thermal	Double Convect	Double Convect/Thermal
240 VAC	4100 W	4100 W	8163 W	8300 W	8300 W
208 VAC	3100 W	3100 W	6300 W	6300 W	6300 W
240 VAC	17.2 A	17.2 A	34.2 A	34.2 A	34.2 A
208 VAC	15.0 A	15.0 A	29.9 A	29.9 A	29.9 A

Because Whirlpool Corporation includes a continues commitment to improve our products, we reserve the right to change materials and specifications without notice.

## PRODUCT DIMENSIONS

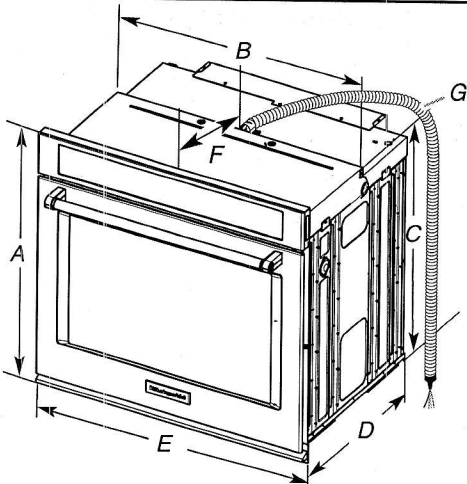

### 27" (68.6 cm) models

- A. 28<sup>3</sup>/<sub>4</sub>" (72.8 cm) max. overall height
- B. 25<sup>7</sup>/<sub>16</sub>" (64.6 cm) max. recessed width
- C. 26<sup>3</sup>/<sub>4</sub>" (67.9 cm) recessed height
- D. 23<sup>1</sup>/<sub>4</sub>" (59.1 cm) max. recessed depth
- E. 27" (68.6 cm) overall width
- F. 12" (30.5 cm) from back of control panel to start of strain relief
- G. 48" (121.9 cm) flexible conduit length

### 30" (76.2 cm) models

- A. 28<sup>3</sup>/<sub>4</sub>" (72.8 cm) max. overall height
- B. 28<sup>1</sup>/<sub>2</sub>" (72.4 cm) max. recessed width
- C. 26<sup>3</sup>/<sub>4</sub>" (67.9 cm) recessed height
- D. 23<sup>1</sup>/<sub>4</sub>" (59.1 cm) max. recessed depth
- E. 30" (76.2 cm) overall width
- F. 12" (30.5 cm) from back of control panel to start of strain relief
- G. 48" (121.9 cm) flexible conduit length

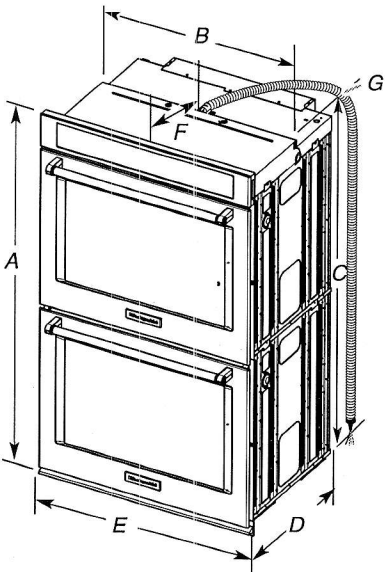

### 27" (68.6 cm) models

- A. 51<sup>1</sup>/<sub>16</sub>" (130.0 cm) max. overall height
- B. 25<sup>7</sup>/<sub>16</sub>" (64.6 cm) max. recessed width
- C. 48<sup>13</sup>/<sub>16</sub>" (124.0 cm) recessed height
- D. 23<sup>1</sup>/<sub>4</sub>" (59.1 cm) max. recessed depth
- E. 27" (68.6 cm) overall width
- F. 12" (30.5 cm) from back of control panel to start of strain relief
- G. 66" (167.6 cm) flexible conduit length

### 30" (76.2 cm) models

- A. 51<sup>1</sup>/<sub>16</sub>" (130.0 cm) max. overall height
- B. 28<sup>1</sup>/<sub>2</sub>" (72.4 cm) max. recessed width
- C. 48<sup>13</sup>/<sub>16</sub>" (124.0 cm) recessed height
- D. 23<sup>1</sup>/<sub>4</sub>" (59.1 cm) max. recessed depth
- E. 30" (76.2 cm) overall width
- F. 12" (30.5 cm) from back of control panel to start of strain relief
- G. 66" (167.6 cm) flexible conduit length

Dimensions are for planning purposes only. For complete details, see Installation Instructions packed with product. Specifications subject to change without notice.

CABINET DIMENSIONS - SINGLE OVENS

Single Oven Undercounter (without cooktop installed above)

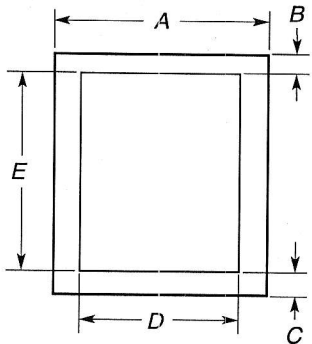

- |   |   |
|---|---|
| <b>27" (68.6 cm) models</b>                                   | <b>30" (76.2 cm) models</b>                                   |
| A. 27" (68.6 cm) min. cabinet width                           | A. 30" (76.2 cm) min. cabinet width                           |
| B. 1½" (3.8 cm) min. top of cutout to underside of countertop | B. 1½" (3.8 cm) min. top of cutout to underside of countertop |
| C. 5¼" (13.3 cm) bottom of cutout to floor                    | C. 5¼" (13.3 cm) bottom of cutout to floor                    |
| D. 25½" (64.8 cm) cutout width                                | D. 28½" (72.4 cm) cutout width                                |
| E. 28" (71.2 cm) min. cutout height                           | E. 28" (71.2 cm) min. cutout height                           |

Single Ovens Installed in Cabinet

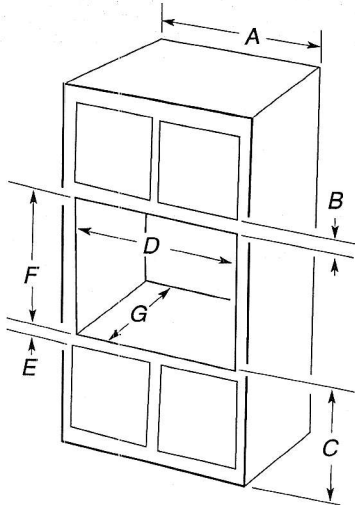

- |  |  |
|--|--|
| <b>27" (68.6 cm) models</b>                                  | <b>30" (76.2 cm) models</b>                                  |
| A. 27" (68.6 cm) min. cabinet width                          | A. 30" (76.2 cm) min. cabinet width                          |
| B. 1" (2.5 cm) top of cutout to bottom of upper cabinet door | B. 1" (2.5 cm) top of cutout to bottom of upper cabinet door |
| C. 32" (81.3 cm) bottom of cutout to floor                   | C. 32" (81.3 cm) bottom of cutout to floor                   |
| D. 25½" (64.8 cm) cutout width                               | D. 28½" (72.4 cm) cutout width                               |
| E. 1½" (3.8 cm) min. bottom of cutout to top of cabinet door | E. 1½" (3.8 cm) min. bottom of cutout to top of cabinet door |
| F. 28" (71.2 cm)* recommended cutout height                  | F. 28" (71.2 cm)* recommended cutout height                  |
| G. 24" (60.7 cm) cutout depth                                | G. 24" (60.7 cm) cutout depth                                |

**\*NOTE:** The cutout height can be between 26<sup>15</sup>/<sub>16</sub>" (68.4 cm) and 29<sup>7</sup>/<sub>16</sub>" (74.8 cm) for single ovens.

CABINET DIMENSIONS - SINGLE OVENS

Double Ovens Installed in Cabinet

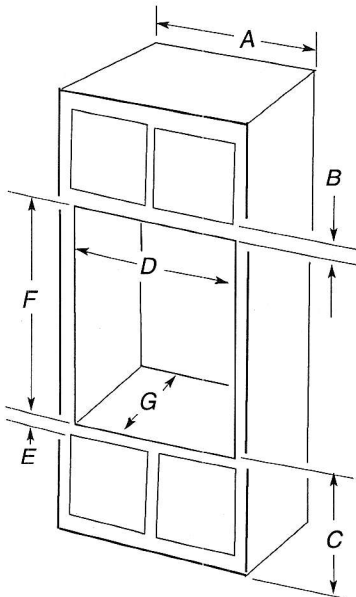

- |   |   |
|---|---|
| <b>27" (68.6 cm) models</b>   | <b>30" (76.2 cm) models</b>   |
| A. 27" (68.6 cm) min. cabinet width   | A. 30" (76.2 cm) min. cabinet width   |
| B. 1" (2.5 cm) top of cutout to bottom of upper cabinet door  | B. 1" (2.5 cm) top of cutout to bottom of upper cabinet door  |
| C. 14¾" (37.5 cm) bottom of cutout to floor is recommended. 4"-14¾" (10.2-37.5 cm) bottom of cutout to floor is acceptable. | C. 14¾" (37.5 cm) bottom of cutout to floor is recommended. 4"-14¾" (10.2-37.5 cm) bottom of cutout to floor is acceptable. |
| D. 25½" (64.8 cm) cutout width  | D. 28½" (72.4 cm) cutout width  |
| E. 1½" (3.8 cm) min. bottom of cutout to top of cabinet door  | E. 1½" (3.8 cm) min. bottom of cutout to top of cabinet door  |
| F. 50¼" (127.6 cm)* recommended cutout height   | F. 50¼" (127.6 cm)* recommended cutout height   |
| G. 24" (60.7 cm) cutout depth   | G. 24" (60.7 cm) cutout depth   |

**\*NOTE:** The cutout height can be between 48<sup>7</sup>/<sub>8</sub>" (124.1 cm) and 52<sup>3</sup>/<sub>16</sub>" (132.6 cm) for double ovens.



DIMENSIONS

MICROWAVE OVEN  
PRODUCT DIMENSIONS

MODEL #	SLIM TRIM KIT MODELS		STANDARD TRIM KIT MODELS	
	YWMT50011K / YKMBT5011K		YWMT55511K / YKMBT5511K	
Unit of Measurement	in	cm	in	cm
Overall width of microwave (A)	27 <sup>13</sup> / <sub>16</sub>	70.7	27 <sup>13</sup> / <sub>16</sub>	70.7
Overall height of microwave (B)	10 <sup>5</sup> / <sub>16</sub>	26.2	10 <sup>5</sup> / <sub>16</sub>	26.2
Height of the door (C)	10 <sup>5</sup> / <sub>16</sub>	26.2	10 <sup>5</sup> / <sub>16</sub>	26.2
Depth without door (D)	16 <sup>3</sup> / <sub>8</sub>	41.6	16 <sup>3</sup> / <sub>8</sub>	41.6
Depth with door (E)	18	45.7	18	45.7
Depth with door open 90° (F)	42 <sup>1</sup> / <sub>8</sub>	107	42 <sup>1</sup> / <sub>8</sub>	107
Distance from fixed wall to door open 90° (G)	1/2	1.3	1/2	1.3

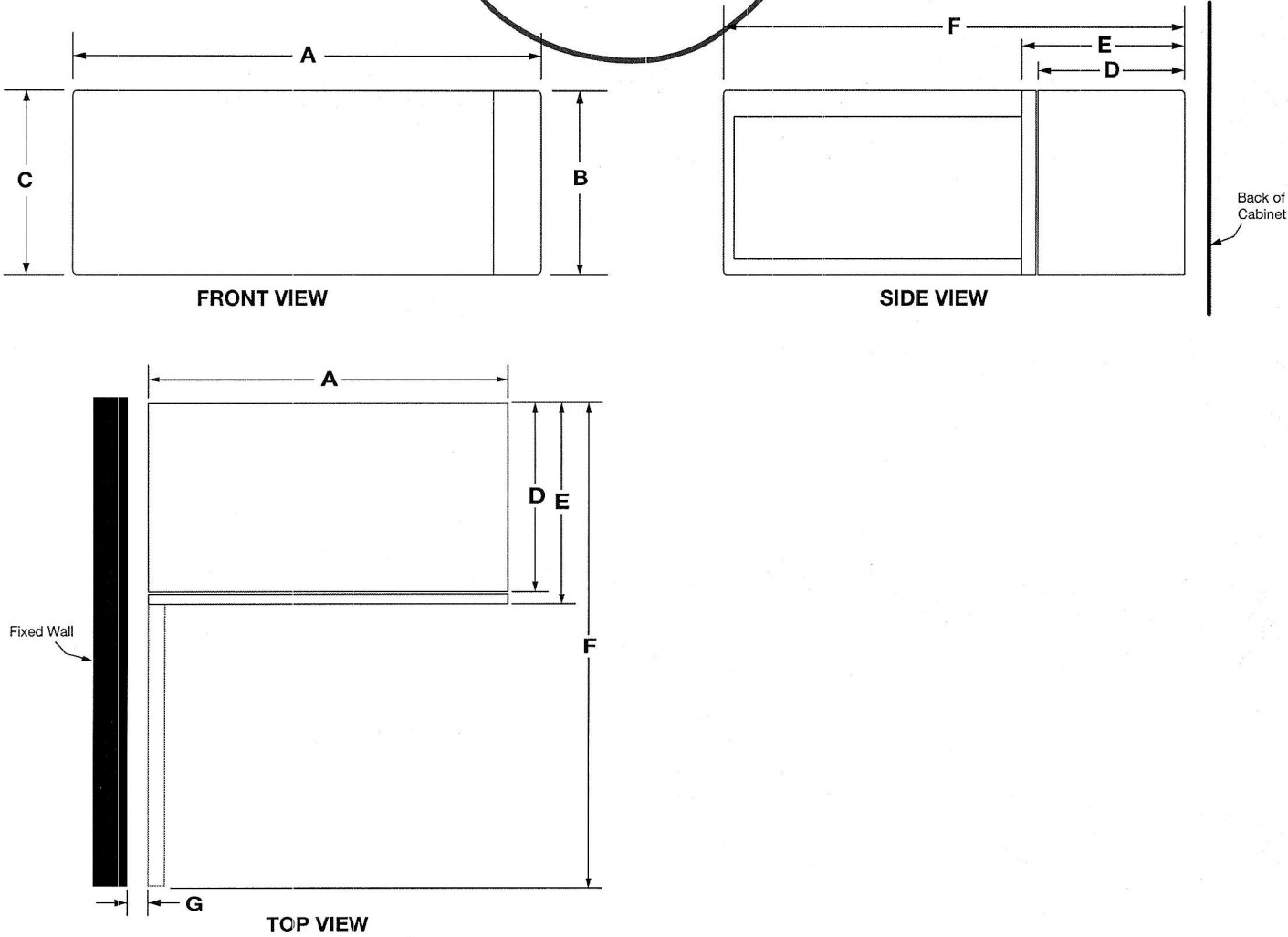

**IMPORTANT:** Dimensional specifications are provided for planning purposes only.  
**Do not make any cutouts based on this information.** Refer to the Installation Guide before selecting cabinetry, verifying electrical/gas connections, making cutouts or beginning installation.  
All Whirlpool® appliances are appropriately UL, CUL or CSA approved.



DIMENSIONS

TRIM KIT FRAME DIMENSIONS

MODEL #	SLIM TRIM KIT MODELS		STANDARD TRIM KIT MODELS	
	YWMT50011K / YKMBT5011K		YWMT55511K / YKMBT5511K	
Unit of Measurement	in	cm	in	cm
Overall width of trim kit frame (H)	29 <sup>3</sup> / <sub>4</sub>	75.6	29 <sup>3</sup> / <sub>4</sub>	75.6
Overall height of trim kit frame (J)	14	35.6	19 <sup>1</sup> / <sub>8</sub>	48.6
Trim kit frame inner opening height (K)	10 <sup>9</sup> / <sub>16</sub>	26.9	10 <sup>9</sup> / <sub>16</sub>	26.9
Width of trim kit inner opening (L)	28	71.1	28	71.1
Depth of trim kit frame (M)	2 <sup>5</sup> / <sub>16</sub>	5.8	2 <sup>5</sup> / <sub>16</sub>	5.8
Trim kit frame thickness (visible) (N)	7/8	2.2	7/8	2.2

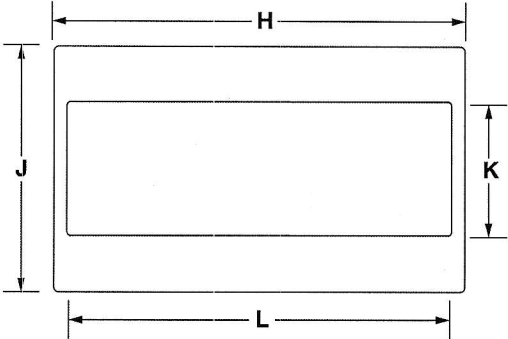

FRONT VIEW

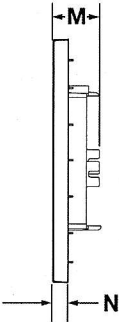

SIDE VIEW

**IMPORTANT:** Dimensional specifications are provided for planning purposes only.  
**Do not make any cutouts based on this information.** Refer to the Installation Guide before selecting cabinetry, verifying electrical/gas connections, making cutouts or beginning installation.  
All Whirlpool® appliances are appropriately UL, CUL or CSA approved.

DIMENSIONS

DIMENSION AS INSTALLED

MODEL #	SLIM TRIM KIT MODELS		STANDARD TRIM KIT MODELS	
	YWMT50011K / YKMBT5011K		YWMT55511K / YKMBT5511K	
Opening/Clearance Measurement	in	cm	in	cm
Height of the door (A)	10 <sup>5</sup> / <sub>16</sub>	26.2	10 <sup>5</sup> / <sub>16</sub>	26.2
Overall height of trim kit frame (B)	14	35.6	19 <sup>1</sup> / <sub>8</sub>	48.6
Overall height of microwave (C)	10 <sup>5</sup> / <sub>16</sub>	26.2	10 <sup>5</sup> / <sub>16</sub>	26.2
Overall height with rail (D)	11 <sup>9</sup> / <sub>64</sub>	28.3	11 <sup>9</sup> / <sub>64</sub>	28.3
Depth with door (E)	18	45.7	18	45.7
Depth with door open 90° (F)	42 <sup>1</sup> / <sub>8</sub>	93.7	42 <sup>1</sup> / <sub>8</sub>	93.7
Trim kit frame overhang-upper frame (G)	1	2.6	1	2.6
Trim kit frame overhang-lower frame (H)	1	2.6	1	2.6
Overall width of trim kit frame (J)	29 <sup>3</sup> / <sub>4</sub>	75.6	29 <sup>3</sup> / <sub>4</sub>	75.6
Overall height of microwave (K)	10 <sup>5</sup> / <sub>16</sub>	26.2	10 <sup>5</sup> / <sub>16</sub>	26.2
Overall height of trim kit frame (L)	14	35.6	19 <sup>1</sup> / <sub>8</sub>	48.6
Trim kit frame overhang-left frame (M)	5/8	1.6	5/8	1.6
Trim kit frame overhang-right frame (N)	5/8	1.6	5/8	1.6
Distance from fixed wall to door open 90° (P)	1/2	1.3	1/2	1.3

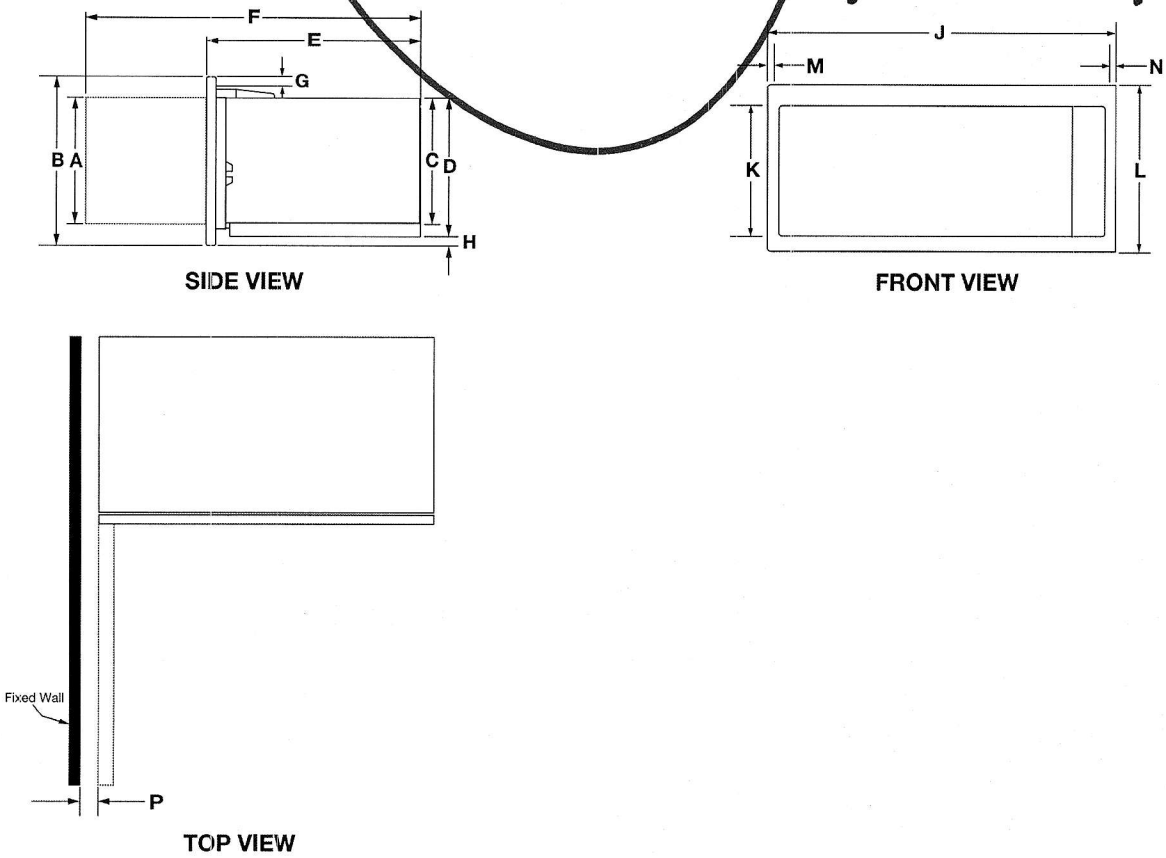

**IMPORTANT:** Dimensional specifications are provided for planning purposes only.  
**Do not make any cutouts based on this information.** Refer to the Installation Guide before selecting cabinetry, verifying electrical/gas connections, making cutouts or beginning installation.  
All Whirlpool® appliances are appropriately UL, CUL or CSA approved.

Silhouette

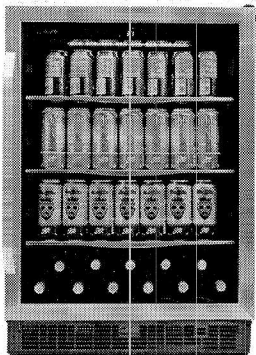

PRODUCT DESCRIPTION

Which type of beverage are you seeking a powerfully-cooled place for? Whatever your chilled choice of decadent drink may be, this beverage center is outfitted to accommodate. This cooler will undoubtedly make you the host with the most options of indulgence.

SPECIFICATIONS

Dimensions

Width	60cm	23.8"
Depth	60cm	23.75"
Height	881cm	347"

Capacity

Bottle Capacity 750ml	138
Can capacity 330ml	11

Temperature Range

Temperature	Low: 37 °F	High: 64 °F
-------------	------------	-------------

WARRANTY

The Silhouette SBC057D1BSS model comes with a 24-month warranty on parts and labour with convenient in-home service. The installation and yearly maintenance (cleaning) of the fridge are not covered under the warranty.

RICCOTTA

24" Single Zone Beverage Center - SBC057D1BSS

PRODUCT FEATURES

STAY COOL, STAY FROSTY

Big Game, Big BBQ or Big Holiday this model will keep all your Bevvies well chilled all year long. Ample storage of up to 138 cans and 11 bottles of wine will keep your guests happy and hydrated.

DISCREET AND ELEGANT

The minimalist control panel has a clean discreet look and is easy to use.

NEVER BE LEFT IN THE DARK

The true, blue LED track lighting that illuminates the interior of this unit exquisitely displays your wine without any damaging heat. It is 50% brighter than the previous model and now offers 3 lighting options.

Where some see room for an appliance;  
We see room for an experience

[www.silhouetteappliances.com](http://www.silhouetteappliances.com)

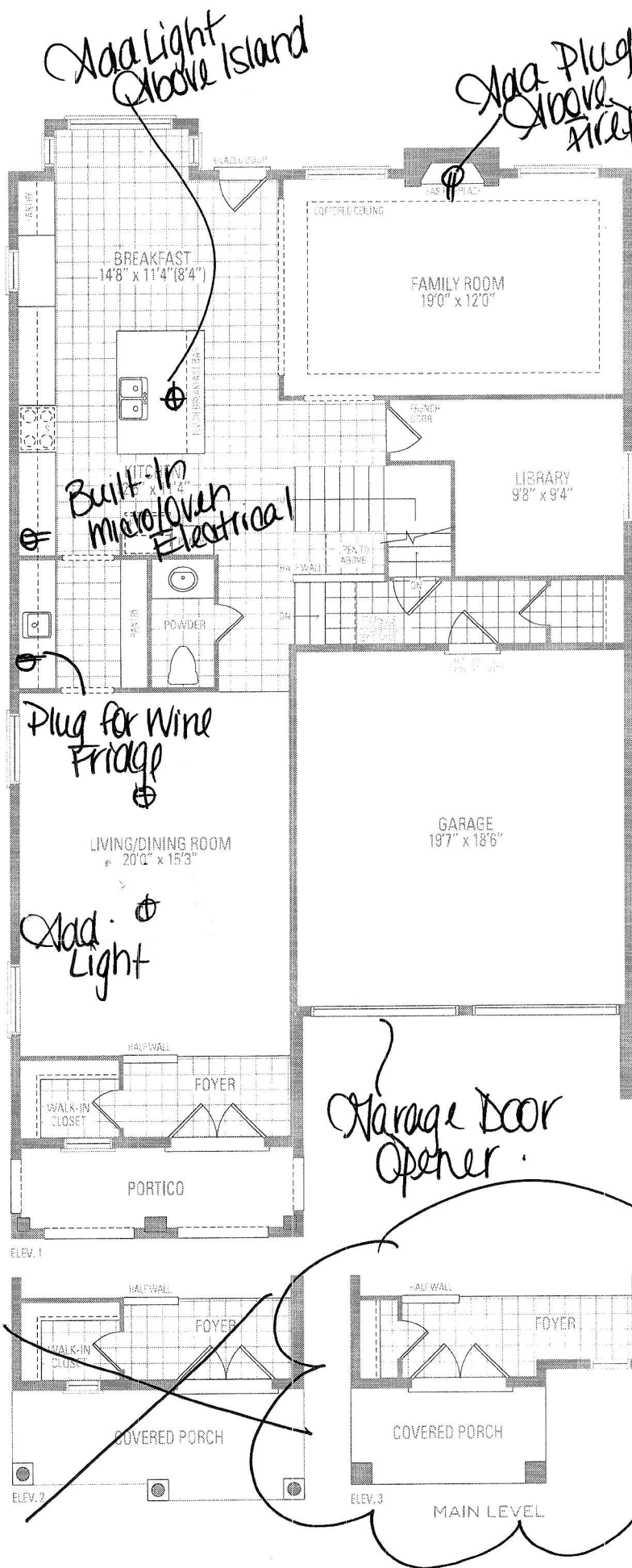

Walk-up  
Larger Basement Windows

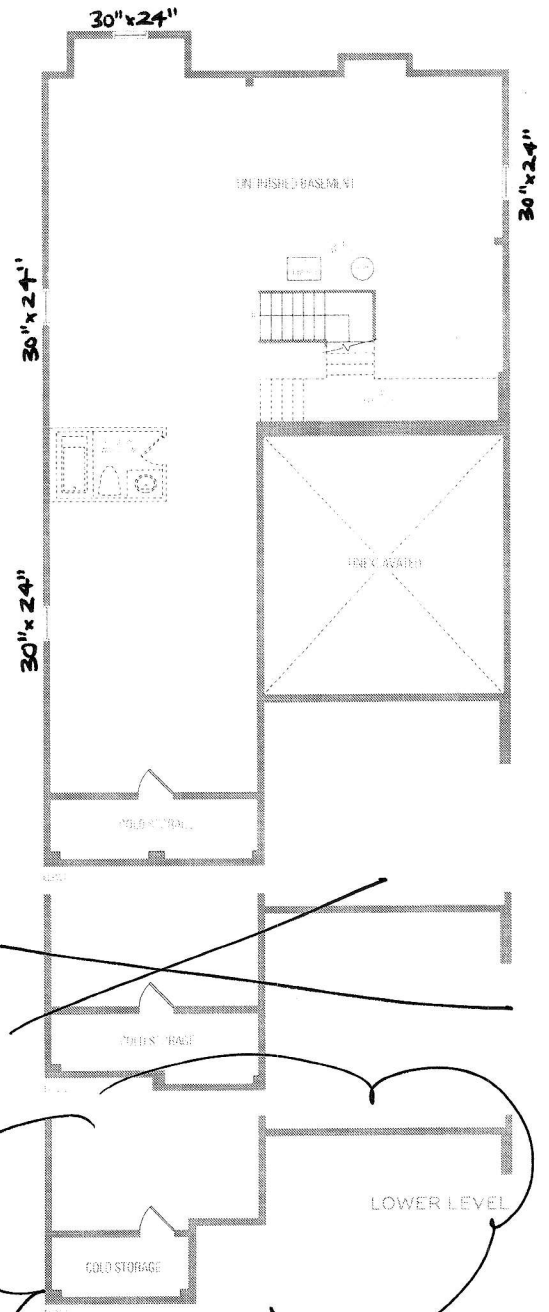

200 AMP

## MOUNTAINASH SIX ELEV. 1 • 3,409 sq.ft. | ELEV. 2 • 3,403 s

Orientation of home may be reversed and purchaser agrees to accept the same. Steps and porches may vary at any exterior entrance ways the stated floor areas. All renderings are artist's concept. Dimensions, specifications and architectural detailing subject to modifications. Roofline



# MOUNTAINASH SIX

ELEV. 1 • 3,409 sq.ft. | ELEV. 2 • 3,403 sq.ft. | ELEV. 3 • 3,368 sq.ft.

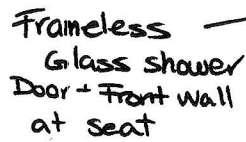

RECEIVED

SEP 18 2020

