

CONSTRUCTION SUMMARY

Reesor Ridge At Wismer - Lampone Investments Inc.

PURCHASERS: Tung-Ting Donald NG and Cathy NGO

TEL:

LOT / PHASE 95 / 1	REG. PLAN # 65M-4573	HOUSE TYPE Kimberly 1 Elev 3		
-----------------------	-------------------------	---------------------------------	--	--

CONSTRUCTION

3 - ENLARGE BASEMENT WINDOWS (MAY REQUIRE WINDOW WELLS) - WINDOW IS 30 INCHES X 24 INCHES 04Aug20 Note:	
--	--

DOORS AND TRIM

1 - TRIM - UPGRADE 2- 5-1/4" ONE STEP BASEBOARD AND 3" ONE STEP CASING 27May21 Note:	
---	--

ELECTRICAL

1 - RELOCATE STANDARD KITCHEN LIGHT TO BE CENTERED OVER ISLAND 27May21 Note:	
2 - LIGHT AND SWITCH - NO FIXTURE INCLUDED 27May21 Note: KITCHEN ABOVE ISLAND X2	
1 - PLUG - ELECTRICAL PLUG - TO BE INSTALLED OVER FIREPLACE 27May21 Note:	
1 - 200 AMP ELECTRICAL SERVICE 04Aug20 Note:	

FIREPLACE AND ACCESSORIES

1 - MANTEL - CAST STONE - AEQUALITAS 1 STYLE MANTEL - TIMELES GREY 27May21 Note:	
---	--

HARDWOOD FLOORING

1 - HARDWOOD - GROUP A SERIES 5 INCH - IN LIEU OF 2 1/4 INCH NATURAL RED OAK - - LIVING AND DINING ROOM 27May21 Note:	
1 - HARDWOOD - GROUP A SERIES 5 INCH - IN LIEU OF 2 1/4 INCH NATURAL RED OAK - - FAMILY ROOM 27May21 Note:	

PLUMBING

1 - DELTA - SINGLE SETTING RAINCAN SHOWER HEAD - CHROME - MODEL# RP51305 WITH CEILING MOUNT SHOWER ARM AND FLANGE - CHROME - MODEL# U4999 27May21 Note: DELETE STANDARD SHOWER HEAD	
1 - WATER LINE FOR FRIDGE - ROUGH-IN ONLY 27May21 Note:	
2 - TOE TESTER - ADD TOE TESTER TO SHOWER 04Aug20 Note:	

PROMOTIONAL

1 - LESS BALANCE OF CREDIT FROM PURCHASER EXTRA SHEET IN OFFER 27May21 Note:	
1 - LESS CREDIT FROM PURCHASER EXTRA SHEET IN OFFER 04Aug20 Note: PROMO AS PE OFFER \$10,00.00 LESS \$2620.00 NEW BALANCE \$7380.00	

STAIRS AND RAILINGS



CONSTRUCTION SUMMARY

Reesor Ridge At Wismer - Lampone Investments Inc.

PURCHASERS: Tung-Ting Donald NG and Cathy NGO TEL:

LOT / PHASE	REG. PLAN #	HOUSE TYPE		
95 / 1	65M-4573	Kimberly 1 Elev 3		
1 - EUROLINE CONTEMPORARY PICKETS 27May21 Note: BLACK IRON PICKETS				
1 - V GROOVE HANDRAIL 27May21 Note:				
1 - STAINED STAIRS – STANDARD STAIRCASE - PRICE IS PER SET 27May21 Note:				

EXTRAS AS PER OFFER

PURCHASER(S) ACKNOWLEDGES THAT THE PURCHASE PRICE IS INCLUSIVE OF ALL CREDITS AND PROMOTIONAL PACKAGES AVAILABLE AT TIME OF PURCHASE. Worksheet Note:	
(Single Detached) The Vendor agrees that notwithstanding any other term or provision in this Agreement included in the Purchase Price and in addition to those items detailed in Schedule GP to the Agreement of Purchase and Sale, the Purchaser is entitled Worksheet Note:	

This Document is Extremely Time Sensitive - Printed 27 May 21 at 13:21

Purchasers: Tung-Ting Donald NG & Cathy NGO

Property: 95

Telephone Res. / Bus: /

Project: Lampone Investments Inc.

Decor Advisor: Aly Aversa

Model and Elevation: Kimberly 1 Elev 3

Lock Date: 27-May-21

27-May-21

Plan #: 65M-4573

Layout Changes: ☐ Yes ☒ No

Sketch Attached: ☐ Yes ☒ No

Exterior Colour Scheme:

1. Cabinetry

	Style and Colour	Hardware
Kitchen / Breakfast	MONACO 823 DRIFT WOOD	431SA
Laundry Room	ELISSE	Standard
Powder Room	MONACO 823 DRIFT WOOD	431SA
Master Ensuite Bathroom	MONACO 904 INK	431SA
Ensuite Bath - Bedroom 2/3	MONACO 350 PLATINUM SILVER	431SA
Ensuite Bath - Bedroom 4	MONACO 904 INK	431SA

Appliances:

Built In Appliances ☐ Yes ☒ No

Slide In Stove ☐ Yes ☒ No

Dishwasher Cabinet

☐ Closed ☒ Open

41" Upper Cabinets ☒ Yes ☐ No

Please NOTE: Standard Cabinet Height is 30"

Stove Opening

NOTE: If not specified, opening will be set to builder's standard opening of approximately 30" width

Fridge Opening

48 INCH

NOTE: If not specified, opening will be set to builder's standard opening of approximately 37" width x 74" height

** Refer to Construction Summary ** NO FULL DEPTH ABOVE THE FRIDGE **

2. Counters

	Counter	Edge
Kitchen / Breakfast	LAMINATE-CALCUTTA MARBLE 4925K-07	
Laundry Room	N/A	
Powder Room	LAMINATE-WHITE CARRARA 4924-38	
Master Ensuite Bathroom	LAMINATE-CARRARA BIANCO 6696-46	
Ensuite Bath - Bedroom 2/3	LAMINATE-WHITE CARRARA 4924-38	
Ensuite Bath - Bedroom 4	LAMINATE-CARRARA BIANCO 6696-46	

** Refer to Construction Summary

Initials:

Purchasers:

Tung-Ting Donald NG & Cathy NGO

Property: 95

Telephone Res. / Bus:

/

Project: Lampone Investments Inc.

Decor Advisor:

Aly Aversa

Model and Elevation: Kimberly 1 Elev 3

Lock Date:

27-May-21

27-May-21

Plan #: 65M-4573

3. Ceramic Flooring

Entrance Vestibule

TILE-RAINBOW WHITE 13X13

At a 45 Threshold-If App.

Metal Strip Where Applic.

Main Hall

N/A

Kitchen / Breakfast

TILE-RAINBOW WHITE 13X13

Laundry Room

TILE-COLOURS NERO 13X13

Powder Room

TILE-RAINBOW WHITE 13X13

Master Ensuite Bathroom

TILE-RAINBOW WHITE 13X13

Ensuite Bath - Bedroom 2/3

TILE-ESSENZE GRIGIO 13X13

Ensuite Bath - Bedroom 4

TILE-RAINBOW LIGHT GREY 13X13

SIDE ENTRANCE

TILE-RAINBOW WHITE 13X13

** Refer to Construction Summary

4. Ceramic Wall Tile

Master Ensuite Bathroom	Selection	Describe
Tub Deck Wall	N/A	
Tub Deck	N/A	
Tub Deck Skirt	N/A	
Shower Stall	TILE-LUC. 09 AFRICA 8X16	
Bathtub Enclosure Walls	N/A	
Ensuite Bath - Bedroom 2/3	TILE-LUC. BLANC GROENLANDIA 8X16	
Ensuite Bath - Bedroom 4	TILE-LUC. 09 AFRICA 8X16	
SIDE ENTRANCE	N/A	
Kitchen Backsplash	N/A	

** Refer to Construction Summary - STANDARD GROUT THROUGHOUT UNLESS SPECIFIED

5. Plumbing Fixtures

All Bathrooms

White

Whirlpool

Yes

No

Dishwasher Rough-In

Yes

No

Waterline for Fridge

Yes

No

** Refer to Construction Summary

6. Trim Carpentry

Interior Doors

As Per Construction Specifications

Interior Trim

BB CASING WITH 5 1/4" BASEBOARD - ONE STEP

Door Handles

As Per Construction Specifications

Exterior Front Door Handle

As Per Construction Specifications

** Refer to Construction Summary

7. Other Flooring

Purchasers:

Tung-Ting Donald NG & Cathy NGO

Property: 95

Telephone Res. / Bus:

/

Project: Lampone Investments Inc.

Decor Advisor:

Aly Aversa

Model and Elevation: Kimberly 1 Elev 3

Lock Date:

27-May-21

27-May-21

Plan #: 65M-4573

7. Other Flooring

Main Hall	HARDWOOD-VINTAGE-NORTHERN SOLID SAWN COLLECTION CHARACTER PEARL MAPLE 5" NOVA	
Living Room	HARDWOOD-VINTAGE-NORTHERN SOLID SAWN COLLECTION CHARACTER PEARL MAPLE 5" NOVA	
Dining Room	HARDWOOD-VINTAGE-NORTHERN SOLID SAWN COLLECTION CHARACTER PEARL MAPLE 5" NOVA	
Family Room	HARDWOOD-VINTAGE-NORTHERN SOLID SAWN COLLECTION CHARACTER PEARL MAPLE 5" NOVA	
Den / Library / Study	N/A	
Basement Landing(If Applies)	N/A	
Lower Landing (If Applies)	HARDWOOD-VINTAGE-NORTHERN SOLID SAWN COLLECTION CHARACTER PEARL MAPLE 5" NOVA	
Upper Landing	HARDWOOD-VINTAGE-NORTHERN SOLID SAWN COLLECTION CHARACTER PEARL MAPLE 5" NOVA	
Upper Hall	LAMINATE-LEXINGTON-ROCHEFORT OAK-TL-LW1317	
Master Bedroom	LAMINATE-LEXINGTON-ROCHEFORT OAK-TL-LW1317	
Bedroom #2	LAMINATE-LEXINGTON-ROCHEFORT OAK-TL-LW1317	
Bedroom #3	LAMINATE-LEXINGTON-ROCHEFORT OAK-TL-LW1317	
Bedroom #4	LAMINATE-LEXINGTON-ROCHEFORT OAK-TL-LW1317	
Bedroom #5	N/A	
Underpad	Type	Area
	N/A	N/A

** Refer to Construction Summary

8. Railings and Pickets

Railing Type	V-GROOVE	Colour	VINTAGE-MAPLE-NOVA
Picket Type	EUROLINE CONTEMPORARY	Colour	BLACK
Stringer / Riser	AS PER CONSTRUCTION SPECIFICATIO	Colour	VINTAGE-MAPLE-NOVA
Treads	AS PER CONSTRUCTION SPECIFICATIO	Colour	VINTAGE-MAPLE-NOVA
Red Oak Stairs with Semi Gloss Finish		<input checked="" type="radio"/> Yes <input type="radio"/> No	

** Refer to Construction Summary THE STAIN COLOURS OR FINISH AVAILABLE ON RISERS, TREADS, PICKETS AND RAILS (STAIRCASES), WILL NOT BE AN EXACT MATCH TO PREFINISHED HARDWOOD OR LAMINATE FLOORS.

9. Wall Paint Flat Finish

Main & Upper Hall	22 WARM GREY	Master Bedroom	22 WARM GREY
Living Room	22 WARM GREY	Bedroom #2	22 WARM GREY
Dining Room	22 WARM GREY	Bedroom #3	22 WARM GREY
Kitchen / Breakfast	22 WARM GREY	Bedroom #4	22 WARM GREY
Family Room	22 WARM GREY	Bedroom #5	N/A
Powder Room	22 WARM GREY	Master Ensuite	22 WARM GREY
Laundry Room	22 WARM GREY	Ensuite Bath - Bedroom 2/3	22 WARM GREY
Den/Library		Ensuite Bath - Bedroom 4	22 WARM GREY
Trim Paint-Semi Gloss	BIRCH WHITE		

Smooth Ceilings First Floor

☐ Yes

☒ No

** Refer to Construction Summary

Purchasers:

Tung-Ting Donald NG & Cathy NGO

Property: 95

Telephone Res. / Bus:

/

Project: Lampone Investments Inc.

Decor Advisor:

Aly Aversa

Model and Elevation: Kimberly 1 Elev 3

Lock Date:

27-May-21

27-May-21

Plan #:

65M-4573

10. Plaster Mouldings and Medallions

Entrance Vestibule			Kitchen/Breakfast		
Main Hall			Den/Library		
Living Room			Lower Landing		
Dining Room					
Family Room					

** Refer to Construction Summary

11. Fireplace

Living Room	Family Room	Other Room - Specify
<div><div>Purchased</div><div>As Per Plan</div><div>N/A</div></div>	<div><div>Purchased</div><div>As Per Plan</div><div>N/A</div></div>	<div><div>Purchased</div><div>As Per Plan</div><div>N/A</div></div>
<div><div>Fireplace Type</div><div></div></div>	<div><div>As Per Construction Specifications</div><div></div></div>	<div><div></div><div></div></div>
<div><div>Mantle Type</div><div></div></div>	<div><div>See Below</div><div></div></div>	<div><div></div><div></div></div>
<div><div>Colour / Stain</div><div></div></div>	<div><div>See Below</div><div></div></div>	<div><div></div><div></div></div>
<div><div>Surround</div><div></div></div>	<div><div>N/A</div><div></div></div>	<div><div></div><div></div></div>
<div><div>Hearth</div><div></div></div>	<div><div>N/A</div><div></div></div>	<div><div></div><div></div></div>

** Refer to Construction Summary ** MANTEL - CAST STONE - AEQUALITAS 1 STYLE MANTEL - TIMELESS GREY

12. Heating and Air Conditioning

<div><div>Air Conditioning</div><div>NO</div></div>	<div><div>Gas Provisions Stove</div><div>NO</div></div>
<div><div>Gas Provisions Dryer</div><div>NO</div></div>	<div><div>Gas Provisions Barbecue</div><div>NO</div></div>
<div><div>Comment</div><div></div></div>	

** Refer to Construction Summary

13. Electrical

<div><div>Plugs and Switches</div><div><div>White</div><div>Standard</div></div></div>	<div><div>Above Kitchen Cabinet Light</div><div><div>Yes</div><div>No</div></div></div>
<div><div>Hood Fan</div><div>STANDARD WHITE</div></div>	<div><div>Below Kitchen Cabinet Light</div><div><div>Yes</div><div>No</div></div></div>
<div><div>Appliances</div><div><div>Built in Cooktop</div><div>Built in Oven</div></div></div>	<div><div>Gas Stove</div><div>Microwave</div></div>
<div><div></div><div><div>Yes</div><div>No</div></div></div>	<div><div></div><div><div>Yes</div><div>No</div></div></div>
<div><div>Dishwasher Rough-in</div><div>Yes</div></div>	

** Refer to Construction Summary

14. General Comments

** Refer to Construction Summary

Disclaimers and Notes

1) Colours of all materials are as close as possible to builder's selection, but not necessarily identical due to variances in manufacturing.

2) Any extras listed above are null and void unless accompanied by a separate invoice/amendment. Said invoice must be paid in full.

3) The Purchaser agrees that this colour selection is final and that no changes will be permitted, unless required by the Vendor.

4) The Purchaser acknowledges reading and accepting document which contains other miscellaneous disclaimers.

Signature:

Date:

May 27, 2021

Signature:

Date:

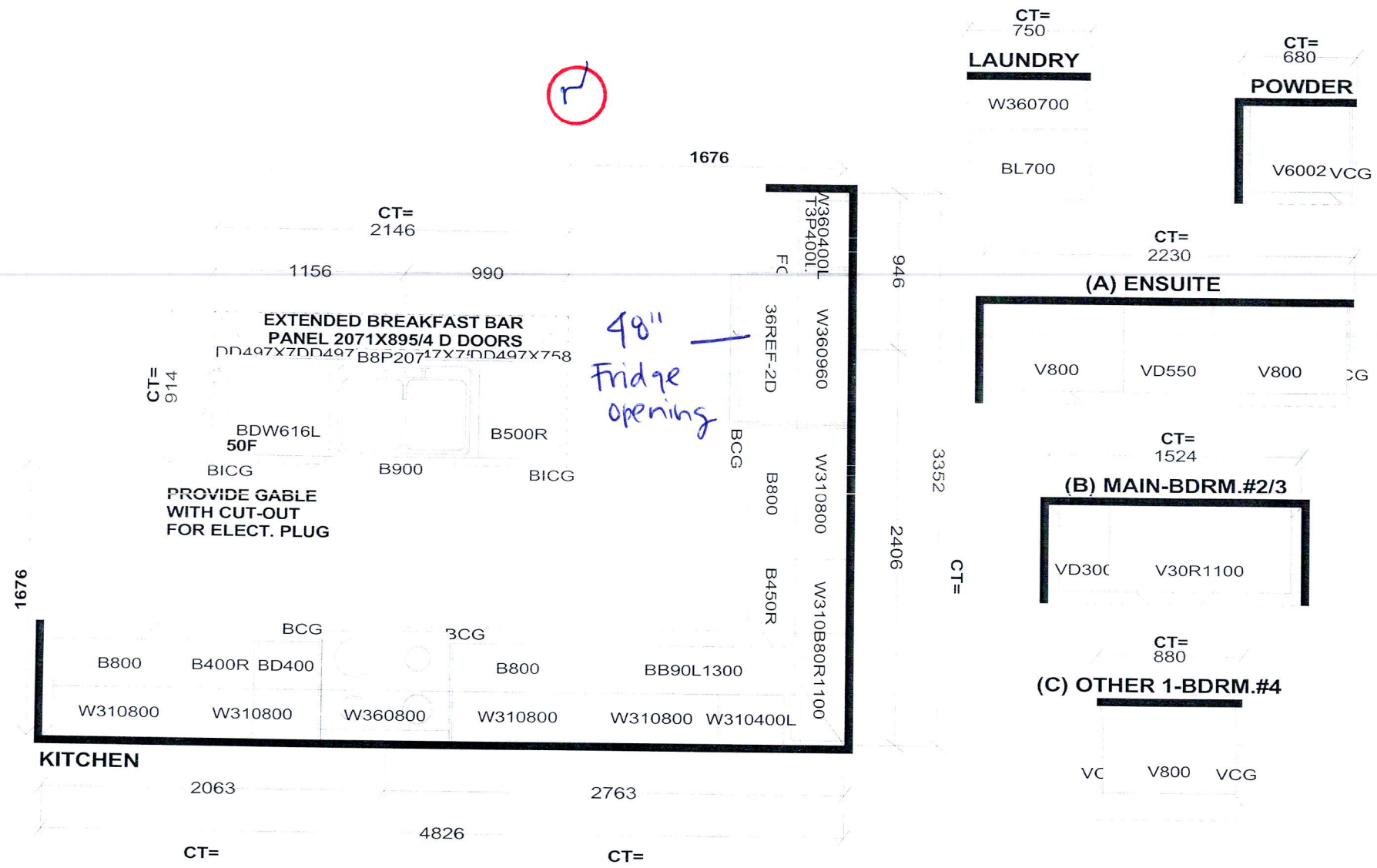

Selba Industries J# _____

This drawing is the intellectual property of SELBA INDUSTRIES INC. and is an original design which must not be released or copied unless applicable fee has been paid or job order placed.

W WIDTH _____	W HGHT _____	W CNT _____	<div style="border: 1px solid black; padding: 2px; text-align: center;">H A B F C E D</div>	DESIGNER: KS	JOB NUMBER: BUILDER: GREENPARK SITE: LAMPONE, Markham MODEL: KIMBERLY 1X EL 1,2,3 LOT #:
FLOOR HGHT _____	DOOR HGHT _____	DATE: July 29 20			
ST CENT _____	2X4 _____	VENT BOX COVER _____			