

CONSTRUCTION SUMMARY

Mountainview Heights 3 (G) - Russell Gardens Building Ltd.

PURCHASERS: SUKHJIT SINGH RANDHAWA and BALJIT KAUR RANDHAWA

TEL:

LOT / PHASE 321 / 3	REG. PLAN # 62M-1266	HOUSE TYPE Mountainash Four (4 Bedroom) Elev 2		
------------------------	-------------------------	---	--	--

CABINETRY

1 - CABINETRY - KITCHEN - HARDWARE UPGRADE 1 31May21 Note:	
1 - KITCHEN - DELETE CABINETS ABOVE STOVE - VENDOR WILL SUPPLY 6 INCH VENT AS PER CONSTRUCTION SPECIFICATIONS AND VENT MAY NOT BE IN THE APPROPRIATE LOCATION FOR INSTALLATION OF PURCHASER SUPPLIED VENT - PURCHASER TO SUPPLY OWN FAN AFTER CLOSING 31May21 Note: TEMPORARY HOOD FAN MAY BE PROVIDED	
1 - CABINETRY - KITCHEN - LIGHT VALENCE 31May21 Note:	
1 - CABINETRY - KITCHEN - UPGRADE 3 31May21 Note:	

CABINETRY ACCESSORIES

1 - KITCHEN CABINETRY - APPLIANCE DOOR PANELS - 24" DISHWASHER DOOR PANEL (SUPPLY ONLY) - UPGRADE 3 31May21 Note:	
1 - KITCHEN CABINETRY BASE - COOKTOP CABINET WITH POT DRAWERS (2 DRAWERS) - UPGRADE 3 31May21 Note:	
1 - VANITY CABINETRY - RAISE VANITY TO 36" HIGH VANITY IN LIEU OF STANDARD HEIGHT 31May21 Note: ENSUITE BDRM 4	
1 - VANITY CABINETRY - RAISE VANITY TO 36" HIGH VANITY IN LIEU OF STANDARD HEIGHT 31May21 Note: SHARED ENSUITE	
1 - VANITY CABINETRY - RAISE VANITY TO 36" HIGH VANITY IN LIEU OF STANDARD HEIGHT 31May21 Note: MASTER ENSUITE	
1 - VANITY CABINETRY - RAISE VANITY TO 36" HIGH VANITY IN LIEU OF STANDARD HEIGHT 31May21 Note: POWDER ROOM	
1 - KITCHEN CABINETRY BASE - PULLOUT RECYCLE 2 BIN - PRICE IS EACH 31May21 Note:	
1 - KITCHEN CABINETRY - BUILT-IN MICROWAVE/OVEN COMBO - UPGRADE 3 31May21 Note:	
1 - CABINETRY FEE FOR FLUSH CUTOUT ON WALL OVEN/MICROWAVE COMBO CABINET ONLY 31May21 Note:	
1 - KITCHEN CABINETRY UPPER - GLASS DOOR - GLK340 CORD GLASS - FINISHED INTERIOR - FITS TALL UPPER CABINETS ONLY - PRICE IS PER DOOR - UPGRADE 3 31May21 Note:	
1 - KITCHEN CABINETRY UPPER - ANGLED CORNER CABINET - FITS TALL UPPER CABINETS - PER UNIT - UPGRADE 3 31May21 Note:	
1 - KITCHEN CABINETRY - APPLIANCE DOOR PANELS - FRIDGE DOOR PANELS - SUPPLY ONLY - 42"-48" WIDE FRIDGES - UPGRADE 3 31May21 Note:	

CONSTRUCTION SUMMARY

Mountainview Heights 3 (G) - Russell Gardens Building Ltd.

PURCHASERS: SUKHJIT SINGH RANDHAWA and BALJIT KAUR RANDHAWA

TEL:

LOT / PHASE 321 / 3	REG. PLAN # 62M-1266	HOUSE TYPE Mountainash Four (4 Bedroom) Elev 2		
------------------------	-------------------------	---	--	--

1 - PANTRY UNIT UPGRADE - TO GO FROM 300MM TO 600MM DEEP - UPGRADE 3

31May21 Note:

1 - KITCHEN CABINETRY UPPER - FULL DEPTH ABOVE FRIDGE - WITH GABLES - 600MM - PRICE IS EACH - UPGRADE 3

31May21 Note:

CERAMIC TILE

1 - TILE - UPGRADE 1 WALL TILE - - BATHROOM 4 - SHOWER

31May21 Note:

1 - TILE - UPGRADE 1 FLOOR TILE - - BATHROOM 4 - FLOOR

31May21 Note:

1 - TILE - UPGRADE 1 WALL TILE - - BATHROOM 2/3 - TUB AREA

31May21 Note:

1 - TILE - UPGRADE 1 FLOOR TILE - - BATHROOM 2/3 - FLOOR

31May21 Note:

1 - DELETE ALL CERAMIC BATHROOM ACCESSORIES - DELETE TOWEL BAR, PAPER HOLDER & SOAP DISH THROUGHOUT

31May21 Note:

1 - TILE - UPGRADE 4 WALL TILE - - ENSUITE WALL TILE - SHOWER

31May21 Note:

1 - TILE - UPGRADE 4 FLOOR TILE - - ENSUITE BATHROOM - FLOOR

31May21 Note:

1 - TILE - UPGRADE 5 FLOOR TILE - - SIDE HALL

31May21 Note:

1 - TILE - UPGRADE 5 FLOOR TILE - - POWDER ROOM

31May21 Note:

1 - TILE - UPGRADE 5 FLOOR TILE - - KITCHEN

31May21 Note:

1 - TILE - UPGRADE 5 FLOOR TILE - - FOYER

31May21 Note:

CONSTRUCTION

1 - HIGHER INTERIOR ARCHS AND DOORS - FIRST FLOOR ONLY

31May21 Note:

1 - SMOOTH CEILINGS ON FIRST FLOOR ONLY - DET

31May21 Note:

1 - SHARED ENSUITE BEDROOM 2/3 -- 5 FOOT SHOWER WITH SLIDING GLASS CHROME DOORS IN LIEU OF TUB

02Sep20 Note: IF CONSTRUCTION PERMITS

1 - KITCHEN - RELOCATE SINK & DISHWASHER FROM ISLAND TO STOVE WALL AS PER SKETCH

02Sep20 Note: IF CONSTRUCTION PERMITS

COUNTER TOP

CONSTRUCTION SUMMARY

Mountainview Heights 3 (G) - Russell Gardens Building Ltd.

PURCHASERS: SUKHJIT SINGH RANDHAWA and BALJIT KAUR RANDHAWA

TEL:

LOT / PHASE	REG. PLAN #	HOUSE TYPE		
321 / 3	62M-1266	Mountainash Four (4 Bedroom) Elev 2		

1 - COUNTER TOP - UPGRADE - 4" BACKSPLASH 31May21 Note: POWDER ROOM X1 MASTER ENSUITE X1 SHARED ENSUITE X1 ENSUITE BDRM 4 ENSUITE X1	
1 - COUNTER TOP - UPGRADE - KITCHEN BACKSPLASH 31May21 Note:	
1 - COUNTER TOP - UPGRADE - ENSUITE BATHROOM 2/3 VANITY COUNTER TOP 31May21 Note:	
1 - COUNTER TOP - UPGRADE - ENSUITE BATHROOM 4 VANITY COUNTER TOP 31May21 Note:	
1 - COUNTER TOP - UPGRADE - ENSUITE BATHROOM VANITY COUNTER TOP 31May21 Note:	
1 - COUNTER TOP - UPGRADE - POWER ROOM VANITY COUNTER TOP 31May21 Note:	
1 - COUNTER TOP - UPGRADE - KITCHEN COUNTER TOP 31May21 Note:	

DOORS AND TRIM

1 - HIGHER INTERIOR ARCH AND DOORS - FIRST FLOOR ONLY 31May21 Note:	
--	--

ELECTICAL

1 - PLUG - ROUGH-IN FOR ELECTRIC CAR PLUG IN GARAGE - FOR FUTURE ELECTRIC CAR - 240V / 40-50 AMPS 31May21 Note: SPECIFICATIONS REQUIRED	
--	--

ELECTRICAL

1 - KITCHEN - VALANCE LIGHTING - LED LIGHTING 31May21 Note:	
4 - FAN - BATHROOM EXHAUST FAN - ENERGY STAR 80 CFM - IN LIEU OF STANDARD FAN 31May21 Note: POWDER X1 MASTER ENSUITE X1 SHARED - X1 ESNUITE BDRM 4 - X1	
1 - BUILT IN OVEN AND COOKTOP PROVISION - PROVISION ONLY - ELECTRICAL ONLY 31May21 Note:	
1 - POT LIGHT - LED - SECOND FLOOR INSTALLATION 31May21 Note: FLEX ROOM - X1 - TO BE INSTALLED ON SEPARATE SWITCH FROM STANDARD LIGHT	
1 - PLUG - ELECTRICAL PLUG - TO BE INSTALLED OVER FIREPLACE 31May21 Note:	
1 - PLUG - ELECTRICAL PLUG - ADD TO ISLAND 31May21 Note:	

CONSTRUCTION SUMMARY

Mountainview Heights 3 (G) - Russell Gardens Building Ltd.

PURCHASERS: SUKHJIT SINGH RANDHAWA and BALJIT KAUR RANDHAWA

TEL:

LOT / PHASE 321 / 3	REG. PLAN # 62M-1266	HOUSE TYPE Mountainash Four (4 Bedroom) Elev 2		
------------------------	-------------------------	---	--	--

1 - RELOCATE STANDARD KITCHEN LIGHT TO BE CENTERED OVER ISLAND

31May21 Note:

1 - ADD - LIGHT AND SWITCH - NO FIXTURE INCLUDED

31May21 Note: KITCHEN ISLAND - X1

4 - POT LIGHT - LED - FIRST FLOOR INSTALLATION - TO BE INSTALLED ON SEPARATE SWITCH FROM STANDARD LIGHT

31May21 Note: FOYER - X1
LIVING/DINING - X1
KITCHEN - X1
BREAKFAST - X1

FIREPLACE AND ACCESSORIES

1 - GAS LINE ROUGH-IN FOR STOVE (INCLUDES ELECTRICAL OUTLET) - FIRST FLOOR

31May21 Note:

HARDWOOD FLOORING

1 - HARDWOOD - GROUP A SERIES 5 INCH - IN LIEU OF 2 1/4 INCH NATURAL RED OAK - - LIBRARY/DEN

31May21 Note:

1 - HARDWOOD - GROUP A SERIES 5 INCH - IN LIEU OF 2 1/4 INCH NATURAL RED OAK - - FAMILY ROOM

31May21 Note:

1 - HARDWOOD - GROUP A SERIES 5 INCH - IN LIEU OF 2 1/4 INCH NATURAL RED OAK - - MAIN HALL

31May21 Note:

1 - HARDWOOD - GROUP A SERIES 5 INCH - IN LIEU OF 2 1/4 INCH NATURAL RED OAK - - LIVING AND DINING ROOM

31May21 Note:

MIRRORS AND GLASS

1 - FRAMELESS GLASS SHOWER DOOR - INCLUDES CHROME KNOB & HINGES

31May21 Note:

PLUMBING

1 - SOAP DISPENSER 3942 CHROME

31May21 Note: KITCHEN

4 - MOEN BATHROOM ACCESSORIES - MASON CHROME - PAPER HOLDER #YB8099/YB8000 - PRICE IS EACH

31May21 Note: POWDER - X1
MASTER ENSUITE - X1
SHARED 2/3 - X1
ENSUITE BDRM 4 - X1

1 - MOEN BATHROOM ACCESSORIES - MASON CHROME - TOWEL RING #YB8086 - PRICE IS EACH

31May21 Note: POWDER - X1

4 - MOEN BATHROOM ACCESSORIES - MASON CHROME - TOWEL BAR 24" #YB8094/YB8000 - PRICE IS EACH

31May21 Note: POWDER - X1
MASTER ENSUITE - X1
SHARED 2/3 - X1
ENSUITE BDRM 4 - X1

CONSTRUCTION SUMMARY

Mountainview Heights 3 (G) - Russell Gardens Building Ltd.

PURCHASERS: SUKHJIT SINGH RANDHAWA and BALJIT KAUR RANDHAWA

TEL:

LOT / PHASE	REG. PLAN #	HOUSE TYPE		
321 / 3	62M-1266	Mountainash Four (4 Bedroom) Elev 2		

5 - SINK - UNDERMOUNT SINK - TECO BATH #4815 31May21 Note: POWDER - X1 MASTER - X2 ENSUITE SHARED - X1 ENSUITE BDRM 4 - X1	
1 - SINK - UNDERMOUNT SINK - BLANCO QUATRUS R15 U2 #401519 31May21 Note: KITCHEN	
1 - WATER LINE FOR FRIDGE - ROUGH-IN ONLY 31May21 Note:	
3 - TOE TESTER - ADD TOE TESTER TO SHOWER - ALL SHOWERS 02Sep20 Note:	

PROMOTIONAL

1 - LESS BALANCE OF CREDIT FROM PURCHASER EXTRA SHEET IN OFFER 31May21 Note:	
1 - PARTIAL REDEMPTION OF PROMOTIONAL PACKAGE \$2,950.00 BALANCE (\$9,050.00) FORWARD TO BE USED AT A LATER DATE. ORIGINAL PROMOTIONAL PACKAGE OF \$12,000.00 AS PER SCHEDULE PE. 02Sep20 Note:	

STAIRS AND RAILINGS

1 - V GROOVE HANDRAIL 31May21 Note:	
1 - 4 X 4 POSTS 31May21 Note:	
1 - EUROLINE R6-3 31May21 Note: BLACK IRON PICKET	
1 - STAINED STAIRS – STANDARD STAIRCASE - PRICE IS PER SET 31May21 Note:	

EXTRAS AS PER OFFER

PURCHASER(S) ACKNOWLEDGES THAT THE PURCHASE PRICE IS INCLUSIVE OF ALL CREDITS AND PROMOTIONAL PACKAGES AVAILABLE AT TIME OF PURCHASE. Worksheet Note:	
(1) The Vendor agrees that notwithstanding any other term or provision in this Agreement included in the Purchase Price and in addition to those items detailed in Schedule GP to the Agreement of Purchase and Sale, the Purchaser is entitled to a credit of Worksheet Note:	
200 AMP Worksheet Note:	
3 LARGER BASEMENT WINDOWS Worksheet Note:	
WALK UP Purchase Price includes a walk up from the basement to the rear of the dwelling unit, and the obligation to construct the house with the walk up is subject to the Vendor's approval, in its sole and unfettered discretion The Purchaser acknowledg Worksheet Note:	

CONSTRUCTION SUMMARY

Mountainview Heights 3 (G) - Russell Gardens Building Ltd.

PURCHASERS: SUKHJIT SINGH RANDHAWA and BALJIT KAUR RANDHAWA

TEL:

LOT / PHASE	REG. PLAN #	HOUSE TYPE		
321 / 3	62M-1266	Mountainash Four (4 Bedroom) Elev 2		

This Document is Extremely Time Sensitive - Printed 31 May 21 at 13:46

Purchasers: SUKHJIT SINGH RANDHAWA & BALJIT KAUR

Property: 321

Telephone Res. / Bus: /

Project: Russell Gardens Building Ltd.

Decor Advisor: Aly Aversa

Model and Elevation: Mountainash Four (4 Bedroom) Elev 2

Lock Date: 9-Jun-21

31-May-21

Plan #: 62M-1266

Layout Changes: ☐ Yes ☒ No

Sketch Attached: ☐ Yes ☒ No

Exterior Colour Scheme:

1. Cabinetry

	Style and Colour	<div><div></div><div></div></div>	Hardware
Kitchen / Breakfast	LEGACY 614 CRISP WHITE		451SB
Laundry Room	ELISSE		Standard
Powder Room	MONACO 823 DRIFT WOOD		431SA
Master Ensuite Bathroom	MONACO 823 DRIFT WOOD		431SA
Ensuite Bath - Bedroom 2/3	MONACO 904 INK		431SA
Ensuite Bath - Bedroom 4	MONACO 904 INK		431SA

Appliances:

Built In Appliances ☒ Yes ☐ No

Slide In Stove ☐ Yes ☒ No

Dishwasher Cabinet ☐ Closed ☒ Open

41" Upper Cabinets ☒ Yes ☐ No

Please NOTE: Standard Cabinet Height is 30"

Stove Opening 36"

NOTE: If not specified, opening will be set to builder's standard opening of approximately 30" width

Fridge Opening 42"

NOTE: If not specified, opening will be set to builder's standard opening of approximately 37" width x 74" height

** Refer to Construction Summary ** HOOD FAN 36" OPENING **

2. Counters

	Counter	Edge
Kitchen / Breakfast	QUARTZ-MISTRAL	#360 EDGE
Laundry Room	N/A	N/A
Powder Room	QUARTZ-FLORENCE T5B7	#360 EDGE
Master Ensuite Bathroom	QUARTZ-GRECALE	#360 EDGE
Ensuite Bath - Bedroom 2/3	QUARTZ-GRECALE	#360 EDGE
Ensuite Bath - Bedroom 4	QUARTZ-FLORENCE T5B7	#360 EDGE

** Refer to Construction Summary

Purchasers: SUKHJIT SINGH RANDHAWA & BALJIT KAUR

Property: 321

Telephone Res. / Bus: /

Project: Russell Gardens Building Ltd.

Decor Advisor: Aly Aversa

Model and Elevation: Mountainash Four (4 Bedroom) Elev 2

Lock Date: 31-May-21

31-May-21

Plan #: 62M-1266

3. Ceramic Flooring

Entrance Vestibule	TILE-GALA SMOOTH SILK POL 24X24	<input type="checkbox"/>	At a 45 Threshold-If App.
Main Hall	N/A	<input type="checkbox"/>	Metal Strip Where Applic.
Kitchen / Breakfast	TILE-GALA SMOOTH SILK POL 24X24	<input type="checkbox"/>	
Laundry Room	TILE-FORM LIGHT GREY 695 13X13	<input type="checkbox"/>	
Powder Room	TILE-GALA SMOOTH SILK POL 24X24	<input type="checkbox"/>	
Master Ensuite Bathroom	TILE- STATUARIO "SILVER" G60160Q 12X24	<input type="checkbox"/>	
Ensuite Bath - Bedroom 2/3	TILE-AQUARELLE SHADOW GREY 16X16	<input type="checkbox"/>	
Ensuite Bath - Bedroom 4	TILE-AQUARELLE NAPLES IVORY 16X16	<input type="checkbox"/>	
SIDE ENTRANCE	TILE-GALA SMOOTH SILK POL 24X24	<input type="checkbox"/>	
		<input type="checkbox"/>	
		<input type="checkbox"/>	

** Refer to Construction Summary

4. Ceramic Wall Tile

Master Ensuite Bathroom	Selection	Describe
Tub Deck Wall	N/A	
Tub Deck	N/A	
Tub Deck Skirt	N/A	
Shower Stall	TILE- STATUARIO "SILVER" G60160Q 12X24	
Bathtub Enclosure Walls	N/A	
Ensuite Bath - Bedroom 2/3	TILE-AQUARELLE SHADOW GREY 10X20	
Ensuite Bath - Bedroom 4	TILE-AQUARELLE NAPLES IVORY 10X20	
SIDE ENTRANCE	N/A	
Kitchen Backsplash	QUARTZ-MISTRAL	*

** Refer to Construction Summary - STANDARD GROUT THROUGHOUT UNLESS SPECIFIED

5. Plumbing Fixtures

All Bathrooms

White

Whirlpool

☐ Yes ☒ No

Dishwasher Rough-In

☒ Yes ☐ No

Waterline for Fridge

☒ Yes ☐ No

** Refer to Construction Summary

6. Trim Carpentry

Interior Doors	SEE UPGRADES - TALLER DOORS
Interior Trim	SEE UPGRADES - TALLER ARCHES
Door Handles	As Per Construction Specifications
Exterior Front Door Handle	As Per Construction Specifications

** Refer to Construction Summary

Initials:

SS

BR

Purchasers: SUKHJIT SINGH RANDHAWA & BALJIT KAUR

Property: 321

Telephone Res. / Bus: /

Project: Russell Gardens Building Ltd.

Decor Advisor: Aly Aversa

Model and Elevation: Mountainash Four (4 Bedroom) Elev 2

Lock Date: 31-May-21

31-May-21

Plan #: 62M-1266

7. Other Flooring

Main Hall	HARDWOOD-MIRAGE-ADMIRATION COLLECTION-CHARCOAL MAPLE 5" CASHMERE	
Living Room	HARDWOOD-MIRAGE-ADMIRATION COLLECTION-CHARCOAL MAPLE 5" CASHMERE	
Dining Room	HARDWOOD-MIRAGE-ADMIRATION COLLECTION-CHARCOAL MAPLE 5" CASHMERE	
Family Room	HARDWOOD-MIRAGE-ADMIRATION COLLECTION-CHARCOAL MAPLE 5" CASHMERE	
Den / Library / Study	HARDWOOD-MIRAGE-ADMIRATION COLLECTION-CHARCOAL MAPLE 5" CASHMERE	
Basement Landing(If Applies)	N/A	
Lower Landing (If Applies)	N/A	
Upper Landing	HARDWOOD-MIRAGE-ADMIRATION COLLECTION-CHARCOAL MAPLE 5" CASHMERE	
Upper Hall	LAMINATE-LEXINGTON-BEAUMONT OAK-TL-LW1313	
Master Bedroom	LAMINATE-LEXINGTON-BEAUMONT OAK-TL-LW1313	
Bedroom #2	LAMINATE-LEXINGTON-BEAUMONT OAK-TL-LW1313	
Bedroom #3	LAMINATE-LEXINGTON-BEAUMONT OAK-TL-LW1313	
Bedroom #4		
Bedroom #5		
FLEX ROOM	LAMINATE-LEXINGTON-BEAUMONT OAK-TL-LW1313	
Underpad	Type	Area
	N/A	N/A

** Refer to Construction Summary

8. Railings and Pickets

Railing Type	V-GROOVE	4x4 posts	Colour	MIRAGE-MAPLE-CHARCOAL
Picket Type	PICKETS R-6-3		Colour	BLACK
Stringer / Riser	AS PER CONSTRUCTION SPECIFICATIO		Colour	MIRAGE-MAPLE-CHARCOAL
Treads	AS PER CONSTRUCTION SPECIFICATIO		Colour	MIRAGE-MAPLE-CHARCOAL
Red Oak Stairs with Semi Gloss Finish			<input checked="" type="radio"/> Yes <input type="radio"/> No	

** Refer to Construction Summary THE STAIN COLOURS OR FINISH AVAILABLE ON RISERS, TREADS, PICKETS AND RAILS (STAIRCASES), WILL NOT BE AN EXACT MATCH TO PREFINISHED HARDWOOD OR LAMINATE FLOORS. 4X4 POSTS

9. Wall Paint Flat Finish

Main & Upper Hall	22 WARM GREY	Master Bedroom	22 WARM GREY
Living Room	22 WARM GREY	Bedroom #2	22 WARM GREY
Dining Room	22 WARM GREY	Bedroom #3	22 WARM GREY
Kitchen / Breakfast	22 WARM GREY	Bedroom #4	22 WARM GREY
Family Room	22 WARM GREY	Bedroom #5	N/A
Powder Room	22 WARM GREY	Master Ensuite	22 WARM GREY
Laundry Room	22 WARM GREY	Ensuite Bath - Bedroom 2/3	22 WARM GREY
Den/Library	22 WARM GREY	Ensuite Bath - Bedroom 4	22 WARM GREY
Trim Paint-Semi Gloss	BIRCH WHITE		

Smooth Ceilings First Floor ☒ Yes ☐ No

** Refer to Construction Summary

Initials:

S.S

B.R

Purchasers: SUKHJIT SINGH RANDHAWA & BALJIT KAUR (Property: 321)
Telephone Res. / Bus: / Project: Russell Gardens Building Ltd.
Decor Advisor: Aly Aversa Model and Elevation: Mountainash Four (4 Bedroom) Elev 2
Lock Date: 31-May-21 31-May-21 Plan #: 62M-1266

10. Plaster Mouldings and Medallions

Entrance Vestibule			Kitchen/Breakfast		
Main Hall			Den/Library		
Living Room			Lower Landing		
Dining Room					
Family Room					

** Refer to Construction Summary

11. Fireplace

Living Room			Family Room			Other Room - Specify		
Purchased	As Per Plan	N/A	Purchased	As Per Plan	N/A	Purchased	As Per Plan	N/A
<input type="radio"/>	<input type="radio"/>	<input checked="" type="radio"/>	<input type="radio"/>	<input checked="" type="radio"/>	<input type="radio"/>	<input type="radio"/>	<input type="radio"/>	<input checked="" type="radio"/>
Fireplace Type			As Per Construction Specifications					
Mantle Type			MANTLE M2-STANDARD					
Colour / Stain			AS PER CONSTRUCTION SPECIFICATIONS					
Surround			NERO					
Hearth			N/A					

** Refer to Construction Summary

12. Heating and Air Conditioning

Air Conditioning	NO	Gas Provisions Stove	YES
Gas Provisions Dryer	NO	Gas Provisions Barbecue	NO
Comment			

** Refer to Construction Summary

13. Electrical

Plugs and Switches	<input checked="" type="radio"/> White	Standard - <u>DEORA</u>	Above Kitchen Cabinet Light	<input type="radio"/> Yes <input checked="" type="radio"/> No
Hood Fan	STANDARD WHITE TEMP.		Below Kitchen Cabinet Light	<input checked="" type="radio"/> Yes <input type="radio"/> No
Appliances	Built in Cooktop	Built in Oven	Gas Stove	Microwave
	<input checked="" type="radio"/> Yes <input type="radio"/> No	<input checked="" type="radio"/> Yes <input type="radio"/> No	<input checked="" type="radio"/> Yes <input type="radio"/> No	<input checked="" type="radio"/> Yes <input type="radio"/> No
Dishwasher Rough-in	Yes			

** Refer to Construction Summary

14. General Comments

** Refer to Construction Summary

Disclaimers and Notes

- Colours of all materials are as close as possible to builder's selection, but not necessarily identical due to variances in manufacturing.
- Any extras listed above are null and void unless accompanied by a separate invoice/amendment. Said invoice must be paid in full.
- The Purchaser agrees that this colour selection is final and that no changes will be permitted, unless required by the Vendor.
- The Purchaser acknowledges reading and accepting document which contains other miscellaneous disclaimers.

Signature: Date: May 31/21Signature: Date: May 31/21

- Upgrade 3
- Light valence

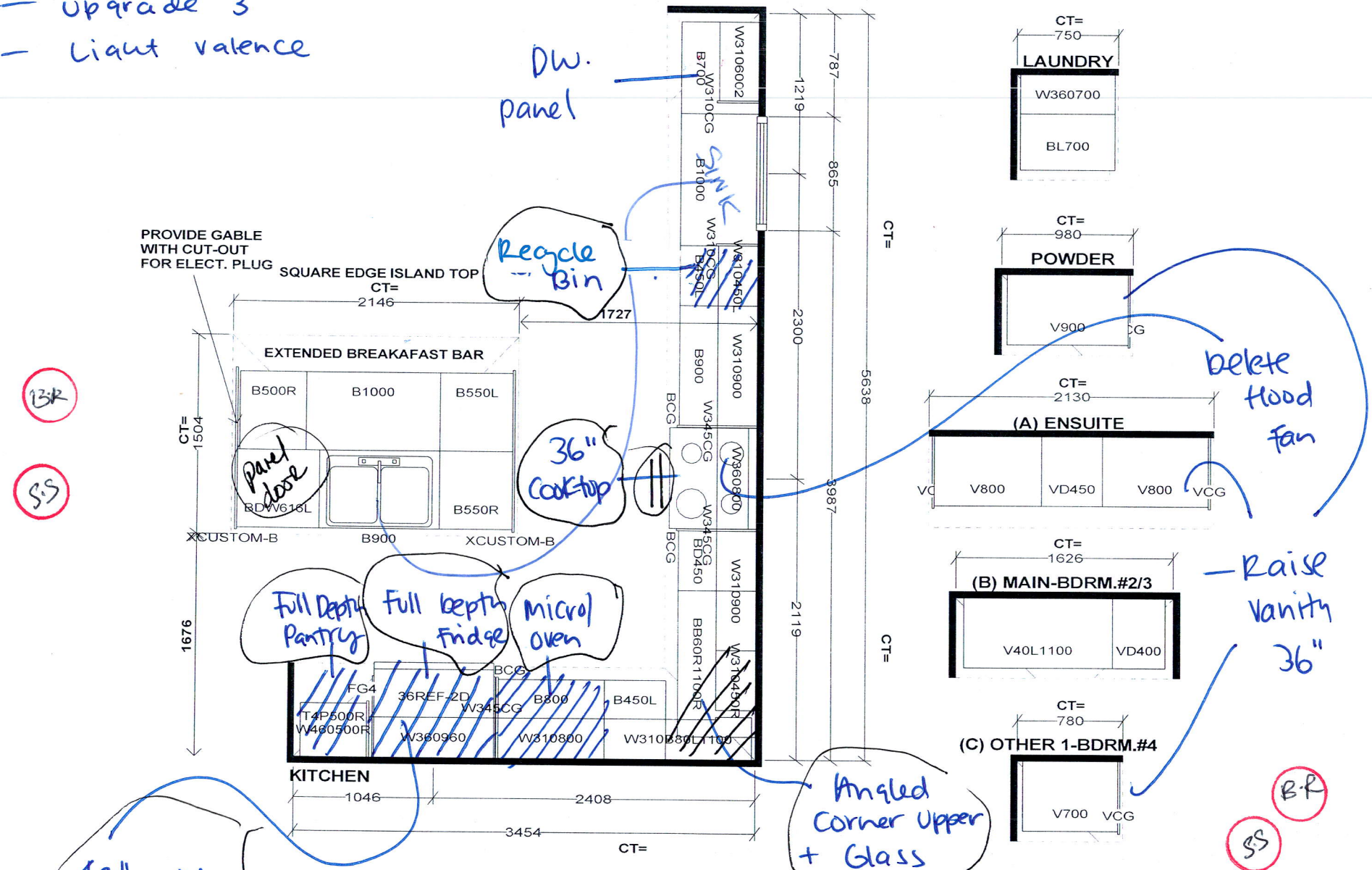

Selba Industries J#		
W WDT	W HGHT	W CNT
FLOOR HGHT	DOOR HGHT	
ST. CENT	2X4	VENT BOX COVER

This drawing is the intellectual property of SELBA INDUSTRIES INC. and is an original design which must not be released or copied unless applicable fee has been paid or job order placed.

DESIGNER: KS
DATE: MAY 13 20

JOB NUMBER:

BUILDER: GREENPARK

SITE: RUSSELL GARDENS PH.3

MODEL: MOUNTAINASH 4X EL 1,2,3

LOT #:

Lot 321 -

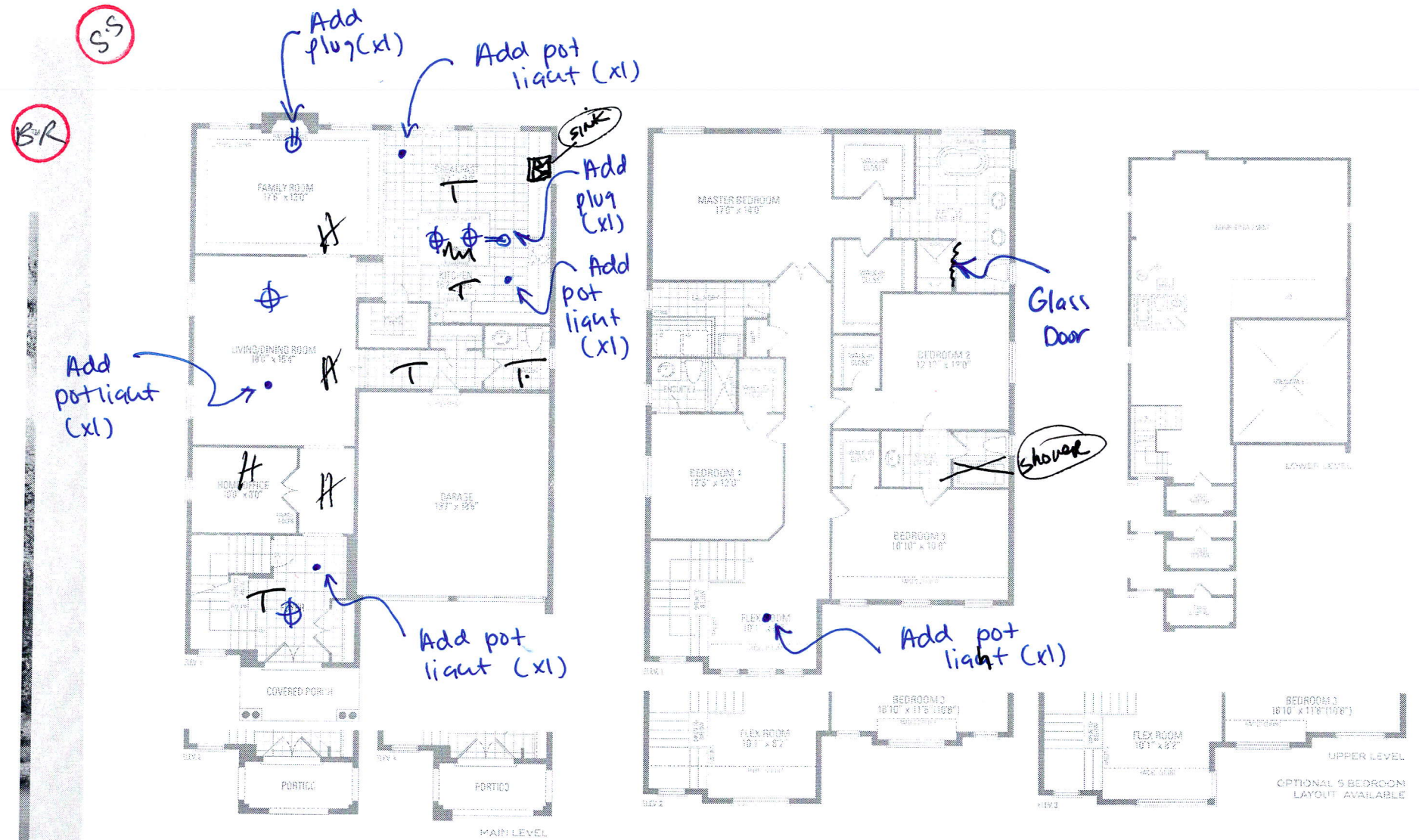

MOUNTAINASH FOUR ELEV. 1 • 3,189 sq.ft. | ELEV. 2 • 3,191 sq.ft. | ELEV. 3 • 3,196 sq.ft.

Orientation of home may be reversed and purchaser agrees to accept that same. Steps and porches may vary at any exterior entrance ways due to grading variance. Actual usable floor space may vary from the stated floor areas. All renderings are artist's concept. Dimensions, specifications and architectural details subject to modifications. Footnote and adjoining model types may vary due to timing. © S.O. May 2020

Prepared by
Arshdeep Singh
arshdeepsg2011@gmail.com (437) 779-5400

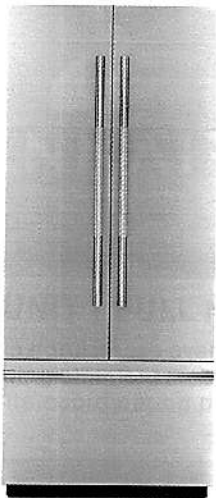

Jenn-Air® 42-Inch Built-In French Door Refrigerator

JF42NXXFXDE

Available Finishes/Colours

JF42NXXFXDE
Panel Ready

Dimensions

Height	84
Width	41 3/4

AHAM Volumes And Shelf Area

Freezer Volume (Cu Ft)	6.42
Refrigerator Volume (Cu Ft)	17.75

Details

Cooling Type	Dual Evaporator
Counter Depth	Yes

Exterior

Base Grille Color	Black
Number of Doors	3
Door Color	Panel Ready
Hidden Hinge	Yes
Reversible Door	No

GDS

isBaseUnit	true
isConsumerUnit	true
IsDispatchUnit	-
IsInvoiceUnit	true
IsOrderableUnit	true
Product Type	EA
GPC Code	10003695
UDEX	1101290375

Controls

Control Type	Touch Pad
Air Filter Indicator/Reset	No
Automatic Defrost	Yes
Door Ajar/Open Alarm	Yes
Control Location	Interior Up Front

Featuring the exclusive Jenn-Air® Obsidian interior, this bottom-freezer refrigerator offers a fully flush, fully integrated design, distinct fresh- and frozen-food climates, and Produce Preserver to help keep fruits and vegetables at optimum freshness.

Top Features

- Obsidian Interior
- Fully Flush, Fully Integrated Design
- Style with Custom Wood Panels or Suite-Coordinating Stainless Steel Panel Kits (not included)

Manuals & Literature:

- CAD Image
- Dimension Guide
- Energy Guide
- Installation Guide
- Use and Care Guide
- Sketch File
- Warranty Information



Because Whirlpool Corporation policy includes a continuous commitment to improve our products, we reserve the right to change materials and specifications without notice. Dimensions are for planning purposes only. For complete details, see Installation Instructions packed with product. Specifications subject to change without notice.



42" FULLY INTEGRATED BOTTOM FREEZER REFRIGERATORS

DETAILED PLANNING DIMENSIONS GUIDE

(BASE UNIT REQUIRES SUITE-COORDINATING FULL HEIGHT PANEL KIT OR CUSTOM PANELS AND HANDLES)

JF42NFXDE – 41 3/4" (W) x 82 1/2" (H) x 24" (depth without door panels/handles)

PRODUCT DIMENSIONS

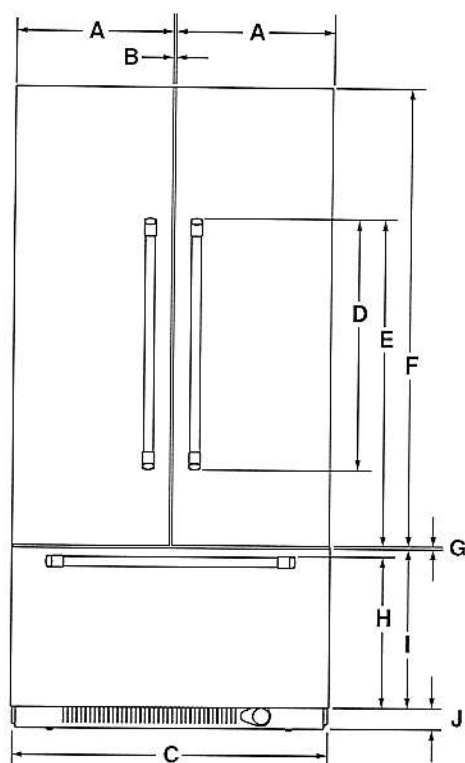

FRONT VIEW

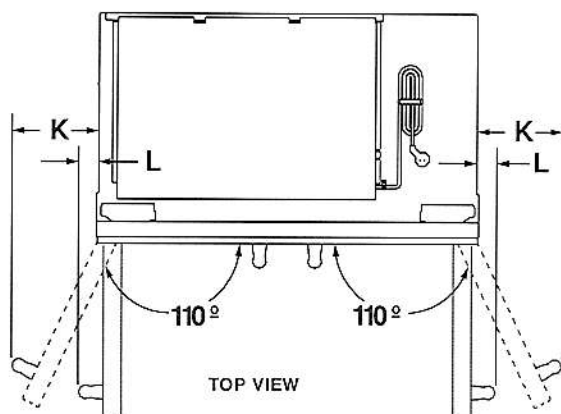

TOP VIEW

DIMENSION	DESCRIPTION	JF42NFXDE
A	Width of each door	20 / " (52.9 cm)
B	Space between doors	1/8" (0.3 cm)
C	Overall width (including vinyl side trim s)	41 / " (106 cm)
D	Height of door handle	
	RISE™ Stainless	40 / " (103.8 cm)
	NOIR™ Stainless	40 / " (103.2 cm)
E	Height to top of door handle	
	RISE™ Stainless	49 / " (126.6 cm)
	NOIR™ Stainless	47 / " (121.8 cm)
F	Height of door	59 / " (150.5 cm)
G	Space between door and drawer	1/8" (0.3 cm)
H	Height to top of drawer handle	
	RISE™ Stainless	19 / " (49.1cm)
	NOIR™ Stainless	19 / " (49.2 cm)
I	Height of drawer	20 / " (52.1 cm)
J	Height of bottom grille	3" (7.6 cm)
K	Width from side of refrigerator to handle – door fully open 110°	
	RISE™ Stainless	8 / " (21cm)
	NOIR™ Stainless	7 / " (19.7 cm)
L	Width from side of refrigerator to handle – door open 90°	
	RISE™ Stainless	2 / " (6.1cm)
	NOIR™ Stainless	1 / " (4.1cm)

Because Whirlpool Corporation policy includes a continuous commitment to improve our products, we reserve the right to change materials and specifications without notice.

Dimensions are for planning purposes only. For complete details, see Installation Instructions packed with product. Specifications subject to change without notice.



42" FULLY INTEGRATED BOTTOM FREEZER REFRIGERATORS

DETAILED PLANNING DIMENSIONS GUIDE

(BASE UNIT REQUIRES SUITE-COORDINATING FULL HEIGHT PANEL KIT OR CUSTOM PANELS AND HANDLES)

JF42NFXDE – 41 3/4" (W) x 82" (H) x 24" (depth without door panels/handles)

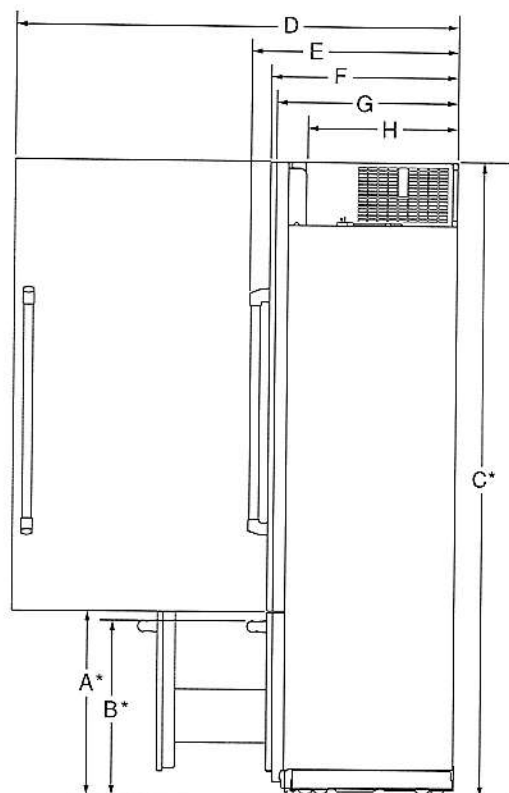

SIDE VIEW

DIMENSION	DESCRIPTION	JF42NFXDE
A*	Height to top of drawer (min.)	23 / " (59.7 cm)
B*	Height to top of drawer handle (min.)	
	RISE™ Stainless	22 / " (56.7 cm)
	NOIR™ Stainless	22 / " (56.8 cm)
C*	Height to top of door (min.)	82 / " (210.5 cm)
D	Depth with door open 90° (min.)	43 / " (111.1 cm)
E	Depth with handle (min.)	
	RISE™ Stainless	27 / " (70.2 cm)
	NOIR™ Stainless	26 / " (68.2 cm)
F	Depth with door (min.)	
	RISE™ Stainless	24 / " (62.9 cm)
	NOIR™ Stainless	24 / " (62.9 cm)
	Custom panel (3/4"/1.9 cm)	24 / " (62.9 cm)
G	Depth without door panel kit (min.)	24" (61 cm)
H	Depth of compressor cover (min.)	19 / " (50.5 cm)

*Add 1 / " (3.2 cm) to the height dimension when leveling legs are fully extended.

Because Whirlpool Corporation policy includes a continuous commitment to improve our products, we reserve the right to change materials and specifications without notice.

Dimensions are for planning purposes only. For complete details, see Installation Instructions packed with product. Specifications subject to change without notice.



42" FULLY INTEGRATED BOTTOM FREEZER REFRIGERATORS

DETAILED PLANNING DIMENSIONS GUIDE

(BASE UNIT REQUIRES SUITE-COORDINATING FULL HEIGHT PANEL KIT OR CUSTOM PANELS AND HANDLES)

JF42NFXDE – 41 1/4" (W) x 82" (H) x 24" (depth without door panels/handles)

AIRFLOW VENTING RECOMMENDATIONS

CLOSED SOFFIT CABINET

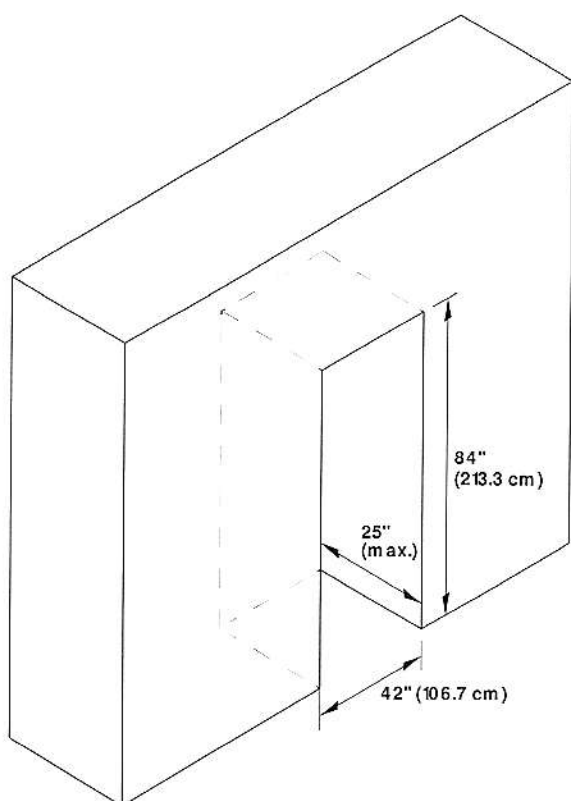

- Depth of cabinet must be less than 25" (63.5 cm).
- Height of soffit must not exceed 84" (213.3 cm).
- Following illustrations explain the cabinet construction (soffit and rear wall positions) required for optimum ventilation and airflow.

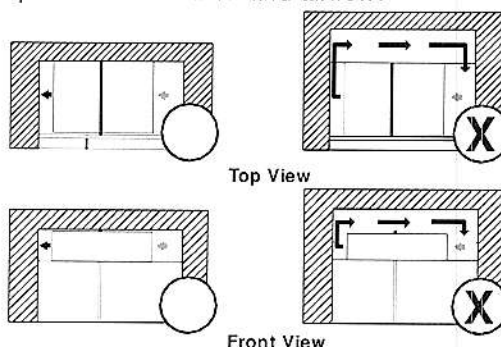

Grey arrow = ambient air; Black arrow = warm air
Cabinet depth 25" and soffit located at 84", provides proper airflow/ventilation to the refrigerator. Efficient cooling is achieved.
Cabinet depth more than 25" and/or soffit located at more than 84", causes air gap at back and/or top of the refrigerator. Air gap allows warm air recirculation causing loss in cooling efficiency.

- If your opening does not meet these requirements, you will need to make modifications.

Because Whirlpool Corporation policy includes a continuous commitment to improve our products, we reserve the right to change materials and specifications without notice.

Dimensions are for planning purposes only. For complete details, see Installation Instructions packed with product. Specifications subject to change without notice.



42" FULLY INTEGRATED BOTTOM FREEZER REFRIGERATORS

DETAILED PLANNING DIMENSIONS GUIDE

(BASE UNIT REQUIRES SUITE-COORDINATING FULL HEIGHT PANEL KIT OR CUSTOM PANELS AND HANDLES)

JF42NXFXDE – 41 3/4" (W) x 82 1/2" (H) x 24" (depth without door panels/handles)

CLEARANCE DIMENSIONS

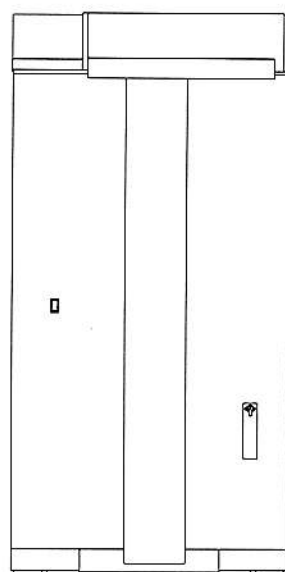
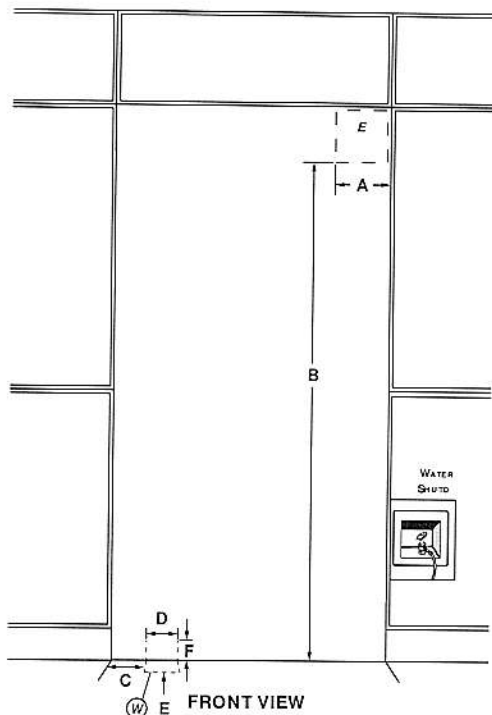

BACK VIEW

DIMENSION	DESCRIPTION	JF42NXFXDE
A	Width of recommended electrical location	7 / " (19.1 cm)
B	Height to recommended electrical location	77" (195.6 cm)
C	Distance from side of cabinet to recommended water connection location	6 / " (16.5 cm)
D	Width of recommended water connection location	1 / " (3.81 cm)
E	Depth of recommended water connection location (max.)	2" (5 cm)
F	Height of recommended water connection location (behind the unit)	2 / " (6.35 cm)
E	Recommended electrical connection location	
	Recommended water connection location	

Because Whirlpool Corporation policy includes a continuous commitment to improve our products, we reserve the right to change materials and specifications without notice.

Dimensions are for planning purposes only. For complete details, see Installation Instructions packed with product. Specifications subject to change without notice.

ELICA PRO SERIES
LEONE

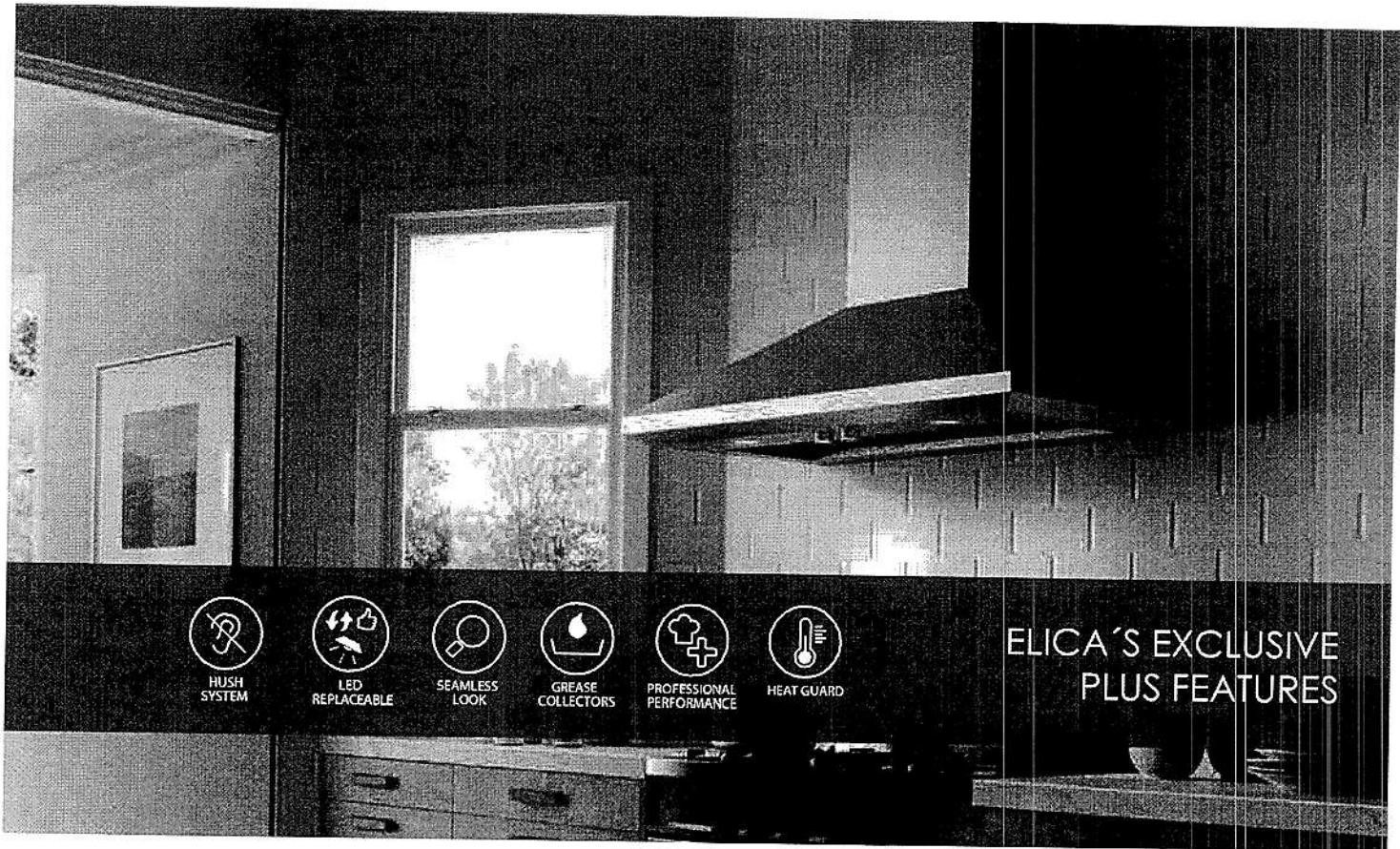

Give a splash of Italian design to your professional kitchen with Leone's crisp lines, seamless welded corner craftsmanship, beveled rim and gleaming stainless steel.

Leone has the extra depth (24") and power (1200 CFM on 36", 42" & 48" widths) needed to support professional ranges and cooktops. No ear plugs required with Leone's HUSH sound suppression system, which enables you to comfortably talk and entertain, even when cooking up a storm. Available in 30", 36" and 42" widths, Leone features backlit hidden knob controls, which operate the 4-speed blower and LED lighting. Designed for standard ducted ventilation only.

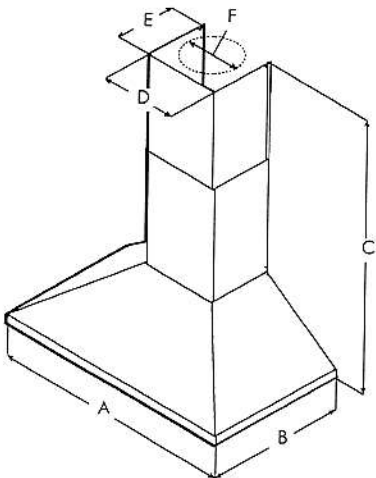

	ELN630S1 ELN630S2	ELN136S1 ELN136S2	ELN142S1 ELN142S2	ELN148SS
A	30" (76.2 cm)	36" (91.4 cm)	42" (106.7 cm)	48" (121.9 cm)
B	24" (61 cm)			
C	Max: 47 5/8" (120.9 cm) Min: 30" (76.2 cm)			
D	13 2/16" (33.2 cm)			
E	10 5/8" (27 cm)			
F	8" (20.3 cm)			

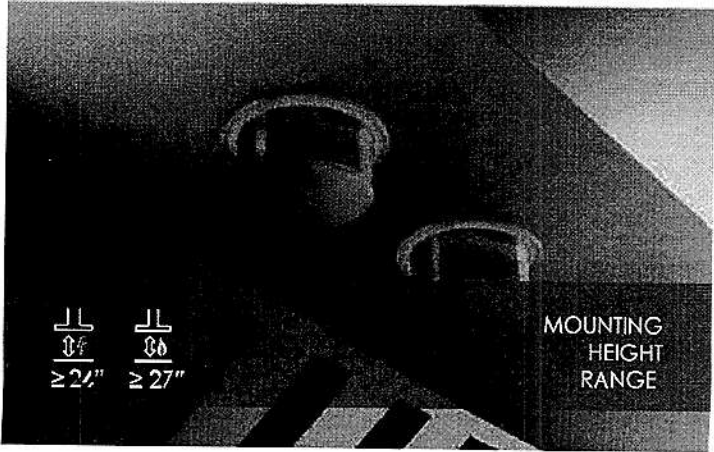

ELICA PRO SERIES
LEONE



SPECIFICATIONS

	30" Unit	36" Unit	42" Unit	48" Unit
Model:	ELN630S1 ELN630S2	ELN136S1 ELN136S2	ELN142S1 ELN142S2	ELN148SS
Dimensions:	30"W x 24"D x 12 1/8"H	36"W x 24"D x 12 1/8"H	42"W x 24"D x 12 1/8 "H	48"W x 24"D x 12 1/8 "H
Blower Type(internal):	600 CFM(4-speed)	1200 CFM(4-speed)	1200 CFM(4-speed)	1200 CFM(4-speed)
Blower Performance:				
Speed 1	205 CFM	375 CFM	375 CFM	375 CFM
Speed 2	350 CFM	640 CFM	640 CFM	640 CFM
Speed 3	510 CFM	940 CFM	940 CFM	940 CFM
Speed 4	600 CFM	1200 CFM	1200 CFM	1200 CFM
Noise (sones):				
Working Speed	Min:2.01, Max:6	Min:3.21, Max:7.7	Min:3.21, Max:7.7	Min:3.21, Max:7.7
Finish:	Stainless Steel			
Controls:	Fully retractable rotating knobs with blue backlighting			
Illumination:	2 LED, 7.5 Watts LED light			
(replaceable lamps 1 intensity)				
Filter Type:	Dishwasher-Safe, Professional Stainless Steel, Angles baffled filters			
Angled Baffle Filters:	1	2	2	3
Duct Transition:	8" Round with BackDraft Damper (top only)			
Installation Type:	Ducted Installation Only			
Electrical:	120V - 60 Hz			
KITS:				
Long Chimney Extension Kit:	KIT02785			
CONSUMABLE PARTS:				
Replacement Grease Filter (1):	GF09FA	GF09EA	GF09FA	
Replacement Light Bulb (1):	LMP0131098			
*Consumable parts are sold in units of one (1). Order accordingly				
INSTALL HEIGHTS:				
Ranger Hood:	Min: 8", Max 10"			
Ranger Hood with extension duct covers:	Min: 9.9", Max 13"			

PLUS FEATURES

- 

HUSH SYSTEM - An exclusive sound deadening technology that effectively reduces sound levels by over 35%
- 

LED CONSUMER REPLACEABLE BULB - High quality LED lighting usually requires a skilled technician to replace lamps. Avoid this expense with Elica's new LED lamps that enable homeowners to replace in seconds
- 

SEAMLESS CRAFTSMANSHIP - Heavy gauge stainless steel "Seamless" construction that delivers refined elegance.
- 

STAINLESS STEEL BAFFLE FILTERS WITH GREASE COLLECTORS - Designed for high airflow cooking, the "S" shape design traps high volumes of grease
- 

PROFESSIONAL PERFORMANCE - Special features and high performances for models with aspiration capacity between 600 and 1200 CFM's
- 

HEAT GUARD - Senses extreme temperatures (>158 degrees) and automatically adjusts the blower speed to HIGH

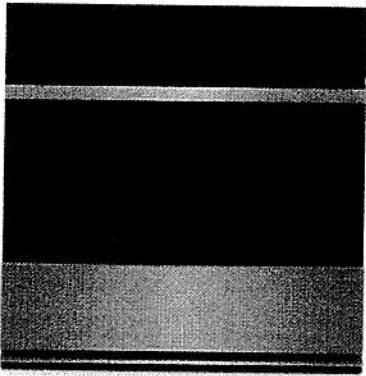

NOIR™ 30" Single Wall Oven with MultiMode® Convection System

JJW2430IM

Available Finishes/Colours

 JJW2430IM
Floating Glass Black

Dimensions	
Depth	23 1/4
Height	29 7/8
Width	30

Exterior	
Door Lock	Yes
Handle Material	Stainless Steel
Door Type	Metal & Glass
Flush Installation Approved	Yes
Installable Under Cooktop	Yes
Handle Color	Stainless Steel

Controls	
Control Type	Tap Touch
Electronic Display Type	LCD Screen





Features	
Language Conversion	English/French

Features	
LP Convertible	No
Power On Indicator Light	Yes

Details	
Automatic Shut-Off	Yes
Bake Element Power	2800W/2427W
Number of Bake Elements	1
Interior Color	Black
Door Broil Position	Closed
Number of Broil Elements	1
Hidden Bake Element	Yes
Broiler Element Power	4000W

Beyond a veil of dark glass, the power of the MultiMode® Convection system caresses every morsel with even heat. With curated recipe presets and full-color images, an intuitive, guided culinary experience awaits your touch.

Top Features
Irresistible Interior
4.3-Inch Full Color LCD Display
Cinematic Lighting

- Manuals & Literature:
-  [CAD Image](#)
 -  [Dimension Guide](#)
 -  [Installation Guide](#)
 -  [Use and Care Guide](#)
 -  [Warranty Information](#)

SINGLE WALL OVENS

JJW2427I – 27" x 29-7/8" x 25-5/16"

JJW2430I, JJW3430I – 30" x 29-7/8" x 25-5/16"

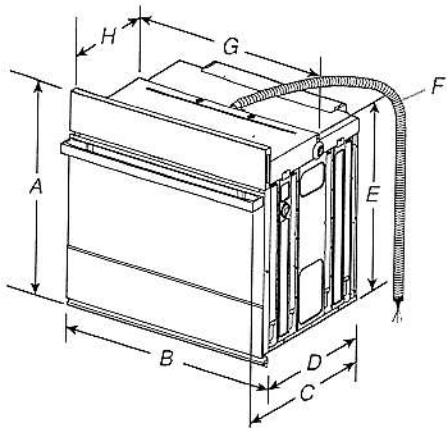

PRODUCT DIMENSIONS SINGLE OVENS

27" (68.6 CM) MODELS

- A. 29-7/8" (75.8 cm) max. overall height
- B. 27" (68.6 cm) overall width
- C. JJW2427IM – 26-3/8" (67 cm)
JJW2427IL – 27-3/16" (69 cm)
- D. 23-1/4" (59.1 cm) max. recessed depth
- E. 27-3/16" (69 cm) recessed height
- F. 48" (121.9 cm) flexible conduit length
- G. 25-7/16" (64.6 cm) max. recessed width
- H. 12" (30.5 cm) from back of control panel to start of strain relief

30" (76.2 CM) MODELS

- A. 29-7/8" (75.8 cm) max. overall height
- B. 30" (76.2 cm) overall width
- C. JJW2430IM – 26-3/8" (67 cm)
JJW2430IL – 27-3/16" (69 cm)
JJW3430IM – 26-3/8" (67 cm)
JJW3430IL – 27-3/16" (69 cm)
- D. 23-1/4" (59.1 cm) max. recessed depth
- E. 27-3/16" (69 cm)
- F. 48" (121.9 cm) flexible conduit length
- G. 28-7/16" (72.2 cm) max. recessed width
- H. 12" (30.5 cm) from back of control panel to start of strain relief

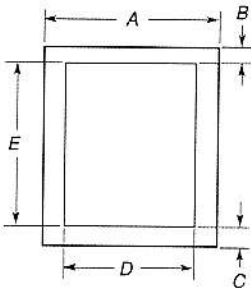

UNDERCOUNTER CABINET DIMENSIONS SINGLE OVENS

27" (68.6 CM) MODELS

- A. 27" (68.6 cm) min. cabinet width
- B. 1-1/2" (3.8 cm) min. top of cutout to underside of countertop
- C. 5-1/4" (13.3 cm) bottom of cutout to floor
- D. 25-1/2" (64.8 cm) cutout width
- E. 28" (71.2 cm) min. cutout height

30" (76.2 CM) MODELS

- A. 30" (76.2 cm) min. cabinet width
- B. 1-1/2" (3.8 cm) min. top of cutout to underside of countertop
- C. 5-1/4" (13.3 cm) bottom of cutout to floor
- D. 28-1/2" (72.4 cm) cutout width
- E. 28" (71.2 cm) min. cutout height

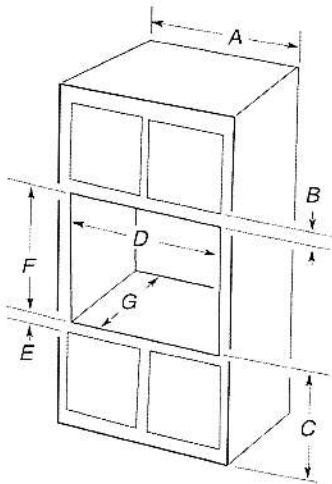

SINGLE OVENS INSTALLED IN CABINET

27" (68.6 CM) MODELS

- A. 27" (68.6 cm) min. cabinet width
- B. 2-3/16" (5.5 cm) top of cutout to bottom of upper cabinet door
- C. 32" (81.3 cm) bottom of cutout to floor
- D. 25-1/2" (64.8 cm) cutout width
- E. 1-1/2" (3.8 cm) min. bottom of cutout to top of cabinet door
- F. 28" (71.2 cm) recommended cutout height
- G. 24" (60.7 cm) cutout depth

*NOTE: The cutout height can be between 27-1/4" (69.2cm) and 29-7/16" (74.8 cm) for 27" single ovens.

30" (76.2 CM) MODELS

- A. 30" (76.2 cm) min. cabinet width
- B. 2-3/16" (5.5 cm) top of cutout to bottom of upper cabinet door
- C. 32" (81.3 cm) bottom of cutout to floor
- D. 28-1/2" (72.4 cm) cutout width
- E. 1-1/2" (3.8 cm) min. bottom of cutout to top of cabinet door
- F. 28" (71.2 cm) recommended cutout height
- G. 24" (60.7 cm) cutout depth

*NOTE: The cutout height can be between 27-1/4" (69.2 cm) and 29-7/16" (74.8 cm) for 30" single ovens.

IMPORTANT: Dimensional specifications are provided for planning purposes only. Do not make any cutouts based on this information. Refer to the Installation or Use & Care Guide BEFORE selecting cabinetry, verifying electrical/gas connections, making cutouts or beginning installation. All JennAir® appliances are appropriately UL, CUL or CSA approved.



SINGLE WALL OVENS

JJW2427I – 27" x 29-7/8" x 25-5/16"

JJW2430I, JJW3430I – 30" x 29-7/8" x 25-5/16"

ELECTRICAL REQUIREMENTS

If codes permit and a separate ground wire is used, it is recommended that a qualified electrical installer determine that the ground path and the wire gauge are in accordance with local codes.

Check with a qualified electrical installer if you are not sure the oven is properly grounded.

This oven must be connected to a grounded metal, permanent wiring system.

Be sure that the electrical connection and wire size are adequate and in conformance with the National Electrical Code, ANSI/NFPA 70-latest edition or CSA Standards C22.1-94, Canadian Electrical Code, Part 1 and C22.2 No. 0-M91-latest edition, and all local codes and ordinances.

A copy of the above code standards can be obtained from:

National Fire Protection Association
1 Batterymarch Park
Quincy, MA 02169-7471

CSA International
8501 East Pleasant Valley Road
Cleveland, OH 44131-5575

ELECTRICAL CONNECTION

To properly install your oven, you must determine the type of electrical connection you will be using and follow the instructions provided for it here.

- Oven must be connected to the proper electrical voltage and frequency as specified on the model/serial/rating plate. The model/serial/rating plate is located under the control panel on single ovens. See the following illustration

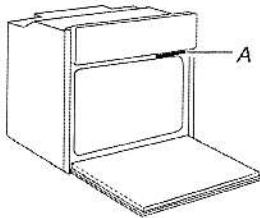

A. Model/Serial/Rating Plate

- Models rated from 7.3 to 9.6 kW at 240 V (5.4 to 7.4 kW at 208 V) require a separate 40 A circuit. Models rated at 4.8 kW and below at 240 V (3.6 kW and below at 208 V) require a separate 20 A circuit.
- A circuit breaker is recommended.
- Connect directly to the circuit breaker box (or fused disconnect) through flexible, armored, or nonmetallic sheathed, copper cable (with grounding wire).
- Flexible conduit from the oven should be connected directly to the junction box.
- Fuse both sides of the line.
- Do not cut the conduit. The length of conduit provided is for serviceability of the oven.
- A UL listed or CSA approved conduit connector must be provided.
- If the house has aluminum wiring, follow the procedure below:
Connect the aluminum wiring using special connectors and/or tools designed and UL listed for joining copper to aluminum.
Follow the electrical connector manufacturer's recommended procedure. Aluminum/copper connection must conform with local codes and industry accepted wiring practices.

For power requirements for models JJW2427I, JJW2430I and JJW3430I, refer to the following table.

MODEL	240 VAC	208 VAC
	kW	kW
JJW2427I	4.1	3.1
JJW2430I	4.1	3.1
JJW3430I	4.5	3.4

IMPORTANT: Dimensional specifications are provided for planning purposes only.
Do not make any cutouts based on this information. Refer to the Installation or Use & Care Guide *BEFORE* selecting cabinetry, verifying electrical/gas connections, making cutouts or beginning installation.
All JennAir® appliances are appropriately UL, CUL or CSA approved.



36" NOIR™ Gas Professional-Style Rangetop

JGCP436HM

Available Finishes/Colours

JGCP436HL

Stainless Steel

JGCP436HM

Floating Glass Black

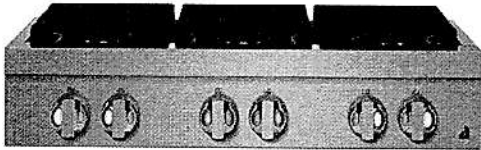

Dimensions

Depth	27 1/2
Height	7 7/16
Width	35 3/4

Controls

Control Location	Front
Control Type	Knobs
Infinite Heat Controls	No
Knob Color	Stainless Steel
Knob Type	Metal

Features

Installs Over Built-In Oven	No
Griddle	NA
Heating Element On Indicator Light	No
LP Convertible	Yes - Kit Included
Power Boost	No
Power Outage Compatible	Yes (Gas Cooktop Burners Only)

Cooktop Details

Cooktop Surface Color	Black
Cooktop Element Style	Sealed Burner
Cooktop Configuration	All Burners





Top Features

14 Rangetop Configurations

Cast Iron Grates

Halo-Effect Knobs

Manuals & Literature:

-  [CAD Image](#)
-  [Dimension Guide](#)
-  [Installation Guide](#)
-  [Use and Care Guide](#)
-  [Warranty Information](#)

Features

Automatic Pan Detection	No
Digital Display	No
Downdraft Vent	No
Hot Surface Indicator Light	No

Sealed brass burners. Precise, dual flames. Unmistakable firepower erupting through cast-iron grates. Turn on the heat without the click-click clamor, and sear and simmer to satisfy your deepest hunger.

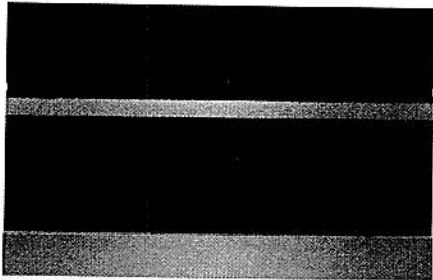

NOIR™ 30" BUILT-IN MICROWAVE OVEN WITH SPEED-COOK

JMC2430IM

Available Finishes/Colours

 JMC2430IM
Floating Glass Black

Dimensions	
Depth	24 3/4
Height	19 7/8
Width	29 3/4

Microwave Details	
Microwave Type	Built-In
Sensor Cooking	Yes
Cavity Finish	Stainless
Cooking Power (watts)	900
Convection	Yes
Convection Power (watts)	1200
Grill	Yes
Grill Power (watts)	1600
Interior Light	No
Number of Racks	1
Turntable	Stoppable





Microwave Details	
Turntable Diameter Size (in.)	14 1/8

Exterior	
Door Release	Handle
Door Opening	Drop Down
Handle Color	Stainless Steel

Controls	
Control Type	Tap Touch
Control Location	Top
Scrolling Electronic Display	No
Number of Quick Touch/One-Touch Selections	1
Display Color	Full Color
Electronic Display Type	LCD Screen

Let your appetite run wild with microwave and convection energy. With curated recipes and full-color doneness images, an intelligent culinary experience awaits your touch.

- Top Features
- 4.3-Inch Full Colour LCD Display
- Seamless Touches
- Stainless Steel Microwave Interior

- Manuals & Literature:
-  [CAD Image](#)
-  [Installation Guide](#)
-  [Use and Care Guide](#)
-  [Warranty Information](#)