

HVAC LEGEND	
	4X10 SUPPLY GRILLE
	14X8 RETURN GRILLE
	4X10 SUPPLY GRILLE 6"Ø BOOT
	30X8 RETURN GRILLE
	SUPPLY DUCTWORK
	RETURN DUCTWORK
	EXHAUST FAN
LW	LOW WALL
HW	HIGH WALL

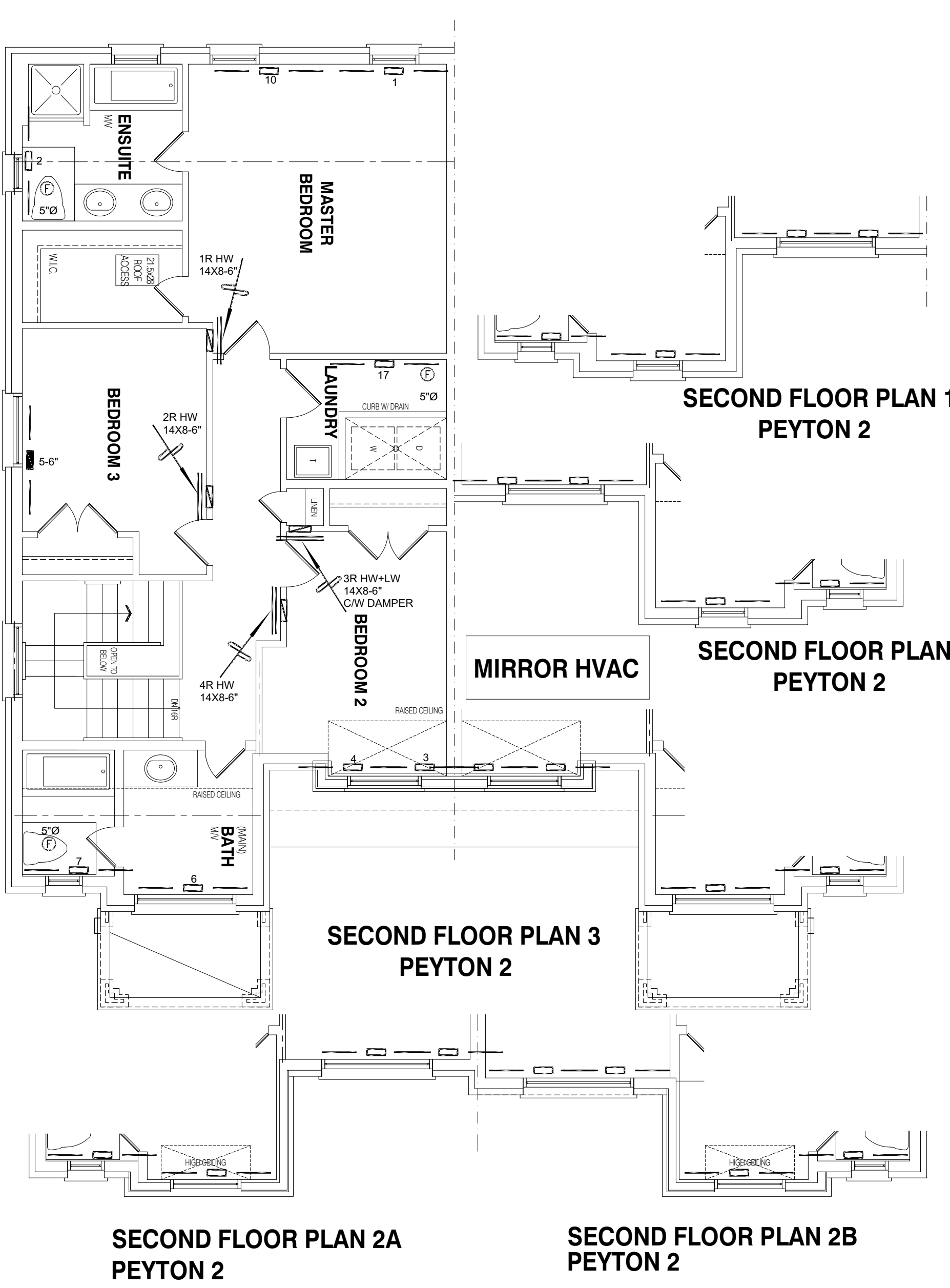

GENERAL NOTES	
ALL DRAWINGS, CALCULATIONS AND SPECIFICATIONS ARE THE PROPERTY OF HVAC DESIGNS LTD.® AND MAY NOT BE REPRODUCED, MODIFIED OR ALTERED WITHOUT EXPRESSED WRITTEN CONSENT. THE DRAWINGS ARE DATED AND USE OF THESE DRAWINGS AFTER ONE YEAR FROM THE DATED NOTED IS NOT AUTHORIZED. CONTRACTOR SHALL CHECK ALL CONDITIONS BEFORE PROCEEDING WITH WORK. LATEST MUNICIPAL APPROVED DRAWINGS ONLY TO BE USED DURING INSTALLATION OF HEATING SYSTEM. HVAC DESIGNS LTD. IS NOT LIABLE FOR ANY CLAIMS ARISING FROM UNAUTHORIZED USE OF THE DRAWINGS OR FROM ANY CHANGES TO ACCEPTED STANDARDS AND/OR THE ONTARIO BUILDING CODE.	
INSTALLATION TO COMPLY WITH THE LATEST ONTARIO BUILDING CODE. ALL SUPPLY BRANCH OUTLETS SHALL BE EQUIPPED WITH MANUAL BALANCING DAMPER. DUCTWORK WHICH PASSES THROUGH THE GARAGE OR UNHEATED SPACES SHALL BE ADEQUATELY INSULATED AND GAS-PROOFED	
ALL S/A DIFFUSERS "4x10" UNLESS NOTED OTHERWISE ON LAYOUT. ALL S/A RUNS 5"Ø UNLESS NOTED OTHERWISE ON LAYOUT. UNDERCUT DOORS 1" min. FOR R/A	
EXHAUST DUCTS SERVING THE KITCHEN SHALL NOT BE SMALLER THAN RECOMMENDED BY THE MANUFACTURER OF THE FANS.	

HEAT LOSS	37220 BTU/H	# OF RUNS	S/A	R/A	FANS
UNIT DATA		3RD FLOOR			
MAKE	GOODMAN	2ND FLOOR	9	4	3
MODEL	GMEC960402BNA	1ST FLOOR	7	1	2
INPUT	40 MBTU/H	BASEMENT	4	1	0
OUTPUT	38.4 MBTU/H	ALL S/A DIFFUSERS 4 "x10" UNLESS NOTED OTHERWISE ON LAYOUT. ALL S/A RUNS 5"Ø UNLESS NOTED OTHERWISE ON LAYOUT. UNDERCUT DOORS 1" min. FOR R/A			
COOLING	2.0 TONS				
FAN SPEED	890 cfm @ 0.6" w.c.				

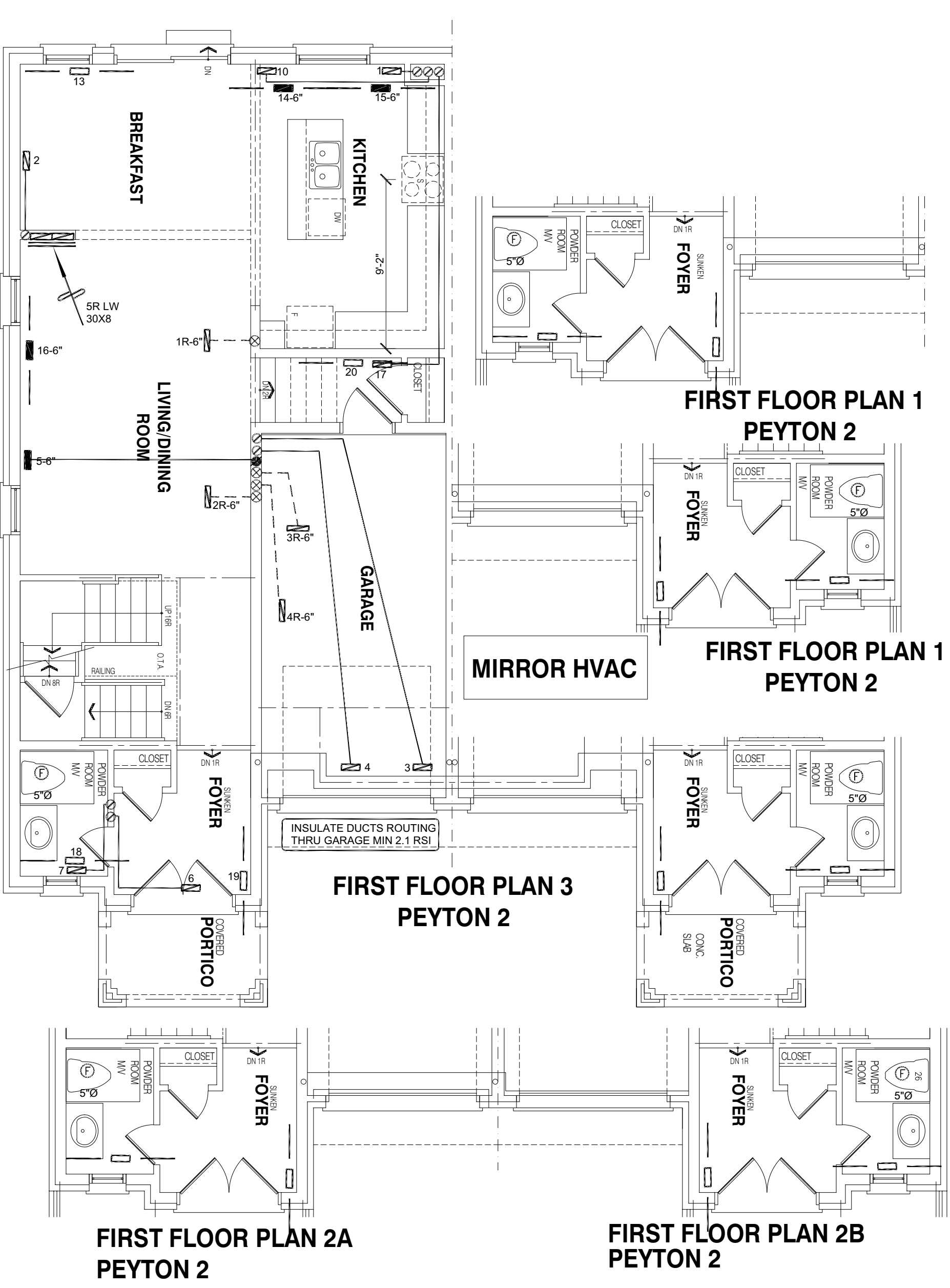
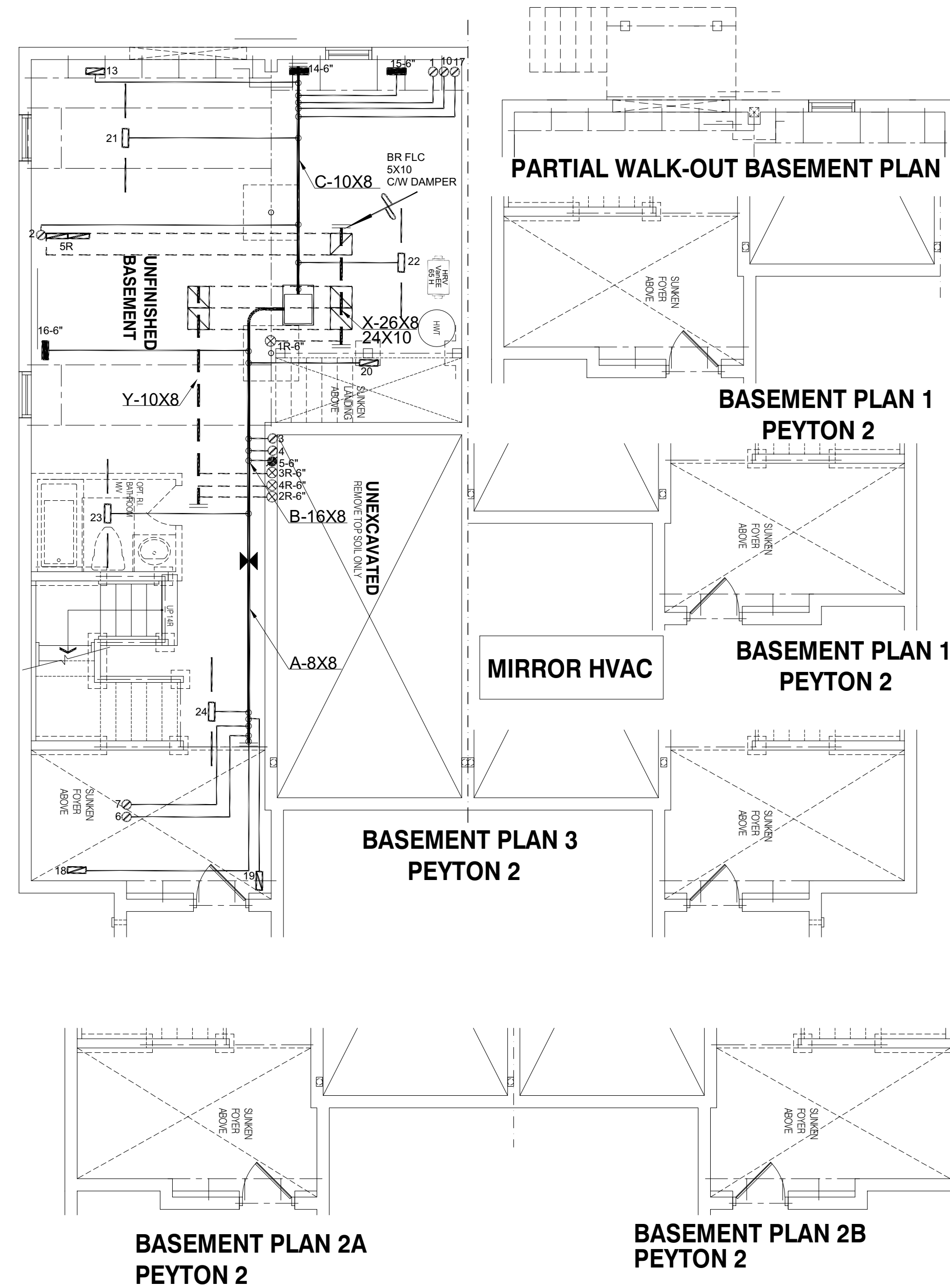

Date: 02/10/21

ALL CONSTRUCTION SHALL COMPLY WITH THE ONTARIO BUILDING CODE

NO PERSON SHALL CONSTRUCT OR DEMOLISH A BUILDING OR CAUSE A BUILDING TO BE CONSTRUCTED EXCEPT IN ACCORDANCE WITH THESE CERTIFIED BUILDING PERMIT DOCUMENTS, THE BUILDING CODE ACT AND THE BUILDING CODE.

NOTE: THE PROPOSED DEVELOPMENT IS SUBJECT TO COMPLIANCE WITH ALL APPLICABLE PROVISIONS OF THE ZONING BY-LAW AND ALL OTHER APPLICABLE LAWS INCLUDING THE PROVISIONS OF A SITE PLAN AND/OR SUBDIVISION AGREEMENT WHICH MAY OR MAY NOT BE REGISTERED ON TITLE

THIS DRAWING WAS REVIEWED AND WAS APPROVED FOR THE DESIGN TEAM
Michael O'Brien, B.Sc. (Hons) P.Eng.
HVAC DESIGNS LTD.

2
1
No. Revision
Date
By

ISSUED FOR PERMIT
JULY 2020
PS

SB-12 PACKAGE
A1

HVACDESIGNS LTD.
375 Finley Ave - Unit 202 - Ajax, Ontario L1S 2E2
Tel. 905.619.2300 - 905.420.5300 Fax 905.619.2375
Email: info@hvacdsgns.ca
Web: www.hvacdsgns.ca
Specializing in Residential Mechanical Design Services

Client: GREENPARK
Project Name: LAMPONE INVESTMENTS
MARKHAM, ONTARIO
PEYTON 2
1935 SQFT

Sheet Title: HVAC DESIGN
Drawn By: PS
Scale: 3/16"=1'-0"
Date: JULY 2020
LO #: 86807

Checked By: AS
Sheet No.: 1