

## CONSTRUCTION SUMMARY

Mountainview Heights 3 (G) - Russell Gardens Building Ltd.

PURCHASERS: IMRAN IQBAL SINGIWALA and SAMIRA IMRAN SINGIWALA

TEL:

LOT / PHASE	REG. PLAN #	HOUSE TYPE		
342 / 3	62M-1266	Mountainash Eleven Elev 2		

### CABINETRY

1 - KITCHEN - DELETE CABINETS ABOVE STOVE - VENDOR WILL SUPPLY 6 INCH VENT AS PER CONSTRUCTION SPECIFICATIONS AND VENT MAY NOT BE IN THE APPROPRIATE LOCATION FOR INSTALLATION OF PURCHASER SUPPLIED VENT - PURCHASER TO SUPPLY OWN FAN AFTER CLOSING 20Aug21 Note: TEMPORARY HOOD FAN MAY BE PROVIDED	
1 - CABINETRY - KITCHEN - CM11 CROWN MOULDING 20Aug21 Note:	
1 - CABINETRY - KITCHEN - HARDWARE UPGRADE 2 20Aug21 Note:	

### CABINETRY ACCESSORIES

1 - KITCHEN CABINETRY UPPER - FULL DEPTH ABOVE FRIDGE - WITH GABLES - 600MM - PRICE IS EACH - STANDARD 20Aug21 Note:	
1 - KITCHEN -REVISE KITCHEN LAYOUT TO ACCOMMODATE BUILT-IN APPLIANCES 20Aug21 Note:	
1 - KITCHEN CABINETRY - BUILT-IN MICROWAVE/OVEN COMBO - STANDARD 20Aug21 Note:	
1 - KITCHEN CABINETRY BASE - COOKTOP CABINET WITH POT DRAWERS (2 DRAWERS) - STANDARD 20Aug21 Note:	
1 - KITCHEN - RELOCATE DOUBLE SINK & DISHWASHER AS WELL AS BAR SINK - SEE SKETCH 20Aug21 Note:	

### CERAMIC TILE

1 - DELETE ALL CERAMIC BATHROOM ACCESSORIES - DELETE TOWEL BAR, PAPER HOLDER & SOAP DISH THROUGHOUT 20Aug21 Note:	
1 - TILE - UPGRADE 5 FLOOR TILE - - POWDER ROOM 20Aug21 Note:	
1 - TILE - UPGRADE 5 FLOOR TILE - - KITCHEN 20Aug21 Note:	
1 - TILE - UPGRADE 5 FLOOR TILE - - FOYER 20Aug21 Note:	
1 - TILE - UPGRADE 4 FLOOR TILE - - ENSUITE BATHROOM - FLOOR 20Aug21 Note:	
1 - TILE - UPGRADE 4 FLOOR TILE - - BATHROOM 3/4 - FLOOR 20Aug21 Note:	
1 - TILE - UPGRADE 4 FLOOR TILE - - BATHROOM 2 - FLOOR 20Aug21 Note:	

### CONSTRUCTION

1 - DELETE BULK HEADS IN KITCHEN IF CONSTRUCTION PERMITS 20Aug21 Note:	
---	--

## CONSTRUCTION SUMMARY

Mountainview Heights 3 (G) - Russell Gardens Building Ltd.

PURCHASERS: IMRAN IQBAL SINGIWALA and SAMIRA IMRAN SINGIWALA

TEL:

LOT / PHASE	REG. PLAN #	HOUSE TYPE		
342 / 3	62M-1266	Mountainash Eleven Elev 2		

1 - KITCHEN - SHIFT STOVE TO ACCOMMOATE RELOCATION OF SINK

20Aug21 Note:

1 - KITCHEN - RELOCATE DOUBLE SINK & DISHWASHER AS WELL AS BAR SINK - SEE SKETCH

20Aug21 Note:

### COUNTER TOP

1 - COUNTER TOP - UPGRADE - KITCHEN COUNTER TOP

20Aug21 Note:

### ELECTRICAL

1 - BUILT IN OVEN AND COOKTOP PROVISION - PROVISION ONLY - ELECTRICAL ONLY

20Aug21 Note:

1 - PLUG - ELECTRICAL PLUG WITH GFI AND SWITCH - FOR FESTIVE LIGHTING

20Aug21 Note:

2 - FAN - BATHROOM EXHAUST FAN - ENERGY STAR 80 CFM - IN LIEU OF STANDARD FAN - MASTER ENSUITE BATHROOM & ENSUITE 3/4 BATHROOM

20Aug21 Note:

1 - POT LIGHT - LED - SECOND FLOOR INSTALLATION - INSTALLED ON SEPERATE SWITCH FROM STANDARD LIGHT - FLEX ROOM

20Aug21 Note:

1 - PLUG - ELECTRICAL PLUG - TO BE INSTALLED OVER FIREPLACE

20Aug21 Note:

1 - POT LIGHT - LED - FIRST FLOOR INSTALLATION - INSTALLED ON SEPERATE SWITCH FROM STANDARD LIGHT - KITCHEN BREAKFAST

20Aug21 Note:

1 - RELOCATE STANDARD KITCHEN LIGHT TO BE CENTERED OVER ISLAND

20Aug21 Note:

1 - POT LIGHT - LED - FIRST FLOOR INSTALLATION - INSTALLED ON SEPERATE SWITCH FROM STANDARD LIGHT - KITCHEN WORKSPACE

20Aug21 Note:

1 - POT LIGHT - LED - FIRST FLOOR INSTALLATION - INSTALLED ON SEPERATE SWITCH FROM STANDARD LIGHT - FAMILY ROOM

20Aug21 Note:

1 - POT LIGHT - LED - FIRST FLOOR INSTALLATION - INSTALLED ON SEPERATE SWITCH FROM STANDARD LIGHT - LIVING/DINING ROOM

20Aug21 Note:

1 - STANDARD DINING ROOM LIGHT TO BE CENTERED BETWEEN LIVING AND DINING ROOM

20Aug21 Note:

1 - 200 AMP ELECTRICAL SERVICE

20Aug21 Note:

### HARDWOOD FLOORING

1 - LAMINATE - UPGRADE TO PARKLANE SERIES IN LIEU OF STANDARD LAMINATE

20Aug21 Note:

## CONSTRUCTION SUMMARY

Mountainview Heights 3 (G) - Russell Gardens Building Ltd.

PURCHASERS: IMRAN IQBAL SINGIWALA and SAMIRA IMRAN SINGIWALA

TEL:

LOT / PHASE	REG. PLAN #	HOUSE TYPE		
342 / 3	62M-1266	Mountainash Eleven Elev 2		
1 - HARDWOOD - GROUP B SERIES 5 INCH - IN LIEU OF 2 1/4 INCH NATURAL RED OAK - - LIVING AND DINING ROOM 20Aug21 Note:				
1 - HARDWOOD - GROUP B SERIES 5 INCH - IN LIEU OF 2 1/4 INCH NATURAL RED OAK - - LIBRARY/DEN 20Aug21 Note:				
1 - HARDWOOD - GROUP B SERIES 5 INCH - IN LIEU OF 2 1/4 INCH NATURAL RED OAK - - FAMILY ROOM 20Aug21 Note:				

### MIRRORS AND GLASS

1 - ALL BATHROOMS - DELETE STANDARD MIRRORS - DO NOT INSTALL 20Aug21 Note:	
---	--

### PLUMBING

1 - SOAP DISPENSER - CHROME FINISH - MOEN #S3948C - KITCHEN 20Aug21 Note:	
4 - MOEN BATHROOM ACCESSORIES - MASON CHROME - TOWEL BAR 24" #YB8094/YB8000 - ALL BATHROOMS 20Aug21 Note:	
4 - MOEN BATHROOM ACCESSORIES - MASON CHROME - PAPER HOLDER #YB8099/YB8000 - ALL BATHROOMS 20Aug21 Note:	
1 - SINK - UNDERMOUNT SINK - BLANCO QUATRUS R15 U BAR #401515 20Aug21 Note:	
1 - SINK - UNDERMOUNT SINK - BLANCO QUATRUS R15 U SUPER SINGLE #401518 20Aug21 Note:	
1 - HOSE BIB - EXTERIOR FROST FREE - GARAGE - INSTALL AS CLOSE TO GARAGE DOOR AS POSSIBLE - IF CONSTRUCTION PERMITS 20Aug21 Note:	
3 - HOT WATER VALVE NEXT TO TOILET - ENSUITE 2 BATHROOM, ENSUITE 3/4 BATHROOM & POWDER ROOM 20Aug21 Note:	
1 - TOE TESTER - ADD TOE TESTER TO SHOWER - ENSUITE 3/4 BATHROOM 20Aug21 Note:	
1 - 5 FOOT SHOWER WITH SLIDING GLASS CHROME DOORS IN LIEU OF TUB - ENSUITE 3/4 BATHROOM 20Aug21 Note:	

### PROMOTIONAL

1 - LESS CREDIT FROM PURCHASER EXTRA SHEET IN OFFER 20Aug21 Note:	
--	--

### STAIRS AND RAILINGS

1 - STAIRCASE - EUROLINE R6-3 IRON PICKETS - BLACK 20Aug21 Note:	
1 - STAIRCASE - V GROOVE HANDRAIL 20Aug21 Note:	

## CONSTRUCTION SUMMARY

Mountainview Heights 3 (G) - Russell Gardens Building Ltd.

PURCHASERS: IMRAN IQBAL SINGIWALA and SAMIRA IMRAN SINGIWALA

TEL:

LOT / PHASE	REG. PLAN #	HOUSE TYPE		
342 / 3	62M-1266	Mountainash Eleven Elev 2		

1 - STAINED STAIRS – STANDARD STAIRCASE - PRICE IS PER SET

20Aug21 Note:

### EXTRAS AS PER OFFER

(1) The Vendor agrees that notwithstanding any other term or provision in this Agreement included in the Purchase Price and in addition to those items detailed in Schedule GP to the Agreement of Purchase and Sale, the Purchaser is entitled to a credit of *Worksheet* Note:

Purchase Price includes FOUR (4) enlarged basement windows, and the obligation to construct the house with the enlarged basement windows is subject to the Vendor's approval, in its sole and unfettered discretion The Purchaser acknowledges and agrees t  
*Worksheet* Note:

PURCHASER(S) ACKNOWLEDGES THAT THE PURCHASE PRICE IS INCLUSIVE OF ALL CREDITS AND PROMOTIONAL PACKAGES AVAILABLE AT TIME OF PURCHASE.

*Worksheet* Note:

**This Document is Extremely Time Sensitive - Printed 20 Aug 21 at 15:21**

**Purchasers:** IMRAN IQBAL SINGIWALA & SAMIRA IMRAN SI **Property:** 342  
**Telephone Res. / Bus:** / **Project:** Russell Gardens Building Ltd.  
**Decor Advisor:** Candace Forza **Model and Elevation:** Mountainash Eleven Elev 2  
**Lock Date:** 20-Aug-21 20-Aug-21 **Plan #:** 62M-1266

**Layout Changes:**  Yes  No **Sketch Attached:**  Yes  No **Exterior Colour Scheme:**

### 1. Cabinetry

	Style and Colour	Hardware
Kitchen / Breakfast	CONTINENTAL 350 DRIFTWOOD	722SC
Laundry Room	ELISSE	Standard
Powder Room	DORAL W-500	447SA
Master Ensuite Bathroom	DORAL K38 RIVERSIDE	431SA
Ensuite Bath - Bedroom 2	DORAL K44 TITAN GREY	431SA
Ensuite Bath - Bedroom 3/4	DORAL H3081 HACIENDA BLACK	431SA
	N/A	N/A
	N/A	N/A
	N/A	N/A



**Appliances:** **Built In Appliances**  Yes  No **Slide In Stove**  Yes  No  
**Dishwasher Cabinet**  Closed  Open **41" Upper Cabinets**  Yes  No Please NOTE: Standard Cabinet Height is 30"  
**Stove Opening**  NOTE: If not specified, opening will be set to builder's standard opening of approximately 30" width  
**Fridge Opening**  NOTE: If not specified, opening will be set to builder's standard opening of approximately 37" width x 74" height

**\*\* Refer to Construction Summary**

### 2. Counters

	Counter	Edge
Kitchen / Breakfast	QUARTZ-BIANCO STARDUST	#360
Laundry Room	N/A	
Powder Room	LAMINATE-CARRARA BIANCO 6696-46	
Master Ensuite Bathroom	LAMINATE-WHITE CARRARA 4924-38	
Ensuite Bath - Bedroom 2	LAMINATE-CALCUTTA MARBLE 4925K-07	
Ensuite Bath - Bedroom 3/4	LAMINATE-CARRARA BIANCO 6696-46	
	N/A	
	N/A	
	N/A	

**\*\* Refer to Construction Summary**

Initials:  

**Purchasers:** IMRAN IQBAL SINGIWALA & SAMIRA IMRAN SI **Property:** 342  
**Telephone Res. / Bus:** / **Project:** Russell Gardens Building Ltd.  
**Decor Advisor:** Candace Forza **Model and Elevation:** Mountainash Eleven Elev 2  
**Lock Date:** 20-Aug-21 20-Aug-21 **Plan #:** 62M-1266

### 3. Ceramic Flooring

		At a 45	Threshold-If App.
Entrance Vestibule	TILE-ELEMENTS CALACATTA LP-24X24 -	<input type="checkbox"/>	metal strip where applicable
Main Hall	N/A	<input type="checkbox"/>	
Kitchen / Breakfast	TILE-ELEMENTS CALACATTA LP-24X24 -	<input type="checkbox"/>	
Laundry Room	TILE-CONCEPT GREY-13X13	<input type="checkbox"/>	
Powder Room	TILE-ELEMENTS CALACATTA LP-24X24 -	<input type="checkbox"/>	
Master Ensuite Bathroom	TILE-SMOT ANTRACITE LAPP-24X24 -	<input type="checkbox"/>	
Ensuite Bath - Bedroom 2	TILE-TRAVERTINO MEM GRIGIO-24X24 -	<input type="checkbox"/>	
Ensuite Bath - Bedroom 3/4	TILE-CLASSIC STATUARIO MATTE-24X24 -	<input type="checkbox"/>	
	N/A	<input type="checkbox"/>	
	N/A	<input type="checkbox"/>	
	N/A	<input type="checkbox"/>	

\*\* Refer to Construction Summary

### 4. Ceramic Wall Tile

Master Ensuite Bathroom	Selection	Describe
Tub Deck Wall	N/A	
Tub Deck	N/A	
Tub Deck Skirt	N/A	
Shower Stall	TILE-SILVIA GREY-8X16	
Bathtub Enclosure Walls	N/A	
Ensuite Bath - Bedroom 2	TILE-LUC AFRICA-8X16	
Ensuite Bath - Bedroom 3/4	TILE-EXTRA DARK GREY-8X16	
	N/A	
	N/A	
	N/A	
Kitchen Backsplash	N/A	

\*\* Refer to Construction Summary - STANDARD GROUT THROUGHOUT UNLESS SPECIFIED

### 5. Plumbing Fixtures

All Bathrooms	White	Whirlpool <input type="checkbox"/> N/A <input type="radio"/> Yes <input checked="" type="radio"/> No  Dishwasher Rough-In <input checked="" type="radio"/> Yes <input type="radio"/> No Waterline for Fridge <input type="radio"/> Yes <input checked="" type="radio"/> No
	N/A	
	N/A	
	N/A	
	N/A	

\*\* Refer to Construction Summary

### 6. Trim Carpentry

Interior Doors	CARRARA-SMOOTH
Interior Trim	As Per Construction Specifications
Door Handles	As Per Construction Specifications
Exterior Front Door Handle	As Per Construction Specifications

\*\* Refer to Construction Summary

Initials:  

**Purchasers:** IMRAN IQBAL SINGIWALA & SAMIRA IMRAN SI **Property:** 342  
**Telephone Res. / Bus:** / **Project:** Russell Gardens Building Ltd.  
**Decor Advisor:** Candace Forza **Model and Elevation:** Mountainash Eleven Elev 2  
**Lock Date:** 20-Aug-21 20-Aug-21 **Plan #:** 62M-1266

### 7. Outer Flooring

Main Hall	N/A	
Living Room	STRIP-VINTAGE-NSS-WIRE BRUSHED-CHARACTER-UV URETHANE OIL-RED OAK-TITAN-5"	
Dining Room	STRIP-VINTAGE-NSS-WIRE BRUSHED-CHARACTER-UV URETHANE OIL-RED OAK-TITAN-5"	
Family Room	STRIP-VINTAGE-NSS-WIRE BRUSHED-CHARACTER-UV URETHANE OIL-RED OAK-TITAN-5"	
Den / Library / Study	STRIP-VINTAGE-NSS-WIRE BRUSHED-CHARACTER-UV URETHANE OIL-RED OAK-TITAN-5"	
Basement Landing (If Applies)	N/A	
Lower Landing (If Applies)	N/A	
Upper Landing	STRIP-VINTAGE-NSS-WIRE BRUSHED-CHARACTER-UV URETHANE OIL-RED OAK-TITAN-5"	
Upper Hall	LAMINATE-PARKLANE-VENICE OAK GREY-TL-EL-3906	
Master Bedroom	LAMINATE-PARKLANE-VENICE OAK GREY-TL-EL-3906	
Bedroom #2	LAMINATE-PARKLANE-VENICE OAK GREY-TL-EL-3906	
Bedroom #3	LAMINATE-PARKLANE-VENICE OAK GREY-TL-EL-3906	
Bedroom #4	LAMINATE-PARKLANE-VENICE OAK GREY-TL-EL-3906	
Bedroom #5	N/A	
FLEX ROOM	LAMINATE-PARKLANE-VENICE OAK GREY-TL-EL-3906	
	N/A	
	N/A	
Underpad	Type	Area
	N/A	N/A

\*\* Refer to Construction Summary

### 8. Railings and Pickets

Railing Type	V-GROOVE	Colour	VINTAGE TITAN RED OAK
Picket Type	PICKETS R-6-3	Colour	BLACK
Stringer / Riser	AS PER CONSTRUCTION SPECIFICATIO	Colour	VINTAGE TITAN RED OAK
Treads	AS PER CONSTRUCTION SPECIFICATIO	Colour	VINTAGE TITAN RED OAK
Red Oak Stairs with Semi Gloss Finish		<input checked="" type="radio"/> Yes <input type="radio"/> No	

\*\* Refer to Construction Summary THE STAIN COLOURS OR FINISH AVAILABLE ON RISERS, TREADS, PICKETS AND RAILS (STAIRCASES), WILL NOT BE AN EXACT MATCH TO PREFINISHED HARDWOOD OR LAMINATE FLOORS.

### 9. Wall Paint Flat Finish

Main & Upper Hall	22 WARM GREY	Master Bedroom	22 WARM GREY
Living Room	22 WARM GREY	Bedroom #2	22 WARM GREY
Dining Room	22 WARM GREY	Bedroom #3	22 WARM GREY
Kitchen / Breakfast	22 WARM GREY	Bedroom #4	22 WARM GREY
Family Room	22 WARM GREY	Bedroom #5	N/A
Powder Room	22 WARM GREY	Master Ensuite	22 WARM GREY
Laundry Room	22 WARM GREY	Ensuite Bath - Bedroom 2	22 WARM GREY
Den/Library	22 WARM GREY	Ensuite Bath - Bedroom 3/4	22 WARM GREY
Trim Paint-Semi Gloss	BIRCH WHITE	FLEX ROOM	22 WARM GREY
	N/A		N/A
	N/A		N/A

Smooth Ceilings First Floor     Yes     No

\*\* Refer to Construction Summary

Initials: \_\_\_\_\_

**Purchasers:** IMRAN IQBAL SINGIWALA & SAMIRA IMRAN S  
**Property:** 342  
**Telephone Res. / Bus:** / **Project:** Russell Gardens Building Ltd.  
**Decor Advisor:** Candace Forza **Model and Elevation:** Mountainash Eleven Elev 2  
**Lock Date:** 20-Aug-21 20-Aug-21 **Plan #:** 62M-1266

### 10. Plaster Mouldings and Medallions

Entrance Vestibule	N/A	N/A	Kitchen/Breakfast	N/A	N/A
Main Hall	N/A	N/A	Den/Library	N/A	N/A
Living Room	N/A	N/A	Lower Landing	N/A	N/A
Dining Room	N/A	N/A		N/A	N/A
Family Room	N/A	N/A		N/A	N/A

\*\* Refer to Construction Summary

### 11. Fireplace

	Living Room			Family Room			Other Room - Specify		
	Purchased	As Per Plan	N/A	Purchased	As Per Plan	N/A	Purchased	As Per Plan	N/A
Fireplace Type	<input type="radio"/>	<input type="radio"/>	<input checked="" type="radio"/>	<input type="radio"/>	<input checked="" type="radio"/>	<input type="radio"/>	<input type="radio"/>	<input type="radio"/>	<input checked="" type="radio"/>
Mantle Type	N/A			FLAT ON WALL			N/A		
Colour / Stain	N/A			MANTLE M1-STANDARD			N/A		
Surround	N/A			AS PER CONSTRUCTION SPECIFICATIONS			N/A		
Hearth	N/A			GRIGIO CARNICO			N/A		
	N/A			NO			N/A		

\*\* Refer to Construction Summary

### 12. Heating and Air Conditioning

**Air Conditioning**  **Gas Provisions Stove**   
**Gas Provisions Dryer**  **Gas Provisions Barbecue**

Comment

\*\* Refer to Construction Summary

### 13. Electrical

**Plugs and Switches**  White  **Above Kitchen Cabinet Light**  Yes  No  
**Hood Fan**  **Below Kitchen Cabinet Light**  Yes  No  
**Appliances** **Built in Cooktop**  Yes  No **Built in Oven**  Yes  No **Gas Stove**  Yes  No **Microwave**  Yes  No  
**Dishwasher Rough-in**

\*\* Refer to Construction Summary

### 14. General Comments

\*\* Refer to Construction Summary

### Disclaimers and Notes

- Colours of all materials are as close as possible to builder's selection, but not necessarily identical due to variances in manufacturing.
- Any extras listed above are null and void unless accompanied by a separate invoice/amendment. Said invoice must be paid in full.
- The Purchaser agrees that this colour selection is final and that no changes will be permitted, unless required by the Vendor.
- The Purchaser acknowledges reading and accepting document which contains other miscellaneous disclaimers.

Signature:  Date: 20-AUG-2021  
 Signature:  Date: 20-AUG-2021



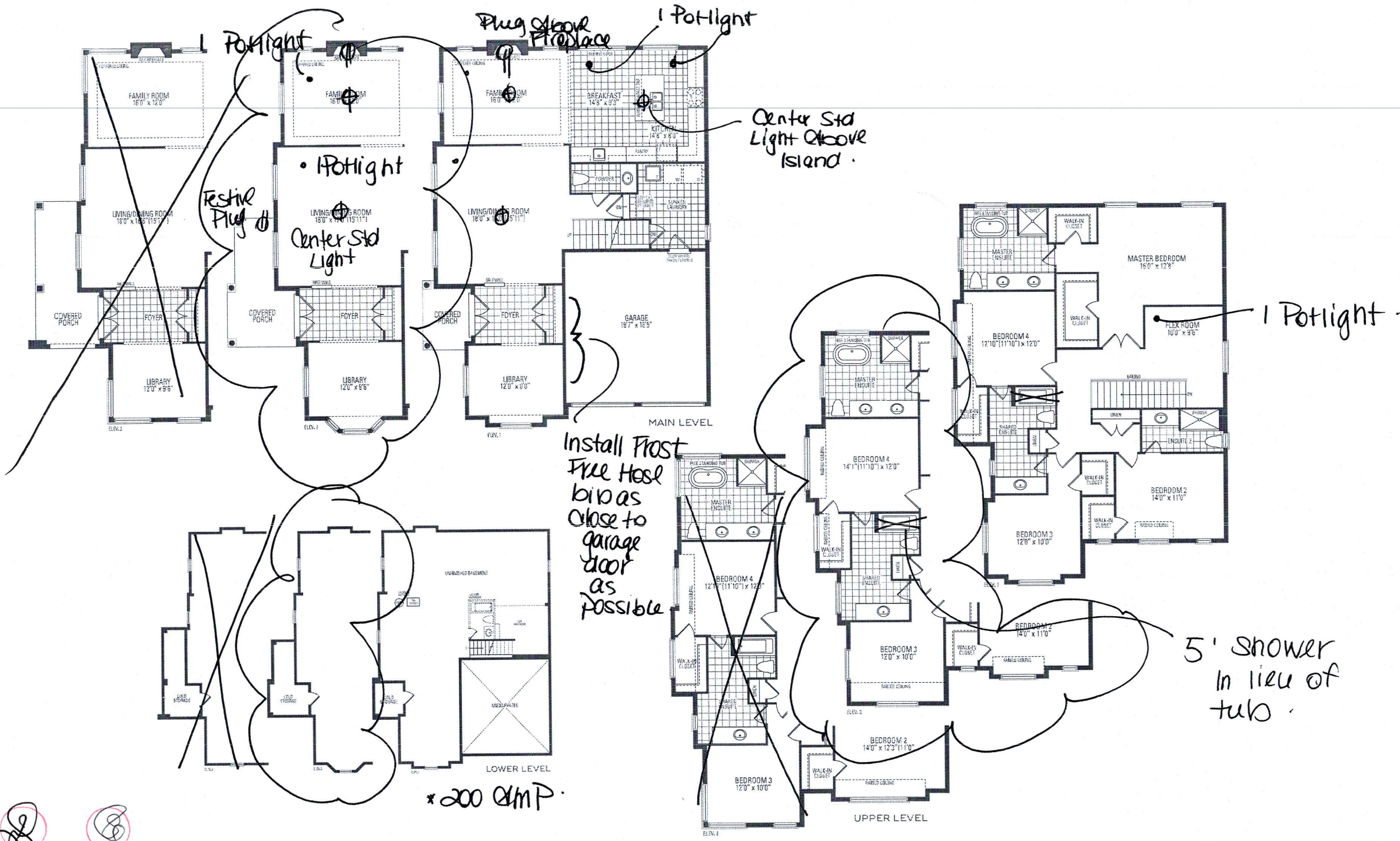

**MOUNTAINASH ELEVEN** ELEV. 1 • 2,958 sq.ft. | ELEV. 2 • 3,001 sq.ft. | ELEV. 3 • 2,975 sq.ft.

Orientation of home may be reversed and purchaser agrees to accept the same. Steps and porches may vary at any exterior entrance ways due to grading variance. Actual usable floor space may vary from the stated floor areas. All renderings are artist's concept. Dimensions, specifications and architectural detailing subject to modifications. Roofline and adjoining model types may vary due to siting. E. & O. E. May 2020

Kitchen

• cm 11 moulding  
 • upg. & hardware

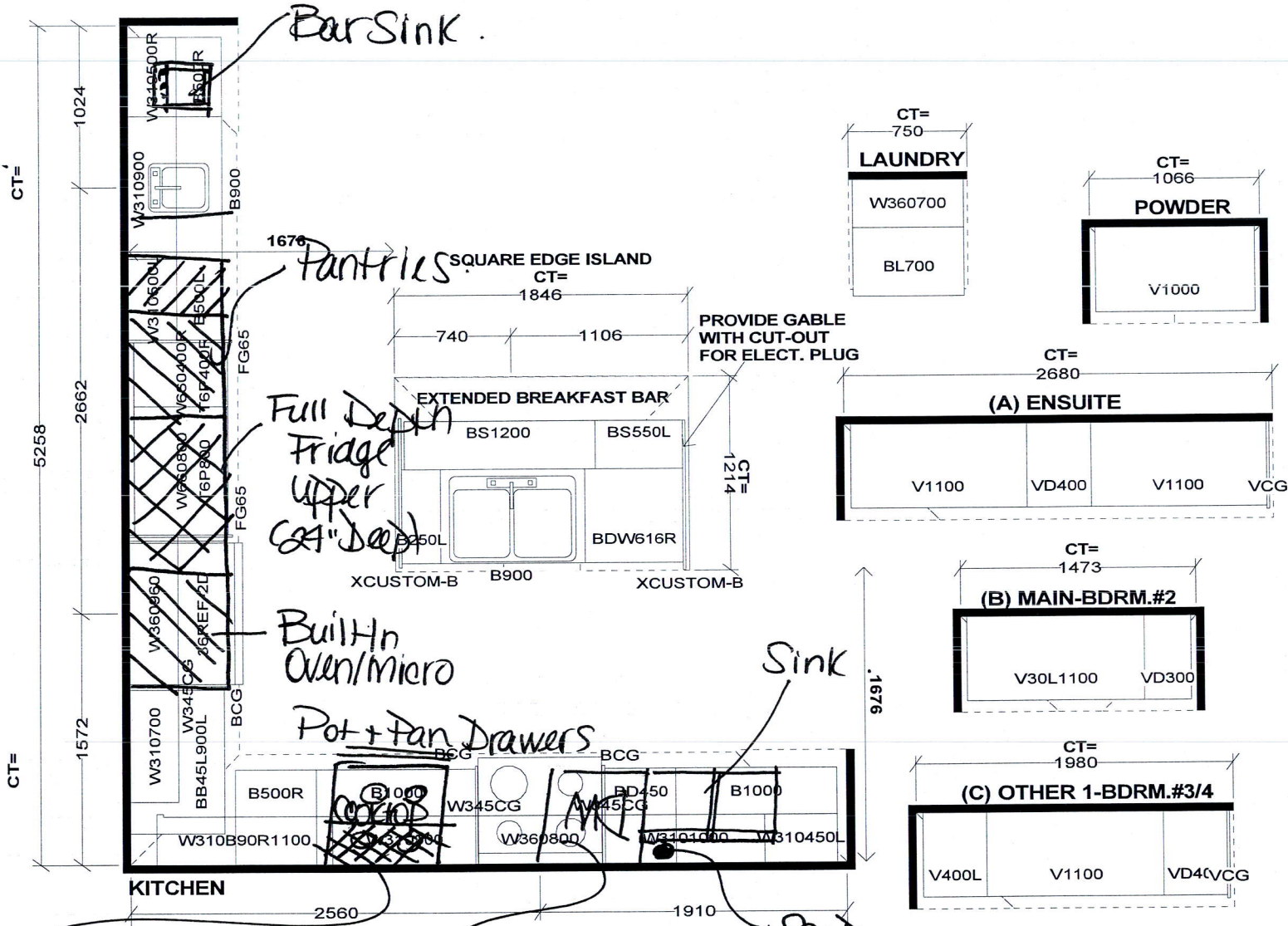

Delete Cabinetry Above (Cooks)

Ⓢ Ⓠ

**Selba Industries** J# \_\_\_\_\_

W WIDTH _____	W HGHT _____	W CNT _____	This drawing is the intellectual property of SELBA INDUSTRIES INC. and is an original design which must not be released or copied unless applicable fee has been paid or job order placed.	JOB NUMBER: BUILDER: GREENPARK SITE: RUSSELL GARDENS PH.3 MODEL: MOUNTAINASH 11X EL 2,3 LOT #:
FLOOR HGHT _____	DOOR HGHT _____			
ST CENT _____	2X4 _____	VENT BOX COVER _____		
DESIGNER: KS DATE: MAY 13 20 REV'D AUG 27 20				

**Wall Mounted**

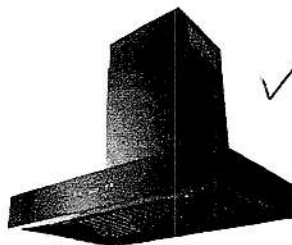
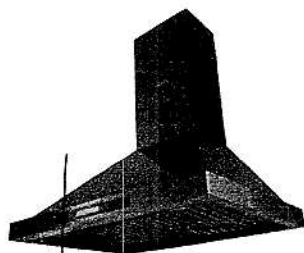

✓ 36 inch

**Frankfurt**

**Stuttgart**

Model #	VRH-W105	VRH-W106 ✓
CFM	900 CFM	900 CFM
Width	30", 36"	30", 36"
Filter Type	Baffle Filter	Baffle Filter
Color/Finish	Black Stainless Steel	Black Stainless Steel
Light Type	LED	LED
# of Lights	2	2
Control Type	Touch Screen	Digital Control
Motor Power	150 Watts	150 Watts
# of Motors	1	1
Fan Speeds	4 Speeds	4 Speeds
Chimney Dimension (W x D x H)	10.75" x 8" x (19" - 34")	12.75" x 11.5" x (19" - 42")
Product Dimension (W x D x H)	29.5" x 22" x 13.25" (30" Model) 35.5" x 22" x 13.25" (36" Model)	29.5" x 19.75" x 4" (30" Model) 35.5" x 19.75" x 4" (36" Model) ✓
Vent Size	6"	6"
Vent Shape	Top Round	Top Round
Features	Delayed Shut-off Oil Tray Remote Control Smoke Sensor	Delayed Shut-off Oil Tray

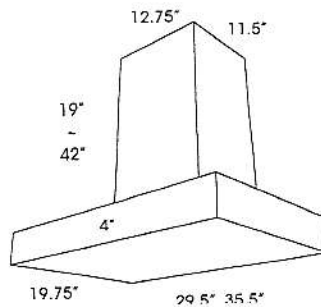
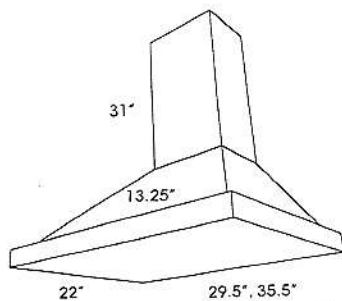

# 30" Speed Combination Oven

800 Series – Black Stainless Steel HBL8743UC

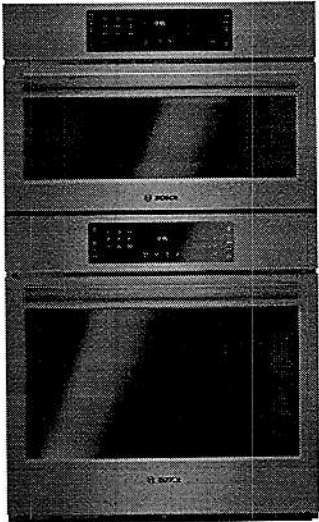

**HBL8743UC**  
Black Stainless Steel

Also available in:  
Stainless Steel HBL8753UC

**Bosch speed combination ovens create an all-in-one cooking center with an upper speed oven and a Genuine European Convection oven below.**

### Features & Benefits

Bosch black stainless steel helps guard against scratches and fingerprints.

2-in-1 microwave and convection oven with 9 SpeedChef® programs to simplify cooking with fast results.

Lower oven's convection multi-rack mode gives uniform baking results even when using all 3 racks simultaneously.

Download the Home Connect app to remotely monitor and control your Bosch wall oven with your smart phone or tablet.

### General Properties

Home Connect™ – lower cavity (WiFi enabled)	Yes
Cooking modes – upper cavity	Speed oven; 12 Auto Programs (including Auto Defrost, Melt Butter, Soften Ice Cream, Pizza), 9 Sensor Cook Programs, 9 SpeedChef® Programs, Hi & Lo Broil, European Convection, Keep Warm, Frozen Foods
Cooking modes – lower cavity	Bake, Variable Broil (hi & low), Roast, Warm, Sabbath, Proof Dough, Convection Bake, Convection Broil, Convection Roast, Pizza, Multi Rack Genuine European Convection, Convection Conversion, Temperature Probe, Fast Preheat

Cleaning type – lower	Self Clean
Telescopic rack	1
Illumination type	LED (Upper) / Incandescent (Lower)
Interior lights	1 Upper / 2 Lower

### Oven Performance

Microwave power – upper cavity	1000 W
Bake / broil element wattages – upper cavity	600 / 1,750 W
Convection element wattages – upper cavity	1,700 W
Bake / broil element wattages – lower cavity	2,400 / 3,800 W
Convection element wattages – lower cavity	2,000 W

### Technical Details

Watts (W)	9,600 W
Circuit breaker (A)	40 A
Volts (V); Frequency (Hz)	240 / 208 V; 60 Hz
Power cord length (in)	50"
Plug type	Fixed Connection, No Plug
Energy source	Electric

### Dimensions & Weight

Overall appliance dimensions (HxWxD)(in)	49" x 29 3/4" x 24 1/2"
Required cutout size – Standard (HxWxD) (in)	48 5/8" x 28 1/2" x 23 1/2"
Required cutout size – Flush (HxWxD) (in)	49 1/8" x 30" x 24 1/2"
Speed oven cavity size – upper	1.6 cu. ft.
Overall upper speed oven interior dimensions (HxWxD) (in.)	9 7/8" x 16 1/2" x 16 1/2"
Metal turntable diameter (in)	13 3/4" dia.
Turntable – ceramic cookware max. – upper	12 1/2" dia.
Rack – rectangular cookware max. – upper	15" x 12"
Oven cavity size – lower	4.6 cu. ft.
Overall lower oven interior dimensions (HxWxD) (in)	17 13/16" x 24 1/8" x 18"
Usable lower oven interior dimensions (HxWxD) (in)	12 1/4" x 23 1/4" x 15 1/4"
Net weight (lbs)	259 lbs

### Accessories – Included

Upper Oven: Metal Turntable, Square rack, Ceramic Cooking Tray  
Lower Oven: 1 Telescopic and 2 Standard Oven Racks, Meat Probe

### Accessories – Optional



**HEZTR301**  
30" Telescopic Rack



\*Lower wall oven only

**Accessories:** To purchase Bosch accessories, cleaners & parts please visit [www.bosch-home.com/us/store](http://www.bosch-home.com/us/store) or call 1-800-944-2904 (Mon to Fri 5 am to 6 pm PST, Sat 6 am to 3 pm PST).  
**Notes:** All height, width and depth dimensions are shown in inches. BSH reserves the absolute and unrestricted right to change product materials and specifications, at any time, without notice. Consult the product's installation instructions for final dimensional data and other details prior to making cutout.  
**Warranties:** Please see Use & Care manual or Bosch website for statement of limited warranty.

For more information on our entire line of products, go to [www.bosch-home.com/us](http://www.bosch-home.com/us) or call 1-800-944-2904

© BSH Home Appliances Corporation. All rights reserved. Bosch is a registered trademark of Robert Bosch GmbH.

# 30" Speed Combination Oven

800 Series – Black Stainless Steel HBL8743UC



## Installation Details

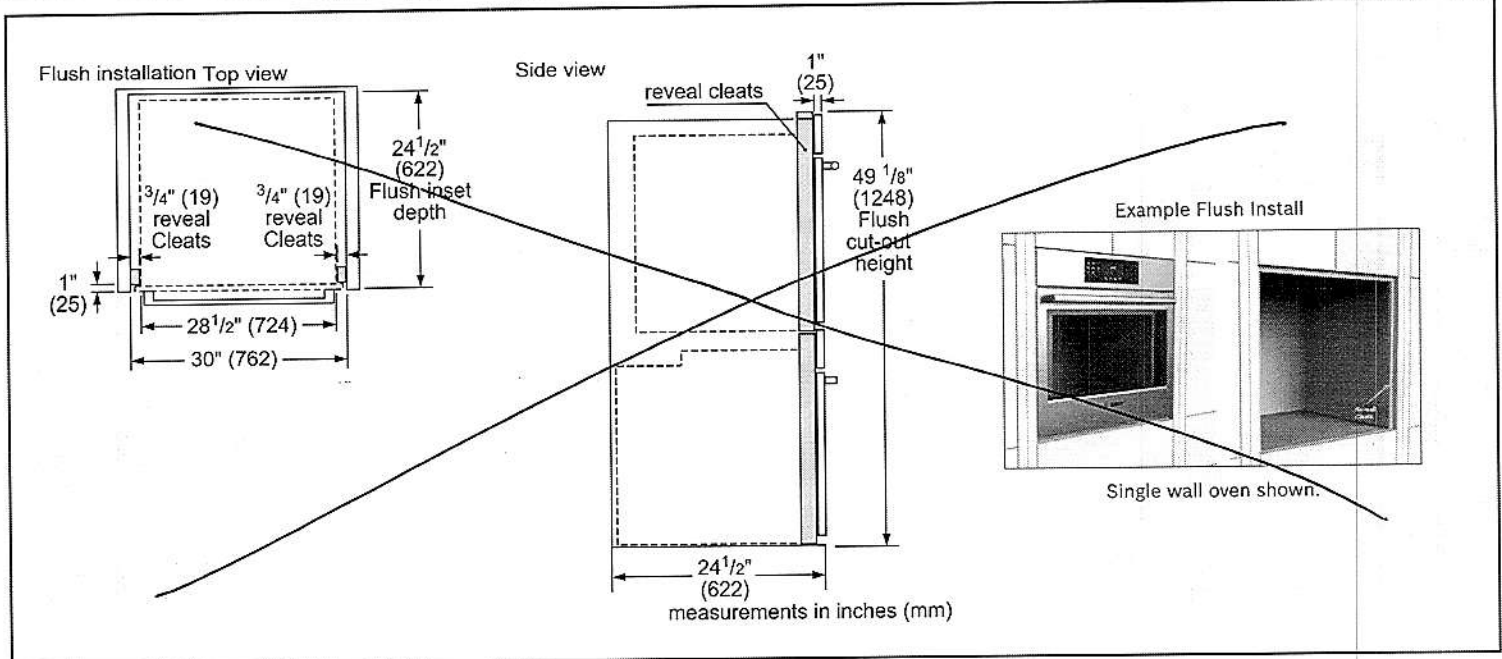
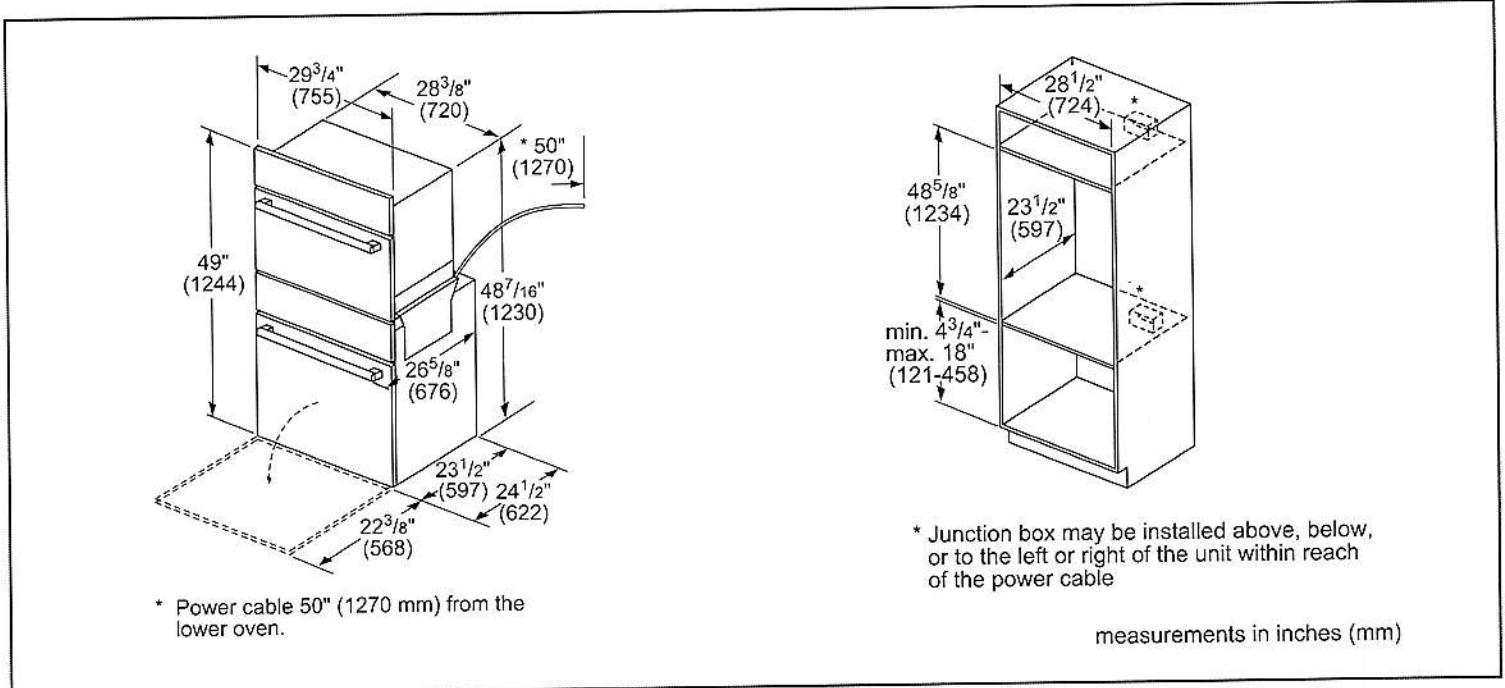

**Accessories:** To purchase Bosch accessories, cleaners & parts please visit [www.bosch-home.com/us/store](http://www.bosch-home.com/us/store) or call 1-800-944-2904 (Mon to Fri 5 am to 6 pm PST, Sat 6 am to 3 pm PST).

**Notes:** All height, width and depth dimensions are shown in inches. BSH reserves the absolute and unrestricted right to change product materials and specifications, at any time, without notice. Consult the product's installation instructions for final dimensional data and other details prior to making cutout.

**Warranties:** Please see Use & Care manual or Bosch website for statement of limited warranty.

For more information on our entire line of products, go to [www.bosch-home.com/us](http://www.bosch-home.com/us) or call 1-800-944-2904

© BSH Home Appliances Corporation. All rights reserved. Bosch is a registered trademark of Robert Bosch GmbH.

# NA36N7755TS

SAMSUNG

## 36" Gas Cooktop

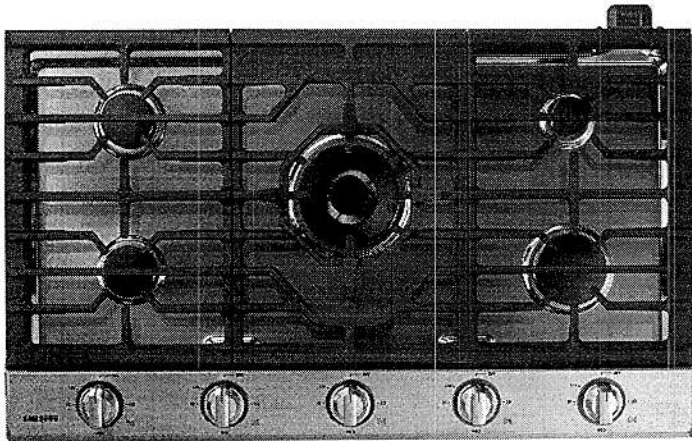

### Signature Features

#### 22K True Dual-Power Burner

- Two independent heating burners offer intense heat and precise control to quickly boil water or temper chocolate.

#### Analog Controls with Digital Wi-Fi and Bluetooth® Technology

- The ultimate combination of analog comfort and digital technology delivers exceptional cooking performance.

#### Cast Iron Griddle

- Cook breakfast, grill sandwiches, or sauté vegetables on the removable griddle.

### Available Colors



Stainless Steel (shown)



Fingerprint Resistant  
Black Stainless Steel

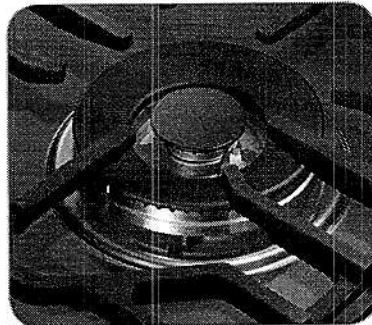

22K True Dual-Power Burner

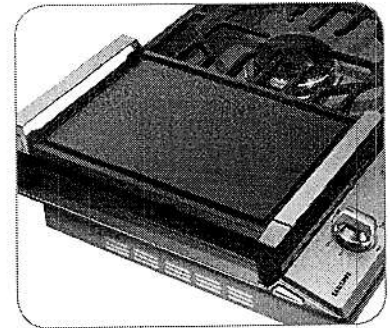

Cast Iron Griddle

### Features

- Bluetooth® Connected to Hood
- Blue LED Lights
- Wi-Fi Connectivity
- Powerful Cooktop
  - Right Front: 13K BTU
  - Left Front: 9.5K BTU
  - Right Rear: 5K BTU
  - Left Rear: 9.5K BTU
  - Center: True Dual, 22K BTU (Brass)

- Cast Iron 3-Piece Grates
- Sealed Burners
- Burner On/Off Monitoring
- ADA Compliant

### Convenience

- Wok Grate
- LP Conversion Kit



ADA Compliant

# NA36N7755TS

**SAMSUNG**

## 36" Gas Cooktop

### Installation Requirements

Countertop cut-out and minimum clearance dimensions:

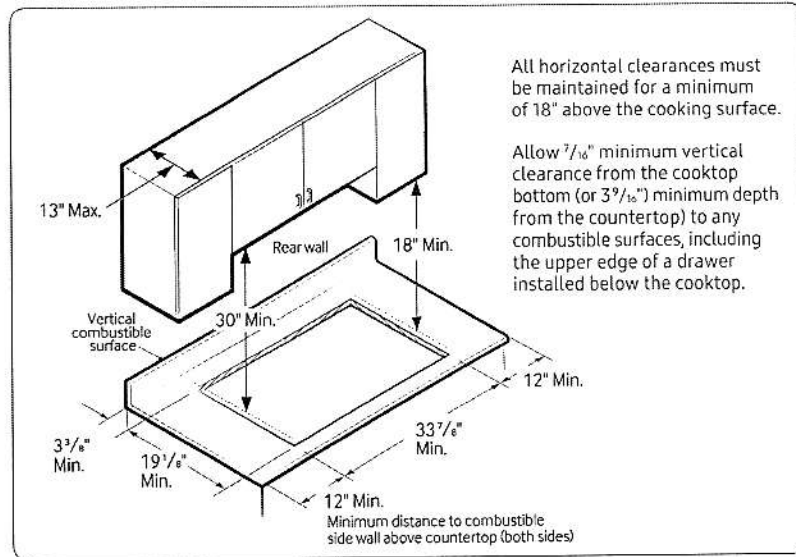

### Total Power (BTU)

59K

### Power Source

120V / 60 Hz / 1A

### Gas Cooktop (BTU)

- Right Front: 13K
- Left Front: 9.5K
- Right Rear: 5K Simmer
- Left Rear: 9.5K
- Center: 22K (True Dual)

### Warranty

One (1) Year All Parts and Labor

### Product Dimensions & Weight (WxHxD)

Outside (Max) Cooktop Dimensions:

36" x 5 $\frac{41}{72}$ " x 22 $\frac{1}{3}$ "

Cooktop Cut-Out Dimensions:

33 $\frac{7}{8}$ " x 3 $\frac{1}{8}$ " x 19 $\frac{1}{8}$ "

Weight: 87.7 lbs. (88.4 lbs. Fingerprint Resistant Black Stainless Steel)

### Shipping Dimensions & Weight (WxHxD)

Dimensions: 40 $\frac{9}{16}$ " x 10 $\frac{5}{8}$ " x 25 $\frac{5}{8}$ "

Weight: 95.9 lbs. (97.2 lbs. Fingerprint Resistant Black Stainless Steel)

### Color

Stainless Steel

### Model #

NA36N7755TS

### UPC Code

887276281766

Fingerprint Resistant

Black Stainless Steel

NA36N7755TG

887276281759

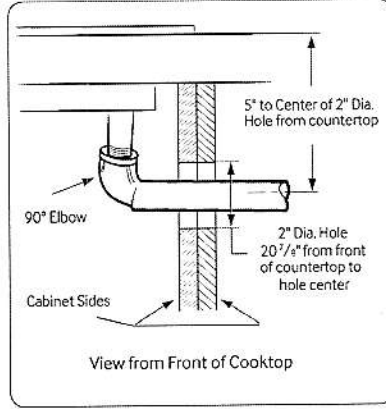
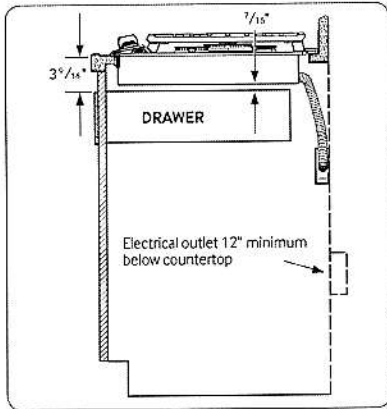

### Installing Over a Single Oven

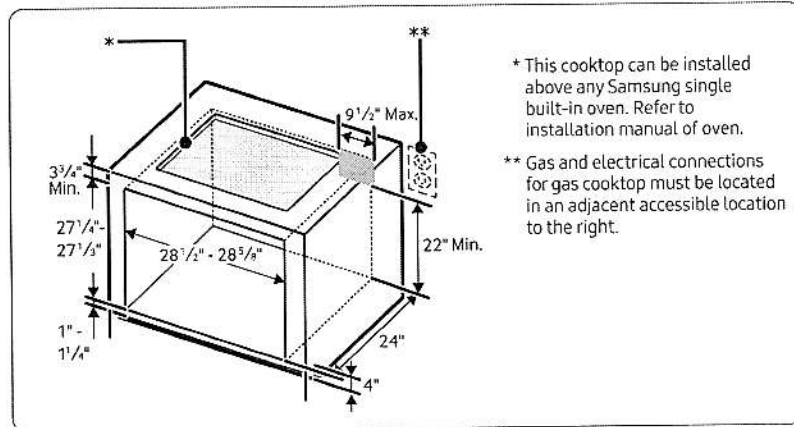

### Cooktop Dimensions

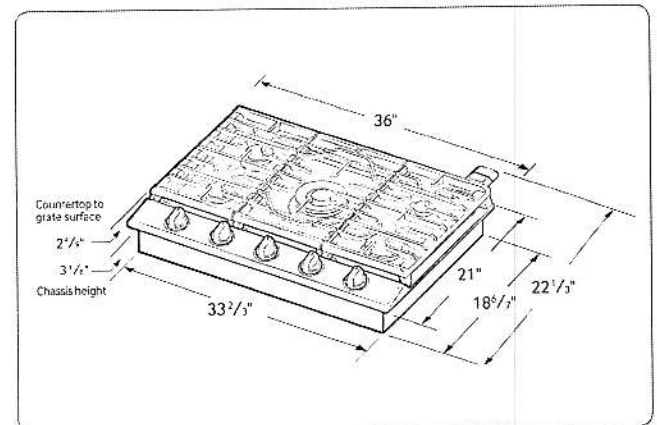

B36CD50SNB

Installation dimensions

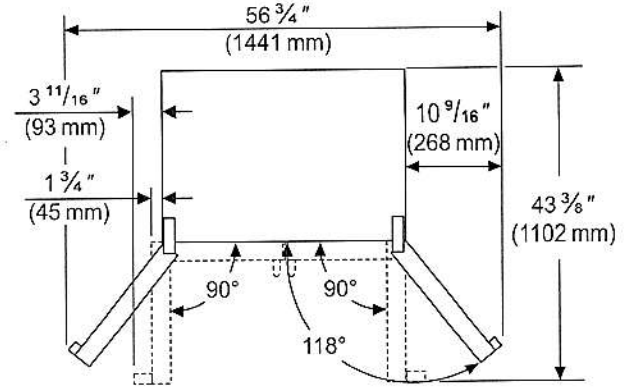
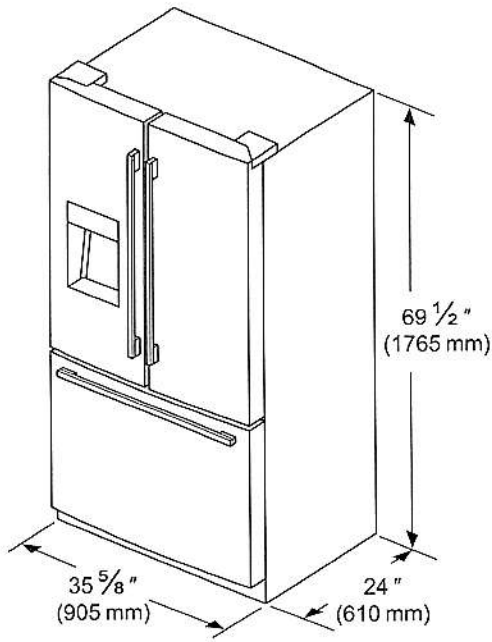

Minimum clearances

Leave a clearance of 1/2" (12.7 mm) above the appliance.

Observe minimum clearances as follows:

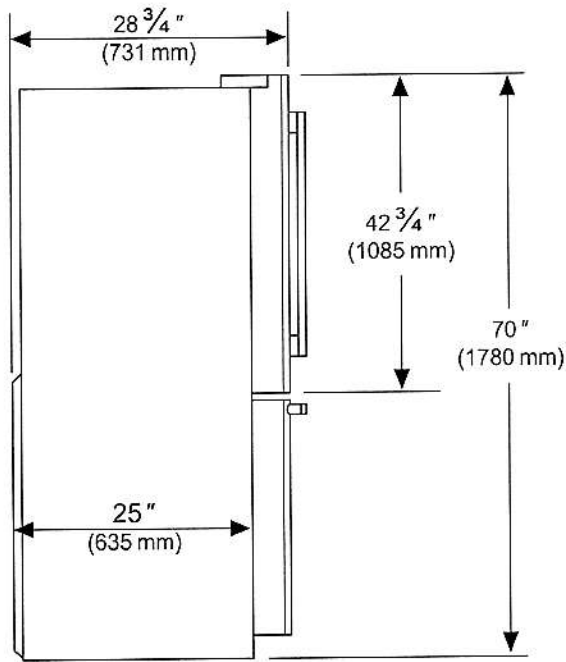
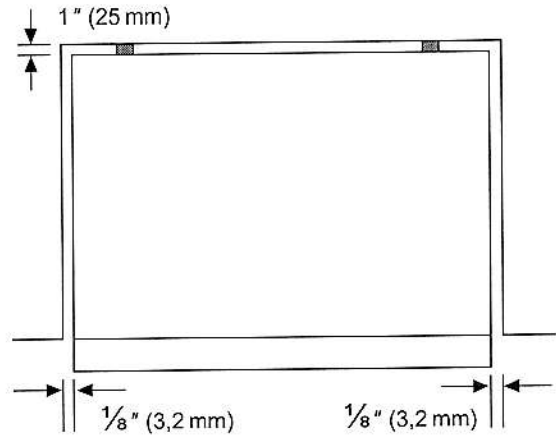

Niche dimensions

If you install the appliance in a niche, adhere to the following dimensions:

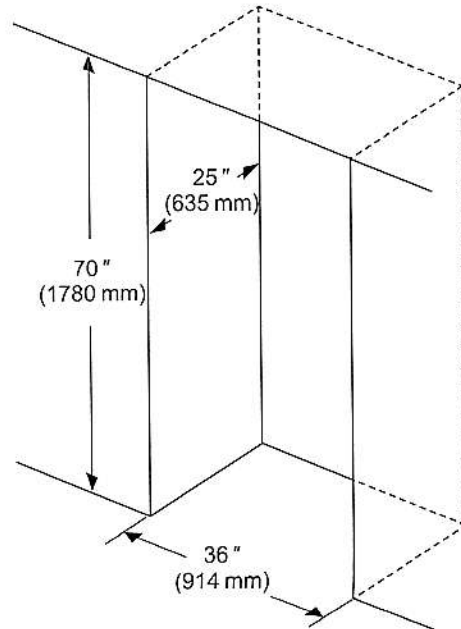

Door opening angle

If the installation location limits the door opening angle to less than 118°, buy a 90° door stopper from our customer service.

→ "Customer service" on page 34

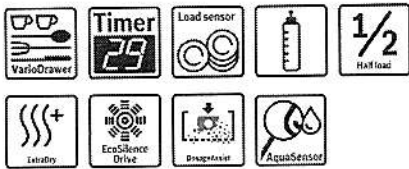
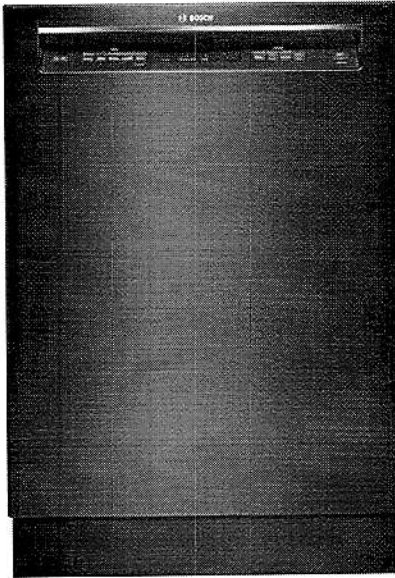

**Dishwashers**
**24" Recessed Handle  
Dishwasher  
300 Series- Black  
SHEM63W56N**

**The 3rd rack provides the perfect space for silverware and large utensils while its V shape leaves room below for taller items.**

- **44 dBA:** Quietest dishwasher brand.
- A 3rd rack adds versatility and offers 30% more loading capacity.
- FlexSpace™ Tines fold back to fit your larger pots & pans.
- RackMatic® offers 3 height levels, for 9 possible rack positions.
- Speed60® gets your dishes from dirty to dry in about an hour.

**Technical Data**

Upper Rack :	500
Adjustable upper rack :	Rackmatic 3-stage
Upper rack cup shelf :	2
Lower Rack :	500
3rd Rack :	3rd Rack 1.0
Silverware Basket :	Standard
Accessories Parts :	no
Optional accessories :	
SGZ1010UC, SMZ4000UC, SMZ5000, SMZPC002UC	
UPC code :	825225922445
Variant color :	Black
Panel ready :	No
Alternative colors available :	SHEM63W52N, SHEM63W55N
Silence level (dBA) :	44
Watts (W) :	1300
Current (A) :	12
Volts (V) :	120
Frequency (Hz) :	60
Energy Consumption (kWh/yr) :	269
Energy Star® qualified :	Yes
Plug type :	fixed connection
Required cutout size (HxWxD) (in) :	x 33 7/8 " x 23 9/16 "
Required cutout size (HxWxD) (mm) :	860-890 x 610 x 610
Overall appliance dimensions (HxWxD) (in) :	
33 7/8 " x 23 9/16 " x 23 3/4 "	
Power cord length (in) :	43 1/2"
Power cord length (cm) :	110
Length outlet hose (in) :	67 "
Length outlet hose (cm) :	175
Product packaging dimensions (HxWxD) (in) :	
35 3/4" x 26" x 29 5/16"	
Tub material :	Stainless steel
Tub type :	TallTub
ADA Compliant :	No
Number of place settings :	16

**Optional accessories**

- SGZ1010UC : Drain hose extension kit
- SMZ4000UC : silverware basket US Duo
- SMZ5000 : Dishwashing aid set
- SMZPC002UC : Powercord with cold plug

## Dishwashers

### 24" Recessed Handle Dishwasher

#### 300 Series- Black SHEM63W56N

**The 3rd rack provides the perfect space for silverware and large utensils while its V shape leaves room below for taller items.**

---

#### Key Features

- 44 dB - Quietest Dishwasher Brand.
- 3rd Rack for Additional Loading Capacity
- InfoLight® Beams on Floor to Indicate Dishwasher is Running
- RackMatic® on Upper Rack - 3 Height Adjustments and Up to 9 Possible Rack Positions
- AquaStop® Leak Protection Works 24/7

#### Design

- Full Size Stainless Steel Tall Tub Installs Perfectly Flush
- 3rd Rack for Additional Loading Capacity
- 16 Place Setting Capacity
- LED Remaining Time Display
- RackMatic® on Upper Rack - 3 Height Adjustments and Up to 9 Possible Rack Positions

#### Performance

- 44 dB - Quietest Dishwasher Brand.
- 5 Wash Cycles and 4 Options
- Detergent Tray Optimizes Detergent Dissolving
- Speed60® gets your dishes from dirty to dry in about an hour.
- Extra Dry Option for Better Drying Results
- Load Size Sensor Automates Wash Temperature
- Sanitize Option Eliminates Bacteria and Enhances Drying Results

#### Efficiency

- 269 kwh/yr - Energy Star®

#### Convenience

- Electronic delay timer: 1-24 hours Delay Start Timer
- AquaStop® Leak Protection Works 24/7
- Self-Latching Door

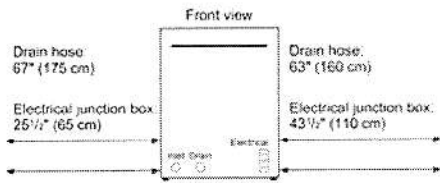
**Dishwashers****24" Recessed Handle Dishwasher  
300 Series- Black  
SHEM63W56N**

All connections are at the rear of the appliance.  
Extension for drain hose available as accessory.  
Power cord for connection to electrical outlet (3-prong plug)  
available as accessory.