

CONSTRUCTION SUMMARY				
Mountainview Heights 3 (G) - Russell Gardens Building Ltd.				
PURCHASERS: KARAMVIR SINGH JUTLA and SABA HAQUE				TEL:
LOT / PHASE 188 / 3	REG. PLAN # 62M-1266	HOUSE TYPE Mountainash Eleven Elev 3		

CABINETRY

1 - LAUNDRY ROOM - HARDWARE UPGRADE 2 21Sep21 Note:	
1 - VANITY - POWDER ROOM - HARDWARE UPGRADE 2 16Sep21 Note:	
3 - KITCHEN - APPLIANCE PULLS FOR DISHWASHER AND FRIDGE - BP8160304160 16Sep21 Note:	
1 - CABINETRY - KITCHEN - HARDWARE UPGRADE 2 16Sep21 Note:	
1 - CABINETRY - KITCHEN - LIGHT VALENCE 16Sep21 Note:	
1 - CABINETRY - KITCHEN - CM3 CROWN MOULDING 16Sep21 Note:	
1 - KITCHEN CABINETRY - TWO COLOUR KITCHEN - FLAT FEE 16Sep21 Note:	
1 - CABINETRY - KITCHEN - UPGRADE 3 16Sep21 Note:	
1 - VANITY - POWDER ROOM - UPGRADE 3 16Sep21 Note:	
1 - VANITY - ENSUITE BATHROOM - UPGRADE 3 16Sep21 Note:	

CABINETRY ACCESSORIES

1 - LAUNDRY ROOM - BASE CABINETS - UPGRADE 3 16Sep21 Note:	
1 - LAUNDRY ROOM - UPPER CABINETS - 760 HEIGHT - UPGRADE 3 16Sep21 Note:	
1 - KICTHEN - SHIFT BAR SINK AND PANTRY TO ACCOMMODATE BUILT-IN APPLIANCES - SEE SKETCH 16Sep21 Note:	
1 - KITCHEN CABINETRY BASE - PULLOUT WIRE SPICE RACK - PRICE IS EACH 16Sep21 Note:	
1 - KITCHEN - BLU MOTION DRAWERS 16Sep21 Note:	
1 - KITCHEN - SOFT CLOSING CABINETRY 16Sep21 Note:	
1 - KITCHEN HOOD CABINETS - CONTEMPORARY WOOD HOOD – UPGRADE 3 16Sep21 Note: PUCHASER TO SUPPY AND INSTALL HOOD FAN AFTER CLOSING	

CONSTRUCTION SUMMARY

Mountainview Heights 3 (G) - Russell Gardens Building Ltd.

PURCHASERS: KARAMVIR SINGH JUTLA and SABA HAQUE

TEL:

LOT / PHASE 188 / 3	REG. PLAN # 62M-1266	HOUSE TYPE Mountainash Eleven Elev 3		
------------------------	-------------------------	---	--	--

6 - KITCHEN CABINETRY ACCESSORY - GLASS SHELVES - STRAIGHT - PRICE IS EACH 16Sep21 Note:	
2 - KITCHEN CABINETRY UPPER - GLASS DOOR - WATERFALL - FINISHED INTERIOR - FITS TALL UPPER CABINETS - PRICE IS PER DOOR - UPGRADE 3 16Sep21 Note:	
1 - KITCHEN CABINETRY BASE - PULLOUT RECYCLE 2 BIN - PRICE IS EACH 16Sep21 Note:	
1 - KITCHEN CABINETRY BASE - GRIDDLE WITH POT DRAWERS (2 DRAWERS) - UPGRADE 3 16Sep21 Note:	
1 - KITCHEN CABINETRY BASE - COOKTOP CABINET WITH POT DRAWERS (2 DRAWERS) - UPGRADE 3 16Sep21 Note:	
1 - KITCHEN CABINETRY BASE - BANK OF DRAWERS - UPGRADE 3 16Sep21 Note:	
1 - KITCHEN CABINETRY BASE - PIE CUT CORNER CABINET - BASE CABINETRY - UPGRADE 3 16Sep21 Note:	
1 - CABINETRY FEE FOR FLUSH CUTOUT ON WALL OVEN/MICROWAVE COMBO CABINET ONLY 16Sep21 Note:	
1 - KITCHEN CABINETRY - BUILT-IN MICROWAVE/OVEN COMBO - UPGRADE 3 16Sep21 Note:	
1 - KITCHEN CABINETRY - APPLIANCE DOOR PANELS - 24" DISHWASHER DOOR PANEL (SUPPLY ONLY) - UPGRADE 3 16Sep21 Note:	
1 - KITCHEN CABINETRY - APPLIANCE DOOR PANELS - FRIDGE DOOR PANELS - SUPPLY ONLY - 42"-48" WIDE FRIDGES - UPGRADE 3 16Sep21 Note:	
2 - KITCHEN CABINETRY UPPER - FULL DEPTH ABOVE FRIDGE - WITH GABLES - 600MM - PRICE IS EACH - UPGRADE 3 16Sep21 Note:	
1 - KITCHEN CABINETRY UPPER - WINE RACK - UPPER - PER UNIT - UPGRADE 3 16Sep21 Note:	

CERAMIC TILE

1 - TILE - UPGRADE 6 FLOOR TILE - - POWDER ROOM 16Sep21 Note:	
1 - TILE - UPGRADE 6 FLOOR TILE - - LAUNDRY ROOM 16Sep21 Note:	
1 - DELETE ALL CERAMIC BATHROOM ACCESSORIES - DELETE TOWEL BAR, PAPER HOLDER & SOAP DISH THROUGHOUT 16Sep21 Note:	
1 - GROUT COLOUR - UPGRADE GROUT COLOUR THROUGHOUT - FLAT FEE 16Sep21 Note:	



CONSTRUCTION SUMMARY				
Mountainview Heights 3 (G) - Russell Gardens Building Ltd.				
PURCHASERS: KARAMVIR SINGH JUTLA and SABA HAQUE				TEL:
LOT / PHASE 188 / 3	REG. PLAN # 62M-1266	HOUSE TYPE Mountainash Eleven Elev 3		
1 - TILE - UPGRADE 6 FLOOR TILE - - ENSUITE BATHROOM - FLOOR				
16Sep21 Note:				

CONSTRUCTION

1 - LAUNDRY ROOM - STACKABLE WASHER AND DRYER IN LIEU OF SIDE BY SIDE	
16Sep21 Note:	
1 - DELETE BULK HEADS IN KITCHEN IF CONSTRUCTION PERMITS	
16Sep21 Note:	
1 - LIBRARY - REFRAME LIBRARY OPENING TO ACCOMMODATE DOUBLE DOOR	
16Sep21 Note:	
1 - SMOOTH CEILINGS ON FIRST FLOOR ONLY - DET	
16Sep21 Note:	

COUNTER TOP

1 - LAUNDRY ROOM - QUARTZ COUNTERTOP	
16Sep21 Note:	
1 - COUNTER TOP - UPGRADE - KITCHEN COUNTER TOP - CAESARSTONE	
16Sep21 Note:	
1 - COUNTER TOP - UPGRADE - POWER ROOM VANITY COUNTER TOP	
16Sep21 Note:	
1 - COUNTER TOP - UPGRADE - ENSUITE BATHROOM VANITY COUNTER TOP	
16Sep21 Note:	

DOORS AND TRIM

1 - TRIM - UPGRADE 3 - 7-¼” ONE STEP BASEBOARD AND ONE STEP CASING	
16Sep21 Note:	
2 - ADD PLAIN CLEAR GLASS DOOR - LIBRARY	
16Sep21 Note:	

ELECTICAL

1 - PLUG – ROUGH-IN FOR ELECTRIC CAR PLUG IN GARAGE – FOR FUTURE ELECTRIC CAR – 240V / 40-50 AMPS	
16Sep21 Note: SPECIFICATIONS REQUIRED	

ELECTRICAL

1 - LAUNDRY ROOM - PLUG FOR LAUNDRY STEAMER	
16Sep21 Note:	
2 - PUCK LIGHT - LED PUCK LIGHT FOR CABINET	
16Sep21 Note:	
1 - BUILT IN OVEN AND COOKTOP PROVISION - PROVISION ONLY - ELECTRICAL ONLY	
16Sep21 Note:	
1 - KITCHEN - VALANCE LIGHTING - LED LIGHTING	
16Sep21 Note:	

CONSTRUCTION SUMMARY

Mountainview Heights 3 (G) - Russell Gardens Building Ltd.

PURCHASERS: KARAMVIR SINGH JUTLA and SABA HAQUE

TEL:

LOT / PHASE	REG. PLAN #	HOUSE TYPE		
188 / 3	62M-1266	Mountainash Eleven Elev 3		
1 - PLUG - ELECTRICAL PLUG WITH GFI AND SWITCH - FOR FESTIVE LIGHTING 16Sep21 Note:				
3 - FAN - BATHROOM EXHAUST FAN - ENERGY STAR 80 CFM - IN LIEU OF STANDARD FAN - ALL ENSUITE BATHROOMS 16Sep21 Note:				
1 - PLUG - ELECTRICAL PLUG - TO BE INSTALLED OVER FIREPLACE 16Sep21 Note:				
1 - SWITCH - DIMMER SWITCH IN LIEU OF EXISTING SWITCH - FAMILY ROOM 16Sep21 Note:				
1 - SWITCH - DIMMER SWITCH IN LIEU OF EXISTING SWITCH - LIVING ROOM 16Sep21 Note:				
1 - SWITCH - DIMMER SWITCH IN LIEU OF EXISTING SWITCH - KITCHEN 16Sep21 Note:				
1 - SWITCH - DIMMER SWITCH IN LIEU OF EXISTING SWITCH - LIBRARY 16Sep21 Note:				
1 - LIGHT AND SWITCH - NO FIXTURE INCLUDED - LIVING ROOM 16Sep21 Note:				
1 - RELOCATE STANDARD KITCHEN LIGHT TO BE CENTERED OVER ISLAND 16Sep21 Note:				

FIREPLACE AND ACCESSORIES

1 - OVERMANTEL - CAST STONE - FOR 9 FOOT CEILING - SINGLE FRAME IF POSSIBLE - SEE SKETCH 16Sep21 Note:				
1 - MANTEL - CAST STONE - AEQUALITAS 1 STYLE MANTEL 16Sep21 Note:				
1 - GAS LINE ROUGH-IN FOR BARBECUE - FIRST FLOOR 16Sep21 Note:				
1 - GAS LINE ROUGH-IN FOR STOVE (INCLUDES ELECTRICAL OUTLET) - FIRST FLOOR 16Sep21 Note:				

HARDWOOD

1 - THROUGHOUT HARDWOOD AREAS - HARDWOOD VENTS FOR FLOOR REGISTERS 21Sep21 Note:				
---	--	--	--	---

HARDWOOD FLOORING

1 - HARDWOOD - GROUP B SERIES 5 INCH - IN LIEU OF STANDARD TILE - FOYER 16Sep21 Note:				
1 - HARDWOOD - GROUP B SERIES 5 INCH - IN LIEU OF STANDARD TILE - KITCHEN & BREAKFAST 16Sep21 Note:				
1 - HARDWOOD - GROUP B SERIES 5 INCH - IN LIEU OF 2 1/4 INCH NATURAL RED OAK - - LIVING AND DINING ROOM 16Sep21 Note:				

CONSTRUCTION SUMMARY

Mountainview Heights 3 (G) - Russell Gardens Building Ltd.

PURCHASERS: KARAMVIR SINGH JUTLA and SABA HAQUE

TEL:

LOT / PHASE	REG. PLAN #	HOUSE TYPE		
188 / 3	62M-1266	Mountainash Eleven Elev 3		
1 - HARDWOOD - GROUP B SERIES 5 INCH - IN LIEU OF 2 1/4 INCH NATURAL RED OAK - - LIBRARY/DEN				
16Sep21 Note:				
1 - HARDWOOD - GROUP B SERIES 5 INCH - IN LIEU OF 2 1/4 INCH NATURAL RED OAK - - FAMILY ROOM				
16Sep21 Note:				
1 - HARDWOOD - GROUP B SERIES 5 INCH - - BEDROOM 4				
16Sep21 Note:				
1 - HARDWOOD - GROUP B SERIES 5 INCH - - BEDROOM 3				
16Sep21 Note:				
1 - HARDWOOD - GROUP B SERIES 5 INCH - - BEDROOM 2				
16Sep21 Note:				
1 - HARDWOOD - GROUP B SERIES 5 INCH - - MASTER BEDROOM				
16Sep21 Note:				
1 - HARDWOOD - GROUP B SERIES 5 INCH - - UPPER HALL				
16Sep21 Note:				

MIRRORS AND GLASS

1 - FRAMELESS GLASS SHOWER DOOR - INCLUDES CHROME KNOB & HINGES - MASTER ENSUITE BATHROOM				
16Sep21 Note:				

PLUMBING

1 - POWDER ROOM - MOEN ALIGN ONE-HANDLE FAUCET - BRUSHED GOLD - 6190BG				
21Sep21 Note:				
1 - LAUNDRY ROOM - TECO UNDERMOUNT SINK - 163				
16Sep21 Note:				
1 - KITCHEN - SHIFT BAR/PREP SINK CLOSER TO WALL - SEE SKETCH				
16Sep21 Note:				
1 - ALL BATHROOMS - DELETE PLATES ON STANDARD FAUCETS - INSTALL WITH SINGLE HOLE INSTALLATION - IF CONSTRUCTION PERMITS				
16Sep21 Note:				
1 - TOILET - CONTRAC VIEIRA 2 PC TOILET #4792BOV/4791BOVU (UNLINED TANK) WITH SMOOTH CLOSE SEAT - POWDER ROOM				
16Sep21 Note:				
3 - SINK - UNDERMOUNT SINK - CONTRAC EMERY #4220CGY - POWDER ROOM & MASTER ENSUITE BATHROOM				
16Sep21 Note:				
2 - SINK - DROP-IN SINK - CONTRAC LOLAND - SINGLE HOLE #4410BST - ENSUITE 2 & ENSUITE 3/4 BATHROOMS				
16Sep21 Note:				
1 - SOAP DISPENSER - CHAMPAGNE BRONZE FINISH - DELTA CASSIDY RP100735CZ - KITCHEN				
16Sep21 Note:				
1 - KITCHEN - DELTA CASSIDY BAR/PREP FAUCET - CHAMPAGNE BRONZE - #9997-CZ-PR-DST				
16Sep21 Note:				

CONSTRUCTION SUMMARY

Mountainview Heights 3 (G) - Russell Gardens Building Ltd.

PURCHASERS: KARAMVIR SINGH JUTLA and SABA HAQUE

TEL:

LOT / PHASE 188 / 3	REG. PLAN # 62M-1266	HOUSE TYPE Mountainash Eleven Elev 3		
------------------------	-------------------------	---	--	--

1 - KITCHEN - DELTA CASSIDY FAUCET - CHAMPAGNE BRONZE - #9197-CZ-PR-DST

16Sep21 Note:

1 - SINK - UNDERMOUNT SINK - BLANCO QUATRUS R15 U BAR #401515

16Sep21 Note:

1 - SINK - UNDERMOUNT SINK - BLANCO QUATRUS R15 U SUPER SINGLE #401518

16Sep21 Note:

1 - WATER LINE FOR FRIDGE - ROUGH-IN ONLY

16Sep21 Note:

PROMOTIONAL

1 - LESS CREDIT FROM PURCHASER EXTRA SHEET IN OFFER

16Sep21 Note:

STAIRS AND RAILINGS

1 - STAINED STAIRS – STANDARD STAIRCASE - PRICE IS PER SET

16Sep21 Note:

1 - STAIRCASE - V GROOVE HANDRAIL

16Sep21 Note:

1 - STAIRCASE - TIFFANY POSTS

16Sep21 Note:

1 - STAIRCASE - EUROLINE CONTEMPORARY PICKETS - BLACK

16Sep21 Note:

EXTRAS AS PER OFFER

(1) The Vendor agrees that notwithstanding any other term or provision in this Agreement included in the Purchase Price and in addition to those items detailed in Schedule GP to the Agreement of Purchase and Sale, the Purchaser is entitled to a credit of

Worksheet Note:

200 AMP SERVICE LABELLED WITH CIRCUIT BREAKER PANEL TO UTILITY AUTHORITY STANDARDS.

Worksheet Note:

Purchase Price includes FOUR (4) enlarged basement windows, and the obligation to construct the house with the enlarged basement windows is subject to the Vendor's approval, in its sole and unfettered discretion The Purchaser acknowledges and agrees t

Worksheet Note:

8-foot 6-inch basement concrete pour

If the Purchaser has purchased or been provided with an 8-foot 6-inch basement concrete pour (being an increase from the Vendor's standard basement depth) the depth is measured from the top of footing to the top of f

Worksheet Note:

PURCHASER(S) ACKNOWLEDGES THAT THE PURCHASE PRICE IS INCLUSIVE OF ALL CREDITS AND PROMOTIONAL PACKAGES AVAILABLE AT TIME OF PURCHASE.

Worksheet Note:

NOTE: This is not an approved document. Document must be locked

Purchasers: KARAMVIR SINGH JUTLA & SABA HAQUE Property: 188
Telephone Res. / Bus: / Project: Russell Gardens Building Ltd.
Decor Advisor: Candace Forza Model and Elevation: Mountainash Eleven Elev 3
Lock Date: 16-Sep-21 Plan #: 62M-1266

Layout Changes: Yes No Sketch Attached: Yes No Exterior Colour Scheme:

1. Cabinetry

	Style and Colour	Hardware
Kitchen / Breakfast	SEE BELOW	833SB
Laundry Room	LEGACY 723 JET BLACK	539SB
Powder Room	LEGACY 723 JET BLACK	539SB
Master Ensuite Bathroom	LEGACY 614 CRISP WHITE	447SA
Ensuite Bath - Bedroom 2	DORAL K38 RIVERSIDE	447SA
Ensuite Bath - Bedroom 3/4	DORAL K38 RIVERSIDE	431SA
	N/A	N/A
	N/A	N/A
	N/A	N/A

Appliances: Built In Appliances Yes No Slide In Stove Yes No
Dishwasher Cabinet Closed Open 41" Upper Cabinets Yes No Please NOTE: Standard Cabinet Height is 30"
Stove Opening NOTE: If not specified, opening will be set to builder's standard opening of approximately 30" width
Fridge Opening NOTE: If not specified, opening will be set to builder's standard opening of approximately 37" width x 74" height

KITCHEN - PERIMETER - LEGACY 614 CRISP WHITE *** ISLAND, BELOW COOKTOP & WOOD HOOD - LEGACY 626 STRATUS *** FRIDGE & DISHWASHER APPLIANCE PULLS - BP8160304160 ** Refer to Construction Summary

2. Counters

	Counter	Edge
Kitchen / Breakfast	QUARTZ-EMPIRA WHITE 5151	#360
Laundry Room	QUARTZ-ISTRIA	#360
Powder Room	QUARTZ-ISTRIA	#360
Master Ensuite Bathroom	GRANITE-BLACK PEARL	#360
Ensuite Bath - Bedroom 2	LAMINATE-WHITE CARRARA 4924-38	
Ensuite Bath - Bedroom 3/4	LAMINATE-WHITE CARRARA 4924-38	
	N/A	
	N/A	
	N/A	

** Refer to Construction Summary

Purchasers:KARAMVIR SINGH JUTLA & SABA HAQUE

Property: 188

Telephone Res. / Bus: /

Project: Russell Gardens Building Ltd.

Decor Advisor: Candace Forza

Model and Elevation: Mountainash Eleven Elev 3

Lock Date: 16-Sep-21

16-Sep-21

Plan #: 62M-1266

3. Ceramic Flooring

		At a 45	Threshold-If App.
Entrance Vestibule	STRIP	<input type="checkbox"/>	metal strip where applicable
Main Hall	N/A	<input type="checkbox"/>	
Kitchen / Breakfast	STRIP	<input type="checkbox"/>	
Laundry Room	TILE-MISTIQ WHITE-24X24	<input type="checkbox"/>	GROUT - 50 TITANIUM
Powder Room	TILE-MISTIQ WHITE-12X24	<input type="checkbox"/>	GROUT - 50 TITANIUM
Master Ensuite Bathroom	TILE-ELEMENTS PORT LAURENT-12X24	<input type="checkbox"/>	GROUT - 4 CHARCOAL
Ensuite Bath - Bedroom 2	TILE-ESSENZE NERO-13X13	<input type="checkbox"/>	GROUT - 4 CHARCOAL
Ensuite Bath - Bedroom 3/4	TILE-ESSENZE NERO-13X13	<input type="checkbox"/>	GROUT - 4 CHARCOAL
	N/A	<input type="checkbox"/>	
	N/A	<input type="checkbox"/>	
	N/A	<input type="checkbox"/>	

** Refer to Construction Summary

4. Ceramic Wall Tile

Master Ensuite Bathroom	Selection	Describe
Tub Deck Wall	N/A	
Tub Deck	N/A	
Tub Deck Skirt	N/A	
Shower Stall	TILE-BIANCO LUCIDO-8X16	GROUT - 50 TITANIUM
Bathtub Enclosure Walls	N/A	
Ensuite Bath - Bedroom 2	TILE-BIANCO LUCIDO-8X16	GROUT - 50 TITANIUM
Ensuite Bath - Bedroom 3/4	TILE-BIANCO LUCIDO-8X16	GROUT - 50 TITANIUM
	N/A	
	N/A	
	N/A	
Kitchen Backsplash	N/A	

** Refer to Construction Summary - STANDARD GROUT THROUGHOUT UNLESS SPECIFIED

5. Plumbing Fixtures

All Bathrooms

White

N/A

N/A

N/A

N/A

N/A

Whirlpool

N/A

Yes

No

Dishwasher Rough-In

Yes

No

Waterline for Fridge

Yes

No

** Refer to Construction Summary

6. Trim Carpentry

Interior Doors	CARRARA-SMOOTH
Interior Trim	BB CASING WITH 7 1/4" BASEBOARD - ONE STEP
Door Handles	As Per Construction Specifications
Exterior Front Door Handle	As Per Construction Specifications

** Refer to Construction Summary

Initials:

Purchasers:KARAMVIR SINGH JUTLA & SABA HAQUE

Property: 188

Telephone Res. / Bus: /

Project: Russell Gardens Building Ltd.

Decor Advisor: Candace Forza

Model and Elevation: Mountainash Eleven Elev 3

Lock Date: 16-Sep-21

16-Sep-21

Plan #: 62M-1266

7. Other Flooring		
Main Hall	N/A	
Living Room	STRIP-MIRAGE-SWEET MEMORIES-CHARACTER-BRUSHED-RED OAK-DURA MATT-TREASURE-5"	
Dining Room	STRIP-MIRAGE-SWEET MEMORIES-CHARACTER-BRUSHED-RED OAK-DURA MATT-TREASURE-5"	
Family Room	STRIP-MIRAGE-SWEET MEMORIES-CHARACTER-BRUSHED-RED OAK-DURA MATT-TREASURE-5"	
Den / Library / Study	STRIP-MIRAGE-SWEET MEMORIES-CHARACTER-BRUSHED-RED OAK-DURA MATT-TREASURE-5"	
Basement Landing(If Applies)	N/A	
Lower Landing (If Applies)	N/A	
Upper Landing	N/A	
Upper Hall	STRIP-MIRAGE-SWEET MEMORIES-CHARACTER-BRUSHED-RED OAK-DURA MATT-TREASURE-5"	
Master Bedroom	STRIP-MIRAGE-SWEET MEMORIES-CHARACTER-BRUSHED-RED OAK-DURA MATT-TREASURE-5"	
Bedroom #2	STRIP-MIRAGE-SWEET MEMORIES-CHARACTER-BRUSHED-RED OAK-DURA MATT-TREASURE-5"	
Bedroom #3	STRIP-MIRAGE-SWEET MEMORIES-CHARACTER-BRUSHED-RED OAK-DURA MATT-TREASURE-5"	
Bedroom #4	STRIP-MIRAGE-SWEET MEMORIES-CHARACTER-BRUSHED-RED OAK-DURA MATT-TREASURE-5"	
Bedroom #5	N/A	
FLEX ROOM	STRIP-MIRAGE-SWEET MEMORIES-CHARACTER-BRUSHED-RED OAK-DURA MATT-TREASURE-5"	
FOYER	STRIP-MIRAGE-SWEET MEMORIES-CHARACTER-BRUSHED-RED OAK-DURA MATT-TREASURE-5"	
KITCHEN & BREAKFAST	STRIP-MIRAGE-SWEET MEMORIES-CHARACTER-BRUSHED-RED OAK-DURA MATT-TREASURE-5"	
Underpad	Type	Area
	N/A	N/A

** Refer to Construction Summary

8. Railings and Pickets

Railing TypeTIFFANY POSTS & V-GROOVE

Complimenting ColourMIRAGE TREASURE RED OAK

Picket TypeEUROLINE CONTEMPORARY

Complimenting ColourBLACK

Stringer / RiserAS PER CONSTRUCTION SPECIFICATIO

Complimenting ColourMIRAGE TREASURE RED OAK

TreadsAS PER CONSTRUCTION SPECIFICATIO

Complimenting ColourMIRAGE TREASURE RED OAK

Red Oak Stairs

☒ Yes

☐ No

** Refer to Construction Summary THE STAIN COLOURS OR FINISH AVAILABLE ON RISERS, TREADS, PICKETS AND RAILS (STAIRCASES), WILL NOT BE AN EXACT MATCH TO PREFINISHED HARDWOOD OR LAMINATE FLOORS.

9. Wall Paint Flat Finish

Main & Upper Hall	22 WARM GREY	Master Bedroom	22 WARM GREY
Living Room	22 WARM GREY	Bedroom #2	22 WARM GREY
Dining Room	22 WARM GREY	Bedroom #3	22 WARM GREY
Kitchen / Breakfast	22 WARM GREY	Bedroom #4	22 WARM GREY
Family Room	22 WARM GREY	Bedroom #5	N/A
Powder Room	22 WARM GREY	Master Ensuite	22 WARM GREY
Laundry Room	22 WARM GREY	Ensuite Bath - Bedroom 2	22 WARM GREY
Den/Library	22 WARM GREY	Ensuite Bath - Bedroom 3/4	22 WARM GREY
Trim & Door Paint-Semi Gloss	BIRCH WHITE		N/A
	N/A		N/A
	N/A		N/A

Smooth Ceilings First Floor ☒ Yes ☐ No

** Refer to Construction Summary

Initials: 

Purchasers:KARAMVIR SINGH JUTLA & SABA HAQUE

Property: 188

Telephone Res. / Bus: /

Project: Russell Gardens Building Ltd.

Decor Advisor: Candace Forza

Model and Elevation: Mountainash Eleven Elev 3

Lock Date: 16-Sep-21

16-Sep-21

Plan #: 62M-1266

10. Plaster Mouldings and Medallions

Entrance Vestibule	N/A	N/A	Kitchen/Breakfast	N/A	N/A
Main Hall	N/A	N/A	Den/Library	N/A	N/A
Living Room	N/A	N/A	Lower Landing	N/A	N/A
Dining Room	N/A	N/A		N/A	N/A
Family Room	N/A	N/A			

** Refer to Construction Summary

11. Fireplace

	Living Room			Family Room			Other Room - Specify		
	Purchased	As Per Plan	N/A	Purchased	As Per Plan	N/A	Purchased	As Per Plan	N/A
	<input type="radio"/>	<input type="radio"/>	<input checked="" type="radio"/>	<input type="radio"/>	<input checked="" type="radio"/>	<input type="radio"/>	<input type="radio"/>	<input type="radio"/>	<input checked="" type="radio"/>
Fireplace Type	N/A			FLAT ON WALL			N/A		
Mantle Type	N/A			CASTONE - AEQUALITAS 1			N/A		
Colour / Stain	N/A			NATURAL IVORY			N/A		
Surround	N/A			N/A			N/A		
Hearth	N/A			N/A			N/A		

CASTONE MANTLE TO INCLUDE OVERHEAD WITH ONE FRAME IF POSSIBLE** Refer to Construction Summary

12. Heating and Air Conditioning

Air Conditioning	NO	Gas Provisions Stove	YES
Gas Provisions Dryer	NO	Gas Provisions Barbecue	YES
Comment			

** Refer to Construction Summary

13. Electrical

Plugs and Switches	<input checked="" type="radio"/> White	DECOR	Above Kitchen Cabinet Light	<input type="radio"/> Yes	<input checked="" type="radio"/> No
Hood Fan	STANDARD WHITE TEMP.		Below Kitchen Cabinet Light	<input checked="" type="radio"/> Yes	<input type="radio"/> No
Appliances	Built in Cooktop	Built in Oven	Gas Stove	Microwave	
	<input checked="" type="radio"/> Yes <input type="radio"/> No	<input checked="" type="radio"/> Yes <input type="radio"/> No	<input checked="" type="radio"/> Yes <input type="radio"/> No	<input checked="" type="radio"/> Yes <input type="radio"/> No	
Dishwasher Rough-in	Yes				

** Refer to Construction Summary

14. General Comments

** Refer to Construction Summary

Disclaimers and Notes

- 1) Colours of all materials are as close as possible to builder's selection, but not necessarily identical due to variances in manufacturing.
- 2) Any extras listed above are null and void unless accompanied by a separate invoice/amendment. Said invoice must be paid in full.
- 3) The Purchaser agrees that this colour selection is final and that no changes will be permitted, unless required by the Vendor.
- 4) The Purchaser acknowledges reading and accepting document which contains other miscellaneous disclaimers.

Signature:  Date: _____

Signature: _____ Date: _____

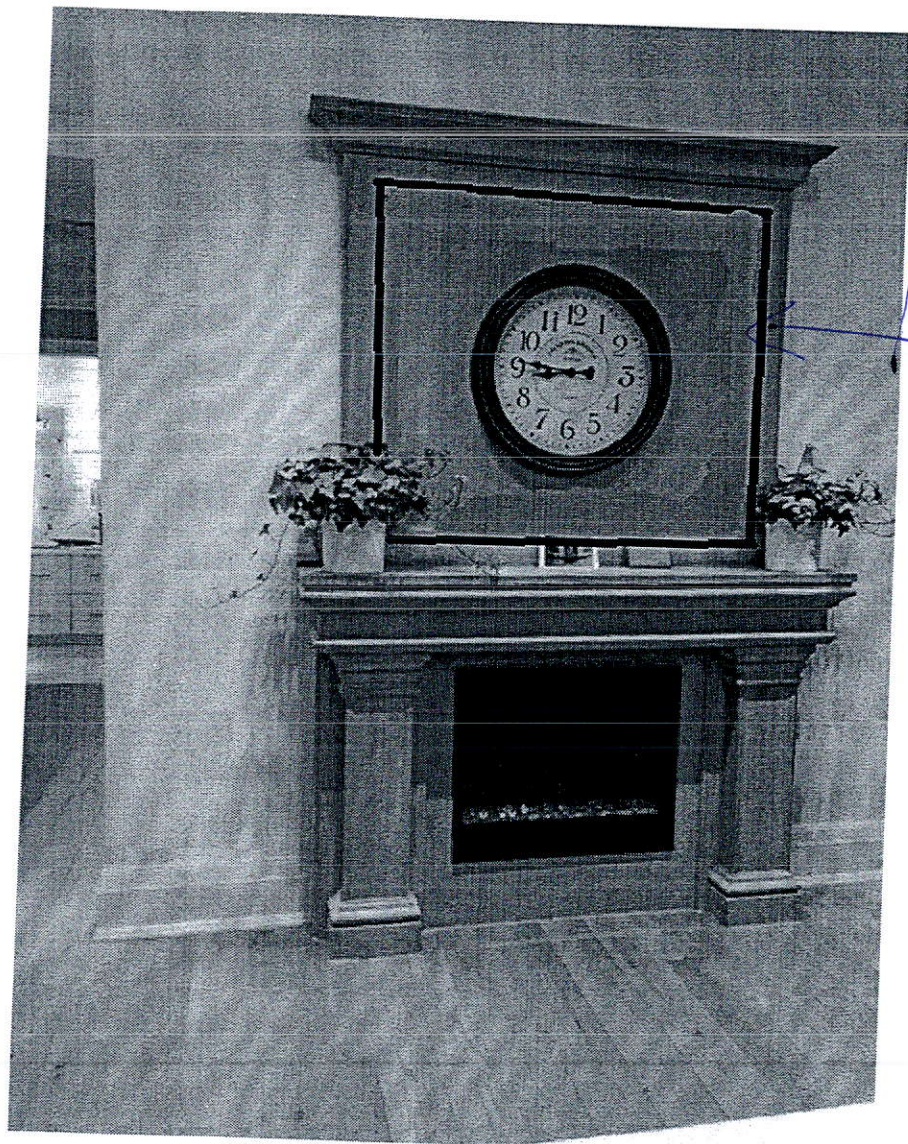

✓ - One frame

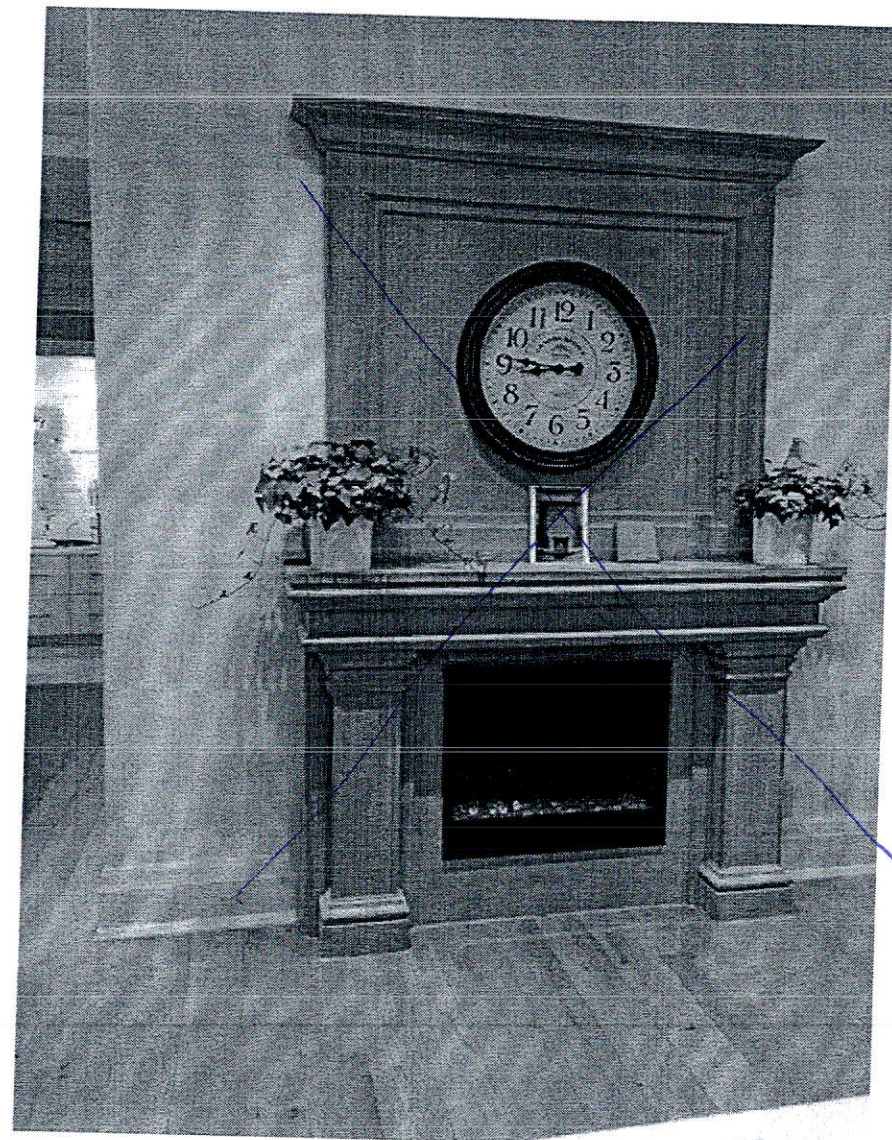

X - NOT TWO frames

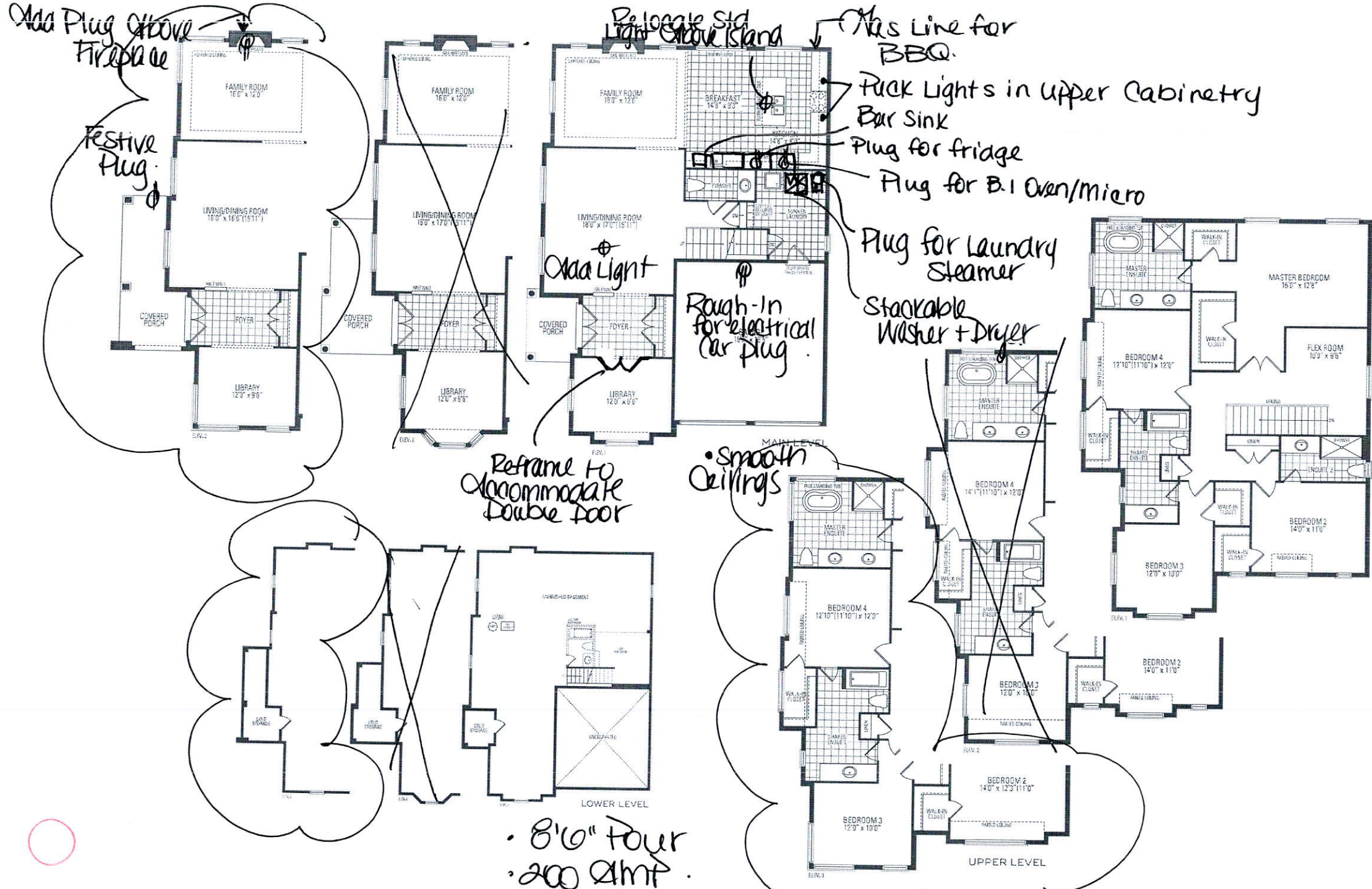

MOUNTAINASH ELEVEN ELEV. 1 • 2,958 sq.ft. | ELEV. 2 • 3,001 sq.ft. | ELEV. 3 • 2,975 sq.ft.

Orientation of home may be reversed and purchaser agrees to accept the same. Steps and porches may vary at any exterior entrance ways due to grading variance. Actual usable floor space may vary from the stated floor areas. All renderings are artist's concept. Dimensions, specifications and architectural detailing subject to modifications. Roofline and adjoining model types may vary due to siting. E. & O. E. May 2020

S3RFBN / S3WFBN / S3MFBN

KEY FEATURES

- Refresh & Deodorize
- Sanitize
- Gentle Dry
- Completes your at-home laundry care system
- Plug & Go Installation

AVAILABLE COLORS

- ESPRESSO DARK BROWN
- WHITE
- MIRROR FINISH



PRODUCT FEATURES

CAPACITY	11.4 lb (5.2kg) / 3 hangers + 1 pant
FEATURES	
Touch Control Hidden Display	Yes
TrueSteam®	Yes
Heat-Pump System (Inverter)	Yes
Gentle Dry	Yes
Sound	On/Off
NFC Tag On Cycle Download (Android Mobile OS)	Yes (10 minute Default Course)
Interior Lights	3 LED (2 White, 1 Blue)
Reversible Door	Yes
CERTIFICATION / AWARDS	
AAFA - Asthma and Allergy Foundation of America	Yes
BAF - British Allergy Foundation*	Yes
Intertek Certified**	Yes (99.9% sterilization effectiveness)
2015 IF Product Design Award	Yes
Red Dot Design Award	Yes
FABRIC CARE	
	Cotton, Linen, Wool, Silk, Rayon / Acetate / Polyester, Nylon, Denim / Surah / Gabardine, Velvet (Silk) / Plush (Silk, Longer Nap Than Velvet)

Estimated Cycle Times (minutes)	
- Refresh (Light/Normal/Heavy)	20/48/67 min.
- Sanitary (Normal/Heavy)	88/103 min.
- Gentle Dry (Normal/Delicates/Time Dry)	120/150/30-150 min.
- Special Care (Downloaded)	10 min.
CAUTION	
- Follow fabric care labels.	
- Don't put items that are sensitive to heat or are not suitable for washing with water in Styler cycles that use steam. Use the Dry cycles only.	
- Fur or leather items should only be treated with the Air Fresh cycle. This is one of the default downloaded cycles on the machine.	
- Using the wrong cycle for items can result in damage to fabrics.	

ACCESSORIES	2 Hangers, 1 Pants Hanger, 1 Shelf, 1 Drip Tray, 1 Anti-Tip Kit, 2 Rear Leveling Feet, 4 Carpet Install Spikes
CONVENIENCE	
1 Portable Water Fill Container (no hose needed)	Yes
2 Portable Water Drainage Container (no hose needed)	Yes
3 Versatile Rack	Yes
4 Aroma Kit	Yes (sheets sold separately)
5 Pants Crease Care	Yes
6 Moving Hanger	3 clothes
SMART TECHNOLOGY (Wi-Fi)	
wi-fi Enabled	Yes
Voice Activation	Yes
Works with	Google Assistant
Remote Control	Yes
Energy Monitoring	Yes
Black Box	Yes
SmartDiagnosis™	Yes
Download Course	Yes
One Touch	Yes

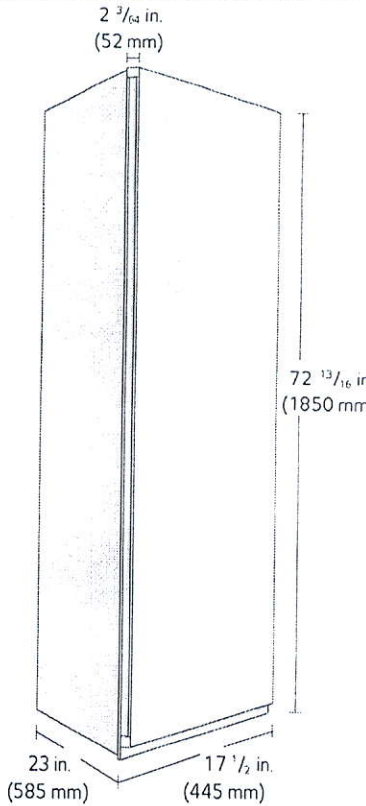
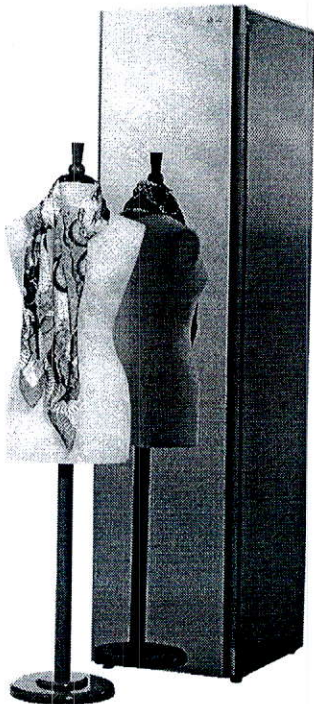

RECOMMENDED INSTALLATION SPACING

The following clearances are recommended for the Styler. The Styler has been tested for clearances of 13/16 inch (3 cm) on the sides and rear.

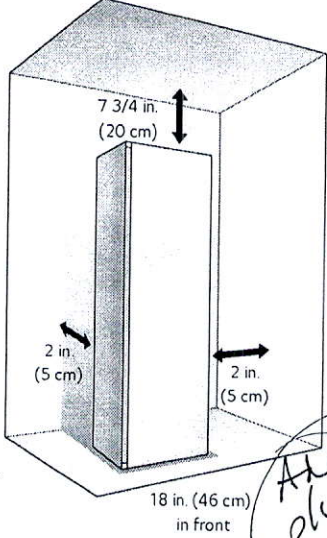
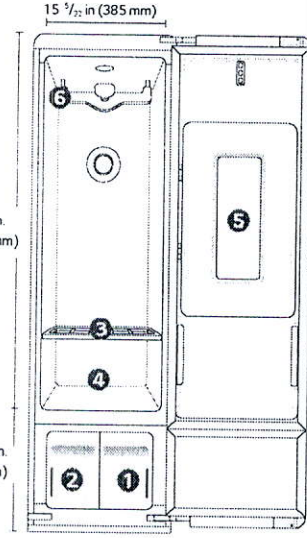

Handwritten note: "Add plug" with a circle around the power source information.

POWER SOURCE	
Ratings	
Electrical Requirements	
Watts	
Type	
DIMENSIONS	
Dimensions (WxHxD)	17 1/2" X 72 3/4" X 23"
Carton Dimensions (WxHxD)	21" x 72 4/5" x 26"
Product Weight	183 lbs
Shipping Weight	207 lbs
Clearances	2" Side/Back, 7 3/4" Top
LIMITED WARRANTY	
	1 Year Parts and Labor (In Home Service), 10 Year Smart Inverter Compressor
UPC CODES	
S3RFBN (Espresso Dark Brown)	048231025164
S3WFBN (White)	048231026314
S3MFBN (Mirror Finish)	048231027601

* British Allergy Foundation test results show reduction in exposure to House Dust Mite Allergen and Reduction of Live House Dust Mites, Fungi and Bacteria.
** Intertek test results show that model S3RFBN successfully reduces the reduction rate (bactericidal effectiveness) of S.aureus (ATCC 6538) and E.coli (ATCC 25922) is all more than 99.9% under the sterilization course. Data on File.
DO NOT PUT THE FOLLOWING ITEMS IN THE STYLER: Starched or Vinyl Clothes, Electric Blankets, Heavy Blankets (Double Layer Or Over 3.3 Lb [1.5 Kg]), Shoes, Items Made With Sponge Rubber, Items With Adhesives

Design features and specifications are subject to change without notice. Non-metric weights and measurements are approximate.

LG LAUNDRY

WKEX200HBA

LG WashTower™ with Centre Control™
5.2 cu.ft. Washer, 7.4 cu.ft. Dryer

Unitary One Body Design with Centre Control™

AIDD™ & AI Sensor Dry™

TurboWash™ 360

TurboSteam™

Wi-Fi Enabled™

Full STS Drums with STS Lifters™

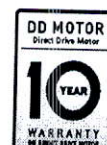
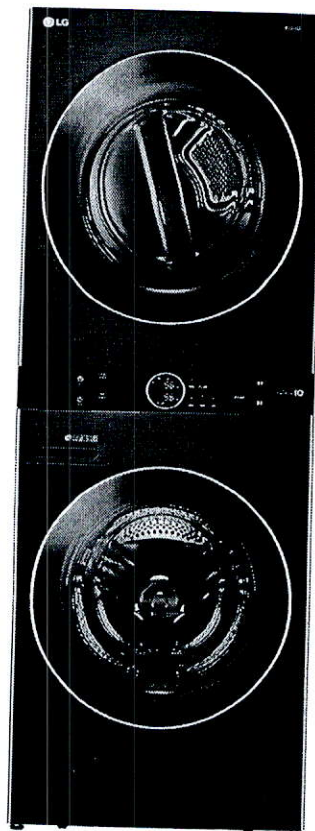

LG ThinQ™

Enjoy new ways to control your home with LG smart appliances

- Start the laundry while you're out shopping
- Get alerts when the cycle is finished
- Works with the LG ThinQ® app

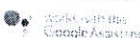

SUMMARY		
	Washer	Dryer
Type	Front Load Washer	Front Load Dryer
Capacity (cu.ft)	5.2	7.4
Colour	Black Steel (B)	
APPEARANCE	Washer	Dryer
Hard Buttons	No	
Full Touch Electronic Control Panel	Yes	
ENERGY	Washer	Dryer
ENERGY STAR® Qualified	Yes	
CEE Tier	Tier2	-
IMEF	2.92	-
IWF	2.9	-
CEF	-	3.94
PROGRAMS	Washer	Dryer
No. of Programs	6 Normal, Bedding, Delicates, Heavy Duty, Speed Wash, Downloaded	6 Normal, Bedding, Delicates, Heavy Duty, Speed Wash, Downloaded
OPTIONS	Washer	Dryer
No. of Options	10 TurboWash®, Steam, Extra Rinse, Pre-wash, Sanitary, Tub Clean, Drum Light, Child Lock, Signal, Wi-Fi / Remote Start	10 Wrinkle Care, TurboSteam™, Reduce Static, Energy Saver, Steam Fresh®, Drum Light®, Child Lock®, Signal®, Wi-Fi® / Remote Start
DETAILS	Washer	Dryer
No. of Wash/Rinse Temps	5 Hot, Warm/Hot, Warm, Cold/ Warm, Cold	-
No. of Spin Speeds	5 High, Medium/ High, Medium, Low, No Spin	-
Max RPM	1300	-
Water Levels	Load Sensing	-
No. of Soil Levels	5	-
Temperature Settings	-	High, Medium/ High, Medium, Low/Medium, Low

Drying Levels	-	Very, More, Normal, Less, Damp
Manual Dry Times	-	60 min., 50 min., 40 min., 30 min., 20 min.
FABRIC CARE FEATURES	Washer	Dryer
AI DD	Yes	-
TurboWash™ 360 Technology	Yes	-
TurboWash™ 2.0 Technology	No	-
Steam Technology	Yes	-
Allergiene™ Cycle	Yes	-
Sanitary Cycle	Yes	-
SenseClean™ System	Yes	-
AI Sensor Dry™	-	Yes
Sensor Dry	-	Yes
Precise Temperature Control with Variable Heater	-	Yes
Steam Technology	-	Yes (TurboSteam™)
CONVENIENCE FEATURES	Washer	Dryer
TrueBalance™ Anti-Vibration System	Yes	-
4 Tray Dispenser	Prewash, Main Wash (with liquid detergent cup), Bleach, Fabric Softener	-
LoadSense	Yes	-
Auto Suds Removal	Yes	-
3 Minute Installation Check	-	Yes
Reversible Door	-	No
FlowSense™ Duct Clogging Indicator	-	Yes
Wrinkle Care Option	-	Yes
Venting Option	-	3 Way
End of Cycle Signal	-	Yes
Control Lock*	-	Yes
Drum Light	-	Yes
4 Adjustable Leveling Legs	-	Yes
Remaining Time Display/Status Indicator(s)	-	Yes

THINQ TECHNOLOGY	Washer	Dryer
SmartDiagnosis™ (v3.0)	-	Yes
Wi-Fi	-	Yes
Remote Start and Cycle Monitor	-	Yes
Energy Monitoring	-	Yes
Tub Clean Coach	Yes	-
MOTOR	Washer	Dryer
Motor Type	Inverter Direct Drive Motor	-
Axis	Horizontal	-
MATERIALS AND FINISHES	Washer	Dryer
NeveRust™ Stainless Steel Drum	-	Yes
Control Panel	Plastic	
Top Plate	Steel	
Cabinet	PCM	
Door / Rim	Large Circle Chrome Rim	
Door Cover	Tinted Round Tempered Glass	
CERTIFICATION	Washer	Dryer
Asthma Canada	Yes	-
POWER SOURCE	Washer	Dryer
Ratings	CSA Listed	
Electrical Requirements	120V, 10 Amps	240V 30 Amps
Type	Electric	
DIMENSIONS	Washer	Dryer
Product (WxHxD)	27" x 74 3/8" x 30 3/8"	
Depth with Door Open	55" D with door open	
Carton (WxHxD)	30 1/16" x 79 11/32" x 32"	
Weight (Product/Carton)	326 lbs / 361 lbs	
LIMITED WARRANTY	Washer	Dryer
Parts and Labour	1 Year	1 Year
Direct Drive Motor	10 Years	-
Drum	3 Years	10 Years
UPC	Washer	Dryer
WKEX200HBA	772454073670	

- upg. 3 Legacy Cabinetry.

- 2 Colour Cabinetry
- 3 maulding
- Light valance
- upg. 2 Hardware
- upg 2 Appliance Pulls
BPO 60 304166
- Blu motion
Drawers
- Soft Closing Cabinetry.
- Appliance Door Panels on
Dishwasher + Fridge.

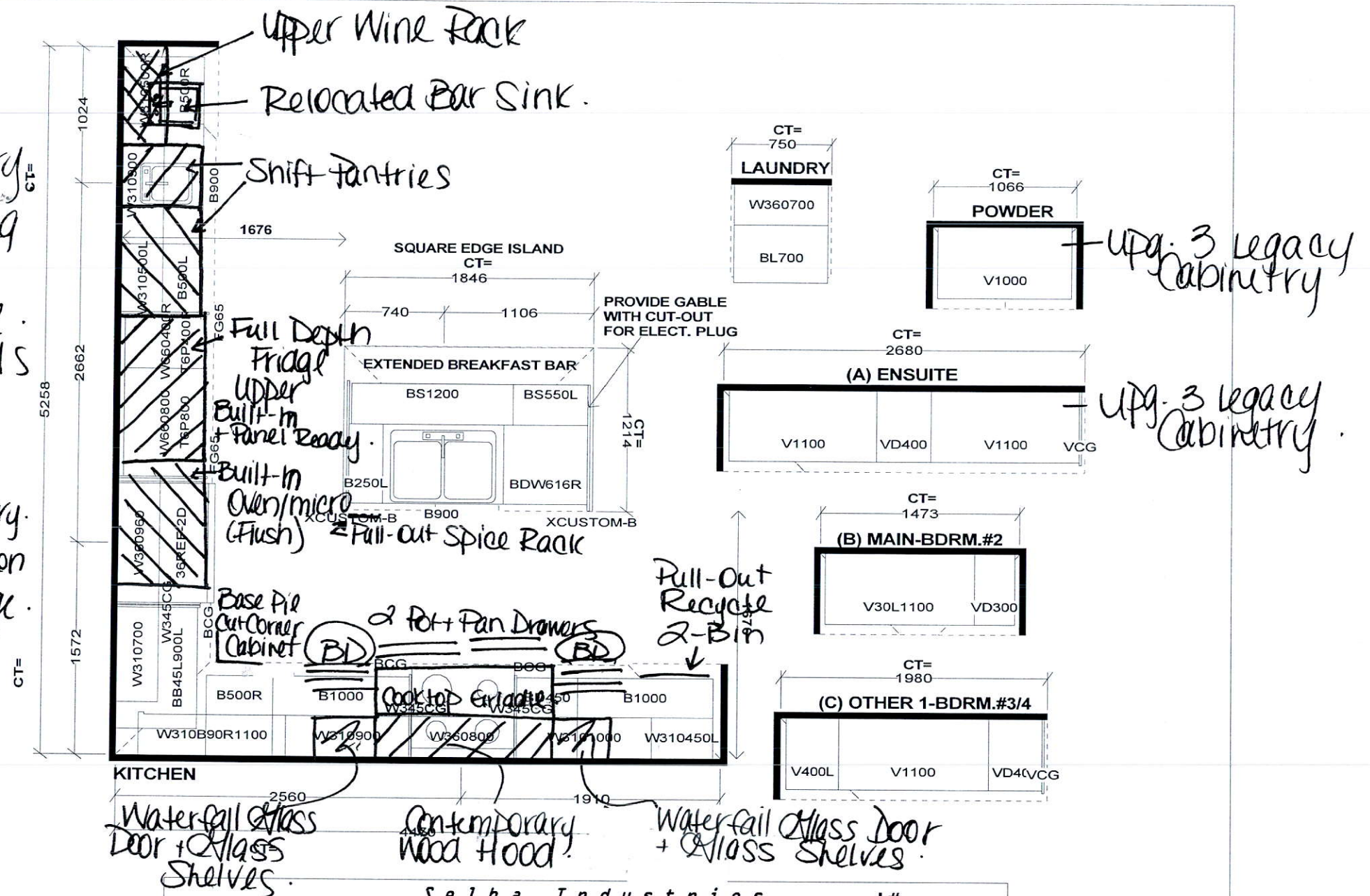

Selba Industries J#

W W DTH _____ W H GHT _____ W C N T _____

FLOOR HGHT _____ DOOR HGHT _____

ST CENT	2X4	VENT BOX COVER
---------	-----	----------------

*This drawing is the intellectual property of
SELBA INDUSTRIES INC. and is an
original design which must not be released
or copied unless applicable fee has been
paid or job order placed.*



DESIGNER: KS
DATE: MAY 13 20
REV'D AUG 27 20

of **JOB NUMBER:**

BUILDER: GREENPARK

SITE: RUSSELL GARDENS PH.3

MODEL: MOUNTAINASH 11X EL 2.3

LOT #:



15" MODULAR ELECTRIC GRIDDLE

Signature Features

1,800-WATT ELECTRIC GRIDDLE

This high-performance, 1,800-watt chrome griddle provides even heat distribution for consistent cooking. Its durable chrome surface allows for faster cooking while radiating less heat into the kitchen, and can be easily cleaned to maintain its sleek appearance.

TRUE FLUSH INSTALLATION OPTION

These cooking surfaces provide the versatility to achieve a true flush installation.

15-INCH WIDTH

Allows consumers to take advantage of multiple cooking capabilities by adding individual appliances such as a griddle or wok, and provides installation options inside and outside the kitchen.

JEF3115G

Preliminary: Q2 2017

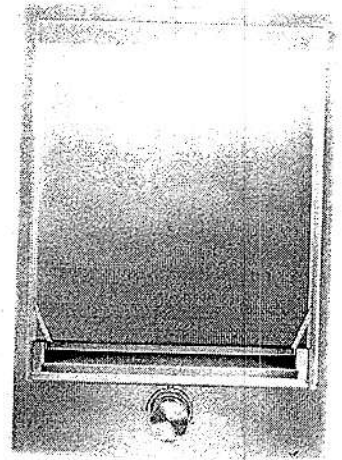

Feature Listing

PERFORMANCE FEATURES (COOKTOP)

1,800-Watt Electric Griddle

DESIGN FEATURES

Low-Profile Design for Traditional Installations

True Flush Installation Option

15-Inch Width

21-Inch Depth

Installation Over Single Wall Oven

White LED Backlit Knobs

Euro-Style Barrel Knobs — Stainless Steel

Style Options

EURO-STYLE STAINLESS DESIGN JEF3115GS

A refined design that satisfies contemporary and traditional tastes and blends in with other Jenn-Air® Euro-Style Stainless appliances.



7 YEAR
LIMITED
WARRANTY

Bold = Top Features

JENN-AIR®

© 2017 Jenn-Air. All rights reserved. Specifications subject to change without notice.

Available Finishes/Colours

JXW9048HP
Stainless Steel

Dimensions

Depth	25
Height	19 3/8
Width	48

Configuration and Overview

Hood Type	Wall Canopy
Fan CFM	1200
Venting Type	Vented Only

Controls

Number of Speeds	4
Task Light	Halogen

Top Features

Velocity Blower

10-Inch Round Exterior Venting

Radiant Until Ready

Manuals & Literature:

PDF Use and Care **PDF Installation Instructions**

IMPORTANT: Observe all governing codes and ordinances. Have a qualified technician install the range hood. It is the installer's responsibility to comply with installation clearances specified on the model/serial/rating plate. The model/serial/rating plate is located inside the range hood on the rear wall of the range hood.

Canopy range hood location should be away from strong draft areas, such as windows, doors and strong heating vents.

Cabinet opening dimensions that are shown must be used.
Given dimensions provide minimum clearance.

The canopy range hood is factory set for venting through the roof or through the wall.

All openings in ceiling and wall where canopy range hood will be installed must be sealed.

For Mobile Home Installations

The installation of this range hood must conform to the Manufactured Home Construction Safety Standards, Title 24 CFR, Part 328 (formerly the Federal Standard for Mobile Home Construction and Safety, Title 24, HUD, Part 280) or when such standard is not applicable, the standard for Manufactured Home Installation 1982 (Manufactured Home Sites, Communities and Setups) ANSI A225.1/NFPA 501A, or latest edition, or with local codes.

Product Dimensions

Front view

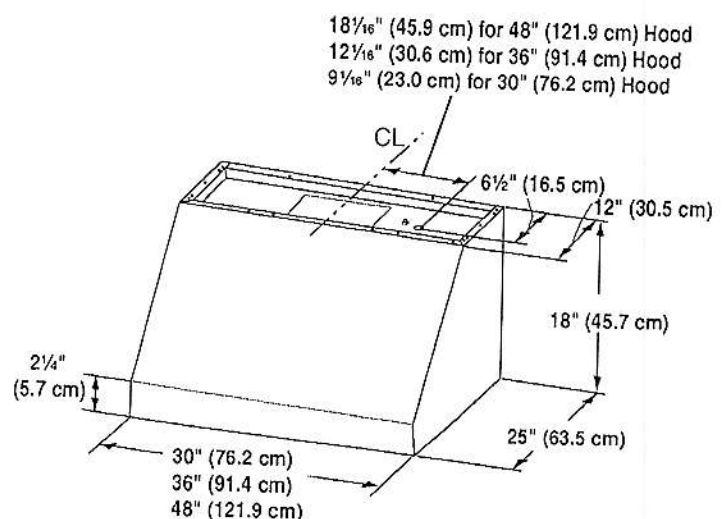

Because Whirlpool Corporation policy includes a continuous commitment to improve our products, we reserve the right to change materials and specifications without notice. Dimensions are for planning purposes only. For complete details, see Installation Instructions packed with product. Specifications subject to change without notice.



36" 6-BURNER GAS COOKTOP

Signature Features

18,000 BTU POWERBURNER

Enjoy the elegance of brass and robust heat from this PowerBurner that's necessary for high-powered cooking techniques, whether searing a steak, stir-frying vegetables or rapidly boiling water.

SINGLE POINT ELECTRONIC IGNITION AND FLAME-SENSING™ RE-IGNITION

If the flame is accidentally blown out by a draft, a spark occurs that automatically re-ignites the extinguished burner.

6,000 BTU SIMMER BURNER

Melt chocolate and butter or simmer sauces just below boiling with a high-precision burner that offers a wide range of power.

JGC7636B

Feature Listing

PERFORMANCE FEATURES

18,000 BTU PowerBurner

15,000 BTU Burner

9,000 BTU Burner

6,000 BTU Simmer Burner

Convertible to LP

CONTROL FEATURES

Infinite Burner Control Settings

Single Point Electronic Ignition and Flame-Sensing™ Re-ignition

White LED Burner Indicator

DESIGN FEATURES

Low-Profile Design

Continuous, Heavy-Duty, Cast Iron Grates

Brass Burners

Sealed Burners

OPTIONAL ACCESSORIES

Gas Connector Kit (Required) – 30-48KITPG

Wok – AQ142

Affresh™ Kitchen & Appliance Cleaner, 16 oz.
– W10355010

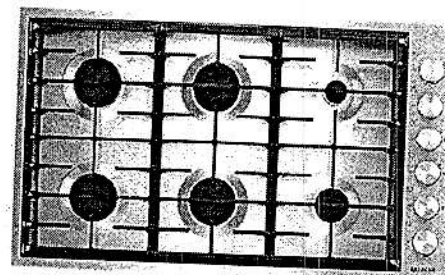

Style Options

EURO-STYLE STAINLESS DESIGN JGC7636BS

A refined design that satisfies contemporary and traditional tastes and blends in with other Jenn-Air® Euro-Style Stainless appliances.

PRO-STYLE® STAINLESS DESIGN JGC7636BP

Express commercial styling and gourmet sensibilities with diamond-etched handles, stainless steel finish and an oversized badge, matching other Jenn-Air® Pro-Style® Stainless appliances.



1 YEAR
WARRANTY

Bold = Top Features

JENN-AIR®



30" BUILT-IN REFRIGERATOR COLUMN, RIGHT SWING

Signature Features

OVER 250 CONFIGURATIONS

Hundreds of ways to make columns suit you.

TRINITY COOLING

Three zones. Three precision sensors. Calibrated every second. Command temperatures and humidity in each zone with an exposed air tower for total control.

REMOTE ACCESS*

Open door. Power outages. Filter changes. Connect to WiFi for real-time notifications and control your columns from anywhere. Tap and swipe on both iOS and Android devices.*

JBRFR30IG

Feature Listing

DESIGN & CRAFTSMANSHIP

Over 250 Configurations
Ecliptic Lighting
Daring Obsidian Interior
Solid Glass and Metal
Emotive Controls

PERFORMANCE

Trinity Cooling
Hushed Acoustics
Shapeshifter Drawers (Refrigerator)
Discreet Water

CONNECTIVITY

Remote Access*
Smart Integration
On-Demand Experts
Monthly Reports

ACCESSORIES

Door Skins
Independent Preserver
Catwalk Shell
EveryDrop® Filter

ADDITIONAL FEATURES

Seamless Touches
Hard Core Steel Door Panels
United Dual Toe Kick
Down-Low Airflow
Max Cool Option
Smooth Close Drawers
ENERGY STAR® Certified

Magnet-to-Metal Seal
Vacation Mode (app only)
Sabbath Mode
Adaptable Installation

OPTIONAL ACCESSORIES

30" Built-in Column Panel Kit (Euro) (Right Swing) – JKOPR30IGS
30" Built-in Column Panel Kit (Pro-Style®) (Right Swing) – JKOPR30IGP
Single Unit Toe Kick - Stainless Steel, for use with single 30" Unit – JAC30HS
30" Column Right Swing NOIR™ Panel Kit – JKOPR30IGM
30" Column Right Swing RISE™ Panel Kit – JKOPR30IGL
Dual Unit Toe Kick - Black, for use with 18" (left) and 30" (right) dual-column installation – JAC1830HB
Dual Unit Toe Kick - Stainless Steel, for use with 18" (left) and 30" (right) dual-column installation – JAC1830HS
Dual Unit Toe Kick - Black, for use with 24" (left) and 30" (right) dual-column installation – JAC2430HB
Dual Unit Toe Kick - Stainless Steel, for use with 24" (left) and 30" (right) dual-column installation – JAC2430HS
Dual Unit Toe Kick - Black, for use with 30" (left) and 18" (right) dual-column installation – JAC3018HB
Dual Unit Toe Kick - Stainless Steel, for use with 30" (left) and 18" (right) dual-column installation – JAC3018HS
Dual Unit Toe Kick - Black, for use with 30" (left) and 24" (right) dual-column installation – JAC3024HB
Dual Unit Toe Kick - Stainless Steel, for use

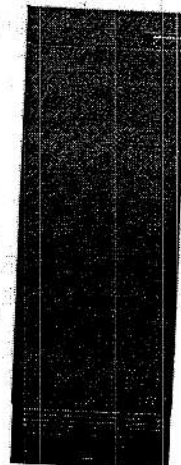

Style Options

RISE™

JBRFR30IG with JKOPR30IGL Kit

PRO-STYLE®

JBRFR30IG with JKOPR30IGP Kit

BASE UNIT

JBRFR30IGX

NOIR™

JBRFR30IG with JKOPR30IGM Kit

EURO-STYLE

JBRFR30IG with JKOPR30IGS Kit



18" BUILT-IN FREEZER COLUMN, LEFT SWING

Signature Features

OVER 250 CONFIGURATIONS

Hundreds of ways to make columns suit you.

DIVINITY FREEZING

One provocative air tower.
Two precision sensors.
Calibrated every second.
Keep freezer temperatures
from swinging and spirits
impeccably chilled.

REMOTE ACCESS*

Open door. Power outages.
Filter changes. Connect to
WiFi for real-time notifications
and control your columns
from anywhere. Tap and
swipe on both iOS and
Android devices.*

JBZFL18IG



Feature Listing

DESIGN & CRAFTSMANSHIP

Over 250 Configurations
Ecliptic Lighting
Daring Obsidian Interior
Solid Glass and Metal
Emotive Controls

PERFORMANCE

Divinity Freezing
Hushed Acoustics
Shapeshifter Drawers (Freezer)
DeepFreeze™ Mode

CONNECTIVITY

Remote Access*
Smart Integration
On-Demand Experts
Monthly Reports

ACCESSORIES

Door Skins
Catwalk Shelf
EveryDrop® Filter

ADDITIONAL FEATURES

Seamless Touches
Hard Core Steel Door Panels
United Dual Toe Kick
Down-Low Airflow
Smooth Close Drawers
Prism Ice
Max Ice
ENERGY STAR® Certified

Magnet-to-Metal Seal
Vacation Mode (app only)
Sabbath Mode
Adaptable Installation

OPTIONAL ACCESSORIES

18" Column Left Swing NOIR™ Panel Kit –
JKCPL18IGM
18" Column Left Swing RISE™ Panel Kit –
JKCPL18IGL
18" Built-in Panel Kit (Euro) (Left Swing) –
JKCPL18IGS
18" Built-in Panel Kit (Pro-Style®) (Left Swing) –
JKCPL18IGP
Single Unit Toe Kick - Stainless Steel, for use
with single 18" Unit – JAC18HS
Dual Unit Toe Kick - Black, for use with 18" (left)
and 18" (right) dual-column installation –
JARC1818HB
Dual Unit Toe Kick - Stainless Steel, for use
with 18" (left) and 18" (right) dual-column
installation – JARC1818HS
Dual Unit Toe Kick - Black, for use with 18"
(left) and 24" (right) dual-column installation –
JAC1824HB
Dual Unit Toe Kick - Stainless Steel, for use
with 18" (left) and 24" (right) dual-column
installation – JAC1824HS
Dual Unit Toe Kick - Black, for use with 18" (left)
and 30" (right) dual-column installation –
JAC1830HB
Dual Unit Toe Kick - Stainless Steel, for use
with 18" (left) and 30" (right) dual-column
installation – JAC1830HS
Dual Unit Toe Kick - Black, for use with 18" (left)
and 36" (right) dual-column installation –
JAC1836HB
Dual Unit Toe Kick - Stainless Steel, for use

Style Options

NOIR™

JBZFL18IG with JKCPR18IGM Kit

EURO-STYLE

JBZFL18IG with JKCPR18IGS Kit

BASE UNIT

JBZFL18IGX

RISE™

JBZFL18IG with JKCPR18IGL Kit

PRO-STYLE®

JBZFL18IG with JKCPR18IGP Kit

JennAir® NOIR™ 30" BUILT-IN MICROWAVE OVEN WITH SPEED-COOK

JMC2430IM

Available Finishes/Colours



JMC2430IM
FA

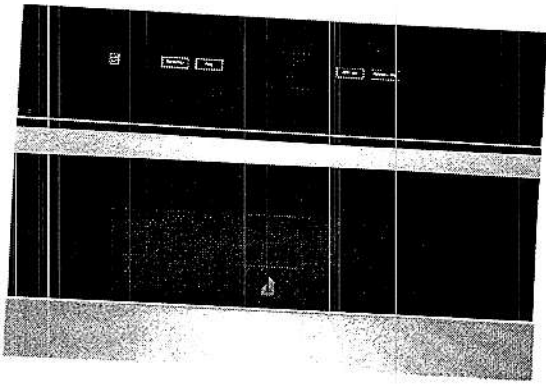

Let your appetite run wild with microwave and convection energy. With curated recipes and full-color doneness images, an intelligent culinary experience awaits your touch.

Top Features

4.3-Inch Full Color LCD Display

Seamless Touches

Stainless Steel Microwave Interior

Manuals & Literature:

[PDF Use and Care](#) [PDF Installation Instructions](#)

[PDF Warranty](#)

JENNAIR

Because Whirlpool Corporation policy includes a continuous commitment to improve our products, we reserve the right to change materials and specifications without notice. Dimensions are for planning purposes only. For complete details, see Installation Instructions packed with product. Specifications subject to change without notice.

INSTALLATION REQUIREMENTS

Tools and Parts

Gather the required tools and parts before starting installation. Read and follow the instructions provided with any tools listed here.

Tools Needed

- Phillips screwdriver
- Flat-blade screwdriver
- Measuring tape
- Level
- Drill (for wall cabinet installations)
- 1/8" (3 mm) drill bit (for wall cabinet installations)
- 1" (2.5 cm) drill bit (for wall cabinet installations)

Parts Needed

- UL listed or CSA approved conduit connector
- UL listed wire connectors

Parts Needed – Flush Installation

- W10801485 Stainless steel flush installation kit for 27" (68.6 cm) models
- W10801486 Stainless steel flush installation kit for 30" (76.2 cm) models
- W10801487 Black flush installation kit for 30" (76.2 cm) models

To order, see the "Assistance or Service" section of the Use and Care Guide.

Parts Supplied

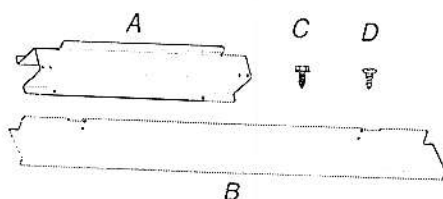

- A. Spacer bars (2)
- B. Bottom vent (1)
- C. 3/8" (9.5 mm) hex-head washer screws (4)
- D. 3/4" (1.9 cm) pan-head screws (4)

Check local codes. Check existing electrical supply. See "Electrical Requirements."

It is recommended that all electrical connections be made by a licensed, qualified electrical installer.

Location Requirements

IMPORTANT: Observe all governing codes and ordinances.

- Cabinet opening dimensions that are shown must be used. Given dimensions provide minimum clearance with microwave oven.
- Recessed installation area must provide complete enclosure around the recessed portion of the microwave oven.
- Grounded electrical supply is required. See "Electrical Requirements" section.
- Electrical supply junction box should be located 3" (7.6 cm) maximum below the support surface when the microwave oven is installed in a wall cabinet. A 1" (2.5 cm) minimum diameter hole should have been drilled in the left rear corner of the support surface to pass the appliance cable through to the junction box.

- For installation above single built-in oven, the junction box must be located inside upper cabinet.
- If you are installing the junction box on rear wall behind the microwave oven, the junction box must be recessed and located in the upper or lower right or left corner of the cabinet; otherwise, the microwave oven will not fit into the cabinet opening.
- Microwave oven support surface must be solid, level, and flush with bottom of cabinet cutout. Floor must be able to support a weight of 108 lbs (49.0 kg).

IMPORTANT: To avoid damage to your cabinets, check with your builder or cabinet supplier to make sure that the materials used will not discolor, delaminate, or sustain other damage. This oven has been designed in accordance with the requirements of UL and CSA International and complies with the maximum allowable wood cabinet temperatures of 194°F (90°C).

Product Dimensions

27" (68.6 cm) and 30" (76.2 cm) Microwave Ovens

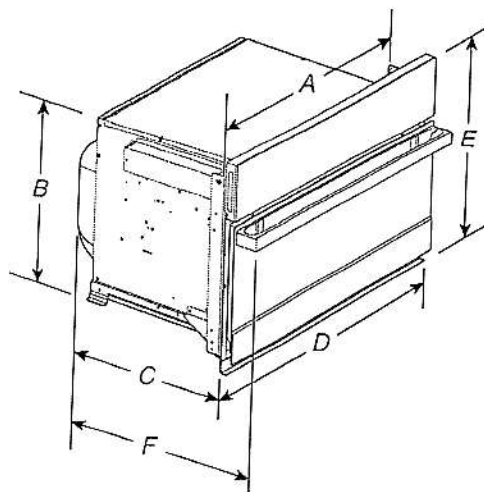

27" (68.6 cm) models

- A. 25³/₈" (64.5 cm)
- B. 17³/₈" (44.1 cm)
- C. 22¹/₁₆" (57.7 cm)
- D. 26³/₄" (68.0 cm) overall width
- E. 19⁷/₈" (50.3 cm) overall height
- F. JMC2427IM: 25³/₁₆" (64.9 cm)
JMC2427IL: 24³/₄" (62.9 cm)

30" (76.2 cm) models

- A. 28³/₈" (72.1 cm)
- B. 17³/₈" (44.1 cm)
- C. 22¹/₁₆" (57.7 cm)
- D. 29³/₄" (75.6 cm) overall width
- E. 19⁷/₈" (50.3 cm) overall height
- F. JMC2430IM: 25³/₁₆" (64.9 cm)
JMC2430IL: 24³/₄" (62.9 cm)

27" (68.6 cm) and 30" (76.2 cm) Microwave Oven Spacer Kit

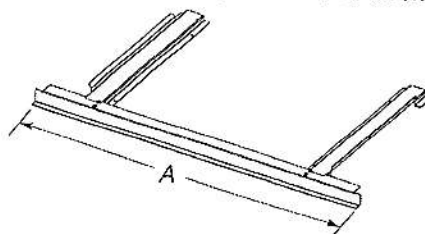

27" (68.6 cm) models

- A. 26³/₄" (67.9 cm) overall width

30" (76.2 cm) models

- A. 29³/₄" (75.6 cm) overall width

NOTE: The microwave oven spacer kit will allow the microwave oven to be installed in a 17³/₈" to 17³/₄" (44.1 to 45.1 cm) maximum cutout height.

INSTALLATION REQUIREMENTS

Tools and Parts

Gather the required tools and parts before starting installation. Read and follow the instructions provided with any tools listed here.

Tools Needed

- Phillips screwdriver
- Flat-blade screwdriver
- Measuring tape
- Level
- Drill (for wall cabinet installations)
- 1/8" (3 mm) drill bit (for wall cabinet installations)
- 1" (2.5 cm) drill bit (for wall cabinet installations)

Parts Needed

- UL listed or CSA approved conduit connector
- UL listed wire connectors

Parts Needed – Flush Installation

- W10801485 Stainless steel flush installation kit for 27" (68.6 cm) models
- W10801486 Stainless steel flush installation kit for 30" (76.2 cm) models
- W10801487 Black flush installation kit for 30" (76.2 cm) models

To order, see the "Assistance or Service" section of the Use and Care Guide.

Parts Supplied

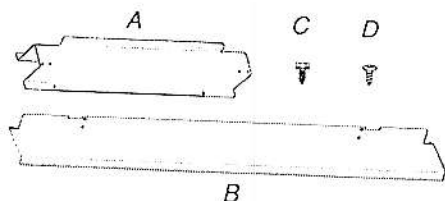

- A. Spacer bars (2)
- B. Bottom vent (1)
- C. 3/8" (9.5 mm) hex-head washer screws (4)
- D. 3/4" (1.9 cm) pan-head screws (4)

Check local codes. Check existing electrical supply. See "Electrical Requirements."

It is recommended that all electrical connections be made by a licensed, qualified electrical installer.

Location Requirements

IMPORTANT: Observe all governing codes and ordinances.

- Cabinet opening dimensions that are shown must be used. Given dimensions provide minimum clearance with microwave oven.
- Recessed installation area must provide complete enclosure around the recessed portion of the microwave oven.
- Grounded electrical supply is required. See "Electrical Requirements" section.
- Electrical supply junction box should be located 3" (7.6 cm) maximum below the support surface when the microwave oven is installed in a wall cabinet. A 1" (2.5 cm) minimum diameter hole should have been drilled in the left rear corner of the support surface to pass the appliance cable through to the junction box.

- For installation above single built-in oven, the junction box must located inside upper cabinet.
- If you are installing the junction box on rear wall behind the microwave oven, the junction box must be recessed and located in the upper or lower right or left corner of the cabinet; otherwise, the microwave oven will not fit into the cabinet opening.
- Microwave oven support surface must be solid, level, and flush with bottom of cabinet cutout. Floor must be able to support a weight of 108 lbs (49.0 kg).

IMPORTANT: To avoid damage to your cabinets, check with your builder or cabinet supplier to make sure that the materials used will not discolor, delaminate, or sustain other damage. This oven has been designed in accordance with the requirements of UL and CSA International and complies with the maximum allowable wood cabinet temperatures of 194°F (90°C).

Product Dimensions

27" (68.6 cm) and 30" (76.2 cm) Microwave Ovens

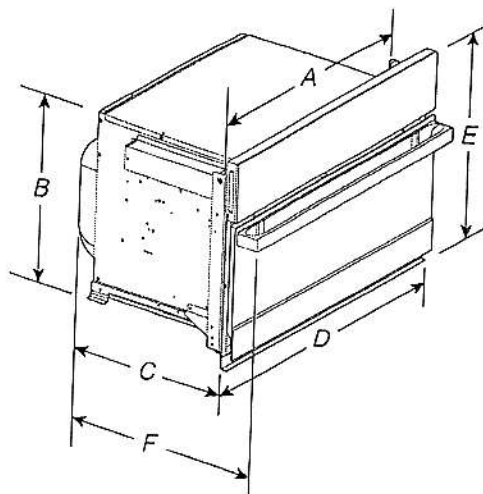

27" (68.6 cm) models

- A. 25³/₈" (64.5 cm)
- B. 17⁷/₈" (44.1 cm)
- C. 22¹/₁₆" (57.7 cm)
- D. 26³/₄" (68.0 cm) overall width
- E. 19⁷/₈" (50.3 cm) overall height
- F. JMC2427IM: 25⁹/₁₆" (64.9 cm)
JMC2427IL: 24³/₄" (62.9 cm)

30" (76.2 cm) models

- A. 28³/₈" (72.1 cm)
- B. 17⁷/₈" (44.1 cm)
- C. 22¹/₁₆" (57.7 cm)
- D. 29³/₄" (75.6 cm) overall width
- E. 19⁷/₈" (50.3 cm) overall height
- F. JMC2430IM: 25⁹/₁₆" (64.9 cm)
JMC2430IL: 24³/₄" (62.9 cm)

27" (68.6 cm) and 30" (76.2 cm) Microwave Oven Spacer Kit

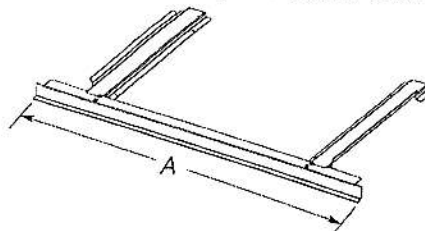

27" (68.6 cm) models

- A. 26³/₄" (67.9 cm) overall width

30" (76.2 cm) models

- A. 29³/₄" (75.6 cm) overall width

NOTE: The microwave oven spacer kit will allow the microwave oven to be installed in a 17³/₈" to 17³/₄" (44.1 to 45.1 cm) maximum cutout height.



30" SINGLE WALL OVEN WITH V2™ VERTICAL DUAL-FAN CONVECTION SYSTEM

Signature Features

V2™ VERTICAL DUAL-FAN CONVECTION

Dual counter-rotating vertical fans work in tandem, helping you wield your cooking prowess with everything from mouthwatering filets to irresistible roasts.

MY CREATIONS

My Creations allows you to seamlessly combine up to three cooking modes and save the settings for your favorite recipes.

IRRISISTIBLE INTERIOR

Captivation cloaked in black. Beyond a dark glass expanse, cinematic lighting illuminates smooth racks, flat tines, and an enticing jet black interior.

JJW3430I

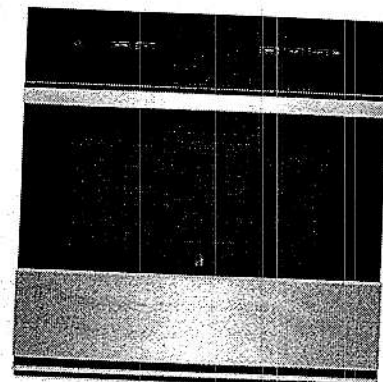

Feature Listing

DESIGN & CRAFTSMANSHIP

Irresistible Interior

7-Inch Full Color LCD Display

Cinematic Lighting

Seamless Touches

Glide Rack

Smooth Close Door

5.0 Cu. Ft. Capacity

PERFORMANCE

V2™ Vertical Dual-Fan Convection

My Creations

Closed Door Broiling

Versatile Modes

3,400-Watt Convection Element

2,800-Watt Hidden Bake Element

4,000-Watt Broil Element

6-Pass Reflective Broil Element

Connected Temperature Probe

ADDITIONAL FEATURES

Keep Warm™ Option

Auto Convection Conversion

Auto Convection Modes

Manual Convection Modes

Rapid Preheat

Proofing Option

Control Lock

Sabbath Mode

ADA Compliant

Badasses at the Ready

Serviced by a Select Few

Specifications

Shipping Weight (lbs) 184

Volts 240

Amps 20

Capacity (Cu. Ft.) 5.0

Dimensions

Overall Dimensions 30" x 29(7/8)" x 25(5/16)"

Opening / Clearance Dimensions (Traditional Installation) 26(1/2)" x 26" x 24"

Opening / Clearance Dimensions (Flush Installation) 30(1/4)" x 30(7/16)" x 25"

(Do not make any cutouts based on this information)

Style Options

RISE™

JJW3430IL

NOIR™

JJW3430IM



LIMITED
WARRANTY

Bold = Top Features

JENNAIR®



24" TRIFECTA™ DISHWASHER, 38 DBA

Signature Features

38 DBA* TRANQUILITY

Listen to the hush. At 38 dBA*, JennAir® is the quietest luxury dishwasher brand, all without sacrificing performance.

ULTRAGLIDE LOWER RACK

The strong and stable type. This adjustable lower rack glides smoothly on high-end rails.

TRIFECTA™ WASH SYSTEM

No need to choose between brilliant cleaning, water/energy reduction or quiet operation because our dishwashers deliver all three. Three-stage filtration, pressurized wash arms and alternating wash action in two zones yield superlative results.

JDTSS245G

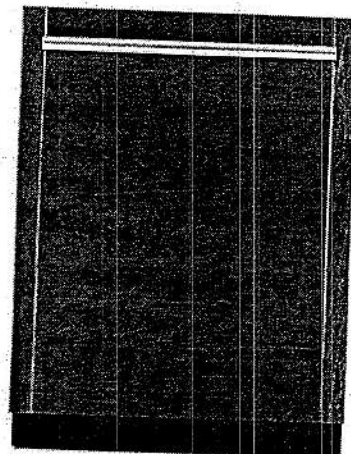

Feature Listing

DESIGN & CRAFTSMANSHIP

UltraGlide Lower Rack
Removable 3rd-Level Rack
Daring Obsidian Racks
Cinematic Lighting
SuperiorGlide Upper Rack
Fold-Away™ Tines
Flexible Capacity
Elevation Rack Adjusters
Concealed Controls
Culinary Caddy

PERFORMANCE

38 dBA* Tranquility
TriFecta™ Wash System
Tall Bottle Wash
3-Stage Filtration
Stainless Steel Spray Arms
ClearScan™ Sensor Cycle
Precision Dry® Plus Option
1-Hour Wash Cycle
Top Rack Wash Option
Bottom Rack Wash Option
Cookware/Bakeware Cycle
Crystal Cycle
Hi-Temp Wash Option
Refresh Cycle
Sanitize Rinse Option
Normal Tableware Cycle
SteamFinish Option

ADDITIONAL FEATURES

Detergent Dispenser

Folding Tines (Lower Rack)
Protector Racks with Cushioning Tines
Silverware Basket
Stainless Steel Tail Tub
Shift Tines
True Hold Door
Cup Shelves with Stemware Holders
Condensation Drying
ENERGY STAR® Certified
Emotive Feedback
Fold-Away Shelf
Waterlock™ Flood Protection
Badasses at the Ready
Serviced by a Select Few

Specifications

Shipping Weight (lbs) 95
Volts 120
Amps 15-20
Sound Rating (dBAs) 38
Capacity (Place Settings) 14

Dimensions

Overall Dimensions 23(7/8)" x 33(1/2)" x 24"

Do not make any cutouts based on this information.

Style Options

PANEL READY
JDTSS245GX

OPTIONAL ACCESSORIES

Classic Tubular Stainless Steel Handle Kit – W10701399
Industrial Grade Dishwasher Installation Kit – 8212488RC
3/4" X 3/8" Elbow Hose Fitting – W10685193
Small Items Bag – 8519716
Baby Bundle – DISHBABY
Capacity Extension Bundle – DISHEXTEND
Affresh Dishwasher and Disposal Cleaner (6 Tablets) – W10282479



LIMITED
WARRANTY

Booklet = Top Features

JENNAIR®

© 2019 JennAir. All rights reserved. See Owner's Manual for details.



✓ - One Frame



X - NOT TWO FRAMES .