

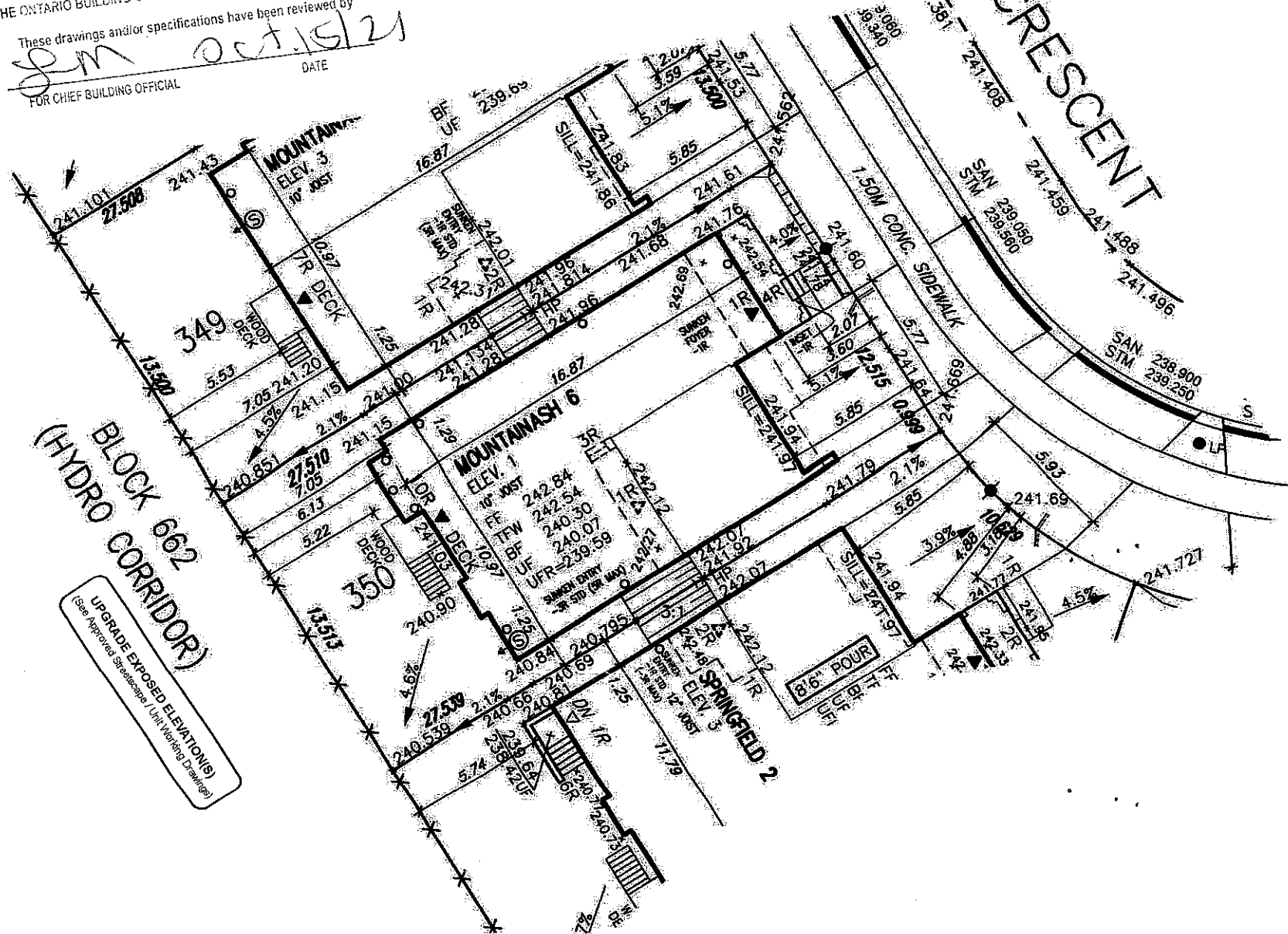







This stamp certifies compliance with the applicable
Design Guidelines only and bears no further
professional responsibility.

FOR CHIEF BUILDING OFFICIAL

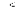

LOT 350		
LOT No.	LOT WIDTH (M) (@ 5.8m)	LOT AREA (M ²)
350	13.513	371.76

These drawings are to be read in conjunction with municipal approved site engineering drawings prepared by Metropolitan Consulting Inc.

- | | | | | | |
|--|---------------------------|---|-------------|--------|-------------------------------|
|  | PROPOSED VALVE |  | HYDRANT | LR | ML OF RISERS |
| UP  | LIGHT POLE |  | TRANSFORMER | FF | FINISHED FLOOR ELEVATION |
|  | WATER SERVICE | | | ML | FINISHED MAIN LEVEL ELEVATION |
|  | DOUBLE STM/SAN CONNECTION | | | UF | UNDERSIDE FOOTING ELEVATION |
|  | SINGLE STM/SAN CONNECTION | | | BF | FIN. BASEMENT FLOOR SLAB |
|  | CATCH BASIN | | | TFW | TOP OF FOUNDATION WALL |
|  | CABLE TELEVISION PEDESTAL | | | UPN | UNDERSIDE FOOTING AT REAR |
| | REF. PROJECT | | | UFF | UNDERSIDE FOOTING AT FRONT |
| | | | | UPS | UNDERSIDE FOOTING AT SIDE |
| | | | | W.O.D. | WALK OUT DECK |
| | | | | W.O.B. | WALK OUT BASEMENT |
| | | | | REV | REVERSE PLAN |

- STREET SIGN
MAIL BOX
RETAINING WALL
CHAIN LINK FENCE (SEE LANDSCAPE PLAN)
ACOUSTICAL FENCE (SEE LANDSCAPE PLAN)
WOOD SCREEN FENCE (SEE LANDSCAPE PLAN)
HYDRO SERVICE LATERAL
HYDRO METER
GIS METER
SWALE DIRECTION
OBSTACLES

- PROVIDE 3/4" DIA. CLEAR
STONE IN THIS AREA
- THIS LOT CONTAINS ENGINEERED F
AIR CONDIONER REQUIRED
RAIN WATER DOWNSPOUT LOCATION
(DISCHARGE ONTO SPLASHPAD)
SIDE WINDOW LOCATION
OPT. DOOR LOCATION
EXTERIOR DOOR LOCATION

North arrow

A simple line drawing of a north arrow, consisting of a long line with a circular head containing the letter 'N' and a small arrowhead at the end.

**VA3
DESIGN**
255 Consumers Rd Suite
Toronto ON M2J 1R4
416.630.2255 / 416.630
va3design.com

GW	1:250	20
----	-------	----

20027-RG4-SITE-LAYOUTS

Drawing no.:



11. *How do you think the current situation in the world will affect the U.S. economy in the next 12 months?*