

THIS LOT GRADING PLAN HAS BEEN REVIEWED BY METROPOLITAN CONSULTING INC. FOR CONFORMANCE WITH THE APPROVED SUBDIVISION GRADING DESIGN. THE PROPOSED GRADES ON THIS PLAN ARE IN GENERAL CONFORMITY WITH THE APPROVED GRADING PLAN AS IT RELATES TO THIS LOT AND ADJACENT LOTS. WHERE THE BASEMENT FLOOR OR OTHER FOUNDATION ELEVATIONS ARE PROPOSED AT A DIFFERENT ELEVATION THAN THAT SHOWN ON THE APPROVED SUBDIVISION PLANS THE SEWER LATERALS HAVE BEEN REVIEWED AND WE ARE SATISFIED THAT THE MINIMUM GRADES FOR THESE LATERALS CAN BE MAINTAINED IN ACCORDANCE WITH THE REQUIREMENTS OF THE O.B.C. AND CITY DESIGN CRITERIA. NOTE, THIS CERTIFICATION DOES NOT REPLACE THE BUILDER'S RESPONSIBILITY TO EXPOSE THE SEWER LATERALS AND CONFIRM ELEVATIONS PRIOR TO EXCAVATING FOR THE FOUNDATION. BY USE OF THIS PLAN THE BUILDER AGREES THAT THEY SHALL BE RESPONSIBLE FOR IMMEDIATELY REPORTING TO METROPOLITAN CONSULTING ANY DISCREPANCY OR VARIATION BETWEEN THE LATERAL INFORMATION AND GRADES DEPICTED ON THIS PLAN AND THE CONDITIONS FOUND IN THE FIELD.

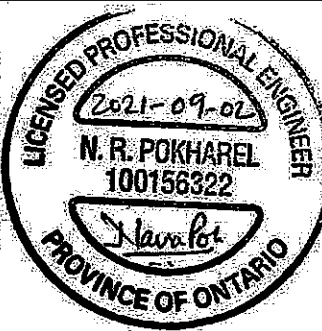

It is the builder's complete responsibility to ensure that all plans submitted for approval fully comply with the Architectural Guidelines and all applicable regulations and requirements including zoning provisions and any provisions in the subdivision agreement. The Control Architect is not responsible in any way for examining or approving site (lotting) plans or working drawings with respect to any zoning or building code or permit matter or that any house can be properly built or located on its lot.

This is to certify that these plans comply with the applicable Architectural Design Guidelines approved by the City of Hamilton.

JOHN G. WILLIAMS LTD., ARCHITECT  
ARCHITECTURAL CONTROL REVIEW  
AND APPROVAL

APPROVED BY:   
DATE: SEP 07, 2021

This stamp certifies compliance with the applicable Design Guidelines only and bears no further professional responsibility.

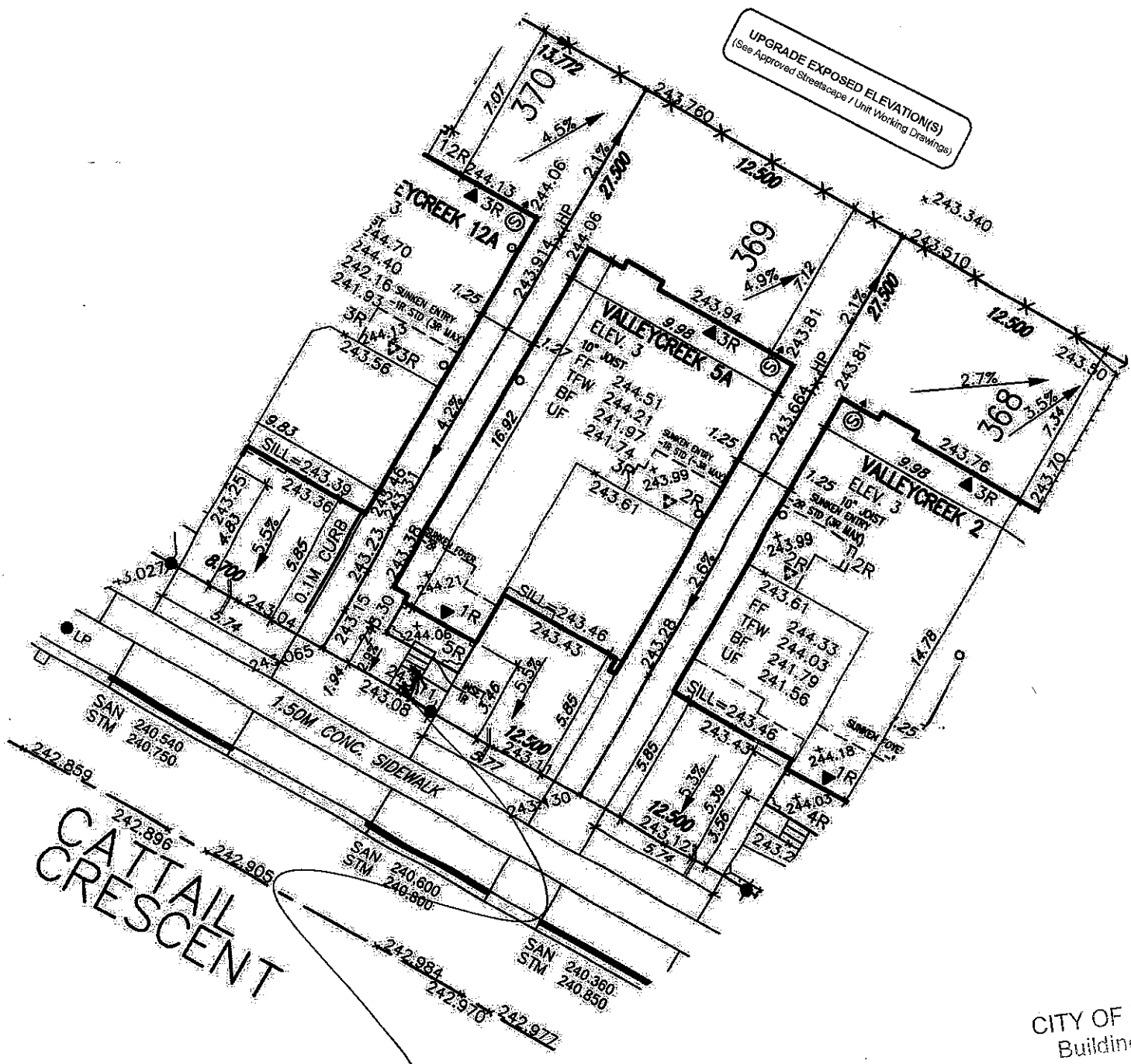

CITY OF HAMILTON  
Building Division

Permit No. 21-150982

THESE STAMPED DRAWINGS SHALL BE AVAILABLE ON SITE  
THE OWNER AND/OR CONTRACTOR SHALL COMPLY WITH  
THE ONTARIO BUILDING CODE AND ALL OTHER APPLICABLE LAW

These drawings and/or specifications have been reviewed by  
  
FOR CHIEF BUILDING OFFICIAL  
DATE OCT 04 2021

ROCK LOT

LOT 369		
LOT No.	LOT WIDTH (M) (± 5.8m)	LOT AREA (M²)
369	12.50	343.75

**Grading Notes:**  
It shall be the responsibility of the builder to have all grades and services verified and checked before construction by an approved grading engineer. These grades and the placement of storm and sanitary services off the street are to meet the requirements of the municipality having jurisdiction.

VA3 Design Inc. is to be notified promptly of any discrepancies at least 1 (one) week prior to excavation commences in order that the building can be re-sited. Failure to observe these conditions may require expensive remedial action that will not be the responsibility of, or cost to VA3 Design Inc. Foundation wall shall be poured to a minimum of 6" above approved grades.

Finished grade lines as indicated on the house prototype are for reference only and do not necessarily depict finish grading conditions of any particular lot.

These drawings are to be read in conjunction with municipal approved site engineering drawings prepared by Metrolan Consulting Inc.

NOTE: REFER TO LANDSCAPE DRAWINGS FOR ALL FENCING TYPES, HEIGHTS AND LOCATIONS. CONTRACTOR TO VERIFY PRIOR TO INSTALLATION.

PROPOSED VALUE

UP ● LIGHT POLE

WATER SERVICE

DOUBLE STN/SAN. CONNECTION

SINGLE STN/SAN. CONNECTION

CATCH BASIN

CHIEF TELEVISION PEDestal

BELL PEDestal

HYDRANT

TRANSFORMER

NO. OF RISERS

FF FINISHED FLOOR ELEVATION

ML FINISHED MAIN LEVEL ELEVATION

UF UNDERSIDE FOOTING ELEVATION

PF FIN. BASEMENT FLOOR SLAB

TFW TOP OF FOUNDATION WALL

UFR UNDERSIDE FOOTING AT REAR

UFF UNDERSIDE FOOTING AT FRONT

UPS UNDERSIDE FOOTING AT SIDE

W.O.B. WALK OUT BECH

W.O.B. WALK OUT BASEMENT

REV. REVERSE PLAN

STREET SIGN

MAIL BOX

RETAINING WALL

CHAIN LINK FENCE (SEE LANDSCAPE PLAN)

ACQUADICAL FENCE (SEE LANDSCAPE PLAN)

WOOD SCREEN FENCE (SEE LANDSCAPE PLAN)

HYDRO SERVICE LATERAL

HYDRO METER

GAS METER

EMBANKMENT (3:1 SLOPE unless otherwise noted)

PROVIDE 3/4" DIA. CLEAR STONE IN THIS AREA

THIS LOT CONTAINS ENGINEERED FILL

AIR CONDITIONER REQUIRED

RAN WATER DOWNSPOUT LOCATION (DISCHARGE INTO SPLASHPAD)

SIDE WINDOW LOCATION

OPT. DOOR LOCATION

EXTERIOR DOOR LOCATION

REDUCE SIDE YARD

North arrow

9

8

7

6

5

4

3

2

1

no. description

date

by

Builder to verify location of all hydrants, street lights, transformers and other services. If minimum elevations are not maintained, builder is to relocate at his own expense.

Builder to verify service connection elevations prior to constructing foundations. Drawings NOT to be scaled.

Richard Vink 24488

signature

BCM

VA3 Design Inc. 42658

VA3 DESIGN

255 Consumers Rd Suite 120

Toronto ON M2J 1R4

1-416-630-2255 / 416-630-4782

va3design.com

Greenpark

project name

RUSSELL GARDENS PHASE 4

city

HAMILTON

date

JUL 2021

checked by

scale

1:250

no. same

20027-RG4-SITE-LAYOUTS

drawing no.

1

lot/block no.

369

registered plan no.

62M-1266

project no.

20027