

This is to certify that these plans comply with the applicable Architectural Design Guidelines approved by the City of HAMILTON.

JOHN G. WILLIAMS LTD., ARCHITECT
ARCHITECTURAL CONTROL REVIEW
AND APPROVAL

APPROVED BY: [Signature]
DATE: SEP 14, 2021

This stamp certifies compliance with the applicable Design Guidelines only and bears no further professional responsibility.

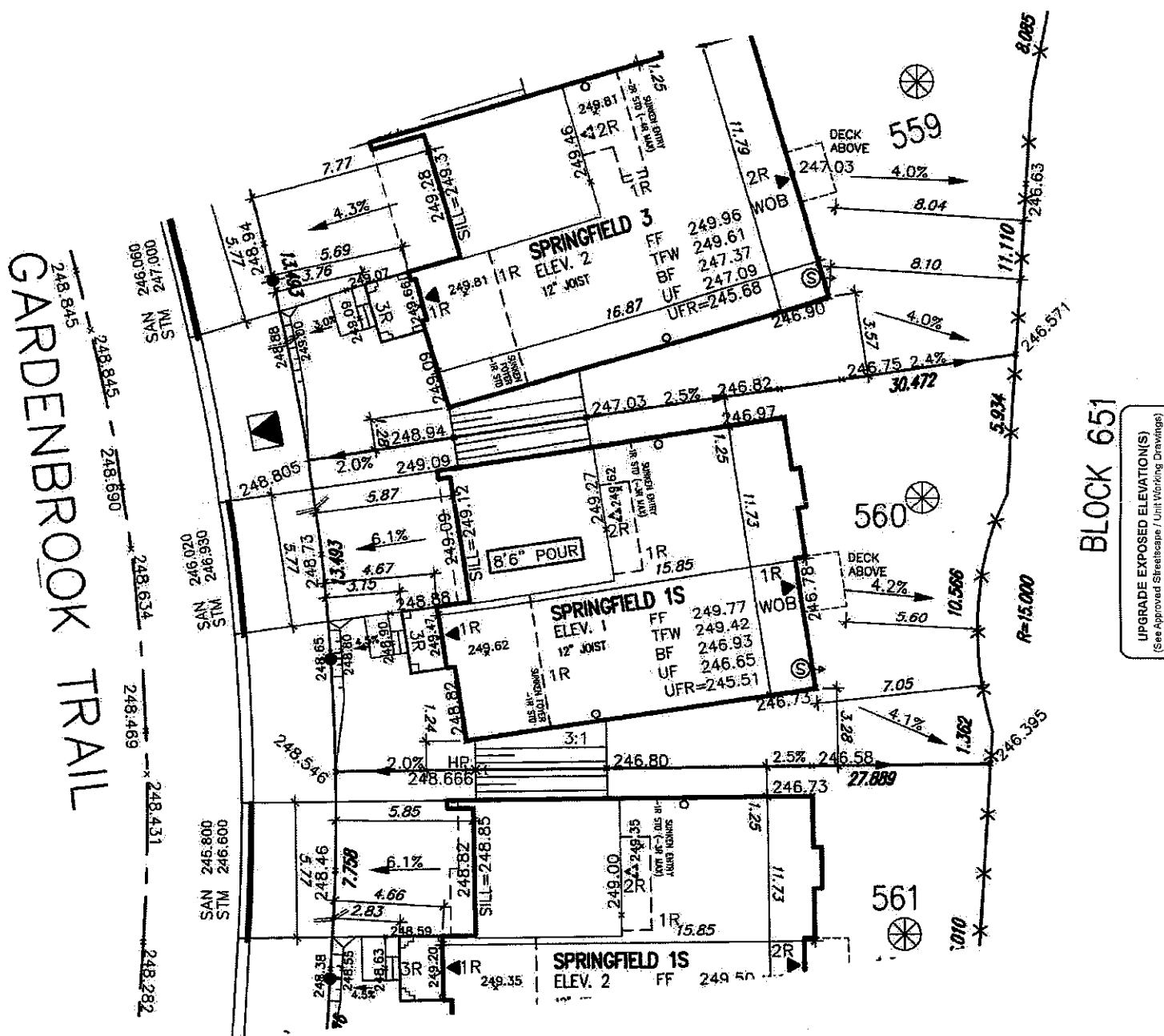

Grading Notes:
It shall be the responsibility of the builder to have all grades and services verified and checked before construction by an approved grading engineer. These grades and the placement of storm and sanitary services off the street are to meet the requirements of the municipality having jurisdiction.

WJ3 Design Inc. is to be notified promptly of any discrepancies at least 1 (one) week prior to excavation commences, in order that the building can be re-sited. Failure to observe these conditions may require expensive remedial action that will not be the responsibility of or cost to WJ3 Design Inc. Foundation wall shall be poured to a minimum of 6" above approved grades.

Finished grade lines as indicated on the house prototype are for reference only and do not necessarily depict finish grading conditions of any particular lot.

These drawings are to be read in conjunction with municipal approved site engineering drawings prepared by Metropolitan Consulting Inc.

LOT 560		
LOT No.	LOT WIDTH (M) (@ 5.8m)	LOT AREA (M ²)
560	14.274	441.79

NOTE: REFER TO LANDSCAPE DRAWINGS FOR ALL FENCING TYPES, HEIGHTS AND LOCATIONS. CONTRACTOR TO VERIFY PRIOR TO INSTALLATION

- | | | | |
|---|---|--|---|
| <p> PROPOSED VALVE
 LIGHT POLE
 HYDRANT
 WATER SERVICE
 TRANSFORMER
 DOUBLE SLM./SAN. CONNECTION
 SINGLE SLM./SAN. CONNECTION
 CATCH BASIN
 CABLE TELEVISION PEDESTAL
 BELL PEDESTAL </p> | <p> NO. OF RISERS
 FINISHED FLOOR ELEVATION
 FINISHED MAIN LEVEL ELEVATION
 FINISHED FOOTING ELEVATION
 FIN. BASEMENT FLOOR SLAB
 TOP OF FOUNDATION WALL
 UNDERSIDE FOOTING AT REAR
 UNDERSIDE FOOTING AT FRONT
 UNDERSIDE FOOTING AT SIDE
 WALK OUT DECK
 WALK OUT BASEMENT
 REVERSE PLAN </p> | <p> MAIL BOX
 RETAINING WALL
 CHAIN LINK FENCE (SEE LANDSCAPE PLAN)
 ACOUSTICAL FENCE (SEE LANDSCAPE PLAN)
 WOOD SCREEN FENCE (SEE LANDSCAPE PLAN)
 HYDRO SERVICE LATERAL
 HYDRO METER
 GAS METER
 SHADE DIRECTION
 ELEVATION </p> | <p> PROVIDE 3/4" DIA. CLEAR STONE IN THIS AREA.
 THIS LOT CONTAINS ENGINEERED FILL
 AIR CONDITIONER REQUIRED
 RAIN WATER DOWNSPOUT LOCATION (DISCHARGE ONTO SPLASHPAD)
 SIDE WINDOW LOCATION
 OPT. DOOR LOCATION
 EXTERIOR DOOR LOCATION
 REDUCE SIDE YARD </p> |
|---|---|--|---|

North River

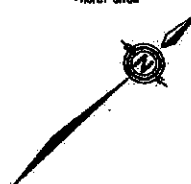

9	-	-	-	-	The undersigned has reviewed and takes responsibility for this design and has the qualifications and meets the requirements set out in the Ontario Building Code to be a Designer.
8	-	-	-	-	
7	-	-	-	-	qualification information
6	-	-	-	-	Richard Vink 24488
5	-	-	-	-	name, registration information signature BCN
4	-	-	-	-	VAJ Design Inc. 42658
3	-	-	-	-	
2	-	-	-	-	Builder to verify location of all hydrants, street lights, transformers and other services. If minimum dimensions are not maintained, builder is to relocate at his own expense.
1	ISSUED FOR PERMIT.	AUG 27/21	GW		Builder to verify service connection elevations prior to constructing foundations. ** Designer NOT to be acted **
no.	description	date	by		

**VA3
DESIGN**
255 Consumers Rd Suite 120
Toronto ON M2J 1R4
416.630.2255 f 416.630.478
va3design.com

Greenpark™

project name
RUSSELL GARDENS PHASE 4

date: 8/11/2021

driven by

GW
GREG - HAN

LOT SITING/GRADING

file name

20027-RG4-SITE-LAYOUTS

lot/block no.
560
registered plan no.
M-1266
project no.
20027

Drawing no.

1

!

All content specifications, related documents and design are the copyright property of MCS DESIGN. Reproduction of the property in whole or in part is strictly prohibited without MCS DESIGN's written permission.