

CONSTRUCTION SUMMARY				
Mountainview Heights 3 (G) - Russell Gardens Building Ltd.				
PURCHASERS: James Daniel CARREIRO and Tonya Lee AMORUSO			TEL: RES.: 289-259-8270	
LOT / PHASE	REG. PLAN #	HOUSE TYPE		
395 / 4	62M-1266	Valleycreek Three Elev 1		

CABINETRY

1 - CABINETRY - KITCHEN - LIGHT VALENCE - NO ELECTRICAL 29Oct21 Note:	
1 - DELETE HARDWARE NO HOLES DRILLED - KITCHEN 29Oct21 Note:	
1 - KITCHEN CABINETRY - DIFFERENT COLOUR ISLAND - FLAT FEE 29Oct21 Note:	
1 - CABINETRY - KITCHEN - UPGRADE 3 29Oct21 Note:	
1 - VANITY - ENSUITE - UPGRADE 3 29Oct21 Note:	
1 - CABINETRY PROVISION - PROVISION FOR PLUG ON ISLAND (PLUG EXTRA ORDERED SEPARATELY) 29Oct21 Note:	

CABINETRY ACCESSORIES

2 - KITCHEN CABINETRY BASE - DUMMY DOOR FOR BASE CABINETRY - UPGRADE 3 29Oct21 Note:	
1 - KITCHEN - ISLAND - CREATE OPENING FOR WINE FRIDGE ON ISLAND 29Oct21 Note:	
1 - KITCHEN HOOD CABINETS - CONTEMPORARY WOOD HOOD – UPGRADE 3 29Oct21 Note: PURCHASER TO SUPPLY AND INSTALL FAN AFTER CLOSING	
1 - PANTRY UNIT UPGRADE - TO GO FROM 300MM TO 600MM DEEP - PRICE IS PER FOOT - UPGRADE 3 29Oct21 Note:	
1 - KITCHEN CABINETRY UPPER - FULL DEPTH ABOVE FRIDGE - WITH GABLES - 600MM - PRICE IS EACH - UPGRADE 3 29Oct21 Note:	
1 - KITCHEN CABINETRY UPPER - MICROWAVE SHELF STANDARD - 700MM WIDE - UPGRADE 3 29Oct21 Note:	
1 - KITCHEN CABINETRY BASE - PULLOUT RECYCLE 4 BIN - PRICE IS EACH 29Oct21 Note:	
2 - KITCHEN CABINETRY BASE - POT/PAN DRAWERS (CABINET) - UPGRADE 3 29Oct21 Note:	
1 - KITCHEN CABINETRY BASE - PULLOUT WIRE SPICE RACK - PRICE IS EACH 29Oct21 Note:	

CERAMIC TILE

1 - TILE - UPGRADE 2 FLOOR TILE - - LAUNDRY ROOM 29Oct21 Note:	
1 - TILE - UPGRADE 2 FLOOR TILE - - POWDER ROOM 29Oct21 Note:	

CONSTRUCTION SUMMARY

Mountainview Heights 3 (G) - Russell Gardens Building Ltd.

PURCHASERS: James Daniel CARREIRO and Tonya Lee AMORUSO

TEL: RES.: 289-259-8270

LOT / PHASE	REG. PLAN #	HOUSE TYPE		
395 / 4	62M-1266	Valleycreek Three Elev 1		
1 - GROUT COLOUR - UPGRADE GROUT COLOUR THROUGHOUT - FLAT FEE 29Oct21 Note:				
1 - TILE - UPGRADE 4 WALL TILE - - ENSUITE WALL TILE - SHOWER 29Oct21 Note:				
1 - TILE - UPGRADE 4 FLOOR TILE - - ENSUITE BATHROOM - FLOOR 29Oct21 Note:				
1 - PRICE IS FOR LABOUR ONLY - INSTALL TILE IN A STAGGERED PATTERN - - BATHROOM 2/3 - TUB AREA 29Oct21 Note:				
1 - PRICE IS FOR LABOUR ONLY - INSTALL TILE IN A STAGGERED PATTERN - - BATHROOM 4 - SHOWER 29Oct21 Note:				
1 - TILE - UPGRADE 1 FLOOR TILE - - BATHROOM 2/3 - FLOOR 29Oct21 Note:				
1 - TILE - UPGRADE 1 FLOOR TILE - - BATHROOM 4 - FLOOR 29Oct21 Note:				
1 - DELETE ALL CERAMIC BATHROOM ACCESSORIES - DELETE TOWEL BAR, PAPER HOLDER & SOAP DISH THROUGHOUT 29Oct21 Note:				

CONSTRUCTION

1 - SMOOTH CEILINGS ON FIRST FLOOR ONLY - DET 29Oct21 Note:	
3 - ENLARGE BASEMENT WINDOWS (MAY REQUIRE WINDOW WELLS) - WINDOW IS 30 INCHES X 24 INCHES 20May21 Note:	

COUNTER TOP

1 - COUNTER TOP - UPGRADE TO CAESARSTONE - KITCHEN COUNTER TOP - IN LIEU OF STANDARD GRANITE AS PER OFFER 29Oct21 Note:	
--	---

DOORS AND TRIM

1 - TRIM - UPGRADE 1- 5-1/4" ONE STEP BASEBOARD AND ONE STEP CASING 29Oct21 Note:	
--	--

ELECTRICAL

1 - PLUG - ELECTRICAL PLUG - FOR WINE FRIDGE 29Oct21 Note:	
1 - PLUG - ELECTRICAL PLUG - FOR MICROWAVE SHELF 29Oct21 Note:	
1 - PLUG - ELECTRICAL PLUG WITH GFI AND SWITCH - FOR FESTIVE LIGHTING 29Oct21 Note:	
1 - PLUG - ELECTRICAL PLUG - TO BE INSTALLED OVER FIREPLACE 29Oct21 Note:	



CONSTRUCTION SUMMARY

Mountainview Heights 3 (G) - Russell Gardens Building Ltd.

PURCHASERS: James Daniel CARREIRO and Tonya Lee AMORUSO

TEL: RES.: 289-259-8270

LOT / PHASE	REG. PLAN #	HOUSE TYPE		
395 / 4	62M-1266	Valleycreek Three Elev 1		
1 - PLUG - ELECTRICAL PLUG - ADD TO ISLAND 29Oct21 Note:				
1 - RELOCATE STANDARD KITCHEN LIGHT TO BE CENTERED OVER ISLAND 29Oct21 Note:				
1 - POWDER ROOM - INSTALL STANDARD LIGHT ON WALL ABOVE MIRROR - IF CONSTRUCTION PERMITS 29Oct21 Note:				
1 - 200 AMP ELECTRICAL SERVICE 20May21 Note:				

FIREPLACE AND ACCESSORIES

1 - GAS LINE ROUGH-IN FOR STOVE (INCLUDES ELECTRICAL OUTLET) - FIRST FLOOR 29Oct21 Note:		
---	--	--

HARDWOOD FLOORING

1 - HARDWOOD - GROUP B SERIES 5 INCH - IN LIEU OF 2 1/4 INCH NATURAL RED OAK - - FAMILY ROOM 29Oct21 Note:		
1 - HARDWOOD - GROUP B SERIES 5 INCH - IN LIEU OF 2 1/4 INCH NATURAL RED OAK - - DINING ROOM 29Oct21 Note:		
1 - HARDWOOD - GROUP B SERIES 5 INCH - IN LIEU OF STANDARD TILE - KITCHEN/BREAKFAST 29Oct21 Note:		
1 - HARDWOOD - GROUP B SERIES 5 INCH - IN LIEU OF STANDARD TILES - FOYER & LOWER LANDING 29Oct21 Note:		

MIRRORS AND GLASS

1 - SHOWER DOOR HANDLE - CHROME D-RING WITH TOWEL BAR - MASTER ENSUITE BATHROOM 29Oct21 Note:		
1 - ALL BATHROOMS - DELETE STANDARD MIRRORS - DO NOT INSTALL 29Oct21 Note:		
1 - MASTER ENSUITE – FRAMELESS GLASS SHOWER ENCLOSURE – INCLUDES CHROME KNOB AND HINGES 20May21 Note:		

PLUMBING

1 - SINK - UNDERMOUNT SINK - BLANCO QUATRUS R15 U SUPER SINGLE #401518 - KITCHEN 02Nov21 Note:		
---	--	--

PROMOTIONAL

1 - LESS BALANCE OF CREDIT FROM PURCHASER EXTRA SHEET IN OFFER 29Oct21 Note:		
1 - LESS CREDIT FROM PURCHASER EXTRA SHEET IN OFFER 20May21 Note: NEW PROMO BALANCE \$2940.00		

STAIRS AND RAILINGS

CONSTRUCTION SUMMARY

Mountainview Heights 3 (G) - Russell Gardens Building Ltd.

PURCHASERS: James Daniel CARREIRO and Tonya Lee AMORUSO

TEL: RES.: 289-259-8270

LOT / PHASE	REG. PLAN #	HOUSE TYPE		
395 / 4	62M-1266	Valleycreek Three Elev 1		
1 - STAINED STAIRS – STANDARD STAIRCASE - PRICE IS PER SET 29Oct21 Note:				
1 - STAIRCASE - V GROOVE HANDRAIL 29Oct21 Note:				
1 - STAIRCASE - EUROLINE 0 IRON PICKETS - BLACK 29Oct21 Note:				

EXTRAS AS PER OFFER

PURCHASER(S) ACKNOWLEDGES THAT THE PURCHASE PRICE IS INCLUSIVE OF ALL CREDITS AND PROMOTIONAL PACKAGES AVAILABLE AT TIME OF PURCHASE. Worksheet Note:	
(1) The Vendor agrees that notwithstanding any other term or provision in this Agreement included in the Purchase Price and in addition to those items detailed in Schedule GP to the Agreement of Purchase and Sale, the Purchaser is entitled to a credit of Worksheet Note:	
Granite kitchen counter top, from Vendor?s standard samples Worksheet Note:	

This Document is Extremely Time Sensitive - Printed 2 Nov 21 at 16:15

Purchasers:

James Daniel CARREIRO & Tonya Lee AMORUS

Property: 395

Telephone Res. / Bus:

(289) 259-8270 /

Project: Russell Gardens Building Ltd.

Decor Advisor:

Ida Viola

Model and Elevation: Valleycreek Three Elev 1

Lock Date:

9-Nov-21

29-Oct-21

Plan #: 62M-1266

Layout Changes: ☒ Yes ☐ No

Sketch Attached: ☒ Yes ☐ No

Exterior Colour Scheme:

1. Cabinetry

	Style and Colour	Hardware
Kitchen / Breakfast	SEE BELOW	N/A
Laundry Room	ELISSE	Standard
Powder Room	EVEREST	410SA
Master Ensuite Bathroom	LEGACY 668 EVENING CLOUD	410SA
Ensuite Bath - Bedroom 2/3	EVEREST	410SA
Ensuite Bath - Bedroom 4	EVEREST	410SA
	N/A	N/A
	N/A	N/A
	N/A	N/A

Appliances:

Built In Appliances ☐ Yes ☒ No

Slide In Stove ☐ Yes ☒ No

Dishwasher Cabinet ☐ Closed ☒ Open

41" Upper Cabinets ☒ Yes ☐ No

Please NOTE: Standard Cabinet Height is 30"

Stove Opening

NOTE: If not specified, opening will be set to builder's standard opening of approximately 30" width

Fridge Opening

NOTE: If not specified, opening will be set to builder's standard opening of approximately 37" width x 74" height

PERIMETER-LEGACY 613 CRISP WHITE***ISLAND-LEGACY 699 PORT BLUE ** Refer to Construction Summary

2. Counters

	Counter	Edge
Kitchen / Breakfast	QUARTZ-CS-STATUARIO MAXIMUS 5031	#360
Laundry Room	N/A	
Powder Room	LAMINATE-WHITE CARRARA 4924-38	
Master Ensuite Bathroom	LAMINATE-PALOMA POLAR 6698-46	
Ensuite Bath - Bedroom 2/3	LAMINATE-WHITE CARRARA 4924-38	
Ensuite Bath - Bedroom 4	LAMINATE-CARRARA BIANCO 6696-46	
	N/A	
	N/A	
	N/A	

** Refer to Construction Summary

Initials:

Purchasers:

James Daniel CARREIRO & Tonya Lee AMORUS

Telephone Res. / Bus:

(289) 259-8270 /

Decor Advisor:

Candace Forza

Lock Date:

29-Oct-21

Property: 395

Project: Russell Gardens Building Ltd.

Model and Elevation: Valleycreek Three Elev 1

Plan #: 62M-1266

3. Ceramic Flooring

At a 45

Threshold-If App.

Entrance Vestibule	STRIP	<input type="checkbox"/>	metal strip where applicable
Main Hall	N/A	<input type="checkbox"/>	
Kitchen / Breakfast	STRIP	<input type="checkbox"/>	
Laundry Room	TILE-AXIS BLACK-12X24	<input type="checkbox"/>	GROUT - 4 CHARCOAL
Powder Room	TILE-AXIS BLACK-12X24	<input type="checkbox"/>	GROUT - 4 CHARCOAL
Master Ensuite Bathroom	TILE-VARENNA CARARRA POLISHED-24X24	<input type="checkbox"/>	GROUT - 50 TITANIUM
Ensuite Bath - Bedroom 2/3	TILE-STONE WHITE-12 1/4 X 24 1/4	<input type="checkbox"/>	GROUT - 61 OYSTER SHELL
Ensuite Bath - Bedroom 4	TILE-STONE DARK GREY-12 1/4 X 24 1/4	<input type="checkbox"/>	GROUT - 3 GREY
	N/A	<input type="checkbox"/>	
	N/A	<input type="checkbox"/>	
	N/A	<input type="checkbox"/>	

** Refer to Construction Summary

4. Ceramic Wall Tile

Master Ensuite Bathroom	Selection	Describe
Tub Deck Wall	N/A	
Tub Deck	N/A	
Tub Deck Skirt	N/A	
Shower Stall	TILE-VARENNA CARARRA POLISHED-12X24	GROUT - 50 TITANIUM
Bathtub Enclosure Walls	N/A	
Ensuite Bath - Bedroom 2/3	TILE-BIANCO MATTE-8X16***LAID STAGGERED***	GROUT - 61 OYSTER SHELL
Ensuite Bath - Bedroom 4	TILE-BIANCO LUCIDO-8X16***LAID STAGGERED***	GROUT - 3 GREY
	N/A	
	N/A	
	N/A	
Kitchen Backsplash	N/A	

** Refer to Construction Summary - STANDARD GROUT THROUGHOUT UNLESS SPECIFIED

5. Plumbing Fixtures

All Bathrooms

White

N/A

N/A

N/A

N/A

N/A

Whirlpool

N/A

☐ Yes

☒ No

Dishwasher Rough-In

☒ Yes

☐ No

Waterline for Fridge

☐ Yes

☒ No

** Refer to Construction Summary

6. Trim Carpentry

Interior Doors	CARRARA-SMOOTH
Interior Trim	BB CASING WITH 5 1/4" BASEBOARD - ONE STEP
Door Handles	As Per Construction Specifications
Exterior Front Door Handle	As Per Construction Specifications

** Refer to Construction Summary

Purchasers:

James Daniel CARREIRO & Tonya Lee AMORUS

Telephone Res. / Bus:

(289) 259-8270 /

Decor Advisor:

Candace Forza

Lock Date:

29-Oct-21

Property: 395

Project: Russell Gardens Building Ltd.

Model and Elevation: Valleycreek Three Elev 1

Plan #: 62M-1266

7. Other Flooring

Main Hall	STRIP-VINTAGE-NSS-CHARACTER-WIRE BRUSHED-UV URETHANE OIL-WHITE OAK-PHARAOH-5"	
Living Room	N/A	
Dining Room	STRIP-VINTAGE-NSS-CHARACTER-WIRE BRUSHED-UV URETHANE OIL-WHITE OAK-PHARAOH-5"	
Family Room	STRIP-VINTAGE-NSS-CHARACTER-WIRE BRUSHED-UV URETHANE OIL-WHITE OAK-PHARAOH-5"	
Den / Library / Study	N/A	
Basement Landing(If Applies)	N/A	
Lower Landing (If Applies)	STRIP-VINTAGE-NSS-CHARACTER-WIRE BRUSHED-UV URETHANE OIL-WHITE OAK-PHARAOH-5"	
Upper Landing	STRIP-VINTAGE-NSS-CHARACTER-WIRE BRUSHED-UV URETHANE OIL-WHITE OAK-PHARAOH-5"	
Upper Hall	LAMINATE-LEXINGTON-CHARLEROI OAK-TL-LW1314	
Master Bedroom	LAMINATE-LEXINGTON-CHARLEROI OAK-TL-LW1314	
Bedroom #2	LAMINATE-LEXINGTON-CHARLEROI OAK-TL-LW1314	
Bedroom #3	LAMINATE-LEXINGTON-CHARLEROI OAK-TL-LW1314	
Bedroom #4	LAMINATE-LEXINGTON-CHARLEROI OAK-TL-LW1314	
Bedroom #5	N/A	
FOYER	STRIP-VINTAGE-NSS-CHARACTER-WIRE BRUSHED-UV URETHANE OIL-WHITE OAK-PHARAOH-5"	
KITCHEN & BREKFAST	STRIP-VINTAGE-NSS-CHARACTER-WIRE BRUSHED-UV URETHANE OIL-WHITE OAK-PHARAOH-5"	
	N/A	
Underpad	Type	Area
	N/A	N/A

** Refer to Construction Summary

8. Railings and Pickets

Railing Type	V-GROOVE	Complimenting Colour	VINTAGE-PHARAOH WHITE OAK
Picket Type	EUROLINE 0	Complimenting Colour	BLACK
Stringer / Riser	AS PER CONSTRUCTION SPECIFICATIO	Complimenting Colour	VINTAGE-PHARAOH WHITE OAK
Treads	AS PER CONSTRUCTION SPECIFICATIO	Complimenting Colour	VINTAGE-PHARAOH WHITE OAK

Red Oak Stairs

☒ Yes

☐ No

** Refer to Construction Summary

THE STAIN COLOURS OR FINISH AVAILABLE ON RISERS, TREADS, PICKETS AND RAILS (STAIRCASES), WILL NOT BE AN EXACT MATCH TO PREFINISHED HARDWOOD OR LAMINATE FLOORS.

9. Wall Paint Flat Finish

Main & Upper Hall	22 WARM GREY	Master Bedroom	22 WARM GREY
Living Room	N/A	Bedroom #2	22 WARM GREY
Dining Room	22 WARM GREY	Bedroom #3	22 WARM GREY
Kitchen / Breakfast	22 WARM GREY	Bedroom #4	22 WARM GREY
Family Room	22 WARM GREY	Bedroom #5	N/A
Powder Room	22 WARM GREY	Master Ensuite	22 WARM GREY
Laundry Room	22 WARM GREY	Ensuite Bath - Bedroom 2/3	22 WARM GREY
Den/Library	N/A	Ensuite Bath - Bedroom 4	22 WARM GREY
Trim & Door Paint-Semi Gloss	BIRCH WHITE		N/A
	N/A		N/A
	N/A		N/A

Smooth Ceilings First Floor

☒ Yes

☐ No

** Refer to Construction Summary

Initials:

Purchasers:

James Daniel CARREIRO & Tonya Lee AMORUS

Property: 395

Telephone Res. / Bus:

(289) 259-8270 /

Project: Russell Gardens Building Ltd.

Decor Advisor:

Candace Forza

Model and Elevation: Valleycreek Three Elev 1

Lock Date:

29-Oct-21

29-Oct-21

Plan #:

62M-1266

10. Plaster Mouldings and Medallions

Entrance Vestibule	N/A	N/A	Kitchen/Breakfast	N/A	N/A
Main Hall	N/A	N/A	Den/Library	N/A	N/A
Living Room	N/A	N/A	Lower Landing	N/A	N/A
Dining Room	N/A	N/A		N/A	N/A
Family Room	N/A	N/A			

** Refer to Construction Summary

11. Fireplace

Living Room	Family Room	Other Room - Specify
Purchased As Per Plan N/A	Purchased As Per Plan N/A	Purchased As Per Plan N/A
<input type="radio"/> <input type="radio"/> <input checked="" type="radio"/>	<input type="radio"/> <input checked="" type="radio"/> <input type="radio"/>	<input type="radio"/> <input type="radio"/> <input checked="" type="radio"/>

Fireplace Type	N/A	FLAT ON WALL	N/A
Mantle Type	N/A	MANTLE M2-STANDARD	N/A
Colour / Stain	N/A	AS PER CONSTRUCTION SPECIFICATIONS	N/A
Surround	N/A	BIANCO	N/A
Hearth	N/A	NO	N/A

** Refer to Construction Summary

12. Heating and Air Conditioning

Air Conditioning	NO	Gas Provisions Stove	YES
Gas Provisions Dryer	NO	Gas Provisions Barbecue	NO
Comment			

** Refer to Construction Summary

13. Electrical

Plugs and Switches	<input checked="" type="radio"/> White DECOR	Above Kitchen Cabinet Light	<input type="radio"/> Yes <input checked="" type="radio"/> No
Hood Fan	STANDARD WHITE TEMP.	Below Kitchen Cabinet Light	<input type="radio"/> Yes <input checked="" type="radio"/> No
Appliances	Built in Cooktop Built in Oven	Gas Stove	Microwave
	<input type="radio"/> Yes <input checked="" type="radio"/> No <input type="radio"/> Yes <input checked="" type="radio"/> No	<input checked="" type="radio"/> Yes <input type="radio"/> No	<input checked="" type="radio"/> Yes <input type="radio"/> No
Dishwasher Rough-in	Yes		

** Refer to Construction Summary

14. General Comments

** Refer to Construction Summary

Disclaimers and Notes

1) Colours of all materials are as close as possible to builder's selection, but not necessarily identical due to variances in manufacturing.

2) Any extras listed above are null and void unless accompanied by a separate invoice/amendment. Said invoice must be paid in full.

3) The Purchaser agrees that this colour selection is final and that no changes will be permitted, unless required by the Vendor.

4) The Purchaser acknowledges reading and accepting document which contains other miscellaneous disclaimers.

Signature: 

Date: _____

Signature: 

Date: _____

Purchaser:
Lot:

Carreiro + Amoroso
395

Schedule SMART
Russell Gardens Building Ltd. (Phase 4)

Smart Home System includes:

1. One (1) Smart Home Hub installed in a location as determined by the Vendor;
2. One (1) Doorbell camera supplied and installed at front door;
3. One (1) smart home thermostat to be installed in a location as determined by the Vendor;
4. One (1) smart Flood sensor to be installed in a location as determined by the Vendor which is designed to detect water in the location of the sensor only;
5. Smart light switches to be installed in such locations as determined by the Vendor;



Certain devices for The Smart Home System require a fully functioning WiFi network and internet connection and others work on the Zwave wireless network. Provision of WiFi, internet access and functionality shall be the sole responsibility of the Purchaser and the Vendor assumes no responsibility or obligation with respect to the functionality or performance of a homeowner's internet or WiFi network. The Vendor does not guarantee that networks, equipment, or services will meet all homeowner needs.

The Purchaser will be required to download the Homewave Smart Connect App (the "App") in order to configure and set up the Smart Home System devices. The Purchaser is responsible to ensure that they have the appropriate technology to download the App and any charges and fees for download and/or data usage shall be at the Purchaser's sole cost and expense. Access to the App shall be provided free of charge for 1 year from the Closing Date and thereafter the Purchaser may enter into an agreement with Homewave Smart Connect to continue the services for a monthly fee (currently \$10.00/month plus HST). Fees subject to change without notice.

Purchasers are responsible for configuring all security features. The Vendor does not warrant or represent that any network or Smart Home System devices are secure or can prevent all privacy intrusions, malware, or cyber-attacks, even when correctly configured. The products and services for the Smart Home System are provided by third parties, and not the Vendor. The Vendor does not guarantee any equipment or services provided by third parties. If the Purchaser contracts with the third-party provider to upgrade or purchase further devices, the Vendor has no responsibility for same, including but not limited to, the installation, service, safety or functionality of said products.

Energy claims are not based upon specific testing of an individual home but are general assumptions. Savings will vary due to many variables, including but not limited to, actual utility rates and fees, actual construction, floor plan, occupancy, appliance usage, thermostat settings, weather conditions, number of individuals occupying the home and orientation of the home.

The Vendor is providing only those Smart Home System's devices and components listed in this Schedule. Please see the balance of your Agreement of Purchase and Sale for additional information, disclosures, and disclaimers relating to your home and its features. The specific features in a home may vary from home to home and from one community to another. The Vendor reserves the right to substitute equipment, material, appliances and brand names with items of equal or higher value, in its sole and unfettered discretion. The Vendor reserves the right, in its sole and absolute discretion, to omit installation of the Smart Home System, in part or in whole, and the Purchaser shall have no claim for abatement or reduction the Purchase Price or to any delay in closing. Installation of the Smart Home System may result in the elimination of other features listed in Schedule GP or other information material, such as but not limited to set back thermostat, rough-in for alarm or other features deemed redundant as a result of the installation of the Smart Home System.

Purchaser Initials	Purchaser Initials
	

Center Std
Light Above
Island

Plug for
Wire fridge.

Plug on
Island

Plug for
micro shelf

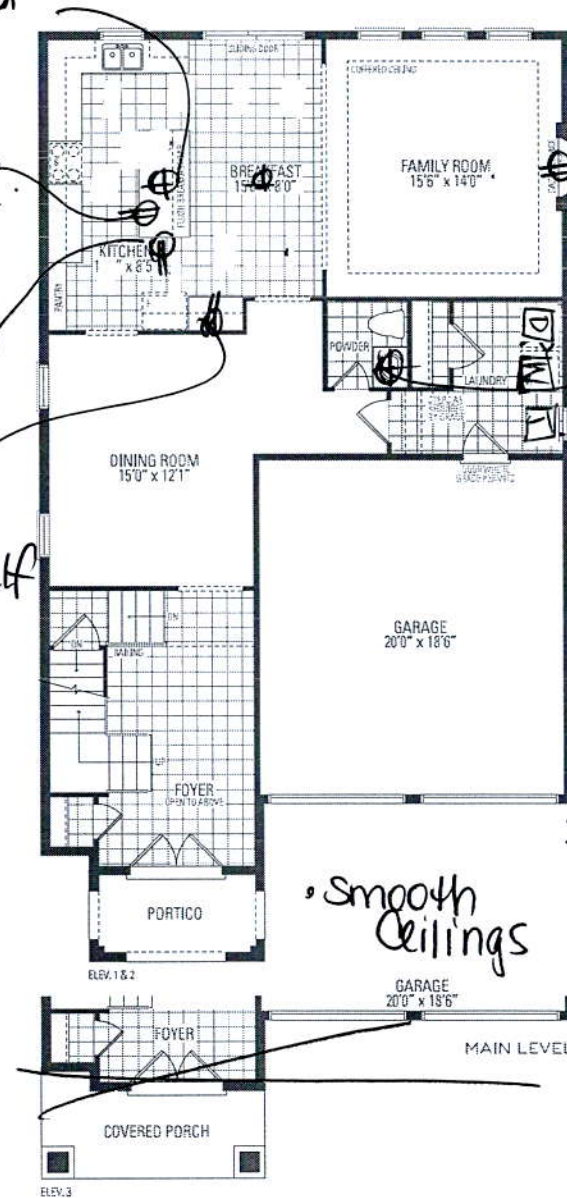

Plug Above
Fireplace

Install
Std
Light
on Wall

Festive
Plug

- Walk-Out
- Enlarge Basement Windows
- 200 AMP

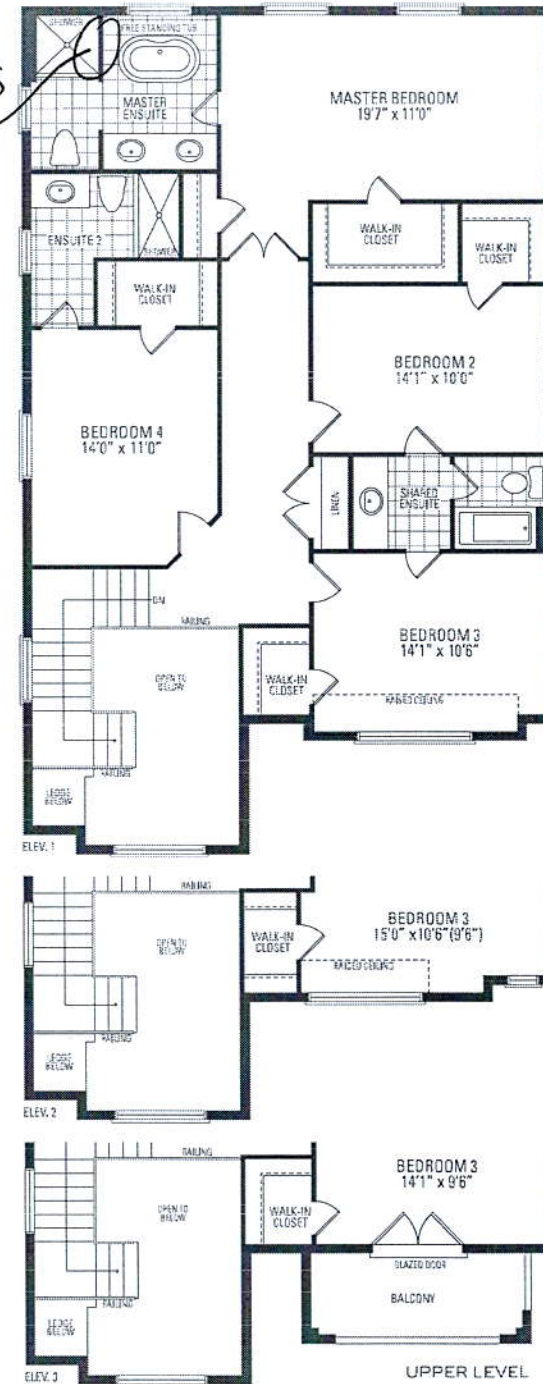

VALLEYCREEK THREE ELEV. 1 • 2,772 sq.ft. | ELEV. 2 • 2,773 sq.ft. | ELEV. 3 • 2,758 sq.ft.

Orientation of home may be reversed and purchaser agrees to accept the same. Steps and porches may vary at any exterior entrance ways due to grading variance. Actual usable floor space may vary from the stated floor areas. All renderings are artist's concept. Dimensions, specifications and architectural detailing subject to modifications. Roofline and adjoining model types may vary due to siting. E. & D. E. May 2020

- Light Variance.



- upg. 3 Legacy Cabinets

- Different Colour Cabinet On Island.

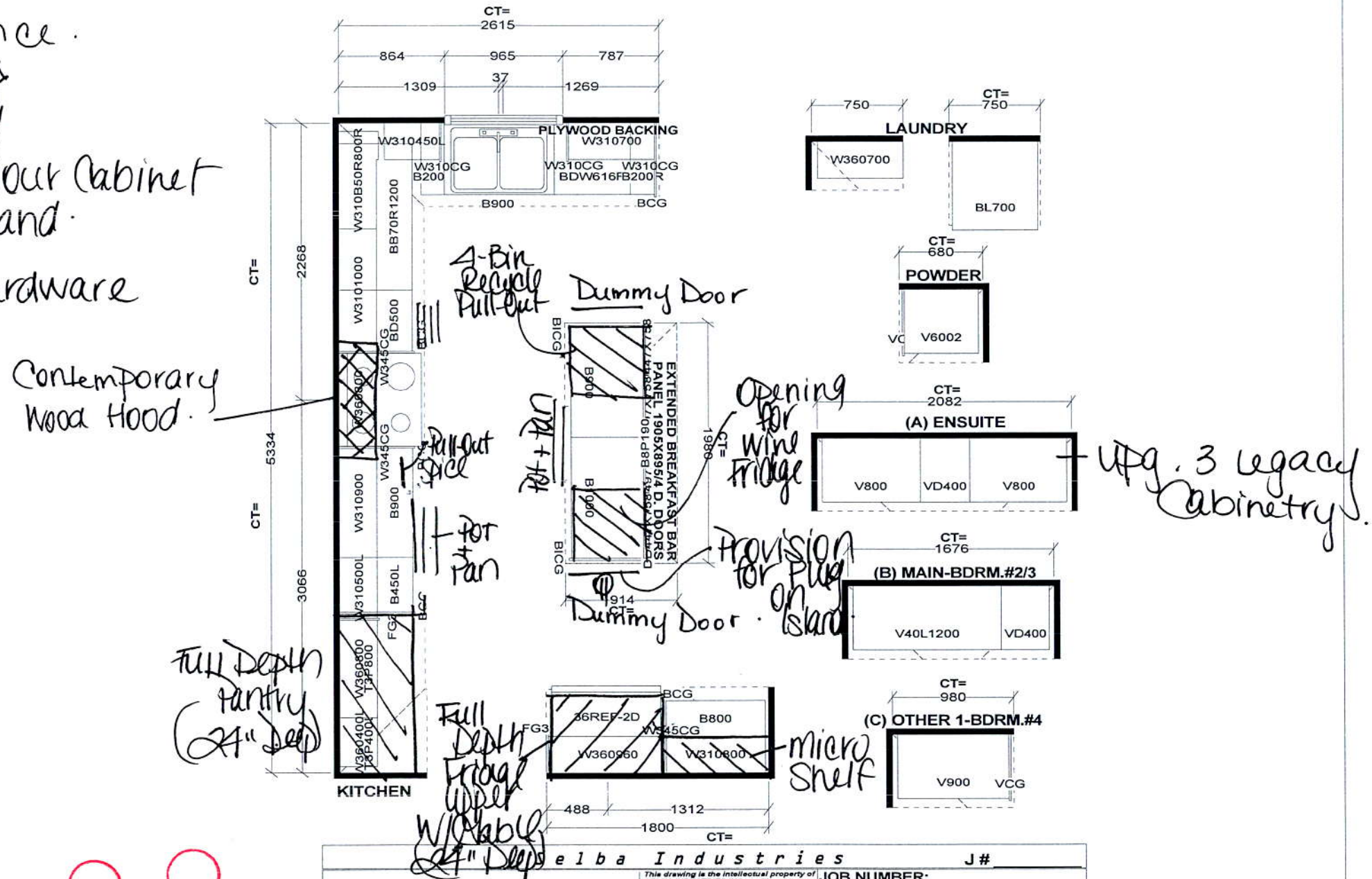
- Delete Hardware



- Upg. 3 legacy Cabinetry.

		SELBA INDUSTRIES		J#
W WDT	W HGT	W CNT	JOB NUMBER:	BUILDER: GREENPARK
FLOOR HGT	DOOR HGT		SITE: RUSSELL GARDENS PH.3	MODEL: VALLEYCREEK 3X EL 1,2,3
ST. CENT	2X4	VENT BOX COVER	DESIGNER: KS DATE: MAY 13 20	LOT #:

KFGC506JBK

KitchenAid®

KitchenAid® 36" Smart Commercial-Style Gas
Range with 6 Burners

<http://www.kitchenaid.com>



Key Features:

- Even-Heat™ True Convection
- Two 20,000 BTU Ultra Power™ Dual-Flame Burners
- Smart Appliance
- 5,000 BTU Simmer & Melt Burner
- Three-Level Convertible Grates
- Three 15,000 BTU Burners
- Dual-Concentric Oven Knob
- SatinGlide™ Roll-Out Extension Rack
- 5.1 Cu. Ft. Capacity
- EasyConvect™ Conversion System
- KitchenAid® Handle Medallion Kit (sold separately)

Product Dimensions:

Height: 36

Width: 35 7/8

Additional Information:

[Use And Care Guide](#)

[Dimension Guide](#)

[Installation Guide](#)

[Warranty Certificate](#)

Available in:

Avocado Cream

● Imperial Black

Ink Blue

Misty Blue

Milkshake

Passion Red

Scorched Orange

● Stainless Steel

Yellow Pepper

INVESTED
IN
AMERICA

®Registered trademark/TM Trademark of Whirlpool, U.S.A. © 2016 Whirlpool Corporation. All Rights Reserved.
All other trademarks are owned by their respective companies.

Because Whirlpool Corporation policy includes a continuous commitment to improve our products, we reserve the right to change materials and specifications without notice. We also reserve the right to discontinue or transition products without notice.

Manufacturer's Suggested Retail Price (MSRP) and Minimum Advertised Price (MAP) provided for reference purposes only. Dealer alone determines advertised and retail prices.

Created On: Friday, May 08, 2020 13:06:49

Parts Supplied

Check that all parts are included.

- Anti-tip bracket kit

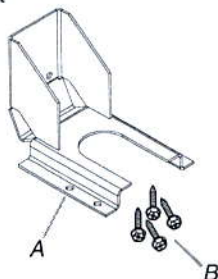

A. Anti-tip bracket

B. #8-18 x 1" (2.5 cm) Phillips head screws (4)

NOTE: Anti-tip bracket must be securely mounted to subfloor. Thickness of flooring may require longer screws to anchor bracket to subfloor. Longer screws are available from your local hardware store. See the "Install Anti-Tip Bracket" section.

- Burner grates
- Burner caps
- Griddle drip tray (on griddle models)

Parts Needed

- All models must be installed with a backguard if installing at zero clearance to a combustible back wall surface such as drywall. See "Cabinet Dimensions" in the "Location Requirements" section for installation requirements.

Check local codes and consult gas supplier. Check existing gas supply and electrical supply. See the "Electrical Requirements" and "Gas Supply Requirements" sections.

It is recommended that all electrical connections be made by a licensed, qualified electrical installer.

Location Requirements

IMPORTANT: Observe all governing codes and ordinances. Do not obstruct flow of combustion and ventilation air.

- It is the installer's responsibility to comply with installation clearances specified on the model/serial/rating plate. The model/serial/rating plate is located under the console on the right-hand side.
- It is recommended that a 585 CFM (993.9 m³/hr) or larger range hood be installed above the range.
- Follow the range hood or microwave hood combination installation instructions for dimensional clearances above the cooktop surface.
- Recessed installations must provide complete enclosure of the sides and rear of the range.
- All openings in the wall or floor where range is to be installed must be sealed.
- Do not seal the range to the side cabinets.
- Cabinet opening dimensions that are shown must be used. Given dimensions are minimum clearances.
- The anti-tip bracket must be installed. To install the anti-tip bracket shipped with the range, see the "Install Anti-Tip Bracket" section.
- Grounded electrical supply is required. See the "Electrical Requirements" section.
- Proper gas supply connection must be available. See the "Gas Supply Requirements" section.
- Contact a qualified floor covering installer to check that the floor covering can withstand at least 200°F (93°C). Use an insulated pad or 1/4" (6.4 mm) plywood over carpet and under range if installing range over carpeting.

IMPORTANT: To avoid damage to your cabinets, check with your builder or cabinet supplier to make sure that the materials used will not discolor, delaminate, or sustain other damage. This oven has been designed in accordance with the requirements of UL and CSA International and complies with the maximum allowable wood cabinet temperatures of 194°F (90°C).

Mobile Home - Additional Installation Requirements

The installation of this range must conform to the Manufactured Home Construction and Safety Standard, Title 24 CFR, Part 3280 (formerly the Federal Standard for Mobile Home Construction and Safety, Title 24, HUD Part 280). When such standard is not applicable, use the Standard for Manufactured Home Installations, ANSI A225.1/NFPA 501A or local codes.

In Canada, the installation of this range must conform with the current standards CAN/CSA-A240-latest edition or with local codes.

Mobile Home Installations Require:

- When this range is installed in a mobile home, it must be secured to the floor during transit. Any method of securing the range is adequate as long as it conforms to the standards listed above.

Product Dimensions

NOTE: Cooktop features may differ.

30" (76.2 cm) models

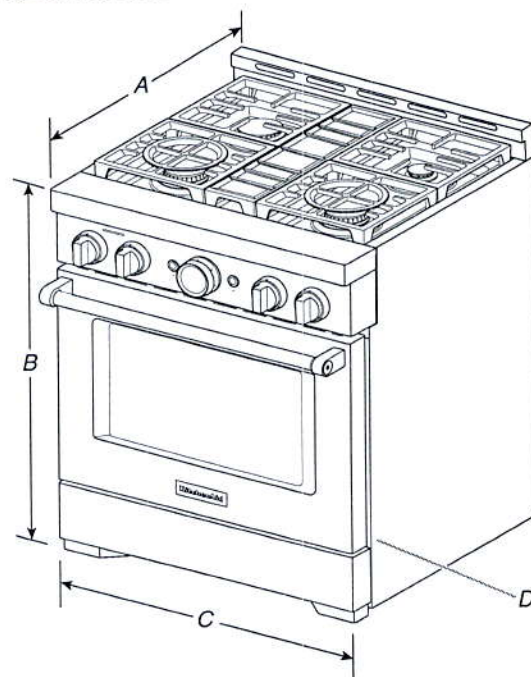

A. 27³/₄" (70.5 cm) depth with control panel (See NOTE.)

B. 36" (91.4 cm) range height when sitting on the wheels

C. 29⁷/₈" (75.7 cm) width

D. Model/serial/rating plate location/SAID label (located on front side panel)

36" (91.4 cm) models

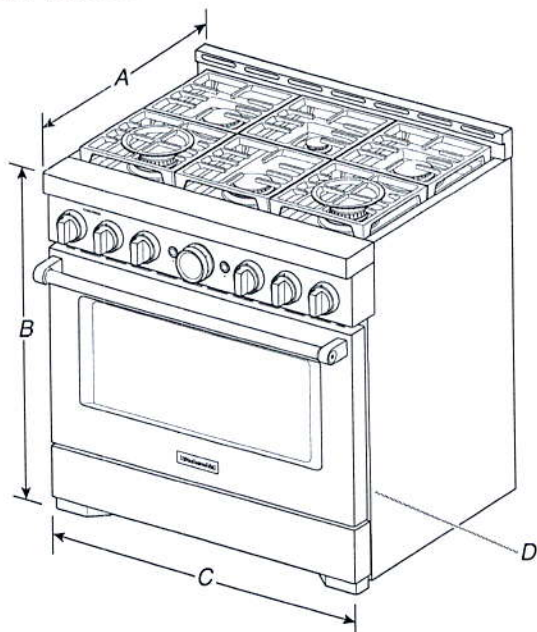

- A. 27³/₄" (70.5 cm) depth with control panel (See NOTE.)
- B. 36" (91.4 cm) range height when sitting on the wheels
- C. 35⁷/₈" (91.1 cm) width
- D. Model/serial/rating plate location/SAID label (located on front side panel)

48" (121.9 cm) models

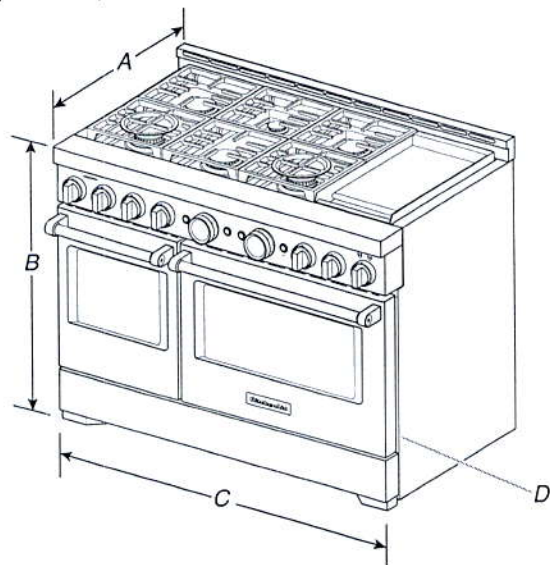

- A. 27³/₄" (70.5 cm) depth with control panel (See NOTE.)
- B. 36" (91.4 cm) range height when sitting on the wheels
- C. 47⁷/₈" (121.6 cm) width
- D. Model/serial/rating plate location/SAID label (located on front side panel)

NOTE: When installed in a 24" (61.0 cm) base cabinet with 25" (63.5 cm) countertop; front of oven door protrudes 3" (7.6 cm) beyond 24" (61.0 cm) base cabinet.

Cabinet Requirements

Cabinet opening dimensions shown are for 25" (64.0 cm) countertop depth, 24" (61.0 cm) base cabinet depth, and 36" (91.4 cm) countertop height. Dimensions must be met in order to ensure a flush fit to back wall.

IMPORTANT: If installing a range hood, hood liner, or microwave hood combination above the cooking surface, follow the range hood or microwave hood combination installation instructions for dimensional clearances above the cooking surface.

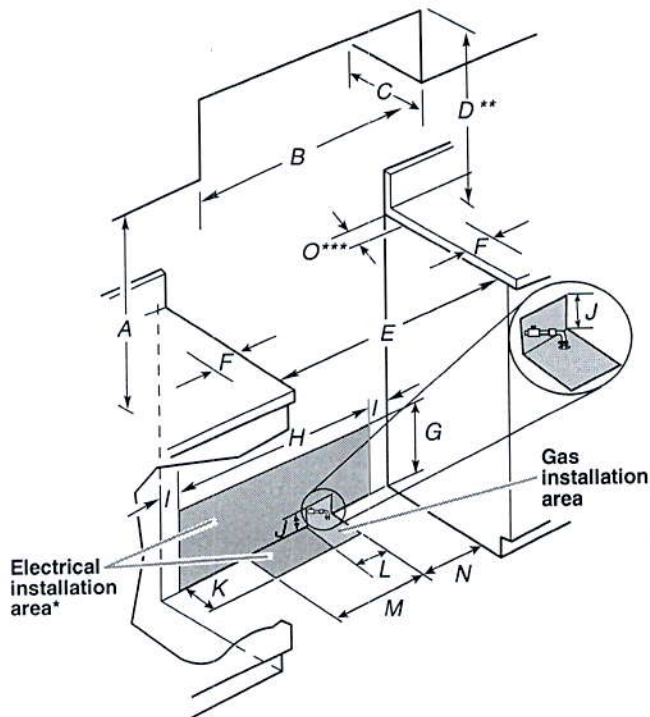

- A. 18" (45.7 cm) upper cabinet to countertop
- B. 30" (76.2 cm) model: 30" (76.2 cm) min. upper cabinet width
36" (91.4 cm) model: 36" (91.4 cm) min. upper cabinet width
48" (121.9 cm) model: 48" (121.9 cm) min. upper cabinet width
- C. 13" (33 cm) max. upper cabinet depth
- D. For minimum clearance to top of range.**
- E. 30" (76.2 cm) on 30" (76.2 cm) models
36" (91.4 cm) on 36" (91.4 cm) models
48" (121.9 cm) on 48" (121.9 cm) models
- F. 12" (30.4 cm) min. clearance from both sides of range to side wall or other combustible material
- G. 15" (38.1 cm)
- H. 22" (55.9 cm) on 30" (76.2 cm) models
28" (71.1 cm) on 36" (91.4 cm) models
40" (101.6 cm) on 48" (121.9 cm) models
- I. 4" (10.1 cm)
- J. 3" (7.6 cm)
- K. 5" (12.7 cm)
- L. 3" (7.6 cm) on 30" (76.2 cm) models
11" (27.9 cm) on 36" (91.4 cm) models
21" (53.3 cm) on 48" (121.9 cm) models
- M. 7¹/₂" (19.0 cm)
- N. 9" (22.9 cm)
- O. 6" (15.2 cm)***

** If not using ventilation, Minimum Clearances

30" (76.2 cm) models: 42" (106.7 cm) minimum clearance between the top of the cooking platform and the bottom of a combustible surface

36" (91.4 cm) models: 58" (147.3 cm) minimum clearance between the top of the cooking platform and the bottom of a combustible surface

48" (121.9 cm) models: 58" (147.3 cm) minimum clearance between the top of the cooking platform and the bottom of a combustible surface

***If the surface of the back wall is constructed of a combustible material and a backguard is not installed, a 6" (15.2 cm) minimum clearance is required for all models.

Electrical Requirements

⚠ WARNING



Electrical Shock Hazard

Plug into a grounded 3 prong outlet.

Do not remove ground prong.

Do not use an adapter.

Do not use an extension cord.

Failure to follow these instructions can result in death, fire, or electrical shock.

IMPORTANT: The range must be electrically grounded in accordance with local codes and ordinances or, in the absence of local codes, with the National Electrical Code, ANSI/NFPA 70 or Canadian Electrical Code, CSA C22.1.

If codes permit and a separate ground wire is used, it is recommended that a qualified electrical installer determine that the ground path is adequate.

A copy of the above code standards can be obtained from:

National Fire Protection Association
1 Batterymarch Park
Quincy, MA 02169-7471

CSA International
8501 East Pleasant Valley Road
Cleveland, Ohio 44131-5575

- A 120 V, 60 Hz, AC only, 15 A, fused electrical circuit is required. A time-delay fuse or circuit breaker is also recommended. It is recommended that a separate circuit serving only this range be provided.
- Electronic ignition systems operate within wide voltage limits, but proper grounding and polarity are necessary. Check that the outlet provides 120 V power and is correctly grounded.
- The wiring diagram is located behind the kick plate in a clear plastic bag.

Gas Supply Requirements

⚠ WARNING



Explosion Hazard

Use a new CSA International approved gas supply line.

Install a shut-off valve.

Securely tighten all gas connections.

If connected to propane, have a qualified person make sure gas pressure does not exceed 14" (36 cm) water column.

Examples of a qualified person include:

licensed heating personnel,
authorized gas company personnel, and
authorized service personnel.

Failure to do so can result in death, explosion, or fire.

Observe all governing codes and ordinances.

IMPORTANT: This installation must conform with all local codes and ordinances. In the absence of local codes, installation must conform with American National Standard, National Fuel Gas Code ANSI Z223.1 — latest edition — or CAN/CGA B149 — latest edition.

IMPORTANT: Range must be connected to a regulated gas supply.

IMPORTANT: Leak testing of the range must be conducted according to the manufacturer's instructions.

KRFC302ESS

22 cu. ft. 36-Inch Width Counter Depth French Door Refrigerator with Interior Dispense

KitchenAid®

<http://www.kitchenaid.com>



Key Features:

- ExtendFresh™ Temperature Management System
- Interior Water Dispenser
- Produce Preserver
- Humidity-Controlled Crispers
- FreshChill™ Temperature-Controlled Full-Width Pantry
- Pull-Out Tri-Level Freezer Drawer
- SatinGlide® System
- LED Lighting
- Star-K Certified
- Automatic Ice Maker
- Max Cool
- Metallic Accents on Shelf Trim

Product Dimensions:

Height: 72

Width: 35 3/4

Depth: 30 1/4

Electrical Requirements:

15.

Additional Information:

[Use And Care Guide](#)

[Dimension Guide](#)

[Energy Guide](#)

[Warranty Certificate](#)

Available in:

Black Stainless

● Stainless Steel

INVESTED
IN
AMERICA

©Registered trademark/TM Trademark of Whirlpool, U.S.A. © 2016 Whirlpool Corporation. All Rights Reserved.
All other trademarks are owned by their respective companies.
Because Whirlpool Corporation policy includes a continuous commitment to improve our products, we reserve the right to change materials and specifications without notice. We also reserve the right to discontinue or transition products without notice.
Manufacturer's Suggested Retail Price (MSRP) and Minimum Advertised Price (MAP) provided for reference purposes only. Dealer alone determines advertised and retail prices.
Created On: Monday, March 06, 2017 19:12:25

Bottom Mount Refrigerator

PRODUCT MODEL NUMBERS

KRFC302E

Electrical: A 115 volt, 60 Hz, AC only 15- or 20-amp fused, grounded electrical supply is required. It is recommended that a separate circuit serving only your refrigerator and approved accessories be provided. Use an outlet that cannot be turned off by a switch. Do not use an extension cord.

Water: A cold water supply with water pressure of between 35 and 120 psi (241 and 827 kPa) is required to operate the water dispenser and ice maker. If you have questions about your water pressure, call a licensed, qualified plumber.

Reverse Osmosis Water Supply:
IMPORTANT: The pressure of the water supply coming out of a reverse osmosis system going to the water inlet valve of the refrigerator needs to be between 35 and 120 psi (241 and 827 kPa).

PRODUCT DIMENSIONS

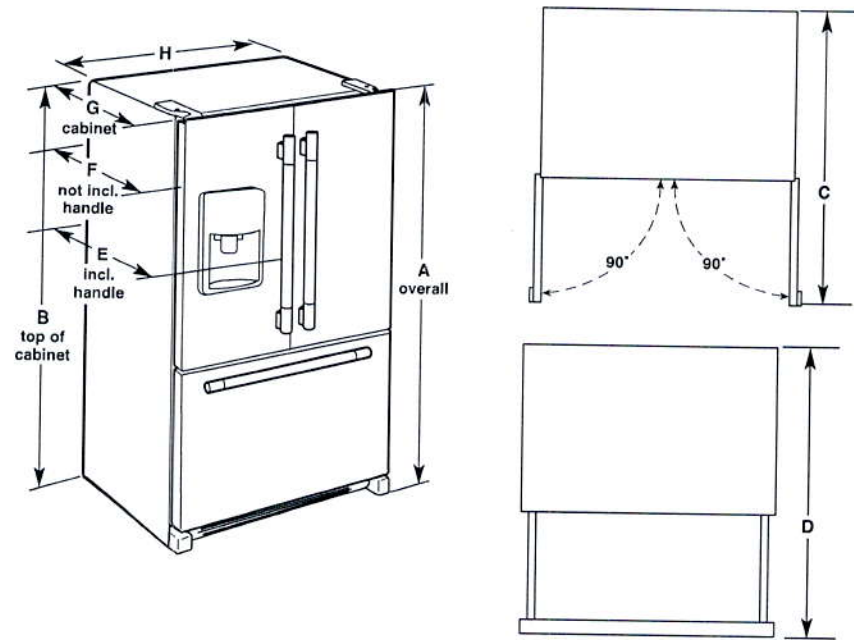

Model Size	Height - Overall "A"	Height - Top of Cabinet "B"	Depth - Doors Open 90° "C"	Depth - Drawer Open "D"	Depth - With Handles "E"	Depth - Without Handles "F"	Depth - Cabinet Only "G"	Width - Cabinet "H"
21.9	72" (182.9 cm)	71 ¹¹ / ₁₆ " (181.3 cm)	44 ¹ / ₈ " (112.1 cm)	45 ¹ / ₄ " (114.9 cm)	30 ¹ / ₄ " (76.8 cm)	27 ³ / ₄ " (70.5 cm)	24 ⁵ / ₈ " (62.5 cm)	35 ³ / ₄ " (90.8 cm)

LOCATION REQUIREMENTS

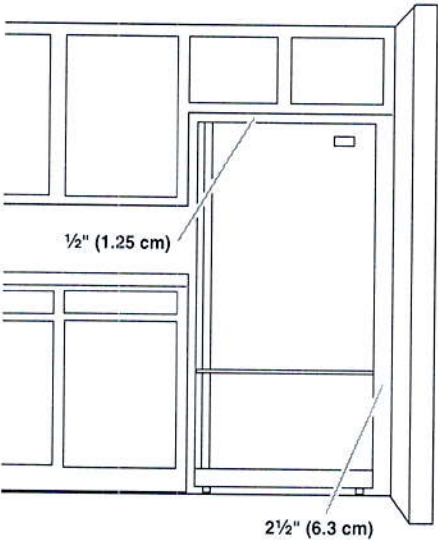

IMPORTANT: This refrigerator is designed for indoor, household use only.

To ensure proper ventilation for your refrigerator, allow for 1/2" (1.25 cm) of space on each side and at the top. Allow for 1" (2.54 cm) of space behind the refrigerator. If your refrigerator has an ice maker, allow extra space at the back for the water line connections. When installing your refrigerator next to a fixed wall, leave 2 1/2" (6.3 cm) minimum on the hinge side (some models require more) to allow for the door to swing open.

NOTE: This refrigerator is intended for use in a location where the temperature ranges from a minimum of 55°F (13°C) to a maximum of 110°F (43°C). The preferred room temperature range for optimum performance, which reduces electricity usage and provides superior cooling, is between 60°F (15°C) and 90°F (32°C). It is recommended that you do not install the refrigerator near a heat source, such as an oven or radiator.

KMCC5015GSS

KitchenAid®

21 3/4" Countertop Convection Microwave Oven – 1000 Watt

<http://www.kitchenaid.com>

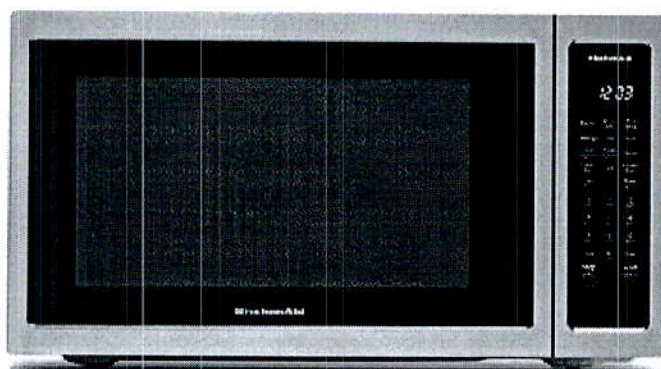

Key Features:

- 1400-Watt Convection Element
- Roast Function
- Grill Function
- 6 Quick-Touch Cycles Including Five Sensor Cycles
- 13 1/2" Recessed Turntable
- 1.5 Cu. Ft. Capacity
- Accepts 30- or 27-Inch Trim Kit
- Electronic Controls with LED Display
- Color-Coordinated Stainless Steel Cabinet

Product Dimensions:

Height: 12 1/2

Width: 21 3/4

Depth: 20 1/2

Additional Information:

[Use And Care Guide](#)

[Dimension Guide](#)

[Warranty Certificate](#)

Available in:

● Stainless Steel

®Registered trademark/TM Trademark of Whirlpool, U.S.A. © 2016 Whirlpool Corporation. All Rights Reserved.
All other trademarks are owned by their respective companies.
Because Whirlpool Corporation policy includes a continuous commitment to improve our products, we reserve the right to change materials and specifications without notice. We also reserve the right to discontinue or transition products without notice.
Manufacturer's Suggested Retail Price (MSRP) and Minimum Advertised Price (MAP) provided for reference purposes only. Dealer alone determines advertised and retail prices.
Created On: Sunday, July 16, 2017 07:06:27

KitchenAid Countertop Microwave Use and Care Guide

PRODUCT MODEL NUMBERS

KMCC5015G

LOCATION REQUIREMENTS

IMPORTANT: The control side of the microwave oven is the heavy side. Handle the microwave oven gently. The weight of the microwave oven is over 35 lbs (15.9 kg).

- Place the microwave oven on a cart, counter, table, or shelf that is strong enough to hold the microwave oven and the food and utensils you place inside it.
- The microwave oven should be at a temperature above 50°F (10°C) for proper operation.

NOTE: Some models can be built into a wall or cabinet by using one of the trim kits listed in the "Assistance or Service" section.

- Do not block the exhaust vents or air intake openings. Allow a few inches of space at the back and side of the microwave oven where the exhaust vents are located. Blocking the exhaust vents could cause damage to the microwave oven as well as poor cooking results.
- Make sure the microwave oven legs are in place to ensure proper airflow. If vents are blocked, a sensitive thermal device may automatically turn the microwave oven off. The microwave oven should work properly once it has cooled.

ELECTRICAL REQUIREMENTS

Observe all governing codes and ordinances.

Required:

- A 120-volt, 60 Hz, AC-only, 15- or 20-amp electrical supply with a fuse or circuit breaker.

Recommended:

- A time-delay fuse or time-delay circuit breaker
- A separate circuit serving only this microwave oven

OVERALL DIMENSIONS

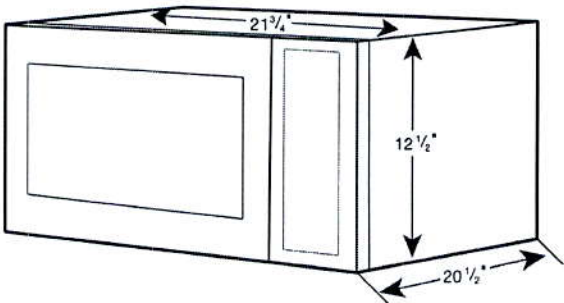



G 5006 SCU
24" Pre-Finished Dishwasher

- Features:
- DirectSelect Controls
 - Integrated Handle
 - QuickIntenseWash - 58 min. program
 - Whisper quiet 44 dB
 - Original Cutlery Tray
 - ExtraClean & ExtraDry Options to customize wash programs
 - Delayed Start
 - SaniWash - Sanitize cycle
 - EnergyStar

MATERIAL #	EAN #
11636690	4002516376507

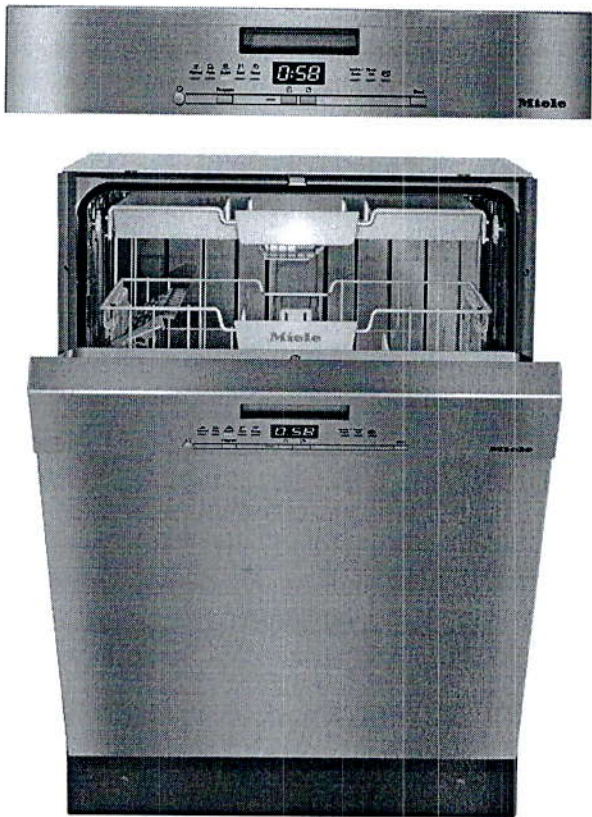

SPECIFICATIONS	
Overall Unit Dimensions	23 ⁹ / ₁₆ " (598 mm) W x 33 ¹ / ₁₆ " - 36 ¹ / ₄ " (855 - 920 mm) H x 22 ⁷ / ₁₆ " (570 mm) D [Depth does not include door panel]
Niche	
Minimum Cabinet Niche Opening	23 ⁹ / ₁₆ " (600 mm) W x 33 ³ / ₄ " (857 mm) H x 22 ⁷ / ₁₆ " (570 mm) D
Plumbing	
Water Supply Requirements	<ul style="list-style-type: none">• Cold or Hot (max 150°F/65°C) water connection• Male 3/8" compression fitting• Water pressure range 7.25 psi (0.5 bar) and 145 psi (10 bar)
Water Connection Line (Supplied)	Length: 5 ft (1.5 m) Female 3/8" compression.
Drain Hose (Supplied)	Length: 5 ft (1.5 m) 7/8" (22 mm) internal diameter
Electrical	
Electrical Requirements	110V / 120V, 60Hz, 15 Amps
Power Cord (Convertible to hardwire)	NEMA 5-15 plug, 5 ft (1.52 m)
Shipping	
Shipping Weight	121 lbs (55 kg)
Shipping Dimensions	27 ¹ / ₈ " W x 38 ¹ / ₈ " H x 26 ³ / ₈ " D

PRODUCT DIMENSIONS

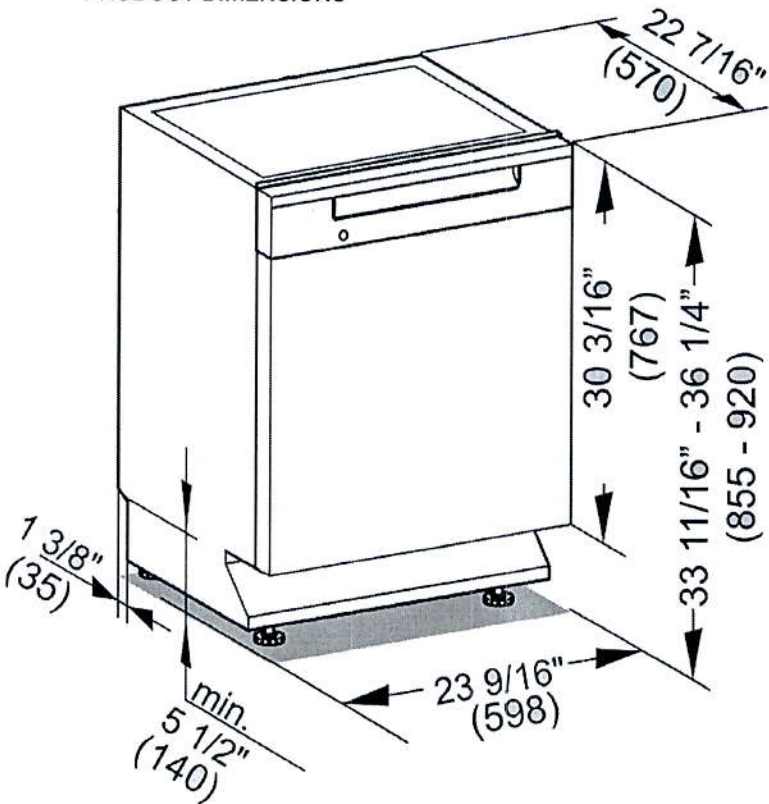

Miele

CUTOUT DIMENSIONS

