

CONSTRUCTION SUMMARY

Mountainview Heights 3 (G) - Russell Gardens Building Ltd.

PURCHASER: ADIL S WAIN

TEL: RES.: 905-333-6202 BUS.: 905-616-8486

LOT / PHASE	REG. PLAN #	HOUSE TYPE		
598 / 4	62M-1266	Grandville Three Elev 2		

CABINETRY

1 - VANITY - ENSUITE - UPGRADE 1 26Oct21 Note:	
1 - CABINETRY PROVISION - PROVISION FOR PLUG ON ISLAND (PLUG EXTRA ORDERED SEPARATELY) 26Oct21 Note:	

CABINETRY ACCESSORIES

1 - CABINETRY FEE FOR FLUSH CUTOUT ON WALL OVEN/MICROWAVE COMBO CABINET ONLY 26Oct21 Note:	
1 - KITCHEN CABINETRY - BUILT-IN FRIDGE CABINET - PRICE IS EACH 26Oct21 Note:	
1 - KITCHEN CABINETRY UPPER - FULL DEPTH ABOVE FRIDGE - WITH GABLES - 600MM - PRICE IS EACH - STANDARD 26Oct21 Note:	
1 - KITCHEN CABINETRY - BUILT-IN MICROWAVE/OVEN COMBO - STANDARD 26Oct21 Note:	
1 - KITCHEN CABINETRY BASE - COOKTOP CABINET WITH POT DRAWERS (2 DRAWERS) - STANDARD 26Oct21 Note:	

CERAMIC TILE

1 - TILE - UPGRADE 4 FLOOR TILE - - ENSUITE BATHROOM - SHOWER 26Oct21 Note:	
1 - TILE - UPGRADE 4 FLOOR TILE - - ENSUITE BATHROOM - FLOOR 26Oct21 Note:	
1 - TILE - UPGRADE 1 FLOOR TILE - - BATHROOM 5 - SHOWER 26Oct21 Note:	
1 - TILE - UPGRADE 1 FLOOR TILE - - BATHROOM 5 - FLOOR 26Oct21 Note:	
1 - TILE - UPGRADE 1 FLOOR TILE - - BATHROOM 3/4 - SHOWER 26Oct21 Note:	
1 - TILE - UPGRADE 1 FLOOR TILE - - BATHROOM 3/4 - FLOOR 26Oct21 Note:	
1 - TILE - UPGRADE 6 FLOOR TILE - - POWDER ROOM 26Oct21 Note:	
1 - TILE - UPGRADE 6 FLOOR TILE - - FOYER 26Oct21 Note:	

CONSTRUCTION

1 - MASTER ENSUITE BATHROOM - DELETE WALL AND DOOR BETWEEN VANITY AND TOILET ONLY - SEE SKETCH 04Nov21 Note:	
---	--



CONSTRUCTION SUMMARY

Mountainview Heights 3 (G) - Russell Gardens Building Ltd.

PURCHASER: ADIL S WAIN

TEL: RES.: 905-333-6202 BUS.: 905-616-8486

LOT / PHASE	REG. PLAN #	HOUSE TYPE		
598 / 4	62M-1266	Grandville Three Elev 2		
4 - ENLARGE BASEMENT WINDOWS (MAY REQUIRE WINDOW WELLS) - WINDOW IS 30 INCHES X 24 INCHES 26Oct21 Note:				
1 - SMOOTH CEILINGS ON FIRST FLOOR ONLY - DET 26Oct21 Note:				

COUNTER TOP

1 - KITCHEN COUNTER TOP - QUARTZ - IN LIEU OF STANDARD AS PER OFFER 26Oct21 Note:	
1 - ENSUITE BATHROOM VANITY COUNTER TOP 26Oct21 Note:	

DOORS AND TRIM

1 - TRIM - UPGRADE 2- 7-¼" BASEBOARD AND 3" CASING 26Oct21 Note:	
---	--

ELECTICAL

1 - PLUG – ROUGH-IN FOR ELECTRIC CAR PLUG IN GARAGE – FOR FUTURE ELECTRIC CAR – 240V / 40-50 AMPS 26Oct21 Note: SPECIFICATIONS REQUIRED	
--	--

ELECTRICAL

1 - BUILT IN OVEN AND COOKTOP PROVISION - PROVISION ONLY - ELECTRICAL ONLY 26Oct21 Note:	
1 - PLUG - ELECTRICAL PLUG - ADD TO ISLAND 26Oct21 Note:	
1 - RELOCATE STANDARD KITCHEN LIGHT TO BE CENTERED OVER ISLAND 26Oct21 Note:	
1 - POT LIGHT - LED - FIRST FLOOR INSTALLATION - INSTALLED ON SEPERATE SWITCH FROM STANDARD LIGHT - KITCHEN WORKSPACE 26Oct21 Note:	
1 - POT LIGHT - LED - FIRST FLOOR INSTALLATION - INSTALLED ON SEPERATE SWITCH FROM STANDARD LIGHT - KITCHEN BREAKFAST 26Oct21 Note:	
1 - POT LIGHT - LED - FIRST FLOOR INSTALLATION - INSTALLED ON SEPERATE SWITCH FROM STANDARD LIGHT - FAMILY ROOM 26Oct21 Note:	
1 - POT LIGHT - LED - FIRST FLOOR INSTALLATION - INSTALLED ON SEPERATE SWITCH FROM STANDARD LIGHT - LIVING ROOM 26Oct21 Note:	
1 - LIGHT AND SWITCH - NO FIXTURE INCLUDED - LIVING ROOM 26Oct21 Note:	
1 - 200 AMP ELECTRICAL SERVICE 26Oct21 Note:	

FIREPLACE AND ACCESSORIES



CONSTRUCTION SUMMARY

Mountainview Heights 3 (G) - Russell Gardens Building Ltd.

PURCHASER: ADIL S WAIN

TEL: RES.: 905-333-6202 BUS.: 905-616-8486

LOT / PHASE 598 / 4	REG. PLAN # 62M-1266	HOUSE TYPE Grandville Three Elev 2		
------------------------	-------------------------	---------------------------------------	--	--

1 - GAS LINE ROUGH-IN FOR STOVE (INCLUDES ELECTRICAL OUTLET) - FIRST FLOOR

26Oct21 Note:

HARDWOOD FLOORING

1 - LAMINATE – UPGRADE TO FJORD SERIES IN LIEU OF STANDARD LAMINATE 26Oct21 Note:	
1 - HARDWOOD - GROUP C SERIES 5 INCH - IN LIEU OF STANDARD TILE - KITCHEN / BREAKFAST 26Oct21 Note:	
1 - HARDWOOD - GROUP C SERIES 5 INCH - IN LIEU OF 2 1/4 INCH NATURAL RED OAK - - MAIN HALL 26Oct21 Note:	
1 - HARDWOOD - GROUP C SERIES 5 INCH - IN LIEU OF 2 1/4 INCH NATURAL RED OAK - - LIVING ROOM 26Oct21 Note:	
1 - HARDWOOD - GROUP C SERIES 5 INCH - IN LIEU OF 2 1/4 INCH NATURAL RED OAK - - GUEST SUITE 26Oct21 Note:	
1 - HARDWOOD - GROUP C SERIES 5 INCH - IN LIEU OF 2 1/4 INCH NATURAL RED OAK - - LIBRARY/DEN 26Oct21 Note:	
1 - HARDWOOD - GROUP C SERIES 5 INCH - IN LIEU OF 2 1/4 INCH NATURAL RED OAK - - FAMILY ROOM 26Oct21 Note:	
1 - HARDWOOD - GROUP C SERIES 5 INCH - IN LIEU OF 2 1/4 INCH NATURAL RED OAK - - DINING ROOM 26Oct21 Note:	

MIRRORS AND GLASS

1 - POWDER ROOM, GUEST ENSUITE & MASTER ENSUITE BATHROOMS - DELETE STANDARD MIRRORS - DO NOT INSTALL 26Oct21 Note:	
---	--

PLUMBING

1 - SINK - UNDERMOUNT SINK - BLANCO QUATRUS R15 U SUPER SINGLE #401518 26Oct21 Note:	
2 - SINK - UNDERMOUNT SINK - CONTRAC COLLETTE #4220CIY - MASTER ENSUITE BATHROOM 26Oct21 Note:	
2 - TOE TESTER - ADD TOE TESTER TO SHOWER - MASTER ENSUITE & GUEST ENSUITE BATHROOMS 26Oct21 Note:	
1 - HOT WATER VALVE NEXT TO TOILET - MASTER ENSUITE BATHROOM 26Oct21 Note:	
1 - WATER LINE FOR FRIDGE - ROUGH-IN ONLY 26Oct21 Note:	
1 - 5 FOOT SHOWER WITH SLIDING GLASS CHROME DOORS IN LIEU OF TUB - GUEST ENSUITE BATHROOM 26Oct21 Note:	

PROMOTIONAL



CONSTRUCTION SUMMARY

Mountainview Heights 3 (G) - Russell Gardens Building Ltd.

PURCHASER: ADIL S WAIN

TEL: RES.: 905-333-6202 BUS.: 905-616-8486

LOT / PHASE 598 / 4	REG. PLAN # 62M-1266	HOUSE TYPE Grandville Three Elev 2		
------------------------	-------------------------	---------------------------------------	--	--

1 - LESS CREDIT FROM PURCHASER EXTRA SHEET IN OFFER
26Oct21 Note:

STAIRS AND RAILINGS

1 - STAIRCASE - V GROOVE HANDRAIL 26Oct21 Note:	
1 - STAIRCASE - EUROLINE 1 IRON PICKETS - BLACK 26Oct21 Note:	
1 - STAINED STAIRS - STANDARD STAIRCASE - PRICE IS PER SET 26Oct21 Note:	

EXTRAS AS PER OFFER

Granite kitchen counter top, from Vendor?s standard samples Worksheet Note:	
PURCHASER(S) ACKNOWLEDGES THAT THE PURCHASE PRICE IS INCLUSIVE OF ALL CREDITS AND PROMOTIONAL PACKAGES AVAILABLE AT TIME OF PURCHASE. Worksheet Note:	
(1) The Vendor agrees that notwithstanding any other term or provision in this Agreement included in the Purchase Price and in addition to those items detailed in Schedule GP to the Agreement of Purchase and Sale, the Purchaser is entitled to a credit of Worksheet Note:	
10 foot ceiling height on Main Floor. The Purchaser acknowledges that as a result of the increased ceiling height from the Vendor?s standard ceiling height, various modifications to the interior and exterior of the dwelling unit may be made, including bu Worksheet Note:	

This Document is Extremely Time Sensitive - Printed 4 Nov 21 at 14:49

Purchaser:ADIL S WAIN

Telephone Res. / Bus: (905) 333-6202 / (905) 616-8486

Decor Advisor: Candace Forza

Lock Date: 26-Oct-21

Property: 598

Project: Russell Gardens Building Ltd.

Model and Elevation: Grandville Three Elev 2

26-Oct-21

Plan #: 62M-1266

Layout Changes: ☒ Yes ☐ No

Sketch Attached: ☒ Yes ☐ No

Exterior Colour Scheme:

1. Cabinetry

	Style and Colour	Hardware
Kitchen / Breakfast	EVEREST	431SA
Laundry Room	ELISSE	Standard
Powder Room	SABRA 1048 FLAX	431SA
Master Ensuite Bathroom	SHAKER 350 PLATINUM SILVER	431SA
Ensuite Bath - Bedroom 2	DORAL W-500	431SA
Ensuite Bath - Bedroom 3/4	MONACO 350 PLATINUM SILVER	431SA
Ensuite Bath - Bedroom 5	DORAL W-500	447SA
GUEST ENSUITE BATH	SABRA 1048 FLAX	431SA
	N/A	N/A

Appliances:

Built In Appliances ☒ Yes ☐ No

Slide In Stove ☐ Yes ☒ No

Dishwasher Cabinet ☐ Closed ☒ Open

41" Upper Cabinets ☒ Yes ☐ No

Please NOTE: Standard Cabinet Height is 30"

Stove Opening

NOTE: If not specified, opening will be set to builder's standard opening of approximately 30" width

Fridge Opening

NOTE: If not specified, opening will be set to builder's standard opening of approximately 37" width x 74" height

** Refer to Construction Summary

2. Counters

	Counter	Edge
Kitchen / Breakfast	QUARTZ-MISTRAL	#360
Laundry Room	N/A	
Powder Room	LAMINATE-WHITE CARRARA 4924-38	
Master Ensuite Bathroom	QUARTZ-VERMONT	#360
Ensuite Bath - Bedroom 2	LAMINATE-CARRARA BIANCO 6696-46	
Ensuite Bath - Bedroom 3/4	LAMINATE-PALOMA POLAR 6698-46	
Ensuite Bath - Bedroom 5	LAMINATE-CARRARA BIANCO 6696-46	
GUEST ENSUITE BATH	LAMINATE-WHITE CARRARA 4924-38	
	N/A	

** Refer to Construction Summary

Initial:

Page 1 of 4

Printed 10/26/2021 16:42:50

Purchaser:

ADIL S WAIN

Telephone Res. / Bus:

(905) 333-6202 / (905) 616-8486

Decor Advisor:

Candace Forza

Lock Date:

26-Oct-21

Property:

598

Project:

Russell Gardens Building Ltd.

Model and Elevation:

Grandville Three Elev 2

Plan #:

62M-1266

3. Ceramic Flooring

Entrance Vestibule

TILE-PURITY CALACATTA LUX-24X24

☐

metal strip where applicable

Main Hall

STRIP

☐

Kitchen / Breakfast

STRIP

☐

Laundry Room

TILE-ESSENZE GRIGIO-13X13

☐

Powder Room

TILE-PURITY CALACATTA LUX-24X24

☐

Master Ensuite Bathroom

TILE-VARENNA CARRARA-24X24

☐

Ensuite Bath - Bedroom 2

TILE-ESSENZE GRIGIO-13X13

☐

Ensuite Bath - Bedroom 3/4

TILE-MARMORE CARRARA-12X24

☐

Ensuite Bath - Bedroom 5

TILE-LIFE FOG-12X24

☐

GUEST ENSUITE BATH

TILE-BEACH IVORY-13X13

☐

mudroom

TILE-BEACH IVORY-13X13

☐

** Refer to Construction Summary

4. Ceramic Wall Tile

Master Ensuite Bathroom

Selection

Describe

Tub Deck Wall

N/A

Tub Deck

N/A

Tub Deck Skirt

N/A

Shower Stall

TILE-VARENNA CARRARA-12X24

Bathtub Enclosure Walls

N/A

Ensuite Bath - Bedroom 2

TILE-EXTRA WHITE/GREY-8X16

Ensuite Bath - Bedroom 3/4

TILE-MARMORE CARRARA-12X24

Ensuite Bath - Bedroom 5

TILE-LIFE ICE-12X24

GUEST ENSUITE BATH

TILE-EXTRA WHITE/BEIGE-8X16

mudroom

N/A

Kitchen Backsplash

N/A

** Refer to Construction Summary - STANDARD GROUT THROUGHOUT UNLESS SPECIFIED

5. Plumbing Fixtures

All Bathrooms

White

N/A

N/A

N/A

N/A

N/A

Whirlpool

N/A

☐ Yes

☒ No

Dishwasher Rough-In

☒ Yes

☐ No

Waterline for Fridge

☒ Yes

☐ No

** Refer to Construction Summary

6. Trim Carpentry

Interior Doors

CARRARA-SMOOTH

Interior Trim

3" BB CASING WITH 7 1/4" BASEBOARD - COLONIAL

Door Handles

As Per Construction Specifications

Exterior Front Door Handle

As Per Construction Specifications

** Refer to Construction Summary

7. Other Flooring

Printed 10/26/2021 16:42:50

Initial:



Page 2 of 4

Purchaser: ADIL S WAIN

Property: 598

Telephone Res. / Bus: (905) 333-6202 / (905) 616-8486

Project: Russell Gardens Building Ltd.

Decor Advisor: Candace Forza

Model and Elevation: Grandville Three Elev 2

Lock Date: 26-Oct-21

26-Oct-21

Plan #: 62M-1266

7. Other Flooring

Main Hall & Side Hall	STRIP-VINTAGE-NORTHERN SOLID SAWN-SCULPTED-CHARACTER-UVF-RED OAK-PEWTER-5"	
Living Room	STRIP-VINTAGE-NORTHERN SOLID SAWN-SCULPTED-CHARACTER-UVF-RED OAK-PEWTER-5"	
Dining Room	STRIP-VINTAGE-NORTHERN SOLID SAWN-SCULPTED-CHARACTER-UVF-RED OAK-PEWTER-5"	
Family Room	STRIP-VINTAGE-NORTHERN SOLID SAWN-SCULPTED-CHARACTER-UVF-RED OAK-PEWTER-5"	
Den / Library / Study	STRIP-VINTAGE-NORTHERN SOLID SAWN-SCULPTED-CHARACTER-UVF-RED OAK-PEWTER-5"	
Basement Landing(If Applies)	N/A	
Lower Landing (If Applies)	STRIP-VINTAGE-NORTHERN SOLID SAWN-SCULPTED-CHARACTER-UVF-RED OAK-PEWTER-5"	
Upper Landing	STRIP-VINTAGE-NORTHERN SOLID SAWN-SCULPTED-CHARACTER-UVF-RED OAK-PEWTER-5"	
Upper Hall	LAMINATE-FJORD-ASTRID OAK-TL-NEUM06	
Master Bedroom	LAMINATE-FJORD-ASTRID OAK-TL-NEUM06	
Bedroom #2	LAMINATE-FJORD-ASTRID OAK-TL-NEUM06	
Bedroom #3	LAMINATE-FJORD-ASTRID OAK-TL-NEUM06	
Bedroom #4	LAMINATE-FJORD-ASTRID OAK-TL-NEUM06	
Bedroom #5	LAMINATE-FJORD-ASTRID OAK-TL-NEUM06	
FLEX ROOM	LAMINATE-FJORD-ASTRID OAK-TL-NEUM06	
KITCHEN / BREAKFAST	STRIP-VINTAGE-NORTHERN SOLID SAWN-SCULPTED-CHARACTER-UVF-RED OAK-PEWTER-5"	
GUEST SUITE	STRIP-VINTAGE-NORTHERN SOLID SAWN-SCULPTED-CHARACTER-UVF-RED OAK-PEWTER-5"	
Underpad	Type	Area
	N/A	N/A

** Refer to Construction Summary

8. Railings and Pickets

Railing Type	V-GROOVE	Complimenting Colour	VINTAGE PEWTER RED OAK
Picket Type	EUROLINE 1	Complimenting Colour	BLACK
Stringer / Riser	AS PER CONSTRUCTION SPECIFICATIO	Complimenting Colour	VINTAGE PEWTER RED OAK
Treads	AS PER CONSTRUCTION SPECIFICATIO	Complimenting Colour	VINTAGE PEWTER RED OAK
Red Oak Stairs	<input checked="" type="radio"/> Yes <input type="radio"/> No		

** Refer to Construction Summary THE STAIN COLOURS OR FINISH AVAILABLE ON RISERS, TREADS, PICKETS AND RAILS (STAIRCASES), WILL NOT BE AN EXACT MATCH TO PREFINISHED HARDWOOD OR LAMINATE FLOORS.

9. Wall Paint Flat Finish

Main & Upper Hall	43 BIRCH WHITE	Master Bedroom	43 BIRCH WHITE
Living Room	43 BIRCH WHITE	Bedroom #2	43 BIRCH WHITE
Dining Room	43 BIRCH WHITE	Bedroom #3	43 BIRCH WHITE
Kitchen / Breakfast	43 BIRCH WHITE	Bedroom #4	43 BIRCH WHITE
Family Room	43 BIRCH WHITE	Bedroom #5	43 BIRCH WHITE
Powder Room	43 BIRCH WHITE	Master Ensuite	43 BIRCH WHITE
Laundry Room	43 BIRCH WHITE	Ensuite Bath - Bedroom 2	43 BIRCH WHITE
Den/Library	43 BIRCH WHITE	Ensuite Bath - Bedroom 3/4	43 BIRCH WHITE
Trim & Door Paint-Semi Gloss		Ensuite Bath - Bed 5	43 BIRCH WHITE
Flex Room	43 BIRCH WHITE	Guest Ensuite Bath	43 BIRCH WHITE
	N/A	Guest Suite	43 BIRCH WHITE
Smooth Ceilings First Floor	<input checked="" type="radio"/> Yes <input type="radio"/> No		

** Refer to Construction Summary

Initial: 

Purchaser: ADIL S WAIN

Property: 598

Telephone Res. / Bus: (905) 333-6202 / (905) 616-8486

Project: Russell Gardens Building Ltd.

Decor Advisor: Candace Forza

Model and Elevation: Grandville Three Elev 2

Lock Date: 26-Oct-21

26-Oct-21

Plan #: 62M-1266

10. Plaster Mouldings and Medallions

Entrance Vestibule	N/A	N/A	Kitchen/Breakfast	N/A	N/A
Main Hall	N/A	N/A	Den/Library	N/A	N/A
Living Room	N/A	N/A	Lower Landing	N/A	N/A
Dining Room	N/A	N/A		N/A	N/A
Family Room	N/A	N/A			

** Refer to Construction Summary

11. Fireplace

	Living Room			Family Room			Other Room - Specify		
	Purchased	As Per Plan	N/A	Purchased	As Per Plan	N/A	Purchased	As Per Plan	N/A
	<input type="radio"/>	<input type="radio"/>	<input checked="" type="radio"/>	<input type="radio"/>	<input checked="" type="radio"/>	<input type="radio"/>	<input type="radio"/>	<input type="radio"/>	<input checked="" type="radio"/>
Fireplace Type	N/A			FLAT ON WALL			N/A		
Mantle Type	N/A			MANTLE M1-STANDARD			N/A		
Colour / Stain	N/A			AS PER CONSTRUCTION SPECIFICATIONS			N/A		
Surround	N/A			GRIGIO CARNICO			N/A		
Hearth	N/A			NO			N/A		

** Refer to Construction Summary

12. Heating and Air Conditioning

Air Conditioning	NO	Gas Provisions Stove	YES
Gas Provisions Dryer	NO	Gas Provisions Barbecue	NO
Comment			

** Refer to Construction Summary

13. Electrical

Plugs and Switches	<input checked="" type="radio"/> White	DECOR	Above Kitchen Cabinet Light	<input type="radio"/> Yes	<input checked="" type="radio"/> No
Hood Fan	STANDARD WHITE		Below Kitchen Cabinet Light	<input type="radio"/> Yes	<input checked="" type="radio"/> No
Appliances	Built in Cooktop	Built in Oven	Gas Stove	Microwave	
	<input checked="" type="radio"/> Yes <input type="radio"/> No	<input checked="" type="radio"/> Yes <input type="radio"/> No	<input checked="" type="radio"/> Yes <input type="radio"/> No	<input checked="" type="radio"/> Yes	<input type="radio"/> No
Dishwasher Rough-in	Yes				

** Refer to Construction Summary

14. General Comments

** Refer to Construction Summary

Disclaimers and Notes

- Colours of all materials are as close as possible to builder's selection, but not necessarily identical due to variances in manufacturing.
- Any extras listed above are null and void unless accompanied by a separate invoice/amendment. Said invoice must be paid in full.
- The Purchaser agrees that this colour selection is final and that no changes will be permitted, unless required by the Vendor.
- The Purchaser acknowledges reading and accepting document which contains other miscellaneous disclaimers.

Signature:  Date: _____

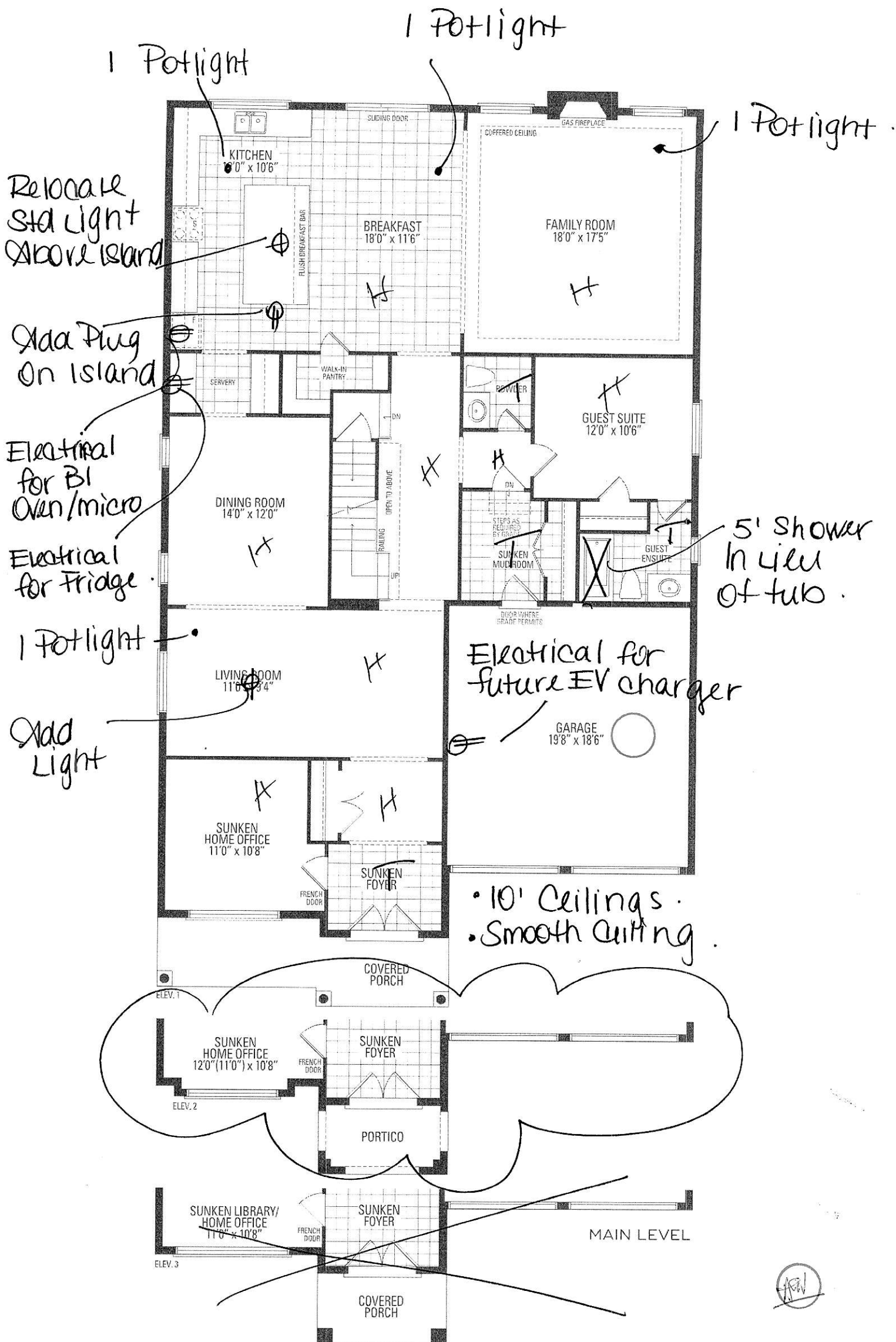

GRANDVILLE THREE ELEV. 1 • 4,55

Orientation of home may be reversed and purchaser agrees to accept stated floor areas. All renderings are artist's concept. Dimensions, speci

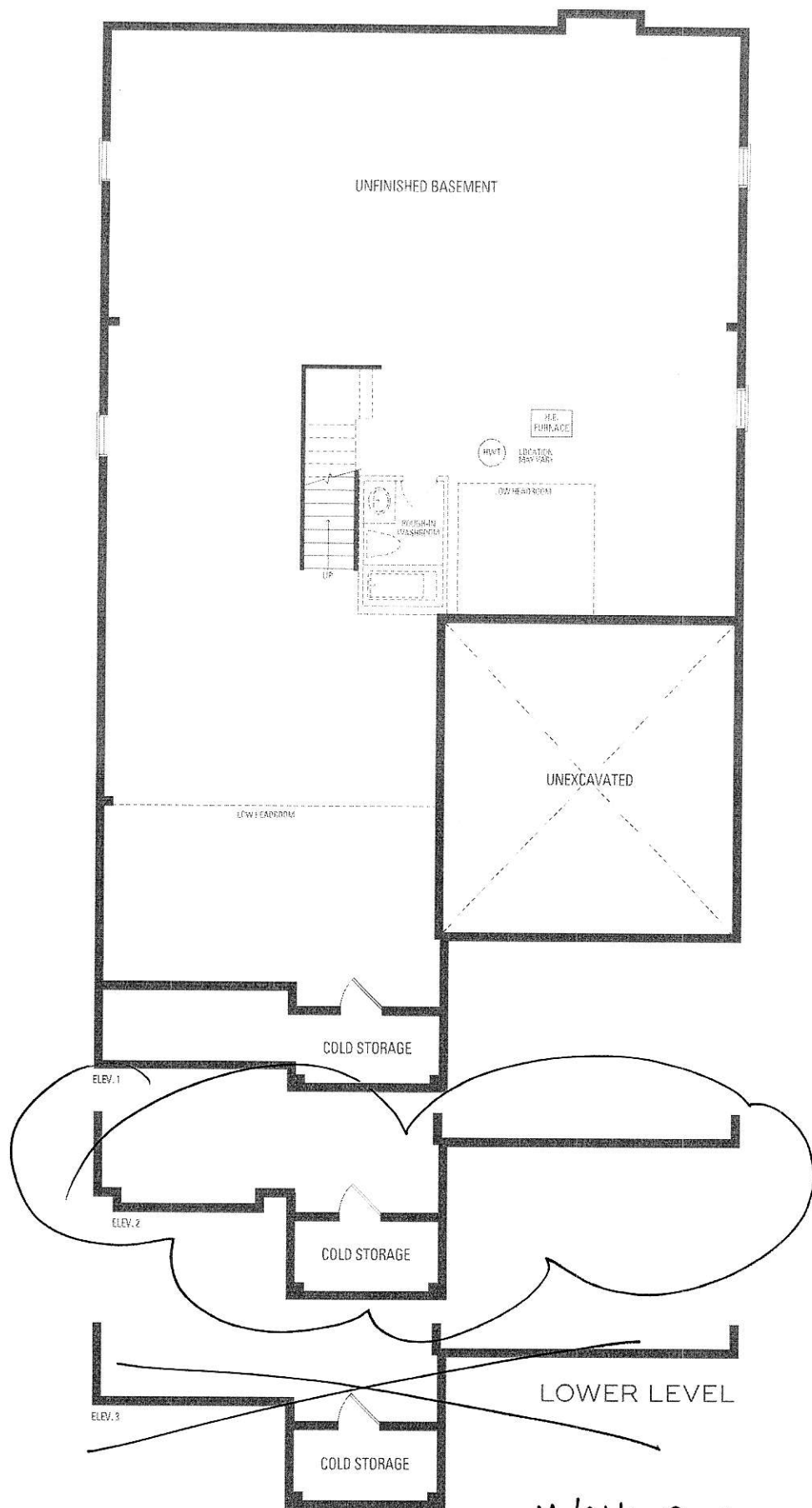

- Walk-Out Basement
- Enlarge All Basement Windows
- 200 AMP

PODMC301W
30-INCH DOUBLE COMBINATION BUILT-IN OVEN
WITH SPEED OVEN
PROFESSIONAL SERIES

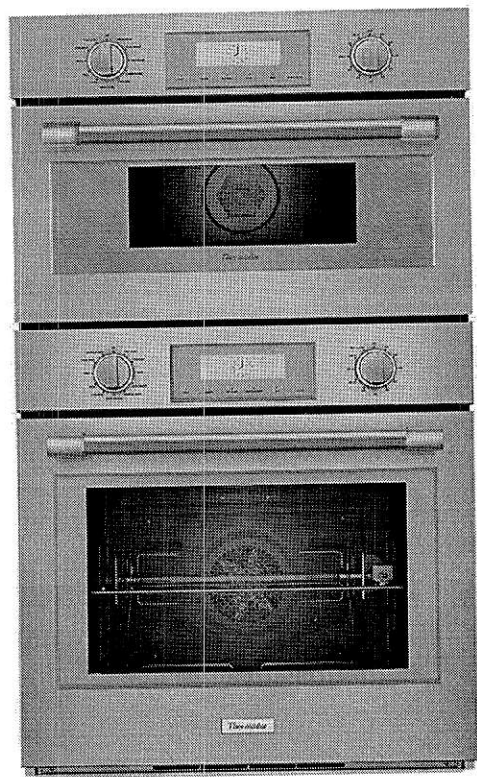

FEATURES & BENEFITS

- Specially crafted gray glass on stainless steel for a luxurious look and finish
- Designed for flexibility—standard or flush installation into kitchen cabinets
- Speed oven with microwave capability can broil and convection bake
- Large commercial style rotisserie with 12 pound capacity
- Multi-point Meat Probe to better capture temperature in roast and poultry

ACCESSORIES (INCLUDED)

Upper Cavity: Metal Turntable, Rack, Ceramic Tray; Lower Cavity: 3 Telescopic Racks, Multi-point Meat Probe, Max Broil Pan, Rotisserie

WARRANTY

Limited Warranty Parts and Labor	2 Year
----------------------------------	--------

GENERAL PROPERTIES

Heating Modes – Upper Cavity		
36 CookSmart™ Auto Programs (including True Convection, Speed Convection, Broil, Convection Broil, Heating Programs, Keep Warm) and Microwave Programs		
Heating Modes – Lower Cavity		
(16) Bake, Broil, Max Broil, Roast, Convection Bake, Convection Broil, Max Convection Broil, Convection Roast, Proof, Warm, Pizza, True Convection, Dehydrate, Speed Convection, Slow Roast, Rotisserie		
Sabbath		Yes
Cleaning Type – Lower Cavity		Easy Clean and Self Clean
Telescopic Rack(s)		3
Illumination Type	Upper Cavity Lower Cavity	LED Halogen
Interior Lights	Upper Cavity Lower Cavity	1 2
Home Connect (Wi-Fi Enabled)		Yes, Lower Oven Only

OVEN PERFORMANCE

Microwave Power		1,000 W
Bake / Broil Element	Upper Cavity Lower Cavity	600 W / 1,750 W 2,400 / 1,000 / 3,800 W
Convection Element	Upper Cavity Lower Cavity	1,700 W 2,000 W

TECHNICAL DETAILS

Watts		10,200 W
Circuit Breaker		50 A
Volts; Frequency		240 / 208 V; 60 Hz
Plug Type		Fixed Connection, No Plug
Conduit		60" 4-Wire
Energy Source		Electric

DIMENSIONS & WEIGHT

Overall Appliance Dimensions (HxWxD)	49" x 29 3/4" x 24 1/2"
Trim Overlaps (Top – Sides – Bottom)	1/2" – 9/16" – 0"
Required Cutout Size (HxWxD) – Standard	48 1/2" x 28 1/2" x 23 1/2"
Required Cutout Size (HxWxD) – Flush	49 1/8" x 30" x 24 1/2"
Speed Oven Capacity	1.6 cu. ft.
Oven Capacity	4.5 cu. ft.
Overall Lower Oven Interior Dimensions (HxWxD)	17 3/4" x 24" x 17 7/8"
Usable Lower Oven Interior Dimensions (HxWxD)	13 1/2" x 21 5/8" x 16 1/4"
Net Weight	267 lbs

PODMC301W

30-INCH DOUBLE COMBINATION BUILT-IN OVEN

WITH SPEED OVEN

PROFESSIONAL SERIES

Thermador

★

30-INCH DOUBLE COMBINATION OVEN WITH SPEED OVEN

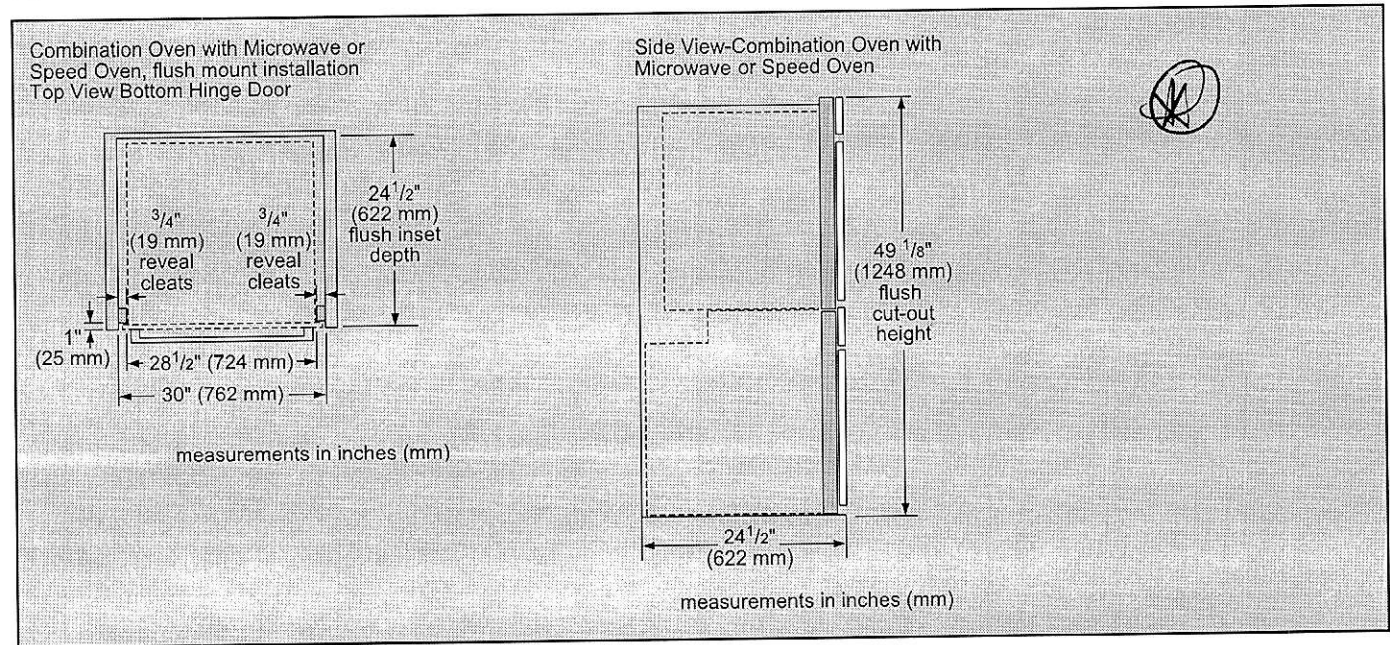
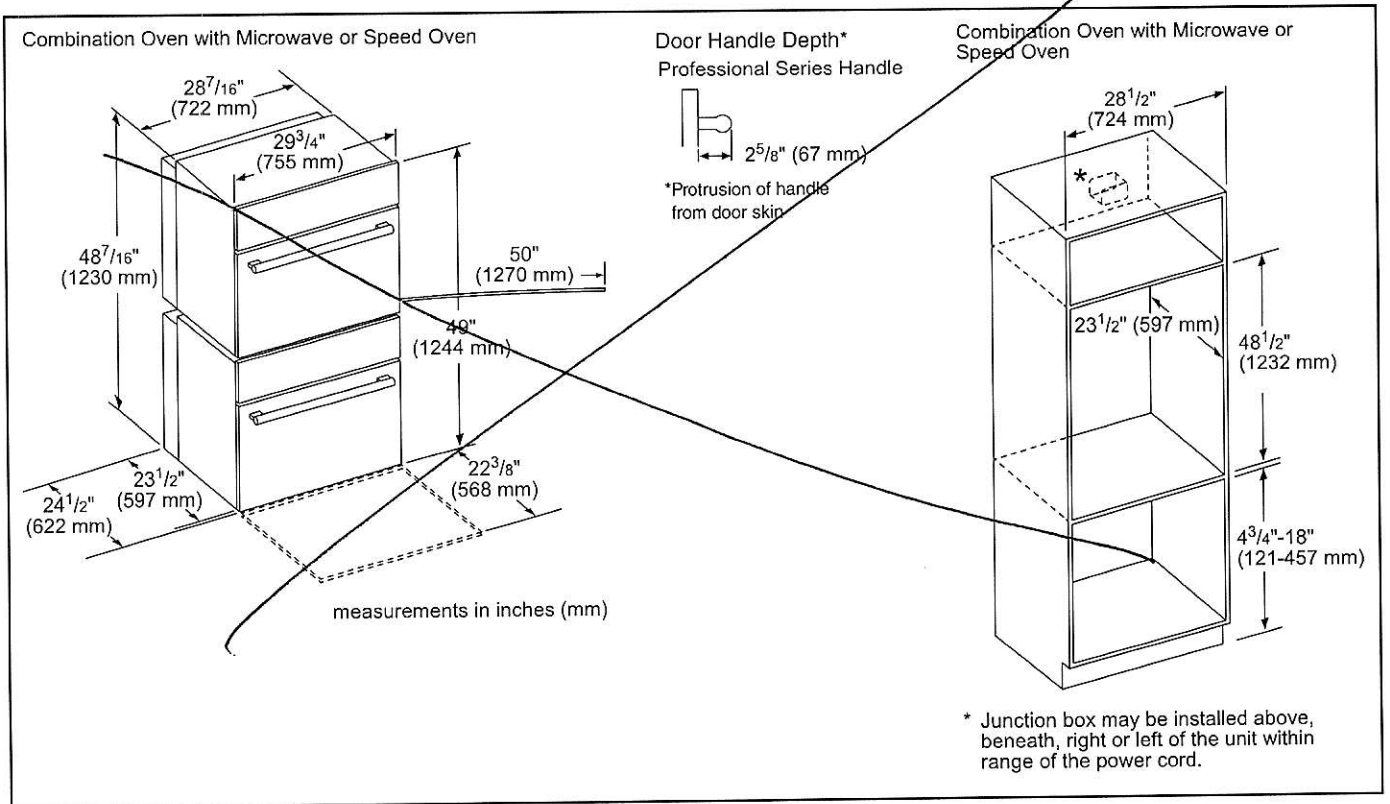

DWHD650WFP
EMERALD® 6-PROGRAM DISHWASHER
PROFESSIONAL SERIES HANDLE

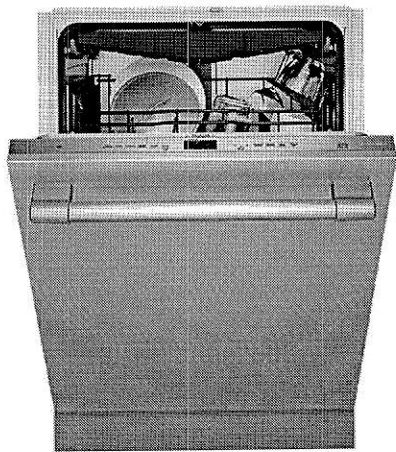

Also Available In:
DWHD650WFM – Flat Stainless Steel Panel with
Masterpiece® Series Handle
DWHD650WPR – Custom Panel

FEATURES & BENEFITS

- Chef's Tool Drawer (3rd Rack) is designed to make loading and unloading tools and hard to place items extraordinarily easier
- Sens-A-Wash® measures water cleanliness and adjusts wash cycle
- Three stage advanced filtration recirculates water for sparkling results
- 3-Level adjustable upper rack is customizable for all of your needs, designed to be raised for extra large items placed on the bottom rack, or lowered to fit taller wine glasses on the upper rack
- Extra Dry Option adds extra heat to the final rinse to enhance drying results
- Impressively Quiet® — 48 dBA for peaceful kitchen experience
- Thermador Connected Experience by Home Connect brings exclusive dish features that keep you connected. Always.

ACCESSORIES (OPTIONAL)

Dishwasher Supply and Drainage Hose Extension 76 3/4"	SGZ1010UC
Dishwasher Accessory Kit	SMZ5000
Fine Silverware Carafe	SMZ5002UC
Junction Box	SMZPCJB1UC



Accessory Kit includes Extra-Tall-Item Sprinkler,
Vase / Bottle Holder, 3 Plastic Item Clips and
Small Item Basket

Fine
Silverware
Carafe

GENERAL PROPERTIES

Number Of Wash Cycles	6
Number Of Options	5
dBA	48
Third Rack	Chef's Tool Drawer®
Rack Adjustability	Rackmatic 3-Stage
Tub Material	Stainless Steel
Control Type	Touch Control
Concealed Heating Element	Yes
Leak Protection System	24/7 AquaStop®
Water Softener	No
Five-Level Wash	Yes
Childlock	No
Home Connect (Wi-Fi Enabled)	Yes

EFFICIENCY

Water Usage Per Cycle (g)	3.5 g
Energy Efficiency Class	Tier 1
ENERGY STAR® Qualified	Yes
Total Annual Energy Consumption (kWh)	269 kWh
Total Annual Water Consumption (g)	624 g

CAPACITY

Number Of Place Settings	16
--------------------------	----

TECHNICAL DETAILS

Watts (W)	1,440 W
Current (A)	12 A
Volts (V)	120 V
Frequency (Hz)	60 Hz
Power Cord Length (in)	67"
Power Cord Install Length from Corner of Unit (in)	45"
Minimum Water Pressure (lb/sin)	14
Max. Temperature for Water Intake	140° F
Length Inlet Hose (in)	N/A
Length Outlet Hose (in)	79"

DIMENSIONS & WEIGHT

Overall Appliance Dimensions (HxWxD) (in)	33 7/8" x 23 9/16" x 23 3/4"
Required Cutout Size (HxWxD) (in)	33 7/8" Min. x 23 5/8" Min. x 24"
Adjustable Feet	Yes
Net Weight (lbs)	93 lbs

DWHD650WFP
EMERALD® 6-PROGRAM DISHWASHER
PROFESSIONAL SERIES HANDLE



WARRANTY	
Limited Warranty, Entire Appliance, Parts and Labor	2 Year
Limited Warranty for Microprocessor or Printed Circuit Board; Parts Only	3rd to 5th Year
Limited Warranty for Racks (Does Not Include Rack Components); Parts Only	3rd to 5th Year
Limited Warranty for Rust-through On Inner Tub Liner; Parts Only	Lifetime

DISHWASHER & CUTOUT DIMENSIONS

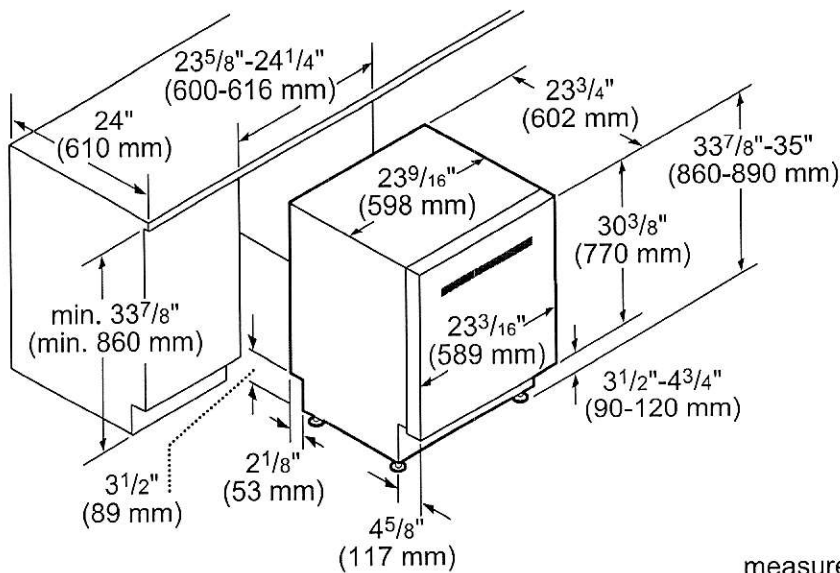

measurements in inches and mm

These warranties give you specific legal rights and you may have other rights that vary from state to state. Full warranty and limited warranty from date of installation. For complete warranty details, refer to your Use & Care manual, or ask your dealer.

Specifications are for planning purposes only. Refer to installation instructions and consult your countertop supplier prior to making counter opening. Consult with a heating and ventilation engineer for your specific ventilation requirements. For the most detailed information, refer to installation instructions accompanying product or write to Thermador indicating the model number. Specifications are correct at time of printing. Thermador reserves the right to change product specifications or design without notice. Some models are certified for use in Canada. Thermador is not responsible for products that are transported from the U.S. for use in Canada.

PCG366W

36-INCH GAS RANGETOP

PROFESSIONAL SERIES, PORCELAIN COOKTOP SURFACE

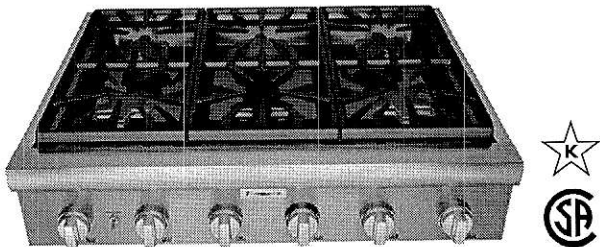

- FEATURES & BENEFITS
- ★- Patented Pedestal Star® Burner with QuickClean Base® designed for easy surface cleaning and superior heat spread for any size pan
 - ★- Precision simmering capabilities as low as 100°F (375 BTU) with 2 ExtraLow® Simmer burners
 - ★- LED Downlighting—hidden discreetly above the control panel provides functional and stylish illumination

GENERAL PROPERTIES	
Controls	Metal Knobs
Sealed Burners	Yes
Grate Material	Cast Iron
BURNER PERFORMANCE	
Total Number of Cooktop Burners	6
Power of Front Left Burner (NG)	18,000 and XLO (NG)
Power of Back Left Burner (NG)	15,000 and XLO (NG)
Power of Back Center Burner (NG)	15,000 (NG)
Power of Front Center Burner (NG)	18,000 (NG)
Power of Center 12" Electric Griddle (W)	N/A
Power of Center 12" Electric Grill (W)	N/A
Power of Back Right Burner (NG)	15,000 (NG)
Power of Front Right Burner (NG)	18,000 (NG)
TECHNICAL DETAILS	
Circuit Breaker (A)	15 A
Volts (V)	120 V
Frequency (Hz)	60 Hz
Plug Type / Receptacle	120V-3 Prong NEMA 5-15
Power Cord Length (in)	65"
Energy Source	Gas
Gas Type	Natural Gas 6" Water Column (14.9 mb) Min. (USA)
Alternative Gas Type	LP 11" Water Column (27.4 mb) Min. (USA)
Convertible To LP (Kit Required)	Yes
DIMENSIONS & WEIGHT	
Overall Appliance Dimensions (HxWxD) (in)	8 1/8" x 35 15/16" x 25 13/16"
Required Cutout Size (HxWxD) (in)	7 11/16" x 35 1/8" x 22 13/16"
Minimum Distance From Rear Wall (in)	6" Min. to Combustible Surface
Net Weight (lbs)	142 lbs
WARRANTY	
Limited Warranty, Entire Appliance, Parts and Labor	2 Year

★ THERMADOR® EXCLUSIVE

PCG366W
36-INCH GAS RANGETOP
PROFESSIONAL SERIES, PORCELAIN COOKTOP SURFACE



ACCESSORIES (OPTIONAL)

	PAGRIDDLE Griddle Sits on Top of Grates Over 2 Star Burners		PA12CHPBLK 12" Cutting Board		PWOKRINGHC Wok Ring
	PA36WLBC 10" Low Backguard		PAKNOBLUWR Metallic Blue Knob Kit		PALPKITHW LP Conversion Kit, Pro Rangetops (4 & 6 Burners)

36" RANGETOP SIDE VIEW

measurements in inches (mm)

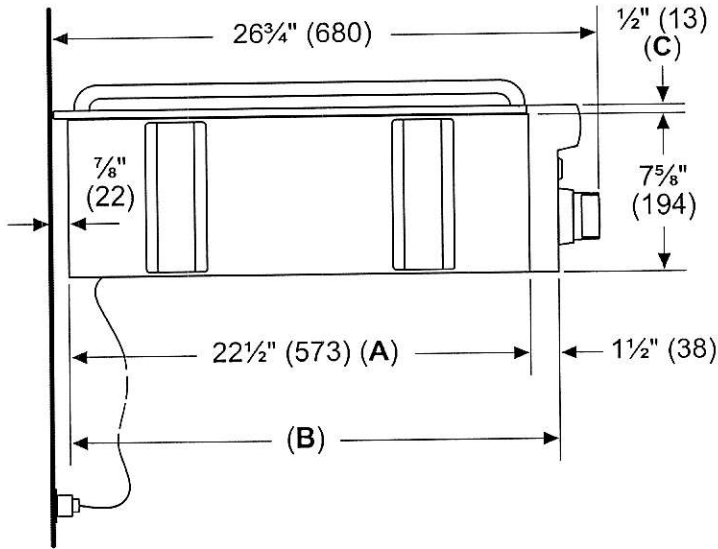

- A: Cabinet face for installation with projecting control panel.
- B: Cabinet face for installation with flush control panel.
- C: Side flange

PCG366W

36-INCH GAS RANGETOP

PROFESSIONAL SERIES, PORCELAIN COOKTOP SURFACE

Thermador

★

36-INCH RANGETOP CUTOUT DIMENSIONS

* Minimum recommended hood width equals that of the range or cooktop.

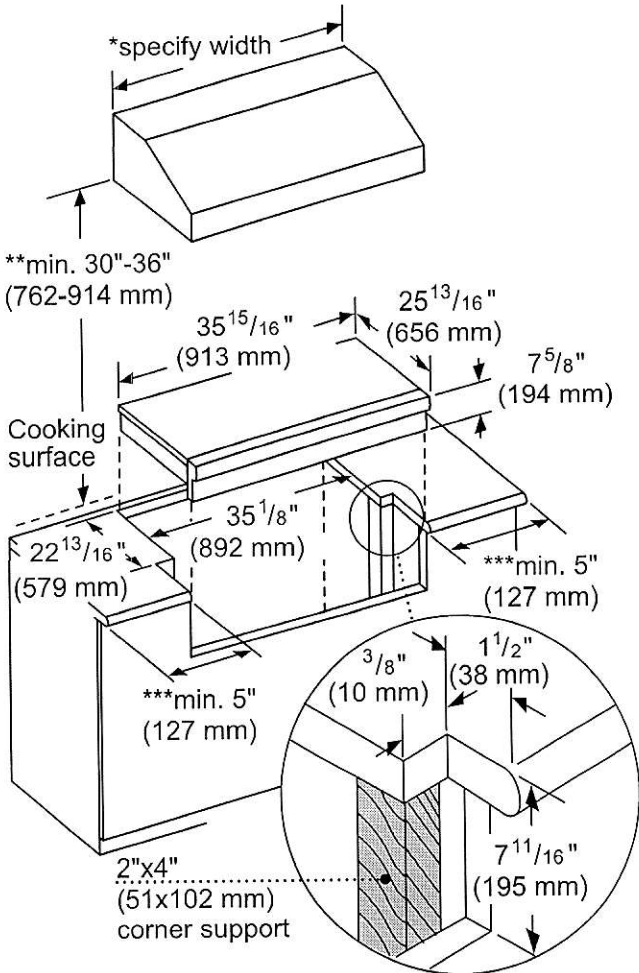

- ** 36" minimum clearance from cooking surface to combustible surfaces.
- *** 5" minimum clearance from cooking surface to combustible side wall.

Note: Most hoods contain combustible components that must be considered when planning the installation.

measurements in inches (mm)

PCG366W
36-INCH GAS RANGETOP
PROFESSIONAL SERIES, PORCELAIN COOKTOP SURFACE



36-INCH RANGETOP GAS LOCATION

The gas and electrical supply must be located in an area that is accessible without requiring removal of the rangetop. The appliance electrical power cord and gas pipe connection are located on the left rear underside of the rangetop.

The junction box must be located within 3 feet (~900 mm) of the rangetop connection.

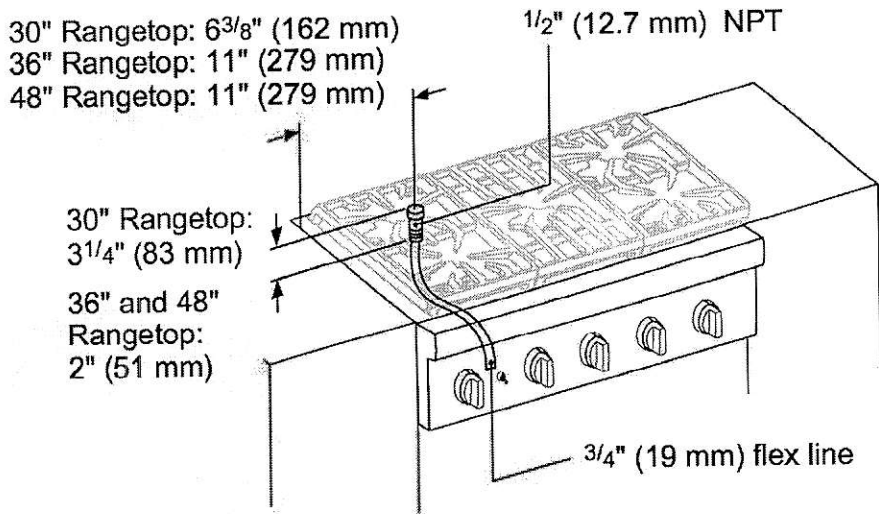

A manual valve must be installed to the appliance, in an accessible location from the front, for the purpose of shutting off the gas supply.

measurements in inches (mm)

NATURAL GAS REQUIREMENTS:

Inlet Connection: 1/2" NPT (min. 3/4" dia. flex line)
Supply Pressure: 6" min. to 14" max. water column (14.9 mb to 34.9 mb)
Manifold Pressure: 5" water column (12.5 mb)

PROPANE GAS REQUIREMENTS:

Inlet Connection: 1/2" NPT (min. 3/4" dia. flex line)
Supply Pressure: 11" min. to 14" max. water column (27.4 mb to 34.9 mb)
Manifold Pressure: 10" water column (24.9 mb)

ELECTRICAL SUPPLY

IMPORTANT: The cord supplied with all-burner gas rangetops requires a NEMA 5-15 receptacle as shown here. Local codes may require a different wiring method.



WARNING: This appliance is equipped with a three-prong grounding plug for protection against shock hazard and should be plugged directly into a properly grounded receptacle. DO NOT cut or remove the grounding prong from this plug. DO NOT ALTER THIS PLUG.

PCG366W
36-INCH GAS RANGETOP
PROFESSIONAL SERIES, PORCELAIN COOKTOP SURFACE



36-INCH RANGETOP CLEARANCES

The shaded area behind the rangetop indicates an opportunity to discolor the back wall under certain cooking conditions.

See the Ventilation Planning Guide for recommended hood options

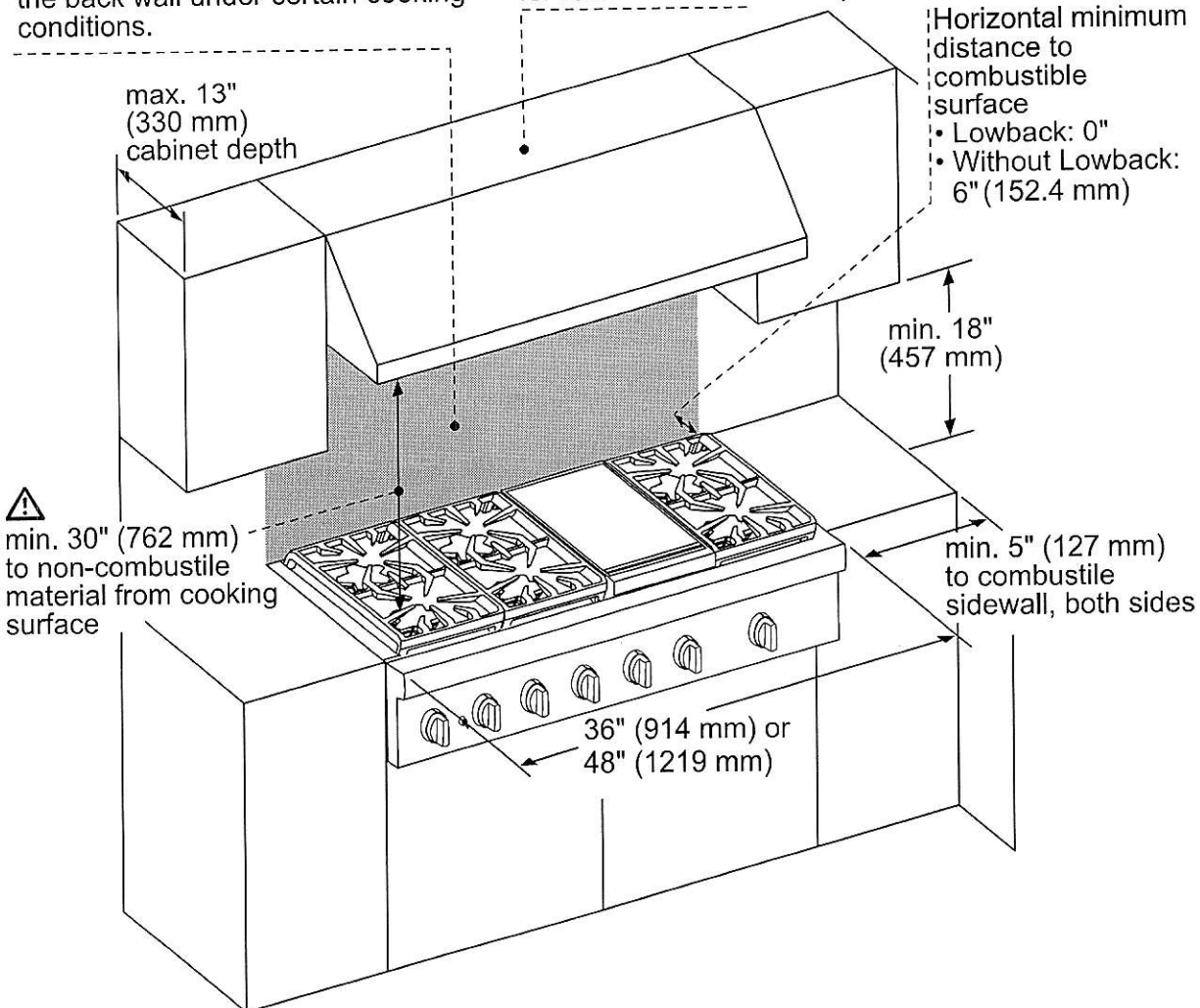

⚠ As defined in the “National Fuel Gas Code” (ANSI Z223.1, Current Edition). Clearances from non-combustible materials are not part of the ANSI Z21.1 scope and are not certified by CSA. Clearances must be approved by the local codes and/or by the local authority having jurisdiction.

measurements in inches (mm)

NOTE: A 36-inch minimum clearance is required between the top of the cooking surface and the bottom of an unprotected cabinet. A 30-inch clearance can be used when the bottom of the wood or metal cabinet is protected by not less than 1/4 inch of a flame retardant material covered with not less than No. 28 MSG sheet steel, 0.015 inch (0.4 mm) thick stainless steel, 0.024 inch (0.6 mm) aluminum, or 0.020 inch (0.5 mm) thick copper.

These warranties give you specific legal rights and you may have other rights that vary from state to state. Full warranty and limited warranty from date of installation. For complete warranty details, refer to your Use & Care manual, or ask your dealer.

Specifications are for planning purposes only. Refer to installation instructions and consult your countertop supplier prior to making counter opening. Consult with a heating and ventilation engineer for your specific ventilation requirements. For the most detailed information, refer to installation instructions accompanying product or write to Thermador indicating the model number. Specifications are correct at time of printing. Thermador reserves the right to change product specifications or design without notice. Some models are certified for use in Canada. Thermador is not responsible for products that are transported from the U.S. for use in Canada.

1 800 735 4328 | USA THERMADOR.COM | CANADA THERMADOR.CA | ©2019 BSH HOME APPLIANCES CORPORATION. ALL RIGHTS RESERVED.

T18IF905SP
18-INCH BUILT-IN FREEZER COLUMN WITH
INTERNAL ICE MAKER
FREEDOM® COLLECTION, PANEL-READY

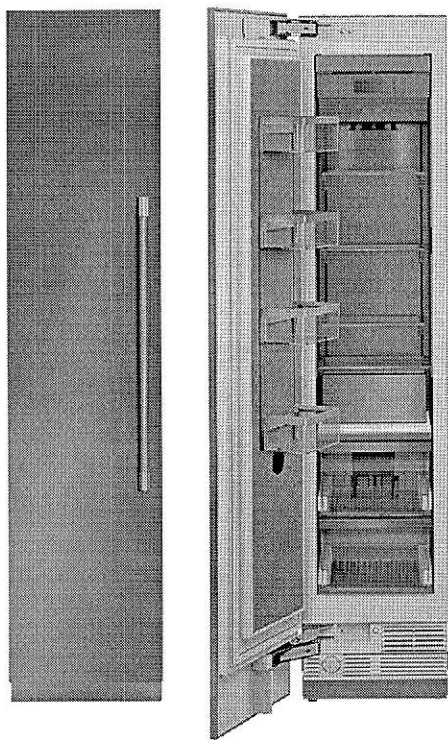

FEATURES & BENEFITS

- Full Stainless Steel Inner Liner
- Freedom® Hinge enables true flush design
- Auto Door Opening provides the opening of the door with just a slight push or pull
- Energy Efficient Diamond Ice made with twist tray technology
- Smooth Filtered Lighting for clear and easy viewing of all product
- SoftClose® Drawers for easy and controlled storage
- Sleek clean design for the perfect symmetry when paired with additional columns
- TFT control panel managing all your columns functions

TEMPERATURE RANGES

Freezer	-11°F (-24°C) to 7°F (-14°C)
SuperFreeze®	-22°F (-30°C) for approximately 52 hours
Energy Saving (Economy) Mode	3°F (-16°C)

GENERAL PROPERTIES

Home Connect™ (Wi-Fi Enabled)	Yes
Panel Ready	Yes
Reversible Door Swing	Yes
SoftClose® Door	Yes*
SoftClose® Drawers	Yes
Lighting	LED Sidewall and Theater Lighting
Freezer Shelves	4
Adjustable Shelves	3
Shelf Material	Glass w/Aluminum Profile
Full Extension Drawers @ 115° Door Opening Angle	Yes
General Use Drawer	2
Door Bins	4
External LED Proximity Sensor	No
Oversized Dispenser Opening	No
Chilled Water, Crushed and Cubed Ice	No
Rapid Water Replenishment System	No
Ice Maker with Diamond Ice System	Yes
Door Open Alarm	Yes
Open Door Assist	Yes
Special Modes	Sabbath, Economy, Vacation

CAPACITY

Total Capacity (cu. ft.)	8.6 cu. ft.
--------------------------	-------------

PERFORMANCE

Dedicated Evaporator & Compressor System	Yes
SuperFreeze®	Yes
Defrost Process	Frost-Free

TECHNICAL DETAILS

Watts (W)	350 W
Current (A)	15 A
Volts (V)	110-120 V
Frequency (Hz)	60 Hz
Power Cord Length (in.)	118
Plug Type	120V-3 Prong

DIMENSIONS & WEIGHT

Appliance Dimensions (H x W x D) (in.)	83 3/4"*** x 17 3/4" x 24"
Required Cutout Size (H x W x D) (in.)	84" x 18" x 25"
Net / Gross Weight (lbs)	273 / 302 lbs

EFFICIENCY

ENERGY STAR® Qualified	Yes
Annual Energy Consumption	404 kWh

*To verify if you have a refrigeration unit with Soft-Close capability please contact our customer team by calling 1-800-735-4328.
**Height adjustable + / -1/2" (+ / -13 mm)

T18IF905SP
18-INCH BUILT-IN FREEZER COLUMN WITH
INTERNAL ICE MAKER
FREEDOM® COLLECTION, PANEL-READY



PRODUCT AND PANEL DIMENSIONS

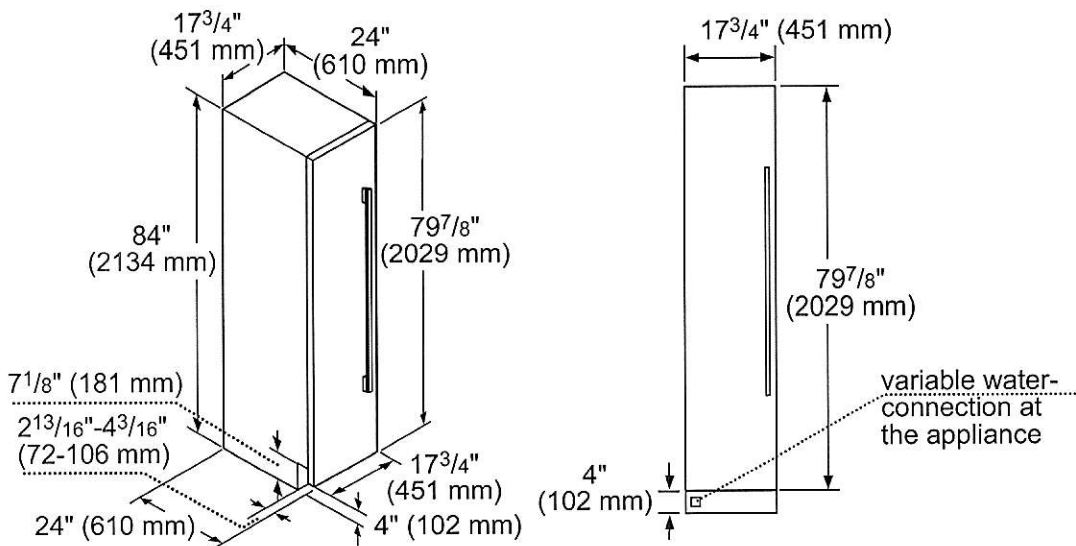

ACCESSORIES (OPTIONAL)

FLAT STAINLESS STEEL DOOR PANELS

18-Inch Flat Stainless Steel Door Panel With Dispenser



TFL18ID800
For use with Handle
TFL18ID905
Handleless

NOTE: Handleless Panels should not be installed on units without the Soft-Close capability. If you are uncertain if you have a refrigeration unit with Soft-Close capability please contact our customer team by calling 1-800-735-4328.

STORAGE



ICEBUCKETL
Large Ice Bucket

FRAMEKIT10

Freedom® Frame Kit
For any custom column installation in 24-inch deep cutouts. With two metal side trims whose placement between the interior cutout wall and the appliance helps overcome the challenge of unfinished cabinet returns.

HANDLES

Choose between two options:



PR36HNDL20
36-Inch Professional Series Handle

or



MS36HNDL20
36-Inch Masterpiece® Series Handle

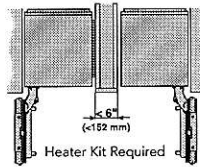

HEATRKIT20 – 13W @ 120V
Freedom® Heater Kit

When two appliances are installed side-by-side a sealing kit must be used. For combinations that involve a freezer column, this sealing kit is included. For all other (non-traditional, i.e. two wine columns, two bottom freezers, etc.) side-by-side combinations or instances where any appliances are installed less than 6-inches (152 mm) apart from one another but not connected side-by-side, purchase this kit. This kit is recommended for use with any installation in areas that are subject to humidity, or located next to an outside wall.

FILTERS



REPLFLTR55
Freedom® Water Filter
Replacement water filter for use in all freezer and bottom freezer models

These warranties give you specific legal rights and you may have other rights that vary from state to state. Limited warranty from date of purchase. For complete warranty details, refer to your Use & Care manual, or ask your dealer.

Specifications are for planning purposes only. Refer to installation instructions and consult your countertop supplier prior to making counter opening. Consult with a heating and ventilation engineer for your specific ventilation requirements. For the most detailed information, refer to installation instructions accompanying product or write to Thermador indicating the model number. Specifications are correct at time of printing. Thermador reserves the right to change product specifications or design without notice. Some models are certified for use in Canada. Thermador is not responsible for products that are transported from the U.S. for use in Canada.

1 800 735 4328 | USA THERMADOR.COM | CANADA THERMADOR.CA | ©2020 BSH HOME APPLIANCES CORPORATION. ALL RIGHTS RESERVED.

T18IF905SP
18-INCH BUILT-IN FREEZER COLUMN WITH
INTERNAL ICE MAKER
FREEDOM® COLLECTION, PANEL-READY



WARRANTY	
Limited, Entire Appliance, Parts and Labor on Any Part of the Refrigerator that Fails Because of a Manufacturing Defect	2 Year
Limited Warranty for Sealed Refrigeration System*; Parts and Labor	3rd to 6th Year
Limited Warranty for Sealed Refrigeration System*; Parts Only	7th to 12th Year
Limited Warranty for Stainless Steel Rust-Through	Lifetime

*Sealed refrigeration system includes compressor, evaporator, condenser, dryer / strainer and connection tubing

CUTOUT DIMENSIONS

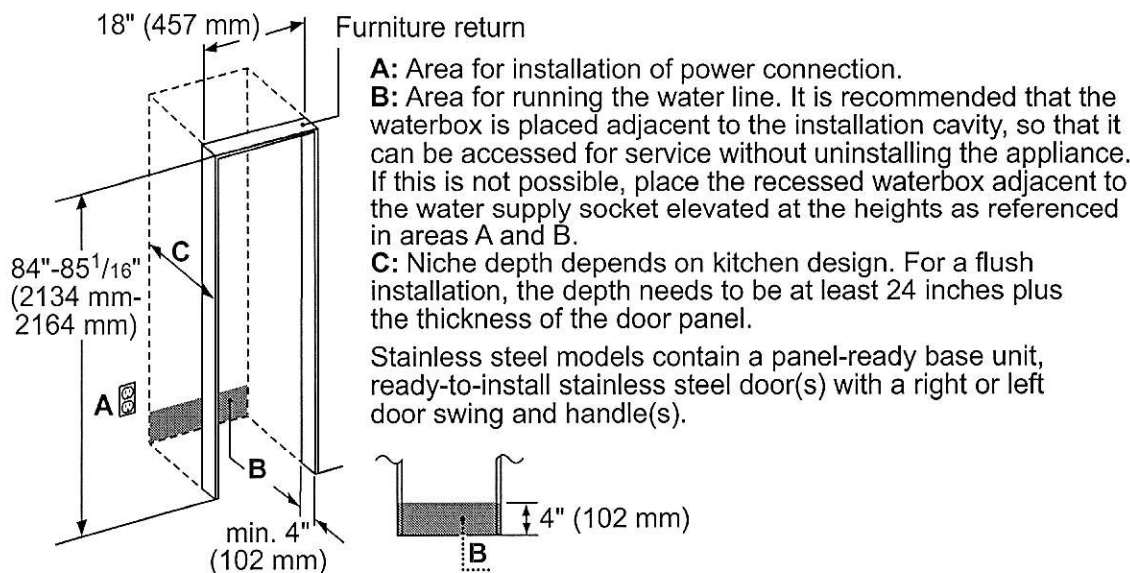

TOP VIEW CLEARANCE

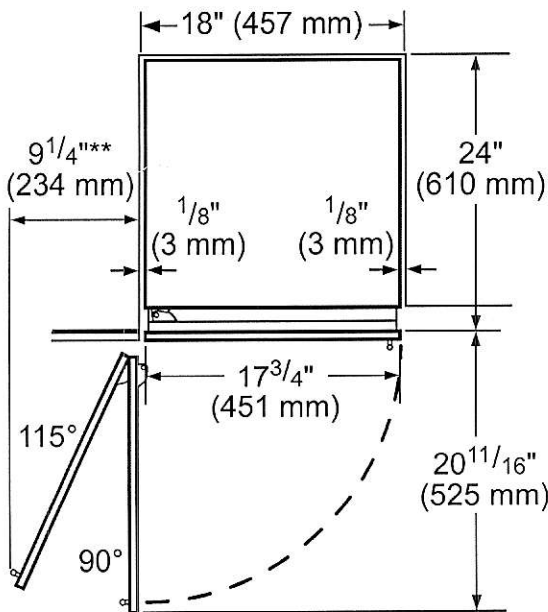

** Door handle must be added to this dimension

* Depends on the thickness of the furniture door. 3/4" (19 mm) is relevant for the stainless steel door. (special Accessory).

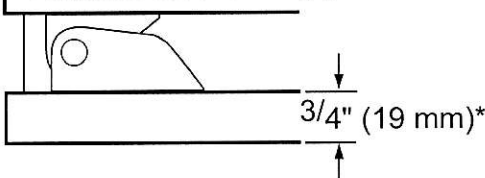

T30IF905SP
30-INCH BUILT-IN FREEZER COLUMN WITH
INTERNAL ICE MAKER
FREEDOM® COLLECTION, PANEL-READY

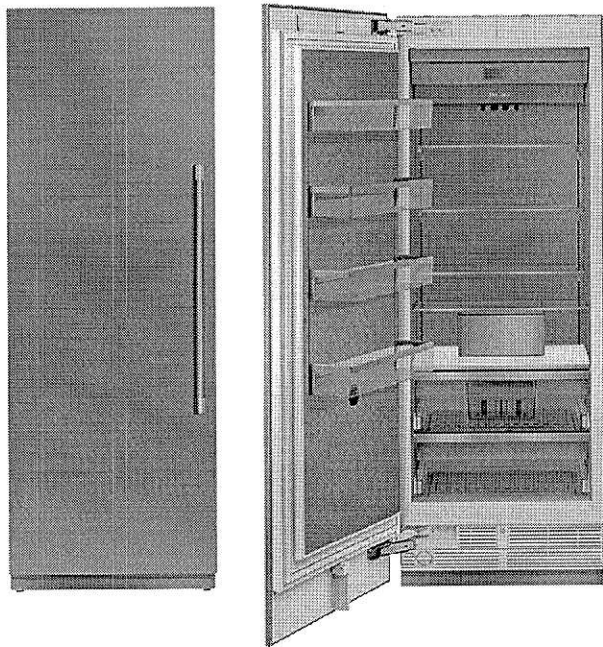

- FEATURES & BENEFITS**
- Full Stainless Steel Inner Liner
 - Freedom® Hinge enables true flush design
 - Auto Door Opening provides the opening of the door with just a slight push or pull
 - SoftClose® Drawers for easy and controlled storage
 - Sleek clean design for the perfect symmetry when paired with additional columns
 - TFT control panel managing all your columns functions

TEMPERATURE RANGES	
Freezer	-11°F (-24°C) to 7°F (-14°C)
SuperFreeze®	-22°F (-30°C) for approximately 52 hours
Energy Saving (Economy) Mode	3°F (-16°C)

GENERAL PROPERTIES	
Home Connect™ (Wi-Fi Enabled)	Yes
Panel Ready	Yes
Reversible Door Swing	Yes
SoftClose® Door	Yes
SoftClose® Drawers	Yes
Lighting	LED Sidewall and Theater Lighting
Freezer Shelves	4
Adjustable Shelves	3
Shelf Material	Glass w/Aluminum Profile
Full Extension Drawers @ 115° Door Opening Angle	Yes
General Use Drawer	2
Door Bins	4
External LED Proximity Sensor	No
Oversized Dispenser Opening	No
Chilled Water, Crushed and Cubed Ice	No
Rapid Water Replenishment System	No
Ice Maker with Diamond Ice System	Yes
Door Open Alarm	Yes
Open Door Assist	Yes
Special Modes	Sabbath, Economy, Vacation

CAPACITY	
Total Capacity (cu. ft.)	15.8 cu. ft.

PERFORMANCE	
Dedicated Evaporator & Compressor System	Yes
SuperFreeze®	Yes
Defrost Process	Frost-Free

TECHNICAL DETAILS	
Watts (W)	350 W
Current (A)	15 A
Volts (V)	110-120 V
Frequency (Hz)	60 Hz
Power Cord Length (in.)	118
Plug Type	120V-3 Prong

DIMENSIONS & WEIGHT	
Appliance Dimensions (H x W x D) (in.)	84" x 29 3/4" x 24"
Required Cutout Size (H x W x D) (in.)	84" x 30" x 25"
Net / Gross Weight (lbs)	362 / 398 lbs

EFFICIENCY	
ENERGY STAR® Certified	Yes
Annual Energy Consumption	479 kWh

*Height adjustable + / -1/2" (+ / -13 mm)

T30IF905SP

30-INCH BUILT-IN FREEZER COLUMN WITH
INTERNAL ICE MAKER

FREEDOM® COLLECTION, PANEL-READY



WARRANTY	
Limited, Entire Appliance, Parts and Labor on Any Part of the Refrigerator that Fails Because of a Manufacturing Defect	2 Year
Limited Warranty for Sealed Refrigeration System*; Parts and Labor	3rd to 6th Year
Limited Warranty for Sealed Refrigeration System*; Parts Only	7th to 12th Year
Limited Warranty for Stainless Steel Rust-Through	Lifetime

*Sealed refrigeration system includes compressor, evaporator, condenser, dryer / strainer and connection tubing

CUTOUT DIMENSIONS

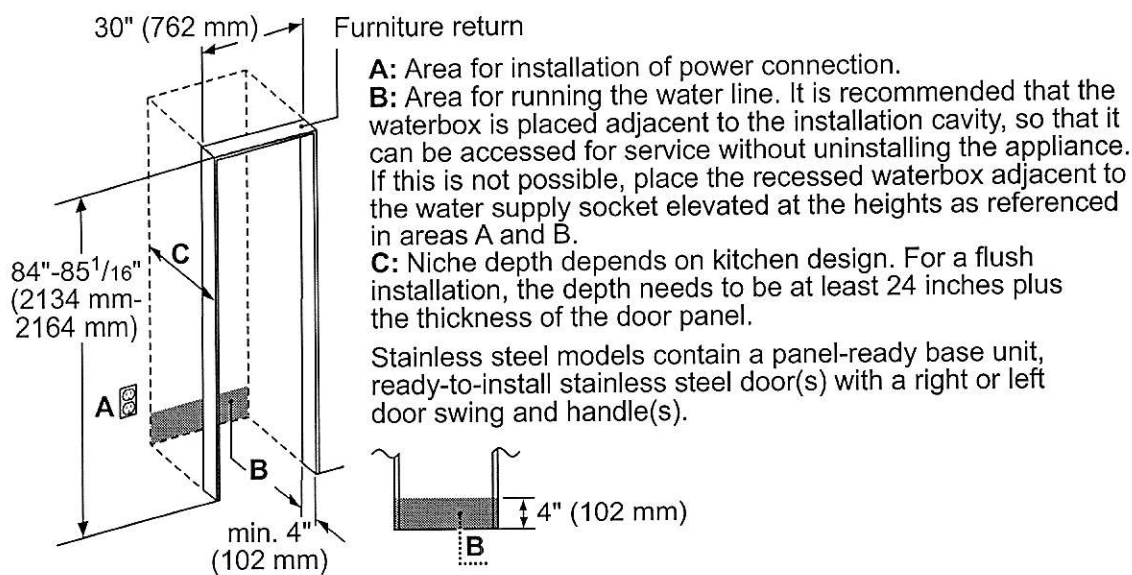

TOP VIEW CLEARANCE

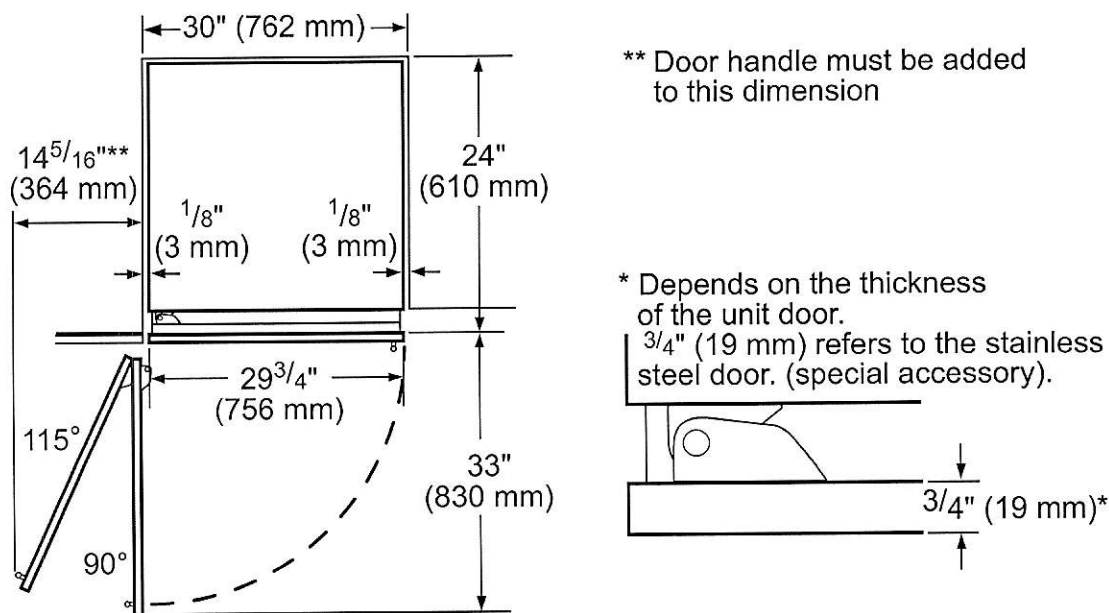

T30IF905SP
30-INCH BUILT-IN FREEZER COLUMN WITH
INTERNAL ICE MAKER
FREEDOM® COLLECTION, PANEL-READY



PRODUCT AND PANEL DIMENSIONS

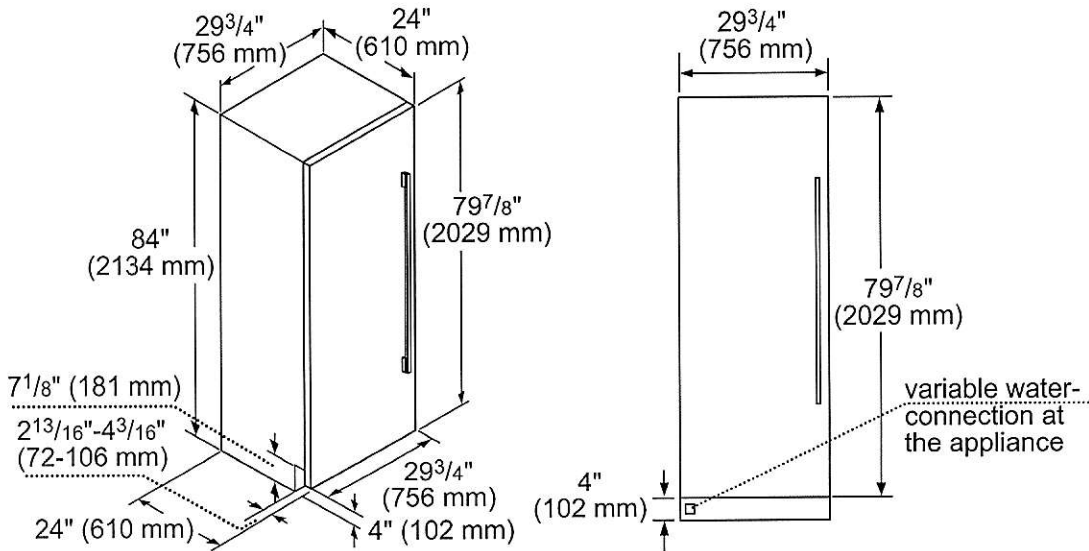

ACCESSORIES (OPTIONAL)

FLAT STAINLESS STEEL DOOR PANELS

30-Inch Flat Stainless Steel Door Panel Without Dispenser

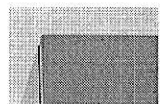

TFL30IR800
For use with Handle
TFL30IR905
Handleless

STORAGE



ICEBUCKETL
Large Ice Bucket

FRAMEKIT10

Freedom® Frame Kit
For any custom column installation in 24-inch deep cutouts. With two metal side trims whose placement between the interior cutout wall and the appliance helps overcome the challenge of unfinished cabinet returns.

HANDLES

Choose between two options:



PR36HNDL20
36-Inch Professional Series Handle

or

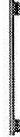

MS36HNDL20
36-Inch Masterpiece® Series Handle

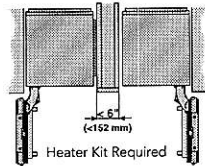

HEATRKIT20 – 13W @ 120V
Freedom® Heater Kit

When two appliances are installed side-by-side a sealing kit must be used. For combinations that involve a freezer column, this sealing kit is included. For all other (non-traditional, i.e. two wine columns, two bottom freezers, etc.) side-by-side combinations or instances where any appliances are installed less than 6-inches (152 mm) apart from one another but not connected side-by-side, purchase this kit. This kit is recommended for use with any installation in areas that are subject to humidity, or located next to an outside wall.

FILTERS



REPLFLTR55
Freedom® Water Filter
Replacement water filter for use in all freezer and bottom freezer models

These warranties give you specific legal rights and you may have other rights that vary from state to state. Limited warranty from date of purchase. For complete warranty details, refer to your Use & Care manual, or ask your dealer.

Specifications are for planning purposes only. Refer to installation instructions and consult your countertop supplier prior to making counter opening. Consult with a heating and ventilation engineer for your specific ventilation requirements. For the most detailed information, refer to installation instructions accompanying product or write to Thermador indicating the model number. Specifications are correct at time of printing. Thermador reserves the right to change product specifications or design without notice. Some models are certified for use in Canada. Thermador is not responsible for products that are transported from the U.S. for use in Canada.

1 800 735 4328 | USA THERMADOR.COM | CANADA THERMADOR.CA | ©2021 BSH HOME APPLIANCES CORPORATION. ALL RIGHTS RESERVED.