

CONSTRUCTION SUMMARY

Mountainview Heights 3 (G) - Russell Gardens Building Ltd.

FEB 16 2022

PURCHASERS: Stephanie Anna SORGIOVANNI and Kevin J. MCKAY

TEL: RES.: 289-888-2567 BUS.: 905-336-8670

LOT / PHASE 494 / 4	REG. PLAN # 62M-1266	HOUSE TYPE Valleycreek Two Elev 2		
------------------------	-------------------------	--------------------------------------	--	--

CABINETRY

1 - CABINETRY - KITCHEN - BLUE MOTION DRAWERS AND SOFT CLOSING CABINETRY 14Feb22 Note:	
1 - VANITY - ENSUITE BATHROOM - HARDWARE UPGRADE 2 01Feb22 Note:	
1 - VANITY - POWDER ROOM - HARDWARE UPGRADE 2 01Feb22 Note:	
1 - CABINETRY - KITCHEN - HARDWARE UPGRADE 2 01Feb22 Note:	
1 - KITCHEN CABINETRY - TWO COLOUR KITCHEN - FLAT FEE 01Feb22 Note:	
1 - VANITY - ENSUITE BATHROOM - UPGRADE 2 01Feb22 Note:	
1 - VANITY - POWDER ROOM - UPGRADE 2 01Feb22 Note:	
1 - CABINETRY - KITCHEN - UPGRADE 2 01Feb22 Note:	
1 - CABINETRY - KITCHEN - LIGHT VALENCE 01Feb22 Note:	

CABINETRY ACCESSORIES

1 - KITCHEN CABINETRY BASE - PULLOUT RECYCLE 2 BIN - PRICE IS EACH 14Feb22 Note:	
1 - CABINETRY FEE FOR FLUSH CUTOUT ON WALL OVEN/MICROWAVE COMBO CABINET ONLY 01Feb22 Note:	
1 - KITCHEN CABINETRY - APPLIANCE DOOR PANELS - 24" DISHWASHER DOOR PANEL (SUPPLY ONLY) - UPGRADE 2 01Feb22 Note:	
1 - KITCHEN CABINETRY UPPER - GLASS DOOR - GROUP 2 GLASS - FINISHED INTERIOR - FITS TALL UPPER CABINETS - PRICE IS PER DOOR - UPGRADE 2 01Feb22 Note: FROSTED GLASS	
1 - KITCHEN CABINETRY UPPER - ANGLED CORNER CABINET - FITS TALL UPPER CABINETS - PER UNIT - UPGRADE 2 01Feb22 Note:	
1 - KITCHEN CABINETRY BASE - PIE CUT CORNER CABINET WITH LAZY SUSAN (WHITE POLYMER) - UPGRADE 2 01Feb22 Note:	
1 - KITCHEN CABINETRY UPPER - FULL DEPTH ABOVE FRIDGE - WITH GABLES - 600MM - PRICE IS EACH - UPGRADE 2 01Feb22 Note:	
5 - PANTRY UNIT UPGRADE - TO GO FROM 300MM TO 600MM DEEP - PRICE IS PER FOOT - UPGRADE 2 01Feb22 Note:	

CONSTRUCTION SUMMARY

Mountainview Heights 3 (G) - Russell Gardens Building Ltd.

PURCHASERS: Stephanie Anna SORGIOVANNI and Kevin J. MCKAY

TEL: RES.: 289-888-2567 BUS.: 905-336-8670

LOT / PHASE	REG. PLAN #	HOUSE TYPE		
494 / 4	62M-1266	Valleycreek Two Elev 2		
1 - KITCHEN CABINETRY BASE - POT/PAN DRAWERS (CABINET) - UPGRADE 2 01Feb22 Note:				
1 - KITCHEN CABINETRY BASE - PULLOUT WIRE SPICE RACK - PRICE IS EACH 01Feb22 Note:				
1 - KITCHEN CABINETRY - BUILT-IN MICROWAVE/OVEN COMBO - UPGRADE 2 01Feb22 Note:				
1 - KITCHEN CABINETRY BASE - COOKTOP CABINET WITH POT DRAWERS (2 DRAWERS) - UPGRADE 2 01Feb22 Note:				

CERAMIC TILE

1 - DELETE ALL CERAMIC BATHROOM ACCESSORIES - DELETE TOWEL BAR, PAPER HOLDER & SOAP DISH THROUGHOUT 01Feb22 Note:				
1 - TILE - UPGRADE 4 FLOOR TILE - - POWDER ROOM 01Feb22 Note:				
1 - TILE - UPGRADE 4 FLOOR TILE - - KITCHEN 01Feb22 Note:				
1 - TILE - UPGRADE 4 FLOOR TILE - - FOYER 01Feb22 Note:				
1 - TILE - UPGRADE 1 FLOOR TILE - - LAUNDRY ROOM 01Feb22 Note:				
1 - TILE - UPGRADE 3 WALL TILE - - ENSUITE WALL TILE - SHOWER 01Feb22 Note:				
1 - TILE - UPGRADE 3 FLOOR TILE - - ENSUITE BATHROOM - FLOOR 01Feb22 Note:				
1 - TILE - UPGRADE 1 WALL TILE - - BATHROOM 3/4 - TUB AREA 01Feb22 Note:				
1 - TILE - UPGRADE 1 WALL TILE - - BATHROOM 2 - SHOWER 01Feb22 Note:				
1 - TILE - UPGRADE 1 FLOOR TILE - - BATHROOM 3/4 - FLOOR 01Feb22 Note:				
1 - TILE - UPGRADE 1 FLOOR TILE - - BATHROOM 2 - FLOOR 01Feb22 Note:				

CONSTRUCTION

1 - PROVISION FOR SHAMPOO NICHE APPROX. 14" WIDE X 20" HIGH AS PER SKETCH – IF CONSTRUCTION PERMITS 01Feb22 Note:				
1 - SMOOTH CEILINGS ON FIRST FLOOR ONLY - DET 01Feb22 Note:				

COUNTER TOP

CONSTRUCTION SUMMARY

Mountainview Heights 3 (G) - Russell Gardens Building Ltd.

PURCHASERS: Stephanie Anna SORGIOVANNI and Kevin J. MCKAY

TEL: RES.: 289-888-2567 BUS.: 905-336-8670

LOT / PHASE	REG. PLAN #	HOUSE TYPE		
494 / 4	62M-1266	Valleycreek Two Elev 2		

1 - COUNTERTOP CUTOUT PROVISION FOR COOKTOP

01Feb22 Note:

1 - COUNTER TOP - UPGRADE - ENSUITE BATHROOM 2 VANITY COUNTER TOP

01Feb22 Note:

1 - COUNTER TOP - UPGRADE - ENSUITE BATHROOM 3/4 VANITY COUNTER TOP

01Feb22 Note:

1 - COUNTER TOP - UPGRADE - ENSUITE BATHROOM VANITY COUNTER TOP

01Feb22 Note:

1 - COUNTER TOP - UPGRADE - POWER ROOM VANITY COUNTER TOP

01Feb22 Note:

1 - COUNTER TOP - UPGRADE - KITCHEN COUNTER TOP

01Feb22 Note:

1 - SHAMPOO NICHE 14" WIDE X 20" HIGH AS PER SKETCH - MARBLE, GRANITE OR QUARTZ - IF CONSTRUCTION PERMITS - REQUIRES PROVISION FROM CONSTRUCTION

01Feb22 Note: SUPPLY & INSTALL - MASTER ENSUITE

DOORS AND TRIM

20 - DOORS INTERIOR - FOR 8 OR 9 FOOT CEILING - LOGAN SMOOTH HALLOW IN LIEU OF STANDARD SERIES - PRICE IS PER DOOR

01Feb22 Note:

ELECTRICAL

1 - PLUG - ELECTRICAL PLUG - TO BE INSTALLED OVER FIREPLACE

01Feb22 Note:

1 - BUILT IN OVEN AND COOKTOP PROVISION - PROVISION ONLY - ELECTRICAL ONLY

01Feb22 Note:

1 - LIGHT - EXTERIOR WITH INTERIOR SWITCH

01Feb22 Note: COVERED PORCH - WALL LIGHT - REFER TO SKETCH

1 - RELOCATE STANDARD UPPER HALLWAY LIGHT TO BE CENTERED TO OPEN TO BELOW STAIRCASE - IF CONSTRUCTION PERMITS

01Feb22 Note:

1 - RELOCATE STANDARD KITCHEN LIGHT TO BE CENTERED OVER ISLAND

01Feb22 Note:

1 - 200 AMP ELECTRICAL SERVICE

19May21 Note:

FIREPLACE AND ACCESSORIES

1 - MANTEL - PAINTED - M6 - IN LIEU OF STANDARD MANTEL

01Feb22 Note:

HARDWOOD FLOORING

1 - HARDWOOD - GROUP B SERIES 5 INCH - IN LIEU OF 2 1/4 INCH NATURAL RED OAK - - MAIN HALL

01Feb22 Note:

CONSTRUCTION SUMMARY

Mountainview Heights 3 (G) - Russell Gardens Building Ltd.

PURCHASERS: Stephanie Anna SORGIOVANNI and Kevin J. MCKAY

TEL: RES.: 289-888-2567 BUS.: 905-336-8670

LOT / PHASE	REG. PLAN #	HOUSE TYPE		
494 / 4	62M-1266	Valleycreek Two Elev 2		
1 - HARDWOOD - GROUP B SERIES 5 INCH - IN LIEU OF 2 1/4 INCH NATURAL RED OAK - - FAMILY ROOM 01Feb22 Note:				
1 - HARDWOOD - GROUP B SERIES 5 INCH - IN LIEU OF 2 1/4 INCH NATURAL RED OAK - - DINING ROOM 01Feb22 Note:				

MIRRORS AND GLASS

1 - MASTER ENSUITE – FRAMELESS GLASS SHOWER ENCLOSURE – INCLUDES CHROME KNOB AND HINGES 19May21 Note:	
--	--

PLUMBING

2 - MOEN - ECO-PERFORMANCE POSI-TEMP SHOWER ONLY - MODEL T2662EP/62320 - CHROME - ENSUITE 2 & ENSUITE 3/4 01Feb22 Note:	
2 - MOEN - SINGLE HANDLE LAV FAUCET WITH LIFT ROD DRAIN - MODEL 6710 - CHROME - ENSUITE 2 & ENSUITE 3/4 01Feb22 Note:	
1 - MOEN - TWO HANDLE ROMAN TUB FAUCET - MODEL TS903/4796 - CHROME - MASTER ENSUITE 01Feb22 Note:	
1 - MOEN - POSI-TEMP SHOWER ONLY WITH 3 FUNCTION TRANSFER VALVE/TRIM AND SLIDE BAR WITH HAND SHOWER - MODE TS2712EP/U361CI/UTS4172/62320/S3879EP/A721 - CHROME - MASTER ENSUITE 01Feb22 Note:	
2 - MOEN - SINGLE HANDLE LAV FAUCET WITH LIFT ROD DRAIN - MODEL S6700 - CHROME - MASTER ENSUITE 01Feb22 Note:	
1 - MOEN - SINGLE HANDLE LAV FAUCET WITH LIFT ROD DRAIN - MODEL 6900 - MATTE BLACK (BL) - POWDER 01Feb22 Note:	
1 - MOEN - SINGLE HANDLE PULLDOWN KITCHEN FAUCET - MODEL S72308 - MATTE BLACK - KITCHEN 01Feb22 Note:	
5 - SINK - UNDERMOUNT SINK - CONTRAC COLLETTE #4220CIY 01Feb22 Note: POWDER - X1 MASTER ENSUITE - X2 ENSUITE 2 - X1 ENSUITE 3.4 - X1	
1 - SINK - UNDERMOUNT SINK - BLANCO QUATRUS R15 U2 #401519 01Feb22 Note:	

PROMOTIONAL

1 - LESS BALANCE OF CREDIT FROM PURCHASER EXTRA SHEET IN OFFER 01Feb22 Note:	
1 - LESS CREDIT FROM PURCHASER EXTRA SHEET IN OFFER 19May21 Note: NEW PROMO BALANCE \$4710.00	

STAIRS AND RAILINGS

1 - V GROOVE HANDRAIL 01Feb22 Note:	
--	--

CONSTRUCTION SUMMARY

Mountainview Heights 3 (G) - Russell Gardens Building Ltd.

PURCHASERS: Stephanie Anna SORGIOVANNI and Kevin J. MCKAY

TEL: RES.: 289-888-2567 BUS.: 905-336-8670

LOT / PHASE	REG. PLAN #	HOUSE TYPE		
494 / 4	62M-1266	Valleycreek Two Elev 2		
1 - EUROLINE 1				
01Feb22 Note: BLACK IRON PICKET				
1 - STAINED STAIRS – STANDARD STAIRCASE - PRICE IS PER SET				
01Feb22 Note:				

EXTRAS AS PER OFFER

(1) The Vendor agrees that notwithstanding any other term or provision in this Agreement included in the Purchase Price and in addition to those items detailed in Schedule GP to the Agreement of Purchase and Sale, the Purchaser is entitled to a credit of	
Worksheet Note:	
PURCHASER(S) ACKNOWLEDGES THAT THE PURCHASE PRICE IS INCLUSIVE OF ALL CREDITS AND PROMOTIONAL PACKAGES AVAILABLE AT TIME OF PURCHASE.	
Worksheet Note:	
Granite kitchen counter top, from Vendor?s standard samples	
Worksheet Note:	

This Document is Extremely Time Sensitive - Printed 15 Feb 22 at 9:14

NZ30K7880US

30" Induction Cooktop

Features

- Power Boost
- Wi-Fi Connectivity
- Bluetooth Connected to Hood
- 15 Power Levels plus Booster
- Simmer
- Melt Setting
- 5 Induction Elements – Including 4800W Dual Element – 7"/11"
- 8.6 kW Power
- 2-Stage Residual Heat Indicator

Convenience

- Kitchen Timer
- Child Safety Lock
- Safety Shutoff
- Direct Access
- Quick Stop/Start/Pause Controls
- Demo Mode

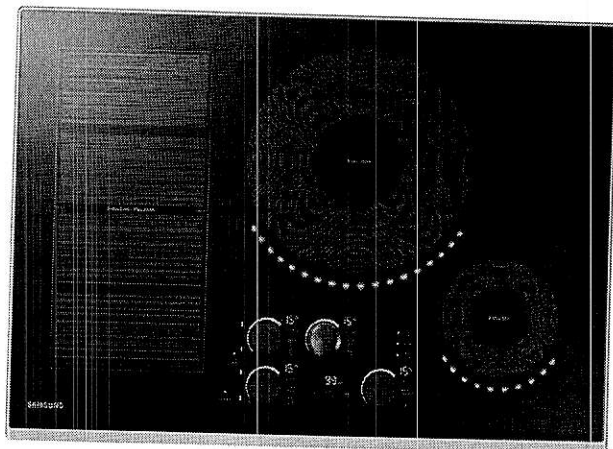

Flex Zone

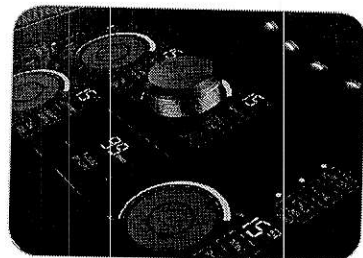

Magnetic Knob

Available Colors



Stainless Steel (shown)



Black Stainless Steel

Signature Features

VIRTUAL FLAME™ TECHNOLOGY

- LED Surface lights shine onto pans to give the visual of gas cooking, with the precision of induction.

FLEX ZONE

- Large cooking area designed to adapt to different pot shapes and sizes for optimal flexibility.

DIGITAL-ANALOG CONTROLS

- The ultimate interface, choose between a removable magnetic analog-knob or digital touch controls.

SAMSUNG

NZ30K7880US

30" Induction Cooktop

Installing Your Cooktop

Can be installed over a single oven.

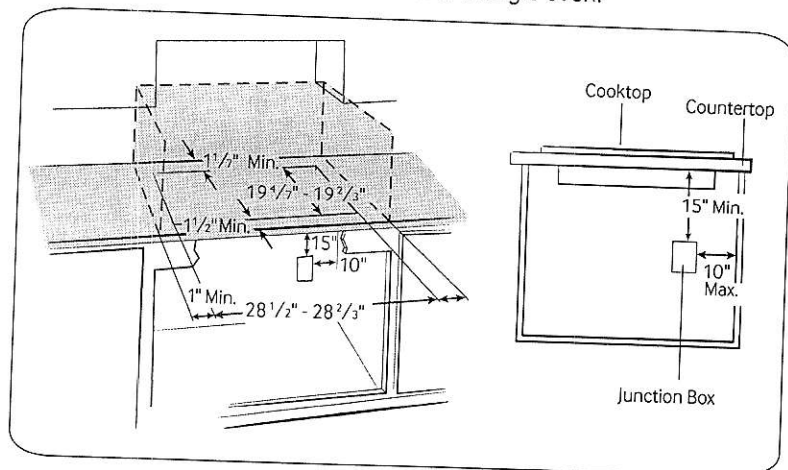

Total Power
8.6 kW

Power Source
240V / 60 Hz / 40A

Induction Cooktop

- Left Front: Flex Zone 1800W (Boost 2600W)
- Left Rear: Flex Zone 1800W (Boost 2600W)
- Right Front: 6" (Virtual Flame™) 1400W (Boost 1800W)
- Center: 7/11" (Virtual Flame™) 3600W (Boost 4800W)
- Flex Zone: 7 11/16" x 15 3/4"

Warranty

One (1) Year All Parts and Labor

Product Dimensions & Weight (WxHxD)

Outside (Max) Cooktop Dimensions:
30" x 4" x 21 1/4"

Cooktop Cut-Out Dimensions:
28 1/2" x 4" x 19 4/7"

Weight: 49.8 lbs.

Shipping Dimensions & Weight (WxHxD)

Dimensions:
34" x 7 5/16" x 25"

Weight: 60.8 lbs.

Color

Model #

UPC Code

Stainless Steel

NZ30K7880US

887276183190

Black Stainless Steel

NZ30K7880UG

887276183435

Dimensions

Cooktop Dimensions

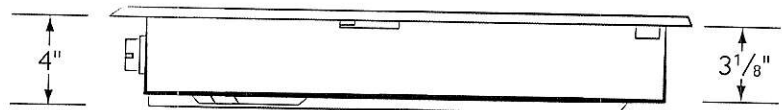
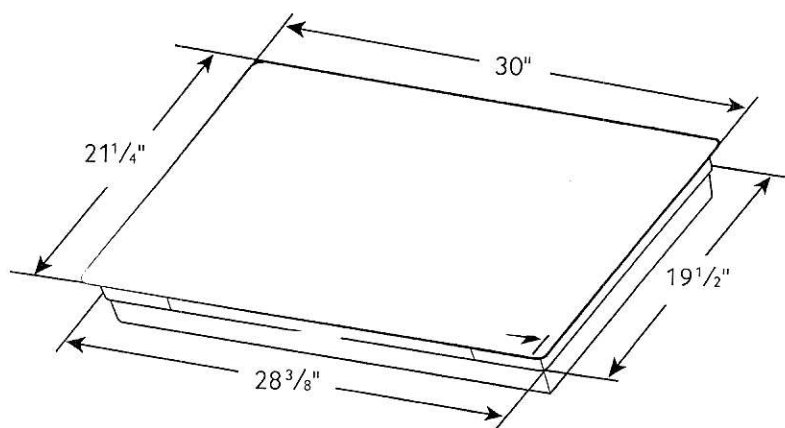

Cut-Out Dimensions of Countertop

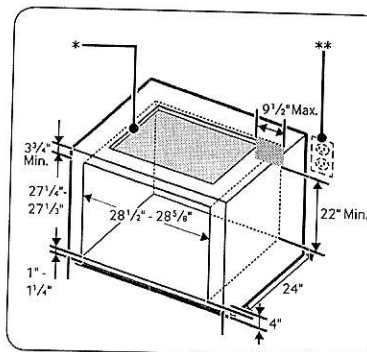

* See built-in oven installation for complete installation instructions. See label on top of approved built-in oven models.

** Refer to installation manual of oven.

SAMSUNG

Actual color may vary. Design, specifications, and color availability are subject to change without notice. Non-metric weights and measurements are approximate.

©2017 Samsung Electronics America, Inc. 85 Challenger Road, Ridgefield Park, NJ 07660. Tel: 800-SAMSUNG, samsung.com. Samsung is a registered trademark of Samsung Electronics Co., Ltd.

RF23A9071SR

SAMSUNG

23 cu. ft. Smart Counter Depth 4-Door Flex™ Refrigerator
with AutoFill Water Pitcher and Dual Ice Maker

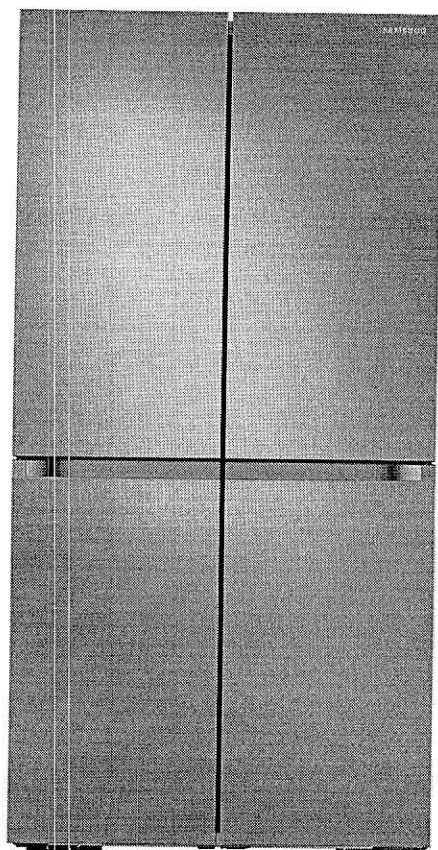

Signature Features

AutoFill Water Pitcher

A built-in pitcher that automatically refills with filtered water and the option to infuse with a flavor of your choice.

Dual Ice Maker with Ice Bites

Enjoy your favorite beverage with your choice of ice. Select from cubed ice or new nugget-style Ice Bites that chill your drink faster. Makes up to 6 lbs per day, stores up to 6.8 lbs total.

FlexZone™

Customize your lower-right storage space to be a refrigerator or freezer. With five adjustable settings, you choose what foods to store from fruits and vegetables to your favorite ice cream.

Available Colors



Fingerprint Resistant
Stainless Steel (shown)



Fingerprint Resistant
Black Stainless Steel

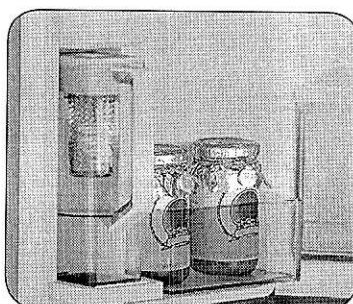

AutoFill Water Pitcher

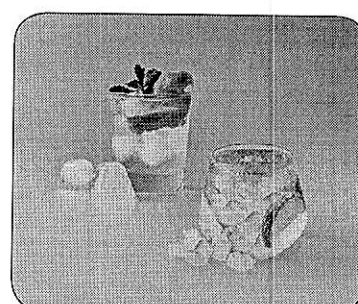

Dual Ice Maker with Ice Bites

Design

- AutoFill Water Pitcher
- Modern Design
- Built-in Look
- Fingerprint Resistant Finish
- LED Lighting

Technology

- Dual Ice Maker with Ice Bites and Cubed Ice
- UV Deodorizing Filter
- Wi-Fi Enabled

Performance

- FlexZone™
- FlexCrisper
- Triple Cooling

Rating



ENERGY STAR® rated:
635 kWh/yr



ADA Compliant

RF23A9071SR

SAMSUNG

23 cu. ft. Smart Counter Depth 4-Door Flex™ Refrigerator with AutoFill Water Pitcher and Dual Ice Maker

Installation Specifications

1. Measure the height, width and depth of the opening, making sure to include baseboards, molding tile, countertop overhang, etc. Check to be sure there is enough room to open the door (consider walls, islands or other obstacles when measuring).
2. Refer to illustration below to determine dimensions.
3. Allow 2.5" of clearance on hinge side of refrigerator when installing next to a wall where handle may make contact.
4. Allow 1" minimum clearance at rear for proper air circulation and water/electrical connections. Allow a 3/8" minimum clearance at sides and top for ease of installation.
5. Ensure each door and entryway in the home is wide enough for the refrigerator to be moved through easily.

For optimal usage and ability to open refrigerator doors completely, do not install next to a wall.

Please note: The following dimension and cutout information is for planning purposes only. For complete installation details, consult manual packed with product or download manual online at samsung.com.

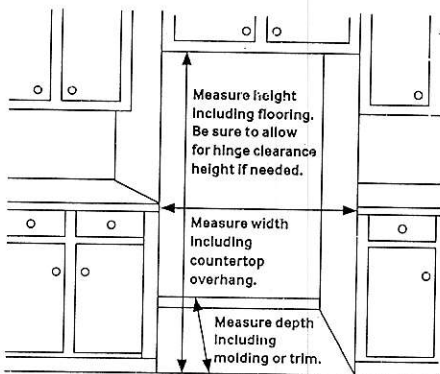

Total Capacity: 22.9 cu. ft.

Refrigerator: 14.1 cu. ft.

- 4 Tempered Glass Spill-Proof Shelves
- 2 Clear Drawers: FlexCrisper and Crisper+
- 6 Door Bins
 - Right: 1 Gallon Bin, 2 Regular Bins
 - Left: 1 Gallon Bin, 2 Regular Bins
- LED Lighting

Freezer: 8.8 cu. ft.

- Dual Ice Maker in Freezer (Cubed Ice or Ice Bites)
 - 2 Ice Buckets with Cover and 1 Scoop
- 3 Slide-Out Shelves
- 6 Door Bins
- LED Lighting

Accessories

Water Filter: HAF-QIN

Warranty

One (1) Year Parts and Labor on Refrigerator
Five (5) Years Parts and Labor on Sealed Refrigeration System*
Ten (10) Years Parts and Five (5) Years Labor on Digital Inverter Compressor

*Compressor, evaporator, condenser, drier and connecting tubing.

Product Dimensions & Weight

Dimensions (WxHxD with hinges and doors):

35⁷/₈" x 71⁷/₈" x 28¹/₂"

Dimensions (WxHxD without hinges and door):

35⁷/₈" x 70³/₄" x 24"

Weight: 282.2 lbs

Shipping Dimensions & Weight (WxHxD)

Dimensions: 38¹/₄" x 77⁵/₈" x 30³/₅"

Weight: 304.2 lbs

Color

Fingerprint Resistant
Stainless Steel

Fingerprint Resistant
Black Stainless Steel

Model

RF23A9071SR

RF23A9071SG

UPC Code

887276525594

887276525570

Dimensions

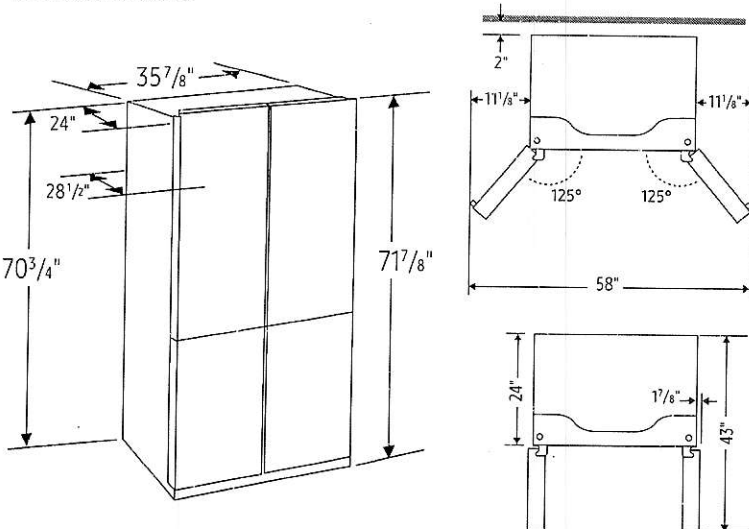

NQ70M7770DS

30" Microwave Combination Wall Oven

SAMSUNG

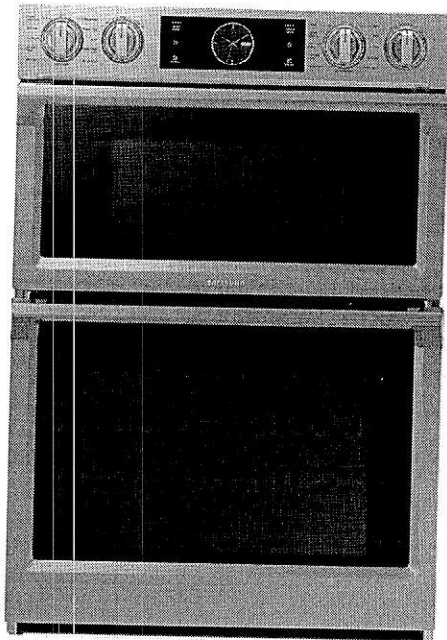

Signature Features

Steam Cook (Oven)

- Delivers moisture at precise times for a crisp, browned outside and tender inside.

Speed Cook (Microwave)

- Cook food faster and more evenly by using power convection.

Flex Duo™ (Oven)

- Cook two dishes at different temperatures simultaneously with the Smart Divider.

Available Colors



Stainless Steel (shown)



Black Stainless Steel

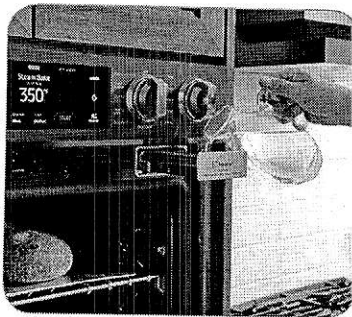

Steam Cook

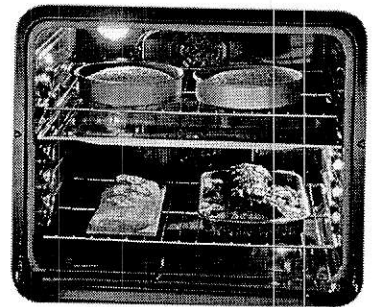

Flex Duo™

Features

- Digital-Analog Controls
- 1.9/5.1 cu. ft. Capacity
- Hybrid Clean and Self-Clean (Oven)
- Gourmet Cook (Oven)
- Dual Convection (Oven)
- Wi-Fi Connectivity
- Wi-Fi Enabled Temperature Probe (Oven)
- LED Spotlights (Oven)
- Easy View Window
- 3 Heavy-Duty Racks including a Gliding Rack (Oven)
- Soft-Close Door (Oven)

- Ceramic Plate (Microwave)
- Rapid Preheat (Oven)
- Auto Latch Microwave Door
- 6 Oven Modes including Steam Bake and Steam Roast
- Blue LED Illuminated Knobs
- Broil Element
- Smart Control Key (Oven)
- 6 Rack Positions (Oven)
- Drop-Down Door Design
- LCD Display

Convenience

- Hidden Heating Element (Oven)
- Sabbath Mode (Oven)
- Delay Start (Oven)
- Proofing (Oven)
- Warming Mode (Oven)
- Kitchen Timer
- Child Safety Lock
- Convection Conversion

NQ70M7770DS

30" Microwave Combination Wall Oven

SAMSUNG

Cabinet Dimensions

Combination Oven Installed in Cabinet

* Junction Box

**Allow a minimum of 22" for clearance to adjacent corners, drawers, walls, etc. when door is open.

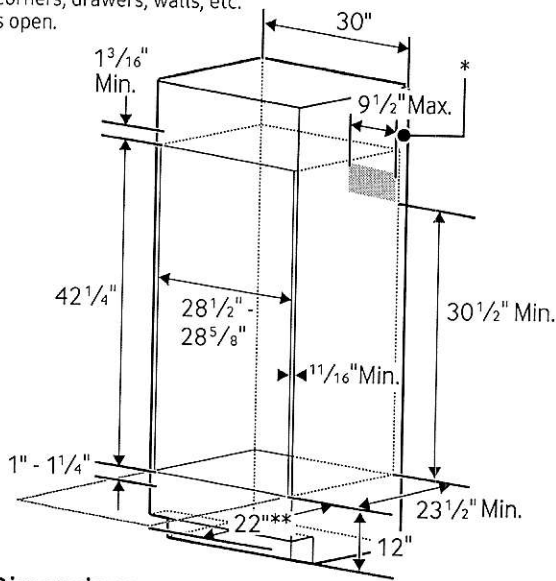

Product Dimensions

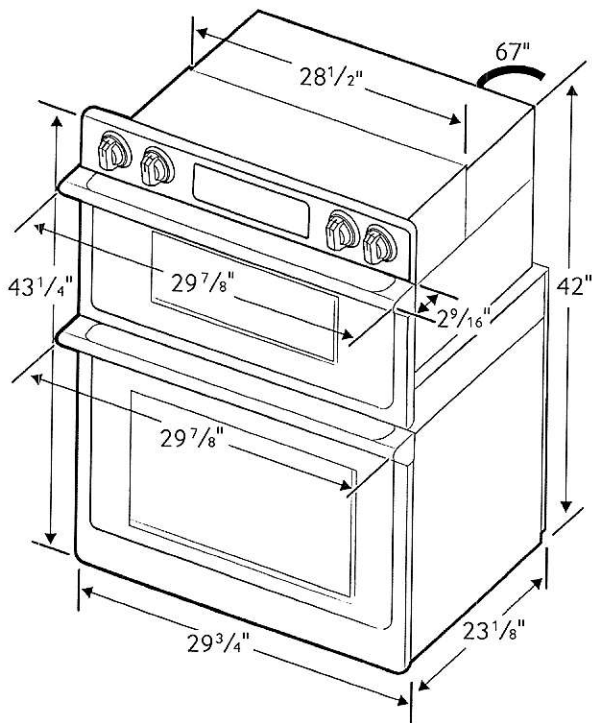

Total Capacity: 1.9/5.1 cu. ft.

- Microwave: 1.9 cu. ft.
- Wall Oven: 5.1 cu. ft. total, 2.8/2.2 cu. ft.
- Hidden Bake Element
- Bake: 175°F–550°F
- Convection Bake: 175°F–550°F
- Convection Roast: 175°F–550°F
- Broil: Low-High
- Steam Bake: 230°F–550°F
- Steam Roast: 230°F–550°F
- Proofing
- Sabbath Mode

Warranty

One (1) Year All Parts and Labor
Ten (10) Years Parts Warranty for Magnetron

Product Dimensions & Weight (WxHxD)

Outside (Max) Combination Oven Dimensions:
29 7/8" x 43 1/4" x 25 11/16"

Combination Oven Cut-Out Dimensions:
28 1/2" x 42 1/4" x 23 1/2"

Weight: 262.4 lbs.

Shipping Dimensions & Weight (WxHxD)

Dimensions:
33 5/8" x 48 3/16" x 29 51/64"

Weight: 291.1 lbs.

Color	Model #	UPC Code
Stainless Steel	NQ70M7770DS	887276195186
Black Stainless Steel	NQ70M7770DG	887276195162

RATING	
240V	9.5 kW
208V	7.2 kW
BREAKER SIZE	
240V	40 Amps
208V	40 Amps

24" Custom Panel Dishwasher

800 Series – Custom Panel SHVM78Z53N

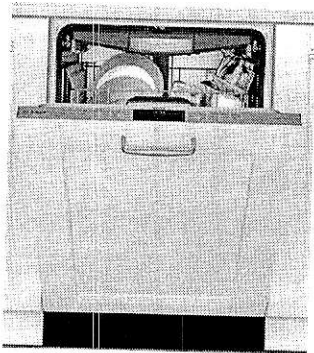

SHVM78Z53N
Custom Panel

Patented CrystalDry™ technology transforms moisture into heat to get dishes, including plastics, 60% drier.¹

Features & Benefits

42 dBA: dishwasher runs quietly so your kitchen conversations aren't interrupted.

The Flexible 3rd Rack with fold down sides adds 30% more² loading area, perfect for utensils and ramekins.

Touch Control Technology allows for quick cycle programming.

The AquaStop® leak protection system contains leaks through a precisely engineered system. If a leak occurs, the system contains it by shutting down operation and pumping out water. So you have the ultimate peace of mind whether you are away or at home.

General Properties	
Number of wash cycles	6
Number of options	5
dBA	42
Drying system	CrystalDry™ option
Third rack	Flexible 3rd Rack
Rack adjustability	Rackmatic®
Tub material	Stainless Steel
Control type	Touch Control
Concealed water heating element	Yes
Leak protection system	24/7 AquaStop®
NSF®-certified ³ sanitize option	Yes
Water softener	No
Five-level wash	Yes
ChildLock	No
Special features	InfoLight®
Efficiency	
Water usage per cycle	3.5
Energy efficiency class	Tier 1
ENERGY STAR® qualified	Yes
Total annual energy consumption (kWh)	269
Total annual water consumption (g)	623.5
Capacity	
Number of place settings	16

Technical Details	
Watts (W)	1440 W
Current (A)	12 Amps
Volts (V)	120 V
Frequency (Hz)	60 Hz
Power cord full length	67"
Power cord install length from edge of unit when facing the door (in) ⁴	Left – 45" Right – 56"
Minimum water pressure (lb/sin)	14
Length outlet hose (in)	79"
Dimensions & Weight	
Overall appliance dimensions (HxWxD) (in)	33 7/8" x 23 9/16" x 23 1/16"
Required cutout size (HxWxD) (in)	33 7/8" x 23 5/8" x 24"
Adjustable feet	Yes
Net weight (lbs)	99 lbs
Accessories–Optional	
Junction Box	SMZPCJB1UC
Bosch Dishwasher Water Supply Hose	SMZSH002UC
Drain Hose Extension Kit	SGZ1010UC
Dishwasher Accessory Kit	SMZ5000
Anti-Tarnish Silverware Cassette	SMZ5002UC
Edge Protector + Power Cord Clip Install Kit	SMZEPCC1UC
Stainless Steel Straight Bosch Bar Handle	SMZ1007UC

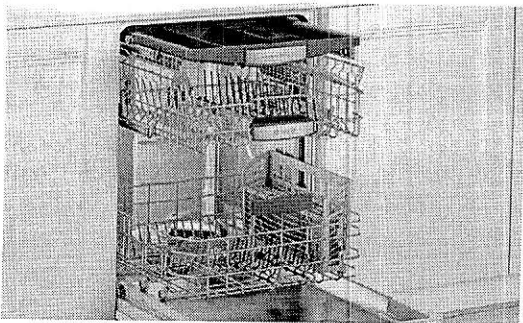
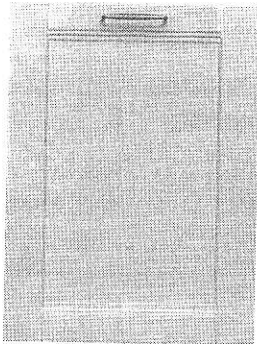

¹Based on aggregate average drying performance of Bosch Dishwashers with CrystalDry on combined household load including plastics, glass, steel, and porcelain as compared to Bosch Dishwashers with PureDry. Drying performance may vary by dish type.

²Compared to a Bosch dishwasher with 2 racks.

³Certification to NSF/ANSI Standard 184 for residential dishwashers.

⁴September 2020 running production change to remove adhesive routing clips for power cord. These clips and the edge protector are now included in the dishwasher accessory kit # SMZEPCC1UC.

Accessories: To purchase Bosch accessories, cleaners & parts please visit www.bosch-home.com/us/store or call 1-800-944-2904 (Mon to Fri 5 am to 6 pm PST, Sat 6 am to 3 pm PST).

Notes: All height, width and depth dimensions are shown in inches. BSH reserves the absolute and unrestricted right to change product materials and specifications, at any time, without notice. Consult the product's installation instructions for final dimensional data and other details prior to making cutout.

Warranties: Please see Use & Care manual or Bosch website for statement of limited warranty.

For more information on our entire line of products, go to www.bosch-home.com/us or call 1-800-944-2904

© BSH Home Appliances Corporation. All rights reserved. Bosch is a registered trademark of Robert Bosch GmbH.

24" Custom Panel Dishwasher

800 Series – Custom Panel SHVM78Z53N



Installation Details

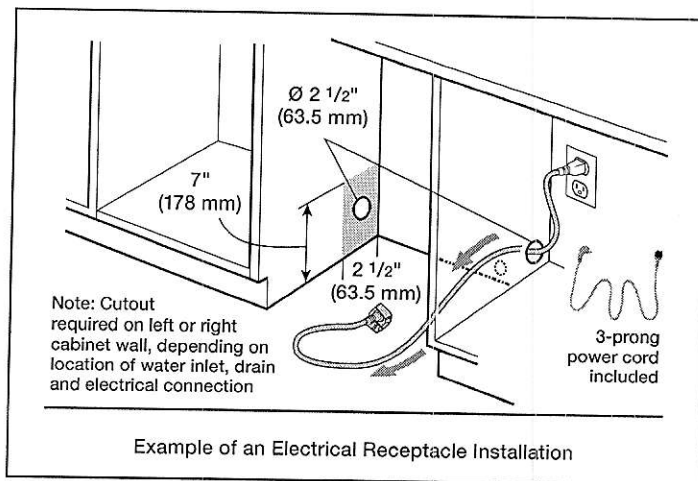
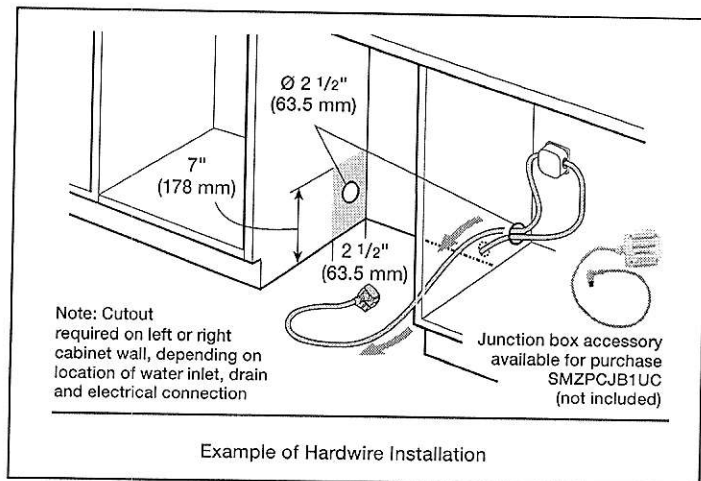
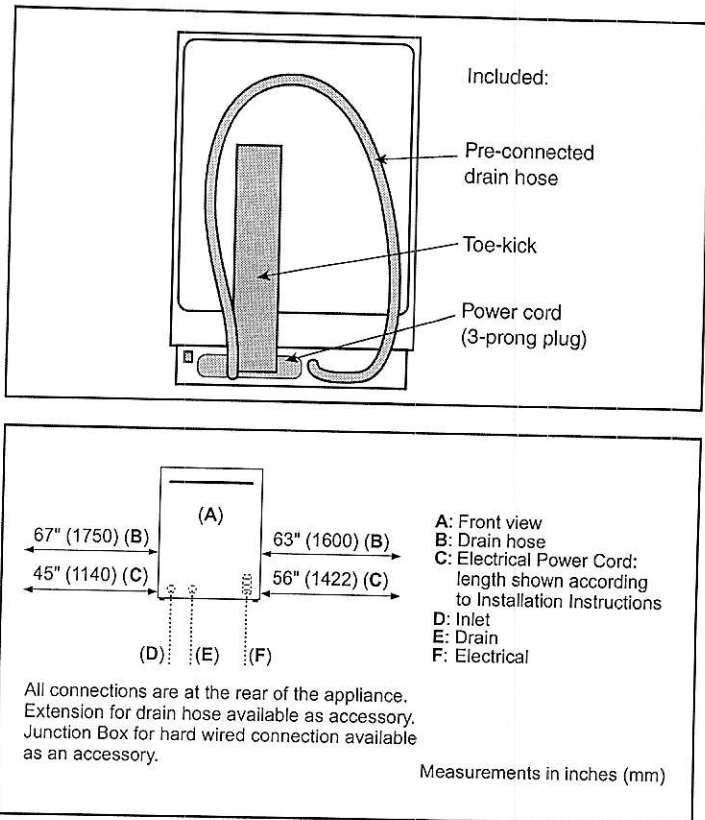
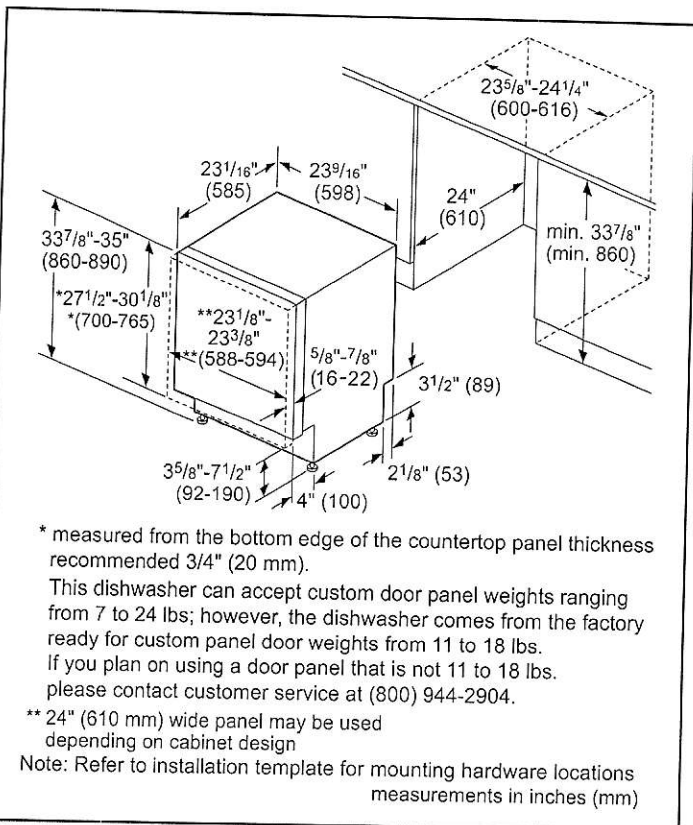

Accessories: To purchase Bosch accessories, cleaners & parts please visit www.bosch-home.com/us/store or call 1-800-944-2904 (Mon to Fri 5 am to 6 pm PST, Sat 6 am to 3 pm PST).
Notes: All height, width and depth dimensions are shown in inches. BSH reserves the absolute and unrestricted right to change product materials and specifications, at any time, without notice. Consult the product's installation instructions for final dimensional data and other details prior to making cutout.

Warranties: Please see Use & Care manual or Bosch website for statement of limited warranty.

For more information on our entire line of products, go to www.bosch-home.com/us or call 1-800-944-2904

© BSH Home Appliances Corporation. All rights reserved. Bosch is a registered trademark of Robert Bosch GmbH.

24" Custom Panel Dishwasher

800 Series – Custom Panel SHVM78Z53N



Installation Details

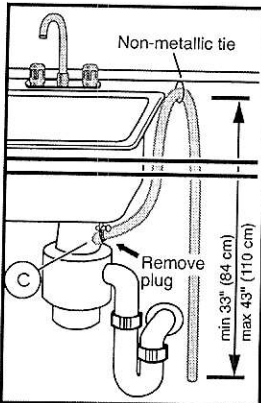
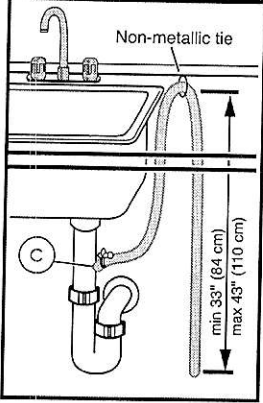

Note: Plumbing installations will vary - refer to local codes. Drain hose included is 79" (201 cm) and can be extended to a maximum of 155 3/4" (396 cm).

Always use the approved drain hose extension kit (SGZ1010UC).

Ensure a portion of the drain hose is raised between min. 33" (84 cm) and max. 43" (110 cm) above the cabinet floor.

Accessories: To purchase Bosch accessories, cleaners & parts please visit www.bosch-home.com/us/store or call 1-800-944-2904 (Mon to Fri 5 am to 6 pm PST, Sat 6 am to 3 pm PST).

Notes: All height, width and depth dimensions are shown in inches. BSH reserves the absolute and unrestricted right to change product materials and specifications, at any time, without notice. Consult the product's installation instructions for final dimensional data and other details prior to making cutout.

Warranties: Please see Use & Care manual or Bosch website for statement of limited warranty.

For more information on our entire line of products, go to www.bosch-home.com/us or call 1-800-944-2904

© BSH Home Appliances Corporation. All rights reserved. Bosch is a registered trademark of Robert Bosch GmbH.

- light valence
- Upgrade 2
- Upgrade 2 hardware
- two tone kitchen
- soft close doors + drawers

PM
SS

Pie Cut Corner / Lazy Susan
Angled Upper Corner / Frosted Glass

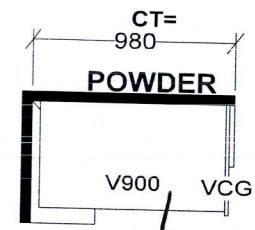
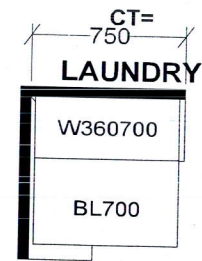
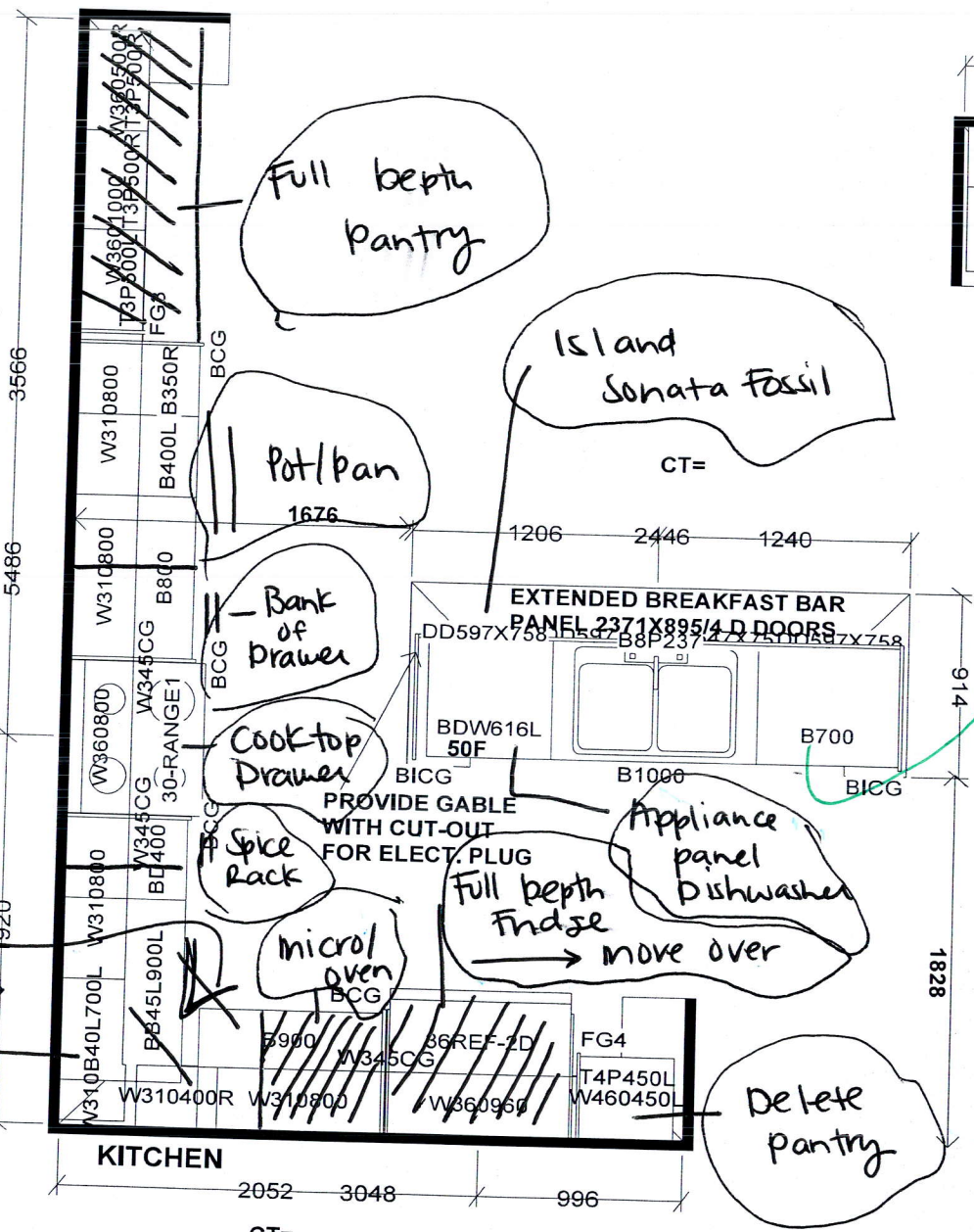

Upgrade 2 Cabinet + hardware

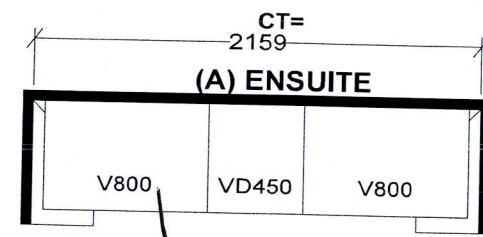

Upgrade 2 cabinet + hardware

Recycle / Garbage



SS

PM

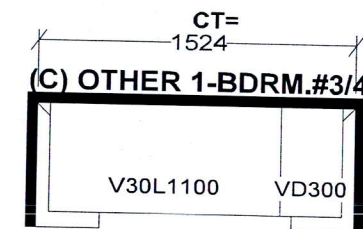

Revised

Selba Industries			J #
WWIDTH	WHGHT	WCNT	This drawing is the intellectual property of SELBA INDUSTRIES INC. and is an original design which must not be released or copied unless applicable fee has been paid or job order placed. JOB NUMBER: BUILDER: GREENPARK SITE: RUSSELL GARDENS PH.4 MODEL: VALLEYCREEK 2X EL 1,2,3 LOT #: DESIGNER: KS DATE: APR 28 21
FLOOR HGHT	DOOR HGHT		
ST CENT	2X4	VENT BOX COVER	