

CONSTRUCTION SUMMARY				
Mountainview Heights 3 (G) - Russell Gardens Building Ltd.				
PURCHASERS: Olumuyiwa THOMAS and Marlene I. THOMAS			TEL: RES.: 437-217-2255	
LOT / PHASE	REG. PLAN #	HOUSE TYPE		
356 / 4	62M-1266	Springfield Two (4 Bedroom) Elev 2		

CABINETRY

1 - KITCHEN - DELETE CABINETS ABOVE STOVE - VENDOR WILL SUPPLY 6 INCH VENT AS PER CONSTRUCTION SPECIFICATIONS AND VENT MAY NOT BE IN THE APPROPRIATE LOCATION FOR INSTALLATION OF PURCHASER SUPPLIED VENT - PURCHASER TO SUPPLY OWN FAN AFTER CLOSING 10Dec21 Note: TEMPORARY HOOD FAN MAY BE PROVIDED	
1 - KITCHEN CABINETRY - TWO COLOUR KITCHEN - FLAT FEE 10Dec21 Note:	
1 - CABINETRY - KITCHEN - UPGRADE 2 10Dec21 Note:	

CABINETRY ACCESSORIES

1 - KITCHEN CABINETRY BASE - PIE CUT CORNER CABINET - BASE CABINETRY - UPGRADE 2 10Dec21 Note:	
1 - KITCHEN - CREATE OPENING FOR WINE FRIDGE 10Dec21 Note:	
1 - KITCHEN CABINETRY BASE - EXTEND 4' OF SHALLOW BASE CABINETRY FROM 12" TO 24" DEPTH - SEE SKETCH - UPGRADE 2 10Dec21 Note:	
1 - KITCHEN CABINETRY BASE - PULLOUT RECYCLE 2 BIN - PRICE IS EACH 10Dec21 Note:	
1 - RELOCATE SINGLE DOOR CABINET ON EITHER SIDE OF HOOD - SEE SKETCH FOR LOCATION 10Dec21 Note:	
1 - KITCHEN CABINETRY UPPER - ADD APPROX 1' OF UPPER CABINETS - FITS TALL UPPER CABINETS - UPGRADE 2 10Dec21 Note:	
1 - KITCHEN CABINETRY BASE - ADD APPROX 2' OF BASE CABINETRY TO FILL IN SPACE BELOW DESK - UPGRADE 2 10Dec21 Note:	
2 - KITCHEN CABINETRY UPPER - GLASS DOOR - CLEAR - FINISHED INTERIOR - FITS TALL UPPER CABINETS - PRICE IS PER DOOR - UPGRADE 2 10Dec21 Note:	
3 - KITCHEN CABINETRY BASE - POT/PAN DRAWERS (CABINET) - UPGRADE 2 10Dec21 Note:	
2 - KITCHEN CABINETRY BASE - PULLOUT WIRE SPICE RACK - PRICE IS EACH 10Dec21 Note:	
1 - KITCHEN CABINETRY BASE - BANK OF DRAWERS - UPGRADE 2 10Dec21 Note:	
1 - KITCHEN CABINETRY - BUILT-IN MICROWAVE (ADD TO EXISTING FULL DEPTH PANTRY) - UPGRADE 2 10Dec21 Note: NOTE: NOT TO BE INSTALLED AT EYE LEVEL	
1 - PANTRY UNIT UPGRADE - TO GO FROM 300MM TO 600MM DEEP - PRICE IS PER FOOT - UPGRADE 2 10Dec21 Note:	

CONSTRUCTION SUMMARY

Mountainview Heights 3 (G) - Russell Gardens Building Ltd.

PURCHASERS: Olumuyiwa THOMAS and Marlene I. THOMAS

TEL: RES.: 437-217-2255

LOT / PHASE	REG. PLAN #	HOUSE TYPE		
356 / 4	62M-1266	Springfield Two (4 Bedroom) Elev 2		

1 - PLUG - ELECTRICAL PLUG WITH GFI - INSTALLED BESIDE TOILET FOR FUTURE WASHLET - MASTER ENSUITE BATHROOM 10Dec21 Note:	
3 - FAN - BATHROOM EXHAUST FAN - ENERGY STAR 80 CFM - IN LIEU OF STANDARD FAN - ALL ENSUITE BATHROOMS 10Dec21 Note:	
1 - POT LIGHT - SHOWER POT LIGHT - ENSUITE 4 BATHROOM 10Dec21 Note:	
1 - PLUG - ELECTRICAL PLUG - INSTALLED 5 FEET FROM FLOOR - FAMILY ROOM 10Dec21 Note:	
1 - PLUG - ELECTRICAL PLUG - TO BE INSTALLED OVER FIREPLACE 10Dec21 Note:	
1 - RELOCATE STANDARD KITCHEN LIGHT TO BE CENTERED OVER ISLAND 10Dec21 Note:	
1 - POT LIGHT - LED - FIRST FLOOR INSTALLATION - INSTALLED ON SEPERATE SWITCH - KITCHEN 10Dec21 Note:	
1 - POT LIGHT - LED - FIRST FLOOR INSTALLATION - INSTALLED ON SEPERATE SWITCH FROM STANDARD LIGHT - DINING ROOM 10Dec21 Note:	
1 - STANDARD DINING ROOM LIGHT TO BE CENTERED BETWEEN LIVING AND DINING ROOM 10Dec21 Note:	
1 - PLUG - ELECTRICAL PLUG WITH GFI AND SWITCH - FOR FESTIVE LIGHTING 11Jun21 Note:	
1 - 200 AMP ELECTRICAL SERVICE 11Jun21 Note:	

FIREPLACE AND ACCESSORIES

1 - GAS LINE ROUGH-IN FOR BARBECUE - FIRST FLOOR 10Dec21 Note:	
---	--

HARDWOOD FLOORING

1 - HARDWOOD - GROUP B SERIES 5 INCH - IN LIEU OF STANDARD TILE - KITCHEN & BREAKFAST 10Dec21 Note:	
1 - LAMINATE - UPGRADE TO PARKLANE SERIES IN LIEU OF STANDARD LAMINATE 10Dec21 Note:	
1 - HARDWOOD - GROUP B SERIES 5 INCH - IN LIEU OF 2 1/4 INCH NATURAL RED OAK - - MAIN HALL 10Dec21 Note:	
1 - HARDWOOD - GROUP B SERIES 5 INCH - IN LIEU OF 2 1/4 INCH NATURAL RED OAK - - LIVING AND DINING ROOM 10Dec21 Note:	
1 - HARDWOOD - GROUP B SERIES 5 INCH - IN LIEU OF 2 1/4 INCH NATURAL RED OAK - - LIBRARY/DEN 10Dec21 Note:	

CONSTRUCTION SUMMARY

Mountainview Heights 3 (G) - Russell Gardens Building Ltd.

PURCHASERS: Olumuyiwa THOMAS and Marlene I. THOMAS

TEL: RES.: 437-217-2255

LOT / PHASE 356 / 4	REG. PLAN # 62M-1266	HOUSE TYPE Springfield Two (4 Bedroom) Elev 2		
------------------------	-------------------------	--	--	--

1 - KITCHEN CABINETRY UPPER - FULL DEPTH ABOVE FRIDGE - WITH GABLES - 600MM - PRICE IS EACH - UPGRADE 2
10Dec21 Note:

CERAMIC TILE

1 - DELETE ALL CERAMIC BATHROOM ACCESSORIES - DELETE TOWEL BAR, PAPER HOLDER & SOAP DISH THROUGHOUT
10Dec21 Note:

1 - TILE - UPGRADE 4 FLOOR TILE - - POWDER ROOM
10Dec21 Note:

1 - TILE - UPGRADE 4 FLOOR TILE - - FOYER
10Dec21 Note:

CONSTRUCTION

1 - PROVISION FOR SHAMPOO NICHE APPROX. 24" WIDE X 20" HIGH AS PER SKETCH - IF CONSTRUCTION PERMITS - MASTER ENSUITE BATHROOM
10Dec21 Note:

3 - ENLARGE BASEMENT WINDOWS (MAY REQUIRE WINDOW WELLS) - WINDOW IS 30 INCHES X 24 INCHES
11Jun21 Note:

1 - SMOOTH CEILINGS ON FIRST FLOOR ONLY - DET
11Jun21 Note:

COUNTER TOP

1 - SHAMPOO NICHE 24" WIDE X 20" HIGH AS PER SKETCH - MARBLE, GRANITE OR QUARTZ - IF CONSTRUCTION PERMITS - REQUIRES PROVISION FROM CONSTRUCTION - MASTER ENSUITE BATHROOM
10Dec21 Note: SUPPLY & INSTALL

1 - KITCHEN - EXTEND FOR OVERHANG ON ONE SIDE OF ISLAND - SEE SKETCH
10Dec21 Note:

1 - KITCHEN - UPGRADE QUARTZ COUNTERTOP IN LIEU OF STANDARD GRANITE AS PER OFFER
10Dec21 Note:

DOORS AND TRIM

1 - TRIM - UPGRADE 1- 5-¼" ONE STEP ONE BASEBOARD AND ONE STEPP BB CASING
10Dec21 Note:

1 - DOOR - EXTERIOR - FRENCH - CLEAR GLASS - BOTH DOORS ARE OPERABLE - IN LIEU OF SLIDING PATIO DOOR
28Sep21 Note:

ELECTRICAL

1 - PLUG - ELECTRICAL PLUG - FOR WINE FRIDGE
10Dec21 Note:

1 - PLUG - ELECTRICAL PLUG - FOR BUILT-IN MICROWAVE
10Dec21 Note:

1 - PLUG - ELECTRICAL PLUG - INSTALLED 5' FROM FLOOR - FLEX ROOM
10Dec21 Note:

CONSTRUCTION SUMMARY

Mountainview Heights 3 (G) - Russell Gardens Building Ltd.

PURCHASERS: Olumuyiwa THOMAS and Marlene I. THOMAS

TEL: RES.: 437-217-2255

LOT / PHASE	REG. PLAN #	HOUSE TYPE		
356 / 4	62M-1266	Springfield Two (4 Bedroom) Elev 2		

1 - HARDWOOD - GROUP B SERIES 5 INCH - IN LIEU OF 2 1/4 INCH NATURAL RED OAK - - FAMILY ROOM
10Dec21 Note:

MIRRORS AND GLASS

1 - POWDER ROOM & MASTER ENSUITE BATHROOM - DELETE STANDARD MIRRORS - DO NOT INSTALL
10Dec21 Note:

1 - MASTER ENSUITE – FRAMELESS GLASS SHOWER ENCLOSURE – INCLUDES CHROME KNOB AND HINGES
11Jun21 Note:

PLUMBING

1 - KITCHEN - RELOCATE BAR SINK BELOW WINDOW - SEE SKETCH
10Dec21 Note:

1 - SOAP DISPENSER - CHROME FINISH - MOEN 3942 - KITCHEN
10Dec21 Note:

1 - SINK - UNDERMOUNT SINK - BLANCO QUATRUS R15 U SUPER SINGLE #401518
10Dec21 Note:

1 - KITCHEN ISLAND SINK- SHIFT TO ONE SIDE FACING STOVE- SEE SKETCH
11Jun21 Note:

PROMOTIONAL

1 - LESS CREDIT FROM PURCHASER EXTRA SHEET IN OFFER
11Jun21 Note:

STAIRS AND RAILINGS

1 - STAIRCASE - V GROOVE HANDRAIL
10Dec21 Note:

1 - STAIRCASE - 1 1/4" SQUARE PICKETS
10Dec21 Note:

1 - STAINED STAIRS – STANDARD STAIRCASE - PRICE IS PER SET
10Dec21 Note:

EXTRAS AS PER OFFER

PURCHASER(S) ACKNOWLEDGES THAT THE PURCHASE PRICE IS INCLUSIVE OF ALL CREDITS AND PROMOTIONAL PACKAGES AVAILABLE AT TIME OF PURCHASE.
Worksheet Note:

(1) The Vendor agrees that notwithstanding any other term or provision in this Agreement included in the Purchase Price and in addition to those items detailed in Schedule GP to the Agreement of Purchase and Sale, the Purchaser is entitled to a credit of
Worksheet Note:

Granite kitchen counter top, from Vendor's standard samples
Worksheet Note:

Purchasers:

Telephone Res. / Bus:

Decor Advisor:

Lock Date:

Olumuyiwa THOMAS & Marlene I. THOMAS

(437) 217-2255 /

Candace Forza

10-Dec-21

Property: 356

Project: Russell Gardens Building Ltd.

Model and Elevation: Springfield Two (4 Bedroom) Elev 2

Plan #: 62M-1266

Layout Changes:

Sketch Attached:

Exterior Colour Scheme:

☐ Yes

☒ No

☒ Yes

☐ No

1. Cabinetry

	Style and Colour	Hardware
Kitchen / Breakfast	SEE BELOW	431SA
Laundry Room	ELISSE	Standard
Powder Room	MONACO 823 DRIFT WOOD	447SA
Master Ensuite Bathroom	CONTINENTAL 350 PLATINUM SILVER	431SA
Ensuite Bath - Bedroom 2/3	DORAL K44 TITAN GREY	431SA
Ensuite Bath - Bedroom 4	DORAL K44 TITAN GREY	431SA
	N/A	N/A
	N/A	N/A
	N/A	N/A

Appliances:

Built In Appliances

Slide In Stove

☐ Yes

☒ No

☐ Closed

☒ Open

☒ Yes

☐ No

Please NOTE: Standard Cabinet Height is 30"

NOTE: If not specified, opening will be set to builder's standard opening of approximately 30" width

NOTE: If not specified, opening will be set to builder's standard opening of approximately 37" width x 74" height

KITCHEN - BASE CABINETRY, PANTRIES & FULL DEPTH FRIDGE UPPER - SONATA FOSSIL

UPPER CABINETRY - SONATA SATIN SNOW

** Refer to Construction Summary

2. Counters

	Counter	Edge
Kitchen / Breakfast	QUARTZ-GRECALE	#360
Laundry Room	N/A	
Powder Room	LAMINATE-PALOMA POLAR 6698-46	
Master Ensuite Bathroom	LAMINATE-WHITE CARRARA 4924-38	
Ensuite Bath - Bedroom 2/3	LAMINATE-PALOMA POLAR 6698-46	
Ensuite Bath - Bedroom 4	LAMINATE-WHITE CARRARA 4924-38	
	N/A	
	N/A	
	N/A	

** Refer to Construction Summary

Purchasers:Olumuyiwa THOMAS & Marlene I. THOMAS

Property: 356

Telephone Res. / Bus: (437) 217-2255 /

Project: Russell Gardens Building Ltd.

Decor Advisor: Candace Forza

Model and Elevation: Springfield Two (4 Bedroom) Elev 2

Lock Date: 10-Dec-21

10-Dec-21

Plan #: 62M-1266

3. Ceramic Flooring

At a 45 Threshold-If App.

Entrance Vestibule	TILE-AGATA WHITE POLISHED-24X24	<input type="checkbox"/>	metal strip where applicable
Main Hall	STRIP	<input type="checkbox"/>	
Kitchen / Breakfast	STRIP	<input type="checkbox"/>	
Laundry Room	TILE-CONCEPT 603 BLACK-13X13	<input type="checkbox"/>	
Powder Room	TILE-AGATA WHITE POLISHED-24X24	<input type="checkbox"/>	
Master Ensuite Bathroom	TILE-CONCEPT 603 BLACK-13X13	<input type="checkbox"/>	
Ensuite Bath - Bedroom 2/3	TILE-ESSENZE GRIGIO-13X13	<input type="checkbox"/>	
Ensuite Bath - Bedroom 4	TILE-ESSENZE GRIGIO-13X13	<input type="checkbox"/>	
Mud Room	TILE-ESSENZE GRIGIO-13X13	<input type="checkbox"/>	
	N/A	<input type="checkbox"/>	
	N/A	<input type="checkbox"/>	

** Refer to Construction Summary

4. Ceramic Wall Tile

Master Ensuite Bathroom	Selection	Describe
Tub Deck Wall	N/A	
Tub Deck	N/A	
Tub Deck Skirt	N/A	
Shower Stall	TILE-SILVIA WHITE-8X16	NICHE - QUARTZ - ISTRIA
Bathtub Enclosure Walls	N/A	
Ensuite Bath - Bedroom 2/3	TILE-CONCEPT DARK GREY-8X16	
Ensuite Bath - Bedroom 4	TILE-EXTRA WHITE/GREY-8X16	
Mud Room	N/A	
	N/A	
	N/A	
Kitchen Backsplash	N/A	

** Refer to Construction Summary - STANDARD GROUT THROUGHOUT UNLESS SPECIFIED

5. Plumbing Fixtures

All Bathrooms

White

N/A

N/A

N/A

N/A

N/A

Whirlpool

N/A

☐ Yes

☒ No

Dishwasher Rough-In

☒ Yes

☐ No

Waterline for Fridge

☒ Yes

☐ No

** Refer to Construction Summary

6. Trim Carpentry

Interior Doors	CARRARA-SMOOTH
Interior Trim	BB CASING WITH 5 1/4" BASEBOARD - ONE STEP
Door Handles	As Per Construction Specifications
Exterior Front Door Handle	As Per Construction Specifications

** Refer to Construction Summary

Purchasers:

Telephone Res. / Bus:

Decor Advisor:

Lock Date:

Olumuyiwa THOMAS & Marlene I. THOMAS

(437) 217-2255 /

Candace Forza

10-Dec-21

Property: 356

Project: Russell Gardens Building Ltd.

Model and Elevation: Springfield Two (4 Bedroom) Elev 2

Plan #: 62M-1266

7. Other Flooring		
Main Hall	STRIP-MIRAGE-ESCAPE-ENGRAVED-CHARACTER-MAPLE-CASHMERE-DESTIN-5"	
Living Room	STRIP-MIRAGE-ESCAPE-ENGRAVED-CHARACTER-MAPLE-CASHMERE-DESTIN-5"	
Dining Room	STRIP-MIRAGE-ESCAPE-ENGRAVED-CHARACTER-MAPLE-CASHMERE-DESTIN-5"	
Family Room	STRIP-MIRAGE-ESCAPE-ENGRAVED-CHARACTER-MAPLE-CASHMERE-DESTIN-5"	
Den / Library / Study	STRIP-MIRAGE-ESCAPE-ENGRAVED-CHARACTER-MAPLE-CASHMERE-DESTIN-5"	
Basement Landing(If Applies)	N/A	
Lower Landing (If Applies)	N/A	
Upper Landing	STRIP-MIRAGE-ESCAPE-ENGRAVED-CHARACTER-MAPLE-CASHMERE-DESTIN-5"	
Upper Hall	LAMINATE-PARKLANE-OLD OAK MATT OILED-TL-EL-312	
Master Bedroom	LAMINATE-PARKLANE-OLD OAK MATT OILED-TL-EL-312	
Bedroom #2	LAMINATE-PARKLANE-OLD OAK MATT OILED-TL-EL-312	
Bedroom #3	LAMINATE-PARKLANE-OLD OAK MATT OILED-TL-EL-312	
Bedroom #4	LAMINATE-PARKLANE-OLD OAK MATT OILED-TL-EL-312	
Bedroom #5	N/A	
KITCHEN & BREAKFAST	STRIP-MIRAGE-ESCAPE-ENGRAVED-CHARACTER-MAPLE-CASHMERE-DESTIN-5"	
FLEX ROOM	LAMINATE-PARKLANE-OLD OAK MATT OILED-TL-EL-312	
	N/A	
Underpad	Type	Area
	N/A	N/A

** Refer to Construction Summary

8. Railings and Pickets			
Railing Type	V-GROOVE	Complimenting Colour	MIRAGE DESTIN MAPLE COLOUR
Picket Type	1 3/4" SQUARE PICKETS	Complimenting Colour	MIRAGE DESTIN MAPLE COLOUR
Stringer / Riser	AS PER CONSTRUCTION SPECIFICATIO	Complimenting Colour	MIRAGE DESTIN MAPLE COLOUR
Treads	AS PER CONSTRUCTION SPECIFICATIO	Complimenting Colour	MIRAGE DESTIN MAPLE COLOUR
Red Oak Stairs <input checked="" type="radio"/> Yes <input type="radio"/> No			

** Refer to Construction Summary THE STAIN COLOURS OR FINISH AVAILABLE ON RISERS, TREADS, PICKETS AND RAILS (STAIRCASES), WILL NOT BE AN EXACT MATCH TO PREFINISHED HARDWOOD OR LAMINATE FLOORS.

9. Wall Paint Flat Finish			
Main & Upper Hall	22 WARM GREY	Master Bedroom	22 WARM GREY
Living Room	22 WARM GREY	Bedroom #2	22 WARM GREY
Dining Room	22 WARM GREY	Bedroom #3	22 WARM GREY
Kitchen / Breakfast	22 WARM GREY	Bedroom #4	22 WARM GREY
Family Room	22 WARM GREY	Bedroom #5	N/A
Powder Room	22 WARM GREY	Master Ensuite	22 WARM GREY
Laundry Room	22 WARM GREY	Ensuite Bath - Bedroom 2/3	22 WARM GREY
Den/Library	22 WARM GREY	Ensuite Bath - Bedroom 4	22 WARM GREY
Trim & Door Paint-Semi Gloss	BIRCH WHITE	FLEX ROOM	22 WARM GREY
	N/A		N/A
	N/A		N/A
Smooth Ceilings First Floor <input checked="" type="radio"/> Yes <input type="radio"/> No			

** Refer to Construction Summary

Purchasers: Olumuyiwa THOMAS & Marlene I. THOMAS Property: 356
Telephone Res. / Bus: (437) 217-2255 / Project: Russell Gardens Building Ltd.
Decor Advisor: Candace Forza Model and Elevation: Springfield Two (4 Bedroom) Elev 2
Lock Date: 10-Dec-21 10-Dec-21 Plan #: 62M-1266

10. Plaster Mouldings and Medallions

Entrance Vestibule	N/A	N/A	Kitchen/Breakfast	N/A	N/A
Main Hall	N/A	N/A	Den/Library	N/A	N/A
Living Room	N/A	N/A	Lower Landing	N/A	N/A
Dining Room	N/A	N/A		N/A	N/A
Family Room	N/A	N/A			

**** Refer to Construction Summary****11. Fireplace**

	Living Room			Family Room			Other Room - Specify		
	Purchased	As Per Plan	N/A	Purchased	As Per Plan	N/A	Purchased	As Per Plan	N/A
	<input type="radio"/>	<input type="radio"/>	<input checked="" type="radio"/>	<input type="radio"/>	<input checked="" type="radio"/>	<input type="radio"/>	<input type="radio"/>	<input type="radio"/>	<input checked="" type="radio"/>
Fireplace Type	N/A			FLAT ON WALL			N/A		
Mantle Type	N/A			MANTLE M2-STANDARD			N/A		
Colour / Stain	N/A			AS PER CONSTRUCTION SPECIFICATIONS			N/A		
Surround	N/A			GRIGIO CARNICO			N/A		
Hearth	N/A			NO			N/A		

**** Refer to Construction Summary****12. Heating and Air Conditioning**



Air Conditioning	NO	Gas Provisions Stove	NO
Gas Provisions Dryer	NO	Gas Provisions Barbecue	YES
Comment			

**** Refer to Construction Summary****13. Electrical**

Plugs and Switches	<input checked="" type="radio"/> White	DECOR	Above Kitchen Cabinet Light	<input type="radio"/> Yes <input checked="" type="radio"/> No
Hood Fan	STANDARD WHITE TEMP.		Below Kitchen Cabinet Light	<input type="radio"/> Yes <input checked="" type="radio"/> No
Appliances	Built in Cooktop	Built in Oven	Gas Stove	Microwave
	<input type="radio"/> Yes <input checked="" type="radio"/> No	<input type="radio"/> Yes <input checked="" type="radio"/> No	<input type="radio"/> Yes <input checked="" type="radio"/> No	<input checked="" type="radio"/> Yes <input type="radio"/> No
Dishwasher Rough-in	Yes			

**** Refer to Construction Summary****14. General Comments****** Refer to Construction Summary****Disclaimers and Notes**

- Colours of all materials are as close as possible to builder's selection, but not necessarily identical due to variances in manufacturing.
- Any extras listed above are null and void unless accompanied by a separate invoice/amendment. Said invoice must be paid in full.
- The Purchaser agrees that this colour selection is final and that no changes will be permitted, unless required by the Vendor.
- The Purchaser acknowledges reading and accepting document which contains other miscellaneous disclaimers.
- In the event of a conflict between the Standard Features schedule of the Agreement of Purchase and Sale and the Interior Colour Scheme, the Interior Colour Scheme shall prevail.

Signature:  Date: Signature:  Date:

FILE NAME:
RUSSELL GARDENS LOT 356 PH4

DEC 15 21 FB

RUSSELL GARDENS LOT 356 PH4
PROTOTYPE FOR EXTRAS

THIS LAYOUT CONTAINS EXTRAS
THAT ARE NOT PART OF CONTRACT

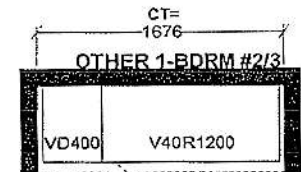
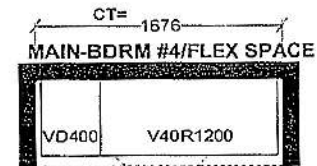
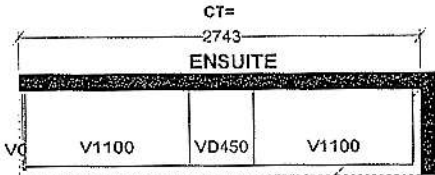
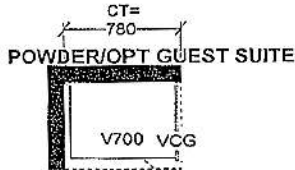
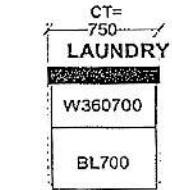
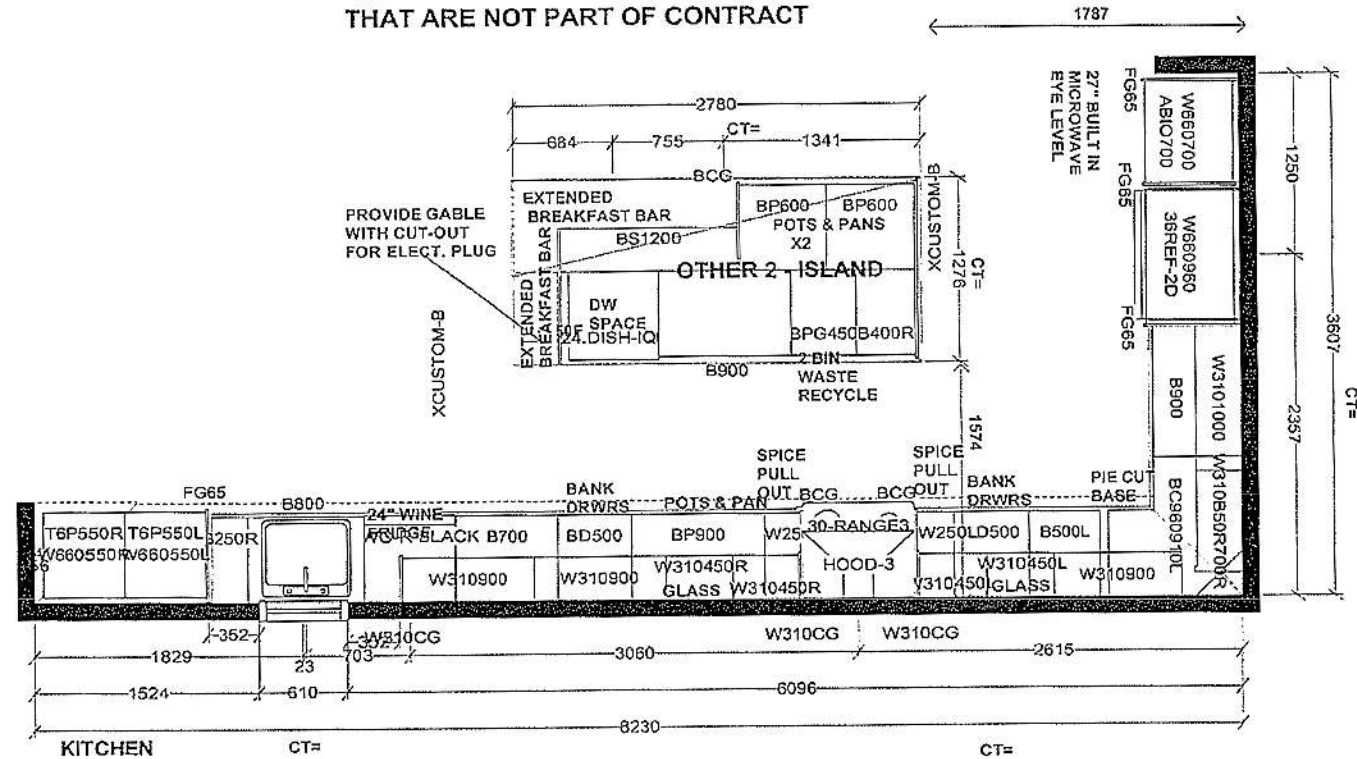

Selba Industries				J #
W WIDTH	W HGT	W CNT	This drawing is the intellectual property of SELBA INDUSTRIES INC. and is an original design which must not be released or copied unless a applicable fee has been paid or job order placed.	JOB NUMBER:
FLOOR HGHT	DOOR HGHT			BUILDER: GREENPARK
ST CENT	2X4	VENT BOX COVER		SITE: RUSSELL GARDENS PH.4
				MODEL: SPRINGFIELD 2X EL 1,2,3
			DESIGNER: LR	LOT #: 356
			DATE: APR 28 21	
			REV'D-SEPT 22 21	

RUSSELL GARDENS PH4
LOT. 356

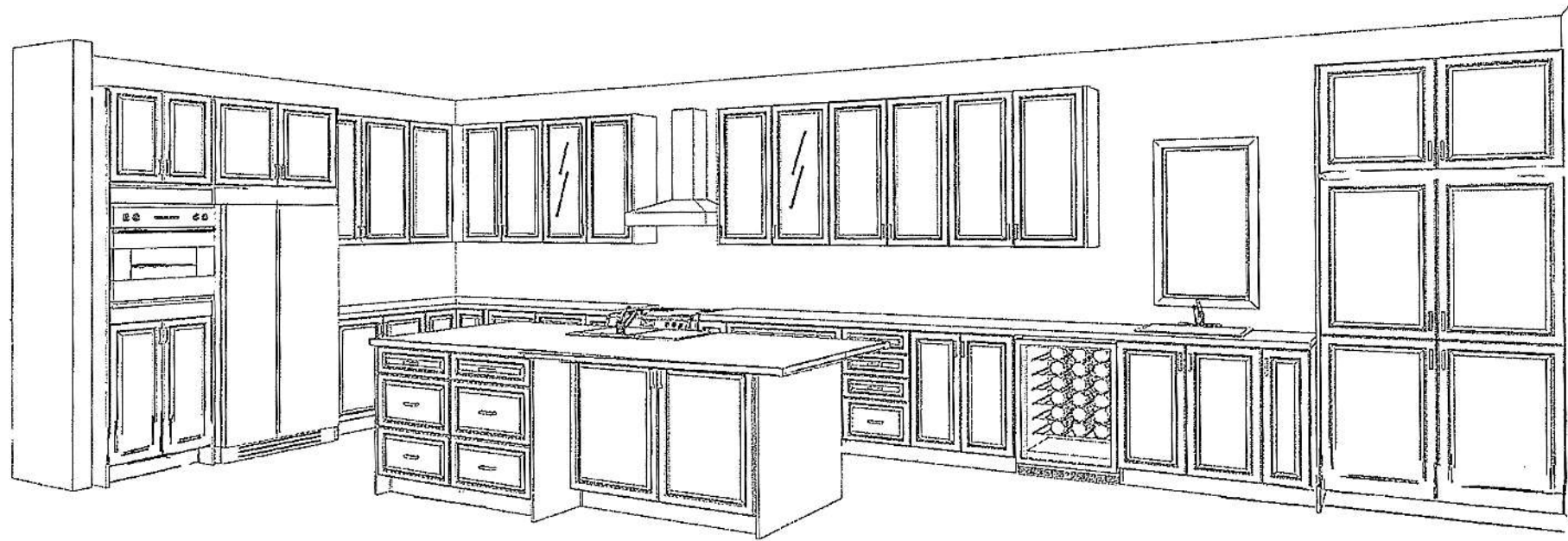

RUSSELL GARDENS PH4

LOT 356

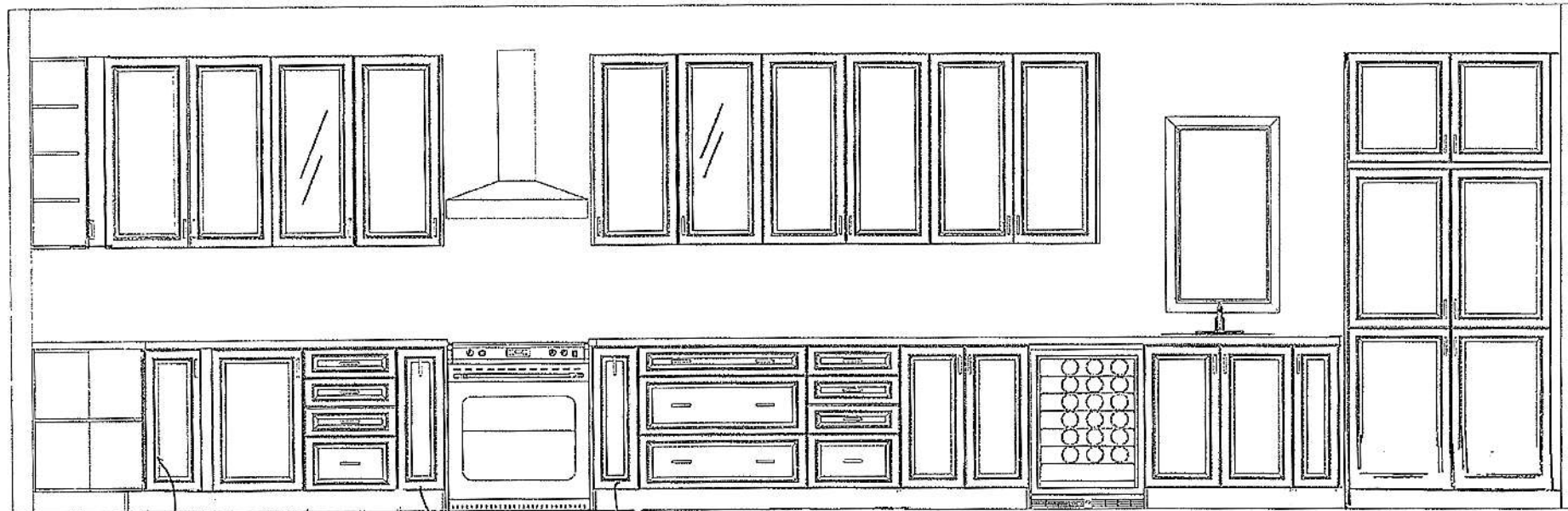

PIE CUT
BASE

SPICE
PULL
OUT

POTS & PAN

WINE
REF
24" W

RUSSELL GARDENS
PH4
LOT 356

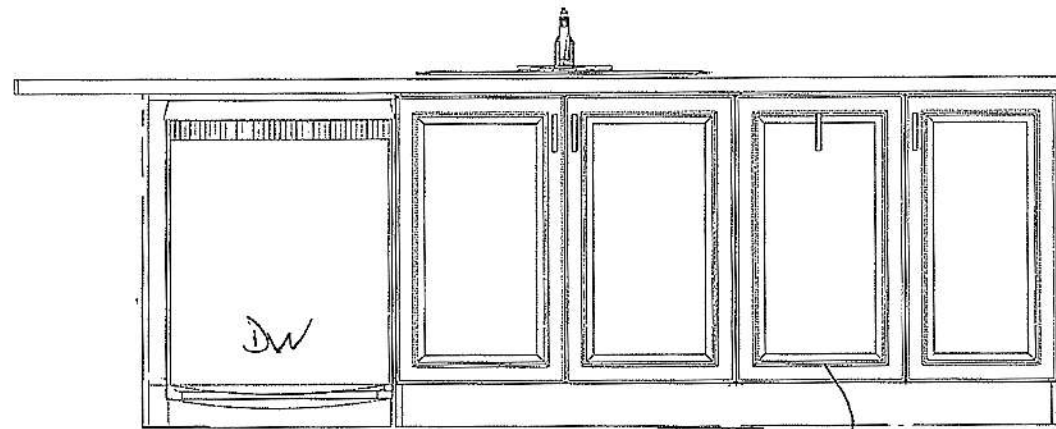

2 BIN
WASTE
RECYCLE

ISLAND FACING STOVE

RUSSELL GARDENS PH4
LOT 356

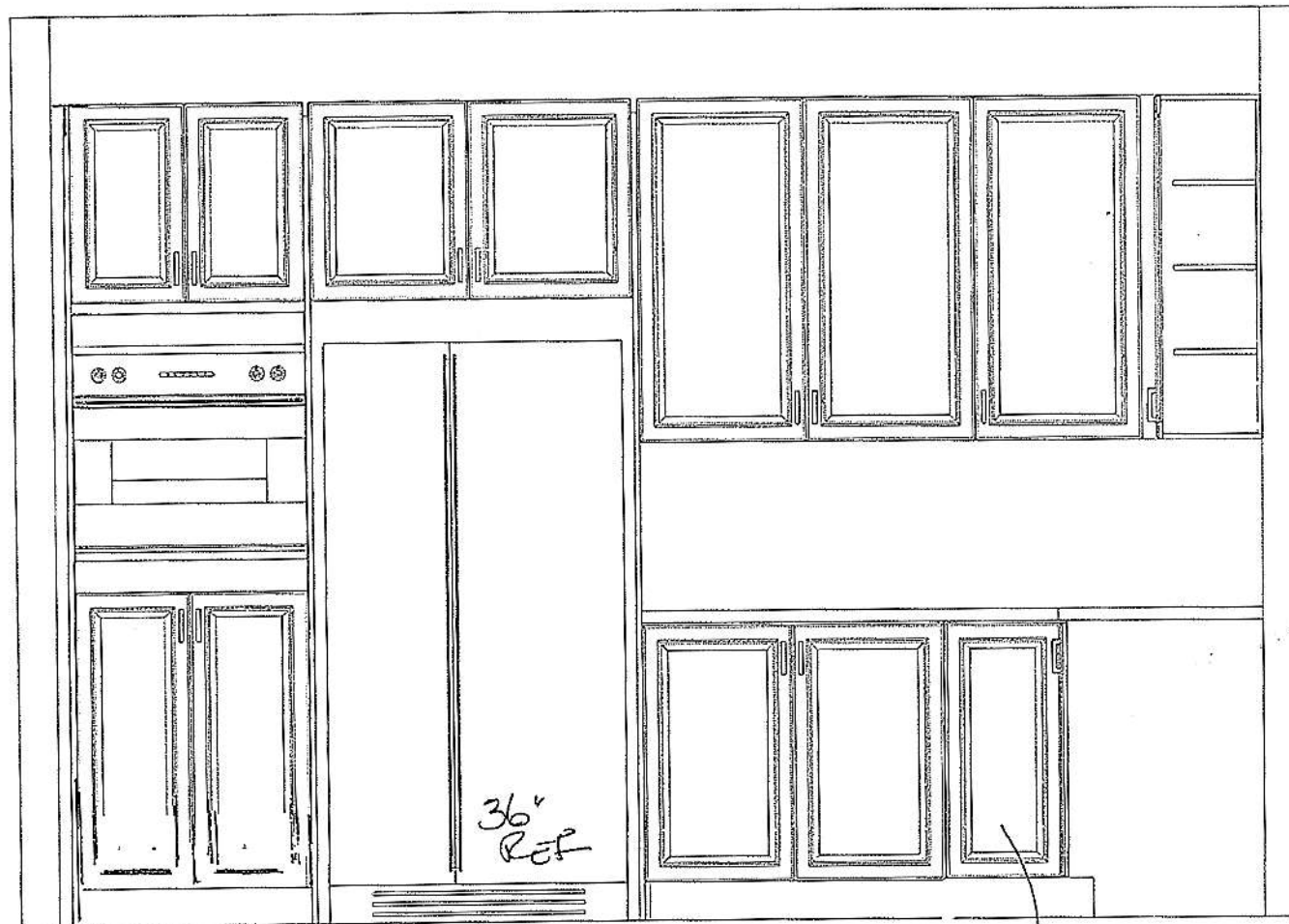

27" MICRO
EYE LEVEL

PIE CUT
BASE

PRODUCT DIMENSIONS

356.

Model features may vary.
Optional kickstrip shown is available (purchased separately).

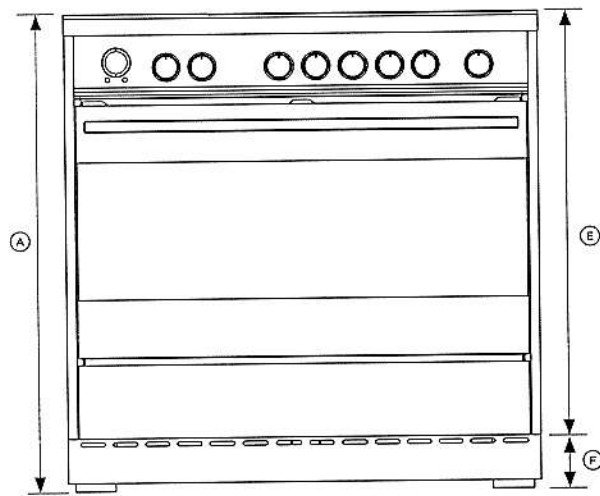

FRONT

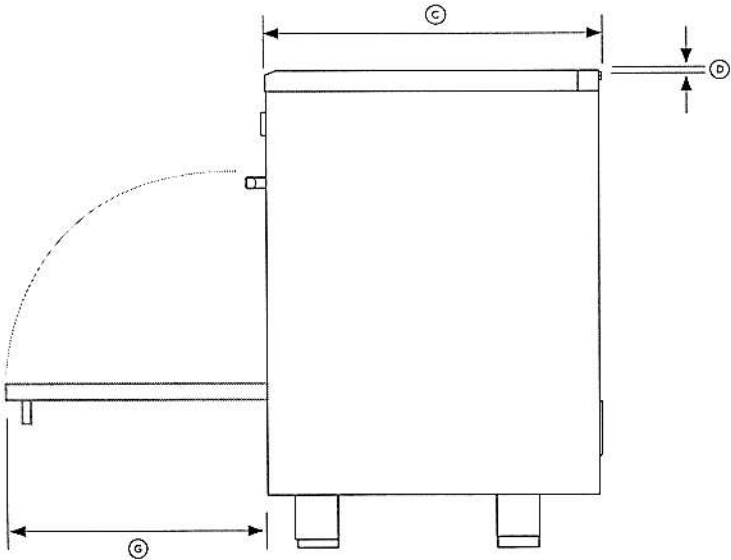

PROFILE

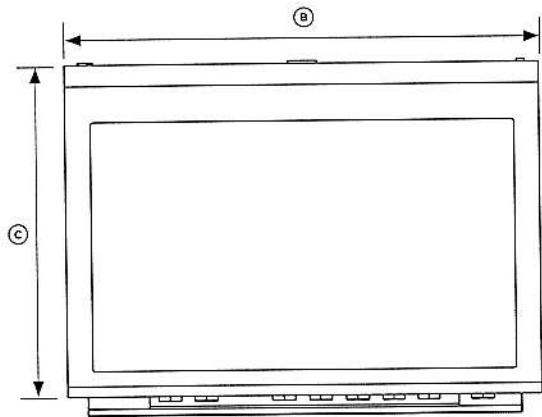

PLAN

PRODUCT DIMENSIONS	OR36SDI	
	INCHES	MM
Ⓐ Overall height of range (from floor to top of cooktop, excl. optional backguard)	min 35 3/8 max 37 1/4	min 898 max 946
Ⓑ Overall width of range	35 7/8	911
Ⓒ Overall depth of range (from front of range to rear of island trim/backguard, excl. handles and dials)	25 1/4	641
Ⓓ Height from top of cooktop to top of <ul style="list-style-type: none">▪ Island trim (fitted)▪ Backguard (optional)	Level with cooktop 3	Level with cooktop 76
Ⓔ Height of chassis (excluding adjustable feet)	32	813
Ⓕ Adjustable feet height	min 3 3/8 max 5 1/4	min 85 max 133
Ⓖ Depth of open door to front of range	17 3/4	451

CLEARANCE DIMENSIONS

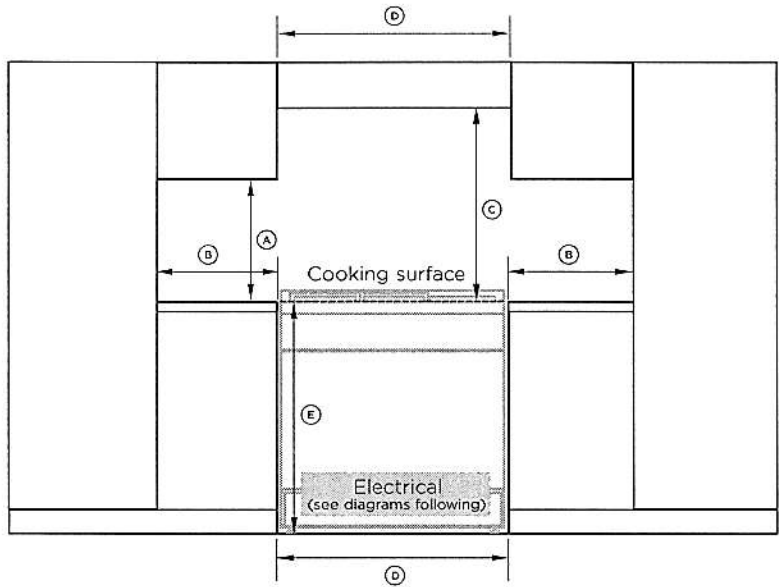

FRONT

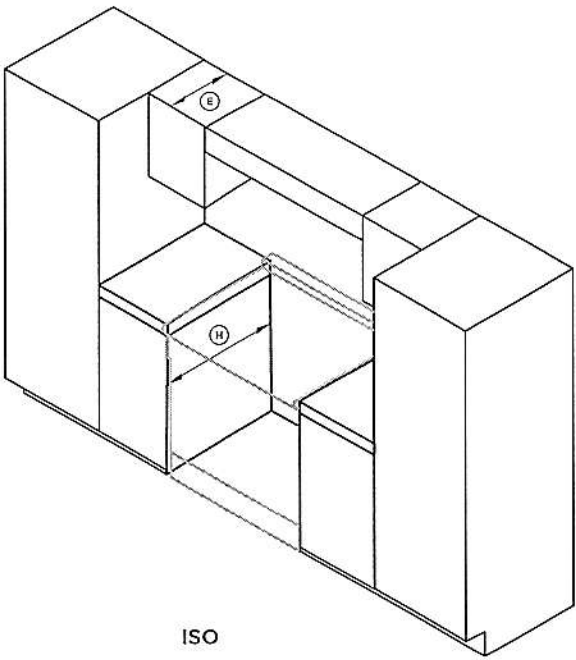

ISO

Note #1

To eliminate the risk of burns or fire by reaching over heated surface units, cabinet storage space located above the surface units should be avoided. If cabinet storage is to be provided, the risk can be reduced by installing a rangehood that projects horizontally a minimum of 5" (127mm) beyond the bottom of the cabinets.

Note #2

(D) = 30" (762mm) minimum clearance between the top of the cooking surface and the bottom of an unprotected wood or metal cabinet; or
(D) = 24" (610mm) minimum when bottom of wood or metal cabinet is protected by not less than 1/4"-thick flame retardant millboard covered with not less than No. 28 MSG sheet steel, 0.015"-thick stainless steel, 0.024"-thick aluminum, or 0.020"-thick copper.

Note

- This range may be installed directly adjacent to existing 36" (914mm) high base cabinets.
- If the range is to be placed adjacent to cabinets, the clearances shown are required. The same clearances apply to island installations.
- The range can be placed in various positions with respect to the cabinet front, with the control panel either flush or projecting, depending on the cabinetry depth.
- The electrical supply should be within the zones shown in the following diagrams.
- Any openings in the wall behind the range and in the floor under the range must be sealed.
- Always keep the appliance area clear and free from combustible materials, gasoline and other flammable vapors and liquids.
- Do not obstruct the flow of ventilation air to the unit.

CLEARANCE DIMENSIONS	OR36SDI	
	INCHES	MM
(A) Minimum width of ventilation hood installed above range	36	914
(B) Minimum vertical distance between countertop and cabinet extending above counter	18	457
(C) Minimum clearance from left and right edge of range to nearest vertical combustible surface	2	50
(D) Minimum clearance from cooking surface to: <ul style="list-style-type: none">• Overhead cabinet centered above the cooktop (combustible/unprotected) (see notes #1, #2)• Overhead cabinet centered above the cooktop (non-combustible/protected) (see notes #1, #2)• Ventilation hood** centered above the cooking surface	30 24 24	762 610 610
(E) Maximum depth of overhead cabinetry	13	330
(F) Width of cabinetry opening	36	914
(G) Maximum height of cabinetry immediately adjacent to the range (from floor to countertop)*	37 1/4	946
(H) Maximum depth from wall to cabinetry face	25 1/4	641

*Depending on the height of the feet adjustment. The cooking surface must sit flush or above countertop level.

**Refer to local/national codes for ventilation requirements.

Purchaser: Thomas
Lot: 356

Schedule SMART
Russell Gardens Building Ltd. (Phase 4)

Smart Home System includes:

1. One (1) Smart Home Hub installed in a location as determined by the Vendor;
2. One (1) Doorbell camera supplied and installed at front door;
3. One (1) smart home thermostat to be installed in a location as determined by the Vendor;
4. One (1) smart Flood sensor to be installed in a location as determined by the Vendor which is designed to detect water in the location of the sensor only;
5. Smart light switches to be installed in such locations as determined by the Vendor;



Certain devices for The Smart Home System require a fully functioning WiFi network and internet connection and others work on the Zwave wireless network. Provision of WiFi, internet access and functionality shall be the sole responsibility of the Purchaser and the Vendor assumes no responsibility or obligation with respect to the functionality or performance of a homeowner's internet or WiFi network. The Vendor does not guarantee that networks, equipment, or services will meet all homeowner needs.

The Purchaser will be required to download the Homewave Smart Connect App (the "App") in order to configure and set up the Smart Home System devices. The Purchaser is responsible to ensure that they have the appropriate technology to download the App and any charges and fees for download and/or data usage shall be at the Purchaser's sole cost and expense. Access to the App shall be provided free of charge for 1 year from the Closing Date and thereafter the Purchaser may enter into an agreement with Homewave Smart Connect to continue the services for a monthly fee (currently \$10.00/month plus HST). Fees subject to change without notice.

Purchasers are responsible for configuring all security features. The Vendor does not warrant or represent that any network or Smart Home System devices are secure or can prevent all privacy intrusions, malware, or cyber-attacks, even when correctly configured. The products and services for the Smart Home System are provided by third parties, and not the Vendor. The Vendor does not guarantee any equipment or services provided by third parties. If the Purchaser contracts with the third-party provider to upgrade or purchase further devices, the Vendor has no responsibility for same, including but not limited to, the installation, service, safety or functionality of said products.

Energy claims are not based upon specific testing of an individual home but are general assumptions. Savings will vary due to many variables, including but not limited to, actual utility rates and fees, actual construction, floor plan, occupancy, appliance usage, thermostat settings, weather conditions, number of individuals occupying the home and orientation of the home.

The Vendor is providing only those Smart Home System's devices and components listed in this Schedule. Please see the balance of your Agreement of Purchase and Sale for additional information, disclosures, and disclaimers relating to your home and its features. The specific features in a home may vary from home to home and from one community to another. The Vendor reserves the right to substitute equipment, material, appliances and brand names with items of equal or higher value, in its sole and unfettered discretion. The Vendor reserves the right, in its sole and absolute discretion, to omit installation of the Smart Home System, in part or in whole, and the Purchaser shall have no claim for abatement or reduction the Purchase Price or to any delay in closing. Installation of the Smart Home System may result in the elimination of other features listed in Schedule GP or other information material, such as but not limited to set back thermostat, rough-in for alarm or other features deemed redundant as a result of the installation of the Smart Home System.

Purchaser Initials	Purchaser Initials
	

FRIGIDAIRE GALLERY

CGMO226NUF

Smudge-Proof™
Stainless Steel

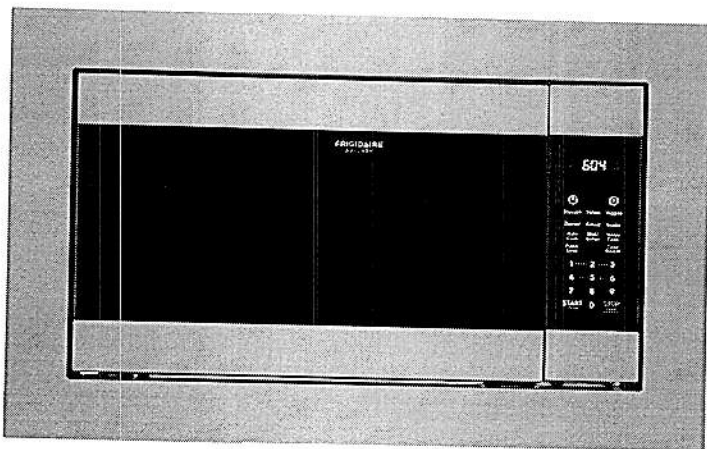

AVAILABLE COLOURS



SIGNATURE FEATURES

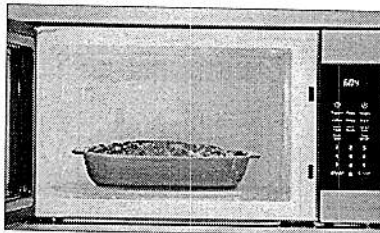

Fits-More™ Microwave
Extra-large microwave provides
2.2 cu. ft. of cooking space.

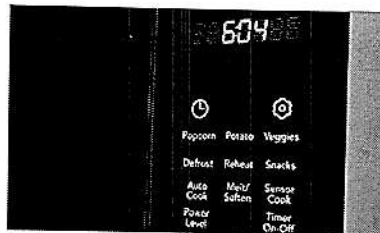

Sensor Cooking Options
Microwave automatically adjusts power
levels and cooking times to cook a variety
of items, effortlessly.

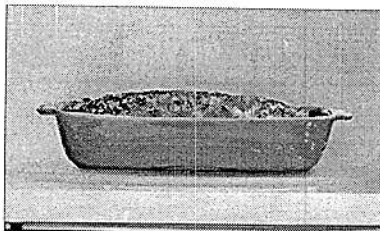

Over 30 Setting Options
Offers multiple settings to meet your
cooking needs, including chicken nuggets
and snacks.



One-Touch Options
Our microwaves feature easy-to-use
one-touch buttons so you can cook baked
potatoes, popcorn or even add 30 seconds
with the touch of a button.

MICROWAVE 24" BUILT-IN

PRODUCT DIMENSIONS

Height	13-5/8"
Width	24-7/16"
Depth	19-5/8"

MORE EASY-TO-USE FEATURES

Smudge-Proof™ Stainless Steel
Resists fingerprints and cleans easily.

Effortless™ Reheat
Reheat almost anything at the touch
of a button.

Built-In Trim Kit
Optional trim kit available in stainless and black
stainless steel trim in 27" or 30" diameter.

CGMO226NUF
MICROWAVE
24" BUILT-IN

FRIGIDAIRE
GALLERY.

FEATURES

Control/Timing System	Ready-Select*
Exterior Door Finish	Smudge-Proof™ Stainless
Handle Design	Push Button
Microwave Capacity (Cu.Ft.)	2.2
Watts (IEC-705 Test Procedure)	1,100
Interior Light	Yes
Interior Colour	White
Turntable Diameter	16-1/2"
Control Lock	Yes
Clock	Yes
Touch Pad Buttons	25
Power Levels	High (1-9)

MICROWAVE CONTROL OPTIONS

Popcorn Button	Yes
Baked Potato Button	Yes
Snack Button	Yes
Melt & Soften Options	2/2
Auto Reheat Options	4
Snack Menu Options	4
Auto Cook Options	4
Auto Defrost Options	3
Add-30-Seconds	Yes
Sensor Cooking Options	4
Vegetable Cook Sensor	Yes
User Preferences	Yes

POWER RATINGS

Frequency (MHz)	2,450
Watts @ 120 Volts	1,100
Amps @ 120 Volts	14.2

OPTIONAL ACCESSORIES

30" Stainless Steel Trim Kit	PN# MWTK30FGUF
27" Stainless Steel Trim Kit	PN# MWTK27FGUF

SPECIFICATIONS

Oven Interior (HxWxD)	11-1/4" x 17-7/8" x 19-1/8"
Power Supply Connection Location	Right Rear Top
Voltage Rating	120V/60Hz/15A
Connected Load (kW Rating) @ 120 Volts¹	1.7
Minimum Circuit Required (Amps)	15
Plug Type (NEMA)	LCDI (5-15P)
Shipping Weight (Approx.)	49 Lbs.

¹For use on adequately wired 120V dedicated circuit having 2-wire service with a separate ground wire. Appliance must be grounded for safe operation.

PRODUCT DIMENSIONS

A-Height	13-5/8"
B-Width	24-7/16"
C-Depth	19-5/8"
Depth with Door Open 90°	39"

CUTOUT DIMENSIONS

Height (Min.)	16-3/4"
Height (Max.)	17"
Width (Min.)	24-3/4"
Width (Max.)	25"
Depth (Min.)	20"

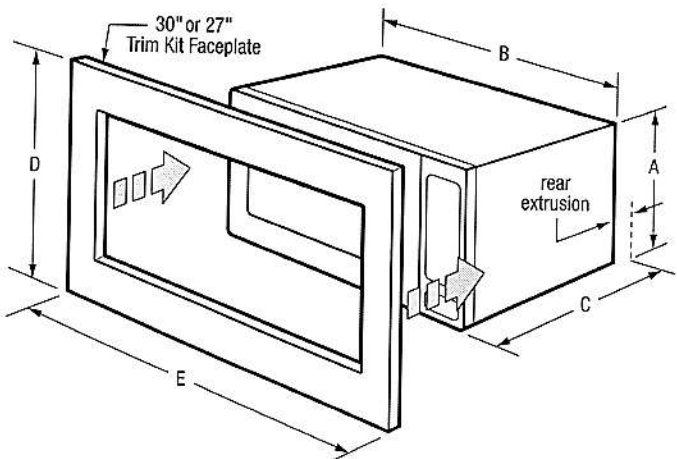

Note: For planning purposes only. Always consult local and national electric, gas and plumbing codes. Refer to Product Installation Guide for detailed installation instructions on the web at frigidaire.ca. Specifications subject to change. Accessories information available on the web at frigidaire.ca

FRIGIDAIRE

CANADA • 5855 Terry Fox Way • Mississauga, ON L5V 3E4 • 1-800-265-8352 • frigidaire.ca

CGMO226NU 09/18
© 2018 Electrolux Major Appliances, NA

CGMO226NUF
MICROWAVE
 24" BUILT-IN

FRIGIDAIRE
 GALLERY.

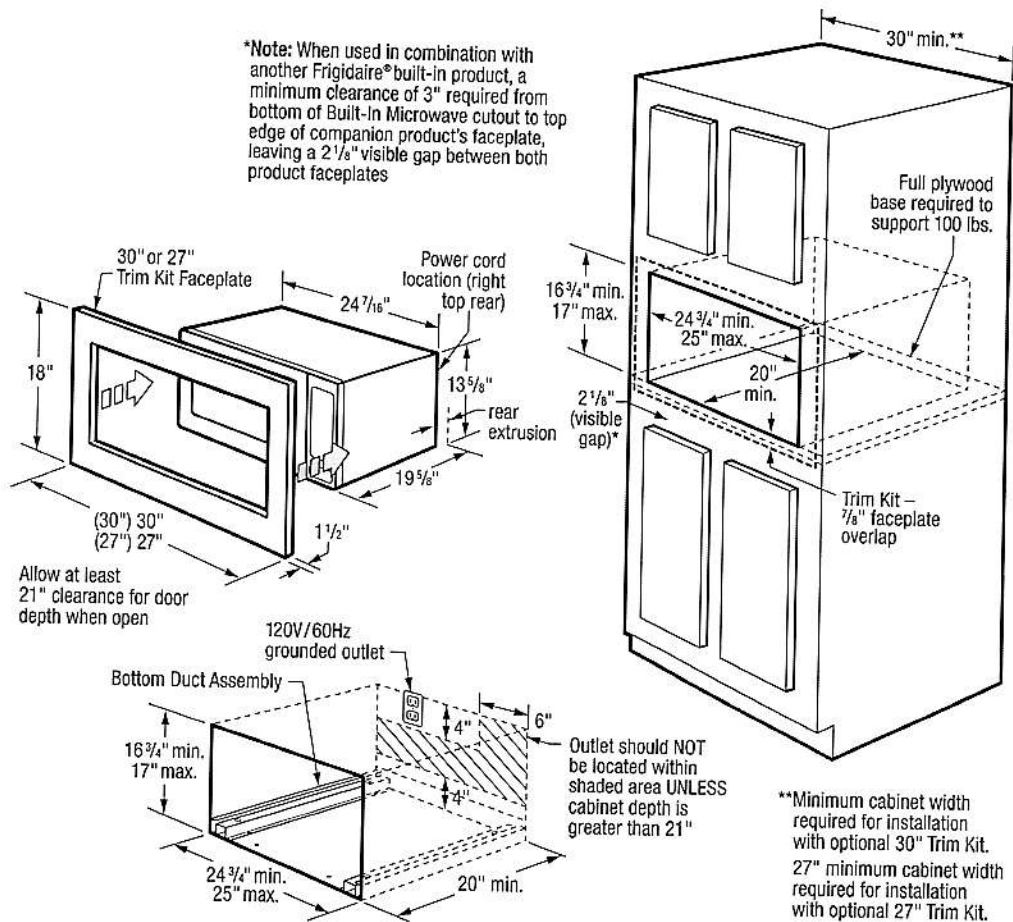

INSTALLATION SPECIFICATIONS

- Product Shipping Weight (Approx.) - 49 Lbs. (not incl. Trim Kit)
- Voltage Rating - 120V/60 Hz/15 Amps
- Connected Load (kW Rating) @ 120 Volts = 1.7 kW
(For use on adequately wired 120V, dedicated circuit having 2-wire service with a separate ground wire. Appliance must be grounded for safe operation.)
- Amps @ 120 Volts = 14.2 Amps
- Always consult local and national electric codes.
- Microwave can stand alone on countertop or be built in with optional 30" or 27" Trim Kit (ordered by individual part number) which includes Bottom Duct Assembly - shipped in separate box.
- Allow 21" minimum clearance for 90° door swing.
- Minimum 20" deep oven cutout dimension is critical for proper installation for oven and faceplate to fit flush against cabinet front.
- Consult local building code, in the event that cutout opening may be required to be enclosed with sides, ceiling and rear partition.
- Full oven base of solid plywood or similar material required, capable of supporting 100 Lbs.

- Base must be level and front of cabinet square for proper operation.
- Grounded outlet should NOT be located in shaded area, as indicated, UNLESS cabinet depth is greater than 21".
- Can NOT be installed above any gas wall oven.
- Built-In Microwave is approved to be used in combination with any Frigidaire® Electric Single Wall Oven and/or Warmer Drawer. (Refer to model-specific Combination Installation Specification pages on web.)
- When used in combination with another Frigidaire® built-in product, a minimum clearance of 3" required from bottom of Built-In Microwave cutout to top edge of companion product's faceplate, leaving a 2-1/8" visible gap between both product faceplates.

OPTIONAL ACCESSORIES

- 30" Stainless Steel Trim Kit - (PN# MWTK30FGUF).
- 27" Stainless Steel Trim Kit - (PN# MWTK27FGUF).



FRIGIDAIRE

CANADA • 5855 Terry Fox Way • Mississauga, ON L5V 3E4 • 1-800-265-8352 • frigidaire.ca

Note: For planning purposes only. Always consult local and national electric, gas and plumbing codes. Refer to Product Installation Guide for detailed installation instructions on the web at frigidaire.ca. Specifications subject to change. Accessories information available on the web at frigidaire.ca

CGMO226NU 09/18
 © 2018 Electrolux Major Appliances, NA

FRIGIDAIRE GALLERY

Wine Cooler FGWC5233TS

52-Bottle Capacity

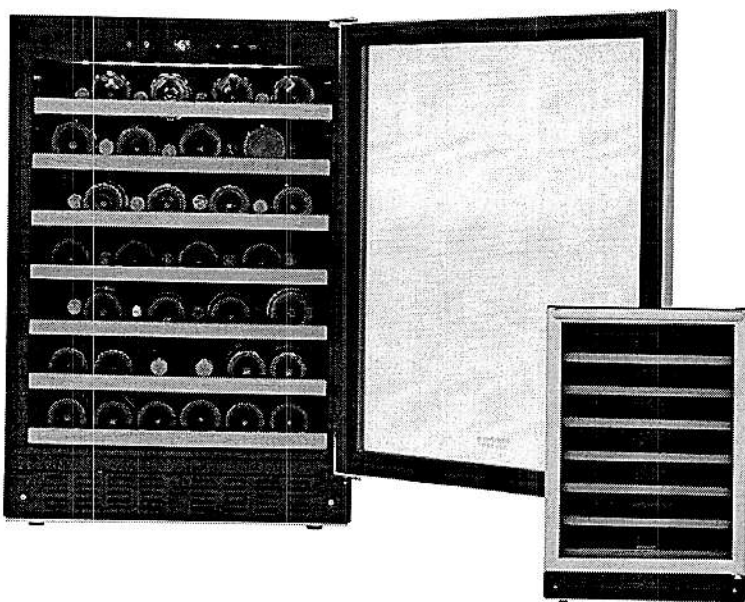

Product Dimensions

Height	34-1/4"
Width	23-7/16"
Depth (Incl. Door/Incl. Handle)	23-7/16"/25-3/4"
Depth with Door Opened 90°	45-3/4"

More Easy-To-Use Features

Wire Wine Racks with Wood Trim
Wood trim wire racks add an elegant touch to complement your wine collection.

Flexible Installation Options
Built-in or freestanding installation offers a variety of placement options, including leg levelers for customizing to your height needs.

LED Digital Control
LED digital control with white display.

LED Interior Light
LED interior lighting so you can easily see what's inside.

Tinted Stainless Glass Door
High-quality look to complement your room and wine collection.

Reversible Door Swing Option
Door can be installed to open left or right based on your needs.

Available in:

Stainless
(S)

Signature Features

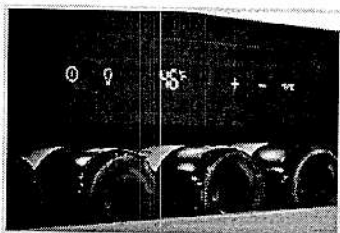

Precision Electronic Temperature Control with LED Digital Display
Set temperature anywhere between 41° - 64°F and the wine cooler will hold it precisely.



52-Bottle Capacity
Holds up to 52 wine bottles for maximum storage.

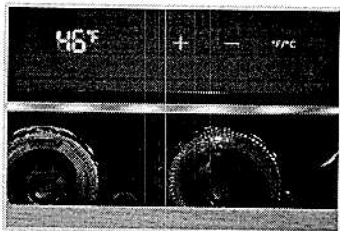

Temperature Range—41° to 64°F
Store red, white, and sparkling wines, or your favorite canned beverages at the appropriate temperature (41° to 64°F) for maximum taste.

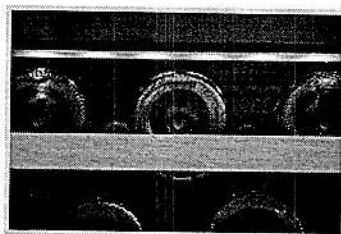

Convertible Shelf
1 Convertible Shelf (holds wine bottles or 12 oz. cans).

FRIGIDAIRE
GALLERY.

Wine Cooler
FGWC5233TS 52-Bottle Capacity

Features	
Cubic Feet (Cu.Ft.)	5.3
Bottle / Can Capacity	52 Bottles
Exterior	
Door Color	Stainless Steel
Cabinet Color	Black
Window Type	Tinted
Door Handle	Stainless Steel
Reversible Door	Yes
Adjustable Leveling Legs	4
Interior	
Control Type	Electronic
Display	F° or C° LED
Lighting	Exhibit - LED
Manual Control Lighting	Yes
Frost-Free Performance	Yes
Condenser	Dynamic
High-Temperature Acoustic Alarm	Yes
Power-On/Off Control	Yes
Temperature Zones	1
Temperature Range	41°F to 64°F
Slide-Out Wine Racks	Yes
Convertible Bottle / Can Shelf	Yes
Black Soft-Coat Wireform Racks	Yes
Natural Wood Rack Fronts	Yes
Cabinet Liner	Yes
Specifications	
Power Supply Connection Location	Lower RH Rear Corner
Voltage Rating	115V / 60Hz
Minimum Circuit Required (Amps)	15
Shipping Weight (Approx.)	116 Lbs.
Installation Type	Built-In or Freestanding

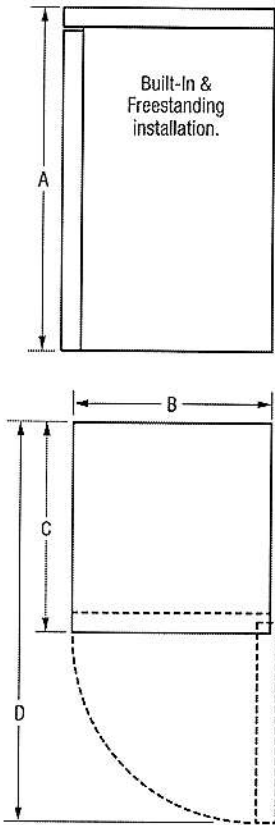

NOTE: For planning purposes only. Always consult local and national electric and plumbing codes. Refer to Product Installation Guide for detailed installation instructions on the web at frigidaire.com.



Product Dimensions	
A - Height	34-1/4"
B - Width	23-7/16"
C - Depth (Incl. Door / Incl. Handle)	23-7/16" / 25-3/4"
D - Depth with Door Open 90°	45-3/4"

Accessories information available on the web at frigidaire.com

FRIGIDAIRE

USA • 10200 David Taylor Drive • Charlotte, NC 28262 • 1-800-FRIGIDAIRE • frigidaire.com
CANADA • 5855 Terry Fox Way • Mississauga, ON L5V 3E4 • 1-800-265-8352 • frigidaire.ca
FGWC5233T G4/17

© 2017 Electrolux Home Products, Inc.

Specifications subject to change.