

CONSTRUCTION SUMMARY

Mountainview Heights 3 (G) - Russell Gardens Building Ltd.

RECEIVED

APR - 7 2022

TEL:

PURCHASERS: Vijaya Kumar RAYUDU and Bhargavi RAYUDU

LOT / PHASE	REG. PLAN #	HOUSE TYPE		
372 / 4	62M-1266	Springfield Three (4 Bed with Guest Suite) Elev 3		

CABINETRY

1 - KITCHEN - CM 11 CROWN MOULDING 09Mar22 Note:	
1 - KITCHEN - LIGHT VALANCE - NO ELECTRICAL 09Mar22 Note:	
1 - KITCHEN CABINETRY - TWO COLOUR KITCHEN - FLAT FEE 09Mar22 Note:	
1 - CABINETRY - KITCHEN - HARDWARE UPGRADE 1 09Mar22 Note:	
1 - CABINETRY - KITCHEN - UPGRADE 2 09Mar22 Note:	
1 - VANITY - GUEST ENSUITE BATHROOM - HARDWARE UPGRADE 1 09Mar22 Note:	
1 - VANITY - ENSUITE 3/4 - HARDWARE UPGRADE 1 09Mar22 Note:	
1 - VANITY - ENSUITE 2 - HARDWARE UPGRADE 1 09Mar22 Note:	
1 - VANITY - ENSUITE - HARDWARE UPGRADE 1 09Mar22 Note:	
1 - CABINETRY PROVISION - PROVISION FOR PLUG ON ISLAND (PLUG EXTRA ORDERED SEPARATELY) 09Mar22 Note:	

CABINETRY ACCESSORIES

1 - KITCHEN - BLU MOTION DRAWERS 09Mar22 Note:	
1 - KITCHEN - SOFT CLOSING CABINETRY 09Mar22 Note:	
1 - KITCHEN HOOD CABINETS - TRANSITIONAL WOOD HOOD (DHB) 800-1000 WIDE - UPGRADE 2 09Mar22 Note:	
1 - KITCHEN CABINETRY BASE - PULLOUT RECYCLE 4 BIN - PRICE IS EACH 09Mar22 Note:	
1 - KITCHEN CABINETRY BASE - POT/PAN DRAWERS (CABINET) - UPGRADE 2 09Mar22 Note:	
1 - KITCHEN CABINETRY BASE - BANK OF DRAWERS - UPGRADE 2 09Mar22 Note:	
2 - KITCHEN CABINETRY BASE - PULLOUT WIRE SPICE RACK - PRICE IS EACH 09Mar22 Note:	

CONSTRUCTION SUMMARY

Mountainview Heights 3 (G) - Russell Gardens Building Ltd.

PURCHASERS: Vijaya Kumar RAYUDU and Bhargavi RAYUDU

TEL:

LOT / PHASE 372 / 4	REG. PLAN # 62M-1266	HOUSE TYPE Springfield Three (4 Bed with Guest Suite) Elev 3		
------------------------	-------------------------	---	--	--

1 - PANTRY UNIT UPGRADE - TO GO FROM 300MM TO 600MM DEEP - UPGRADE 2 09Mar22 Note:	
1 - KITCHEN CABINETRY - BUILT-IN FRIDGE CABINET - PRICE IS EACH 09Mar22 Note:	
1 - KITCHEN CABINETRY UPPER - FULL DEPTH ABOVE FRIDGE - WITH GABLES - 600MM - PRICE IS EACH - UPGRADE 2 09Mar22 Note:	
1 - KITCHEN CABINETRY BASE - COOKTOP CABINET WITH POT DRAWERS (2 DRAWERS) - UPGRADE 2 09Mar22 Note:	
1 - KITCHEN CABINETRY - BUILT-IN MICROWAVE/OVEN COMBO - UPGRADE 2 09Mar22 Note:	
1 - VANITY CABINETRY - RAISE VANITY TO 36" HIGH VANITY IN LIEU OF STANDARD HEIGHT - MASTER ENSUITE BATHROOM 09Mar22 Note:	
1 - VANITY CABINETRY - RAISE VANITY TO 36" HIGH VANITY IN LIEU OF STANDARD HEIGHT - POWDER ROOM 09Mar22 Note:	

CERAMIC TILE

1 - TILE - UPGRADE 4 WALL TILE - - OPTIONAL ENSUITE - SHOWER WALL 09Mar22 Note:	
1 - TILE - UPGRADE 4 FLOOR TILE - - OPTIONAL ENSUITE - FLOOR AREA 09Mar22 Note:	
1 - TILE - UPGRADE 4 FLOOR TILE - - MUD ROOM 09Mar22 Note:	
1 - TILE - UPGRADE 4 FLOOR TILE - - KITCHEN 09Mar22 Note:	
1 - TILE - UPGRADE 4 FLOOR TILE - - FOYER 09Mar22 Note:	
1 - TILE - UPGRADE 6 WALL TILE - - ENSUITE BATHROOM - SHOWER WALL 09Mar22 Note:	
1 - TILE - UPGRADE 6 FLOOR TILE - - ENSUITE BATHROOM - FLOOR 09Mar22 Note:	

CONSTRUCTION

1 - DELETE OR REDUCE BULK HEADS IN KITCHEN TO ACCOMMODATE CROWN MOULDING - IF CONSTRUCTION PERMITS 09Mar22 Note:	
1 - PROVISION FOR SHAMPOO NICHE APPROX. 24" WIDE X 20" HIGH AS PER SKETCH – IF CONSTRUCTION PERMITS - MASTER ENSUITE BATHROOM 09Mar22 Note:	
1 - SMOOTH CEILINGS ON FIRST FLOOR ONLY - DET 09Mar22 Note:	

COUNTER TOP



JENN-AIR® DETAILED PLANNING DIMENSIONS

1 of 3

48" SIDE-BY-SIDE REFRIGERATORS WITH ICE & WATER DISPENSER

JS48PPDUDE – 48<sup>3⁄8</sup>" x 83<sup>3⁄8</sup>" x 27<sup>3⁄4</sup>" (with handles)

JS48SSDUDE – 48<sup>3⁄8</sup>" x 83<sup>3⁄8</sup>" x 27<sup>1⁄8</sup>" (with handles)

PRODUCT DIMENSIONS

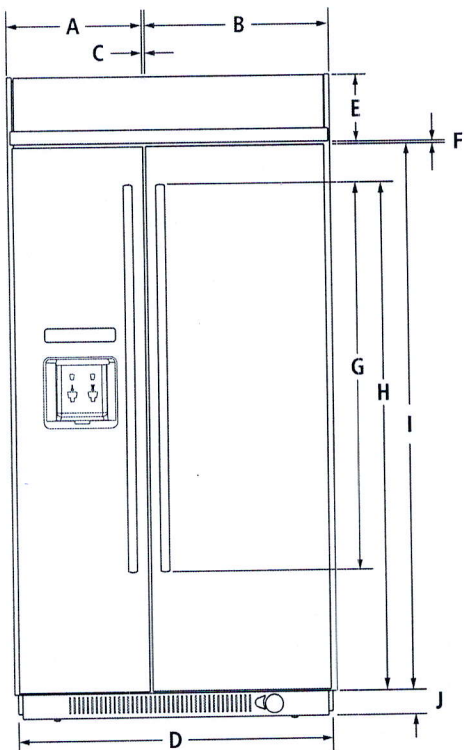

FRONT VIEW

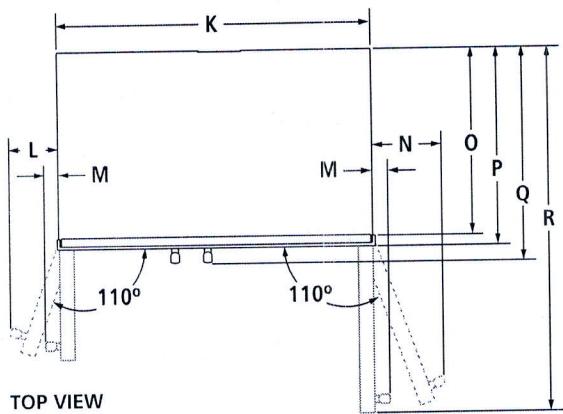

TOP VIEW

MODEL #		JS48PPDUDE JS48SSDUDE	
		in	cm
A	Width of freezer door (including hinge side offset)	20	50.8
B	Width of refrigerator door (including hinge side offset)	27	68.6
C	Space between doors	3⁄8	1.0
D	Overall width (Including side trim)	48 <sup>3⁄8</sup>	122.9
E	Height of top grille	8 <sup>5⁄8</sup>	21.7
F	Space between doors and top grille	3⁄8	1.0
G	Height of handles		
	Pro-Style® Stainless	45 <sup>1⁄16</sup>	115.7
	Euro Style Stainless	50	127.1
H	Height to top of handles		
	Pro-Style® Stainless	63 <sup>11⁄16</sup>	163.5
	Euro Style Stainless	65 <sup>3⁄4</sup>	167.0
I	Height of doors	71	180.2
J	Height of bottom grille	3	7.6
K	Width of recessed refrigerator	47	119.4
L	Width from side of refrigerator to freezer handle – door fully open 110°		
	Pro-Style® Stainless	8 <sup>3⁄8</sup>	21.3
	Euro Style Stainless	8	20.3
M	Width from side of refrigerator to handle – door open 90°		
	Pro-Style® Stainless	2 <sup>5⁄8</sup>	6.7
	Euro Style Stainless	2	5.1
N	Width from side of refrigerator to refrigerator handle – door fully open 110°		
	Pro-Style® Stainless	10 <sup>7⁄8</sup>	27.6
	Euro Style Stainless	10 <sup>1⁄4</sup>	26.1
O	Depth without doors	22 <sup>1⁄8</sup>	56.2
P	Depth with doors	25 <sup>1⁄8</sup>	63.8
Q	Depth with handles		
	Pro-Style® Stainless	27 <sup>3⁄4</sup>	70.5
	Euro Style Stainless	27 <sup>7⁄8</sup>	68.8
R	Depth with refrigerator door open 90°	50 <sup>13⁄16</sup>	129.0

**IMPORTANT:** Dimensional specifications are provided for planning purposes only.  
**Do not make any cutouts based on this information.** Refer to the Installation or Use & Care Guide before selecting cabinetry, verifying electrical/gas connections, making cutouts or beginning installation.  
All Jenn-Air® appliances are appropriately UL, CUL or CSA approved.



8116AdZw915

JENN-AIR® DETAILED PLANNING DIMENSIONS

48" SIDE-BY-SIDE REFRIGERATORS WITH ICE & WATER DISPENSER

JS48PPDUDE – 48<sup>3⁄8</sup>" x 83<sup>3⁄8</sup>" x 27<sup>3⁄4</sup>" (with handles)  
JS48SSDUDE – 48<sup>3⁄8</sup>" x 83<sup>3⁄8</sup>" x 27<sup>1⁄8</sup>" (with handles)

DIMENSIONS AS INSTALLED

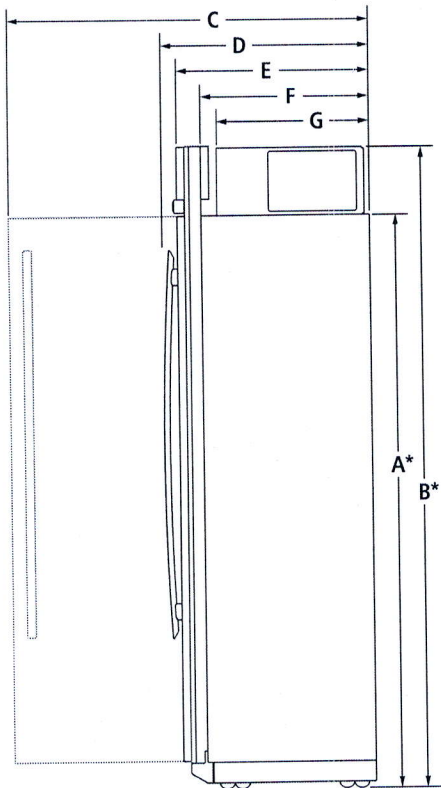

SIDE VIEW

MODEL #		JS48PPDUDE JS48SSDUDE	
		in	cm
A*	Height without compressor (min.)	74 <sup>3⁄8</sup>	188.9
B*	Height of recessed refrigerator (min.)	83 <sup>3⁄8</sup>	211.8
C	Depth with refrigerator door open 90° (min.)	51 <sup>1⁄8</sup>	129.7
D	Depth with handles (min.)		
	Pro-Style® Stainless	27 <sup>3⁄4</sup>	70.5
	Euro Style Stainless	27 <sup>1⁄8</sup>	68.8
E	Depth with doors (min.)	25 <sup>1⁄8</sup>	63.8
F	Depth without doors (min.)	22 <sup>1⁄8</sup>	56.2
G	Depth of compressor (min.)	19 <sup>3⁄8</sup>	49.8

\*Add 1<sup>1⁄4</sup>" (3.2 cm) to the height dimension when leveling legs are fully extended.

**IMPORTANT:** Dimensional specifications are provided for planning purposes only.  
**Do not make any cutouts based on this information.** Refer to the Installation or Use & Care Guide before selecting cabinetry, verifying electrical/gas connections, making cutouts or beginning installation. All Jenn-Air® appliances are appropriately UL, CUL or CSA approved.





JENN-AIR® DETAILED PLANNING DIMENSIONS

48" SIDE-BY-SIDE REFRIGERATORS WITH ICE & WATER DISPENSER

JS48PPDUDE – 48<sup>3⁄8</sup>" x 83<sup>3⁄8</sup>" x 27<sup>3⁄4</sup>" (with handles)  
JS48SSDUDE – 48<sup>3⁄8</sup>" x 83<sup>3⁄8</sup>" x 27<sup>1⁄8</sup>" (with handles)

OPENING/CLEARANCE DIMENSIONS

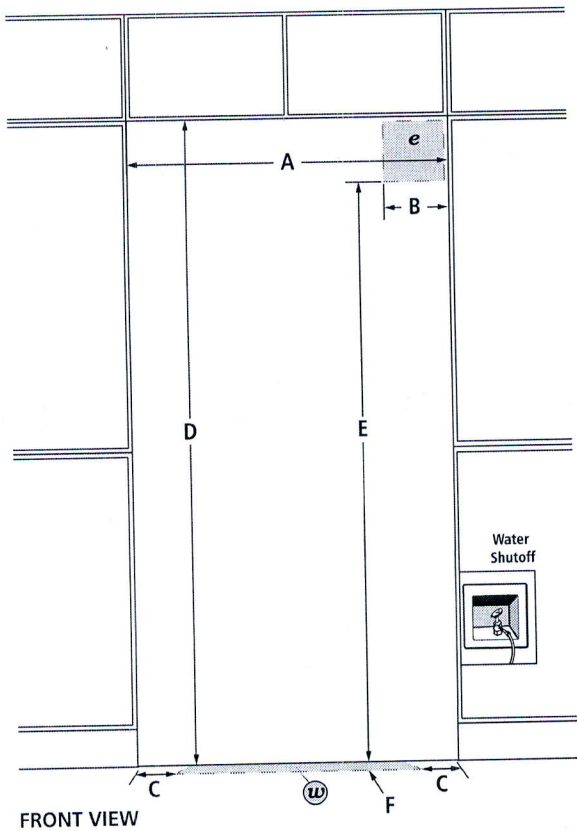

FRONT VIEW

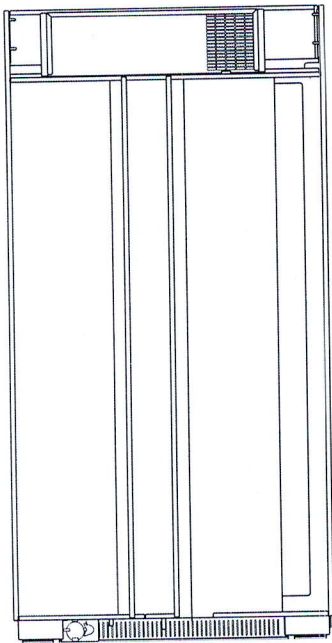

BACK VIEW

**IMPORTANT:** Dimensional specifications are provided for planning purposes only.  
**Do not make any cutouts based on this information.** Refer to the Installation or Use & Care Guide before selecting cabinetry, verifying electrical/gas connections, making cutouts or beginning installation. All Jenn-Air® appliances are appropriately UL, CUL or CSA approved.

MODEL #		JS48PPDUDE JS48SSDUDE	
		in	cm
A	Width (min.)	47½	120.7
B	Width of recommended electrical location	13½	34.3
C	Distance from side of cabinet to recommended water connection location	6	15.2
D	Height (min.)	84	213.4
E	Height to recommended electrical location	77	195.6
F	Depth of recommended water connection location (max.)	1	2.5
e	Recommended electrical connection location		
w	Recommended water connection location		

ELECTRICAL REQUIREMENTS

115 volt, 60 Hz, AC only, 15- or 20-amp fused, grounded circuit is required. A dedicated circuit is recommended. Use an outlet that cannot be turned off by a switch.  
Minimum length of power cord is 84" (213.4 cm). Do not use an extension cord.

WATER PRESSURE REQUIREMENTS

A cold water supply with water pressure between 30 and 120 psi (207 and 827 kPa) is required to operate the water dispenser and ice maker. Call a licensed, qualified plumber with any questions about the water pressure.

Reverse Osmosis Water Supply

**IMPORTANT:** The pressure of the water coming out of a reverse osmosis system going to the water inlet valve of the refrigerator needs to be between 30 and 120 psi (207 and 827 kPa).

If a reverse osmosis water filtration system is connected to the cold water supply, the water pressure to the reverse osmosis system needs to be a minimum of 40 to 60 psi (276 to 414 kPa).

LOCATION REQUIREMENTS

Floor must be able to support refrigerator (more than 600 lb [272 kg]) and contents of the refrigerator and must be at the same level as flooring in the room.



DOUBLE WALL OVENS

JJW2827I – 27" x 52-3/8" x 25-5/16"

JJW2830I, JJW3830I – 30" x 52-3/8" x 25-5/16"

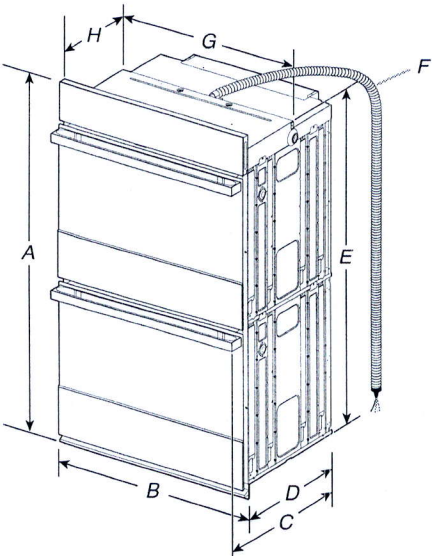

PRODUCT DIMENSIONS – DOUBLE OVENS

~~27" (68.6 CM) MODELS~~

- ~~A. 52-3/8" (133 cm) overall height~~
- ~~B. 27" (68.6 cm) overall width~~
- ~~C. JJW2827IM – 26-3/8" (67 cm)  
JJW2827IL – 27-3/16" (69 cm)~~
- ~~D. 23-1/4" (59.1 cm) max. recessed depth~~
- ~~E. 49-1/4" (125.1 cm) recessed height~~
- ~~F. 66" (167.6 cm) flexible conduit length measured from the conduit clamp located at the rear of the oven. Do not remove the conduit clamp.~~
- ~~G. 25-7/16" (64.6 cm) recessed width~~

30" (76.2 CM) MODELS

- A. 52-3/8" (133 cm) overall height
- B. 30" (76.2 cm) overall width
- C. JJW2830IM – 26-3/8" (67 cm)  
JJW2830IL – 27-3/16" (69 cm)  
JJW3830IM – 26-3/8" (67 cm)  
JJW3830IL – 27-3/16" (69 cm)
- D. 23-1/4" (59.1 cm) max. recessed depth
- E. 49-1/4" (125.1 cm)
- F. 66" (167.6 cm) flexible conduit length measured from the conduit clamp located at the rear of the oven. Do not remove the conduit clamp.
- G. 28-7/16" (72.2 cm) recessed width

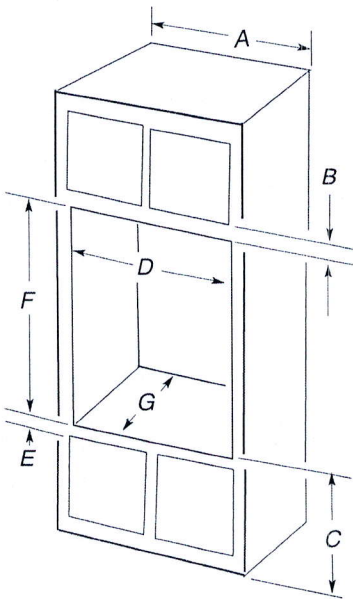

DOUBLE OVENS INSTALLED IN CABINET

~~27" (68.6 CM) MODELS~~

- ~~A. 27" (68.6 cm) min. cabinet width~~
- ~~B. 2-3/16" (5.5 cm) top of cutout to bottom of upper cabinet door~~
- ~~C. 14-3/4" (37.5 cm) bottom of cutout to floor is recommended. 4"-19 1/4" (10.2-49.9 cm) bottom of cutout to floor is acceptable.~~
- ~~D. 25-1/2" (64.8 cm) cutout width~~
- ~~E. 1-1/2" (3.8 cm) min. bottom of cutout to top of cabinet door~~
- ~~F. 50-1/4" (127.6 cm)\* recommended cutout height~~
- ~~G. 24" (60.7 cm) cutout depth~~

**\*NOTE:** The cutout height can be between 49-1/2" (125.7 cm) and 52-3/16" (132.6 cm) for 27" double ovens.

30" (76.2 CM) MODELS

- A. 30" (76.2 cm) min. cabinet width
- B. 2-3/16" (5.5 cm) top of cutout to bottom of upper cabinet door
- C. 14-3/4" (37.5 cm) bottom of cutout to floor is recommended. 4"-14-3/4" (10.2-37.5 cm) bottom of cutout to floor is acceptable.
- D. 28-1/2" (72.4 cm) cutout width
- E. 1-1/2" (3.8 cm) min. bottom of cutout to top of cabinet door
- F. 50-1/4" (127.6 cm)\* recommended cutout height
- G. 24" (60.7 cm) cutout depth

**\*NOTE:** The cutout height can be between 49-1/2" (125.7 cm) and 52-3/16" (132.6 cm) for 30" double ovens.

**IMPORTANT:** Dimensional specifications are provided for planning purposes only.  
**Do not make any cutouts based on this information.** Refer to the Installation or Use & Care Guide **BEFORE** selecting cabinetry, verifying electrical/gas connections, making cutouts or beginning installation.  
All JennAir® appliances are appropriately UL, CUL or CSA approved.





DOUBLE WALL OVENS

JJW2827I – 27" x 52-3/8" x 25-5/16"

JJW2830I, JJW3830I – 30" x 52-3/8" x 25-5/16"

ELECTRICAL REQUIREMENTS

If codes permit and a separate ground wire is used, it is recommended that a qualified electrical installer determine that the ground path and the wire gauge are in accordance with local codes.

Check with a qualified electrical installer if you are not sure the oven is properly grounded.

This oven must be connected to a grounded metal, permanent wiring system.

Be sure that the electrical connection and wire size are adequate and in conformance with the National Electrical Code, ANSI/NFPA 70-latest edition or CSA Standards C22.1-94, Canadian Electrical Code, Part 1 and C22.2 No. O-M91-latest edition, and all local codes and ordinances.

A copy of the above code standards can be obtained from:

National Fire Protection Association  
1 Batterymarch Park  
Quincy, MA 02169-7471

CSA International  
8501 East Pleasant Valley Road  
Cleveland, OH 44131-5575

ELECTRICAL CONNECTION

To properly install your oven, you must determine the type of electrical connection you will be using and follow the instructions provided for it here.

- Oven must be connected to the proper electrical voltage and frequency as specified on the model/serial/rating plate. The model/serial/rating plate is located under the control panel on the upper oven cavity on double ovens. See the following illustration.

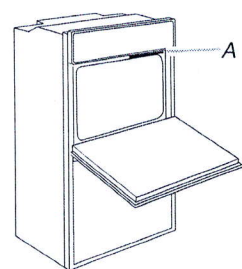

Double Oven  
A. Model/Serial/Rating Plate

- Models rated from 7.3 to 9.6 kW at 240 V (5.4 to 7.4 kW at 208 V) require a separate 40 A circuit. Models rated at 4.8 kW and below at 240 V (3.6 kW and below at 208 V) require a separate 20 A circuit.
- A circuit breaker is recommended.
- Connect directly to the circuit breaker box (or fused disconnect) through flexible, armored, or nonmetallic sheathed, copper cable (with grounding wire).
- Flexible conduit from the oven should be connected directly to the junction box.
- Fuse both sides of the line.
- Do not cut the conduit. The length of conduit provided is for serviceability of the oven.
- A UL listed or CSA approved conduit connector must be provided.
- If the house has aluminum wiring, follow the procedure below:  
Connect the aluminum wiring using special connectors and/or tools designed and UL listed for joining copper to aluminum.  
Follow the electrical connector manufacturer's recommended procedure. Aluminum/copper connection must conform with local codes and industry accepted wiring practices.

For power requirements for models JJW2827I, JJW2830I and JJW3830I, refer to the following table.

	240 VAC	208 VAC
Model	kW	kW
JJW2827I	8.7	6.5
JJW2830I	8.7	6.5
JJW3830I	9.2	6.9

**IMPORTANT:** Dimensional specifications are provided for planning purposes only.  
**Do not make any cutouts based on this information.** Refer to the Installation or Use & Care Guide *BEFORE* selecting cabinetry, verifying electrical/gas connections, making cutouts or beginning installation.  
All JennAir® appliances are appropriately UL, CUL or CSA approved.

JENN-AIR® DETAILED PLANNING DIMENSIONS

1 of 4

36" JX3™ GAS DOWNDRAFT COOKTOP  
JGD3536G – 36" x 18<sup>5</sup>/<sub>16</sub>" x 21<sup>1</sup>/<sub>2</sub>"

PRODUCT DIMENSIONS

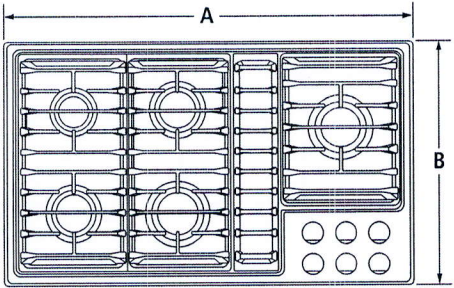

TOP VIEW

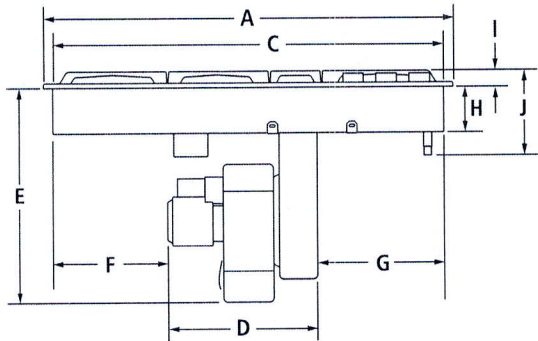

FRONT VIEW

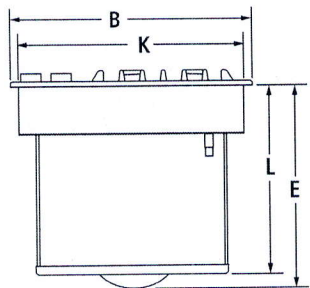

SIDE VIEW

MODEL #		JGD3536G	
		in	cm
A	Overall width	36	91.4
B	Overall depth	21½	54.6
C	Width of cooktop base	34 <sup>17</sup> / <sub>32</sub>	87.7
D	Width of assembled blower motor and plenum	14 <sup>29</sup> / <sub>64</sub>	36.7
E	Height from blower motor to underside of cooktop	18 <sup>5</sup> / <sub>16</sub>	46.5
F	Width from left side of cooktop base to blower motor	10 <sup>15</sup> / <sub>64</sub>	26.0
G	Width from plenum to right side of cooktop base	9 <sup>5</sup> / <sub>64</sub>	24.9
H	Height of cooktop base	4 <sup>9</sup> / <sub>64</sub>	10.5
I	Height of cooktop with grates	1 <sup>37</sup> / <sub>64</sub>	4.0
J	Height from gas inlet to top of grates	7 <sup>13</sup> / <sub>64</sub>	18.3
K	Depth of cooktop base	19 <sup>61</sup> / <sub>64</sub>	50.7
L	Height from plenum to underside of cooktop	16 <sup>49</sup> / <sub>64</sub>	42.6

**IMPORTANT:** Dimensional specifications are provided for planning purposes only.  
**Do not make any cutouts based on this information.** Refer to the Installation Guide *before* selecting cabinetry, verifying electrical/gas connections, making cutouts or beginning installation.  
All Jenn-Air® appliances are appropriately UL, CUL or CSA approved.



8990dZw117



JENN-AIR® DETAILED PLANNING DIMENSIONS

36" JX3™ GAS DOWNDRAFT COOKTOP  
JGD3536G – 36" x 18<sup>3</sup>/<sub>16</sub>" x 21<sup>1</sup>/<sub>2</sub>"

OPENING/CLEARANCE DIMENSIONS

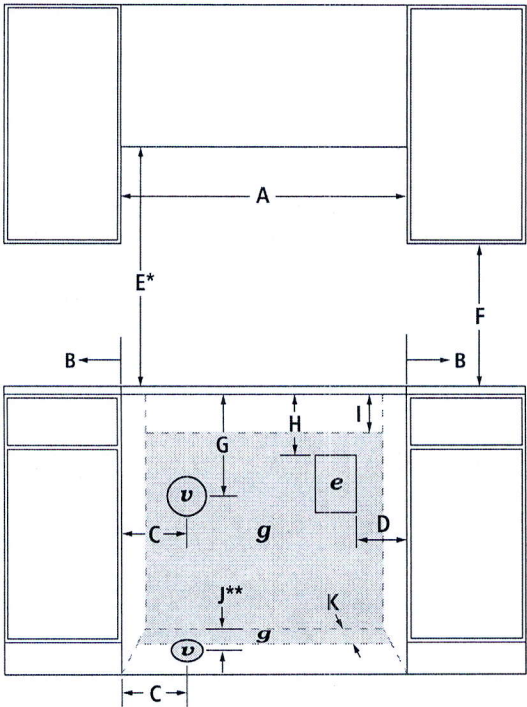

FRONT VIEW

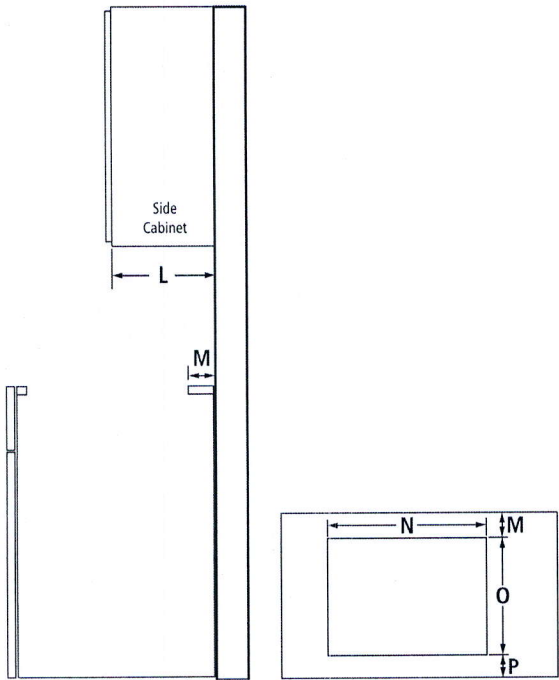

SIDE VIEW

TOP VIEW

MODEL #		JGD3536G	
		in	cm
A	Width of combustible area above cooking surface (min.)	36	91.4
B	Width from cooktop to fixed wall or other combustible material (min.)	6	15.2
C	Width to center of vent opening option (min.)	16 <sup>3</sup> / <sub>16</sub>	41.1
D	Width to outer edge of outlet (min.)	10	25.4
E*	Height to bottom of uncovered wood or metal cabinet above cooking surface (min.)	30	76.2
F	Height to bottom of uncovered wood or metal cabinet (min.)	18	45.7
G	Height to center of vent opening option	14 <sup>1</sup> / <sub>16</sub>	37.3
H	Height to top edge of outlet (min.)	12	30.5
I	Height to top of gas installation area	6	15.2
J**	Depth to center of vent opening option	17 <sup>1</sup> / <sub>8</sub>	43.5
K	Depth of gas installation area	6	15.2
L	Depth of upper cabinet (recommended)	13	33.0
M	Depth from cutout to wall (min.)	2 <sup>1</sup> / <sub>32</sub>	6.1
N	Width of cutout	34 <sup>3</sup> / <sub>4</sub>	88.3
O	Depth of cutout	19 <sup>1</sup> / <sub>16</sub>	50.6
P	Depth from cutout to front of countertop (min.)	2 <sup>1</sup> / <sub>8</sub>	5.4
e	Recommended electrical access location		
g	Recommended gas supply line location		
v	Recommended venting location – see pages 3-4 for ducting information		

\*Dimension can be reduced by 6" (15.2 cm) when bottom of wood or metal cabinet is covered by not less than 1/4" (0.6 cm) flame retardant millboard covered with not less than No. 28 MSG sheet metal, 0.015" (0.4 mm) stainless steel, 0.024" (0.6 mm) aluminum or 0.020" (0.5 mm) copper.

\*\*Based on installation in a 24" (61.0 cm) deep by 34<sup>1</sup>/<sub>2</sub>" (87.6 cm) high base cabinet with a 1<sup>1</sup>/<sub>2</sub>" (3.8 cm) thick counter top.

GAS REQUIREMENTS

Natural Gas

This cooktop is factory-set for use with natural gas.

LP Gas Conversion

Conversion must be done by a qualified service technician. To convert to LP gas, use the LP gas conversion kit provided with the cooktop.

ELECTRICAL REQUIREMENTS

120 volt, 60 Hz, AC only, 40-amp fused, electrical circuit is required. A time-delay fuse or dedicated circuit is recommended.

VENTING REQUIREMENTS

This cooktop must be exhausted outdoors unless using the duct-free filter kit (JDA7000WX). Refer to kit instructions for further information.

LOCATION REQUIREMENTS

- To ensure cooktop base clearance, cabinet side walls need to be wider than the cutout.
- A minimum clearance of 2" (5.1 cm) is recommended between the blower motor and cabinet for proper cooling. A 6" (15.2 cm) clearance is recommended for servicing access.
- An under counter built-in oven cannot be installed under this cooktop.

**IMPORTANT:** Dimensional specifications are provided for planning purposes only.  
**Do not make any cutouts based on this information.** Refer to the Installation Guide *before* selecting cabinetry, verifying electrical/gas connections, making cutouts or beginning installation.  
 All Jenn-Air® appliances are appropriately UL, CUL or CSA approved.



8990dZw117

JENN-AIR® DETAILED PLANNING DIMENSIONS

DUCT-FREE KIT

JDA7000WX – 17⅝" x 10⅜" x 7½"

JX3" DOWNDRAFT COOKTOPS WITH DUCT-FREE VENTILATION

The duct-free filter kit (JDA7000WX) is approved for use with JX3™ downdraft cooktop models JGD3536G, JGD3430G, JED4536G, JED3536G, JED4430G and JED3430G. The kit filters the air from the downdraft system and ventilates the conditioned air into the room through the toe kick of the base cabinet. Do not ventilate the air from the downdraft system into the base cabinet, base cabinet pedestal, crawl space, wall or attic.

PRODUCT DIMENSIONS

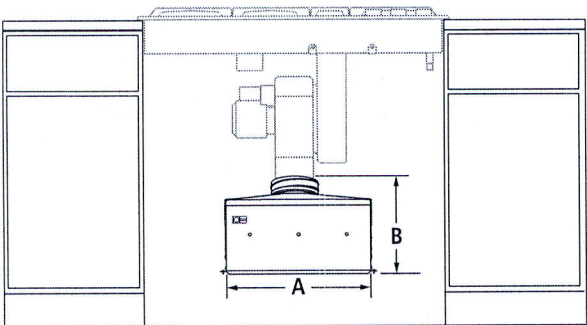

FRONT VIEW

MODEL #		JDA7000WX	
		in	cm
A	Width of housing	17⅝	44.7
B	Height of housing	10⅜	26.5
C	Depth of housing	7½	19.0
D	Minimum height of toe kick	3	7.6
E	Minimum depth to toe kick	2½	6.4

EXHAUST CUTOUT LOCATION

The cutout location in the toe kick area of the cabinet floor is dependent upon the dimensions of the cooktop and base cabinet.

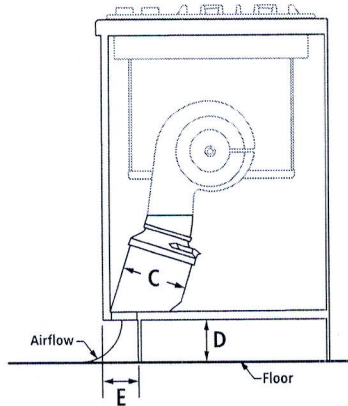

SIDE VIEW

**IMPORTANT:** Dimensional specifications are provided for planning purposes only. Do not make any cutouts based on this information. Refer to the Installation Guide before selecting cabinetry, verifying electrical/gas connections, making cutouts or beginning installation. All Jenn-Air® appliances are appropriately UL, CUL or CSA approved.



JENN-AIR® DETAILED PLANNING DIMENSIONS

DOWNDRAFT COOKTOP DUCTING ARRANGEMENTS

The diagrams below show typical duct arrangements for downdraft cooktops. JX3™ downdraft cooktops also offer a duct-free installation option. For more details, refer to page 3.

DUCTING CONFIGURATIONS

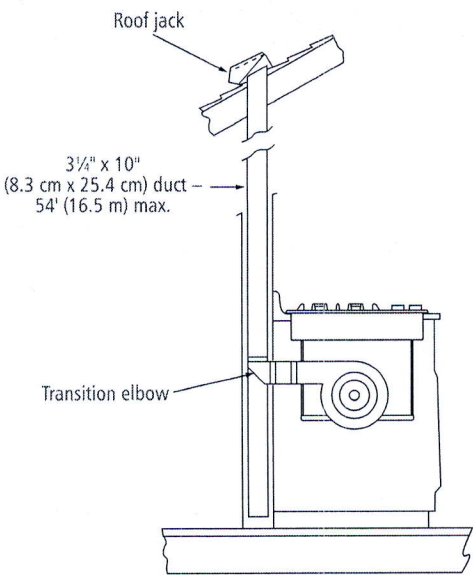

REAR DUCTING IN WALL TO ROOF

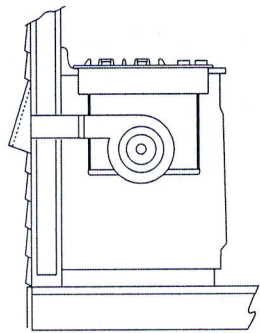

REAR DUCTING THROUGH WALL TO OUTSIDE

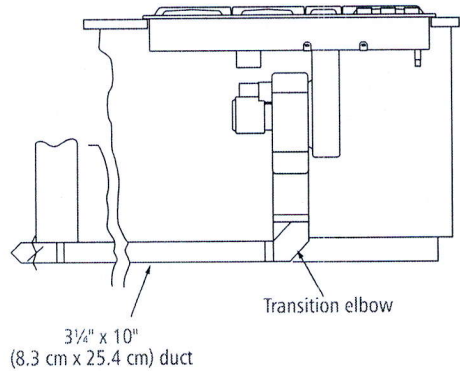

SIDE DUCTING IN TOE KICK TO OUTSIDE

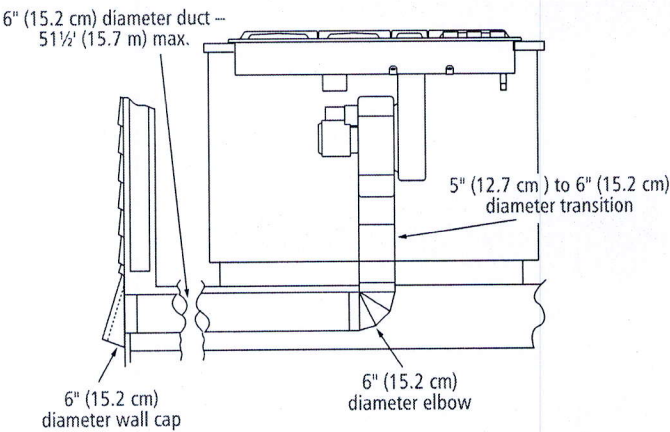

THROUGH FLOOR BETWEEN JOISTS TO OUTSIDE

DUCTING REQUIREMENTS

COOKTOP	DUCT LENGTH	DUCT SIZE
Gas	10' (3.0 m) or less*	5" (12.7 cm) diameter*
	Between 10' (3.0 m) and 60' (18.3 m)	6" (15.2 cm) diameter 3 1/4" x 10" (8.3 cm x 25.4 cm)
Electric	10' (3.0 m) or less**	5" (12.7 cm) diameter**
	Between 10' (3.0 m) and 60' (18.3 m)	6" (15.2 cm) diameter 3 1/4" x 10" (8.3 cm x 25.4 cm)

\*Gas cooktops must use 5" (12.7 cm) diameter for runs of 10' (3.0 m) or less.  
\*\*May be used to vent straight out the back of the cooktop and directly through the wall.

CALCULATING MAXIMUM DUCTING LENGTH

- Maximum ducting length is 60' (18.3 m).
- Each 90° elbow equals 5' (1.5 m) duct.
- Use no more than three 90° elbows.
- Flexible metal vent is not recommended.
- Do not install two elbows together.

NOTES:

- For ducting runs up to 30' (9.1 m), install cooktop as shipped.
- For ducting runs of 31' (9.4 m) to 60' (15.2 cm), remove the restricter ring on the blower inlet housing.
- For altitudes above 4500' (1272.0 m), reduce recommended vent run by 20% for best performance.

**IMPORTANT:** Dimensional specifications are provided for planning purposes only.  
**Do not make any cutouts based on this information.** Refer to the Installation Guide before selecting cabinetry, verifying electrical/gas connections, making cutouts or beginning installation.  
All Jenn-Air® appliances are appropriately UL, CUL or CSA approved.



8990dZw117