

CONSTRUCTION SUMMARY

Mountainview Heights 3 (G) - Russell Gardens Building Ltd.

PURCHASERS: Madiha KHAN and Gulraiz KHAN

TEL:

LOT / PHASE	REG. PLAN #	HOUSE TYPE		
575 / 4	62M-1266	Springfield Eleven (5 Bedroom) Elev 3		

CABINETRY

1 - KITCHEN - CM 3 CROWN MOULDING 18May22 Note:	
1 - CABINETRY - KITCHEN - UPGRADE 1 18May22 Note:	

CABINETRY ACCESSORIES

1 - KITCHEN - SOFT CLOSING CABINETRY - (DOORS - ONLY) 18May22 Note:	
1 - PANTRY UNIT UPGRADE - TO GO FROM 300MM TO 600MM DEEP - PRICE IS PER FOOT - UPGRADE 1 18May22 Note:	
1 - KITCHEN CABINETRY UPPER - FULL DEPTH ABOVE FRIDGE - WITH GABLES - 600MM - PRICE IS EACH - UPGRADE 1 18May22 Note:	
1 - KITCHEN CABINETRY BASE - PULLOUT RECYCLE 2 BIN - PRICE IS EACH 18May22 Note:	
1 - KITCHEN CABINETRY BASE - BANK OF DRAWERS - UPGRADE 1 18May22 Note: Add Extra -	
2 - KITCHEN CABINETRY BASE - PULLOUT WIRE SPICE RACK 18May22 Note:	
1 - KITCHEN CABINETRY - BUILT-IN MICROWAVE/OVEN COMBO - UPGRADE 1 18May22 Note:	
1 - KITCHEN CABINETRY BASE - COOKTOP CABINET WITH POT DRAWERS (2 DRAWERS) - UPGRADE 1 18May22 Note:	
1 - KITCHEN - LIGHT VALANCE - NO ELECTRICAL 18May22 Note:	
1 - VANITY CABINETRY - RAISE VANITY TO 36" HIGH VANITY IN LIEU OF STANDARD HEIGHT - MASTER ENSUITE BATHROOM 18May22 Note:	
1 - VANITY CABINETRY - RAISE VANITY TO 36" HIGH VANITY IN LIEU OF STANDARD HEIGHT - POWDER ROOM 18May22 Note:	

CERAMIC TILE

1 - DELETE ALL CERAMIC BATHROOM ACCESSORIES - DELETE TOWEL BAR, PAPER HOLDER & SOAP DISH THROUGHOUT 18May22 Note:	
1 - TILE - UPGRADE 4 FLOOR TILE - - LAUNDRY ROOM 18May22 Note:	
1 - TILE - UPGRADE 4 FLOOR TILE - - KITCHEN 18May22 Note:	
1 - TILE - UPGRADE 4 FLOOR TILE - - POWDER ROOM 18May22 Note:	

CONSTRUCTION SUMMARY

Mountainview Heights 3 (G) - Russell Gardens Building Ltd.

PURCHASERS: Madiha KHAN and Gulraiz KHAN

TEL:

LOT / PHASE	REG. PLAN #	HOUSE TYPE		
575 / 4	62M-1266	Springfield Eleven (5 Bedroom) Elev 3		
1 - TILE - UPGRADE 4 FLOOR TILE - - MUD ROOM 18May22 Note:				
1 - TILE - UPGRADE 4 FLOOR TILE - - FOYER 18May22 Note:				
1 - TILE - UPGRADE 4 WALL TILE - - BATHROOM 4 - TUB 18May22 Note:				
1 - TILE - UPGRADE 4 FLOOR TILE - - BATHROOM 4 - FLOOR 18May22 Note:				
1 - TILE - UPGRADE 4 WALL TILE - - BATHROOM 2/3 - SHOWER 18May22 Note:				
1 - TILE - UPGRADE 4 FLOOR TILE - - BATHROOM 2/3 - FLOOR 18May22 Note:				
1 - TILE - UPGRADE 4 WALL TILE - - ENSUITE BATHROOM - SHOWER 18May22 Note:				
1 - TILE - UPGRADE 4 FLOOR TILE - - ENSUITE BATHROOM - FLOOR 18May22 Note:				

COUNTER TOP

1 - ALL BATHROOMS - 3' RETURN ON COUNTERTOPS 18May22 Note:	
1 - UPGRADE COUNTERTOP MATERIAL IN LIEU OF STANDARD IN OFFER - Kitchen 18May22 Note:	
1 - UPGRADE COUNTERTOP MATERIAL - Powder 18May22 Note:	
1 - UPGRADE COUNTERTOP MATERIAL - Main 4/5 18May22 Note:	
1 - UPGRADE COUNTERTOP MATERIAL - Bdrm 2/3 18May22 Note:	
1 - UPGRADE COUNTERTOP MATERIAL - Master 18May22 Note:	

DOORS AND TRIM

1 - MASTER BEDROOM - PRIVACY LOCK ON DOOR 18May22 Note:	
1 - ALL INTERIOR DOORS AND INTERIOR OF EXTERIOR DOORS - WEISER HALIFAX LEVERS - MATTE BLACK - 514 18May22 Note:	
1 - FRONT FOOR - WEISER TAVARIS GRIPSET - MATTE BLACK - 514 18May22 Note:	

CONSTRUCTION SUMMARY

Mountainview Heights 3 (G) - Russell Gardens Building Ltd.

PURCHASERS: Madiha KHAN and Gulraiz KHAN

TEL:

LOT / PHASE	REG. PLAN #	HOUSE TYPE		
575 / 4	62M-1266	Springfield Eleven (5 Bedroom) Elev 3		
1 - ALL INTERIOR DOORS - BLACK PLAIN HINGES 18May22 Note:				
1 - TRIM - UPGRADE 3- 7-¼" ONE STEP BASEBOARD AND ONE STEP BB CASING 18May22 Note:				

ELECTRICAL

1 - 200 AMP ELECTRICAL SERVICE 18May22 Note:	
1 - BUILT IN OVEN AND COOKTOP PROVISION - PROVISION ONLY - ELECTRICAL ONLY 18May22 Note:	
3 - FAN - BATHROOM EXHAUST FAN - ENERGY STAR 80 CFM - IN LIEU OF STANDARD FAN - ENSUITE BATHROOMS ONLY 18May22 Note:	
1 - PLUG - ELECTRICAL PLUG - TO BE INSTALLED OVER FIREPLACE 18May22 Note:	
1 - ABOVE KITCHEN ISLAND - ADD LIGHT AND SWITCH - NO FIXTURE INCLUDED 18May22 Note:	

FIREPLACE AND ACCESSORIES

1 - MANTEL - PAINTED - M 3 - IN LIEU OF STANDARD MANTEL 18May22 Note:	
--	--

HARDWOOD FLOORING

1 - LAMINATE – UPGRADE TO AVENUE SERIES IN LIEU OF STANDARD LAMINATE 18May22 Note:	
1 - HARDWOOD - GROUP B SERIES 5 INCH - IN LIEU OF 2 1/4 INCH NATURAL RED OAK - - MAIN HALL 18May22 Note:	
1 - HARDWOOD - GROUP B SERIES 5 INCH - IN LIEU OF 2 1/4 INCH NATURAL RED OAK - - LIVING AND DINING ROOM 18May22 Note:	
1 - HARDWOOD - GROUP B SERIES 5 INCH - IN LIEU OF 2 1/4 INCH NATURAL RED OAK - - LIBRARY/DEN 18May22 Note:	
1 - HARDWOOD - GROUP B SERIES 5 INCH - IN LIEU OF 2 1/4 INCH NATURAL RED OAK - - FAMILY ROOM 18May22 Note:	

PAINTING

1 - THROUGHOUT INTERIOR DOORS, BASEBAORDS, TRIM & FIREPLACE MANTEL - UPGRADE WHITE PAINT 18May22 Note:	
---	--

PLUMBING

2 - TOE TESTER - ADD TOE TESTER TO SHOWER - MASTER ENSUITE & ENSUITE 2/3 BATHROOMS 18May22 Note:	
1 - KITCHEN - DELTA EMMELINE- SINGLE HANDLE PULL DOWN FAUCET - CHAMPAGNE BRONZE - #9182-CZ-PR-DST 18May22 Note:	

CONSTRUCTION SUMMARY

Mountainview Heights 3 (G) - Russell Gardens Building Ltd.

PURCHASERS: Madiha KHAN and Gulraiz KHAN

TEL:

LOT / PHASE	REG. PLAN #	HOUSE TYPE		
575 / 4	62M-1266	Springfield Eleven (5 Bedroom) Elev 3		
1 - POWDER ROOM - MOEN RIZON ACCESSORIES - CHROME PIVOTING PAPER HOLDER - #YB2408 - C 9" TOWEL BAR - #YB2486 - C 18May22 Note:				
1 - MASTER ENSUITE, ENSUITE 2/3 & ENSUITE 4/5 BATHROOMS - MOEN RIZON ACCESSORIES - CHROME PIVOTING PAPER HOLDER - #YB2408 - C 24" TOWEL BAR - #YB2424 - C 9" TOWEL BAR - #YB2486 - C (2 IN MASTER) 18May22 Note:				
2 - ENSUITE 2/3 & ENSUITE 4/5 BATHROOMS - MOEN ENGAGE ECO-PERFORMANCE 6 FUNCTION HAND SHOWER WITH MAGNETIX DOCKING - CHROME - #26100EP-C 18May22 Note:				
1 - ALL BATHROOMS - DELETE PLATE FROM STANDARD FAUCET - INSTALL WITH SINGLE HOLE INSTALLATION 18May22 Note:				
5 - SINK - UNDERMOUNT SINK - TECO BATH #4815 - ALL BATHROOMS 18May22 Note:				
1 - SINK - UNDERMOUNT SINK - BLANCO QUATRUS R15 U SUPER SINGLE #401518 - KITCHEN 18May22 Note:				
4 - HOT WATER VALVE NEXT TO TOILET - ALL BATHROOMS 18May22 Note:				

PROMOTIONAL

1 - LESS CREDIT FROM PURCHASER EXTRA SHEET IN OFFER 18May22 Note:	
--	--

STAIRS AND RAILINGS

1 - STAINED STAIRS – STANDARD STAIRCASE - PRICE IS PER SET 18May22 Note:	
---	--

EXTRAS AS PER OFFER

PURCHASER(S) ACKNOWLEDGES THAT THE PURCHASE PRICE IS INCLUSIVE OF ALL CREDITS AND PROMOTIONAL PACKAGES AVAILABLE AT TIME OF PURCHASE. Worksheet Note:	
Granite kitchen counter top, from Vendor?s standard samples Worksheet Note:	
(1) The Vendor agrees that notwithstanding any other term or provision in this Agreement included in the Purchase Price and in addition to those items detailed in Schedule GP to the Agreement of Purchase and Sale, the Purchaser is entitled to a credit of Worksheet Note:	
Purchase Price includes 3 enlarged basement windows, and the obligation to construct the house with the enlarged basement windows is subject to the Vendors approval, in its sole and unfettered discretion The Purchaser acknowledges and agrees that the loc Worksheet Note:	
10 foot ceiling height on Main Level. The Purchaser acknowledges that as a result of the increased ceiling height from the Vendor?s standard ceiling height, various modifications to the interior and exterior of the dwelling unit may be made, including bu Worksheet Note:	

Purchasers:

Madiha KHAN & Gulraiz KHAN

Telephone Res. / Bus:

/

Decor Advisor:

Candace Forza

Lock Date:

18-May-22

Property: 575

Project: Russell Gardens Building Ltd.

Model and Elevation: Springfield Eleven (5 Bedroom) Elev 3

Plan #:

62M-1266

Layout Changes:

☒ Yes ☐ No

Sketch Attached:

☒ Yes ☐ No

Exterior Colour Scheme:

1. Cabinetry

	Style and Colour	Hardware
Kitchen / Breakfast	RICHMOND 350 PLATINUM SILVER	465SA
Laundry Room	ELISSE	Standard
Powder Room	CONTINENTAL 350 PLATINUM SILVER	468SA
Master Ensuite Bathroom	CONTINENTAL 350 PLATINUM SILVER	468SA
Ensuite Bath - Bedroom 2/3	DORAL H3081 HACIENDA BLACK	467SA
Ensuite Bath - Bedroom 4/5	DORAL W-500	467SA

Appliances:

Built In Appliances ☒ Yes ☐ No

Slide In Stove ☐ Yes ☒ No

Dishwasher Cabinet ☐ Closed ☒ Open

41" Upper Cabinets ☒ Yes ☐ No

Please NOTE: Standard Cabinet Height is 30"

Stove Opening

NOTE: If not specified, opening will be set to builder's standard opening of approximately 30" width

Fridge Opening

NOTE: If not specified, opening will be set to builder's standard opening of approximately 37" width x 74" height

** Refer to Construction Summary

2. Counters

	Counter	Edge
Kitchen / Breakfast	QUARTZITE-SEA PEARL	#360
Laundry Room	N/A	
Powder Room	QUARTZ-TRAMONTANA	#360
Master Ensuite Bathroom	QUARTZ-VICTORIA	#360
Ensuite Bath - Bedroom 2/3	QUARTZ-ISTRIA	#360
Ensuite Bath - Bedroom 4/5	QUARTZ-ARABESCATO NUOVO	#360

** Refer to Construction Summary

Initials:

MK

Purchasers:

Madiha KHAN & Gulraiz KHAN

Telephone Res. / Bus:

/

Decor Advisor:

Candace Forza

Lock Date:

18-May-22

Property: 575

Project: Russell Gardens Building Ltd.

Model and Elevation: Springfield Eleven (5 Bedroom) Elev 3

Plan #:

62M-1266

3. Ceramic Flooring

Entrance Vestibule	TILE-MILOS WHITE POLISHED-24X24	<input type="checkbox"/>	At a 45 Threshold-If App. metal strip where applicable
Main Hall	STRIP	<input type="checkbox"/>	
Kitchen / Breakfast	TILE-MILOS WHITE POLISHED-24X24	<input type="checkbox"/>	
Laundry Room	TILE-MILOS WHITE POLISHED-24X24	<input type="checkbox"/>	
Powder Room	TILE-MILOS WHITE POLISHED-24X24	<input type="checkbox"/>	
Master Ensuite Bathroom	TILE-AGATA WHITE POLISHED-24X24	<input type="checkbox"/>	
Ensuite Bath - Bedroom 2/3	TILE-NANTES WHITE POLISHED-24X24	<input type="checkbox"/>	
Ensuite Bath - Bedroom 4/5	TILE-LITIUM SILVER POLISHED-24X24	<input type="checkbox"/>	
MUD ROOM	TILE-MILOS WHITE POLISHED-24X24	<input type="checkbox"/>	
		<input type="checkbox"/>	
		<input type="checkbox"/>	

** Refer to Construction Summary

4. Ceramic Wall Tile

Master Ensuite Bathroom	Selection	Describe
Tub Deck Wall	N/A	
Tub Deck	N/A	
Tub Deck Skirt	N/A	
Shower Stall	TILE-AGATA WHITE POLISHED-24X24	
Bathtub Enclosure Walls	N/A	
Ensuite Bath - Bedroom 2/3	TILE-NANTES WHITE POLISHED-24X24	
Ensuite Bath - Bedroom 4/5	TILE-LITIUM SILVER POLISHED-24X24	
MUD ROOM		
Kitchen Backsplash	N/A	

** Refer to Construction Summary - STANDARD GROUT THROUGHOUT UNLESS SPECIFIED

5. Plumbing Fixtures

All Bathrooms

White

N/A

N/A

N/A

N/A

N/A

Whirlpool

N/A

Yes

No

Dishwasher Rough-In

Yes

No

Waterline for Fridge

Yes



No

** Refer to Construction Summary

6. Trim Carpentry

Interior Doors	CARRARA-SMOOTH
Interior Trim	BB CASING WITH 7 1/4" BASEBOARD - ONE STEP
Door Handles	As Per Construction Specifications
Exterior Front Door Handle	WEISER TAVARIS GRIPSET - M ATTE BLACK 514

** Refer to Construction Summary

Initials:  

Purchasers: Madiha KHAN & Gulraiz KHAN

Telephone Res. / Bus: /

Decor Advisor: Candace Forza

Lock Date: 18-May-22

Property: 575

Project: Russell Gardens Building Ltd.

Model and Elevation: Springfield Eleven (5 Bedroom) Elev 3

Plan #: 62M-1266

7. Other Flooring		
Main Hall	STRIP-MIRAGE-SWEET MEMORIES-BRUSHED-RED OAK-DURAMATT-TREASURE-5"	
Living Room	STRIP-MIRAGE-SWEET MEMORIES-BRUSHED-RED OAK-DURAMATT-TREASURE-5"	
Dining Room	STRIP-MIRAGE-SWEET MEMORIES-BRUSHED-RED OAK-DURAMATT-TREASURE-5"	
Family Room	STRIP-MIRAGE-SWEET MEMORIES-BRUSHED-RED OAK-DURAMATT-TREASURE-5"	
Den / Library / Study	STRIP-MIRAGE-SWEET MEMORIES-BRUSHED-RED OAK-DURAMATT-TREASURE-5"	
Basement Landing(If Applies)	N/A	
Lower Landing (If Applies)	N/A	
Upper Landing	STRIP-MIRAGE-SWEET MEMORIES-BRUSHED-RED OAK-DURAMATT-TREASURE-5"	
Upper Hall	LAMINATE-AVENUE-LAUREL OAK-TL-AV233-PEFC	
Master Bedroom	LAMINATE-AVENUE-LAUREL OAK-TL-AV233-PEFC	
Bedroom #2	LAMINATE-AVENUE-LAUREL OAK-TL-AV233-PEFC	
Bedroom #3	LAMINATE-AVENUE-LAUREL OAK-TL-AV233-PEFC	
Bedroom #4	LAMINATE-AVENUE-LAUREL OAK-TL-AV233-PEFC	
Bedroom #5	LAMINATE-AVENUE-LAUREL OAK-TL-AV233-PEFC	
Underpad	Type	Area
	N/A	N/A

** Refer to Construction Summary

8. Railings and Pickets

Railing Type	BOX 4X4 POSTS & V-GROOVE	Complimenting Colour	MIRAGE TREASURE RED OAK
Picket Type	EUROLINE 1	Complimenting Colour	BLACK
Stringer / Riser	AS PER CONSTRUCTION SPECIFICATIO	Complimenting Colour	MIRAGE TREASURE RED OAK
Treads	AS PER CONSTRUCTION SPECIFICATIO	Complimenting Colour	MIRAGE TREASURE RED OAK
Red Oak Stairs <input checked="" type="radio"/> Yes <input type="radio"/> No			



** Refer to Construction Summary THE STAIN COLOURS OR FINISH AVAILABLE ON RISERS, TREADS, PICKETS AND RAILS (STAIRCASES), WILL NOT BE AN EXACT MATCH TO PREFINISHED HARDWOOD OR LAMINATE FLOORS.

9. Wall Paint Flat Finish

Main & Upper Hall	22 WARM GREY	Master Bedroom	22 WARM GREY
Living Room	22 WARM GREY	Bedroom #2	22 WARM GREY
Dining Room	22 WARM GREY	Bedroom #3	22 WARM GREY
Kitchen / Breakfast	22 WARM GREY	Bedroom #4	22 WARM GREY
Family Room	22 WARM GREY	Bedroom #5	22 WARM GREY
Powder Room	22 WARM GREY	Master Ensuite	22 WARM GREY
Laundry Room	22 WARM GREY	Ensuite Bath - Bedroom 2/3	22 WARM GREY
Den/Library	22 WARM GREY	Ensuite Bath - Bedroom 4/5	22 WARM GREY
Trim & Door Paint-Semi Gloss	WHITE	MUD ROOM	22 WARM GREY

Smooth Ceilings First Floor ☐ Yes ☒ No

** Refer to Construction Summary

Initials:  

Purchasers: Madiha KHAN & Gulraiz KHAN

Property: 575

Telephone Res. / Bus: /

Project: Russell Gardens Building Ltd.

Decor Advisor: Candace Forza

Model and Elevation: Springfield Eleven (5 Bedroom) Elev 3

Lock Date: 18-May-22

18-May-22

Plan #: 62M-1266

10. Plaster Mouldings and Medallions

Entrance Vestibule	N/A	N/A	Kitchen/Breakfast	N/A	N/A
Main Hall	N/A	N/A	Den/Library	N/A	N/A
Living Room	N/A	N/A	Lower Landing	N/A	N/A
Dining Room	N/A	N/A		N/A	N/A
Family Room	N/A	N/A		N/A	N/A

** Refer to Construction Summary

11. Fireplace

Living Room			Family Room			Other Room - Specify		
Purchased	As Per Plan	N/A	Purchased	As Per Plan	N/A	Purchased	As Per Plan	N/A
<input type="radio"/>	<input type="radio"/>	<input checked="" type="radio"/>	<input type="radio"/>	<input checked="" type="radio"/>	<input type="radio"/>	<input type="radio"/>	<input type="radio"/>	<input checked="" type="radio"/>
Fireplace Type	N/A		FLAT ON WALL		N/A		N/A	
Mantle Type	N/A		MANTLE M3		N/A		N/A	
Colour / Stain	N/A		AS PER CONSTRUCTION SPECIFICATIONS		N/A		N/A	
Surround	N/A		GRIGIO CARNICO		N/A		N/A	
Hearth	N/A		NO		N/A		N/A	

** Refer to Construction Summary

12. Heating and Air Conditioning

Air Conditioning	NO	Gas Provisions Stove	NO
Gas Provisions Dryer	NO	Gas Provisions Barbecue	NO
Comment			

** Refer to Construction Summary

13. Electrical

Plugs and Switches	<input checked="" type="radio"/> White	DECOR	Above Kitchen Cabinet Light	<input type="radio"/> Yes	<input checked="" type="radio"/> No
Hood Fan	STANDARD WHITE		Below Kitchen Cabinet Light	<input type="radio"/> Yes	<input checked="" type="radio"/> No
Appliances	Built in Cooktop	Built in Oven	Gas Stove	Microwave	
	<input checked="" type="radio"/> Yes <input type="radio"/> No	<input checked="" type="radio"/> Yes <input type="radio"/> No	<input type="radio"/> Yes <input checked="" type="radio"/> No	<input checked="" type="radio"/> Yes <input type="radio"/> No	
Dishwasher Rough-in	Yes				

** Refer to Construction Summary

14. General Comments

** Refer to Construction Summary

Disclaimers and Notes

- Colours of all materials are as close as possible to builder's selection, but not necessarily identical due to variances in manufacturing.
- Any extras listed above are null and void unless accompanied by a separate invoice/amendment. Said invoice must be paid in full.
- The Purchaser agrees that this colour selection is final and that no changes will be permitted, unless required by the Vendor.
- The Purchaser acknowledges reading and accepting document which contains other miscellaneous disclaimers.
- In the event of a conflict between the Standard Features schedule of the Agreement of Purchase and Sale and the Interior Colour Scheme, the Interior Colour Scheme shall prevail.

Signature: 

Date: May 18, 2022

Signature: 

Date:

575-Russell
Gardens
Ph 4.

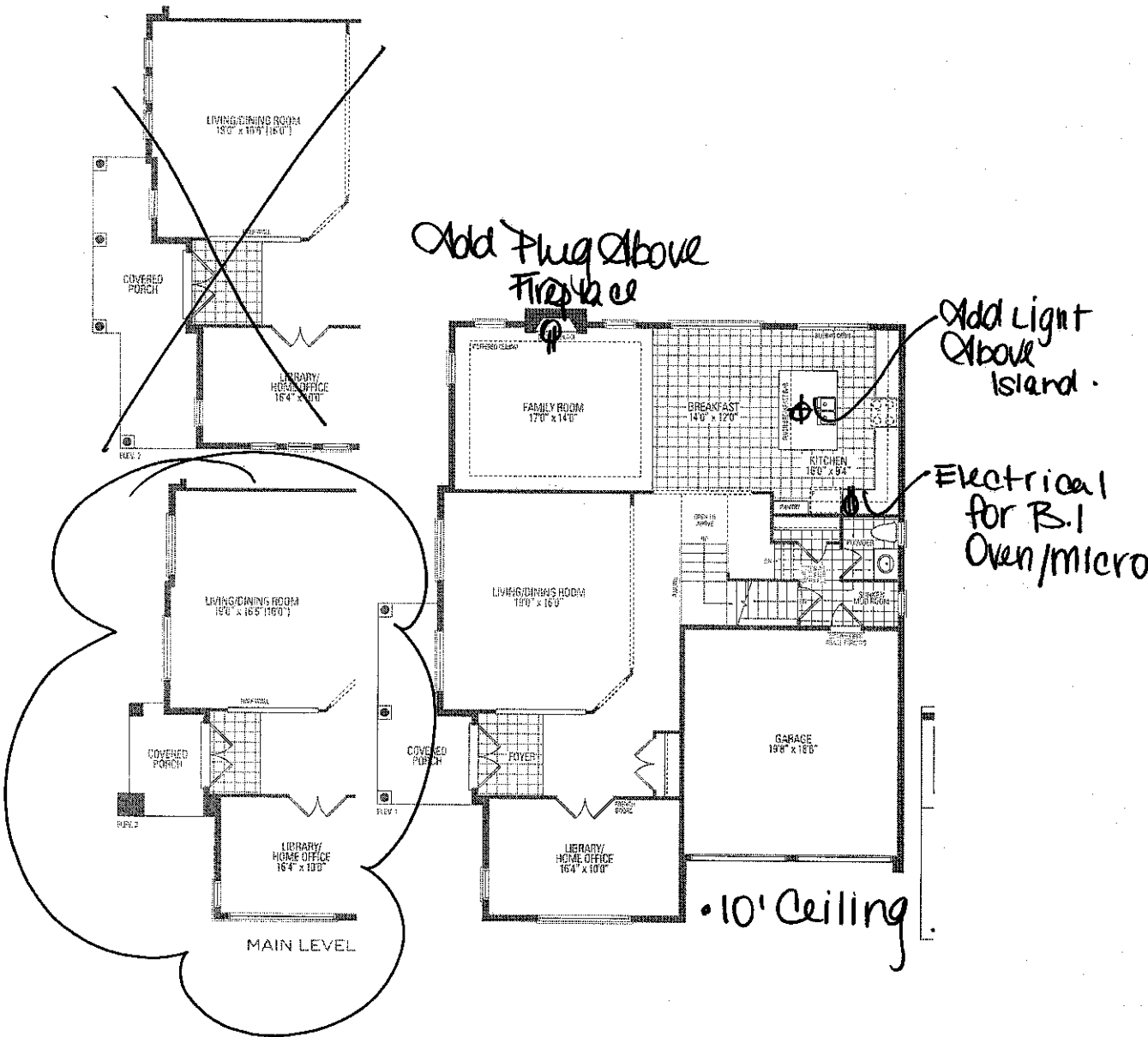

SPRINGFIELD ELEVEN ELEV. 1

Orientation of home may be reversed and purchaser agrees to stated floor areas. All renderings are artist's concept. Dimension



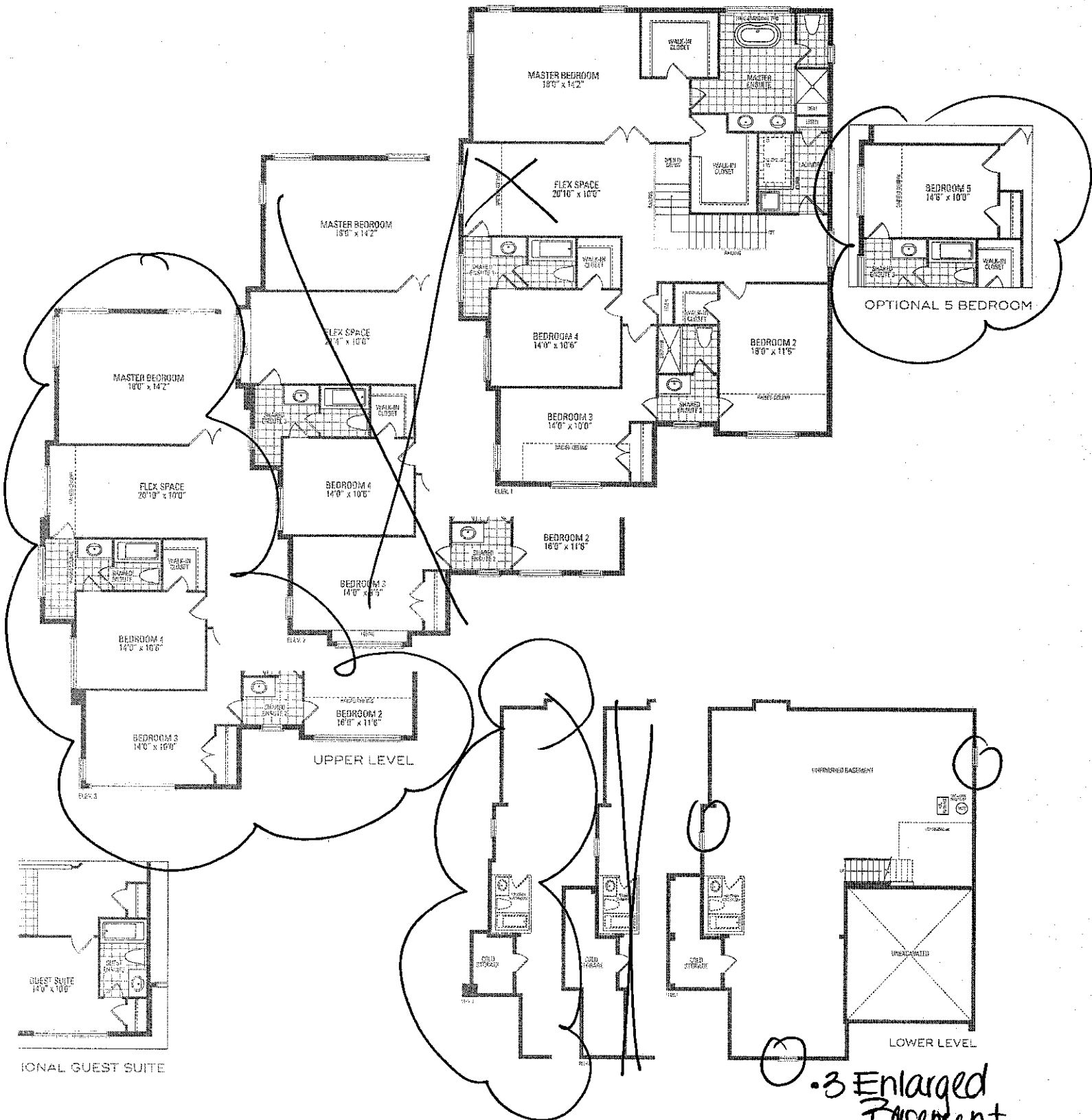

321 sq.ft. | ELEV. 2 • 3,641 sq.ft. | ELEV. 3 • 3,633 sq.ft. | Include 16 sq.ft. of open area.

note: Steps and porches may vary at any exterior entrance ways due to grading variance. Actual usable floor space may vary from the options and architectural detailing subject to modifications. Roofline and adjoining model types may vary due to siting. E. & O.E May 2021

Full-out Spice
+ $\text{Rack}(x2)$.

Upg. 1 Richmond
Cabinetry

am 3 Moulding

• Light Valve.

- Soft closing cabinetry.

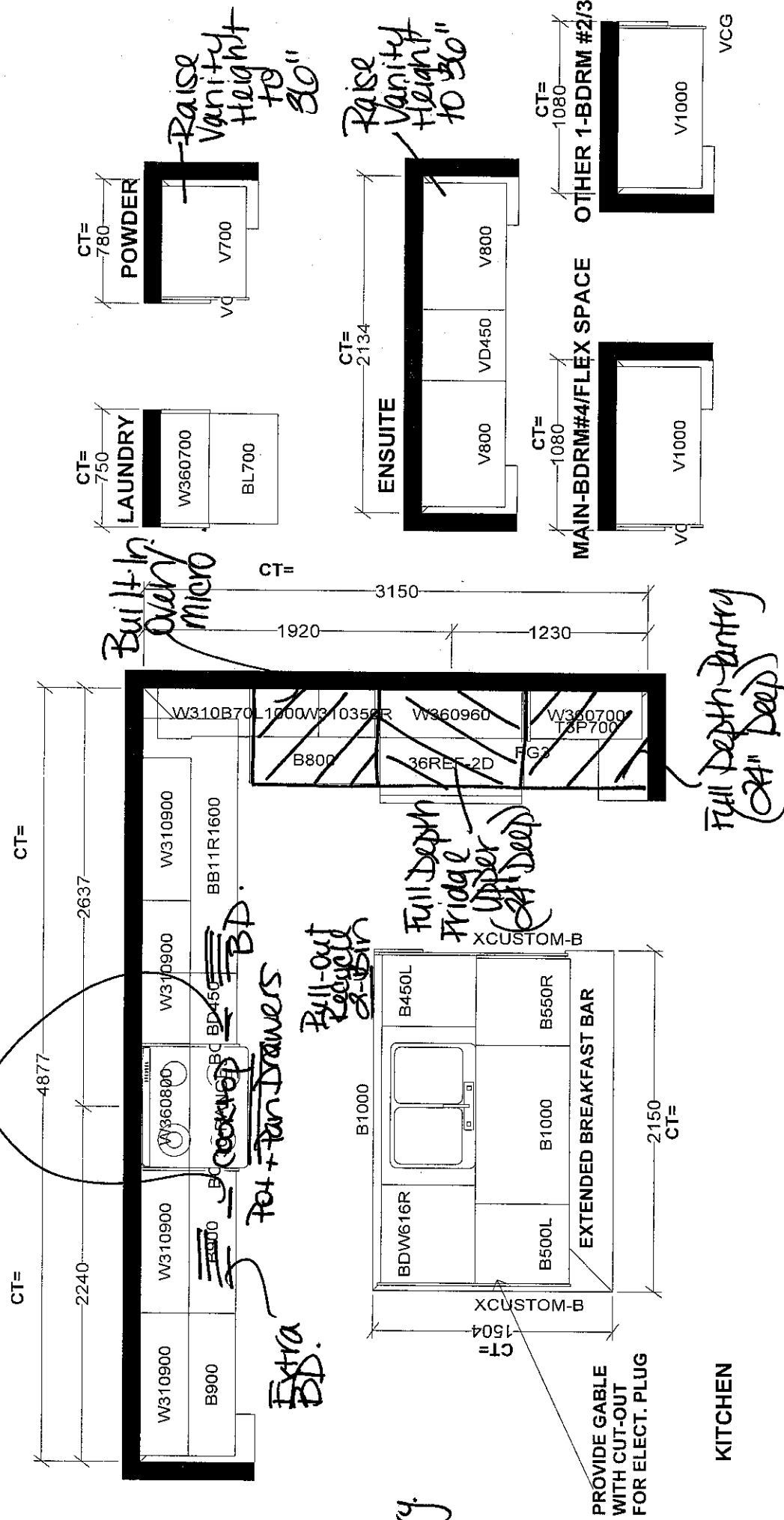

KITCHEN

Selba Industries				J #
W WDTH	W HGHT	W CNT	This drawing is the intellectual property of SELBA INDUSTRIES, INC. and is an original design which must not be released or copied unless applicable fee has been paid or job order placed.	
FLOOR HGHT	DOOR HGHT		JOB NUMBER: BUILDER: GREENPARK SITE: RUSSELL GARDENS PH.4 MODEL: SPRINGFIELD 11X EL 1, 2, 3 LOT #:	
ST CNT	2X4	VENT BOX COVER	DESIGNER: LR DATE: APR 28 21	

30" Double Wall Oven

800 Series – Stainless Steel HBL8651UC

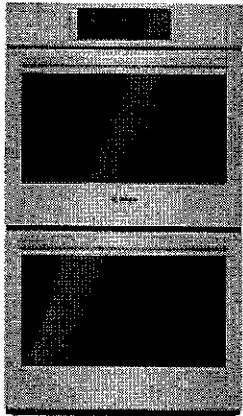

HBL8651UC
Stainless Steel

Also available in:
Black HBL8661UC

The Bosch wall oven
installs flush and features
a SmoothClose door.

Features & Benefits

- Dampened hinges softly and quietly guide the SmoothClose door shut.
- A full-extension telescopic rack offers safe access to the oven cavity.
- Touch control with SteelTouch™ buttons makes operating the oven easier.
- The wall oven is designed to be installed flush with cabinetry.
- Bosch wall ovens are compatible with most competitors' cutouts.

General Properties	
Cooking Modes - upper cavity	Bake, Variable Broil (hi & low), Roast, Warm, Sabbath, Proof Dough, Convection Bake, Convection Broil, Convection Roast, Pizza, Multi Rack, Genuine European Convection, Convection Conversion, Temperature Probe, Fast Preheat
Cooking Modes - lower cavity	Bake, Variable Broil (hi & low), Roast, Warm, Sabbath
Cleaning Type - upper cavity	Self-Clean
Cleaning Type - lower cavity	Self-Clean
Telescopic Rack	1
Illumination Type - upper cavity	Incandescent
Illumination Type - lower cavity	Incandescent
Interior Lights - upper cavity	2
Interior Lights - lower cavity	1

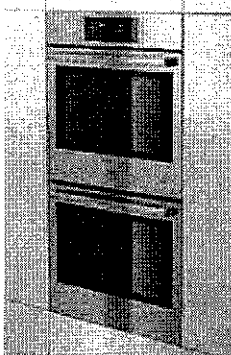

Oven Performance	
Bake Element Wattages - upper cavity	2,400 W
Broil Element Wattages - upper cavity	3,800 W
Convection Element Wattages - upper cavity	2,000 W
Bake Element Wattages - lower cavity	2,400 W
Broil Element Wattages - lower cavity	3,800 W
Convection Element Wattages - lower cavity	N/A
Technical Details	
Watts (W)	8,495 W
Circuit Breaker (A)	40 A
Volts (V)	240/208 V
Frequency (Hz)	60 Hz
Power Cord Length (in)	50"
Plug Type	Fixed Connection, No Plug
Energy Source	Electric
Dimensions & Weight	
Overall Appliance Dimensions (HxWxD)(in)	52 1/16" x 29 3/4" x 23 1/2"
Required Cutout Size (HxWxD) (in)	49 3/4" x 51 1/2" x 28 1/2" x 23 1/2"
Net Weight (lbs)	261 lbs
Accessories-Included	
Included	Upper Oven: 3 x Oven Racks, Temperature Probe Lower Oven: 2 x Oven Racks
Accessories-Optional	

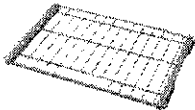

HEZTR301
30" Telescopic Rack

For help and assistance with Bosch accessories please call 1-800-944-2904 Mon-Fri 8am to 5pm EST

Notes: All height, width and depth dimensions are shown in inches. Please refer to installation instructions prior to making cutout. BSH reserves the absolute and unrestricted right to change product materials and specifications, at any time, without notice. Consult the product's installation instructions for final dimensional data and other details. Applicable product warranty can be found in accompanying product literature or you may contact your account manager for further details.

Warranties: Bosch warrants that the Product is free from defects in materials and workmanship for a period of three hundred and sixty-five (365) days from the date of purchase. The foregoing timeline begins to run upon the date of purchase, and shall not be stalled, tolled, extended, or suspended, for any reason whatsoever. This Product is also warranted to be free from cosmetic defects in material and workmanship (such as scratches of stainless steel, paint/porcelain blemishes, chip, dents, or other damage to the finish of the Product) for a period of thirty (30) days from the date of purchase or closing date for new construction. This cosmetic warranty excludes slight colour variations due to inherent differences in painted and porcelain parts, as well as differences caused by kitchen lighting, product location, or other similar factors. This cosmetic warranty specifically excludes any display, floor, "As Is", or "B" stock appliances.

For more information on our entire line of products, go to www.bosch-home.ca or call 1-800-944-2904

© 2014 BSH Home Appliances Canada. All rights reserved. Bosch is a registered trademark of Robert Bosch GmbH.

30" Double Wall Oven

800 Series – Stainless Steel HBL8651UC



Installation Details

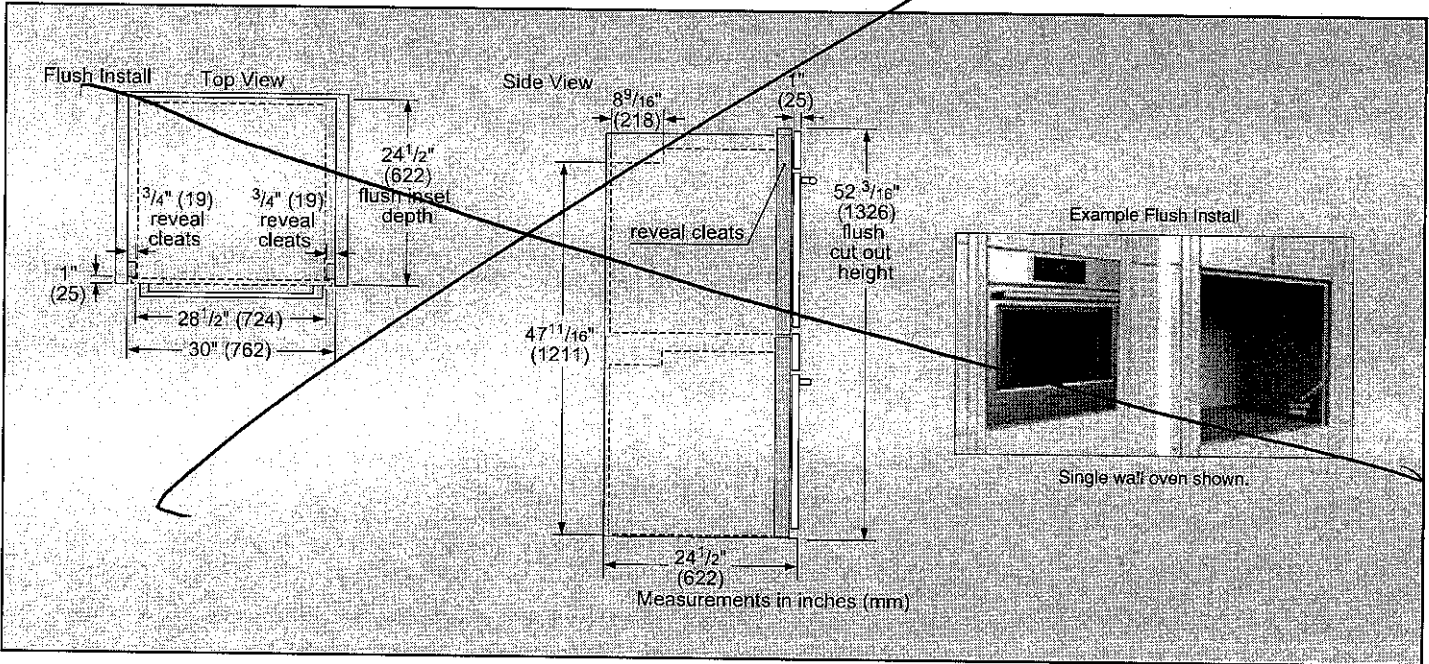
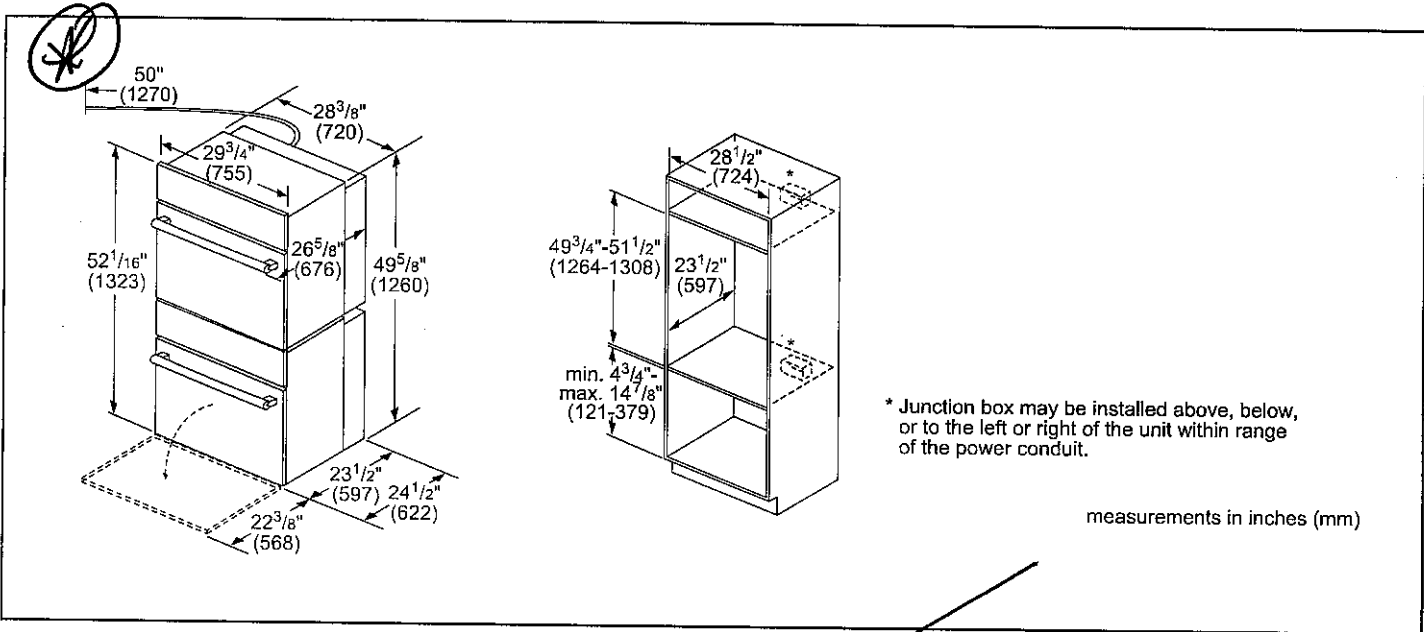

For help and assistance with Bosch accessories please call 1-800-944-2904 Mon-Fri 8am to 6pm EST

Notes: All height, width and depth dimensions are shown in inches. Please refer to installation instructions prior to making cutout. BSH reserves the absolute and unrestricted right to change product materials and specifications, at any time, without notice. Consult the product's installation instructions for final dimensional data and other details. Applicable product warranty can be found in accompanying product literature or you may contact your account manager for further details.

Warranties: Bosch warrants that the Product is free from defects in materials and workmanship for a period of three hundred and sixty-five (365) days from the date of purchase. The foregoing timeline begins to run upon the date of purchase, and shall not be stalled, tolled, extended, or suspended, for any reason whatsoever. This Product is also warranted to be free from cosmetic defects in material and workmanship (such as scratches of stainless steel, paint/porcelain blemishes, chip, dents, or other damage to the finish of the Product) for a period of thirty (30) days from the date of purchase or closing date for new construction. This cosmetic warranty excludes slight colour variations due to inherent differences in painted and porcelain parts, as well as differences caused by kitchen lighting, product location, or other similar factors. This cosmetic warranty specifically excludes any display, floor, "As Is", or "B" stock appliances.

For more information on our entire line of products, go to www.bosch-home.ca or call 1-800-944-2904

© 2014 BSH Home Appliances Canada. All rights reserved. Bosch is a registered trademark of Robert Bosch GmbH.

36" Gas Cooktop

800 Series – Stainless Steel NGM8657UC

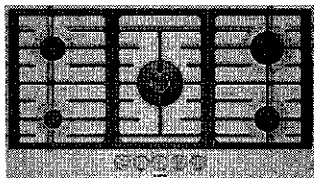

NGM8657UC
Stainless Steel

The stainless steel gas cooktop with FlameSelect® – achieve consistent cooking results thanks to nine precisely defined power levels.

Features & Benefits

- FlameSelect® – allows for a precise adjustment of the flame size with nine defined power levels
- Dual flame power burner with two heat options, quickly boil water or maintain a precise simmer
- Heavy-duty grates can be easily and quickly cleaned in the dishwasher
- OptiSim® burner – simmer delicate sauces and melt chocolate without scorching
- Low profile stainless steel cooking surface is easily accessible and quick to clean

General Properties	
No. of burners	5
Knob color	Stainless steel appearance
Control location	Front center
Sealed burners	Yes
Gas valves	Five 9-level step valves
Ignition system	Electric, thermocouple safety control
Cooktop surface material	Stainless steel
Grate material	Cast iron
Grate features	Continuous grates, dishwasher safe
Element Performance	
Total BTU load (NG / LP)	41,400 / 40,100
Power of front left burner (NG / LP) OptiSim®	3,400 / 3,400 BTU
Power of back left burner (NG / LP)	6,000 / 6,000 BTU
Power of center burner (NG / LP) Dual-flame	17,000 / 15,700 BTU
Power of back right burner (NG / LP)	9,000 / 9,000 BTU
Power of front right burner (NG / LP)	6,000 / 6,000 BTU

Technical Details	
Circuit breaker	15 A
Volts	120 V
Frequency	60 Hz
Plug type	3-prong
Power cord length	40"
Fuel type	Natural Gas (factory set)
Convertible to LP (kit required)	Yes
Dimensions & Weight	
Overall appliance dimensions (HxWxD)	2 23/64" x 36" x 20 1/2"
Required cutout size (HxWxD)	1 1/4" x 33 1/2" x 19 5/16"
Minimum distance from counter front	1 7/8"
Minimum distance from rear wall	3"
Net weight	42 lbs
Accessories – Included	
Included	LP conversion kit, OptiSim® cap
Accessories – Optional	



HEZ298107
Wok ring



Accessories: To purchase Bosch accessories, cleaners & parts please visit www.bosch-home.com/us/store or call 1-800-944-2904 (Mon to Fri 5 am to 6 pm PST, Sat 6 am to 3 pm PST).
Notes: All height, width and depth dimensions are shown in inches. BSH reserves the absolute and unrestricted right to change product materials and specifications, at any time, without notice. Consult the product's installation instructions for final dimensional data and other details prior to making cutout.
Warranties: Please see Use & Care manual or Bosch website for statement of limited warranty.
For more information on our entire line of products, go to www.bosch-home.com/us or call 1-800-944-2904
© BSH Home Appliances Corporation. All rights reserved. Bosch is a registered trademark of Robert Bosch GmbH.

36" Gas Cooktop

800 Series – Stainless Steel NGM8657UC



Installation Details

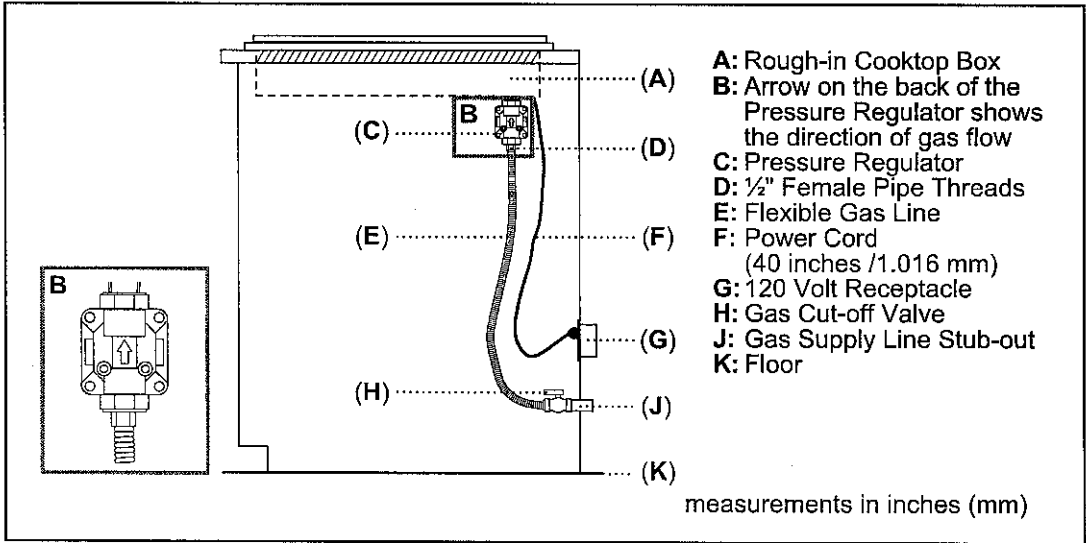
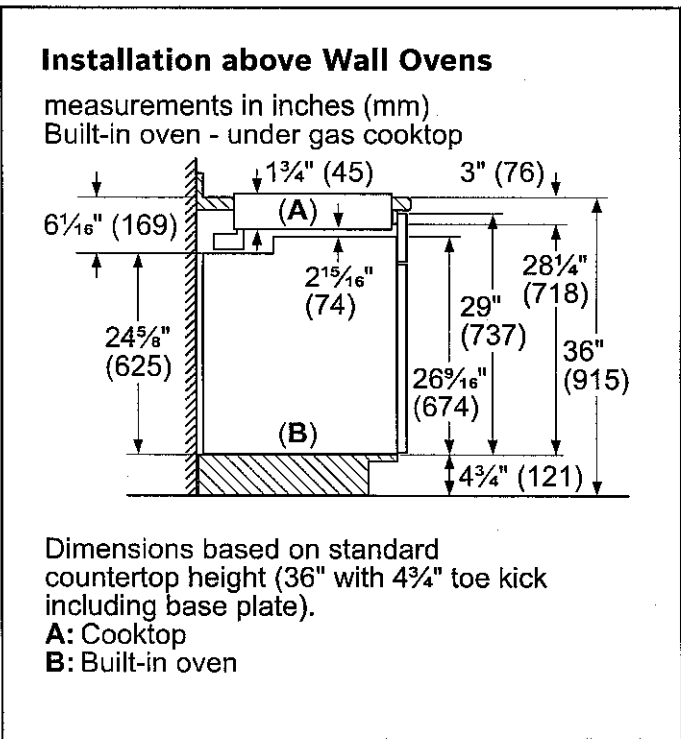
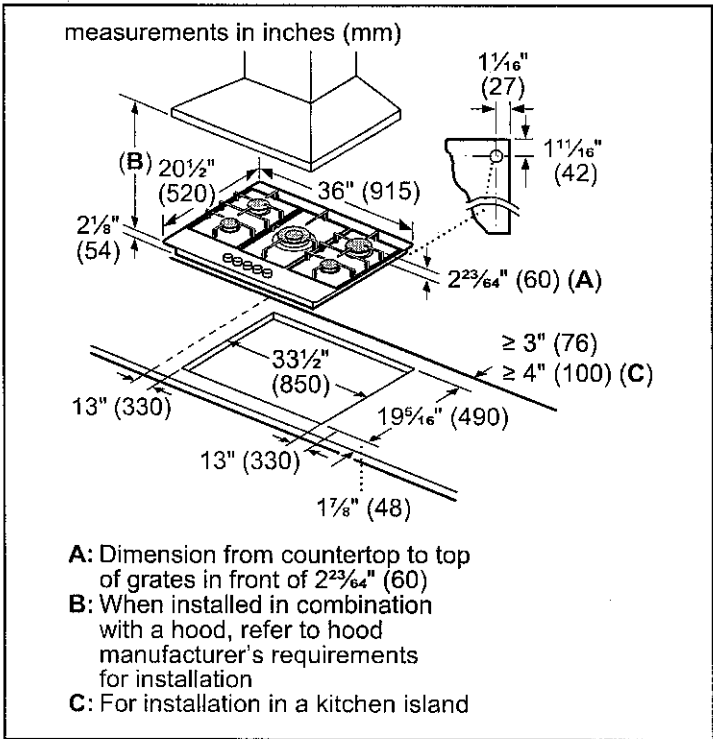

Accessories: To purchase Bosch accessories, cleaners & parts please visit www.bosch-home.com/us/store or call 1-800-944-2904 (Mon to Fri 5 am to 6 pm PST, Sat 6 am to 3 pm PST).

Notes: All height, width and depth dimensions are shown in inches. BSH reserves the absolute and unrestricted right to change product materials and specifications, at any time, without notice. Consult the product's installation instructions for final dimensional data and other details prior to making cutout.

Warranties: Please see Use & Care manual or Bosch website for statement of limited warranty.

For more information on our entire line of products, go to www.bosch-home.com/us or call 1-800-944-2904

© BSH Home Appliances Corporation. All rights reserved. Bosch is a registered trademark of Robert Bosch GmbH.

36" Gas Cooktop

800 Series – Stainless Steel NGM8657UC



Installation Details

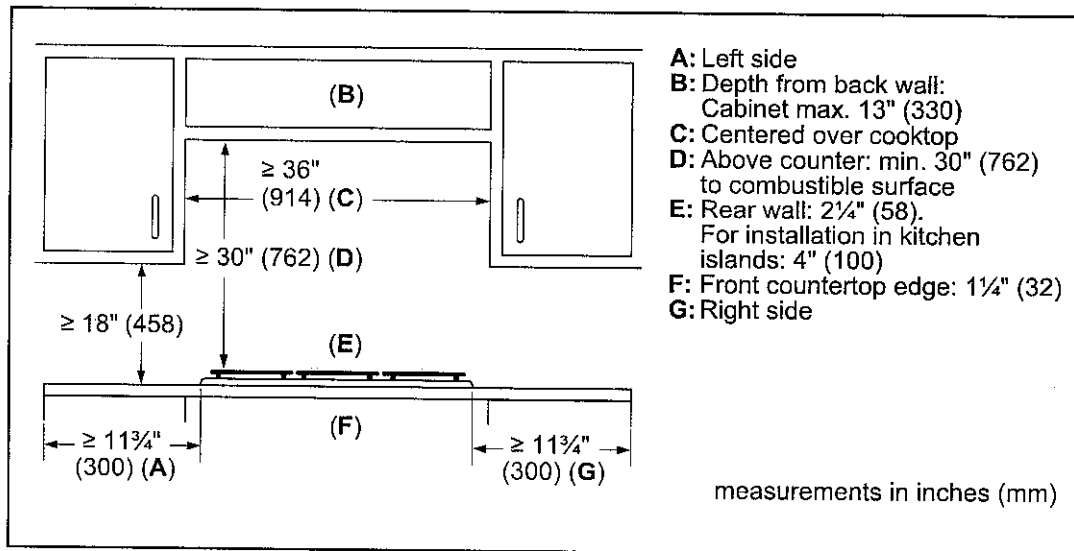

Accessories: To purchase Bosch accessories, cleaners & parts please visit www.bosch-home.com/us/store or call 1-800-944-2904 (Mon to Fri 5 am to 6 pm PST, Sat 6 am to 3 pm PST).

Notes: All height, width and depth dimensions are shown in inches. BSH reserves the absolute and unrestricted right to change product materials and specifications, at any time, without notice. Consult the product's installation instructions for final dimensional data and other details prior to making cutout.

Warranties: Please see Use & Care manual or Bosch website for statement of limited warranty.

For more information on our entire line of products, go to www.bosch-home.com/us or call 1-800-944-2904

© BSH Home Appliances Corporation. All rights reserved. Bosch is a registered trademark of Robert Bosch GmbH.



Dishwashers

24" Recessed Handle
Dishwasher
300 Series- Stainless steel
SHEM63W55N

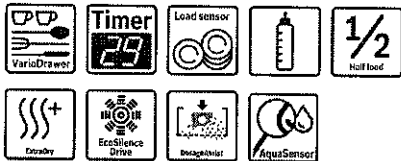
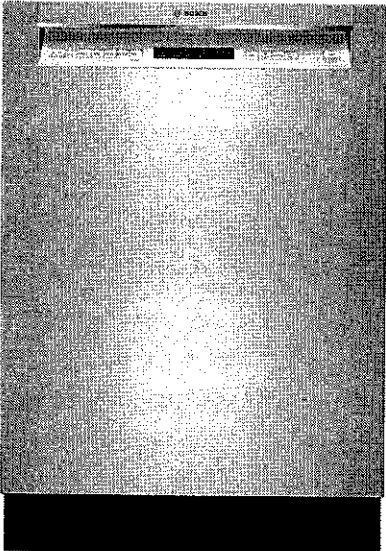

The 3rd rack provides the perfect space for silverware and large utensils while its V shape leaves room below for taller items.

- 44 dBA: Quietest dishwasher brand.
- A 3rd rack adds versatility and offers 30% more loading capacity.
- FlexSpace™ Tines fold back to fit your larger pots & pans.
- RackMatic® offers 3 height levels, for 9 possible rack positions.
- Speed60® gets your dishes from dirty to dry in about an hour.

Technical Data

Upper Rack :	500
Adjustable upper rack :	Rackmatic 3-stage
Upper rack cup shelf :	2
Lower Rack :	500
3rd Rack :	3rd Rack 1.0
Silverware Basket :	Standard
Accessories Parts :	no
Optional accessories :	
SGZ1010UC, SMZ4000UC, SMZ5000, SMZPC002UC	
UPC code :	825225922438
Variant color :	Stainless steel
Panel ready :	No
Alternative colors available :	SHEM63W52N, SHEM63W56N
Silence level (dBA) :	44
Watts (W) :	1300
Current (A) :	12
Volts (V) :	120
Frequency (Hz) :	60
Energy Consumption (kWh/yr) :	269
Energy Star® qualified :	Yes
Plug type :	fixed connection
Required cutout size (HxWxD) (in) :	x 33 7/8 " x 23 9/16 "
Required cutout size (HxWxD) (mm) :	860-890 x 610 x 610
Overall appliance dimensions (HxWxD) (in) :	
33 7/8 " x 23 9/16 " x 23 3/4 "	
Power cord length (in) :	43 1/2"
Power cord length (cm) :	110
Length outlet hose (in) :	67 "
Length outlet hose (cm) :	175
Product packaging dimensions (HxWxD) (in) :	
35 3/4" x 26" x 29 5/16"	
Tub material :	Stainless steel
Tub type :	TallTub
ADA Compliant :	No
Number of place settings :	16

Optional accessories

- SGZ1010UC : Drain hose extension kit
- SMZ4000UC : silverware basket US Duo
- SMZ5000 : Dishwashing aid set
- SMZPC002UC : Powercord with cold plug



Dishwashers

24" Recessed Handle Dishwasher 300 Series- Stainless steel SHEM63W55N

The 3rd rack provides the perfect space for silverware and large utensils while its V shape leaves room below for taller items.

Key Features

- 44 dB - Quietest Dishwasher Brand.
- 3rd Rack for Additional Loading Capacity
- InfoLight® Beams on Floor to Indicate Dishwasher is Running
- RackMatic® on Upper Rack - 3 Height Adjustments and Up to 9 Possible Rack Positions
- AquaStop® Leak Protection Works 24/7

Design

- Full Size Stainless Steel Tall Tub Installs Perfectly Flush
- 3rd Rack for Additional Loading Capacity
- 16 Place Setting Capacity
- LED Remaining Time Display
- RackMatic® on Upper Rack - 3 Height Adjustments and Up to 9 Possible Rack Positions

Performance

- 44 dB - Quietest Dishwasher Brand.
- 5 Wash Cycles and 4 Options
- Detergent Tray Optimizes Detergent Dissolving
- Speed60® gets your dishes from dirty to dry in about an hour.
- Extra Dry Option for Better Drying Results
- Load Size Sensor Automates Wash Temperature
- Sanitize Option Eliminates Bacteria and Enhances Drying Results

Efficiency

- 269 kwh/yr - Energy Star®

Convenience

- Electronic delay timer: 1-24 hours Delay Start Timer
- AquaStop® Leak Protection Works 24/7
- Self-Latching Door



Dishwashers

24" Recessed Handle Dishwasher
300 Series- Stainless steel
SHEM63W55N

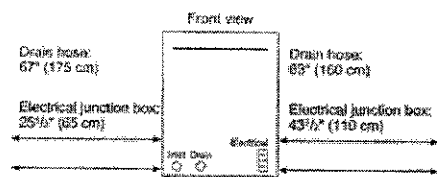

All connections are at the rear of the appliance.
Extension for drain hose available as accessory.
Power cord for connection to electrical outlet (3-prong plug) available as accessory.

Purchaser: **Khan**
Lot: **575-Russell Gardens - Ph. 4.**

Schedule SMART
Russell Gardens Building Ltd. (Phase 4)

Smart Home System includes:

1. One (1) Smart Home Hub installed in a location as determined by the Vendor;
2. One (1) Doorbell camera supplied and installed at front door;
3. One (1) smart home thermostat to be installed in a location as determined by the Vendor;
4. One (1) smart Flood sensor to be installed in a location as determined by the Vendor which is designed to detect water in the location of the sensor only;
5. Smart light switches to be installed in such locations as determined by the Vendor;



Certain devices for The Smart Home System require a fully functioning WiFi network and internet connection and others work on the Zwave wireless network. Provision of WiFi, internet access and functionality shall be the sole responsibility of the Purchaser and the Vendor assumes no responsibility or obligation with respect to the functionality or performance of a homeowner's internet or WiFi network. The Vendor does not guarantee that networks, equipment, or services will meet all homeowner needs.

The Purchaser will be required to download the Homewave Smart Connect App (the "App") in order to configure and set up the Smart Home System devices. The Purchaser is responsible to ensure that they have the appropriate technology to download the App and any charges and fees for download and/or data usage shall be at the Purchaser's sole cost and expense. Access to the App shall be provided free of charge for 1 year from the Closing Date and thereafter the Purchaser may enter into an agreement with Homewave Smart Connect to continue the services for a monthly fee (currently \$10.00/month plus HST). Fees subject to change without notice.

Purchasers are responsible for configuring all security features. The Vendor does not warrant or represent that any network or Smart Home System devices are secure or can prevent all privacy intrusions, malware, or cyber-attacks, even when correctly configured. The products and services for the Smart Home System are provided by third parties, and not the Vendor. The Vendor does not guarantee any equipment or services provided by third parties. If the Purchaser contracts with the third-party provider to upgrade or purchase further devices, the Vendor has no responsibility for same, including but not limited to, the installation, service, safety or functionality of said products.

Energy claims are not based upon specific testing of an individual home but are general assumptions. Savings will vary due to many variables, including but not limited to, actual utility rates and fees, actual construction, floor plan, occupancy, appliance usage, thermostat settings, weather conditions, number of individuals occupying the home and orientation of the home.

The Vendor is providing only those Smart Home System's devices and components listed in this Schedule. Please see the balance of your Agreement of Purchase and Sale for additional information, disclosures, and disclaimers relating to your home and its features. The specific features in a home may vary from home to home and from one community to another. The Vendor reserves the right to substitute equipment, material, appliances and brand names with items of equal or higher value, in its sole and unfettered discretion. The Vendor reserves the right, in its sole and absolute discretion, to omit installation of the Smart Home System, in part or in whole, and the Purchaser shall have no claim for abatement or reduction the Purchase Price or to any delay in closing. Installation of the Smart Home System may result in the elimination of other features listed in Schedule GP or other information material, such as but not limited to set back thermostat, rough-in for alarm or other features deemed redundant as a result of the installation of the Smart Home System.

Purchaser Initials 	Purchaser Initials 
--	--